

# PECCOLE WEST LOT 12-A PHASE 1

Recorded in Book 75 Page 100 of Plats

200 Scale Map Location: L-31-7

Fire Dept. District Map # 2415:84

MASTER SITE ADDRESS: 9750 KING WILLIAM DR

BLOCK A	LOT	1	9801	GAVIN STONE AVE	E/W	PRIVATE STREET	
		2	9805				
BLOCK A	LOT	3	809	NOAHS STAR ST	N/S	PRIVATE STREET	
		4	805				
		5	801				
BLOCK A	LOT	6	9804	CAMDEN HILLS AVE	E/W	PRIVATE STREET	
		7	9800				
		8	9732				
		9	9728				
		10	9724				
		11	9720				
		12	9716				
		13	9712				
		14	9708				
		15	9704				
		16	9700				
BLOCK B	LOT	49	9801	CAMDEN HILLS AVE	E/W	PRIVATE STREET	
		50	9733				
BLOCK B	LOT	51	805	LONE TREE ST	N/S	PRIVATE STREET	
		52	801				
see Pg. 3	BLOCK C	LOT	53	9721	CAMDEN HILLS AVE	E/W	PRIVATE STREET
			54	9717			
			55	9713			
			56	9709			
			57	9705			
			58	9701			
	BLOCK C	LOT	75	9640	GAVIN STONE AVE	E/W	PRIVATE STREET
			76	9700			
			77	9704			
			78	9708			
			79	9712			
			80	9716			
BLOCK D	LOT	41	9701	GAVIN STONE AVE	E/W	PRIVATE STREET	
		42	9705				
		43	9709				
		44	9713				
		45	9717				
		46	9721				
		47	9725				
		48	9729				
Common Area	A		9750	KING WILLIAM DR	E/W	PRIVATE STREET	

# PECCOLE WEST LOT 12-A PHASE 1

Common Area	B	9726	GAVIN STONE AVE	EW	PRIVATE STREET
Common Area	C	824	TYLER BRIDGE LN	N/S	PRIVATE STREET
	D	825			

ORIGINAL DATE: 9/09/1996

**CITY OF LAS VEGAS  
PLANNING & DEVELOPMENT DEPARTMENT**

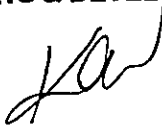

**KYLE C WALTON, SENIOR PLANNER**

★ All of BLOCK C (LOTS 53 - 58, Camden Hills Avenue, and LOTS 75 - 80, Gavin Stone Avenue) are excluded from this map and are shown on the AMENDED PLAT OF PECCOLE WEST LOT 12-A - PHASE 1, recorded in BOOK 79, PAGE 45, Clark County, Nevada Records on May 6, 1997

# PECCOLE WEST LOT 12-A PHASE 1

Recorded in Book 75 Page 100 of Plats

200 Scale Map Location: L-31-7

Fire Dept. District Map # 2415:84

MASTER SITE ADDRESS: 9750 KING WILLIAM DR

BLOCK A	LOT	1	9801	GAVIN STONE AVE	E/W	PRIVATE STREET
		2	9805			

BLOCK A	LOT	3	809	NOAHS STAR ST	N/S	PRIVATE STREET
		4	805			
		5	801			

BLOCK A	LOT	6	9804	CAMDEN HILLS AVE	E/W	PRIVATE STREET
		7	9800			
		8	9732			
		9	9728			
		10	9724			
		11	9720			
		12	9716			
		13	9712			
		14	9708			
		15	9704			
		16	9700			

BLOCK B	LOT	49	9801	CAMDEN HILLS AVE	E/W	PRIVATE STREET
		50	9733			

BLOCK B	LOT	51	805	LONE TREE ST	N/S	PRIVATE STREET
		52	801			

see  
Pg. 3

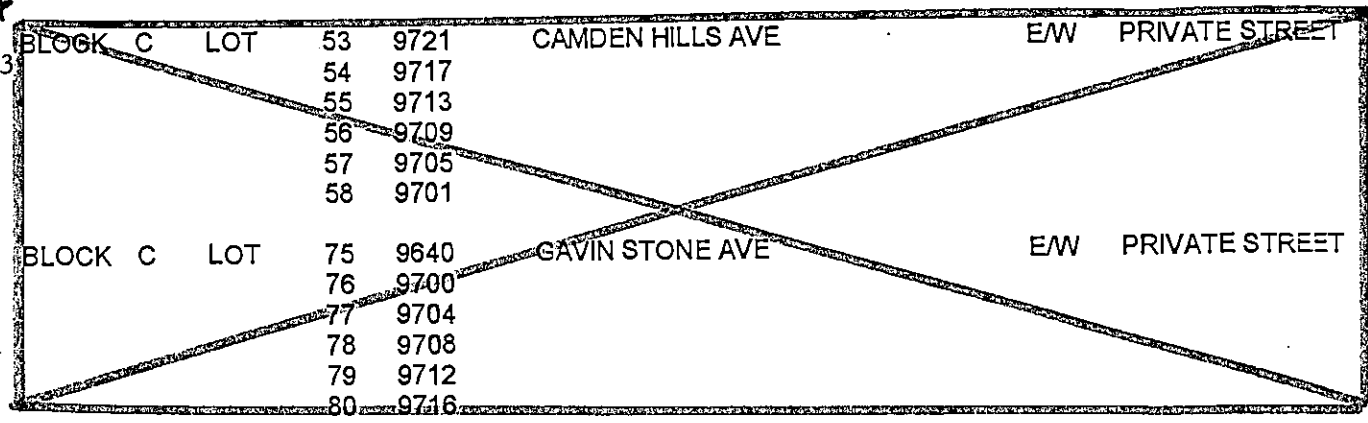

BLOCK D	LOT	41	9701	GAVIN STONE AVE	E/W	PRIVATE STREET
		42	9705			
		43	9709			
		44	9713			
		45	9717			
		46	9721			
		47	9725			
		48	9729			

Common Area	A	9750	KING WILLIAM DR	E/W	PRIVATE STREET
-------------	---	------	-----------------	-----	----------------

# PECCOLE WEST LOT 12-A PHASE 1

Common Area	B	9726	GAVIN STONE AVE	E/W	PRIVATE STREET
Common Area	C	824	TYLER BRIDGE LN	N/S	PRIVATE STREET
	D	825			

ORIGINAL DATE: 9/09/1996

**CITY OF LAS VEGAS  
PLANNING & DEVELOPMENT DEPARTMENT**



**KYLE C WALTON, SENIOR PLANNER**

\* All of BLOCK C (LOTS 53 - 58, Camden Hills Avenue, and LOTS 75 - 80, Gavin Stone Avenue) are excluded from this map and are shown on the AMENDED PLAT OF PECCOLE WEST LOT 12-A - PHASE 1, recorded in BOOK 79, PAGE 45, Clark County, Nevada Records on May 6, 1997

# PECCOLE WEST LOT 12-A PHASE 1

Recorded in Book 75 Page 100 of Plats

200 Scale Map Location: L-31-7

Fire Dept. District Map # 2415:84

MASTER SITE ADDRESS: 9750 KING WILLIAM DR

BLOCK A	LOT	1	9801	GAVIN STONE AVE	EW	PRIVATE STREET	
		2	9805				
BLOCK A	LOT	3	809	NOAHS STAR ST	N/S	PRIVATE STREET	
		4	805				
		5	801				
BLOCK A	LOT	6	9804	CAMDEN HILLS AVE	EW	PRIVATE STREET	
		7	9800				
		8	9732				
		9	9728				
		10	9724				
		11	9720				
		12	9716				
		13	9712				
		14	9708				
		15	9704				
		16	9700				
BLOCK B	LOT	49	9801	CAMDEN HILLS AVE	E/W	PRIVATE STREET	
		50	9733				
BLOCK B	LOT	51	805	LONE TREE ST	N/S	PRIVATE STREET	
		52	801				
<sup>★</sup> see Pg. 3	BLOCK C	LOT	53	9721	CAMDEN HILLS AVE	E/W	PRIVATE STREET
			54	9717			
			55	9713			
			56	9709			
			57	9705			
			58	9701			
	BLOCK C	LOT	75	9640	GAVIN STONE AVE	E/W	PRIVATE STREET
			76	9700			
			77	9704			
			78	9708			
			79	9712			
			80	9716			
BLOCK D	LOT	41	9701	GAVIN STONE AVE	EW	PRIVATE STREET	
		42	9705				
		43	9709				
		44	9713				
		45	9717				
		46	9721				
		47	9725				
		48	9729				
Common Area	A		9750	KING WILLIAM DR	E/W	PRIVATE STREET	

# PECCOLE WEST LOT 12-A PHASE 1

Common Area	B	9726	GAVIN STONE AVE	E/W	PRIVATE STREET
Common Area	C	824	TYLER BRIDGE LN	N/S	PRIVATE STREET
	D	825			

ORIGINAL DATE: 9/09/1996

CITY OF LAS VEGAS  
PLANNING & DEVELOPMENT DEPARTMENT



KYLE C WALTON, SENIOR PLANNER

★ All of BLOCK C (LOTS 53 - 58, Camden Hills Avenue, and LOTS 75 - 80, Gavin Stone Avenue) are excluded from this map and are shown on the AMENDED PLAT OF PECCOLE WEST LOT 12-A - PHASE 1, recorded in BOOK 79, PAGE 45, Clark County, Nevada Records on May 6, 1997