

# Town Center 44/50 NO. 2

Recorded in Book 138 Page 012 of Plats

MASTER SITE ADDRESS: 9372 Echlon Point

Fire Department District Map Number:  
01515-68

<u>Block</u>	<u>Lot</u>	<u>Address</u>
1	1	6701 ROBINSON CANYON CT
1	2	6705
1	3	6709
1	4	6713
1	5	6717
1	6	6721
1	7	6725
1	8	6729
1	9	6733
1	10	6737
1	11	6741
1	12	6745
1	13	6746
1	14	6742
1	15	6738
1	16	6734
1	17	6730
1	18	6726
1	19	6722
1	20	6718
1	21	6714
1	22	6710
1	23	6706
1	24	6702

Mark Rex, Planner I





**SUBDIVISION PLAT ADDRESS TRACKING  
2007**

<u>Plat Entry No. and Map #</u>	<u>Date &amp; Time received</u>	<u>Exact name of subdivision</u>	<u>Recorded date, book / page</u>	<u>Fire map grid #</u>	<u>Master Site Address</u>	<u>No. of Lots / Units</u>	<u>Date addressed &amp; by whom</u>	<u>Date of copy to Eng. / Develop</u>	<u>Date mailed out</u>	<u>Distribution No.</u>
24 #20342	6/26 11:20	SANTA FE SHADOWS CONDOMINIUMS (CONVERSION)	6/22/07 B137/ P35	02517-17	1111 WARBONNET WAY 89117 (Original Address)	124	7/5 M REX	7/9	7/13	21
25 #21434	6/26 2:55	AMENDED PLAT OF A PORTION OF BRIGHTON & KENSINGTON @ PROVIDENCE/ CLIFFS EDGE UNIT 1	6/22/07 B137/ P 34	01514-24	10594 DORRELL LN 89117	7	7/9 M REX	7/9	7/13	22
26 #15912	7/2 2:50	STRATTON 35	6/29/07 B137/ P54	01319-29	8701 N JONES BLVD 89131	77	7/9 M REX	7/9	7/13	23
27 #20383	8/1 1:00	STONEWATER	7/30/07 B137/ P66	01619-86	6266 W ANN RD	32	8/10 J B	8/10	8/13	24
28 #7253	8/8 3:30	BRADLEY ROAD / AZURE AVENUE	4/28/06 B131/ P04	01621-35	5410 W AZURE RD	14	8/9 GREG K	8/10	8/13	25
29 #21871	8/20 9:24	CLIFF'S EDGE POD 201& 203-AMENDED UNIT 4	8/16/07 B137/ P83	01414-21	10810 BROXDEN JUNCTION AVE 89166	32	8/22 JB	8/23		26
30 #17738	09/18 2:30	TOWN CENTER 44/50 NO. 2	9/14/07 B138/P12	01515-68	9372 ECHELON POINT DR 89149	24	9/20/07	9/21/07		27

**SUBDIVISION PLAT ADDRESS TRACKING  
2007**

<u>Plat Entry No. and Map #</u>	<u>Date &amp; Time received</u>	<u>Exact name of subdivision</u>	<u>Recorded date, book / page</u>	<u>Fire map grid #</u>	<u>Master Site Address</u>	<u>No. of Lots / Units</u>	<u>Date addressed &amp; by whom</u>	<u>Date of copy to Eng. / Develop</u>	<u>Date mailed out</u>	<u>Distri bution No.</u>
---	---	----------------------------------	---	----------------------------	----------------------------	------------------------------------	---	---	--------------------------------	----------------------------------

30 #17738	09/18 2:30	TOWN CENTER 44/50 NO. 2	9/14/07 B138/P12	01515-68	9372 ECHELON POINT DR 89149	24	9/21 M REX	9/21		27
--------------	---------------	-------------------------	---------------------	----------	--------------------------------	----	---------------	------	--	----

Town Center 44/50 No. 2

# 1515

© City of Las Vegas 12/19/06

0 250 500 1,000 1,500 2,000 Feet

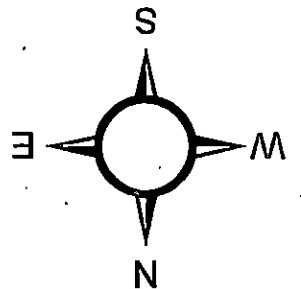

1414	1415	1416
1514	1515	1516
1614	1615	1616

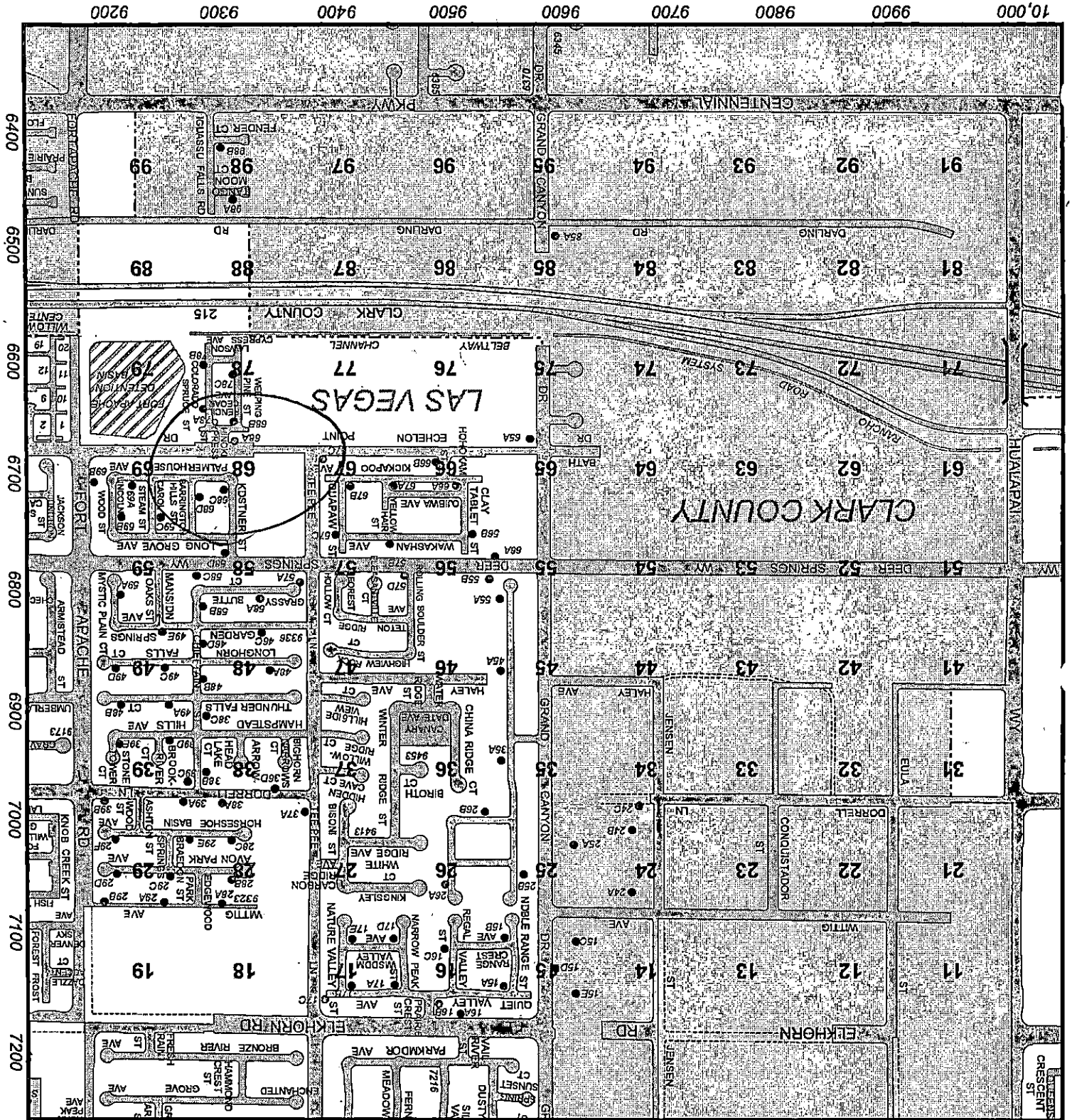

10,000 9900 9800 9700 9600 9500 9400 9300 9200

6400 6500 6600 6700 6800 6900 7000 7100 7200

# Town Center 44/50 NO. 2

Recorded in Book 138 Page 012 of Plats

MASTER SITE ADDRESS: 9372 Echlon Point

Fire Department District Map Number:  
01515-68

<u>Block</u>	<u>Lot</u>	<u>Address</u>
1	1	6701 ROBINSON CANYON CT
1	2	6705
1	3	6709
1	4	6713
1	5	6717
1	6	6721
1	7	6725
1	8	6729
1	9	6733
1	10	6737
1	11	6741
1	12	6745
1	13	6746
1	14	6742
1	15	6738
1	16	6734
1	17	6730
1	18	6726
1	19	6722
1	20	6718
1	21	6714
1	22	6710
1	23	6706
1	24	6702

Mark Rex, Planner I



# Town Center 44/50 NO. 2

Recorded in Book 138 Page 012 of Plats

MASTER SITE ADDRESS: 9372 Echlon Point

Fire Department District Map Number:  
01515-68

<u>Block</u>	<u>Lot</u>	<u>Address</u>
1	1	6701 ROBINSON CANYON CT
1	2	6705
1	3	6709
1	4	6713
1	5	6717
1	6	6721
1	7	6725
1	8	6729
1	9	6733
1	10	6737
1	11	6741
1	12	6745
1	13	6746
1	14	6742
1	15	6738
1	16	6734
1	17	6730
1	18	6726
1	19	6722
1	20	6718
1	21	6714
1	22	6710
1	23	6706
1	24	6702

Mark Rex, Planner I



# Town Center 44/50 NO. 2

Recorded in Book 138 Page 012 of Plats

MASTER SITE ADDRESS: 9372 Echlon Point

Fire Department District Map Number:  
01515-68

<u>Block</u>	<u>Lot</u>	<u>Address</u>
1	1	6701 ROBINSON CANYON CT
1	2	6705
1	3	6709
1	4	6713
1	5	6717
1	6	6721
1	7	6725
1	8	6729
1	9	6733
1	10	6737
1	11	6741
1	12	6745
1	13	6746
1	14	6742
1	15	6738
1	16	6734
1	17	6730
1	18	6726
1	19	6722
1	20	6718
1	21	6714
1	22	6710
1	23	6706
1	24	6702

Mark Rex, Planner I





## TRANSMITTAL

**To:** Ms. Darlene Reeder  
City of Las Vegas  
Planning and Development

**From:** Neil School  
neil@b2ds.com

**Date:** September 18, 2007

**Via:** Hand Deliver

**Re:** Town Center 44/50 No. 2  
FMP #17738 recorded in  
Book 138, Page 12  
Residential Subdivision  
Addressing

**CC:** D. Hale, PH  
G, Nguyen, PH  
T. Steadham, SHG

For Your Review & Approval  
 For Your Review & Comments  
 For Your Records  
 Per Our Discussion

Per Your Request  
 For Your Action  
 For Your Information

• **We have enclosed the following:**

- 1 Duplicate Mylar of Recorded Subdivision Map
- 2 24" x 36" Bond Copy of Recorded Subdivision Map
- 1 11"x 17" Reduced Copy of Recorded Subdivision Map

• **Comments:**

We are requesting the assignment of addresses for the Recorded Final Map of Town Center 44/50 No. 2. Addressing should be sent to the attention of Neil School at fax number (702) 451-4988. Please contact our office if you have any questions or if you require further information. Thank you for your assistance with this project.

CITY OF  
LAS VEGAS  
PLANNING &  
DEVELOPMENT  
**F A X**

Tuesday, September 25, 2007

NO. OF PAGES: 2 (Including this sheet)

TO: Neil School

FROM: ANGIE HORN  
OFFICE SPECIALIST II  
Phone: 702-229-4774

PLANNING &  
DEVELOPMENT



DEVELOPMENT  
SERVICES CENTER

731 South Fourth Street  
Las Vegas, Nevada 89101  
PHONE: 702/229-6301  
FAX: 702/474-0352

**SUBJECT: Address List for Town Center 44/50 No. 2**

FAX NO. 702-451-4988:

If any portion of this transmission is illegible, unreadable or missing, please contact our office at 702-229-6301. Thank you.

TRANSMISSION VERIFICATION REPORT

TIME : 09/25/2007 08:51  
NAME :  
FAX :  
TEL :  
SER.# : BROJ6J530588

DATE, TIME	09/25 08:51
FAX NO./NAME	4514988
DURATION	00:00:17
PAGE(S)	02
RESULT	OK
MODE	STANDARD ECM

CITY OF  
LAS VEGAS  
PLANNING &  
DEVELOPMENT  
**F A X**

Tuesday, September 25, 2007

**NO. OF PAGES: 2** (including this sheet)

**TO: Neil School**

**FROM: ANGIE HORN**  
**OFFICE SPECIALIST II**  
**Phone: 702-229-4774**

PLANNING &  
DEVELOPMENT

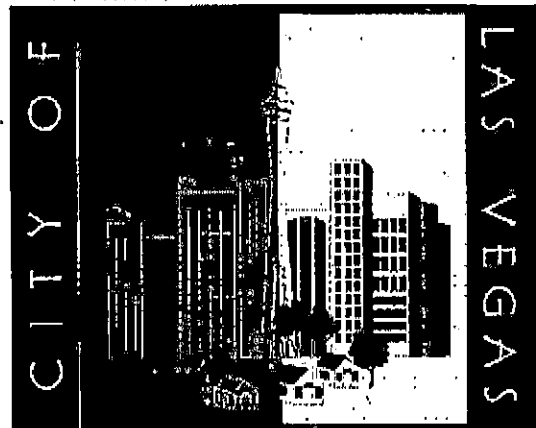

DEVELOPMENT  
SERVICES CENTER

731 South Fourth Street  
Las Vegas, Nevada 89101  
PHONE: 702/229-6301  
FAX: 702/474-0352

**SUBJECT: Address List for Town Center 44/50 No. 2**