

CIMARRON RIDGE UNIT 6

DECEMBER 18, 1992

FIRE MAP #2317::23
200 MAP: L-28-1

BLOCK 5 LOT	248	8240	HERCULES DRIVE	E/W	PUBLIC STREET
	249	8244			
	250	8248			
	251	8252			
	252	8256			
	253	8260			
BLOCK 5 LOT	254	8300	CARMEN BOULEVARD	E/W	PUBLIC STREET
	255	8304			
	256	8308			
	257	8312			
	258	8316			
	259	8320			
	260	8324			
	261	8328			
	262	8332			
	263	8336			
	264	8340			
	265	8344			
	266	8348			
	267	8352			
BLOCK 7 LOT	238	8200	HERCULES DRIVE	E/W	PUBLIC STREET
	239	8204			
	240	8208			
	241	8212			
	242	8216			
	243	8220			
	244	8224			
	245	8228			
	246	8232			
	247	8236			
BLOCK 8 LOT	268	1301	LITTLE DIPPER STREET	N/S	PUBLIC STREET
	269	1305			
	270	1309			
	* 271	1313 1311			
	272	1317			
BLOCK 8 LOT	273	8221	HERCULES DRIVE	E/W	PUBLIC STREET
	274	8225			
	275	8229			
	276	8233			
	277	8257			
	278	8261			
BLOCK 8 LOT	279	8236	CARMEN BOULEVARD	E/W	PUBLIC STREET
	280	8232			
	281	8228			
	282	8224			
	283	8220			
	284	8216			
	285	8212			
	286	8208			
	287	8204			
	288	8200			
STREET WITH NO ADDRESSES: STAR QUAKE WAY				N/S	PUBLIC STREET

CITY OF LAS VEGAS
DEPARTMENT OF COMMUNITY PLANNING
AND DEVELOPMENT

 MATT PINJUV, PLANNER

MASTER SUBDIVISION ADDRESS: 8202 CARMEN BOULEVARD

* Change of address effective 9/1/93
MP/dr

CIMARRON RIDGE UNIT 6

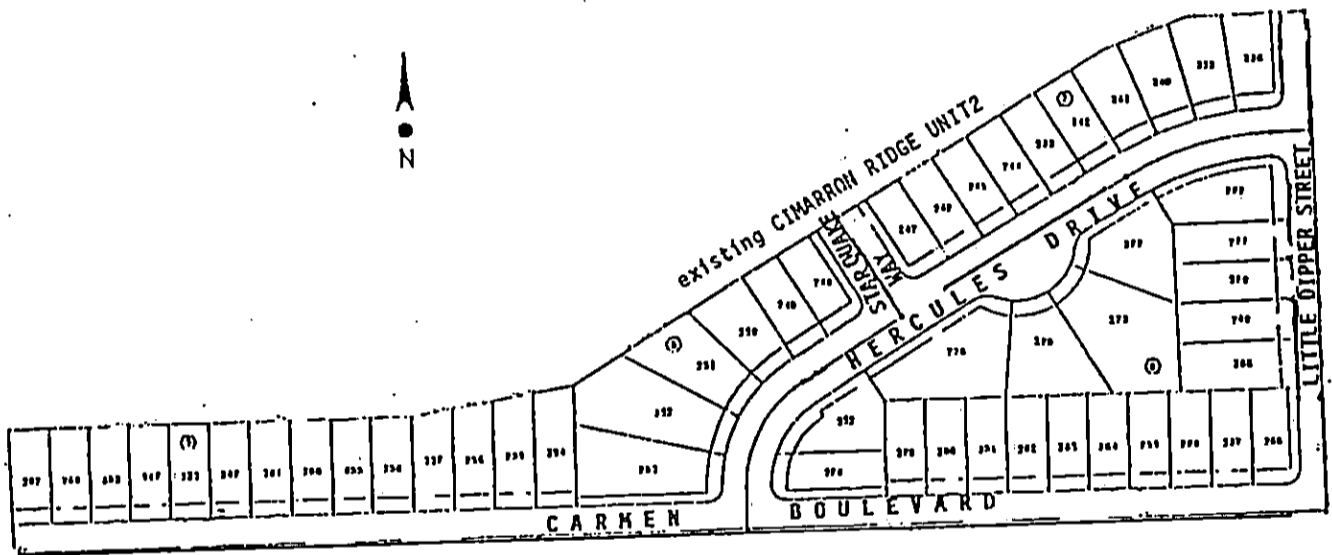

E.J. WOJCIK ENGINEERING
Civil, Mechanical, Electrical
210 South 21st Street, Suite F
Las Vegas, Nevada 89102
Edward A. Wojcik, P.E.
(702) 885-1522