

REFLECTIONS UNIT 1

SEPTEMBER 7, 1993

FIREMAP #2117::14
200 MAP: L-16-2

BLOCK 2	LOT	33	3117	POINT SAL CIRCLE	N/S	PUBLIC STREET
		34	3109			
		35	3105			
		36	3101			
		37	3100			
		38	3104			
		39	3108			
		40	3112			
		41	3116			

BLOCK 3	LOT	56	3128	PISMO BEACH DRIVE	N/S	PUBLIC STREET
		57	3124			
		58	3120			

BLOCK 4	LOT	1	8008	VILLA FINESTRA DRIVE E/W		PUBLIC STREET
		2	8012			
		3	8016			
		4	8100			
		5	8104			
		6	8108			
		7	8112			
		8	8116			
		9	8120			
		10	8124			
		11	8128			
		12	8132			
		13	8133			
		14	8129			
		15	8125			
		16	8121			
		17	8117			
		18	8109			
		19	8105			
		20	8101			

BLOCK 4	LOT	21	8100	NEPTUNE BEACH AVENUE E/W		PUBLIC STREET
		22	8104			
		23	8108			
		24	8112			
		25	8116			
		26	8120			
		27	8124			
		28	8128			

CITY OF LAS VEGAS
DEPARTMENT OF COMMUNITY
PLANNING & DEVELOPMENT

JBH JOHN B. HERBERT, PLANNING ASSISTANT

MASTER SUBDIVISION ADDRESS: 8017 VILLA FINESTRA DRIVE

CHEYENNE AVENUE

JBH/dr

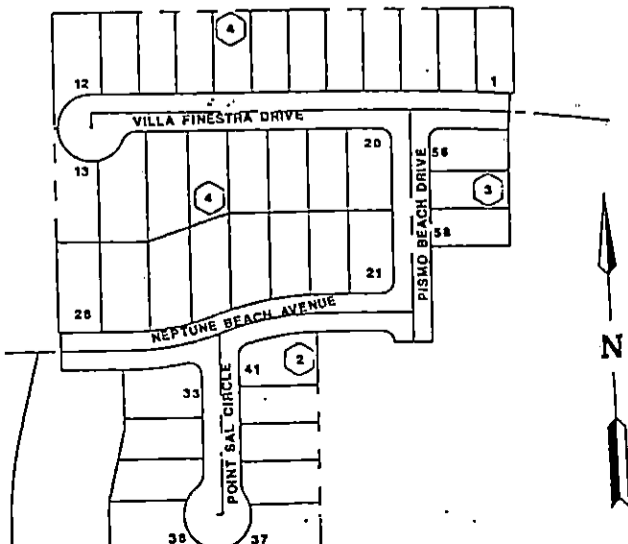

REFLECTIONS UNIT 1

SEPTEMBER 7, 1993

FIREMAP #2117::14
200 MAP: L-16-2

BLOCK 2	LOT	33	3117	POINT SAL CIRCLE	N/S	PUBLIC STREET
		34	3109			
		35	3105			
		36	3101			
		37	3100			
		38	3104			
		39	3108			
		40	3112			
		41	3116			
BLOCK 3	LOT	56	3128	PISMO BEACH DRIVE	N/S	PUBLIC STREET
		57	3124			
		58	3120			
BLOCK 4	LOT	1	8008	VILLA FINESTRA DRIVE E/W		PUBLIC STREET
		2	8012			
		3	8016			
		4	8100			
		5	8104			
		6	8108			
		7	8112			
		8	8116			
		9	8120			
		10	8124			
		11	8128			
		12	8132			
		13	8133			
		14	8129			
		15	8125			
		16	8121			
		17	8117			
		18	8109			
		19	8105			
		20	8101			
BLOCK 4	LOT	21	8100	NEPTUNE BEACH AVENUE E/W		PUBLIC STREET
		22	8104			
		23	8108			
		24	8112			
		25	8116			
		26	8120			
		27	8124			
		28	8128			

CITY OF LAS VEGAS
DEPARTMENT OF COMMUNITY
PLANNING & DEVELOPMENT

 JOHN B. HERBERT, PLANNING ASSISTANT

MASTER SUBDIVISION ADDRESS: 8017 VILLA FINESTRA DRIVE

JBH/dr

REFLECTIONS UNIT 1

SEPTEMBER 7, 1993

FIREMAP #2117::14
200 MAP: L-16-2

BLOCK 2	LOT	33	3117	POINT SAL CIRCLE	N/S	PUBLIC STREET
		34	3109			
		35	3105			
		36	3101			
		37	3100			
		38	3104			
		39	3108			
		40	3112			
		41	3116			
BLOCK 3	LOT	56	3128	PISMO BEACH DRIVE	N/S	PUBLIC STREET
		57	3124			
		58	3120			
BLOCK 4	LOT	1	8008	VILLA FINESTRA DRIVE E/W		PUBLIC STREET
		2	8012			
		3	8016			
		4	8100			
		5	8104			
		6	8108			
		7	8112			
		8	8116			
		9	8120			
		10	8124			
		11	8128			
		12	8132			
		13	8133			
		14	8129			
		15	8125			
		16	8121			
		17	8117			
		18	8109			
		19	8105			
		20	8101			
BLOCK 4	LOT	21	8100	NEPTUNE BEACH AVENUE E/W		PUBLIC STREET
		22	8104			
		23	8108			
		24	8112			
		25	8116			
		26	8120			
		27	8124			
		28	8128			

CITY OF LAS VEGAS
DEPARTMENT OF COMMUNITY
PLANNING & DEVELOPMENT

JA JOHN B. HERBERT, PLANNING ASSISTANT

MASTER SUBDIVISION ADDRESS: 8017 VILLA FINESTRA DRIVE

CHEYENNE AVENUE

JBH/dr

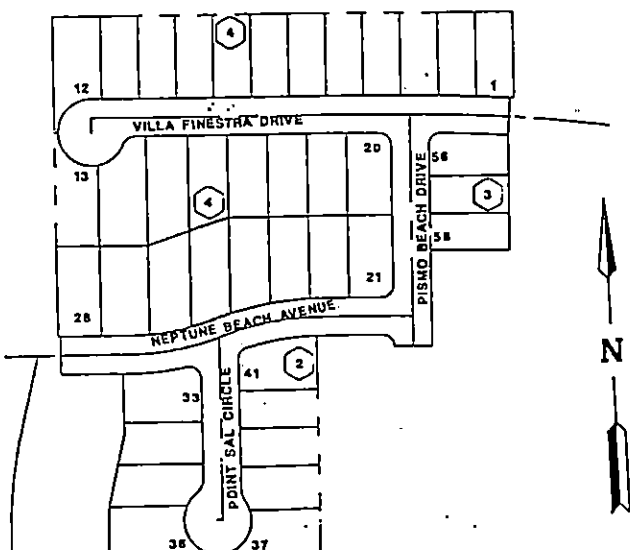

ALPHA ENGINEERING

Tel: (702) 877-1300
50 South Jones, Suite 202
Las Vegas, NV 89107
Fax: (702) 877-0300

Tel: (801) 628-6500
136 North 100 East, Suite 2
St. George, UT 84770
Fax: (801) 628-6553

September 8, 1993

Ms. Rita Lumos, P.L.S.
City Surveyor, City of Las Vegas
400 East Stewart Avenue
Las Vegas, Nevada 89101

Subject: Certificate of Amendment for REFLECTIONS UNIT 1
Filed in the Office of the Clark County, Nevada Recorder in Book 57 of
Plats on Page 98.

Location: Lying within Section 16, Township 20 South, Range 60 East, M.D.M., City
of Las Vegas, Clark County, Nevada.

Dear Ms. Lumos:

Please be advised that in accordance with the provisions of N.R.S. 278.371.2, I, J Edward Leavitt, P.L.S. 5878, acting as agent for Alpha Engineering Company, hereby request that the above referenced Plat be amended to change the name of NEPTUNE BEACH DRIVE, as shown thereon, to NEPTUNE BEACH AVENUE.

Very truly yours,

ALPHA ENGINEERING COMPANY

J Edward Leavitt, P.L.S. 5878

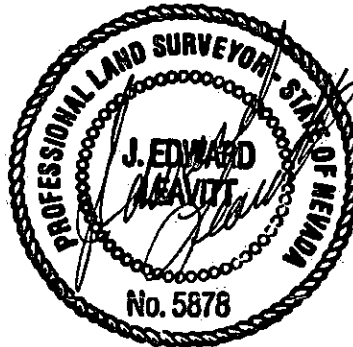

City Surveyor's Certificate

9-08-93

I hereby certify that I have examined the Certificate of Amendment and that the changes to the original document specified therein are provided for in the applicable sections of N.R.S. 278.010 to 278.630 inclusive, N.R.S. 625.340 to 625.380 inclusive and local ordinances adopted pursuant thereto, and I am satisfied that this Certificate of Amendment so amends the document as to make it technically correct.

Paul H. Sullivan PLS 9886

For Rita M. Lumos
Rita M. Lumos, P.L.S. 5094
City Surveyor, City of Las Vegas

9/13/93

CLARK COUNTY, NEVADA			
JOAN L. SWIFT, RECORDER			
RECORDED AT REQUEST OF:			
ALPHA ENGINEERING			
09-13-93	10:54	ALA	1
BOOK: 930913	INST: 00702		
FEE: 5.00	APPT: .00		
CA PLAT			
CONFORMED COPY HAS NOT BEEN COMPARED TO THE ORIGINAL			