

JANUARY 22, 1992

L-19-4,6; L-20-3,5

~~BLOCK A LOT 20 9000 CENTER HILL DRIVE E/W PRIVATE DRIVE~~
~~21 9004~~
~~22 9008~~
~~23 9012~~
~~24 9016~~

~~BLOCK A LOT 25 2100 BALD EAGLE DRIVE N/S PRIVATE DRIVE~~
~~26 2104~~
~~27 2108~~
~~28 2112~~

**BLOCK A LOT 29 9013 NIGHT OWL COURT E/W PRIVATE DRIVE
 ** 30 9009
 ** 31 9005
 ** 32 9001
 33 9004
 34 9012

~~BLOCK A LOT 35 2120 BALD EAGLE DRIVE N/S PRIVATE DRIVE~~

~~BLOCK A LOT 36 9200 WINGED TAIL DRIVE E/W PRIVATE DRIVE~~
~~37 9204~~
~~38 9208~~
~~39 9212~~

BLOCK A LOT 40 9200 GOLDEN EAGLE DRIVE E/W PRIVATE DRIVE
 41 9204
 42 9208
 43 9212
 44 9216
 45 9220
 46 9224

BLOCK A LOT 47 2049 GROUSE STREET N/S PRIVATE DRIVE
 48 2045
 49 2041
 50 2037
 51 2033
 52 2029
 53 2025
 54 2021
 55 2017
 56 2013
 57 2009
 58 2005
 59 2001 - Changed to 1921 REDBIRD DRIVE 7/22/97

BLOCK A LOT 60 1913 REDBIRD DRIVE N/S PRIVATE DRIVE
 61 1909
 62 1905
 63 1901

BLOCK A LOT 64 1817 WHITE HAWK COURT N/S PRIVATE DRIVE
 65 1813
 66 1809
 67 1805
 68 1801
 69 1804
 70 1808
 71 1812

BLOCK B LOT 72 9201 GOLDEN EAGLE DRIVE E/W PRIVATE DRIVE

~~BLOCK B LOT 73 9224 WINGED TAIL DRIVE E/W PRIVATE DRIVE~~
~~74 9228~~
~~75 9232~~
~~76 9236~~
~~77 9240~~
~~78 9244~~
~~79 9248~~

**CORRECTED PAGE FOR BLOCK A, LOTS 29-32 NIGHT OWL COURT (10/14/92)

THE LINED-OUT ADDRESSES ARE THE PORTION OF EAGLE HILLS (AMENDED)>>>>>

EAGLE HILLS
JANUARY 22, 1992

PAGE 3
L-19-4,6; L-20-3,5

BLOCK D LOT	130	9100	EAGLE HILLS DRIVE	E/W	PRIVATE DRIVE
	131	9108			
	132	9112			
	133	9116			
	134	9120			
	135	9124			

BLOCK D LOT	136	1904	RED ROBIN COURT	N/S	PRIVATE DRIVE
	137	1908			
	138	1909			
	139	1905			
	140	1901			

BLOCK D LOT	141	1900	SOARING COURT	N/S	PRIVATE DRIVE
	142	1904			
	143	1908			
	144	1909			
	145	1905			
	146	1901			

BLOCK E LOT	1	9221	EAGLE HILLS DRIVE	E/W	PRIVATE DRIVE
	2	9217			
	3	9213			
	4	9209			
	5	9205			
	6	9201			
	7	9129			
	8	9125			
	9	9121			
	10	9117			
	11	9113			
	12	9109			
	13	9105			
	14	9101			

~~BLOCK E LOT 15 2000 BALD EAGLE DRIVE N/S PRIVATE DRIVE~~
~~16 2004~~

~~BLOCK E LOT 17 9021 CENTER HILL DRIVE E/W PRIVATE DRIVE~~
~~18 9017~~
~~19 9013~~

COMMON AREA:

LOT A	1900	REDBIRD DRIVE	N/S	PRIVATE DRIVE
LOT B	1803	HILLS DRIVE	N/S	PUBLIC STREET
C	1803			
D	1822			
LOT E	1802	WHITE HAWK COURT	N/S	PRIVATE DRIVE
LOT F	9002	NIGHT OWL COURT	E/W	PRIVATE DRIVE
LOT G	8990	CENTER HILL DRIVE	E/W	PRIVATE DRIVE

STREETS WITH NO ADDRESSES:

GOLF CENTER DRIVE
TOWN CENTER DRIVE
HILLPOINTE ROAD
LONGSPUR DRIVE

CITY OF LAS VEGAS
DEPARTMENT OF COMMUNITY
PLANNING & DEVELOPMENT



MATT PINJUV
PLANNER

MP/dr

EAGLE HILLS

L-19-4,6; L-20-3,5

JANUARY 22, 1992

~~BLOCK A LOT 20 9000 CENTER HILL DRIVE E/W PRIVATE DRIVE~~
~~21 9004~~
~~22 9006~~
~~23 9012~~
~~24 9016~~

~~BLOCK A LOT 25 2100 BALD EAGLE DRIVE N/S PRIVATE DRIVE~~
~~26 2104~~
~~27 2108~~
~~28 2112~~

**BLOCK A LOT 29 9013 NIGHT OWL COURT E/W PRIVATE DRIVE
 ** 30 9009
 ** 31 9005
 ** 32 9001
 33 9004
 34 9012

~~BLOCK A LOT 35 2120 BALD EAGLE DRIVE N/S PRIVATE DRIVE~~

~~BLOCK A LOT 36 9200 WINGED TAIL DRIVE E/W PRIVATE DRIVE~~
~~37 9204~~
~~38 9208~~
~~39 9212~~

BLOCK A LOT 40 9200 GOLDEN EAGLE DRIVE E/W PRIVATE DRIVE
 41 9204
 42 9208
 43 9212
 44 9216
 45 9220
 46 9224

BLOCK A LOT 47 2049 GROUSE STREET N/S PRIVATE DRIVE
 48 2045
 49 2041
 50 2037
 51 2033
 52 2029
 53 2025
 54 2021
 55 2017
 56 2013
 57 2009
 58 2005
 59 2001

Changed to 1921 REDBIRD DRIVE 7/22/97

BLOCK A LOT 60 1913 REDBIRD DRIVE N/S PRIVATE DRIVE
 61 1909
 62 1905
 63 1901

BLOCK A LOT 64 1817 WHITE HAWK COURT N/S PRIVATE DRIVE
 65 1813
 66 1809
 67 1805
 68 1801
 69 1804
 70 1808
 71 1812

BLOCK B LOT 72 9201 GOLDEN EAGLE DRIVE E/W PRIVATE DRIVE

~~BLOCK B LOT 73 9221 WINGED TAIL DRIVE E/W PRIVATE DRIVE~~
~~74 9226~~
~~75 9232~~
~~76 9236~~
~~77 9242~~
~~78 9248~~
~~79 9254~~

**CORRECTED PAGE FOR BLOCK A, LOTS 29-32 NIGHT OWL COURT (10/14/92)

EAGLE HILLS

JANUARY 22, 1992

L-19-4,6; L-20-3,5

BLOCK A LOT	20	9000	CENTER HILL DRIVE	E/W	PRIVATE DRIVE
	21	9004			
	22	9008			
	23	9012			
	24	9016			
BLOCK A LOT	25	2100	BALD EAGLE DRIVE	N/S	PRIVATE DRIVE
	26	2104			
	27	2108			
	28	2112			
**BLOCK A LOT	29	9013	NIGHT OWL COURT	E/W	PRIVATE DRIVE
**	30	9009			
**	31	9005			
**	32	9001			
	33	9004			
	34	9012			
BLOCK A LOT	35	2120	BALD EAGLE DRIVE	N/S	PRIVATE DRIVE
BLOCK A LOT	36	9200	WINGED TAIL DRIVE	E/W	PRIVATE DRIVE
	37	9204			
	38	9208			
	39	9212			
BLOCK A LOT	40	9200	GOLDEN EAGLE DRIVE	E/W	PRIVATE DRIVE
	41	9204			
	42	9208			
	43	9212			
	44	9216			
	45	9220			
	46	9224			
BLOCK A LOT	47	2049	GROUSE STREET	N/S	PRIVATE DRIVE
	48	2045			
	49	2041			
	50	2037			
	51	2033			
	52	2029			
	53	2025			
	54	2021			
	55	2017			
	56	2013			
	57	2009			
	58	2005			
	59	2001			
			Changed to 1921 REDBIRD DRIVE 7/22/97		
BLOCK A LOT	60	1913	REDBIRD DRIVE	N/S	PRIVATE DRIVE
	61	1909			
	62	1905			
	63	1901			
BLOCK A LOT	64	1817	WHITE HAWK COURT	N/S	PRIVATE DRIVE
	65	1813			
	66	1809			
	67	1805			
	68	1801			
	69	1804			
	70	1808			
	71	1812			
BLOCK B LOT	72	9201	GOLDEN EAGLE DRIVE	E/W	PRIVATE DRIVE
BLOCK B LOT	73	9224	WINGED TAIL DRIVE	E/W	PRIVATE DRIVE
	74	9228			
	75	9232			
	76	9236			
	77	9240			
	78	9244			
	79	9248			

**CORRECTED PAGE FOR BLOCK A, LOTS 29-32 NIGHT OWL COURT (10/14/92)



G.C. WALLACE, INC.
Engineering/Architecture

620.701EM1

July 24, 1992

Mrs. Rita M. Lumos
City Surveyor
City of Las Vegas
400 East Stewart Avenue
Las Vegas, Nevada 89101

Subject: **Certificate of Amendment**
"Eagle Hills"

Location: Lying Within Sections 19 and 20, Township 20 South,
Range 60 East, M.D.M.

Dear Mrs. Lumos:

In accordance with the provisions of N.R.S. No. 278.473, it is hereby requested that the subdivision plat of "Eagle Hills," filed July 29, 1991, in Book 50, Page 35 of Plats in the Clark County Recorder's Office, Clark County, Nevada, be amended in the following manner:

1. All of the building setback lines, together with all references thereto on Sheets 3 through 8 inclusive, are to be deleted.

Very truly yours,

G. C. WALLACE, INC.

Allen L. Hagen
Professional Land Surveyor
P.L.S. #7755

/sjl



City Surveyor's Certificate

I hereby certify that I have examined the Certificate of Amendment and that the changes to the original document specified therein are provided for in the applicable sections of N.R.S. 278.010 to 278.630 inclusive, N.R.S. 625.340 to 625.380 inclusive, and local ordinances adopted pursuant thereto, and I am satisfied that this Certificate of Amendment so amends the document as to make it technically correct.

Rita M. Lumos
City Surveyor
P.L.S. #5094

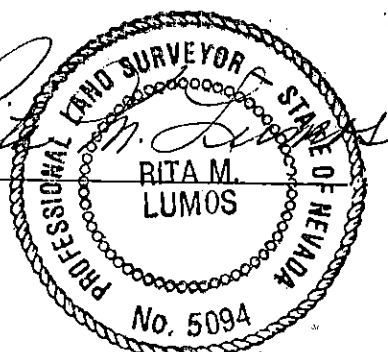

CLARK COUNTY, NEVADA
JOAN L. SWIFT, RECORDER
RECORDED AT REQUEST OF:
GC WALLACE

08-05-92 15:33 SEN 1
OFFICIAL RECORDS
BOOK: 920805 INST: 01057

FEE: 5.00 RPTT: .00
MAP TYPE PL BOOK/PAGE 050/0035

RETURN TO

9 1 1 2 1 2 0 0 7 0 2



G.C. WALLACE, P.E.
TERRILL B. ADAMS
CALVIN L. BLACK, P.E.
JAMES A. DUDDLESTEN, P.E.
DAVID HUCKLE, P.E.
JACK H. MITCHELL, P.E.
MICHAEL D. ROSS, P.E.
RONALD R. THOMAS
MARIE RAINWATER

CHRISTOPHER W. ANDERSON, P.E.
L. STEVEN ANDERSON, P.E.
MICHAEL J. CSIZMADIA, P.E.
DAN STUART DAVIS, ARCHITECT
C. RUSSELL DAVIS, S.E.
HOWARD L. HARRIS, P.E.
DONALD A. HASELHOF, P.E.
MICHAEL S. KOIZUMI, P.E.
MARC A. LEMOINE
SCOTT R. PLUMMER, P.E.
HOWARD K. VANDER MEER, P.E.

620.314L

November 20, 1991

Mrs. Rita M. Lumos, P.L.S.
City Surveyor
City of Las Vegas
400 East Stewart Avenue
Las Vegas, Nevada 89101

JIM BAKKEDAHL, P.E.
RICHARD G. CLARKE
R. GUY DOTY, P.L.S.
JEFFREY J. FREIBERG, P.E.
DOUGLAS M. HANKEL
ROBERT J. HERMAN
KRISTOFER D. KORPI
MARVIN W. MAIZE
BENJAMIN C. SMITH, P.E.
KATHY R. SMITH, P.E.
RICHARD STRUTZ
JOHN R. TOBIN, P.E.
SAUNDRA L. VANCE, CCS

**Subject: Certificate of Amendment
"Eagle Hills," Filed July 29, 1991, in Book 50, Page 35 of Plats in the Clark
County Recorder's Office, Clark County, Nevada**

Location: Lying Within Sections 19 and 20, Township 20 South, Range 60 East, M.D.M.

Dear Mrs. Lumos:

In accordance with the provisions of N.R.S. No. 278.473, it is hereby requested that the subdivision plat of "Eagle Hills," filed July 29, 1991, in Book 50, Page 35 of Plats in the Clark County Recorder's Office, Clark County, Nevada, be amended in the following manner:

On sheet 8 of 8 of "Eagle Hills," Lockspur Drive to be revised to Longspur Drive.

Very truly yours,

R. Guy Doty, P.L.S.
Professional Land Surveyor
P.L.S. #7635

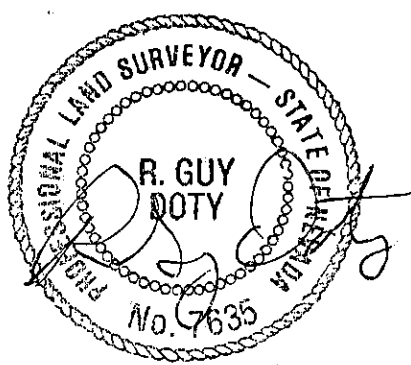

12-4-91

/tp

City Surveyor's Certificate

I hereby certify that I have examined the Certificate of Amendment and that the changes to the original document specified thereon are provided for in the applicable sections of N.R.S. 278.010 to 278.630 inclusive, N.R.S. 625.340 to 625.380 inclusive, and local ordinances adopted pursuant thereto, and I am satisfied that this Certificate of Amendment so amends the document as to make it technically correct.

Rita M. Lumos
City Surveyor
P.L.S. #5094

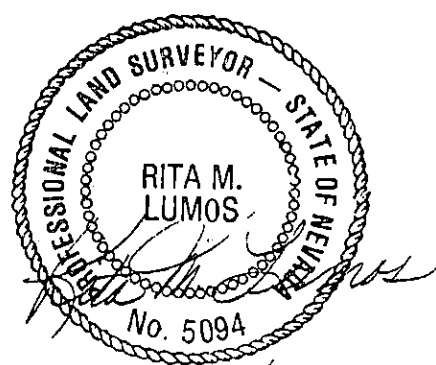

12/11/91

Return to:

G.C. Wallace, Inc.
1555 SOUTH RAINBOW BLVD./LAS VEGAS, NEVADA 89102/TELEPHONE: (702) 363-1200/FAX: 363-8979