

SANTA MARGARITA CONDOMINIUMS  
MAY 19, 1993

FIRE MAP #2519:41,51  
200 MAP:Q-2-3

<..LEGAL DESCRIPTION..>	<<.....	MAILING ADDRESS.....>>			
BUILDING 9 UNIT	9C	1620 DAVILLA STREET	NO.	202	
	9D			104	
	9E			204	
	9F			203	
BUILDING 10 UNIT	10A	1621 SANDECKER COURT	NO.	101	N/S
	10B			201	
	10C			202	
	10D			104	
	10E			204	
	10F			203	
BUILDING 11 UNIT	11A	1620 SANDECKER COURT	NO.	101	N/S
	11B			201	
	11C			202	
	11D			104	
	11E			204	
	11F			203	
BUILDING 12 UNIT	12A	1700 SANDECKER COURT	NO.	101	N/S
	12B			201	
	12C			202	
	12D			104	
	12E			204	
	12F			203	
BUILDING 13 UNIT	13A	1701 SANDECKER COURT	NO.	101	N/S
	13B			201	
	13C			202	
	13D			104	
	13E			204	
	13F			203	
BUILDING 14 UNIT	14A	6821 SANTA ISABEL AVENUE	NO.	101	E/W
	14B			201	
	14C			202	
	14D			104	
	14E			204	
	14F			203	
COMMON AREA	A	1601 SANTA MARGARITA STREET			PUBLIC STREET
		[RECREATION AREA]			
COMMON AREA	B	1701 SANTA MARGARITA STREET			
COMMON AREA	C	[IS THE PRIVATE DRIVE AND PUBLIC UTILITY EASEMENT - NO ADDRESS ASSIGNED]			
(Note: As indicated for common area "c", the drives within this subdivision are Private)					
STREET WITH NO ADDRESSES:		OAKLEY BOULEVARD			PUBLIC STREET

CITY OF LAS VEGAS  
DEPARTMENT OF COMMUNITY  
PLANNING & DEVELOPMENT

JOHN HERBERT  
PLANNING ASSISTANT

JH/dr

MASTER SUBDIVISION ADDRESS: 1771 SANTA MARGARITA STREET

SANTA MARGARITA  
CONDOMINIUMS

MAY 19, 1993

FIRE MAP #2519::41,51  
200 MAP:Q-2-3

<..LEGAL DESCRIPTION..>		<<..... MAILING ADDRESS.....>>				
BUILDING 1 UNIT	1A	1500	OSCAR COURT	NO.	101	N/S
	1B				201	
	1C				202	
	1D				104	
	1E				204	
	1F				203	
BUILDING 2 UNIT	2A	1501	OSCAR COURT	NO.	101	N/S
	2B				201	
	2C				202	
	2D				104	
	2E				204	
	2F				203	
BUILDING 3 UNIT	3A	6820	SAN RICARDO AVENUE	NO.	101	E/W
	3B				201	
	3C				202	
	3D				104	
	3E				204	
	3F				203	
BUILDING 4 UNIT	4A	6811	SAN RICARDO AVENUE	NO.	101	E/W
	4B				201	
	4C				202	
	4D				104	
	4E				204	
	4F				203	
BUILDING 5 UNIT	5A	6801	SAN RICARDO AVENUE	NO.	101	E/W
	5B				201	
	5C				202	
	5D				104	
	5E				204	
	5F				203	
BUILDING 6 UNIT	6A	1600	DAVILLA STREET	NO.	101	N/S
	6B				201	
	6C				202	
	6D				104	
	6E				204	
	6F				203	
BUILDING 7 UNIT	7A	1610	DAVILLA STREET	NO.	101	N/S
	7B				201	
	7C				202	
	7D				104	
	7E				204	
	7F				203	
BUILDING 8 UNIT	8A	1610	SANDECKER COURT	NO.	101	N/S
	8B				201	
	8C				202	
	8D				104	
	8E				204	
	8F				203	
BUILDING 9 UNIT	9A	1620	DAVILLA STREET	NO.	101	N/S
	9B				201	

SANTA MARGARITA CONDOMINIUMS  
MAY 19, 1993

FIRE MAP #2519::41,51  
200 MAP:Q-2-3

<..LEGAL DESCRIPTION..>		<<..... MAILING ADDRESS.....>>				
BUILDING 9 UNIT	9C	1620	DAVILLA STREET	NO.	202	
	9D				104	
	9E				204	
	9F				203	
BUILDING 10 UNIT	10A	1621	SANDECKER COURT	NO.	101	N/S
	10B				201	
	10C				202	
	10D				104	
	10E				204	
	10F				203	
BUILDING 11 UNIT	11A	1620	SANDECKER COURT	NO.	101	N/S
	11B				201	
	11C				202	
	11D				104	
	11E				204	
	11F				203	
BUILDING 12 UNIT	12A	1700	SANDECKER COURT	NO.	101	N/S
	12B				201	
	12C				202	
	12D				104	
	12E				204	
	12F				203	
BUILDING 13 UNIT	13A	1701	SANDECKER COURT	NO.	101	N/S
	13B				201	
	13C				202	
	13D				104	
	13E				204	
	13F				203	
BUILDING 14 UNIT	14A	6821	SANTA ISABEL AVENUE	NO.	101	E/W
	14B				201	
	14C				202	
	14D				104	
	14E				204	
	14F				203	
COMMON AREA	A	1601	SANTA MARGARITA STREET			PUBLIC STREET
	[RECREATION AREA]					
COMMON AREA	B	1701	SANTA MARGARITA STREET			
COMMON AREA	C	[IS THE PRIVATE DRIVE AND PUBLIC UTILITY EASEMENT - NO ADDRESS ASSIGNED]				

(Note: As indicated for common area "c", the drives within this subdivision are Private)

STREET WITH NO ADDRESSES: OAKLEY BOULEVARD PUBLIC STREET

CITY OF LAS VEGAS  
DEPARTMENT OF COMMUNITY  
PLANNING & DEVELOPMENT

JOHN HERBERT  
PLANNING ASSISTANT

JH/dr

MASTER SUBDIVISION ADDRESS: 1771 SANTA MARGARITA STREET

SANTA MARGARITA  
CONDOMINIUMS

MAY 19, 1993

FIRE MAP #2519::41,51  
200 MAP:Q-2-3

<..LEGAL DESCRIPTION..>		<<..... MAILING ADDRESS.....>>				
BUILDING 1 UNIT	1A	1500	OSCAR COURT	NO.	101	N/S
	1B				201	
	1C				202	
	1D				104	
	1E				204	
	1F				203	
BUILDING 2 UNIT	2A	1501	OSCAR COURT	NO.	101	N/S
	2B				201	
	2C				202	
	2D				104	
	2E				204	
	2F				203	
BUILDING 3 UNIT	3A	6820	SAN RICARDO AVENUE	NO.	101	E/W
	3B				201	
	3C				202	
	3D				104	
	3E				204	
	3F				203	
BUILDING 4 UNIT	4A	6811	SAN RICARDO AVENUE	NO.	101	E/W
	4B				201	
	4C				202	
	4D				104	
	4E				204	
	4F				203	
BUILDING 5 UNIT	5A	6801	SAN RICARDO AVENUE	NO.	101	E/W
	5B				201	
	5C				202	
	5D				104	
	5E				204	
	5F				203	
BUILDING 6 UNIT	6A	1600	DAVILLA STREET	NO.	101	N/S
	6B				201	
	6C				202	
	6D				104	
	6E				204	
	6F				203	
BUILDING 7 UNIT	7A	1610	DAVILLA STREET	NO.	101	N/S
	7B				201	
	7C				202	
	7D				104	
	7E				204	
	7F				203	
BUILDING 8 UNIT	8A	1610	SANDECKER COURT	NO.	101	N/S
	8B				201	
	8C				202	
	8D				104	
	8E				204	
	8F				203	
BUILDING 9 UNIT	9A	1620	DAVILLA STREET	NO.	101	N/S
	9B				201	

SANTA MARGARITA CONDOMINIUMS  
MAY 19, 1993

FIRE MAP #2519::41,51  
200 MAP:Q-2-3

<..LEGAL DESCRIPTION..>		<<..... MAILING ADDRESS.....>>	
BUILDING 9 UNIT	9C 9D 9E 9F	1620	DAVILLA STREET NO. 202 104 204 203
BUILDING 10 UNIT	10A 10B 10C 10D 10E 10F	1621	SANDECKER COURT NO. 101 N/S 201 202 104 204 203
BUILDING 11 UNIT	11A 11B 11C 11D 11E 11F	1620	SANDECKER COURT NO. 101 N/S 201 202 104 204 203
BUILDING 12 UNIT	12A 12B 12C 12D 12E 12F	1700	SANDECKER COURT NO. 101 N/S 201 202 104 204 203
BUILDING 13 UNIT	13A 13B 13C 13D 13E 13F	1701	SANDECKER COURT NO. 101 N/S 201 202 104 204 203
BUILDING 14 UNIT	14A 14B 14C 14D 14E 14F	6821	SANTA ISABEL AVENUE NO. 101 E/W 201 202 104 204 203
COMMON AREA	A <u>[RECREATION AREA]</u>	1601	SANTA MARGARITA STREET PUBLIC STREET
COMMON AREA	B	1701	SANTA MARGARITA STREET
COMMON AREA	C	[IS THE PRIVATE DRIVE AND PUBLIC UTILITY EASEMENT - NO ADDRESS ASSIGNED]	
(Note: As indicated for common area "c", the drives within this subdivision are Private)			
STREET WITH NO ADDRESSES:		OAKLEY BOULEVARD	PUBLIC STREET

CITY OF LAS VEGAS  
DEPARTMENT OF COMMUNITY  
PLANNING & DEVELOPMENT

JOHN HERBERT  
PLANNING ASSISTANT  
JH/dr

MASTER SUBDIVISION ADDRESS: 1771 SANTA MARGARITA STREET

SANTA MARGARITA  
CONDOMINIUMS

MAY 19, 1993

FIRE MAP #2519::41,51  
200 MAP:Q-2-3

<..LEGAL DESCRIPTION..>		<<..... MAILING ADDRESS.....>>				
BUILDING 1 UNIT	1A	1500	OSCAR COURT	NO.	101	N/S
	1B				201	
	1C				202	
	1D				104	
	1E				204	
	1F				203	
BUILDING 2 UNIT	2A	1501	OSCAR COURT	NO.	101	N/S
	2B				201	
	2C				202	
	2D				104	
	2E				204	
	2F				203	
BUILDING 3 UNIT	3A	6820	SAN RICARDO AVENUE	NO.	101	E/W
	3B				201	
	3C				202	
	3D				104	
	3E				204	
	3F				203	
BUILDING 4 UNIT	4A	6811	SAN RICARDO AVENUE	NO.	101	E/W
	4B				201	
	4C				202	
	4D				104	
	4E				204	
	4F				203	
BUILDING 5 UNIT	5A	6801	SAN RICARDO AVENUE	NO.	101	E/W
	5B				201	
	5C				202	
	5D				104	
	5E				204	
	5F				203	
BUILDING 6 UNIT	6A	1600	DAVILLA STREET	NO.	101	N/S
	6B				201	
	6C				202	
	6D				104	
	6E				204	
	6F				203	
BUILDING 7 UNIT	7A	1610	DAVILLA STREET	NO.	101	N/S
	7B				201	
	7C				202	
	7D				104	
	7E				204	
	7F				203	
BUILDING 8 UNIT	8A	1610	SANDECKER COURT	NO.	101	N/S
	8B				201	
	8C				202	
	8D				104	
	8E				204	
	8F				203	
BUILDING 9 UNIT	9A	1620	DAVILLA STREET	NO.	101	N/S
	9B				201	

SANTA MARGARITA CONDOMINIUMS  
MAY 19, 1993

FIRE MAP #2519::41,51  
200 MAP:Q-2-3

<..LEGAL DESCRIPTION..>		<<..... MAILING ADDRESS.....>>			
BUILDING 9 UNIT	9C 9D 9E 9F	1620	DAVILLA STREET	NO.	202 104 204 203
BUILDING 10 UNIT	10A 10B 10C 10D 10E 10F	1621	SANDECKER COURT	NO.	101 201 202 104 204 203
BUILDING 11 UNIT	11A 11B 11C 11D 11E 11F	1620	SANDECKER COURT	NO.	101 201 202 104 204 203
BUILDING 12 UNIT	12A 12B 12C 12D 12E 12F	1700	SANDECKER COURT	NO.	101 201 202 104 204 203
BUILDING 13 UNIT	13A 13B 13C 13D 13E 13F	1701	SANDECKER COURT	NO.	101 201 202 104 204 203
BUILDING 14 UNIT	14A 14B 14C 14D 14E 14F	6821	SANTA ISABEL AVENUE	NO.	101 201 202 104 204 203
COMMON AREA	A [RECREATION AREA]	1601	SANTA MARGARITA STREET	PUBLIC STREET	
COMMON AREA	B	1701	SANTA MARGARITA STREET		
COMMON AREA	C	[IS THE PRIVATE DRIVE AND PUBLIC UTILITY EASEMENT - NO ADDRESS ASSIGNED]			
(Note: As indicated for common area "c", the drives within this subdivision are Private)					
STREET WITH NO ADDRESSES:		OAKLEY BOULEVARD		PUBLIC STREET	

CITY OF LAS VEGAS  
DEPARTMENT OF COMMUNITY  
PLANNING & DEVELOPMENT

JOHN HERBERT  
PLANNING ASSISTANT  
JH/dr

MASTER SUBDIVISION ADDRESS: 1771 SANTA MARGARITA STREET

SANTA MARGARITA  
CONDOMINIUMS

MAY 19, 1993

FIRE MAP #2519::41,51  
200 MAP:Q-2-3

<..LEGAL DESCRIPTION..>		<<..... MAILING ADDRESS.....>>				
BUILDING 1 UNIT	1A	1500	OSCAR COURT	NO.	101	N/S
	1B				201	
	1C				202	
	1D				104	
	1E				204	
	1F				203	
BUILDING 2 UNIT	2A	1501	OSCAR COURT	NO.	101	N/S
	2B				201	
	2C				202	
	2D				104	
	2E				204	
	2F				203	
BUILDING 3 UNIT	3A	6820	SAN RICARDO AVENUE	NO.	101	E/W
	3B				201	
	3C				202	
	3D				104	
	3E				204	
	3F				203	
BUILDING 4 UNIT	4A	6811	SAN RICARDO AVENUE	NO.	101	E/W
	4B				201	
	4C				202	
	4D				104	
	4E				204	
	4F				203	
BUILDING 5 UNIT	5A	6801	SAN RICARDO AVENUE	NO.	101	E/W
	5B				201	
	5C				202	
	5D				104	
	5E				204	
	5F				203	
BUILDING 6 UNIT	6A	1600	DAVILLA STREET	NO.	101	N/S
	6B				201	
	6C				202	
	6D				104	
	6E				204	
	6F				203	
BUILDING 7 UNIT	7A	1610	DAVILLA STREET	NO.	101	N/S
	7B				201	
	7C				202	
	7D				104	
	7E				204	
	7F				203	
BUILDING 8 UNIT	8A	1610	SANDECKER COURT	NO.	101	N/S
	8B				201	
	8C				202	
	8D				104	
	8E				204	
	8F				203	
BUILDING 9 UNIT	9A	1620	DAVILLA STREET	NO.	101	N/S
	9B				201	

SANTA MARGARITA  
CONDOMINIUMS

MAY 19, 1993

FIRE MAP #2519::41,51  
200 MAP:Q-2-3

<..LEGAL DESCRIPTION..>		<<..... MAILING ADDRESS.....>>					
BUILDING 1	UNIT 1A	1500	OSCAR COURT	NO.	101	N/S	
	1B				201		
	1C				202		
	1D				104		
	1E				204		
	1F				203		
BUILDING 2	UNIT 2A	1501	OSCAR COURT	NO.	101	N/S	
	2B				201		
	2C				202		
	2D				104		
	2E				204		
	2F				203		
BUILDING 3	UNIT 3A	6820	SAN RICARDO AVENUE	NO.	101	E/W	
	3B				201		
	3C				202		
	3D				104		
	3E				204		
	3F				203		
BUILDING 4	UNIT 4A	6811	SAN RICARDO AVENUE	NO.	101	E/W	
	4B				201		
	4C				202		
	4D				104		
	4E				204		
	4F				203		
BUILDING 5	UNIT 5A	6801	SAN RICARDO AVENUE	NO.	101	E/W	
	5B				201		
	5C				202		
	5D				104		
	5E				204		
	5F				203		
BUILDING 6	UNIT 6A	1600	DAVILLA STREET	NO.	101	N/S	
	6B				201		
	6C				202		
	6D				104		
	6E				204		
	6F				203		
BUILDING 7	UNIT 7A	1610	DAVILLA STREET	NO.	101	N/S	
	7B				201		
	7C				202		
	7D				104		
	7E				204		
	7F				203		
BUILDING 8	UNIT 8A	1610	SANDECKER COURT	NO.	101	N/S	
	8B				201		
	8C				202		
	8D				104		
	8E				204		
	8F				203		
BUILDING 9	UNIT 9A	1620	DAVILLA STREET	NO.	101	N/S	
	9B				201		

<..LEGAL DESCRIPTION..>	<<.....>>	MAILING ADDRESS.....>>				
BUILDING 9 UNIT 9C	1620	DAVILLA STREET	NO.	202		
9D				104		
9E				204		
9F				203		
BUILDING 10 UNIT 10A	1621	SANDECKER COURT	NO.	101	N/S	
10B				201		
10C				202		
10D				104		
10E				204		
10F				203		
BUILDING 11 UNIT 11A	1620	SANDECKER COURT	NO.	101	N/S	
11B				201		
11C				202		
11D				104		
11E				204		
11F				203		
BUILDING 12 UNIT 12A	1700	SANDECKER COURT	NO.	101	N/S	
12B				201		
12C				202		
12D				104		
12E				204		
12F				203		
BUILDING 13 UNIT 13A	1701	SANDECKER COURT	NO.	101	N/S	
13B				201		
13C				202		
13D				104		
13E				204		
13F				203		
BUILDING 14 UNIT 14A	6821	SANTA ISABEL AVENUE	NO.	101	E/W	
14B				201		
14C				202		
14D				104		
14E				204		
14F				203		

COMMON AREA A 1601 SANTA MARGARITA STREET PUBLIC STREET  
[RECREATION AREA]

COMMON AREA B 1701 SANTA MARGARITA STREET

COMMON AREA C [IS THE PRIVATE DRIVE AND PUBLIC UTILITY  
EASEMENT - NO ADDRESS ASSIGNED]

(Note: As indicated for common area "c", the drives within this subdivision are Private)

STREET WITH NO ADDRESSES: OAKLEY BOULEVARD PUBLIC STREET

CITY OF LAS VEGAS  
DEPARTMENT OF COMMUNITY  
PLANNING & DEVELOPMENT

JOHN HERBERT  
PLANNING ASSISTANT

JH/dr

MASTER SUBDIVISION ADDRESS: 1771 SANTA MARGARITA STREET

# SANTA MARGARITA CONDOMINIUMS

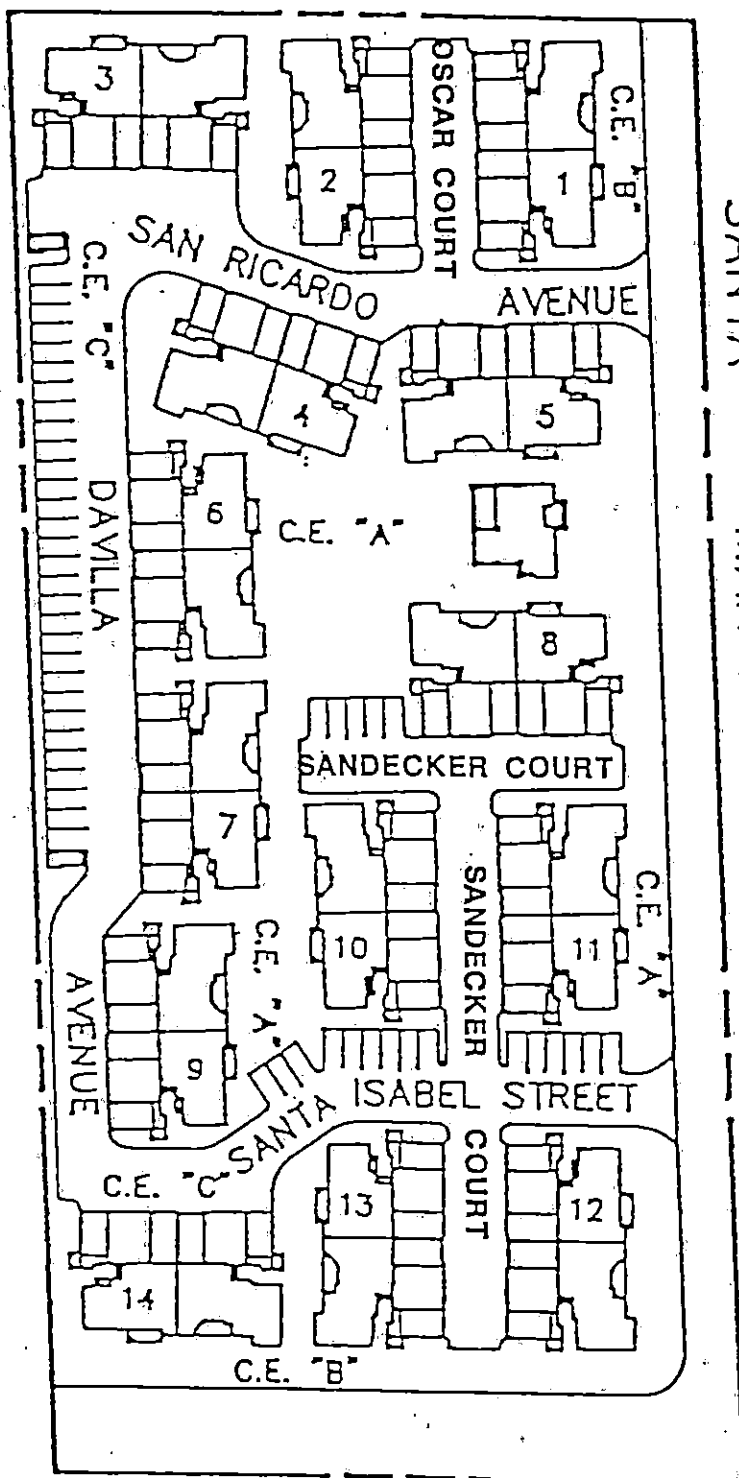

WEST OAKLEY BOULEVARD

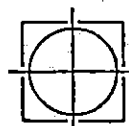

**ESI** ENGINEERS AND SURVEYORS INC.  
PLANNERS • CONSULTING ENGINEERS • SURVEYORS

7018 W. CHARLESTON BLVD. • LAS VEGAS, NEVADA 89117 • 17021363-6415