

MSA 1501 Chaparral Summit Dr.

ASCOT PARK

APRIL 3, 1991

Q-6-1,3

MAY 29, 1991 CORRECTIONS ON PAGE 5 ONLY

BLOCK 1	LOT				
		14	9729	NORTHERN DANCER DRIVE	E/W PRIVATE DRIVE
		15	9733		
		16	9737		
		17	9741		
		18	9745		
		19	9749		
		20	9753		
		21	9757		
		22	9761		
		23	9765		
		24	9769		
		25	9772		
		26	9768		
		27	9764		
		28	9760		
		29	9756		
BLOCK 1	LOT	30	1613	SADDLE ROCK CIRCLE	N/S PRIVATE DRIVE
		31	1609		
		32	1605		
		33	1600		
		34	1604		
		35	1608		
BLOCK 1	LOT	36	9740	NORTHERN DANCER DRIVE	E/W PRIVATE DRIVE
		37	9736		
BLOCK 1	LOT	38	1617	CHAPARRAL SUMMIT DRIVE	N/S PRIVATE DRIVE
		39	1613		
		40	1609		
		41	1605		
		42	1601		
BLOCK 1	LOT	43	9729	DERBYHILL CIRCLE	E/W PRIVATE DRIVE
		44	9733		
		45	9737		
		46	9741		
		47	9745		
		48	9749		
		49	9753		
		50	9757		
		51	9761		
		52	9765		
		53	9769		
		54	9773		
		55	9776		
		56	9772		
		57	9768		
		58	9764		
		59	9760		
		60	9756		
		61	9752		
		62	9748		
		63	9744		
		64	9740		
		65	9736		
		66	9728		
BLOCK 1	LOT	67	9733	LOST COLT CIRCLE	E/W PRIVATE DRIVE
		68	9737		
		69	9741		
		70	9745		
		71	9749		
		72	9753		
		73	9757		
		74	9761		
		75	9765		

ASCOT PARK

PAGE 2
Q-6-1,3

BLOCK 1	LOT	76	9769	LOST COLT CIRCLE	E/W PRIVATE DRIVE
		77	9773		
		78	9776		
		79	9772		
		80	9768		
		81	9764		
		82	9760		
		83	9752		
		84	9748		
		85	9744		
		86	9740		
		87	9736		
		88	9732		
BLOCK 1	LOT	89	9733	HORSE BACK CIRCLE	E/W PRIVATE DRIVE
		90	9737		
		91	9741		
		92	9745		
		93	9749		
		94	9753		
		95	9757		
		96	9761		
		97	9765		
		98	9769		
		99	9772		
		100	9768		
		101	9764		
		102	9760		
		103	9756		
		104	9752		
105	9744				
106	9740				
BLOCK 1	LOT	107	1433	CHAPARRAL SUMMIT DRIVE	N/S PRIVATE DRIVE
		108	1429		
		109	1425		
BLOCK 1	LOT	110	9741	BOOTSTRAP CIRCLE	E/W PRIVATE DRIVE
		111	9748		
		112	9744		
		113	9740		
BLOCK 1	LOT	114	1413	CHAPARRAL SUMMIT DRIVE	N/S PRIVATE DRIVE
		115	1409		
		116	1405		
		117	1401		
BLOCK 1	LOT	118	9749	HITCHING RAIL DRIVE	E/W PRIVATE DRIVE
		119	9757		
		120	9761		
		121	9765		
		122	9769		
		123	9773		
		124	9768		
		125	9764		
		126	9760		
		127	9756		
		128	9752		
		129	9748		
		130	9744		
BLOCK 1	LOT	131	1333	CHAPARRAL SUMMIT DRIVE	N/S PRIVATE DRIVE
		132	1329		
		133	1325		
		134	1321		

ASCOT PARK

PAGE 3
Q-6-1,3

BLOCK 1	LOT	135	9761	TRAIL RIDER DRIVE	E/W PRIVATE DRIVE
		136	9765		
		137	9769		
		138	9773		
		139	9777		
		140	9781		
		141	9785		
		142	9780		
		143	9776		
		144	9772		
		145	9768		
		146	9764		
		147	9760		
		148	9756		
		149	9752		
BLDCK 1	LOT	150	1313	CHAPARRAL SUMMIT DRIVE	N/S PRIVATE DRIVE
		151	1309		
		152	1305		
		153	1301		
		154	1300		
		155	1304		
		156	1308		
		157	1312		
BLOCK 1	LOT	158	9744	TRAIL RIDER DRIVE	E/W PRIVATE DRIVE
		159	9740		
		160	9736		
		161	9732		
		162	9728		
		163	9724		
		164	9720		
		165	9716		
		166	9712		
		167	9704		
		168	9701		
		169	9705		
		170	9709		
		171	9713		
		172	9717		
		173	9721		
BLOCK 1	LOT	174	9708	HITCHING RAIL DRIVE	E/W PRIVATE DRIVE
		175	9704		
		176	9700		
BLOCK 1	LOT	177	1408	UNBRIDLED CIRCLE	N/S PRIVATE DRIVE
		178	1404		
		179	1400		
		180	1401		
		181	1405		
		182	1409		
BLOCK 1	LOT	183	1408	COUNTRY HOLLOW DRIVE	N/S PRIVATE DRIVE
		184	1412		
		185	1416		
		186	1420		
		187	1424		
		188	1428		
		189	1432		
		190	1436		
		191	1440		
		192	1444		
		193	1500		
		194	1504		
		195	1508		
		196	1512		
		197	1516		

BLOCK 2	LOT	1	1600	COUNTRY HOLLOW DRIVE	N/S PRIVATE DRIVE
		2	1604		
		3	1608		
		4	1612		
		5	1616		
		6	1620		
		7	1624		
BLOCK 2	LOT	8	9701	NORTHERN DANCER DRIVE	E/W PRIVATE DRIVE
		9	9705		
		10	9709		
		11	9713		
		12	9717		
		13	9721		
BLOCK 3	LOT	198	9701	ENGLISH SADDLE CIRCLE	E/W PRIVATE DRIVE
		199	9705		
		200	9709		
		201	9713		
		202	9712		
		203	9708		
		204	9704		
BLOCK 3	LOT	205	1505	COUNTRY HOLLOW DRIVE	N/S PRIVATE DRIVE
		206	1501		
		207	1445		
		208	1441		
BLOCK 3	LOT	209	9709	POLO CIRCLE	E/W PRIVATE DRIVE
		210	9713		
		211	9717		
		212	9720		
		213	9716		
		214	9712		
		215	9708		
BLOCK 3	LOT	216	1433	COUNTRY HOLLOW DRIVE	N/S PRIVATE DRIVE
		217	1429		
		218	1425		
		219	1421		
		220	1417		
		221	1413		
		222	1409		
		223	1405		
		224	1401		
		BLOCK 3	LOT		
226	9709				
BLOCK 3	LOT	227	1412	GOLDENSPUR LANE	N/S PRIVATE DRIVE
		228	1416		
		229	1420		
		230	1424		
		231	1428		
		232	1432		
		233	1437		
		234	1433		
		235	1429		
		236	1425		
		237	1421		
		238	1417		
		239	1413		
		240	1409		
BLOCK 3	LOT	241	1405	HITCHING RAIL DRIVE	E/W PRIVATE DRIVE
		242	1401		
BLOCK 3	LOT	243	9725	HITCHING RAIL DRIVE	E/W PRIVATE DRIVE
		244	9729		

ASCOT PARK
** see Block 3 and note

PAGE 5
Q-6-1,3

BLOCK 3	LOT	245	1400	CHAPARRAL SUMMIT DRIVE	N/S	PRIVATE DRIVE
		246	1404			
		247	1412			
		248	1416			
		249	1420			
		250	1424			
		251	1428			
		252	1432			
		253	1436			
		254	1440			
		255	1444			
		256	1448			
		257	1452			
		258	1500			
		259	1504			
		260	1508			
		262 1	1512			
		263 2	1516			
		264 3	1520			
		265 4	1524			
		266 5	1528			
BLOCK 4	LOT	266	9716	HITCHING RAIL DRIVE	E/W	PRIVATE DRIVE
		267	9720			
		268	9724			
		269	9728			
		270	9732			
		271	9736			
BLOCK 4	LOT	272	1324	CHAPARRAL SUMMIT DRIVE	N/S	PRIVATE DRIVE
BLOCK 4	LOT	273	9749	TRAIL RIDER DRIVE	E/W	PRIVATE DRIVE
		274	9745			
		275	9741			
		276	9737			
		277	9733			
		278	9729			
		279	9725			
COMMON AREA LOTS:	A	1627		CHAPARRAL SUMMIT DRIVE	N/S	PRIVATE DRIVE
	B	1626				
	C	9703		STARTING GATE LANE	E/W	PRIVATE DRIVE
	D	9702				
	E	9708		TRAIL RIDER DRIVE	E/W	PRIVATE DRIVE
	F	1631		CHAPARRAL SUMMIT DRIVE	N/S	PRIVATE DRIVE
	G	9706		STARTING GATE LANE	E/W	PRIVATE DRIVE
	H	9712		NORTHERN DANCER DRIVE	E/W	PRIVATE DRIVE
STREETS WITH NO ADDRESSES:				HOMESTRETCH DRIVE	E/W	PUBLIC STREET
				GRAND CANYON DRIVE	N/S	PUBLIC STREET

MATT PINJUY
PLANNER

MP/dr

**This is the only page with corrections (BLOCK 3, LOTS 261 - 265)
due to an amendment for the Recorded Plat Map dated April 4, 1991

April 4, 1991

TO: City of Las Vegas

CERTIFICATE OF AMENDMENT

This Certificate is to amend the Ascot Park Final Map recorded March 27, 1991 in Book 49 Page 19, on file in the Clark County, Nevada Recorders office, in the following manner:

On Sheet 7 of 7 of the map the lots adjacent to Chaparral Drive in Block 3 are numbered incorrectly.

- Lot Number Shown as 261 Should be 260
- Lot Number Shown as 262 Should be 261
- Lot Number Shown as 263 Should be 262
- Lot Number Shown as 264 Should be 263
- Lot Number Shown as 265 Should be 264
- Lot Number Shown as 266 Should be 265

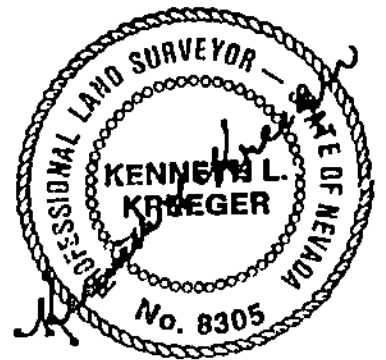

4-4-91

Kenneth L. Kreeger
 Kenneth L. Kreeger P.L.S. 8305

I hereby certify that I have examined the certificate of amendment and that the changes to the original document specified therein are provided for in applicable sections of NRS 278.010 to 278.630, inclusive, NRS 625.340 to 625.380, inclusive, and local ordinances adopted pursuant thereto, and I am satisfied that this certificate of amendment so amends the document as to make it technically correct.

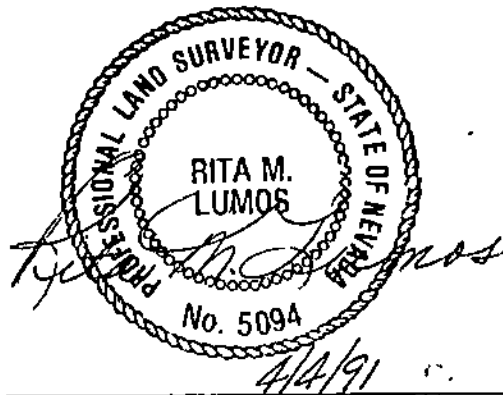

4/4/91
 Rita M. Lumos P.L.S. 5094
 City of Las Vegas Surveyor

CLARK COUNTY, NEVADA
 JOAN L. SWIFT, RECORDER
 RECORDED AT REQUEST OF:
 SOUTHWEST ENGINEERING

04-08-91 15:28 LCC 1
 OFFICIAL RECORDS
 BOOK: 910408 INST: 00888

FEE: 5.00 RPTT: .00
 MAP TYPE PL BOOK/PAGE 049/0019

RETURN TO

SOUTHWEST ENGINEERING
 5426 Vegas Drive Las Vegas N.V. 89108
 5426 W. VEGAS DRIVE • LAS VEGAS, NEVADA 89108
 (702) 648-9700