

SUMMERLIN VILLAGE 1 SOUTH PARCEL 1

May 9, 1996

Fire Map: 2315:16A and 17A
L-30-2

=====

GENERAL SITE ADDRESS: 1499 HILLSHIRE DRIVE

Lot 1	Block A	1551 Hillshire Drive	Raytheon Office Building
Lot 2	Block A	9500 Hillwood Drive	Summerlin Office Building
Common Lot A	Block A	1582 Town Center Drive	
Common Lot B	Block A	1549 Hillshire Drive	
Common Lot C	Block A	9502 Hillwood Drive	
Common Lot D	Block A	1552 Town Center Drive	
Lot 3	Block B	9551 Hillwood Drive	VACANT
Common Lot E	Block A	9559 Hillwood Drive	

**CITY OF LAS VEGAS
PLANNING AND DEVELOPMENT
DEPARTMENT**



**KYLE WALTON
SENIOR PLANNER**

KW:BM:cl

SUMMERLIN VILLAGE 1 SOUTH PARCEL 1

May 9, 1996

Fire Map: 2315:16A and 17A
L-30-2



GENERAL SITE ADDRESS: 1499 HILLSHIRE DRIVE

Lot 1	Block A	1551 Hillshire Drive	Raytheon Office Building
Lot 2	Block A	9500 Hillwood Drive	Summerlin Office Building
Common Lot A	Block A	1582 Town Center Drive	
Common Lot B	Block A	1549 Hillshire Drive	
Common Lot C	Block A	9502 Hillwood Drive	
Common Lot D	Block A	1552 Town Center Drive	
Lot 3	Block B	9551 Hillwood Drive	VACANT
Common Lot E	Block A	9559 Hillwood Drive	

**CITY OF LAS VEGAS
PLANNING AND DEVELOPMENT
DEPARTMENT**

**KYLE WALTON
SENIOR PLANNER**

KW:BM:cj



G.C. WALLACE, INC.
Engineering/Architecture

620.314SL8

June 11, 1992

Mrs. Rita M. Lumos
City Surveyor
City of Las Vegas
400 East Stewart Avenue
Las Vegas, Nevada 89101

Subject: **Certificate of Amendment**
"Summerlin Village 1 South - Parcel 1"

Location: Lying Within Sections 19 and 30, Township 20 South,
Range 60 East, M.D.M.

Dear Mrs. Lumos:

In accordance with the provisions of N.R.S. No. 278.473, it is hereby requested that the subdivision plat of "Summerlin Village 1 South - Parcel 1", filed December 2, 1991, in Book 51, Page 26 of Plats in the Clark County Recorder's Office, Clark County, Nevada, be amended in the following manner:

1. On Sheet 2 of 4, Town Center Drive from the circle north be revised to Hills Center Drive.
2. On Sheet 3 of 4, Village Center Drive be revised to Village Center Circle.

Very truly yours,

G. C. WALLACE, INC.

Allen L. Hagēn
Professional Land Surveyor
P.L.S. #7755

/sjl



City Surveyor's Certificate

I hereby certify that I have examined the Certificate of Amendment and that the changes to the original document specified therein are provided for in the applicable sections of N.R.S. 278.010 to 278.630 inclusive, N.R.S. 625.340 to 625.380 inclusive, and local ordinances adopted pursuant thereto, and I am satisfied that this Certificate of Amendment so amends the document as to make it technically correct.

Rita M. Lumos

 Rita M. Lumos
 City Surveyor
 P.L.S. #5094

6/16/92

CLARK COUNTY, NEVADA			
JOAN L. SWIFT, RECORDER			
RECORDED AT REQUEST OF:			
GC WALLACE			
06-17-92	13:43	NA1	1
BOOK	920617	INST	00979
FEE:	5.00	RPTT:	.00
CA PLAT			
CONFORMED COPY HAS NOT BEEN COMPARED TO THE ORIGINAL			

G.C. WALLACE, P.E.
 TERRILL B. ADAMS
 CALVIN L. BLACK, P.E.
 JAMES A. DUDDLESTEN, P.E.
 DAVID HUCKLE, P.E.
 JACK H. MITCHELL, P.E.
 MICHAEL D. ROSS, P.E.
 RONALD R. THOMAS
 MARIE RAINWATER

CHRISTOPHER W. ANDERSON, P.E.
 L. STEVEN ANDERSON, P.E.
 MICHAEL J. CSIZMADIA, P.E.
 DAN STUART DAVIS, ARCHITECT
 C. RUSSELL DAVIS, S.E.
 HOWARD L. HARRIS, P.E.
 DONALD A. HASELHOFF, P.E.
 MICHAEL S. KOIZUMI, P.E.
 MARC A. LEMOINE, ARCHITECT
 SCOTT R. PLUMMER, P.E.
 HOWARD K. VANDER MEER, P.E.

JIM BAKKEDAHL, P.E.
 RICHARD G. CLARKE
 JEFFREY J. FREIBERG, P.E.
 ALLEN L. HAGEN, P.L.S.
 DOUGLAS M. HANKEL
 ROBERT J. HERMAN
 KRISTOFER D. KORPI
 MARVIN W. MAIZE
 BENJAMIN C. SMITH, P.E.
 KATHY R. SMITH, P.E.
 RICHARD STRUTZ
 JOHN R. TOBIN, P.E.
 SAUNDRA L. VANCE, CCS

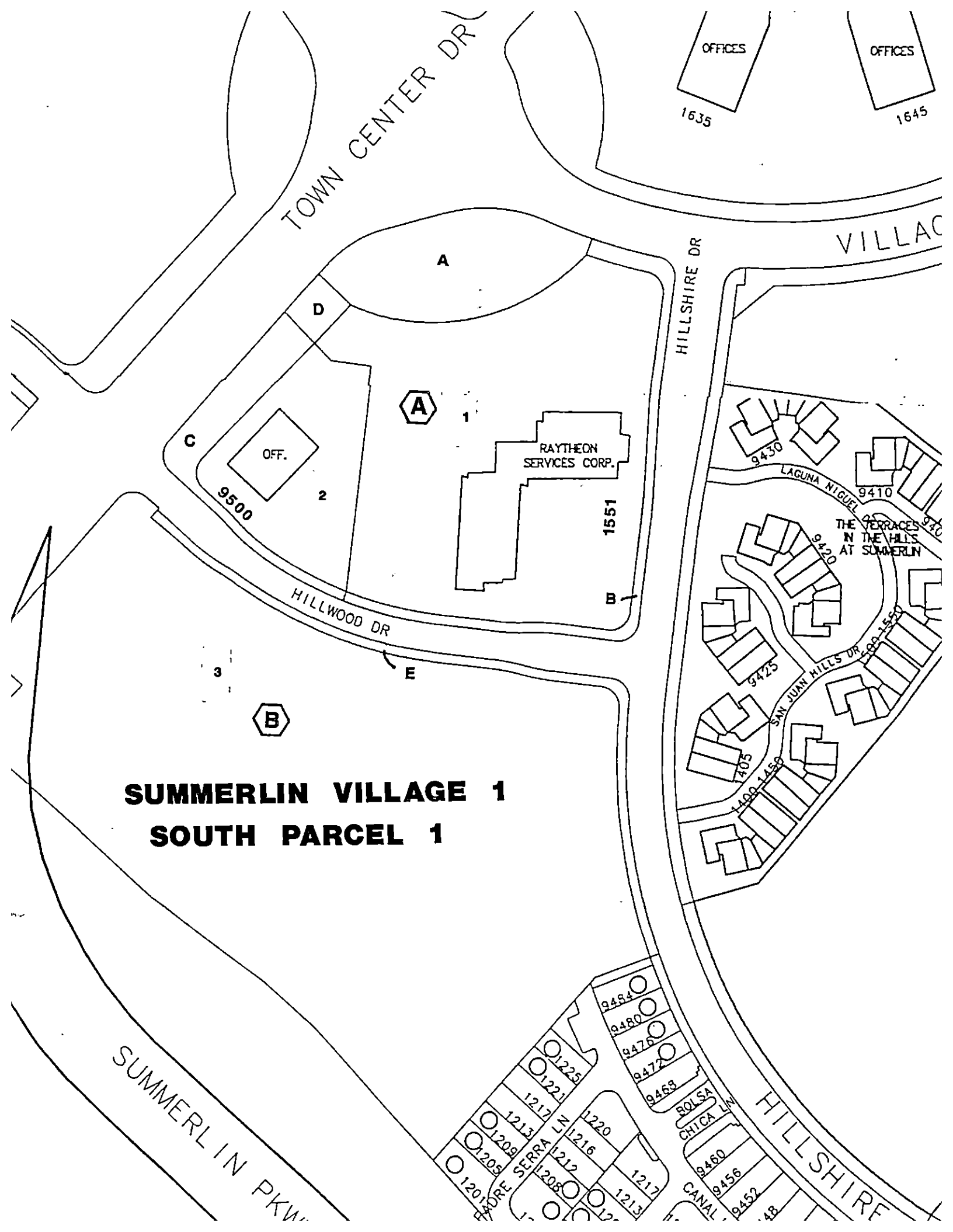

**SUMMERLIN VILLAGE 1
SOUTH PARCEL 1**

TOWN CENTER DR

OFFICES 1635
OFFICES 1645

VILLAGE

HILLSHIRE DR

A
OFF. 9500
RAYTHEON SERVICES CORP. 1551
B
C
D
E

9430
9410
9420
9425
405
1400-1450
LAGUNA NIGUEL
SAN JUAN HILLS DR
THE TERRACES IN THE HILLS AT SUMMERLIN

B

3

SUMMERLIN PKWY

9484
9480
9476
9472
9468
1225
1223
1217
1213
1209
1205
1201
1220
1216
1212
1208
1217
1213
9460
9456
9452
HILLSHIRE
CANAL
ROLSA
CHITCA LN