

# MANNETTA LANE CONDOMINIUMS

Recorded in Book 81 Page 24 of Plats

200 Scale Map Location: L-25-1

Fire Dept. District Map # 2321:25

MASTER SITE ADDRESS: 1401 MICHAEL WAY

BLDG	A	UNIT	101 102 103 104 201 202	1401	MICHAEL WAY	157 158 159 160 259 260	N/S	PUBLIC STREET
BLDG	B	UNIT	101 102 103 104 201 202	1401	MICHAEL WAY	153 154 155 156 255 256	N/S	PUBLIC STREET
BLDG	C	UNIT	101 102 103 104 201 202	1401	MICHAEL WAY	149 150 151 152 251 252	N/S	PUBLIC STREET
BLDG	D	UNIT	101 102 103 104 201 202	1401	MICHAEL WAY	145 146 147 148 247 248	N/S	PUBLIC STREET
BLDG	E	UNIT	101 102 103 104 201 202	1401	MICHAEL WAY	141 142 143 144 243 244	N/S	PUBLIC STREET
BLDG	F	UNIT	101 102 103 104 201 202	1401	MICHAEL WAY	137 138 139 140 239 240	N/S	PUBLIC STREET
BLDG	G	UNIT	101 102 103 104 201 202	1401	MICHAEL WAY	133 134 135 136 235 236	N/S	PUBLIC STREET
BLDG	H	UNIT	101	1401	MICHAEL WAY	129	N/S	PUBLIC STREET

NOTE: All internal drive lanes are Private Drives

# MANNETTA LANE CONDOMINIUMS

BLDG	H	UNIT	102 103 104 201 202	1401	MICHAEL WAY	130 131 132 231 232	N/S	PUBLIC STREET
BLDG	J	UNIT	101 102 103 104 201 202	1401	MICHAEL WAY	125 126 127 128 227 228	N/S	PUBLIC STREET
BLDG	K	UNIT	101 102 103 104 201 202	1401	MICHAEL WAY	121 122 123 124 223 224	N/S	PUBLIC STREET
BLDG	L	UNIT	101 102 103 104 201 202	1401	MICHAEL WAY	117 118 119 120 219 220	N/S	PUBLIC STREET
BLDG	M	UNIT	101 102 103 104 201 202	1401	MICHAEL WAY	113 114 115 116 215 216	N/S	PUBLIC STREET
BLDG	N	UNIT	101 102 103 104 201 202	1401	MICHAEL WAY	109 110 111 112 211 212	N/S	PUBLIC STREET
BLDG	O	UNIT	101 102 103 104 201 202	1401	MICHAEL WAY	105 106 108 107 207 208	N/S	PUBLIC STREET
BLDG	P	UNIT	101 102 103 104 201 202	1401	MICHAEL WAY	101 102 103 104 203 204	N/S	PUBLIC STREET
Common Area				1401	MICHAEL WAY		N/S	PUBLIC STREET

Street with no addresses: VEGAS DRIVE

ORIGINAL DATE: 9/08/1997

CITY OF LAS VEGAS  
PLANNING & DEVELOPMENT DEPARTMENT

  
JOHN B HERBERT, PLANNER I

# MANNETTA LANE CONDOMINIUMS

Recorded in Book 81 Page 24 of Plats

200 Scale Map Location: L-25-1

Fire Dept. District Map # 2321:25

MASTER SITE ADDRESS: 1401 MICHAEL WAY

BLDG	A	UNIT	101 102 103 104 201 202	1401	MICHAEL WAY	157 158 159 160 259 260	N/S	PUBLIC STREET
BLDG	B	UNIT	101 102 103 104 201 202	1401	MICHAEL WAY	153 154 155 156 255 256	N/S	PUBLIC STREET
BLDG	C	UNIT	101 102 103 104 201 202	1401	MICHAEL WAY	149 150 151 152 251 252	N/S	PUBLIC STREET
BLDG	D	UNIT	101 102 103 104 201 202	1401	MICHAEL WAY	145 146 147 148 247 248	N/S	PUBLIC STREET
BLDG	E	UNIT	101 102 103 104 201 202	1401	MICHAEL WAY	141 142 143 144 243 244	N/S	PUBLIC STREET
BLDG	F	UNIT	101 102 103 104 201 202	1401	MICHAEL WAY	137 138 139 140 239 240	N/S	PUBLIC STREET
BLDG	G	UNIT	101 102 103 104 201 202	1401	MICHAEL WAY	133 134 135 136 235 236	N/S	PUBLIC STREET
BLDG	H	UNIT	101	1401	MICHAEL WAY	129	N/S	PUBLIC STREET

NOTE: All internal drive lanes are Private Drives

## MANNETTA LANE CONDOMINIUMS

BLDG	H	UNIT	102 103 104 201 202	1401	MICHAEL WAY	130 131 132 231 232	N/S	PUBLIC STREET
BLDG	J	UNIT	101 102 103 104 201 202	1401	MICHAEL WAY	125 126 127 128 227 228	N/S	PUBLIC STREET
BLDG	K	UNIT	101 102 103 104 201 202	1401	MICHAEL WAY	121 122 123 124 223 224	N/S	PUBLIC STREET
BLDG	L	UNIT	101 102 103 104 201 202	1401	MICHAEL WAY	117 118 119 120 219 220	N/S	PUBLIC STREET
BLDG	M	UNIT	101 102 103 104 201 202	1401	MICHAEL WAY	113 114 115 116 215 216	N/S	PUBLIC STREET
BLDG	N	UNIT	101 102 103 104 201 202	1401	MICHAEL WAY	109 110 111 112 211 212	N/S	PUBLIC STREET
BLDG	O	UNIT	101 102 103 104 201 202	1401	MICHAEL WAY	105 106 108 107 207 208	N/S	PUBLIC STREET
BLDG	P	UNIT	101 102 103 104 201 202	1401	MICHAEL WAY	101 102 103 104 203 204	N/S	PUBLIC STREET
Common Area				1401	MICHAEL WAY		N/S	PUBLIC STREET

Street with no addresses: VEGAS DRIVE

ORIGINAL DATE: 9/08/1997

**CITY OF LAS VEGAS  
PLANNING & DEVELOPMENT DEPARTMENT**

  
JOHN B HERBERT, PLANNER I

# MANNETTA LANE CONDOMINIUMS

BLDG	H	UNIT	102 103 104 201 202	1401	MICHAEL WAY	130 131 132 231 232	N/S	PUBLIC STREET
BLDG	J	UNIT	101 102 103 104 201 202	1401	MICHAEL WAY	125 126 127 128 227 228	N/S	PUBLIC STREET
BLDG	K	UNIT	101 102 103 104 201 202	1401	MICHAEL WAY	121 122 123 124 223 224	N/S	PUBLIC STREET
BLDG	L	UNIT	101 102 103 104 201 202	1401	MICHAEL WAY	117 118 119 120 219 220	N/S	PUBLIC STREET
BLDG	M	UNIT	101 102 103 104 201 202	1401	MICHAEL WAY	113 114 115 116 215 216	N/S	PUBLIC STREET
BLDG	N	UNIT	101 102 103 104 201 202	1401	MICHAEL WAY	109 110 111 112 211 212	N/S	PUBLIC STREET
BLDG	O	UNIT	101 102 103 104 201 202	1401	MICHAEL WAY	105 106 108 107 207 208	N/S	PUBLIC STREET
BLDG	P	UNIT	101 102 103 104 201 202	1401	MICHAEL WAY	101 102 103 104 203 204	N/S	PUBLIC STREET
Common Area				1401	MICHAEL WAY		N/S	PUBLIC STREET

Street with no addresses: VEGAS DRIVE

ORIGINAL DATE: 9/08/1997

CITY OF LAS VEGAS  
PLANNING & DEVELOPMENT DEPARTMENT

  
JOHN B HERBERT, PLANNER I

00913

FILE COPY

**FINAL MAP OF MANNETTA LANE (CONDOMINIUMS)**  
 (A COMPONENT DEVELOPMENT AND COMMON INTEREST COMMUNITY)  
 A PORTION OF THE NORTHEAST QUARTER (NE 1/4) OF  
 THE NORTHEAST ONE-QUARTER (NW 1/4) OF  
 SECTION 28, TOWNSHIP 30 SOUTH, RANGE 60 EAST, M.D.B. & M.,  
 CITY OF LAS VEGAS, CLARK COUNTY, NEVADA  
 LOT 1 OF PARCEL MAP: 1115 4, PAGE 50

DO NOT REMOVE

LINE TABLE (THIS SHEET ONLY)

PARCEL MAP: FILE 4, PAGE 50  
 PLAT: BOOK 50, PAGE 10  
 PLAT: BOOK 4, PAGE 70

LEGEND

PROPERTY LINE  
 CENTERLINE  
 PHASE LINE  
 FOUND MONUMENT AS DESCRIBED  
 SET TYPE "B" REBAR AND AL. CAP  
 SET SET "B" REBAR AND AL. CAP  
 PLS 7468  
 COVERED ASSIGNED PARKING SPACE  
 HANDICAP STALL  
 DENOTES FIRST FLOOR UNIT  
 DENOTES SECOND FLOOR UNIT  
 EASEMENT LINE AS DESCRIBED  
 CURVE NUMBER  
 LINE NUMBER  
 BUILDING SETBACK LINE  
 TRIANGLE ENCLOSURE  
 BUILDING AND PARKING TIES  
 SOFT VISIBILITY RESTRICTION EASEMENT  
 NO LANDSCAPING OR SOFT RESTRICTION  
 IMPROVEMENTS (SUCH AS WALLS/TREES E)

SCALE: 1" = 20'  
 NORTH

CURVE TABLE (THIS SHEET ONLY)

NUMBER	DIRECTION	ANGLE	LENGTH	MARKING
L1	S 00°21'51" W	18.00'	18.00'	24.02
L2	S 89°38'09" E	54.00'	54.00'	24.02
L3	S 00°21'51" E	18.00'	18.00'	24.02
L4	S 89°38'09" W	54.00'	54.00'	24.02
L5	N 00°21'51" W	18.00'	18.00'	24.02
L6	N 89°38'09" E	54.00'	54.00'	24.02
L7	N 00°21'51" E	18.00'	18.00'	24.02
L8	N 89°38'09" W	54.00'	54.00'	24.02
L9	S 00°21'51" E	18.00'	18.00'	24.02
L10	S 89°38'09" W	54.00'	54.00'	24.02
L11	N 00°21'51" W	18.00'	18.00'	24.02
L12	N 89°38'09" E	54.00'	54.00'	24.02
L13	N 00°21'51" W	18.00'	18.00'	24.02
L14	N 89°38'09" E	54.00'	54.00'	24.02
L15	S 00°21'51" W	18.00'	18.00'	24.02
L16	S 89°38'09" E	54.00'	54.00'	24.02
L17	S 00°21'51" E	18.00'	18.00'	24.02
L18	S 89°38'09" W	54.00'	54.00'	24.02
L19	N 00°21'51" W	18.00'	18.00'	24.02
L20	N 89°38'09" E	54.00'	54.00'	24.02
L21	N 00°21'51" E	18.00'	18.00'	24.02
L22	N 89°38'09" W	54.00'	54.00'	24.02
L23	S 00°21'51" W	18.00'	18.00'	24.02
L24	S 89°38'09" E	54.00'	54.00'	24.02
L25	N 00°21'51" W	18.00'	18.00'	24.02
L26	N 89°38'09" E	54.00'	54.00'	24.02
L27	N 00°21'51" W	18.00'	18.00'	24.02
L28	N 89°38'09" E	54.00'	54.00'	24.02
L29	S 00°21'51" W	18.00'	18.00'	24.02
L30	S 89°38'09" E	54.00'	54.00'	24.02
L31	N 00°21'51" W	18.00'	18.00'	24.02
L32	N 89°38'09" E	54.00'	54.00'	24.02
L33	S 00°21'51" W	18.00'	18.00'	24.02
L34	S 89°38'09" E	54.00'	54.00'	24.02
L35	N 00°21'51" W	18.00'	18.00'	24.02
L36	N 89°38'09" E	54.00'	54.00'	24.02
L37	S 00°21'51" W	18.00'	18.00'	24.02
L38	S 89°38'09" E	54.00'	54.00'	24.02
L39	N 00°21'51" W	18.00'	18.00'	24.02
L40	N 89°38'09" E	54.00'	54.00'	24.02
L41	S 00°21'51" W	18.00'	18.00'	24.02
L42	S 89°38'09" E	54.00'	54.00'	24.02
L43	N 00°21'51" W	18.00'	18.00'	24.02
L44	N 89°38'09" E	54.00'	54.00'	24.02
L45	S 00°21'51" W	18.00'	18.00'	24.02
L46	S 89°38'09" E	54.00'	54.00'	24.02
L47	N 00°21'51" W	18.00'	18.00'	24.02
L48	N 89°38'09" E	54.00'	54.00'	24.02
L49	S 00°21'51" W	18.00'	18.00'	24.02
L50	S 89°38'09" E	54.00'	54.00'	24.02
L51	N 00°21'51" W	18.00'	18.00'	24.02
L52	N 89°38'09" E	54.00'	54.00'	24.02
L53	S 00°21'51" W	18.00'	18.00'	24.02
L54	S 89°38'09" E	54.00'	54.00'	24.02
L55	N 00°21'51" W	18.00'	18.00'	24.02
L56	N 89°38'09" E	54.00'	54.00'	24.02
L57	S 00°21'51" W	18.00'	18.00'	24.02
L58	S 89°38'09" E	54.00'	54.00'	24.02
L59	N 00°21'51" W	18.00'	18.00'	24.02
L60	N 89°38'09" E	54.00'	54.00'	24.02
L61	S 00°21'51" W	18.00'	18.00'	24.02
L62	S 89°38'09" E	54.00'	54.00'	24.02

NUMBER	ANGLE	LENGTH	MARKING
C1	67°42'24"	25.00'	48.82
C2	67°42'24"	25.00'	24.02

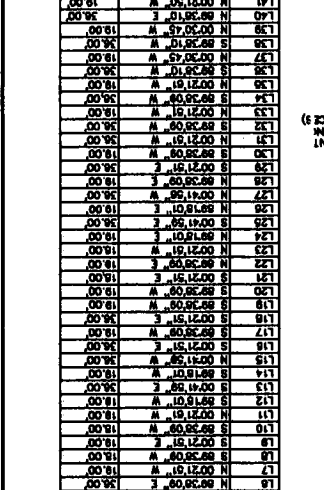
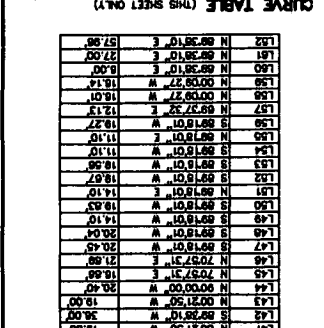

FOUND 3" BRASS CAP  
 CITY OF LAS VEGAS

FOUND 2" BRASS CAP  
 IN WELL-PLS 3720

FOUND 10" NEVADA POWER  
 COMPANY RIGHT-OF-WAY  
 BOOK 4848, DOC. NO. 407578 RECORDED 10/18/74

APN: 158-25-116-021

APN: 158-25-116-020

APN: 158-25-116-018

BOOK 4, PAGE 70

SEE SHEET 3 OF 6



970408

00713

# FINAL MAP OF MANNETTA LANE CONDOMINIUMS

(A CONDOMINIUM DEVELOPMENT AND COMMON INTEREST COMMUNITY)  
A PORTION OF THE NORTHEAST ONE-QUARTER (NE1/4) OF THE NORTHWEST ONE-QUARTER (NW 1/4) OF  
SECTION 25, TOWNSHIP 20 SOUTH, RANGE 60 EAST, M.D.B. & M., CITY OF LAS VEGAS, CLARK COUNTY, NEVADA  
LOT 1 OF PARCEL MAP: FILE 4, PAGE 60

### NOTE

FOR LEGEND SEE SHEET 2 OF 6

### LINE TABLE (THIS SHEET ONLY)

NUMBER	DIRECTION	DISTANCE
L101	N 00°30'45" W	18.00'
L102	N 89°29'15" E	38.00'
L103	S 00°30'45" E	18.00'
L104	N 89°29'15" W	38.00'
L105	S 89°29'15" W	18.00'
L106	N 00°30'45" E	18.00'
L107	S 00°30'45" E	18.00'
L108	S 89°29'15" W	18.00'
L109	S 00°21'51" E	18.00'
L110	N 89°38'09" E	38.00'
L111	N 00°21'51" W	18.00'
L112	N 89°38'09" W	38.00'
L113	S 89°29'15" W	18.00'
L114	S 00°30'45" E	38.00'
L115	N 89°29'15" W	18.00'
L116	S 00°30'45" E	38.00'
L117	S 89°38'09" W	18.00'
L118	S 00°21'51" E	38.00'
L119	S 89°38'09" W	18.00'
L120	S 00°21'51" E	38.00'
L121	S 89°29'15" W	18.00'
L122	S 00°30'45" E	38.00'
L123	S 89°29'15" W	18.00'
L124	S 00°30'45" E	38.00'
L125	S 89°38'09" W	18.00'
L126	S 00°21'51" E	18.00'
L127	N 89°38'09" E	18.00'
L128	S 00°21'51" E	18.00'
L129	S 89°38'09" W	18.00'
L130	S 00°21'51" W	18.00'
L131	S 89°38'09" W	18.00'
L132	S 00°21'51" E	18.00'
L133	N 00°00'63" E	18.00'
L134	N 89°59'07" W	38.00'
L135	N 00°00'63" E	18.00'
L136	S 89°59'07" E	38.00'
L137	N 89°59'23" W	38.00'
L138	S 00°21'51" E	18.00'
L139	N 89°59'07" W	38.00'
L140	N 00°21'51" E	18.00'
L141	N 89°29'15" E	18.00'
L142	S 00°30'45" E	18.00'
L143	S 89°29'15" W	18.00'
L144	N 00°30'45" W	18.00'
L145	S 00°00'77" E	13.40'
L147	S 00°02'77" E	14.83'
L148	S 00°02'77" E	14.80'
L149	N 72°01'07" W	22.88'
L150	N 72°01'07" W	18.97'
L151	S 89°38'10" W	11.39'
L152	N 89°38'10" E	18.14'
L153	N 89°38'10" E	11.32'
L154	S 89°38'10" W	18.04'
L155	N 89°38'10" E	14.21'
L156	N 89°38'10" E	18.04'
L157	S 89°38'10" W	14.12'
L158	S 89°38'10" W	18.04'
L159	S 74°10'40" E	18.14'
L160	S 74°10'40" E	21.85'
L161	N 00°00'35" E	5.00'
L162	N 00°00'35" E	5.00'

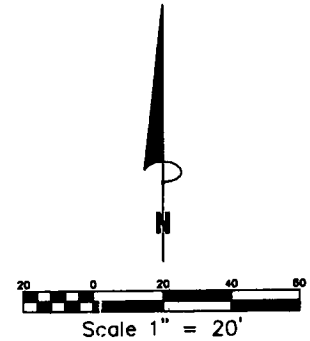
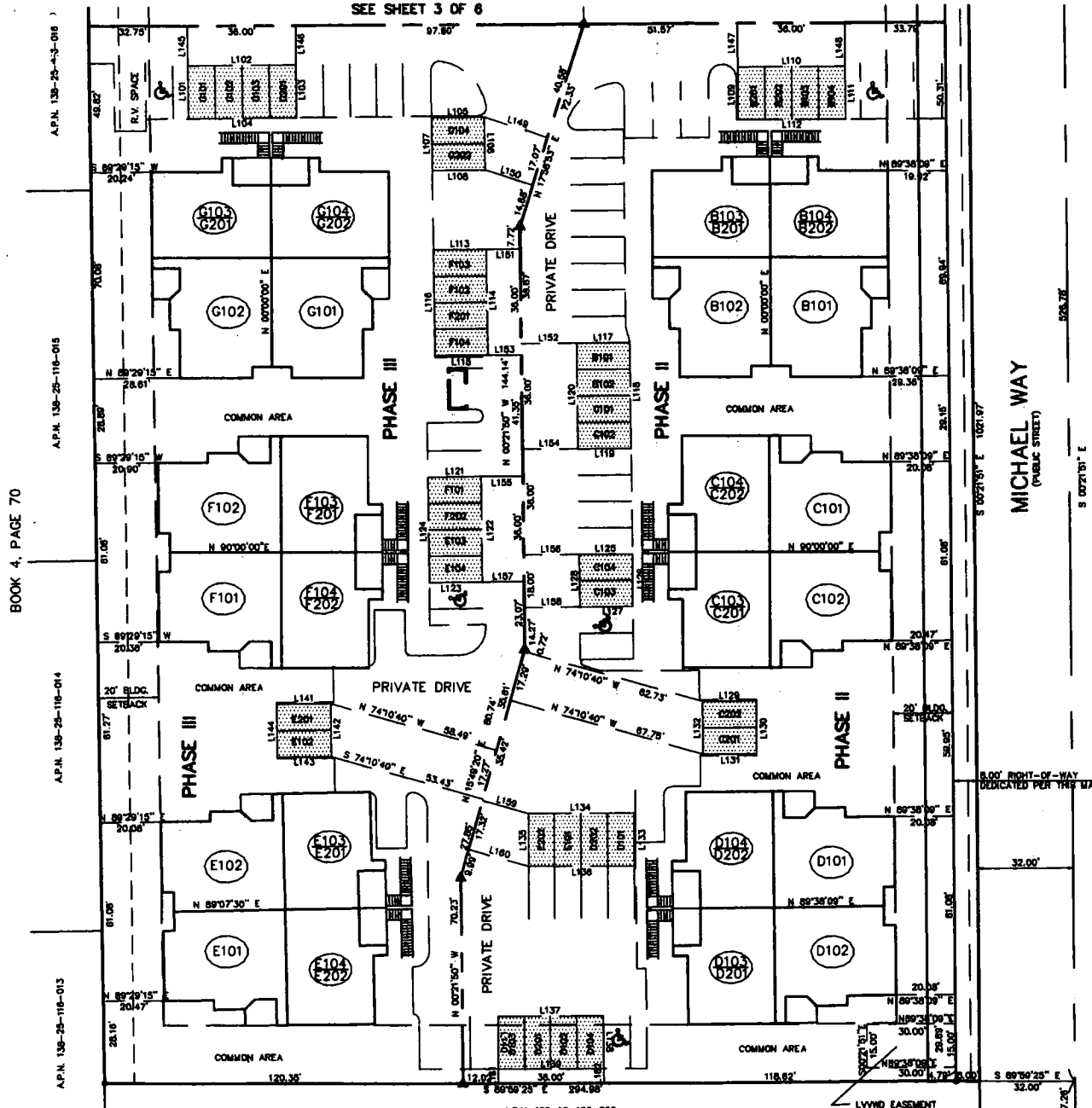

Root 81 Page 2