

TENNINGTON RIDGE - PHASE 5

JULY 8, 1993

FIRE MAP #2318::24  
200 MAP:L-27-1

```

=====
BLOCK 1   LOT   68   1217  OLVERA WAY           N/S   PUBLIC STREET
          69   1221
          70   1225
          71   1301
          72   1305
          73   1309
          74   1313
          75   1317
          76   1321
          77   1325

BLOCK 1   LOT   78   7328  SILVER RIDGE DRIVE  E/W   PUBLIC STREET
          79   7324
          80   7320
          81   7316
          82   7312
          83   7308
          84   7304
          85   7300

BLOCK 1   LOT   86   7301  BRASWELL DRIVE      E/W   PUBLIC STREET
          87   7305
          88   7309
          89   7313
          90   7317
          91   7321
          92   7325
          93   7329
          94   7333
          95   7337

BLOCK 4   LOT    1   1320  OLVERA WAY           N/S   PUBLIC STREET
          2   1316
          3   1312
          4   1308
          5   1304
          6   1300
          7   1224
          8   1220
          9   1216

BLOCK 4   LOT   38   1217  RAINBOW MEADOWS DRIVE N/S   PUBLIC STREET
          39   1221
          40   1225
          41   1301
          42   1305
          43   1309
          44   1313

BLOCK 4   LOT   45   7313  SILVER RIDGE DRIVE  E/W   PUBLIC STREET
          46   7309
          47   7305

BLOCK 5   LOT   21   7313  DANNON COURT        E/W   PUBLIC STREET
          22   7309
          23   7305
          24   7301
          25   7300
          26   7304
          27   7308
          28   7312

BLOCK 5   LOT   29   1312  RAINBOW MEADOWS DRIVE N/S   PUBLIC STREET
          30   1316
          31   1320
          32   1324
          33   1328
          34   1332
          35   1336
          36   1340
          37   1344

STREET WITH NO ADDRESSES:  TENAYA WAY           N/S   PUBLIC STREET
  
```

CITY OF LAS VEGAS  
DEPARTMENT OF COMMUNITY  
PLANNING & DEVELOPMENT

MATT PINJUV, PLANNER

MP/dr

MASTER SUBDIVISION ADDRESS: 1317 RAINBOW MEADOWS DRIVE

# TENNINGTON RIDGE - PHASE 5

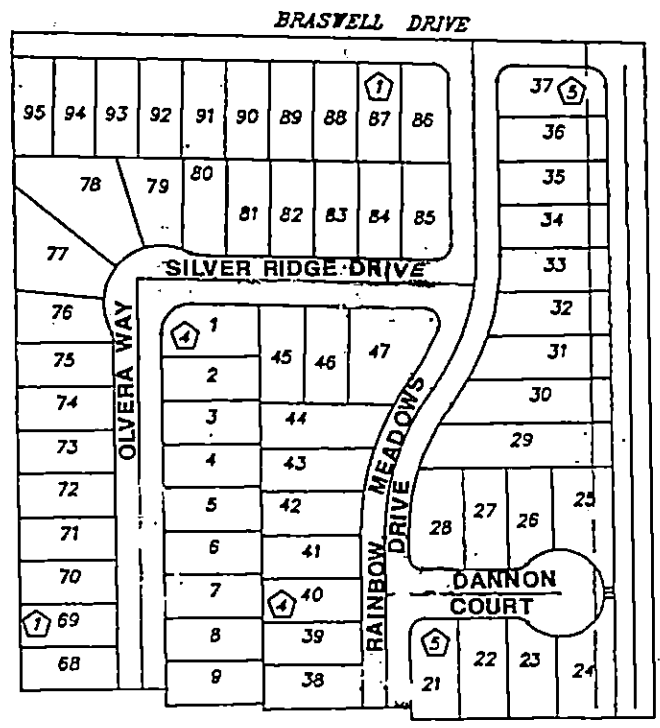

TENNINGTON RIDGE - PHASE 5

JULY 8, 1993

FIRE MAP #2318::24  
200 MAP:L-27-1

```

=====
BLOCK 1   LOT   68   1217  OLVERA WAY           N/S   PUBLIC STREET
          69   1221
          70   1225
          71   1301
          72   1305
          73   1309
          74   1313
          75   1317
          76   1321
          77   1325

BLOCK 1   LOT   78   7328  SILVER RIDGE DRIVE   E/W   PUBLIC STREET
          79   7324
          80   7320
          81   7316
          82   7312
          83   7308
          84   7304
          85   7300

BLOCK 1   LOT   86   7301  BRASWELL DRIVE       E/W   PUBLIC STREET
          87   7305
          88   7309
          89   7313
          90   7317
          91   7321
          92   7325
          93   7329
          94   7333
          95   7337

BLOCK 4   LOT    1   1320  OLVERA WAY           N/S   PUBLIC STREET
          2   1316
          3   1312
          4   1308
          5   1304
          6   1300
          7   1224
          8   1220
          9   1216

BLOCK 4   LOT   38   1217  RAINBOW MEADOWS DRIVE N/S   PUBLIC STREET
          39   1221
          40   1225
          41   1301
          42   1305
          43   1309
          44   1313

BLOCK 4   LOT   45   7313  SILVER RIDGE DRIVE   E/W   PUBLIC STREET
          46   7309
          47   7305

BLOCK 5   LOT   21   7313  DANNON COURT         E/W   PUBLIC STREET
          22   7309
          23   7305
          24   7301
          25   7300
          26   7304
          27   7308
          28   7312

BLOCK 5   LOT   29   1312  RAINBOW MEADOWS DRIVE N/S   PUBLIC STREET
          30   1316
          31   1320
          32   1324
          33   1328
          34   1332
          35   1336
          36   1340
          37   1344

STREET WITH NO ADDRESSES:  TENAYA WAY           N/S   PUBLIC STREET
  
```

CITY OF LAS VEGAS  
DEPARTMENT OF COMMUNITY  
PLANNING & DEVELOPMENT

MATT PINJUV, PLANNER

MP/dr

MASTER SUBDIVISION ADDRESS: 1317 RAINBOW MEADOWS DRIVE

# TENNINGTON RIDGE - PHASE 5

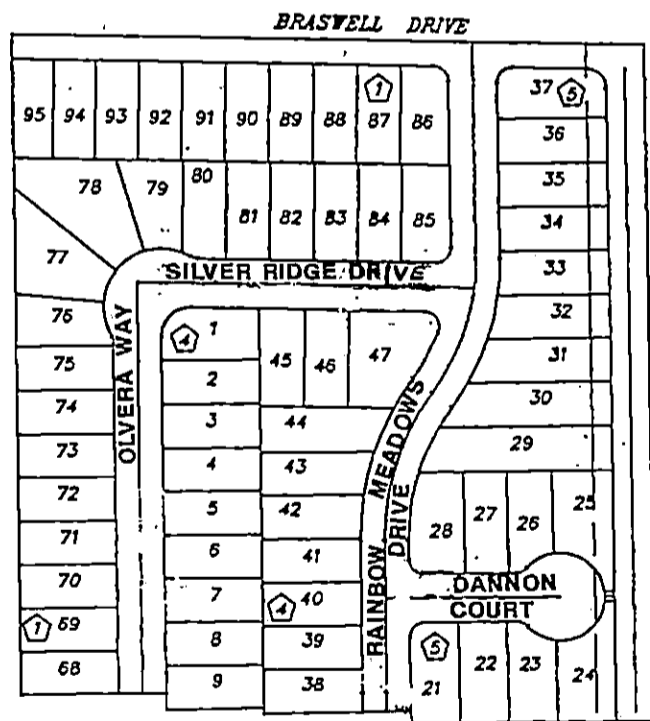

TENNINGTON RIDGE - PHASE 5

JULY 8, 1993

FIRE MAP #2318::24  
200 MAP:L-27-1

BLOCK 1	LOT	68	1217	OLVERA WAY	N/S	PUBLIC STREET
		69	1221			
		70	1225			
		71	1301			
		72	1305			
		73	1309			
		74	1313			
		75	1317			
		76	1321			
77	1325					
BLOCK 1	LOT	78	7328	SILVER RIDGE DRIVE	E/W	PUBLIC STREET
		79	7324			
		80	7320			
		81	7316			
		82	7312			
		83	7308			
		84	7304			
		85	7300			
BLOCK 1	LOT	86	7301	BRASWELL DRIVE	E/W	PUBLIC STREET
		87	7305			
		88	7309			
		89	7313			
		90	7317			
		91	7321			
		92	7325			
		93	7329			
		94	7333			
		95	7337			
BLOCK 4	LOT	1	1320	OLVERA WAY	N/S	PUBLIC STREET
		2	1316			
		3	1312			
		4	1308			
		5	1304			
		6	1300			
		7	1224			
		8	1220			
		9	1216			
BLOCK 4	LOT	38	1217	RAINBOW MEADOWS DRIVE	N/S	PUBLIC STREET
		39	1221			
		40	1225			
		41	1301			
		42	1305			
		43	1309			
44	1313					
BLOCK 4	LOT	45	7313	SILVER RIDGE DRIVE	E/W	PUBLIC STREET
		46	7309			
		47	7305			
BLOCK 5	LOT	21	7313	DANNON COURT	E/W	PUBLIC STREET
		22	7309			
		23	7305			
		24	7301			
		25	7300			
		26	7304			
		27	7308			
		28	7312			
BLOCK 5	LOT	29	1312	RAINBOW MEADOWS DRIVE	N/S	PUBLIC STREET
		30	1316			
		31	1320			
		32	1324			
		33	1328			
		34	1332			
		35	1336			
		36	1340			
		37	1344			
		STREET WITH NO ADDRESSES:				

CITY OF LAS VEGAS  
DEPARTMENT OF COMMUNITY  
PLANNING & DEVELOPMENT

MATT PINJUV, PLANNER

MP/dr

MASTER SUBDIVISION ADDRESS: 1317 RAINBOW MEADOWS DRIVE

# TENNINGTON RIDGE - PHASE 5

