

1
2
3
4
5
6
7
8
9
10
11
12
13
14
15
16
17
18
19
20
21
22
23
24
25

FIRST AMENDMENT

BILL NO. 2014-88

ORDINANCE NO. 6387

AN ORDINANCE TO EXTEND THE BOUNDARIES OF THE CITY, TO PARTICULARLY DESCRIBE THE LAND TO BE ANNEXED, TO MAKE ITS INHABITANTS SUBJECT TO THE LAWS, OBLIGATIONS AND BENEFITS OF THE CITY, AND TO PROVIDE FOR OTHER RELATED MATTERS. (ANX-56310)

Sponsored by: Mayor Pro Tem Stavros S. Anthony Summary: Annexes property described generally as located at 4850 through 4880 Conough Lane.

THE CITY COUNCIL OF THE CITY OF LAS VEGAS DOES HEREBY ORDAIN AS FOLLOWS:

SECTION 1: The corporate limits of the City of Las Vegas, Nevada, are hereby extended to annex, include, and make a part of the City of Las Vegas, Nevada, the following described real property:

That portion of the Southwest Quarter (SW 1/4) of the Southeast Quarter (SE 1/4) of the Southeast Quarter (SE 1/4) of Section 33, Township 19 South, Range 60 East, M.D.M., Clark County Nevada, being LOT 1, LOT 2 and LOT 3 as shown on Parcel Map in File 87, Page 3 together with LOT 1 and LOT 2 as shown on Parcel Map in File 88, Page 81 all of Clark County Nevada records, also together with the adjoining 30.00 foot half street right-of-way of Conough Lane as dedicated by said Parcel Map in File 87, Page 3 described as follows:

1 COMMENCING at the southeast corner of said Section 33; thence along the south
2 line of the Southeast Quarter (SE 1/4) of said Section 33 and the centerline of Lone
3 Mountain Road, North 88°04'00" West 1387.23 feet to the centerline intersection
4 of said Lone Mountain Road and Conough Lane; thence along the centerline of
5 said Conough Lane North 00°31'19" West 342.51 feet to the POINT OF
6 BEGINNING; thence departing said centerline, South 88°10'59" East 30.02 feet to
7 the southwest corner of LOT 1 of said Parcel Map in File 87, Page 3; thence
8 continuing South 88°10'59" East 305.84 feet to the southeast corner of LOT 2 of
9 said Parcel Map in File 87, Page 3; thence North 00°40'21" West 342.88 feet to the
10 northeast corner of LOT 2 of said Parcel Map in File 88, Page 81; thence
11 North 88°17'59" West 304.91 feet to the northwest corner of LOT 1 of said Parcel
12 Map in File 88, Page 81; thence continuing North 88°17'59" West 30.02 feet to the
13 centerline of said Conough Lane; thence along said centerline,
14 South 00°31'19" East 342.16 feet to the POINT OF BEGINNING.

15 BASIS OF BEARINGS: South 88°04'00" East, being the south line of the
16 Southeast Quarter (SE 1/4) of the Southeast Quarter (SE 1/4) of Section 33,
17 Township 19 South, Range 60 East M.D.M. as show on Parcel Map in File 68,
18 Page 21 of Clark County Nevada records.

19 Prepared by:
20 Brian Yu, PLS
21 Dept. of Operations and Maintenance, Right-of-Way
22 City of Las Vegas
23 333 N. Rancho Drive, 8th Floor
24 Las Vegas, NV 89106
25 byu@lasvegasnevada.gov

SECTION 2: The City Council hereby determines that the described territory
meets the requirements provided by law for annexation to the City for the following reasons:

A. The area to be annexed was contiguous to the City's boundaries at the time
the annexation proceedings were instituted;

B. More than one-eighth (1/8) of the aggregate external boundaries of the
area are contiguous to the City;

C. The territory proposed to be annexed is not included within the boundaries
of another incorporated city or within the boundaries of any unincorporated town as those
boundaries existed as of July 1, 1983;

D. The City is eligible to annex the described territory because the present or
previous landowners have signed a petition constituting one hundred percent (100%) of the owners

1 | of record of individual lots or parcels of land within the annexation area.

2 | SECTION 3: The City will provide police protection through the Las Vegas
3 | Metropolitan Police Department, fire protection, street maintenance, and library services
4 | immediately upon annexation. Garbage collection by the company franchised by the City will also
5 | be provided immediately. The City sanitary sewer system will serve the proposed annexation area.
6 | Any connection to or extension of this sewer line to serve the annexation area shall be at the
7 | expense of the landowners. Other services, such as participation in the City's recreational
8 | programs, special education classes and programs, public works planning, building inspections, and
9 | other City services will also be available immediately. Utilities such as gas, electricity, telephone,
10 | and water are provided by private utility companies and other services to the area will not be
11 | affected by annexation. Street paving, curbs and gutters, sidewalks and street lights which are not
12 | in place at the time of annexation will be installed in the presently developed areas upon the request
13 | of the property owners and at their expense by means of special assessment districts. Such
14 | improvements will be extended into the undeveloped areas as development takes place and the
15 | need therefor arises, and will be located according to the needs of the area at that time. Such
16 | installations will also be made at the expense of the property owners, either by means of special
17 | assessment districts or as prerequisites to the approval of subdivision plats, building permits or
18 | other land use or development applications.

19 | SECTION 4: The annexation of the described territory shall become effective
20 | on the 26th day of December, 2014, and on that date the City will have the funds appropriated in
21 | sufficient amount to finance the extension into the described territory of police protection, fire
22 | protection, street maintenance, street sweeping, and street lighting maintenance.

23 | SECTION 5: The described territory, together with the inhabitants and property
24 | thereof, shall, from and after the 26th day of December, 2014, be subject to all debts, laws,
25 | ordinances and regulations in force in the City and shall be entitled to the same privileges and

1 | benefits as other parts of the City, and shall be subject to municipal taxes levied by the City.

2 | SECTION 6: The City Engineer is hereby instructed to cause to be prepared an
3 | accurate map or plat of the described territory and to record the map or plat, together with a
4 | certified copy of this ordinance, in the office of the County Recorder of Clark County, Nevada,
5 | which recording shall be done prior to the 26th day of December, 2014.

6 | SECTION 7: The described territory, which previously has been zoned R-E
7 | (County of Clark classification), is hereby classified as R-E (City of Las Vegas classification),
8 | which is deemed to be the City equivalent of the County classification.

9 | SECTION 8: If any section, subsection, subdivision, paragraph, sentence, clause
10 | or phrase in this ordinance or any part thereof is for any reason held to be unconstitutional or
11 | invalid or ineffective by any court of competent jurisdiction, such decision shall not affect the
12 | validity or effectiveness of the remaining portions of this ordinance or any part thereof. The City
13 | Council of the City of Las Vegas hereby declares that it would have passed each section,
14 | subsection, subdivision, paragraph, sentence, clause or phrase thereof irrespective of the fact that
15 | any one or more sections, subsections, subdivisions, paragraphs, sentences, clauses or phrases be
16 | declared unconstitutional, invalid or ineffective.

17 | ...
18 | ...
19 | ...
20 | ...
21 | ...
22 | ...
23 | ...
24 | ...
25 | ...

1 SECTION 9: All ordinances or parts of ordinances or sections, subsections,
2 phrases, sentences, clauses or paragraphs contained in the Municipal Code of the City of Las
3 Vegas, Nevada, 1983 Edition, in conflict herewith are hereby repealed.

4 PASSED, ADOPTED and APPROVED this 17TH day of December,
5 2014.

6 APPROVED:

7
8 By 
CAROLYN G. GOODMAN, Mayor

9 ATTEST:

10 
11 BEVERLY K. BRIDGES, MMC
City Clerk

12 APPROVED AS TO FORM:

13  12-17-14
14 Val Steed, Date
15 Deputy City Attorney

1 The above and foregoing ordinance was first proposed and read by title to the City Council
2 on the 19th day of November, 2014, and referred to a committee for recommendation;
3 thereafter the said committee reported favorably on said ordinance on the 17th day of
4 December, 2014, which was a regular meeting of said Council; that at said regular
5 meeting, the proposed ordinance was read by title to the City Council as amended and
6 adopted by the following vote:

7 VOTING "AYE": Mayor Goodman and Councilmembers Anthony. Tarkanian, Ross,
Barlow, Coffin and Beers
8 VOTING "NAY": None
9 EXCUSED: None
10 ABSTAINED: None
11 DID NOT VOTE: None

12 APPROVED:

13 
14 _____
CAROLYN G. GOODMAN, Mayor

15 ATTEST:

16 
17 _____
BEVERLY K. BRIDGES, MMC City Clerk

18
19
20
21
22
23
24
25
26

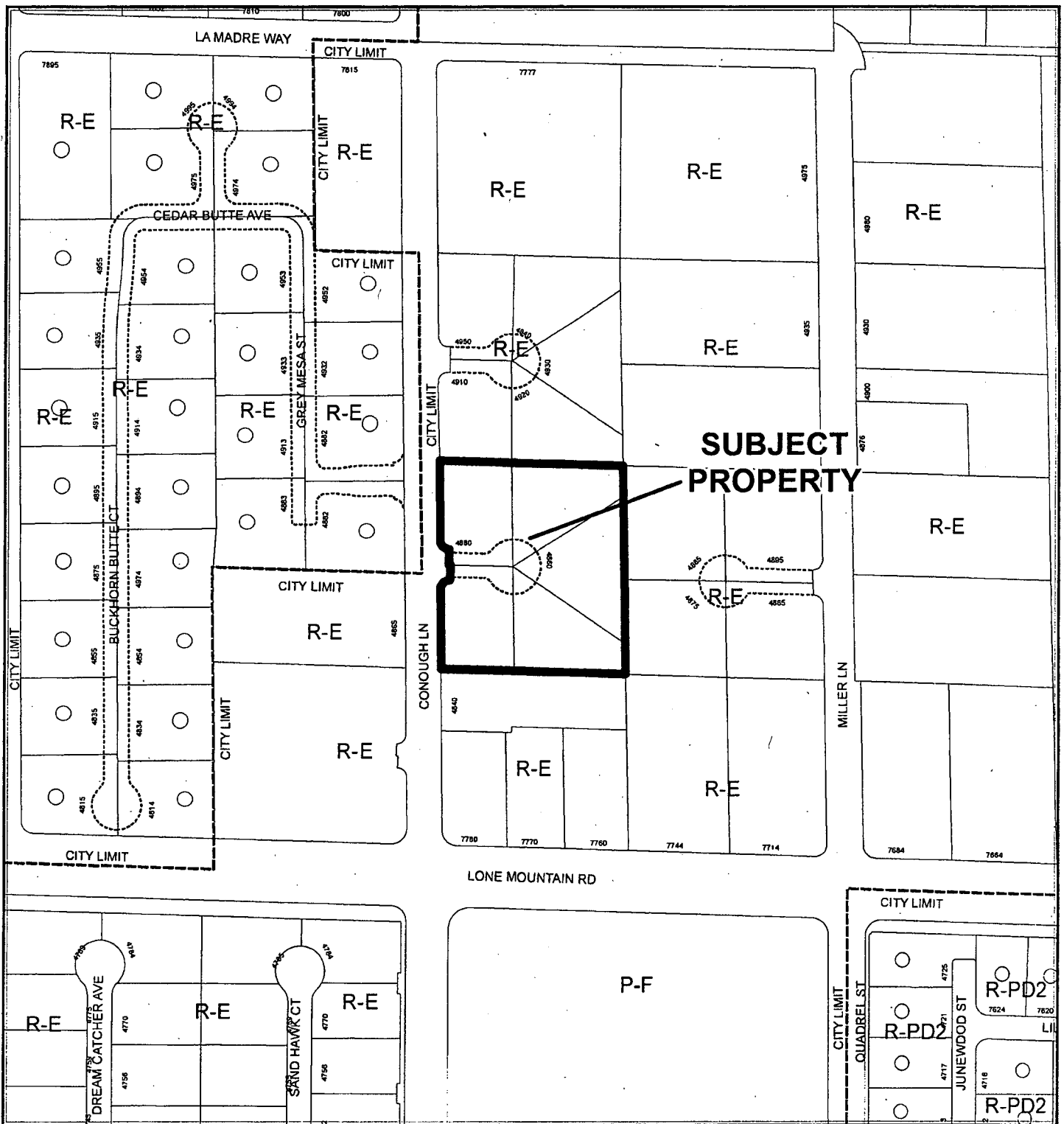

CASE: ANX-56310

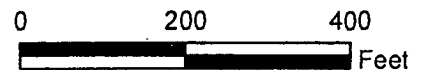

Affidavit of Publication

STATE OF NEVADA)
COUNTY OF CLARK) SS:

**LV CITY CLERK
495 S MAIN ST
LAS VEGAS NV 89101**

**Account # 22515
Ad Number 0000375707**

Stacey M. Lewis, being 1st duly sworn, deposes and says: That she is the Legal Clerk for the Las Vegas Review-Journal and the Las Vegas Sun, daily newspapers regularly issued, published and circulated in the City of Las Vegas, County of Clark, State of Nevada, and that the advertisement, a true copy attached for, was continuously published in said Las Vegas Review-Journal and / or Las Vegas Sun in 1 edition(s) of said newspaper issued from 11/20/2014 to 11/20/2014, on the following days:

11 / 20 / 14

BILL NO. 2014-88

AN ORDINANCE TO EXTEND THE BOUNDARIES OF THE CITY, TO PARTICULARLY DESCRIBE THE LAND TO BE ANNEXED, TO MAKE ITS INHABITANTS SUBJECT TO THE LAWS, OBLIGATIONS AND BENEFITS OF THE CITY, AND TO PROVIDE FOR OTHER RELATED MATTERS. (ANX-56310)

Sponsored by: Mayor Pro Tem Stavros S. Anthony
Summary: Annexes property described generally as located at 4850 through 4880 Conough Lane.

At the City Council meeting of November 19, 2014 BILL NO. 2014-88 WAS BE READ BY TITLE AND REFERRED TO A RECOMMENDING COMMITTEE

COPIES OF THE COMPLETE ORDINANCE ARE AVAILABLE FOR PUBLIC INFORMATION IN THE OFFICE OF THE CITY CLERK, 2ND FLOOR, 495 SOUTH MAIN STREET, LAS VEGAS, NEVADA
PUB: November 20, 2014
LV Review-Journal

Stacey M. Lewis
IS/ _____
LEGAL ADVERTISEMENT REPRESENTATIVE

Subscribed and sworn to before me on this 20th day of November, 2014

Notary *Mary Lee*

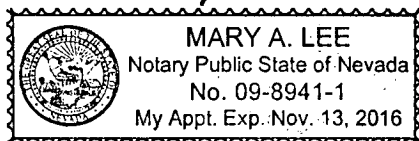

Affidavit of Publication

STATE OF NEVADA)
COUNTY OF CLARK) SS:

LV CITY CLERK
495 S MAIN ST
LAS VEGAS NV 89101

Account # 22515
Ad Number 0000400364

Stacey M. Lewis, being 1st duly sworn, deposes and says: That she is the Legal Clerk for the Las Vegas Review-Journal and the Las Vegas Sun, daily newspapers regularly issued, published and circulated in the City of Las Vegas, County of Clark, State of Nevada, and that the advertisement; a true copy attached for, was continuously published in said Las Vegas Review-Journal and / or Las Vegas Sun in 1 edition(s) of said newspaper issued from 12/20/2014 to 12/20/2014, on the following days:

12 / 20 / 14

FIRST AMENDMENT
BILL NO. 2014-88
ORDINANCE NO. 6387

AN ORDINANCE TO EXTEND THE BOUNDARIES OF THE CITY, TO PARTICULARLY DESCRIBE THE LAND TO BE ANNEXED, TO MAKE ITS INHABITANTS SUBJECT TO THE LAWS, OBLIGATIONS AND BENEFITS OF THE CITY, AND TO PROVIDE FOR OTHER RELATED MATTERS. (ANX-56310)

Sponsored by: Mayor Pro Tem Stavros S. Anthony
Summary: Annexes property described generally as located at 4850 through 4880 Conough Lane.

The above and foregoing ordinance was first proposed and read by title to the City Council on the 19th day of November 2014, and referred to a committee for recommendation; thereafter the committee reported favorably on said ordinance on the 17th day of December 2014, which was a regular meeting of said City Council; and that at said regular meeting the proposed ordinance was read by title to the City Council as amended and was adopted by the following vote:

VOTING "AYE": Mayor Goodman and Councilmembers Anthony, Tarkanian, Ross, Barlow, Coffin and Beers
VOTING "NAY": NONE
EXCUSED: NONE

COPIES OF THE COMPLETE ORDINANCE ARE AVAILABLE FOR PUBLIC INFORMATION IN THE OFFICE OF THE CITY CLERK, 2ND FLOOR, 495 SOUTH MAIN STREET, LAS VEGAS, NEVADA
PUB: December 20, 2014
LV Review-Journal

Stacey M. Lewis

LEGAL ADVERTISEMENT REPRESENTATIVE

Subscribed and sworn to before me on this 22nd day of December, 2014

Notary *Mary Lee*

 MARY A. LEE
Notary Public State of Nevada
No. 09-8941-1
My Appt. Exp: Nov. 13, 2016