



# Ordinance & Resolutions Transmittal Scanning & Separator Page

## RECORD TYPE: ORDINANCE

Date of Transfer: 7/15/2014

Page Count: 9

Retention: Permanent

Meeting Type: City Council<=>

File By: Meeting Date

Bill No: 2014-37

Ordinance No: 6332<=>

Date Read: 6/4/2014

Date Adopted: 7/2/2014

Ordinance Title: AN ORDINANCE TO EXTEND THE BOUNDARIES OF THE CITY, TO PARTICULARLY DESCRIBE THE LAND TO BE ANNEXED, TO MAKE ITS INHABITANTS SUBJECT TO THE LAWS, OBLIGATIONS AND BENEFITS OF THE CITY, AND TO PROVIDE FOR OTHER RELATED MATERS. (ANX-53692) <=>

Ordinance Summary: Annexes property described generally as located on the west side of Grand Canyon Road between Elkhorn Road and Dorrell Lane. <=>

Ordinance Sponsor: Councilman Steven D. Ross<=>



Prepared By:

Scanned By:

QC By:

1  
2  
3  
4  
5  
6  
7  
8  
9  
10  
11  
12  
13  
14  
15  
16  
17  
18  
19  
20  
21  
22  
23  
24  
25

**BILL NO. 2014-37**

**ORDINANCE NO. 6332**

AN ORDINANCE TO EXTEND THE BOUNDARIES OF THE CITY, TO PARTICULARLY DESCRIBE THE LAND TO BE ANNEXED, TO MAKE ITS INHABITANTS SUBJECT TO THE LAWS, OBLIGATIONS AND BENEFITS OF THE CITY, AND TO PROVIDE FOR OTHER RELATED MATTERS. (ANX-53692)

Sponsored by: Councilman Steven D. Ross

Summary: Annexes property described generally as located on the west side of Grand Canyon Road between Elkhorn Road and Dorrell Lane.

THE CITY COUNCIL OF THE CITY OF LAS VEGAS DOES HEREBY  
ORDAIN AS FOLLOWS:

SECTION 1: The corporate limits of the City of Las Vegas, Nevada, are hereby extended to annex, include, and make a part of the City of Las Vegas, Nevada, the following described real property:

That portion of the Northeast Quarter (NE 1/4) of the Northwest Quarter (NW 1/4) of Section 19, Township 19 South, Range 60 East, MDM, Clark County, Nevada, described as follows:

BEGINNING at the northeast corner of the Northeast Quarter (NE 1/4) of the Northwest Quarter (NW 1/4) of said Section 19; thence along the east line of the Northeast Quarter (NE 1/4) of the Northwest Quarter (NW 1/4) of said Section 19 and along the centerline of GRAND CANYON DRIVE (35.00 foot half-street width), South 00°00'42" East, 1332.40 feet to the southeast corner of the Northeast

1 Quarter (NE 1/4) of the Northwest Quarter (NW 1/4) of said Section 19; thence  
2 along the south line of the Northeast Quarter (NE 1/4) of the Northwest Quarter  
(NW 1/4) of said Section 19 and along the centerline of DORRELL LANE (30.00  
3 foot half-street width), North 89°16'32" West, 662.38 feet to the southwest corner  
4 of the Southeast Quarter (SE 1/4) of the Northeast Quarter (NE 1/4) of the  
Northwest Quarter (NW 1/4) of said Section 19; thence along the west line of the  
5 Southeast Quarter (SE 1/4) of the Northeast Quarter (NE 1/4) of the  
Northwest Quarter (NW 1/4) of said Section 19 and along the centerline of  
6 JENSEN STREET (30.00 foot half-street width), North 00°01'11" East, 667.11 feet  
to the northwest corner of the Southeast Quarter (SE 1/4) of the Northeast Quarter  
7 (NE 1/4) of the Northwest Quarter (NW 1/4) of said Section 19; thence along the  
north line of the Southeast Quarter (SE 1/4) of the Northeast Quarter (NE 1/4) of  
8 the Northwest Quarter (NW 1/4) of said Section 19 and along the centerline of  
WITTIG AVENUE (30.00 foot half-street width), South 89°11'46" East, 331.01  
9 feet to the southwest corner of the East Half (E 1/2) of the Northeast Quarter  
(NE 1/4) of the Northeast Quarter (NE 1/4) of the Northwest Quarter (NW 1/4) of  
10 said Section 19; thence along the west line of said East Half (E 1/2),  
North 00°00'15" East, 666.66 feet to the north line of said East Half (E 1/2); thence  
11 along the north line of said East Half (E 1/2) and along the centerline of  
ELKHORN ROAD (50.00 foot half-street width), South 89°07'00" East, 330.84  
feet to the POINT OF BEGINNING.

12 The Basis of Bearings for this land description is South 00°00'42" East, being the  
13 east line of the Northeast Quarter (NE 1/4) of the Northwest Quarter (NW 1/4) of  
Section 19, Township 19 South, Range 60 East, MDM, Clark County, Nevada, as  
14 shown on the plat of SAVONA UNIT 2, on file in Book 146 of Plats, Page 17, of  
Clark County, Nevada Records.

15 Written by:  
16 Neil Wacaser  
City of Las Vegas, Department of Operations & Maintenance  
17 333 N. Rancho Drive  
Las Vegas, NV, 89106  
18 (702) 229-2475  
nwacaser@lasvegasnevada.gov

19 SECTION 2: The City Council hereby determines that the described territory  
20 meets the requirements provided by law for annexation to the City for the following reasons:

21 A. The area to be annexed was contiguous to the City's boundaries at the time  
22 the annexation proceedings were instituted;

23 B. More than one-eighth (1/8) of the aggregate external boundaries of the  
24 area are contiguous to the City;

25 C. The territory proposed to be annexed is not included within the boundaries

1 of another incorporated city or within the boundaries of any unincorporated town as those  
2 boundaries existed as of July 1, 1983;

3 D. The City is eligible to annex the described territory because the  
4 landowners have signed a petition constituting one hundred percent (100%) of the owners of record  
5 of individual lots or parcels of land within the annexation area.

6 SECTION 3: The City will provide police protection through the Las Vegas  
7 Metropolitan Police Department, fire protection, street maintenance, and library services  
8 immediately upon annexation. Garbage collection by the company franchised by the City will also  
9 be provided immediately. The City sanitary sewer system will serve the proposed annexation area.  
10 Any connection to or extension of this sewer line to serve the annexation area shall be at the  
11 expense of the landowners. Other services, such as participation in the City's recreational  
12 programs, special education classes and programs, public works planning, building inspections, and  
13 other City services will also be available immediately. Utilities such as gas, electricity, telephone,  
14 and water are provided by private utility companies and other services to the area will not be  
15 affected by annexation. Street paving, curbs and gutters, sidewalks and street lights which are not  
16 in place at the time of annexation will be installed in the presently developed areas upon the request  
17 of the property owners and at their expense by means of special assessment districts. Such  
18 improvements will be extended into the undeveloped areas as development takes place and the  
19 need therefor arises, and will be located according to the needs of the area at that time. Such  
20 installations will also be made at the expense of the property owners, either by means of special  
21 assessment districts or as prerequisites to the approval of subdivision plats, building permits or  
22 other land use or development applications.

23 SECTION 4: The annexation of the described territory shall become effective  
24 on the 11th day of July, 2014, and on that date the City will have the funds appropriated in  
25 sufficient amount to finance the extension into the described territory of police protection, fire

1 protection, street maintenance, street sweeping, and street lighting maintenance.

2 SECTION 5: The described territory, together with the inhabitants and property  
3 thereof, shall, from and after the 11th day of July, 2014, be subject to all debts, laws, ordinances  
4 and regulations in force in the City and shall be entitled to the same privileges and benefits as other  
5 parts of the City, and shall be subject to municipal taxes levied by the City.

6 SECTION 6: The City Engineer is hereby instructed to cause to be prepared an  
7 accurate map or plat of the described territory and to record the map or plat, together with a  
8 certified copy of this ordinance, in the office of the County Recorder of Clark County, Nevada,  
9 which recording shall be done prior to the 11th day of July, 2014.

10 SECTION 7: The described territory, which previously has been zoned R-E  
11 (County of Clark classification), is hereby classified as R-1 (City of Las Vegas classification),  
12 which is deemed to be the City equivalent of the County classification.

13 SECTION 8: If any section, subsection, subdivision, paragraph, sentence, clause  
14 or phrase in this ordinance or any part thereof is for any reason held to be unconstitutional or  
15 invalid or ineffective by any court of competent jurisdiction, such decision shall not affect the  
16 validity or effectiveness of the remaining portions of this ordinance or any part thereof. The City  
17 Council of the City of Las Vegas hereby declares that it would have passed each section,  
18 subsection, subdivision, paragraph, sentence, clause or phrase thereof irrespective of the fact that  
19 any one or more sections, subsections, subdivisions, paragraphs, sentences, clauses or phrases be  
20 declared unconstitutional, invalid or ineffective.

21 ...

22 ...

23 ...

24 ...

25 ...

1 SECTION 9: All ordinances or parts of ordinances or sections, subsections,  
2 phrases, sentences, clauses or paragraphs contained in the Municipal Code of the City of Las  
3 Vegas, Nevada, 1983 Edition, in conflict herewith are hereby repealed.

4 PASSED, ADOPTED and APPROVED this 2<sup>nd</sup> day of July,  
5 2014.

6 APPROVED:

7  
8 By   
9 CAROLYN G. GOODMAN, Mayor

10 ATTEST:

11   
12 BEVERLY K. BRIDGES, MMC  
13 City Clerk

14 APPROVED AS TO FORM:

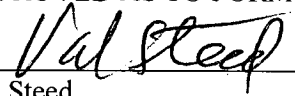
15  5-20-14  
16 Val Steed, Date  
17 Deputy City Attorney  
18  
19  
20  
21  
22  
23  
24  
25

1  
2  
3  
4  
5  
6  
7  
8  
9  
10  
11  
12  
13  
14  
15  
16  
17  
18  
19  
20  
21  
22  
23  
24  
25  
26

The above and foregoing ordinance was first proposed and read by title to the City Council on the 4th day of June, 2014, and referred to a committee for recommendation; thereafter the committee reported favorably on said ordinance on the 2<sup>nd</sup> day of July, 2014, which as a regular meeting of said Council; that at said regular meeting, the proposed ordinance was read by title to the City Council as first introduced and adopted by the following vote:

VOTING "AYE": Mayor Goodman and Councilmembers Tarkanian, Ross, Barlow, Coffin and Beers  
VOTING "NAY": None  
EXCUSED: Councilmember Anthony  
ABSTAINED: None

APPROVED:

  
CAROLYN G. GOODMAN, Mayor

ATTEST:

  
BEVERLY K. BRIDGES, MMC City Clerk

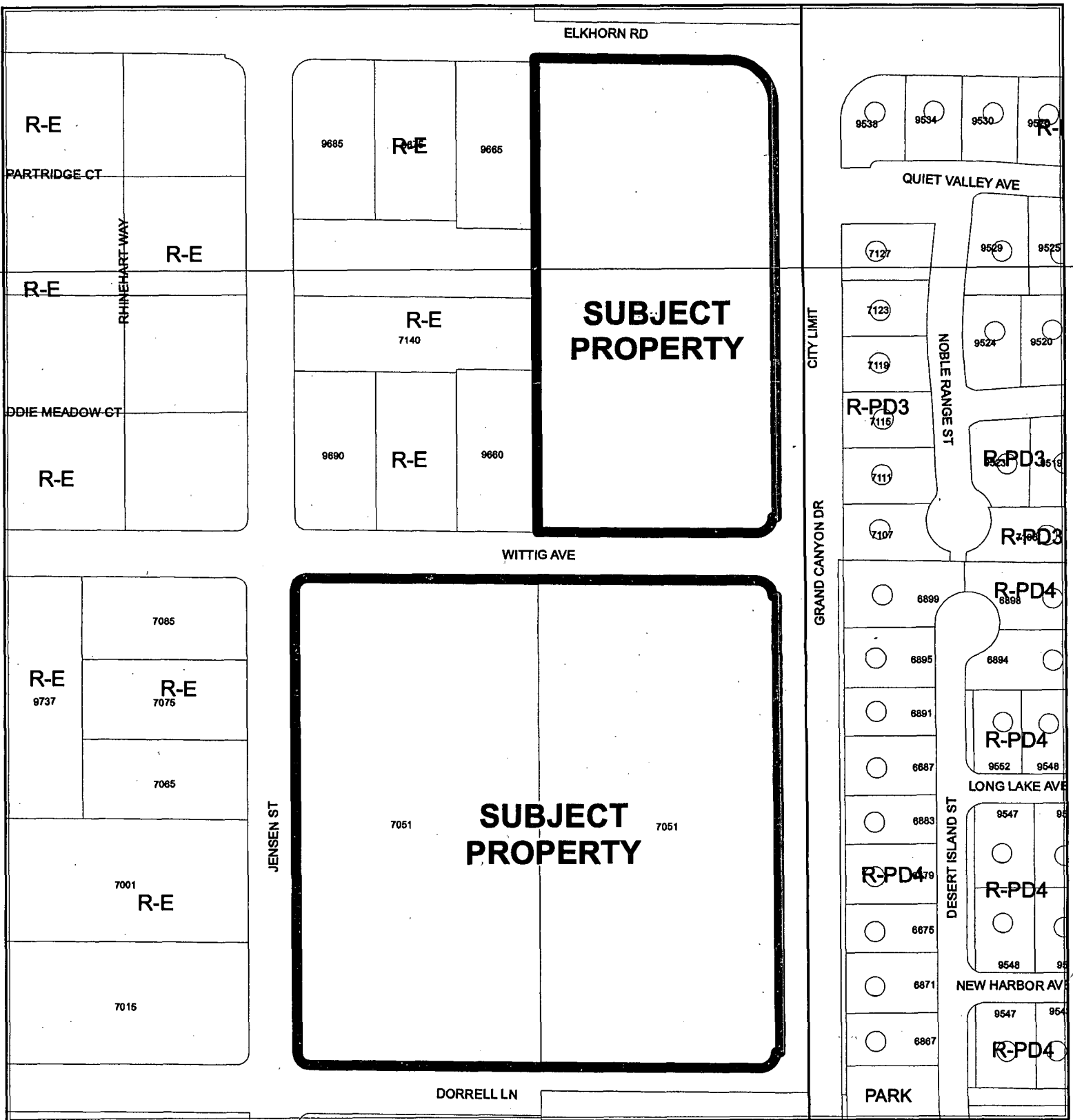

CASE: ANX-53692 (PRJ-53653)

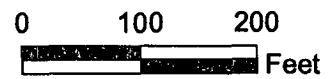

**AFFIDAVIT OF PUBLICATION**

STATE OF NEVADA)  
COUNTY OF CLARK) SS:

**LV CITY CLERK  
495 S MAIN ST  
LAS VEGAS NV 89101**

**Account # 22515  
Ad Number 0000223139**

Stacey M. Lewis, being 1st duly sworn, deposes and says: That she is the Legal Clerk for the Las Vegas Review-Journal and the Las Vegas Sun, daily newspapers regularly issued, published and circulated in the City of Las Vegas, County of Clark, State of Nevada, and that the advertisement, a true copy attached for, was continuously published in said Las Vegas Review-Journal and / or Las Vegas Sun in 1 edition(s) of said newspaper issued from 06/19/2014 to 06/19/2014, on the following days:

06 / 19 / 14

BILL NO. 2014-37 . . .

AN ORDINANCE TO EXTEND THE BOUNDARIES OF THE CITY, TO PARTICULARLY DESCRIBE THE LAND TO BE ANNEXED, TO MAKE ITS INHABITANTS SUBJECT TO THE LAWS, OBLIGATIONS AND BENEFITS OF THE CITY, AND TO PROVIDE FOR OTHER RELATED MATTERS. (ANX-53692)

Sponsored by: Councilman Steven D. Ross  
Summary: Annexes property described generally as located on the west side of Grand Canyon Road between Elkhorn Road and Dorrell Lane.

At the City Council meeting of June 4, 2014  
BILL NO. 2014-37 WAS READ BY TITLE AND REFERRED TO A RECOMMENDING COMMITTEE

COPIES OF THE COMPLETE ORDINANCE ARE AVAILABLE FOR PUBLIC INFORMATION IN THE OFFICE OF THE CITY CLERK, 2ND FLOOR, 495 SOUTH MAIN STREET, LAS VEGAS, NEVADA  
PUB: June 19, 2014  
LV Review-Journal

IS/   
LEGAL ADVERTISEMENT REPRESENTATIVE

Subscribed and sworn to before me on this 19th day of June, 2014

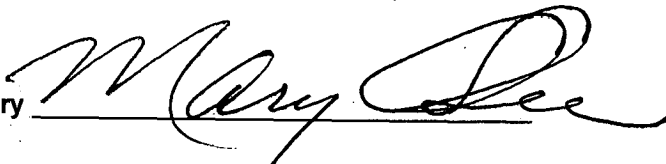
Notary 

 **MARY A. LEE**  
Notary Public State of Nevada  
No. 09-8941-1  
My Appt. Exp. Nov. 13, 2016

**Affidavit of Publication**

STATE OF NEVADA)  
COUNTY OF CLARK) SS:

LV CITY CLERK  
495 S MAIN ST  
LAS VEGAS NV 89101

Account # 22515  
Ad Number 0000240255

Stacey M. Lewis, being 1st duly sworn, deposes and says: That she is the Legal Clerk for the Las Vegas Review-Journal and the Las Vegas Sun, daily newspapers regularly issued, published and circulated in the City of Las Vegas, County of Clark, State of Nevada, and that the advertisement, a true copy attached for, was continuously published in said Las Vegas Review-Journal and / or Las Vegas Sun in 1 edition(s) of said newspaper issued from 07/05/2014 to 07/05/2014, on the following days:

07 / 05 / 14

BILL NO. 2014-37  
ORDINANCE NO. 6332

AN ORDINANCE TO EXTEND THE BOUNDARIES OF THE CITY, TO PARTICULARLY DESCRIBE THE LAND TO BE ANNEXED, TO MAKE ITS INHABITANTS SUBJECT TO THE LAWS, OBLIGATIONS AND BENEFITS OF THE CITY, AND TO PROVIDE FOR OTHER RELATED MATTERS. (ANX-53692)

Sponsored by: Councilman Steven D. Ross  
Summary: Annexes property described generally as located on the west side of Grand Canyon Road between Elkhorn Road and Dorrell Lane.

The above and foregoing ordinance was first proposed and read by title to the City Council on the 4th day of June 2014 and referred to a committee for recommendation; thereafter the committee reported favorably on said ordinance on the 2nd day of July 2014, which was a regular meeting of said City Council; and that at said regular meeting the proposed ordinance was read by title to the City Council as introduced and was adopted by the following vote:

VOTING "AYE": Mayor Goodman and Councilmembers Tarkanian, Ross, Barlow, Coffin, and Beers  
VOTING "NAY": NONE  
EXCUSED: Councilman Anthony

COPIES OF THE COMPLETE ORDINANCE ARE AVAILABLE FOR PUBLIC INFORMATION IN THE OFFICE OF THE CITY CLERK, 2ND FLOOR, 495 SOUTH MAIN STREET, LAS VEGAS, NEVADA  
PUB: July 5, 2014  
LV Review-Journal

*Stacey M. Lewis*  
\_\_\_\_\_  
LEGAL ADVERTISEMENT REPRESENTATIVE

Subscribed and sworn to before me on this 7th day of July, 2014

Notary *Mary Lee*  
\_\_\_\_\_

