

City of Las Vegas  
Department of Planning  
Development Services Center  
333 North Rancho Drive, 3<sup>rd</sup> Floor  
Las Vegas, Nevada 89106

5

## Return Service Requested Official Notice of Public Hearing

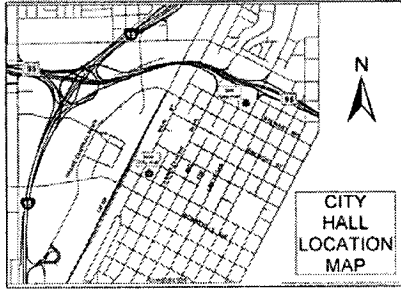

If you wish to file your protest or support on this request, check the appropriate box below and return this card in an envelope with postage to the Department of Planning at the address listed above, fax this side of this card to (702) 464-7499 or make your comments at [www.lasvegasnevada.gov](http://www.lasvegasnevada.gov). If you would like to contact your Council Representative, please call (702) 229-6405.

I SUPPORT  
this Request

I OPPOSE  
this Request

Please use available blank space on card for your comments.

**SUP-55295**

Special Planning Commission Meeting of **9/23/2014**

## Application Information

**SUP-55295 - SPECIAL USE PERMIT - PUBLIC HEARING - APPLICANT: M'LIFE WELLNESS, LLC - OWNER: NEVADA SPACE, INC.** - For possible action on a request for a Special Use Permit FOR A PROPOSED 4,000 SQUARE-FOOT MEDICAL MARIJUANA DISPENSARY at 2800 Highland Drive (APN 162-09-202-007), M (Industrial) Zone, Ward 1 (Tarkanian).

## Application Location

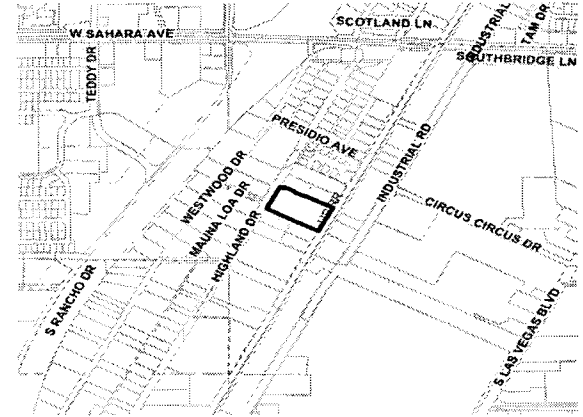

The proposed project may not pertain to the entire highlighted project site.

## Public Hearing Information

**Meeting:** Special Planning Commission  
**Date:** *September 23, 2014*  
**Time:** 3:00 P.M.  
**Location:** City Council Chambers  
495 South Main Street, 2<sup>nd</sup> Floor  
Las Vegas, Nevada 89101

Any and all interested persons may appear before the City Planning Commission either in person or by representative and object to or express approval of this request; or may, prior to this meeting, file a written objection thereto or approval thereof with the Department of Planning, Development Services Center, 333 North Rancho Drive, 3<sup>rd</sup> Floor, Las Vegas, Nevada 89106. Final Action on General Plan Amendments and Rezoning will be determined by the City Council. Other public hearing items may be deemed Final Action by the Planning Commission or forwarded to the City Council. The date of the City Council meeting, if applicable, will be announced at the Planning Commission meeting after the discussion of the item. For further information, including the full staff report, please call (702) 229-6301 (TDD 386-9108) or go to <http://www.lasvegasnevada.gov>.

**Report of All Selected Parcels****Case Number:** SUP-55295**Printed On:** Thu: August 7, 2014

<u>Owner</u>	<u>Address</u>	<u>Parcel Numbe</u>
2010-1 CRE NV-OFFICE L L C	2450 BROADWAY 6TH FLR SANTA MONICA CA 90404	16209302007
2575 S HIGHLAND DRIVE L P	2575 HIGHLAND DR LAS VEGAS NV 89109-1113	16209110018
2620 HIGHLAND L L C	10300 W CHARLESTON BLVD #13-156 LAS VEGAS NV 89135-1037	16209110024
2620 HIGHLAND L L C	10300 W CHARLESTON BLVD #13-156 LAS VEGAS NV 89135-1037	16209110023
2685 L L C	2830 ELK CANYON CT LAS VEGAS NV 89117-2982	16209104004
2687 L L C	2830 ELK CANYON CT LAS VEGAS NV 89117-2982	16209104005
2701 WESTWOOD L L C	1113 PINE ISLAND CT LAS VEGAS NV 89134-6330	16209102002
2861 S HIGHLAND DRIVE L L C	P O BOX 1305 CAMARILLO CA 93011-1305	16209201003
B M HIGHLAND L L C	3030 S HIGHLAND DR LAS VEGAS NV 89109-1047	16208707002
B M HIGHLAND L L C	3030 S HIGHLAND DR LAS VEGAS NV 89109-1047	16209301004
BANYAN PROPERTIES L L C	9030 W SAHARA AVE #299 LAS VEGAS NV 89117-5744	16209211002
BARRY PATRICK & DAWN L	2664 HIGHLAND DR LAS VEGAS NV 89109-1116	16209110027
BRADY DONALD B	2600 WESTWOOD DR LAS VEGAS NV 89109-1118	16209110005
BRADY DONALD B	2600 WESTWOOD DR LAS VEGAS NV 89109-1118	16209110004
BROSSEAU 1993 TRUST	BROSSEAU PAUL H TRS 2609 S HIGHLAND DR LAS VEGAS NV 89109-1156	16209110015
CARL ROBERT SCOTT LIVING TR 2006	CARL ROBERT S TRS 2605 HIGHLAND DR LAS VEGAS NV 89109-1113	16209110016
CARTANIA INC	4465 S JONES BLVD LAS VEGAS NV 89103-3307	16209110028
CARTANIA INC	4465 S JONES BLVD LAS VEGAS NV 89103-3307	16209110030
CARTANIA INC	4465 S JONES BLVD LAS VEGAS NV 89103-3307	16209110029
CIRCUS CIRCUS CASINOS INC	4882 FRANK SINATRA DR LAS VEGAS NV 89158-4316	16209501001
CIRCUS CIRCUS CASINOS INC	4882 FRANK SINATRA DR LAS VEGAS NV 89158-4316	16209204002
CIRCUS CIRCUS ENTERPRISES INC	4882 FRANK SINATRA DR LAS VEGAS NV 89158-4316	16209204001
CLAREMONT HOTEL INC	135 W 70TH ST #7CD NEW YORK NY 10023	16209102005
CNB FKA BBN L L C	C SHELTON 2015 E WINDMILL LN LAS VEGAS NV 89123	16209110021
CNB FKA BBN L L C	C SHELTON 2015 E WINDMILL LN LAS VEGAS NV 89123	16209110035
COUNTY OF CLARK(FIRE DEPT)	500 S GRAND CENTRAL PKWY LAS VEGAS NV 89155	16209303006
D 2753 L L C	6200 RICHMOND AVE #111 HOUSTON TX 77057	16209102004
D 2753 L L C	6200 RICHMOND AVE #111 HOUSTON TX 77057	16209102003
D 2765 L L C	8222 ANOINE DR #100 HOUSTON TX 77088	16209201001
D 2801 WESTWOOD INC	P O BOX 570413 HOUSTON TX 77257-0413	16208604001
DITEL L L C	6817 S EASTERN AVE #101 LAS VEGAS NV 89119-4684	16209203003
DITEL L L C	6817 S EASTERN AVE #101 LAS VEGAS NV 89119-4684	16209203002

**Report of All Selected Parcels****Case Number:** SUP-55295**Printed On:** Thu: August 7, 2014

<u>Owner</u>	<u>Address</u>	<u>Parcel Numbe</u>
DITEL L L C	6817 S EASTERN AVE #101 LAS VEGAS NV 89119-4684	16209203001
DRATTER PETER J LIVING TRUST	DRATTER PETER J TRS P O BOX 277 HURRICANE UT 84737-0277	16209104003
E-J CLUB L L C	12740 E CONTROL TOWER RD #J8 ENGLEWOOD CO 80112	16209203005
ENGLERT HIGHLANDS PPTYS L L C	P O BOX 46650 LAS VEGAS NV 89114-6650	16208705002
ENGLERT HIGHLANDS PPTYS L L C	P O BOX 46650 LAS VEGAS NV 89114-6650	16208705001
ENGLERT SUTTER PROPERTIES L L C	2935 S HIGHLAND DR LAS VEGAS NV 89109-1011	16209110034
F K C HIGHLAND L L C	180 N RIVERVIEW DR #100 ANAHEIM CA 92808	16209301002
F K C HIGHLAND L L C	180 N RIVERVIEW DR #100 ANAHEIM CA 92808	16209202012
F K C HIGHLAND L L C	180 N RIVERVIEW DR #100 ANAHEIM CA 92808	16208707001
F K C HIGHLAND L L C	180 N RIVERVIEW DR #100 ANAHEIM CA 92808	16209301003
F K C HIGHLAND L L C	180 N RIVERVIEW DR #100 ANAHEIM CA 92808	16208706001
GARRETT CAPITAL L L C	3790 PARADISE RD #250 LAS VEGAS NV 89169-4640	16209102008
H & H CORPORATION	6120 S TORREY PINES LAS VEGAS NV 89118-3209	16208705006
H & H CORPORATION	6120 S TORREY PINES LAS VEGAS NV 89118-3209	16208705005
HAAS FAMILY TRUST	HAAS ROBERT MELVIN & JO A TRS 10804 FRANKLIN HILLS AVE LAS VEGAS NV 89135-1725	16209211005
HAAS FAMILY TRUST	10804 FRANKLIN HILLS AVE LAS VEGAS NV 89135	16209211006
HIGHLAND BY THE HIGHWAY L L C	8275 S EASTERN AVE #200 LAS VEGAS NV 89123-2545	16209110017
HIGHLAND INDUST PK PTNRSH	2500 W SAHARA AVE #211 LAS VEGAS NV 89102-4393	16208611010
HIGHLAND INDUST PK PTNRSH	2500 W SAHARA AVE #211 LAS VEGAS NV 89102-4393	16208611016
HIGHLAND INDUST PK PTNRSH	2500 W SAHARA AVE #211 LAS VEGAS NV 89102-4393	16208611007
HIGHLAND INDUST PK PTNRSH	2500 W SAHARA AVE #211 LAS VEGAS NV 89102-4393	16208611012
HIGHLAND INDUST PK PTNRSH	2500 W SAHARA AVE #211 LAS VEGAS NV 89102-4393	16209210001
HIGHLAND INDUST PK PTNRSH	2500 W SAHARA AVE #211 LAS VEGAS NV 89102-4393	16208611008
HIGHLAND INDUST PK PTNRSH	2500 W SAHARA AVE #211 LAS VEGAS NV 89102-4393	16208611009
HIGHLAND INDUST PK PTNRSH	2500 W SAHARA AVE #211 LAS VEGAS NV 89102-4393	16208611001
HIGHLAND INDUST PK PTNRSH	2500 W SAHARA AVE #211 LAS VEGAS NV 89102-4393	16208611011
HIGHLAND INDUST PK PTNRSH	2500 W SAHARA AVE #211 LAS VEGAS NV 89102-4393	16208611005
HIGHLAND INDUST PK PTNRSH	2500 W SAHARA AVE #211 LAS VEGAS NV 89102-4393	16208611004
HIGHLAND INDUST PK PTNRSH	2500 W SAHARA AVE #211 LAS VEGAS NV 89102-4393	16208611003
HIGHLAND INDUST PK PTNRSH	2500 W SAHARA AVE #211 LAS VEGAS NV 89102-4393	16208611002
HIGHLAND INDUST PK PTNRSH	2500 W SAHARA AVE #211 LAS VEGAS NV 89102-4393	16208611015
HIGHLAND INDUST PK PTNRSH	2500 W SAHARA AVE #211 LAS VEGAS NV 89102-4393	16208611014

**Report of All Selected Parcels****Case Number:** SUP-55295**Printed On:** Thu: August 7, 2014

<u>Owner</u>	<u>Address</u>	<u>Parcel Numbe</u>
HIGHLAND INDUST PK PTNRSHIP	2500 W SAHARA AVE #211 LAS VEGAS NV 89102-4393	16208611006
HIGHLAND INDUST PK PTNRSHIP	2500 W SAHARA AVE #211 LAS VEGAS NV 89102-4393	16209210002
HIGHLAND INDUSTRIAL PARK PTNRSHIP	2500 W SAHARA AVE #211 LAS VEGAS NV 89102-4393	16208611013
HIGHLAND INDUSTRIAL PARK PTNRSHIP	2500 W SAHARA AVE #211 LAS VEGAS NV 89102-4393	16208604002
HIGHLAND NEVADA PROPERTY L L C	1850 BUSINESS CENTER DR DUARTE CA 91010-2901	16209202014
HUGHES FAMILY L L C #2	COURY FAMILY L L C #3 2975 S HIGHLAND DR LAS VEGAS NV 89109-1011	16208705004
J X E INVESTMENT L L C	10569 PURDEY RD EDEN PRAIRIE MN 55347	16208703003
JACOBS JOSEPH & NANCY TRUST	JACOBS JOSEPH A & NANCY D TRS 3729 TOPAWA ST LAS VEGAS NV 89103-2435	16209211009
JACOBS JOSEPH & NANCY TRUST	JACOBS JOSEPH A & NANCY D TRS 3729 TOPAWA ST LAS VEGAS NV 89103-2435	16209111001
JOHNSON FAMILY REVOCABLE TRUST	379 N 1580 W HURRICANE UT 84737	16209110011
K E N C O INVESTMENTS L L C	2504 SPRINGBROOK DR LAS VEGAS NV 89134-7584	16209110022
KHAZAI SHAHRIAR & ISABELA	P O BOX 25879 LOS ANGELES CA 90025-0879	16209202008
L C 111 L L C	P O BOX 81745 LAS VEGAS NV 89180-1745	16209110032
L'CHAIM WESTERN SUPPLY PPTY LLC	6130 W FLAMINGO RD #402 LAS VEGAS NV 89103-2280	16209201002
LEONARDI PROPERTIES	46 LOUISE ST SAN RAFAEL CA 94901-4718	16209203006
M T WAREHOUSE L L C	9030 W SAHARA AVE #299 LAS VEGAS NV 89117-5744	16209211004
M T WAREHOUSE L L C	9030 W SAHARA AVE #299 LAS VEGAS NV 89117-5744	16209211003
MARTIN ROBERT E & KAYE	1500 MARBELLA RIDGE CT LAS VEGAS NV 89117	16208703001
MARX GORDON L	X R A M L L C 2620 WESTERN AVE LAS VEGAS NV 89109	16209110036
MENDELL FAMILY PARTNERS L P	P O BOX 8510 RANCHO SANTA FE CA 92067-8510	16208703002
MOMARY DOUGLAS R & EMILY J	BOND GEORGE T & PHYLLIS D 2708 HIGHLAND DR LAS VEGAS NV 89109-1004	16209111002
N & J PROPERTIES NEVADA L L C	2305 WIMBLEDON LAS VEGAS NV 89107-2363	16209110025
N P PALACE L L C	1505 S PAVILION CENTER DR LAS VEGAS NV 89135-1403	16208502010
N P PALACE L L C	1505 S PAVILION CENTER DR LAS VEGAS NV 89135-1403	16208502011
N P PALACE L L C	1505 S PAVILION CENTER DR LAS VEGAS NV 89135-1403	16208502006
N P PALACE L L C	1505 S PAVILION CENTER DR LAS VEGAS NV 89135-1403	16208502009
N P PALACE L L C	1505 S PAVILION CENTER DR LAS VEGAS NV 89135-1403	16208502007
N P PALACE L L C	1505 S PAVILION CENTER DR LAS VEGAS NV 89135-1403	16208505004
N P PALACE L L C	1505 S PAVILION CENTER DR LAS VEGAS NV 89135-1403	16208602005
N Y P CORPORATION	6120 S TORREY PINES LAS VEGAS NV 89118-3209	16209202013
N Y P CORPORATION	6120 S TORREY PINES LAS VEGAS NV 89118-3209	16209202001
NEVADA POWER COMPANY	P O BOX 10100 RENO NV 89520	16209104002

**Report of All Selected Parcels****Case Number:** SUP-55295**Printed On:** Thu: August 7, 2014

<u>Owner</u>	<u>Address</u>	<u>Parcel Numbe</u>
NEVADA POWER COMPANY	P O BOX 98910 LAS VEGAS NV 89193-8910	16209103002
O H D B L L C	2651 WEST WOOD DR LAS VEGAS NV 89109-1117	16209102006
P L MOTOR L L C	6625 W BADURA AVE LAS VEGAS NV 89118-4673	16209211007
PFIZENMAYER FAMILY TRUST	PFIZENMAYER GARY & ANGEL TRS 2338 READING HILLS AVE HENDERSON NV 89052-5836	16208705003
PLANET PROPERTIES L L C	1647 COLLINGWOOD DR SAN DIEGO CA 92109	16209202009
PLANET PROPERTIES L L C	1647 COLLINGWOOD DR SAN DIEGO CA 92109	16209202011
POSITIVE SPACE INC	18 STAR BROOK AVE HENDERSON NV 89052-6628	16209202010
R S G PARTNERS L L C	1625 SKYLINE DR FULLERTON CA 92831-1007	16208704001
RED OAK TRUST	CREEL ALLAN & DEBORAH TRS 11 BURNING TREE CT LAS VEGAS NV 89113-1329	16209110013
RED OAK TRUST	CREEL ALLAN & DEBORAH TRS 11 BURNING TREE CT LAS VEGAS NV 89113-1329	16209110012
RED OAK TRUST	CREEL ALLAN & DEBORAH TRS 6330 W SUNSET RD LAS VEGAS NV 89118-3318	16209110010
RESORTS WORLD LAS VEGAS L L C	300 S 4TH ST #1700 LAS VEGAS NV 89101	16209303004
RESORTS WORLD LAS VEGAS L L C	300 S 4TH ST #1700 LAS VEGAS NV 89101	16209310002
RESORTS WORLD LAS VEGAS L L C	300 S 4TH ST #1700 LAS VEGAS NV 89101	16209311003
RODRIGUEZ NORMA E	2621 HIGHLAND DR LAS VEGAS NV 89109-1113	16209110014
S H A C MT L L C	11151 MISSOURI AVE LOS ANGELES CA 90025-5634	16209302006
SCHIFF MARVIN JAMES TRS	MASON FAMILY TRUST 2401 INDUSTRIAL RD LAS VEGAS NV 89102-4817	16209301001
SEDANO AIDA C & HIRAM H	2706 S HIGHLAND DR LAS VEGAS NV 89109-1004	16209211008
SHARPE ALLEN L TRUST	SHARPE FLORENCE M TRUST 2855 BELCASTRO ST LAS VEGAS NV 89117-3035	16209110008
SHARPE ALLEN L TRUST	SHARPE FLORENCE M TRUST 2855 BELCASTRO ST LAS VEGAS NV 89117-3035	16209110009
SHARPE ALLEN L TRUST	SHARPE FLORENCE M TRUST 2855 BELCASTRO ST LAS VEGAS NV 89117-3035	16209110007
SHARPE ALLEN L TRUST	SHARPE FLORENCE M TRUST 2855 BELCASTRO ST LAS VEGAS NV 89117-3035	16209110006
SOBEL WESTEX	2670 S WESTERN AVE LAS VEGAS NV 89109-1112	16209110037
SOBEL WESTEX	2670 S WESTERN AVE LAS VEGAS NV 89109-1112	16209110038
SOBEL WESTEX	2670 S WESTERN AVE LAS VEGAS NV 89109-1112	16209110039
SOBEL WESTEX	2670 S WESTERN AVE LAS VEGAS NV 89109-1112	16209110041
SOBEL WESTEX	2670 S WESTERN AVE LAS VEGAS NV 89109-1112	16209110040
STORAGE WORKS II L L C	2922 RED ARROW DR LAS VEGAS NV 89135	16208704003
THISTLE DANIEL J & J J FAM TR	THISTLE FAMILY TRUST 2710 S HIGHLAND DR LAS VEGAS NV 89109	16209211001
TRUSTEE CLARK COUNTY TREASURER	1900 E DESERT INN RD LAS VEGAS NV 89169-3211	16209202007
URBAN LAND NEVADA	3271 S HIGHLAND DR #704 LAS VEGAS NV 89109-1051	16209110020
W B P LEASING INC	621 NW 53RD ST #700 BOCA RATON FL 33487-8242	16209203004

**Report of All Selected Parcels****Case Number:** SUP-55295**Printed On:** Thu: August 7, 2014

<u>Owner</u>	<u>Address</u>	<u>Parcel Numbe</u>
WADE JO FERN TRUST	SHANE DAVID L CO-TRS 200 N WESTLAKE BLVD #201 WESTLAKE VILLAGE CA 91362-3774	16209110026
WESTCOM DEVELOPMENT L L C	3273 E WARM SPRINGS RD LAS VEGAS NV 89120-3157	16209110033
WESTWOOD RENTAL L L C	3592 PROCYON ST LAS VEGAS NV 89103-1908	16208704002
WYANDOTTE HOLDINGS L L C	299 PARK AVE 42ND FL NEW YORK NY 10171-4299	16208610104
WYANDOTTE HOLDINGS L L C	299 PARK AVE 42ND FL NEW YORK NY 10171-4299	16208602002
ZARGARYAN GAGIK & K REV TR AGMT	ZARGARYAN GAGIK & KNARIK CO-TRS 2920 S TIOGA WAY LAS VEGAS NV 89117-3202	16209110031