

City of Las Vegas
Department of Planning
Development Services Center
333 North Rancho Drive, 3rd Floor
Las Vegas, Nevada 89106

S.

Return Service Requested Official Notice of Public Hearing

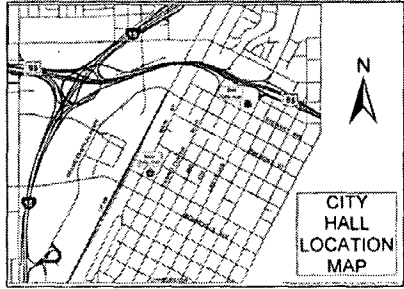

If you wish to file your protest or support on this request, check the appropriate box below and return this card in an envelope with postage to the Department of Planning at the address listed above, fax this side of this card to (702) 464-7499 or make your comments at www.lasvegasnevada.gov. If you would like to contact your Council Representative, please call (702) 229-6405.

I SUPPORT
this Request

I OPPOSE
this Request

Please use available blank space on card for your comments.

SUP-55278

Special Planning Commission Meeting of **9/23/2014**

Application Information

SUP-55278 - SPECIAL USE PERMIT - PUBLIC HEARING - APPLICANT: NATURAL MEDICINE, LLC - OWNER: THE JEWELERS, INC. 401(K) PROFIT SHARING PLAN AND TRUST - For possible action on a request for a Special Use Permit FOR A PROPOSED 3,414 SQUARE-FOOT MEDICAL MARIJUANA DISPENSARY at 2411 Western Avenue Suites, A, B and C (APN 162-04-406-011), M (Industrial) Zone, Ward 3 (Coffin).

Application Location

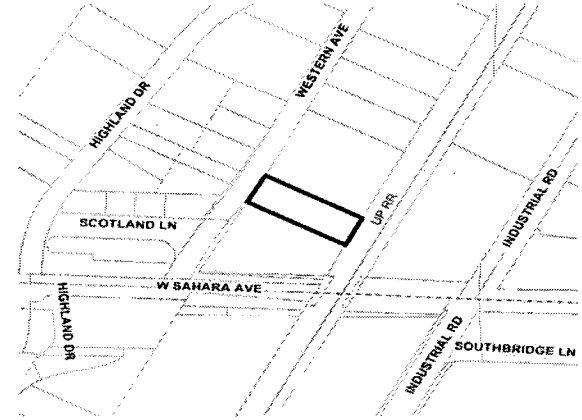

The proposed project may not pertain to the entire highlighted project site.

Public Hearing Information

Meeting: Special Planning Commission
Date: *September 23, 2014*
Time: 3:00 P.M.
Location: City Council Chambers
495 South Main Street, 2nd Floor
Las Vegas, Nevada 89101

Any and all interested persons may appear before the City Planning Commission either in person or by representative and object to or express approval of this request; or may, prior to this meeting, file a written objection thereto or approval thereof with the Department of Planning, Development Services Center, 333 North Rancho Drive, 3rd Floor, Las Vegas, Nevada 89106. Final Action on General Plan Amendments and Rezoning will be determined by the City Council. Other public hearing items may be deemed Final Action by the Planning Commission or forwarded to the City Council. The date of the City Council meeting, if applicable, will be announced at the Planning Commission meeting after the discussion of the item. For further information, including the full staff report, please call (702) 229-6301 (TDD 386-9108) or go to <http://www.lasvegasnevada.gov>.

9

Report of All Selected Parcels

Case Number: SUP-55278

Printed On: Thu: August 7, 2014

<u>Owner</u>	<u>Address</u>	<u>Parcel Numbe</u>
1901 LOCH LOMOND WY TRUST	P O BOX 36208 LAS VEGAS NV 89133	16204311018
2000 WESTERN L L C	3111 BEL AIR DR #17G LAS VEGAS NV 89109	16204302004
2000 WESTERN L L C	3111 BEL AIR DR #17G LAS VEGAS NV 89109	16204302003
2201 L L C	2830 ELK CANYON CT LAS VEGAS NV 89117-2982	16204803009
2201 L L C	2830 ELK CANYON CT LAS VEGAS NV 89117-2982	16204803008
2320 WESTERN L L C	375 LAUREL DR BOULDER CITY NV 89005-2646	16204404003
2424 WESTERN REALTY INC	2424 WESTERN AVE LAS VEGAS NV 89102-4816	16204404017
2575 S HIGHLAND DRIVE L P	2575 HIGHLAND DR LAS VEGAS NV 89109-1113	16209110018
2620 HIGHLAND L L C	10300 W CHARLESTON BLVD #13-156 LAS VEGAS NV 89135-1037	16209110024
2620 HIGHLAND L L C	10300 W CHARLESTON BLVD #13-156 LAS VEGAS NV 89135-1037	16209110023
2685 L L C	2830 ELK CANYON CT LAS VEGAS NV 89117-2982	16209104004
2687 L L C	2830 ELK CANYON CT LAS VEGAS NV 89117-2982	16209104005
AD AMERICA INC	2310 HIGHLAND DR LAS VEGAS NV 89102-4809	16204402004
ALVERNAZ JOSEPH P & LINDA	235 UPPER CAMP LOOP RD ROSEBURG OR 97470-9483	16204406002
ALVERNAZ JOSEPH P & LINDA	235 UPPER CAMP LOOP RD ROSEBURG OR 97470-9483	16204406001
AMBER INVESTMENT COMPANY	132 9TH ST #200 OAKLAND CA 94607-4727	16204807002
B E L L L C	2929 PLEASANT LAKE DR LAS VEGAS NV 89117	16204803007
BALTIMORE GARDEMS LTD PTNRSHP	14125 CLAYTON RD CHESTERFIELD MO 63017-8355	16204810003
BALTIMORE GARDEMS LTD PTNRSHP	14125 CLAYTON RD CHESTERFIELD MO 63017-8355	16204810004
BALTIMORE GARDEMS LTD PTNRSHP	14125 CLAYTON RD CHESTERFIELD MO 63017-8355	16204810001
BALTIMORE GARDEMS LTD PTNRSHP	14125 CLAYTON RD CHESTERFIELD MO 63017-8355	16204810002
BALTIMORE GARDEMS LTD PTNRSHP	14125 CLAYTON RD CHESTERFIELD MO 63017-8355	16204810005
BALTIMORE GARDENS L P	14125 CLAYTON RD CHESTERFIELD MO 63017-8355	16204806001
BELL REAL ESTATE L L C	1910 INDUSTRIAL RD LAS VEGAS NV 89102-4610	16204704008
BELL REAL ESTATE L L C	1910 INDUSTRIAL RD LAS VEGAS NV 89102-4610	16204802001
BELL REAL ESTATE L L C	1900 INDUSTRIAL RD LAS VEGAS NV 89102-4610	16204802018
BELL REAL ESTATE L L C	1910 INDUSTRIAL RD LAS VEGAS NV 89102-4610	16204802011
BELL REAL ESTATE L L C	1910 INDUSTRIAL RD LAS VEGAS NV 89102-4610	16204802003
BOYER ELAINE	SCHWINGDORF LEONARD & L LIV TR 6245 GALILEO DR LAS VEGAS NV 89149-1385	16204404013
BOYER ELAINE	SCHWINGDORF LEONARD & L LIV TR 6245 GALILEO DR LAS VEGAS NV 89149-1385	16204404011
BRADY DONALD B	2600 WESTWOOD DR LAS VEGAS NV 89109-1118	16209110005
BRADY DONALD B	2600 WESTWOOD DR LAS VEGAS NV 89109-1118	16209110004

Report of All Selected Parcels**Case Number:** SUP-55278**Printed On:** Thu: August 7, 2014

<u>Owner</u>	<u>Address</u>	<u>Parcel Numbe</u>
BROSSEAU 1993 TRUST	BROSSEAU PAUL H TRS 2609 S HIGHLAND DR LAS VEGAS NV 89109-1156	16209110015
CARL ROBERT SCOTT LIVING TR 2006	CARL ROBERT S TRS 2605 HIGHLAND DR LAS VEGAS NV 89109-1113	16209110016
CARTANIA INC	4465 S JONES BLVD LAS VEGAS NV 89103-3307	16209110030
CHAMBERLAIN DAVID T & LINDA L	P O BOX 473 SURFSIDE CA 90743	16204811032
CHAMBERLAIN DAVID T & LINDA L	P O BOX 473 SURFSIDE CA 90743	16204811033
CIRCUS CIRCUS CASINOS INC	4882 FRANK SINATRA DR LAS VEGAS NV 89158-4316	16209501001
CLAREMONT HOTEL INC	135 W 70TH ST #7CD NEW YORK NY 10023	16209102005
CNB FKA BBN L L C	C SHELTON 2015 E WINDMILL LN LAS VEGAS NV 89123	16209110021
CNB FKA BBN L L C	C SHELTON 2015 E WINDMILL LN LAS VEGAS NV 89123	16209110035
CRICHLow DONALD & TRACY	678 W MENDOCINO ST ALTADENA CA 91001	16204811009
D K M DEVELOPMENT L L C	3273 E WARM SPRINGS RD LAS VEGAS NV 89120-3157	16204703009
DALTON JACQUELINE R	7000 TRADING POST LN LAS VEGAS NV 89125	16204404009
DENAULT JOHN B TRUST	500 LINDEN AVE SOUTH SAN FRANCISCO CA 94066	16204803006
DIAMONOF 1991 TRUST	DIAMONOF CHARLES J & C J CO-TRS 1913 BIRCH ST LAS VEGAS NV 89102-4405	16204312058
DRATTER PETER J LIVING TRUST	DRATTER PETER J TRS P O BOX 277 HURRICANE UT 84737-0277	16209104003
DREWCHRIS L L C	8847 LAKERSHKM BLVD SUN VALLEY CA 91352	16204703011
DUNN DENNIS	1812 IVANHOE WAY LAS VEGAS NV 89102	16204311012
EDSCHIT TRUST	8880 W SUNSET RD #250 LAS VEGAS NV 89148-5006	16204811047
ENGLERT BRAD & ROBYN	2935 S HIGHLAND DR LAS VEGAS NV 89109-1011	16204406005
ENGLERT BRAD & ROBYN	2935 S HIGHLAND DR LAS VEGAS NV 89109-1011	16204406006
ENGLERT SUTTER PROPERTIES L L C	2935 S HIGHLAND DR LAS VEGAS NV 89109-1011	16209110034
FAVELA ERASMO	1821 LOCH LOMOND WY LAS VEGAS NV 89102-4437	16204311020
FELDMAN SAM TRUST	FELDMAN ROBERT L TRS 800 N RAINBOW BLVD #208 LAS VEGAS NV 89107-1193	16204301010
FERRIS INVESTMENTS INC	P O BOX 232345 LAS VEGAS NV 89105	16204301008
FLEMING KENNETH E & JOY C LIV TR	FLEMING JOY C TRS 7850 WILLIAMSON VALLEY RD PRESCOTT AZ 86305	16204406009
FLOWER WILLIAM P FAMILY TRUST	FLOWER WILLIAM P TRS 2606 BRYANT AVE LAS VEGAS NV 89102-2177	16204311015
FONSECA GUADALUPE	HERNANDEZ EVELIA 2129 GLEN HEATHER WY LAS VEGAS NV 89102-4417	16204410009
G J G DEVELOPMENT L L C	6903 GOOSE RIVER AVE LAS VEGAS NV 89131-0121	16204301012
GALLIGAN THOMAS L L C	2110 S HIGHLAND LAS VEGAS NV 89102-4622	16204301011
GARRETT CAPITAL L L C	3790 PARADISE RD #250 LAS VEGAS NV 89169-4640	16209102008
GARRETT CAPITAL L L C	3790 PARADISE RD #250 LAS VEGAS NV 89169-4640	16209102009
GARRETT CAPITAL L L C	3790 PARADISE RD #250 LAS VEGAS NV 89169-4640	16209102010

Report of All Selected Parcels**Case Number:** SUP-55278**Printed On:** Thu: August 7, 2014

<u>Owner</u>	<u>Address</u>	<u>Parcel Number</u>
GARRISON RODERICK E & V M FAM TR	GARRISON R E & V M CO-TRS 1904 BIRCH ST LAS VEGAS NV 89102-4443	16204312036
GIBSON HARRY & CHARLOTTE TRUST	SANDERS ELISABETH TRS P O BOX 2770 ALPINE CA 91903-2770	16204411006
GONZALEZ AHUIZOTL	1608 KIRKLAND LAS VEGAS NV 89102-4415	16204411002
GRAINGER W W INC	410 17TH ST #1175 DENVER CO 80202-4439	16204406010
GREMM MANFRED	GREMM MYRA 2405 HIGHLAND DR LAS VEGAS NV 89102-4803	16204404007
GRIFFIS CURTIS ALLEN	2412 WESTERN AVE LAS VEGAS NV 89102-4816	16204404012
GRIFFITHS BRIAN KEITH	1615 8TH ST OAKLAND CA 94607	16204411001
GUTIERREZ CHRISTIAN GALINDO	GALINDO CISSY M 1909 BIRCH ST LAS VEGAS NV 89102-4405	16204312033
HALEX HOLDINGS L L C	18-20 STEINWAY ST ASTORIA NY 11105-1011	16204406004
HALEX HOLDINGS L L C	18-20 STEINWAY ST ASTORIA NY 11105-1011	16204406003
HANG CHU L L C	722 N ROYAL CREST CIR #51 LAS VEGAS NV 89169-3851	16204811050
HANG CHU L L C	722 N ROYAL CREST CIR #51 LAS VEGAS NV 89169-3851	16204811049
HANG CHU L L C	722 N ROYAL CREST CIR #51 LAS VEGAS NV 89169-3851	16204811048
HEISHMAN JOHN	7016 ACORN CT LAS VEGAS NV 89147-4712	16204312059
HELLER BERYL S	1908 INVERNESS AVE LAS VEGAS NV 89102-4423	16204312032
HIGHLAND BY THE HIGHWAY L L C	8275 S EASTERN AVE #200 LAS VEGAS NV 89123-2545	16209110017
HILTON RESORTS CORPORATION	6355 METRO WEST BLVD #180 ORLANDO FL 32835	16209613001
HOGAN ROBERT E & DOLORES F	1908 BIRCH ST LAS VEGAS NV 89102-4443	16204312035
I B I AMERICA	324 W CINCINNATI AVE #3 LAS VEGAS NV 89102-5066	16204811022
I B I AMERICA	324 W CINCINNATI AVE #3 LAS VEGAS NV 89102-5066	16204811024
I B I AMERICA	324 W CINCINNATI AVE #3 LAS VEGAS NV 89102-5066	16204811031
I B I AMERICA	324 W CINCINNATI AVE #3 LAS VEGAS NV 89102-5066	16204811017
I B I AMERICA	324 W CINCINNATI AVE #3 LAS VEGAS NV 89102-5066	16204811030
I B I AMERICA	324 W CINCINNATI AVE #3 LAS VEGAS NV 89102-5066	16204811029
I B I AMERICA	324 W CINCINNATI AVE #3 LAS VEGAS NV 89102-5066	16204811019
I B I AMERICA	324 W CINCINNATI AVE #3 LAS VEGAS NV 89102-5066	16204811023
I B I AMERICA	324 W CINCINNATI AVE #3 LAS VEGAS NV 89102-5066	16204811025
I B I AMERICA	324 W CINCINNATI AVE #3 LAS VEGAS NV 89102-5066	16204811021
I B I AMERICA	324 W CINCINNATI AVE #3 LAS VEGAS NV 89102-5066	16204811020
I B I AMERICA	324 W CINCINNATI AVE #3 LAS VEGAS NV 89102-5066	16204811018
I B I AMERICA	324 W CINCINNATI AVE #3 LAS VEGAS NV 89102-5066	16204811016
INDUSTRIAL L L C	6450 SPRING MOUNTAIN RD #12 LAS VEGAS NV 89146-8836	16204802006

Report of All Selected Parcels**Case Number:** SUP-55278**Printed On:** Thu: August 7, 2014

<u>Owner</u>	<u>Address</u>	<u>Parcel Numbe</u>
INDUSTRIAL ROAD 2440-2497 L L C	1000 S WESTGATE AVE #100 LOS ANGELES CA 90049-7206	16204407001
J & M H FAMILY L P	2416 TAM DR LAS VEGAS NV 89102-4966	16204803014
JANEWAY L L C	2319 WESTERN AVE LAS VEGAS NV 89102	16204406008
JANEWAY L L C	2885 MANN ST LAS VEGAS NV 89146-5230	16204406007
JAROS PAULINE M	1817 LOCH LOMOND WY LAS VEGAS NV 89102-4437	16204311021
JAYASINGHA IMOGENE & GLADSTONE	JAYASINGHA GLADSTONE 2104 GLEN HEATHER WY LAS VEGAS NV 89102-4418	16204410010
JEWELER'S 401K PFT SHR PL & TR	2400 WESTERN AVE LAS VEGAS NV 89102-4816	16204406011
JOHNSON BERTHA	3963 S LASALLE AVE LOS ANGELES CA 90062	16204311014
K E N C O INVESTMENTS L L C	2504 SPRINGBROOK DR LAS VEGAS NV 89134-7584	16209110022
KARR JERRY K & JAMES N L C 111 L L C	2111 WESTERN AVE LAS VEGAS NV 89102-4621 P O BOX 81745 LAS VEGAS NV 89180-1745	16204801001 16209110032
LOCH LOMOND IRREVOCABLE TRUST	TILROE JASON TRS 1825 LOCH LOMOND WY LAS VEGAS NV 89102-4437	16204311019
LUCKY DRAGON L L C	601 S 10TH ST #201 LAS VEGAS NV 89101	16204811028
MACMILLAN BYRON F	P O BOX 7440 LAS VEGAS NV 89125-7440	16204811002
MACMILLAN DOUGLAS JR	P O BOX 7440 LAS VEGAS NV 89125-7440	16204811003
MAGAR JAMES	3020 WATERSIDE CIR LAS VEGAS NV 89117-2276	16204410012
MARSHALL FAMILY L P	P O BOX 46470 LAS VEGAS NV 89114-6470	16204802007
MARTIN ROBERT L & KATHLEEN P	2410 WESTERN AVE LAS VEGAS NV 89102-4816	16204404010
MARX GORDON L	X R A M L L C 2620 WESTERN AVE LAS VEGAS NV 89109	16209110036
MCKINLEY RAYMOND & NINA	5109 GENTLE RIVER AVE LAS VEGAS NV 89130	16204311017
MCKNIGHT KIRK	1909 LOCH LOMOND WAY LAS VEGAS NV 89102-4442	16204311016
MELVID INC	4660 S EASTERN AVE #105 LAS VEGAS NV 89119-6138	16204811036
MILLER GARY & VELMA TRUST	MILLER GARY H & VELMA L TRS 7634 TROPHY PLACE DR HUMBLE TX 77346-8003	16204312037
MISCH LINDA	4519 ADMIRALTY WAY #D MARINA DEL REY CA 90292	16204811004
MONTCLAIR APTS INC	327 W CINCINNATI ST LAS VEGAS NV 89102-5037	16204811034
MONTCLAIR APTS INC	327 W CINCINNATI ST LAS VEGAS NV 89102-5037	16204811035
MONTEREY PROPERTIES L L C	7278 CROW CANYON AVE LAS VEGAS NV 89179	16204811001
MORRIS PROPERTIES L L C	2311 S INDUSTRIAL RD LAS VEGAS NV 89102-4801	16204803010
N & J PROPERTIES NEVADA L L C	2305 WIMBLEDON LAS VEGAS NV 89107-2363	16209110025
NEBULOUS	2441 WESTERN AVE LAS VEGAS NV 89102-4815	16204406012
NEVADA POWER COMPANY	P O BOX 10100 RENO NV 89520	16209104002
NEVADA POWER COMPANY	P O BOX 98910 LAS VEGAS NV 89193-8910	16209103002

Report of All Selected Parcels**Case Number:** SUP-55278**Printed On:** Thu: August 7, 2014

<u>Owner</u>	<u>Address</u>	<u>Parcel Numbe</u>
NEVADA POWER COMPANY	P O BOX 98910 LAS VEGAS NV 89193-8910	16209103003
NEW INTERNATIONAL PROPERTIES LLC	713 E OGDEN LAS VEGAS NV 89101-4230	16204403003
NEW INTERNATIONAL PROPERTIES LLC	713 E OGDEN LAS VEGAS NV 89101-4230	16204403002
PRINDL JASON	1820 BIRCH ST LAS VEGAS NV 89102-4404	16204312038
R J L LIMITED PARTNERSHIP	14125 CLAYTON RD CHESTERFIELD MO 63017-8355	16204811005
REBEL OIL COMPANY INC	2200 S HIGHLAND DR LAS VEGAS NV 89102-4629	16204402006
REBEL OIL COMPANY INC	2200 S HIGHLAND DR LAS VEGAS NV 89102-4629	16204402005
REBEL OIL COMPANY INC	2200 S HIGHLAND DR LAS VEGAS NV 89102-4629	16204403004
REBEL OIL COMPANY INCORPORATED	2200 S HIGHLAND DR LAS VEGAS NV 89102-4629	16204404001
REBEL OIL COMPANY INCORPORATED	2200 S HIGHLAND DR LAS VEGAS NV 89102-4629	16204402007
RED OAK TRUST	CREEL ALLAN & DEBORAH TRS 11 BURNING TREE CT LAS VEGAS NV 89113-1329	16209110013
REGHETTI INDUSTRIAL L L C	431 EASTGATE RD 3RD FLR HENDERSON NV 89011	16204803002
REGHETTI INDUSTRIAL L L C	431 EASTGATE RD 3RD FLR HENDERSON NV 89011	16204803001
REGHETTI INDUSTRIAL L L C	431 EASTGATE RD 3RD FLR HENDERSON NV 89011	16204803003
RODRIGUEZ NORMA E	2621 HIGHLAND DR LAS VEGAS NV 89109-1113	16209110014
S & F LIMITED PARTNERSHIP	14125 CLAYTON RD CHESTERFIELD MO 63017-8355	16204811014
S & F LIMITED PARTNERSHIP	14125 CLAYTON RD CHESTERLAND MO 63017-8355	16204811012
S & F LIMITED PARTNERSHIP	14125 CLAYTON RD CHESTERFIELD MO 63017-8355	16204811013
S & F LIMITED PARTNERSHIP	14125 CLAYTON RD CHESTERFIELD MO 63017-8355	16204811010
S & F LIMITED PARTNERSHIP	14125 CLAYTON RD CHESTERFIELD MO 63017-8355	16204811011
S & F LIMITED PARTNERSHIP	14125 CLAYTON RD CHESTERFIELD MO 63017-8355	16204811015
SAHARA INVESTMENTS L L C	9710 W TROPICANA AVE #120 LAS VEGAS NV 89147-8498	16204807004
SAHARA RANCHO OFFICE CTR L L C	2250 S RANCHO DR #225 LAS VEGAS NV 89102-4455	16204412003
SAHARA RANCHO OFFICE CTR L L C	2250 S RANCHO DR #225 LAS VEGAS NV 89102-4455	16204412005
SAHARA RANCHO OFFICE CTR L L C	2250 S RANCHO DR #225 LAS VEGAS NV 89102-4455	16204412004
SCHIFF MARVIN JAMES TR	SCHIFF MARVIN JAMES TRS 2401 INDUSTRIAL RD LAS VEGAS NV 89102-4817	16204803012
SCHUERGER RUBY BACA & JOSEPH	12014 ELIJAH STAPP SAN ANTONIO TX 78253-5095	16204410014
SCHWINGDORF LEONARD & L LIV TR	SCHWINGDORF LEONARD JR & L TRS 6245 GALILEO DR LAS VEGAS NV 89149-1385	16204404014
SCHWINGDORF LEONARD & L LIV TR	SCHWINGDORF LEONARD JR & L TRS 6245 GALILEO DR LAS VEGAS NV 89149-1385	16204404015
SEDLMEYER STEPHEN G & ANGELINA A	1809 LOCH LOMOND WY LAS VEGAS NV 89102-4437	16204311023
SEQUEIRA ROBERT J	SEQUEIRA TINH T 2737 BAYO CT LAS VEGAS NV 89102-2086	16204410008
SHARPE ALLEN L TRUST	SHARPE FLORENCE M TRUST 2855 BELCASTRO ST LAS VEGAS NV 89117-3035	16209110007

Report of All Selected Parcels**Case Number:** SUP-55278**Printed On:** Thu: August 7, 2014

<u>Owner</u>	<u>Address</u>	<u>Parcel Number</u>
SHARPE ALLEN L TRUST	SHARPE FLORENCE M TRUST 2855 BELCASTRO ST LAS VEGAS NV 89117-3035	16209110006
SHARPE ALLEN L TRUST	SHARPE FLORENCE M TRUST 2855 BELCASTRO ST LAS VEGAS NV 89117-3035	16209110008
SHARPE ALLEN L TRUST	SHARPE FLORENCE M TRUST 2855 BELCASTRO ST LAS VEGAS NV 89117-3035	16209110009
SHOEN FAMILY L L C	143 S CEDROS AVE #C-201 SOLANA BEACH CA 92075-1999	16204802017
SOBEL WESTEX	2670 S WESTERN AVE LAS VEGAS NV 89109-1112	16209110038
SOBEL WESTEX	2670 S WESTERN AVE LAS VEGAS NV 89109-1112	16209110039
SOBEL WESTEX	2670 S WESTERN AVE LAS VEGAS NV 89109-1112	16209110037
SPINUZZI JOE & CARMELA	8644 HIGHLAND VIEW LAS VEGAS NV 89145-5710	16204410013
SRABERG GERALD & ILENE	P O BOX 512037 LOS ANGELES CA 90051-0037	16204803011
SRABERG GERALD A & ILENE	SCHEELER 1999 REVOCABLE TRUST 400 N BRIDGE LN LAS VEGAS NV 89102-4802	16204803013
STABILI MADELEINE	1614 INVERNESS AVE LAS VEGAS NV 89102-4423	16204312031
STATE OF NEVADA TRANS LEASOR	USA MARSHALS SERVICE LEASEE 333 LAS VEGAS BLVD #2058 LAS VEGAS NV 89101	16209104001
STATE OF NEVADA TRANS LEASOR	USA MARSHALS SERVICE LEASEE 333 LAS VEGAS BLVD #2058 LAS VEGAS NV 89101	16204407002
SU ZHE	3495 WHISTLER AVE ELMONTE CA 91732-2667	16204411005
SUMNER MARYLYN E	2004 BIRCH ST LAS VEGAS NV 89102-4439	16204411009
SUNDLING BARTON & ELIZABETH	2008 BIRCH ST LAS VEGAS NV 89102	16204411008
T B S HIGHLAND PROPERTIES L L C	4720 N GRAND CANYON DR LAS VEGAS NV 89129-2662	16204301009
T N T FAMILY TRUST	1716 HIGHLAND DR LAS VEGAS NV 89102-2606	16204301007
TAM APARTMENTS L L C	1526 S BROADWAY LOS ANGELES CA 90015-3031	16204811045
TAM APARTMENTS L L C	1526 S BROADWAY LOS ANGELES CA 90015-3031	16204811042
TAM APARTMENTS L L C	1526 S BROADWAY LOS ANGELES CA 90015-3031	16204811043
TAM APARTMENTS L L C	1526 S BROADWAY LOS ANGELES CA 90015-3031	16204811044
TAM APARTMENTS L L C	1526 S BROADWAY LOS ANGELES CA 90015-3031	16204811046
TAM APARTMENTS L L C	1526 S BROADWAY LOS ANGELES CA 90015-3031	16204811039
TAM APARTMENTS L L C	1526 S BROADWAY LOS ANGELES CA 90015-3031	16204811040
TAM APARTMENTS L L C	1526 S BROADWAY LOS ANGELES CA 90015-3031	16204811041
THOMPSON HEIDI	2113 GLEN HEATHER WY LAS VEGAS NV 89102-4417	16204411004
TIZABGAR PAYAM	TIZABGAR & ABAYAHOUDIAN 2006 TR 15531 HAMNER DR LOS ANGELES CA 90077-1804	16204803004
TIZABGAR PAYAM	TIZABGAR & ABAYAHOUDIAN 2006 TR 15531 HAMNER DR LOS ANGELES CA 90077-1804	16204803005
TRUSTEE CLARK COUNTY TREASURER	2310 HIGHLAND DR LAS VEGAS NV 89102-4809	16204402002
TRUSTEE CLARK COUNTY TREASURER	1220 ALDERTON LN LAS VEGAS NV 89144-6523	16204402001
TRUSTEE CLARK COUNTY TREASURER	4475 S PECOS RD LAS VEGAS NV 89121	16204302005

Report of All Selected Parcels**Case Number:** SUP-55278**Printed On:** Thu: August 7, 2014

<u>Owner</u>	<u>Address</u>	<u>Parcel Number</u>
TRUSTEE CLARK COUNTY TREASURER	2310 HIGHLAND DR LAS VEGAS NV 89102-4809	16204402003
TRUSTEE CLARK COUNTY TREASURER	2310 S HIGHLAND DR LAS VEGAS NV 89102-4809	16204404002
UNGAR INVESTMENTS L P	P O BOX 80246 LAS VEGAS NV 89180-0246	16204811037
URBAN LAND NEVADA	3271 S HIGHLAND DR #704 LAS VEGAS NV 89109-1051	16204807001
URBAN LAND NEVADA	3271 S HIGHLAND DR #704 LAS VEGAS NV 89109-1051	16209110019
URBAN LAND NEVADA	3271 S HIGHLAND DR #704 LAS VEGAS NV 89109-1051	16209110020
VANDIS ELEANORE MAHLEIN TRS	WALL IRVING M TRS 421 W 57TH ST NEW YORK NY 10019-1763	16204404016
VAUGHAN EYVONNE	2108 GLEN HEATHER WY LAS VEGAS NV 89102-4418	16204410011
VINTAGE LAND HOLDINGS II L L C	3600 LAS VEGAS BLVD S LAS VEGAS NV 89109-4303	16209510002
WADE JO FERN TRUST	SHANE DAVID L TRS 3125 OLD CONEJO RD NEWBURY PARK CA 91320	16204703012
WADE JO FERN TRUST	SHANE DAVID L CO-TRS 200 N WESTLAKE BLVD #201 WESTLAKE VILLAGE CA 91362-3774	16209110026
WESTCOM DEVELOPMENT L L C	3273 E WARM SPRINGS RD LAS VEGAS NV 89120-3157	16209110033
WESTERN PROPERTY HOLDINGS L L C	713 E OGDEN #B LAS VEGAS NV 89101-4230	16204302006
WESTERN PROPERTY HOLDINGS L L C	713 E OGDEN #B LAS VEGAS NV 89101-4230	16204403001
WESTERN PROPERTY HOLDINGS L L C	J GALARDI 713 E OGDEN #B LAS VEGAS NV 89101-4230	16204302007
WILKIE RICHARD E REVOCABLE TRUST	7220 W CAMERO AVE LAS VEGAS NV 89113-4643	16204703010
WILLIAMS FAMILY TRUST	WILLIAMS ANTHONY & PATRICIA TRS 1 GOLF VIEW DR HENDERSON NV 89074-1717	16204411007
WONG STEPHEN A TRS	WONG VALERIE ANN 132 9TH ST #200 OAKLAND CA 94607-4727	16204807003
WORD ALIVE CHURCH INC	3710 W SUNSET RD LAS VEGAS NV 89118-3804	16204811038
WORTHY DARRIN	1900 LOCH LAMOND WAY LAS VEGAS NV 89102-4442	16204311013
YERUSHALMI PROPERTIES V L L C	2400 WESTERN AVE LAS VEGAS NV 89102	16204404006
YERUSHALMI PROPERTIES V L L C	2400 WESTERN AVE LAS VEGAS NV 89102-4816	16204404005
YERUSHALMI PROPERTIES VI L L	8912 GREENSBORO LN LAS VEGAS NV 89134-0502	16204404004
YERUSHALMI PROPERTIES VII L L C	8912 GREENSBORO LN LAS VEGAS NV 89134-0502	16204404008
ZARGARYAN GAGIK & K REV TR AGMT	ZARGARYAN GAGIK & KNARIK CO-TRS 2920 S TIOGA WAY LAS VEGAS NV 89117-3202	16209110031
ZAVALA LUIS E & DORIS A	1613 INVERNESS AVE LAS VEGAS NV 89102-4427	16204312030
ZHANG AIMIN	2117 GLEN HEATHER WY LAS VEGAS NV 89102-4417	16204411003