

City of Las Vegas
Department of Planning
Development Services Center
333 North Rancho Drive, 3rd Floor
Las Vegas, Nevada 89106

5

Return Service Requested Official Notice of Public Hearing

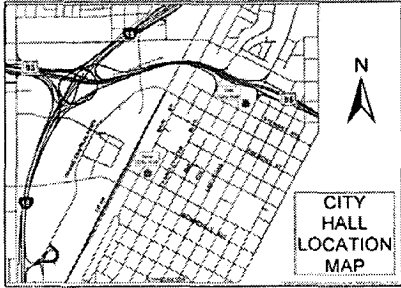

If you wish to file your protest or support on this request, check the appropriate box below and return this card in an envelope with postage to the Department of Planning at the address listed above, fax this side of this card to (702) 464-7499 or make your comments at www.lasvegasnevada.gov. If you would like to contact your Council Representative, please call (702) 229-6405.

I SUPPORT
this Request

I OPPOSE
this Request

Please use available blank space on card for your comments.

SUP-55276 & SDR-55290

Special Planning Commission Meeting of **9/23/2014**

Application Information

SUP-55276 - SPECIAL USE PERMIT - PUBLIC HEARING - APPLICANT: COMPASSIONATE CARE OF LAS VEGAS, LLC - OWNER: HIGHLAND BY THE HIGHWAY, LLC - For possible action on a request for a Special Use Permit FOR A PROPOSED 3,004 SQUARE-FOOT MEDICAL MARIJUANA DISPENSARY at 2601 Highland Drive (APN 162-09-110-017), M (Industrial) Zone, Ward 1 (Tarkanian).

SUP-55290 - SPECIAL USE PERMIT - PUBLIC HEARING - APPLICANT: COMPASSIONATE TEAM OF LAS VEGAS, LLC - OWNER: HIGHLAND BY THE HIGHWAY, LLC - For possible action on a request for a Special Use Permit FOR A PROPOSED 6,600 SQUARE-FOOT MEDICAL MARIJUANA CULTIVATION FACILITY at 2601 Highland Drive (APN 162-09-110-017), M (Industrial) Zone, Ward 1 (Tarkanian).

Application Location

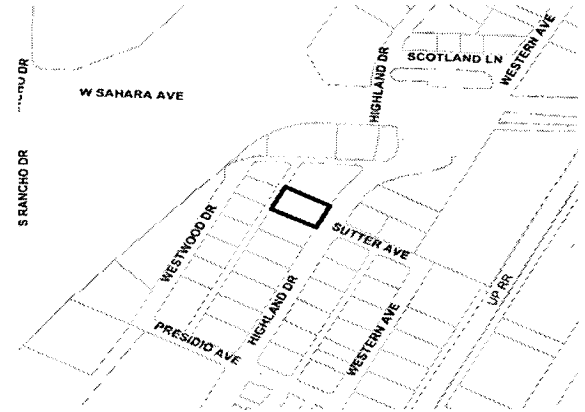

The proposed project may not pertain to the entire highlighted project site.

Public Hearing Information

Meeting: Special Planning Commission
Date: *September 23, 2014*
Time: 3:00 P.M.
Location: City Council Chambers
495 South Main Street, 2nd Floor
Las Vegas, Nevada 89101

Any and all interested persons may appear before the City Planning Commission either in person or by representative and object to or express approval of this request; or may, prior to this meeting, file a written objection thereto or approval thereof with the Department of Planning, Development Services Center, 333 North Rancho Drive, 3rd Floor, Las Vegas, Nevada 89106. Final Action on General Plan Amendments and Rezoning will be determined by the City Council. Other public hearing items may be deemed Final Action by the Planning Commission or forwarded to the City Council. The date of the City Council meeting, if applicable, will be announced at the Planning Commission meeting after the discussion of the item. For further information, including the full staff report, please call (702) 229-6301 (TDD 386-9108) or go to <http://www.lasvegasnevada.gov>.

5

Report of All Selected Parcels

Case Number: SUP-55276

Printed On: Tue: August 5, 2014

<u>Owner</u>	<u>Address</u>	<u>Parcel Numbe</u>
2320 WESTERN L L C	375 LAUREL DR BOULDER CITY NV 89005-2646	16204404003
2424 WESTERN REALTY INC	2424 WESTERN AVE LAS VEGAS NV 89102-4816	16204404017
2575 S HIGHLAND DRIVE L P	2575 HIGHLAND DR LAS VEGAS NV 89109-1113	16209110018
2620 HIGHLAND L L C	10300 W CHARLESTON BLVD #13-156 LAS VEGAS NV 89135-1037	16209110023
2620 HIGHLAND L L C	10300 W CHARLESTON BLVD #13-156 LAS VEGAS NV 89135-1037	16209110024
2685 L L C	2830 ELK CANYON CT LAS VEGAS NV 89117-2982	16209104004
2687 L L C	2830 ELK CANYON CT LAS VEGAS NV 89117-2982	16209104005
2701 WESTWOOD L L C	1113 PINE ISLAND CT LAS VEGAS NV 89134-6330	16209102002
2861 S HIGHLAND DRIVE L L C	P O BOX 1305 CAMARILLO CA 93011-1305	16209201003
AD AMERICA INC	2310 HIGHLAND DR LAS VEGAS NV 89102-4809	16204402004
BANYAN PROPERTIES L L C	9030 W SAHARA AVE #299 LAS VEGAS NV 89117-5744	16209211002
BARRY PATRICK & DAWN L	2664 HIGHLAND DR LAS VEGAS NV 89109-1116	16209110027
BOYER ELAINE	SCHWINGDORF LEONARD & L LIV TR 6245 GALILEO DR LAS VEGAS NV 89149-1385	16204404013
BOYER ELAINE	SCHWINGDORF LEONARD & L LIV TR 6245 GALILEO DR LAS VEGAS NV 89149-1385	16204404011
BRADY DONALD B	2600 WESTWOOD DR LAS VEGAS NV 89109-1118	16209110004
BRADY DONALD B	2600 WESTWOOD DR LAS VEGAS NV 89109-1118	16209110005
BROSSEAU 1993 TRUST	BROSSEAU PAUL H TRS 2609 S HIGHLAND DR LAS VEGAS NV 89109-1156	16209110015
CARL ROBERT SCOTT LIVING TR 2006	CARL ROBERT S TRS 2605 HIGHLAND DR LAS VEGAS NV 89109-1113	16209110016
CARTANIA INC	4465 S JONES BLVD LAS VEGAS NV 89103-3307	16209110029
CARTANIA INC	4465 S JONES BLVD LAS VEGAS NV 89103-3307	16209110030
CARTANIA INC	4465 S JONES BLVD LAS VEGAS NV 89103-3307	16209110028
CIRCUS CIRCUS CASINOS INC	4882 FRANK SINATRA DR LAS VEGAS NV 89158-4316	16209501001
CIRCUS CIRCUS ENTERPRISES INC	4882 FRANK SINATRA DR LAS VEGAS NV 89158-4316	16209204001
CLAREMONT HOTEL INC	135 W 70TH ST #7CD NEW YORK NY 10023	16209102005
CNB FKA BBN L L C	C SHELTON 2015 E WINDMILL LN LAS VEGAS NV 89123	16209110035
CNB FKA BBN L L C	C SHELTON 2015 E WINDMILL LN LAS VEGAS NV 89123	16209110021
D 2753 L L C	6200 RICHMOND AVE #111 HOUSTON TX 77057	16209102004
D 2753 L L C	6200 RICHMOND AVE #111 HOUSTON TX 77057	16209102003
D 2765 L L C	8222 ANOINE DR #100 HOUSTON TX 77088	16209201001
D 2801 WESTWOOD INC	P O BOX 570413 HOUSTON TX 77257-0413	16208604001
DALTON JACQUELINE R	7000 TRADING POST LN LAS VEGAS NV 89125	16204404009
DITEL L L C	6817 S EASTERN AVE #101 LAS VEGAS NV 89119-4684	16209203001

Report of All Selected Parcels**Case Number:** SUP-55276**Printed On:** Tue: August 5, 2014

<u>Owner</u>	<u>Address</u>	<u>Parcel Numbe</u>
DITEL L L C	6817 S EASTERN AVE #101 LAS VEGAS NV 89119-4684	16209203002
DITEL L L C	6817 S EASTERN AVE #101 LAS VEGAS NV 89119-4684	16209203003
DRATTER PETER J LIVING TRUST	DRATTER PETER J TRS P O BOX 277 HURRICANE UT 84737-0277	16209104003
ENGLERT SUTTER PROPERTIES L L C	2935 S HIGHLAND DR LAS VEGAS NV 89109-1011	16209110034
FEDERAL NATIONAL MORTGAGE ASSN	14523 SW MILIKAN WAY #200 P O BOX 4128 BEAVERTON OR 97005	16205814001
FLEMING KENNETH E & JOY C LIV TR	FLEMING JOY C TRS 7850 WILLIAMSON VALLEY RD PRESCOTT AZ 86305	16204406009
FONSECA GUADALUPE	HERNANDEZ EVELIA 2129 GLEN HEATHER WY LAS VEGAS NV 89102-4417	16204410009
FORSTER JOEL S JR	2137 GLEN HEATHER WY LAS VEGAS NV 89102-4417	16204410007
GARRETT CAPITAL L L C	3790 PARADISE RD #250 LAS VEGAS NV 89169-4640	16209102008
GARRETT CAPITAL L L C	3790 PARADISE RD #250 LAS VEGAS NV 89169-4640	16209102010
GARRETT CAPITAL L L C	3790 PARADISE RD #250 LAS VEGAS NV 89169-4640	16209102009
GIBSON HARRY & CHARLOTTE TRUST	SANDERS ELISABETH TRS P O BOX 2770 ALPINE CA 91903-2770	16204411006
GONZALEZ AHUIZOTL	1608 KIRKLAND LAS VEGAS NV 89102-4415	16204411002
GRAINGER W W INC	410 17TH ST #1175 DENVER CO 80202-4439	16204406010
GREMM MANFRED	GREMM MYRA 2405 HIGHLAND DR LAS VEGAS NV 89102-4803	16204404007
GRIFFIS CURTIS ALLEN	2412 WESTERN AVE LAS VEGAS NV 89102-4816	16204404012
GRIFFITHS BRIAN KEITH	1615 8TH ST OAKLAND CA 94607	16204411001
HAAS FAMILY TRUST	10804 FRANKLIN HILLS AVE LAS VEGAS NV 89135	16209211006
HAAS FAMILY TRUST	HAAS ROBERT MELVIN & JO A TRS 10804 FRANKLIN HILLS AVE LAS VEGAS NV 89135-1725	16209211005
HIGHLAND BY THE HIGHWAY L L C	8275 S EASTERN AVE #200 LAS VEGAS NV 89123-2545	16209110017
HIGHLAND NEVADA PROPERTY L L C	1850 BUSINESS CENTER DR DUARTE CA 91010-2901	16209202014
INDUSTRIAL ROAD 2440-2497 L L C	1000 S WESTGATE AVE #100 LOS ANGELES CA 90049-7206	16204407001
JACOBS JOSEPH & NANCY TRUST	JACOBS JOSEPH A & NANCY D TRS 3729 TOPAWA ST LAS VEGAS NV 89103-2435	16209111001
JACOBS JOSEPH & NANCY TRUST	JACOBS JOSEPH A & NANCY D TRS 3729 TOPAWA ST LAS VEGAS NV 89103-2435	16209211009
JANEWAY L L C	2319 WESTERN AVE LAS VEGAS NV 89102	16204406008
JEWELER'S 401K PFT SHR PL & TR	2400 WESTERN AVE LAS VEGAS NV 89102-4816	16204406011
JOHNSON FAMILY REVOCABLE TRUST	379 N 1580 W HURRICANE UT 84737	16209110011
K E N C O INVESTMENTS L L C	2504 SPRINGBROOK DR LAS VEGAS NV 89134-7584	16209110022
L C 111 L L C	P O BOX 81745 LAS VEGAS NV 89180-1745	16209110032
L'CHAIM WESTERN SUPPLY PPTY LLC	6130 W FLAMINGO RD #402 LAS VEGAS NV 89103-2280	16209201002
M T WAREHOUSE L L C	9030 W SAHARA AVE #299 LAS VEGAS NV 89117-5744	16209211003
M T WAREHOUSE L L C	9030 W SAHARA AVE #299 LAS VEGAS NV 89117-5744	16209211004

Report of All Selected Parcels**Case Number:** SUP-55276**Printed On:** Tue: August 5, 2014

<u>Owner</u>	<u>Address</u>	<u>Parcel Number</u>
MARTIN ROBERT L & KATHLEEN P	2410 WESTERN AVE LAS VEGAS NV 89102-4816	16204404010
MARX GORDON L	X R A M L L C 2620 WESTERN AVE LAS VEGAS NV 89109	16209110036
MOMARY DOUGLAS R & EMILY J	BOND GEORGE T & PHYLLIS D 2708 HIGHLAND DR LAS VEGAS NV 89109-1004	16209111002
N & J PROPERTIES NEVADA L L C	2305 WIMBLEDON LAS VEGAS NV 89107-2363	16209110025
N F C L L C	P O BOX 802206 DALLAS TX 75380	16205802010
N F C L L C	2300 W SAHARA #530 LAS VEGAS NV 89102	16205802009
N F C L L C	2300 W SAHARA #530 LAS VEGAS NV 89102	16205802011
N P PALACE L L C	1505 S PAVILION CENTER DR LAS VEGAS NV 89135-1403	16208502011
N P PALACE L L C	1505 S PAVILION CENTER DR LAS VEGAS NV 89135-1403	16208502006
N P PALACE L L C	1505 S PAVILION CENTER DR LAS VEGAS NV 89135-1403	16208502010
N P PALACE L L C	1505 S PAVILION CENTER DR LAS VEGAS NV 89135-1403	16208502009
N P PALACE L L C	1505 S PAVILION CENTER DR LAS VEGAS NV 89135-1403	16208502003
N P PALACE L L C	1505 S PAVILION CENTER DR LAS VEGAS NV 89135-1403	16208502007
N Y P CORPORATION	6120 S TORREY PINES LAS VEGAS NV 89118-3209	16209202001
N Y P CORPORATION	6120 S TORREY PINES LAS VEGAS NV 89118-3209	16209202013
NEBULOUS	2441 WESTERN AVE LAS VEGAS NV 89102-4815	16204406012
NEVADA POWER COMPANY	P O BOX 98910 LAS VEGAS NV 89193-8910	16209103002
NEVADA POWER COMPANY	P O BOX 10100 RENO NV 89520	16209104002
NEVADA POWER COMPANY	P O BOX 98910 LAS VEGAS NV 89193-8910	16209103003
O H D B L L C	2651 WEST WOOD DR LAS VEGAS NV 89109-1117	16209102006
P L MOTOR L L C	6625 W BADURA AVE LAS VEGAS NV 89118-4673	16209211007
REBEL OIL COMPANY INC	2200 S HIGHLAND DR LAS VEGAS NV 89102-4629	16204402005
REBEL OIL COMPANY INC	2200 S HIGHLAND DR LAS VEGAS NV 89102-4629	16204402006
REBEL OIL COMPANY INCORPORATED	2200 S HIGHLAND DR LAS VEGAS NV 89102-4629	16204402007
RED OAK TRUST	CREEL ALLAN & DEBORAH TRS 11 BURNING TREE CT LAS VEGAS NV 89113-1329	16209110013
RED OAK TRUST	CREEL ALLAN & DEBORAH TRS 6330 W SUNSET RD LAS VEGAS NV 89118-3318	16209110010
RED OAK TRUST	CREEL ALLAN & DEBORAH TRS 11 BURNING TREE CT LAS VEGAS NV 89113-1329	16209110012
RHOADS H KAY	2305 EL CAMINO AVE LAS VEGAS NV 89102-2008	16205814002
RODRIGUEZ NORMA E	2621 HIGHLAND DR LAS VEGAS NV 89109-1113	16209110014
SAHARA RANCHO OFFICE CTR L L C	2250 S RANCHO DR #225 LAS VEGAS NV 89102-4455	16204412002
SAHARA RANCHO OFFICE CTR L L C	2250 S RANCHO DR #225 LAS VEGAS NV 89102-4455	16204412005
SAHARA RANCHO OFFICE CTR L L C	2250 S RANCHO DR #225 LAS VEGAS NV 89102-4455	16204412003

Report of All Selected Parcels**Case Number:** SUP-55276**Printed On:** Tue: August 5, 2014

<u>Owner</u>	<u>Address</u>	<u>Parcel Numbe</u>
SAHARA RANCHO OFFICE CTR L L C	2250 S RANCHO DR #225 LAS VEGAS NV 89102-4455	16204412004
SCHWINGDORF LEONARD & L LIV TR	SCHWINGDORF LEONARD JR & L TRS 6245 GALILEO DR LAS VEGAS NV 89149-1385	16204404015
SCHWINGDORF LEONARD & L LIV TR	SCHWINGDORF LEONARD JR & L TRS 6245 GALILEO DR LAS VEGAS NV 89149-1385	16204404014
SEDANO AIDA C & HIRAM H	2706 S HIGHLAND DR LAS VEGAS NV 89109-1004	16209211008
SEQUEIRA ROBERT J	SEQUEIRA TINH T 2737 BAYO CT LAS VEGAS NV 89102-2086	16204410008
SHARPE ALLEN L TRUST	SHARPE FLORENCE M TRUST 2855 BELCASTRO ST LAS VEGAS NV 89117-3035	16209110006
SHARPE ALLEN L TRUST	SHARPE FLORENCE M TRUST 2855 BELCASTRO ST LAS VEGAS NV 89117-3035	16209110009
SHARPE ALLEN L TRUST	SHARPE FLORENCE M TRUST 2855 BELCASTRO ST LAS VEGAS NV 89117-3035	16209110008
SHARPE ALLEN L TRUST	SHARPE FLORENCE M TRUST 2855 BELCASTRO ST LAS VEGAS NV 89117-3035	16209110007
SOBEL WESTEX	2670 S WESTERN AVE LAS VEGAS NV 89109-1112	16209110038
SOBEL WESTEX	2670 S WESTERN AVE LAS VEGAS NV 89109-1112	16209110040
SOBEL WESTEX	2670 S WESTERN AVE LAS VEGAS NV 89109-1112	16209110039
SOBEL WESTEX	2670 S WESTERN AVE LAS VEGAS NV 89109-1112	16209110041
SOBEL WESTEX	2670 S WESTERN AVE LAS VEGAS NV 89109-1112	16209110037
STATE OF NEVADA TRANS LEASOR	USA MARSHALS SERVICE LEASEE 333 LAS VEGAS BLVD #2058 LAS VEGAS NV 89101	16209104001
STATE OF NEVADA TRANS LEASOR	USA MARSHALS SERVICE LEASEE 333 LAS VEGAS BLVD #2058 LAS VEGAS NV 89101	16204407002
SU ZHE	3495 WHISTLER AVE ELMONTE CA 91732-2667	16204411005
THISTLE DANIEL J & J J FAM TR	THISTLE FAMILY TRUST 2710 S HIGHLAND DR LAS VEGAS NV 89109	16209211001
THOMPSON HEIDI	2113 GLEN HEATHER WY LAS VEGAS NV 89102-4417	16204411004
TRUSTEE CLARK COUNTY TREASURER	2310 HIGHLAND DR LAS VEGAS NV 89102-4809	16204402003
TRUSTEE CLARK COUNTY TREASURER	1900 E DESERT INN RD LAS VEGAS NV 89169-3211	16209202007
TRUSTEE CLARK COUNTY TREASURER	2310 HIGHLAND DR LAS VEGAS NV 89102-4809	16204402002
URBAN LAND NEVADA	3271 S HIGHLAND DR #704 LAS VEGAS NV 89109-1051	16209110020
URBAN LAND NEVADA	3271 S HIGHLAND DR #704 LAS VEGAS NV 89109-1051	16209110019
VANDIS ELEANORE MAHLEIN TRS	WALL IRVING M TRS 421 W 57TH ST NEW YORK NY 10019-1763	16204404016
W B P LEASING INC	621 NW 53RD ST #700 BOCA RATON FL 33487-8242	16209203004
WADE JO FERN TRUST	SHANE DAVID L CO-TRS 200 N WESTLAKE BLVD #201 WESTLAKE VILLAGE CA 91362-3774	16209110026
WESTCOM DEVELOPMENT L L C	3273 E WARM SPRINGS RD LAS VEGAS NV 89120-3157	16209110033
WILLIAMS FAMILY TRUST	WILLIAMS ANTHONY & PATRICIA TRS 1 GOLF VIEW DR HENDERSON NV 89074-1717	16204411007
YERUSHALMI PROPERTIES V L L C	2400 WESTERN AVE LAS VEGAS NV 89102	16204404006
YERUSHALMI PROPERTIES V L L C	2400 WESTERN AVE LAS VEGAS NV 89102-4816	16204404005
YERUSHALMI PROPERTIES VI L L	8912 GREENSBORO LN LAS VEGAS NV 89134-0502	16204404004

Report of All Selected Parcels

Case Number: SUP-55276

Printed On: Tue: August 5, 2014

<u>Owner</u>	<u>Address</u>	<u>Parcel Numbe</u>
YERUSHALMI PROPERTIES VII L L C	8912 GREENSBORO LN LAS VEGAS NV 89134-0502	16204404008
ZARGARYAN GAGIK & K REV TR AGMT	ZARGARYAN GAGIK & KNARIK CO-TRS 2920 S TIOGA WAY LAS VEGAS NV 89117-3202	16209110031
ZHANG AIMIN	2117 GLEN HEATHER WY LAS VEGAS NV 89102-4417	16204411003