

S. ✓

City of Las Vegas
Department of Planning
Development Services Center
333 North Rancho Drive, 3rd Floor
Las Vegas, Nevada 89106

PRSR
FIRST CLASS MAIL
U.S. Postage
PAID
Las Vegas, NV
Permit No. 1630

Return Service Requested
Official Notice of Public Hearing

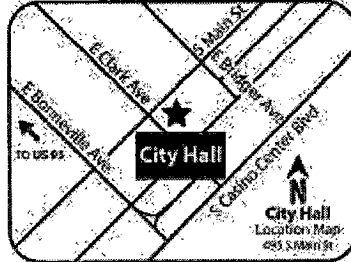

If you wish to file your protest or support on this request, check the appropriate box below and return this card in an envelope with postage to the Department of Planning at the address listed above, fax this side of this card to (702) 464-7499. If you would like to contact your Council Representative, please call (702) 229-6405.

I SUPPORT
this Request

I OPPOSE
this Request

Please use available blank space on card for your comments.

SDR-64584 [PRJ-63854]

Special Planning Commission Meeting of 8/2/2016

12 ✓

Application Information

SDR-64584 - SITE DEVELOPMENT PLAN REVIEW RELATED TO GPA-64582 AND ZON-64583 - PUBLIC HEARING - APPLICANT/OWNER: RICHIE LAATZ - For possible action on a request for a Site Development Plan Review FOR A PROPOSED 21,440 SQUARE-FOOT WHOLESALE SHOWROOM FACILITY on 1.63 acres at 4021 North Rancho Drive (APN 138-02-814-006), C-1 (Limited Commercial) Zone[PROPOSED: C-2 (General Commercial)], Ward 4 (Anthony) [PRJ-63854].

Application Location

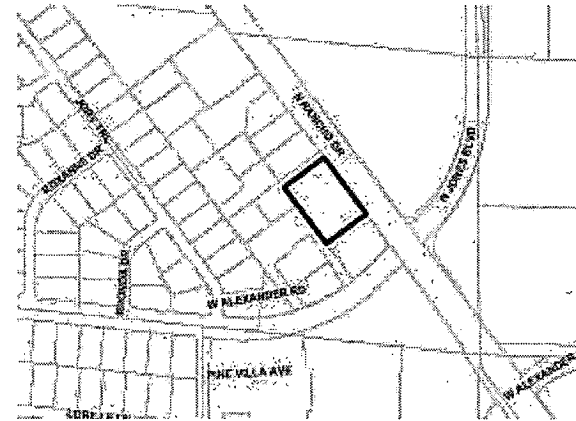

The proposed project may not pertain to the entire highlighted project site.

Public Hearing Information

Meeting: Special Planning Commission
Date: August 2, 2016
Time: 6:00 P.M.
Location: City Council Chambers
495 South Main Street, 2nd Floor
Las Vegas, Nevada 89101

Any and all interested persons may appear before the City Planning Commission either in person or by representative and object to or express approval of this request; or may, prior to this meeting, file a written objection thereto or approval thereof with the Department of Planning, Development Services Center, 333 North Rancho Drive, 3rd Floor, Las Vegas, Nevada 89106. Final Action on General Plan Amendments and Rezonings will be determined by the City Council. Other public hearing items may be deemed Final Action by the Planning Commission or forwarded to the City Council. The date of the City Council meeting, if applicable, will be announced at the Planning Commission meeting after the discussion of the item. For further information, including the full staff report, please call (702) 229-6301 (TTY 7-1-1) or go to <http://www.lasvegasnevada.gov>. Note that postcards and comments received after an agenda posts will not be reflected online until after the meeting; however, the comments are made available to the members of the governing body for their consideration prior to the meeting.

SOR-04584

Report of All Selected Parcels**Case Number:**~~CPA-07382~~**Printed On:** Wed: May 18, 2016

<u>Owner</u>	<u>Address</u>	<u>Parcel Numbe</u>
3920 SWEET PINE L L C	12855 S W 57TH AVE CORAL GABLES FL 33156	13811517054
4089 N RANCHO L L C	23801 CALABASAS RD #2026 CALABASAS CA 91302	13802814023
6164 ALEXANDER L L C	10033 TRAPPER MOUNTAIN ST LAS VEGAS NV 89178	13802801003
ABAIR ALAN & SANDRA	3A RED MAPLE LN CLIFTON PARK NY 12065	13811517050
ABEL STEVEN F & LEANNE E FAM TR	%S ABEL 1819 BELCASTRO ST LAS VEGAS NV 89117-2103	13811517088
ABEL STEVEN F & LEANNE E FAM TR	%S ABEL 1819 BELCASTRO ST LAS VEGAS NV 89117-2103	13811517155
ABEL STEVEN F & LEANNE E FAM TR	ABEL STEVEN F & LEANNE E TRS 1819 BELCASTRO ST LAS VEGAS NV 89117-2103	13811517086
ACEVEDO ISELA	6140 PINE VILLA AVE #102 LAS VEGAS NV 89108	13811517005
ACHIARDI MICHELLE	3066 CADBURY DR LAS VEGAS NV 89121-5608	13802803001
ADAMS CHARLES HOWARD	4108 ROXANNE DR LAS VEGAS NV 89108-5218	13802813009
AGUILAR MELINDA P	907 CRESCENT AVE SAN FRANCISCO CA 94110-6153	13811517074
AMIRI HEIDI	DOWLATSHAHI PATRICK NIMA 4777 CRAKOW CT LAS VEGAS NV 89147-8123	13811517020
AMIRI HEIDI	DOWLATSHAHI PATRICK N 4777 CRAKOW CT LAS VEGAS NV 89147	13811517110
ANNILLO JOHN J	8-6TH ST PARK RIDGE NJ 07656-1938	13811515035
ARETE L L C	7465 W LAKE MEAD BLVD #100 LAS VEGAS NV 89128-1033	13802814019
AVILA DENISE	3905 SWEET PINE ST #101 LAS VEGAS NV 89108-5195	13811517158
AVILA DENISE	3905 SWEET PINE ST #101 LAS VEGAS NV 89108-5195	13811517079
BAHAM CHIN-JUNG	3904 LAZY PINE ST #102 LAS VEGAS NV 89108	13811517083
BANICH B MICHAEL	GAEB-BANICH SANDRA K 2630 GALLY RD PAHRUMP NV 89060	13802811008
BANK FIRST SAVINGS	2605 E FLAMINGO RD LAS VEGAS NV 89121	13802814021
BARCLEY MYRA L	6170 CALM BREEZE AVE #102 LAS VEGAS NV 89108-8112	13811517119
BARLING HAROLD R REV TR AGMT	BARLING HAROLD R TRS 6164 PINE VILLA AVE LAS VEGAS NV 89108-5194	13811515018
BARTHELEMY JANE	8000 W BADURA #2126 LAS VEGAS NV 89113-2117	13811517100
BARTHELEMY JANE	8000 W BADURA #2126 LAS VEGAS NV 89113-2117	13811517151
BARTSAS MARY 13 L L C	601 S RANCHO DR #C23 LAS VEGAS NV 89106-4825	13812110049
BARTSAS MARY 13 L L C	601 S RANCHO DR #C23 LAS VEGAS NV 89106-4825	13811502003
BASA DALE	6153 PINE DESERT AVE #102 LAS VEGAS NV 89108-8155	13811517137
BEHSMANN CANDACE L & RONALD L	6200 LORILLE LN LAS VEGAS NV 89108-5223	13811510012
BERGER MICHELLE	4057 JORY TRL LAS VEGAS NV 89108-5202	13802811009
BERRY LIVING TRUST	BERRY PATRICIA S TRS 6164 PINE VILLA AVE #104 LAS VEGAS NV 89108	13811515149
BERRY LIVING TRUST	BERRY PATRICIA S TRS 6164 PINE VILLA AVE #104 LAS VEGAS NV 89108	13811515020
BILL BRIAN D	LUCERO DEVORA J 6301 JENNIFER CT LAS VEGAS NV 89108-5201	13802811027

Report of All Selected Parcels**Case Number:***5DR-64584*
~~GPA-04382~~**Printed On:** Wed: May 18, 2016

<u>Owner</u>	<u>Address</u>	<u>Parcel Number</u>
BOTT LEAH RENEE LIVING TRUST	BOTT LEAH RENEE TRS 2018 KARSEN LN HEARTLAND TX 75126	13811517062
BRANAM FAMILY TRUST	BRANAM JOSEPH C & LEANNE L TRS 13345 CONSTABLE AVE GRANADA HILLS CA 91344	13811510010
BROOKS PAULA	9526 CAPISTRANO AVE CHATSWORTH CA 91311-2631	13811517032
BROOKS STEWART	9526 CAPISTRANO AVE CHATSWORTH CA 91311-2631	13811517089
BROOKS STEWART & PAULA	9526 CAPISTRANO AVE CHATSWORTH CA 91311	13811517063
BROOKS STEWART & PAULA	9526 CAPISTRANO AVE CHATSWORTH CA 91311-2631	13811517018
BROWN MARION R & MARGARET J	4025 ROXANNE DR LAS VEGAS NV 89108-5212	13802813004
C A I INVESTMENTS SERIES 43 L L	3753 HOWARD HUGES PKWY #200 LAS VEGAS NV 89169	13811515160
C S C TRUST	CASE CHARLEEN TRS 66090 MESSANGER CT LAS VEGAS NV 89108	13811517002
C S D C P C FOUNDERS ACADEMY	6731 COLUMBIA GATEWAY DR #220 COLUMBIA MD 21046	13802814029
C S D C P C FOUNDERS ACADEMY	6731 COLUMBIA GATEWAY DR #220 COLUMBIA MD 21046	13802814027
CACCAVALE ROBERT REV LIV TR	CACCAVALE ROBERT TRS 5755 SUNSET DOWNS ST NORTH LAS VEGAS NV 89081-5243	13811517049
CAI INVESTMENTS SERIES 43 L L C	3753 HOWARD HUGHES PKWY #200 LAS VEGAS NV 89169	13811515148
CASTRO GERARDO M	3912 SWEET PINE ST #101 LAS VEGAS NV 89108-8183	13811517169
CASTRO GERARDO M & NEMIA J	3912 SWEET PINE ST #101 LAS VEGAS NV 89108-8183	13811517046
CHAO KO SHIH & LIFANG	10212 ROBIN HOOD CIR VILLA PARK CA 92861-4512	13811517111
CHEN KUAN-CHENG & LE C H FAM TR	CHEN KUAN-CHENG & LE CHAU H TRS 28371 VISTA DEL VALLE HEMET CA 92544-8361	13811517056
CHEN LILY	6164 PINE VILLA AVE #202 LAS VEGAS NV 89108	13811515022
CHERNYUK TETYANA	420 LAKE WINDEMERE ST LAS VEGAS NV 89138-3004	13811517001
CHERNYUK TETYANA	420 LAKE WINDEMERE ST LAS VEGAS NV 89138-3004	13811517184
CLARK JASON	5421 ROYAL YACHT WY NORTH LAS VEGAS NV 89031-0731	13811517047
CLARK NORMAN W & MARIA L	3917 PRESCOTT PINES ST #103 LAS VEGAS NV 89108-8173	13811517030
CLOUSE ANN M	6122 PINE VILLA AVE #101 LAS VEGAS NV 89108-8122	13811517180
CLOUSE ANN M	6122 PINE VILLA AVE #101 LAS VEGAS NV 89108-8122	13811517013
COHEN ISRAEL & SHOSHANA REVOCABL	%S COHEN 23673 GERRAD WAY WEST HILLS CA 91307-1319	13811515055
COHEN ISRAEL & SHOSHANA REVOCABL	%S COHEN 23673 GERRARD WAY WEST HILLS CA 91307	13811517114
COHEN ISRAEL & SHOSHANA REVOCABL	%SHAY COHEN 23673 GERRAD WAY WEST HILLS CA 91307-1319	13811517027
COHEN SARA IRA #11559	COHEN SHAI IRA #11560 23673 GERRAD WY WEST HILLS CA 91307-1319	13811515031
COLEMAN LORETTA	438 W 1045 N CEDAR CITY UT 84721-4164	13811517126
COLEY JAMES SCOTT & PATRICIA R	6208 LORILLE LN LAS VEGAS NV 89108	13811510013
CORD DONNA G	6158 CALM BREEZE AVE #101 LAS VEGAS NV 89108-8110	13811517112
CORD DONNA G	6158 CALM BREEZE AVE #101 LAS VEGAS NV 89108-8110	13811517147

Report of All Selected ParcelsCase Number:50R-64584
~~CPA-04582~~Printed On: Wed: May 18, 2016

<u>Owner</u>	<u>Address</u>	<u>Parcel Number</u>
CORRAL MARCO A	6153 PINE DESERT AVE #103 LAS VEGAS NV 89108-8155	13811517138
CORTEZ ARMIDA Y	4008 JORY TRL LAS VEGAS NV 89108-5203	13802811018
COTTERILL ANDREW	%SMART REALTY 6955 N DURANGO DR #1115-107 LAS VEGAS NV 89149-4411	13811517178
COUDAYRE JAMES B & P M FAM TR	9960 W CHEYENNE AVE #190 LAS VEGAS NV 89129	13802811014
COUNTY OF CLARK(UMC)	1800 W CHARLESTON BLVD LAS VEGAS NV 89102-2329	13802701003
DAS RACHEL	3736 ALPINE BYPASS AVE NORTH LAS VEGAS NV 89081	13811517177
DAS RACHEL	3736 ALPINE BYPASS AVE NORTH LAS VEGAS NV 89081	13811517022
DAVIS STEVEN C	6620 ASKELAND DR ANCHORAGE AK 99507	13802811023
DAVIS TONY	6 RUE DU PALAIS CT HENDERSON NV 89011	13811517127
DAVIS TONY	6 RUE DU PALAIS CT HENDERSON NV 89011	13811517142
DELAFUENTE FAMILY 2003 TRUST	DELAFUENTE JESUS TRS 4117 JORY TRL LAS VEGAS NV 89108-5206	13802811006
DELGADO DENISE RENE	213 MACADAMIA NUT AVE NORTH LAS VEGAS NV 89084	13811517108
DEMETRIOU DEMETRIOS	11159 HOLLAND CIR EDEN PRAIRIE MN 55347	13811517068
DENNISON RONALD L	3904 SWEET PINE ST #102 LAS VEGAS NV 89108	13811517041
DESERT PINE VILLAS HOMEOWNERS AS	%DESERT COMM MGMT LLC 5550 PAINTED MIRAGE RD #120 LAS VEGAS NV 89149	13811517085
DESERT PINE VILLAS HOMEOWNERS AS	%DESERT COMMUNITY MANAGEMENT L L 5550 PAINTED MIRAGE RD #120 LAS VEGAS NV 89149	13811517009
DESERT PINE VILLAS HOMEOWNERS AS	%DESERT COMMUNITY MANAGEMENT L L 5550 PAINTED MIRAGE RD #120 LAS VEGAS NV 89149	13811515015
DESERT PINE VILLAS HOMEOWNERS AS	%DESERT COMMUNITY MANAGEMENT L L 5550 PAINTED MIRAGE RD #120 LAS VEGAS NV 89149	13811517028
DEVERA ALFONSO R & N D REV TR	DEVERA ALFONSO R & NORMA D TRS 2277 PHEASANT DR HERCULES CA 94547-1640	13811517015
DIXON WILLIAM LOYD & DOLORES	4101 ROXANNE DR LAS VEGAS NV 89108-5219	13802813005
DOMINICK ROBERT L LIVING TRUST	DOMINICK ROBERT L & JULIE M TRS 6216 LORILLE LN LAS VEGAS NV 89108-5223	13811510014
DONOVAN MICHAEL P & TRINA M	5471 BRODERICK AVE LAS VEGAS NV 89130-2503	13811515019
DORRELL DEIRICK	1494 COUNTY RD 607 PONTIAC MO 65729	13811517052
DORRELL DEIRICK	1494 COUNTY RD 607 PONTIAC MO 65729	13811517167
DOWLATSHAHI BEHZAD	3925 LAZY PINE ST #204 LAS VEGAS NV 89108	13811515056
DOWLATSHAHI BEHZAD	3925 LAZY PINE ST #204 LAS VEGAS NV 89108	13811515161
DUCHARME JEREMY JAMES & JACYLN J	4008 RHONDA DR LAS VEGAS NV 89108-5209	13802811024
ELLIANO JACK & ANIETA FAMILY TR	ELLIANO JACK L JR & ANICETA TRS 4117 ROXANNE DR LAS VEGAS NV 89108-5219	13802813006
ELLIANO JACK L & ANICETA	4117 ROXANNE DR LAS VEGAS NV 89108-5219	13802813007
EQUITY TRUST COMPANY	156 ST CHARLES AVE SAN FRANCISCO CA 94132	13811517024

Report of All Selected Parcels**Case Number:***SDR-64584*
~~GPA-84582~~**Printed On:** Wed: May 18, 2016

<u>Owner</u>	<u>Address</u>	<u>Parcel Numbe</u>
ETHIER CHRIS	POIROT TATYANA A 8250 N GRAND CANYON AVE #2031 LAS VEGAS NV 89166	13811517124
FAUNI LUCILLE	3925 SWEET PINE ST #102 LAS VEGAS NV 89108	13811517065
FISCHER D'OR ANTHONY NI'HEEM	12118 LA CARTA CT LAS VEGAS NV 89138	13811515023
FLYNN EDWARD J III	103 GLENDALE AVE MANCHESTER NH 03103-2900	13811517153
FLYNN EDWARD J III	103 GLENDALE AVE MANCHESTER NH 03103-2900	13811517094
FOSTER CORY	301 N 45TH ST #3 FREEMONT WA 98103-6364	13811517174
FOSTER CORY	301 N 45TH ST #3 FREEMONT WA 98103-6364	13811517031
G M A C MORTGAGE L L C	1100 VIRGINIA DR FT WASHINGTON PA 19034-3204	13811517179
GALLAGHER MICHAEL & APRIL	3916 LAZY PINE ST #103 LAS VEGAS NV 89108-5188	13811517016
GALLAGHER MICHAEL & APRIL	3916 LAZY PINE ST #103 LAS VEGAS NV 89108-5188	13811517011
GALLAGHER MICHAEL & APRIL	3916 LAZY PINE ST #101 LAS VEGAS NV 89108-5188	13811517154
GALLAGHER MICHAEL & APRIL	3916 LAZY PINE ST #103 LAS VEGAS NV 89108-5188	13811517091
GALLAGHER MICHAEL J & APRIL L	3916 LAZY PINE ST #103 LAS VEGAS NV 89108-5188	13811517093
GANDECHA ANOOP	23441 GOLDEN SPRINGS DR #170 DIAMOND BAR CA 91765-2030	13811517044
GARCIA ERIC G	6140 PINE VILLA AVE #103 LAS VEGAS NV 89108-8100	13811517006
GARCIA GERONIMO	3829 SWEET PINE ST #101 LAS VEGAS NV 89108	13811517164
GARCIA GERONIMO	3929 SWEET PINE ST #101 LAS VEGAS NV 89108	13811517061
GARCIA JAIME G & ROSALINDA C	3921 SWEET PINE ST #103 LAS VEGAS NV 89108-8189	13811517069
GATTUSO CARMELO VINCENT MICHAEL	3940 QUIET PINE ST #202 LAS VEGAS NV 89108-8103	13811515014
GREEN NANCY	3917 LAZY PINE ST #202 LAS VEGAS NV 89108-8105	13811515038
GREGG KRISTEN E	6164 CALM BREEZE AVE LAS VEGAS NV 89108-8107	13811517117
GUR TOMER & EDITH	14534 NEWPORT AVE #2 TUSTIN CA 92780-1017	13811517106
GUR TOMER & EDITH	14534 NEWPORT AVE #2 TUSTIN CA 92780-1017	13811517149
H L N ENTERPRISES L L C	9337 CANYON SHADOW LN LAS VEGAS NV 89117	13802814011
HABERMAN RACHEL	P O BOX 48528 LOS ANGELES CA 90048-0528	13811515040
HADI HERMAWAN	405 BUCHANAN ROCK ST HENDERSON NV 89074	13811517105
HALL SHERRY D	3904 LAZY PINE ST #101 LAS VEGAS NV 89108-5182	13811517157
HALL SHERRY D	3904 LAZY PINE ST #101 LAS VEGAS NV 89108-5182	13811517082
HANSEN KAREN A REVOCABLE LIVING	HANSEN KAREN A TRS 4009 RHONDA DR LAS VEGAS NV 89108-5208	13802811020
HARDEMAN RAMONA L	6134 PINE VILLA AVE #102 LAS VEGAS NV 89108-8124	13811517008
HARRINGTON WILLIAM C	3107 BRIGHTON AVE LOS ANGELES CA 90018	13811515016
HARWELL KIM E	3920 SWEET PINE ST #102 LAS VEGAS NV 89108-8187	13811517053

Report of All Selected Parcels**Case Number:***SDR-64584*
~~GPA-84582~~**Printed On:** Wed: May 18, 2016

<u>Owner</u>	<u>Address</u>	<u>Parcel Numbe</u>
HERNANDEZ MARIA L	3909 SWEET PINE ST #103 LAS VEGAS NV 89108-8131	13811517078
HERRMANN RICHARD & KERRIE A	4012 RHONDA DR LAS VEGAS NV 89108-5209	13802811025
HESS BRIAN D & BRIAN DALE	10872 MONTASOLA ST LAS VEGAS NV 89141	13802813010
HICKSTEIN FRANK B SR & JULIA L	3924 QUIET PINE ST #101 LAS VEGAS NV 89108-8102	13811515041
HICKSTEIN FRANK B SR & JULIA L	3924 QUIET PINE ST #101 LAS VEGAS NV 89108-8102	13811515147
HODSON ADAM	6116 PINE VILLA AVE #102 LAS VEGAS NV 89108-8121	13811517017
HONTUCAN MARY NANCY	3921 PRESCOTT PINES ST #101 LAS VEGAS NV 89108-8175	13811517025
HONTUCAN MARY NANCY	3921 PRESCOTT PINES ST #101 LAS VEGAS NV 89108-8175	13811517176
HUGHES KAREN	3920 LAZY PINE ST #103 LAS VEGAS NV 89108-5190	13811517096
INTEREST INCOME PARTNERS L P	10D YELLOW FERRY HARBOR SAUSALITO CA 94965	13802814033
INTEREST INCOME PARTNERS L P	10D YELLOW FERRY HARBOR SAUSALITO CA 94965	13802814034
J A M PROPERTIES INTL L L C	17555 VENTURA BLVD #202 ENCINO CA 91316-3890	13811517145
J A M PROPERTIES INTL L L C	17555 VENTURA BLVD #202 ENCINO CA 91316-3890	13811517118
JACKSON LULA M	6156 PINE VILLA AVE #204 LAS VEGAS NV 89108-8127	13811515032
JIMENEZ JONATHAN RAFAEL	2232 MELINDA LAS VEGAS NV 89101	13801304010
JOHNSON PAULETTE L	6122 PINE VILLA AVE #102 LAS VEGAS NV 89108-8122	13811517014
K & M RENTALS INC	13426 TRACY ST #4 BALDWIN PARK CA 91706	13811515029
KECK FRED G & IRENE H LIVING TR	KECK FRED G & IRENE H TRS 3940 QUIET PINE ST #201 LAS VEGAS NV 89108-8103	13811515139
KECK FRED G & IRENE H LIVING TR	KECK FRED G & IRENE H TRS 3940 QUIET PINE ST #201 LAS VEGAS NV 89108-8103	13811515013
KIRKWOOD JOEL D	10658 MOUNT BLACKBURN AVE LAS VEGAS NV 89166	13811517034
KIRKWOOD JOEL D	10658 MOUNT BLACKBURN AVE LAS VEGAS NV 89166	13811517173
KOYSHMAN YACOV & OLGA LIVING TR	KOYSHMAN YACOV & OLGA TRS 10330 ETON AVE CHATSWORTH CA 91311	13811515152
KOYSHMAN YACOV & OLGA LIVING TR	KOYSHMAN YACOV & OLGA TRS 10330 ETON AVE CHATSWORTH CA 91311-2322	13811517121
KOYSHMAN YACOV & OLGA LIVING TR	KOYSHMAN YACOV & OLGA TRS 10330 ETON AVE CHATSWORTH CA 91311-2322	13811517144
KOYSHMAN YACOV & OLGA LIVING TR	KOYSHMAN YACOV & OLGA TRS 10330 ETON AVE CHATSWORTH CA 91311-2322	13811515047
KRAUSHAAR MARK C	3940 QUIET PINE ST #104 LAS VEGAS NV 89108-8103	13811515012
KURLAND MICHELE	3905 PRESCOTT PINES ST #103 LAS VEGAS NV 89108-8167	13811517039
LAATZ RICHARD	34 N MAY FLOWER AVE NORTH LAS VEGAS NV 89030	13802814006
LAI PAK SUNG & ANGIE WONG	P O BOX 3686 COVINA CA 91722	13811517067
LAI PAK SUNG & ANGIE WONG	P O BOX 3686 COVINA CA 91722	13811517162
LAI PAK SUNG & ANNGIE WONG	P O BOX 3686 COVINA CA 91722	13811515051
LAI PAK SUNG & ANNGIE WONG	P O BOX 3686 COVINA CA 91722	13811515157

Report of All Selected Parcels**Case Number:**SDR-64584
~~GPA-04502~~**Printed On:** Wed: May 18, 2016

<u>Owner</u>	<u>Address</u>	<u>Parcel Number</u>
LAKIS MARK & KITTY TRUST	LAKIS MARK G & CATHERINE M TRS 6320 DARBY AVE LAS VEGAS NV 89146-6608	13811517036
LAKIS MARK G & KITTY M	6320 DARBY AVE LAS VEGAS NV 89146-6608	13811517132
LAM ROGER PUN-TAK	REIMER LAI MING 11402 SITKA ROSE CIR EAGLE RIVER AK 99577	13811517185
LAM ROGER PUN-TAK	REIMER LAI MING 11402 SITKA ROSE CIR EAGLE RIVER AK 99577	13811517072
LAS VEGAS DEV GROUP L L C	397 3RD AVE #A CHULA VISTA CA 91910-3982	13811517057
LAS VEGAS RENTAL HOMES I L L L P	1950 S RAINBOW BLVD #103-210 LAS VEGAS NV 89146	13811517140
LAS VEGAS RENTAL HOMES I L L L P	1950 S RAINBOW BLVD #103-210 LAS VEGAS NV 89146	13811517133
LASKOVA RADKA	LASKOV JEKO 543 HOLTHOUSE TERR SUNNYVALE CA 94087	13811517033
LE MICHAEL	NGO THUY HANG & TONY 9364 DE ADALENA ST ROSEMEAD CA 91770	13811517051
LEDDY JAMES	6177 PINE DESERT AVE #101 LAS VEGAS NV 89108-8163	13811517143
LEWIS MICHAEL R & CAROLYN K	6165 PINE DESERT AVE #102 LAS VEGAS NV 89108-8159	13811517131
LI JUN	YAO LI 4280 SALT LAKE BLVD #H52 HONOLULU HI 96818-1154	13811517107
LONG-DURAND FAMILY TRUST	24 LYLEWOOD CT SACRAMENTO CA 95834-3827	13811517081
LOPEZ JOHN R & RUTH M	139 KENTUCKY WAY FREEHOLD NJ 07728	13811515049
LU CHYI-CHING & YUH-YUN	3908 LAZY PINE ST #103 LAS VEGAS NV 89108-5184	13811517087
LUJAN GREGORY	3924 QUIET PINE ST #204 LAS VEGAS NV 89108-8102	13811515048
LUTZ MARILYN J	3917 LAZY PINE ST #101 LAS VEGAS NV 89108-5189	13811515033
MACON JANISSA	2128 SADDLEBILL CT NORTH LAS VEGAS NV 89084	13811517048
MADDOX RICHARD A & BETH L	6812 WAR EAGLE CIR LAS VEGAS NV 89108-5017	13811517141
MADDOX RICHARD A & BETH L	6812 WAR EAGLE CIR LAS VEGAS NV 89108-5017	13811517130
MADSEN CHRISTOPHER E	6158 CALM BREEZE AVE #102 LAS VEGAS NV 89108-8110	13811517113
MANUMALEUNA BRANDON	6159 PINE DESERT AVE #102 LAS VEGAS NV 89108-8157	13811517134
MARTIN GREGORY C & MARCIA D	5444 MADRE MESA DR LAS VEGAS NV 89108	13811510011
MASOOD AHMED & MALKA M	6171 PINE DESERT AVE #102 LAS VEGAS NV 89108-8161	13811517128
MCCOY JAMES A & ELLEN J	4025 JORY TRL LAS VEGAS NV 89108-5202	13802811013
MEIER D FAMILY TRUST	MEIER DIANE MARIE TRS 4017 RHONDA DR LAS VEGAS NV 89108-5208	13802811019
MERRITT MATTHEW W & SHEREE A	4041 JORY TRL LAS VEGAS NV 89108-5202	13802811011
MIRABELLI FRANK & KAREN TRUST	MIRABELLI FRANK R & KAREN L TRS 4009 JORY TRL LAS VEGAS NV 89108-5202	13802811015
MOE ALTA M	856 MORRISON ST SAN DIEGO CA 92102	13811517172
MOE ALTA M	856 MORRISON ST SAN DIEGO CA 92012	13811517037
MOORE FAMILY TRUST	MOORE LOREN T & MICHELLE M TRS 5932 LADY CAROLINA ST NORTH LAS VEGAS NV 89081	13811517077
MORRELL BEVERLY A	6164 PINE VILLA AVE #203 LAS VEGAS NV 89108-8120	13811515158

Report of All Selected Parcels**Case Number:**50R-64584
~~GPA-64582~~**Printed On:** Wed: May 18, 2016

<u>Owner</u>	<u>Address</u>	<u>Parcel Numbe</u>
MOUSENYOK INC	%C BRAUNAGEL P O BOX 4230 PORT JERVIS NY 12771-4230	13811515011
MOUSENYOK INC	%C BRAUNAGEL P O BOX 4230 PORT JERVIS NY 12771-4230	13811515142
MULKERN TIMOTHY & M SIDNEY	6164 PINE VILLA AVE #201 LAS VEGAS NV 89108-8120	13811515021
MYNARCIK NEVADA TRUST	MYNARCIK BRANDON TRS 6350 W CHEYENNE LAS VEGAS NV 89108-4309	13802814035
O'BRIEN ANGELITA	6128 PINE VILLA AVE #101 LAS VEGAS NV 89108	13811517010
O'BRIEN ANGELITA	6128 PINE VILLA AVE #101 LAS VEGAS NV 89108	13811517181
OLSEN MITCHEL A & CYNTHIA I	4125 JORY TRL LAS VEGAS NV 89108-5206	13802811005
OLSEN MITCHEL ALAN & CYNTHIA I	4009 ROXANNE DR LAS VEGAS NV 89108-5212	13802813002
ORLANDO SUZANNE E	3904 SWEET PINE ST #103 LAS VEGAS NV 89108-8181	13811517042
OSHIRO KEVIN T	156 ST CHARLES AVE SAN FRANCISCO CA 94132	13811517075
OWENS WARDELL & BOBBIE J	4116 ROXANNE DR LAS VEGAS NV 89108-5218	13802813008
PARRIS ROBINSON EASTERN L L C	120 PRESIDENTIAL WAY #300 WOBURN MA 01801	13801401003
PARRIS ROBINSON EASTERN L L C	120 PRESIDENTIAL WAY #300 WOBURN MA 01801	13801401001
PARRIS ROBINSON EASTERN L L C	120 PRESIDENTIAL WAY #300 WOBURN MA 01801	13802804001
PARRISH BISHOP P & HELEN N	P O BOX 370968 LAS VEGAS NV 89137-0968	13811515146
PARRISH BISHOP P III & HELEN N	P O BOX 370968 LAS VEGAS NV 89137-0968	13811515025
PARRISH BISHOP P III & HELEN N	P O BOX 370968 LAS VEGAS NV 89137-0968	13811515137
PARRISH BISHOP P III & HELEN N	P O BOX 370968 LAS VEGAS NV 89137-0968	13811515046
PAZ FAMILY TRUST	PAZ CAESAR JR & ESMERALDA TRS 2059 NEWCASTLE DR OXNARD CA 93036	13811517115
PAZ FAMILY TRUST	PAZ CAESAR JR & ESMERALDA CO-TRS 2059 NEWCASTLE DR OXNARD CA 93036	13811517146
PEP BOYS MANNY MOE & JACK CA	4141 N RANCHO LAS VEGAS NV 89130-3411	13802814003
PERONA LOURDES R LIVING TRUST	PERONA LOURDES R TRS %P PERONA JR 3933 LAZY PINE ST #204 LAS VEGAS NV 89108-8165	13811515008
PHOENIX L V REALTY PARTNERS NO 2	3753 HOWARD HUGHES PKWY #200 LAS VEGAS NV 89169	13811515052
PHOENIX LV REALTY PARTNERS LLC	3753 HOWARD HUGHES PKWY #200 LAS VEGAS NV 89169	13811515150
PHOENIX LV REALTY PARTNERS LLC	3753 HOWARD HUGHES PKWY #200 LAS VEGAS NV 89169	13811515024
PHOENIX LV REALTY PARTNERS NO 2	3753 HOWARD HUGHES PKWY #200 LAS VEGAS NV 89169	13811515002
PHOENIX LV REALTY PTNRS #2 L L P	3753 HOWARD HUGHES PKWY #200 LAS VEGAS NV 89169	13811515039
PHOENIX LV REALTY PTNRS #2 L L P	3753 HOWARD HUGHES PKWY #200 LAS VEGAS NV 89169-0952	13811515026
PHOENIX LV REALTY PTNRS #2 L L P	3753 HOWARD HUGHES PKWY #200 LAS VEGAS NV 89169	13811517019
PHOENIX LV REALTY PTNRS #2 LLP	3753 HOWARD HUGHES PKWY LAS VEGAS NV 89169	13811515036
PHOENIX LV REALTY PTNRS NO2 LLP	3753 HOWARD HUGHES PKWY #200 LAS VEGAS NV 89169	13811515006
PIKE RANDALL & CYNTHIA	6164 CALM BREEZE AVE #102 LAS VEGAS NV 89108-8111	13811517116

Report of All Selected Parcels**Case Number:**

50R-64584

~~GPA-84582~~**Printed On:** Wed: May 18, 2016

<u>Owner</u>	<u>Address</u>	<u>Parcel Number</u>
PLOTKIN FERN & ROBERT	6164 PINE VILLA AVE #101 LAS VEGAS NV 89108-8120	13811515017
PRE RANCHO CRAIG L L C	120 PRESIDENTIAL WAY #300 WOBURN MA 01801	13802802001
PRE RANCHO CRAIG L L C	120 PRESIDENTIAL WAY #300 WOBURN MA 01801	13802702002
PRESCIA ANTHONY & NANCY FAM TR	PRESCIA NADINE LIVING TRUST 10538 MEADOW MIST AVE LAS VEGAS NV 89135	13802814013
PRESCIA ANTHONY & NANCY FAM TR	PRESCIA NADINE LIVING TRUST 10538 MEADOW MIST AVE LAS VEGAS NV 89135	13802814014
PRINGLE LORI	4016 RHONDA DR LAS VEGAS NV 89108-5209	13802811026
PRODROMIDES JOHN & BRENDA	1916 SMITH ST LAS VEGAS NV 89108-2433	13811517092
PRUETTE ROGER	4001 JORY TRL LAS VEGAS NV 89108-5202	13802811016
R J R EIRING FAMILY TRUST	EIRING ROBERTA JEAN TRS P O BOX 580 PAROWEN UT 84761-0580	13802813003
RAFFER HELEN P	RUDICK LILY 5317 FRIESAN WY ELK GROVE CA 95757-3222	13811515138
RAFFER HELEN P	RUDICK LILY 5317 FRIESAN WY ELK GROVE CA 95757-3222	13811515009
RANDAZZO VICTOR	3924 QUIET PINE ST #201 LAS VEGAS NV 89108-8102	13811515045
REED SHAWNA L	9509 COUNTRY WINE CT LAS VEGAS NV 89129-7879	13811515007
REINHARDT KATHERINE A	6177 PINE DESERT AVE #102 LAS VEGAS NV 89108-8163	13811517125
RESMA ANTONIO R & ROMONA D	RESMA ERIC D 4000 RHONDA DR LAS VEGAS NV 89108-5209	13802811022
RHIZOR STEVE T	KOZAK-RHIZOR SHARON A 4109 JORY TRL LAS VEGAS NV 89108-5206	13802811007
RHODES T T & HECHT D E LIV TR	RHODES TIMOTHY T TRS 3157 N RAINBOW BLVD #186 LAS VEGAS NV 89108-4578	13811510008
RIDGE VIEW L L C	P O BOX 1099DUCK CREEK VILLAGE U T 84762-1099	13802814005
ROSAS DAVID J III	1025 CALHOUN AVE BRONX NY 10465-1910	13811517038
ROSE MICHAEL S & CAROL D	5424 IRELAND ST LAS VEGAS NV 89149-2019	13811517064
ROSE MICHAEL S & CAROL D	5424 IRELAND ST LAS VEGAS NV 89149-2019	13811517163
ROSS IRIS M	6159 PINE DESERT AVE #103 LAS VEGAS NV 89108-8157	13811517135
ROVERE GREG	RETCHLESS VICTORIA ANN 100 PANORAMA DR #A LAS VEGAS NV 89107-1131	13811517095
ROVERE GREG A	RETCHLESS VICTORIA ANN 100 PANORAMA DR #A LAS VEGAS NV 89107-1131	13811517003
S F R INVESTMENT POOL 1 L L C	5030 PARADISE RD #B-214 LAS VEGAS NV 89119	13811517090
S F R INVESTMENTS POOL 1 L L C	5030 PARADISE RD #B-214 LAS VEGAS NV 89119	13811517102
SANBUMA L L C	4135 N RANCHO DR LAS VEGAS NV 89130-3411	13802814028
SANCHEZ EFREN R & LEIGHA JANEL	12716 GREAT COUNTRY DR BAKERSFIELD CA 93312-6902	13811517104
SANCHEZ SANTIAGO & CYNTHIA E	6217 W ALEXANDER RD LAS VEGAS NV 89108	13811510009
SANTOS AMANDA RIBERTO	3929 PRESCOTT PINES ST #103 LAS VEGAS NV 89108-8179	13811517021
SHELL RODGER	4033 JORY TRL LAS VEGAS NV 89108-5202	13802811012
SCHINNERER FAMILY TRUST	SCHINNERER DAVID E & DEBRA TRS 30936 CARTIER DR RANCHO PALOS VERDES CA 90275	13802814032

50R-64584

~~SPR-64582~~

Report of All Selected Parcels

Case Number:

Printed On: Wed: May 18, 2016

<u>Owner</u>	<u>Address</u>	<u>Parcel Numbe</u>
SCUDDER MICHAEL Y & CAROL J	3925 LAZY PINE ST #201 LAS VEGAS NV 89108-8164	13811515053
SELVA GRACIELA A REVOCABLE TRUST	SELVA GRACIELA A TRS 6156 PINE VILLA AVE #204 LAS VEGAS NV 89108-8127	13811515030
SHIVAN INVESTMENTS L L C	8440 W LAKE MEAD BLVD #101 LAS VEGAS NV 89128	13811517045
SLAVIN HELEN	517 FALCON LN LAS VEGAS NV 89107-3838	13812101002
SLEEK FAMILY TRUST	SLEEK THEODORE R TRS 1214 VISTA CANTORA SAN CLEMENTE CA 92672-2362	13811515050
SLEEK FAMILY TRUST	MENDEZ BLANCA E TRS 1214 VISTA CANTORA SAN CLEMENTE CA 92672-2362	13811515155
SLEEK FAMILY TRUST	SLEEK THEODORE R TRS 1214 VISTA CANTORA SAN CLEMENTE CA 92672-2362	13811515043
SLEEK FAMILY TRUST	SLEEK THEODORE R TRS 1214 VISTA CANTORA SAN CLEMENTE CA 92672-2362	13811515153
SLEEK FAMILY TRUST	MENDEZ BLANCA E TRS 1214 VISTA CANTORA SAN CLEMENTE CA 92672-2362	13811515054
SLEEK FAMILY TRUST	SLEEK THEODORE R TRS 1214 VISTA CANTORA SAN CLEMENTE CA 92672-2362	13811515154
SMITH CHRISTOPHER A	1116 PORTER ST RIDGECREST CA 93555-8805	13811517071
SOJKA MARYLEE	POLLACK JACOB 2721 MOON WAVE AVE NORTH LAS VEGAS NV 89031-1105	13811517098
STEPHENSON MARK L & BARBARA G	4049 JORY TRL LAS VEGAS NV 89108-5202	13802811010
STERLING ASSETS L L C	402 E OCEANFRONT #A NEWPORT BEACH CA 92661	13811515010
STERLING ASSETS L L C	402 E OCEANFRONT #A NEWPORT BEACH CA 92661	13811515140
STETS MARK	3925 LOST MINER CT LAS VEGAS NV 89129-7658	13811517099
STEWART THOMAS J	3904 LAZY PINES ST #103 LAS VEGAS NV 89108-5182	13811517084
SU JINGMEI	4662 SAUK AVE SAN DIEGO CA 92117	13811517182
SU JINGMEI	4662 SAUK AVE SAN DIEGO CA 92117	13811517007
SUMMERS MELVIN G & JULIA B	3933 LAZY PINE ST #101 LAS VEGAS NV 89108-8151	13811515001
T & T PROPERTIES L L C	4804 LAUREL CANYON BLVD #135 VALLEY VILLAGE CA 91607	13811515005
T T R PROPERTIES L L C	P O BOX 370997 LAS VEGAS NV 89137	13802814009
TATE SUSAN R	3933 LAZY PINE ST #103 LAS VEGAS NV 89108-8151	13811515003
TATE SUSAN R	3933 LAZY PINE ST #103 LAS VEGAS NV 89108-8151	13811515144
TAYLOR LLOYD	10850 KNICKERBOCKER AVE LAS VEGAS NV 89166	13811517150
TAYLOR LLOYD	10850 KNICKERBOCKER AVE LAS VEGAS NV 89166	13811517103
THODUPUNOORI SRIKANTH	630 PARK VIEW DR #108 SANTA CLARA CA 95054-3579	13811517059
THOM SUSAN A	4001 RHONDA DR LAS VEGAS NV 89108	13802811021
TICE JOSHUA	3944 LAZY PINE ST #104 LAS VEGAS NV 89108	13811515143
TICE JOSHUA	3933 LAZY PINE ST #104 LAS VEGAS NV 89108	13811515145
TICE JOSHUA	3933 LAZY PINE ST #104 LAS VEGAS NV 89108	13811515004
TOUCHE TRUST	OZERETSKAYA ANNA TRS 172 DUNBLANE ST HENDERSON NV 89012	13811515037

Report of All Selected Parcels**Case Number:***SDR-64584*
~~OPA-64582~~**Printed On:** Wed: May 18, 2016

<u>Owner</u>	<u>Address</u>	<u>Parcel Number</u>
TOUCHE TRUST	OZERETSKAYA ANNA TRS 172 DUNBLANE ST HENDERSON NV 89012	13811517043
TOUCHE TRUST	OZERETSKAYA ANNA TRS 172 DUNBLANE ST HENDERSON NV 89012	13811517170
TRUSTEE CLARK COUNTY TREASURER	%TOWNER PHELEANCE 3928 SWEET PINE ST #101 LAS VEGAS NV 89108-8191	13811517165
TRUSTEE CLARK COUNTY TREASURER	%FEDERAL HOME LOAN MORTGAGE CORP 5000 PLANO PKWY CARROLLTON TX 75010-4900	13811517168
TRUSTEE CLARK COUNTY TREASURER	%AGHA RAZA ALI 7865 TIDAL POOL CT LAS VEGAS NV 89139-6121	13811517175
TRUSTEE CLARK COUNTY TREASURER	%DESERT PINES ASSOCIATES 333 N RANCHO #100 LAS VEGAS NV 89106-3797	13811515141
TRUSTEE CLARK COUNTY TREASURER	%ELIAS YOLANDA 316 AUTUMN PALACE CT LAS VEGAS NV 89144-4108	13811517152
TRUSTEE CLARK COUNTY TREASURER	%SHARPE JUNE R LIVING TRUST 3925 LAZY PINE ST #101 LAS VEGAS NV 89108-8147	13811515159
TRUSTEE CLARK COUNTY TREASURER	%DESERT PINES ASSOCIATES 333 N RANCHO #100 LAS VEGAS NV 89106-3797	13811515156
TRUSTEE CLARK COUNTY TREASURER	%JOHNSON SEAN 3908 LAZY PINE ST #101 LAS VEGAS NV 89108-5184	13811517156
UGOCHUKWU VITALIS N & GLORIA N	4430 CELESTE CT VALLEJO CA 94591-6385	13811517035
ULANSKI MICHAEL	3921 PRESCOTT PINES ST #102 LAS VEGAS NV 89108-8175	13811517026
VANFOSSEN JUDY L	4000 JORY TRL LAS VEGAS NV 89108-5203	13802811017
VEGAS VALLEY AUCTIONS L L C	3900 S HUALAPAI WAY #125 LAS VEGAS NV 89147-5738	13811517122
VIOLA ENTERTAINMENT INC	25835 TABLE MEADOW RD AUBURN CA 95602-8958	13802814004
W & H ASSOCIATES L L C	16468 BELL RIDGE DR CHINO HILLS CA 91709-4911	13811517066
WEINBERGER DAVID ALAN	3924 LAZY PINE #101 LAS VEGAS NV 89108-8145	13811517097
WEN FABIENNE	%FOSTER REALTY LLC 3900 PARADISE RD #121 LAS VEGAS NV 89169	13811517073
WEN FABIENNE	%FOSTER REALTY LLC 3900 PARADISE RD #121 LAS VEGAS NV 89169	13811517160
WHITEMAN DENNIS F	MUILENBURG JULIE JANE 3917 LAZY PINE ST #102 LAS VEGAS NV 89108	13811515034
WILCOX GEOFF	3917 SWEET PINE ST #101 LAS VEGAS NV 89108-8136	13811517070
WILCOX GEOFF	3917 SWEET PINE ST #101 LAS VEGAS NV 89108-8136	13811517161
WISEINVEST L L C	1782 SOUTH RD #87 WAPPINGERS FALLS NY 12590	13811515044
WOJCIK MICHAEL & JEANETTE M	7212 FRAND BORMAN LAS VEGAS NV 89145	13802811004
WOOD ROBIN L	3928 SWEET PINE ST #103 LAS VEGAS NV 89108-8191	13811517060
WOYTOWISH STEPHEN J	3904 SWEET PINE ST #101 LAS VEGAS NV 89108-8181	13811517040
WOYTOWISH STEPHEN J	3904 SWEET PINE ST #101 LAS VEGAS NV 89108-8181	13811517171
YAHAV SHMUEL & NAOMI	1685 H ST #311 BLAINE wa 98230	13811515027
YAO YE	6336 BLUE TWILIGHT CT LAS VEGAS NV 89108	13811517123
YUAN JERRY	301 OSPREY RIDGE DR EMERALD ISLE NC 28594	13811517120
YUEN LANCE LEE	4471 DEAN MARTIN DR #1504 LAS VEGAS NV 89103	13811515028
Z & G MANAGEMENT INC	12117 VISTA LINDA AVE LAS VEGAS NV 89138	13811517129