

City of Las Vegas  
Office Of The City Clerk  
495 S. Main St., City Hall  
Las Vegas, Nevada 89101

## Return Service Requested Official Notice of Public Hearing

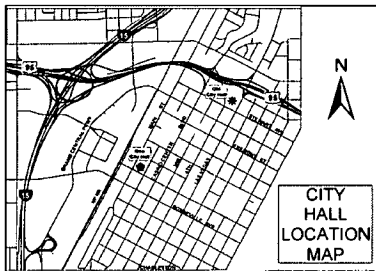

If you wish to file your protest or support on this request, check the appropriate box below and return this card in an envelope with postage to the Office Of The City Clerk at the address listed above, fax this side of this card to (702) 382-4803 or make your comments at [www.lasvegasnevada.gov](http://www.lasvegasnevada.gov). If you would like to contact your Council Representative, please call (702) 229-6405.

I SUPPORT  
this Request

I OPPOSE  
this Request

Please use available blank space on card for your comments.

**SUP-55295**

Special City Council Meeting of **October 28, 2014**

## Application Information

**SUP-55295 - SPECIAL USE PERMIT - PUBLIC HEARING - APPLICANT: M'LIFE WELLNESS, LLC - OWNER: NEVADA SPACE, INC. - For possible action on a request for a Special Use Permit FOR A PROPOSED 4,000 SQUARE-FOOT MEDICAL MARIJUANA DISPENSARY at 2800 Highland Drive (APN 162-09-202-007), M (Industrial) Zone, Ward 1 (Tarkanian).**

## Application Location

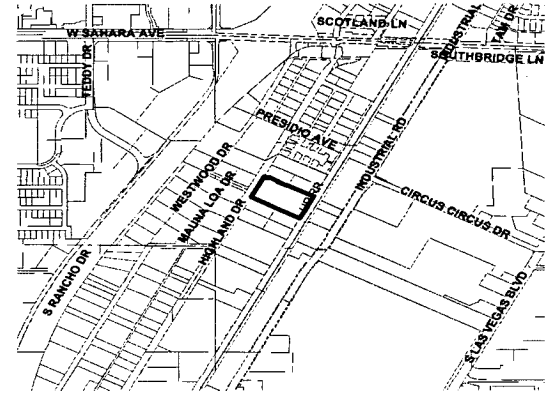

The proposed project may not pertain to the entire highlighted project site.

## Public Hearing Information

**Meeting:** Special City Council  
**Date:** *October 28, 2014*  
**Time:** 9:00 A.M.  
**Location:** City Council Chambers  
495 South Main Street, 2<sup>nd</sup> Floor  
Las Vegas, Nevada 89101

Any and all interested persons may appear and be heard at said meeting, or may, prior to this meeting, file a written objection thereto or approval thereof with the City Clerk, 2nd Floor, City Hall, 495 South Main Street, Las Vegas, Nevada 89101. For further information, including the full staff report, please call (702)229-6311 (7-1-1 Relay Nevada) or go to <http://www.lasvegasnevada.gov>.

CASE# SUP-55295

PARCEL#	OWNER	ADDRESS1	ADDRESS2	ADDRESS3	ADDRESS4	ADDRESS5
1	16209302007	2010-1 CRE NV-OFFICE L L C	2450 BROADWAY 6TH FLR	SANTA MONICA CA 90404		
2	16209110018	2575 S HIGHLAND DRIVE L P	%CANTOR G & W NV HOLDINGS L P	2575 HIGHLAND DR	LAS VEGAS NV 89109-1113	
3	16209110023	2620 HIGHLAND L L C	10300 W CHARLESTON BLVD #13-156	LAS VEGAS NV 89135-1037		
4	16209104004	2685 L L C	%M BOGAN	2830 ELK CANYON CT	LAS VEGAS NV 89117-2982	
5	16209104005	2687 L L C	2830 ELK CANYON CT	LAS VEGAS NV 89117-2982		
6	16209102002	2701 WESTWOOD L L C	%MR R BRANDY	1113 PINE ISLAND CT	LAS VEGAS NV 89134-6330	
7	16209201003	2861 S HIGHLAND DRIVE L L C	P O BOX 1305	CAMARILLO CA 93011-1305		
8	16208707002	B M HIGHLAND L L C	3030 S HIGHLAND DR	LAS VEGAS NV 89109-1047		
9	16209211002	BANYAN PROPERTIES L L C	9030 W SAHARA AVE #299	LAS VEGAS NV 89117-5744		
10	16209110027	BARRY PATRICK & DAWN L	2664 HIGHLAND DR	LAS VEGAS NV 89109-1116		
11	16209110005	BRADY DONALD B	2600 WESTWOOD DR	LAS VEGAS NV 89109-1118		
12	16209110015	BROSSEAU 1993 TRUST	BROSSEAU PAUL H TRS	2609 S HIGHLAND DR	LAS VEGAS NV 89109-1156	
13	16209110016	CARL ROBERT SCOTT LIVING TR 2006	CARL ROBERT S TRS	2605 HIGHLAND DR	LAS VEGAS NV 89109-1113	
14	16209110028	CARTANIA INC	%PREMIER TRUST	4465 S JONES BLVD	LAS VEGAS NV 89103-3307	

	PARCEL#	OWNER	ADDRESS1	ADDRESS2	ADDRESS3	ADDRESS4	ADDRESS5
15	16209501001	CIRCUS CIRCUS CASINOS INC	%MGM RESORTS INTL ~ %PROCESS ACC	4882 FRANK SINATRA DR	LAS VEGAS NV 89158-4316		
16	16209204001	CIRCUS CIRCUS ENTERPRISES INC	%MGM RESORTS INTL ~ %PROCESS ACC	4882 FRANK SINATRA DR	LAS VEGAS NV 89158-4316		
17	16209102005	CLAREMONT HOTEL INC	%P CHOPRA	135 W 70TH ST #7CD	NEW YORK NY 10023		
18	16209110021	CNB FKA BBN L L C	C SHELTON	2015 E WINDMILL LN	LAS VEGAS NV 89123		
19	16209303006	COUNTY OF CLARK(FIRE DEPT)	500 S GRAND CENTRAL PKWY	LAS VEGAS NV 89155			
20	16209102004	D 2753 L L C	P O BOX 570427	HOUSTON TX 77257			
21	16209201001	D 2765 L L C	8222 ANOINE DR #100	HOUSTON TX 77088			
22	16208604001	D 2801 WESTWOOD INC	P O BOX 570413	HOUSTON TX 77257-0413			
23	16209203003	DITEL L L C	6817 S EASTERN AVE #101	LAS VEGAS NV 89119-4684			
24	16209104003	DRATTER PETER J LIVING TRUST	DRATTER PETER J TRS	P O BOX 277	HURRICANE UT 84737-0277		
25	16209203005	E-J CLUB L L C	%E WEDELSTEDT	12740 E CONTROL TOWER RD #J8	ENGLEWOOD CO 80112		
26	16208705002	ENGLERT HIGHLANDS PPTYS L L C	P O BOX 46650	LAS VEGAS NV 89114-6650			
27	16209110034	ENGLERT SUTTER PROPERTIES L L C	2935 S HIGHLAND DR	LAS VEGAS NV 89109-1011			
28	16209301003	F K C HIGHLAND L L C	180 N RIVERVIEW DR #100	ANAHEIM CA 92808			

	PARCEL#	OWNER	ADDRESS1	ADDRESS2	ADDRESS3	ADDRESS4	ADDRESS5
29	16209102008	GARRETT CAPITAL L L C	%SIEGEL GROUP/SASCO PPTYS	3790 PARADISE RD #250	LAS VEGAS NV 89169-4640		
30	16208705005	H & H CORPORATION	6120 S TORREY PINES	LAS VEGAS NV 89118-3209			
31	16209211006	HAAS FAMILY TRUST	HAAS ROBERT MELVIN & JO A TRS	%R HAAS	10804 FRANKLIN HILLS AVE	LAS VEGAS NV 89135	
32	16209110017	HIGHLAND BY THE HIGHWAY L L C	8275 S EASTERN AVE #200	LAS VEGAS NV 89123-2545			
33	16209210002	HIGHLAND INDUST PK PTNRSHIP	2500 W SAHARA AVE #211	LAS VEGAS NV 89102-4393			
34	16208604002	HIGHLAND INDUSTRIAL PARK PTNRSHIP	%NEVADA DEVELOPMENT & REALTY CO	2500 W SAHARA AVE #211	LAS VEGAS NV 89102-4393		
35	16209202014	HIGHLAND NEVADA PROPERTY L L C	%G D'AQUINO	1850 BUSINESS CENTER DR	DUARTE CA 91010- 2901		
36	16208705004	HUGHES FAMILY L L C #2	COURY FAMILY L L C #3	2975 S HIGHLAND DR	LAS VEGAS NV 89109-1011		
37	16208703003	J X E INVESTMENT L L C	10569 PURDEY RD	EDEN PRAIRIE MN 55347			
38	16209111001	JACOBS JOSEPH & NANCY TRUST	JACOBS JOSEPH A & NANCY D TRS	3729 TOPAWA ST	LAS VEGAS NV 89103-2435		
39	16209110011	JOHNSON FAMILY REVOCABLE TRUST	EARL HAROLD L & HORTENSE C TR	%N THOMAS	379 N 1580 W	HURRICANE UT 84737	
40	16209110022	K E N C O INVESTMENTS L L C	2504 SPRINGBROOK DR	LAS VEGAS NV 89134-7584			
41	16209202008	KHAZAI SHAHRIAR & ISABELA	P O BOX 25879	LOS ANGELES CA 90025-0879			
42	16209110032	L C 111 L L C	P O BOX 81745	LAS VEGAS NV 89180-1745			

	PARCEL#	OWNER	ADDRESS1	ADDRESS2	ADDRESS3	ADDRESS4	ADDRESS5
43	16209201002	L'CHAIM WESTERN SUPPLY PPTY LLC	6130 W FLAMINGO RD #402	LAS VEGAS NV 89103-2280			
44	16209203006	LEONARDI PROPERTIES	46 LOUISE ST	SAN RAFAEL CA 94901-4718			
45	16209211004	M T WAREHOUSE L L C	9030 W SAHARA AVE #299	LAS VEGAS NV 89117-5744			
46	16208703001	MARTIN ROBERT E & KAYE	1500 MARBELLA RIDGE CT	LAS VEGAS NV 89117			
47	16209110036	MARX GORDON L	X R A M L L C	2620 WESTERN AVE	LAS VEGAS NV 89109		
48	16208703002	MENDELL FAMILY PARTNERS L P	%S MENDELL	P O BOX 8510	RANCHO SANTA FE CA 92067-8510		
49	16209111002	MOMARY DOUGLAS R & EMILY J	BOND GEORGE T & PHYLLIS D	2708 HIGHLAND DR	LAS VEGAS NV 89109-1004		
50	16209110025	N & J PROPERTIES NEVADA L L C	2305 WIMBLEDON	LAS VEGAS NV 89107-2363			
51	16208502006	N P PALACE L L C	%GEN COUNSEL	1505 S PAVILION CENTER DR	LAS VEGAS NV 89135-1403		
52	16209202001	N Y P CORPORATION	6120 S TORREY PINES	LAS VEGAS NV 89118-3209			
53	16209103002	NEVADA POWER COMPANY	%LAND SERV STA #9	P O BOX 98910	LAS VEGAS NV 89193-8910		
54	16209202007	NEVADA SPACE INC	1900 E DESERT INN RD	LAS VEGAS NV 89169-3211			
55	16209102006	O H D B L L C	%BLUE MOON RESORT	2651 WEST WOOD DR	LAS VEGAS NV 89109-1117		
56	16209211007	P L MOTOR L L C	6625 W BADURA AVE	LAS VEGAS NV 89118-4673			

	PARCEL#	OWNER	ADDRESS1	ADDRESS2	ADDRESS3	ADDRESS4	ADDRESS5
57	16208705003	PFIZENMAYER FAMILY TRUST	PFIZENMAYER GARY & ANGEL TRS	2338 READING HILLS AVE	HENDERSON NV 89052-5836		
58	16209202009	PLANET PROPERTIES L L C	1647 COLLINGWOOD DR	SAN DIEGO CA 92109			
59	16209202010	POSITIVE SPACE INC	%B ALLEN PHOTOGRAPHY	18 STAR BROOK AVE	HENDERSON NV 89052-6628		
60	16208704001	R S G PARTNERS L L C	1625 SKYLINE DR	FULLERTON CA 92831-1007			
61	16209110013	RED OAK TRUST	CREEL ALLAN & DEBORAH TRS	11 BURNING TREE CT	LAS VEGAS NV 89113-1329		
62	16209303004	RESORTS WORLD LAS VEGAS L L C	%GENTING ASSETS INC	300 S 4TH ST #1700	LAS VEGAS NV 89101		
63	16209110014	RODRIGUEZ NORMA E	2621 HIGHLAND DR	LAS VEGAS NV 89109-1113			
64	16209302006	S H A C M T L L C	ALMOND-JURUPA ASSOCIATES LTD	%SHAC LLC ~ %D TALLA	11151 MISSOURI AVE	LOS ANGELES CA 90025-5634	
65	16209301001	SCHIFF MARVIN JAMES TRS	MASON FAMILY TRUST	2401 INDUSTRIAL RD	LAS VEGAS NV 89102-4817		
66	16209211008	SEDANO AIDA C & HIRAM H	2706 S HIGHLAND DR	LAS VEGAS NV 89109-1004			
67	16209110008	SHARPE ALLEN L TRUST	SHARPE FLORENCE M TRUST	2855 BELCASTRO ST	LAS VEGAS NV 89117-3035		
68	16209110037	SOBEL WESTEX	2670 S WESTERN AVE	LAS VEGAS NV 89109-1112			
69	16208704003	STORAGE WORKS II L L C	%M KRAFT	2922 RED ARROW DR	LAS VEGAS NV 89135		
70	16209211001	THISTLE DANIEL J & J J FAM TR	THISTLE FAMILY TRUST	2710 S HIGHLAND DR	LAS VEGAS NV 89109		

CASE# SUP-55295

	PARCEL#	OWNER	ADDRESS1	ADDRESS2	ADDRESS3	ADDRESS4	ADDRESS5
71	16209110020	URBAN LAND NEVADA	3271 S HIGHLAND DR #704	LAS VEGAS NV 89109-1051			
72	16209203004	W B P LEASING INC	621 NW 53RD ST #700	BOCA RATON FL 33487-8242			
73	16209110026	WADE JO FERN TRUST	SHANE DAVID L CO- TRS	200 N WESTLAKE BLVD #201	WESTLAKE VILLAGE CA 91362- 3774		
74	16209110033	WESTCOM DEVELOPMENT L L C	%K CANE	3273 E WARM SPRINGS RD	LAS VEGAS NV 89120-3157		
75	16208704002	WESTWOOD RENTAL L L C	3592 PROCYON ST	LAS VEGAS NV 89103-1908			
76	16208610104	WYANDOTTE HOLDINGS L L C	299 PARK AVE 42ND FL	NEW YORK NY 10171-4299			
77	16209110031	ZARGARYAN GAGIK & K REV TR AGMT	ZARGARYAN GAGIK & KNARIK CO-TRS	2920 S TIOGA WAY	LAS VEGAS NV 89117-3202		