

City of Las Vegas
Office Of The City Clerk
495 S. Main St., City Hall
Las Vegas, Nevada 89101

Return Service Requested Official Notice of Public Hearing

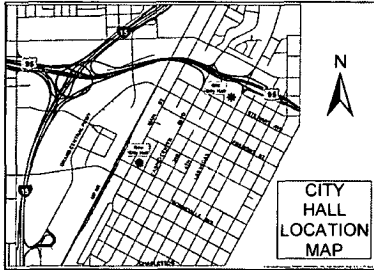

If you wish to file your protest or support on this request, check the appropriate box below and return this card in an envelope with postage to the Office Of The City Clerk at the address listed above, fax this side of this card to (702) 382-4803 or make your comments at www.lasvegasnevada.gov. If you would like to contact your Council Representative, please call (702) 229-6405.

I SUPPORT
this Request

I OPPOSE
this Request

Please use available blank space on card for your comments.

SUP-55271 & SDR-55270

Special City Council Meeting of **October 28, 2014**

Application Information

SUP-55271 - SPECIAL USE PERMIT - PUBLIC HEARING - APPLICANT: RED ROCK WELLNESS, LLC - OWNER: SMADY, LLC - For possible action on a request for a Special Use Permit FOR A PROPOSED 6,222 SQUARE-FOOT MEDICAL MARIJUANA DISPENSARY at the northeast corner of Bonanza Road and Main Street (APNs 139-27-810-001 and 139-27-707-008), C-1 (Limited Commercial) Zone, Ward 5 (Barlow).

SDR-55270 - SITE DEVELOPMENT PLAN REVIEW RELATED TO SUP-55271 - PUBLIC HEARING - APPLICANT: RED ROCK WELLNESS, LLC - OWNER: SMADY, LLC - For possible action on a request for a Site Development Plan Review FOR A PROPOSED 6,222 SQUARE-FOOT MEDICAL MARIJUANA DISPENSARY on 1.37 acres at the northeast corner of Bonanza Road and Main Street (APNs 139-27-810-001 and 139-27-707-008), C-1 (Limited Commercial) Zone, Ward 5 (Barlow).

Application Location

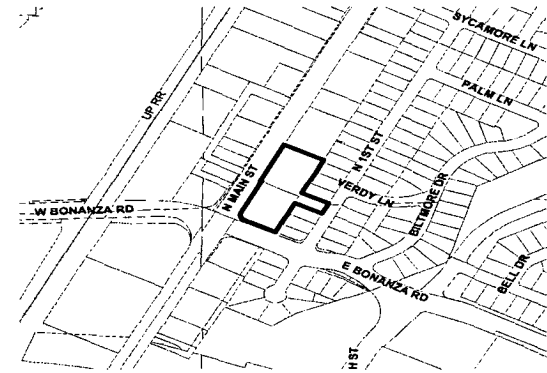

The proposed project may not pertain to the entire highlighted project site.

Public Hearing Information

Meeting: Special City Council
Date: *October 28, 2014*
Time: 9:00 A.M.
Location: City Council Chambers
495 South Main Street, 2nd Floor
Las Vegas, Nevada 89101

Any and all interested persons may appear and be heard at said meeting, or may, prior to this meeting, file a written objection thereto or approval thereof with the City Clerk, 2nd Floor, City Hall, 495 South Main Street, Las Vegas, Nevada 89101. For further information, including the full staff report, please call (702)229-6311 (7-1-1 Relay Nevada) or go to <http://www.lasvegasnevada.gov>.

CASE# SUP-55271

	PARCEL#	OWNER	ADDRESS1	ADDRESS2	ADDRESS3	ADDRESS4	ADDRESS5
1	13927810027	100 E BONANZA L L C	%L FEENEY	435 ARLINGTON RD	REDWOOD CITY CA 94062-1838		
2	13927811049	307 BONANZA WAY L L C	%DESERT RLTY INC	3160 W SAHARA AVE #A-22	LAS VEGAS NV 89102		
3	13927812003	717 L L C	%T COBLENTZ ~ %S & A FELD	3207 BEL AIR DR	LAS VEGAS NV 89109-1518		
4	13927811050	A G S PROPERTY GROUP L L C	5137 N TIOGA WAY	LAS VEGAS NV 89149			
5	13927711013	ALI SYED AMJAD	P O BOX 70634	LAS VEGAS NV 89170-0634			
6	13927710007	ALL AMERICAN DREAM L L C	4471 DEAN MARTIN DR #3810	LAS VEGAS NV 89103			
7	13927810033	ANGUIANO HUGO & MARIA C	2004 SAN JOSE AVE	LAS VEGAS NV 89104-3832			
8	13927811047	ANSARI ABDUL R & NASEEMA F	8701 KNOLLMIST DR	LAS VEGAS NV 89147-6500			
9	13927711007	ARCADIA JESUS & IRENE	116 SYCAMORE LN	LAS VEGAS NV 89101-1937			
10	13927702008	ARIZONA CIVIL CONSTRUCTORS INC	CONRAD ROGERS GROUP INC	737 N MAIN ST	LAS VEGAS NV 89101		
11	13927711025	ARROLIGA IMELDA	907 BILTMORE DR	LAS VEGAS NV 89101-1916			
12	13927711036	AVENDANO COLUMBA	900 N 1ST ST	LAS VEGAS NV 89101-1909			
13	13927712056	AVILA JOSE M	4738 W MONTARA CIR	LAS VEGAS NV 89121-5649			
14	13927712022	AVILA-RAMIREZ AUSENCION	111 VERDY LN	LAS VEGAS NV 89101-1938			

CASE# SUP-55271

	PARCEL#	OWNER	ADDRESS1	ADDRESS2	ADDRESS3	ADDRESS4	ADDRESS5
15	13927711035	AZPEITIA EFRAIN HERNANDEZ	3009 WOODLAND AVE	LAS VEGAS NV 89106-1316			
16	13927711005	BAKER JEAN	108 SYCAMORE LN	LAS VEGAS NV 89101-1937			
17	13927811043	BASCH JANET & LEO D	5137 N TIOGA WAY	LAS VEGAS NV 89149			
18	13927711028	BAUTISTA JAIME	MARTINEZ SANDRA	24513 RAVENNA AVE	CARSON CA 90745- 6437		
19	13927711030	BEASINGER LARRY E	925 MELROSE DR	LAS VEGAS NV 89101-1932			
20	13927310094	BEHEN BECKY BINION	1900 SILVER AVE	LAS VEGAS NV 89102-2431			
21	13927705003	BEHNEN BECKY BINION	1900 SILVER AVE	LAS VEGAS NV 89102-2431			
22	13927702006	BERG IDELL	GRANT SAMUEL A TRS	%FOUR QUEENS HOTEL	202 FREMONT ST	LAS VEGAS NV 89101-5606	
23	13927712055	BJELICIC MANOJLE & VERA	8121 WYATT RD	BROADVIEW HEIGHTS OH 44147- 1343			
24	13927711027	BLAKE LARRY L & ADELAIDA PENA	900 MELROSE DR	LAS VEGAS NV 89101-1933			
25	13927710002	BONILLA FAMILY TRUST	BONILLA TEOFILO & MARIA TRS	5919 TYBALT CT	LAS VEGAS NV 89113		
26	13927710009	BONILLA SONIA	108 MOUNT VERNON CIR	LAS VEGAS NV 89101-1012			
27	13927712029	BONILLA UVALDO	725 BILTMORE DR	LAS VEGAS NV 89101-1905			
28	13927711034	BOTELLO ROSA & FRANCISCO	109 SYCAMORE LN	LAS VEGAS NV 89101-1936			

	PARCEL#	OWNER	ADDRESS1	ADDRESS2	ADDRESS3	ADDRESS4	ADDRESS5
29	13927712036	BRADLEY SVEN V TRUST	BRADLEY SVEN V TRS	5029 TROPICAL KNOLL CT	LAS VEGAS NV 89130-7240		
30	13927810007	BRISTLECONE L L C	11736 PUERTO BANUS AVE	LAS VEGAS NV 89138			
31	13927811045	BUSH MICKEY	3237 WILMOT ST	SIMI VALLEY CA 93063-2655			
32	13927404001	CALIFORNIA HOTEL & CASINO	%BOYD GAMING	6465 S RAINBOW BLVD	LAS VEGAS NV 89118-3215		
33	13927712061	CASTILLO LUIS	745 N 1ST ST	LAS VEGAS NV 89101-1927			
34	13927712063	CASTRO LUIS F & ESTELA	805 N 1ST ST	LAS VEGAS NV 89101-1928			
35	13927811032	CHAVEZ JOSE E T	1246 S WILSON DR	W COVINA CA 91791-3857			
36	13927810031	CHRISTIANSOON LOUIS D	%S DAY REALTY INC	5460 S EASTERN AVE	LAS VEGAS NV 89119-2313		
37	13934501003	CITY HALL L L C	%A DONNER	P O BOX 1570	LAS VEGAS NV 89125-1570		
38	13927401031	CITY PARKWAY V INC	%ECONOMIC & URBAN DEVELOPMENT ED	495 S MAIN ST 6TH FLR	LAS VEGAS NV 89101-6318		
39	13927812005	CIVIC CENTER PLAZA L L C	%EQUITY GROUP	8367 W FLAMINGO #201	LAS VEGAS NV 89147-4153		
40	13927812002	COBLENTZ JONATHAN	COBLENTZ THELMA CO-TRS	3207 BEL AIR DR	LAS VEGAS NV 89109-1518		
41	13927712009	CORTEZ RUBEN & ROSARIO	135 PALM LN	LAS VEGAS NV 89101-1934			
42	13927711033	CRUZ MARIA	911 MELROSE DR	LAS VEGAS NV 89101-1932			

	PARCEL#	OWNER	ADDRESS1	ADDRESS2	ADDRESS3	ADDRESS4	ADDRESS5
43	13927811054	DEBERUMEN FERMINA CORNEJO	618 BELL DR	LAS VEGAS NV 89101-2009			
44	13927810025	DESERT VALLEY GROUP L L C	452 E SILVERADO RANCH #249	LAS VEGAS NV 89183-6290			
45	13927712062	DOLAN ANNE T	801 N 1ST ST	LAS VEGAS NV 89101-1928			
46	13927811008	DUNTLEY L D	P O BOX 2422	SANTA BARBARA CA 93120-2422			
47	13927812006	E G B 1 L L C	6018 S DURANGO DR #110	LAS VEGAS NV 89113-1789			
48	13927710001	ELMOULA SHEHADY	50 E WASHINGTON #4	LAS VEGAS NV 89101-1028			
49	13927710003	ELSEY TROY VORIS	4016 YELLOW MANDARIN AVE	NORTH LAS VEGAS NV 89081-4020			
50	13927712017	ESCAMILLA LUCIO	FRANCO SUSANA	722 BILTMORE	LAS VEGAS NV 89101-1907		
51	13927711031	ESQUITE JUAN J & MARIA D	919 MELROSE DR	LAS VEGAS NV 89101-1932			
52	13927711039	ESTRADA ALMA R	ACUNA YOLANDA A	9112 ROYAL MONARCH CT	LAS VEGAS NV 89147		
53	13927706002	EWING FAMILY TRUST	EWING JAY T & REX C III TRS	1200 N A ST	LAS VEGAS NV 89106-3215		
54	13927601006	EWING INVESTMENTS	1200 A ST	LAS VEGAS NV 89106-3215			
55	13927706001	EWING JAMES L SR & BETTY LOU TRS	P O BOX 430	MOAPA NV 89025- 0430			
56	13927711041	F A T D REAL ESTATE HOLDINGS LLC	150 N LAS VEGAS BLVD #2310	LAS VEGAS NV 89101			

	PARCEL#	OWNER	ADDRESS1	ADDRESS2	ADDRESS3	ADDRESS4	ADDRESS5
57	13927810036	FORTUNE SERIES L L C I	%DESERT RLTY INC	3160 W SAHARA AVE #A-22	LAS VEGAS NV 89102		
58	13927811029	FRANKLIN STEVEN	624 N 4TH ST	LAS VEGAS NV 89101-2006			
59	13927811014	GALLEGO CAMILLE	711 BELL DR	LAS VEGAS NV 89101-2012			
60	13927711008	GALLEGOS-MARTINEZ ANTONIO	FRANCO-RAMIREZ MARTHA	120 SYCAMORE LN	LAS VEGAS NV 89101		
61	13927712024	GAYAZOVA LEYSAN	2801 VIA FLORENTINE	HENDERSON NV 89074-1403			
62	13927711037	GINES RODRIGO M & GLORIA	1765 20TH AVE	DELANO CA 93215- 1254			
63	13927710008	GLASSMAN FAMILY TRUST	GLASSMAN JEROME & GERALDENE TRS	15939 OSBORNE ST	NORTH HILLS CA 91343-3135		
64	13927811001	GOGERT DOROTHY L LIVING TRUST	P O BOX 3120 HC 33	LAS VEGAS NV 89161-9252			
65	13927702007	GONZALEZ 2002 FAMILY TRUST	GONZALEZ RAMON & IRMA TRS	15257 PROCTOR AVE	CITY OF INDUSTRY CA 91745-1019		
66	13927712011	GONZALEZ APOLINAR & NORMA A	800 BILTMORE DR	LAS VEGAS NV 89101-1913			
67	13927711009	GONZALEZ JOSE CRUZ	124 SYCAMORE LN	LAS VEGAS NV 89101-1937			
68	13927811010	GRAYSON LINDA IRA	4801 LANG N E #110	ALBUQUERQUE NM 87109-4475			
69	13927811020	GROSS THOMAS G	1407 GRIFFITH	LAS VEGAS NV 89104-3327			
70	13927811042	GUTIERREZ IVAN	725 N BRUCE ST	LAS VEGAS NV 89101-2614			

	PARCEL#	OWNER	ADDRESS1	ADDRESS2	ADDRESS3	ADDRESS4	ADDRESS5
71	13927810030	HAAG R WAYNE & DIANE C	516 N 1ST ST	LAS VEGAS NV 89101-1902			
72	13927811022	HAM MI RYUNG	P O BOX 31373	LAS VEGAS NV 89173			
73	13927811021	HARMON JEFFREY E & RHONDA FAM TR	HARMON JEFFREY E & RHONDA R TRS	3668 HILLARY ELAN CT	LAS VEGAS NV 89139-8186		
74	13927811035	HATFIELD TOM	606 TIFFANY LN	LAS VEGAS NV 89101-2022			
75	13927712060	HATTA CHIEKO	2776 CARNATION LN	HENDERSON NV 89074-2412			
76	13927712052	HEIDT HORACE JR	14155 MAGNOLIA BLVD	SHERMAN OAKS CA 91423-1112			
77	13927711014	HICKS JOSHUA	2403 WILLOWBY DR	HOUSTON TX 77008			
78	13927811006	HIDDEN MARY L REVOCABLE TRUST	HIDDEN MARY L TRS	621 BELL DR	LAS VEGAS NV 89101-2008		
79	13927810015	HUMPHREY KATHRYN	HUMPHREY JARRED	7050/7 PARKLAND BLVD	BRISBANE OLD 4000	AUSTRALIA	
80	13927710006	IBARRA-GUTIERREZ HECTOR A	102 E WASHINGTON AVE #A	LAS VEGAS NV 89101-1029			
81	13927702013	IKE GAMING INC	107 N 6TH ST 3RD FLOOR	LAS VEGAS NV 89101-4239			
82	13927710004	JACKSON DUNCAN C	105 LAS JUNTAS WAY	WALNUT CREEK CA 94597			
83	13927810009	JACKSON JOHN F	931 AZURE HEIGHTS PL	LAS VEGAS NV 89110-2890			
84	13927810008	JACKSON JOVAN	604 TALIPUT PALM PL	HENDERSON NV 89011			

CASE# SUP-55271

	PARCEL#	OWNER	ADDRESS1	ADDRESS2	ADDRESS3	ADDRESS4	ADDRESS5
85	13927711010	JIMENEZ LUCIA	5610 WINCHESTER CT	LAS VEGAS NV 89110-3827			
86	13927711029	JOENELL FAMILY TRUST	4668 BULLION CT	LAS VEGAS NV 89103-4508			
87	13927811051	KAPETAN GARY & LINDA	601 TIFFANY LN	LAS VEGAS nv 89101			
88	13927811019	KITCHUKOV TODOR	2500 S POWER RD #120	MESA AZ 85209- 6688			
89	13927704002	KRAUSE BETTY 2005 FAMILY TRUST	KRAUSE BETTY J TRS	2550 E DESERT INN RD #890	LAS VEGAS NV 89121-3611		
90	13927711003	KUESTER GREGORY & KATHRYN D	100 SYCAMORE LN	LAS VEGAS NV 89101-1937			
91	13927811009	LACA MARILEE	4928 HIGHLAND VIEW	LOS ANGELES CA 90041-2013			
92	13927712020	LARIOSIA DOUGLAS T & MINERVA N	704 BILTMORE AVE	LAS VEGAS NV 89101-1907			
93	13927602004	LAS VEGAS PAIUTE TRIBE	1 PAIUTE DR	LAS VEGAS NV 89106-3261			
94	13927301003	LAS VEGAS RESCUE MISSION	LAS VEGAS RESCUE MISSION INC	480 W BONANZA RD	LAS VEGAS NV 89106-3227		
95	13927710005	LEERAY GLORIA M	1929 8TH AVE	LOS ANGELES CA 90018-1102			
96	13927811037	LEONFORTE FRAN	400 BONANZA WAY L L C	%DESERT RLTY INC	3160 W SAHARA AVE #A-22	LAS VEGAS NV 89102	
97	13927711020	LIQUORISH NICOLLE	GOOD DARIN	1305 FRANCIS AVE	LAS VEGAS NV 89101		
98	13927708007	LODGE AMERICAN LEGION POST #8	733 VETERANS MEMORIAL DR	LAS VEGAS NV 89101-1945			

	PARCEL#	OWNER	ADDRESS1	ADDRESS2	ADDRESS3	ADDRESS4	ADDRESS5
99	13927812004	LODGE V F W	BOX 659	LAS VEGAS NV 89195-0001			
100	13927711021	LOPEZ MARVIN	RODAS MARIA	916 BILTMORE DR	LAS VEGAS NV 89101-1917		
101	13927712013	LOPEZ-GOMEZ RAFAEL	742 BILTMORE DR	LAS VEGAS NV 89101-1907			
102	13927712015	LOUDEN MARILYN K	1853 HALLWOOD DR	LAS VEGAS NV 89119-6141			
103	13927712059	LUK DIANA A	10313 POMPEI PL	LAS VEGAS NV 89144			
104	13927711038	LUK KAYE C & DIANA A	10313 POMPEI PL	LAS VEGAS NV 89144			
105	13927712042	LYNCH PATRICK S	1366 STACCATO ST	HENDERSON NV 89052-6484			
106	13927401013	M & I ASSET MANAGEMENT COMPANY	%SIGNA REALTY GROUP	601 S RANCHO DR # A-5	LAS VEGAS NV 89106-4898		
107	13927402002	M S W INC	%BOYD GAMING	6465 S RAINBO BLVD	LAS VEGAS NV 89118-3215		
108	13927707006	MAIN STREET ACQUISITIONS L L C	6070 N FEDERAL HWY	BOCA RATON FL 33487-3937			
109	13927810017	MARCUS FRED	622 BILTMORE DR	LAS VEGAS NV 89101-1911			
110	13927810018	MARCUS FRED R	622 BILTMORE DR	LAS VEGAS NV 89101-1911			
111	13927811053	MCCARTER RICHARD A	622 BELL DR	LAS VEGAS NV 89101-2009			
112	13927712026	MEAH MOHD RAFIQUE	8429 N 27TH AVE #205	PHOENIX AZ 85051- 4028			

	PARCEL#	OWNER	ADDRESS1	ADDRESS2	ADDRESS3	ADDRESS4	ADDRESS5
113	13927401023	MESQUITEWOOD L L C	10800 WOODSTREAM CT	LAS VEGAS NV 89135-1731			
114	13927712006	MILLER BETTY L	123 PALM LN	LAS VEGAS NV 89101-1934			
115	13927712012	MITCHELL GLORIA D & HARRY A	4101 AUTUMN ST	LAS VEGAS NV 89120-1453			
116	13927712045	MOORE OLIVER D	733 N 1ST ST	LAS VEGAS NV 89101			
117	13927711042	MORENO RAYMUNDO P & GLORIA D	907 N 1ST ST	LAS VEGAS NV 89101-1908			
118	13927711004	MORTON JENNIE B	LOPEZ WILLIAM & CAREN	4421 W WASHINGTON AVE	LAS VEGAS NV 89107-2056		
119	13927811044	MORTON JENNIE B FAMILY TRUST	MORTON JENNIE B TRS	305 BONANZA WY	LAS VEGAS NV 89101-2014		
120	13927711011	MUEHLHAUSEN ROBERT & GWENDOLYN F	13808 MURPHY LN	OAK RUN CA 96069- 9626			
121	13927811024	MUNOZ JUAN R & VIRGINIA P	405 S MCDOWELL AVE	LOS ANGELES CA 90022			
122	13927712014	MURO GISSELL	742 BILTMORE DR	LAS VEGAS NV 89101-1907			
123	13927811003	NEVER LAND PROPERTIES L L C	609 BELL DR	LAS VEGAS NV 89101			
124	13927712023	NICHOLS OBED D LIVING TRUST	NICHOLS OBED D TRS	701 BILTMORE DR	LAS VEGAS NV 89101-1905		
125	13927707003	NORTH MAIN L L C	K GRAGSON	2001 SLOW WIND ST	LAS VEGAS NV 89134-6693		
126	13927712043	NUGENT-BUSH MICHAEL JOHN	3237 WILMONT ST	SIMI VALLEY ca 93063			

CASE# SUP-55271

	PARCEL#	OWNER	ADDRESS1	ADDRESS2	ADDRESS3	ADDRESS4	ADDRESS5
127	13927712032	OCHOA IGNACIO & RIGOBERTA	120 PALM LN	LAS VEGAS NV 89101-1935			
128	13927711017	OKAMOTO RAYMOND REVOCABLE TRUST	900 BILTMORE DR	LAS VEGAS NV 89101-1917			
129	13927410011	P H G S A L L C	100 N CITY PKWY #1700	LAS VEGAS NV 89106-4614			
130	13927702003	PACIFIC ENTERPRISES I L L C	827 N MAIN ST	LAS VEGAS NV 89101-1923			
131	13927410013	PARKWAY CENTER L L C	100 N CITY PKWY #140	LAS VEGAS NV 89106			
132	13927811031	PATEL AVKASH	1195 BURNHAM DR	SAN JOSE CA 95132-2710			
133	13934111003	PECCOLE WILLIAM P	COHOON CHRISTOPHER	547 LONG MEADOW LN	LINCOLN CA 94548		
134	13934111004	PECCOLI JOHN P	PECCOLE WILLIAM P & ROBERTA TRS	8689 W CHARLESTON BLVD #109	LAS VEGAS NV 89117-5485		
135	13927712038	PERALES CASIMIRO FAMILY TRUST	PERALES CASIMIRO TRS	728 N 1ST ST	LAS VEGAS NV 89101		
136	13927401016	PERALTA FAMILY L P	1130 CASHMAN DR	LAS VEGAS NV 89102-1912			
137	13927712001	PEREZ JOSE A	101 PALM LN	LAS VEGAS NV 89101-1934			
138	13927704001	PORTER WOODROW P	709 N MAIN ST	LAS VEGAS NV 89101-1918			
139	13927810005	POWERS ROBERT	P O BOX 19425	JEAN NV 89019- 9425			
140	13927810011	PROVONSHA KAREN RAE	607 BILTMORE DR	LAS VEGAS NV 89101-1910			

	PARCEL#	OWNER	ADDRESS1	ADDRESS2	ADDRESS3	ADDRESS4	ADDRESS5
141	13927401033	QUALITY COMMERCIAL MAINTENANCE	1800 INDUSTRIAL RD #104C	LAS VEGAS NV 89102			
142	13927811005	RANDRIVER INC	7395 VALHALLA LN	LAS VEGAS NV 89123			
143	13927712035	RED LIST HOMES L L C	770 E MAIN ST #501	LEHI UT 84043			
144	13927704004	REED SARA ELIZABETH & DEREK R	REED TREVER EDGAR	4674 LINDA AVE	LAS VEGAS NV 89121-7114		
145	13927810013	REGUERO RAFAEL	615 BILTMORE DR	LAS VEGAS NV 89101-1910			
146	13927810019	REGUERO RAFAEL L	615 BILTMORE DR	LAS VEGAS NV 89101-1910			
147	13927810016	REYES EVELYN	ALARCON MIQUEL	630 BILTMORE DR	LAS VEGAS NV 89101-1911		
148	13927310089	RIEGER 1982 REVOCABLE TRUST	RIEGER RONALD H & ROSE M CO-TRS	38 PRINCEVILLE LN	LAS VEGAS NV 89113-1345		
149	13927712039	RIVERA APOLINAR GONZALEZ	800 BILTMORE DR	LAS VEGAS NV 89101-1913			
150	13927811002	RIVERA NESTOR H SR & CORAZON M	607 BELL DR	LAS VEGAS NV 89101-2008			
151	13927711015	RIZZO SALVATORE & SHERMAN FAM TR	2570 LINCOLN RD	LAS VEGAS NV 89115-4316			
152	13927711032	ROBERTSON BARBARA D	915 MELROSE DR	LAS VEGAS NV 89101-1932			
153	13927811030	RODRIGUEZ A R & P D JT REV TR	RODRIGUEZ ABRAHAM & PEACHES TRS	2325 BOULDER LN	BELOIT WI 53511		
154	13927811018	RODRIGUEZ A R & P JT REV TR AGMT	2325 BOULDER L A	BELOIT WI 53511- 6709			

CASE# SUP-55271

	PARCEL#	OWNER	ADDRESS1	ADDRESS2	ADDRESS3	ADDRESS4	ADDRESS5
155	13927811036	RODRIGUEZ ABRAHAM & P JT REV TR	RODRIGUEZ ABRAHAM & PEACHES TRS	2325 BOULDER LN	BELOIT WI 53511- 6709		
156	13927811052	RODRIGUEZ ABRAHAM R & P D REV TR	RODRIGUEZ ABRAHAM & PEACHES TRS	2325 BOULDER LN	BELOIT WI 53511- 6709		
157	13927711012	RODRIGUEZ DAVID RIVIERA	808 BILTMORE DR	LAS VEGAS NV 89101-1913			
158	13927710011	RODRIGUEZ JAIME	2422 CEDAR AVE	LONG BEACH ca 90806			
159	13927811013	RODRIGUEZ ROGELIO	DE RODRIGUEZ MARIA LUISA IBARRA	705 BELL DR	LAS VEGAS NV 89101-2012		
160	13927701002	ROMANIKA L L C	798 A ST	LAS VEGAS NV 89106-3200			
161	13927811038	ROMANO DANIEL ALLEN	733 N 10TH ST	LAS VEGAS NV 89101-2503			
162	13927712027	ROMERO NARCISO JACUINDE	JACUINDE IRENE G	717 BILTMORE DR	LAS VEGAS NV 89101-1905		
163	13927712005	RONNOW DAN	117 PALM LN	LAS VEGAS NV 89101-1934			
164	13927811046	ROXLEX SERIES L L C I	P O BOX 570460	LAS VEGAS NV 89147			
165	13927810014	RUGGEROLI HARRY J & MAXINE	RUGGEROLI BARBARA P TRS	2501 DRIFTWOOD DR	LAS VEGAS NV 89107-2322		
166	13927711022	RUMFORD W RICHARD & JUDITH	720 N 1ST ST	LAS VEGAS NV 89101-1906			
167	13927707005	SACKLEY FAMILY TRUST	SACKLEY STUART TRS	700 N MAIN ST	LAS VEGAS NV 89101		
168	13927712044	SANCHEZ JULIAN	704 N 1ST ST	LAS VEGAS NV 89101-1906			

CASE# SUP-55271

	PARCEL#	OWNER	ADDRESS1	ADDRESS2	ADDRESS3	ADDRESS4	ADDRESS5
169	13927811026	SAVILLE ROBERT S & GUADALUPE Y	159 SAGEMONT CIR	PARACHUTE CO 81635-9509			
170	13927811011	SCAGNELLI STELLA K & JIMMY	%S LETOURNEAU	3708 MIGUELS LN	LAS VEGAS NV 89120-2546		
171	13927711002	SCHNEIDER DEVELOPMENT L P	%S SCHNEIDER	12 QUAIL RUN RD	HENDERSON NV 89014-2146		
172	13927708004	SCHOOL BOARD OF TRUSTEES	4190 MCLEOD DR 2ND FLR	LAS VEGAS NV 89121			
173	13927712025	SECRETARY HOUSING & URBAN DEV	DEVAL CORP	WESTPOINT 1 #300	1255 CORPORATE DR	IRVING TX 75038	
174	13927711026	SEDILLO GINO	901 BILTMORE DR	LAS VEGAS NV 89101-1916			
175	13927711016	SEVON L L C	4391 FERNBROOK RD	LAS VEGAS NV 89103-4226			
176	13927712048	SMADY L L C	17644 RANCHO ST	ENCINO CA 91316			
177	13927811033	SOLORZANO-JARAMILLO ROGELIO	618 TIFFANY LN	LAS VEGAS NV 89101-2022			
178	13927811028	SOURLA-SEARLES CHRYSOULA A	7854 PRIZE DR	LAS VEGAS NV 89117			
179	13927603024	SPINSIG ENTERPRISES L L C	1000 N MAIN ST	LAS VEGAS NV 89101-1011			
180	13927811004	SREEWAROM WANIDA ETAL	SREEWAROM WANIDA	8782 GRANT CIR	BUENA PARK CA 90620-3811		
181	13927810021	STARCHER FAMILY TRUST	STARCHER JAMEY & ALPHA C TRS	346 E SHORELINE DR	LONG BEACH CA 89115		
182	13927803007	STATE OF NEVADA	%DIV OF STATE LANDS	901 S STEWART ST #5003	CARSON CITY NV 89701		

	PARCEL#	OWNER	ADDRESS1	ADDRESS2	ADDRESS3	ADDRESS4	ADDRESS5
183	13927211051	STATE OF NEVADA DIV OF LANDS	NEVADA EMPLOYMENT SECURITY LEASE	%DIV OF STATE LANDS	901 S STEWART ST #5003	CARSON CITY NV 89701	
184	13927402004	STATE OF NEVADA TRANS LEASOR	M S W INC LEASE	%BOYD GAMING TAX DEPT	6465 S RAINBOW BLVD	LAS VEGAS NV 89118-3215	
185	13927212002	STATE OF NEVADA TRANSPORTATION	NEVADA EMPLOYMENT SECURITY LEASE	NEVADA EMPLOYMENT SECURITY LEASE	901 S STEWART ST #5003	CARSON CITY NV 897010000	
186	13927711040	STEVENS RONALD A	915 N 1ST ST	LAS VEGAS NV 89101-1908			
187	13927712037	STEVENSON YULONDA	732 N 1ST ST	LAS VEGAS NV 89101-1906			
188	13927712007	STEVES R US SERIES I	2394 MILLCROFT AVE	HENDERSON NV 89074-5947			
189	13927705001	STUGOTS L L C	D J LIVING TRUST	%D JARCHOW	901 S FIRST ST	LAS VEGAS NV 89101-6414	
190	13927310093	SUMMIT ONE NETWORK INC	%FINANCE DEPT	129 E FREMONT ST	LAS VEGAS NV 89101		
191	13927712004	TAPIA AGUSTIN	113 PALM LN	LAS VEGAS NV 89101-1934			
192	13927810010	TAYLOR ELANDERS & LUCENA F	601 BILTMORE DR	LAS VEGAS NV 89101-1910			
193	13927712034	THOMAS DORIS M	110 PALM LN	LAS VEGAS NV 89101-1935			
194	13927810012	THOMPSON ERIC & LYNDA	HACKETT KAREN ERMERSON	%K HACKETT	525 E SEASIDE WAY #304	LONG BEACH CA 90802	
195	13927810032	TINNEY RICHARD M & CAROL L	513 N 1ST ST	LAS VEGAS NV 89101-1902			
196	13927711018	TORRES CARLA ELISSE	QUAYLE JEFF	1366 CAYETANO DR	NAPA CA 94559		

	PARCEL#	OWNER	ADDRESS1	ADDRESS2	ADDRESS3	ADDRESS4	ADDRESS5
197	13927811015	TRUSTEE CLARK COUNTY TREASURER	%SHEBAH TRUST & SHEBAH YHIEL TRS	7828 CORONADO ISLAND ST	LAS VEGAS NV 89139-6299		
198	13927310098	U S F PROPCO II L L C	%US FOODSERVICE ~ %TAX DEPT	P O BOX 29291	PHOENIX AZ 85038- 9291		
199	13927712016	ULLOA MOISES	730 BILTMORE DR	LAS VEGAS NV 89101-1907			
200	13927401030	UNION PACIFIC RAILROAD COMPANY	%PPTY TAX	1400 DOUGLAS	STOP 1640	OMAHA NE 68179- 0001	
201	13927710010	VALDOVINOS HONORIO	GALEAN RAUL	112 MOUNT VERNON CIR	LAS VEGAS NV 89101-1016		
202	13927706003	VASCONCELLOS PRISCILLA A	P O BOX 1658	LAS VEGAS NV 89125-1658			
203	13927711043	VASCONCELLOS PRISCILLA A RAMOS	P O BOX 1658	LAS VEGAS NV 89125-1658			
204	13927712033	VICENTE CLAUDIO D & MARLENE Z	451 DELAMERE WAY	LAS VEGAS NV 89123			
205	13927712010	VILLAGRANA JULIO & ESTELA	804 BILTMORE DR	LAS VEGAS NV 89101-1913			
206	13927712002	VINCENT KOREN	2153 BRIDLEWOOD DR	LAS VEGAS NV 89119-6122			
207	13934111014	VINTAGE VEGAS GAMING INC	%R SZEPELAK	128 E FREMONT ST	LAS VEGAS NV 89101-5604		
208	13927712003	VINTHER MICHAEL A & ANGELA	109 PALM LN	LAS VEGAS NV 89101-1934			
209	13927712008	WARE ALAN M TRUST	131 PALM LN	LAS VEGAS NV 89101-1934			
210	13927712041	WEBSTER LEASING CO	P O BOX 19301	LAS VEGAS NV 89132-0301			

CASE# SUP-55271

	PARCEL#	OWNER	ADDRESS1	ADDRESS2	ADDRESS3	ADDRESS4	ADDRESS5
211	13927712064	WEBSTER LEASING COMPANY	%J CRUMLEY	P O BOX 19301	LAS VEGAS NV 89132-0301		
212	13927712066	WILLIAMS KENNETH K	130 PALM LN	LAS VEGAS NV 89101-1935			
213	13927712028	WISHING WELL PROPERTIES L L C	7566 SPANISH BAY DR	LAS VEGAS NV 89113			
214	13927810006	WOLF PAC FAMILY TRUST	AUSTIN LINDA LOU TRS	P O BOX 19425	JEAN NV 89019- 9425		
215	13927811055	WOODBRIIDGE JAMES A	1215 S FORT APACHE #220	LAS VEGAS NV 89117-5491			
216	13927401012	WORTHEN RONALD W & SHERRI K	125 WORTHEN CIR	LAS VEGAS NV 89145-4017			
217	13927712019	YANAY AMIR	5780 SW 25TH ST #8	HOLLYWOOD FL 33023			
218	13927811034	YIMLAMAI BOONCHAI & SOMLEE	YIMLAMAI VARITH	2203 W ALMOND AVE	ORANGE CA 92868		
219	13927811017	YIMLAMAI DEAN	KONNIKOV YELIZAVET	2203 W ALMOND AVE	ORANGE CA 92868		
220	13927712018	YUAN ACE G W	YUAN SHIH KUAN REVOCABLE LIV TR	712 BILTMORE DR	LAS VEGAS NV 89101-1907		
221	13927712021	ZHANG MICHAEL Y H TRUST	8273 KIMBERLY DIAMOND ST	LAS VEGAS NV 89139			