

S. ✓

City of Las Vegas  
Department of Planning  
Development Services Center  
333 North Rancho Drive, 3<sup>rd</sup> Floor  
Las Vegas, Nevada 89106

PRSR  
FIRST CLASS MAIL  
U.S. Postage  
**PAID**  
Las Vegas, NV  
Permit No. 1630

**Return Service Requested**  
**Official Notice of Public Hearing**

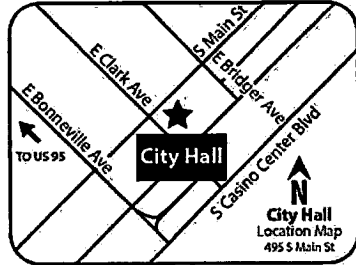

If you wish to file your protest or support on this request, check the appropriate box below and return this card in an envelope with postage to the Department of Planning at the address listed above, fax this side of this card to (702) 464-7499 or make your comments at [www.lasvegasnevada.gov](http://www.lasvegasnevada.gov). If you would like to contact your Council Representative, please call (702) 229-6405.

I SUPPORT  
this Request

I OPPOSE  
this Request

Please use available blank space on card for your comments.

**VAR-66428 [PRJ-66176]**

Planning Commission Meeting of 10/11/2016

11 ✓

## Application Information

**VAR-66428 - VARIANCE - PUBLIC HEARING - APPLICANT/OWNER: GARRY ORANGE** - For possible action on a request for a Variance TO ALLOW A SEVEN-FOOT CORNER SIDE YARD SETBACK WHERE 15 FEET IS REQUIRED FOR A PROPOSED HOME ADDITION located at 5920 Ivy Trellis Street (APN 125-27-710-060), R-1 (Single Family Residential) Zone, Ward 6 (Ross) [PRJ-66176].

## Application Location

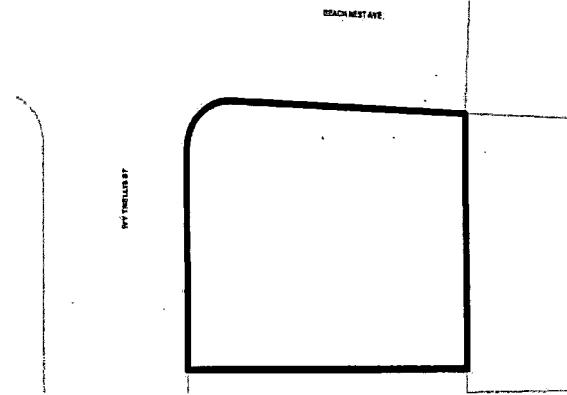

The proposed project may not pertain to the entire highlighted project site.

## Public Hearing Information

**Meeting:** Planning Commission  
**Date:** *October 11, 2016*  
**Time:** 9:00 A.M.  
**Location:** City Council Chambers  
495 South Main Street, 2<sup>nd</sup> Floor  
Las Vegas, Nevada 89101

Any and all interested persons may appear before the City Planning Commission either in person or by representative and object to or express approval of this request; or may, prior to this meeting, file a written objection thereto or approval thereof with the Department of Planning, Development Services Center, 333 North Rancho Drive, 3<sup>rd</sup> Floor, Las Vegas, Nevada 89106. Final Action on General Plan Amendments and Rezonings will be determined by the City Council. Other public hearing items may be deemed Final Action by the Planning Commission or forwarded to the City Council. The date of the City Council meeting, if applicable, will be announced at the Planning Commission meeting after the discussion of the item. For further information, including the full staff report, please call (702) 229-6301 (TTY 7-1-1) or go to <http://www.lasvegasnevada.gov>.

5. ✓

**Report of All Selected Parcels**

Case Number:

VAR-66428

Printed On: Mon: September 12, 2016

<u>Owner</u>	<u>Address</u>	<u>Parcel Numbe</u>
2015-1 I H 2 BORROWER L P	901 MAIN ST #4700 DALLAS TX 75202	12527715025
2015-3 I H 2 BORROWER L P	901 MAIN ST #4700 DALLAS TX 75202	12526310037
2015-3 I H 2 BORROWER L P	901 MAIN ST #4700 DALLAS TX 75202	12527612010
2015-3 I H 2 BORROWER L P	901 MAIN ST #4700 DALLAS TX 75202	12527816016
ABBATTE BRADLEY W	6013 IRON KETTLE ST LAS VEGAS NV 89130-1064	12527611028
ACCOLA ANTHONY G & GAIL	5817 KANE HOLLY ST LAS VEGAS NV 89130-4943	12527716020
AINO X 2	103 FOULK RD #900 WILMINGTON DE 19803	12527714002
ALCAZAR ISIDORO	6033 RIO VISTA ST LAS VEGAS NV 89130	12527610058
ALDINGER RONALD W & MARY A	6801 SILVER CHISEL AVE LAS VEGAS NV 89130-1066	12527611035
ALDINGER RONALD W & MARY A	6009 GOLDEN SADDLE ST LAS VEGAS NV 89130-7914	12527612040
AMBIANCE ESTATES HOMEOWNERS ASSN	375 N STEPHANIE #911 HENDERSON NV 89014-8700	12526310050
ANDERSEN-DESAUTELS LISA LIV TR	5809 KANE HOLLY ST LAS VEGAS NV 89130-4943	12527714008
ANGUIANO AIDEE	6000 IRON KETTLE ST LAS VEGAS NV 89130-1062	12527611014
ANSARY MUSKA	7004 PALATIAL AVE LAS VEGAS NV 89130-4917	12527715015
APOLLO DEVELOPMENTS L L C	5000 W OAKEY BLVD #A2 LAS VEGAS NV 89146	12527716042
ARONSTEIN HOWARD	6801 HAVEN HOLLOW AVE LAS VEGAS NV 89130-1187	12527714018
ASHWORTH MICHELLE P & IAN	6904 CLOUDY RIDGE CT LAS VEGAS NV 89130-1173	12527710014
BACSKAI BERT J & GLORIA REV TR	BACSKAI BERT J & GLORIA J CO-TRS 5820 IVY TRELIS ST LAS VEGAS NV 89130-4941	12527710054
BAERGA JULIA	6912 BEACH NEST AVE LAS VEGAS NV 89130-1172	12527710004
BANFIELDS PROPERTY L L C	10909 EVERGREEN TERR SW LAKEWOOD WA 98498-6703	12527612032
BARNARD HEATH	6794 WEEPING FIG CT LAS VEGAS NV 89130-5007	12527816014
BARRETT FAMILY TRUST	BARRETT RONALD F & JUDITH F TRS 6913 CLOUDY RIDGE CT LAS VEGAS NV 89130-1173	12527710017
BARTON ROBERT L & FRANCES M	7065 W ANN RD #130-680 LAS VEGAS NV 89130-3865	12526310029
BELLISARIO HENRY J	5348 HURON RD LYNDHURST OH 44124-2810	12527710053
BOGDANOVICH NICK & DANIELLE	6113 BLOWING BELLOWS ST LAS VEGAS NV 89130-1091	12527612026
BOOTHE JON A REVOCABLE LIVING TR	BOOTHE JON A TRS 6805 SILVER CHISEL AVE LAS VEGAS NV 89130-1066	12527611034
BOYD DOUGLAS K	1050 WOODWARD AVE DETROIT MI 48226	12527611037
BRADFORD PATRICK A & CECILIA M	6809 HAVEN HOLLOW AVE LAS VEGAS NV 89130-1187	12527714020
BRANDHAGEN FAMILY TRUST	BRANDHAGEN ORVIN L & DONNA C TRS 7260 W AZURE DRD #140-39 LAS VEGAS NV 89130	12527716036
BREWER ELLA REVOCABLE LIV TR	BREWER ELLA TRS 6817 GREENERY CT LAS VEGAS NV 89130-1184	12527710039
BURNS JASON W	7001 GRANDIOSE CT LAS VEGAS NV 89130	12527713014
BUSTAMANTE GEORGE	262 S SIERRA BONITA AVE PASADENA CA 91106-3531	12527611020

11 ✓

**Report of All Selected Parcels****Case Number:**

VAR-66428

**Printed On:** Mon: September 12, 2016

<u>Owner</u>	<u>Address</u>	<u>Parcel Number</u>
C A H 2014-1 BORROWER L L C	8665 E HARTFORD DR #200 SCOTTSDALE AZ 85255	12527716015
C A H 2014-2 BORROWER L L C	8665 E HARTFORD DR #200 SCOTTSDALE AZ 85255	12527713010
C A H 2015-1 BORROWER L L C	8665 E HARTFORD DR #200 SCOTTSDALE AZ 85255	12527714022
C B F LIVING TRUST	FLANIGAN CORA B & RACHEL E TRS 6067 RIO VISTA ST LAS VEGAS NV 89130-1003	12527610059
C B F LIVING TRUST	FLANIGAN CORA B & RACHEL E TRS 6067 RIO VISTA ST LAS VEGAS NV 89130-1003	12527610060
CANTRELL WILLIAM T & KATHRYN L	5924 KANE HOLLY ST LAS VEGAS NV 89130-4950	12527716011
CARRELL KYLE R & TARA C	6780 BEACH NEST AVE LAS VEGAS NV 89130-1112	12527716010
CARTER RUTH	5816 EMPEROR WAY LAS VEGAS NV 89130-4904	12527713007
CARUSO JOHN	6816 CLOUDY RIDGE CT LAS VEGAS NV 89130-1173	12527710011
CATON FREDERICK T & BARBARA	6812 HAVEN HOLLOW AVE LAS VEGAS NV 89130-1186	12527710041
CHANG DANIEL	5812 EMPEROR WAY LAS VEGAS NV 89130-4904	12527713006
CHAPMAN RHONDA ANN	5804 IVY TRELIS ST LAS VEGAS NV 89130-4941	12527710050
CHAVEZ ADAM L	5904 KANE HOLLY ST LAS VEGAS NV 89130-4950	12527716016
CLARK JOSEPH P & MYRA Y	749 MAIDENCANE DR LEXINGTON KY 40509-9049	12527612027
CLEMENTE VITO & TANA MARIA	5943 MUSKETEER LN LAS VEGAS NV 89130-1249	12526310001
CODAY JEFFREY J	6016 COTTONTAIL ST LAS VEGAS NV 89130	12527714003
COLEMANSMITH GARY L	3021 N E 72ND DR #9-152 VANCOUVER WA 98661-7300	12527716041
CORPUZ FRANKLIN B & GLORIA A	6820 BEACH NEST AVE LAS VEGAS NV 89130-1171	12527716001
CRAIG FAMILY REVOCABLE LIVING TR	CRAIG STEVEN GLEN & ANN EILEEN T 5716 WANDERING IVY ST LAS VEGAS NV 89130-4910	12527714026
CRANDALL JAMES & CLAUDIA FAM TR	CRANDALL JAMES P & CLAUDIA TRS 6045 N SERENE DR LAS VEGAS NV 89130-1401	12526201014
CUSSICK FAMILY 2008 TRUST	CUSSICK LINDA S & PAUL S TRS 6913 GREENERY CT LAS VEGAS NV 89130-1185	12527710033
DANIELS FAMILY TRUST	DANIELS LEE E & ISABELL C TRS 5946 RIO VISTA ST LAS VEGAS NV 89130-1103	12527702004
DANIELS FAMILY TRUST	DANIELS LEE E & ISABELL C TRS 5946 RIO VISTA ST LAS VEGAS NV 89130-1103	12527702003
DELAROCHE ALOYCHA LI TRUST	6100 IRON KETTLE ST LAS VEGAS NV 89130-1065	12527611018
DENNIS MARVIN DEAN & MARIE	6808 HAVEN HOLLOW AVE LAS VEGAS NV 89130-1186	12527710040
DONOHUE SIEGLINDE	6101 IRON KETTLE ST LAS VEGAS NV 89130-1065	12527611027
DOWE JOHN K	5820 GRAND HERITAGE ST LAS VEGAS NV 89130-4938	12527716035
DUNFORD DANIEL T & LISA M	6060 N RAINBOW BLVD LAS VEGAS NV 89130-1400	12526201013
DYKES DOROTHY M TRUST	DYKES DOROTHY M TRS 5917 GRAND HERITAGE ST LAS VEGAS NV 89130-4953	12527716045
EGUCHI LAURA C	EGUCHI LAURA C TRS 5804 GRAND HERITAGE ST LAS VEGAS NV 89130-4938	12527714005
EICKOFF RANDY L	P O BOX 750474 LAS VEGAS NV 89136-0474	12527710027
ELLIOTT LANA K	6912 CLOUDY RIDGE CT LAS VEGAS NV 89130-1173	12527710016

**Report of All Selected Parcels****Case Number:**

VAR-66428

**Printed On:** Mon: September 12, 2016

<u>Owner</u>	<u>Address</u>	<u>Parcel Number</u>
ERASMUS WILHELMINA	6821 CLOUDY RIDGE CT LAS VEGAS NV 89130-1173	12527710021
ESTES RICHARD SR & J REV LIV TR	ESTES RICHARD L SR TRS 5916 GRAND HERITAGE ST LAS VEGAS NV 89130-4952	12527716030
EVANS ROBERT D & ALICIA C	6001 GOLDEN SADDLE ST LAS VEGAS NV 89130-7914	12527612038
EVENSON SUSAN R	5804 KANE HOLLY ST LAS VEGAS NV 89130-4942	12527714013
FAIR DAVID L & SHIRLEY S	6901 BEACH NEST AVE LAS VEGAS NV 89130-1172	12527710008
FARRIS TRUST	FARRIS ROBERT H & ANGELA M TRS 5721 WANDERING IVY ST LAS VEGAS NV 89130-4911	12527714028
FEI EDDIJOHN	19174 DEHAVILLAND DR SARATOGA ca 95070	12526310043
FELDMAN LIVING TRUST	6901 GREENERY CT LAS VEGAS NV 89130-1185	12527710036
FISHEL AUBRA JAMES & KAREN J	5900 IVY TRELIS ST LAS VEGAS NV 89130-1198	12527710055
FITZMAURICE FRANK & ARCHIEL N	6747 BASTILLE AVE LAS VEGAS NV 89130-1210	12526310047
FORD THOMAS J	6000 GOLDEN SADDLE ST LAS VEGAS NV 89130-7914	12527612014
FORGEY GORDON A JR & NORA M	6100 BLOWING BELLOWS ST LAS VEGAS NV 89130-1091	12527612028
FOSTER SUZANNE YVONNE	6821 GREENERY CT LAS VEGAS NV 89130-1184	12527710038
FRIEDMAN SCOTT	FRIEDMAN JOEL & DIANA 6786 WEEPING FIG CT LAS VEGAS NV 89130	12527816013
FUNK DOLORESA	P O BOX 60355 LAS VEGAS NV 89160-0355	12527702001
GALICIA THOMAS C & CONCHITA B	12330 NELSON RD MOORPARK CA 93021-8774	12527715023
GARCIA JORGE L & CECILIA	6008 LONESOME CACTUS ST LAS VEGAS NV 89130-1050	12527611038
GLOVER STACY	6001 BLOWING BELLOWS ST LAS VEGAS NV 89130-1089	12527612015
GONZALEZ HECTOR G & NANCY	6900 CLOUDY RIDGE CT LAS VEGAS NV 89130	12527710013
GOODMAN PATRICIA ANN	7005 GRANDIOSE CT LAS VEGAS NV 89130-1199	12527713013
GORCH FAMILY TRUST	GORCH CHRISTOPHER R TRS 6080 N RAINBOW BLVD LAS VEGAS NV 89130-1400	12526201012
GOSSE PATRICK M & JENNIFER S	6008 GOLDEN SADDLE ST LAS VEGAS NV 89130-7914	12527612012
GRIFFITH LAWRENCE & VICKY TRUST	PIKE-GRIFFITH VICKY TRS 6008 IRON KETTLE ST LAS VEGAS NV 89130-1062	12527611015
GUERRERO MANUEL & TONI	5901 KANE HOLLY ST LAS VEGAS NV 89130-4951	12527716023
HALL DEREK B & MELANIE J	6816 BEACH NEST AVE LAS VEGAS NV 89130-1169	12527716002
HALL RODNEY W & VICTORIA L	7012 PALATIAL AVE LAS VEGAS NV 89130-4917	12527715014
HAMAWI BURKAN & MEGAN O	5805 KANE HOLLY ST LAS VEGAS NV 89130	12527714007
HARSCH JOHN R & ELEANORE J	5912 GRAND HERITAGE ST LAS VEGAS NV 89130-4952	12527716031
HART FAMILY TRUST	HART BRET E & RITA LEE TRS 5720 WANDERING IVY ST LAS VEGAS NV 89130-4910	12527714025
HARTNEY JOSEPH A	6105 BLOWING BELLOWS ST LAS VEGAS NV 89130-1091	12527612020
HERNANDEZ JOSE A LABANINO	GARCIA ARGELINA RAMOS 7008 GRANDIOSE CT LAS VEGAS NV 89130-1199	12527713011
HERTZEL RICHARD D & CONSTANCE A	5713 CRYSTAL LILLY CT LAS VEGAS NV 89130-4902	12527814018

**Report of All Selected Parcels****Case Number:**

VAR-66428

**Printed On:** Mon: September 12, 2016

<b>Owner</b>	<b>Address</b>	<b>Parcel Number</b>
HIGHLAND GROVE HOMEOWNERS ASSN	630 TRACE CENTER DR #100 LAS VEGAS NV 89119	12527816037
HINDERS STEVEN L & FUMIKO	6779 BASTILLE AVE LAS VEGAS NV 89130-1210	12526310049
HOGAN DENNIS L	6105 IRON KETTLE ST LAS VEGAS NV 89130-1065	12527611026
HOLLAND JEFFERY D	5912 EMPEROR WY LAS VEGAS NV 89130-4905	12527715017
IHNEN FAMILY TRUST	IHNEN DANIEL E & LINDA S TRS 6817 CLOUDY RIDGE CT LAS VEGAS NV 89130-1173	12527710022
JACKSON DAN & JULIE	5916 IVY TRELIS ST LAS VEGAS NV 89130	12527710059
JACOT DOUGLAS D & LEAH M	6005 LONESOME CACTUS ST LAS VEGAS NV 89130-1051	12527611013
JANKER JOSEPH R & JEANNIE L	7000 BALLROOM CT LAS VEGAS NV 89130-4913	12527715026
JOHNSON BETTY L	5801 GRAND HERITAGE ST LAS VEGAS NV 89130-4939	12527714001
JOHNSON JEFF & SHERYL RAE	6909 BEACH NEST AVE LAS VEGAS NV 89130-1172	12527710006
JONAS MICHAEL	6824 GREENERY CT LAS VEGAS NV 89130-1183	12527710025
KENEMAN H L & J REV LIV TR AGMT	KENEMAN HARRY & JOSEPHINE CO-TRS 5905 KANE HOLLY ST LAS VEGAS NV 89130-4951	12527716024
KEOSONGKET CHAIYAPHANT	KRISHNAKIJ WANALEE 5920 GRAND HERITAGE ST LAS VEGAS NV 89130-4952	12527716029
KING JOHN E & DAWN M	6013 GOLDEN SADDLE ST LAS VEGAS NV 89130-7914	12527612041
KLAREN JASON T & JODY L	6780 BASTILLE AVE LAS VEGAS NV 89130	12526310031
KLIPPERT BRIAN A & MELISSA S	5904 EMPEROR WAY LAS VEGAS NV 89130-4905	12527715019
KOPLINER RICHARD E & SINGEL ISAB	KOPLINER RICHARD E TRS 5900 KANE HOLLY ST LAS VEGAS NV 89130-4950	12527716017
LARRICK DONALD E JR	18654 W CAPASTRANO AVE GOODYEAR AZ 85338	12527716018
LARY MICHAEL P & CECILIA L	5808 KANE HOLLY ST LAS VEGAS NV 89130-4942	12527714012
LATNER BRUCE & KAREN	5812 GRAND HERITAGE ST LAS VEGAS NV 89130-4938	12527716037
LAUB ELMER B & CICELIA K	6781 HAVEN HOLLOW AVE LAS VEGAS NV 89130-4912	12527714015
LESSARY FRANCIS K & URSULA	6764 BASTILLE AVE LAS VEGAS NV 89130-1210	12526310030
LINDER JEFFREY J	AMADON-LINDER LINDA M 6009 IRON KETTLE ST LAS VEGAS NV 89130	12527611029
LIONE SALVATORE JR & CHRISTINA L	6101 BLOWING BELLOWS ST LAS VEGAS NV 89130-1091	12527612019
LOMBARDI RICK A & DIANA E	6780 TROPICAL PKWY LAS VEGAS NV 89130-1206	12526201018
LONG C L REVOCABLE TRUST	5800 GRAND HERITAGE ST LAS VEGAS NV 89130-4938	12527714006
LOPEZ SILVESTRE & NORMA	6825 GREENERY CT LAS VEGAS NV 89130-1184	12527710037
LOPEZ VALENTIN	6905 CLOUDY RIDGE CT LAS VEGAS NV 89130-1173	12527710019
LOPEZLEON CARLOS ANTONIO	6905 GREENERY CT LAS VEGAS NV 89130	12527710035
LOVE SANDRA L	6802 WEEPING FIG CT LAS VEGAS NV 89130-5007	12527816015
LOVELOCK WILLIAM V	6004 BLOWING BELLOWS ST LAS VEGAS NV 89130-1088	12527612031
MADONNA ROXANNE & WILLIAM R	6909 GREENERY CT LAS VEGAS NV 89130-1185	12527710034

**Report of All Selected Parcels****Case Number:**

VAR-66428

**Printed On:** Mon: September 12, 2016

<b>Owner</b>	<b>Address</b>	<b>Parcel Number</b>
MAJOR LAUREN	GREENBAUM SHEILA 5812 IVY TRELIS ST LAS VEGAS NV 89130	12527710052
MARCU BRIAN M	6917 COPPER KETTLE AVE LAS VEGAS NV 89130-7932	12527612037
MARKLE DIANE L & HERBERT E	5800 KANE HOLLY ST LAS VEGAS NV 89130-4942	12527714014
MAROTTA RUSSELL & ANITA	5929 MUSKETEER LN LAS VEGAS NV 89130-1249	12526310002
MARTINEZ DANIEL R	6908 HAVEN HOLLOW AVE LAS VEGAS NV 89130-1188	12527710045
MARTINEZ-GODINEZ CARLOS A	GARCIA MARIA C 6012 GOLDEN SADDLE ST LAS VEGAS NV 89130-7914	12527612011
MATTHEWS CHRISTOPHER T	5808 EMPEROR WY LAS VEGAS NV 89130-4904	12527713005
MATTHEWS MARK A & VICKI S	6777 ALPINE BROOKS AVE LAS VEGAS NV 89130-1254	12526310005
MATTOS JOHN L SR & CAROL A	6900 GREENERY CT LAS VEGAS NV 89130-1185	12527710026
MCCOY TRUST	MCCOY DAVID A & JULIANN M TRS 25571 HARRINGTON LAGUNA HILLS CA 92653-7506	12527710009
MCGOWAN JEREMY D	5804 EMPEROR WAY LAS VEGAS NV 89130-4904	12527713004
MEAD DAVID R	6740 W TROPICAL PKWY LAS VEGAS NV 89130-1206	12526201020
MECHURA CAROL REVOCABLE LIV TR	MECHURA CAROL TRS 5900 EMPEROR WY LAS VEGAS NV 89130-4905	12527715020
MENDOZA MELANIE & CHRISTOPHER	6908 GREENERY CT LAS VEGAS NV 89130-1185	12527710028
MILLER JERRY J & DOROTHY J	5821 GRAND HERITAGE ST LAS VEGAS NV 89130-4940	12527716040
MILSTEAD COLENE R	6760 W TROPICAL PKWY LAS VEGAS NV 89130-1206	12526201019
MILTON JO A	REESE KIMBERLY 5785 N RAINBOW BLVD LAS VEGAS NV 89130-1230	12527803001
MIONE SALVATORE & C REV LIV TR	MIONE SALVATORE & CAMILLE TRS 5908 IVY TRELIS ST LAS VEGAS NV 89130-1198	12527710057
MIRKA MISHA	6818 WEEPING FIG CT LAS VEGAS NV 89130-5007	12527816017
MUNGUIA-VARGAS LUIS MANUEL	DEMUNGUIA EDELMIRA LEAL LEAL 6015 RIO VISTA ST LAS VEGAS NV 89130	12527610057
MYERS JOHN R	6005 IRON KETTLE ST LAS VEGAS NV 89130	12527611030
NELSON GLEN K & LESLI M	6905 COPPER KETTLE AVE LAS VEGAS NV 89130-7932	12527612034
NELSON MARY LUCREZIA LIVING TR	6005 GOLDEN SADDLE ST LAS VEGAS NV 89130-7914	12527612039
NELSON MATTHEW & JENNIFER	6013 LONESOME CACTUS ST LAS VEGAS NV 89130-1051	12527611011
NELSON TRUST	NELSON BRAD & YULI TRS 5985 MUSKETEER LN LAS VEGAS NV 89130-1233	12526310034
NORRIS NANCY L	6785 HAVEN HOLLOW AVE LAS VEGAS NV 89130-4912	12527714016
O'DONNELL PATRICK & KATHLEEN	7065 W ANN RD #130-648 LAS VEGAS NV 89130-3865	12527714023
ORANGE GARRY L	5920 IVY TRELIS ST LAS VEGAS NV 89130-1198	12527710060
OROZCO WILLIAM & RUBY C	5913 GRAND HERITAGE ST LAS VEGAS NV 89130	12527716044
PALMER EMMET C & LINDA F	6016 IRON KETTLE ST LAS VEGAS NV 89130-1063	12527611017
PALMER FAMILY TRUST	PALMER CECIL & JOYCE MARIE TRS 5800 EMPEROR WAY LAS VEGAS NV 89130-4904	12527713003
PARKER THEODORE III	6009 LONESOME CACTUS ST LAS VEGAS NV 89130-1051	12527611012

**Report of All Selected Parcels****Case Number:**

VAR-66428

**Printed On:** Mon: September 12, 2016

<b>Owner</b>	<b>Address</b>	<b>Parcel Number</b>
PARSONS FAMILY TRUST	6796 BASTILLE AVE LAS VEGAS NV 89130-1210	12526310032
PATTERSON KENNETH & ADRIENNE	6905 BEACH NEST AVE LAS VEGAS NV 89130-1172	12527710007
PATTERSON WILLIAM A & V FAM TR	PATTERSON WILLIAM A & V TRS 6784 BEACH NEST LAS VEGAS NV 89130-1112	12527716009
PEARSON JOHN & JEFFREY A	5916 KANE HOLLY ST LAS VEGAS NV 89130-4950	12527716013
PELKEY ROBIN & JOHN	6909 CLOUDY RIVER RIDGE CT LAS VEGAS NV 89130	12527710018
PERKINS MARIO A	5908 EMPEROR WY LAS VEGAS NV 89130-4905	12527715018
PINEGAR BRIAN J & J J FAM TR	PINEGAR BRIAN J & JANECE J TRS 6012 IRON KETTLE ST LAS VEGAS NV 89130-1062	12527611016
PLATZKOW MARY BETH TRUST	PLATZKOW MARY BETH TRS 6808 BEACH NEST AVE LAS VEGAS NV 89130-1169	12527716004
PODOSAHO L L C	4525 N FORT APACHE LAS VEGAS NV 89129	12527710023
POGUE TIMOTHY & TRACY	6100 N RAINBOW BLVD LAS VEGAS NV 89130-1408	12526201009
POKRZYK FAMILY TRUST	POKRZYK SHIRLEY BALE TRS 6908 CLOUDY RIDGE CT LAS VEGAS NV 89130-1173	12527710015
PORCHE JOSEPH & SHARON	6050 N RAINBOW BLVD LAS VEGAS NV 89130-1400	12526201016
PRATT ROGER JR	6920 GREENERY CT LAS VEGAS NV 89130-1185	12527710030
PREBUL WAYNE A & LINDA L FAM TR	PREBUL WAYNE A & LINDA L TRS 5720 CRYSTAL LILLY CT LAS VEGAS NV 89130-4902	12527714021
PROGRESS RESIDENTIAL 2014-1 BORR	P O BOX 4090 SCOTTSDALE AZ 85261	12527710020
QUINN LIVING TRUST	QUINN MIKE & CAROLYN S TRS 5912 IVY TRELIS ST LAS VEGAS NV 89130-1198	12527710058
QUINTERO MOISES JR & ANGELICA V	5908 GRAND HERITAGE ST LAS VEGAS NV 89130	12527716032
RATLIFF GARY L & JEANETTE	6904 GLEN LANDING AVE LAS VEGAS NV 89130-4908	12527814015
REBOLLO GLEN & SHARON	5816 KANE HOLLY ST LAS VEGAS NV 89130-4942	12527714010
REINERT STEPHEN & BONNIE LIVING	REINERT STEPHEN R & BONNIE L TRS 5800 IVY TRELIS ST LAS VEGAS NV 89130-4941	12527710049
REITZ DARLENE	5926 RIO VISTA ST LAS VEGAS NV 89130	12527702005
REITZ JASON A	6012 LONESOME CACTUS ST LAS VEGAS NV 89130-1050	12527611039
RENKIEWICZ DOLORESA MARIE	P O BOX 60355 LAS VEGAS NV 89160-0355	12527702002
REYNOLDS CHRISTOPHER L	6900 HAVEN HOLLOW AVE LAS VEGAS NV 89130	12527710043
RHOADES CARL W	LAVOIE KATHLEEN 6012 BLOWING BELLOWS ST LAS VEGAS NV 89130-1088	12527612029
RICE NICHOLAS A & RICHELLE M	6100 LONESOME CACTUS ST LAS VEGAS NV 89130-1053	12527611001
RICE WILLIAM LEE	ZIBULSKI ROSE MARY 6005 BLOWING BELLOWS ST LAS VEGAS NV 89130	12527612016
RICHARDSON PERRY LYLE JR	6916 GREENERY CT LAS VEGAS NV 89130-1185	12527710029
RICHMOND AMERICAN HOMES NEVADA I	7770 S DEAN MARTIN DR #308 LAS VEGAS NV 89139	12526312025
RICHMOND AMERICAN HOMES NEVADA I	7770 S DEAN MARTIN DR #308 LAS VEGAS NV 89139	12526312024
RICHMOND AMERICAN HOMES NEVADA I	7770 S DEAN MARTIN DR #308 LAS VEGAS NV 89139	12526312034
RICO LINO ANGEL	5912 KANE HOLLY ST LAS VEGAS NV 89130-4950	12527716014

**Report of All Selected Parcels****Case Number:**

VAR-66428

**Printed On:** Mon: September 12, 2016

<b><u>Owner</u></b>	<b><u>Address</u></b>	<b><u>Parcel Numbe</u></b>
RIMBACH JACK J & BERNICE J	5917 KANE HOLLY ST LAS VEGAS NV 89130-4951	12527716027
ROBERTS RUSSELL C & KATHERINE L	6013 BLOWING BELLOWS ST LAS VEGAS NV 89130-1090	12527612018
ROCK BOBBIE E JR & DEBORAH	6813 SILVER CHISEL AVE LAS VEGAS NV 89130-1066	12527611032
RODIN JACK & SHEILA M	5904 IVY TRELIS ST LAS VEGAS NV 89130-1198	12527710056
ROUSE TAMI	7000 PALATIAL AVE LAS VEGAS NV 89130-4917	12527715016
RUPE JAMES THOMAS & DEBRA	6904 HAVEN HOLLOW AVE LAS VEGAS NV 89130-1188	12527710044
RUZICKA KARL & KARL S	5812 KANE HOLLY ST LAS VEGAS NV 89130-4942	12527714011
SAK MARGO K	2332 KENNETH AVE HENDERSON NV 89052-2395	12527714004
SANDERS BARBARA E TRUST	ABBOTT BARBARA E TRS 5909 KANE HOLLY ST LAS VEGAS NV 89130-4951	12527716025
SANDOVAL EDUARDO	JACINTO ARLAE 5971 MUSKETEER LN LAS VEGAS NV 89130-1233	12526310035
SARABIA MARK & JULIA M	6040 N RAINBOW LN LAS VEGAS NV 89130-1400	12526201015
SAVINI JOHN J & ELIZABETH A	6017 LONESOME CACTUS ST LAS VEGAS NV 89130-1052	12527611010
SCHERBO VITALY V	5999 MUSKETEER LN LAS VEGAS NV 89130-1233	12526310033
SCOTT CHAD T	HECK BRITTNEY D 6916 HAVEN HOLLOW AVE LAS VEGAS NV 89130-1188	12527710047
SEARLES LARRY F & NADINE N	6812 BEACH NEST AVE LAS VEGAS NV 89130-1169	12527716003
SEN LIVING TRUST	NEWTON SAMUEL E JR TRS 6000 LONESOME CACTUS ST LAS VEGAS NV 89130-1050	12527611036
SHAFFER PATRICK D	6820 GREENERY CT LAS VEGAS NV 89130-1183	12527710024
SHAFFER SAVONNE J	5817 GRAND HERITAGE ST LAS VEGAS NV 89130	12527716039
SHAFFNER JON M & MICHELLE L	5721 CRYSTAL LILLY CT LAS VEGAS NV 89130-4902	12527714024
SHANLEY PATRICIA A	6788 BEACH NEST DR LAS VEGAS NV 89130-1112	12527716008
SHATTUCK STEVEN L & GEORGINA E	6901 COPPER KETTLE AVE LAS VEGAS NV 89130-7932	12527612033
SHERIDAN JANICE M	6912 HAVEN HOLLOW AVE LAS VEGAS NV 89130-1188	12527710046
SIKORSKI WILLIAM R	KRANTZ LINDA H 5813 KANE HOLLY ST LAS VEGAS NV 89130	12527714009
SIMMONS ELSIE REVOCABLE LIV TR	SIMMONS ELSIE TRS 6904 BEACH NEST AVE LAS VEGAS NV 89130-1172	12527710002
SITO MOLLY J	6009 BLOWING BELLOWS ST LAS VEGAS NV 89130	12527612017
SLIDER RICHARD & ELISA	6120 N RAINBOW BLVD LAS VEGAS NV 89130	12526201010
SOTELO JUAN C	5915 MUSKETEER LN LAS VEGAS NV 89130-1249	12526310003
SOUTHERN NV HOUSING AUTHORITY	340 N 11 ST #170 LAS VEGAS NV 89101-3125	12527715022
STAMPER SHANE & STEPHANIE	6809 SILVER CHISEL AVE LAS VEGAS NV 89130	12527611033
STONE MEADOW L L C	1159 KINGSTON HILLS CT HENDERSON NV 89002	12527716033
STRATTON FAMILY TRUST	STRATTON ALBERT L & GLORIA J TRS 6921 GREENERY CT LAS VEGAS NV 89130-1185	12527710031
STUCKERT HENRY A & VIOLET FAM TR	STUCKERT HENRY A & VIOLET TRS 5920 KANE HOLLY ST LAS VEGAS NV 89130-4950	12527716012

**Report of All Selected Parcels****Case Number:**

VAR-66428

**Printed On:** Mon: September 12, 2016

<b><u>Owner</u></b>	<b><u>Address</u></b>	<b><u>Parcel Number</u></b>
STUCKY JOANNE C & JIM R	6008 BLOWING BELLOWS ST LAS VEGAS NV 89130-1088	12527612030
SUAREZ-GUERRERO JOSE A	OTIS DESIREE J 6805 HAVEN HOLLOW AVE LAS VEGAS NV 89130-1187	12527714019
SUMMERS LEWIS	5813 GRAND HERITAGE ST LAS VEGAS NV 89130-4939	12527716038
SWEENEY MARK B	GOODHOPE LINDA L 6920 HAVEN HOLLOW AVE LAS VEGAS NV 89130	12527710048
SZYDLO JOHN & ZOFIA	5921 GRAND HERITAGE ST LAS VEGAS NV 89130-4953	12527716046
T J M TRUST	MEYER TIMOTHY J & THERESA J TRS 7965 MAVERICK ST LAS VEGAS NV 89131-2148	12527814016
TARBELL RICHARD A & BEVERLEE J	5921 KANE HOLLY ST LAS VEGAS NV 89130-4951	12527716028
THURTLIE TIMOTHY & DENISE	5521 LUCKY CLOVER ST LAS VEGAS NV 89149	12527611008
TORRES MARTIN C	6781 ALPINE BROOKS AVE LAS VEGAS NV 89130-1254	12526310004
TRIPP BLANE	DANIEL-TRIPP BLANE 6104 IRON KETTLE ST LAS VEGAS NV 89130-1065	12527611019
TRUONG MICHELLE	6533 GRAND STAND AVE LAS VEGAS NV 89131	12527715021
TURNER EMILY C	5001 LIGHT SPRINGS AVE LAS VEGAS NV 89130-7052	12527610056
VALENTI JULIA S	5909 GRAND HERITAGE ST LAS VEGAS NV 89130-4953	12527716043
VANRYNE STEVEN P & CHRISTINE J	6900 BEACH NEST AVE LAS VEGAS NV 89130-1172	12527710001
VEGA THOMAS M JR & BRENDA	6101 LONESOME CACTUS ST LAS VEGAS NV 89130-1054	12527611009
VIDALES JAVIER & MARTA	7008 BALLROOM CT LAS VEGAS NV 89130-4913	12527715024
VILLELLA SUSAN & FRANK	6816 HAVEN HOLLOW AVE LAS VEGAS NV 89130-1186	12527710042
VITALE MARK R & CARRIE ANN	VITALE SHARON LOU 5913 KANE HOLLEY ST LAS VEGAS NV 89130-4951	12527716026
W K S TRUST	LOWREY DONALD E & PAULE A CO-TRS 6763 BASTILLE AVE LAS VEGAS NV 89130-1210	12526310048
WADE BRADFORD	6001 IRON KETTLE ST LAS VEGAS NV 89130	12527611031
WAGNER BARBARA A	6820 CLOUDY RIDGE CT LAS VEGAS NV 89130-1173	12527710012
WALDRIP DEBRA G	6792 BEACH NEST AVE LAS VEGAS NV 89130-1112	12527716007
WALL JAMES	PAULSEN JULIE 5900 GRAND HERITAGE ST LAS VEGAS NV 89130	12527716034
WANG PAUL K	6908 BEACH NEST AVE LAS VEGAS NV 89130-1172	12527710003
WARRILOW RICHARD L & LINDA S	5712 CRYSTAL LILLY CT LAS VEGAS NV 89130	12527814017
WEISHEIT RONALD S	EMMERT-WEISHEIT CHRISTIE A 6804 BEACH NEST AVE LAS VEGAS NV 89130-1169	12527716005
WELLS HERBERT C	WELLS MELISSA JAYE H REV LIV TR 5808 IVY TRELIS ST LAS VEGAS NV 89130-4941	12527710051
WELLS RONALD S	WYATT-WELLS THERESA 6776 ALPINE BROOKS AVE LAS VEGAS NV 89130-1254	12526310036
WHITLEY JAMES & EDITH	6800 BEACH NEST AVE LAS VEGAS NV 89130	12527716006
WHITTLE JAMES & LINDA FAMILY TR	6913 BEACH NEST AVE LAS VEGAS NV 89130-1172	12527710005
WIESNER KIM M	7000 GRANDIOSE CT LAS VEGAS NV 89130-1199	12527713009
WILLARD CAROLE A & LYLE R	7000 ROTUNDA CT LAS VEGAS NV 89130-4900	12527713015

---

**Report of All Selected Parcels****Case Number:**

VAR-66428

**Printed On:** Mon: September 12, 2016

<b><u>Owner</u></b>	<b><u>Address</u></b>	<b><u>Parcel Numbe</u></b>
WING FREDERICK N & GINA M	6004 GOLDEN SADDLE ST LAS VEGAS NV 89130-7914	12527612013
WINSTON JOYCE M	5820 KANE HOLLY ST LAS VEGAS NV 89130-4942	12527716019
WRIGHT FAMILY REVOCABLE LIVING T	WRIGHT DENNIS JAMES & LORI JEAN 6761 MONTSOURIS PARK CT LAS VEGAS NV 89130-1251	12526310042
YOUNG CONNIE	MOSSE TRACIE 6909 COPPER KETTLE AVE LAS VEGAS NV 89130-7932	12527612035
YU-HONG REVOCABLE TRUST AGMT	600 ARTREA PL LAS VEGAS NV 89123	12527716021
YU-HONG REVOCABLE TRUST AGMT	600 ARTREA PL LAS VEGAS NV 89123	12527716022
YUMART A & REVELS-YUMART FAM TR	6817 BEACH NEST DR LAS VEGAS NV 89130-1174	12527710010
ZAMORANO SANDRA	5820 EMPEROR WY LAS VEGAS NV 89130-4904	12527713008
ZEH JON M & ANA M	6913 COPPER KETTLE AVE LAS VEGAS NV 89130-7932	12527612036
ZUBRICK JOAN KATHARINA TRUST	ZUBRICK JOAN KATHARINA TRS 6789 HAVEN HOLLOW AVE LAS VEGAS NV 89130-4912	12527714017