

City of Las Vegas
Department of Planning
Development Services Center
333 North Rancho Drive, 3rd Floor
Las Vegas, Nevada 89106

Si ✓
PRSR
FIRST CLASS MAIL
U.S. Postage
PAID
Las Vegas, NV
Permit No. 1630

Return Service Requested
Official Notice of Public Hearing

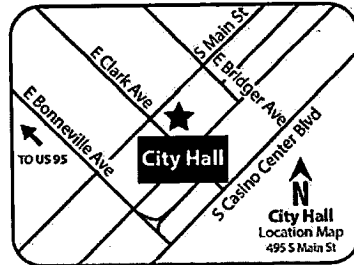

If you wish to file your protest or support on this request, check the appropriate box below and return this card in an envelope with postage to the Department of Planning at the address listed above, fax this side of this card to (702) 464-7499 or make your comments at www.lasvegasnevada.gov. If you would like to contact your Council Representative, please call (702) 229-6405.

I SUPPORT
this Request

I OPPOSE
this Request

Please use available blank space on card for your comments.

VAR-66354 and VAR-66355 [PRJ-66198]

Planning Commission Meeting of 10/11/2016

Application Information

VAR-66354 - VARIANCE - PUBLIC HEARING - APPLICANT/OWNER: KB HOMES NEVADA, INC. - For possible action on a request for a Variance TO ALLOW A FIVE-FOOT SIDE YARD SETBACK WHERE 20 FEET IS REQUIRED AND A 10-FOOT BUILDING SEPARATION WHERE 15 FEET IS REQUIRED ON LOT 4 OF A 157-LOT RESIDENTIAL SUBDIVISION on 18.02 acres at the southeast corner of Egan Crest Drive and Grand Teton Drive (APN 126-13-501-022), M (Medium Density Residential) Cliff's Edge Land Use Designation, PROPOSED: R-SL [Residential Small Lot (Mini-Lot Conventional) Cliff's Edge Land Use Designation], Ward 6 (Ross) [PRJ-66198].

VAR-66355 - VARIANCE - PUBLIC HEARING - APPLICANT/OWNER: KB HOMES NEVADA, INC. - For possible action on a request for a Variance TO ALLOW A FIVE-FOOT SIDE YARD SETBACK WHERE 20 FEET IS REQUIRED AND A 10-FOOT BUILDING SEPARATION WHERE 15 FEET IS REQUIRED ON LOT 5 OF A 157-LOT RESIDENTIAL SUBDIVISION on 18.02 acres at the southeast corner of Egan Crest Drive and Grand Teton Drive (APN 126-13-501-022), M (Medium Density Residential) Cliff's Edge Land Use Designation, PROPOSED: R-SL [Residential Small Lot (Mini-Lot Conventional) Cliff's Edge Land Use Designation], Ward 6 (Ross) [PRJ-66198].

Any and all interested persons may appear before the City Planning Commission either in person or by representative and object to or express approval of this request; or may, prior to this meeting, file a written objection thereto or approval thereof with the Department of Planning, Development Services Center, 333 North Rancho Drive, 3rd Floor, Las Vegas, Nevada 89106. Final Action on General Plan Amendments and Rezonings will be determined by the City Council. Other public hearing items may be deemed Final Action by the Planning Commission or forwarded to the City Council. The date of the City Council meeting, if applicable, will be announced at the Planning Commission meeting after the discussion of the item. For further information, including the full staff report, please call (702) 229-6301 (TTY 7-1-1) or go to <http://www.lasvegasnevada.gov>.

Application Location

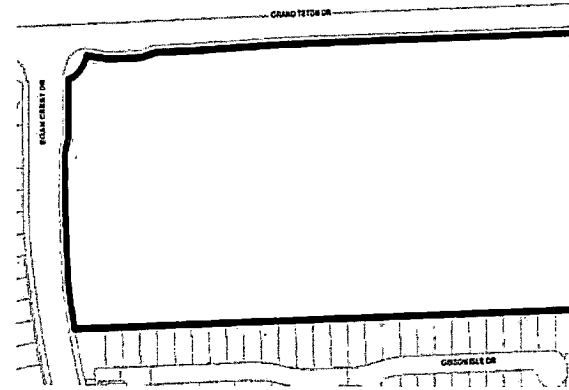

The proposed project may not pertain to the entire highlighted project site.

Public Hearing Information

Meeting: Planning Commission
Date: *October 11, 2016*
Time: 9:00 A.M.
Location: City Council Chambers
495 South Main Street, 2nd Floor
Las Vegas, Nevada 89101

52 ✓

Report of All Selected Parcels

Case Number:

VAR-66354, VAR-66355
~~MOD-66199, VAR-66346~~

Printed On: Mon: September 12, 2016

| <u>Owner</u> | <u>Address</u> | <u>Parcel Numbe</u> |
|--------------------------------|---|---------------------|
| 10029 MADISON WALK L L C | P O BOX 631730 IRVING TX 75063-0002 | 12518111020 |
| ACEVEDO ROBERT G | 10227 DANSKIN DR LAS VEGAS NV 89166-2505 | 12613519019 |
| AFZALI TIM | 10125 NASH PEAK AVE LAS VEGAS NV 89166-5213 | 12613516041 |
| ALBA JOHN B | 4406 KITTIWAKE WAY OCEANSIDE CA 92057 | 12613517020 |
| ALBERT GINA L | PEARL TYLER B 7841 ASKEW PL LAS VEGAS NV 89166 | 12613518017 |
| ALBISTON DIANA | 10441 WHITE PRINCESS AVE LAS VEGAS NV 89166 | 12613513039 |
| ALFARO-RUIZ ANDRES C | 7824 RHODORA PEAK ST LAS VEGAS NV 89166 | 12613516034 |
| ALFONSO EDDIE S & MARISSA M | ALFONSO ERIKA JEAN MAGPAYO 10512 WHITE PRINCESS AVE LAS VEGAS NV 89166-5085 | 12613114006 |
| ALLEN AMERICIOUS & KEONA | 10452 WHITE PRINCESS AVE LAS VEGAS NV 89166 | 12613513003 |
| ALLEN CRYSTAL | 7746 RHODORA PEAK ST LAS VEGAS NV 89166-5212 | 12613616056 |
| ALTEMUELLER KLAUS C & JENNIFER | 10304 GIBSON ISLE DR LAS VEGAS NV 89166 | 12613522025 |
| ANDERSON LINDA A & JAMES M | 10239 GLADSTONE PEAK LAS VEGAS NV 89166-5209 | 12613616009 |
| ANDREWS CHRISTOPHER | 7821 ASKEW PL LAS VEGAS NV 89166 | 12613518002 |
| APPELZOLLER SAMANTHA N | 10253 GIBSON ISLE DR LAS VEGAS NV 89166 | 12613521001 |
| ARGUELLES ARNEL M | ARELLANO-ARGUELLES MYRA T 7746 EAGLE ROCK PEAK CT LAS VEGAS NV 89166-5222 | 12613616031 |
| ASKEY ROBERT D & CHRISTINE R | 10240 SCOPES AVE LAS VEGAS NV 89166 | 12613513027 |
| ATIENZA ALLIY P | 7843 CASTLE ROCK PEAK ST LAS VEGAS NV 89166-5215 | 12613516017 |
| B & B FAMILY TRUST | BERGQUIST KATHLEEN L TRS 7816 RHODORA PEAK ST LAS VEGAS NV 89166-5212 | 12613516036 |
| BADGER GABRIELLE M | DELATORRE GARRETT 7820 RHODORA PEAK ST LAS VEGAS NV 89166-5212 | 12613516035 |
| BAGOCUS JOHN P & NANCY L | 10426 GROTTO MOUNTAIN AVE LAS VEGAS NV 89166-5008 | 12613514009 |
| BAIELEY JEFFREY A | 7854 AIROLA PEAK ST LAS VEGAS NV 89166-5021 | 12613513025 |
| BAILEY AVERRE & CHAUFFE | 7922 TORREYS PEAK ST LAS VEGAS NV 89166 | 12613513062 |
| BALAGTAS KIMBERLY G | LAUX CHRISTOPHER L 7835 CASTLE ROCK PEAK ST LAS VEGAS NV 89166-5215 | 12613516015 |
| BANANA TRUST | ECHAVES ROBERTA K TRS 6421 WILLOWSTONE ST LAS VEGAS NV 89166 | 12613516004 |
| BANK FLAGSTAR FSB | 5151 CORPORATE DR TROY MI 48098 | 12613513087 |
| BARILLAS FRANCIS & ZOILA | 7812 RHODORA PEAK ST LAS VEGAS NV 89166-5212 | 12613516037 |
| BARNES TROY J & NATALIE T | 7840 RHODORA PEAK ST LAS VEGAS NV 89166-5212 | 12613516030 |
| BARTON BRUCE & CONNIE | 7815 SUGARLOAF PEAK ST LAS VEGAS NV 89166 | 12613514002 |
| BAUM PHILLIP & OKCHA | 7831 CASTLE ROCK PEAK ST LAS VEGAS NV 89166 | 12613516014 |
| BAUTISTA GERTRUDE | 1884 FIREBRICK TERR UNION CITY CA 94587-4692 | 12613517016 |
| BAWDEN KAREN | 44 SANTA ELENA AVE DALY CITY CA 94015 | 12613517018 |
| BEARD DEANNA J | 10129 NASH PEAK AVE LAS VEGAS NV 89166-5213 | 12613516042 |

Report of All Selected ParcelsCase Number:VAR-66354, VAR-66355
~~MOB-66199, VAR-66346~~Printed On: Mon: September 12, 2016

| <u>Owner</u> | <u>Address</u> | <u>Parcel Number</u> |
|----------------------------------|--|----------------------|
| BEASLEY JEREMY R & HEATHER M | 7734 AMBERWOOD PEAK CT LAS VEGAS NV 89166-5220 | 12613616049 |
| BEASLEY JESSE R | 7742 AMBERWOOD PEAK CT LAS VEGAS NV 89166-5220 | 12613616047 |
| BEAULIEU KARSON D & BEATA K | 7919 TORREYS PEAK ST LAS VEGAS NV 89166-5077 | 12613114019 |
| BECKETT JOHN R & MILDRED A | 7743 SUGARLOAF PEAK ST LAS VEGAS NV 89166-5020 | 12613615029 |
| BEERS GARTH W & CARLENE M | 2720 KYLE CIR LOVELAND CO 80537 | 12518111061 |
| BEJA LEAH | PLAZA CARL 10426 WHITE PRINCESS AVE LAS VEGAS NV 89166 | 12613513009 |
| BENAMEUR RIADH | 10422 PRAIRIE MOUNTAIN AVE LAS VEGAS NV 89166 | 12613513048 |
| BENESH JAZZMEN KIMBERLY | 10451 PRAIRIE MOUNTAIN AVE LAS VEGAS NV 89166 | 12613513086 |
| BENJAMIN JACQUELINE S | 10230 DANSKIN DR LAS VEGAS NV 89166-2505 | 12613519037 |
| BENNETT LINDA JEAN & MARK BRIAN | 10028 VILLAGE WALK AVE LAS VEGAS NV 89149 | 12518111047 |
| BENNETT PAUL L | 10125 IRON WOOD PEAK AVE LAS VEGAS NV 89166-5216 | 12613516055 |
| BENOIT JIMMY S & KASSIE | 10213 GIBSON ISLE DR LAS VEGAS NV 89166 | 12613521010 |
| BERNAL BENJAMIN | PULIDO ROCIO 10447 PRAIRIE MOUNTAIN AVE LAS VEGAS NV 89166 | 12613513085 |
| BERRY CHRISTINE R | 10245 HEADRICK DR LAS VEGAS NV 89166 | 12613517017 |
| BERWICK MARY | 10324 RUGGED MOUNTAIN AVE LAS VEGAS NV 89166-5014 | 12613615041 |
| BIGLOW ALEX E | 10292 GIBSON ISLE DR LAS VEGAS NV 89166 | 12613522022 |
| BINGHAM REGINA L | 10417 BAYS MOUNTAIN AVE LAS VEGAS NV 89166-5002 | 12613615032 |
| BISHOP MICHAEL JOHN & MONICA A | 10216 DANSKIN DR LAS VEGAS NV 89166-2504 | 12613519030 |
| BISIGNANO LOUIS & OLIVIA | 10438 PRAIRIE MOUNTAIN AVE LAS VEGAS NV 89166 | 12613513052 |
| BLACK HUGH M IV | 5555 PAINTED MIRAGE #140 LAS VEGAS NV 89149 | 12613514029 |
| BLACK LATISHA N & BRENDOLYN | 10413 BAYS MOUNTAIN AVE LAS VEGAS NV 89166-5002 | 12613615033 |
| BLISS CRYSTAL | 10221 HEADRICK DR LAS VEGAS NV 89166-2501 | 12613517029 |
| BLUBAUGH WILLIAM & PEGGY | 7819 SUGARLOAF PEAK ST LAS VEGAS NV 89166-5019 | 12613514003 |
| BOEKANKAMP JOEL & LENORE D | 7908 AIROLA PEAK ST LAS VEGAS NV 89166-5021 | 12613513023 |
| BOLEWARE WALTER DUDLEY FAMILY TR | BOLEWARE MARY JESSIE TRS 4550 N CIMARRON RD LAS VEGAS NV 89129 | 12613514014 |
| BONE ANDRE LAVERT | 10450 PRAIRIE MOUNTAIN AVE LAS VEGAS NV 89166 | 12613513054 |
| BOUCHE ELVIA | 10414 PRAIRIE MOUNTAIN AVE LAS VEGAS NV 89166-5059 | 12613513046 |
| BOYLAN LIVING TRUST | BOYLAN TIMOTHY L & SHARON L TRS 5835 JANELL DR LAS VEGAS NV 89149-4649 | 12613516040 |
| BRADDOCK ALBERT MITCH JR & JENNI | 7745 AMBERWOOD PEAK CT LAS VEGAS NV 89166-5220 | 12613616045 |
| BRADLEY BRYCE & JULIA M | 7920 FARRALON RIDGE CT LAS VEGAS NV 89149-3769 | 12518111060 |
| BRADLEY ERIK BRETT & RANDI MICHE | 10434 PRAIRIE MOUNTAIN AVE LAS VEGAS NV 89166 | 12613513051 |
| BRANSON STEVEN H & CHRISTINE M | 7745 EAGLE ROCK PEAK CT LAS VEGAS NV 89166-5222 | 12613616030 |

Report of All Selected Parcels**Case Number:****VAR-66354, VAR-66355**
~~MCD-66199, VAR-66346~~**Printed On:** Mon: September 12, 2016

| <u>Owner</u> | <u>Address</u> | <u>Parcel Number</u> |
|---------------------------------|---|----------------------|
| BREWER JAMIEKA L | 10272 DANSKIN DR LAS VEGAS NV 89166-2506 | 12613520016 |
| BRIDGES NERISA | 10426 PRAIRIE MOUNTAIN AVE LAS VEGAS NV 89166-5059 | 12613513049 |
| BROOKS ERIC L & DIONE L | 7733 EAGLE ROCK PEAK CT LAS VEGAS NV 89166-5222 | 12613616027 |
| BROUSSARD STEVEN H | 10248 DANSKIN DR LAS VEGAS NV 89166-2506 | 12613520010 |
| BRYNER DAVID J | 10141 BLUE WATER PEAK AVE LAS VEGAS NV 89166 | 12613616067 |
| BURKE EDWARD | SINO BIO MARY 10461 BURENSBURG AVE LAS VEGAS NV 89135 | 12613513107 |
| BURKS MICHAEL E & LINDA G | 7742 TREE LANE PEAK CT LAS VEGAS NV 89166-5219 | 12613616039 |
| BURTON CRAIG S & ERIN M R | 10434 WHITE PRINCESS AVE LAS VEGAS NV 89166-5085 | 12613513007 |
| BURTON ROBERT W | 7859 ASKEW PL LAS VEGAS NV 89166 | 12613518009 |
| BUSHING JASON D & KIMBERLY KRIS | 10236 DANSKIN DR LAS VEGAS NV 89166 | 12613519040 |
| C A H 2014-1 BORROWER L L C | 8665 E HARTFORD DR #200 SCOTTSDALE AZ 85255 | 12518111056 |
| C A H 2014-2 BORROWER L L C | 8665 E HARTFORD DR #200 SCOTTSDALE AZ 85255 | 12518111050 |
| C A H 2014-2 BORROWER L L C | 8665 E HARTFORD DR #200 SCOTTSDALE AZ 85255 | 12613517008 |
| C A H 2015-1 BORROWER L L C | 8665 E HARTFORD DR #200 SCOTTSDALE AZ 85255 | 12613616052 |
| C M D REVOCABLE LIVING TRUST | 7848 ASKEW PL LAS VEGAS NV 89166-1200 | 12613518007 |
| CAHILL MICHAEL & ERIN | CAHILL BRIAN M & KAREN R 7928 AIROLA PEAK DR LAS VEGAS NV 89166 | 12613513018 |
| CALARA FRANCISCO & MYRA | 7737 EAGLE ROCK PEAK CT LAS VEGAS NV 89166-5222 | 12613616028 |
| CALIENDO GRACE | 10416 BAYS MOUNTAIN AVE LAS VEGAS NV 89166 | 12613514034 |
| CALL PARLEY PRATT III | 10020 SCENIC WALK AVE LAS VEGAS NV 89149-3774 | 12518111091 |
| CANEZ FAMILY TRUST | CANEZ ROBERT E & DORENE TRS 10334 BAYS MOUNTAIN AVE LAS VEGAS NV 89166-5001 | 12613514030 |
| CANTRELL JEFFREY & KERRY WIRFEL | 411 STATHAMS WAY WARNER ROBINS GA 31088 | 12613513079 |
| CAO JING | YOU SIEW MEI 24752 JUDI CT LAGUNA NIGUEL CA 92677 | 12613616016 |
| CARLSON BRENT E | 7735 TREE LANE PEAK CT LAS VEGAS NV 89166-5219 | 12613616035 |
| CARPENDALE GARY & CHARLENE P | 10032 VILLAGE WALK AVE LAS VEGAS NV 89149 | 12518111046 |
| CARRIER CHRISTOPHER & SAMANTHA | 10244 BLUE WATER PEAK LAS VEGAS NV 89166 | 12613616006 |
| CARROLL CLAYTON W & APRIL L | 10452 TURTLE MOUNTAIN AVE LAS VEGAS NV 89166-5081 | 12613513110 |
| CARROLL DERECK P & NIA LANAY | 10454 MOUNT WASHINGTON AVE LAS VEGAS NV 89166-5057 | 12613513066 |
| CARROLL JENNIFER R | LAROCQUE ANNETTE YVONNE 10233 HEADRICK DR LAS VEGAS NV 89166-2501 | 12613517023 |
| CASTELLANOS DAISY | BANUELOS-OLAGUEL EVELYN 10437 WHITE PRINCESS AVE LAS VEGAS NV 89166 | 12613513040 |
| CASTOE BRENDA | 10021 VILLAGE WALK AVE LAS VEGAS NV 89149-3776 | 12518111042 |
| CASWELL BONNIE J & DAVID L | 7918 TORREYS PEAK ST LAS VEGAS NV 89166 | 12613513063 |
| CASYAO RIZALINA | 10441 TURTLE MOUNTAIN AVE LAS VEGAS NV 89166-5081 | 12613513036 |

Report of All Selected Parcels**Case Number:****VAR-66354, VAR-66355**
~~MOD-66199, VAR-66346~~**Printed On:** Mon: September 12, 2016

| <u>Owner</u> | <u>Address</u> | <u>Parcel Number</u> |
|---------------------------------|---|----------------------|
| CAYANAN MARIE TERESA JEANETTE | 10225 GIBSON ISLE DR LAS VEGAS NV 89166-2508 | 12613521007 |
| CHAVANA THERESA M | ASHFORD OLGA O 10210 GIBSON ISLE DR LAS VEGAS NV 89166-2508 | 12613521014 |
| CHRISTENSEN BRANDON R | 10141 IRON WOOD PEAK AVE LAS VEGAS NV 89166-5216 | 12613516059 |
| CHRISTENSEN BRIAN JACOB & ALTER | 10443 PRAIRIE MOUNTAIN AVE LAS VEGAS NV 89166 | 12613513084 |
| CHUN DOREEN MAE TRUST | CHUN DOREEN MAE TRS 10222 DANSKIN DR LAS VEGAS NV 89166-2504 | 12613519033 |
| CLAWSON CASEY T & BRIANNA C | 10437 MOUNT WASHINGTON AVE LAS VEGAS NV 89166 | 12613513093 |
| COLE & COLE LIVING TRUST | COLE ROBIN K & LINDA D TRS 10327 BAYS MOUNTAIN AVE LAS VEGAS NV 89166 | 12613615039 |
| COLLIS KRISTINE | 10228 DANSKIN DR LAS VEGAS NV 89166-2505 | 12613519036 |
| CONCEPCION NICHOLAS J | PARTIDA YVETTE 10296 GIBSON ISLE DR LAS VEGAS NV 89166 | 12613522023 |
| CONGDON CHERYL L | 416 WATERBURY WAY MEDFORD OR 97504 | 12613616022 |
| CONNOR JOSEPH J JR | 10297 GIBSON ISLE DR LAS VEGAS NV 89166 | 12613522001 |
| CONROY SEAN R & CHELSEA R | 10243 DANSKIN DR LAS VEGAS NV 89166-2505 | 12613520008 |
| CONTRERAS MILTON | RIOS SANDRA M DAVILA 10128 HAYMARKET PEAK AVE LAS VEGAS NV 89166-5217 | 12613516065 |
| COOK JACOB H & EUN-JI | 10252 DANSKIN DR LAS VEGAS NV 89166 | 12613520011 |
| COOPERMAN ALEXANDRA N | GAGNON COLIN W 10243 GLADSTONE PEAK ST LAS VEGAS NV 89166 | 12613616010 |
| CORNELIUS MARY | 10242 HEADRICK DR LAS VEGAS NV 89166-2500 | 12613517040 |
| CORNELIUSSEN CHRISTINA | 7746 AMBERWOOD PEAK CT LAS VEGAS NV 89166-5220 | 12613616046 |
| CORREA JOHON JAIRO | 10335 BAYS MOUNTAIN AVE LAS VEGAS NV 89166-5001 | 12613615037 |
| COUNTS CHRISTOPHER L | 10256 GIBSON ISLE DR LAS VEGAS NV 89166 | 12613522013 |
| COVEL JOSEPHINE A | 10223 BLUE WATER PEAK AVE LAS VEGAS NV 89166-5211 | 12613616076 |
| CRAWFORD FAMILY TRUST | CRAWFORD BRUCE M & JEANNIE TRS 413 MORSE AVE PLACENTIA CA 92870-3413 | 12613517036 |
| CRUSE SAMANTHA J | 10229 GIBSON ISLE DR LAS VEGAS NV 89166-2509 | 12613521006 |
| CRUZ DINAH | 7819 CASTLE ROCK PEAK ST LAS VEGAS NV 89166-5215 | 12613516011 |
| CUESTA CARLOS L | SARMIENTO MARIA C 10251 HEADRICK DR LAS VEGAS NV 89166 | 12613517014 |
| DAHILIG RAYMOND & JENBETH A | 7734 RHODORA PEAK ST LAS VEGAS NV 89166-5212 | 12613616059 |
| DAISY TRUST | P O BOX 36208 LAS VEGAS NV 89133-6208 | 12613616036 |
| DALE FAMILY TRUST | DALE MIKELL E & LINDA L TRS 7400 RED CINDER ST LAS VEGAS NV 89131 | 12613522021 |
| DAMKE SHELLY L | 10126 HARTFORD PEAK CT LAS VEGAS NV 89166-5218 | 12613616054 |
| DANCOSK RICHARD | 10231 DANSKIN DR LAS VEGAS NV 89166 | 12613519017 |
| DARDIS DEREK J & KATHERINE M | 10232 DANSKIN DR LAS VEGAS NV 89166 | 12613519038 |
| DAS SINDHU | 10277 GIBSON ISLE DR LAS VEGAS NV 89166 | 12613522006 |
| DAVIS ROSS MICHAEL & REBECCA | 10238 HEADRICK DR LAS VEGAS NV 89166-2500 | 12613517038 |

Report of All Selected Parcels**Case Number:****VAR-66354, VAR-66355**
~~MOD-66199, VAR-66346~~**Printed On:** Mon: September 12, 2016

| Owner | Address | Parcel Number |
|----------------------------------|--|----------------------|
| DAWA CATHERINE J | 10148 NASH PEAK AVE LAS VEGAS NV 89166 | 12613516020 |
| DEGUIRE LEO A III | 10237 HEADRICK DR LAS VEGAS NV 89166-2500 | 12613517021 |
| DELACRUZ MA LIWAYWAY | 645 BLUE YUCCA ST LAS VEGAS NV 89144 | 12518111059 |
| DELLOSA ROBERT L JR | 10021 ARTISTIC WALK AVE LAS VEGAS NV 89149-3767 | 12518111049 |
| DENNY LAURENCE A III & DEBORAH J | 3125 BERKSHIRE CT PLEASANTON CA 94588 | 12613517051 |
| DENT JODIE R | 10235 GLADSTONE PEAK LAS VEGAS NV 89166-5209 | 12613616008 |
| DESANTOS JOSE R & MARGARITA L | 10418 GROTTO MOUNTAIN AVE LAS VEGAS NV 89166-5008 | 12613514011 |
| DEVINE WILLIAM EDWARD & RENAE JE | 7935 TORREYS PEAK ST LAS VEGAS NV 89166 | 12613114002 |
| DHIAA MUSTAFA A | 10124 NASH PEAK AVE LAS VEGAS NV 89166 | 12613516026 |
| DINKINS ROBERT & LATHYRELLE | 10250 HEADRICK DR LAS VEGAS NV 89166-2502 | 12613517043 |
| DITTMER RICHARD F | 10028 SCENIC WALK AVE LAS VEGAS NV 89149-3774 | 12518111089 |
| DIXON GLORIA | 7738 RHODORA PEAK ST LAS VEGAS NV 89166-5212 | 12613616058 |
| DIZON WARREN | 10033 MADISON WALK AVE LAS VEGAS NV 89149-3771 | 12518111021 |
| DORIA MICHELE J | 7808 RHODORA PEAK ST LAS VEGAS NV 89166-5212 | 12613516038 |
| DOUGLAS MAXIMILLIANO | AMARO-DOUGLAS ANGELINA R 10448 TURTLE MOUNTAIN AVE LAS VEGAS NV 89166-5081 | 12613513109 |
| DRISCOLL FRANK | 10339 BAYS MOUNTAIN AVE LAS VEGAS NV 89166-5001 | 12613615036 |
| DUKE PARTNERS L L C | 2320 POTOSI ST #130 LAS VEGAS NV 89146 | 12613615046 |
| DUNLAP KRYSTAL | 7851 ASKEW PL LAS VEGAS NV 89166-1200 | 12613518013 |
| DUYOR ERICSON C & LILIA G | 10123 HAYMARKET PEAK AVE LAS VEGAS NV 89166-5217 | 12613516001 |
| DYNABURSKY MARK & JANESSA | 10125 HARTFORD PEAK CT LAS VEGAS NV 89166-5218 | 12613616051 |
| EAGLE INVESTORS | P O BOX 7565 LAS VEGAS NV 89125 | 12613514031 |
| EASON RONALD A II | ALBERT GRACE R 10254 HEADRICK DR LAS VEGAS NV 89166-2502 | 12613517045 |
| EASTMAN FRED & ARLENE | 506 DOGWOOD LN CHAGRIN FALLS OH 44023-6736 | 12613514008 |
| ECKERT HAROLD JR & BLYNNDA | 7828 RHODORA PEAK ST LAS VEGAS NV 89166-5212 | 12613516033 |
| EIDE MICHAEL | 10268 GIBSON ISLE DR LAS VEGAS NV 89166 | 12613522016 |
| EMERSON BETH ANN | 7744 SUNDIAL PEAK ST LAS VEGAS NV 89166-5006 | 12613615002 |
| EPSTEIN MARVIN A LIVING TRUST ET | EPSTEIN CATHERINE M TRS 10280 GIBSON ISLE DR LAS VEGAS NV 89166 | 12613522019 |
| ESPINOZA ROBERT A & CHARLOTTE | 10411 GROTTO MOUNTAIN AVE LAS VEGAS NV 89166-5008 | 12613514026 |
| ESTARIS FRANCISCO M & CLARA G | 10144 IRON WOOD PEAK AVE LAS VEGAS NV 89166-5216 | 12613516047 |
| EVARO RICHARD REYES & MONICA | JOHNSON MARY JANE 7949 POINT POWELL CT LAS VEGAS NV 89166 | 12613513005 |
| FALVEY DARLENE TRUST | FALVEY DARLENE ANN TRS 10131 HAYMARKET PEAK AVE LAS VEGAS NV 89166-5217 | 12613516003 |
| FARISS DOUGLAS V & GLADYS F | 10140 HAYMARKET PEAK AVE LAS VEGAS NV 89166-5217 | 12613516062 |

Report of All Selected ParcelsCase Number:VAR-66354, VAR-66355
~~MOD-88488, VAR-66348~~Printed On: Mon: September 12, 2016

| <u>Owner</u> | <u>Address</u> | <u>Parcel Numbe</u> |
|---------------------------------|---|---------------------|
| FARRER LES | 10419 GROTTO MOUNTAIN LAS VEGAS NV 89166-5008 | 12613514024 |
| FARRIS MATTHEW J & TRACY L | 10217 GIBSON ISLE DR LAS VEGAS NV 89166-2508 | 12613521009 |
| FERNANDEZ JOSEPH-ROYCE C | 10256 GLADSTONE PEAK ST LAS VEGAS NV 89166-5209 | 12613616012 |
| FERNANDEZ PHILIP R | 7738 FORTRESS PEAK CT LAS VEGAS NV 89166-5221 | 12613616025 |
| FIELDS JANA E | 10260 GIBSON ISLE DR LAS VEGAS NV 89166 | 12613522014 |
| FISHEL AMANDA L | 10308 GIBSON ISLE DR LAS VEGAS NV 89166 | 12613522026 |
| FLEMING KAREN J | ORLANDO PETER 7818 SUNDIAL PEAK ST LAS VEGAS NV 89166-5006 | 12613514016 |
| FLOREK MARK J & DEBBIE L | 5455 S NICOLE CT NEW BERLIN WI 53151-8195 | 12613514023 |
| FLORES MAURICIO ESPINOSA | 6941 DIVER AVE NORTH LAS VEGAS NV 89084 | 12613518005 |
| FOREHAND HAROLD L FAMILY TRUST | 3516 E 3138 N KIMBERLY ID 83341-5361 | 12613114013 |
| FOWLER REBECCA | 7937 FARRALON RIDGE CT LAS VEGAS NV 89149-3769 | 12518111057 |
| FRANCESE ANITA M | 10414 GRATTO MOUNTAIN AVE LAS VEGAS NV 89166-5008 | 12613514012 |
| FRANK RICHARD J JR | 10229 HEADRICK DR LAS VEGAS NV 89166 | 12613517025 |
| FREE RANGE MANAGEMENT L T D | 1347 CADENCE ST HENDERSON NV 89052 | 12518111054 |
| FRIEDMAN BEAU | 7901 FARRALON RIDGE CT LAS VEGAS NV 89149 | 12518111052 |
| FRILLES RHODORA G | 10270 HEADRICK DR LAS VEGAS NV 89166 | 12613517053 |
| FRITZ FAMILY TRUST | FRITZ GARY R & JODI L TRS 10434 GROTTO MOUNTAIN AVE LAS VEGAS NV 89166-5008 | 12613514007 |
| FURUKEN GLORIA | 7732 SUNDIAL PEAK ST LAS VEGAS NV 89166 | 12613615005 |
| GACCIONE ZACHARY | 10260 HEADRICK DR LAS VEGAS NV 89166-2502 | 12613517048 |
| GALAVIZ VERONICA & DANNY | 10420 BAYS MOUNTAIN AVE LAS VEGAS NV 89166-5002 | 12613514035 |
| GALLANT DAWNYA CHRISTINE | 7943 TORREYS PEAK ST LAS VEGAS NV 89166 | 12613114004 |
| GARCIA CRYSTAL B | BALAORO EDWIN A 10259 DANSKIN DR LAS VEGAS NV 89166-2506 | 12613520004 |
| GARCIA IRMA | 10120 NASH PEAK AVE LAS VEGAS NV 89166-5213 | 12613516027 |
| GARDUQUE NATHANIEL I | GARDUQUE NATANAEL R & LETICIA B 10124 IRON WOOD PEAK AVE LAS VEGAS NV 89166 | 12613516052 |
| GEHRT ALDEN K JR & JEANNIE M | 10253 HEADRICK DR LAS VEGAS NV 89166-2502 | 12613517013 |
| GERRITY BRIANNA | BARBER RONALD A JR 10252 GIBSON ISLE DR LAS VEGAS NV 89166-2509 | 12613522012 |
| GILES PAUL P & CHA Y | 7734 FORTRESS PEAK ST LAS VEGAS NV 89166-5221 | 12613616026 |
| GIOVANNITTI CHRISTOPHER & SARAH | 10256 DANSKIN DR LAS VEGAS NV 89166-2506 | 12613520012 |
| GLASGOW JASON & SUMMER MARIE | 10456 WHITE PRINCESS AVE LAS VEGAS NV 89166 | 12613513002 |
| GLASS KEVIN | GETTY MISHA 10275 HEADRICK DR LAS VEGAS NV 89166 | 12613517002 |
| GOODWIN CHRISTOPHER R & TANYA N | 10449 MOUNT WASHINGTON AVE LAS VEGAS NV 89166-5057 | 12613513090 |
| GORTON THOMAS | 5524 CASTLE HILLS DR LA JOLLA CA 92037 | 12518111045 |

Report of All Selected Parcels**Case Number:**~~VAR-66346~~
VAR-66354, VAR-66355**Printed On:** Mon: September 12, 2016

| <u>Owner</u> | <u>Address</u> | <u>Parcel Number</u> |
|----------------------------------|---|----------------------|
| GOULET SAMUEL & JESSICA ANN | 10235 BLUE WATER PEAK AVE LAS VEGAS NV 89166 | 12613616001 |
| GRACE ROBERT J | 10132 NASH PEAK AVE LAS VEGAS NV 89166-5213 | 12613516024 |
| GRAHAM NATOSHIA L | 10219 DANSKIN DR LAS VEGAS NV 89166-2504 | 12613519023 |
| GRAMLICH BLAINE | 10024 MADISON WALK AVE LAS VEGAS NV 89149 | 12518111024 |
| GRANT ARAXIE ROSE | 10417 WHITE PRINCESS AVE LAS VEGAS NV 89166 | 12613513045 |
| GRAVES MELISSA S | 10248 BLUE WATER PEAK AVE LAS VEGAS NV 89166 | 12613616005 |
| GREENWALD LAWRENCE S & BARBARA M | 2540 BRIAN DR NORTHBROOK IL 60062 | 12613514013 |
| GRILLO DENNIS & DELORES FAMILY T | GRILLO DENNIS CHARLES & DELORES 10231 BLUE WATER PEAK AVE LAS VEGAS NV 89166-5211 | 12613616078 |
| GRIMES MAUREEN LIVING TRUST | GRIMES MAUREEN TRS 10430 PRAIRIE MOUNTAIN AVE LAS VEGAS NV 89166 | 12613513050 |
| GROFF JULIE L | 125-A CLAREMONT AVE LONG BEACH CA 90803 | 12613520013 |
| GUARINO GEORGIA W & MICHAEL J | 7843 TORREYS PEAK ST LAS VEGAS NV 89166-5076 | 12613114010 |
| GUNDERSON MARK F & JAMIE R | 10418 WHITE PRINCESS AVE LAS VEGAS NV 89166 | 12613513011 |
| GUNTER TAMARA S | 10122 HARTFORD PEAK CT LAS VEGAS NV 89166-5218 | 12613616053 |
| GUTIERREZ KELLY | WEINER DW 10244 DANSKIN DR LAS VEGAS NV 89166-2505 | 12613520009 |
| GUZMAN JEROME & CORRINE ANNE | 10021 SCENIC WALK LAS VEGAS NV 89149-3774 | 12518111084 |
| HAACKE BRENDON & CAYLEE | 10284 GIBSON ISLE DR LAS VEGAS NV 89166 | 12613522020 |
| HADDAD MARC & JANE | 10419 PRAIRIE MOUNTAIN AVE LAS VEGAS NV 89166 | 12613513078 |
| HADDAD PENNY G | DAVID BRITTANY L 1708 GLENVIEW DR LAS VEGAS NV 89134 | 12613516060 |
| HALL DENNIS L & DOROTHY L | SIBAL MELISS R 10418 PRAIRIE MOUNTAIN AVE LAS VEGAS NV 89166 | 12613513047 |
| HALLETT DANIEL S & SARAH E | 10412 RUGGED MOUNTAIN AVE LAS VEGAS NV 89166-5015 | 12613615047 |
| HANSON DIRK EDWARD | JEAGER LORI LYNN 10431 PRAIRIE MOUNTAIN AVE LAS VEGAS NV 89166 | 12613513081 |
| HANSON PATRICIA ANN | 10416 RUGGED MOUNTAIN AVE LAS VEGAS NV 89166-5015 | 12613615048 |
| HANSON ROGER K | SANTOS ANDREWS 7733 FORTRESS PEAK CT LAS VEGAS NV 89166-5221 | 12613616019 |
| HARRIS JOSEPH W | 7827 CASTLE ROCK PEAK ST LAS VEGAS NV 89166-5215 | 12613516013 |
| HARRISON KENNETH W & LENORE M | 7804 RHODORA PEAK ST LAS VEGAS NV 89166-5212 | 12613516039 |
| HAYER RUSSELL J & NICOLLE R | 10408 BAYS MOUNTAIN AVE LAS VEGAS NV 89166-5002 | 12613514032 |
| HAYES LEO & LISA M | 7737 AMBERWOOD PEAK CT LAS VEGAS NV 89166 | 12613616043 |
| HEADRICK DRIVE TRUST | P O BOX 36208 LAS VEGAS NV 89133-6208 | 12613517006 |
| HEARTHSTONE BROOKSTONE HOA | 1820 E SAHARA AVE #101 LAS VEGAS NV 89104-3736 | 12613516068 |
| HEARTHSTONE BROOKSTONE HOA | 1820 E SAHARA AVE #101 LAS VEGAS NV 89104-3736 | 12613616172 |
| HEARTHSTONE BROOKSTONE HOA | 1820 E SAHARA AVE #101 LAS VEGAS NV 89104-3736 | 12613516070 |

Report of All Selected Parcels**Case Number:****VAR-66354, VAR-66355**
~~MOD-66199, VAR-66346~~**Printed On:** Mon: September 12, 2016

| Owner | Address | Parcel Number |
|---------------------------------|--|----------------------|
| HEARTHSTONE BROOKSTONE HOA | 1820 E SAHARA AVE #101 LAS VEGAS NV 89104-3736 | 12613616171 |
| HEARTHSTONE BROOKSTONE HOA | 1820 E SAHARA AVE #101 LAS VEGAS NV 89104-3736 | 12613616178 |
| HEARTHSTONE BROOKSTONE HOA | 1820 E SAHARA AVE #101 LAS VEGAS NV 89104-3736 | 12613516069 |
| HEARTHSTONE BROOKSTONE HOA | 1820 E SAHARA AVE #101 LAS VEGAS NV 89104-3736 | 12613616177 |
| HEARTHSTONE BROOKSTONE HOA | 1820 E SAHARA AVE #101 LAS VEGAS NV 89104-3736 | 12613516071 |
| HEDLIND KATIE T | HEDLIND VERONICA M & JEFFERY S 10231 HEADRICK DR LAS VEGAS NV 89166-2501 | 12613517024 |
| HERMAN SANTA D | 65 CASSANDRA BLVD #103 WEST HARTFORD CT 06107-3149 | 12613513100 |
| HIATT NOLAN C & MARY L | 10032 MADISON WALK AVE LAS VEGAS NV 89149 | 12518111022 |
| HILL OLGA A LIVING TRUST | HILL OLGA A TRS 10421 BAYS MOUNTAIN AVE LAS VEGAS NV 89166-5002 | 12613615031 |
| HORVATH JEREMY E | NAUGLE KRISTY M 7947 TORREYS PEAK ST LAS VEGAS NV 89166 | 12613114005 |
| HULTGREN PAUL W | ARROYO-HULTGREN PAMELA A 10024 SCENIC WALK AVE LAS VEGAS NV 89149-3774 | 12518111090 |
| HUNT DEAN R & RHONDA L | 10405 BAYS MOUNTAIN AVE LAS VEGAS NV 89166-5002 | 12613615035 |
| HURENCHYK IVANNA & ARTSIOM | 10029 VILLAGE WALK AVE LAS VEGAS NV 89149 | 12518111044 |
| INES CONSTANTE Y & BEATRIZ G | 10228 HEADRICK DR LAS VEGAS NV 89166-2501 | 12613517033 |
| ISAACS AMY J | 10214 DANSKIN DR LAS VEGAS NV 89166-2504 | 12613519029 |
| JACKLIN ANNE K | PUCCI JOHN P 10029 SCENIC WALK AVE LAS VEGAS NV 89149-3774 | 12518111086 |
| JACKSON CLIFTON R JR & KIMBERLY | 7842 AIROLA PEAK ST LAS VEGAS NV 89166 | 12613513028 |
| JACKSON-HALE NAKIA C | 10151 HAYMARKET PEAK LAS VEGAS NV 89166-5217 | 12613516008 |
| JENSEN BEN & SUMMER | 10127 BLUE WATER PEAK AVE LAS VEGAS NV 89166-5210 | 12613616064 |
| JENSEN WAYNE L & CAROL ELAINE | 3639 VAN BUREN AVE OGDEN UT 84403-2028 | 12613616048 |
| JOHNSON CHRISTOPHER OWEN | 779 CLIFTON WAY VACAVILLE CA 95688 | 12613517010 |
| JOHNSON DAVID K | 10149 BLUE WATER PEAK AVE LAS VEGAS NV 89166-5210 | 12613616069 |
| JOHNSON PRESTON & LINDSAY | 10215 BLUE WATER PEAK AVE LAS VEGAS NV 89166-5211 | 12613616074 |
| JOHNSON SONIA M & RONALD J | 10427 PRAIRIE MOUNTAIN AVE LAS VEGAS NV 89166 | 12613513080 |
| JOHNSTON PETER C | 7850 AIROLA PEAK ST LAS VEGAS NV 89166-5021 | 12613513026 |
| JOLLY BRYAN A & VALERIE N | 10430 MOUNT WASHINGTON AVE LAS VEGAS NV 89166-5056 | 12613513072 |
| JONES DAVID R | 10140 IRON WOOD PEAK AVE LAS VEGAS NV 89166-5216 | 12613516048 |
| JORDAN DINA E | GRAHAM RAY O 7914 TORREYS PEAK ST LAS VEGAS NV 89166 | 12613513064 |
| JORDAN JAMES M | HARTER CARILYNN 10267 DANSKIN DR LAS VEGAS NV 89166-2506 | 12613520002 |
| K B HOME NEVADA INC | 4127 E VAN BUREN ST #150 PHOENIX AZ 85008-6934 | 12613501022 |
| KAHOOKELE JENNIFER M | 10246 HEADRICK DR LAS VEGAS NV 89166-2500 | 12613517042 |
| KAISER STEPHEN M & REBECCA L | 7924 AIROLA PEAK ST LAS VEGAS NV 89166-5021 | 12613513019 |

Report of All Selected ParcelsCase Number:VAR-66354, VAR-66355
~~MOB-66199, VAR-66246~~Printed On: Mon: September 12, 2016

| <u>Owner</u> | <u>Address</u> | <u>Parcel Number</u> |
|----------------------------------|--|----------------------|
| KARY LISA M | 10442 MOUNT WASHINGTON AVE LAS VEGAS NV 89166-5057 | 12613513069 |
| KELLER ANDREW STEPHEN | 10128 NASH PEAK AVE LAS VEGAS NV 89166-5213 | 12613516025 |
| KELLER THOMAS J | 10264 DANSKIN DR LAS VEGAS NV 89166-2506 | 12613520014 |
| KESSLER TANYA ANNE | CHAVEZ RUDOLFO 10409 WHITE PRINCESS AVE LAS VEGAS NV 89166-5084 | 12613513015 |
| KING KIRK R & SANDRA DENISE | 10153 BLUE WATER PEAK AVE LAS VEGAS NV 89166-5210 | 12613616070 |
| KIRKHART JAMIE | 10137 IRON WOOD PEAK AVE LAS VEGAS NV 89166-5216 | 12613516058 |
| KLEDA DARYL S & JENNIFER A | 10413 MOUNT WASHINGTON AVE LAS VEGAS NV 89166 | 12613513099 |
| KNOTT KATHRYN | MIRTI BENJAMIN 7836 BLUE LAKE PEAK ST LAS VEGAS NV 89166 | 12613113026 |
| KRANZ MATTHEW C | 10276 GIBSON ISLE DR LAS VEGAS NV 89166 | 12613522018 |
| LAMBERT ROGER E & CYNTHIA | 10331 GROTTO MOUNTAIN AVE LAS VEGAS NV 89166 | 12613514028 |
| LAMELA SCOTT & ANGELA | 10418 MOUNT WASHINGTON AVE LAS VEGAS NV 89166-5056 | 12613513075 |
| LAMONTAGNE JERRY & LEAH | 10123 BLUE WATER PEAK AVE LAS VEGAS NV 89166 | 12613616063 |
| LAMPART STEVEN | 10226 DANSKIN DR LAS VEGAS NV 89166 | 12613519035 |
| LANDSMAN MICHAEL B | 7737 FORTRESS PEAK CT LAS VEGAS NV 89166-5221 | 12613616020 |
| LANTZ BRADY J & KENNEDY B | BROADHEAD RANDY E 10232 HEADRICK DR LAS VEGAS NV 89166-2501 | 12613517035 |
| LAPID MANUEL S & AMELITA R | LITTLE SHELBY 10225 DANSKIN DR LAS VEGAS NV 89166-2504 | 12613519020 |
| LEAVITT SCOTT | 10261 HEADRICK DR LAS VEGAS NV 89166-2502 | 12613517009 |
| LEBEL DANIEL J & PATRICIA K | 10453 MOUNT WASHINGTON AVE LAS VEGAS NV 89166-5057 | 12613513089 |
| LEEDHAM JANET LARUE FAMILY TRUST | LEEDHAM JANET LARUE TRS HC 74 BOX 263-2 PIOCHE NV 89043 | 12613518015 |
| LEON DENNIS | 10285 GIBSON ISLE DR LAS VEGAS NV 89166 | 12613522004 |
| LESIEWICZ JANEL | 10445 MOUNT WASHINGTON AVE LAS VEGAS NV 89166-5057 | 12613513091 |
| LEVINSON ROBERT & KATHY | 10224 HEADRICK DR LAS VEGAS NV 89166-2501 | 12613517031 |
| LILII JONAH & DESIREE | 10213 DANSKIN DR LAS VEGAS NV 89166-2504 | 12613519026 |
| LOEBER ANTHONY J | 10252 HEADRICK DR LAS VEGAS NV 89166-2502 | 12613517044 |
| LOMBARDO JAMES J & CORRINE M | 10137 NASH PEAK AVE LAS VEGAS NV 89166 | 12613516044 |
| LOMIS JENNIFER W | EDMONDSON BRADLEY TYSON 10224 DANSKIN DR LAS VEGAS NV 89166-2504 | 12613519034 |
| LONG DONNY J & AMANDA C | 10448 WHITE PRINCESS AVE LAS VEGAS NV 89156 | 12613513004 |
| LOPEZ SUZETTE & SIDENY P | 10257 HEADRICK DR LAS VEGAS NV 89166 | 12613517011 |
| LOTRUGLIO GABRIELA SOLEDAD | 10239 DANSKIN DR LAS VEGAS NV 89166 | 12613519013 |
| LOWE DAVID E | 7915 TORREYS PEAK ST LAS VEGAS NV 89166-5076 | 12613114018 |
| LUNA JAMIE | 3901 LARKCREST ST LAS VEGAS NV 89129 | 12613519015 |
| LUNSFORD ANDREW N & RHONDA K | 10415 PRAIRIE MOUNTAIN AVE LAS VEGAS NV 89166 | 12613513077 |

Report of All Selected ParcelsCase Number:VAR-66354, VAR-66355
~~MOD-66199, VAR-66346~~Printed On: Mon: September 12, 2016

| <u>Owner</u> | <u>Address</u> | <u>Parcel Number</u> |
|----------------------------------|--|----------------------|
| LUTTMAN AARON B & SUSANNAH I | 10128 IRON WOOD PEAK AVE LAS VEGAS NV 89166-5216 | 12613516051 |
| LYON CHARLES & SANDRA | 10263 DANSKIN DR LAS VEGAS NV 89166-2506 | 12613520003 |
| LYPKA SANDRA J TRUST | LYPKA SANDRA J TRS 10248 GLADSTONE PEAK ST LAS VEGAS NV 89166-5209 | 12613616014 |
| MACK MORGAN & IRENE | 10240 DANSKIN DR LAS VEGAS NV 89166 | 12613519042 |
| MADILL MICHAEL | 10513 BAUDERA MOUNTAIN LN LAS VEGAS NV 89166 | 12613113027 |
| MADISON COLONY AT PROVIDENCE HOA | P O BOX 12117 LAS VEGAS NV 89112-0117 | 12613519057 |
| MADISON COLONY AT PROVIDENCE HOA | 1820 E SAHARA AVE #101 LAS VEGAS NV 89104-3736 | 12613518021 |
| MADISON COLONY AT PROVIDENCE HOA | 1820 E SAHARA AVE #101 LAS VEGAS NV 89104-3736 | 12613518018 |
| MADISON COLONY AT PROVIDENCE HOA | 1820 E SAHARA AVE #101 LAS VEGAS NV 89104-3736 | 12613518020 |
| MADISON COLONY AT PROVIDENCE HOA | P O BOX 12117 LAS VEGAS NV 89112-0117 | 12613517055 |
| MADISON COLONY AT PROVIDENCE HOA | 1820 E SAHARA AVE #101 LAS VEGAS NV 89104-3736 | 12613518019 |
| MADISON COLONY PROVIDENCE H O A | P O BOX 12117 LAS VEGAS NV 89112-0117 | 12613517056 |
| MAGALLANES ANTHONY | 7485 ASKEW PL LAS VEGAS NV 89166 | 12613518016 |
| MALINIEMI TONI MARIE ZAMORA | 7736 SUNDIAL PEAK ST LAS VEGAS NV 89166-5006 | 12613615004 |
| MAPOY MARIA L | 10453 TURTLE MOUNTAIN AVE LAS VEGAS NV 89166-5081 | 12613114009 |
| MARCHESE DIANE | 10241 HEADRICK DR LAS VEGAS NV 89166-2500 | 12613517019 |
| MARCU ANDREW DAVID | DONG THUY-XUAN THI 17419 119TH LN SE #E-24 RENTON WA 98058 | 12613114001 |
| MARKIEWITZ LEAH & JONATHAN | 10425 WHITE PRINCESS AVE LAS VEGAS NV 89166 | 12613513043 |
| MARKLEY ALICIA D & JONATHON I | 10421 MOUNT WASHINGTON AVE LAS VEGAS NV 89166 | 12613513097 |
| MARTIN JEFFREY & MANDY | 10427 TURTLE MOUNTAIN AVE LAS VEGAS NV 89166 | 12613513034 |
| MARTIN KELLY RANDOLPH | 10289 GIBSON ISLE DR LAS VEGAS NV 89166 | 12613522003 |
| MARTIN MICHAEL J | 10236 HEADRICK DR LAS VEGAS NV 89166-2501 | 12613517037 |
| MARTIN STACY | RICHARDS BRYAN 7742 EAGLE ROCK PEAK CT LAS VEGAS NV 89166-5222 | 12613616032 |
| MARTINEZ DANIEL & CHELSIE NOEL | 10422 WHITE PRINCESS AVE LAS VEGAS NV 89166 | 12613513010 |
| MARTINEZ JOSE G & SANDRA M | 10232 GLADSTONE PEAK ST LAS VEGAS NV 89166 | 12613616018 |
| MARTINEZ PEDRO D | 7847 TORREYS PEAK ST LAS VEGAS NV 89166-5076 | 12613114011 |
| MAYS WILLIAM TRUST | MAYS WILLIAM B TRS 7742 RHODORA PEAK ST LAS VEGAS NV 89166-5212 | 12613616057 |
| MARTHUR MICHELLE | HOGAN FRANCES 10144 HAYMARKET PEAK AVE LAS VEGAS NV 89166-5217 | 12613516061 |
| MCDANEL JENNIFER | 10407 GROTTO MOUNTAIN AVE LAS VEGAS NV 89166 | 12613514027 |
| MCDOWELL MARIO | 7815 CASTLE ROCK PEAK ST LAS VEGAS NV 89166-5215 | 12613516010 |
| MCGEE MICHELLE | 10136 NASH PEAK AVE LAS VEGAS NV 89166-5213 | 12613516023 |
| MCKINNEY STEPHEN R | JYDSTRUP-MCKINNEY ANDREA M 10441 MT WASHINGTON AVE LAS VEGAS NV 89166-5057 | 12613513092 |

Report of All Selected Parcels**Case Number:****VAR-66354, VAR-66355**
~~MOD-66198, VAR-66346~~**Printed On:** Mon: September 12, 2016

| Owner | Address | Parcel Number |
|----------------------------------|--|----------------------|
| MCLEAN NATHAN D & KAREN J | 10139 HAYMARKET PEAK AVE LAS VEGAS NV 89166-5217 | 12613516005 |
| MCNEEL RODNEY J SR | 10216 GIBSON ISLE DR LAS VEGAS NV 89166-2508 | 12613521016 |
| MECKE ANNE | 10247 GLADSTONE PEAK ST LAS VEGAS NV 89166-5209 | 12613616011 |
| MELJER ANNEKE & CHARLES FREDERIK | LOPEZ FRANCESCA JOSEPHINE MELJER 7939 TORREYS PEAK ST LAS VEGAS NV 89166 | 12613114003 |
| MENDEZ FAMILY TRUST | MENDEZ LUIS T & LAURA O 10420 RUGGED MOUNTAIN AVE LAS VEGAS NV 89166-5015 | 12613615049 |
| MENDOZA RONALDO S & EVANGELINE L | 10504 WHITE PRINCESS AVE LAS VEGAS NV 89166 | 12613513001 |
| MENESES MARTIN G & STELLA | 10029 ARTISTIC WALK AVE LAS VEGAS NV 89149-3767 | 12518111051 |
| MEZA ALFREDO | 10226 DEADRICK DR LAS VEGAS NV 89166 | 12613517032 |
| MEZA ANNA LIZA RUANTO | 10442 PRAIRIE MOUNTAIN AVE LAS VEGAS NV 89166 | 12613513053 |
| MITCHELL ETHYL L | 10211 GIBSON ISLE DR LAS VEGAS NV 89166 | 12613521011 |
| MIYAMA BRUCE D | 7748 SUNDIAL PEAK ST LAS VEGAS NV 89166-5006 | 12613615001 |
| MOHLER FAMILY REVOCABLE LIV TR | MOHLER WILLIAM S & GERALDINE TRS 10332 RUGGED MOUNTAIN AVE LAS VEGAS NV 89166-5014 | 12613615043 |
| MOLINA MARCOS A JR & REBEKAH M | 10220 DANSKIN DR LAS VEGAS NV 89166 | 12613519032 |
| MONTENEGRO RAY M & VICTORIA | 7953 POINT POWELL CT LAS VEGAS NV 89166-5067 | 12613513006 |
| MONTOJO ALICIA | 10438 GROTTTO MOUNTAIN AVE LAS VEGAS NV 89166 | 12613514006 |
| MOODIE ANDREA E | 7746 TREE LANE PEAK CT LAS VEGAS NV 89166-5219 | 12613616038 |
| MOORE JOHN P & MARY E | 10437 TURTLE MOUNTAIN AVE LAS VEGAS NV 89166-5081 | 12613513035 |
| MORA PATRICIA | 10551 HEDGE VIEW AVE LAS VEGAS NV 89129-3318 | 12613616072 |
| MORAN CODY L | 10450 MOUNT WASHINGTON AVE LAS VEGAS NV 89166-5057 | 12613513067 |
| MORDINI MICHAEL D & ROSANA C | 10434 MOUNT WASHINGTON AVE LAS VEGAS NV 89166-5056 | 12613513071 |
| MORTON WAYNE R | 10223 HEADRICK DR LAS VEGAS NV 89166-2501 | 12613517028 |
| MUIR ERIC A & ALIW S | 10265 HEADRICK DR LAS VEGAS NV 89166-2502 | 12613517007 |
| MURPHY MICHAEL B & MEGAN | 10120 IRON WOOD PEAK AVE LAS VEGAS NV 89166-5216 | 12613516053 |
| MUSINSKI MICHAEL | 7911 TORREYS PEAK ST LAS VEGAS NV 89166-5076 | 12613114017 |
| MYAGMARKHUU AMARBOLD & SHELAH | 7941 REED PEAK ST LAS VEGAS NV 89166-5066 | 12613513057 |
| MYROLD JESSICA & ERIC | 10132 IRON WOOD PEAK AVE LAS VEGAS NV 89166 | 12613516050 |
| NEIGHOFF HEATH ADAM | 10133 IRON WOOD PEAK AVE LAS VEGAS NV 89166-5216 | 12613516057 |
| NELSON DOUGLAS BRUCE & BRIDGET M | 10412 BAYS MOUNTAIN AVE LAS VEGAS NV 89166-5002 | 12613514033 |
| NELSON MICHAEL | 10129 IRON WOOD PEAK AVE LAS VEGAS NV 89166-5216 | 12613516056 |
| NERI CHRISTOPHER M & TIFFANY M | 10436 TURTLE MOUNTAIN AVE LAS VEGAS NV 89166-5081 | 12613513106 |
| NESS STEVEN K | 7738 EAGLE ROCK PEAK CT LAS VEGAS NV 89166-5222 | 12613616033 |

Report of All Selected Parcels**Case Number:**VAR-66354, VAR-66355
~~MOD-00199, VAR-66346~~**Printed On:** Mon: September 12, 2016

| <u>Owner</u> | <u>Address</u> | <u>Parcel Number</u> |
|----------------------------------|---|----------------------|
| NEVAREZ JIMMY & NICOLE T | 7859 TORREYS PEAK ST LAS VEGAS NV 89166-5076 | 12613114014 |
| NEVAREZ ZACARIAS | 10269 GIBSON ISLE DR LAS VEGAS NV 89166 | 12613522008 |
| NG KENNETH | 10028 MADISON WALK AVE LAS VEGAS NV 89149-3771 | 12518111023 |
| NGUYEN NANCY & RUDY | 10202 GIBSON ISLE DR LAS VEGAS NV 89166-2508 | 12613521012 |
| NIDAY KOLIN L | UMFLEET JEANMARIE 10206 GIBSON ISLE DR LAS VEGAS NV 89166-2508 | 12613521013 |
| NIELSON MARJEAN | 3901 GRIFBRICK DR PLANO TX 75075 | 12613514036 |
| NOMURA FRANK & FRANCES Y FAM TR | NOMURA FRANK S & FRANCES Y TRS 10121 IRON WOOD PEAK AVE LAS VEGAS NV 89166-5216 | 12613516054 |
| NORTHERN TERRACE H O A | 7610 SILVER RUN PEAK LAS VEGAS NV 89166 | 12613214061 |
| NORTHERN TERRACE HOMEOWNERS ASSO | 7610 SILVER RUN PEAK DR LAS VEGAS NV 89166 | 12613114021 |
| NORTHERN TERRACE HOMEOWNERS ASSO | 7610 SILVER RUN PEAK DR LAS VEGAS NV 89166 | 12613514040 |
| NORTHERN TERRACE HOMEOWNERS ASSO | 7610 SILVER RUN PEAK DR LAS VEGAS NV 89166 | 12613513127 |
| NORTHERN TERRACE HOMEOWNERS ASSO | 7610 SILVER RUN PEAK DR LAS VEGAS NV 89166 | 12613513124 |
| NORTHERN TERRACE HOMEOWNERS ASSO | 7610 SILVER RUN PEAK DR LAS VEGAS NV 89166 | 12613114022 |
| NORTHERN TERRACE HOMEOWNERS ASSO | 7610 SILVER RUN PEAK DR LAS VEGAS NV 89166 | 12613513114 |
| NORTHERN TERRACE HOMEOWNERS ASSO | 7610 SILVER RUN PEAK DR LAS VEGAS NV 89166 | 12613114024 |
| NORTHERN TERRACE HOMEOWNERS ASSO | 7610 SILVER RUN PEAK DR LAS VEGAS NV 89166 | 12613513117 |
| NORTHERN TERRACE HOMEOWNERS ASSO | 7610 SILVER RUN PEAK DR LAS VEGAS NV 89166 | 12613615050 |
| NORTHERN TERRACE HOMEOWNERS ASSO | 7610 SILVER RUN PEAK DR LAS VEGAS NV 89166 | 12613513118 |
| NORTHERN TERRACE HOMEOWNERS ASSO | 7610 SILVER RUN PEAK DR LAS VEGAS NV 89166 | 12613513116 |
| NORTHERN TERRACE HOMEOWNERS ASSO | 7610 SILVER RUN PEAK DR LAS VEGAS NV 89166 | 12613512002 |
| NORTHERN TERRACE HOMEOWNERS ASSO | 7610 SILVER RUN PEAK DR LAS VEGAS NV 89166 | 12613514042 |
| NORTHERN TERRACE HOMEOWNERS ASSO | 7610 SILVER RUN PEAK DR LAS VEGAS NV 89166 | 12613113137 |
| NORTHERN TERRACE HOMEOWNERS ASSO | 7610 SILVER RUN PEAK DR LAS VEGAS NV 89166 | 12613513120 |
| NORTHERN TERRACE HOMEOWNERS ASSO | 7610 SILVER RUN PEAK DR LAS VEGAS NV 89166 | 12613114020 |
| NORTHERN TERRACE HOMEOWNERS ASSO | 7610 SILVER RUN PEAK DR LAS VEGAS NV 89166 | 12613513119 |
| NORTHERN TERRACE HOMEOWNERS ASSO | 7610 SILVER RUN PEAK DR LAS VEGAS NV 89166 | 12613513112 |
| NORTHERN TERRACE HOMEOWNERS ASSO | 7610 SILVER RUN PEAK DR LAS VEGAS NV 89166 | 12613513126 |
| NORTHERN TERRACE HOMEOWNERS ASSO | 7610 SILVER RUN PEAK DR LAS VEGAS NV 89166 | 12613513113 |
| NORTHERN TERRACE HOMEOWNERS ASSO | 7610 SILVER RUN PEAK DR LAS VEGAS NV 89166 | 12613113138 |
| NORTHERN TERRACE HOMEOWNERS ASSO | 7610 SILVER RUN PEAK DR LAS VEGAS NV 89166 | 12613514038 |
| NORTHERN TERRACE HOMEOWNERS ASSO | 7610 SILVER RUN PEAK DR LAS VEGAS NV 89166 | 12613513123 |

Report of All Selected Parcels**Case Number:****VAR-66354, VAR-66355**
~~MOD-66400, VAR-66346~~**Printed On:** Mon: September 12, 2016

| <u>Owner</u> | <u>Address</u> | <u>Parcel Numbe</u> |
|----------------------------------|---|---------------------|
| NORTHERN TERRACE HOMEOWNERS ASSO | 7610 SILVER RUN PEAK DR LAS VEGAS NV 89166 | 12613514041 |
| NORTHERN TERRACE HOMEOWNERS ASSO | 7610 SILVER RUN PEAK DR LAS VEGAS NV 89166 | 12613513115 |
| NORTHERN TERRACE HOMEOWNERS ASSO | 7610 SILVER RUN PEAK DR LAS VEGAS NV 89166 | 12613615051 |
| NORTHERN TERRACE HOMEOWNERS ASSO | 7610 SILVER RUN PEAK DR LAS VEGAS NV 89166 | 12613615053 |
| NORTHERN TERRACE HOMEOWNERS ASSO | 7610 SILVER RUN PEAK DR LAS VEGAS NV 89166 | 12613514039 |
| NORTHERN TERRACE HOMEOWNERS ASSO | 7610 SILVER RUN PEAK DR LAS VEGAS NV 89166 | 12613513121 |
| NORTHERN TERRACE HOMEOWNERS ASSO | 7610 SILVER RUN PEAK DR LAS VEGAS NV 89166 | 12613513125 |
| NORTHERN TERRACE HOMEOWNERS ASSO | 7610 SILVER RUN PEAK DR LAS VEGAS NV 89166 | 12613611014 |
| NORTHERN TERRACE HOMEOWNERS ASSO | 7610 SILVER RUN PEAK DR LAS VEGAS NV 89166 | 12613513111 |
| NORTHERN TERRACE HOMEOWNERS ASSO | 7610 SILVER RUN PEAK DR LAS VEGAS NV 89166 | 12613513122 |
| NORTHERN TERRACE HOMEOWNERS ASSO | 7610 SILVER RUN PEAK DR LAS VEGAS NV 89166 | 12613513128 |
| NORTHERN TERRACE HOMEOWNERS ASSO | 7610 SILVER RUN PEAK DR LAS VEGAS NV 89166 | 12613114023 |
| NYGARD RITA | WALSH JUNE 5701 BIA RT1 POPLAR MT 59255-9441 | 12613514025 |
| O GROUP L L C | 10235 HEADRICK DR LAS VEGAS NV 89166 | 12613517022 |
| OELHOFFEN DALE | 6550 GRAND COURSE ST LAS VEGAS NV 89166 | 12613513012 |
| OLAGUE MIGUEL | DUNCAN-OLAGUE CHERYL 7937 REED PEAK ST LAS VEGAS NV 89166 | 12613513056 |
| OLIVE JENNIFER | 10221 DANSKIN DR LAS VEGAS NV 89166-2504 | 12613519022 |
| OLIVEIRA STEPHEN M JR | VERNON ALEXIS N 10316 RUGGED MOUNTAIN AVE LAS VEGAS NV 89166-5014 | 12613615040 |
| OLSEN COLBY E & MARILEE | 10272 HEADRICK DR LAS VEGAS NV 89166-2503 | 12613517054 |
| O'REILLY SEAN P | 10212 DANSKIN DR LAS VEGAS NV 89166-2504 | 12613519028 |
| ORR REBECCA | 7857 ASKEW PL LAS VEGAS NV 89166-1200 | 12613518010 |
| ORTIZ TRICIA ANN & ENRIQUE | 10024 VILLAGE WALK AVE LAS VEGAS NV 89149 | 12518111048 |
| OYER THOMAS G & SALLY J | 10407 TURTLE MOUNTAIN AVE LAS VEGAS NV 89166-5080 | 12613513029 |
| PAGE BRIAN M | 7904 AIROLA PEAK ST LAS VEGAS NV 89166-5021 | 12613513024 |
| PAIO IRENE C & RAYMOND F | 10268 HEADRICK DR LAS VEGAS NV 89166 | 12613517052 |
| PALM PETER | BARONE-PALM RONDA 10032 SCENIC WALK AVE LAS VEGAS NV 89149-3774 | 12518111088 |
| PANO CONSTANTIN | 10227 HEADRICK DR LAS VEGAS NV 89166-2501 | 12613517026 |
| PASSALACQUA EDWARD P & JOAN P | 7823 SUGARLOAF PEAK ST LAS VEGAS NV 89166-5019 | 12613514004 |
| PASSALACQUA MATTHEW & CHRISTINE | 10211 BLUE WATER AVE LAS VEGAS NV 89166 | 12613616073 |
| PERCOSKI WILLIAM D | 10433 WHITE PRINCESS AVE LAS VEGAS NV 89166 | 12613513041 |
| PEREZ CLARISSA | 10503 MOUNT WASHINGTON AVE LAS VEGAS NV 89166-5057 | 12613513088 |
| PERRYMAN J ALLEN & GLENDA L | 7735 SUGARLOAF PEAK ST LAS VEGAS NV 89166-5020 | 12613615026 |

Report of All Selected Parcels**Case Number:**~~VAR-66354~~ VAR-66355
~~VAR-66354~~**Printed On:** Mon: September 12, 2016

| <u>Owner</u> | <u>Address</u> | <u>Parcel Number</u> |
|-------------------------------|---|----------------------|
| PERRYMAN J ALLEN & GLENDA L | 7735 SUGARLOAF PEAK ST LAS VEGAS NV 89166-5020 | 12613615027 |
| PETERSON CHRIS & KELLI | 10025 VILLAGE WALK AVE LAS VEGAS NV 89149 | 12518111043 |
| PETERSON FAMILY TRUST | PETERSON LAWRENCE TRS 200 ROLAND WILEY RD LAS VEGAS NV 89145 | 12613517039 |
| PETERSON GARY | 10415 TURTLE MOUNTAIN AVE LAS VEGAS NV 89166 | 12613513031 |
| PHILLIPS CORY RUSSELL | 7741 AMBERWOOD PEAK CT LAS VEGAS NV 89166-5220 | 12613616044 |
| PHILLIPS LARRY & SARAH | 10255 DANSKIN DR LAS VEGAS NV 89166-2506 | 12613520005 |
| PHYLCON INC | 3235 S RAINBOW #101 LAS VEGAS NV 89146-6215 | 12613501021 |
| PICHOTTA MICHAEL | 10272 GIBSON ISLE DR LAS VEGAS NV 89166 | 12613522017 |
| PIPPIN GARY & KAREN B | 587 NE 19TH AVE HILLSBORO OR 97124 | 12613513030 |
| PLETINSKAYA EKATERINA V | 10252 GLADSTONE PEAK ST LAS VEGAS NV 89166-5209 | 12613616013 |
| POTOCZNY PAWEL M & JAEL W | 10261 GIBSON ISLE DR LAS VEGAS NV 89166 | 12613522010 |
| PRATER DENNIS & KIMBERLY | 10136 HAYMARKET PEAK AVE LAS VEGAS NV 89166-5217 | 12613516063 |
| PRICE COLE S | 10229 DANSKIN DR LAS VEGAS NV 89166-2505 | 12613519018 |
| PRIKHODKO VITALIY P & GANNA N | 10144 NASH PEAK AVE LAS VEGAS NV 89166-5213 | 12613516021 |
| R J E LIVING TRUST | EDGE ROSEMARY J TRS 10414 MOUNT WASHINGTON AVE LAS VEGAS NV 89166 | 12613513076 |
| RABAH RAFFI D | 7907 TORREYS PEAK ST LAS VEGAS NV 89149 | 12613114016 |
| RACHMAT BAYU | YANTI FNU 10214 GIBSON ISLE DR LAS VEGAS NV 89166-2508 | 12613521015 |
| RAFFONE EVELINA & HUGO | 10331 BAYS MOUNTAIN AVE LAS VEGAS NV 89166-5001 | 12613615038 |
| RAMIREZ ANTONIO & CECILIA B | 1233 LIBERTY BELL CHERRYHILL NJ 08003 | 12613616023 |
| RAMOS EDGAR P | SONGCO LINDSEY 10233 DANSKIN DR LAS VEGAS NV 89166 | 12613519016 |
| RAMOS STEVEN R | 7734 TREE LANE PEAK CT LAS VEGAS NV 89166-5219 | 12613616041 |
| RAY BARBARA | 10124 HAYMARKET PEAK AVE LAS VEGAS NV 89166-5217 | 12613516066 |
| RECLOSADO MICHELLE L | 10130 HARTFORD PEAK CT LAS VEGAS NV 89166-5218 | 12613616055 |
| RENKEN MICHAEL & ROBIN | 7940 TORREY PEAK ST LAS VEGAS NV 89166 | 12613513058 |
| REYNA DAVID R & JEANINE N | 7912 AIROLA PEAK ST LAS VEGAS NV 89166 | 12613513022 |
| REYNOSO SAUL | 7842 ASKEW PL LAS VEGAS NV 89166 | 12613518004 |
| RHYMER PRESTON L & COURTNEY L | P S C 50 BOX 541 APO AE 09494 | 12613514015 |
| RICE CRAIG M & ELIZABETH A | 10147 HAYMARKET PEAK AVE LAS VEGAS NV 89166-5217 | 12613516007 |
| RIVER GLIDER AVENUE TRUST | 900 S LAS VEGAS BLVD #810 LAS VEGAS NV 89101-6850 | 12613517027 |
| RIVERA CARLOS R & CINDE J | 10406 WHITE PRINCESS AVE LAS VEGAS NV 89166-5084 | 12613513014 |
| ROBINSON MONIQUE M | 10430 WHITE PRINCESS AVE LAS VEGAS NV 89166 | 12613513008 |
| RODAS-PINOCHET FAMILY TRUST | RODAS PINOCHET CARMEN A TRS 10429 WHITE PRINCESS AVE LAS VEGAS NV 89166 | 12613513042 |

Report of All Selected ParcelsCase Number:VAR-66354, VAR-66355
~~MOD-00199, VAR-00340~~Printed On: Mon: September 12, 2016

| <u>Owner</u> | <u>Address</u> | <u>Parcel Number</u> |
|----------------------------------|---|----------------------|
| RODRIGUEZ JANE R | 10240 BLUE WATER PEAK AVE LAS VEGAS NV 89166-5211 | 12613616007 |
| RODRIGUEZ-ANCHANTE CECILIA D | CHANG-WONG MIGUEL F 10240 GIBSON ISLE DR LAS VEGAS NV 89166-2509 | 12613521022 |
| ROLLINS SCOTT S & LADONNA K | 1677 DODGE RD ELLENBURG WA 98920 | 12613615045 |
| ROMAN OSCAR E | PETERSON STACY R 7827 SUGARLOAF PEAK ST LAS VEGAS NV 89166-5019 | 12613514005 |
| ROMANO KRYSTLYNN C & CHRISTOPHER | 7851 TORREYS PEAK ST LAS VEGAS NV 89166-5076 | 12613114012 |
| ROMER TRUST | ROMER PRISCILLA M TRS 3891 PURPLE PLUM CT LAS VEGAS NV 89147 | 12613517004 |
| ROMER TRUST | ROMER PRISCILLA M TRS 3891 PURPLE PLUM CT LAS VEGAS NV 89147 | 12613522002 |
| ROMER TRUST | ROMER PRISCILLA M TRS 3891 PURPLE PLUM CT LAS VEGAS NV 89147 | 12613517003 |
| ROSS FAMILY REVOCABLE LIVING TRU | ROSS LINDA JENNEY & KENNETH M TR 7855 ASKEW PL LAS VEGAS NV 89166 | 12613518011 |
| RUEGER LORI J | 7817 ASKEW PL LAS VEGAS NV 89166 | 12613517001 |
| RUSSELL DONALD J III & ANGELINA | 10256 HEADRICK DR LAS VEGAS NV 89166-2502 | 12613517046 |
| RUSZCZYK ROBERT & CYNTHIA | 7741 FORTRESS PEAK CT LAS VEGAS NV 89166-5221 | 12613616021 |
| RUZICKA AMANDA J | 10203 BLUE WATER PEAK AVE LAS VEGAS NV 89166-5211 | 12613616071 |
| RYLAND HOMES NEVADA L L C | 8925 W RUSSELL RD #200 LAS VEGAS NV 89148 | 12613513105 |
| RYLAND HOMES NEVADA L L C | 8925 W RUSSELL RD #200 LAS VEGAS NV 89148 | 12613513059 |
| RYLAND HOMES NEVADA L L C | 8925 W RUSSELL RD #200 LAS VEGAS NV 89148 | 12613513101 |
| RYLAND HOMES NEVADA L L C | 8925 W RUSSELL RD #200 LAS VEGAS NV 89148 | 12613513060 |
| RYLAND HOMES NEVADA L L C | 8925 W RUSSELL RD #200 LAS VEGAS NV 89148 | 12613513082 |
| RYLAND HOMES NEVADA L L C | 8925 W RUSSELL RD #200 LAS VEGAS NV 89148 | 12613513103 |
| RYLAND HOMES NEVADA L L C | 8925 W RUSSELL RD #200 LAS VEGAS NV 89148 | 12613513098 |
| RYLAND HOMES NEVADA L L C | 8925 W RUSSELL RD #200 LAS VEGAS NV 89148 | 12613513094 |
| RYLAND HOMES NEVADA L L C | 8925 W RUSSELL RD #200 LAS VEGAS NV 89148 | 12613513095 |
| RYLAND HOMES NEVADA L L C | 8925 W RUSSELL RD #200 LAS VEGAS NV 89148 | 12613513096 |
| RYLAND HOMES NEVADA L L C | 8925 W RUSSELL RD #200 LAS VEGAS NV 89148 | 12613513104 |
| RYLAND HOMES NEVADA L L C | 8925 W RUSSELL RD #200 LAS VEGAS NV 89148 | 12613513033 |
| SADLE KEVIN & KAREN | 7743 TREE LANE PEAK CT LAS VEGAS NV 89166 | 12613616037 |
| SAHARA WRIGHT L L C | 8635 W SAHARA AVE #100 LAS VEGAS NV 89117 | 12613518014 |
| SAIN RANDY W & MARIA T | P S C 10 BOX 1658 APO AE 09142 | 12613615044 |
| SALAZAR JOSE & MARISOL | 7742 FORTRESS PEAK CT LAS VEGAS NV 89166-5221 | 12613616024 |
| SALVATION ARMY | 180 E OCEAN BLVD LONG BEACH CA 90802 | 12613114008 |
| SAMMARCO ROSSI & SUSAN | 7741 EAGLE ROCK PEAK CT LAS VEGAS NV 89166 | 12613616029 |
| SAMUELS RICHARD & MARY-MARGARET | 10422 GROTTO MOUNTAIN AVE LAS VEGAS NV 89166-5008 | 12613514010 |

Report of All Selected Parcels**Case Number:****VAR-66354, VAR-66355**
~~MOB-88199, VAR-88846~~**Printed On:** Mon: September 12, 2016

| Owner | Address | Parcel Number |
|---------------------------------|--|----------------------|
| SANCHEZ MIGUEL A & ELVA L | 7932 AIROLA PEAK ST LAS VEGAS NV 89166-5021 | 12613513017 |
| SANDERS VICTORIA | 10251 DANSKIN DR LAS VEGAS NV 89166-2506 | 12613520006 |
| SANGUINETTI CAROL POMBO | 10312 BUSH MOUNTAIN AVE LAS VEGAS NV 89166 | 12613520017 |
| SANTOS JUAN & MILAGROS | 7752 SUNDIAL PEAK ST LAS VEGAS NV 89166-5006 | 12613514021 |
| SATO REVOCABLE FAMILY TRUST | SATO ROBERT T & GAYLE N TRS 7728 SUNDIAL PEAK ST LAS VEGAS NV 89166-5006 | 12613615006 |
| SATO-HONDA REVOCABLE FAMILY TR | SATO KENNETH T TRS 7740 SUNDIAL PEAK ST LAS VEGAS NV 89166 | 12613615003 |
| SCALLY HEATHER | 10120 HAYMARKET PEAK AVE LAS VEGAS NV 89166-5217 | 12613516067 |
| SCHAIBLEY DEAN & ERICA L | 7747 SUGARLOAF PEAK ST LAS VEGAS NV 89166 | 12613615030 |
| SCHERER LOUISE & DAVID | 10268 DANSKIN DR LAS VEGAS NV 89166-2506 | 12613520015 |
| SCHROEDER JEFFREY J & LINDSAY N | 10141 NASH PEAK AVE LAS VEGAS NV 89166-5213 | 12613516045 |
| SCHUEBEL JASON M | 10025 SCENIC WALK AVE LAS VEGAS NV 89149-3774 | 12518111085 |
| SECTION 12 L L C | 11411 SOUTHERN HIGHLANDS #300 LAS VEGAS NV 89141 | 12612000001 |
| SEGURA LORENA | GALLEGOS RICHARD 10508 WHITE PRINCESS AVE LAS VEGAS NV 89166 | 12613114007 |
| SEMINOLE FAMILY LIVING TRUST | 9974 RAMS LEAP AVE LAS VEGAS NV 89166 | 12613521024 |
| SEPULVEDA BOBBIE | 10257 GIBSON ISLE DR LAS VEGAS NV 89166 | 12613522011 |
| SERPA HECTOR & GIANNINA | 10239 BLUE WATER PEAK AVE LAS VEGAS NV 89166-5211 | 12613616002 |
| SHAKERI CYRUS & KIMM M | 10218 DANSKIN DR LAS VEGAS NV 89166-2504 | 12613519031 |
| SHEER RONALD E & KATHLEEN M | 10156 NASH PEAK AVE LAS VEGAS NV 89166-5214 | 12613516018 |
| SHERMAN ANDREW | 10445 WHITE PRINCESS AVE LAS VEGAS NV 89166 | 12613513038 |
| SHRIVER CHRISTOPHER | 10140 NASH PEAK AVE LAS VEGAS NV 89166-5213 | 12613516022 |
| SILVERMAN SORAYA | 10221 GIBSON ISLE DR LAS VEGAS NV 89166-2508 | 12613521008 |
| SKAGGS JOSEPH G & BRENDA L | 6680 FARM RD LAS VEGAS NV 89131 | 12613516019 |
| SLATSKY MARTIN | 10033 SCENIC WALK AVE LAS VEGAS NV 89149-3774 | 12518111087 |
| SMITH ANTHONY J | RELOS DAVID C 10428 BAYS MOUNTAIN AVE LAS VEGAS NV 89166-5002 | 12613514037 |
| SMITH JENNIFER THERESA | 10155 HAYMARKET PEAK AVE LAS VEGAS NV 89166-5217 | 12613516009 |
| SMITH RONALD L & CHONG H | 10219 BLUE WATER PEAK AVE LAS VEGAS NV 89166 | 12613616075 |
| SNODGRASS THEODORE III | 10136 IRON WOOD PEAK AVE LAS VEGAS NV 89166-5216 | 12613516049 |
| SOKO TRUST | SOKOLOWSKI NICHOLAS R SR TRS 9933 MAGIC DUNES LAS VEGAS NV 89149-1948 | 12518111053 |
| SOMMER COLE ALBERT & KELLI S | 7738 TREE LANE PEAK CT LAS VEGAS NV 89166-5219 | 12613616040 |
| SPIECE DARREN M | HILGER JENNY L 10264 GIBSON ISLE DR LAS VEGAS NV 89166 | 12613522015 |
| SPREDEMAN LORI A | 7724 SUNDIAL PEAK ST LAS VEGAS NV 89166 | 12613615007 |
| SPRINGHETTI MARK R & CARINA I | 10438 MOUNT WASHINGTON AVE LAS VEGAS NV 89166-5057 | 12613513070 |

Report of All Selected ParcelsCase Number:VAR-66354 VAR-66355
~~MOD-66499, VAR-66346~~Printed On: Mon: September 12, 2016

| <u>Owner</u> | <u>Address</u> | <u>Parcel Numbe</u> |
|----------------------------------|--|---------------------|
| SPROULE SCOTT LIVING TRUST | 33216 ELDRROW RD AGUA DULCE CA 91390 | 12613518006 |
| STINEHOUR JASON A | 10215 DANSKIN DR LAS VEGAS NV 89166-2504 | 12613519025 |
| STOKER NICHOLAS K & DEBBY A | 7936 FARRALON RIDGE CT LAS VEGAS NV 89149-3769 | 12518111058 |
| STOUT RANDY L | 7739 SUGARLOAF PEAK ST LAS VEGAS NV 89166-5020 | 12613615028 |
| STUTZMAN WILLIAM P | 10132 HAYMARKET PEAK AVE LAS VEGAS NV 89166-5217 | 12613516064 |
| SUAN CECILIA C | SIGA AVELINO P JR 7733 AMBERWOOD PEAK AVE LAS VEGAS NV 89166 | 12613616042 |
| SULLIVAN DANIEL J & AMANDA Y | 10244 GIBSON ISLE DR LAS VEGAS NV 89166-2509 | 12613521023 |
| SUMMIT PROVIDENCE L L C | 3425 CLIFF SHADOWS PKWY #110 LAS VEGAS NV 89129 | 12613214009 |
| SUMMIT PROVIDENCE L L C | 3425 CLIFF SHADOWS PKWY #110 LAS VEGAS NV 89129 | 12613214007 |
| SUMMIT PROVIDENCE L L C | 3425 CLIFF SHADOWS PKWY #110 LAS VEGAS NV 89129 | 12613214008 |
| SUMMIT PROVIDENCE L L C | 3425 CLIFF SHADOWS PKWY #110 LAS VEGAS NV 89129 | 12613214004 |
| SUMMIT PROVIDENCE L L C | 3425 CLIFF SHADOWS PKWY #110 LAS VEGAS NV 89129 | 12613214005 |
| SUMMIT PROVIDENCE L L C | 3425 CLIFF SHADOWS PKWY #110 LAS VEGAS NV 89129 | 12613214006 |
| SUMO PROPERTIES L L C | 7120 SMOKE RANCH RD LAS VEGAS NV 89128-3157 | 12613514022 |
| SURIANO ANDREW JAMES RUDOLPH REV | SURIANO ANDREW JAMES RUDOLPH TRS 10271 DANSKIN DR LAS VEGAS NV 89166-2506 | 12613520001 |
| SWALWELL TRAVIS | 10241 GIBSON ISLE DR LAS VEGAS NV 89166 | 12613521003 |
| SYLVESTER STEVEN | 10145 NASH PEAK AVE LAS VEGAS NV 89166-5213 | 12613516046 |
| TAN GIFFEN | 9120 HARBOR WIND AVE LAS VEGAS NV 89178 | 12613517050 |
| TANNER HOYT D | LAUCELLA EMILY 10328 RUGGED MOUNTAIN AVE LAS VEGAS NV 89166-5014 | 12613615042 |
| TEDDER RENE M | 7850 ASKEW PL LAS VEGAS NV 89166-1200 | 12613518008 |
| THISTLE ROBERT A & BRITTANY H | 10145 BLUE WATER PEAK AVE LAS VEGAS NV 89166-5210 | 12613616068 |
| THOMASON FRANCES LIVING TRUST | THOMASON FRANCES & TODD CO-TRS 7734 EAGLE ROCK PEAK CT LAS VEGAS NV 89166-5222 | 12613616034 |
| THOMPSON FAMILY TRUST | THOMPSON GEOFFREY & C CO-TRS 7806 SUNDIAL PEAK ST LAS VEGAS NV 89166-5006 | 12613514019 |
| THOMPSON MORGAN MERCEDES | 10281 GIBSON ISLE DR LAS VEGAS NV 89166 | 12613522005 |
| THORNE CHRISTOPHER A & MARIELLE | 7916 AIROLA PEAK ST LAS VEGAS NV 89166 | 12613513021 |
| THURMAN SHANE | 1781 MARGARITA LOOP ALAMOGORDO NM 88310 | 12613522024 |
| TINITIGAN FRANCESCA O | 10238 DANSKIN DR LAS VEGAS NV 89166 | 12613519041 |
| TISCOPA PROPERTIES L L C | 2629 VIA FIRENZE AVE HENDERSON NV 89044 | 12613521020 |
| TODD ALEXANDER & EVELYN | 7823 CASTLE ROCK PEAK ST LAS VEGAS NV 89166-5215 | 12613516012 |
| TOMCZYK AMY & BRIAN | 10420 TURTLE MOUNTAIN AVE LAS VEGAS NV 89166 | 12613513102 |
| TORBECK TYLER HARRISON | JORDAN ASHLY EMILY 7910 TORREYS PEAK ST LAS VEGAS NV 89166-5076 | 12613513065 |
| TORRECAMPO JEFFERSON & C S | 10236 GIBSON ISLE DR LAS VEGAS NV 89166-2509 | 12613521021 |

Report of All Selected Parcels**Case Number:****VAR-66354, VAR-66355**
~~MCD-66199, VAR-66346~~**Printed On:** Mon: September 12, 2016

| <u>Owner</u> | <u>Address</u> | <u>Parcel Numbe</u> |
|-------------------------------|---|---------------------|
| TORRES CHRISTIAN J | 7832 RHODORA PEAK ST LAS VEGAS NV 89166-5212 | 12613516032 |
| TOWNSEND BRIAN CHRISTOPHER SR | BREWER-TOWNSEND SHANELL 10421 WHITE PRINCESS AVE LAS VEGAS NV 89166 | 12613513044 |
| TRIVEDI ROHIT R | 38730 LEXINGTON ST #279 FREMONT CA 94536-6289 | 12613517005 |
| TROSS JAMES ROBERT & LYNN | 7926 TORREYS PEAK ST LAS VEGAS NV 89166 | 12613513061 |
| TURNER BRIAN & CAMILLE | 4209 N DUSTIN AVE FARMINGTON NM 87401 | 12613518012 |
| UNGER FERNE S TRUST | UNGER FERNE S TRS 7814 SUNDIAL PEAK ST LAS VEGAS NV 89166-5006 | 12613514017 |
| USON CORAZON T | 7836 RHODORA PEAK ST LAS VEGAS NV 89166-5212 | 12613516031 |
| VACA SALVADOR R & BETHZAIDA P | 21431 MORESBY WAY LAKE FOREST CA 92630 | 12613519014 |
| VALVO RUSSELL | SENYAHAN-VALVO SHEIRYL R 10211 DANSKIN DR LAS VEGAS NV 89166 | 12613519027 |
| VANSANT MATTHEW | 7903 TORREYS PEAK ST LAS VEGAS NV 89166-5076 | 12613114015 |
| VAZQUEZ LUZ M | KOSLOFF DYLAN 10419 TURTLE MOUNTAIN AVE LAS VEGAS NV 89166 | 12613513032 |
| VELANDRIA FLOREDELYN & RUEL | 10445 TURTLE MOUNTAIN AVE LAS VEGAS NV 89166-5081 | 12613513037 |
| VERLEY MATT & DEMARIS | 83428 RAGHORN RD SEASIDE OR 97138 | 12613517034 |
| VICK JONATHAN D & NAASHIA C | 10245 GIBSON ISLE DR LAS VEGAS NV 89166-2509 | 12613521002 |
| VOLDEN JOSEPH M | 10127 HAYMARKET PEAK AVE LAS VEGAS NV 89166 | 12613516002 |
| VOROS VICTORIA | 24157 MATTHEW PL NEWHALL CA 91321 | 12613518001 |
| VOSE SARAH E & JAKE T | 10227 BLUE WATER PEAK AVE LAS VEGAS NV 89166-5211 | 12613616077 |
| WAGNER TODD M | 10446 MOUNT WASHINGTON AVE LAS VEGAS NV 89166-5057 | 12613513068 |
| WALKER CHARLES SCOTT | 10422 MT WASHINGTON AVE LAS VEGAS NV 89166-5056 | 12613513074 |
| WALKER DANIEL | 10237 GIBSON ISLE DR LAS VEGAS NV 89166-2509 | 12613521004 |
| WARNACK JUSTIN D | 10112 NASH PEAK AVE LAS VEGAS NV 89166-5213 | 12613516029 |
| WARREN PATRICK J & JULIE M | 8560 W FISHER AVE LAS VEGAS NV 89149-4058 | 12613513016 |
| WASHINGTON ANGEL | 10133 NASH PEAK AVE LAS VEGAS NV 89166-5213 | 12613516043 |
| WATSON STEFAN JR | 10255 HEADRICK DR LAS VEGAS NV 89166 | 12613517012 |
| WCIORKA JUERGEN & MARLENE | 10409 BAYS MOUNTAIN AVE LAS VEGAS NV 89166-5002 | 12613615034 |
| WEAVER DAVID E & JILL C | 10220 GIBSON ISLE DR LAS VEGAS NV 89166-2508 | 12613521017 |
| WEBB JILLIAN G | 10137 BLUE WATER PEAK AVE LAS VEGAS NV 89166-5210 | 12613616066 |
| WELLS JOSHUA | 10244 GLADSTONE PEAK ST LAS VEGAS NV 89166-5209 | 12613616015 |
| WHIPPLE BRANDON & KRISTAL A | 10439 PRAIRIE MOUNTAIN AVE LAS VEGAS NV 89166 | 12613513083 |
| WHITE SHANTEL R | 10262 HEADRICK DR LAS VEGAS NV 89166-2502 | 12613517049 |
| WILHELM KAPUALEILANI TEAURE | P O BOX 271324 LAS VEGAS NV 89127-1324 | 12613517047 |
| WILLIAMS EBONY M | 10265 GIBSON ISLE DR LAS VEGAS NV 89166 | 12613522009 |

Report of All Selected Parcels**Case Number:**VAR-66354, VAR-66355
~~MOD-66198, VAR-66346~~**Printed On:** Mon: September 12, 2016

| <u>Owner</u> | <u>Address</u> | <u>Parcel Number</u> |
|----------------------------------|--|----------------------|
| WILLIAMS GLEN V REVOCABLE TRUST | WILLIAMS GLEN V TRS 5555 MICHELLI CREST WY LAS VEGAS NV 89149-0901 | 12613517030 |
| WILLIAMS JEFFREY S & MICHELLE R | 10249 HEADRICK DR LAS VEGAS NV 89166 | 12613517015 |
| WILLIAMS JOSHUA R & AMANDA A | 10228 GIBSON ISLE DR LAS VEGAS NV 89166-2509 | 12613521019 |
| WILSON JOHN M | GADLEY TEENA 10410 WHITE PRINCESS AVE LAS VEGAS NV 89166 | 12613513013 |
| WILSON THOMAS A LIVING TRUST | WILSON THOMAS A TRS 3510 LACROSS DR BRYANT AR 72022-9314 | 12613519024 |
| WILSTEAD ROBERT TAB & TAMARA MAR | 10444 TURTLE MOUNTAIN AVE LAS VEGAS NV 89166 | 12613513108 |
| WINBERG ROBERT C & DANICA M | 7819 ASKEW PL LAS VEGAS NV 89166 | 12613518003 |
| WOJDE ELZBIETA | 7756 SUNDIAL PEAK ST LAS VEGAS NV 89166-5006 | 12613514020 |
| WOLLENZIEN RICK D & HEATHER | 10247 DANSKIN DR LAS VEGAS NV 89166 | 12613520007 |
| WOOD ALAN GEORGE & LEE ANNE | 7921 FARRALON RIDGE CT LAS VEGAS NV 89149 | 12518111055 |
| WOOD SHAWN KIRKPATRIC & SHAUNA | 10236 GLADSTONE PEAK ST LAS VEGAS NV 89166-5209 | 12613616017 |
| WOODALL OSCAR J | 7810 SUNDIAL PEAK ST LAS VEGAS NV 89166-5006 | 12613514018 |
| WOODSIDE HOMES NEVADA L L C | 4670 S FORT APACHE RD #200 LAS VEGAS NV 89147 | 12507410004 |
| WOODSIDE MADISON COLONY L L C | 4730 S FORT APACHE RD #370 LAS VEGAS NV 89147-7948 | 12613522027 |
| WOODY GORDON E & MAY P VASQUEZ | P O BOX 671 MOUNTLAKE TERRACE WA 98043 | 12613522007 |
| WORLAND DANIEL J & LAURA C | 10116 NASH PEAK AVE LAS VEGAS NV 89166-5213 | 12613516028 |
| WRIGHT BARBARA J & DAVID | 7811 SUGARLOAF PEAK ST LAS VEGAS NV 89166 | 12613514001 |
| WRIGHT MARVIN & PAULETTE | 10454 PRAIRIE MOUNTAIN AVE LAS VEGAS NV 89166 | 12613513055 |
| WU JAMES C | 10224 GIBSON ISLE DR LAS VEGAS NV 89166-2508 | 12613521018 |
| WYATT JASON O | 10234 DANSKIN DR LAS VEGAS NV 89166 | 12613519039 |
| WYLLER LIVING TRUST | WYLLER ALF E & ARDYTH A TRS P O BOX 817 SHERWOOD OR 97140-0817 | 12613513020 |
| YANKEE REVOCABLE LIVING TRUST | 7840 BLUE LAKE PEAK ST LAS VEGAS NV 89166 | 12613113025 |
| YEH BING | 901 S FREMONT AVE #248 ALHAMBRA CA 91803-4706 | 12613517041 |
| YOUHTARENKO ANTON | 7904 FARRALON RIDGE CT LAS VEGAS NV 89149-3769 | 12518111062 |
| YUNIS JULIANA K & JONATHAN G | 10131 BLUE WATER PEAK AVE LAS VEGAS NV 89166-5210 | 12613616065 |
| ZAPANTA ERIC | 10223 DANSKIN DR LAS VEGAS NV 89166-2504 | 12613519021 |
| ZORN ZACHARY L & JESSICA B | 10426 MT WASHINGTON AVE LAS VEGAS NV 89166-5056 | 12613513073 |