

City of Las Vegas
Department of Planning
Development Services Center
333 North Rancho Drive, 3rd Floor
Las Vegas, Nevada 89106

Se ✓
PRSR
FIRST CLASS MAIL
U.S. Postage
PAID
Las Vegas, NV
Permit No. 1630

Return Service Requested
Official Notice of Public Hearing

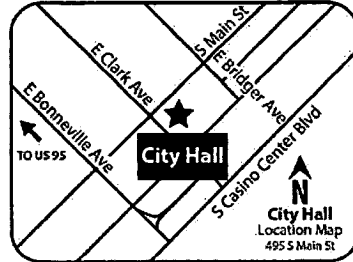

If you wish to file your protest or support on this request, check the appropriate box below and return this card in an envelope with postage to the Department of Planning at the address listed above, fax this side of this card to (702) 464-7499 or make your comments at www.lasvegasnevada.gov. If you would like to contact your Council Representative, please call (702) 229-6405.

I SUPPORT
this Request

I OPPOSE
this Request

Please use available blank space on card for your comments.

VAR-66352 and VAR-66353 [PRJ-66198]

Planning Commission Meeting of 10/11/2016

Application Information

VAR-66352 - VARIANCE - PUBLIC HEARING - APPLICANT/OWNER: KB HOMES NEVADA, INC. - For possible action on a request for a Variance TO ALLOW A FIVE-FOOT SIDE YARD SETBACK WHERE 20 FEET IS REQUIRED AND A 10-FOOT BUILDING SEPARATION WHERE 15 FEET IS REQUIRED ON LOT 2 OF A 157-LOT RESIDENTIAL SUBDIVISION on 18.02 acres at the southeast corner of Egan Crest Drive and Grand Teton Drive (APN 126-13-501-022), M (Medium Density Residential) Cliff's Edge Land Use Designation, PROPOSED: R-SL [Residential Small Lot (Mini-Lot Conventional) Cliff's Edge Land Use Designation], Ward 6 (Ross) [PRJ-66198].

VAR-66353 - VARIANCE - PUBLIC HEARING - APPLICANT/OWNER: KB HOMES NEVADA, INC. - For possible action on a request for a Variance TO ALLOW A FIVE-FOOT SIDE YARD SETBACK WHERE 20 FEET IS REQUIRED AND A 10-FOOT BUILDING SEPARATION WHERE 15 FEET IS REQUIRED ON LOT 3 OF A 157-LOT RESIDENTIAL SUBDIVISION on 18.02 acres at the southeast corner of Egan Crest Drive and Grand Teton Drive (APN 126-13-501-022), M (Medium Density Residential) Cliff's Edge Land Use Designation, PROPOSED: R-SL [Residential Small Lot (Mini-Lot Conventional) Cliff's Edge Land Use Designation], Ward 6 (Ross) [PRJ-66198].

Application Location

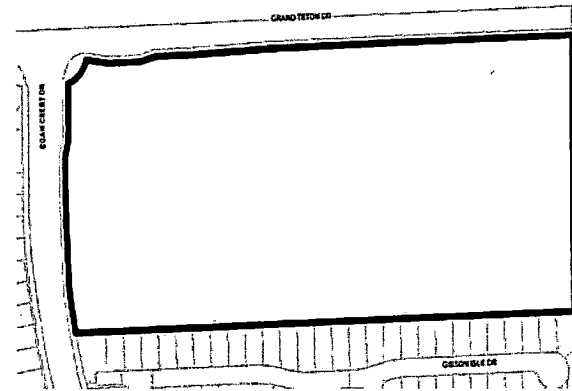

The proposed project may not pertain to the entire highlighted project site.

Public Hearing Information

Meeting: Planning Commission
Date: *October 11, 2016*
Time: 9:00 A.M.
Location: City Council Chambers
495 South Main Street, 2nd Floor
Las Vegas, Nevada 89101

Any and all interested persons may appear before the City Planning Commission either in person or by representative and object to or express approval of this request; or may, prior to this meeting, file a written objection thereto or approval thereof with the Department of Planning, Development Services Center, 333 North Rancho Drive, 3rd Floor, Las Vegas, Nevada 89106. Final Action on General Plan Amendments and Rezonings will be determined by the City Council. Other public hearing items may be deemed Final Action by the Planning Commission or forwarded to the City Council. The date of the City Council meeting, if applicable, will be announced at the Planning Commission meeting after the discussion of the item. For further information, including the full staff report, please call (702) 229-6301 (TTY 7-1-1) or go to <http://www.lasvegasnevada.gov>.

5. ✓

VAR-66352, VAR-66353
MOD-66499, VAR-66346

Report of All Selected Parcels

Case Number:

Printed On: Mon: September 12, 2016

<u>Owner</u>	<u>Address</u>	<u>Parcel Numbe</u>
10029 MADISON WALK L L C	P O BOX 631730 IRVING TX 75063-0002	12518111020
ACEVEDO ROBERT G	10227 DANSKIN DR LAS VEGAS NV 89166-2505	12613519019
AFZALI TIM	10125 NASH PEAK AVE LAS VEGAS NV 89166-5213	12613516041
ALBA JOHN B	4406 KITTIWAKE WAY OCEANSIDE CA 92057	12613517020
ALBERT GINA L	PEARL TYLER B 7841 ASKEW PL LAS VEGAS NV 89166	12613518017
ALBISTON DIANA	10441 WHITE PRINCESS AVE LAS VEGAS NV 89166	12613513039
ALFARO-RUIZ ANDRES C	7824 RHODORA PEAK ST LAS VEGAS NV 89166	12613516034
ALFONSO EDDIE S & MARISSA M	ALFONSO ERIKA JEAN MAGPAYO 10512 WHITE PRINCESS AVE LAS VEGAS NV 89166-5085	12613114006
ALLEN AMERICIOUS & KEONA	10452 WHITE PRINCESS AVE LAS VEGAS NV 89166	12613513003
ALLEN CRYSTAL	7746 RHODORA PEAK ST LAS VEGAS NV 89166-5212	12613616056
ALTEMUELLER KLAUS C & JENNIFER	10304 GIBSON ISLE DR LAS VEGAS NV 89166	12613522025
ANDERSON LINDA A & JAMES M	10239 GLADSTONE PEAK LAS VEGAS NV 89166-5209	12613616009
ANDREWS CHRISTOPHER	7821 ASKEW PL LAS VEGAS NV 89166	12613518002
APPELZOLLER SAMANTHA N	10253 GIBSON ISLE DR LAS VEGAS NV 89166	12613521001
ARGUELLES ARNEL M	ARELLANO-ARGUELLES MYRA T 7746 EAGLE ROCK PEAK CT LAS VEGAS NV 89166-5222	12613616031
ASKEY ROBERT D & CHRISTINE R	10240 SCOPES AVE LAS VEGAS NV 89166	12613513027
ATIENZA ALLIY P	7843 CASTLE ROCK PEAK ST LAS VEGAS NV 89166-5215	12613516017
B & B FAMILY TRUST	BERGQUIST KATHLEEN L TRS 7816 RHODORA PEAK ST LAS VEGAS NV 89166-5212	12613516036
BADGER GABRIELLE M	DELATORRE GARRETT 7820 RHODORA PEAK ST LAS VEGAS NV 89166-5212	12613516035
BAGOCUS JOHN P & NANCY L	10426 GROTTO MOUNTAIN AVE LAS VEGAS NV 89166-5008	12613514009
BAIELEY JEFFREY A	7854 AIROLA PEAK ST LAS VEGAS NV 89166-5021	12613513025
BAILEY AVERRE & CHAUFFE	7922 TORREYS PEAK ST LAS VEGAS NV 89166	12613513062
BALAGTAS KIMBERLY G	LAUX CHRISTOPHER L 7835 CASTLE ROCK PEAK ST LAS VEGAS NV 89166-5215	12613516015
BANANA TRUST	ECHAVES ROBERTA K TRS 6421 WILLOWSTONE ST LAS VEGAS NV 89166	12613516004
BANK FLAGSTAR FSB	5151 CORPORATE DR TROY MI 48098	12613513087
BARILLAS FRANCIS & ZOILA	7812 RHODORA PEAK ST LAS VEGAS NV 89166-5212	12613516037
BARNES TROY J & NATALIE T	7840 RHODORA PEAK ST LAS VEGAS NV 89166-5212	12613516030
BARTON BRUCE & CONNIE	7815 SUGARLOAF PEAK ST LAS VEGAS NV 89166	12613514002
BAUM PHILLIP & OKCHA	7831 CASTLE ROCK PEAK ST LAS VEGAS NV 89166	12613516014
BAUTISTA GERTRUDE	1884 FIREBRICK TERR UNION CITY CA 94587-4692	12613517016
BAWDEN KAREN	44 SANTA ELENA AVE DALY CITY CA 94015	12613517018
BEARD DEANNA J	10129 NASH PEAK AVE LAS VEGAS NV 89166-5213	12613516042

Report of All Selected Parcels**Case Number:**VAR-66352, VAR-66353
~~MOB-66499, VAR-66346~~**Printed On:** Mon: September 12, 2016

Owner	Address	Parcel Number
BEASLEY JEREMY R & HEATHER M	7734 AMBERWOOD PEAK CT LAS VEGAS NV 89166-5220	12613616049
BEASLEY JESSE R	7742 AMBERWOOD PEAK CT LAS VEGAS NV 89166-5220	12613616047
BEAULIEU KARSON D & BEATA K	7919 TORREYS PEAK ST LAS VEGAS NV 89166-5077	12613114019
BECKETT JOHN R & MILDRED A	7743 SUGARLOAF PEAK ST LAS VEGAS NV 89166-5020	12613615029
BEERS GARTH W & CARLENE M	2720 KYLE CIR LOVELAND CO 80537	12518111061
BEJA LEAH	PLAZA CARL 10426 WHITE PRINCESS AVE LAS VEGAS NV 89166	12613513009
BENAMEUR RIADH	10422 PRAIRIE MOUNTAIN AVE LAS VEGAS NV 89166	12613513048
BENESH JAZZMEN KIMBERLY	10451 PRAIRIE MOUNTAIN AVE LAS VEGAS NV 89166	12613513086
BENJAMIN JACQUELINE S	10230 DANSKIN DR LAS VEGAS NV 89166-2505	12613519037
BENNETT LINDA JEAN & MARK BRIAN	10028 VILLAGE WALK AVE LAS VEGAS NV 89149	12518111047
BENNETT PAUL L	10125 IRON WOOD PEAK AVE LAS VEGAS NV 89166-5216	12613516055
BENOIT JIMMY S & KASSIE	10213 GIBSON ISLE DR LAS VEGAS NV 89166	12613521010
BERNAL BENJAMIN	PULIDO ROCIO 10447 PRAIRIE MOUNTAIN AVE LAS VEGAS NV 89166	12613513085
BERRY CHRISTINE R	10245 HEADRICK DR LAS VEGAS NV 89166	12613517017
BERWICK MARY	10324 RUGGED MOUNTAIN AVE LAS VEGAS NV 89166-5014	12613615041
BIGLOW ALEX E	10292 GIBSON ISLE DR LAS VEGAS NV 89166	12613522022
BINGHAM REGINA L	10417 BAYS MOUNTAIN AVE LAS VEGAS NV 89166-5002	12613615032
BISHOP MICHAEL JOHN & MONICA A	10216 DANSKIN DR LAS VEGAS NV 89166-2504	12613519030
BISIGNANO LOUIS & OLIVIA	10438 PRAIRIE MOUNTAIN AVE LAS VEGAS NV 89166	12613513052
BLACK HUGH M IV	5555 PAINTED MIRAGE #140 LAS VEGAS NV 89149	12613514029
BLACK LATISHA N & BRENDOLYN	10413 BAYS MOUNTAIN AVE LAS VEGAS NV 89166-5002	12613615033
BLISS CRYSTAL	10221 HEADRICK DR LAS VEGAS NV 89166-2501	12613517029
BLUBAUGH WILLIAM & PEGGY	7819 SUGARLOAF PEAK ST LAS VEGAS NV 89166-5019	12613514003
BOEKANKAMP JOEL & LENORE D	7908 AIROLA PEAK ST LAS VEGAS NV 89166-5021	12613513023
BOLEWARE WALTER DUDLEY FAMILY TR	BOLEWARE MARY JESSIE TRS 4550 N CIMARRON RD LAS VEGAS NV 89129	12613514014
BONE ANDRE LAVERT	10450 PRAIRIE MOUNTAIN AVE LAS VEGAS NV 89166	12613513054
BOUCHE ELVIA	10414 PRAIRIE MOUNTAIN AVE LAS VEGAS NV 89166-5059	12613513046
BOYLAN LIVING TRUST	BOYLAN TIMOTHY L & SHARON L TRS 5835 JANELL DR LAS VEGAS NV 89149-4649	12613516040
BRADDOCK ALBERT MITCH JR & JENNI	7745 AMBERWOOD PEAK CT LAS VEGAS NV 89166-5220	12613616045
BRADLEY BRYCE & JULIA M	7920 FARRALON RIDGE CT LAS VEGAS NV 89149-3769	12518111060
BRADLEY ERIK BRETT & RANDI MICHE	10434 PRAIRIE MOUNTAIN AVE LAS VEGAS NV 89166	12613513051
BRANSON STEVEN H & CHRISTINE M	7745 EAGLE ROCK PEAK CT LAS VEGAS NV 89166-5222	12613616030

Report of All Selected ParcelsCase Number:VAR-66352, VAR-66353
~~MOD-66199, VAR-66346~~Printed On: Mon: September 12, 2016

<u>Owner</u>	<u>Address</u>	<u>Parcel Number</u>
BREWER JAMIEKA L	10272 DANSKIN DR LAS VEGAS NV 89166-2506	12613520016
BRIDGES NERISA	10426 PRAIRIE MOUNTAIN AVE LAS VEGAS NV 89166-5059	12613513049
BROOKS ERIC L & DIONE L	7733 EAGLE ROCK PEAK CT LAS VEGAS NV 89166-5222	12613616027
BROUSSARD STEVEN H	10248 DANSKIN DR LAS VEGAS NV 89166-2506	12613520010
BRYNER DAVID J	10141 BLUE WATER PEAK AVE LAS VEGAS NV 89166	12613616067
BURKE EDWARD	SINOBIO MARY 10461 BURENSBURG AVE LAS VEGAS NV 89135	12613513107
BURKS MICHAEL E & LINDA G	7742 TREE LANE PEAK CT LAS VEGAS NV 89166-5219	12613616039
BURTON CRAIG S & ERIN M R	10434 WHITE PRINCESS AVE LAS VEGAS NV 89166-5085	12613513007
BURTON ROBERT W	7859 ASKEW PL LAS VEGAS NV 89166	12613518009
BUSHING JASON D & KIMBERLY KRIS	10236 DANSKIN DR LAS VEGAS NV 89166	12613519040
C A H 2014-1 BORROWER L L C	8665 E HARTFORD DR #200 SCOTTSDALE AZ 85255	12518111056
C A H 2014-2 BORROWER L L C	8665 E HARTFORD DR #200 SCOTTSDALE AZ 85255	12518111050
C A H 2014-2 BORROWER L L C	8665 E HARTFORD DR #200 SCOTTSDALE AZ 85255	12613517008
C A H 2015-1 BORROWER L L C	8665 E HARTFORD DR #200 SCOTTSDALE AZ 85255	12613616052
C M D REVOCABLE LIVING TRUST	7848 ASKEW PL LAS VEGAS NV 89166-1200	12613518007
CAHILL MICHAEL & ERIN	CAHILL BRIAN M & KAREN R 7928 AIROLA PEAK DR LAS VEGAS NV 89166	12613513018
CALARA FRANCISCO & MYRA	7737 EAGLE ROCK PEAK CT LAS VEGAS NV 89166-5222	12613616028
CALIENDO GRACE	10416 BAYS MOUNTAIN AVE LAS VEGAS NV 89166	12613514034
CALL PARLEY PRATT III	10020 SCENIC WALK AVE LAS VEGAS NV 89149-3774	12518111091
CANEZ FAMILY TRUST	CANEZ ROBERT E & DORENE TRS 10334 BAYS MOUNTAIN AVE LAS VEGAS NV 89166-5001	12613514030
CANTRELL JEFFREY & KERRY WIRFEL	411 STATHAMS WAY WARNER ROBINS GA 31088	12613513079
CAO JING	YOU SIEW MEI 24752 JUDI CT LAGUNA NIGUEL CA 92677	12613616016
CARLSON BRENT E	7735 TREE LANE PEAK CT LAS VEGAS NV 89166-5219	12613616035
CARPENDALE GARY & CHARLENE P	10032 VILLAGE WALK AVE LAS VEGAS NV 89149	12518111046
CARRIER CHRISTOPHER & SAMANTHA	10244 BLUE WATER PEAK LAS VEGAS NV 89166	12613616006
CARROLL CLAYTON W & APRIL L	10452 TURTLE MOUNTAIN AVE LAS VEGAS NV 89166-5081	12613513110
CARROLL DERECK P & NIA LANAY	10454 MOUNT WASHINGTON AVE LAS VEGAS NV 89166-5057	12613513066
CARROLL JENNIFER R	LAROCQUE ANNETTE YVONNE 10233 HEADRICK DR LAS VEGAS NV 89166-2501	12613517023
CASTELLANOS DAISY	BANUELOS-OLAGUEL EVELYN 10437 WHITE PRINCESS AVE LAS VEGAS NV 89166	12613513040
CASTOE BRENDA	10021 VILLAGE WALK AVE LAS VEGAS NV 89149-3776	12518111042
CASWELL BONNIE J & DAVID L	7918 TORREYS PEAK ST LAS VEGAS NV 89166	12613513063
CASYAO RIZALINA	10441 TURTLE MOUNTAIN AVE LAS VEGAS NV 89166-5081	12613513036

Report of All Selected Parcels**Case Number:****VAR-66352, VAR-66353**
~~MOD-66199, VAR-66346~~**Printed On:** Mon: September 12, 2016

<u>Owner</u>	<u>Address</u>	<u>Parcel Number</u>
CAYANAN MARIE TERESA JEANETTE	10225 GIBSON ISLE DR LAS VEGAS NV 89166-2508	12613521007
CHAVANA THERESA M	ASHFORD OLGA O 10210 GIBSON ISLE DR LAS VEGAS NV 89166-2508	12613521014
CHRISTENSEN BRANDON R	10141 IRON WOOD PEAK AVE LAS VEGAS NV 89166-5216	12613516059
CHRISTENSEN BRIAN JACOB & ALTER	10443 PRAIRIE MOUNTAIN AVE LAS VEGAS NV 89166	12613513084
CHUN DOREEN MAE TRUST	CHUN DOREEN MAE TRS 10222 DANSKIN DR LAS VEGAS NV 89166-2504	12613519033
CLAWSON CASEY T & BRIANNA C	10437 MOUNT WASHINGTON AVE LAS VEGAS NV 89166	12613513093
COLE & COLE LIVING TRUST	COLE ROBIN K & LINDA D TRS 10327 BAYS MOUNTAIN AVE LAS VEGAS NV 89166	12613615039
COLLIS KRISTINE	10228 DANSKIN DR LAS VEGAS NV 89166-2505	12613519036
CONCEPCION NICHOLAS J	PARTIDA YVETTE 10296 GIBSON ISLE DR LAS VEGAS NV 89166	12613522023
CONGDON CHERYL L	416 WATERBURY WAY MEDFORD OR 97504	12613616022
CONNOR JOSEPH J JR	10297 GIBSON ISLE DR LAS VEGAS NV 89166	12613522001
CONROY SEAN R & CHELSEA R	10243 DANSKIN DR LAS VEGAS NV 89166-2505	12613520008
CONTRERAS MILTON	RIOS SANDRA M DAVILA 10128 HAYMARKET PEAK AVE LAS VEGAS NV 89166-5217	12613516065
COOK JACOB H & EUN-JI	10252 DANSKIN DR LAS VEGAS NV 89166	12613520011
COOPERMAN ALEXANDRA N	GAGNON COLIN W 10243 GLADSTONE PEAK ST LAS VEGAS NV 89166	12613616010
CORNELIUS MARY	10242 HEADRICK DR LAS VEGAS NV 89166-2500	12613517040
CORNELIUSSEN CHRISTINA	7746 AMBERWOOD PEAK CT LAS VEGAS NV 89166-5220	12613616046
CORREA JOHON JAIRO	10335 BAYS MOUNTAIN AVE LAS VEGAS NV 89166-5001	12613615037
COUNTS CHRISTOPHER L	10256 GIBSON ISLE DR LAS VEGAS NV 89166	12613522013
COVEL JOSEPHINE A	10223 BLUE WATER PEAK AVE LAS VEGAS NV 89166-5211	12613616076
CRAWFORD FAMILY TRUST	CRAWFORD BRUCE M & JEANNIE TRS 413 MORSE AVE PLACENTIA CA 92870-3413	12613517036
CRUSE SAMANTHA J	10229 GIBSON ISLE DR LAS VEGAS NV 89166-2509	12613521006
CRUZ DINAH	7819 CASTLE ROCK PEAK ST LAS VEGAS NV 89166-5215	12613516011
CUESTA CARLOS L	SARMIENTO MARIA C 10251 HEADRICK DR LAS VEGAS NV 89166	12613517014
DAHILIG RAYMOND & JENBETH A	7734 RHODORA PEAK ST LAS VEGAS NV 89166-5212	12613616059
DAISY TRUST	P O BOX 36208 LAS VEGAS NV 89133-6208	12613616036
DALE FAMILY TRUST	DALE MIKELL E & LINDA L TRS 7400 RED CINDER ST LAS VEGAS NV 89131	12613522021
DAMKE SHELLY L	10126 HARTFORD PEAK CT LAS VEGAS NV 89166-5218	12613616054
DANCSOK RICHARD	10231 DANSKIN DR LAS VEGAS NV 89166	12613519017
DARDIS DEREK J & KATHERINE M	10232 DANSKIN DR LAS VEGAS NV 89166	12613519038
DAS SINDHU	10277 GIBSON ISLE DR LAS VEGAS NV 89166	12613522006
DAVIS ROSS MICHAEL & REBECCA	10238 HEADRICK DR LAS VEGAS NV 89166-2500	12613517038

Report of All Selected ParcelsCase Number:VAR-66352, VAR-66353
~~MOD-66199, VAR-66346~~Printed On: Mon: September 12, 2016

<u>Owner</u>	<u>Address</u>	<u>Parcel Number</u>
DAWA CATHERINE J	10148 NASH PEAK AVE LAS VEGAS NV 89166	12613516020
DEGUIRE LEO A III	10237 HEADRICK DR LAS VEGAS NV 89166-2500	12613517021
DELACRUZ MA LIWAYWAY	645 BLUE YUCCA ST LAS VEGAS NV 89144	12518111059
DELLOSA ROBERT L JR	10021 ARTISTIC WALK AVE LAS VEGAS NV 89149-3767	12518111049
DENNY LAURENCE A III & DEBORAH J	3125 BERKSHIRE CT PLEASANTON CA 94588	12613517051
DENT JODIE R	10235 GLADSTONE PEAK LAS VEGAS NV 89166-5209	12613616008
DESANTOS JOSE R & MARGARITA L	10418 GROTTO MOUNTAIN AVE LAS VEGAS NV 89166-5008	12613514011
DEVINE WILLIAM EDWARD & RENAE JE	7935 TORREYS PEAK ST LAS VEGAS NV 89166	12613114002
DHIAA MUSTAFA A	10124 NASH PEAK AVE LAS VEGAS NV 89166	12613516026
DINKINS ROBERT & LATHYRELLE	10250 HEADRICK DR LAS VEGAS NV 89166-2502	12613517043
DITTMER RICHARD F	10028 SCENIC WALK AVE LAS VEGAS NV 89149-3774	12518111089
DIXON GLORIA	7738 RHODORA PEAK ST LAS VEGAS NV 89166-5212	12613616058
DIZON WARREN	10033 MADISON WALK AVE LAS VEGAS NV 89149-3771	12518111021
DORIA MICHELE J	7808 RHODORA PEAK ST LAS VEGAS NV 89166-5212	12613516038
DOUGLAS MAXIMILLIANO	AMARO-DOUGLAS ANGELINA R 10448 TURTLE MOUNTAIN AVE LAS VEGAS NV 89166-5081	12613513109
DRISCOLL FRANK	10339 BAYS MOUNTAIN AVE LAS VEGAS NV 89166-5001	12613615036
DUKE PARTNERS L L C	2320 POTOSI ST #130 LAS VEGAS NV 89146	12613615046
DUNLAP KRYSTAL	7851 ASKEW PL LAS VEGAS NV 89166-1200	12613518013
DUYOR ERICSON C & LILIA G	10123 HAYMARKET PEAK AVE LAS VEGAS NV 89166-5217	12613516001
DYNABURSKY MARK & JANELLA	10125 HARTFORD PEAK CT LAS VEGAS NV 89166-5218	12613616051
EAGLE INVESTORS	P O BOX 7565 LAS VEGAS NV 89125	12613514031
EASON RONALD A II	ALBERT GRACE R 10254 HEADRICK DR LAS VEGAS NV 89166-2502	12613517045
EASTMAN FRED & ARLENE	506 DOGWOOD LN CHAGRIN FALLS OH 44023-6736	12613514008
ECKERT HAROLD JR & BLYNNDA	7828 RHODORA PEAK ST LAS VEGAS NV 89166-5212	12613516033
EIDE MICHAEL	10268 GIBSON ISLE DR LAS VEGAS NV 89166	12613522016
EMERSON BETH ANN	7744 SUNDIAL PEAK ST LAS VEGAS NV 89166-5006	12613615002
EPSTEIN MARVIN A LIVING TRUST ET	EPSTEIN CATHERINE M TRS 10280 GIBSON ISLE DR LAS VEGAS NV 89166	12613522019
ESPINOZA ROBERT A & CHARLOTTE	10411 GROTTO MOUNTAIN AVE LAS VEGAS NV 89166-5008	12613514026
ESTARIS FRANCISCO M & CLARA G	10144 IRON WOOD PEAK AVE LAS VEGAS NV 89166-5216	12613516047
EVARO RICHARD REYES & MONICA	JOHNSON MARY JANE 7949 POINT POWELL CT LAS VEGAS NV 89166	12613513005
FALVEY DARLENE TRUST	FALVEY DARLENE ANN TRS 10131 HAYMARKET PEAK AVE LAS VEGAS NV 89166-5217	12613516003
FARISS DOUGLAS V & GLADYS F	10140 HAYMARKET PEAK AVE LAS VEGAS NV 89166-5217	12613516062

Report of All Selected ParcelsCase Number:VAR-66352, VAR-66353
~~MOD-66199, VAR-66348~~Printed On: Mon: September 12, 2016

<u>Owner</u>	<u>Address</u>	<u>Parcel Number</u>
FARRER LES	10419 GROTTO MOUNTAIN LAS VEGAS NV 89166-5008	12613514024
FARRIS MATTHEW J & TRACY L	10217 GIBSON ISLE DR LAS VEGAS NV 89166-2508	12613521009
FERNANDEZ JOSEPH-ROYCE C	10256 GLADSTONE PEAK ST LAS VEGAS NV 89166-5209	12613616012
FERNANDEZ PHILIP R	7738 FORTRESS PEAK CT LAS VEGAS NV 89166-5221	12613616025
FIELDS JANA E	10260 GIBSON ISLE DR LAS VEGAS NV 89166	12613522014
FISHEL AMANDA L	10308 GIBSON ISLE DR LAS VEGAS NV 89166	12613522026
FLEMING KAREN J	ORLANDO PETER 7818 SUNDIAL PEAK ST LAS VEGAS NV 89166-5006	12613514016
FLOREK MARK J & DEBBIE L	5455 S NICOLE CT NEW BERLIN WI 53151-8195	12613514023
FLORES MAURICIO ESPINOSA	6941 DIVER AVE NORTH LAS VEGAS NV 89084	12613518005
FOREHAND HAROLD L FAMILY TRUST	3516 E 3138 N KIMBERLY ID 83341-5361	12613114013
FOWLER REBECCA	7937 FARRALON RIDGE CT LAS VEGAS NV 89149-3769	12518111057
FRANCESE ANITA M	10414 GRATTO MOUNTAIN AVE LAS VEGAS NV 89166-5008	12613514012
FRANK RICHARD J JR	10229 HEADRICK DR LAS VEGAS NV 89166	12613517025
FREE RANGE MANAGEMENT L T D	1347 CADENCE ST HENDERSON NV 89052	12518111054
FRIEDMAN BEAU	7901 FARRALON RIDGE CT LAS VEGAS NV 89149	12518111052
FRIELLES RHODORA G	10270 HEADRICK DR LAS VEGAS NV 89166	12613517053
FRITZ FAMILY TRUST	FRITZ GARY R & JODI L TRS 10434 GROTTO MOUNTAIN AVE LAS VEGAS NV 89166-5008	12613514007
FURUKEN GLORIA	7732 SUNDIAL PEAK ST LAS VEGAS NV 89166	12613615005
GACCIONE ZACHARY	10260 HEADRICK DR LAS VEGAS NV 89166-2502	12613517048
GALAVIZ VERONICA & DANNY	10420 BAYS MOUNTAIN AVE LAS VEGAS NV 89166-5002	12613514035
GALLANT DAWNYA CHRISTINE	7943 TORREYS PEAK ST LAS VEGAS NV 89166	12613114004
GARCIA CRYSTAL B	BALAURO EDWIN A 10259 DANSKIN DR LAS VEGAS NV 89166-2506	12613520004
GARCIA IRMA	10120 NASH PEAK AVE LAS VEGAS NV 89166-5213	12613516027
GARDUQUE NATHANIEL I	GARDUQUE NATANAEL R & LETICIA B 10124 IRON WOOD PEAK AVE LAS VEGAS NV 89166	12613516052
GEHRT ALDEN K JR & JEANNIE M	10253 HEADRICK DR LAS VEGAS NV 89166-2502	12613517013
GERRITY BRIANNA	BARBER RONALD A JR 10252 GIBSON ISLE DR LAS VEGAS NV 89166-2509	12613522012
GILES PAUL P & CHA Y	7734 FORTRESS PEAK ST LAS VEGAS NV 89166-5221	12613616026
GIOVANNITTI CHRISTOPHER & SARAH	10256 DANSKIN DR LAS VEGAS NV 89166-2506	12613520012
GLASGOW JASON & SUMMER MARIE	10456 WHITE PRINCESS AVE LAS VEGAS NV 89166	12613513002
GLASS KEVIN	GETTY MISHA 10275 HEADRICK DR LAS VEGAS NV 89166	12613517002
GOODWIN CHRISTOPHER R & TANYA N	10449 MOUNT WASHINGTON AVE LAS VEGAS NV 89166-5057	12613513090
GORTON THOMAS	5524 CASTLE HILLS DR LA JOLLA CA 92037	12518111045

Report of All Selected Parcels**Case Number:****VAR-66352, VAR-66353**
~~MOB-66499, VAR-66346~~**Printed On:** Mon: September 12, 2016

<u>Owner</u>	<u>Address</u>	<u>Parcel Numbe</u>
GOULET SAMUEL & JESSICA ANN	10235 BLUE WATER PEAK AVE LAS VEGAS NV 89166	12613616001
GRACE ROBERT J	10132 NASH PEAK AVE LAS VEGAS NV 89166-5213	12613516024
GRAHAM NATOSHIA L	10219 DANSKIN DR LAS VEGAS NV 89166-2504	12613519023
GRAMLICH BLAINE	10024 MADISON WALK AVE LAS VEGAS NV 89149	12518111024
GRANT ARAXIE ROSE	10417 WHITE PRINCESS AVE LAS VEGAS NV 89166	12613513045
GRAVES MELISSA S	10248 BLUE WATER PEAK AVE LAS VEGAS NV 89166	12613616005
GREENWALD LAWRENCE S & BARBARA M	2540 BRIAN DR NORTHBROOK IL 60062	12613514013
GRILLO DENNIS & DELORES FAMILY T	GRILLO DENNIS CHARLES & DELORES 10231 BLUE WATER PEAK AVE LAS VEGAS NV 89166-5211	12613616078
GRIMES MAUREEN LIVING TRUST	GRIMES MAUREEN TRS 10430 PRAIRIE MOUNTAIN AVE LAS VEGAS NV 89166	12613513050
GROFF JULIE L	125-A CLAREMONT AVE LONG BEACH CA 90803	12613520013
GUARINO GEORGIA W & MICHAEL J	7843 TORREYS PEAK ST LAS VEGAS NV 89166-5076	12613114010
GUNDERSON MARK F & JAMIE R	10418 WHITE PRINCESS AVE LAS VEGAS NV 89166	12613513011
GUNTER TAMARA S	10122 HARTFORD PEAK CT LAS VEGAS NV 89166-5218	12613616053
GUTIERREZ KELLY	WEINER DW 10244 DANSKIN DR LAS VEGAS NV 89166-2505	12613520009
GUZMAN JEROME & CORRINE ANNE	10021 SCENIC WALK LAS VEGAS NV 89149-3774	12518111084
HAACKE BRENDON & CAYLEE	10284 GIBSON ISLE DR LAS VEGAS NV 89166	12613522020
HADDAD MARC & JANE	10419 PRAIRIE MOUNTAIN AVE LAS VEGAS NV 89166	12613513078
HADDAD PENNY G	DAVID BRITTANY L 1708 GLENVIEW DR LAS VEGAS NV 89134	12613516060
HALL DENNIS L & DOROTHY L	SIBAL MELISS R 10418 PRAIRIE MOUNTAIN AVE LAS VEGAS NV 89166	12613513047
HALLETT DANIEL S & SARAH E	10412 RUGGED MOUNTAIN AVE LAS VEGAS NV 89166-5015	12613615047
HANSON DIRK EDWARD	JEAGER LORI LYNN 10431 PRAIRIE MOUNTAIN AVE LAS VEGAS NV 89166	12613513081
HANSON PATRICIA ANN	10416 RUGGED MOUNTAIN AVE LAS VEGAS NV 89166-5015	12613615048
HANSON ROGER K	SANTOS ANDREWS 7733 FORTRESS PEAK CT LAS VEGAS NV 89166-5221	12613616019
HARRIS JOSEPH W	7827 CASTLE ROCK PEAK ST LAS VEGAS NV 89166-5215	12613516013
HARRISON KENNETH W & LENORE M	7804 RHODORA PEAK ST LAS VEGAS NV 89166-5212	12613516039
HAVER RUSSELL J & NICOLLE R	10408 BAYS MOUNTAIN AVE LAS VEGAS NV 89166-5002	12613514032
HAYES LEO & LISA M	7737 AMBERWOOD PEAK CT LAS VEGAS NV 89166	12613616043
HEADRICK DRIVE TRUST	P O BOX 36208 LAS VEGAS NV 89133-6208	12613517006
HEARTHSTONE BROOKSTONE HOA	1820 E SAHARA AVE #101 LAS VEGAS NV 89104-3736	12613516068
HEARTHSTONE BROOKSTONE HOA	1820 E SAHARA AVE #101 LAS VEGAS NV 89104-3736	12613616172
HEARTHSTONE BROOKSTONE HOA	1820 E SAHARA AVE #101 LAS VEGAS NV 89104-3736	12613516070

Report of All Selected Parcels**Case Number:****VAR-66352, VAR-66353**
~~MOD-66199, VAR-66346~~**Printed On:** Mon: September 12, 2016

<u>Owner</u>	<u>Address</u>	<u>Parcel Number</u>
HEARTHSTONE BROOKSTONE HOA	1820 E SAHARA AVE #101 LAS VEGAS NV 89104-3736	12613616171
HEARTHSTONE BROOKSTONE HOA	1820 E SAHARA AVE #101 LAS VEGAS NV 89104-3736	12613616178
HEARTHSTONE BROOKSTONE HOA	1820 E SAHARA AVE #101 LAS VEGAS NV 89104-3736	12613516069
HEARTHSTONE BROOKSTONE HOA	1820 E SAHARA AVE #101 LAS VEGAS NV 89104-3736	12613616177
HEARTHSTONE BROOKSTONE HOA	1820 E SAHARA AVE #101 LAS VEGAS NV 89104-3736	12613516071
HEDLIND KATIE T	HEDLIND VERONICA M & JEFFERY S 10231 HEADRICK DR LAS VEGAS NV 89166-2501	12613517024
HERMAN SANTA D	65 CASSANDRA BLVD #103 WEST HARTFORD CT 06107-3149	12613513100
HIATT NOLAN C & MARY L	10032 MADISON WALK AVE LAS VEGAS NV 89149	12518111022
HILL OLGA A LIVING TRUST	HILL OLGA A TRS 10421 BAYS MOUNTAIN AVE LAS VEGAS NV 89166-5002	12613615031
HORVATH JEREMY E	NAUGLE KRISTY M 7947 TORREYS PEAK ST LAS VEGAS NV 89166	12613114005
HULTGREN PAUL W	ARROYO-HULTGREN PAMELA A 10024 SCENIC WALK AVE LAS VEGAS NV 89149-3774	12518111090
HUNT DEAN R & RHONDA L	10405 BAYS MOUNTAIN AVE LAS VEGAS NV 89166-5002	12613615035
HURENCHYK IVANNA & ARTSIOM	10029 VILLAGE WALK AVE LAS VEGAS NV 89149	12518111044
INES CONSTANTE Y & BEATRIZ G	10228 HEADRICK DR LAS VEGAS NV 89166-2501	12613517033
ISAACS AMY J	10214 DANSKIN DR LAS VEGAS NV 89166-2504	12613519029
JACKLIN ANNE K	PUCCI JOHN P 10029 SCENIC WALK AVE LAS VEGAS NV 89149-3774	12518111086
JACKSON CLIFTON R JR & KIMBERLY	7842 AIROLA PEAK ST LAS VEGAS NV 89166	12613513028
JACKSON-HALE NAKIA C	10151 HAYMARKET PEAK LAS VEGAS NV 89166-5217	12613516008
JENSEN BEN & SUMMER	10127 BLUE WATER PEAK AVE LAS VEGAS NV 89166-5210	12613616064
JENSEN WAYNE L & CAROL ELAINE	3639 VAN BUREN AVE OGDEN UT 84403-2028	12613616048
JOHNSON CHRISTOPHER OWEN	779 CLIFTON WAY VACAVILLE CA 95688	12613517010
JOHNSON DAVID K	10149 BLUE WATER PEAK AVE LAS VEGAS NV 89166-5210	12613616069
JOHNSON PRESTON & LINDSAY	10215 BLUE WATER PEAK AVE LAS VEGAS NV 89166-5211	12613616074
JOHNSON SONIA M & RONALD J	10427 PRAIRIE MOUNTAIN AVE LAS VEGAS NV 89166	12613513080
JOHNSTON PETER C	7850 AIROLA PEAK ST LAS VEGAS NV 89166-5021	12613513026
JOLLY BRYAN A & VALERIE N	10430 MOUNT WASHINGTON AVE LAS VEGAS NV 89166-5056	12613513072
JONES DAVID R	10140 IRON WOOD PEAK AVE LAS VEGAS NV 89166-5216	12613516048
JORDAN DINA E	GRAHAM RAY O 7914 TORREYS PEAK ST LAS VEGAS NV 89166	12613513064
JORDAN JAMES M	HARTER CARILYNN 10267 DANSKIN DR LAS VEGAS NV 89166-2506	12613520002
K B HOME NEVADA INC	4127 E VAN BUREN ST #150 PHOENIX AZ 85008-6934	12613501022
KAHOOKELE JENNIFER M	10246 HEADRICK DR LAS VEGAS NV 89166-2500	12613517042
KAISER STEPHEN M & REBECCA L	7924 AIROLA PEAK ST LAS VEGAS NV 89166-5021	12613513019

Report of All Selected Parcels**Case Number:**VAR-66352, VAR-66353
~~MOD-66199, VAR-66348~~**Printed On:** Mon: September 12, 2016

<u>Owner</u>	<u>Address</u>	<u>Parcel Number</u>
KARY LISA M	10442 MOUNT WASHINGTON AVE LAS VEGAS NV 89166-5057	12613513069
KELLER ANDREW STEPHEN	10128 NASH PEAK AVE LAS VEGAS NV 89166-5213	12613516025
KELLER THOMAS J	10264 DANSKIN DR LAS VEGAS NV 89166-2506	12613520014
KESSLER TANYA ANNE	CHAVEZ RUDOLFO 10409 WHITE PRINCESS AVE LAS VEGAS NV 89166-5084	12613513015
KING KIRK R & SANDRA DENISE	10153 BLUE WATER PEAK AVE LAS VEGAS NV 89166-5210	12613616070
KIRKHART JAMIE	10137 IRON WOOD PEAK AVE LAS VEGAS NV 89166-5216	12613516058
KLEDA DARYL S & JENNIFER A	10413 MOUNT WASHINGTON AVE LAS VEGAS NV 89166	12613513099
KNOTT KATHRYN	MIRTI BENJAMIN 7836 BLUE LAKE PEAK ST LAS VEGAS NV 89166	12613113026
KRANZ MATTHEW C	10276 GIBSON ISLE DR LAS VEGAS NV 89166	12613522018
LAMBERT ROGER E & CYNTHIA	10331 GROTTO MOUNTAIN AVE LAS VEGAS NV 89166	12613514028
LAMELA SCOTT & ANGELA	10418 MOUNT WASHINGTON AVE LAS VEGAS NV 89166-5056	12613513075
LAMONTAGNE JERRY & LEAH	10123 BLUE WATER PEAK AVE LAS VEGAS NV 89166	12613616063
LAMPART STEVEN	10226 DANSKIN DR LAS VEGAS NV 89166	12613519035
LANDSMAN MICHAEL B	7737 FORTRESS PEAK CT LAS VEGAS NV 89166-5221	12613616020
LANTZ BRADY J & KENNEDY B	BROADHEAD RANDY E 10232 HEADRICK DR LAS VEGAS NV 89166-2501	12613517035
LAPID MANUEL S & AMELITA R	LITTLE SHELBY 10225 DANSKIN DR LAS VEGAS NV 89166-2504	12613519020
LEAVITT SCOTT	10261 HEADRICK DR LAS VEGAS NV 89166-2502	12613517009
LEBEL DANIEL J & PATRICIA K	10453 MOUNT WASHINGTON AVE LAS VEGAS NV 89166-5057	12613513089
LEEDHAM JANET LARUE FAMILY TRUST	LEEDHAM JANET LARUE TRS HC 74 BOX 263-2 PIOCHE NV 89043	12613518015
LEON DENNIS	10285 GIBSON ISLE DR LAS VEGAS NV 89166	12613522004
LESIEWICZ JANEL	10445 MOUNT WASHINGTON AVE LAS VEGAS NV 89166-5057	12613513091
LEVINSON ROBERT & KATHY	10224 HEADRICK DR LAS VEGAS NV 89166-2501	12613517031
LILII JONAH & DESIREE	10213 DANSKIN DR LAS VEGAS NV 89166-2504	12613519026
LOEBER ANTHONY J	10252 HEADRICK DR LAS VEGAS NV 89166-2502	12613517044
LOMBARDO JAMES J & CORRINE M	10137 NASH PEAK AVE LAS VEGAS NV 89166	12613516044
LOMIS JENNIFER W	EDMONDSON BRADLEY TYSON 10224 DANSKIN DR LAS VEGAS NV 89166-2504	12613519034
LONG DONNY J & AMANDA C	10448 WHITE PRINCESS AVE LAS VEGAS NV 89156	12613513004
LOPEZ SUZETTE & SIDENY P	10257 HEADRICK DR LAS VEGAS NV 89166	12613517011
LOTUGLIO GABRIELA SOLEDAD	10239 DANSKIN DR LAS VEGAS NV 89166	12613519013
LOWE DAVID E	7915 TORREYS PEAK ST LAS VEGAS NV 89166-5076	12613114018
LUNA JAMIE	3901 LARKCREST ST LAS VEGAS NV 89129	12613519015
LUNSFORD ANDREW N & RHONDA K	10415 PRAIRIE MOUNTAIN AVE LAS VEGAS NV 89166	12613513077

Report of All Selected Parcels**Case Number:**VAR-66352, VAR-66353
~~MOB-66199, VAR-66346~~**Printed On:** Mon: September 12, 2016

<u>Owner</u>	<u>Address</u>	<u>Parcel Numbe</u>
LUTTMAN AARON B & SUSANNAH I	10128 IRON WOOD PEAK AVE LAS VEGAS NV 89166-5216	12613516051
LYON CHARLES & SANDRA	10263 DANSKIN DR LAS VEGAS NV 89166-2506	12613520003
LYPKA SANDRA J TRUST	LYPKA SANDRA J TRS 10248 GLADSTONE PEAK ST LAS VEGAS NV 89166-5209	12613616014
MACK MORGAN & IRENE	10240 DANSKIN DR LAS VEGAS NV 89166	12613519042
MADILL MICHAEL	10513 BAUDERA MOUNTAIN LN LAS VEGAS NV 89166	12613113027
MADISON COLONY AT PROVIDENCE HOA	P O BOX 12117 LAS VEGAS NV 89112-0117	12613519057
MADISON COLONY AT PROVIDENCE HOA	1820 E SAHARA AVE #101 LAS VEGAS NV 89104-3736	12613518021
MADISON COLONY AT PROVIDENCE HOA	1820 E SAHARA AVE #101 LAS VEGAS NV 89104-3736	12613518018
MADISON COLONY AT PROVIDENCE HOA	1820 E SAHARA AVE #101 LAS VEGAS NV 89104-3736	12613518020
MADISON COLONY AT PROVIDENCE HOA	P O BOX 12117 LAS VEGAS NV 89112-0117	12613517055
MADISON COLONY AT PROVIDENCE HOA	1820 E SAHARA AVE #101 LAS VEGAS NV 89104-3736	12613518019
MADISON COLONY PROVIDENCE H O A	P O BOX 12117 LAS VEGAS NV 89112-0117	12613517056
MAGALLANES ANTHONY	7485 ASKEW PL LAS VEGAS NV 89166	12613518016
MALINIEMI TONI MARIE ZAMORA	7736 SUNDIAL PEAK ST LAS VEGAS NV 89166-5006	12613615004
MAPOY MARIA L	10453 TURTLE MOUNTAIN AVE LAS VEGAS NV 89166-5081	12613114009
MARCHESE DIANE	10241 HEADRICK DR LAS VEGAS NV 89166-2500	12613517019
MARCU ANDREW DAVID	DONG THUY-XUAN THI 17419 119TH LN SE #E-24 RENTON WA 98058	12613114001
MARKIEWITZ LEAH & JONATHAN	10425 WHITE PRINCESS AVE LAS VEGAS NV 89166	12613513043
MARKLEY ALICIA D & JONATHON I	10421 MOUNT WASHINGTON AVE LAS VEGAS NV 89166	12613513097
MARTIN JEFFREY & MANDY	10427 TURTLE MOUNTAIN AVE LAS VEGAS NV 89166	12613513034
MARTIN KELLY RANDOLPH	10289 GIBSON ISLE DR LAS VEGAS NV 89166	12613522003
MARTIN MICHAEL J	10236 HEADRICK DR LAS VEGAS NV 89166-2501	12613517037
MARTIN STACY	RICHARDS BRYAN 7742 EAGLE ROCK PEAK CT LAS VEGAS NV 89166-5222	12613616032
MARTINEZ DANIEL & CHELSIE NOEL	10422 WHITE PRINCESS AVE LAS VEGAS NV 89166	12613513010
MARTINEZ JOSE G & SANDRA M	10232 GLADSTONE PEAK ST LAS VEGAS NV 89166	12613616018
MARTINEZ PEDRO D	7847 TORREYS PEAK ST LAS VEGAS NV 89166-5076	12613114011
MAYS WILLIAM TRUST	MAYS WILLIAM B TRS 7742 RHODORA PEAK ST LAS VEGAS NV 89166-5212	12613616057
MCARTHUR MICHELLE	HOGAN FRANCES 10144 HAYMARKET PEAK AVE LAS VEGAS NV 89166-5217	12613516061
MCDANEL JENNIFER	10407 GROTTO MOUNTAIN AVE LAS VEGAS NV 89166	12613514027
MCDOWELL MARIO	7815 CASTLE ROCK PEAK ST LAS VEGAS NV 89166-5215	12613516010
MCGEE MICHELLE	10136 NASH PEAK AVE LAS VEGAS NV 89166-5213	12613516023
MCKINNEY STEPHEN R	JYDSTRUP-MCKINNEY ANDREA M 10441 MT WASHINGTON AVE LAS VEGAS NV 89166-5057	12613513092

Report of All Selected ParcelsCase Number:VAR-66352, VAR-66353
~~MOD-66499, VAR-66346~~Printed On: Mon: September 12, 2016

<u>Owner</u>	<u>Address</u>	<u>Parcel Number</u>
MCLEAN NATHAN D & KAREN J	10139 HAYMARKET PEAK AVE LAS VEGAS NV 89166-5217	12613516005
MCNEEL RODNEY J SR	10216 GIBSON ISLE DR LAS VEGAS NV 89166-2508	12613521016
MECKE ANNE	10247 GLADSTONE PEAK ST LAS VEGAS NV 89166-5209	12613616011
MELJER ANNEKE & CHARLES FREDERIK	LOPEZ FRANCESCA JOSEPHINE MELJER 7939 TORREYS PEAK ST LAS VEGAS NV 89166	12613114003
MENDEZ FAMILY TRUST	MENDEZ LUIS T & LAURA O 10420 RUGGED MOUNTAIN AVE LAS VEGAS NV 89166-5015	12613615049
MENDOZA RONALDO S & EVANGELINE L	10504 WHITE PRINCESS AVE LAS VEGAS NV 89166	12613513001
MENESES MARTIN G & STELLA	10029 ARTISTIC WALK AVE LAS VEGAS NV 89149-3767	12518111051
MEZA ALFREDO	10226 DEADRICK DR LAS VEGAS NV 89166	12613517032
MEZA ANNA LIZA RUANTO	10442 PRAIRIE MOUNTAIN AVE LAS VEGAS NV 89166	12613513053
MITCHELL ETHYL L	10211 GIBSON ISLE DR LAS VEGAS NV 89166	12613521011
MIYAMA BRUCE D	7748 SUNDIAL PEAK ST LAS VEGAS NV 89166-5006	12613615001
MOHLER FAMILY REVOCABLE LIV TR	MOHLER WILLIAM S & GERALDINE TRS 10332 RUGGED MOUNTAIN AVE LAS VEGAS NV 89166-5014	12613615043
MOLINA MARCOS A JR & REBEKAH M	10220 DANSKIN DR LAS VEGAS NV 89166	12613519032
MONTENEGRO RAY M & VICTORIA	7953 POINT POWELL CT LAS VEGAS NV 89166-5067	12613513006
MONTOJO ALICIA	10438 GROTTO MOUNTAIN AVE LAS VEGAS NV 89166	12613514006
MOODIE ANDREA E	7746 TREE LANE PEAK CT LAS VEGAS NV 89166-5219	12613616038
MOORE JOHN P & MARY E	10437 TURTLE MOUNTAIN AVE LAS VEGAS NV 89166-5081	12613513035
MORA PATRICIA	10551 HEDGE VIEW AVE LAS VEGAS NV 89129-3318	12613616072
MORAN CODY L	10450 MOUNT WASHINGTON AVE LAS VEGAS NV 89166-5057	12613513067
MORDINI MICHAEL D & ROSANA C	10434 MOUNT WASHINGTON AVE LAS VEGAS NV 89166-5056	12613513071
MORTON WAYNE R	10223 HEADRICK DR LAS VEGAS NV 89166-2501	12613517028
MUIR ERIC A & ALIW S	10265 HEADRICK DR LAS VEGAS NV 89166-2502	12613517007
MURPHY MICHAEL B & MEGAN	10120 IRON WOOD PEAK AVE LAS VEGAS NV 89166-5216	12613516053
MUSINSKI MICHAEL	7911 TORREYS PEAK ST LAS VEGAS NV 89166-5076	12613114017
MYAGMARKHUU AMARBOLD & SHELAH	7941 REED PEAK ST LAS VEGAS NV 89166-5066	12613513057
MYROLD JESSICA & ERIC	10132 IRON WOOD PEAK AVE LAS VEGAS NV 89166	12613516050
NEIGHOFF HEATH ADAM	10133 IRON WOOD PEAK AVE LAS VEGAS NV 89166-5216	12613516057
NELSON DOUGLAS BRUCE & BRIDGET M	10412 BAYS MOUNTAIN AVE LAS VEGAS NV 89166-5002	12613514033
NELSON MICHAEL	10129 IRON WOOD PEAK AVE LAS VEGAS NV 89166-5216	12613516056
NERI CHRISTOPHER M & TIFFANY M	10436 TURTLE MOUNTAIN AVE LAS VEGAS NV 89166-5081	12613513106
NESS STEVEN K	7738 EAGLE ROCK PEAK CT LAS VEGAS NV 89166-5222	12613616033

Report of All Selected Parcels**Case Number:****VAR-66352, VAR-66353**
~~MCD-66199, VAR-66346~~**Printed On:** Mon: September 12, 2016

Owner	Address	Parcel Number
NEVAREZ JIMMY & NICOLE T	7859 TORREYS PEAK ST LAS VEGAS NV 89166-5076	12613114014
NEVAREZ ZACARIAS	10269 GIBSON ISLE DR LAS VEGAS NV 89166	12613522008
NG KENNETH	10028 MADISON WALK AVE LAS VEGAS NV 89149-3771	12518111023
NGUYEN NANCY & RUDY	10202 GIBSON ISLE DR LAS VEGAS NV 89166-2508	12613521012
NIDAY KOLIN L	UMFLEET JEANMARIE 10206 GIBSON ISLE DR LAS VEGAS NV 89166-2508	12613521013
NIELSON MARJEAN	3901 GRIFBRICK DR PLANO TX 75075	12613514036
NOMURA FRANK & FRANCES Y FAM TR	NOMURA FRANK S & FRANCES Y TRS 10121 IRON WOOD PEAK AVE LAS VEGAS NV 89166-5216	12613516054
NORTHERN TERRACE H O A	7610 SILVER RUN PEAK LAS VEGAS NV 89166	12613214061
NORTHERN TERRACE HOMEOWNERS ASSO	7610 SILVER RUN PEAK DR LAS VEGAS NV 89166	12613114021
NORTHERN TERRACE HOMEOWNERS ASSO	7610 SILVER RUN PEAK DR LAS VEGAS NV 89166	12613514040
NORTHERN TERRACE HOMEOWNERS ASSO	7610 SILVER RUN PEAK DR LAS VEGAS NV 89166	12613513127
NORTHERN TERRACE HOMEOWNERS ASSO	7610 SILVER RUN PEAK DR LAS VEGAS NV 89166	12613513124
NORTHERN TERRACE HOMEOWNERS ASSO	7610 SILVER RUN PEAK DR LAS VEGAS NV 89166	12613114022
NORTHERN TERRACE HOMEOWNERS ASSO	7610 SILVER RUN PEAK DR LAS VEGAS NV 89166	12613513114
NORTHERN TERRACE HOMEOWNERS ASSO	7610 SILVER RUN PEAK DR LAS VEGAS NV 89166	12613114024
NORTHERN TERRACE HOMEOWNERS ASSO	7610 SILVER RUN PEAK DR LAS VEGAS NV 89166	12613513117
NORTHERN TERRACE HOMEOWNERS ASSO	7610 SILVER RUN PEAK DR LAS VEGAS NV 89166	12613615050
NORTHERN TERRACE HOMEOWNERS ASSO	7610 SILVER RUN PEAK DR LAS VEGAS NV 89166	12613513118
NORTHERN TERRACE HOMEOWNERS ASSO	7610 SILVER RUN PEAK DR LAS VEGAS NV 89166	12613513116
NORTHERN TERRACE HOMEOWNERS ASSO	7610 SILVER RUN PEAK DR LAS VEGAS NV 89166	12613512002
NORTHERN TERRACE HOMEOWNERS ASSO	7610 SILVER RUN PEAK DR LAS VEGAS NV 89166	12613514042
NORTHERN TERRACE HOMEOWNERS ASSO	7610 SILVER RUN PEAK DR LAS VEGAS NV 89166	12613113137
NORTHERN TERRACE HOMEOWNERS ASSO	7610 SILVER RUN PEAK DR LAS VEGAS NV 89166	12613513120
NORTHERN TERRACE HOMEOWNERS ASSO	7610 SILVER RUN PEAK DR LAS VEGAS NV 89166	12613114020
NORTHERN TERRACE HOMEOWNERS ASSO	7610 SILVER RUN PEAK DR LAS VEGAS NV 89166	12613513119
NORTHERN TERRACE HOMEOWNERS ASSO	7610 SILVER RUN PEAK DR LAS VEGAS NV 89166	12613513112
NORTHERN TERRACE HOMEOWNERS ASSO	7610 SILVER RUN PEAK DR LAS VEGAS NV 89166	12613513126
NORTHERN TERRACE HOMEOWNERS ASSO	7610 SILVER RUN PEAK DR LAS VEGAS NV 89166	12613513113
NORTHERN TERRACE HOMEOWNERS ASSO	7610 SILVER RUN PEAK DR LAS VEGAS NV 89166	12613113138
NORTHERN TERRACE HOMEOWNERS ASSO	7610 SILVER RUN PEAK DR LAS VEGAS NV 89166	12613514038
NORTHERN TERRACE HOMEOWNERS ASSO	7610 SILVER RUN PEAK DR LAS VEGAS NV 89166	12613513123

Report of All Selected Parcels**Case Number:**VAR-66352, VAR-66353
~~MOB-66499, VAR-66346~~**Printed On:** Mon: September 12, 2016

<u>Owner</u>	<u>Address</u>	<u>Parcel Numbe</u>
NORTHERN TERRACE HOMEOWNERS ASSO	7610 SILVER RUN PEAK DR LAS VEGAS NV 89166	12613514041
NORTHERN TERRACE HOMEOWNERS ASSO	7610 SILVER RUN PEAK DR LAS VEGAS NV 89166	12613513115
NORTHERN TERRACE HOMEOWNERS ASSO	7610 SILVER RUN PEAK DR LAS VEGAS NV 89166	12613615051
NORTHERN TERRACE HOMEOWNERS ASSO	7610 SILVER RUN PEAK DR LAS VEGAS NV 89166	12613615053
NORTHERN TERRACE HOMEOWNERS ASSO	7610 SILVER RUN PEAK DR LAS VEGAS NV 89166	12613514039
NORTHERN TERRACE HOMEOWNERS ASSO	7610 SILVER RUN PEAK DR LAS VEGAS NV 89166	12613513121
NORTHERN TERRACE HOMEOWNERS ASSO	7610 SILVER RUN PEAK DR LAS VEGAS NV 89166	12613513125
NORTHERN TERRACE HOMEOWNERS ASSO	7610 SILVER RUN PEAK DR LAS VEGAS NV 89166	12613611014
NORTHERN TERRACE HOMEOWNERS ASSO	7610 SILVER RUN PEAK DR LAS VEGAS NV 89166	12613513111
NORTHERN TERRACE HOMEOWNERS ASSO	7610 SILVER RUN PEAK DR LAS VEGAS NV 89166	12613513122
NORTHERN TERRACE HOMEOWNERS ASSO	7610 SILVER RUN PEAK DR LAS VEGAS NV 89166	12613513128
NORTHERN TERRACE HOMEOWNERS ASSO	7610 SILVER RUN PEAK DR LAS VEGAS NV 89166	12613114023
NYGARD RITA	WALSH JUNE 5701 BIA RT1 POPLAR MT 59255-9441	12613514025
O GROUP L L C	10235 HEADRICK DR LAS VEGAS NV 89166	12613517022
OELHOFFEN DALE	6550 GRAND COURSE ST LAS VEGAS NV 89166	12613513012
OLAGUE MIGUEL	DUNCAN-OLAGUE CHERYL 7937 REED PEAK ST LAS VEGAS NV 89166	12613513056
OLIVE JENNIFER	10221 DANSKIN DR LAS VEGAS NV 89166-2504	12613519022
OLIVEIRA STEPHEN M JR	VERNON ALEXIS N 10316 RUGGED MOUNTAIN AVE LAS VEGAS NV 89166-5014	12613615040
OLSEN COLBY E & MARILEE	10272 HEADRICK DR LAS VEGAS NV 89166-2503	12613517054
O'REILLY SEAN P	10212 DANSKIN DR LAS VEGAS NV 89166-2504	12613519028
ORR REBECCA	7857 ASKEW PL LAS VEGAS NV 89166-1200	12613518010
ORTIZ TRICIA ANN & ENRIQUE	10024 VILLAGE WALK AVE LAS VEGAS NV 89149	12518111048
OYER THOMAS G & SALLY J	10407 TURTLE MOUNTAIN AVE LAS VEGAS NV 89166-5080	12613513029
PAGE BRIAN M	7904 AIROLA PEAK ST LAS VEGAS NV 89166-5021	12613513024
PAIO IRENE C & RAYMOND F	10268 HEADRICK DR LAS VEGAS NV 89166	12613517052
PALM PETER	BARONE-PALM RONDA 10032 SCENIC WALK AVE LAS VEGAS NV 89149-3774	12518111088
PANO CONSTANTIN	10227 HEADRICK DR LAS VEGAS NV 89166-2501	12613517026
PASSALACQUA EDWARD P & JOAN P	7823 SUGARLOAF PEAK ST LAS VEGAS NV 89166-5019	12613514004
PASSALACQUA MATTHEW & CHRISTINE	10211 BLUE WATER AVE LAS VEGAS NV 89166	12613616073
PERCOSKI WILLIAM D	10433 WHITE PRINCESS AVE LAS VEGAS NV 89166	12613513041
PEREZ CLARISSA	10503 MOUNT WASHINGTON AVE LAS VEGAS NV 89166-5057	12613513088
PERRYMAN J ALLEN & GLENDA L	7735 SUGARLOAF PEAK ST LAS VEGAS NV 89166-5020	12613615026

Report of All Selected Parcels**Case Number:**VAR-66352, VAR-66353
~~MOD-66199, VAR-66346~~**Printed On:** Mon: September 12, 2016

<u>Owner</u>	<u>Address</u>	<u>Parcel Number</u>
PERRYMAN J ALLEN & GLENDA L	7735 SUGARLOAF PEAK ST LAS VEGAS NV 89166-5020	12613615027
PETERSON CHRIS & KELLI	10025 VILLAGE WALK AVE LAS VEGAS NV 89149	12518111043
PETERSON FAMILY TRUST	PETERSON LAWRENCE TRS 200 ROLAND WILEY RD LAS VEGAS NV 89145	12613517039
PETERSON GARY	10415 TURTLE MOUNTAIN AVE LAS VEGAS NV 89166	12613513031
PHILLIPS CORY RUSSELL	7741 AMBERWOOD PEAK CT LAS VEGAS NV 89166-5220	12613616044
PHILLIPS LARRY & SARAH	10255 DANSKIN DR LAS VEGAS NV 89166-2506	12613520005
PHYLCON INC	3235 S RAINBOW #101 LAS VEGAS NV 89146-6215	12613501021
PICHOTTA MICHAEL	10272 GIBSON ISLE DR LAS VEGAS NV 89166	12613522017
PIPPIN GARY & KAREN B	587 NE 19TH AVE HILLSBORO OR 97124	12613513030
PLETINSKAYA EKATERINA V	10252 GLADSTONE PEAK ST LAS VEGAS NV 89166-5209	12613616013
POTOCZNY PAWEL M & JAEL W	10261 GIBSON ISLE DR LAS VEGAS NV 89166	12613522010
PRATER DENNIS & KIMBERLY	10136 HAYMARKET PEAK AVE LAS VEGAS NV 89166-5217	12613516063
PRICE COLE S	10229 DANSKIN DR LAS VEGAS NV 89166-2505	12613519018
PRIKHODKO VITALIY P & GANNA N	10144 NASH PEAK AVE LAS VEGAS NV 89166-5213	12613516021
R J E LIVING TRUST	EDGE ROSEMARY J TRS 10414 MOUNT WASHINGTON AVE LAS VEGAS NV 89166	12613513076
RABAH RAFFI D	7907 TORREYS PEAK ST LAS VEGAS NV 89149	12613114016
RACHMAT BAYU	YANTI FNU 10214 GIBSON ISLE DR LAS VEGAS NV 89166-2508	12613521015
RAFFONE EVELINA & HUGO	10331 BAYS MOUNTAIN AVE LAS VEGAS NV 89166-5001	12613615038
RAMIREZ ANTONIO & CECILIA B	1233 LIBERTY BELL CHERRYHILL NJ 08003	12613616023
RAMOS EDGAR P	SONGCO LINDSEY 10233 DANSKIN DR LAS VEGAS NV 89166	12613519016
RAMOS STEVEN R	7734 TREE LANE PEAK CT LAS VEGAS NV 89166-5219	12613616041
RAY BARBARA	10124 HAYMARKET PEAK AVE LAS VEGAS NV 89166-5217	12613516066
RECLOSADO MICHELLE L	10130 HARTFORD PEAK CT LAS VEGAS NV 89166-5218	12613616055
RENKEN MICHAEL & ROBIN	7940 TORREY PEAK ST LAS VEGAS NV 89166	12613513058
REYNA DAVID R & JEANINE N	7912 AIROLA PEAK ST LAS VEGAS NV 89166	12613513022
REYNOSO SAUL	7842 ASKEW PL LAS VEGAS NV 89166	12613518004
RHYMER PRESTON L & COURTNEY L	P S C 50 BOX 541 APO AE 09494	12613514015
RICE CRAIG M & ELIZABETH A	10147 HAYMARKET PEAK AVE LAS VEGAS NV 89166-5217	12613516007
RIVER GLIDER AVENUE TRUST	900 S LAS VEGAS BLVD #810 LAS VEGAS NV 89101-6850	12613517027
RIVERA CARLOS R & CINDE J	10406 WHITE PRINCESS AVE LAS VEGAS NV 89166-5084	12613513014
ROBINSON MONIQUE M	10430 WHITE PRINCESS AVE LAS VEGAS NV 89166	12613513008
RODAS-PINOCHET FAMILY TRUST	RODAS PINOCHET CARMEN A TRS 10429 WHITE PRINCESS AVE LAS VEGAS NV 89166	12613513042

Report of All Selected Parcels**Case Number:**VAR-66352, VAR-66353
~~MOB-88199, VAR-66346~~**Printed On:** Mon: September 12, 2016

<u>Owner</u>	<u>Address</u>	<u>Parcel Number</u>
RODRIGUEZ JANE R	10240 BLUE WATER PEAK AVE LAS VEGAS NV 89166-5211	12613616007
RODRIGUEZ-ANCHANTE CECILIA D	CHANG-WONG MIGUEL F 10240 GIBSON ISLE DR LAS VEGAS NV 89166-2509	12613521022
ROLLINS SCOTT S & LADONNA K	1677 DODGE RD ELLENBURG WA 98920	12613615045
ROMAN OSCAR E	PETERSON STACY R 7827 SUGARLOAF PEAK ST LAS VEGAS NV 89166-5019	12613514005
ROMANO KRISTLYNN C & CHRISTOPHER	7851 TORREYS PEAK ST LAS VEGAS NV 89166-5076	12613114012
ROMER TRUST	ROMER PRISCILLA M TRS 3891 PURPLE PLUM CT LAS VEGAS NV 89147	12613517004
ROMER TRUST	ROMER PRISCILLA M TRS 3891 PURPLE PLUM CT LAS VEGAS NV 89147	12613522002
ROMER TRUST	ROMER PRISCILLA M TRS 3891 PURPLE PLUM CT LAS VEGAS NV 89147	12613517003
ROSS FAMILY REVOCABLE LIVING TRU	ROSS LINDA JENNEY & KENNETH M TR 7855 ASKEW PL LAS VEGAS NV 89166	12613518011
RUEGER LORI J	7817 ASKEW PL LAS VEGAS NV 89166	12613517001
RUSSELL DONALD J III & ANGELINA	10256 HEADRICK DR LAS VEGAS NV 89166-2502	12613517046
RUSZCZYK ROBERT & CYNTHIA	7741 FORTRESS PEAK CT LAS VEGAS NV 89166-5221	12613616021
RUZICKA AMANDA J	10203 BLUE WATER PEAK AVE LAS VEGAS NV 89166-5211	12613616071
RYLAND HOMES NEVADA L L C	8925 W RUSSELL RD #200 LAS VEGAS NV 89148	12613513105
RYLAND HOMES NEVADA L L C	8925 W RUSSELL RD #200 LAS VEGAS NV 89148	12613513059
RYLAND HOMES NEVADA L L C	8925 W RUSSELL RD #200 LAS VEGAS NV 89148	12613513101
RYLAND HOMES NEVADA L L C	8925 W RUSSELL RD #200 LAS VEGAS NV 89148	12613513060
RYLAND HOMES NEVADA L L C	8925 W RUSSELL RD #200 LAS VEGAS NV 89148	12613513082
RYLAND HOMES NEVADA L L C	8925 W RUSSELL RD #200 LAS VEGAS NV 89148	12613513103
RYLAND HOMES NEVADA L L C	8925 W RUSSELL RD #200 LAS VEGAS NV 89148	12613513098
RYLAND HOMES NEVADA L L C	8925 W RUSSELL RD #200 LAS VEGAS NV 89148	12613513094
RYLAND HOMES NEVADA L L C	8925 W RUSSELL RD #200 LAS VEGAS NV 89148	12613513095
RYLAND HOMES NEVADA L L C	8925 W RUSSELL RD #200 LAS VEGAS NV 89148	12613513096
RYLAND HOMES NEVADA L L C	8925 W RUSSELL RD #200 LAS VEGAS NV 89148	12613513104
RYLAND HOMES NEVADA L L C	8925 W RUSSELL RD #200 LAS VEGAS NV 89148	12613513033
SADLE KEVIN & KAREN	7743 TREE LANE PEAK CT LAS VEGAS NV 89166	12613616037
SAHARA WRIGHT L L C	8635 W SAHARA AVE #100 LAS VEGAS NV 89117	12613518014
SAIN RANDY W & MARIA T	P S C 10 BOX 1658 APO AE 09142	12613615044
SALAZAR JOSE & MARISOL	7742 FORTRESS PEAK CT LAS VEGAS NV 89166-5221	12613616024
SALVATION ARMY	180 E OCEAN BLVD LONG BEACH CA 90802	12613114008
SAMMARCO ROSSI & SUSAN	7741 EAGLE ROCK PEAK CT LAS VEGAS NV 89166	12613616029
SAMUELS RICHARD & MARY-MARGARET	10422 GROTTO MOUNTAIN AVE LAS VEGAS NV 89166-5008	12613514010

Report of All Selected ParcelsCase Number:VAR-66352, VAR-66353
~~MOD-66199, VAR-66346~~Printed On: Mon: September 12, 2016

<u>Owner</u>	<u>Address</u>	<u>Parcel Number</u>
SANCHEZ MIGUEL A & ELVA L	7932 AIROLA PEAK ST LAS VEGAS NV 89166-5021	12613513017
SANDERS VICTORIA	10251 DANSKIN DR LAS VEGAS NV 89166-2506	12613520006
SANGUINETTI CAROL POMBO	10312 BUSH MOUNTAIN AVE LAS VEGAS NV 89166	12613520017
SANTOS JUAN & MILAGROS	7752 SUNDIAL PEAK ST LAS VEGAS NV 89166-5006	12613514021
SATO REVOCABLE FAMILY TRUST	SATO ROBERT T & GAYLE N TRS 7728 SUNDIAL PEAK ST LAS VEGAS NV 89166-5006	12613615006
SATO-HONDA REVOCABLE FAMILY TR	SATO KENNETH T TRS 7740 SUNDIAL PEAK ST LAS VEGAS NV 89166	12613615003
SCALLY HEATHER	10120 HAYMARKET PEAK AVE LAS VEGAS NV 89166-5217	12613516067
SCHAIBLEY DEAN & ERICA L	7747 SUGARLOAF PEAK ST LAS VEGAS NV 89166	12613615030
SCHERER LOUISE & DAVID	10268 DANSKIN DR LAS VEGAS NV 89166-2506	12613520015
SCHROEDER JEFFREY J & LINDSAY N	10141 NASH PEAK AVE LAS VEGAS NV 89166-5213	12613516045
SCHUEBEL JASON M	10025 SCENIC WALK AVE LAS VEGAS NV 89149-3774	12518111085
SECTION 12 L L C	11411 SOUTHERN HIGHLANDS #300 LAS VEGAS NV 89141	12612000001
SEGURA LORENA	GALLEGOS RICHARD 10508 WHITE PRINCESS AVE LAS VEGAS NV 89166	12613114007
SEMINOLE FAMILY LIVING TRUST	9974 RAMS LEAP AVE LAS VEGAS NV 89166	12613521024
SEPULVEDA BOBBIE	10257 GIBSON ISLE DR LAS VEGAS NV 89166	12613522011
SERPA HECTOR & GIANNINA	10239 BLUE WATER PEAK AVE LAS VEGAS NV 89166-5211	12613616002
SHAKERI CYRUS & KIMM M	10218 DANSKIN DR LAS VEGAS NV 89166-2504	12613519031
SHEER RONALD E & KATHLEEN M	10156 NASH PEAK AVE LAS VEGAS NV 89166-5214	12613516018
SHERMAN ANDREW	10445 WHITE PRINCESS AVE LAS VEGAS NV 89166	12613513038
SHRIVER CHRISTOPHER	10140 NASH PEAK AVE LAS VEGAS NV 89166-5213	12613516022
SILVERMAN SORAYA	10221 GIBSON ISLE DR LAS VEGAS NV 89166-2508	12613521008
SKAGGS JOSEPH G & BRENDA L	6680 FARM RD LAS VEGAS NV 89131	12613516019
SLATSKY MARTIN	10033 SCENIC WALK AVE LAS VEGAS NV 89149-3774	12518111087
SMITH ANTHONY J	RELOS DAVID C 10428 BAYS MOUNTAIN AVE LAS VEGAS NV 89166-5002	12613514037
SMITH JENNIFER THERESA	10155 HAYMARKET PEAK AVE LAS VEGAS NV 89166-5217	12613516009
SMITH RONALD L & CHONG H	10219 BLUE WATER PEAK AVE LAS VEGAS NV 89166	12613616075
SNODGRASS THEODORE III	10136 IRON WOOD PEAK AVE LAS VEGAS NV 89166-5216	12613516049
SOKO TRUST	SOKOLOWSKI NICHOLAS R SR TRS 9933 MAGIC DUNES LAS VEGAS NV 89149-1948	12518111053
SOMMER COLE ALBERT & KELLI S	7738 TREE LANE PEAK CT LAS VEGAS NV 89166-5219	12613616040
SPIECE DARREN M	HILGER JENNY L 10264 GIBSON ISLE DR LAS VEGAS NV 89166	12613522015
SPREDEMAN LORI A	7724 SUNDIAL PEAK ST LAS VEGAS NV 89166	12613615007
SPRINGHETTI MARK R & CARINA I	10438 MOUNT WASHINGTON AVE LAS VEGAS NV 89166-5057	12613513070

Report of All Selected ParcelsCase Number:VAR-66352, VAR-66353
~~MOD-66199, VAR-66346~~Printed On: Mon: September 12, 2016

<u>Owner</u>	<u>Address</u>	<u>Parcel Numbe</u>
SPROULE SCOTT LIVING TRUST	33216 ELDROW RD AGUA DULCE CA 91390	12613518006
STINEHOUR JASON A	10215 DANSKIN DR LAS VEGAS NV 89166-2504	12613519025
STOKER NICHOLAS K & DEBBY A	7936 FARRALON RIDGE CT LAS VEGAS NV 89149-3769	12518111058
STOUT RANDY L	7739 SUGARLOAF PEAK ST LAS VEGAS NV 89166-5020	12613615028
STUTZMAN WILLIAM P	10132 HAYMARKET PEAK AVE LAS VEGAS NV 89166-5217	12613516064
SUAN CECILIA C	SIGA AVELINO P JR 7733 AMBERWOOD PEAK AVE LAS VEGAS NV 89166	12613616042
SULLIVAN DANIEL J & AMANDA Y	10244 GIBSON ISLE DR LAS VEGAS NV 89166-2509	12613521023
SUMMIT PROVIDENCE L L C	3425 CLIFF SHADOWS PKWY #110 LAS VEGAS NV 89129	12613214009
SUMMIT PROVIDENCE L L C	3425 CLIFF SHADOWS PKWY #110 LAS VEGAS NV 89129	12613214007
SUMMIT PROVIDENCE L L C	3425 CLIFF SHADOWS PKWY #110 LAS VEGAS NV 89129	12613214008
SUMMIT PROVIDENCE L L C	3425 CLIFF SHADOWS PKWY #110 LAS VEGAS NV 89129	12613214004
SUMMIT PROVIDENCE L L C	3425 CLIFF SHADOWS PKWY #110 LAS VEGAS NV 89129	12613214005
SUMMIT PROVIDENCE L L C	3425 CLIFF SHADOWS PKWY #110 LAS VEGAS NV 89129	12613214006
SUMO PROPERTIES L L C	7120 SMOKE RANCH RD LAS VEGAS NV 89128-3157	12613514022
SURIANO ANDREW JAMES RUDOLPH REV	SURIANO ANDREW JAMES RUDOLPH TRS 10271 DANSKIN DR LAS VEGAS NV 89166-2506	12613520001
SWALWELL TRAVIS	10241 GIBSON ISLE DR LAS VEGAS NV 89166	12613521003
SYLVESTER STEVEN	10145 NASH PEAK AVE LAS VEGAS NV 89166-5213	12613516046
TAN GIFFEN	9120 HARBOR WIND AVE LAS VEGAS NV 89178	12613517050
TANNER HOYT D	LAUCELLA EMILY 10328 RUGGED MOUNTAIN AVE LAS VEGAS NV 89166-5014	12613615042
TEDDER RENE M	7850 ASKEW PL LAS VEGAS NV 89166-1200	12613518008
THISTLE ROBERT A & BRITTANY H	10145 BLUE WATER PEAK AVE LAS VEGAS NV 89166-5210	12613616068
THOMASON FRANCES LIVING TRUST	THOMASON FRANCES & TODD CO-TRS 7734 EAGLE ROCK PEAK CT LAS VEGAS NV 89166-5222	12613616034
THOMPSON FAMILY TRUST	THOMPSON GEOFFREY & C CO-TRS 7806 SUNDIAL PEAK ST LAS VEGAS NV 89166-5006	12613514019
THOMPSON MORGAN MERCEDES	10281 GIBSON ISLE DR LAS VEGAS NV 89166	12613522005
THORNE CHRISTOPHER A & MARIELLE	7916 AIROLA PEAK ST LAS VEGAS NV 89166	12613513021
THURMAN SHANE	1781 MARGARITA LOOP ALAMOGORDO NM 88310	12613522024
TINITIGAN FRANCESCA O	10238 DANSKIN DR LAS VEGAS NV 89166	12613519041
TISCOPA PROPERTIES L L C	2629 VIA FIRENZE AVE HENDERSON NV 89044	12613521020
TODD ALEXANDER & EVELYN	7823 CASTLE ROCK PEAK ST LAS VEGAS NV 89166-5215	12613516012
TOMCZYK AMY & BRIAN	10420 TURTLE MOUNTAIN AVE LAS VEGAS NV 89166	12613513102
TORBECK TYLER HARRISON	JORDAN ASHLY EMILY 7910 TORREYS PEAK ST LAS VEGAS NV 89166-5076	12613513065
TORRECAMPO JEFFERSON & C S	10236 GIBSON ISLE DR LAS VEGAS NV 89166-2509	12613521021

Report of All Selected Parcels**Case Number:**VAR-66352, VAR-66353
~~MOB-66499, VAR-66346~~**Printed On:** Mon: September 12, 2016

<u>Owner</u>	<u>Address</u>	<u>Parcel Numbe</u>
TORRES CHRISTIAN J	7832 RHODORA PEAK ST LAS VEGAS NV 89166-5212	12613516032
TOWNSEND BRIAN CHRISTOPHER SR	BREWER-TOWNSEND SHANELL 10421 WHITE PRINCESS AVE LAS VEGAS NV 89166	12613513044
TRIVEDI ROHIT R	38730 LEXINGTON ST #279 FREMONT CA 94536-6289	12613517005
TROSS JAMES ROBERT & LYNN	7926 TORREYS PEAK ST LAS VEGAS NV 89166	12613513061
TURNER BRIAN & CAMILLE	4209 N DUSTIN AVE FARMINGTON NM 87401	12613518012
UNGER FERNE S TRUST	UNGER FERNE S TRS 7814 SUNDIAL PEAK ST LAS VEGAS NV 89166-5006	12613514017
USON CORAZON T	7836 RHODORA PEAK ST LAS VEGAS NV 89166-5212	12613516031
VACA SALVADOR R & BETHZAIDA P	21431 MORESBY WAY LAKE FOREST CA 92630	12613519014
VALVO RUSSELL	SENYAHAN-VALVO SHEIRYL R 10211 DANSKIN DR LAS VEGAS NV 89166	12613519027
VANSANT MATTHEW	7903 TORREYS PEAK ST LAS VEGAS NV 89166-5076	12613114015
VAZQUEZ LUZ M	KOSLOFF DYLAN 10419 TURTLE MOUNTAIN AVE LAS VEGAS NV 89166	12613513032
VELANDRIA FLOREDELYN & RUEL	10445 TURTLE MOUNTAIN AVE LAS VEGAS NV 89166-5081	12613513037
VERLEY MATT & DEMARIS	83428 RAGHORN RD SEASIDE OR 97138	12613517034
VICK JONATHAN D & NAASHIA C	10245 GIBSON ISLE DR LAS VEGAS NV 89166-2509	12613521002
VOLDEN JOSEPH M	10127 HAYMARKET PEAK AVE LAS VEGAS NV 89166	12613516002
VOROS VICTORIA	24157 MATTHEW PL NEWHALL CA 91321	12613518001
VOSE SARAH E & JAKE T	10227 BLUE WATER PEAK AVE LAS VEGAS NV 89166-5211	12613616077
WAGNER TODD M	10446 MOUNT WASHINGTON AVE LAS VEGAS NV 89166-5057	12613513068
WALKER CHARLES SCOTT	10422 MT WASHINGTON AVE LAS VEGAS NV 89166-5056	12613513074
WALKER DANIEL	10237 GIBSON ISLE DR LAS VEGAS NV 89166-2509	12613521004
WARNACK JUSTIN D	10112 NASH PEAK AVE LAS VEGAS NV 89166-5213	12613516029
WARREN PATRICK J & JULIE M	8560 W FISHER AVE LAS VEGAS NV 89149-4058	12613513016
WASHINGTON ANGEL	10133 NASH PEAK AVE LAS VEGAS NV 89166-5213	12613516043
WATSON STEFAN JR	10255 HEADRICK DR LAS VEGAS NV 89166	12613517012
WCIORKA JUERGEN & MARLENE	10409 BAYS MOUNTAIN AVE LAS VEGAS NV 89166-5002	12613615034
WEAVER DAVID E & JILL C	10220 GIBSON ISLE DR LAS VEGAS NV 89166-2508	12613521017
WEBB JILLIAN G	10137 BLUE WATER PEAK AVE LAS VEGAS NV 89166-5210	12613616066
WELLS JOSHUA	10244 GLADSTONE PEAK ST LAS VEGAS NV 89166-5209	12613616015
WHIPPLE BRANDON & KRISTAL A	10439 PRAIRIE MOUNTAIN AVE LAS VEGAS NV 89166	12613513083
WHITE SHANTEL R	10262 HEADRICK DR LAS VEGAS NV 89166-2502	12613517049
WILHELM KAPUALEILANI TEAURE	P O BOX 271324 LAS VEGAS NV 89127-1324	12613517047
WILLIAMS EBONY M	10265 GIBSON ISLE DR LAS VEGAS NV 89166	12613522009

Report of All Selected Parcels**Case Number:**VAR-66352, VAR-66353
~~VAR-66199, VAR-66246~~**Printed On:** Mon: September 12, 2016

<u>Owner</u>	<u>Address</u>	<u>Parcel Number</u>
WILLIAMS GLEN V REVOCABLE TRUST	WILLIAMS GLEN V TRS 5555 MICHELLI CREST WY LAS VEGAS NV 89149-0901	12613517030
WILLIAMS JEFFREY S & MICHELLE R	10249 HEADRICK DR LAS VEGAS NV 89166	12613517015
WILLIAMS JOSHUA R & AMANDA A	10228 GIBSON ISLE DR LAS VEGAS NV 89166-2509	12613521019
WILSON JOHN M	GADLEY TEENA 10410 WHITE PRINCESS AVE LAS VEGAS NV 89166	12613513013
WILSON THOMAS A LIVING TRUST	WILSON THOMAS A TRS 3510 LACROSS DR BRYANT AR 72022-9314	12613519024
WILSTEAD ROBERT TAB & TAMARA MAR	10444 TURTLE MOUNTAIN AVE LAS VEGAS NV 89166	12613513108
WINBERG ROBERT C & DANICA M	7819 ASKEW PL LAS VEGAS NV 89166	12613518003
WOJDE ELZBIETA	7756 SUNDIAL PEAK ST LAS VEGAS NV 89166-5006	12613514020
WOLLENZIEN RICK D & HEATHER	10247 DANSKIN DR LAS VEGAS NV 89166	12613520007
WOOD ALAN GEORGE & LEE ANNE	7921 FARRALON RIDGE CT LAS VEGAS NV 89149	12518111055
WOOD SHAWN KIRKPATRIC & SHAUNA	10236 GLADSTONE PEAK ST LAS VEGAS NV 89166-5209	12613616017
WOODALL OSCAR J	7810 SUNDIAL PEAK ST LAS VEGAS NV 89166-5006	12613514018
WOODSIDE HOMES NEVADA L L C	4670 S FORT APACHE RD #200 LAS VEGAS NV 89147	12507410004
WOODSIDE MADISON COLONY L L C	4730 S FORT APACHE RD #370 LAS VEGAS NV 89147-7948	12613522027
WOODY GORDON E & MAY P VASQUEZ	P O BOX 671 MOUNTLAKE TERRACE WA 98043	12613522007
WORLAND DANIEL J & LAURA C	10116 NASH PEAK AVE LAS VEGAS NV 89166-5213	12613516028
WRIGHT BARBARA J & DAVID	7811 SUGARLOAF PEAK ST LAS VEGAS NV 89166	12613514001
WRIGHT MARVIN & PAULETTE	10454 PRAIRIE MOUNTAIN AVE LAS VEGAS NV 89166	12613513055
WU JAMES C	10224 GIBSON ISLE DR LAS VEGAS NV 89166-2508	12613521018
WYATT JASON O	10234 DANSKIN DR LAS VEGAS NV 89166	12613519039
WYLLER LIVING TRUST	WYLLER ALF E & ARDYTH A TRS P O BOX 817 SHERWOOD OR 97140-0817	12613513020
YANKEE REVOCABLE LIVING TRUST	7840 BLUE LAKE PEAK ST LAS VEGAS NV 89166	12613113025
YEH BING	901 S FREMONT AVE #248 ALHAMBRA CA 91803-4706	12613517041
YOUHTARENKO ANTON	7904 FARRALON RIDGE CT LAS VEGAS NV 89149-3769	12518111062
YUNIS JULIANA K & JONATHAN G	10131 BLUE WATER PEAK AVE LAS VEGAS NV 89166-5210	12613616065
ZAPANTA ERIC	10223 DANSKIN DR LAS VEGAS NV 89166-2504	12613519021
ZORN ZACHARY L & JESSICA B	10426 MT WASHINGTON AVE LAS VEGAS NV 89166-5056	12613513073