

City of Las Vegas  
Department of Planning  
Development Services Center  
333 North Rancho Drive, 3<sup>rd</sup> Floor  
Las Vegas, Nevada 89106

SR ✓  
PRSR  
FIRST CLASS MAIL  
U.S. Postage  
**PAID**  
Las Vegas, NV  
Permit No. 1630

**Return Service Requested**  
**Official Notice of Public Hearing**

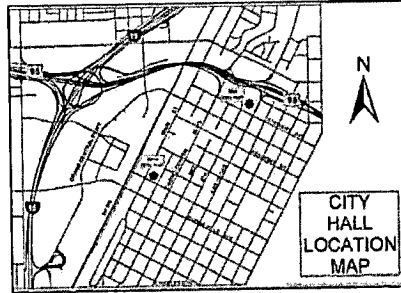

If you wish to file your protest or support on this request, check the appropriate box below and return this card in an envelope with postage to the Department of Planning at the address listed above, fax this side of this card to (702) 464-7499 or make your comments at [www.lasvegasnevada.gov](http://www.lasvegasnevada.gov). If you would like to contact your Council Representative, please call (702) 229-6405.

I SUPPORT  
this Request

I OPPOSE  
this Request

Please use available blank space on card for your comments.  
**VAR-65321 & VAR-65326 & WVR-65331 [PRJ-65268]**  
Planning Commission Meeting of 8/9/2016

10 ✓

## Application Information

**VAR-65321 - VARIANCE - PUBLIC HEARING - APPLICANT: DR HORTON - OWNER: GREENGALE PROPERTIES, LLC** - For possible action on a request for a Variance TO ALLOW A NINE-FOOT REAR YARD SETBACK WHERE 30 FEET IS REQUIRED ON LOT 78 OF A PROPOSED 95-LOT SINGLE-FAMILY RESIDENTIAL SUBDIVISION on 39.18 acres at the southeast corner of Elkhorn Road and Tenaya Way (APN 125-22-501-001), R-D (Single Family Residential-Restricted) Zone, Ward 6 (Ross) [PRJ-65268].

**VAR-65326 - VARIANCE - PUBLIC HEARING - APPLICANT: DR HORTON - OWNER: GREENGALE PROPERTIES, LLC** - For possible action on a request for a Variance TO ALLOW NO ADDITIONAL OFFSITE IMPROVEMENTS WHERE COMPLETE STREETS STANDARDS REQUIRE A FIVE-FOOT SIDEWALK, A FIVE-FOOT AMENITY ZONE AND OTHER AMENITIES ALONG ELKHORN ROAD AND TO ALLOW A CONNECTIVITY RATIO OF 1.25 WHERE 1.30 IS THE MINIMUM REQUIRED on 39.18 acres at the southeast corner of Elkhorn Road and Tenaya Way (APN 125-22-501-001), R-D (Single Family Residential-Restricted) Zone, Ward 6 (Ross) [PRJ-65268].

**WVR-65331 - WAIVER - PUBLIC HEARING - APPLICANT: DR HORTON - OWNER: GREENGALE PROPERTIES, LLC** - For possible action on a request for a Waiver FROM LVMC 13.52 TO ALLOW OVERHEAD TRANSMISSION LINES WHERE UNDERGROUND UTILITIES ARE REQUIRED on 39.18 acres at the southeast corner of Elkhorn Road and Tenaya Way (APN 125-22-501-001), R-D (Single Family Residential-Restricted) Zone, Ward 6 (Ross) [PRJ-65268].

Any and all interested persons may appear before the City Planning Commission either in person or by representative and object to or express approval of this request; or may, prior to this meeting, file a written objection thereto or approval thereof with the Department of Planning, Development Services Center, 333 North Rancho Drive, 3<sup>rd</sup> Floor, Las Vegas, Nevada 89106. Final Action on General Plan Amendments and Rezonings will be determined by the City Council. Other public hearing items may be deemed Final Action by the Planning Commission or forwarded to the City Council. The date of the City Council meeting, if applicable, will be announced at the Planning Commission meeting after the discussion of the item. For further information, including the full staff report, please call (702) 229-6301 (TDD 386-9108) or go to <http://www.lasvegasnevada.gov>.

## Application Location

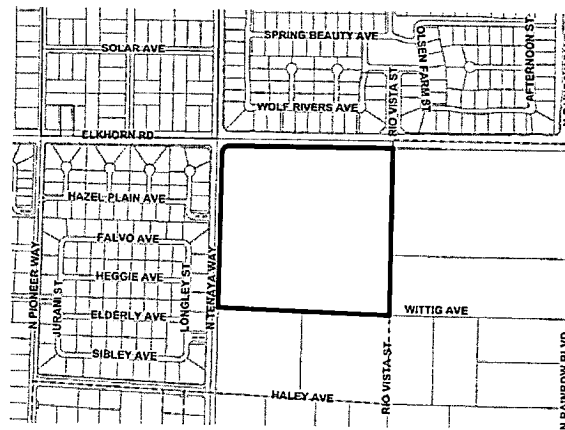

The proposed project may not pertain to the entire highlighted project site.

## Public Hearing Information

**Meeting:** Planning Commission  
**Date:** *August 09, 2016*  
**Time:** 6:00 P.M.  
**Location:** City Council Chambers  
495 South Main Street, 2<sup>nd</sup> Floor  
Las Vegas, Nevada 89101

S✓

VAR 65321, VAR-65326 & VAR-65331

**Report of All Selected Parcels**

Case Number:

~~VAR-65209, etc.~~

Printed On: Tue: August 9, 2016

<u>Owner</u>	<u>Address</u>	<u>Parcel Number</u>
ALDEROAKS TRUST	7020 W DEER SPRINGS WY LAS VEGAS NV 89131-3427	12522601010
ALLEN JOHN R & YVONNE S	7252 N MONTE CRISTO WY LAS VEGAS NV 89131-3339	12515405001
ALLISON MARK E	7321 ELDERLY AVE LAS VEGAS NV 89131-3223	12522212028
ANDERSON CHARLES MICHAEL	7150 SUDLEY CT LAS VEGAS NV 89131-3234	12522113011
AOUN ELIE	7141 SUDLEY CT LAS VEGAS NV 89131-3234	12522113010
ARMSTRONG THOMAS J & CAROLYN M	7331 FALVO AVE LAS VEGAS NV 89131-3240	12522114027
ATKINSON THEODORE C & MARIA	7260 ELKHORN RD LAS VEGAS NV 89131-3345	12515405013
BABCOCK ELIZABETH T	7220 DEER SPRINGS WY LAS VEGAS NV 89131-3529	12522203018
BALLS ERIC S & TINA K	7310 ELDERLY AVE LAS VEGAS NV 89131	12522212018
BALZO DENA DEL LIVING TRUST	BALZO DENA DEL TRS 7290 SEA ANCHOR CT LAS VEGAS NV 89131-0142	12515811074
BERRY MAX & MARCELLA FAMILY TR	BERRY MAX W & MARCELLA S TRS 7345 N TENAYA WY LAS VEGAS NV 89131-0103	12515403010
BERTGES LORI K	5455 S DURANGO DR #140 LAS VEGAS NV 89113-1868	12522203017
BIERSTEDT JEFFREY L	7101 SPRING BEAUTY AVE LAS VEGAS NV 89131-0136	12515811059
BLOMQUIST RICHARD & HOLLY	7300 SIBLEY AVE LAS VEGAS NV 89131-3225	12522212035
BOYETTE ROBERT A	7310 FALVO AVE LAS VEGAS NV 89131-3240	12522114007
BROWN ALLEN & JEANETTE LIV TR	BROWN ALLEN E & C JEANETTE TRS 7320 ELDERLY AVE LAS VEGAS NV 89131-3223	12522212017
BURKE MARY HYDAR	6888 RIO VISTA ST LAS VEGAS NV 89131-3431	12522603001
BURNETT JOHN	7231 FALVO AVE LAS VEGAS NV 89131-3236	12522114032
BURR WARREN C & PATRICIA M	6903 KELP LEDGE CT LAS VEGAS NV 89131-0122	12515810055
BUSTAMANTE JOHN E	7321 HEGGIE AVE LAS VEGAS NV 89131-3232	12522114023
CADE JOHN E III	HUENFELDT SAMANTHA 6900 KELP LEDGE CT LAS VEGAS NV 89131-0122	12515810051
CAITO GREGORY V	PHILLIPS CAROL J 7089 SPRING BEAUTY AVE LAS VEGAS NV 89131-0136	12515811056
CAJTHAML JAMES B	PRESSER-CAJTHAML KERRI 6899 KELP LEDGE CT LAS VEGAS NV 89131-0122	12515810056
CANAFF ADAM & LISA	7294 MOUNT KEARSARGE ST LAS VEGAS NV 89131	12515811065
CANTU JOE & KATELYN J	7225 SOLAR AVE LAS VEGAS NV 89131-3310	12515405006
CARDEN ZACHARY J	7281 MOUNT KEARSARGE ST LAS VEGAS NV 89131	12515811014
CARDWELL-LUETKEMEYER LIVING TR	LUETKEMEYER DENNIS C TRS 6896 KELP LEDGE CT LAS VEGAS NV 89131-0122	12515810050
CARLSON SCHONNA M	7289 SEA BOOT CT LAS VEGAS NV 89131-0141	12515811077
CASTILLO NOEL M & JOCELYN M	7321 FALVO AVE LAS VEGAS NV 89131-3240	12522114028
CHILDRESS BRUCE	7097 SPRING BEAUTY AVE LAS VEGAS NV 89131-0136	12515811058
CLARY SPENDTHRIFT TRUST	CLARY RALPH ESTES JR & G D TRS 7275 N MONTE CRISTO WY LAS VEGAS NV 89131-3335	12515404006
CLEMENT STEVEN D TRUST	CLEMENT STEVEN D TRS 7000 LONGLEY ST LAS VEGAS NV 89131	12522114016

10✓

**Report of All Selected Parcels**Case Number:

VAR 05260, etc.

Printed On: Tue: August 9, 2016

<u>Owner</u>	<u>Address</u>	<u>Parcel Number</u>
CLUCAS FAMILY TRUST	CLUCAS JERRY K & SHIRLEY A TRS 7225 N MONTE CRISTO WY LAS VEGAS NV 89131-3335	12515404015
COOK CHAD ALLEN & KATHRYN A	7115 WOLF RIVERS AVE LAS VEGAS NV 89131-0139	12515811012
COOK SANDRA J	7116 SPRING BEAUTY AVE LAS VEGAS NV 89131	12515811047
COOPER FAMILY LIVING TRUST	COOPER JAMES L & DIANA L TRS 7297 SEA ANCHOR CT LAS VEGAS NV 89131-0142	12515811071
CORDNER MARK R & NAOMI E	6887 MAY BASKET AVE LAS VEGAS NV 89131	12515810023
CORNEY LEE & PAMELA	7298 SEA BOOT CT LAS VEGAS NV 89131-0141	12515811080
COX ORLO E III TRUST	COX ORLO E III TRS 7117 SPRING BEAUTY AVE LAS VEGAS NV 89131-0137	12515811063
CRUZ A & J FAMILY TRUST	CRUZ ANTONIO SR & JOSIE A TRS 7220 ELDERLY AVE LAS VEGAS NV 89131-3220	12522212022
DAHL ROBERT J & APRIL LOVE	7220 SOLAR AVE LAS VEGAS NV 89131-3309	12515403015
DELIN JOYCE M LIVING TRUST	DELIN JOYCE M TRS 6895 KELP LEDGE CT LAS VEGAS NV 89131-0122	12515810057
DEPAOLO MICHAEL & MICHELLE	7231 SIBLEY AVE LAS VEGAS NV 89131	12522212005
DINICOLA RICHARD S & SHELLEY S	7270 SOLAR AVE LAS VEGAS NV 89131-3309	12515403012
DOTTERO RALPH A & BERNADETTE M	7289 OLSEN FARM ST LAS VEGAS NV 89131-0124	12515810032
DRAKE ERIK A & STACIE L	PSC 2 BOX 14475 APO AE 09012	12515810033
DUARTE CINDY A & JAMES T	6915 MAY BASKET AVE LAS VEGAS NV 89131-0123	12515810030
DUFFEY TIMOTHY ALAN & CHARLOTTE	6911 GOOSE RIVER AVE LAS VEGAS NV 89131-0121	12515810041
ELSOM LAWRENCE C & KEIKO K	6907 KELP LEDGE CT LAS VEGAS NV 89131-0122	12515810054
EVANS SEAN P & HEATHER L	7121 DOGAN RIDGE ST LAS VEGAS NV 89131-3229	125222112007
F & W TRUST	WALDEN FREDERICK L TRS 7301 SIBLEY AVE LAS VEGAS NV 89131-3225	12522212007
FALVO E W QUAL PERS RES TR	FALVO J W QUAL PERS RES TR 7230 FALVO AVE LAS VEGAS NV 89131-3236	12522114010
FARMER DWIGHT F	ARCHIE JO ANN 7293 SEA ANCHOR CT LAS VEGAS NV 89131-0142	12515811070
FEATHERSTON MARY E & RICK J	7311 SIBLEY AVE LAS VEGAS NV 89131-3225	12522212008
FERNANDEZ FAUSTINO & GUADALUPE	7245 SOLAR AVE LAS VEGAS NV 89131-3310	12515405005
FIFE FAMILY TRUST	FIFE BRIAN K & PENNY J TRS 7240 FALVO AVE LAS VEGAS NV 89131-3239	12522114009
FILIPOV-NITA CRISTINA	FILIPOV CRISTINA 7320 HEGGIE AVE LAS VEGAS NV 89131	125222114041
FISK FAMILY TRUST	FISK JOHN EDGAR & CONSTANCE TRS 7285 SOLAR AVE LAS VEGAS NV 89131-3352	12515405002
FITZPATRICK RUSSELL G & KELLIE M	7290 SOLAR AVE LAS VEGAS NV 89131	12515403011
FLOWERS JULIAN S & BEVERLY K	7298 SEA ANCHOR CT LAS VEGAS NV 89131-0142	12515811072
FOREMAN FAMILY TRUST	FOREMAN JOHN RUSSELL & ELEANOR T 7113 SPRING BEAUTY AVE LAS VEGAS NV 89131-0137	12515811062
FOREST JASON D & KARLA M	7294 FARM POND ST LAS VEGAS NV 89131	12515811001
FOSTER MARGARET M REV LIV TR	FOSTER MARGARET M TRS 6891 MAY BASKET AVE LAS VEGAS NV 89131-0123	12515810024

**Report of All Selected Parcels**Case Number:~~VAR-85269, etc.~~Printed On: Tue: August 9, 2016

<u>Owner</u>	<u>Address</u>	<u>Parcel Number</u>
FOSTER MICHAEL E & LISA J	7298 MOUNT KEARSARGE ST LAS VEGAS NV 89131	12515811064
FOUR SEASONS TRUST	DELGADO-SCHUETZE ELIZABETH TRS 7294 SEA ANCHOR CT LAS VEGAS NV 89131-0142	12515811073
FRANK WILLIAM J & TERESA L	7087 WOLF RIVERS AVE LAS VEGAS NV 89131-0139	12515811005
FREHNER SHAWN D & SARAH Y	7245 N TENAYA WY LAS VEGAS NV 89131-2231	12515405009
GAEDE RAYMOND M & SANDRA A	7231 HAZEL PLAIN AVE LAS VEGAS NV 89131-3227	12522112017
GAMBINI PAUL & MICHELLE	7301 ELDERLY AVE LAS VEGAS NV 89131-3223	12522212026
GARCIA FRANKLIN A & JESSICA J	7104 SPRING BEAUTY AVE LAS VEGAS NV 89131	12515811050
GAZLAY MICHAEL J	7240 W SOLAR AVE LAS VEGAS NV 89131-3309	12515403014
GOLIMOWSKI MATTHEW L & AMY J	7311 HEGGIE AVE LAS VEGAS NV 89131-3245	12522114022
GREENGALE PROPERTIES L L C	6722 N RAINBOW LAS VEGAS NV 89131	12522501001
GREENGALE PROPERTIES L L C	6722 N RAINBOW LAS VEGAS NV 89131-3100	12522502010
GREENGALE PROPERTIES L L C	6722 N RAINBOW LAS VEGAS NV 89131-3100	12522502013
GRIMALDI ANTHONY & JUDY	9521 SPRING SUNSET CT LAS VEGAS NV 89149	12522114015
GRIMBLE BILLY & CONNIE	7120 GROVETON CT LAS VEGAS NV 89131-3226	12522112008
GUERRA DAVID A & KAORI S TRUST	GUERRA DAVID ALAN & KAORI S TRS 8221 SHAD BUSH AVE LAS VEGAS NV 89149-2001	12522203007
GUINAN BRETT T	7321 HAZEL PLAIN AVE LAS VEGAS NV 89131	12522113017
GUNTHER FAMILY TRUST	GUNTHER GEORGE G & VICKI M TRS P O BOX 750340 LAS VEGAS NV 89136-0340	12515811003
HALLAND SHAWN L & KELLEY H	7221 SILVER VALLEY ST LAS VEGAS NV 89149-0100	12515810039
HANKEL DARREN L & MARITES S	7084 SPRING BEAUTY AVE LAS VEGAS NV 89131	12515811055
HARDING ARVIS & GWENNETH	6852 N PIONEER WY LAS VEGAS NV 89131-3500	12522203020
HARRIS ALLYSON & KENNETH V	7301 HAZEL PLAIN AVE LAS VEGAS NV 89131-3228	12522113015
HARRISON FAMILY TRUST	HARRISON BARRET R LORI E TRS 7300 HEGGIE AVE LAS VEGAS NV 89131-3245	12522114039
HARTER TRUST	HARTER LARRY LEE & JUNE I TRS 6891 KELP LEDGE CT LAS VEGAS NV 89131-0122	12515810058
HAUX RICHARD SR	8996 MIRAMAR DR #310 SAN DIEGO CA 92126-4463	12515810035
HAWKINS ERNEST & CYNTHIA	7241 HEGGIE AVE LAS VEGAS NV 89131	12522114020
HENRICKSEN JOHN A JR & LORI E	7241 FALVO AVE LAS VEGAS NV 89131-3239	12522114031
HERBERT RICK W & CHRISTINE L	7300 ELDERLY AVE LAS VEGAS NV 89131-3223	12522212019
HILL OLIVER LEE & RITA	P O BOX 750691 LAS VEGAS NV 89136-0691	12515811049
HILLS DEAN A & KYMBERLY K	7313 MOUNT KEAR SARGE ST LAS VEGAS NV 89131-0138	12515811022
HORSEMINT CLASSICAL DRESSAGE CTR	7260 W AZURE DR #140-302 LAS VEGAS NV 89130-2405	12522602004
HORSEMINT CLASSICAL DRESSAGE CTR	7260 W AZURE DR #140-302 LAS VEGAS NV 89130-2405	12522602001
HORSEMINT CLASSICAL DRESSAGE CTR	7260 W AZURE DR #140-302 LAS VEGAS NV 89130-2405	12522602002

**Report of All Selected Parcels****Case Number:**~~VAR-65260~~, etc.**Printed On:** Tue: August 9, 2016

<u>Owner</u>	<u>Address</u>	<u>Parcel Number</u>
HORSEMINT CLASSICAL DRESSAGE CTR	7260 W AZURE DR #140-302 LAS VEGAS NV 89130-2405	12522602003
HOWLETT MICHAEL J & MELISSA H	7130 DOGAN RIDGE ST LAS VEGAS NV 89131	12522112003
HUGHES EDWARD M & SUSAN BROWN	7300 FALVO AVE LAS VEGAS NV 89131-3240	12522114008
HUNOLD CHRISTOPHER JAY	PATTERSON-HUNOLD SARAH 5328 LOCHMOR AVE LAS VEGAS NV 89130	12522114033
IDEHARA MIKE & SHANNON REVOCABLE	IDEHARA GEORGE M & SHANNON H TRS 7305 MOUNT KEARSARGE ST LAS VEGAS NV 89131-0138	12515811020
ISOLA L A TRUST	ISOLA LOUIS A TRS 7263 HALEY AVE LAS VEGAS NV 89131-3541	12522203008
JACKSON CHARLES E & PAULINE E	6895 MAY BASKET ST LAS VEGAS NV 89131-0123	12515810025
JARAMILLO CHRISTOPHER J	7150 GROVETON CT LAS VEGAS NV 89131-3226	12522112011
JOHNSON JAMES H & ADELMA E REVOC	7330 HEGGIE AVE LAS VEGAS NV 89131-3232	12522114042
JOHNSON WILLIAM L SR & GEORGETTE	7230 HEGGIE AVE LAS VEGAS NV 89131-3233	12522114037
JOHNSTON RICHARD D & SALLY J	7260 SOLAR AVE LAS VEGAS NV 89131-3309	12515403013
JOMPHE JEAN-FRANCOIS	6440 SKY POINTE DR #140 P M B 349 LAS VEGAS NV 89131-4048	12515811078
JONES EARL D	BECK ANGELA G 7215 N MONTE CRISTO WAY LAS VEGAS NV 89131	12515404016
JONES REGINA	P O BOX 750995 LAS VEGAS NV 89136-0995	12522112006
JORDAN DAVID LEE	3124 CENTAVO DR LAS VEGAS NV 89117	12515811016
KIDD OLIVER P & KARI J	7220 ELKHORN RD LAS VEGAS NV 89131-3304	12515405010
KINGO FAMILY TRUST	7331 ELDERLY AVE LAS VEGAS NV 89131-3223	12522212029
KLINE TIMOTHY D & JUDITH E	2684 SATURN DR LAKE ORION MI 48360-1735	12515810064
KNUDSEN LEIF & KIMBERLY	N7344 LURWOOD DR WHITEWATER WI 53190-4432	12515810067
KOENEN ROBERT D & BARBARA	6908 MAY BASKET AVE LAS VEGAS NV 89131	12515810065
KOERWITZ JAMES T & NICOLE	7275 SOLAR AVE LAS VEGAS NV 89131-3338	12515405003
KORKIDAS DARLENE M	7290 ELKHORN RD LAS VEGAS NV 89131-3345	12515405015
KOVACH RICHARD & BETTY LIVING TR	KOVACH RICHARD G TRS 7130 SUDLEY CT LAS VEGAS NV 89131-3234	12522113013
KOZISEK JOHN L	6904 KELP LEDGE CT LAS VEGAS NV 89131-0122	12515810052
KRAMER LAWRENCE	P O BOX 750400 LAS VEGAS NV 89136-0400	12515811002
KUFUOR FAMILY TRUST	KUFUOR NANA K & GENEVIEVE TRS 7140 SUDLEY CT LAS VEGAS NV 89131-3234	12522113012
KYNASTON FAMILY TRUST	KYNASTON ANDREW L & AMELIA R TRS 7105 SPRING BEAUTY AVE LAS VEGAS NV 89131-0136	12515811060
L N MANAGEMENT LLC SER 7311 FALV	P O BOX 36208 LAS VEGAS NV 89133	12522114029
LANG CHRISTINE A	7331 HEGGIE AVE LAS VEGAS NV 89131-3232	12522114024
LANINI GABRIEL	8931 SANDY ISLE CT LAS VEGAS NV 89131	12515811021
LEMASTER JEFFREY & MICHELLE	7021 WIITIG AVE LAS VEGAS NV 89131-3416	12522601027

**Report of All Selected Parcels****Case Number:**~~VAP 65269, etc.~~**Printed On:** Tue: August 9, 2016

<u>Owner</u>	<u>Address</u>	<u>Parcel Number</u>
LEONE JOSEPH L III & BERNADETTE	7330 ELDERLY AVE NORTH LAS VEGAS NV 89131-3223	12522212016
LEVY RICHARD A & NORA N	6908 KELP LEDGE CT LAS VEGAS NV 89131-0122	12515810053
LEWIS JEFFREY	7128 W DEER SPRINGS WAY LAS VEGAS NV 89131-3449	12522610006
LILLARD BRIAN D	7300 OLSEN FARM ST LAS VEGAS NV 89131	12515810038
LITTLE BRUCE W & NANCY M	6900 MAY BASKET AVE LAS VEGAS NV 89131-0123	12515810063
LOCKLEAR DALLAS S & ERIKA A	7030 LONGLEY ST LAS VEGAS NV 89131-3238	12522114013
LONGHURST JOHN & SANDY	7219 HALEY AVE LAS VEGAS NV 89131-3541	12522203003
LUKEN CHRISTOPHER P & GINGER M	7103 WOLF RIVERS AVE LAS VEGAS NV 89131-0139	12515811009
LUNT ROBERT & JODY FAMILY TRUST	LUNT ROBERT S & JODY D TRS 6903 GOOSE RIVER AVE LAS VEGAS NV 89131-0121	12515810043
MADSEN JAMES R	6310 MICHELLI CREST WAY LAS VEGAS NV 89149	12515811018
MAHROU BEHZAD & REBECCA	7296 OLSEN FARM ST LAS VEGAS NV 89131-0124	12515810037
MAIER MICHAEL G	ALEMAN-MAIER ISABEL P O BOX 750178 LAS VEGAS NV 89136-0178	12515810061
MARTIN FAMILY TRUST 1981	MARTIN FRANK E & BONNIE K TRS 3030 S HIGHLAND DR LAS VEGAS NV 89109-1047	12522603006
MARTIN JOHN M	6875 RIO VISTA ST LAS VEGAS NV 89131-3421	12522601005
MEAD ELSIE M	7240 N MONTE CRISTO WAY LAS VEGAS NV 89131-3334	12515405016
MEADOW LEE REVOCABLE TRUST	MEADOW LEE TRS 6911 MAY BASKET AVE LAS VEGAS NV 89131-0123	12515810029
MEYER W S TRUST ETAL	SOPKO CHERYL TRS 7088 SPRING BEAUTY AVE LAS VEGAS NV 89131-0136	12515811054
MOBLEY 1999 FAMILY TRUST	MOBLEY DONALD & QUEENIE E TRS 7210 FALVO AVE LAS VEGAS NV 89131-3236	12522114012
MONA'S TRUST	5223 156TH ST SE BOTHELL WA 98012	12522212024
MONTOYA DANIEL & ESTELA	7170 W DEER SPRINGS WY LAS VEGAS NV 89131-3449	12522610003
MOORE KATHERINE H & JASON J	7221 HAZEL PLAIN AVE LAS VEGAS NV 89131-3227	12522112018
MOORE PAMELA J	3019 IVANPAH DR HENDERSON NV 89074-6569	12522212021
MORGON FAMILY TRUST	MORGON JACK & DEBORAH M CO-TRS 7140 DOGAN RIDGE ST LAS VEGAS NV 89131-3229	12522112004
MORLEY FAMILY REVOCABLE LIV TR	MORLEY JAMES P JR & PATRICIA TRS 7295 N MONTE CRISTO WY LAS VEGAS NV 89131-3335	12515404004
MORROW JON & HEATHER	6896 MAY BASKET AVE LAS VEGAS NV 89131-0123	12515810062
MULHERN DONALD M & CLODY K	7229 HALEY AVE LAS VEGAS NV 89131-3541	12522203010
MUNDELL KEVIN R	7241 SIBLEY AVE LAS VEGAS NV 89131-3224	12522212006
NAYLOR JAMES V & NANCY R	6907 GOOSE RIVER AVE LAS VEGAS NV 89131-0121	12515810042
NICHOLAS CHRISTOPHER B & TUNE K	7297 OLSEN FARM ST LAS VEGAS NV 89131-0124	12515810034
NORLAND ALLAN C & NANCY W LIVING	NORLAND ALLAN C & NANCY W TRS 7060 W DEER SPRINGS WAY LAS VEGAS NV 89131	12522601008
NORLAND DONALD W & BRANDY JO	7080 W DEER SPRINGS WAY LAS VEGAS NV 89131	12522601007
NOVACK ROBERT E & SUSAN L	7265 SOLAR AVE LAS VEGAS NV 89131-3338	12515405004

**Report of All Selected Parcels****Case Number:**~~VAR 05200, etc.~~**Printed On:** Tue: August 9, 2016

<u>Owner</u>	<u>Address</u>	<u>Parcel Number</u>
O'BRIEN C S & K K REV LIV TR	O'BRIEN CHRISTOPHER S & K K TRS 7294 SEA BOOT CT LAS VEGAS NV 89131-0141	12515811081
O'BRIEN IRREVOCABLE TRUST	O'BRIEN RICHARD & KAROL TRS 6440 SKY POINTE DR #140-114 LAS VEGAS NV 89131-4047	12515811057
OCHIPINTI CARLO O	7285 MOUNT KEARSARGE ST LAS VEGAS NV 89131-0138	12515811015
OHENE FREDERICK A	AIDAM-OHENE LEBENE A 7140 GROVETON CT LAS VEGAS NV 89131-3226	12522112010
OLIVER CHAD & JENNIFER	7290 SEA BOOT CT LAS VEGAS NV 89131-0141	12515811082
OLSON SIEGLINDE S & RALPH R	19 VIA TORRE RANCHO SANTA MARGARITA CA 92688 -3174	12515811051
ORELLANA ELIZABETH	8200 STOCKDALE HWY M10-277 BAKERSFIELD CA 93311	12515811075
PAGE J & L FAMILY TRUST	PAGE JOSEPH R & LINDA L TRS 7230 SIBLEY AVE LAS VEGAS NV 89131-3224	12522212037
PATE MICHAEL J & KATHY L	7020 LONGLEY ST LAS VEGAS NV 89131	12522114014
PEDONE FAMILY TRUST	PEDONE MICHAEL A & DORIS L TRS 7120 DOGAN RIDGE ST LAS VEGAS NV 89131-3229	12522112002
PEPE BERNARD J	7107 WOLF RIVERS AVE LAS VEGAS NV 89131-0139	12515811010
PERDICHIZZI MARIO & DESIREE D	6920 LONGLEY ST LAS VEGAS NV 89131-3237	12522212001
PEREZ DAVID T & JESSICA E B	6899 MAY BASKET AVE LAS VEGAS NV 89131	12515810026
PETERSON BRETT & LESLIE	7289 SEA ANCHOR CT LAS VEGAS NV 89131-0142	12515811069
PETRILLO MARY LEE LIVING TRUST	PETRILLO MARY LEE TRS 7221 HEGGIE AVE LAS VEGAS NV 89131-3233	12522114018
PHAM KHANH B	7211 FALVO AVE LAS VEGAS NV 89131-3236	12522114034
POSANKE GEORGE P	7280 ELKHORN RD LAS VEGAS NV 89131-3345	12515405014
POSTMA CARL & HEIDI	7308 OLSEN FARM ST LAS VEGAS NV 89131-0124	12515810040
PRIETO-ROJAS FAMILY LIVING TRUST	PRIETO JAIME E TRS 1205 PACIFIC HWY #3106 SAN DIEGO CA 92101-8467	12515811007
PROPST DONALD E & JULIE LYNN	6903 MAY BASKET AVE LAS VEGAS NV 89131-0123	12515810027
RACHELS ARMON W & LORAIN D	7215 SOLAR AVE LAS VEGAS NV 89131-3341	12515405007
RAMOS NOE	7240 ELKHORN RD NORTH LAS VEGAS NV 89131-3340	12515405012
RAYFORD LEE E & BILLIE K LIV TR	RAYFORD LEE E & BILLIE K TRS 7096 SPRING BEAUTY AVE LAS VEGAS NV 89131-0136	12515811052
ROBINETT ROBERT E & LUCIA P	6900 LONGLEY ST LAS VEGAS NV 89131-3237	12522212002
ROCH JEFFREY S	7301 FALVO AVE LAS VEGAS NV 89131-3240	12522114030
ROSE ALYSON T	7141 GROVETON CT LAS VEGAS NV 89131-3226	12522112012
ROTH HARVEY D & RENEE I	7301 MOUNT KEARSARGE ST LAS VEGAS NV 89131-0138	12515811019
RUBALCAVA GONZALO H	7220 HEGGIE AVE LAS VEGAS NV 89131-3233	12522114036
RUGGEROLI NICK & VICKIE	7282 FARM POND ST LAS VEGAS NV 89131-0140	12515811004
S F R INVESTMENTS POOL 1 L L C	5030 PARADISE RD #B-214 LAS VEGAS NV 89119	12515811013
SANDERS JOHN J	COON CHRISSIE 7293 MOUNT KEARSARGE ST LAS VEGAS NV 89131-0138	12515811017
SANTOS TRACY	7310 SIBLEY AVE LAS VEGAS NV 89131-3225	12522212034

**Report of All Selected Parcels****Case Number:**~~VAR 05200~~, etc.**Printed On:** Tue: August 9, 2016

<u>Owner</u>	<u>Address</u>	<u>Parcel Numbe</u>
SCHLIEP DIXIE LEE REVOCABLE TR	SCHLIEP DIXIE LEE TRS 9712 SERENE STAR WY LAS VEGAS NV 89149	12515811067
SCHULTZ ROBERT E	COLUMBO VALENTINA M 7285 SEA ANCHOR CT LAS VEGAS NV 89131-0142	12515811068
SCOTT JIMMIE J	MCELROY BARBARA JO 7330 SIBLEY AVE LAS VEGAS NV 89131-3225	12522212032
SENN MICHAEL J & DEBORAH L	7292 OLSEN FARM ST LAS VEGAS NV 89131-0124	12515810036
SHACKLEY DONALD	7141 DOGAN RIDGE ST LAS VEGAS NV 89131-3229	12522112005
SHENANDOAH OWNERS ASSOCIATION	6767 W TROPICANA AVE #200 LAS VEGAS NV 89103	12522212039
SHENANDOAH OWNERS ASSOCIATION	6767 W TROPICANA AVE #200 LAS VEGAS NV 89103	12522212038
SIMMONS THOMAS W & EDITH	7340 ELKHORN RD LAS VEGAS NV 89131-3336	12515404014
SKVAREK CHARLES F & PHONGSAVANH	7184 W DEER SPRINGS WY LAS VEGAS NV 89131-3449	12522610002
SMITH RYAN L	6888 MAY BASKET AVE LAS VEGAS NV 89131	12515810060
SONERHOLM LIVING TRUST	SONERHOLM CHAD L & KIMBERLY K TR 7210 HEGGIE AVE LAS VEGAS NV 89131-3233	12522114035
SORIANO MARK J & ROSEMARIE M	7076 SPRING BEAUTY AVE LAS VEGAS NV 89131-0136	12515810066
SOTELO TETSUO	7241 HAZEL PLAIN AVE LAS VEGAS NV 89131-3227	12522112016
SPINAK AARON	WRIGHT PATRICIA K 7211 SIBLEY AVE LAS VEGAS NV 89131-3224	12522213002
SPRIESTERBACH HAROLD & F FAM TR	SPRIESTERBACH HAROLD R & F TRS 6907 MAY BASKET AVE LAS VEGAS NV 89131-0123	12515810028
STELLA VINCENT J & MARY C	7311 ELDERLY AVE LAS VEGAS NV 89131-3223	12522212027
STEMPIEN THERESA L 1996 TRUST	STEMPIEN THERESA L TRS 7231 HEGGIE AVE LAS VEGAS NV 89131-3233	12522114019
STEWART RONALD E & RITA M	7221 SIBLEY AVE LAS VEGAS NV 89131-3224	12522213001
STOCKTON EDWARD GALEN	44 EMERALD DUNES CIR HENDERSON NV 89052	12522601028
STORM 2011 TRUST	6919 MAY BASKET AVE LAS VEGAS NV 89131	12515810031
STUBBLEFIELD TRAVIS & JESSICA	7239 HALEY AVE LAS VEGAS NV 89131	12522203009
SUN CASTLE BUILDERS L L C	4535 W SAHARA AVE #105 LAS VEGAS NV 89102-3736	12522610009
SWEET MICHAEL ALAN	7301 HEGGIE AVE LAS VEGAS NV 89131	12522114021
T R P FUND IV L L C	180 NEWPORT CENTER DR #230 NEWPORT BEACH CA 92660	12515811053
TAYLOR JEFFREY J & PAMELA F	7240 HEGGIE AVE LAS VEGAS NV 89131-3233	12522114038
TENAYA TRUST #7255	32392 S COAST HWY #150 LAGUNA BEACH CA 92651	12515405008
THOMSON JAMES F JR & LISA G	7110 DOGAN RIDGE ST LAS VEGAS NV 89131-3229	12522112001
THORNTON CASEY D	7040 W DEER SPRINGS WAY LAS VEGAS NV 89131	12522601009
THURMAN JAMES D & BONNIE J	7114 W DEER SPRINGS WY LAS VEGAS NV 89131-3449	12522610007
TOCCI TRUST	TOCCI LEO L SR & ARLENE S TRS 7131 GROVETON CT LAS VEGAS NV 89131-3226	12522112013
TRAN ESTHER MY	7121 GROVETON CT LAS VEGAS NV 89131-3226	12522112014
TROUTMAN WILLIAM	P O BOX 2570 MATTHEWS NC 28106	12515811066

**Report of All Selected Parcels****Case Number:**~~VARS 209, etc.~~**Printed On:** Tue: August 9, 2016

<u>Owner</u>	<u>Address</u>	<u>Parcel Number</u>
TRUMAN GRANT S & INGRID H	7145 HALEY AVE LAS VEGAS NV 89131-3481	12522601004
TRUMAN INGRID H	7145 HALEY AVE LAS VEGAS NV 89131	12522601022
TRUMAN INGRID H	7145 HALEY AVE LAS VEGAS NV 89131-3481	12522601020
TUCKER FAMILY TRUST	TUCKER HOWARD L & MICHELE CO-TRS 7249 HALEY AVE LAS VEGAS NV 89131-3541	12522203002
TURNER JAMES T & ELIZABETH	7240 SIBLEY AVE LAS VEGAS NV 89131-3224	12522212036
TURNER MICHAEL	7320 SIBLEY AVE LAS VEGAS NV 89131-3225	12522212033
UONITES DAN F	7091 WOLF RIVERS AVE LAS VEGAS NV 89131-0139	12515811006
VALDEZ ROSENDO SANCHEZ & BRENDA	7210 SOLAR AVE LAS VEGAS NV 89131-3309	12515403016
VENEGAS FAMILY TRUST	VENEGAS JAMES N & SOCORRO TRS 7099 WOLF RIVERS AVE LAS VEGAS NV 89131-0139	12515811008
VERDERAME NICHOLAS G	7130 GROVETON CT LAS VEGAS NV 89131-3226	12522112009
WALKER KENNETH DALE	7111 WOLF RIVERS AVE LAS VEGAS NV 89131	12515811011
WALLACE DENNIS	7286 SEA BOOT CT LAS VEGAS NV 89131-0141	12515811083
WARNER BERENICE P TRUST	WARNER BERENICE P TRS 7230 ELKHORN RD LAS VEGAS NV 89131-3340	12515405011
WEHRKAMP GARY C & C A REV LIV TR	WEHRKAMP GARY C & CANDYCE A TRS 7121 SUDLEY CT LAS VEGAS NV 89131-3234	12522113008
WEIDMAN FAMILY TRUST	WEIDMAN JENNIFER L & GLENN R TRS 7321 SIBLEY AVE LAS VEGAS NV 89131-3225	12522212009
WEISBERG JONATHAN D & DARLENE C	7255 N MONTE CRISTO WY LAS VEGAS NV 89131-3335	12515404008
WELCH CHRISTOPHER M TRUST	WELCH CHRISTOPHER TRS 7120 SUDLEY CT LAS VEGAS NV 89131	12522113014
WENDELBOE TRUST	WENDELBOE MICHAEL & KRISTEN TRS 7285 SEA BOOT CT LAS VEGAS NV 89131-0141	12515811076
WENNER FAMILY TRUST	WENNER EDWARD G III & SANDRA TRS 7112 SPRING BEAUTY AVE LAS VEGAS NV 89131-0137	12515811048
WILLIAMS JAY W & DALEEN	7251 HAZEL PLAIN AVE LAS VEGAS NV 89131-3227	12522112015
WILLIAMS SANDRA L LIVING TRUST	7245 N MONTE CRISTO WAY LAS VEGAS NV 89131-3335	12515404010
WINTER BARRY	7109 SPRING BEAUTY AVE LAS VEGAS NV 89131-0137	12515811061
WISEMAN C M TRUST	WISEMAN CRAIG E & MARY K TRS 7320 FALVO AVE LAS VEGAS NV 89131-3240	12522114006
WOLF ANDREAS & STACEY	7220 FALVO AVE LAS VEGAS NV 89131	12522114011
WYETH RANCH COMMUNITY ASSN	P O BOX 12117 LAS VEGAS NV 89112-0117	12515810079
YADEGAR SHOSHANNA	7240 ELDERLY AVE LAS VEGAS NV 89131	12522212020
ZIERMAN DONNA J	POTTER CHERYL J 7211 HEGGIE AVE LAS VEGAS NV 89131-3233	12522114017