

City of Las Vegas  
Department of Planning  
Development Services Center  
333 North Rancho Drive, 3<sup>rd</sup> Floor  
Las Vegas, Nevada 89106

S ✓  
PRSRT  
FIRST CLASS MAIL  
U.S. Postage  
**PAID**  
Las Vegas, NV  
Permit No. 1630

**Return Service Requested**  
**Official Notice of Public Hearing**

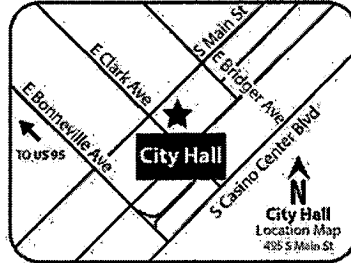

If you wish to file your protest or support on this request, check the appropriate box below and return this card in an envelope with postage to the Department of Planning at the address listed above, fax this side of this card to (702) 464-7499. If you would like to contact your Council Representative, please call (702) 229-6405.

I SUPPORT  
this Request

I OPPOSE  
this Request

Please use available blank space on card for your comments.

**VAR-64111 [PRJ-63878]**

Planning Commission Meeting of 5/10/2016

8 ✓

## Application Information

**VAR-64111 - VARIANCE - PUBLIC HEARING - APPLICANT/OWNER: JAMES MCCARTHY** - For possible action on a request for a Variance TO ALLOW A DEVIATION FROM TITLE 19.08 PARKING DESIGN STANDARDS at 5310 Grand Teton Drive (APN 125-12-801-012), R-E (Residence Estates) Zone, Ward 6 (Ross) [PRJ-63878].

## Application Location

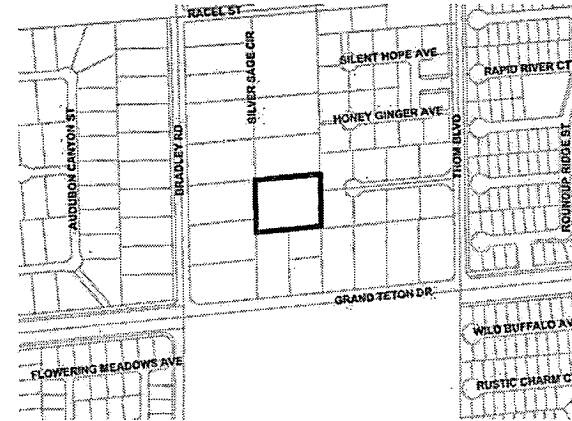

The proposed project may not pertain to the entire highlighted project site.

## Public Hearing Information

**Meeting:** Planning Commission  
**Date:** *May 10, 2016*  
**Time:** 6:00 P.M.  
**Location:** City Council Chambers  
495 South Main Street, 2<sup>nd</sup> Floor  
Las Vegas, Nevada 89101

Any and all interested persons may appear before the City Planning Commission either in person or by representative and object to or express approval of this request; or may, prior to this meeting, file a written objection thereto or approval thereof with the Department of Planning, Development Services Center, 333 North Rancho Drive, 3<sup>rd</sup> Floor, Las Vegas, Nevada 89106. Final Action on General Plan Amendments and Rezonings will be determined by the City Council. Other public hearing items may be deemed Final Action by the Planning Commission or forwarded to the City Council. The date of the City Council meeting, if applicable, will be announced at the Planning Commission meeting after the discussion of the item. For further information, including the full staff report, please call (702) 229-6301 (TTY 7-1-1) or go to <http://www.lasvegasnevada.gov>. Note that postcards and comments received after an agenda posts will not be reflected online until after the meeting; however, the comments are made available to the members of the governing body for their consideration prior to the meeting.

S. ✓

**Report of All Selected Parcels**

Case Number:

VAR-64111, SUP-63981 & SUP-63982

Printed On: Thu: April 14, 2016

<u>Owner</u>	<u>Address</u>	<u>Parcel Number</u>
5150 ELVIS PRESLEY COURT 2015 LI	5150 ELVIS PRESLEY CT LAS VEGAS NV 89131	12512801026
AHERN GERARD A & JANET G	5995 N PARK SST LAS VEGAS NV 89149	12512810025
AHN KATHY 2009 TRUST	AHN KATHY TRS 1030 CAPP ST SAN FRANCISCO CA 94110	12512810035
ALKIRE JOSEPH R II	13295 WRANGLERS REST DR VAIL AZ 85641-6835	12512810047
ALLISON CHARLES L & ZOE P	3505 MUSTANG ST LAS VEGAS NV 89108-4928	12512801017
ANDREW & LEE GROUP L P	5841 E CHARLESTON BLVD #230-472 LAS VEGAS NV 89142-1021	12512812012
BACHNER HENRY C & PATRICIA B	BACHNER DANIEL 5221 HONEY GINGER AVE LAS VEGAS NV 89131-5218	12512812014
BAILEY DAVID	PO BOX 750187 LAS VEGAS NV 89136	12512412058
BARRETT DOUGLAS A & EMILY S	5200 HONEY GINGER LAS VEGAS NV 89131-5218	12512812010
BASH JACQUELINE F LIVING TRUST	BASH JACQUELINE F TRS 5517 FLOWERING MEADOWS AVE LAS VEGAS NV 89131-5200	12513116020
BEEMAN STEPHEN & K REV LIV TR	BEEMAN STEPHEN & KAREN TRS 5521 FLOWERING MEADOWS AVE LAS VEGAS NV 89131-5200	12513116021
BLACKSTOCK JIMMY & JOAN LIVING T	BLACKSTOCK JIMMY DALE & JOAN ELI 5300 ELVIS PRESLEY CT LAS VEGAS NV 89131	12512801027
BLANKMEYER DEREK & BETHANY O	8113 S OVERTON DR WEST JORDAN UT 84081-5720	12512812009
BRIGGS DEVELOPMENT LIVING TRUST	GRINNELL TORI EVE TRS 5033 APACHE VALLEY AVE LAS VEGAS NV 89131-5504	12512811053
BROOKS JEREMY C & KARIE L	8025 BRADLEY RD LAS VEGAS NV 89131-2017	12512412055
BROWN ANDREW	5024 WILD BUFFALO AVE LAS VEGAS NV 89131-3663	12513510006
BROWN MONTE & A 2000 LIV TR	BROWN MONTE & ANNETTE TRS 7485 BUCKSKIN AVE LAS VEGAS NV 89129-6231	12512801004
BROWN SAM	5220 SILENT HOPE AVE LAS VEGAS NV 89131-5215	12512812005
BRUCE JAMES T	5021 RAPID RIVER CT LAS VEGAS NV 89131-5501	12512810063
C A H 2014-1 BORROWER L L C	9305 E VIA DE VENTURA #201 SCOTTSDALE AZ 85258	12512810023
C A H 2014-1 BORROWER L L C	9305 E VIA DE VENTURA #201 SCOTTSDALE AZ 85258	12512810042
C A H 2015-1 BORROWER L L C	9305 E VIA DE VENTURA #201 SCOTTSDALE AZ 85258	12513510035
CALDWELL DARRIN & SERA	5021 JUSTICE CREEK AVE LAS VEGAS NV 89131-3694	12512810019
CARRILLO FABIAN M & ADRIENNE E	5029 RAPID RIVER CT LAS VEGAS NV 89131-5501	12512810065
CARROZZA SALVATORE L	5220 HONEY GINGER AVE LAS VEGAS NV 89131-5218	12512812011
CARSON GARRY	KARA KELSEY 5100 ELVIS PRESLEY CT LAS VEGAS NV 89131-3636	12512801033
CARVER KIMBERLY N	5528 FLOWERING MEADOWS AVE LAS VEGAS NV 89131-5200	12513116007
CASTANEDA EMILIO & HILDA	5036 RAPID RIVER CT LAS VEGAS NV 89131-5501	12512810068
CHAN STANLEY & SZE MIN	5009 ROPERS ROCK CT LAS VEGAS NV 89131-3697	12512810032
CHENEVERT GARY F & SALLY K	5036 ROPERS ROCK CT LAS VEGAS NV 89131-3698	12512810040
CHISHOLM BRUCE W & TERESA M	5033 RAPID RIVER CT LAS VEGAS NV 89131-5501	12512810066

8

**Report of All Selected Parcels****Case Number:**

VAR-64111, SUP-63981 &amp; SUP-63982

**Printed On:** Thu: April 14, 2016

<u>Owner</u>	<u>Address</u>	<u>Parcel Number</u>
CHOW & WONG INVESTMENTS L L C	16690 BONANZA DR RIVERSIDE CA 92504	12512810039
CHRISTENSEN DAVID L & RENEE	5121 HONEY GINGER AVE LAS VEGAS NV 89131-5217	12512812016
CIMINO KIM E TRUST	CIMINO KIM E TRS 621 EDGEBROOK DR LAS VEGAS NV 89145-8808	12512810058
CITY OF LAS VEGAS	333 N RANCHO DR 8TH FL LAS VEGAS NV 89106	12512714022
CLATTERBUCK CHARLES E JR & JOYCE	CLATTERBUCK CHARLES III 5020 RAPID RIVER CT LAS VEGAS NV 89131-5501	12512810072
CLAYTON JAMES V & STACY	RIDLEY GINGER E 5025 JUSTICE CREEK AVE LAS VEGAS NV 89131-3694	12512810020
CLENDENEN MATTHEW P & BRENDA K	8040 AUDOBON CANYON ST LAS VEGAS NV 89131-2047	12512412008
COLFIN AH-NEVADA 3 L L C	9305 E VIA DE VENTURA #201 SCOTTSDALE AZ 85258	12513510036
COLLECTIONS EAGLE RANCH HOA	720 S FOURTH ST LAS VEGAS NV 89101-6743	12512714021
COLLECTIONS EAGLE RANCH HOA	720 S FOURTH ST LAS VEGAS NV 89101-6743	12512714018
CONNELL DAVID & REGINA	5525 FLOWERING MEADOWS AVE LAS VEGAS NV 89131-5200	12513116022
COTTRELL ROBERT & LISA	5513 FLOWERING MEADOWS AVE LAS VEGAS NV 89131-5200	12513116019
COURTNEY SCOTT E & VICTORIA A	5013 STUMBLING COLT CT LAS VEGAS NV 89131-3699	12512810051
COVARRUBIAS IRINEO	5016 JUSTICE CREEK AVE LAS VEGAS NV 89131-3694	12512810027
CRAWFORD MICHAEL C & MICHELLE Q	5251 ELVIS PRESLEY CT LAS VEGAS NV 89131-3637	12512801029
CUBA KAYE A REVOCABLE TRUST	CUBA KAYE A TRS 5151 ELVIS PRESLEY CT LAS VEGAS NV 89131-3636	12512801031
D S B HOLDINGS L L C	848 N RAINBOW BLVD #4308 LAS VEGAS NV 89107	12512810043
DAMELE JAMES B & S L JT LIV TR	DAMELE JAMES B & SHELLY L TRS 8008 AUDUBON CANYON ST LAS VEGAS NV 89131-2047	12512412004
DAVIS RICKEY & CAROLYN	811 WESTWOOD DR #12 ELKO NV 89801-2796	12512810041
DELANEY YVETTE M & JOHN F	5033 JUSTICE CREEK AVE LAS VEGAS NV 89131	12512810022
DELEON FAMILY TRUST	DELEON PATRICIA L TRS 4270 HOOKER ST DENVER CO 80211-1624	12512412043
DELGADO KIMBERLY T & DANIEL	5037 RAPID RIVER CT LAS VEGAS NV 89131-5501	12512810067
DENMAN MIRLA V	8101 SILVER SAGE CIR LAS VEGAS NV 89131-3610	12512801006
DEPATTA PAUL & KATHLEEN	8041 BRADLEY RD LAS VEGAS NV 89131-2017	12512412057
DESALVIO LOUIS & TISH	8240 WATERFALL RANCH CT LAS VEGAS NV 89131-5275	12512714007
DHILLON ROOP K LIVING TRUST	DHILLON ROOP K TRS 11748 CREEK BLUFF DR POWAY CA 92064-6132	12512810060
DREW ROY	5020 ROPERS ROCK CT LAS VEGAS NV 89131-3698	12512810044
DURR PAUL D	8117 BRADLEY RD LAS VEGAS NV 89131-2046	12512412060
ESQUIVEL LESLIE K	8116 AUDUBON CANYON ST LAS VEGAS NV 89131-2048	12512412011
EWALT TONY C & LAURA K	5100 SILENT HOPE AVE LAS VEGAS NV 89131	12512812002
FIDELIUS OPERATIONS L L C	6322 PRIMROSE AVE TEMPLE CITY CA 91780-1345	12512810024
FLEMINO TROY A	8009 BRADLEY RD LAS VEGAS NV 89131-2017	12512412053

**Report of All Selected Parcels****Case Number:**

VAR-64111, SUP-63981 &amp; SUP-63982

**Printed On:** Thu: April 14, 2016

<b><u>Owner</u></b>	<b><u>Address</u></b>	<b><u>Parcel Number</u></b>
FOX RONALD J & SOFIA A	5528 BREECHER AVE LAS VEGAS NV 89131-2045	12512412037
FRITSCHER JEFFREY R	PARADISO CHRISTINE A 8160 PECHAVEZ ST LAS VEGAS NV 89131-5216	12512812001
GEOGHEGAN ROBERT P & MARION L	8000 BRADLEY RD LAS VEGAS NV 89131-2016	12512801011
GODOY MARIO O	8010 BRADLEY RD LAS VEGAS NV 89131	12512801010
GUARDADO JOSE NUNEZ & GLORIA M	8016 AUDUBON CANYON ST LAS VEGAS NV 89131-2047	12512412005
GUBAS LAWRENCE J & NANCY	8240 BRADLEY RD LAS VEGAS NV 89131-5272	12512714003
H WEIWEN	5044 WILD BUFFALO AVE LAS VEGAS NV 89131-3663	12513510011
HEROLD JAMES F & CHERIE L	244 VILLA POINT DR NEWPORT BEACH CA 92660	12512412009
HODGES TERRANCE D & PAMELA J	5201 ELVIS PRESLEY CT LAS VEGAS NV 89131	12512801030
HOUSSEIN HARRUB AHMAD	CARLSON ROBERTA A 5527 BREECHER AVE LAS VEGAS NV 89131-2045	12512412003
HOXENG GREGORY J & GLORIA Q	8132 AUDUBON CANYON ST LAS VEGAS NV 89131	12512412013
HRUBOVCAK THOMAS S & JENNY NETA	8241 WATERFALL RANCH CT LAS VEGAS NV 89131-5275	12512714006
IRON MOUNTAIN RANCH ASSN INC	630 TRADE CENTER DR LAS VEGAS NV 89119-3712	12512810083
ISTAS ALAN J & GENEVIEVE I	5025 RAPID RIVER CT LAS VEGAS NV 89131-5501	12512810064
JORDAN BARBARA JEAN REVOCABLE LI	5028 RAPID RIVER CT LAS VEGAS NV 89131-5501	12512810070
KAHN ROBERT B	8820 CANYON SPRINGS LAS VEGAS NV 89117-5837	12513116017
KAPOLEI MEDICAL PARK VENTURE	27372 CALLE ARROYO SAN JUAN CAPISTRANO CA 92675	12513510016
KHATCHADOURIAN ARA & ADRINE	565 OLMSTEAD DR GLENDALE CA 91202-1511	12512811052
KHILNANI KARUNA	583 NE 199TH TER MIAMI FL 33179	12512810046
KIM DUK-YOUNG & YOON-JOO	5036 WILD BUFFALO AVE LAS VEGAS NV 89131-3663	12513510009
KOEBKE THOMAS H	7932 AMBER MIST ST LAS VEGAS NV 89131-5203	12513116002
KOEBKE THOMAS SR & CYNTHIA	7932 AMBER MIST ST LAS VEGAS NV 89131-5203	12513116018
KWIATKOWSKI JOSEPH J REV FAM TR	5033 WILD BUFFALO AVE LAS VEGAS NV 89131-3663	12513510015
L M R J TRUST	OLSON LOREN C & MICHELLE CO-TRS 7916 AMBER MIST ST LAS VEGAS NV 89131-5203	12513116014
LARA VICENTE	10525 BIRIBA PL LAS VEGAS NV 89144-4291	12512801023
LARSON GLEN LAMAR	5304 GRAND TETON DR LAS VEGAS NV 89131	12512801014
LEE HEATHER & ANTHONY W JR	5529 AMBROSIA STREAM AVE LAS VEGAS NV 89131-2050	12512412044
LOCOCO FAMILY TRUST	LOCOCO SALVATORE & VIRGINIA TRS 3129 VIA VALESICO ESCONDIDO CA 92029-7440	12512810026
LONGHURST C SHAYNE & NANCY M	8221 UNICORN ST LAS VEGAS NV 89131-5271	12512714009
LOPEZ DANIEL	7721 FALL CLIFF RD LAS VEGAS NV 89149-5177	12512811055
LOPEZ JOSE	5045 WILD BUFFALO AVE LAS VEGAS NV 89131-3663	12513510012
M P S LIVING TRUST	SUHR MICHAEL V & POLLY TRS 5512 NATURES TOUCH AVE LAS VEGAS NV 89131-5201	12513116026

**Report of All Selected Parcels****Case Number:**

VAR-64111, SUP-63981 &amp; SUP-63982

**Printed On:** Thu: April 14, 2016

<u>Owner</u>	<u>Address</u>	<u>Parcel Number</u>
MAC FAMILY LIVING TRUST	HELLER MICHAEL & UBOL K TRS 5008 JUSTICE CREEK AVE LAS VEGAS NV 89131-3694	12512810029
MAGHRAK LAURENCE P & SHERRI D	8220 BRADLEY RD LAS VEGAS NV 89131-5272	12512714004
MALLOY SHARI A	5516 FLOWERING MEADOWS AVE LAS VEGAS NV 89131-5200	12513116004
MANGRU DUSRAT & BERTHA	5250 GRAND TETON DR LAS VEGAS NV 89131-3632	12512801022
MCCARTHY JAMES	ROHRER HEATHER 7258 SASHAYING SPIRIT CT LAS VEGAS NV 89131	12512801012
MCCLELLAND FAMILY TRUST	MCCLELLAND JAMES E JR TRS 5520 AMBROSIA STREAM AVE LAS VEGAS NV 89131-2050	12512412014
MCDONALD NICOLE L	2721 ROBUST CT HENDERSON NV 89052	12513510010
MCPALMER HERBERT JR & MICHELLE	5021 STUMBLING COLT CT LAS VEGAS NV 89131-3699	12512810053
MEDLEY DOUGLAS P	5024 STUMBLING COLT CT LAS VEGAS NV 89131	12512810061
MEI ZEQUIN	XU PING P O BOX 60651 SUNNYVALE CA 94088	12512810055
MILAZZO JOSEPH & SUSAN M	8210 SIENNA SKIES CT LAS VEGAS NV 89131-5259	12512713008
MILLER GREGG ALVIN	5020 STUMBLING COLT CT LAS VEGAS NV 89131-3699	12512810062
MINDEN GREGORY	NELSON MARIETTA 8241 UNICORN ST LAS VEGAS NV 89131-5271	12512714010
MISTER MICHAELINE	5037 STUMBLING COLT CT LAS VEGAS NV 89131-3699	12512810057
MITCHELL TODD & LINDA	8033 BRADLEY RD LAS VEGAS NV 89131-2017	12512412056
MONTELL GUY & DONNA	5036 RUSTIC CHARM CT LAS VEGAS NV 89131	12513510033
MONTGOMERY LARRY DEAN & SANDRA M	5032 RUSTIC CHARM CT LAS VEGAS NV 89131-3670	12513510032
MOORE WILLIAM	5250 ELVIS PRESLEY CT LAS VEGAS NV 89131	12512801028
MOSS JOHN D	5100 GRAND TETON LAS VEGAS NV 89131-3619	12512801025
MURPHY JOSHUA E	5024 RAPID RIVER CT LAS VEGAS NV 89131-5501	12512810071
NAGUIAT LOUIE L	5529 GREEBER CT LAS VEGAS NV 89131-2049	12512412038
NEWBY LIONEL	P O BOX 751453 LAS VEGAS NV 89136-1453	12512412039
NISH FAMILY L P	P O BOX 750595 LAS VEGAS NV 89136-0595	12512412036
ORTIZ EFRAIN	8024 AUDUBON CANYON ST LAS VEGAS NV 89131-2047	12512412006
PARKERSON 2009 TRUST	PARKERSON RON E & AIMEE TRS 8109 BRADLEY RD LAS VEGAS NV 89131-2046	12512412059
PARRISH JESSICA M & ANDREW G JR	5504 FLOWERING MEADOWS AVE LAS VEGAS NV 89131-5200	12513116001
PEOPLES EZRA J & DORY	5032 WILD BUFFALO AVE LAS VEGAS NV 89131	12513510008
PEREZ GILBERTO	5040 RUSTIC CHARM CT LAS VEGAS NV 89131-3670	12513510034
PETRELLI TONI MICHELLE & SHANE	8108 AUDUBON CANYON ST LAS VEGAS NV 89131-2048	12512412010
PETRILLO ELIZABETH M	5029 ROPERS ROCK CT LAS VEGAS NV 89131-3698	12512810037
PIETSCH JAMES & ZENA	8220 WATERFALL RANCH CT LAS VEGAS NV 89131-5275	12512714008
PITTMAN TAMMY E & BENJAMEN A	5200 SILENT HOPE LAS VEGAS NV 89131-5215	12512812004

**Report of All Selected Parcels****Case Number:**

VAR-64111, SUP-63981 &amp; SUP-63982

**Printed On:** Thu: April 14, 2016

<u>Owner</u>	<u>Address</u>	<u>Parcel Number</u>
PLOURDE MICHAEL J	5032 RAPID RIVER CT LAS VEGAS NV 89131-5501	12512810069
PRICE TERRY J & SALLY G	5300 GRAND TETON DR LAS VEGAS NV 89131-3600	12512801015
REFOSCO CRAIG A & DIANE M	17609 WHEAT FALL DR DERWOOD MD 20855-1151	12512810059
ROBINETT LARRY E	5241 HONEY GINGER AVE LAS VEGAS NV 89131-5218	12512812013
ROBINSON JACK RAY	8032 AUDUBON CANYON ST LAS VEGAS NV 89131-2047	12512412007
RUGGED OAKS INVESTMENTS L L C	2320 POTOSI ST #130 LAS VEGAS NV 89146	12513510005
S L V INVESTMENTS L L C	P O BOX 7473 LAS VEGAS NV 89125	12512801036
S L V INVESTMENTS L L C	P O BOX 7473 LAS VEGAS NV 89125	12512801035
SANDLER FAMILY TRUST	SANDLER ALEKSANDR & ALLA TRS 17440 LOS ALIMOS ST GRANADA HILLS CA 91344	12513510007
SCHAEFFER CHRISTOPHER	5009 STUMBLING COLT CT LAS VEGAS NV 89131-3699	12512810050
SERRANO NIKO A	RODRIGUEZ VANESA 5017 STUMBLING COLT CT LAS VEGAS NV 89131-3699	12512810052
SHOEMAKER JOHN A & CHERYL REV TR	SHOEMAKER JOHN A & CHERYL L TRS 5101 ELVIS PRESLEY CT LAS VEGAS NV 89131-3636	12512801032
SICHY TRUST	GRISLEY DONALD R TRS 5101 HONEY GINGER LAS VEGAS NV 89131-5217	12512812017
SILVERIO ROMULO & PAULA	5240 SILENT HOPE LAS VEGAS NV 89131-5215	12512812006
SLAUGHTER MARK & DANIELLE	5512 FLOWERING MEADOW LAS VEGAS NV 89131-5200	12513116003
SMITH JOHNNIE T JR & KIM	5535 BREECHER AVE LAS VEGAS NV 89131-2045	12512412002
SNARR JENNIFER M	2012 PLAZA DEL SANTA FE LAS VEGAS NV 89102	12512810036
SORIA MATTHEW & JENNIFER	7145 ROYAL MELBOURNE DR LAS VEGAS NV 89131	12512801013
SOSATOLED0 EVELYN	5120 SILENT HOPE AVE LAS VEGAS NV 89131-5214	12512812003
SOUSA PAUL DANIEL & HEATHER D	8221 WATERFALL RANCH CT LAS VEGAS NV 89131-5275	12512714005
STERRY MICHAEL P	125 LOOKING EAST DR SOMERS MT 59932-9707	12512810018
STEWART JORY B & ROBERT D JR	19948 VALLEY VISTA WY PENN VALLEY CA 95946-9544	12512801009
SULLIVAN ANTHONY E & CATHERINE M	5017 ROPERS ROCK CT LAS VEGAS NV 89131	12512810034
TALLEDO JANIE E	5241 SILENT HOPE AVE LAS VEGAS NV 89131-5215	12512812007
TEMPLE STREET HOMES L L C	909 N SEPULVEDA BLVD #840 EL SEGUNDO CA 90245	12513510013
TERWILLIGER J T & CRYSTAL C	5201 HONEY GINGER AVE LAS VEGAS NV 89131-5218	12512812015
THOMAS FAMILY TRUST	THOMAS RICHARD A & YUVONNE TRS 8109 SILVER SAGE CIR LAS VEGAS NV 89131-3610	12512801007
THOMAS FAMILY TRUST	THOMAS RICHARD A & YUVONNE TRS 8109 SILVER SAGE CIR LAS VEGAS NV 89131-3610	12512801008
THOMAS FAMILY TRUST	THOMAS GUY R & JESSIE F TRS 8105 SILVER SAGE CIR LAS VEGAS NV 89131-3610	12512801005
THOMAS MELVIN & LYNNETTER	8409 CHAPMAN RAVINE ST LAS VEGAS NV 89131-2052	12512810038
THOMAS RICHARD L	8109 SILVER SAGE CIR LAS VEGAS NV 89131-3610	12512801001
THOMAS RICHARD L	8109 SILVER SAGE CIR LAS VEGAS NV 89131-3610	12512801002

**Report of All Selected Parcels****Case Number:**

VAR-64111, SUP-63981 &amp; SUP-63982

**Printed On:** Thu: April 14, 2016

<u>Owner</u>	<u>Address</u>	<u>Parcel Numbe</u>
THOMAS RICHARD L JR	8109 SILVER SAGE CIR LAS VEGAS NV 89131-3610	12512801003
TIPPING KATHRYN P TRUST	TIPPING KATHRYN P TRS 5037 WILD BUFFALO AVE LAS VEGAS NV 89131-3663	12513510014
TORRES GERARDO & MARIA E	5221 SILENT HOPE AVE LAS VEGAS NV 89131-5215	12512812008
TROXELL RYAN MATTHEW & MICHELLE	5016 ROPERS ROCK CT LAS VEGAS NV 89131-3697	12512810045
TUATAGALOA ELIJAH F	5033 STUMBLING COLT CT LAS VEGAS NV 89131-3699	12512810056
TURNER BRAD & AMBROSIA	8125 BRADLEY RD NORTH LAS VEGAS NV 89131-2046	12512412061
TURNER PATRICK S & ELENA I	8211 SIENNA SKIES CT LAS VEGAS NV 89131-5259	12512713005
TYLER JEFFREY & LAURA	222 CLINTON AVE EAST PATCHOGUE NY 11772	12513116006
VANNISING CHANPHENG & VICKY	8211 THOM BLVD LAS VEGAS NV 89131-3603	12512713009
VASZIL FAMILY REVOCABLE LIVING T	VASZIL WAYNE PATRICK & PATRICIA 8264 SILVER CATFISH ST LAS VEGAS NV 89131	12512810054
VENICE TRUST	THOMAS KIMBERLY TRS 7924 AMBER MIST ST LAS VEGAS NV 89131-5203	12513116016
VOGT CHERYL A	8220 UNICORN ST LAS VEGAS NV 89131	12512713003
VONDRAK BRENT E & VALERIE D	8150 PECHAVEZ ST LAS VEGAS NV 89131	12512812018
WEATHERLY FAMILY TRUST	WEATHERLY TROY A & SUSAN J TRS 5516 NATURES TOUCH AVE LAS VEGAS NV 89131	12513116025
WEBSTER FAMILY LIVING TRUST	WEBSTER CHRISTOPHER W & A J TRS 7920 AMBER MIST ST LAS VEGAS NV 89131-5203	12513116015
WEIDKNECHT PATRICIA A	5013 ROPERS ROCK CT LAS VEGAS NV 89131-3697	12512810033
WHITTLE J & S QUAL PERS RES TR	WHITTLE JEFFREY A & SHELLEY TRS 5150 GRAND TETON DR LAS VEGAS NV 89131-3619	12512801024
WILKES MICHELLE DENSON	5029 JUSTICE CREEK AVE LAS VEGAS NV 89131-3694	12512810021
WILKINS PAUL AARON	38 E GARLAND SPOKANE WA 99207	12512412012
WILLIAMS HEATHER	5012 JUSTICE CREEK AVE LAS VEGAS NV 89131	12512810028
WILSON ROSE MARIE OJEDA	8210 UNICORN ST LAS VEGAS NV 89131	12512713004
YEGGE MICHELE S	5536 GREEBER CT LAS VEGAS NV 89131-2049	12512412042
YUHAS RONALD J & RAE A	5520 FLOWERING MEADOWS AVE LAS VEGAS NV 89131-5200	12513116005
ZANE ROGER J	5037 APACHE VALLEY AVE LAS VEGAS NV 89131-5504	12512811054