

City of Las Vegas
Department of Planning
Development Services Center
333 North Rancho Drive, 3rd Floor
Las Vegas, Nevada 89106

PRSR
FIRST CLASS MAIL
U.S. Postage
PAID
Las Vegas, NV
Permit No. 1630

Return Service Requested
Official Notice of Public Hearing

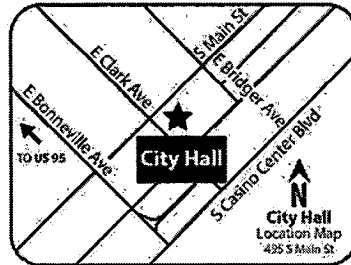

If you wish to file your protest or support on this request, check the appropriate box below and return this card in an envelope with postage to the Department of Planning at the address listed above, fax this side of this card to (702) 464-7499 or make your comments at www.lasvegasnevada.gov. If you would like to contact your Council Representative, please call (702) 229-6405.

I SUPPORT
this Request

I OPPOSE
this Request

Please use available blank space on card for your comments.

VAR-63259 [PRJ-63042]

Planning Commission Meeting of 4/12/2016

Application Information

ABEYANCE - RENOTIFICATION - VAR-63259 - VARIANCE RELATED TO VAR-63098 - PUBLIC HEARING - APPLICANT: DR HORTON INC. - OWNER: BUREAU OF LAND MANAGEMENT OF THE UNITED STATES GOVERNMENT - For possible action on a request for a Variance TO ALLOW NO CURB, GUTTER OR SIDEWALKS ON MICHELLI CREST WAY, ANTIQUE RIDGE COURT, SHRINE RIDGE COURT, EL CAMPO GRANDE AVENUE, TROPICAL PARKWAY EAST OF ALPINE RIDGE WAY AS WELL AS NON-STANDARD CURB IN PUBLIC RIGHT-OF-WAY TO ALLOW THREE FOOT VALLEY GUTTERS INSTEAD OF L-CURB ON ANTIQUE RIDGE COURT AND SHRINE RIDGE COURT WHERE COMPLETE STREET STANDARDS ARE REQUIRED on 25.00 acres at the southwest corner of Tropical Parkway and Michelli Crest Way (APN 126-25-701-001), R-D (Single Family Residential-Restricted) Zone, Ward 6 (Ross) [PRJ-63042].

Application Location

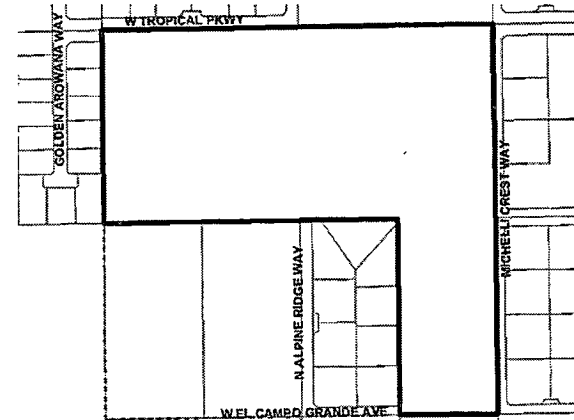

The proposed project may not pertain to the entire highlighted project site.

Public Hearing Information

Meeting: Planning Commission
Date: *April 12, 2016*
Time: 6:00 P.M.
Location: City Council Chambers
495 South Main Street, 2nd Floor
Las Vegas, Nevada 89101.

Any and all interested persons may appear before the City Planning Commission either in person or by representative and object to or express approval of this request; or may, prior to this meeting, file a written objection thereto or approval thereof with the Department of Planning, Development Services Center, 333 North Rancho Drive, 3rd Floor, Las Vegas, Nevada 89106. Final Action on General Plan Amendments and Rezonings will be determined by the City Council. Other public hearing items may be deemed Final Action by the Planning Commission or forwarded to the City Council. The date of the City Council meeting, if applicable, will be announced at the Planning Commission meeting after the discussion of the item. For further information, including the full staff report, please call (702) 229-6301 (TTY 7-1-1) or go to <http://www.lasvegasnevada.gov>.

Report of All Selected Parcels**Case Number:**

VAR-63098, VAR-63259, WVR-63099 & TMP-63100

Printed On:

Mon: February 8, 2016

<u>Owner</u>	<u>Address</u>	<u>Parcel Number</u>
ALBRIGHT JEFFREY D & HEATHER	6115 GOLDEN AROWANA WAY LAS VEGAS NV 89149	12625212005
ALPINE RIDGE L L C	8375 W FLAMINGO #200 LAS VEGAS NV 89147-4149	12625211026
ALTRECHE SUZANNE & DARREN	6170 CORTNEY RIDGE CT LAS VEGAS NV 89149	12625601021
ARGO FAMILY TRUST	5850 S MICHELLI CREST WAY LAS VEGAS NV 89149-1217	12625701031
ASANTE KRISTI A LIVING TRUST	ASANTE KRISTI A TRS 5835 EGAN CREST DR LAS VEGAS NV 89149-1225	12625701043
B & B FAMILY TRUST	6042 ALPINE ESTATES CIR LAS VEGAS NV 89149-2023	12625211011
BACA RANDY J	6028 ALPINE ESTATES CIR LAS VEGAS NV 89149-2023	12625211001
BARFIELD JOSHUA	5725 MICHELLI CREST WAY LAS VEGAS NV 89149	12625801022
BARKEN MARVIN B & CINDY C REV TR	BARKEN MARVIN B & CINDY C TRS 10455 W LA MANCHA AVE LAS VEGAS NV 89149-1006	12625401014
BARKER BILLY H & MARIE	5905 GOLDEN AROWANA WAY LAS VEGAS NV 89149	12625310007
BARRETT CHAD L & SHANNON	6028 GOLDEN AROWANA WAY LAS VEGAS NV 89149	12625213005
BARRIEAULT MARK & HIROMI K	6129 GOLDEN AROWANA WAY LAS VEGAS NV 89149	12625212006
BARRY BARBARA ANN	2336 MINOLTA CT HENDERSON NV 89044	12625701030
BEARD JOHN M & SUSAN M	10281 BRIGHT ANGEL WY LAS VEGAS NV 89149-1256	12625601020
BECK FAMILY TRUST	BECK STEPHEN E & PATRICIA TRS 5940 MICHELLI CREST WY LAS VEGAS NV 89149-1218	12625701006
BENDER DANIEL & CHRISTINA FAM TR	BENDER DANIEL & CHRISTINA CO-TRS 10270 W TROPICAL PKWY LAS VEGAS NV 89149-1250	12625601022
BIERSTEDT CHAD E & EMYLEE R	6154 GOLDEN AROWANA WAY LAS VEGAS NV 89149	12625212014
BLOOM MARK E REVOCABLE TRUST	BLOOM MARK E TRS 10175 W TROPICAL PKWY LAS VEGAS NV 89149-1208	12625701012
BOYD FAMILY TRUST	BOYD RENE THOMAS JR & R TRS 5750 N ALPINE RIDGE WY LAS VEGAS NV 89149-1248	12625801019
BRANDT TRAVIS	6042 GOLDEN AROWANA WAY LAS VEGAS NV 89149	12625213004
BRENNAN KRIS V & ANGELA C	6072 ALPINE ESTATES CIR LAS VEGAS NV 89149-2024	12625211018
BUNCE CURTIS A	10190 CORBETT ST LAS VEGAS NV 89149-1232	12625701016
CANNITO VINCENT & STEPHANIE TR	6075 EGAN CREST DR LAS VEGAS NV 89149-1247	12625601029
CARDOZA STEVE & PATTI	6058 ALPINE ESTATES CIR LAS VEGAS NV 89149-2024	12625211015
CASPER HERBERT J & ELIZABETH S	10270 W EL CAMPO GRANDE AVE LAS VEGAS NV 89149-1212	12625701035
CATANIA MYLES	10280 W LA MANCHA DR LAS VEGAS NV 89149-1008	12625801006
CINA RANDY	6010 ALPINE ESTATES CIR LAS VEGAS NV 89149-2023	12625211004
COBLER RICHARD P & TANYA L	10291 BRIGHT ANGEL WY LAS VEGAS NV 89149-1256	12625601018
COPE JAMES E & SARAH BETH C	5942 GOLDEN AROWANA WAY LAS VEGAS NV 89149	12625310005
COULSON ERIKA L	6101 GOLDEN AROWANA WAY LAS VEGAS NV 89149	12625212004
COUNTY OF CLARK(PUBLIC WORKS)	500 S GRAND CENTRAL PKWY LAS VEGAS NV 89155	12625201016
COUNTY OF CLARK(PUBLIC WORKS)	500 S GRAND CENTRAL PKWY LAS VEGAS NV 89155	12625301010

Report of All Selected Parcels**Case Number:** VAR-63098, VAR-63259, WVR-63099 & TMP-63100**Printed On:** Mon: February 8, 2016

<u>Owner</u>	<u>Address</u>	<u>Parcel Number</u>
COUNTY OF CLARK(PUBLIC WORKS)	500 S GRAND CENTRAL PKWY LAS VEGAS NV 89155	12625201015
COUNTY OF CLARK(PUBLIC WORKS)	500 S GRAND CENTRAL PKWY LAS VEGAS NV 89155	12625301009
D L X INVEST L L C-SERIES IV	6055 EGAN CREST DR LAS VEGAS NV 89149-1247	12625601027
DAVIDSON JOEL MD ROTH IRA ETAL	11920 S HIGHLANDS PKWY #100 LAS VEGAS NV 89141	12625201002
DRUMMOND DEBORAH	10250 W TROPICAL PKWY LAS VEGAS NV 89149-1250	12625601024
DUBE RONALD & CARLA REV LIV TR	DUBE RONALD & CARLA TRS 10260 TROPICAL PKWY LAS VEGAS NV 89149-1250	12625601023
DUCAN SHAWN SCOTT	6103 ROCKETMAN CIR LAS VEGAS NV 89149	12625210016
EDGINGTON MICHAEL J & STACY C	4013 N CHIEFTAIN ST LAS VEGAS NV 89129	12625601025
ELLIS J & E FAMILY TRUST	ELLIS JAMES F JR & ERIN R TRS 10165 W TROPICAL PKWY LAS VEGAS NV 89149-1208	12625701011
ESKEW WILLIAM GEORGE & SANDRA L	5825 EGAN CREST DR LAS VEGAS NV 89149-1225	12625701044
FIELDS PERRY JEROME & VALERIE D	6032 ALPINE ESTATES CIR LAS VEGAS NV 89149-2023	12625211009
FINK WILLIAM C & NANCY A	5933 GOLDEN AROWANA WAY LAS VEGAS NV 89149	12625310009
FLORES PETER J & HEATHER M	6036 ALPINE ESTATES CIR LAS VEGAS NV 89149	12625211010
FORD TIMOTHY & TRACY S	6054 ALPINE ESTATES CIR LAS VEGAS NV 89149-2024	12625211014
FORNEY DOROTHY J	WALTERS CARRIE L 10250 W EL CAMPO GRANDE AVE LAS VEGAS NV 89149	12625701037
FRANCO LINDA	5998 GOLDEN AROWANA WAY LAS VEGAS NV 89149	12625310001
FRANKEN BENJAMIN E & MYONGSU	6056 GOLDEN AROWANA WAY LAS VEGAS NV 89149	12625212021
FRISCO TRUST	COSTELLO MICHAEL R TRS 3817 RUSSETT FALLS ST LAS VEGAS NV 89129	12625701033
GERBER MATTHEW D & JENNIFER A	6025 ALPINE ESTATES CIR LAS VEGAS NV 89149-2023	12625211025
GIBSON FAMILY TRUST	GIBSON DONALD & BARBARA J TRS 6014 ALPINE ESTATES CIR LAS VEGAS NV 89149-2023	12625211005
GIBSON PATRICIA A	5960 MICHELLI CREST WY LAS VEGAS NV 89149-1218	12625701002
GORDON FAMILY IRREVOCABLE TRUST	6141 GALILEO DR LAS VEGAS NV 89149-1386	12625210003
GRAUBERGER ELDON & CAROL A REVOC	GRAUBERGER ELDON & CAROL A TRS 10280 W EL CAMPO GRANDE AVE LAS VEGAS NV 89149-1245	12625701034
GUTIERREZ LOUIS	808 CHICO DR SAN LEANDRO CA 94578	12625601031
HALL ROBERT EDWARD LEE JR & ROSA	6003 GOLDEN AROWANA WAY LAS VEGAS NV 89149	12625310014
HECHT FAMILY TRUST	HECHT STEPHEN M & DIANE K TRS 10170 CORBETT ST LAS VEGAS NV 89149-1232	12625701014
HELFFMAN FAMILY SURVIVORS TRUST	HELFFMAN LAUREN DEPIERO TRS 5112 FOREST OAKS DR LAS VEGAS NV 89149	12625801003
HELFFMAN LAUREN	HELFFMAN FAMILY SURVIVOR'S TRUST 5112 FOREST OAKS DR LAS VEGAS NV 89149	12625801001
HIGHPOINTE NORTH L L C	2360 CORPORATE CIR #400 HENDERSON NV 89074	12625701045
HOGAN RUSSELL & DALENA FAMILY TR	HOGAN RUSSELL M & DALENA E TRS 5956 GOLDEN AROWANA WAY LAS VEGAS NV 89149	12625310004
HOSANNY RHYMAL L	7628 LAKE FORK PEAK ST LAS VEGAS NV 89166	12625212001

Report of All Selected Parcels**Case Number:** VAR-63098, VAR-63259, WVR-63099 & TMP-63100**Printed On:** Mon: February 8, 2016

<u>Owner</u>	<u>Address</u>	<u>Parcel Number</u>
HOWARD CHARLES & TINA	495 S HEATH LN IDAHO FALLS ID 83401-4628	12625211023
HUCKLEBUCK IRREVOCABLE SPEND TR	10260 W EL CAMPO GRANDE AVE LAS VEGAS NV 89149-1212	12625701036
HULME JOHN & MICHELLE FAMILY TR	HULME JOHN R & MICHELLE S TRS 6065 EGAN CREST DR LAS VEGAS NV 89149-1247	12625601028
HUME PAUL W & DAWN E	6014 GOLDEN AROWANA WAY LAS VEGAS NV 89149	12625213006
HUMMEL WILLIAM R & SUSAN MURPHY	6025 EGAN CREST DR LAS VEGAS NV 89149-1247	12625601033
HUSEMAN LAUREN & CHRIS	6112 GOLDEN AROWANA WAY LAS VEGAS NV 89149	12625212017
INGELS JAIRUS & LENA V	6073 GOLDEN AROWANA WAY LAS VEGAS NV 89149	12625212002
JAKOVAC AMANDA M	6024 ALPINE ESTATES CIR LAS VEGAS NV 89149-2023	12625211007
JENNINGS WILLIAM B	6138 ROCKETMAN CIR LAS VEGAS NV 89149-1387	12625210023
JORDAN LYLE & IRENE A	6020 ALPINE ESTATES CIR LAS VEGAS NV 89149-2023	12625211006
KAHN BERNARD & ESTELLE	25 B ELMWOOD TERR ELMWOOD PARK NJ 07407-1728	12625301004
KROGH ZACHARY H & ARRON M	6064 ALPINE ESTATES CIR LAS VEGAS NV 89149-2024	12625211016
L2D2 L L C	9225 W FLAMINGO RD #190 LAS VEGAS NV 89147	12625611007
L2D2 L L C	9225 W FLAMINGO RD #190 LAS VEGAS NV 89147	12625611005
L2D2 L L C	9225 W FLAMINGO RD #190 LAS VEGAS NV 89147	12625611003
L2D2 L L C	9225 W FLAMINGO RD #190 LAS VEGAS NV 89147	12625611008
L2D2 L L C	9225 W FLAMINGO RD #190 LAS VEGAS NV 89147	12625611002
L2D2 L L C	9225 W FLAMINGO RD #190 LAS VEGAS NV 89147	12625611004
L2D2 L L C	9225 W FLAMINGO RD #190 LAS VEGAS NV 89147	12625611001
L2D2 L L C	9225 W FLAMINGO RD #190 LAS VEGAS NV 89147	12625611006
LANCE-TERRY RUSSELL	6140 GOLDEN AROWANA WAY LAS VEGAS NV 89149	12625212015
LANKFORD MICHAEL	BULLOCK NEOMA 6084 GOLDEN AROWANA WAY LAS VEGAS NV 89149	12625212019
LARSON JAMES	5240 MAVERICK AVE LAS VEGAS NV 89108	12625701041
LAUDENSACK PETER S & MICHELE B	6105 GALILEO DR LAS VEGAS NV 89149-1386	12625210001
LAWHORN DUNBAR JR & WANDA F	6068 ALPINE ESTATES CIR LAS VEGAS NV 89149-2024	12625211017
LEACH JENNIFER TRUST	LEACH JENNIFER D TRS 6046 ALPINE ESTATES CIR LAS VEGAS NV 89149	12625211012
LERONI L L C	1600 PINE ST LAS VEGAS NV 89102-2242	12625301003
LEWIS LEONARD V & JULIE A	5875 EGAN CREST DR LAS VEGAS NV 89149-1225	12625701038
LIBERTY HOMES LAS VEGAS L L C	1180 N TOWN CENTER DR #100 LAS VEGAS NV 89144	12625710003
LIBERTY HOMES LAS VEGAS L L C	1180 N TOWN CENTER DR #100 LAS VEGAS NV 89144	12625710009
LIBERTY HOMES LAS VEGAS L L C	1180 N TOWN CENTER DR #100 LAS VEGAS NV 89144	12625710004
LIBERTY HOMES LAS VEGAS L L C	1180 N TOWN CENTER DR #100 LAS VEGAS NV 89144	12625710002

Report of All Selected Parcels**Case Number:** VAR-63098, VAR-63259, WVR-63099 & TMP-63100**Printed On:** Mon: February 8, 2016

<u>Owner</u>	<u>Address</u>	<u>Parcel Numbe</u>
LIBERTY HOMES LAS VEGAS L L C	1180 N TOWN CENTER DR #100 LAS VEGAS NV 89144	12625710007
LIBERTY HOMES LAS VEGAS L L C	1180 N TOWN CENTER DR #100 LAS VEGAS NV 89144	12625710001
LIBERTY HOMES LAS VEGAS L L C	1180 N TOWN CENTER DR #100 LAS VEGAS NV 89144	12625710008
LIBERTY HOMES LAS VEGAS L L C	1180 N TOWN CENTER DR #100 LAS VEGAS NV 89144	12625710005
LIBERTY HOMES LAS VEGAS L L C	1180 N TOWN CENTER DR #100 LAS VEGAS NV 89144	12625710006
LIEN STEPHANIE TRUST	LIEN STEPHANIE TRS 5860 MICHELLI CREST WY LAS VEGAS NV 89149-1217	12625701032
LISTER LATONIA	6035 EGAN CREST DR LAS VEGAS NV 89149-1247	12625601030
LONG GARY W	5975 GOLDEN AROWANA WAY LAS VEGAS NV 89149	12625310012
LOZANO GABRIEL & CLAUDIA	5845 EGAN CREST DR LAS VEGAS NV 89149-1225	12625701042
LUTHIGER RICHARD A & CLAUDINA	6126 GOLDEN AROWANA WAY LAS VEGAS NV 89149	12625212016
MACINTYRE DONALD & CAROL L	6122 GALILEO DR LAS VEGAS NV 89149-1386	12625210014
MARINO FAMILY REVOCABLE LIVING T	MARINO FRANK A & DEBORAH A TRS 6139 ROCKETMAN CIR LAS VEGAS NV 89149-1387	12625210018
MARTINEZ EDMUND M & RUTH C 1993	MARTINEZ EDMUND M & RUTH C TRS 6098 GOLDEN AROWANA WAY LAS VEGAS NV 89149	12625212018
MARTINSON DAVID FARR & ROSALIE K	10261 BRIGHT ANGEL WY LAS VEGAS NV 89149-1256	12625601019
MERCER RICHARD A & CHRISTINE S	6292 CALM BROOK CT LAS VEGAS NV 89149-3225	12625801012
MISSAGHI BIJAN & DENA	5961 GOLDEN AROWANA WAY LAS VEGAS NV 89149	12625310011
MONCAYO MARK J & VANESSA E	6015 EGAN CREST DR LAS VEGAS NV 89149-1247	12625601032
MOORE MATTHEW S & JENNIFER K	5989 GOLDEN AROWANA WAY LAS VEGAS NV 89149	12625310013
MUNOZ RAYMOND A	RIZZO DEBORAH M 5855 EGAN CREST DR LAS VEGAS NV 89149-1225	12625701040
MURRAY MICHAEL T	CRAWFORD-MURRAY CONNIE D 6031 GOLDEN AROWANA WAY LAS VEGAS NV 89149	12625213002
NARVID RONALD F	SKURSKI CANDACE L 6050 ALPINE ESTATES CIR LAS VEGAS NV 89149-2023	12625211013
NATALE FAMILY TRUST	NATALE THOMAS F & LINDA D TRS 10225 W EL CAMPO GRANDE AVE LAS VEGAS NV 89149-1213	12625801007
NORTON EDWARD C II & VICTORIA S	6077 ALPINE ESTATES CIR LAS VEGAS NV 89149-2024	12625211020
NYGREN THOMAS L	6158 GALILEO DR LAS VEGAS NV 89149-1386	12625210012
OISBOID RACHEL	LEWIS MATTHEW 5919 GOLDEN AROWANA WAY LAS VEGAS NV 89149	12625310008
OSTROWKSY AVI A	6140 GALILEO DR LAS VEGAS NV 89149-1386	12625210013
PERNICIARO THOMAS	6029 ALPINE ESTATES CIR LAS VEGAS NV 89149-2023	12625211024
POLOVINA FAMILY REVOCABLE LIV TR	10185 W TROPICAL PKWY LAS VEGAS NV 89149-1208	12625701009
PRODAN OLEG & ELENA	6087 GOLDEN AROWANA WAY LAS VEGAS NV 89149	12625212003
RAMIREZ TONY & ESMERALDA	5947 GOLDEN AROWANA WAY LAS VEGAS NV 89149	12625310010
RAZO GERALD M & JUANA MARIZELA	6070 GOLDEN AROWANA WAY LAS VEGAS NV 89149	12625212020

Report of All Selected Parcels

Owner

REED EDWARD W & MARY K
 ROSSSMAN MICHAEL & CAROLINE
 RUSHFIELD MICHAEL & JUDY
 SAMPEY KEITH M & CELESTE M
 SAMUELSON PAUL TRUST
 SCHRAEDER FAMILY TRUST
 SCHUSTER CHELSEA L & SCOTT R
 SCOTT BILL & JO A
 SEIDLINGER LIVING TRUST
 SEOK CHIL YONG & MYUNG AE
 SHAPIRO ELAINE KAHN & FRED J
 SMITH FAMILY TRUST
 SOTELO RYAN T
 SPEED KEVIN & MELANIE P
 SPRIGGS JAMES C & SUSAN L
 STAVARACHE ROBERT
 STRANDBOGE FAMILY REV LIV TR
 THEWIS DANIEL J
 THOMAS CYNTHIA M
 THOMPSON BRUCE & SUSANN
 TIEDT DAVID
 TOTH FAMILY LIVING TRUST
 VALENTINO HENRY III & JAN
 VANHOOVE KYLE & BLYTHE
 WILKINSON WESLEY E
 WOOD DAVID & JULIA
 WOOD JAMES & MERNA FAMILY TRUST
 WUNDERLIN 1999 TRUST
 YADEGAR F & J F REV LIV TR

Case Number:

VAR-63098, VAR-63259, WVR-63099 & TMP-63100

Address

6090 ALPINE ESTATES CIR LAS VEGAS NV 89149-2024
 6157 ROCKETMAN CIR LAS VEGAS NV 89149-1387
 6102 ROCKETMAN CIR LAS VEGAS NV 89149-1387
 6069 ALPINE ESTATES CIR LAS VEGAS NV 89149-2024
 SAMUELSON PAUL TRS 5885 EGAN CREST DR LAS VEGAS NV 89149-1225
 SCHRAEDER SYLVIA A TRS 1729 N MICHAEL WY LAS VEGAS NV 89108-2306
 6045 GOLDEN AROWANA WAY LAS VEGAS NV 89149
 5928 GOLDEN AROWANA WAY LAS VEGAS NV 89149
 SEIDLINGER RAY JR & DIANE TRS 10160 CORBETT AVE LAS VEGAS NV 89149-1232
 6123 GALILEO DR LAS VEGAS NV 89149-1386
 34-10 HILLSIDE TERRACE FAIR LAWN NJ 07410-4255
 SMITH JULIANA B TRS 5980 MICHELLI CREST WY LAS VEGAS NV 89149-1218
 6143 GOLDEN AROWANA WAY LAS VEGAS NV 89149
 6157 GOLDEN AROWANA WAY LAS VEGAS NV 89149
 6073 ALPINE ESTATES CIR LAS VEGAS NV 89149-2024
 10155 W TROPICAL PKWY LAS VEGAS NV 89149-1208
 STRANDBOGE LANCE D & KATHLEEN A 6121 ROCKETMAN CIR LAS VEGAS NV 89149
 5125 WOODLAWN BLVD MINNEAPOLIS MN 55417
 6076 ALPINE ESTATES CIR LAS VEGAS NV 89149-2024
 6086 ALPINE ESTATES CIR LAS VEGAS NV 89149-2024
 HALEY JENNIFER 5970 GOLDEN AROWANA WAY LAS VEGAS NV 89149
 TOTH FRANCIS J III & BONNIE L TR 6085 EGAN CREST DR LAS VEGAS NV 89149-1247
 10180 CORBETT ST LAS VEGAS NV 89149-1232
 6028 ALPINE ESTATES CIR LAS VEGAS NV 89149-2023
 P O BOX 752726 LAS VEGAS NV 89136
 5984 GOLDEN AROWANA WAY LAS VEGAS NV 89149
 WOOD MERNA TRS 6156 ROCKETMAN CIR LAS VEGAS NV 89149-1387
 WUNDERLIN JAMES & CHRISTINE TRS 6104 GALILEO DR LAS VEGAS NV 89149-1386
 YADEGAR FARIBORZ & JOYCE FAY TRS 6055 W BROOKS AVE LAS VEGAS NV 89108-4220

Printed On: Mon: February 8, 2016

Parcel Number

12625211003
 12625210019
 12625210025
 12625211022
 12625701039
 12625801005
 12625213003
 12625310006
 12625701015
 12625210002
 12625301005
 12625701003
 12625212007
 12625212008
 12625211021
 12625701010
 12625210017
 12625701061
 12625211019
 12625211002
 12625310003
 12625601026
 12625701013
 12625211008
 12625213001
 12625310002
 12625210022
 12625210015
 12625601002