

City of Las Vegas
Department of Planning
Development Services Center
333 North Rancho Drive, 3rd Floor
Las Vegas, Nevada 89106

Return Service Requested
Official Notice of Public Hearing

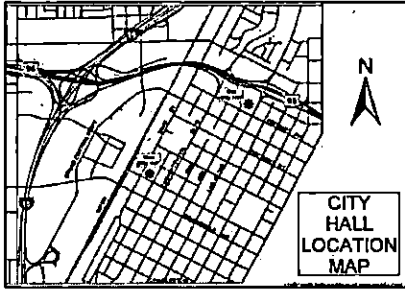

If you wish to file your protest or support on this request, check the appropriate box below and return this card in an envelope with postage to the Department of Planning at the address listed above, fax this side of this card to (702) 464-7499 or make your comments at www.lasvegasnevada.gov. If you would like to contact your Council Representative, please call (702) 229-6405.

I SUPPORT
this Request

I OPPOSE
this Request

Please use available blank space on card for your comments.

VAR-60700 [PRJ-60520]

Planning Commission Meeting of 10/13/2015

Application Information

VAR-60700 - PUBLIC HEARING - VARIANCE - APPLICANT/OWNER: VAN BUREN FAMILY TRUST - For possible action on a request for a Variance TO ALLOW A FIVE-FOOT REAR AND SIDE YARD SETBACK WHERE 10 FEET IS REQUIRED FOR A PROPOSED 2,560 SQUARE-FOOT ACCESSORY STRUCTURE (CLASS II) [GARAGE] AND TO ALLOW AN ACCESSORY STRUCTURE THAT IS NOT AESTHETICALLY COMPATIBLE WITH THE PRINCIPAL DWELLING on 0.51 acres at 4858 East Van Buren Avenue (APN 140-29-510-043), R-E (Residence Estates) Zone, Ward 3 (Coffin) [PRJ-60520].

Application Location

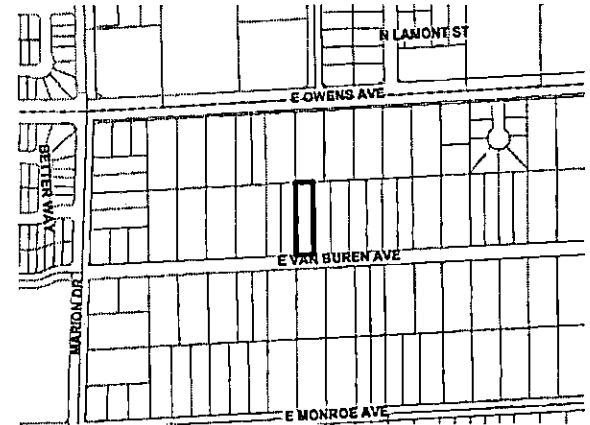

The proposed project may not pertain to the entire highlighted project site.

Public Hearing Information

Meeting: Planning Commission
Date: *October 13, 2015*
Time: 6:00 P.M.
Location: City Council Chambers
495 South Main Street, 2nd Floor
Las Vegas, Nevada 89101

Any and all interested persons may appear before the City Planning Commission either in person or by representative and object to or express approval of this request; or may, prior to this meeting, file a written objection thereto or approval thereof with the Department of Planning, Development Services Center, 333 North Rancho Drive, 3rd Floor, Las Vegas, Nevada 89106. Final Action on General Plan Amendments and Rezonings will be determined by the City Council. Other public hearing items may be deemed Final Action by the Planning Commission or forwarded to the City Council. The date of the City Council meeting, if applicable, will be announced at the Planning Commission meeting after the discussion of the item. For further information, including the full staff report, please call (702) 229-6301 (TDD 386-9108) or go to <http://www.lasvegasnevada.gov>.

Report of All Selected Parcels**Case Number:**

VAR-60700

Printed On: Tue: August 25, 2015

<u>Owner</u>	<u>Address</u>	<u>Parcel Numbe</u>
4704 LUCITE 26 L L C	P O BOX 364826 NORTH LAS VEGAS NV 89036	14020812002
4748 EAST MONROE L L C	4748 E MONROE AVE LAS VEGAS NV 89110	14029510102
4770 EAST MONROE L L C	6390 W DEWEY DR LAS VEGAS NV 89118-1904	14029510101
4D MANAGEMENT HOLDINGS INC	6360 MCLEOD DR #15 LAS VEGAS NV 89120	14029510050
A B J GROUP INVESTMENTS L L C	7293 ALTIZER CT CORONA CA 92880	14020803005
A B J GROUP INVESTMENTS L L C	7293 ALTIZER CT CORONA CA 92880	14020803007
ABURTO JOSE	4838 E MONROE AVE LAS VEGAS NV 89110-1500	14029510095
ACEVEDO DARIO	MUNETON-SALDIVAR MIREYA 1530 MARIDN DR LAS VEGAS NV 89110-1423	14029510053
ADAMS JOHN & LDUISE	3680 VIA GENEVA HENDERSON NV 89052-0517	14029510016
AGUILAR HECTDR	4604 SHOEN AVE LAS VEGAS NV 89110	14029511007
ALARCON ERICKA J	4728 E MONROE AVE LAS VEGAS NV 89110-1510	14029510103
ALVARADO LILIANA TEJADA	4821 HOT SPRINGS AVE LAS VEGAS NV 89110	14029611019
AMERSON FAMILY TRUST	AMERSON GERALD L & KAROLYNN TRS 2901 VISTA DEL SOL LAS VEGAS NV 89120-3612	14029510011
AMERSON FAMILY TRUST	AMERSON GERALD L & KAROLYNN TRS 2901 VISTA DEL SOL LAS VEGAS NV 89120-3612	14029510009
AMERSDN FAMILY TRUST	AMERSON GERALD L & KAROLYNN TRS 2901 VISTA DEL SOL LAS VEGAS NV 89120-3612	14029510010
ANAYA ANNA L	4917 E MONROE AVE LAS VEGAS NV 89110-1586	14029612001
ANDERSSON INVESTMENTS L L C	7229 WHITE DAK AVE RESEDA CA 91335	14020804005
ANDERSSON PROPERTIES L L C	4740 N PARK ST LAS VEGAS NV 89129	14020804004
ANDRADE CRISTINA	1509 BETTER WY LAS VEGAS NV 89110-1408	14029111069
ARAMBULA MILTON & ARACELI	350 PENNEY VIEW CT NORTH LAS VEGAS NV 89032-6144	14020812001
ARANZA ESPERANZA RODRIGUEZ	RODRIGUEZ FRANCISO LOPEZ 17638 SAN CANDELO ST FOUNTAIN VALLEY CA 92708	14020804002
ARTEAGA-IBANEZ CARLA VIRGINIA	4808 HOT SPRINGS AVE LAS VEGAS NV 89110-1508	14029611032
BARNETT FAMILY TRUST	BARNETT JOHN L & NINA TRS 4958 E VAN BUREN AVE LAS VEGAS NV 89110-1561	14029510035
BARRAGAN-SILVA BLADIMIR	MCKNIGHT JANET H 4918 E MONROE AVE LAS VEGAS NV 89110-1584	14029510090
BECHTOL DOUGLAS L	BELL-BECHTOL WENDY 1550 MARION DR LAS VEGAS NV 89110-1423	14029510055
BELLER HELEN	4941 E MONROE AVE LAS VEGAS NV 89110-1586	14029612003
BLAQUE DIAMOND INVESTMENTS L L C	7495 W AZURE DR #227 LAS VEGAS NV 89143	14029611036
BONILLA LETICIA	5751 SHINYLEAF CIR LAS VEGAS NV 89142-1125	14020812011
BONILLA MARIO	DIAZ MARIA 2013 HASSETT AVE LAS VEGAS NV 89104-3628	14029510040
BRYNER PAUL R & CAROLYN M	4816 E HOT SPRINGS AVE LAS VEGAS NV 89110-1508	14029611030
CARDOSO GABRIEL & BERTHA	1844 BLUE RIBBON DR LAS VEGAS NV 89142-0741	14029611039
CARRASCO-CRUZ MARIA	4817 HOT SPRINGS AVE LAS VEGAS NV 89110-1507	14029611018

Report of All Selected Parcels**Case Number:**

VAR-60700

Printed On: Tue: August 25, 2015

<u>Owner</u>	<u>Address</u>	<u>Parcel Numbe</u>
CASTELLVI JUAN J & MATILDE	4829 E HOT SPRINGS AVE LAS VEGAS NV 89110-1507	14029611021
CASTRO RAUL & CLAUDIA	20271 CASE ST CORONA CA 92881	14029511001
CAVADA LUCIO C & LUCRECIA	4897 E MONROE AVE LAS VEGAS NV 89110-1511	14029611045
CHAN FLORENTIUS	WANG HELENA 1681 KINGSPPOINT DR WALNUT CA 91789	14029510104
CHAVEZ JORGE	6268 DOWNPOUR CT LAS VEGAS NV 89110-5037	14029510033
COLON-SALDIVAR JOSE R	4779 E VAN BUREN AVE LAS VEGAS NV 89110-1537	14029510060
CONNER MATTHEW	1660 N LAMONT ST LAS VEGAS NV 89115-6708	14020813001
CORSINELLI HENRY ALFRED & PAMELA	4735 E MONROE AVE LAS VEGAS NV 89110-1509	14029610003
CROUCH JERRY	BARTON HELEN 6017 JUBILEE GARDENS AVE LAS VEGAS NV 89131-2333	14029510012
CUSTOM ESTATES L L C	9067 W POST RD #A LAS VEGAS NV 89148	14029611002
DIAZ DEANNA	1621 N LAMONT ST A-D LAS VEGAS NV 89115	14020812010
DIAZ JOEL CHOSCO	CHOSCO ELISA 11300 MIRANDA ST NDRTH HOLLYWOOD CA 91601-1820	14020813006
DZANAKARIDIS ATANASIS G	SZAUER SYLVIA 11000 S EASTERN AVE #1022 HENDERSON NV 89052	14020813002
DZANAKARIDIS ATANASIS GEORGE	11000 S EASTERN AVE #1022 HENDERSON NV 89052	14020813008
EARNEST CHARLES V	8002 SECRETARIAT LN LAS VEGAS NV 89123	14029511005
EGYPT MELVIN L	4712 RIVERBANK LN LAS VEGAS NV 89110-1518	14029610010
ESTEBAN DAVID & SANDRA	4878 E MONROE AVE LAS VEGAS NV 89110-1500	14029510093
F D D INVESTMENTS L L C	1436 MARION DR LAS VEGAS NV 89110	14029510105
FAGER HELENE	4857 E MONROE AVE LAS VEGAS NV 89110-1511	14029611041
FAJARDO AIDENIS R & AIDENIS	4877 E MONROE AVE LAS VEGAS NV 89110-1511	14029611043
FIERROS ARTURO VILLA	1641 N LAMONT ST #C LAS VEGAS NV 89115	14020812012
FINESTONE ALAN E	10170 CULVER BLVD CULVER CITY CA 90232	14029111051
FREGOSO JOSE A & MARIA T	1213 STONEY BEACH ST LAS VEGAS NV 89110-1591	14029611024
GARCIA MARIA E	1560 MARION DR LAS VEGAS NV 89110-1423	14029510056
GONZALEZ ANTONIO S JR & IRMA B	724 LINCOLN ST WATSONVILLE CA 95076-4331	14029511002
GONZALEZ JULIO C	VARGAS-SIMON MARIA GUADALUPE 1611 N LAMONT ST #C NORTH LAS VEGAS NV 89030	14020812009
GRADY FAMILY TRUST	GRADY CYNTHIA R TRS 4825 E VAN BUREN AVE LAS VEGAS NV 89110-1563	14029510063
GU MEIQIONG	1029 S EASTHILLS DR WEST COVINA CA 91791	14029111068
GUEVARA JOSE V HUERTA	HUERTA FERNANDO G 4804 HOT SPRINGS AVE LAS VEGAS NV 89110-1508	14029611033
HACKLEY MARSHA S	SPAZIANI BERNARD JR 4978 E MONROE AVE LAS VEGAS NV 89110-1584	14029510086
HAGGARD RONALD R & SHERRY D	HAGGARD LASHAY 2221 CAMEL ST LAS VEGAS NV 89115-5224	14029510074
HAGGARD RONALD R & SHERRY DIANE	HAGGARD LASHAY 2221 CAMEL ST LAS VEGAS NV 89115-5224	14029510075

Report of All Selected ParcelsCase Number:

VAR-60700

Printed On: Tue: August 25, 2015

<u>Owner</u>	<u>Address</u>	<u>Parcel Number</u>
HANNIG CELTA L REVOCABLE LIV TR	HANNIG CELTA L TRS 4738 1/2 E VAN BUREN AVE LAS VEGAS NV 89110-1538	14029510051
HEARD GREGORY H	4661 CURDSEN WY LAS VEGAS NV 89110-1406	14029111048
HERNANDEZ ERNEST & ROSA	5591 LA PERLA CT LAS VEGAS NV 89122-8390	14020813007
HERNANDEZ RICARDO & AMALIA	4953 E MONROE AVE LAS VEGAS NV 89110-1586	14029612006
HERNANDEZ ROBERTO CORTEZ	4664 E VAN BUREN AVE LAS VEGAS NV 89110-1442	14029111050
HERRERA LUZ N & NAOMI	4918 E VAN BUREN AVE LAS VEGAS NV 89110-1561	14029510038
HILL MORGAN G & SALLIE L	4990 E VAN BUREN AVE LAS VEGAS NV 89110-1561	14029510032
HOLLINGSWORTH JEAN FAMILY TRUST	HOLLINGSWORTH EDNA JEAN TRS 4778 E MONROE AVE LAS VEGAS NV 89110-1510	14029510099
HOSTIA CESAR	3436 LACEBARK PINE ST LAS VEGAS NV 89129	14029510004
HOSTIA CESAR	3436 LACEBARK PINE ST LAS VEGAS NV 89129	14029510005
HUANG INGRID INA LIVING TRUST	H I ORANGE VILLAS L L C 7021 BRIGHT SPRINGS CT LAS VEGAS NV 89113-1341	14029510017
HUGHES MADELINE A	4945 E MONROE AVE LAS VEGAS NV 89110-1586	14029612004
INGLESIAS ANER & REBECCA	P O BOX 29269 LAS VEGAS NV 89126	14029611017
JENSEN MARK S	4998 E VAN BUREN AVE LAS VEGAS NV 89110-1561	14029510031
JHAKRY RADJKOEMAR & NELLY	94-02 96 ST OZONE PARK NY 11416	14029511004
KING FUTT'S P F M L L C	5700 BOULDER HWY LAS VEGAS NV 89122-7204	14029510003
KIRKBERG LYSENDA J	4878 E VAN BUREN AVE LAS VEGAS NV 89110-1558	14029510041
KOLANDER WILLIAM G	CABRERA-ROSSAL ONELIA C 7735 S INDUSTRIAL RD LAS VEGAS NV 89139-6612	14029510106
KRUISE KENNETH M & SHIRLEY L	4885 E MONROE AVE LAS VEGAS NV 89110-1511	14029611044
L Z ENTERPRISES L L C	P O BOX 151177 SAN RAFAEL CA 94915	14029611038
LAS VEGAS GROCERY INC	180 RATON DR HENDERSON NV 89074-1058	14020803006
LEMONDS JAMES L	4760 E VAN BUREN AVE LAS VEGAS NV 89110-1538	14029510049
LIAO LIH-NAN & SHU-CHEN	7697 KEATING CIR LAS VEGAS NV 89147-4927	14029510030
LINDQUIST CHERYL A LIVING TRUST	4836 HOT SPRINGS AVE LAS VEGAS NV 89110-1508	14029611025
LOPEZ JOSE T & MARIA BARRAGAN	4799 E VAN BUREN LAS VEGAS NV 89110-1537	14029510061
LOPEZ MIRIAM	MIRANDA ALEX 3405 DROVER AVE LAS VEGAS NV 89101-1809	14020411007
LOPEZ VICKI	2106 MARLIN AVE LAS VEGAS NV 89101	14029511006
M F S 26 L L C	P O BOX 13381 LOS ANGELES CA 90013	14020812007
MACINTOSH DALE T & JOYCE E	4979 E VAN BUREN AVE LAS VEGAS NV 89110-1564	14029510073
MARROQUIN FRANCISCO & ALBERTA	5277 BIRDSTONE CT LAS VEGAS NV 89156-0930	14029511008
MARTIN ANTHONY JAMES	SALTER-MARTIN DONNA MARIE 4828 HOT SPRINGS AVE LAS VEGAS NV 89110-1508	14029611027
MARTIN TIMM W & CRYSTAL D	5018 E MONROE AVE LAS VEGAS NV 89110-1585	14029510084

Report of All Selected ParcelsCase Number:

VAR-60700

Printed On: Tue: August 25, 2015

<u>Owner</u>	<u>Address</u>	<u>Parcel Numbe</u>
MARTINEZ CHRISTINA F	4859 E VAN BUREN AVE LAS VEGAS NV 89110-1563	14029510065
MARTINEZ JORGE	1650 MARY JANE DR LAS VEGAS NV 89115-6651	14020812004
MARTINEZ JORGE	1671 N LAMONT ST LAS VEGAS NV 89115-6661	14020812015
MARTINEZ PAUL A & ONA REV LIV TR	MARTINEZ ONA TRS 4792 E MONROE AVE LAS VEGAS NV 89110-1510	14029510098
MARY JANE DRIVE TRUST	9224 RED TWIG DR LAS VEGAS NV 89134-6037	14020812005
MARYLAND VIEW L P	468 N CAMDEN DR #300 BEVERLY HILLS CA 90210	14020803004
MAUGER GEORGE C	4899 E VAN BUREN AVE LAS VEGAS NV 89110-1563	14029510067
MAUGER GEORGE C	4899 E VAN BUREN AVE LAS VEGAS NV 89110-1563	14029510068
MCALLISTER JOAL & P N REV TRUST	MCALLISTER JOEL & PAULINE N TRS 4858 E MONROE AVE LAS VEGAS NV 89110-1500	14029510094
MCALLISTER MARK W	4808 E MONROE AVE LAS VEGAS NV 89110-1500	14029510097
MCDONALD HOMER JR	4656 SUPREME CT LAS VEGAS NV 89110-1405	14029111073
MEAD LYLE A & NOY W	4888 E MONROE AVE LAS VEGAS NV 89110-1500	14029510092
MEDINA FAMILY TRUST	MEDINA CONRADO & EMELIA P TRS 3055 PHOENIX ST LAS VEGAS NV 89121-2182	14020812006
MENDEZ VERONICA	1488 MARION DR LAS VEGAS NV 89110	14029510057
MESSINA SANDRA E	4959 E VAN BUREN AVE LAS VEGAS NV 89110-1564	14029510108
MEZA MANUEL DE JESUS	4774 E MONROE AVE LAS VEGAS NV 89110-1510	14029510100
MEZA MANUEL JESUS	4998 E MONROE AVE LAS VEGAS NV 89110-1584	14029510085
MEZA MARIA	4812 HOT SPRINGS AVE LAS VEGAS NV 89110-1508	14029611031
MILEY JUANITA LUCILLE TRUST	MASSE JUANITA LUCILLE MILEY TRS 1540 MARION DR LAS VEGAS NV 89110-1423	14029510054
MIXSON GARRY R & D ANN	4771 E MONROE AVE LAS VEGAS NV 89110-1509	14029610001
MUNGARAY RUDY D	ZEMLO-MUNGARAY MARGARET A 4879 E VAN BURAN AVE LAS VEGAS NV 89110-1563	14029510066
MUSSO LIVING TRUST	MUSSO WILLIAM P & BARBARA L TRS 3821 CAVALRY ST LAS VEGAS NV 89121-4456	14029510036
NAVARRO ROSALIO	4919 E VAN BUREN AVE LAS VEGAS NV 89110-1564	14029510069
NEVINS DEBRA H	806 ROCKY PARK CT LAS VEGAS NV 89123-3696	14020813005
NGUYEN WILAIPHORN	RIEWREANG PAIRIN 4820 HOT SPRINGS AVE LAS VEGAS NV 89110-1508	14029611029
OWENS 16 L L C	4055 CATHEDRAL FALLS NORTH LAS VEGAS NV 89085-4469	14020804017
PALAFX LINA	1251 BLEDSOE LN LAS VEGAS NV 89110	14020804003
PEREZ AURELIO & IRMA	1521 BETTER WY LAS VEGAS NV 89110-1408	14029111072
PEREZ MARTIN GONZALEZ	9113 HASTY AVE DOWNEY CA 90240-2472	14029611016
PETERSON LEONARD JR & MADGE	4815 E VAN BUREN AVE LAS VEGAS NV 89110-1563	14029510062
PHUONG VICTORIA FAMILY TRUST	PHUONG BECKY TRS 4690 GREY DR LOS ANGELES CA 90032-2019	14029510006
PRADO VICTOR & AMALIA	4413 HALBERT AVE LAS VEGAS NV 89110-5465	14029111067

Report of All Selected Parcels**Case Number:**

VAR-60700

Printed On: Tue: August 25, 2015

<u>Owner</u>	<u>Address</u>	<u>Parcel Numbe</u>
PRIETO GREGORIO LANDEROS	4801 E MONROE AVE LAS VEGAS NV 89110-1511	14029611035
PUNTES-HERRERA ALAIN	1513 BETTER WAY LAS VEGAS NV 89110	14029111070
PULIDO PORFIRIO P & NETI I	4124 THUNDER TWICE ST LAS VEGAS NV 89129-6067	14029510007
PULIDO SUZANNA	4124 THUNDER TWICE ST LAS VEGAS NV 89129-6067	14029510008
QUINONES HECTOR	RODRIGUEZ JESUS G 233 DAWN ISLE DR LAS VEGAS NV 89145	14029510052
R J NEVADA L L C	18520 BURBANK BLVD TARZANA CA 91356	14020815004
R J NEVADA L L C	18520 BURBANK BLVD TARZANA CA 91356	14020815003
R J NEVADA L L C	18520 BURBANK BLVD TARZANA CA 91356	14020815001
R J NEVADA L L C	18520 BURBANK BLVD TARZANA CA 91356	14020815005
R J NEVADA L L C	18520 BURBANK BLVD TARZANA CA 91356	14020815007
R J NEVADA L L C	18520 BURBANK BLVD TARZANA CA 91356	14020815008
R J NEVADA L L C	18520 BURBANK BLVD TARZANA CA 91356	14020815006
R J NEVADA L L C	18520 BURBANK BLVD TARZANA CA 91356	14020815002
RANGEL MARIA FAMILY TRUST	RANGEL MARIA TRS 4743 E MONROE AVE LAS VEGAS NV 89110-1509	14029611001
RANGEL MARIA FAMILY TRUST	RANGEL MARIA TRS 4743 E MONROE AVE LAS VEGAS NV 89110-1509	14029610002
RAUGUST EUGENE	4778 E VAN BUREN AVE LAS VEGAS NV 89110-1538	14029510048
RESNIK ROBERT S	4928 E MONROE AVE LAS VEGAS NV 89110-1584	14029510089
RINGLER SCOTT A & PATRICIA L	4935 E MONROE AVE LAS VEGAS NV 89110-1586	14029612002
RITCHIE ISABELLE TERRY	DZIEDZIC GENE 4839 E VAN BUREN AVE LAS VEGAS NV 89110-1563	14029510064
ROBERSON KIM S	4970 E VAN BUREN AVE LAS VEGAS NV 89110-1561	14029510034
ROBINSON SAMULE M & LAURA D	4938 E MONROE AVE LAS VEGAS NV 89110-1584	14029510088
RODRIGUEZ APOLINAR & MARTHA	6065 THORNE BAY CT LAS VEGAS NV 89110-1880	14020812008
RODRIGUEZ FAMILY L P	4410 PALM MESA DR LAS VEGAS NV 89120-4239	14029510042
RODRIGUEZ RUTILIO	GUTIERREZ MARIA D 4834 E VAN BUREN AVE LAS VEGAS NV 89110-1558	14029510045
RUIZ ABELARDO DEJESUS	DEJESUS DELMA G 4800 HOT SPRINGS AVE LAS VEGAS NV 89110-1508	14029611034
SALGADD SILVESTRE	4743 STANLEY AVE LAS VEGAS NV 89115-6629	14020803003
SALGADO SILVESTRE & MARIA	4743 STANLEY AVE NORTH LAS VEGAS NV 89030	14020803002
SANABRIA PEDRO MORALES	4939 E VAN BUREN AVE LAS VEGAS NV 89110-1564	14029510070
SANCHEZ SERGIO & MARIA LAURA	4341 CHAFER DR LAS VEGAS NV 89121-4616	14020812003
SANDOVAL J ROSARIO	483B E VAN BUREN AVE LAS VEGAS NV 89110-1558	14029510044
SANDOVAL JOSE R	SANDOVAL-PEREZ M ESTELA 4838 E VAN BUREN LAS VEGAS NV 89110-1558	14029501003
SHELL DON & DIANA M FAMILY TR	SHELL DON & DIANA M TRS 4898 E VAN BUREN AVE LAS VEGAS NV 89110-1558	14029510039

Report of All Selected Parcels**Case Number:**

VAR-60700

Printed On: Tue: August 25, 2015

<u>Owner</u>	<u>Address</u>	<u>Parcel Numbe</u>
SCHOOL BOARD OF TRUSTEES	4190 MCLEOD DR 2ND FLR LAS VEGAS NV 89121	14029101018
SHARP VAL D	4956 E MONROE AVE LAS VEGAS NV 89110-1584	14029510087
SLACK KAYE	P O BOX 43435 LAS VEGAS NV 89116-1435	14029510037
SOLORZANO-LUNA MARIO	DESOLORZANO ESTANISLADA B 4824 HOT SPRINGS AVE LAS VEGAS NV 89110-1508	14029611028
SOUTHERN NV HOUSING AUTHORITY	340 N 11TH ST #170 LAS VEGAS NV 89101-3125	14020804006
SPARTAN GAMING L L C	1821 LAS VEGAS BLVD N NORTH LAS VEGAS NV 89030-6936	14020812016
STARR MANAGEMENT GROUP INC	4427 NORMA JEAN LN LAS VEGAS NV 89031-2214	14029510002
TATUM SMEAD	4817 E MONROE AVE LAS VEGAS NV 89110-1511	14029611037
TERRAZAS JOSEFINA	659 SUMMER HEIGHTS LN LAS VEGAS NV 89110	14020411006
THOMAS ALETTA J	4818 E MONROE AVE LAS VEGAS NV 89110-1500	14029510096
TORRES GUADALUPE	4845 E MONROE AVE LAS VEGAS NV 89110-1511	14029611040
TRUJILLO MIKE	2262 BRIDLE WREATH LN LAS VEGAS NV 89156-7926	14020812014
TRUSTEE CLARK COUNTY TREASURER	4959 E OWENS AVE LAS VEGAS NV 89110-1570	14029510015
TRUSTEE CLARK COUNTY TREASURER	6975 DOCILE DAYBREAK CT LAS VEGAS NV 89156-7208	14029612005
TURNER PATRICIA L	4832 E HOT SPRINGS AVE LAS VEGAS NV 89110-1508	14029611026
VALENZUELA RODOLFO & MARTHA A	4898 E MONROE AVE LAS VEGAS NV 89110-1500	14029510091
VAN BUREN FAMILY TRUST	4858 E VAN BUREN AVE LAS VEGAS NV 89110-1558	14029510043
VARGAS RAMON	1695 ROCKWELL LN LAS VEGAS NV 89156-6738	14020812013
VASEY KATHERINE	4833 HOT SPRINGS AVE LAS VEGAS NV 89110-1507	14029611022
VELASCO PAMELA FAMILY TRUST	VELASCO PAMELA TRS 4741 E VAN BUREN AVE LAS VEGAS NV 89110-1537	14029510058
VELOZ-LEOS GAVINO & CARLOS	5405 MOONSTRUCK AVE LAS VEGAS NV 89107-1594	14029501002
VILLANUEVA JUAN MANUEL & ELENA	4665 CURDSEN WAY LAS VEGAS NV 89110-1406	14029111049
WATKINS WILLIAM	840 S RANCHO DR #4-424 LAS VEGAS NV 89106-3837	14029510014
WATKINS WILLIAM C	840 S RANCHO DR SUITE 4 #424 LAS VEGAS NV 89106-3800	14029510013
WESSON BETTE C	4759 E VAN BUREN AVE LAS VEGAS NV 89110-1537	14029510059
WILHELM SONIA U	6656 RUTGERS DR LAS VEGAS NV 89156-4955	14029510001
WISNIEWSKI DALE L & RUTH E	7950 LA MADRE LAS VEGAS NV 89149-5206	14029611042
WOMENS DEVELOPMENT CENTER	4020 PECOS MCLEOD LAS VEGAS NV 89121-4350	14029511003
ZULIANI MICHAEL L	6260 S RAINBOW BLVD #100 LAS VEGAS NV 89118-3239	14029611020