

City of Las Vegas  
Department of Planning  
Development Services Center  
333 North Rancho Drive, 3<sup>rd</sup> Floor  
Las Vegas, Nevada 89106

## Return Service Requested Official Notice of Public Hearing

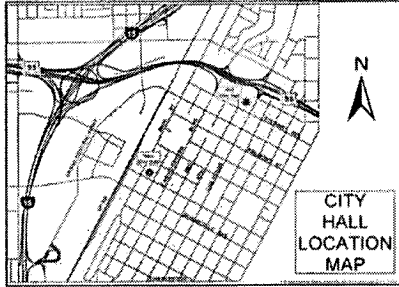

If you wish to file your protest or support on this request, check the appropriate box below and return this card in an envelope with postage to the Department of Planning at the address listed above, fax this side of this card to (702) 464-7499 or make your comments at [www.lasvegasnevada.gov](http://www.lasvegasnevada.gov). If you would like to contact your Council Representative, please call (702) 229-6405.

I SUPPORT  
this Request

I OPPOSE  
this Request

Please use available blank space on card for your comments.

**VAR-58028 [PRJ-57818]**

Planning Commission Meeting of 4/14/2015

## Application Information

**VAR-58028 - VARIANCE - PUBLIC HEARING - APPLICANT/OWNER: RYLAND HOMES NEVADA, LLC** - For possible action on a request for a Variance TO ALLOW A 9.5-FOOT REAR YARD SETBACK WHERE 15 FEET IS REQUIRED on 0.07 acres at 10648 Forum Peak Lane (APN 126-13-113-064), PD (Planned Development) Zone [ML (Medium Low Density Residential) Cliff's Edge Special Land Use Designation], Ward 6 (Ross) [PRJ-57818].

## Application Location

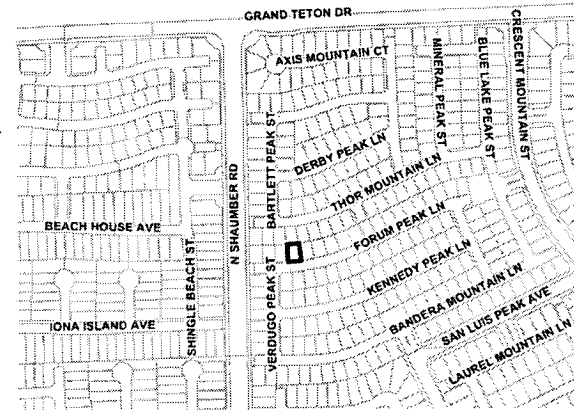

The proposed project may not pertain to the entire highlighted project site.

## Public Hearing Information

**Meeting:** Planning Commission  
**Date:** April 14, 2015  
**Time:** 6:00 P.M.  
**Location:** City Council Chambers  
495 South Main Street, 2<sup>nd</sup> Floor  
Las Vegas, Nevada 89101

Any and all interested persons may appear before the City Planning Commission either in person or by representative and object to or express approval of this request; or may, prior to this meeting, file a written objection thereto or approval thereof with the Department of Planning, Development Services Center, 333 North Rancho Drive, 3<sup>rd</sup> Floor, Las Vegas, Nevada 89106. Final Action on General Plan Amendments and Rezonings will be determined by the City Council. Other public hearing items may be deemed Final Action by the Planning Commission or forwarded to the City Council. The date of the City Council meeting, if applicable, will be announced at the Planning Commission meeting after the discussion of the item. For further information, including the full staff report, please call (702) 229-6301 (TDD 386-9108) or go to <http://www.lasvegasnevada.gov>.

**Report of All Selected Parcels**

**Case Number:** VAR-58024 VAR-58025 VAR-58026 VAR-58027 VAR-58028 VAR-58029 VAR-58030 VAR-58031 VAR-58032  
VAR-58033 VAR-58034

**Printed On:** Wed: March 4, 2015

| <u>Owner</u>                  | <u>Address</u>  | <u>Parcel Number</u> |
|-------------------------------|---|----------------------|
| 10628 TRAY MT L L C           | 3273 E WARM SPRINGS RD LAS VEGAS NV 89120   | 12613215036          |
| A R P PHOENIX FUND I L P      | 7047 E GREENWAY PKWY #350 SCOTTSDALE AZ 85254-8117                                | 12613117059          |
| A R P PHOENIX FUND I L P      | 7047 E GREENWAY PKWY #350 SCOTTSDALE AZ 85254-8117                                | 12613115026          |
| ABRUZZO STEVE & GERALDINE     | 10803 IONA ISLAND AVE LAS VEGAS NV 89166-5087                                     | 12613115087          |
| AHMAD SHAKIR & MEGAN          | 10745 BEACH HOUSE AVE LAS VEGAS NV 89166-5093                                     | 12613115028          |
| ALFONSO EDDIE S & MARISSA M   | 10512 WHITE PRINCESS AVE LAS VEGAS NV 89166-5085                                  | 12613114006          |
| ALLEN STEVEN J & RACHEL M     | 7923 BARTLETT PEAK ST LAS VEGAS NV 89166  | 12613116026          |
| ALLEY SHIRLEY                 | 10609 THOR MOUNTAIN LN LAS VEGAS NV 89166-5074                                    | 12613116010          |
| ALVAREZ HECTOR JR & RUTH N    | 10717 DOBBS AVE LAS VEGAS NV 89166-5112   | 12613212274          |
| AMARO ROBERT H & SUZANNE L    | 10668 MOUNT JEFFERSON AVE LAS VEGAS NV 89166-5055                                 | 12613213057          |
| AMBRIZ VERONICA               | 10741 BROXDEN JUNCTION AVE LAS VEGAS NV 89166-5101                                | 12613117026          |
| ANDERSEN MISTY L              | 10635 BANDERA MOUNTAIN LN LAS VEGAS NV 89166-5029                                 | 12613113046          |
| ANDERSEN SETH J               | BEGG KATHLEEN A 2321 W VIA PERUGIA PHOENIX AZ 85086                               | 12613513047          |
| ANDERSON BRITTANY D           | 10633 MOUNT JEFFERSON AVE LAS VEGAS NV 89166-5054                                 | 12613213079          |
| ANDERSON JENNIFER A & SCOTT D | 10620 KEARNEY MOUNTAIN AVE LAS VEGAS NV 89166                                     | 12613215054          |
| ANDERSON RAYMON & HEATHER     | 10746 BAYVIEW HOUSE AVE LAS VEGAS NV 89166-5096                                   | 12613117054          |
| ANGELES ERWIN G & FRANCISCO R | 10556 BANDERA MOUNTAIN LN LAS VEGAS NV 89166-5027                                 | 12613113123          |
| ANTHES JOEL B                 | 10617 CAPITOL PEAK AVE LAS VEGAS NV 89166   | 12613116102          |
| ARCADE MICHELE DENISE         | 10741 DOBBS AVE LAS VEGAS NV 89166-5112   | 12613212268          |
| ARTEAGA JESUS                 | 10656 KENNEDY PEAK LN LAS VEGAS NV 89166-5045                                     | 12613113101          |
| ASKEY ROBERT D & CHRISTINE R  | 10240 SCOPES AVE LAS VEGAS NV 89166   | 12613513027          |
| AXTELL JAMES ROBERT JR        | 7815 VERDUGO PEAK ST LAS VEGAS NV 89166-5083                                      | 12613113054          |
| BAGOCUS 2011 TRUST            | BAGOCUS JOHN P & NANCY L CO-TRS 10426 GROTTO MOUNTAIN AVE LAS VEGAS NV 89166-5008 | 12613514009          |
| BAIELEY JEFFREY A             | 7854 AIROLA PEAK ST LAS VEGAS NV 89166-5021                                       | 12613513025          |
| BAILEY RONALD L & DONIA M     | 10629 MOUNT JEFFERSON AVE LAS VEGAS NV 89166-5054                                 | 12613213080          |
| BAPTIST DAWN                  | 575 URSA MAJOR DR NORTH POLE AK 99705-5080  | 12613117062          |
| BAREA MARY JOLENE             | 10725 BEACH HOUSE AVE LAS VEGAS NV 89166-5093                                     | 12613115033          |
| BARRONE JOHN D & COLLEEN L    | 10656 KEARNEY MOUNTAIN AVE LAS VEGAS NV 89166-5043                                | 12613215063          |
| BARTON BRUCE & CONNIE         | 7815 SUGARLOAF PEAK ST LAS VEGAS NV 89166   | 12613514002          |
| BASS RACHEL                   | DELCID DANIEL 7725 DONNER PEAK ST LAS VEGAS NV 89166-5082                         | 12613215021          |
| BAUGH KAYLEE                  | 10609 CAPITOL PEAK AVE LAS VEGAS NV 89166   | 12613116104          |

**Report of All Selected Parcels**

**Case Number:** VAR-58024 VAR-58025 VAR-58026 VAR-58027 VAR-58028 VAR-58029 VAR-58030 VAR-58031 VAR-58032  
VAR-58033 VAR-58034

**Printed On:** Wed: March 4, 2015

| <b>Owner</b>                     | <b>Address</b>   | <b>Parcel Number</b> |
|----------------------------------|--|----------------------|
| BAULA MERCEDITA C                | 10656 MOUNT JEFFERSON AVE LAS VEGAS NV 89166-5055                          | 12613213060          |
| BEADLE FREENA & FREENA PINEDA    | 10628 KEARNEY MOUNTAIN AVE LAS VEGAS NV 89166                              | 12613215056          |
| BEAULIEU KARSON D & BEATA K      | 7919 TORREYS PEAK ST LAS VEGAS NV 89166-5077                               | 12613114019          |
| BEAZER HOMES HOLDINGS CORP       | 2470 PASEO VERDE PKWY #135 HENDERSON NV 89074                              | 12613212320          |
| BECKETT JOHN R & MILDRED A       | 7743 SUGARLOAF PEAK ST LAS VEGAS NV 89166-5020                             | 12613615029          |
| BELL JULIE D                     | 1968 LARKSPUR RANCH CT HENDERSON NV 89012                                  | 12613115007          |
| BELL TERESA                      | 10548 BANDERA MOUNTAIN LN LAS VEGAS NV 89166-5027                          | 12613113121          |
| BENCIC DEAN                      | 10755 IONA ISLAND AVE LAS VEGAS NV 89166-5086                              | 12613115093          |
| BENESH BRADLEY                   | 7920 BARTLETT PEAK ST LAS VEGAS NV 89166                                   | 12613116115          |
| BENZ SUSAN                       | 10633 THOR MOUNTAIN LN LAS VEGAS NV 89166-5075                             | 12613116015          |
| BERTRAN JORGE & JESSICA          | 7747 WEAVERCREST CT LAS VEGAS NV 89166                                     | 12613212162          |
| BISCEGLIA CHRISTOPHER A & ALEXAN | 10760 BEACH HOUSE AVE LAS VEGAS NV 89166                                   | 12613115003          |
| BLACK JOSEPH W & LAUREN R        | 7926 LOST RANGER PEAK ST LAS VEGAS NV 89166                                | 12613116072          |
| BLUBAUGH WILLIAM & PEGGY         | 7819 SUGARLOAF PEAK ST LAS VEGAS NV 89166-5019                             | 12613514003          |
| BOEKANKAMP JOEL & LENORE D       | 7908 AIROLA PEAK ST LAS VEGAS NV 89166-5021                                | 12613513023          |
| BOHN CODY R & KATRINA M          | 7823 BRODIE CASTLE CT LAS VEGAS NV 89166                                   | 12613115061          |
| BOHN LARRY & EVA                 | 1920 AUTUMN SAGE AVE NORTH LAS VEGAS NV 89031-1699                         | 12613213063          |
| BOLDEN NICOLE N                  | 7823 GRANITE CITY CT LAS VEGAS NV 89166-5090                               | 12613115049          |
| BOLEWARE WALTER DUDLEY FAMILY TR | BOLEWARE MARY JESSIE TRS 10406 GROTTO MOUNTAIN AVE LAS VEGAS NV 89166-5008 | 12613514014          |
| BOONE DENNIS LEROY & ERIN K      | 10641 AXIS MOUNTAIN CT LAS VEGAS NV 89166                                  | 12613116051          |
| BOUCEK JOHN J                    | 10613 CAPITOL PEAK AVE LAS VEGAS NV 89166                                  | 12613116103          |
| BOUCHE ELVIA                     | 10414 PRAIRIE MOUNTAIN AVE LAS VEGAS NV 89166-5059                         | 12613513046          |
| BOWLER BENJAMIN JAMES & JENNIFER | 7755 HOUSTON PEAK ST LAS VEGAS NV 89166-5105                               | 12613212176          |
| BRAGANZA MICHAEL                 | 19 DESERT HIGHLANDS DR HENDERSON NV 89052                                  | 12613115103          |
| BRAUD BRIAN J                    | 7919 BARTLETT PEAK ST LAS VEGAS NV 89166                                   | 12613116025          |
| BRAY CHRISTOPHER L & AMANDA J    | 7759 LONE SHEPHERD DR LAS VEGAS NV 89166-5120                              | 12613212210          |
| BRAY COURTNEY J                  | 10761 BAYVIEW HOUSE AVE LAS VEGAS NV 89166-5097                            | 12613117061          |
| BRIDGES CHRISTOPHER A            | 7818 GRANITE CITY CT LAS VEGAS NV 89166-5090                               | 12613115041          |
| BRIDGES NERISA                   | 10426 PRAIRIE MOUNTAIN AVE LAS VEGAS NV 89166-5059                         | 12613513049          |
| BRONSON JASON A                  | 10624 KEARNEY MOUNTAIN AVE LAS VEGAS NV 89166                              | 12613215055          |
| BROOKS DAVID W                   | 30902 CLUBHOUSE #28F LAGUNA NIGUEL CA 92677-2399                           | 12613212207          |
| BROWN BRENDAN ROGERS             | 10717 OREGON AVE CULVER CITY CA 90232                                      | 12613117035          |

**Report of All Selected Parcels**

**Case Number:** VAR-58024 VAR-58025 VAR-58026 VAR-58027 VAR-58028 VAR-58029 VAR-58030 VAR-58031 VAR-58032  
VAR-58033 VAR-58034

**Printed On:** Wed: March 4, 2015

| <b>Owner</b>                     | <b>Address</b>  | <b>Parcel Number</b> |
|----------------------------------|---|----------------------|
| BRYANT KENNETH JR & MAESHA       | 7764 CALEY CANYON ST LAS VEGAS NV 89166                         | 12613212157          |
| BUCHANAN TAMMY R                 | 10613 THOR MOUNTAIN LN LAS VEGAS NV 89166-5074                  | 12613116011          |
| BUCHORN BRYAN A & LACEY D        | 7830 SHINGLE BEACH ST LAS VEGAS NV 89166-5088                   | 12613115110          |
| BUCK TERENCE                     | 7760 HOUSTON PEAK ST LAS VEGAS NV 89166                         | 12613212184          |
| BUDDE FLORENCE C                 | 10616 BANDERA MOUNTAIN LN LAS VEGAS NV 89166-5028               | 12613113127          |
| BULMAN MERISSA                   | 10810 BEACH HOUSE AVE LAS VEGAS NV 89166-5095                   | 12613115006          |
| BURGOS BRITTANY NICOLE           | 3808 KILGORES ROCKS AVE NORTH LAS VEGAS NV 89085                | 12613113111          |
| BURKE EDWARD                     | SINOBIO MARY 10461 BURENSBURG AVE LAS VEGAS NV 89135            | 12613513107          |
| BURKE WARREN R                   | 7774 LONE SHEPHERD DR LAS VEGAS NV 89166-5120                   | 12613212203          |
| BURTON CRAIG S & ERIN M R        | 10434 WHITE PRINCESS AVE LAS VEGAS NV 89166-5085                | 12613513007          |
| C A H 2014-1 BORROWER L L C      | 9305 E VIA DE VENTURA #201 SCOTTSDALE AZ 85258                  | 12613115024          |
| C T COMPANY INTL L L C           | 9312 VERLAINE CT LAS VEGAS NV 89145-8687                        | 12613117032          |
| C T COMPANY INT'L L L C          | 9312 VERLAINE CT LAS VEGAS NV 89145-8687                        | 12613115109          |
| CADMAN JULIE                     | 7718 ALBRIGHT PEAK DR LAS VEGAS NV 89166                        | 12613215004          |
| CAHILL MICHAEL & ERIN            | CAHILL BRIAN M & KAREN R 7928 AIROLA PEAK DR LAS VEGAS NV 89166 | 12613513018          |
| CALA JOHN & JEANETTE             | 10663 BANDERA MOUNTAIN LN LAS VEGAS NV 89166-5029               | 12613113052          |
| CALIENDO GRACE                   | 10416 BAYS MOUNTAIN AVE LAS VEGAS nv 89166                      | 12613514034          |
| CALLAS NICK & MARIA FAMILY TRUST | CALLAS NICK & MARIA TRS P O BOX 5732 FULLERTON CA 92838-0732    | 12613213061          |
| CAMBRIDGE HOA                    | 630 TRADE CENTER DR #100 LAS VEGAS NV 89119-3712                | 12613117079          |
| CAMBRIDGE HOMEOWNERS ASSN INC    | 630 TRADE CENTER DR #100 LAS VEGAS NV 89119-3712                | 12613115124          |
| CAMBRIDGE HOMEOWNERS ASSN INC    | 630 TRADE CENTER DR #100 LAS VEGAS NV 89119-3712                | 12613115127          |
| CAMBRIDGE HOMEOWNERS ASSN INC    | 630 TRADE CENTER DR #100 LAS VEGAS NV 89119-3712                | 12613115120          |
| CAMBRIDGE HOMEOWNERS ASSN INC    | 630 TRADE CENTER DR #100 LAS VEGAS NV 89119-3712                | 12613115118          |
| CAMBRIDGE HOMEOWNERS ASSN INC    | 630 TRADE CENTER DR #100 LAS VEGAS NV 89119-3712                | 12613117072          |
| CAMBRIDGE HOMEOWNERS ASSN INC    | 630 TRADE CENTER DR #100 LAS VEGAS NV 89119-3712                | 12613117069          |
| CAMBRIDGE HOMEOWNERS ASSN INC    | 630 TRADE CENTER DR #100 LAS VEGAS NV 89119-3712                | 12613117075          |
| CAMBRIDGE HOMEOWNERS ASSN INC    | 630 TRADE CENTER DR #100 LAS VEGAS NV 89119-3712                | 12613117067          |
| CAMBRIDGE HOMEOWNERS ASSN INC    | 630 TRADE CENTER DR #100 LAS VEGAS NV 89119-3712                | 12613115123          |
| CAMBRIDGE HOMEOWNERS ASSN INC    | 630 TRADE CENTER DR #100 LAS VEGAS NV 89119-3712                | 12613115121          |
| CAMBRIDGE HOMEOWNERS ASSN INC    | 630 TRADE CENTER DR #100 LAS VEGAS NV 89119-3712                | 12613115126          |
| CAMBRIDGE HOMEOWNERS ASSN INC    | 630 TRADE CENTER DR #100 LAS VEGAS NV 89119-3712                | 12613115125          |
| CAMBRIDGE HOMEOWNERS ASSN INC    | 630 TRADE CENTER DR #100 LAS VEGAS NV 89119-3712                | 12613117071          |

**Report of All Selected Parcels**

**Case Number:** VAR-58024 VAR-58025 VAR-58026 VAR-58027 VAR-58028 VAR-58029 VAR-58030 VAR-58031 VAR-58032  
VAR-58033 VAR-58034

**Printed On:** Wed: March 4, 2015

| <b>Owner</b>                     | <b>Address</b>  | <b>Parcel Number</b> |
|----------------------------------|---|----------------------|
| CAMBRIDGE HOMEOWNERS ASSN INC    | 630 TRADE CENTER DR #100 LAS VEGAS NV 89119-3712              | 12613117073          |
| CAMBRIDGE HOMEOWNERS ASSN INC    | 630 TRADE CENTER DR #100 LAS VEGAS NV 89119-3712              | 12613117070          |
| CAMBRIDGE HOMEOWNERS ASSN INC    | 630 TRADE CENTER DR #100 LAS VEGAS NV 89119-3712              | 12613117068          |
| CAMBRIDGE HOMEOWNERS ASSN INC    | 630 TRADE CENTER DR #100 LAS VEGAS NV 89119-3712              | 12613117074          |
| CAMBRIDGE HOMEOWNERS ASSN INC    | 630 TRADE CENTER DR #100 LAS VEGAS NV 89119-3712              | 12613115128          |
| CAMBRIDGE HOMEOWNERS ASSN INC    | 630 TRADE CENTER DR #100 LAS VEGAS NV 89119-3712              | 12613111011          |
| CAMMY INVESTMENTS INC            | 3525 DEL MAR HEIGHTS RD #758 SAN DIEGO CA 92130               | 12613213001          |
| CAMPBELL CYNTHIA MAE & MICHELLE  | 10637 DERBY PEAK LN LAS VEGAS NV 89166-5036                   | 12613116120          |
| CAMPBELL LORRI A                 | 7755 WEAVERCREST CT LAS VEGAS NV 89166-5121                   | 12613212164          |
| CANTRELL JEFFREY & KERRY WIRFEL  | 411 STATHAMS WAY WARNER ROBINS ga 31088                       | 12613513079          |
| CARMEL DRAWBRIDGE JUNCTION L L C | P O BOX 35878 LAS VEGAS NV 89133-5878                         | 12613117030          |
| CARROLL CLAYTON W & APRIL L      | 10452 TURTLE MOUNTAIN AVE LAS VEGAS NV 89166-5081             | 12613513110          |
| CARTER LARA G & CORY W           | 10620 TRAY MOUNTAIN AVE LAS VEGAS NV 89166-5078               | 12613215038          |
| CARTER NATACHIA J REVOCABLE TRUS | 7834 SHINGLE BEACH ST LAS VEGAS NV 89166-5088                 | 12613115111          |
| CASKIE ROBERT F IV & ROBERT F II | 10638 THOR MOUNTAIN LN LAS VEGAS NV 89166-5075                | 12613116137          |
| CASTILLO RONALD P                | 7936 TIGH BRACHEN CT LAS VEGAS NV 89166-5131                  | 12613117017          |
| CASYAO RIZALINA                  | 10441 TURTLE MOUNTAIN AVE LAS VEGAS NV 89166-5081             | 12613513036          |
| CEJA ALBERTO & ROCIO             | 7826 GRANITE CITY CT LAS VEGAS NV 89166-5090                  | 12613115043          |
| CERVANTEZ GAILE                  | 10621 MOUNT JEFFERSON AVE LAS VEGAS NV 89166-5054             | 12613213082          |
| CHAMBERLAIN DUSTIN M             | 10608 DERBY PEAK LN LAS VEGAS NV 89166                        | 12613116109          |
| CHAN GARY KALEK                  | 5 TIMBER TRAIL SUFFERN NY 10901                               | 12613116130          |
| CHAU MINH K                      | 813 MONTECITO DR SAN GABRIEL CA 91776                         | 12613115019          |
| CHAVEZ FAUSTO M                  | 7756 HOUSTON PEAK ST LAS VEGAS NV 89166                       | 12613212185          |
| CHEN WILLIAM & YVONNE            | 150 HURFFVILLE RD TURNERSVILLE NJ 08012                       | 12613117011          |
| CHISHOLM ALEX                    | 7763 HOUSTON PEAK ST LAS VEGAS NV 89166-5105                  | 12613212178          |
| CHULICK KELLY J                  | WINCHESTER TAMARA D 10605 CAPITOL PEAK AVE LAS VEGAS NV 89166 | 12613116105          |
| CHUNG RANDALL                    | HAMAMOTO VALERIE 210 GARDEN HILL DR LOS GATOS CA 95032        | 12613116132          |
| CHURCH LUTHERAN SHEPHERD HILLS   | 10667 KEARNEY MOUNTAIN AVE LAS VEGAS NV 89166-5043            | 12613215020          |
| CIRAULO DANIEL                   | 10759 IONA ISLAND AVE LAS VEGAS NV 89166                      | 12613115092          |
| CLARK TRAVIS A & KATELYN C       | 10641 MOUNT JEFFERSON AVE LAS VEGAS NV 89166-5055             | 12613213077          |
| CLIFFS EDGE L L C                | 7175 N DURANGO DR #280 LAS VEGAS NV 89149-4483                | 12613115131          |
| CLOUTIER MARC & AMANDA           | 7814 BRODIE CASTLE CT LAS VEGAS NV 89166-5091                 | 12613115052          |

**Report of All Selected Parcels**

**Case Number:** VAR-58024 VAR-58025 VAR-58026 VAR-58027 VAR-58028 VAR-58029 VAR-58030 VAR-58031 VAR-58032  
VAR-58033 VAR-58034

**Printed On:** Wed: March 4, 2015

| <b>Owner</b>                     | <b>Address</b>  | <b>Parcel Number</b> |
|----------------------------------|---|----------------------|
| COBURN MONICA L & ROBERT P       | 11244 GIBBS HILL AVE LAS VEGAS NV 89138-1527                      | 12613117006          |
| COLDIRON NICHOLAS                | 7768 CALEY CANYON ST LAS VEGAS NV 89166                           | 12613212156          |
| COLE JEFFREY B & KRISTINE ELLEN  | P O BOX 522 SPRINGER NM 87747                                     | 12613116116          |
| COMBS STEVEN D                   | 10602 AXIS MOUNTAIN CT LAS VEGAS NV 89166                         | 12613116063          |
| CONDO KRISTEL                    | 10751 BROXDEN JUNCTION AVE LAS VEGAS NV 89166-5101                | 12613117024          |
| CONNORS ANDREW J                 | 7767 HOUSTON PEAK ST LAS VEGAS NV 89166-5105                      | 12613212179          |
| CONRAD MICHAEL E & KAYLI B       | 10644 KEARNEY MOUNTAIN AVE LAS VEGAS NV 89166                     | 12613215060          |
| COPELAND COLLEEN C               | COPELAND JOSEPH H 10412 BAYS MOUNTAIN AVE LAS VEGAS NV 89166-5002 | 12613514033          |
| CORNELIS CHARLES A & KELLY J     | 10739 IONA ISLAND AVE LAS VEGAS NV 89166-5086                     | 12613115097          |
| CORNYN SHEILA & ROBERT           | 7772 CALEY CANYON ST LAS VEGAS NV 89166                           | 12613212155          |
| CORSARO MICHAEL & MEGHAN A       | 7747 LONE SHEPHERD DR LAS VEGAS NV 89166-5120                     | 12613212213          |
| COSTELLO MATTHEW J               | 10543 GALLEON PEAK LN LAS VEGAS NV 89166                          | 12613211016          |
| COTTINO TAMMY D                  | 10615 KEARNEY MOUNTAIN AVE LAS VEGAS NV 89166                     | 12613215007          |
| COWELL DAVID BRIAN & DEBRA       | 7730 ALBRIGHT PEAK DR LAS VEGAS NV 89166-5023                     | 12613215001          |
| COWICK ROBERT C                  | CANCHOLA GAYSINI 22941 COUNCIL BLUFFS AVE LAKE FOREST CA 92630    | 12613513108          |
| COZART MARGARET ANN & ROBERT W   | 10653 KENNEDY PEAK LN LAS VEGAS NV 89166-5045                     | 12613113103          |
| CRAWFORD HERBERT B & BLANCA M    | 10652 BANDERA MOUNTAIN LN LAS VEGAS NV 89166-5029                 | 12613113133          |
| CREER RICHARD T & STEPHANIE C    | 10625 KENNEDY PEAK LN LAS VEGAS NV 89166-5045                     | 12613113107          |
| CREWS JUSTEN                     | 1059 VIA DI RIENZO ST HENDERSON NV 89052                          | 12613212190          |
| CRUZ GILBERT DANIEL & BONITA L   | 10711 BAYVIEW HOUSE AVE LAS VEGAS NV 89166-5096                   | 12613117001          |
| CUEVAS RICHARD A                 | DESTEFANO DESIREE V 7778 LONE SHEPHERD DR LAS VEGAS NV 89166-5120 | 12613212204          |
| CULLEN TERESA                    | 7748 HOUSTON PEAK ST LAS VEGAS NV 89166                           | 12613212187          |
| CUNNINGHAM BRIAN J               | 10643 KEARNEY MOUNTAIN AVE LAS VEGAS NV 89166                     | 12613215014          |
| CURI ALBERTO JR                  | CIPRIAN-CURI ANI 10810 BAYVIEW HOUSE AVE LAS VEGAS NV 89166-5097  | 12613118023          |
| DADLANI VIKRAM J                 | 4517 E KELTON LN PHOENIX AZ 85032                                 | 12613116033          |
| DAHAN DEBRA J & EYAL             | 10709 DOBBS AVE LAS VEGAS NV 89166-5112                           | 12613212276          |
| DANNEHL DANIEL A & KATIE H       | 10645 MOUNT JEFFERSON AVE LAS VEGAS NV 89166-5055                 | 12613213076          |
| DAVIS DONALD H                   | FABIEN FRAN R 360 GRAND AVE #135 OAKLAND CA 94610                 | 12613215002          |
| DAVIS NORMAN L & SYLIVA J        | 10549 GALLEON PEAK LN LAS VEGAS NV 89166-5041                     | 12613211017          |
| DAVIS STEPHANIE SUE & SCOTT RULO | 7815 BRODIE CASTLE CT LAS VEGAS NV 89166                          | 12613115063          |
| DEARNLEY MELISSA A & LEE R       | 7737 DONNER PEAK ST LAS VEGAS NV 89166                            | 12613215024          |
| DEIST DUSTIN M                   | GOUIN HOLLY D 10437 MOUNT WASHINGTON AVE LAS VEGAS NV 89166-5057  | 12613513093          |

**Report of All Selected Parcels**

**Case Number:** VAR-58024 VAR-58025 VAR-58026 VAR-58027 VAR-58028 VAR-58029 VAR-58030 VAR-58031 VAR-58032  
VAR-58033 VAR-58034

**Printed On:** Wed: March 4, 2015

| <u>Owner</u>                     | <u>Address</u>   | <u>Parcel Number</u> |
|----------------------------------|--|----------------------|
| DELACRUZ CHARLENE L              | 7671 ALBRIGHT PEAK DR LAS VEGAS NV 89166-5023                              | 12613213086          |
| DELFIANDRA LIVING TRUST          | DELFIANDRA RAYMOND & D CO-TRS 82861 BURNETT DR INDIO CA 92201-9631         | 12613211008          |
| DELONEY DAVID III & LUCY         | 10509 GALLEON PEAK LN LAS VEGAS NV 89166-5040                              | 12613611008          |
| DEMAIO GEOFFREY G & JACQUELINE A | 10620 BANDERA MOUNTAIN LN LAS VEGAS NV 89166-5028                          | 12613113128          |
| DENNIS MARCUS A & KELLIE A       | 10601 AXIS MOUNTAIN CT LAS VEGAS NV 89166                                  | 12613116041          |
| DESANTOS JOSE R & MARGARITA L    | 10418 GROTTO MOUNTAIN AVE LAS VEGAS NV 89166-5008                          | 12613514011          |
| DESERT PALM PROPERTIES L L C     | 2445 W HORIZON RIDGE PKWY #100 HENDERSON NV 89052                          | 12613212211          |
| DESSIE ASEGID T                  | ASMARE ETUNESH M 13470 EAGEL NEST CT CORONA CA 92880                       | 12613117064          |
| DICKINSON KYLE M & BRITTANY L    | 7732 HOUSTON PEAK ST LAS VEGAS NV 89166                                    | 12613212191          |
| DIDONNA MARY & ANTHONY           | 10517 GALLEON PEAK LN LAS VEGAS NV 89166-5040                              | 12613211011          |
| DIERENFIELD DENNIS               | 14 CAMINO VERDE SANTA BARBARA CA 93103                                     | 12613113132          |
| DILLING KEITH A & RECHELLE A     | 10540 GALLEON PEAK LN LAS VEGAS NV 89166-5041                              | 12613211005          |
| DILORETO VINCENT J               | 7815 GRANITE CITY CT LAS VEGAS NV 89166                                    | 12613115051          |
| DITMEIER MICHAEL K & TAMI L      | 10651 KEARNEY MOUNTAIN AVE LAS VEGAS NV 89166                              | 12613215016          |
| DIXON BLAKE N                    | 7751 WEAVERCREST CT LAS VEGAS NV 89166-5121                                | 12613212163          |
| DIXON KASHIRO                    | 7760 CALEY CANYON ST LAS VEGAS NV 89166                                    | 12613212158          |
| DORIA FELIZARDO R JR & HAZEL R   | 7854 SHINGLE BEACH ST LAS VEGAS NV 89166-5089                              | 12613115116          |
| DOUGLAS MAXIMILLIANO             | AMARO-DOUGLAS ANGELINA R 10448 TURTLE MOUNTAIN AVE LAS VEGAS NV 89166-5081 | 12613513109          |
| DROEGMOELLER JEANETTE            | 10733 DOBBS AVE LAS VEGAS NV 89166-5112                                    | 12613212270          |
| DROST MICHAEL L                  | 10711 OLD IRONSIDES AVE LAS VEGAS NV 89166-5098                            | 12613117005          |
| DUCHARME PAUL MICHAEL & SAMANTHA | 10632 MOUNT JEFFERSON AVE LAS VEGAS NV 89166-5054                          | 12613213066          |
| DUNN RYAN & KERI                 | 10544 BANDERA MOUNTAIN LN LAS VEGAS NV 89166-5027                          | 12613113120          |
| DURAN DHEVIE & DIMPLE JADE AGREG | RATANA TY 7958 LOST RANGER PEAK ST LAS VEGAS NV 89166                      | 12613116064          |
| DUVAL AGRISELA J                 | 10807 BAYVIEW HOUSE AVE LAS VEGAS NV 89166                                 | 12613117060          |
| EASTMAN FRED & ARLENE            | 506 DOGWOOD LN CHAGRIN FALLS OH 44023-6736                                 | 12613514008          |
| EKLOF WALDEMAR E IV & VICTORIA E | 10657 KENNEDY PEAK LN LAS VEGAS NV 89166-5046                              | 12613113102          |
| ELDRIDGE DONNA S                 | 8460 WALKER GARDEN PL LAS VEGAS NV 89166                                   | 12613116131          |
| ELIZONDO JAMES & KRISTEN         | 10764 BEACH HOUSE AVE LAS VEGAS NV 89166-5094                              | 12613115004          |
| EMSIE AUNDREY                    | 7927 BARTLETT PEAK ST LAS VEGAS NV 89166                                   | 12613116027          |
| ENG RAYMOND                      | P O BOX 401372 LAS VEGAS NV 89140  | 12613116101          |
| ENSLEY WILL & JANET              | 7763 WEAVERCREST CT LAS VEGAS NV 89166-5121                                | 12613212166          |
| ENZI DWIGHT & JOANNE             | 21101 PENNINGTON LN TRABUCO CANYON CA 92679-3334                           | 12613215041          |

**Report of All Selected Parcels**

**Case Number:** VAR-58024 VAR-58025 VAR-58026 VAR-58027 VAR-58028 VAR-58029 VAR-58030 VAR-58031 VAR-58032 VAR-58033 VAR-58034

**Printed On:** Wed: March 4, 2015

| <u>Owner</u>                  | <u>Address</u>                                    | <u>Parcel Number</u> |
|-------------------------------|---|----------------------|
| ESCHENBACHER CHRISTIAN B      | 10655 KEARNEY MOUNTAIN AVE LAS VEGAS NV 89166     | 12613215017          |
| ESPINOZA ROBERT A & CHARLOTTE | 10411 GROTTO MOUNTAIN AVE LAS VEGAS NV 89166-5008 | 12613514028          |
| ESTANCIA DESERT L L C         | 2020 MAIN ST #1100 IRVINE CA 92614-8234           | 12613214048          |
| ESTANCIA DESERT L L C         | 2020 MAIN ST #1100 IRVINE CA 92614-8234           | 12613214046          |
| ESTANCIA DESERT L L C         | 2020 MAIN ST #1100 IRVINE CA 92614-8234           | 12613116143          |
| ESTANCIA DESERT L L C         | 2020 MAIN ST #1100 IRVINE CA 92614-8234           | 12613214035          |
| ESTANCIA DESERT L L C         | 2020 MAIN ST #1100 IRVINE CA 92614-8234           | 12613116071          |
| ESTANCIA DESERT L L C         | 2020 MAIN ST #1100 IRVINE CA 92614-8234           | 12613214044          |
| ESTANCIA DESERT L L C         | 2020 MAIN ST #1100 IRVINE CA 92614-8234           | 12613116091          |
| ESTANCIA DESERT L L C         | 2020 MAIN ST #1100 IRVINE CA 92614-8234           | 12613213083          |
| ESTANCIA DESERT L L C         | 2020 MAIN ST #1100 IRVINE CA 92614-8234           | 12613116097          |
| ESTANCIA DESERT L L C         | 2020 MAIN ST #1100 IRVINE CA 92614-8234           | 12613116146          |
| ESTANCIA DESERT L L C         | 2020 MAIN ST #1100 IRVINE CA 92614-8234           | 12613116004          |
| ESTANCIA DESERT L L C         | 2020 MAIN ST #1100 IRVINE CA 92614-8234           | 12613116090          |
| ESTANCIA DESERT L L C         | 2020 MAIN ST #1100 IRVINE CA 92614-8234           | 12613214001          |
| ESTANCIA DESERT L L C         | 2020 MAIN ST #1100 IRVINE CA 92614-8234           | 12613214037          |
| ESTANCIA DESERT L L C         | 2020 MAIN ST #1100 IRVINE CA 92614-8234           | 12613116089          |
| ESTANCIA DESERT L L C         | 2020 MAIN ST #1100 IRVINE CA 92614-8234           | 12613213084          |
| ESTANCIA DESERT L L C         | 2020 MAIN ST #1100 IRVINE CA 92614-8234           | 12613116078          |
| ESTANCIA DESERT L L C         | 2020 MAIN ST #1100 IRVINE CA 92614-8234           | 12613214007          |
| ESTANCIA DESERT L L C         | 2020 MAIN ST #1100 IRVINE CA 92614-8234           | 12613116151          |
| ESTANCIA DESERT L L C         | 2020 MAIN ST #1100 IRVINE CA 92614-8234           | 12613116148          |
| ESTANCIA DESERT L L C         | 2020 MAIN ST #1100 IRVINE CA 92614-8234           | 12613213070          |
| ESTANCIA DESERT L L C         | 2020 MAIN ST #1100 IRVINE CA 92614-8234           | 12613214034          |
| ESTANCIA DESERT L L C         | 2020 MAIN ST #1100 IRVINE CA 92614-8234           | 12613214004          |
| ESTANCIA DESERT L L C         | 2020 MAIN ST #1100 IRVINE CA 92614-8234           | 12613213071          |
| ESTANCIA DESERT L L C         | 2020 MAIN ST #1100 IRVINE CA 92614-8234           | 12613214029          |
| ESTANCIA DESERT L L C         | 2020 MAIN ST #1100 IRVINE CA 92614-8234           | 12613214031          |
| ESTANCIA DESERT L L C         | 2020 MAIN ST #1100 IRVINE CA 92614-8234           | 12613214041          |
| ESTANCIA DESERT L L C         | 2020 MAIN ST #1100 IRVINE CA 92614-8234           | 12613214047          |
| ESTANCIA DESERT L L C         | 2020 MAIN ST #1100 IRVINE CA 92614-8234           | 12613214039          |
| ESTANCIA DESERT L L C         | 2020 MAIN ST #1100 IRVINE CA 92614-8234           | 12613214028          |

**Report of All Selected Parcels**

**Case Number:** VAR-58024 VAR-58025 VAR-58026 VAR-58027 VAR-58028 VAR-58029 VAR-58030 VAR-58031 VAR-58032 VAR-58033 VAR-58034

**Printed On:** Wed: March 4, 2015

| <u>Owner</u>          | <u>Address</u>                          | <u>Parcel Numbe</u> |
|-----------------------|---|---------------------|
| ESTANCIA DESERT L L C | 2020 MAIN ST #1100 IRVINE CA 92614-8234 | 12613116088         |
| ESTANCIA DESERT L L C | 2020 MAIN ST #1100 IRVINE CA 92614-8234 | 12613116096         |
| ESTANCIA DESERT L L C | 2020 MAIN ST #1100 IRVINE CA 92614-8234 | 12613214012         |
| ESTANCIA DESERT L L C | 2020 MAIN ST #1100 IRVINE CA 92614-8234 | 12613214023         |
| ESTANCIA DESERT L L C | 2020 MAIN ST #1100 IRVINE CA 92614-8234 | 12613214043         |
| ESTANCIA DESERT L L C | 2020 MAIN ST #1100 IRVINE CA 92614-8234 | 12613214042         |
| ESTANCIA DESERT L L C | 2020 MAIN ST #1100 IRVINE CA 92614-8234 | 12613116075         |
| ESTANCIA DESERT L L C | 2020 MAIN ST #1100 IRVINE CA 92614-8234 | 12613214036         |
| ESTANCIA DESERT L L C | 2020 MAIN ST #1100 IRVINE CA 92614-8234 | 12613214045         |
| ESTANCIA DESERT L L C | 2020 MAIN ST #1100 IRVINE CA 92614-8234 | 12613116085         |
| ESTANCIA DESERT L L C | 2020 MAIN ST #1100 IRVINE CA 92614-8234 | 12613214022         |
| ESTANCIA DESERT L L C | 2020 MAIN ST #1100 IRVINE CA 92614-8234 | 12613116139         |
| ESTANCIA DESERT L L C | 2020 MAIN ST #1100 IRVINE CA 92614-8234 | 12613214018         |
| ESTANCIA DESERT L L C | 2020 MAIN ST #1100 IRVINE CA 92614      | 12613116002         |
| ESTANCIA DESERT L L C | 2020 MAIN ST #1100 IRVINE CA 92614-8234 | 12613116094         |
| ESTANCIA DESERT L L C | 2020 MAIN ST #1100 IRVINE CA 92614-8234 | 12613116092         |
| ESTANCIA DESERT L L C | 2020 MAIN ST #1100 IRVINE CA 92614-8234 | 12613214011         |
| ESTANCIA DESERT L L C | 2020 MAIN ST #1100 IRVINE CA 92614-8234 | 12613214038         |
| ESTANCIA DESERT L L C | 2020 MAIN ST #1100 IRVINE CA 92614-8234 | 12613116079         |
| ESTANCIA DESERT L L C | 2020 MAIN ST #1100 IRVINE CA 92614-8234 | 12613214020         |
| ESTANCIA DESERT L L C | 2020 MAIN ST #1100 IRVINE CA 92614-8234 | 12613116074         |
| ESTANCIA DESERT L L C | 2020 MAIN ST #1100 IRVINE CA 92614-8234 | 12613116140         |
| ESTANCIA DESERT L L C | 2020 MAIN ST #1100 IRVINE CA 92614-8234 | 12613214008         |
| ESTANCIA DESERT L L C | 2020 MAIN ST #1100 IRVINE CA 92614-8234 | 12613214015         |
| ESTANCIA DESERT L L C | 2020 MAIN ST #1100 IRVINE CA 92614-8234 | 12613116149         |
| ESTANCIA DESERT L L C | 2020 MAIN ST #1100 IRVINE CA 92614-8234 | 12613116008         |
| ESTANCIA DESERT L L C | 2020 MAIN ST #1100 IRVINE CA 92614-8234 | 12613116009         |
| ESTANCIA DESERT L L C | 2020 MAIN ST #1100 IRVINE CA 92614-8234 | 12613116006         |
| ESTANCIA DESERT L L C | 2020 MAIN ST #1100 IRVINE CA 92614-8234 | 12613214006         |
| ESTANCIA DESERT L L C | 2020 MAIN ST #1100 IRVINE CA 92614-8234 | 12613116007         |
| ESTANCIA DESERT L L C | 2020 MAIN ST #1100 IRVINE CA 92614-8234 | 12613116147         |
| ESTANCIA DESERT L L C | 2020 MAIN ST #1100 IRVINE CA 92614-8234 | 12613214024         |

**Report of All Selected Parcels**

**Case Number:** VAR-58024 VAR-58025 VAR-58026 VAR-58027 VAR-58028 VAR-58029 VAR-58030 VAR-58031 VAR-58032 VAR-58033 VAR-58034

**Printed On:** Wed: March 4, 2015

| <u>Owner</u>          | <u>Address</u>                          | <u>Parcel Number</u> |
|-----------------------|---|----------------------|
| ESTANCIA DESERT L L C | 2020 MAIN ST #1100 IRVINE CA 92614-8234 | 12613214002          |
| ESTANCIA DESERT L L C | 2020 MAIN ST #1100 IRVINE CA 92614-8234 | 12613116152          |
| ESTANCIA DESERT L L C | 2020 MAIN ST #1100 IRVINE CA 92614-8234 | 12613116144          |
| ESTANCIA DESERT L L C | 2020 MAIN ST #1100 IRVINE CA 92614-8234 | 12613214016          |
| ESTANCIA DESERT L L C | 2020 MAIN ST #1100 IRVINE CA 92614-8234 | 12613214019          |
| ESTANCIA DESERT L L C | 2020 MAIN ST #1100 IRVINE CA 92614-8234 | 12613116073          |
| ESTANCIA DESERT L L C | 2020 MAIN ST #1100 IRVINE CA 92614-8234 | 12613116098          |
| ESTANCIA DESERT L L C | 2020 MAIN ST #1100 IRVINE CA 92614-8234 | 12613116082          |
| ESTANCIA DESERT L L C | 2020 MAIN ST #1100 IRVINE CA 92614-8234 | 12613214005          |
| ESTANCIA DESERT L L C | 2020 MAIN ST #1100 IRVINE CA 92614-8234 | 12613214032          |
| ESTANCIA DESERT L L C | 2020 MAIN ST #1100 IRVINE CA 92614-8234 | 12613116083          |
| ESTANCIA DESERT L L C | 2020 MAIN ST #1100 IRVINE CA 92614-8234 | 12613214010          |
| ESTANCIA DESERT L L C | 2020 MAIN ST #1100 IRVINE CA 92614-8234 | 12613116076          |
| ESTANCIA DESERT L L C | 2020 MAIN ST #1100 IRVINE CA 92614-8234 | 12613116095          |
| ESTANCIA DESERT L L C | 2020 MAIN ST #1100 IRVINE CA 92614-8234 | 12613116142          |
| ESTANCIA DESERT L L C | 2020 MAIN ST #1100 IRVINE CA 92614-8234 | 12613116141          |
| ESTANCIA DESERT L L C | 2020 MAIN ST #1100 IRVINE CA 92614-8234 | 12613116065          |
| ESTANCIA DESERT L L C | 2020 MAIN ST #1100 IRVINE CA 92614-8234 | 12613214003          |
| ESTANCIA DESERT L L C | 2020 MAIN ST #1100 IRVINE CA 92614-8234 | 12613214026          |
| ESTANCIA DESERT L L C | 2020 MAIN ST #1100 IRVINE CA 92614-8234 | 12613116080          |
| ESTANCIA DESERT L L C | 2020 MAIN ST #1100 IRVINE CA 92614-8234 | 12613116003          |
| ESTANCIA DESERT L L C | 2020 MAIN ST #1100 IRVINE CA 92614-8234 | 12613116087          |
| ESTANCIA DESERT L L C | 2020 MAIN ST #1100 IRVINE CA 92614-8234 | 12613116005          |
| ESTANCIA DESERT L L C | 2020 MAIN ST #1100 IRVINE CA 92614-8234 | 12613116093          |
| ESTANCIA DESERT L L C | 2020 MAIN ST #1100 IRVINE CA 92614-8234 | 12613116066          |
| ESTANCIA DESERT L L C | 2020 MAIN ST #1100 IRVINE CA 92614-8234 | 12613214009          |
| ESTANCIA DESERT L L C | 2020 MAIN ST #1100 IRVINE CA 92614-8234 | 12613214021          |
| ESTANCIA DESERT L L C | 2020 MAIN ST #1100 IRVINE CA 92614-8234 | 12613116001          |
| ESTANCIA DESERT L L C | 2020 MAIN ST #1100 IRVINE CA 92614-8234 | 12613214030          |
| ESTANCIA DESERT L L C | 2020 MAIN ST #1100 IRVINE CA 92614-8234 | 12613214040          |
| ESTANCIA DESERT L L C | 2020 MAIN ST #1100 IRVINE CA 92614-8234 | 12613116084          |
| ESTANCIA DESERT L L C | 2020 MAIN ST #1100 IRVINE CA 92614-8234 | 12613116150          |

**Report of All Selected Parcels**

**Case Number:** VAR-58024 VAR-58025 VAR-58026 VAR-58027 VAR-58028 VAR-58029 VAR-58030 VAR-58031 VAR-58032 VAR-58033 VAR-58034

**Printed On:** Wed: March 4, 2015

| <u>Owner</u>                   | <u>Address</u>  | <u>Parcel Number</u> |
|--------------------------------|---|----------------------|
| ESTANCIA DESERT L L C          | 2020 MAIN ST #1100 IRVINE CA 92614-8234                           | 12613213069          |
| ESTANCIA DESERT L L C          | 2020 MAIN ST #1100 IRVINE CA 92614-8234                           | 12613116145          |
| ESTANCIA DESERT L L C          | 2020 MAIN ST #1100 IRVINE CA 92614-8234                           | 12613116068          |
| ESTANCIA DESERT L L C          | 2020 MAIN ST #1100 IRVINE CA 92614-8234                           | 12613116081          |
| ESTANCIA DESERT L L C          | 2020 MAIN ST #1100 IRVINE CA 92614-8234                           | 12613116099          |
| ESTANCIA DESERT L L C          | 2020 MAIN ST #1100 IRVINE CA 92614-8234                           | 12613214014          |
| ESTANCIA DESERT L L C          | 2020 MAIN ST #1100 IRVINE CA 92614-8234                           | 12613214017          |
| ESTANCIA DESERT L L C          | 2020 MAIN ST #1100 IRVINE CA 92614-8234                           | 12613116086          |
| ESTANCIA DESERT L L C          | 2020 MAIN ST #1100 IRVINE CA 92614-8234                           | 12613214025          |
| ESTANCIA DESERT L L C          | 2020 MAIN ST #1100 IRVINE CA 92614-8234                           | 12613214013          |
| ESTANCIA DESERT L L C          | 2020 MAIN ST #1100 IRVINE CA 92614-8234                           | 12613214027          |
| ESTANCIA DESERT L L C          | 2020 MAIN ST #1100 IRVINE CA 92614-8234                           | 12613116077          |
| ESTANCIA DESERT L L C          | 2020 MAIN ST #1100 IRVINE CA 92614-8234                           | 12613116154          |
| ESTANCIA DESERT L L C          | 2020 MAIN ST #1100 IRVINE CA 92614-8234                           | 12613214033          |
| ESTANCIA DESERT L L C          | 2020 MAIN ST #1100 IRVINE CA 92614-8234                           | 12613116153          |
| EVERETT SEAN D & ALISHA D      | 7759 WEAVERCREST CT LAS VEGAS NV 89166-5121                       | 12613212165          |
| FADEM MICHELLE                 | 10738 BAYVIEW HOUSE AVE LAS VEGAS NV 89166                        | 12613117052          |
| FAIRCLOTH JOHN C               | 7946 LOST RANGER PEAK ST LAS VEGAS NV 89166                       | 12613116067          |
| FARRER LES                     | 10419 GROTTO MOUNTAIN LAS VEGAS NV 89166-5008                     | 12613514024          |
| FAY JOHN D                     | 10438 GROTTO MOUNTAIN AVE LAS VEGAS NV 89166                      | 12613514006          |
| FERGUSON MICHAEL & DANA        | 7830 BRODIE CASTLE CT LAS VEGAS NV 89166-5091                     | 12613115056          |
| FERNANDEZ JULIO & TRACY        | 7720 GATSBY HOUSE ST LAS VEGAS NV 89166-5117                      | 12613212202          |
| FIANDACA JUNE                  | FIANDACA RONALD 7822 GRANITE CITY CT LAS VEGAS NV 89166           | 12613115042          |
| FIELDER VICTORIA               | BAGLEY WILLIAM & JUDY 7767 WEAVERCREST ST LAS VEGAS NV 89166-5121 | 12613212167          |
| FIGIEL VIOLETA D               | 10651 BANDERA MOUNTAIN LN LAS VEGAS NV 89148                      | 12613113049          |
| FLOREK MARK J & DEBBIE L       | 5455 S NICOLE CT NEW BERLIN WI 53151-8195                         | 12613514023          |
| FOREHAND HAROLD L FAMILY TRUST | 3516 E 3138 N KIMBERLY ID 83341-5361                              | 12613114013          |
| FOX DANNY & TONI               | 1838 S CONCHO DR SAN ANGELO TX 76904                              | 12613116044          |
| FRANCESE ANITA M               | 10414 GRATTO MOUNTAIN AVE LAS VEGAS NV 89166-5008                 | 12613514012          |
| FRANCOM ROCKY L                | 7815 SHINGLE BEACH ST LAS VEGAS NV 89166-5088                     | 12613115039          |
| FRANK DEITRE D                 | 10660 MOUNT JEFFERSON AVE LAS VEGAS NV 89166-5055                 | 12613213059          |
| FRANTEL JAMES H                | 7830 GRANITE CITY CT LAS VEGAS NV 89166-5090                      | 12613115044          |

**Report of All Selected Parcels**

**Case Number:** VAR-58024 VAR-58025 VAR-58026 VAR-58027 VAR-58028 VAR-58029 VAR-58030 VAR-58031 VAR-58032  
VAR-58033 VAR-58034

**Printed On:** Wed: March 4, 2015

| <b>Owner</b>                    | <b>Address</b>  | <b>Parcel Number</b> |
|---------------------------------|---|----------------------|
| FRAZIER MICHAEL                 | FRAZIER LAVERN L & SALLY A 10626 THOR MOUNTAIN LN LAS VEGAS NV 89166-5075   | 12613116135          |
| FRITZ FAMILY TRUST              | FRITZ GARY R & JODI L TRS 10434 GROTTO MOUNTAIN AVE LAS VEGAS NV 89166-5008 | 12613514007          |
| GALAVIZ VERONICA & DANNY        | 10420 BAYS MOUNTAIN AVE LAS VEGAS NV 89166-5002                             | 12613514035          |
| GALLARDO JORGE & BRIANNA        | 10730 BROXDEN JUNCTION AVE LAS VEGAS NV 89166                               | 12613117015          |
| GARCIA RAMON PANIAGUA           | 7831 GRANITE CITY CT LAS VEGAS NV 89166-5090                                | 12613115047          |
| GEISPERGER HAROLD H & DENISE    | 92-38 246 STREET BELLEROSE TERRACE NY 11001                                 | 12613116069          |
| GEORGE SCOTT L                  | 3305 KENSINGTON DR WINNEMUCCA NV 89445                                      | 12613117041          |
| GEORGIADIS FILIPPOS & MARIA     | 10629 DERBY PEAK LN LAS VEGAS NV 89166-5036                                 | 12613116121          |
| GIAMONA TARA                    | CAMPBELL DARIN 129 POPPY AVE #A MONROVIA CA 91016                           | 12613115050          |
| GIANCOLA RICK J & LAURIE A      | 10525 GALLEON PEAK LN LAS VEGAS NV 89166-5040                               | 12613211012          |
| GIBSON BOBBIE JO                | 10560 BANDERA MOUNTAIN LN LAS VEGAS NV 89166-5028                           | 12613113124          |
| GILLINS CHARLES D & CHERYL      | 7935 TIGH BRACHEN CT LAS VEGAS NV 89166-5131                                | 12613117020          |
| GILMARTIN SEAN M                | 10737 BAYVIEW HOUSE AVE LAS VEGAS NV 89166                                  | 12613111002          |
| GIMMESTAD JACOB P               | BATES DANA L 10620 CAPITOL PEAK AVE LAS VEGAS NV 89166                      | 12613116035          |
| GINN JESSE                      | 10722 BROXDEN JUNCTION AVE LAS VEGAS NV 89166-5100                          | 12613117013          |
| GLASS KELLY S                   | ATWELL JENNIFER A 7728 HOUSTON PEAK ST LAS VEGAS NV 89166                   | 12613212192          |
| GLOVER CHET AARON & KORRYN D    | 10609 KENNEDY PEAK LN LAS VEGAS NV 89166-5044                               | 12613113110          |
| GOERLICH LOUISE B               | 108 BARBARA AVE RIDGECREST CA 93555   | 12613115001          |
| GOLDSTEIN JAYSON & MEGAN        | 10659 KEARNEY MOUNTAIN AVE LAS VEGAS NV 89166                               | 12613215018          |
| GONZALES JASON & ANDREA M       | 10733 BEACH HOUSE AVE LAS VEGAS NV 89166-5093                               | 12613115031          |
| GONZALEZ ANA                    | 10418 MOUNT WASHINGTON AVE LAS VEGAS NV 89166-5056                          | 12613513075          |
| GONZALEZ SETH J                 | 7903 BARTLETT PEAK ST LAS VEGAS NV 89166                                    | 12613116021          |
| GOODWIN CHRISTOPHER R & TANYA N | 10449 MOUNT WASHINGTON AVE LAS VEGAS NV 89166-5057                          | 12613513090          |
| GORDON DARLA C                  | 10613 KENNEDY PEAK LN LAS VEGAS NV 89166-5045                               | 12613113109          |
| GRAB JOHN III                   | 7748 CALEY CANYON ST LAS VEGAS NV 89166                                     | 12613212161          |
| GRACE HUGH JAMES & ANITA JANE   | 10521 BANDERA MOUNTAIN LN LAS VEGAS NV 89166-5027                           | 12613113029          |
| GRACE JEREMIAH & BRISA          | 10613 DERBY PEAK LN LAS VEGAS NV 89166                                      | 12613116125          |
| GRAHAM DOUGLAS E                | 10729 OLD IRONSIDES AVE LAS VEGAS NV 89166                                  | 12613117047          |
| GRANT ARAXIE ROSE               | 10417 WHITE PRINCESS AVE LAS VEGAS NV 89166                                 | 12613513045          |
| GRANT GEORGE L                  | 7932 BARTLETT PEAK ST LAS VEGAS NV 89166                                    | 12613116118          |
| GRANTHAM KRISTOPHER L           | 7733 DONNER PEAK ST LAS VEGAS NV 89166                                      | 12613215023          |
| GREEN BRIAN                     | 7834 TAY RIVER CT LAS VEGAS NV 89166-5092                                   | 12613115069          |

**Report of All Selected Parcels**

**Case Number:** VAR-58024 VAR-58025 VAR-58026 VAR-58027 VAR-58028 VAR-58029 VAR-58030 VAR-58031 VAR-58032  
VAR-58033 VAR-58034

**Printed On:** Wed: March 4, 2015

| <u>Owner</u>                     | <u>Address</u>   | <u>Parcel Number</u> |
|----------------------------------|--|----------------------|
| GREENWALD LAWRENCE S & BARBARA M | 2540 BRIAN DR NORTHBROOK IL 60062  | 12613514013          |
| GRIEVE DAVID & JESSICA           | 10606 MOUNT JEFFERSON AVE LAS VEGAS NV 89166                               | 12613213072          |
| GRIFFITHS NANCY                  | 7846 SHINGLE BEACH ST LAS VEGAS NV 89166-5089                              | 12613115114          |
| GROSE LARRY                      | 721 EL ENCINO WAY SACRAMENTO CA 95864                                      | 12613111004          |
| GROVE SAMIRA                     | 10616 TRAY MOUNTAIN AVE LAS VEGAS NV 89166-5078                            | 12613215039          |
| GUARINO GEORGIA W & MICHAEL J    | 7843 TORREYS PEAK ST LAS VEGAS NV 89166-5076                               | 12613114010          |
| GUERINO JAMES A & LISA           | 10618 THOR MOUNTAIN LN LAS VEGAS NV 89166-5075                             | 12613116133          |
| GUINTU ERROL T                   | 8419 CORBIN AVE WINNETKA CA 91306  | 12613116127          |
| GUSTAFSON MARK                   | 8905 RENDON ST LAS VEGAS NV 89143-5445                                     | 12613115034          |
| GUY CHAD                         | 10749 BEACH HOUSE AVE LAS VEGAS NV 89166                                   | 12613115027          |
| HALLETT JOSHUA J & JORDAN A      | 7720 HOUSTON PEAK ST LAS VEGAS NV 89166                                    | 12613212194          |
| HARRELL WILLIAM L & AMANDA L     | 10637 MOUNT JEFFERSON AVE LAS VEGAS NV 89166-5054                          | 12613213078          |
| HARRIS FAMILY TRUST              | 6130 W FLAMINGO RD #155 LAS VEGAS NV 89103-2280                            | 12613513022          |
| HART JEFFERY M                   | 7915 BARTLETT PEAK ST LAS VEGAS NV 89166                                   | 12613116024          |
| HEATER CEDRIC L & DIONE P        | 10713 DOBBS AVE LAS VEGAS NV 89166-5112                                    | 12613212275          |
| HEPLER FAMILY TRUST              | HEPLER JULIAN D & DEBRA J TRS 7907 TORREYS PEAK ST LAS VEGAS NV 89166-5076 | 12613114016          |
| HERMAN SANTA D                   | 65 CASSANDRA BLVD #103 WEST HARTFORD CT 06107-3149                         | 12613513100          |
| HERNDON BRANDON & JODI           | 2418 PEBBLE CREEK CT HERMITAGE PA 16148                                    | 12613113038          |
| HERRERA ALVARO ENRIQUE           | PAREDES-ORTIZ ELSA A 10659 THOR MOUNTAIN LN LAS VEGAS NV 89166-5075        | 12613116019          |
| HILL OLGA A LIVING TRUST         | HILL OLGA A TRS 10421 BAYS MOUNTAIN AVE LAS VEGAS NV 89166-5002            | 12613615031          |
| HIROTA JAMES                     | 10746 OLD IRONSIDES AVE LAS VEGAS NV 89166-5099                            | 12613117036          |
| HOFFMANN RICHARD                 | 7741 DONNER PEAK ST LAS VEGAS NV 89178                                     | 12613215025          |
| HOLDEFEHR DANIEL J               | 22 COLONIAL DR ALLENDALE NJ 07401-1415                                     | 12613212267          |
| HOOVER PATRICIA A                | 10640 BANDERA MOUNTAIN LN LAS VEGAS NV 89166-5029                          | 12613113131          |
| HORA DONALD J & ELENA            | 10726 BROXDEN JUNCITON AVE LAS VEGAS NV 89166-5100                         | 12613117014          |
| HORVATH JEREMY E                 | NAUGLE KRISTY M 7947 TORREYS PEAK ST LAS VEGAS NV 89166                    | 12613114005          |
| HUANG YUCHIH                     | CHANG CLEO 151 BRIDGE ST SAN GABRIEL CA 91775                              | 12613116112          |
| HUBBARD LYNETTE & ROD            | 10629 THOR MOUNTAIN LN LAS VEGAS NV 89166-5075                             | 12613116014          |
| HUDSON DUSTIN R & JANNA S        | 10635 KEARNEY MOUNTAIN AVE LAS VEGAS NV 89166                              | 12613215012          |
| HUDSON OSCAR & KATE              | 7911 BARTLETT PEAK ST LAS VEGAS NV 89166                                   | 12613116023          |
| HURLEY MATTHEW                   | 7744 HOUSTON PEAK ST LAS VEGAS NV 89166                                    | 12613212188          |
| HUTH CHRISTOPHER C & KRISTIN A   | 10648 CAPITOL PEAK AVE LAS VEGAS NV 89166                                  | 12613116032          |

**Report of All Selected Parcels**

**Case Number:** VAR-58024 VAR-58025 VAR-58026 VAR-58027 VAR-58028 VAR-58029 VAR-58030 VAR-58031 VAR-58032 VAR-58033 VAR-58034

**Printed On:** Wed: March 4, 2015

| <b>Owner</b>                    | <b>Address</b>  | <b>Parcel Number</b> |
|---------------------------------|---|----------------------|
| HYAMS ALYSSA F                  | GARAMENDI TYSON N 10623 KEARNEY MOUNTAIN AVE LAS VEGAS NV 89166   | 12613215009          |
| HYBARGER CHRISTOPHER C JR       | 10612 DERBY PEAK LN LAS VEGAS NV 89166-5036                       | 12613116110          |
| I H 2 PROPERTY NEVADA L P       | 21001 N TATUM BLVD #1630-630 PHOENIX AZ 85050                     | 12613117063          |
| ISOM KRISTOPHER A & KRISTENA M  | 7702 ALBRIGHT PEAK DR LAS VEGAS NV 89166-5023                     | 12613213003          |
| JACKSON CLIFTON R JR & KIMBERLY | 7842 AIROLA PEAK ST LAS VEGAS NV 89166                            | 12613513028          |
| JACKSON MORGAN A & CODY         | 7839 VERDUGO PEAK ST LAS VEGAS NV 89166-5083                      | 12613113060          |
| JANOTA PATRICK J & MARY N       | 10763 IONA ISLAND AVE LAS VEGAS NV 89166-5086                     | 12613115091          |
| JEANPIERRE JUSTIN & JULIANA     | 10625 MOUNT JEFFERSON AVE LAS VEGAS NV 89166-5054                 | 12613213081          |
| JOHNSON KYLE B & NICOLE         | 7858 SHINGLE BEACH ST LAS VEGAS NV 89166-5089                     | 12613115117          |
| JOHNSON SONIA M & RONALD J      | 10427 PRAIRIE MOUNTAIN AVE LAS VEGAS NV 89166                     | 12613513080          |
| JOHNSTON PETER C                | 7850 AIROLA PEAK ST LAS VEGAS NV 89166-5021                       | 12613513026          |
| JOLLY BRYAN A & VALERIE N       | 10430 MOUNT WASHINGTON AVE LAS VEGAS NV 89166-5056                | 12613513072          |
| JONES BARRY R & JOCELYN R       | 10663 KEARNEY MOUNTAIN AVE LAS VEGAS NV 89166-5043                | 12613215019          |
| JONES CHARLES D & KATRINA F     | 10733 OLD IRONSIDES AVE LAS VEGAS NV 89166-5098                   | 12613117046          |
| JOSEPH STACY                    | 10516 GALLEON PEAK LN LAS VEGAS NV 89166-5040                     | 12613611001          |
| JOVEL-AMAYA JOSE L              | 10737 DOBBS AVE LAS VEGAS NV 89166-5112                           | 12613212269          |
| JUSAY CESAR & TEODORA           | 11401 ANEGADA ST CYPRESS CA 90630-5331                            | 12613215032          |
| K B HOME NEVADA INC             | 5655 BADURA AVE LAS VEGAS NV 89118-4713                           | 12613115129          |
| KANDT JEREMY A                  | ADAMS AMBER 10608 CAPITOL PEAK AVE LAS VEGAS NV 89166             | 12613116038          |
| KANIRIE MATTHEW A & JESSICA D   | 10708 BAYVIEW HOUSE AVE LAS VEGAS NV 89166-5096                   | 12613117003          |
| KANOUNIAN MARLENE               | IZANIAN BEDROS A & FILOR S 4596 TIMARU DR LAS VEGAS NV 89147      | 12613212195          |
| KARY LISA M                     | 10442 MOUNT WASHINGTON AVE LAS VEGAS NV 89166-5057                | 12613513069          |
| KEE AUNDREA                     | 10454 MOUNT WASHINGTON AVE LAS VEGAS NV 89166-5057                | 12613513066          |
| KEENER MATTHEW S                | 10727 IONA ISLAND AVE LAS VEGAS NV 89166-5086                     | 12613115100          |
| KELLOGG STEVEN                  | 10632 TRAY MOUNTAIN AVE LAS VEGAS NV 89166-5078                   | 12613215035          |
| KELLY TAMMY L & STEVEN K        | 5410 66TH AVE NW OLYMPIA WA 98502-9664                            | 12613215030          |
| KENDALL SANDRA LOU              | DOPLER KIMBERLY ANN 7838 SHINGLE BEACH ST LAS VEGAS NV 89166-5089 | 12613115112          |
| KENNEDY MARTHA                  | 10604 CAPITOL PEAK AVE LAS VEGAS NV 89166                         | 12613116039          |
| KESTER MATTHEW                  | 7831 BRODIE CASTLE CT LAS VEGAS NV 89166-5091                     | 12613115059          |
| KIEFER HEATHER                  | 10536 GALLEON PEAK LN LAS VEGAS NV 89166                          | 12613211006          |
| KING CLIFTON MARK & NICHOLE R   | 10611 KEARNEY MOUNTAIN AVE LAS VEGAS NV 89166                     | 12613215006          |
| KING MICHAEL T & LYN A          | 5717 BROOK HOLLOW DR BROOMFIELD CO 80020                          | 12613113039          |

**Report of All Selected Parcels**

**Case Number:** VAR-58024 VAR-58025 VAR-58026 VAR-58027 VAR-58028 VAR-58029 VAR-58030 VAR-58031 VAR-58032  
VAR-58033 VAR-58034

**Printed On:** Wed: March 4, 2015

| <u>Owner</u>                  | <u>Address</u>  | <u>Parcel Number</u> |
|-------------------------------|---|----------------------|
| KINNAMON CHANCE A & MARY      | 7764 HOUSTON PEAK ST LAS VEGAS NV 89166-5105                                    | 12613212183          |
| KINOSHITA NOBUHIRO            | GUYER HARUKO 7751 LONE SHEPHERD DR LAS VEGAS NV 89166-5120                      | 12613212212          |
| KIRKLAND MARY                 | 10821 BEACHHOUSE AVE LAS VEGAS NV 89166-5095                                    | 12613115016          |
| KLEENDA DARYL S & JENNIFER A  | 10413 MOUNT WASHINGTON AVE LAS VEGAS NV 89166                                   | 12613513099          |
| KLINKNER MICHAEL E & PAMELA G | 158 OAKRIDGE DR DAYTON NV 89403   | 12613117051          |
| KNAPP CORDAYO & SYDNEY        | 10606 AXIS MOUNTAIN CT LAS VEGAS NV 89166                                       | 12613116062          |
| KNUDSEN PREBEN                | FLORA DIANE 10625 THOR MOUNTAIN LN LAS VEGAS NV 89166-5075                      | 12613116013          |
| KOONCE CHARLES A & THU        | 10529 BANDERA MOUNTAIN LN LAS VEGAS NV 89166-5027                               | 12613113031          |
| KOPECKY CARMINE B JR          | KOPECKY CARMINE & TERESA A 10818 BEACH HOUSE AVE LAS VEGAS NV 89166-5095        | 12613115008          |
| KOPER STEVEN R & LEAH         | 7759 HOUSTON PEAK ST LAS VEGAS NV 89166-5105                                    | 12613212177          |
| KUOCH REVOCABLE FAMILY TRUST  | KUOCH PETER L C & SUTTHY EAP TRS 4055 HOOSIER LAWN LAWN WY YORBA LINDA CA 92886 | 12613215026          |
| L M B PROPERTIES L L C        | 1668 GROVE ST SAN FRANCISCO CA 94117-1323                                       | 12613117029          |
| L M CLIFF'S EDGE L L C        | 2020 MAIN ST #1100 IRVINE CA 92614-8234   | 12613513114          |
| L M CLIFF'S EDGE L L C        | 2020 MAIN ST #1100 IRVINE CA 92614-8234   | 12613514042          |
| L M CLIFF'S EDGE L L C        | 2020 MAIN ST #1100 IRVINE CA 92614-8234   | 12613213168          |
| L M CLIFF'S EDGE L L C        | 2020 MAIN ST #1100 IRVINE CA 92614-8234   | 12613211020          |
| L M CLIFF'S EDGE L L C        | 2020 MAIN ST #1100 IRVINE CA 92614-8234   | 12613113149          |
| L M CLIFF'S EDGE L L C        | 2020 MAIN ST #1100 IRVINE CA 92614-8234   | 12613116169          |
| L M CLIFF'S EDGE L L C        | 2020 MAIN ST #1100 IRVINE CA 92614-8234   | 12613513125          |
| L M CLIFF'S EDGE L L C        | 2020 MAIN ST #1100 IRVINE CA 92614-8234   | 12613611012          |
| L M CLIFF'S EDGE L L C        | 2020 MAIN ST #1100 IRVINE CA 92614-8234   | 12613113141          |
| L M CLIFF'S EDGE L L C        | 2020 MAIN ST #1100 IRVINE CA 92614-8234   | 12613615050          |
| L M CLIFF'S EDGE L L C        | 2020 MAIN ST #1100 IRVINE CA 92614-8234   | 12613114020          |
| L M CLIFF'S EDGE L L C        | 2020 MAIN ST #1100 IRVINE CA 92614-8234   | 12613214054          |
| L M CLIFF'S EDGE L L C        | 2020 MAIN ST #1100 IRVINE CA 92614-8234   | 12613214052          |
| L M CLIFF'S EDGE L L C        | 2020 MAIN ST #1100 IRVINE CA 92614-8234   | 12613116161          |
| L M CLIFF'S EDGE L L C        | 2020 MAIN ST #1100 IRVINE CA 92614-8234   | 12613113146          |
| L M CLIFF'S EDGE L L C        | 2020 MAIN ST #1100 IRVINE CA 92614-8234   | 12613113138          |
| L M CLIFF'S EDGE L L C        | 2020 MAIN ST #1100 IRVINE CA 92614-8234   | 12613513124          |
| L M CLIFF'S EDGE L L C        | 2020 MAIN ST #1100 IRVINE CA 92614-8234   | 12613113140          |
| L M CLIFF'S EDGE L L C        | 2020 MAIN ST #1100 IRVINE CA 92614-8234   | 12613513118          |

**Report of All Selected Parcels**

**Case Number:** VAR-58024 VAR-58025 VAR-58026 VAR-58027 VAR-58028 VAR-58029 VAR-58030 VAR-58031 VAR-58032 VAR-58033 VAR-58034

**Printed On:** Wed: March 4, 2015

| <u>Owner</u>           | <u>Address</u>                          | <u>Parcel Number</u> |
|------------------------|---|----------------------|
| L M CLIFF'S EDGE L L C | 2020 MAIN ST #1100 IRVINE CA 92614-8234 | 12613213157          |
| L M CLIFF'S EDGE L L C | 2020 MAIN ST #1100 IRVINE CA 92614-8234 | 12613113139          |
| L M CLIFF'S EDGE L L C | 2020 MAIN ST #1100 IRVINE CA 92614-8234 | 12613113144          |
| L M CLIFF'S EDGE L L C | 2020 MAIN ST #1100 IRVINE CA 92614-8234 | 12613116162          |
| L M CLIFF'S EDGE L L C | 2020 MAIN ST #1100 IRVINE CA 92614-8234 | 12613611011          |
| L M CLIFF'S EDGE L L C | 2020 MAIN ST #1100 IRVINE CA 92614-8234 | 12613513113          |
| L M CLIFF'S EDGE L L C | 2020 MAIN ST #1100 IRVINE CA 92614-8234 | 12613114021          |
| L M CLIFF'S EDGE L L C | 2020 MAIN ST #1100 IRVINE CA 92614-8234 | 12613513111          |
| L M CLIFF'S EDGE L L C | 2020 MAIN ST #1100 IRVINE CA 92614-8234 | 12613513126          |
| L M CLIFF'S EDGE L L C | 2020 MAIN ST #1100 IRVINE CA 92614-8234 | 12613214051          |
| L M CLIFF'S EDGE L L C | 2020 MAIN ST #1100 IRVINE CA 92614-8234 | 12613513120          |
| L M CLIFF'S EDGE L L C | 2020 MAIN ST #1100 IRVINE CA 92614-8234 | 12613213169          |
| L M CLIFF'S EDGE L L C | 2020 MAIN ST #1100 IRVINE CA 92614-8234 | 12613116163          |
| L M CLIFF'S EDGE L L C | 2020 MAIN ST #1100 IRVINE CA 92614-8234 | 12613116156          |
| L M CLIFF'S EDGE L L C | 2020 MAIN ST #1100 IRVINE CA 92614-8234 | 12613215070          |
| L M CLIFF'S EDGE L L C | 2020 MAIN ST #1100 IRVINE CA 92614-8234 | 12613113150          |
| L M CLIFF'S EDGE L L C | 2020 MAIN ST #1100 IRVINE CA 92614-8234 | 12613113151          |
| L M CLIFF'S EDGE L L C | 2020 MAIN ST #1100 IRVINE CA 92614-8234 | 12613116158          |
| L M CLIFF'S EDGE L L C | 2020 MAIN ST #1100 IRVINE CA 92614-8234 | 12613513112          |
| L M CLIFF'S EDGE L L C | 2020 MAIN ST #1100 IRVINE CA 92614-8234 | 12613113152          |
| L M CLIFF'S EDGE L L C | 2020 MAIN ST #1100 IRVINE CA 92614-8234 | 12613116165          |
| L M CLIFF'S EDGE L L C | 2020 MAIN ST #1100 IRVINE CA 92614-8234 | 12613114023          |
| L M CLIFF'S EDGE L L C | 2020 MAIN ST #1100 IRVINE CA 92614-8234 | 12613513117          |
| L M CLIFF'S EDGE L L C | 2020 MAIN ST #1100 IRVINE CA 92614-8234 | 12613116164          |
| L M CLIFF'S EDGE L L C | 2020 MAIN ST #1100 IRVINE CA 92614-8234 | 12613113142          |
| L M CLIFF'S EDGE L L C | 2020 MAIN ST #1100 IRVINE CA 92614-8234 | 12613116166          |
| L M CLIFF'S EDGE L L C | 2020 MAIN ST #1100 IRVINE CA 92614-8234 | 12613113143          |
| L M CLIFF'S EDGE L L C | 2020 MAIN ST #1100 IRVINE CA 92614-8234 | 12613514040          |
| L M CLIFF'S EDGE L L C | 2020 MAIN ST #1100 IRVINE CA 92614-8234 | 12613116172          |
| L M CLIFF'S EDGE L L C | 2020 MAIN ST #1100 IRVINE CA 92614-8234 | 12613116160          |
| L M CLIFF'S EDGE L L C | 2020 MAIN ST #1100 IRVINE CA 92614-8234 | 12613116155          |
| L M CLIFF'S EDGE L L C | 2020 MAIN ST #1100 IRVINE CA 92614-8234 | 12613615051          |

**Report of All Selected Parcels**

**Case Number:** VAR-58024 VAR-58025 VAR-58026 VAR-58027 VAR-58028 VAR-58029 VAR-58030 VAR-58031 VAR-58032 VAR-58033 VAR-58034

**Printed On:** Wed: March 4, 2015

| <u>Owner</u>           | <u>Address</u>                          | <u>Parcel Number</u> |
|------------------------|---|----------------------|
| L M CLIFF'S EDGE L L C | 2020 MAIN ST #1100 IRVINE CA 92614-8234 | 12613513116          |
| L M CLIFF'S EDGE L L C | 2020 MAIN ST #1100 IRVINE CA 92614-8234 | 12613211021          |
| L M CLIFF'S EDGE L L C | 2020 MAIN ST #1100 IRVINE CA 92614-8234 | 12613113135          |
| L M CLIFF'S EDGE L L C | 2020 MAIN ST #1100 IRVINE CA 92614-8234 | 12613215064          |
| L M CLIFF'S EDGE L L C | 2020 MAIN ST #1100 IRVINE CA 92614-8234 | 12613215068          |
| L M CLIFF'S EDGE L L C | 2020 MAIN ST #1100 IRVINE CA 92614-8234 | 12613215067          |
| L M CLIFF'S EDGE L L C | 2020 MAIN ST #1100 IRVINE CA 92614-8234 | 12613113148          |
| L M CLIFF'S EDGE L L C | 2020 MAIN ST #1100 IRVINE CA 92614-8234 | 12613215065          |
| L M CLIFF'S EDGE L L C | 2020 MAIN ST #1100 IRVINE CA 92614-8234 | 12613215066          |
| L M CLIFF'S EDGE L L C | 2020 MAIN ST #1100 IRVINE CA 92614-8234 | 12613214053          |
| L M CLIFF'S EDGE L L C | 2020 MAIN ST #1100 IRVINE CA 92614-8234 | 12613513127          |
| L M CLIFF'S EDGE L L C | 2020 MAIN ST #1100 IRVINE CA 92614-8234 | 12613116167          |
| L M CLIFF'S EDGE L L C | 2020 MAIN ST #1100 IRVINE CA 92614-8234 | 12613513119          |
| L M CLIFF'S EDGE L L C | 2020 MAIN ST #1100 IRVINE CA 92614-8234 | 12613116170          |
| L M CLIFF'S EDGE L L C | 2020 MAIN ST #1100 IRVINE CA 92614-8234 | 12613215071          |
| L M CLIFF'S EDGE L L C | 2020 MAIN ST #1100 IRVINE CA 92614-8234 | 12613513128          |
| L M CLIFF'S EDGE L L C | 2020 MAIN ST #1100 IRVINE CA 92614-8234 | 12613214050          |
| L M CLIFF'S EDGE L L C | 2020 MAIN ST #1100 IRVINE CA 92614-8234 | 12613113145          |
| L M CLIFF'S EDGE L L C | 2020 MAIN ST #1100 IRVINE CA 92614-8234 | 12613514041          |
| L M CLIFF'S EDGE L L C | 2020 MAIN ST #1100 IRVINE CA 92614-8234 | 12613113137          |
| L M CLIFF'S EDGE L L C | 2020 MAIN ST #1100 IRVINE CA 92614-8234 | 12613514038          |
| L M CLIFF'S EDGE L L C | 2020 MAIN ST #1100 IRVINE CA 92614-8234 | 12613116171          |
| L M CLIFF'S EDGE L L C | 2020 MAIN ST #1100 IRVINE CA 92614-8234 | 12613513121          |
| L M CLIFF'S EDGE L L C | 2020 MAIN ST #1100 IRVINE CA 92614-8234 | 12613214049          |
| L M CLIFF'S EDGE L L C | 2020 MAIN ST #1100 IRVINE CA 92614-8234 | 12613113147          |
| L M CLIFF'S EDGE L L C | 2020 MAIN ST #1100 IRVINE CA 92614-8234 | 12613215069          |
| L M CLIFF'S EDGE L L C | 2020 MAIN ST #1100 IRVINE CA 92614-8234 | 12613114022          |
| L M CLIFF'S EDGE L L C | 2020 MAIN ST #1100 IRVINE CA 92614-8234 | 12613114024          |
| L M CLIFF'S EDGE L L C | 2020 MAIN ST #1100 IRVINE CA 92614-8234 | 12613116168          |
| L M CLIFF'S EDGE L L C | 2020 MAIN ST #1100 IRVINE CA 92614-8234 | 12613116157          |
| L M CLIFF'S EDGE L L C | 2020 MAIN ST #1100 IRVINE CA 92614-8234 | 12613116159          |
| L M CLIFF'S EDGE L L C | 2020 MAIN ST #1100 IRVINE CA 92614-8234 | 12613113136          |

**Report of All Selected Parcels**

**Case Number:** VAR-58024 VAR-58025 VAR-58026 VAR-58027 VAR-58028 VAR-58029 VAR-58030 VAR-58031 VAR-58032  
VAR-58033 VAR-58034

**Printed On:** Wed: March 4, 2015

| <b>Owner</b>                    | <b>Address</b>  | <b>Parcel Number</b> |
|---------------------------------|---|----------------------|
| L M CLIFF'S EDGE L L C          | 2020 MAIN ST #1100 IRVINE CA 92614-8234                                     | 12613112002          |
| LABORDE TODD & JULIE            | 4520 RIGA PL WASHINGTON DC 20521  | 12613513076          |
| LAMB RYAN J                     | 7911 TORREYS PEAK ST LAS VEGAS NV 89166-5076                                | 12613114017          |
| LAO ZENAIDA                     | ORDANEZ LANA & ABRAHAM 7706 ALBRIGHT PEAK DR LAS VEGAS NV 89166             | 12613213002          |
| LAUBERT MARK C & BROOK E        | 10622 AXIS MOUNTAIN CT LAS VEGAS NV 89166                                   | 12613116058          |
| LAW KATHARINE R                 | CRUZ KENNETH T 10656 CAPITOL PEAK AVE LAS VEGAS NV 89166                    | 12613116031          |
| LAWSON EDWARD & ASHLEY M        | 10602 THOR MOUNTAIN LN LAS VEGAS NV 89166                                   | 12613116129          |
| LE R & P FAMILY TRUST           | LE RANDY TU & PAULA PHUONG TRS P O BOX 60985 IRVINE CA 92602                | 12613117022          |
| LEBEL DANIEL J & PATRICIA K     | 10453 MOUNT WASHINGTON AVE LAS VEGAS NV 89166-5057                          | 12613513089          |
| LEE PATRICK & JENNIFER          | 10635 TRAY MOUNTAIN AVE LAS VEGAS NV 89166-5078                             | 12613215048          |
| LEE YI-CHIEH                    | 10647 KEARNEY MOUNTAIN AVE LAS VEGAS NV 89166                               | 12613215015          |
| LEEDHAM BRIANNA                 | 10738 OLD IRONSIDES AVE LAS VEGAS NV 89166-5098                             | 12613117034          |
| LEFEVRE CORY & BROOKE           | 10752 OLD IRONSIDES AVE LAS VEGAS NV 89166-5099                             | 12613117037          |
| LELAND MICHAEL A & SUSAN M      | 10616 CAPITOL PEAK AVE LAS VEGAS NV 89166                                   | 12613116036          |
| LEONG DANIEL                    | 7768 HOUSTON PEAK ST LAS VEGAS NV 89166                                     | 12613212182          |
| LEROUX TRUST                    | LEROUX DANIEL & MARIE TRS 10533 BANDERA MOUNTAIN LN LAS VEGAS NV 89166-5027 | 12613113032          |
| LESIEWICZ JANEL                 | 10445 MOUNT WASHINGTON AVE LAS VEGAS NV 89166-5057                          | 12613513091          |
| LESTER ROBERT                   | 7756 WEAVERCREST CT LAS VEGAS NV 89166-5121                                 | 12613212171          |
| LICHARDI JOSEPH V & PAULA A     | 7722 ALBRIGHT PEAK DR LAS VEGAS NV 89166                                    | 12613215003          |
| LILES ANDREW R                  | ROHRER LUKAS 7760 WEAVERCREST CT LAS VEGAS NV 89166-5121                    | 12613212170          |
| LILLIS LYNSI & JACK II          | 7826 TAY RIVER CT LAS VEGAS NV 89166-5092                                   | 12613115067          |
| LIMA-MERLOS ORVIN O             | 10705 DOBBS AVE LAS VEGAS NV 89166  | 12613212277          |
| LINDENBAUM RONALD L & RHONDA H  | 10636 TRAY MOUNTAIN AVE LAS VEGAS NV 89166-5078                             | 12613215034          |
| LISAMA MA ADORINA C & ERNESTO D | 10664 CAPITOL PEAK AVE LAS VEGAS NV 89166                                   | 12613116029          |
| LITTLES JENNIFER MARIE          | 7751 HOUSTON PEAK ST LAS VEGAS NV 89166-5105                                | 12613212175          |
| LIUZZA LEONARD S & KATIE M      | 7772 HOUSTON PEAK ST LAS VEGAS NV 89166-5105                                | 12613212181          |
| LIVINGSTON KARLA N              | 10751 OLD IRONSIDES AVE LAS VEGAS NV 89166-5099                             | 12613117042          |
| LLOREN BIRGIT                   | 7748 ALBRIGHT PEAK DR LAS VEGAS NV 89166-5023                               | 12613215040          |
| LONG DONNY J & AMANDA C         | 10448 WHITE PRINCESS AVE LAS VEGAS NV 89156                                 | 12613513004          |
| LOPEZ JOHN D & LINDA F          | 10648 KEARNEY MOUNTAIN AVE LAS VEGAS NV 89166                               | 12613215061          |
| LOWE DAVID E                    | 7915 TORREYS PEAK ST LAS VEGAS NV 89166-5076                                | 12613114018          |
| LUCERO MOSES S                  | 10767 IONA ISLAND AVE LAS VEGAS NV 89166-5086                               | 12613115090          |

**Report of All Selected Parcels**

**Case Number:** VAR-58024 VAR-58025 VAR-58026 VAR-58027 VAR-58028 VAR-58029 VAR-58030 VAR-58031 VAR-58032  
VAR-58033 VAR-58034

**Printed On:** Wed: March 4, 2015

| <b>Owner</b>                   | <b>Address</b>   | <b>Parcel Number</b> |
|--------------------------------|--|----------------------|
| LUNSFORD ANDREW N & RHONDA K   | 10415 PRAIRIE MOUNTAIN AVE LAS VEGAS NV 89166                              | 12613513077          |
| LUSTED RACHEL                  | 7775 LONE SHEPHERD DR LAS VEGAS NV 89166-5120                              | 12613212206          |
| LYTLE LUKE S & AMY D           | 7935 LOST RANGER PEAK ST LAS VEGAS NV 89166                                | 12613116106          |
| MACALANDA XAVIER J & SHIERLY   | 10616 DERBY PEAK LN LAS VEGAS NV 89166-5036                                | 12613116111          |
| MADILL MICHAEL                 | 10513 BAUDERA MOUNTAIN LN LAS VEGAS NV 89166                               | 12613113027          |
| MAEDA JAMIE                    | 10762 OLD IRONSIDES AVE LAS VEGAS NV 89166                                 | 12613117039          |
| MAHAN DUSTY                    | 10625 DERBY PEAK LN LAS VEGAS NV 89166-5036                                | 12613116122          |
| MAPOY MARIA L                  | 10453 TURTLE MOUNTAIN AVE LAS VEGAS NV 89166-5081                          | 12613114009          |
| MARENTES FORTINO JR & ISABEL   | 10638 AXIS MOUNTAIN CT LAS VEGAS NV 89166                                  | 12613116054          |
| MARK JOSHUA                    | 18625 NE 161ST PL WOODINVILLE WA 98072                                     | 12613514027          |
| MARTIN JASON A & SABINA        | 10642 AXIS MOUNTAIN CT LAS VEGAS NV 89166                                  | 12613116053          |
| MARTINEZ PEDRO D               | 7847 TORREYS PEAK ST LAS VEGAS NV 89166-5076                               | 12613114011          |
| MATTAUSCH SARAH C              | 10622 THOR MOUNTAIN LN LAS VEGAS NV 89166-5075                             | 12613116134          |
| MATYJEVIC NATALIJA             | 10643 TRAY MOUNTAIN AVE LAS VEGAS NV 89166-5078                            | 12613215046          |
| MAY DEBORAH A                  | 10634 BANDERA MOUNTAIN LN LAS VEGAS NV 89166-5028                          | 12613113130          |
| MCCAULEY CHASSIDY NICOLE       | 10707 IONA ISLAND AVE LAS VEGAS NV 89166-5086                              | 12613115105          |
| MCCORMICK CHASEN & HALEY A     | 10617 DERBY PEAK LN LAS VEGAS NV 89166-5036                                | 12613116124          |
| MCDERMOTT ROBERT F & DANIELA   | 3625 RIVERBED LANE S E #9 CALEDONIA MI 49316                               | 12613118028          |
| MCDEVITT JANA M                | 10801 BEACH HOUSE AVE LAS VEGAS NV 89166-5094                              | 12613115021          |
| MCFATE MICHAEL R               | 10630 THOR MOUNTAIN LN LAS VEGAS NV 89166-5075                             | 12613116136          |
| MCFERRIN JONATHON M & ASHLEY C | 10627 KEARNEY MOUNTAIN AVE LAS VEGAS NV 89166                              | 12613215010          |
| MCGINNIS BRANDY E & STEVEN R   | 10737 BROXDEN JUNCTION AVE LAS VEGAS NV 89166-5100                         | 12613117027          |
| MCINERNEY HEIDI                | 657 WING ST PLYMOUTH MI 48170  | 12613611002          |
| MCINTYRE KEITH                 | 7931 BARTLETT PEAK ST LAS VEGAS NV 89166                                   | 12613116028          |
| MCKINNEY STEPHEN R             | JYDSTRUP-MCKINNEY ANDREA M 10441 MT WASHINGTON AVE LAS VEGAS NV 89166-5057 | 12613513092          |
| MCMOORE AMBER E                | 7752 CALEY CANYON ST LAS VEGAS NV 89166                                    | 12613212160          |
| MEDINA MARISOL                 | MAXFIELD JACK K JR 10707 BAYVIEW HOUSE AVE LAS VEGAS NV 89166-5096         | 12613117002          |
| MELCHOR CHRISTIAN              | 10740 BEACH HOUSE AVE LAS VEGAS NV 89166-5093                              | 12613111008          |
| MEMMOTT JAN C & ANN A          | 10614 AXIS MOUNTAIN CT LAS VEGAS NV 89166                                  | 12613116060          |
| MENDES ANTHONY G               | MORIN-MENDES MURIEL J 7065 W ANN RD #130-520 LAS VEGAS NV 89130            | 12613116061          |
| MERITAGE HOMES NEVADA INC      | 8800 E RAINTREE DR #300 SCOTTSDALE AZ 85260                                | 12613113022          |
| MERITAGE HOMES NEVADA INC      | 8800 E RAINTREE DR #300 SCOTTSDALE AZ 85260                                | 12613513001          |

**Report of All Selected Parcels**

**Case Number:** VAR-58024 VAR-58025 VAR-58026 VAR-58027 VAR-58028 VAR-58029 VAR-58030 VAR-58031 VAR-58032  
VAR-58033 VAR-58034

**Printed On:** Wed: March 4, 2015

| <b>Owner</b>                    | <b>Address</b>  | <b>Parcel Number</b> |
|---------------------------------|---|----------------------|
| MERITAGE HOMES NEVADA INC       | 8800 E RAINTREE DR #300 SCOTTSDALE AZ 85260                     | 12613513002          |
| MERITAGE HOMES NEVADA INC       | 8800 E RAINTREE DR #300 SCOTTSDALE AZ 85260                     | 12613513003          |
| MERITAGE HOMES NEVADA INC       | 8800 E RAINTREE DR #300 SCOTTSDALE AZ 85260                     | 12613513005          |
| MERKLEY GLADE & JERI            | 2474 W 1500 NORTH VERNAL UT 84078-9625                          | 12613115058          |
| MEYER GEORGE R & NANCY M        | 10601 DERBY PEAK LN LAS VEGAS NV 89166                          | 12613116128          |
| MEYERS MICHAEL A TRUST          | MEYERS MICHAEL A TRS 7729 DONNER PEAK ST LAS VEGAS NV 89135     | 12613215022          |
| MEZA NATALIA & ALFREDO          | 10807 OLD IRONSIDES AVE LAS VEGAS NV 89166-5129                 | 12613118027          |
| MILES PHUNG H & MARLIN M        | 10762 BAYVIEW HOUSE AVE LAS VEGAS NV 89166-5097                 | 12613117057          |
| MILLER ANTHONY & ANDREA         | 10721 DOBBS AVE LAS VEGAS NV 89166-5112                         | 12613212273          |
| MILLS CRAIG D                   | 7740 ALBRIGHT PEAK DR LAS VEGAS NV 89166-5023                   | 12613215042          |
| MINASSI-HAFTVANI GERMAN & ARLET | MINASSI-HAFTVANI JAKLEEN 7749 DONNER PEAK ST LAS VEGAS nv 89166 | 12613215027          |
| MOLINA KIMBERLI M               | 10525 BANDERA MOUNTAIN LN LAS VEGAS NV 89166-5027               | 12613113030          |
| MONTENEGRO RAY M & VICTORIA     | 7953 POINT POWELL CT LAS VEGAS NV 89166-5067                    | 12613513006          |
| MONYAK LINDA A & MICHAEL E      | 10736 BEACH HOUSE AVE LAS VEGAS NV 89166-5093                   | 12613111007          |
| MOORE JOHN P & MARY E           | 10437 TURTLE MOUNTAIN AVE LAS VEGAS NV 89166-5081               | 12613513035          |
| MOORE LAVONNE                   | 7928 BARTLETT PEAK ST LAS VEGAS NV 89166                        | 12613116117          |
| MORAN CODY L                    | 10450 MOUNT WASHINGTON AVE LAS VEGAS NV 89166-5057              | 12613513067          |
| MORDINI MICHAEL D & ROSANA C    | 10434 MOUNT WASHINGTON AVE LAS VEGAS NV 89166-5056              | 12613513071          |
| MORENO ROSENDO J                | 10627 TRAY MOUNTAIN AVE LAS VEGAS NV 89166-5078                 | 12613215050          |
| MORFORD RYAN                    | 2351 N 160TH AVE GOODYEAR az 85395                              | 12613212169          |
| MORGAN CHRISTIAN H & ASHLEY E   | 5239 MONARCH CREST WAY COLORADO SPRINGS CO 80924                | 12613115032          |
| MORGAN RAYMOND R                | 7819 VERDUGO PEAK ST LAS VEGAS NV 89166-5083                    | 12613113055          |
| MORRILL STEVE III               | 10639 TRAY MOUNTAIN AVE LAS VEGAS NV 89166-5078                 | 12613215047          |
| MORRISETTE JAYME RAE            | 10545 BANDERA MOUNTAIN LN LAS VEGAS NV 89166-5027               | 12613113035          |
| MOTA JAMIE & BLANCA             | 10667 BADERA MOUNTAIN LN LAS VEGAS NV 89166                     | 12613113053          |
| MOUCHAWAR GABRIEL & ELIA        | 24721 GARLAND DR VALENCIA CA 91355-4960                         | 12613115115          |
| MULLINER ALAN V & LAURA J       | 10811 IONA ISLAND AVE LAS VEGAS NV 89166-5087                   | 12613115085          |
| MURILLO ADRAIN                  | 4531 AVONDALE AVE LAS VEGAS NV 89121                            | 12613113061          |
| MURPHY JULIETTE H               | 10745 BROXDEN JUNCTION AVE LAS VEGAS NV 89166-5101              | 12613117025          |
| MURRAY JONATHAN J               | PUNZALAN MARY GRACE A 10626 AXIS MOUNTAIN CT LAS VEGAS NV 89166 | 12613116057          |
| MURTAGH JASON M & KALEA R       | 7822 TAY RIVER CT LAS VEGAS NV 89166-5092                       | 12613115066          |
| MUSNI MARC J & MARC             | 6263 RADIANT RAPTURE AVE LAS VEGAS NV 89131-3804                | 12613513048          |

**Report of All Selected Parcels**

**Case Number:** VAR-58024 VAR-58025 VAR-58026 VAR-58027 VAR-58028 VAR-58029 VAR-58030 VAR-58031 VAR-58032  
VAR-58033 VAR-58034

**Printed On:** Wed: March 4, 2015

| <b>Owner</b>                     | <b>Address</b>   | <b>Parcel Number</b> |
|----------------------------------|--|----------------------|
| MYAGMARKHUU AMARBOLD & SHELAH    | 7941 REED PEAK ST LAS VEGAS NV 89166-5066                                    | 12613513057          |
| NASON GUY J JR & HEATHER M       | 10807 IONA ISLAND AVE LAS VEGAS NV 89166-5087                                | 12613115086          |
| NAVARRO DONALDO B                | 7827 SHINGLE BEACH ST LAS VEGAS NV 89166-5088                                | 12613115036          |
| NEPA PAUL G                      | 10619 KEARNEY MOUNTAIN AVE LAS VEGAS NV 89166                                | 12613215008          |
| NERI CHRISTOPHER M & TIFFANY M   | 10436 TURTLE MOUNTAIN AVE LAS VEGAS NV 89166-5081                            | 12613513106          |
| NEVAREZ JIMMY & NICOLE T         | 7859 TORREYS PEAK ST LAS VEGAS NV 89166-5076                                 | 12613114014          |
| NEWBERG 2000 TRUST               | NEWBERG DAVID TRS P O BOX 2053 STREETSBORO HO 44241                          | 12613113069          |
| NEWBERG 2000 TRUST               | NEWBERG DAVID TRS P O BOX 2053 STREETSBORO OH 44241                          | 12613113068          |
| NEWELL CALLIE                    | 10621 THOR MOUNTAIN LN LAS VEGAS NV 89166-5075                               | 12613116012          |
| NGAI HING YAN & FOO YEE A FAM TR | NGAI HING YAN & FOO YEE A TRS 6735 ALTA VISTA DR RANCHO PALOS VERDE CA 90215 | 12613111010          |
| NGUYEN PHO & AI-NHI T            | 10639 KEARNEY MOUNTAIN AVE LAS VEGAS NV 89166                                | 12613215013          |
| NGUYEN VIETBINH D                | 10751 IONA ISLAND AVE LAS VEGAS NV 89166                                     | 12613115094          |
| NIELSON MARJEAN                  | 3901 GRIFBRICK DR PLANO TX 75075   | 12613514036          |
| NOVELLO CYNTHIA M                | 7834 BRODIE CASTLE CT LAS VEGAS NV 89166-5091                                | 12613115057          |
| NURUDDIN MANIYYA                 | 832 RED HART LN ALPHARETTA GA 30004  | 12613115048          |
| NV PROPERTY MANAGEMENT L L C     | P O BOX 10001 P M B 29 SAIPAN MP 96950                                       | 12613115095          |
| NYGARD RITA                      | WALSH JUNE 5701 BIA RT1 POPLAR MT 59255-9441                                 | 12613514025          |
| OBERLING MATTHEW & MARISSA       | 10817 BEACH HOUSE AVE LAS VEGAS NV 89166                                     | 12613115017          |
| OFFENBURGER ANN MARKIEL          | 10728 BEACH HOUSE AVE LAS VEGAS NV 89166-5093                                | 12613111005          |
| OHLINGER BONNIE M                | 10609 AXIS MOUNTAIN CT LAS VEGAS NV 89166                                    | 12613116043          |
| OKAZAKI JON M                    | 7814 GRANITE CITY CT LAS VEGAS NV 89166-5090                                 | 12613115040          |
| ORME DEL LEE & ROBYN KAY         | 10659 BANDERA MOUNTAIN LN LAS VEGAS NV 89166                                 | 12613113051          |
| ORRELL LAURA ANDREA              | 10719 IONA ISLAND AVE LAS VEGAS NV 89166-5086                                | 12613115102          |
| ORTIZ KENNETH & CONNIE           | 10455 PRAIRIE MOUNTAIN AVE LAS VEGAS NV 89166-5065                           | 12613513087          |
| OSBORN KENNETH C                 | HALE-OSBORN TARRA 10656 TRAY MOUNTAIN AVE LAS VEGAS NV 89166-5079            | 12613215029          |
| OSLIE CHRISTOPHER & STACY        | 7814 TAY RIVER CT LAS VEGAS NV 89166-5092                                    | 12613115064          |
| OSTERBECK-WALLER TRACEY A        | WALLER JOSHUA 10723 IONA ISLAND AVE LAS VEGAS NV 89166-5086                  | 12613115101          |
| OYER THOMAS G & SALLY J          | 10407 TURTLE MOUNTAIN AVE LAS VEGAS NV 89166-5080                            | 12613513029          |
| PACADA NESTOR A & NICIA          | 12531 DORAL ST EL MONTE CA 91732-4336  | 12613117004          |
| PAGE BRIAN M                     | 7904 AIROLA PEAK ST LAS VEGAS NV 89166-5021                                  | 12613513024          |
| PALAROAN PATRICIA                | 10624 MOUNT JEFFERSON AVE LAS VEGAS NV 89166-5054                            | 12613213068          |
| PALO ESTRELLA                    | 10745 OLD IRONSIDES AVE LAS VEGAS NV 89166-5099                              | 12613117043          |

**Report of All Selected Parcels**

**Case Number:** VAR-58024 VAR-58025 VAR-58026 VAR-58027 VAR-58028 VAR-58029 VAR-58030 VAR-58031 VAR-58032  
VAR-58033 VAR-58034

**Printed On:** Wed: March 4, 2015

| <b>Owner</b>                     | <b>Address</b>   | <b>Parcel Number</b> |
|----------------------------------|--|----------------------|
| PAMARAN JULIUS                   | 58 VILLAGE DR HATTIESBURG MS 39402                           | 12613116040          |
| PANO CONSTANTIN                  | 629 N HAYWORTH AVE #6 LOS ANGELES CA 90048                   | 12613117058          |
| PAREDES MIGUEL A & ANGELES       | 10549 BANDERA MOUNTAIN LN LAS VEGAS NV 89166-5027            | 12613113036          |
| PARK SEJIN & YOUNGJIN J          | 10553 BANDERA MOUNTAIN LN LAS VEGAS NV 89166-5027            | 12613113037          |
| PASQUAL SUSAN MARIE              | 10649 KENNEDY PEAK LN LAS VEGAS NV 89166-5045                | 12613113104          |
| PASSALACQUA EDWARD P & JOAN P    | 7823 SUGARLOAF PEAK ST LAS VEGAS NV 89166-5019               | 12613514004          |
| PATTERSON ROBERT J               | 10632 CAPITOL PEAK AVE LAS VEGAS NV 89166                    | 12613116034          |
| PAUL ERIC & ADRIAN STOBBE        | 10757 BEACH HOUSE AVE LAS VEGAS NV 89166                     | 12613115025          |
| PEAK DEE ANN & LETROY EDWARD     | 10647 TRAY MOUNTAIN AVE LAS VEGAS NV 89166-5078              | 12613215045          |
| PERCIVAL MICHAEL R & GAIL J      | 10617 AXIS MOUNTAIN CT LAS VEGAS NV 89166                    | 12613116045          |
| PEREZ ANGEL                      | 10725 DOBBS AVE LAS VEGAS NV 89166-5112                      | 12613212272          |
| PEREZ CLARISSA                   | 10503 MOUNT WASHINGTON AVE LAS VEGAS NV 89166-5057           | 12613513088          |
| PEREZ MAYRA                      | 10628 DERBY PEAK LN LAS VEGAS NV 89166-5036                  | 12613116114          |
| PERRYMAN J ALLEN & GLENDA L      | 7735 SUGARLOAF PEAK ST LAS VEGAS NV 89166-5020               | 12613615027          |
| PERRYMAN J ALLEN & GLENDA L      | 7735 SUGARLOAF PEAK ST LAS VEGAS NV 89166-5020               | 12613615026          |
| PETER JAMES L & MARY ANN         | 7771 HOUSTON PEAK ST LAS VEGAS NV 89166-5105                 | 12613212180          |
| PETERS PHILIP D & ANGEL L        | 10636 MOUNT JEFFERSON AVE LAS VEGAS NV 89166-5054            | 12613213065          |
| PETERSON ERNEST T III            | 10618 AXIS MOUNTAIN CT LAS VEGAS NV 89166                    | 12613116059          |
| PETERSON GARY                    | 10415 TURTLE MOUNTAIN AVE LAS VEGAS NV 89166                 | 12613513031          |
| PEZONE SAMUEL L & ANN MARIE      | 7934 LOST RANGER PEAK ST LAS VEGAS NV 89166                  | 12613116070          |
| PHILLIPS RACHEL J                | MOGEL MICHAEL W 7835 GRANITE CITY CT LAS VEGAS NV 89166-5090 | 12613115046          |
| PIPPIN GARY & KAREN B            | 587 NE 19TH AVE HILLSBORO OR 97124                           | 12613513030          |
| POFF EMORY                       | 10726 OLD IRONSIDES AVE LAS VEGAS NV 89166-5098              | 12613117031          |
| PONCE IDANIA                     | 10810 HUNTERS GREEN AVE LAS VEGAS NV 89166                   | 12613212153          |
| POPE JIM                         | P O BOX 95456 LAS VEGAS NV 89193-5456                        | 12613113043          |
| PREBULA GABRIELLE M & RICHARD C  | 10628 MOUNT JEFFERSON LAS VEGAS NV 89166-5054                | 12613213067          |
| PRENTICE STEVE A & SHAUNNA M     | 10653 MOUNT JEFFERSON AVE LAS VEGAS NV 89166-5055            | 12613213074          |
| PRESHA HENRY L & YASMINE I       | 10640 KEARNEY MOUNTAIN AVE LAS VEGAS NV 89166                | 12613215059          |
| PROGRESS RESIDENTIAL 2014-1 BORR | 909 N SEPULVEDA BLVD #840 EL SEGUNDO CA 90245                | 12613113122          |
| PROGRESS RESIDENTIAL 2014-1 BORR | 909 N SEPULVEDA BLVD #840 EL SEGUNDO CA 90245                | 12613116138          |
| PROVIDENCE MASTER H O A INC      | 7181 N HUALAPAI WAY #150 LAS VEGAS NV 89166-1118             | 12613117065          |
| PROVIDENCE MASTER H O A INC      | 7181 N HUALAPAI WAY #150 LAS VEGAS NV 89166-1118             | 12613117076          |

**Report of All Selected Parcels**

**Case Number:** VAR-58024 VAR-58025 VAR-58026 VAR-58027 VAR-58028 VAR-58029 VAR-58030 VAR-58031 VAR-58032  
VAR-58033 VAR-58034

**Printed On:** Wed: March 4, 2015

| <u>Owner</u>                     | <u>Address</u>   | <u>Parcel Number</u> |
|----------------------------------|--|----------------------|
| PROVIDENCE MASTER HOA INC        | 7181 NHUALAPAI WAY #150 LAS VEGAS NV 89166                             | 12613117080          |
| PROVIDENCE MASTER HOA INC        | 7181 N HUALAPAI WAY #150 LAS VEGAS NV 89166-1118                       | 12613117078          |
| PROVIDENCE MASTER HOWNERS ASSN   | 7181 N HUALAPAI WAY #150 LAS VEGAS NV 89166-1118                       | 12613115130          |
| QUINTANA JORGE A                 | 2708 WARD COOP #C JBER AK 99506  | 12613111006          |
| R INVESTMENT ULTD LIV REV TR     | 848 N RAINBOW BLVD #135 LAS VEGAS NV 89107                             | 12613118022          |
| RACZ JEANETTE G                  | 10752 BAYVIEW HOUSE AVE LAS VEGAS NV 89166-5097                        | 12613117055          |
| RAMIREZ MICHAEL R                | 10631 KEARNEY MOUNTAIN AVE LAS VEGAS NV 89166                          | 12613215011          |
| RAMPA EDWARD R                   | 10729 DOBBS AVE LAS VEGAS NV 89166-5112                                | 12613212271          |
| RAY BRITT A                      | 10765 BEACH HOUSE AVE LAS VEGAS NV 89166-5094                          | 12613115023          |
| RAYNOR IVAN ANDREW               | 4700 E MONROE LAS VEGAS NV 89110-1510                                  | 12613213087          |
| REBOLLO JOSEPH                   | ULEP DARLEME M 10755 BROXDEN JUNCTION AVE LAS VEGAS NV 89166-5101      | 12613117023          |
| REEVES NICOL R & DARIN P         | 7714 ALBRIGHT PEAK DR LAS VEGAS NV 89166                               | 12613215005          |
| REYES LUDWID & ANDRES            | REYES CARMEN 10633 AXIS MOUNTAIN CT LAS VEGAS NV 89166                 | 12613116049          |
| REYNOLDS SAMUEL R                | FINELLI ALEXANDRIA F 7768 WEAVERCREST CT LAS VEGAS NV 89166-5121       | 12613212168          |
| RICHMAN GARY A                   | 19468 MANCHESTER DR REHOBOTH BEACH DE 19971                            | 12613211007          |
| RIDDLE CARRIE J & CHARLES M      | 10708 OLD IRONSIDES AVE LAS VEGAS NV 89166-5098                        | 12613117007          |
| RIPINGILL DALE                   | 10734 BROXDEN JUNCTION AVE LAS VEGAS NV 89166-5100                     | 12613117016          |
| RIVERA SACHIKO EE                | 10632 KEARNEY MOUNTAIN AVE LAS VEGAS NV 89166                          | 12613215057          |
| RIVERS JOSHUA B                  | 10742 BAYVIEW HOUSE AVE LAS VEGAS NV 89166                             | 12613117053          |
| ROBERTSON NICHOLAS               | WALTON-ROBERTSON SUPAPORN 7823 VERDUGO PEAK ST LAS VEGAS NV 89166-5083 | 12613113056          |
| ROJAS SERVANDO & MARIA           | 10741 BEACH HOUSE AVE LAS VEGAS NV 89166-5093                          | 12613115029          |
| ROLL SHIRLEY & JOSEPH            | 7668 ALBRIGHT PEAK DR LAS VEGAS NV 89166                               | 12613213004          |
| ROLLO JEFFREY & BRANDY           | 7830 TAY RIVER CT LAS VEGAS NV 89166-5092                              | 12613115068          |
| ROMAN OSCAR E                    | PETERSON STACY R 7827 SUGARLOAF PEAK ST LAS VEGAS NV 89166-5019        | 12613514005          |
| ROMANO KRISTLYNN C & CHRISTOPHER | 7851 TORREYS PEAK ST LAS VEGAS NV 89166-5076                           | 12613114012          |
| ROOF SARAH                       | 10815 IONA ISLAND AVE LAS VEGAS NV 89166-5087                          | 12613115084          |
| ROSABELLA SARATOGA HIGHLANDS HOA | 630 TRADE CENTER DR #100 LAS VEGAS NV 89119-3712                       | 12613212312          |
| ROSABELLA SARATOGA HIGHLANDS HOA | 630 TRADE CENTER DR #100 LAS VEGAS NV 89119-3712                       | 12613212315          |
| ROSABELLA SARATOGA HIGHLANDS HOA | 630 TRADE CENTER DR #100 LAS VEGAS NV 89119-3712                       | 12613212313          |
| ROSABELLA SARATOGA HIGHLANDS HOA | 630 TRADE CENTER DR #100 LAS VEGAS NV 89119-3712                       | 12613212314          |
| ROSS SCOTT                       | 10517 BANDERA MOUNTAIN LN LAS VEGAS NV 89166-5027                      | 12613113028          |
| ROZEK R T & P J JOINT REV TR     | 10533 GALLEON PEAK LN LAS VEGAS NV 89166-5041                          | 12613211014          |

**Report of All Selected Parcels**

**Case Number:** VAR-58024 VAR-58025 VAR-58026 VAR-58027 VAR-58028 VAR-58029 VAR-58030 VAR-58031 VAR-58032 VAR-58033 VAR-58034

**Printed On:** Wed: March 4, 2015

| <u>Owner</u>              | <u>Address</u>                            | <u>Parcel Number</u> |
|---------------------------|---|----------------------|
| RYLAND HOMES NEVADA L L C | 8925 W RUSSELL RD #200 LAS VEGAS NV 89148 | 12613211001          |
| RYLAND HOMES NEVADA L L C | 8925 W RUSSELL RD #200 LAS VEGAS NV 89148 | 12613113090          |
| RYLAND HOMES NEVADA L L C | 8925 W RUSSELL RD #200 LAS VEGAS NV 89148 | 12613113057          |
| RYLAND HOMES NEVADA L L C | 8925 W RUSSELL RD #200 LAS VEGAS NV 89148 | 12613513054          |
| RYLAND HOMES NEVADA L L C | 8925 W RUSSELL RD #200 LAS VEGAS NV 89148 | 12613513083          |
| RYLAND HOMES NEVADA L L C | 8925 W RUSSELL RD #200 LAS VEGAS NV 89148 | 12613113025          |
| RYLAND HOMES NEVADA L L C | 8925 W RUSSELL RD #200 LAS VEGAS NV 89148 | 12613113024          |
| RYLAND HOMES NEVADA L L C | 8925 W RUSSELL RD #200 LAS VEGAS NV 89148 | 12613113065          |
| RYLAND HOMES NEVADA L L C | 8925 W RUSSELL RD #200 LAS VEGAS NV 89148 | 12613513096          |
| RYLAND HOMES NEVADA L L C | 8925 W RUSSELL RD #200 LAS VEGAS NV 89148 | 12613513034          |
| RYLAND HOMES NEVADA L L C | 8925 W RUSSELL RD #200 LAS VEGAS NV 89148 | 12613513050          |
| RYLAND HOMES NEVADA L L C | 8925 W RUSSELL RD #200 LAS VEGAS NV 89148 | 12613513041          |
| RYLAND HOMES NEVADA L L C | 8925 W RUSSELL RD #200 LAS VEGAS NV 89148 | 12613513044          |
| RYLAND HOMES NEVADA L L C | 8925 W RUSSELL RD #200 LAS VEGAS NV 89148 | 12613513039          |
| RYLAND HOMES NEVADA L L C | 8925 W RUSSELL RD #200 LAS VEGAS NV 89148 | 12613513061          |
| RYLAND HOMES NEVADA L L C | 8925 W RUSSELL RD #200 LAS VEGAS NV 89148 | 12613113106          |
| RYLAND HOMES NEVADA L L C | 8925 W RUSSELL RD #200 LAS VEGAS NV 89148 | 12613113003          |
| RYLAND HOMES NEVADA L L C | 8925 W RUSSELL RD #200 LAS VEGAS NV 89148 | 12613113023          |
| RYLAND HOMES NEVADA L L C | 8925 W RUSSELL RD #200 LAS VEGAS NV 89148 | 12613113091          |
| RYLAND HOMES NEVADA L L C | 8925 W RUSSELL RD #200 LAS VEGAS NV 89148 | 12613113089          |
| RYLAND HOMES NEVADA L L C | 8925 W RUSSELL RD #200 LAS VEGAS NV 89148 | 12613113097          |
| RYLAND HOMES NEVADA L L C | 8925 W RUSSELL RD #200 LAS VEGAS NV 89148 | 12613113118          |
| RYLAND HOMES NEVADA L L C | 8925 W RUSSELL RD #200 LAS VEGAS NV 89148 | 12613113082          |
| RYLAND HOMES NEVADA L L C | 8925 W RUSSELL RD #200 LAS VEGAS NV 89148 | 12613113115          |
| RYLAND HOMES NEVADA L L C | 8925 W RUSSELL RD #200 LAS VEGAS NV 89148 | 12613513058          |
| RYLAND HOMES NEVADA L L C | 8925 W RUSSELL RD #200 LAS VEGAS NV 89148 | 12613113012          |
| RYLAND HOMES NEVADA L L C | 8925 W RUSSELL RD #200 LAS VEGAS NV 89148 | 12613113011          |
| RYLAND HOMES NEVADA L L C | 8925 W RUSSELL RD #200 LAS VEGAS NV 89148 | 12613113019          |
| RYLAND HOMES NEVADA L L C | 8925 W RUSSELL RD #200 LAS VEGAS NV 89148 | 12613611005          |
| RYLAND HOMES NEVADA L L C | 8925 W RUSSELL RD #200 LAS VEGAS NV 89148 | 12613113093          |
| RYLAND HOMES NEVADA L L C | 8925 W RUSSELL RD #200 LAS VEGAS NV 89148 | 12613113073          |
| RYLAND HOMES NEVADA L L C | 8925 W RUSSELL RD #200 LAS VEGAS NV 89148 | 12613113015          |

**Report of All Selected Parcels**

**Case Number:** VAR-58024 VAR-58025 VAR-58026 VAR-58027 VAR-58028 VAR-58029 VAR-58030 VAR-58031 VAR-58032 VAR-58033 VAR-58034

**Printed On:** Wed: March 4, 2015

| <u>Owner</u>              | <u>Address</u>                            | <u>Parcel Number</u> |
|---------------------------|---|----------------------|
| RYLAND HOMES NEVADA L L C | 8925 W RUSSELL RD #200 LAS VEGAS NV 89148 | 12613513056          |
| RYLAND HOMES NEVADA L L C | 8925 W RUSSELL RD #200 LAS VEGAS NV 89148 | 12613513085          |
| RYLAND HOMES NEVADA L L C | 8925 W RUSSELL RD #200 LAS VEGAS NV 89148 | 12613113098          |
| RYLAND HOMES NEVADA L L C | 8925 W RUSSELL RD #200 LAS VEGAS NV 89148 | 12613113072          |
| RYLAND HOMES NEVADA L L C | 8925 W RUSSELL RD #200 LAS VEGAS NV 89148 | 12613113026          |
| RYLAND HOMES NEVADA L L C | 8925 W RUSSELL RD #200 LAS VEGAS NV 89148 | 12613113063          |
| RYLAND HOMES NEVADA L L C | 8925 W RUSSELL RD #200 LAS VEGAS NV 89148 | 12613113086          |
| RYLAND HOMES NEVADA L L C | 8925 W RUSSELL RD #200 LAS VEGAS NV 89148 | 12613113002          |
| RYLAND HOMES NEVADA L L C | 8925 W RUSSELL RD #200 LAS VEGAS NV 89148 | 12613113059          |
| RYLAND HOMES NEVADA L L C | 8925 W RUSSELL RD #200 LAS VEGAS NV 89148 | 12613513084          |
| RYLAND HOMES NEVADA L L C | 8925 W RUSSELL RD #200 LAS VEGAS NV 89148 | 12613113099          |
| RYLAND HOMES NEVADA L L C | 8925 W RUSSELL RD #200 LAS VEGAS NV 89148 | 12613513094          |
| RYLAND HOMES NEVADA L L C | 8925 W RUSSELL RD #200 LAS VEGAS NV 89148 | 12613513105          |
| RYLAND HOMES NEVADA L L C | 8925 W RUSSELL RD #200 LAS VEGAS NV 89148 | 12613513086          |
| RYLAND HOMES NEVADA L L C | 8925 W RUSSELL RD #200 LAS VEGAS NV 89148 | 12613113021          |
| RYLAND HOMES NEVADA L L C | 8925 W RUSSELL RD #200 LAS VEGAS NV 89148 | 12613113071          |
| RYLAND HOMES NEVADA L L C | 8925 W RUSSELL RD #200 LAS VEGAS NV 89148 | 12613113076          |
| RYLAND HOMES NEVADA L L C | 8925 W RUSSELL RD #200 LAS VEGAS NV 89148 | 12613113062          |
| RYLAND HOMES NEVADA L L C | 8925 W RUSSELL RD #200 LAS VEGAS NV 89148 | 12613611007          |
| RYLAND HOMES NEVADA L L C | 8925 W RUSSELL RD #200 LAS VEGAS NV 89148 | 12613513051          |
| RYLAND HOMES NEVADA L L C | 8925 W RUSSELL RD #200 LAS VEGAS NV 89148 | 12613114001          |
| RYLAND HOMES NEVADA L L C | 8925 W RUSSELL RD #200 LAS VEGAS NV 89148 | 12613513043          |
| RYLAND HOMES NEVADA L L C | 8925 W RUSSELL RD #200 LAS VEGAS NV 89148 | 12613513008          |
| RYLAND HOMES NEVADA L L C | 8925 W RUSSELL RD #200 LAS VEGAS NV 89148 | 12613113074          |
| RYLAND HOMES NEVADA L L C | 8925 W RUSSELL RD #200 LAS VEGAS NV 89148 | 12613113092          |
| RYLAND HOMES NEVADA L L C | 8925 W RUSSELL RD #200 LAS VEGAS NV 89148 | 12613113081          |
| RYLAND HOMES NEVADA L L C | 8925 W RUSSELL RD #200 LAS VEGAS NV 89148 | 12613113088          |
| RYLAND HOMES NEVADA L L C | 8925 W RUSSELL RD #200 LAS VEGAS NV 89148 | 12613513063          |
| RYLAND HOMES NEVADA L L C | 8925 W RUSSELL RD #200 LAS VEGAS NV 89148 | 12613113116          |
| RYLAND HOMES NEVADA L L C | 8925 W RUSSELL RD #200 LAS VEGAS NV 89148 | 12613113075          |
| RYLAND HOMES NEVADA L L C | 8925 W RUSSELL RD #200 LAS VEGAS NV 89148 | 12613513095          |
| RYLAND HOMES NEVADA L L C | 8925 W RUSSELL RD #200 LAS VEGAS NV 89148 | 12613113008          |

**Report of All Selected Parcels**

**Case Number:** VAR-58024 VAR-58025 VAR-58026 VAR-58027 VAR-58028 VAR-58029 VAR-58030 VAR-58031 VAR-58032 VAR-58033 VAR-58034

**Printed On:** Wed: March 4, 2015

| <u>Owner</u>              | <u>Address</u>                            | <u>Parcel Numbe</u> |
|---------------------------|---|---------------------|
| RYLAND HOMES NEVADA L L C | 8925 W RUSSELL RD #200 LAS VEGAS NV 89148 | 12613513060         |
| RYLAND HOMES NEVADA L L C | 8925 W RUSSELL RD #200 LAS VEGAS NV 89148 | 12613113067         |
| RYLAND HOMES NEVADA L L C | 8925 W RUSSELL RD #200 LAS VEGAS NV 89148 | 12613611003         |
| RYLAND HOMES NEVADA L L C | 8925 W RUSSELL RD #200 LAS VEGAS NV 89148 | 12613513055         |
| RYLAND HOMES NEVADA L L C | 8925 W RUSSELL RD #200 LAS VEGAS NV 89148 | 12613513010         |
| RYLAND HOMES NEVADA L L C | 8925 W RUSSELL RD #200 LAS VEGAS NV 89148 | 12613513009         |
| RYLAND HOMES NEVADA L L C | 8925 W RUSSELL RD #200 LAS VEGAS NV 89148 | 12613211003         |
| RYLAND HOMES NEVADA L L C | 8925 W RUSSELL RD #200 LAS VEGAS NV 89148 | 12613513040         |
| RYLAND HOMES NEVADA L L C | 8925 W RUSSELL RD #200 LAS VEGAS NV 89148 | 12613513042         |
| RYLAND HOMES NEVADA L L C | 8925 W RUSSELL RD #200 LAS VEGAS NV 89148 | 12613513102         |
| RYLAND HOMES NEVADA L L C | 8925 W RUSSELL RD #200 LAS VEGAS NV 89148 | 12613114003         |
| RYLAND HOMES NEVADA L L C | 8925 W RUSSELL RD #200 LAS VEGAS NV 89148 | 12613513032         |
| RYLAND HOMES NEVADA L L C | 8925 W RUSSELL RD #200 LAS VEGAS NV 89148 | 12613513081         |
| RYLAND HOMES NEVADA L L C | 8925 W RUSSELL RD #200 LAS VEGAS NV 89148 | 12613113096         |
| RYLAND HOMES NEVADA L L C | 8925 W RUSSELL RD #200 LAS VEGAS NV 89148 | 12613211004         |
| RYLAND HOMES NEVADA L L C | 8925 W RUSSELL RD #200 LAS VEGAS NV 89148 | 12613113083         |
| RYLAND HOMES NEVADA L L C | 8925 W RUSSELL RD #200 LAS VEGAS NV 89148 | 12613113017         |
| RYLAND HOMES NEVADA L L C | 8925 W RUSSELL RD #200 LAS VEGAS NV 89148 | 12613113014         |
| RYLAND HOMES NEVADA L L C | 8925 W RUSSELL RD #200 LAS VEGAS NV 89148 | 12613113078         |
| RYLAND HOMES NEVADA L L C | 8925 W RUSSELL RD #200 LAS VEGAS NV 89148 | 12613113079         |
| RYLAND HOMES NEVADA L L C | 8925 W RUSSELL RD #200 LAS VEGAS NV 89148 | 12613113080         |
| RYLAND HOMES NEVADA L L C | 8925 W RUSSELL RD #200 LAS VEGAS NV 89148 | 12613113087         |
| RYLAND HOMES NEVADA L L C | 8925 W RUSSELL RD #200 LAS VEGAS NV 89148 | 12613113013         |
| RYLAND HOMES NEVADA L L C | 8925 W RUSSELL RD #200 LAS VEGAS NV 89148 | 12613113020         |
| RYLAND HOMES NEVADA L L C | 8925 W RUSSELL RD #200 LAS VEGAS NV 89148 | 12613113077         |
| RYLAND HOMES NEVADA L L C | 8925 W RUSSELL RD #200 LAS VEGAS NV 89148 | 12613513062         |
| RYLAND HOMES NEVADA L L C | 8925 W RUSSELL RD #200 LAS VEGAS NV 89148 | 12613113094         |
| RYLAND HOMES NEVADA L L C | 8925 W RUSSELL RD #200 LAS VEGAS NV 89148 | 12613113016         |
| RYLAND HOMES NEVADA L L C | 8925 W RUSSELL RD #200 LAS VEGAS NV 89148 | 12613113095         |
| RYLAND HOMES NEVADA L L C | 8925 W RUSSELL RD #200 LAS VEGAS NV 89148 | 12613113108         |
| RYLAND HOMES NEVADA L L C | 8925 W RUSSELL RD #200 LAS VEGAS NV 89148 | 12613113010         |
| RYLAND HOMES NEVADA L L C | 8925 W RUSSELL RD #200 LAS VEGAS NV 89148 | 12613513101         |

**Report of All Selected Parcels**

**Case Number:** VAR-58024 VAR-58025 VAR-58026 VAR-58027 VAR-58028 VAR-58029 VAR-58030 VAR-58031 VAR-58032 VAR-58033 VAR-58034

**Printed On:** Wed: March 4, 2015

| <u>Owner</u>              | <u>Address</u>                            | <u>Parcel Numbe</u> |
|---------------------------|---|---------------------|
| RYLAND HOMES NEVADA L L C | 8925 W RUSSELL RD #200 LAS VEGAS NV 89148 | 12613513098         |
| RYLAND HOMES NEVADA L L C | 8925 W RUSSELL RD #200 LAS VEGAS NV 89148 | 12613513103         |
| RYLAND HOMES NEVADA L L C | 8925 W RUSSELL RD #200 LAS VEGAS NV 89148 | 12613513059         |
| RYLAND HOMES NEVADA L L C | 8925 W RUSSELL RD #200 LAS VEGAS NV 89148 | 12613513082         |
| RYLAND HOMES NEVADA L L C | 8925 W RUSSELL RD #200 LAS VEGAS NV 89148 | 12613114004         |
| RYLAND HOMES NEVADA L L C | 8925 W RUSSELL RD #200 LAS VEGAS NV 89148 | 12613513033         |
| RYLAND HOMES NEVADA L L C | 8925 W RUSSELL RD #200 LAS VEGAS NV 89148 | 12613114007         |
| RYLAND HOMES NEVADA L L C | 8925 W RUSSELL RD #200 LAS VEGAS NV 89148 | 12613114002         |
| RYLAND HOMES NEVADA L L C | 8925 W RUSSELL RD #200 LAS VEGAS NV 89148 | 12613513097         |
| RYLAND HOMES NEVADA L L C | 8925 W RUSSELL RD #200 LAS VEGAS NV 89148 | 12613113058         |
| RYLAND HOMES NEVADA L L C | 8925 W RUSSELL RD #200 LAS VEGAS NV 89148 | 12613113085         |
| RYLAND HOMES NEVADA L L C | 8925 W RUSSELL RD #200 LAS VEGAS NV 89148 | 12613113018         |
| RYLAND HOMES NEVADA L L C | 8925 W RUSSELL RD #200 LAS VEGAS NV 89148 | 12613113066         |
| RYLAND HOMES NEVADA L L C | 8925 W RUSSELL RD #200 LAS VEGAS NV 89148 | 12613113007         |
| RYLAND HOMES NEVADA L L C | 8925 W RUSSELL RD #200 LAS VEGAS NV 89148 | 12613113084         |
| RYLAND HOMES NEVADA L L C | 8925 W RUSSELL RD #200 LAS VEGAS NV 89148 | 12613513064         |
| RYLAND HOMES NEVADA L L C | 8925 W RUSSELL RD #200 LAS VEGAS NV 89148 | 12613113064         |
| RYLAND HOMES NEVADA L L C | 8925 W RUSSELL RD #200 LAS VEGAS NV 89148 | 12613513053         |
| RYLAND HOMES NEVADA L L C | 8925 W RUSSELL RD #200 LAS VEGAS NV 89148 | 12613513052         |
| RYLAND HOMES NEVADA L L C | 8925 W RUSSELL RD #200 LAS VEGAS NV 89148 | 12613611006         |
| RYLAND HOMES NEVADA L L C | 8925 W RUSSELL RD #200 LAS VEGAS NV 89148 | 12613113001         |
| RYLAND HOMES NEVADA L L C | 8925 W RUSSELL RD #200 LAS VEGAS NV 89148 | 12613113006         |
| RYLAND HOMES NEVADA L L C | 8925 W RUSSELL RD #200 LAS VEGAS NV 89148 | 12613113009         |
| RYLAND HOMES NEVADA L L C | 8925 W RUSSELL RD #200 LAS VEGAS NV 89148 | 12613113005         |
| RYLAND HOMES NEVADA L L C | 8925 W RUSSELL RD #200 LAS VEGAS NV 89148 | 12613113117         |
| RYLAND HOMES NEVADA L L C | 8925 W RUSSELL RD #200 LAS VEGAS NV 89148 | 12613113100         |
| RYLAND HOMES NEVADA L L C | 8925 W RUSSELL RD #200 LAS VEGAS NV 89148 | 12613113112         |
| RYLAND HOMES NEVADA L L C | 8925 W RUSSELL RD #200 LAS VEGAS NV 89148 | 12613513104         |
| RYLAND HOMES NEVADA L L C | 8925 W RUSSELL RD #200 LAS VEGAS NV 89148 | 12613113114         |
| RYLAND HOMES NEVADA L L C | 8925 W RUSSELL RD #200 LAS VEGAS NV 89148 | 12613211002         |
| RYLAND HOMES NEVADA L L C | 8925 W RUSSELL RD #200 LAS VEGAS NV 89148 | 12613611004         |
| RYLAND HOMES NEVADA L L C | 8925 W RUSSELL RD #200 LAS VEGAS NV 89148 | 12613113113         |

**Report of All Selected Parcels**

**Case Number:** VAR-58024 VAR-58025 VAR-58026 VAR-58027 VAR-58028 VAR-58029 VAR-58030 VAR-58031 VAR-58032  
VAR-58033 VAR-58034

**Printed On:** Wed: March 4, 2015

| <b>Owner</b>                     | <b>Address</b>   | <b>Parcel Number</b> |
|----------------------------------|--|----------------------|
| RYLAND HOMES NEVADA L L C        | 8925 W RUSSELL RD #200 LAS VEGAS NV 89148                                  | 12613513038          |
| RYLAND HOMES NEVADA L L C        | 8925 W RUSSELL RD #200 LAS VEGAS NV 89148                                  | 12613113004          |
| RYNES SEAN P                     | 10625 AXIS MOUNTAIN CT LAS VEGAS NV 89166                                  | 12613116047          |
| S A B A LTD                      | 17555 VENTURA BLVD #202 ENCINO CA 91316                                    | 12613117010          |
| S B Y 2014-1 BORROWER L L C      | 3300 FERNBROOK LN N #210 PLYMOUTH MN 55447                                 | 12613211009          |
| S B Y 2014-1 BORROWER L L C      | 3300 FERNBROOK LN N #210 PLYMOUTH MN 55447                                 | 12613115054          |
| S F R INVESTMENTS POOL 1 L L C   | 5030 PARADISE RD #B-214 LAS VEGAS NV 89119                                 | 12613113105          |
| S R O F 2013-S3 REO 1 L L C      | 8742 LUCENT BLVD #300 HIGHLANDS RANCH CO 80129                             | 12613117049          |
| SABLE RANDALL W                  | 10643 DERBY PEAK LN LAS VEGAS NV 89166-5036                                | 12613116119          |
| SACCA ROSARIO JR & CHERYL        | 10529 GALLEON PEAK LN LAS VEGAS NV 89166                                   | 12613211013          |
| SAGERT ALYSSA                    | 10621 DERBY PEAK LN LAS VEGAS NV 89166-5036                                | 12613116123          |
| SALVADOR JULIE A & JOHN M        | 7826 BRODIE CASTLE CT LAS VEGAS NV 89166-5091                              | 12613115055          |
| SALVATION ARMY                   | 180 E OCEAN BLVD LONG BEACH CA 90802                                       | 12613114008          |
| SALZMAN LESLEE                   | 10655 BANDERA MOUNTAIN LN LAS VEGAS NV 89166-5029                          | 12613113050          |
| SAMUELS RICHARD & MARY-MARGARET  | 10422 GROTTO MOUNTAIN AVE LAS VEGAS NV 89166-5008                          | 12613514010          |
| SANTIAGO LUIGIE                  | GUZMAN AILENID X 10646 AXIS MOUNTAIN CT LAS VEGAS NV 89166                 | 12613116052          |
| SARMIENTO MERLIN                 | CHAVEZ MARLENE 7767 LONE SHEPHERD DR LAS VEGAS NV 89166-5120               | 12613212208          |
| SAUNDERS LACIE                   | SUEMNICK TERRY & TAMIE J 10540 BANDERA MOUNTAIN LN LAS VEGAS NV 89166-5027 | 12613113119          |
| SAWYER MICHELLE                  | 10301 HOMESTEAD RD LAS VEGAS NV 89143-1017                                 | 12613113129          |
| SCHABLOSKI ADAM & JILL           | 7834 GRANITE CITY CT LAS VEGAS NV 89166                                    | 12613115045          |
| SCHAIBLEY DEAN DAVID K & ERICA L | 7747 SUGARLOAF PEAK ST LAS VEGAS NV 89166                                  | 12613615030          |
| SCHOLER KARA J M                 | STOUT REED M 7818 BRODIE CASTLE CT LAS VEGAS NV 89166                      | 12613115053          |
| SCHONERT MARK & KIMBERLY         | 10731 IONA ISLAND AVE LAS VEGAS NV 89166-5086                              | 12613115099          |
| SCHUMANN MAUREEN & KARL          | 3775 MARY EVELYN WAY ALEXANDRIA VA 22309                                   | 12613213064          |
| SCHURLEY IRENE L                 | 10664 MOUNT JEFFERSON AVE LAS VEGAS NV 89166-5055                          | 12613213058          |
| SCRIVO ANDREW & RALPH D          | 10630 AXIS MOUNTAIN CT LAS VEGAS NV 89166                                  | 12613116056          |
| SEBASTIAN RYAN E & COLLEEN A     | 2051 E 6175 S OGDEN UT 84403   | 12613215033          |
| SECTION 12 L L C                 | 11411 SOUTHERN HIGHLANDS #300 LAS VEGAS NV 89141                           | 12612000001          |
| SENGDARA LORI                    | 10771 IONA ISLAND AVE LAS VEGAS NV 89166-5087                              | 12613115089          |
| SERRANO MARIO J                  | 10629 AXIS MOUNTAIN CT LAS VEGAS NV 89166                                  | 12613116048          |
| SEXTON ASHLEY JEAN & BENJAMIN K  | 10805 BEACH HOUSE AVE LAS VEGAS NV 89166-5094                              | 12613115020          |
| SHACKELFORD RENE                 | 7823 SHINGLE BEACH ST LAS VEGAS NV 89166-5088                              | 12613115037          |

**Report of All Selected Parcels**

**Case Number:** VAR-58024 VAR-58025 VAR-58026 VAR-58027 VAR-58028 VAR-58029 VAR-58030 VAR-58031 VAR-58032  
VAR-58033 VAR-58034

**Printed On:** Wed: March 4, 2015

| <b>Owner</b>                     | <b>Address</b>   | <b>Parcel Number</b> |
|----------------------------------|--|----------------------|
| SHINGLE BEACH L L C              | 7842 SHINGLE BEACH ST LAS VEGAS NV 89166-5089                      | 12613115113          |
| SHROBA CYNTHIA S                 | 10607 BANDERA MOUNTAIN LN LAS VEGAS NV 89166-5028                  | 12613113041          |
| SIMPKINS DAVID & MELINDA         | 7814 SHINGLE BEACH ST LAS VEGAS NV 89166-5088                      | 12613115106          |
| SIMPSON RAVONN T                 | HICKEY LISA I 10711 BROXDEN JUNCTION AVE LAS VEGAS NV 89166-5100   | 12613117009          |
| SLAVIN ROBERT                    | SHIBOU-SLAVIN DEBRA JILL 7664 ALBRIGHT PEAK DR LAS VEGAS NV 89166  | 12613213005          |
| SMALL JOSHUA F                   | LOFTON JESSICA R 10641 THOR MOUNTAIN LN LAS VEGAS NV 89166-5075    | 12613116016          |
| SMITH ANTHONY J                  | RELOS DAVID C 10428 BAYS MOUNTAIN AVE LAS VEGAS NV 89166-5002      | 12613514037          |
| SMITH CRYSTAL P & JACOB S        | 9000 ROCKVILLE AVE LAS VEGAS NV 89143                              | 12613117012          |
| SMITH HEATHER                    | 7831 SHINGLE BEACH ST LAS VEGAS NV 89166                           | 12613115035          |
| SMITH KALLI J                    | 3933 CARLA ANNE RD NORTH LAS VEGAS NV 89081                        | 12613111003          |
| SMITH RICHARD A                  | P O BOX 370812 LAS VEGAS NV 89137                                  | 12613116108          |
| SMITH STACY                      | 7752 WEAVERCREST CT LAS VEGAS NV 89166-5121                        | 12613212172          |
| SMITH TALYN A                    | DEFILIPPO LARISA L 10652 KEARNEY MOUNTAIN AVE LAS VEGAS NV 89166   | 12613215062          |
| SMOOT JUANNE M                   | 10648 MOUNT JEFFERSON AVE LAS VEGAS NV 89166-5055                  | 12613213062          |
| SOLE JOSEPH                      | FIX NANCY 171 PARK ST BUFFALO NY 14201-1526                        | 12613111009          |
| SOTO CHRISTIAN F                 | RESTREPO PAULA A 10541 BANDERA MOUNTAIN LN LAS VEGAS NV 89166-5027 | 12613113034          |
| SOUTHERN NEVADA HOLDINGS L L C   | 8301 BROAD PEAK DR LAS VEGAS NV 89131                              | 12613115088          |
| SOVITSKY GEORGE A & PAULINE R    | 8025 BATTISTA LN LAS VEGAS NV 89123                                | 12613115098          |
| SPRINGHETTI MARK R & CARINA I    | 10438 MOUNT WASHINGTON AVE LAS VEGAS NV 89166-5057                 | 12613513070          |
| SPURGIN BONITA                   | 9761 CANYON WALK ST LAS VEGAS NV 89147                             | 12613116107          |
| STAFFORD ERIC T                  | 10621 AXIS MOUNTAIN CT LAS VEGAS NV 89166                          | 12613116046          |
| STARR JACK                       | 7752 HOUSTON PEAK ST LAS VEGAS NV 89166                            | 12613212186          |
| STEELE CAMERON S & TARA A        | 9030 GRIZZLY ST LAS VEGAS NV 89131                                 | 12613115062          |
| STENGER BRANDON T & ELIZABETH    | 10613 BANDERA MOUNTAIN LN LAS VEGAS NV 89166-5028                  | 12613113042          |
| STOUT RANDY L                    | 7739 SUGARLOAF PEAK ST LAS VEGAS NV 89166-5020                     | 12613615028          |
| STROUD JIMMY F                   | 5730 GARDEN POINT DR KING WOOD TX 77345-1767                       | 12613211015          |
| STROUD JIMMY F                   | 5730 GARDEN POINT DR KINGWOOD TX 77345-1767                        | 12613611009          |
| SULLIVAN JAMES F & NICOLE M      | 10624 DERBY PEAK LN LAS VEGAS NV 89166-5036                        | 12613116113          |
| SUMBANG MA LOURDES               | 10623 BANDERA MOUNTAIN LN LAS VEGAS NV 89166-5028                  | 12613113044          |
| SUMO PROPERTIES L L C            | 7120 SMOKE RANCH RD LAS VEGAS NV 89128-3157                        | 12613514022          |
| T H P I ACQUISITION HOLDINGS LLC | 9406 W LAKE MEAD BLVD #101 LAS VEGAS NV 89134-8331                 | 12613115096          |
| TAJIMA DEAN                      | 10741 OLD IRONSIDES AVE LAS VEGAS NV 89166-5099                    | 12613117044          |

**Report of All Selected Parcels**

**Case Number:** VAR-58024 VAR-58025 VAR-58026 VAR-58027 VAR-58028 VAR-58029 VAR-58030 VAR-58031 VAR-58032  
VAR-58033 VAR-58034

**Printed On:** Wed: March 4, 2015

| <b>Owner</b>                     | <b>Address</b>  | <b>Parcel Number</b> |
|----------------------------------|---|----------------------|
| TALARICO JEANETTE & FRED         | 7940 TIGH BRACHEN CT LAS VEGAS NV 89166-5131                                | 12613117018          |
| TAMAGOS ALADIN N & AMY D         | JOHNSON DALE D & JUDY DELGADO 7779 LONE SHEPHERD DR LAS VEGAS NV 89166-5120 | 12613212205          |
| TATE IRREVOCABLE TRUST           | KERR P STERLING TRS 10722 ARUSHA AVE LAS VEGAS NV 89166-7006                | 12613215028          |
| TATE IRREVOCABLE TRUST           | KERR P STERLING TRS 10722 ARUSHA AVE LAS VEGAS NV 89166                     | 12613215049          |
| TEICH PATRICK & SHANNON E        | 7740 HOUSTON PEAK ST LAS VEGAS NV 89166                                     | 12613212189          |
| TEIS MATTHEW P                   | 10813 BEACH HOUSE AVE LAS VEGAS NV 89166-5095                               | 12613115018          |
| TENGASANTOS BEVERLY G            | UCHIDA NEIL K 10655 TRAY MOUNTAIN AVE LAS VEGAS NV 89166-5079               | 12613215043          |
| TERUEL MARIA B                   | YARROW JAMES S 16117 N E 57TH ST REDMOND WA 98052-4839                      | 12613117008          |
| TESSEMA SOLOMON                  | 803 S ORANGE GROVE BLVD PASADENA CA 91105                                   | 12613113134          |
| THOMAS GWENDOLYN                 | 2085 KOALA DR OXNARD CA 93036-9036  | 12613117040          |
| THOMPSON ASHLEY & JEBRON         | 10811 OLD IRONSIDES AVE LAS VEGAS NV 89166-5129                             | 12613118026          |
| THOMPSON BRIAN W & MICHELLE L    | 10733 BROXDEN JUNCTION AVE LAS VEGAS NV 89166-5100                          | 12613117028          |
| THOMPSON STEVEN M                | 7907 BARTLETT PEAK ST LAS VEGAS NV 89166                                    | 12613116022          |
| THORNE CHRISTOPHER A & MARIELLE  | 7916 AIROLA PEAK ST LAS VEGAS NV 89166                                      | 12613513021          |
| TIBERI FRANK L & JENNIFER L      | 10663 THOR MOUNTAIN LN LAS VEGAS NV 89166-5075                              | 12613116020          |
| TIDWELL STEVEN BLAKE & JESSICA L | 10725 OLD IRONSIDES AVE LAS VEGAS NV 89166-5098                             | 12613117048          |
| TIKHOMIROV ALEXANDER A & RAEANN  | 10600 BANDERA MOUNTAIN LN LAS VEGAS NV 89166-5028                           | 12613113125          |
| TODARO FAMILY TRUST              | TODARO ANTONIO TRS 688 BAYPORT AVE SAN CARLOS CA 94070                      | 12613115104          |
| TOEWS CAMERON                    | 10769 BEACH HOUSE AVE LAS VEGAS NV 89166-5094                               | 12613115022          |
| TONGOL ROWENA F                  | 7756 CALEY CANYON ST LAS VEGAS NV 89166                                     | 12613212159          |
| TORBECK TYLER HARRISON           | JORDAN ASHLY EMILY 7910 TORREYS PEAK ST LAS VEGAS NV 89166-5076             | 12613513065          |
| TORRES JOSE & ERICA              | 7819 SHINGLE BEACH ST LAS VEGAS NV 89166-5088                               | 12613115038          |
| TORRES ROBERT G & CHRISTINE L    | 10756 BEACH HOUSE AVE LAS VEGAS NV 89166-5094                               | 12613115002          |
| TRAN JUSTIN T & MADISON A        | 10634 AXIS MOUNTAIN CT LAS VEGAS NV 89166                                   | 12613116055          |
| TREFILETTI DINO & KATHLEEN       | 10756 BAYVIEW HOUSE AVE LAS VEGAS NV 89166-5097                             | 12613117056          |
| TUCCI ODIS L JR & BRANDY L       | 7822 SHINGLE BEACH ST LAS VEGAS NV 89166-5088                               | 12613115108          |
| TURNER ALAN & LAUREN NICOLE      | 10609 DERBY PEAK LN LAS VEGAS NV 89166                                      | 12613116126          |
| TURNER WILLIAM B III             | 10605 AXIS MOUNTAIN CT LAS VEGAS NV 89166                                   | 12613116042          |
| TWITCHELL BRIAN W                | 10537 BANDERA MOUNTAIN LN LAS VEGAS NV 89166-5027                           | 12613113033          |
| UGALINO JESSICA ONZA             | TRAN TOMMY NGUYEN 10565 BANDERA MOUNTAIN LN LAS VEGAS NV 89166-5028         | 12613113040          |
| VACCARO-MOORE DONNA              | MOORE BILL H LIVING TRUST 2816 LAKECREST DR LAS VEGAS NV 89128              | 12613215031          |
| VALDEZ JOE A JR & BRENDA R       | 2070 NORTH 650 W LAYTON UT 84041-4704                                       | 12613215052          |

**Report of All Selected Parcels**

**Case Number:** VAR-58024 VAR-58025 VAR-58026 VAR-58027 VAR-58028 VAR-58029 VAR-58030 VAR-58031 VAR-58032  
VAR-58033 VAR-58034

**Printed On:** Wed: March 4, 2015

| <b>Owner</b>                     | <b>Address</b>   | <b>Parcel Number</b> |
|----------------------------------|--|----------------------|
| VALDEZ KATHRYN L                 | 10625 CAPITOL PEAK AVE LAS VEGAS NV 89166                            | 12613116100          |
| VALTIERREZ MANUEL & CLAUDIA      | 10720 SHEEPSHEAD BAY AVE LAS VEGAS NV 89166                          | 12613115060          |
| VANMETER BENJAMIN V & ELSA M     | 10612 CAPITOL PEAK AVE LAS VEGAS NV 89166                            | 12613116037          |
| VANSANT MATTHEW                  | 7903 TORREYS PEAK ST LAS VEGAS NV 89166-5076                         | 12613114015          |
| VEGAS CASA L L C-THOR MTN SERIES | 6485 N DECATUR BLVD #180 LAS VEGAS NV 89131                          | 12613116017          |
| VELANDRIA FLORELYN & RUEL        | 10445 TURTLE MOUNTAIN AVE LAS VEGAS NV 89166-5081                    | 12613513037          |
| VELEY HENRY                      | 10655 THOR MOUNTAIN LN LAS VEGAS NV 89166-5075                       | 12613116018          |
| VILLANDRY L L C                  | 9005 W SAHARA AVE LAS VEGAS NV 89117-5745                            | 12613113126          |
| VIOLANTI FRANCES                 | 7748 WEAVERCREST CT LAS VEGAS NV 89166-5121                          | 12613212173          |
| VIRTS KEVIN M & MARCY A          | CMR 460 BOX 16 APO AE 09752  | 12613513078          |
| WADE KEITH A & JESSICA M         | 2109 CACTUS DESERT CT NORTH LAS VEGAS NV 89084-3171                  | 12613117045          |
| WAGNER MATTHEW J & ANA R         | 10737 BEACH HOUSE AVE LAS VEGAS NV 89166                             | 12613115030          |
| WAGNER TODD M                    | 10446 MOUNT WASHINGTON AVE LAS VEGAS NV 89166-5057                   | 12613513068          |
| WALKER CHARLES SCOTT             | 10422 MT WASHINGTON AVE LAS VEGAS NV 89166-5056                      | 12613513074          |
| WALKER NATE & MICHELLE           | 10616 KEARNEY MOUNTAIN AVE LAS VEGAS NV 89166-5042                   | 12613215053          |
| WALL KAREN ANN LIVING TRUST      | 10643 BANDERA MT LN LAS VEGAS NV 89166                               | 12613113047          |
| WARE RACHEL                      | 10660 CAPITOL PEAK AVE LAS VEGAS NV 89166                            | 12613116030          |
| WATSON KEATON JERMAINE           | 10624 TRAY MOUNTAIN AVE LAS VEGAS NV 89166-5078                      | 12613215037          |
| WEBER GREGORY S                  | 10756 OLD IRONSIDES AVE LAS VEGAS NV 89166-5099                      | 12613117038          |
| WEKSLER FAMILY TRUST             | WEKSLER BRENDA TRS 10629 BANDERA MOUNTAIN LN LAS VEGAS NV 89166-5028 | 12613113045          |
| WELSH ADAM K & BERNADINE         | 10636 KEARNEY MOUNTAIN AVE LAS VEGAS NV 89166                        | 12613215058          |
| WERNET ALAN                      | 10623 TRAY MOUNTAIN AVE LAS VEGAS NV 89166                           | 12613215051          |
| WEST SEAN D                      | 10607 MOUNT JEFFERSON AVE LAS VEGAS NV 89166-5054                    | 12613213085          |
| WHEELER ANTOINETTE N             | 10730 BAYVIEW HOUSE AVE LAS VEGAS NV 89166-5096                      | 12613117050          |
| WHITMIRE-GRIGSBY JANAVA O        | 10741 BAYVIEW HOUSE AVE LAS VEGAS NV 89166-5096                      | 12613111001          |
| WIDMAR SCOTT J                   | 10651 TRAY MOUNTAIN AVE LAS VEGAS NV 89166-5079                      | 12613215044          |
| WILLSON JAMIE JUANIECE           | SIDES STEVEN WILLIAM 7724 HOUSTON PEAK ST LAS VEGAS NV 89166         | 12613212193          |
| WINSCHER KELLY K                 | 7747 HOUSTON PEAK ST LAS VEGAS NV 89166-5105                         | 12613212174          |
| WOJDAK WILLIAM                   | P O BOX 190086 SAN FRANCISCO CA 94119-0086                           | 12613212209          |
| WOTTON RYAN T                    | 10637 AXIS MOUNTAIN CT LAS VEGAS NV 89166                            | 12613116050          |
| WRIGHT BARBARA J & DAVID         | 7811 SUGARLOAF PEAK ST LAS VEGAS NV 89166                            | 12613514001          |
| WYLLER LIVING TRUST              | WYLLER ALF E & ARDYTH A TRS P O BOX 817 SHERWOOD OR 97140-0817       | 12613513020          |

**Report of All Selected Parcels**

**Case Number:** VAR-58024 VAR-58025 VAR-58026 VAR-58027 VAR-58028 VAR-58029 VAR-58030 VAR-58031 VAR-58032  
VAR-58033 VAR-58034

**Printed On:** Wed: March 4, 2015

| <u>Owner</u>                   | <u>Address</u>   | <u>Parcel Numbe</u> |
|--------------------------------|--|---------------------|
| WYNE SHAWN & BONNIE            | 10655 FORUM PEAK LN LAS VEGAS NV 89166-5039            | 12613113070         |
| YANG OWEN                      | ROSS-POWELL COURTNEY 10 YELLOWWOOD WAY IRVINE CA 92612 | 12613117033         |
| YOUNG STEVEN P                 | 7818 TAY RIVER CT LAS VEGAS NV 89166-5092              | 12613115065         |
| ZAVADIL RICHARD J & COURTNEY A | 10649 MT JEFFERSON AVE LAS VEGAS NV 89166-5055         | 12613213075         |
| ZIROS PETRA                    | 7818 SHINGLE BEACH ST LAS VEGAS NV 89166-5088          | 12613115107         |
| ZORN ZACHARY L & JESSICA B     | 10426 MT WASHINGTON AVE LAS VEGAS NV 89166-5056        | 12613513073         |