

City of Las Vegas  
Department of Planning  
Development Services Center  
333 North Rancho Drive, 3<sup>rd</sup> Floor  
Las Vegas, Nevada 89106

**Return Service Requested**  
**Official Notice of Public Hearing**

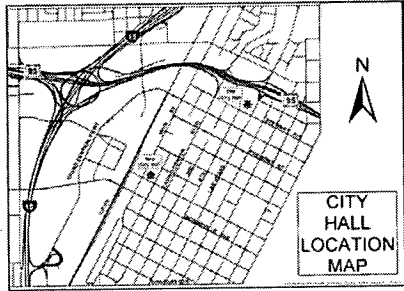

If you wish to file your protest or support on this request, check the appropriate box below and return this card in an envelope with postage to the Department of Planning at the address listed above, fax this side of this card to (702) 464-7499 or make your comments at [www.lasvegasnevada.gov](http://www.lasvegasnevada.gov). If you would like to contact your Council Representative, please call (702) 229-6405.

I SUPPORT  
this Request

I OPPOSE  
this Request

Please use available blank space on card for your comments.

**VAR-56177 & SUP-56178 [PRJ-55959]**

Planning Commission Meeting of 1/13/2015

## Application Information

**VAR-56177 - VARIANCE - PUBLIC HEARING - APPLICANT/OWNER: GURDWARA BABA DEEP SINGH, INC.** - For possible action on a request for a Variance TO ALLOW A RESIDENTIAL ADJACENCY SETBACK OF 40 FEET WHERE A MINIMUM OF 105 FEET IS REQUIRED at 6341 West Lone Mountain Road (APN 138-02-501-002), R-E (Residence Estates) Zone, Ward 4 (Anthony) [PRJ-55959].

**SUP-56178 - SPECIAL USE PERMIT RELATED TO VAR-56177 - PUBLIC HEARING - APPLICANT/OWNER: GURDWARA BABA DEEP SINGH, INC.** - For possible action on a request for a Major Amendment to a previously approved Special Use Permit (U-0139-98) FOR A PROPOSED 15,772 SQUARE-FOOT EXPANSION TO AN EXISTING 3,882 SQUARE-FOOT HOUSE OF WORSHIP USE at 6341 West Lone Mountain Road (APN 138-02-501-002), R-E (Residence Estates) Zone, Ward 4 (Anthony) [PRJ-55959].

## Application Location

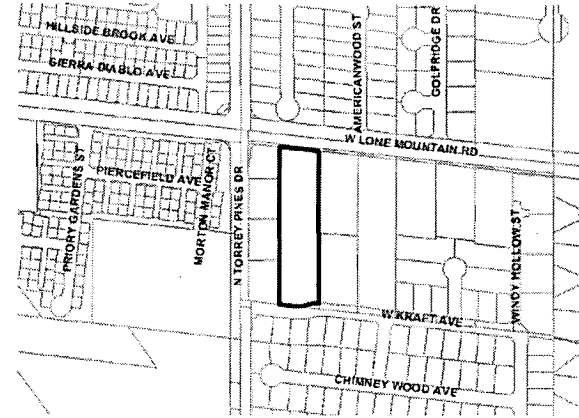

The proposed project may not pertain to the entire highlighted project site.

## Public Hearing Information

**Meeting:** Planning Commission  
**Date:** *January 13, 2015*  
**Time:** 6:00 P.M.  
**Location:** City Council Chambers  
495 South Main Street, 2<sup>nd</sup> Floor  
Las Vegas, Nevada 89101

Any and all interested persons may appear before the City Planning Commission either in person or by representative and object to or express approval of this request; or may, prior to this meeting, file a written objection thereto or approval thereof with the Department of Planning, Development Services Center, 333 North Rancho Drive, 3<sup>rd</sup> Floor, Las Vegas, Nevada 89106. Final Action on General Plan Amendments and Rezonings will be determined by the City Council. Other public hearing items may be deemed Final Action by the Planning Commission or forwarded to the City Council. The date of the City Council meeting, if applicable, will be announced at the Planning Commission meeting after the discussion of the item. For further information, including the full staff report, please call (702) 229-6301 (TDD 386-9108) or go to <http://www.lasvegasnevada.gov>.

**Report of All Selected Parcels****Case Number:** VAR-56177**Printed On:** Mon: January 5, 2015

<u>Owner</u>	<u>Address</u>	<u>Parcel Number</u>
786 REVOCABLE TRUST	2102 DONLON CT HENDERSON NV 89012-2709	13802110060
ABU-SAMRAH SAMEER A & CYNTHIA A	8980 W EL CAMPO GRANDE LAS VEGAS NV 89149-3347	13802511064
ABU-SAMRAH SAMEER A & CYNTHIA M	ABU-SAMRAH SAMEER A & CYNTHIA M 8980 W EL CAMPO GRANDE AVE LAS VEGAS NV 89149-3347	12535811009
ADAMS APRIL	6513 ANGEL MOUNTAIN AVE LAS VEGAS NV 89130-1844	12535414046
AGUILAR EVA MARIA REVOCABLE TR	AGUILAR EVA MARIA TRS 6480 ABBOTSFORD HOUSE CT LAS VEGAS NV 89130-2308	13802110124
AHLBERG KIMBERLY M	4773 MORTON MANOR CT LAS VEGAS NV 89130-2371	13802110034
ALDAKHEELY ILLHAM	207 18TH ST HUNTINGTON BEACH CA 92648-3903	13802110010
ALINO JESUS E & ESTERLITA C	4789 GREENCOMBE CT LAS VEGAS NV 89130-2368	13802110015
ALVAREZ LYANNET	4781 MORTON MANOR CT LAS VEGAS NV 89130-2371	13802110036
ANDERSON MARK J	GALLEGOS FLORENCE K P O BOX 190 DONNELLY ID 83615-0190	12535810021
ANNOR SAMUEL Y & BARBARA	7140 SUDLEY CT LAS VEGAS NV 89131	12535416003
ANOTHER NEW IDEA L L C	18 CHATMOSS RD HENDERSON NV 89052	12535414053
ARRINGTON KATHY FAMILY LIVING TR	ARRINGTON KATHY TRS 6424 SUNDOWN HEIGHTS LAS VEGAS NV 89130-1854	12535413011
AVELLINO ESTATESASSOCIATION	4576 N RANCHO #100 LAS VEGAS NV 89130-3475	12535812048
AYALA RICARDO D	DENSHAM AMY M 4741 PRIORY GARDENS ST LAS VEGAS NV 89130-2309	13802110073
B2 PROPERTIES L L C	8209 FOOTHILL BLVD #A138 SUNLAND CA 91040	13802110117
BABBINGTON BRIDGET M	6429 SIERRA DIABLO AVE LAS VEGAS NV 89130-1871	12535416029
BAILEY MILLICENT L	4765 BURGESS PARK CT LAS VEGAS NV 89130-2362	13802110099
BANNON ERIN JO	4520 BLUE JAY DR LEES SUMMIT MO 64064-3209	12535416001
BARBER JANE	6401 QUANTUM LN LAS VEGAS NV 89130-1831	12535411033
BARMAN RONALD M & CAROLE REV TR	BARMAN RONALD M & CAROLE TRS 6317 KRAFT AVE LAS VEGAS NV 89130-2357	13802511003
BARRETT PAUL J & SHERYL L	340 ALISO DR NE ALBUQUERQUE NM 87108-1005	13802110109
BATIS-MCCOY FAMILY TRUST	MCCOY WILL G JR TRS 4624 WINDY HOLLOW ST LAS VEGAS NV 89130-2350	13802511068
BATTON JACQUELYN	SCARLATO GERTRUDE 6404 SIERRA DIABLO AVE LAS VEGAS NV 89130	12535416013
BAUMGART JONI R	4773 MANDERSTON CT LAS VEGAS NV 89130-2365	13802110052
BECKER NORMAN P	18375 VENTURA BLVD #148 TARZANA CA 91356	12535415054
BERENGUEL FAMILY TRUST	BERENGUEL LAURENCE & AURORA TRS 4800 GOLFRIDGE DR LAS VEGAS NV 89130-5611	12535810039
BERNARD CANDACE L	6332 CEDAR GROVE CIR LAS VEGAS NV 89130-5622	12535810022
BIGELOW APARTMENTS L L C	4538 PATRIOT CANNON ST NORTH LAS VEGAS NV 89031	12535812015
BILAVARN JOHNNY	6277 HILL HAVEN AVE LAS VEGAS NV 89130	13802511054
BIRDMAN LIVING TRUST	TAYLOR DONALD & EILEEN F TRS 6325 CHIMNEY WOOD AVE LAS VEGAS NV 89130-2351	13802511015

**Report of All Selected Parcels****Case Number:** VAR-56177**Printed On:** Mon: January 5, 2015

<u>Owner</u>	<u>Address</u>	<u>Parcel Numbe</u>
BLACK NIGEL L	6257 HILL HAVEN AVE LAS VEGAS NV 89130-2347	13802511059
BLACKBURN THOMAS B & JEAN F	7311 PERFECT DAY AVE LAS VEGAS NV 89129-7124	12535416002
BLANCETT PHILIP M	2196 LAKE TAHOE BLVD SOUTH LAKE TAHOE CA 96150	12535812013
BLUE EYES LIVING TRUST	BURAS MARY LEE TRS P O BOX 28906 LAS VEGAS NV 89126-2906	12535415033
BLUIETT FAMILY TRUST	BLUIETT PRESTON JR TRS 4849 N STORM MOUNTAIN ST LAS VEGAS NV 89130-1853	12535413003
BOLINGER JOSHUA	UDELL CHRISTOPHER 7808 PORTLAND TRL AUSTIN TX 78729-8041	13802110059
BONUGLI LAUREN R	10536 EARLY HEIGHTS CT LAS VEGAS NV 89129	13802110011
BORDEN THURMOND H	U S EMBASSY BEIJING PSC 461 BOX 50 FPO AP 96521	13802110043
BRANCH JESSICA A	WRIGHT-DECAMPOS ANNETTE M 4793 DRUMMOND CASTLE CT LAS VEGAS NV 89130-2366	13802110008
BRIGGS BARBARA A	6508 SIERRA DIABLO AVE LAS VEGAS NV 89130	12535415035
BRODAHL BRUCE A	4829 AMERICANWOOD ST LAS VEGAS NV 89130-5629	12535811023
BROOKS NISHA N	6488 BENTLEY WOOD CT LAS VEGAS NV 89130-2311	13802110104
BROWN HARVEY & HATTIE	4616 WINDY HOLLOW ST LAS VEGAS NV 89130	13802511066
BROWN MICHAEL R & WENDY L	6228 MINERVA DR LAS VEGAS NV 89130-2315	13802510008
BUCHANNAN HERBERT JR & MARGARET	4325 AL CARRISON ST LAS VEGAS NV 89129	13802511007
BUTNER DON & IRENE	6401 ANGEL MOUNTAIN AVE LAS VEGAS NV 89130-1860	12535413033
BUYERS DAVID C	4742 NEWBY HALL CT LAS VEGAS NV 89130	13802110080
CALDER PROPERTIES L L C	5945 WASATCH RIDGE CIR LAS VEGAS NV 89149-3967	13802110096
CAMPANELLI BARROS FAMILY TRUST	CAMPANELLI DILMA TRS 6276 CHIMNEY WOOD AVE LAS VEGAS NV 89130-2300	13802511077
CARLIN ARNOLD & ARLENE	6421 ANGEL MOUNTAIN AVE LAS VEGAS NV 89130-1861	12535414043
CARY REHNA C	6489 ABBOTSFORD HOUSE CT LAS VEGAS NV 89130-2308	13802110121
CASTANEDA WILMA S	4778 PRIORY GARDENS ST LAS VEGAS NV 89130-2310	13802110062
CASTO GERALD F & KATHLEEN M	6337 ECHO CANYON CIR LAS VEGAS NV 89130-5618	12535810016
CECILLO BRIAN & DIANE	4777 MARWOOD VILLA CT LAS VEGAS NV 89130-2369	13802110041
CHAVEZ ANGELICA	MESTA JOSE ROBERT 8923 SNOWTRACK AVE LAS VEGAS NV 89149	13802110007
CHAVEZ JOSE M & MARGARITA L	4809 AMERICANWOOD ST LAS VEGAS NV 89130-5629	12535811018
CHAVEZ SYLVIA TRUST	CHAVEZ SYLVIA V TRS 6320 SIERRA PINES CT LAS VEGAS NV 89130-2343	13802610004
CHENG KIN HUNG	LIN DAN-QING 63 CAMPBELL DR EASTHAMPTON MA 01027-2733	12535411030
CHILDRESS JAMES & GEORGIA FAM TR	CHILDRESS JAMES D & GEORGIA TRS 4201 JORY TRL LAS VEGAS NV 89108-5210	12535805008
CHILDRESS JAMES & GEORGIA FAM TR	CHILDRESS JAMES D & GEORGIA TRS 4201 JORY TRL LAS VEGAS NV 89108-5210	12535805006
CHILDRESS JAMES & GEORGIA FAM TR	CHILDRESS JAMES D & GEORGIA TRS 4201 JORY TRL LAS VEGAS NV 89108-5210	12535805007
CHIN LOIS	4778 MEREWORTH CT LAS VEGAS NV 89130-2367	13802110044

**Report of All Selected Parcels****Case Number:** VAR-56177**Printed On:** Mon: January 5, 2015

<b>Owner</b>	<b>Address</b>	<b>Parcel Number</b>
CHING CHARLIE HO & DOLORES HO	P O BOX 508 PAGO PAGO AS 96799	13802110040
CHURCH BAPTIST LONE MOUNTAIN	6319 W LONE MOUNTAIN RD LAS VEGAS NV 89130-2134	13802501004
CHURCH CHRISTIAN CANYON RIDGE	6200 W LONE MOUNTAIN RD LAS VEGAS NV 89130-2118	12535803004
CILIBERTO CHARMAINE	6417 ANGEL MOUNTAIN AVE LAS VEGAS NV 89130-1861	12535414044
COHEN ALAN K & MYRNA B	4817 GENTLE PINES CT LAS VEGAS NV 89130-5627	12535811036
COLE JEFFREY WADE	COLE PAULA SIMBRO 4527 ORRINGTON RD CORONA DEL MAR CA 92625-3121	12535416039
COLE WY PORTFOLIO NV L L C	1328 DUBLIN RD #300 COLUMBUS OH 43215	13802203003
COLEMAN MICHAEL A & JOYCE ANN	4801 AMERICANWOOD ST LAS VEGAS NV 89130-5629	12535811016
COLFIN AI-NV 2 L L C	9305 E VIA VENTURA #201 SCOTTSDALE AZ 85258	13802110017
COLFIN AI-NV 2 L L C	9305 E VIA DE VENTURA #201 SCOTTSDALE AZ 85258	13802110028
COMRIE CAROL A	6425 SUNDOWN HEIGHTS AVE LAS VEGAS NV 89130-1857	12535413021
CONSTANTINO ESTELA ESER	6481 ARROW COTTAGE CT LAS VEGAS NV 89130	13802110107
CONTI GIUSEPPE & BELINDA I	6261 KRAFT AVE LAS VEGAS NV 89130-2355	13802511072
CONTRERAS CLEMENTE A	4820 AMERICANWOOD ST LAS VEGAS NV 89130-5628	12535811011
COOKE LIVING TRUST	COOKE DOUGLAS J & PATRICIA L TRS 4321 COBBLEHILL WY NORTH LAS VEGAS NV 89032-0176	12535811032
COOPER ADAM D	6336 CEDAR GROVE CIR LAS VEGAS NV 89130-5622	12535810023
COOPER CHAD E	6481 ABBOTSFORD HOUSE CT LAS VEGAS NV 89130-2308	13802110119
COOPER JOHN A & DEIDRA A	12452 SAINT MARK GARDEN GROVE CA 92845	13802110106
COOPER TIMOTHY A	104 BRIGHTWATER DR ANNAPOLIS MD 21401-4520	13802511038
CORTEZ ROSA	P O BOX 10522 ROCKVILLE MD 20849-0522	13802110053
COSTELLO BARRY	233 BROAD ST P O BOX 37 NEVADA CITY CA 95959-0037	13802610011
COYLE JAMES	6264 HILL HAVEN AVE LAS VEGAS NV 89130-2346	13802511032
CREEL BRAD C & BRAD	4900 TINDARI ST LAS VEGAS NV 89130-2119	12535812014
CROMER ASHLEY ANN	6305 HILL HAVEN AVE LAS VEGAS NV 89130-2353	13802511050
CRUMB JANINE R	12947 72ND AVE NORTHEAST KIRKLAND WA 98034-1655	13802110022
D D C DEALS	P O BOX 43876 LAS VEGAS NV 89116-1876	13802110068
D W REALTY HOLDINGS INC	3145 LIGHTHOUSE RIDGE LN SAN DIEGO CA 92110-5342	13802110021
DAMES MICHAEL W & CAROLINE R	4813 AMERICANWOOD ST LAS VEGAS NV 89130-5629	12535811019
DANIELS STELLA REVOCABLE LIV TR	DANIELS STELLA LAWRENCE TRS 6336 ECHO CANYON CIR LAS VEGAS NV 89130-5617	12535810015
DAVID ERNESTO & VIOLETA TR 2007	DAVID ERNESTO G & VIOLETA V TRS 4746 PRIORY GARDENS ST LAS VEGAS NV 89130-2309	13802110069
DAVIES EVAN LEROY & LAURA L	8620 COPPER KNOLL AVE LAS VEGAS NV 89129-7651	13802501003

**Report of All Selected Parcels****Case Number:** VAR-56177**Printed On:** Mon: January 5, 2015

<u>Owner</u>	<u>Address</u>	<u>Parcel Numbe</u>
DAVIS DARREL	4771 SWEETWATER BLVD #188 SUGARLAND TX 77479-3121	12535414040
DAVIS JAMES M LIVING TRUST 2009	DAVIS JAMES M TRS 4754 PRIORY GARDENS ST LAS VEGAS NV 89130-2309	13802110067
DAYANAN HENRY	6308 CHIMNEY WOOD AVE LAS VEGAS NV 89130-2351	13802511010
DEAGOSTENO JOANN LIVING TRUST	DEAGOSTENO JOANN TRS 7114 LAKELAND RD LAS VEGAS NV 89145-6028	12535415057
DEAGOSTENO JOHN J & KATHLEEN A	6449 SIERRA DIABLO AVE LAS VEGAS NV 89130-1865	12535415058
DELAUNE PHILLIP CHARLES	4711 TRIMWATER CT LAS VEGAS NV 89130-2305	13802512007
DELGAUDIO SALVATORE	6400 SUNDOWN HEIGHTS AVE LAS VEGAS NV 89130-1854	12535413005
DENNEY CHARLES W & ELIZABETH S	4800 AMERICANWOOD LAS VEGAS NV 89130-5628	12535811015
DEZELL KARI	WATKINS TAURAN 6394 ADROCK LAS VEGAS NV 89110-2856	12535416007
DIAZ MARIBEL	4761 PRIORY GARDENS ST LAS VEGAS NV 89130	13802110102
DIAZ NESTOR L	4825 GENTLE PINES CT LAS VEGAS NV 89130-5627	12535811037
DIFLOURE JOHN BRUCE & SHARON L	504 VIA DE FORTUNA WY MESQUITE NV 89027-7608	12535416031
DILLON TERRY L & CRISTINA M	DILLON TERRY L & CRISTINA M 6281 CHIMNEY WOOD AVE LAS VEGAS NV 89130-2345	13802511022
DILLOW LOUIS FAMILY TRUST	DILLOW LOUIS C TRS 1900 SIROCCO CT LAS VEGAS NV 89117	13802610033
DIPAY CLAIRE	4781 MARWOOD VILLA CT LAS VEGAS NV 89130	13802110042
DIRAMIO LINA	4612 WINDY HOLLOW ST LAS VEGAS NV 89130-2350	13802511065
DODDS DEBI ELAINE	6481 ARBURY HALL CT LAS VEGAS NV 89130-2307	13802110113
DOSHI PRAFULL	406 GULPH RIDGE DR KING OF PRUSSIA PA 19406	13802110002
DOUGLAS E'LOH	22807 SHELL DR CARSON CA 90745-4743	13802110065
DOWNEY KATHLEEN M	4749 NEWBY HALL CT LAS VEGAS NV 89130-2361	13802110083
DUNN CYNTHIA L	6417 HILLSIDE BROOK AVE LAS VEGAS NV 89130-1836	12535416008
DUNNE JOSEPH E	HERRERA JOSE A 4820 GENTLE PINES CT LAS VEGAS NV 89130-5627	12535811026
EAP SEREY	1001 FIGUEROA TERR #310 LOS ANGELES CA 90012-1398	13802110071
EASTERN PACIFIC HOLDINGS CORP	4881 MAVERICK ST LAS VEGAS NV 89130-2157	12535805005
ECHELBARGER ALAN & SARAH	6325 HILL HAVEN AVE LAS VEGAS NV 89130-2353	13802511045
ELLIS HUI MEI	8101 W FLAMINGO RD #1044 LAS VEGAS NV 89147	13802511031
ENGLERT AUBREE M	6416 SIERRA DIABLO LAS VEGAS NV 89130-1863	12535416016
ENVALL PROPERTIES III L L C	54 ANCIENT HILLS LN HENDERSON NV 89074-1748	12535811020
F R E O NEVADA L L C	7702 E DOUBLETREE RANCH RD #100 SCOTTSDALE AZ 85258	13802511052
FARRARONS ENRIQUE ALPUERTO	CASTILLO ANGELLIE MARIE 5740 FRANKLIN AVE #109 HOLLYWOOD CA 90028-5737	13802110108
FEATHERAN CODY-TAYLOR K	4742 PRIORY GARDENS ST LAS VEGAS NV 89130	13802110070
FEDERAL NATIONAL MORTGAGE ASSN	135 N LOS ROBLES AVE PASADENA CA 91101	12535414042

**Report of All Selected Parcels****Case Number:** VAR-56177**Printed On:** Mon: January 5, 2015

<u>Owner</u>	<u>Address</u>	<u>Parcel Numbe</u>
FEDERAL NATIONAL MORTGAGE ASSN	1 HOME CAMPUS X2504-017 CUST SERV DES MOINES IA 50328	12535413039
FENECH PETER RENO	ANDREOFF CHARLIE 4793 GREENCOMBE CT LAS VEGAS NV 89130	13802110014
FENTON VIRGINIA A	6417 SUNDOWN HEIGHTS AVE LAS VEGAS NV 89130-1856	12535413023
FERNANDEZ EDUARDO & CHRISTINE A	6333 ECHO CANYON CIR LAS VEGAS NV 89130-5618	12535810017
FERNANDEZ FAMILY TRUST AGMT	FERNANDEZ ROBERT N TRS 6280 HILL HAVEN AVE LAS VEGAS NV 89130	13802511036
FISCHER CHARLENE L	126 EVERETT ST BRYSON CITY NC 28713	12535411028
FISCHER ROBERT W & CHARLENE L	P O BOX 1232 BRYSON CITY NC 28713-1232	12535416018
FITZPATRICK PHELTON & LILLIAN	4844 STORM MOUNTAIN ST LAS VEGAS NV 89130-1852	12535413001
FLORES RICARDOS	1548 18TH AVE OAKLAND CA 94606	13802110057
FOGELMAN TRUST	FOGELMAN LEO TRS 6265 CHIMNEY WOOD AVE LAS VEGAS NV 89130-2345	13802511026
FORWARD DANIEL GLEN SR TRUST	2920 S RAINBOW BLVD #120 LAS VEGAS NV 89146-6214	12535415034
FOSTER DIANE L SEPARATE PPTY TR	FOSTER DIANE L TRS 6333 CEDAR GROVE CIR LAS VEGAS NV 89130-5623	12535810025
FOUR D HOLDINGS L L C	1349 GALLERIA #200 HENDERSON NV 89014-8624	12535413007
FOURNIER MARC J	6337 KEY VISTA CIR LAS VEGAS NV 89130-5619	12535810020
FOUSEK RONALD S	7 N 3RD ST NEW FREEDOM PA 17349-9441	13802110038
FRAZIER CHARLES B & AMANDA M	6265 W KRAFT AVE LAS VEGAS NV 89130	13802511073
FREEDMAN HARVEY & GLORIA REV TR	6429 ANGEL MOUNTAIN AVE LAS VEGAS NV 89130-1861	12535414041
FREEMAN DAVID D & CAROLYN REV TR	FREEMAN DAVID D & CAROLYN M TRS 6253 CHIMNEY WOOD AVE LAS VEGAS NV 89130-2345	13802511029
FRENCH-SCHALK KARIN	6232 SIERRA PINES CT LAS VEGAS NV 89130-2341	13802610013
FUERST PROPERTIES L L C	12 BEACON BAY NEWPORT BEACH CA 92660	13802110074
FULTON RANDY D & KAZUYO I	17127 W BERNARDO DR #207 SAN DIEGO CA 92127-1513	13802110076
GABISAN HELEN D	DAVID MA FERLEN D III 4774 MARWOOD VILLA CT LAS VEGAS NV 89130-2369	13802110039
GALLINA MAMIE	6320 CHIMNEY WOOD AVE LAS VEGAS NV 89115	13802511013
GANTT ROBERT A JR & SHARON E P	6360 GENTLEWOOD AVE LAS VEGAS NV 89130	12535811005
GARCIA RAFAEL	REYES ELSA A 6440 HILLSIDE BROOK AVE LAS VEGAS NV 89130-1837	12535414051
GARCIA-VAZQUEZ MAURO	4905 CAPO GALLO ST LAS VEGAS NV 89130-2146	12535812004
GEE FAMILY TRUST	GEE THOMAS B & CYNTHIA A TRS 6372 GENTLEWOOD AVE LAS VEGAS NV 89130-5630	12535811002
GENESIS ACQUISITIONS CORPORATION	1350 E FLAMINGO RD #767 LAS VEGAS NV 89119	12535812003
GEORGE WILLIAM PATTERSON & KELLI	4409 CARIBOU WY LAS VEGAS NV 89108-5707	12535811021
GIBSON MICHAEL H & KATHLEEN C	6321 HILL HAVEN AVE LAS VEGAS NV 89130-2353	13802511046
GIUSTI KRISTY M & DAVID O	8590 W REGENA AVE LAS VEGAS NV 89149	12535811024
GLANKLER ADAM F	6333 YANKEE MEADOW CIR LAS VEGAS NV 89130	12535810013

**Report of All Selected Parcels****Case Number:** VAR-56177**Printed On:** Mon: January 5, 2015

<u>Owner</u>	<u>Address</u>	<u>Parcel Number</u>
GLINSKI DARIN L	MASONER-GLINSKI KRISTIN 3636 FAIRMONT LN OXNARD CA 93036-6331	13802511017
GOALEN SUSAN K	ENGLISH CYNTHIA THOMPSON 6404 SUNDOWN HEIGHTS AVE LAS VEGAS NV 89130-1854	12535413006
GOMEZ FRANCIS GASTON	5140 JAMAICA COAST CT NORTH LAS VEGAS NV 89031-3902	13802110063
GRABB DONALD W	7517 WHITE DEER CT LAS VEGAS NV 89131-3217	13802511002
GRADNEY GORDON R SR & JEWEL D	6336 KEY VISTA CIR LAS VEGAS NV 89130-5620	12535810019
GRANDBERRY SHANNELEE	P O BOX 71294 LAS VEGAS NV 89170-1294	13802110114
GRANT JOHN H & JANICE P LIV TR	GRANT JOHN H & JANICE P TRS 6376 GENTLEWOOD AVE LAS VEGAS NV 89130-5630	12535811001
GRECO LAURA	6408 HILLSIDE BROOK AVE LAS VEGAS NV 89130-1829	12535413038
GREEN JEAN M & WILLIAM W	6316 HILL HAVEN AVE LAS VEGAS NV 89130-2352	13802511042
GREEN JEFFREY	6409 QUANTUM LN LAS VEGAS NV 89130-1831	12535411031
GREENMEADOWS REALTY L L C	1404 S MARYLAND PKWY LAS VEGAS NV 89104-3315	13802110031
GREER ALAN	5852 N ROTHMANS AVE BOISE ID 83713	12535812012
GRIFFIN WILLIE H & PATRICIA A	6256 HILL HAVEN AVE LAS VEGAS NV 89130-2346	13802511030
GROSS RICHARD L & PATTI A	7450 STONELAKE ST LAS VEGAS NV 89131-3390	12535413036
GROSS RICHARD L & PATTI I	6424 ANGEL MOUNTAIN LAS VEGAS NV 89130-1859	12535413029
GRUSE DON	P O BOX 33985 LAS VEGAS NV 89133-3985	12535811017
GUIMAREY JAMIE & SERENA	6224 BUDNICK CIR LAS VEGAS NV 89130-2325	13802510052
GURDWARA BABA DEEP SINGH INC	P O BOX 571495 LAS VEGAS NV 89157-1495	13802501018
GURDWARA BABA DEEP SINGH INC	9312 RED TWIG DR LAS VEGAS NV 89134-1810	13802501002
GURUDAWARA BABA DEEP SINGH INC	P O BOX 571495 LAS VEGAS NV 89157-1495	13802501014
GUTIERREZ JAMIE & SOFIA	2332 WANDERING RIDGE DR CHINO HILLS CA 91709	13802110035
HABUDA DANIEL S	1271 PARKVIEW DR NORTH TONAWANDA NY 14120-4806	13802610007
HALBERG CAROL	6332 SIERRA PINES CT LAS VEGAS NV 89130-2343	13802610001
HAMMAREN JOANNE	BURROUGHS MICHAEL LEE 4720 TRIMWATER CT LAS VEGAS NV 89130-2305	13802512005
HANKINS CARL WALDEN	6256 CHIMNEY WOOD AVE LAS VEGAS NV 89130-2300	13802511082
HARMER THOMAS E	6272 CHIMNEY WOOD AVE LAS VEGAS NV 89130-2300	13802511078
HARMON JODI LEE	6421 SUNDOWN HEIGHTS AVE LAS VEGAS NV 89130-1856	12535413022
HATTER COLLEEN	6228 BUDNICK CIR LAS VEGAS NV 89130-2325	13802510053
HAWKINS TRUST	HAWKINS WILLIAM A & JOYCE D TRS 6416 SUNDOWN HEIGHTS AVE LAS VEGAS NV 89130-1854	12535413009
HAYES-MCKEIRNAN ELIZABETH	6485 ABBOTSFORD HOUSE CT LAS VEGAS NV 89130-2308	13802110120
HEALY STEPHEN E & JACQUELINE M	906 SQUAW PEAK DR HENDERSON NV 89014-0355	12535413026
HEATH JESSIE LEA FAMILY TRUST	HEATH JESSIE L TRS 6324 HILL HAVEN AVE LAS VEGAS NV 89130-2352	13802511044

**Report of All Selected Parcels****Case Number:** VAR-56177**Printed On:** Mon: January 5, 2015

<u>Owner</u>	<u>Address</u>	<u>Parcel Numbe</u>
HENDERSON BREYONNA	4773 LONGSTOCK CT LAS VEGAS NV 89130-2363	13802110058
HERRERA AGUSTIN & CENAYDA	4800 GENTLE PINES CT LAS VEGAS NV 89130-5627	12535811031
HERRMANN SONIA M	6264 CHIMNEY WOOD AVE LAS VEGAS NV 89130-2300	13802511080
HEUER SUSAN E	6261 HILL HAVEN AVE LAS VEGAS NV 89130-2347	13802511058
HILLSIDE BROOK L L C	9204 GOLDEN EAGLE DR LAS VEGAS NV 89134-6162	12535414052
HINES JOHNIE W & SANDRA J	6400 QUANTUM LN LAS VEGAS NV 89130-1830	12535411001
HOFBAUER WILLIAM & MARIA FAM TR	HOFBAUER WILLIAM E & MARIA E TRS 6429 SUNDOWN HEIGHTS AVE LAS VEGAS NV 89130-1857	12535413020
HOFFMAN ROBERT T & MARJORIE	4809 GENTLE PINES CT LAS VEGAS NV 89130-5627	12535811034
HOLMAN JUSTIN L	4766 BURGESS PARK CT LAS VEGAS NV 89130-2362	13802110100
HOMMEL CHARLES FAMILY TRUST	HOMMEL CHARLES E & BARBARA A TRS 6277 CHIMNEY WOOD AVE LAS VEGAS NV 89130-2345	13802511023
HORNE DARNESE SR & FLORENE J	6325 KRAFT AVE LAS VEGAS NV 89130-2357	13802511001
HOUSTON LUZMARIA Q & STEVEN	6742 BAYHAM ABBEY CT LAS VEGAS NV 89130	13802110097
HUANG KAI QIN	LIANG MELANIE 3293 ELK CLOVER ST LAS VEGAS NV 89135	13802513003
HUANG KAI QIN	LIANG MELANIE 3293 ELK CLOVER ST LAS VEGAS NV 89135	13802513002
HUEY JOHN P	91-1162 LANAKOI ST KAPOLEI HI 96707	13802110098
HUGHES CHRIS G REVOCABLE LIV TR	HUGHES CHRIS G TRS 4812 STORM MOUNTAIN ST LAS VEGAS NV 89130-1872	12535416040
HUGHES JOHN C	6441 SIERRA DIABLO AVE LAS VEGAS NV 89130-1871	12535416026
HUKBREGT GREG B	4828 STORM MOUNTIAN ST LAS VEGAS NV 89130-1872	12535416044
HUNGER RICHARD J JR	6305 CHIMNEY WOOD AVE LAS VEGAS NV 89130-2351	13802511020
I H 2 PROPERTY NEVADA L P	21001 N TATUM BLVD #1630-630 PHOENIX AZ 85050	12535810024
I H 2 PROPERTY NEVADA L P	21001 N TATUM BLVD #1630-630 PHOENIX AZ 85050	12535812016
ICENHOWER STEVEN & PATRIA	PSC 78 BOX 715 APO AP	13802512010
ION ROBIN L	6424 HILLSIDE BROOK AVE LAS VEGAS NV 89130-1829	12535414047
ISBELL TODD L	6480 ARBURY HALL CT LAS VEGAS NV 89130-2307	13802110118
IVO SANDRA S	6409 SIERRA DIABLO AVE LAS VEGAS NV 89130-1864	12535416034
IVO SANDRA S	6409 SIERRA DIABLO AVE LAS VEGAS NV 89130-1864	13802511083
J & D PROPERTY HOLDINGS L L C	645 PINNACLE CT MESQUITE NV 89027	13802510037
J A D 1964 INVESTMENT L L C	M & M SMITH 4745 N TEE PEE LN LAS VEGAS NV 89129-2636	12535413010
J A D INVESTMENT TRUST	SMITH JAMES B TRS 4745 N TEE PEE LN LAS VEGAS NV 89129-2636	12535413012
J L V N INVESTMENTS LTD	2530 BRAEHEAD LN HENDERSON NV 89044	13802110004
JACOBS MEREDITH	4778 MORTON MANOR CT LAS VEGAS NV 89130-2371	13802110032

**Report of All Selected Parcels****Case Number:** VAR-56177**Printed On:** Mon: January 5, 2015

<u>Owner</u>	<u>Address</u>	<u>Parcel Numbe</u>
JAMES BOBBY	6356 MARATEA LAS VEGAS NV 89130-2111	12535812041
JEANROY FAMILY TRUST	JEANROY THOMAS L & SUE A TRS 6257 KRAFT AVE LAS VEGAS NV 89130-2355	13802511071
JEW FAMILY TRUST	JEW DOROTHY M & DENNIS L TRS 6268 CHIMNEY WOOD AVE LAS VEGAS NV 89130-2300	13802511079
JOHNSON RICHARD & V LIV TR	JOHNSON RICHARD & VIRGINIA TRS 4732 N TORREY PINES DR LAS VEGAS NV 89130-2302	13802501019
JOHNSON WILLIAM H	6321 CHIMNEY WY LAS VEGAS NV 89130	13802511016
JOHNSTON RORY W & CATHERINE D	4812 GENTLE PINES CT LAS VEGAS NV 89130-5627	12535811028
JONES JUNE	6277 KRAFT AVE LAS VEGAS NV 89130-2355	13802511076
JUILFS HANNAH R	4782 LONGSTOCK CT LAS VEGAS NV 89130-2363	13802110055
JUNGERS LYNN	804 EASTVIEW DR LAS VEGAS NV 89115	13802511047
JUNIOR RODNEY	6364 MARATEA AVE LAS VEGAS NV 89130-2111	12535812043
K & D HOLDINGS L L C	3208 W SR 426 #2060 OVIEDO FL 32765-8656	13802110033
KERBY MARY LOUISE TRUST 1997	KERBY MARY LOUISE TRS 4845 STORM MOUNTAIN ST LAS VEGAS NV 89130-1853	12535413004
KNOX KEITH B & KATHERINE A	4829 GENTLE PINES CT LAS VEGAS NV 89130-5627	12535811038
KOCH THOMAS L	6228 DORCHESTER CIR LAS VEGAS NV 89130-2321	13802510023
KRAMER THADDEUS LANE	6308 HILL HAVEN AVE LAS VEGAS NV 89130-2352	13802511040
KROL ALEKSANDER	1682 APAPUS LN SAN JACINTO CA 92583	12535416038
KUO FUNG CHONG C	1712 S MONTEREY ST ALHAMBRA CA 91801-5457	12535812044
KUOCH PETER L C & SUTTHY EAP	4055 HOOSIER LAWN WY YORBA LINDA CA 92886-7026	13802110024
LA TONY K & JUDY M	6228 SIERRA PINES CT LAS VEGAS NV 89130	13802610014
LABRECQUE SEAN	6412 SIERRA DIABLO AVE LAS VEGAS NV 89130-1863	12535416015
LABUTTI RONALD J & SUSAN REV TR	LABUTTI RONALD J & SUSAN A TRS 6241 SIERRA PINES CT LAS VEGAS NV 89130-2342	13802610027
LAGLIVA LOUIE & JANETTE	4912 CAPO GALLO ST LAS VEGAS NV 89130-2146	12535812046
LAIKEN STEVE G & MARIA T	6273 W KRAFT AVE LAS VEGAS NV 89130	13802511075
LANGE BRYAN R & JERI A	6269 KRAFT AVE LAS VEGAS NV 89130-2355	13802511074
LANGHAM GREGORY	6253 HILL HAVEN AVE LAS VEGAS NV 89130-2347	13802511060
LARA HUGO	6313 SIERRA PINES CT LAS VEGAS NV 89130-2344	13802610032
LEISHMAN SHERRI F & SHERRI	6364 GENTLEWOOD AVE LAS VEGAS NV 89130-5630	12535811004
LEUNG ON WAH MONICA	4745 NEWBY HALL ST LAS VEGAS NV 89130	13802110082
LEUNG YIM THONG	LUO YUNDI 15 CRESTVIEW AVE DALY CITY CA 94015-4502	13802110084
LIEBLIN GEMA TRUST	LOPEZ TONEY E SR & LUPE G TRS 6260 CHIMNEY WOOD AVE LAS VEGAS NV 89130-2300	13802511081
LIGHT DEBORAH	4824 GOLFRIDGE DR LAS VEGAS NV 89130-5616	12535810033
LIM PETER CHEN-LEONG	CHUAH LAY HONG 20 VIA SIENNA DANA POINT CA 92629-3358	13802110051

**Report of All Selected Parcels****Case Number:** VAR-56177**Printed On:** Mon: January 5, 2015

<u>Owner</u>	<u>Address</u>	<u>Parcel Number</u>
LINANG MANUEL L	SAEZ JOCELYN L 914 DRIFTWOOD DR SUISUN CITY CA 94585-2657	13802110023
LLACUNA JEFFREY BERNARD	87-1004 MOALI ST WAIANAE HI 96792	13802110112
LOCKYER ADAM T & AMY	4762 BURGESS PARK CT LAS VEGAS NV 89130-2362	13802110101
LOGAN THEODORE SR & JANICE	4816 GOLFRIDGE DR LAS VEGAS NV 89130-5616	12535810035
LOPEZ HILDA B	P O BOX 571695 LAS VEGAS NV 89157-1695	13802110105
LOPEZ ZADIA	6420 ANGEL MOUNTAIN AVE LAS VEGAS NV 89130-1859	12535413028
LORD TRACEY	4743 CALLE CAMARADA SANTA BARBARA CA 93110-2016	12535416011
LOUDEN MORRIE	6312 CHIMNEY WOOD AVE LAS VEGAS NV 89130-2351	13802511011
LUJAN-LUJAN CLAUDIA A	6371 MARATEA AVE LAS VEGAS NV 89130-2111	12535812008
LYNCH STEPHANIE	6440 SIERRA DIABLE AVE LAS VEGAS NV 89130-1870	12535416022
LYON JOHN J LIVING TRUST	LYON JOHN J TRS 163 113TH ST PLEASANT PRAIRIE WI 53158-5220	13802511069
MA RAYMOND & JANICE	1710 LOUISE AVE ARCADIA CA 91006-4648	13802110072
MADSEN CHARLES C & NANCY L	6437 ANGEL MOUNTAIN AVE LAS VEGAS NV 89130	12535414039
MALDONADO JONATHON C TRUST	MALDONADO JONATHON C TRS 4804 GOLFRIDGE DR LAS VEGAS NV 89130	12535810038
MALONEY KATHLEEN	4824 STROM MOUNTAIN ST LAS VEGAS NV 89130-1872	12535416043
MANHEIM FAMILY TRUST SURV TR	MANHEIM FAMILY TRUST CREDIT TR 4049 VIA MARINA MILL MARINA DEL REY CA 90292	12535413042
MARCHELLO CRAIG	6405 SIERRA DIABLO AVE LAS VEGAS NV 89130-1864	12535416035
MARCIANO DIANNE	KUDER AMY JANE 6416 ANGEL MOUNTAIN AVE LAS VEGAS NV 89130-1858	12535413027
MARSHALL KELLY DON & PATRICE L	4820 GOLFRIDGE DR LAS VEGAS NV 89130-5616	12535810034
MARTIN BEVERLY L	6316 CHIMNEY WOOD AVE LAS VEGAS NV 89130-2351	13802511012
MARTINAT MARY LOU	6281 HILL HAVEN AVE LAS VEGAS NV 89130-2348	13802511053
MARTINEZ ALBERT F & JULIE A	4813 GENTLE PINES CT LAS VEGAS NV 89130-5627	12535811035
MARTINEZ DANIEL	6224 DORCHESTER CIR LAS VEGAS NV 89130-2321	13802510022
MAURY ANITA M	6324 SIERRA PINES CT LAS VEGAS NV 89130-2343	13802610003
MCCLONDON LILIT	957 GALLERY CT SAN DIEGO CA 92114-6509	13802610035
MCDOWELL SYLVIA & ROY	6312 HILL HAVEN AVE LAS VEGAS NV 89130	13802511041
MCGRAIL JOHN M & DIANA	6258 W KRAFT AVE LAS VEGAS NV 89130-2354	13802512002
MCGREEVEY MARGARET	4700 N TORREY PINES DR LAS VEGAS NV 89130-2302	13802501013
MCGUIRE PATRICIA & MICHAEL J	6300 SIERRA PINES CT LAS VEGAS NV 89130	13802610009
MCINTOSH RONALD J & CYNTHIA E	4812 AMERICANWOOD ST LAS VEGAS NV 89130-5628	12535811013
MCINTYRE FAMILY TRUST 2010	MCINTYRE JOHN W & VICTORIA J TRS 4616 BRADPOINT DR LAS VEGAS NV 89130-5247	12535416010
MCKINNEY DONALD G	4798 CANNON HILL CT LAS VEGAS NV 89130-2364	13802110006

**Report of All Selected Parcels**

**Case Number:** VAR-56177

**Printed On:** Mon: January 5, 2015

<u>Owner</u>	<u>Address</u>	<u>Parcel Number</u>
MCMILLAN CASSANDRA M	4816 GENTLE PINES CT LAS VEGAS NV 89130-5627	12535811027
MEADOWBROOK HOMEOWNERS ASSN	4815 W RUSSELL RD #15-0 LAS VEGAS NV 89118-6241	13802110129
MEADOWBROOK HOMEOWNERS ASSN	4815 W RUSSELL RD #15-0 LAS VEGAS NV 89118-6241	13802110137
MEADOWBROOK HOMEOWNERS ASSN	4815 W RUSSELL RD #15-0 LAS VEGAS NV 89118-6241	13802110126
MEADOWBROOK HOMEOWNERS ASSN	4815 W RUSSELL RD #15-0 LAS VEGAS NV 89118-6241	13802110125
MEADOWBROOK HOMEOWNERS ASSN	4815 W RUSSELL RD #15-0 LAS VEGAS NV 89118-6241	13802110145
MEADOWBROOK HOMEOWNERS ASSN	4815 W RUSSELL RD #15-0 LAS VEGAS NV 89118-6241	13802110140
MEADOWBROOK HOMEOWNERS ASSN	4815 W RUSSELL RD #15-0 LAS VEGAS NV 89118-6241	13802110139
MEADOWBROOK HOMEOWNERS ASSN	4815 W RUSSELL RD #15-0 LAS VEGAS NV 89118-6241	13802110133
MEADOWBROOK HOMEOWNERS ASSN	4815 W RUSSELL RD #15-0 LAS VEGAS NV 89118-6241	13802110131
MEADOWBROOK HOMEOWNERS ASSN	4815 W RUSSELL RD #15-0 LAS VEGAS NV 89118-6241	13802110130
MEADOWBROOK HOMEOWNERS ASSN	4815 W RUSSELL RD #15-0 LAS VEGAS NV 89118-6241	13802110143
MEADOWBROOK HOMEOWNERS ASSN	4815 W RUSSELL RD #15-0 LAS VEGAS NV 89118-6241	13802110134
MEADOWBROOK HOMEOWNERS ASSN	4815 W RUSSELL RD #15-0 LAS VEGAS NV 89118-6241	13802110142
MEADOWBROOK HOMEOWNERS ASSN	4815 W RUSSELL RD #15-0 LAS VEGAS NV 89118-6241	13802110138
MEADOWBROOK HOMEOWNERS ASSN	4815 W RUSSELL RD #15-0 LAS VEGAS NV 89118-6241	13802110132
MEADOWBROOK HOMEOWNERS ASSN	4815 W RUSSELL RD #15-0 LAS VEGAS NV 89118-6241	13802110141
MEADOWBROOK HOMEOWNERS ASSN	4815 W RUSSELL RD #15-0 LAS VEGAS NV 89118-6241	13802110135
MEADOWBROOK HOMEOWNERS ASSN	4815 W RUSSELL RD #15-0 LAS VEGAS NV 89118-6241	13802110136
MILAS JOHN A REVOCABLE TRUST	6401 SIERRA DIABLO AVE LAS VEGAS NV 89130-1864	12535416036
MILLER TAWN	BHAKTA REISA 7630 CHANTILLY ISLAND CT LAS VEGAS NV 89123	13802110049
MILLINGTON WARREN R & D LIV TR	MILLINGTON DOROTHY & WARREN TRS 11013 CLEAR MEADOWS DR LAS VEGAS NV 89134	12535414050
MILLS HOWARD C & MARGARET LIV TR	MILLS HOWARD C & MARGARET R TRS 6300 CHIMNEY WOOD AVE LAS VEGAS NV 89130-2351	13802511008
MILSAP MICHAEL R	DRUMMOND NORBURTH P 399 HANCOCK ST BROOKLYN NY 11216-2414	13802110110
MINERS GOLD F L P	5783 HICKAM AVE LAS VEGAS NV 89130-2512	12535811008
MIRER TRUST	MIRER SCOTT D & ANGE M TRS 217 CLIFTON AVE SAN CARLOS CA 94070-1752	12535413040
MISCEVIC CAROL J	6224 MINERVA DR LAS VEGAS NV 89130-2315	13802510007
MOHON PATSY L	HARTMAN KAREN L 6305 SIERRA PINES CT LAS VEGAS NV 89130-2344	13802610030
MOORE S DAVID & JENNIFER L	7604 PAINTED DUNES DR LAS VEGAS NV 89149-6416	12535416021
MORALES TIFFANY R	MORALES-VIDANA OMAR A 4781 MANDERSTON CT LAS VEGAS NV 89130-2365	13802110054
MORLEY JAMES P & PATRICIA J	7295 N MONTE CRISTO WY LAS VEGAS NV 89131-3335	12535414054
MOSELEY GLADYS J	4832 STORM MOUNTAIN ST LAS VEGAS NV 89130-1851	12535413041

**Report of All Selected Parcels****Case Number:** VAR-56177**Printed On:** Mon: January 5, 2015

<u>Owner</u>	<u>Address</u>	<u>Parcel Number</u>
MOSES LINDA K & GLEN A	6356 GENTLEWOOD AVE LAS VEGAS NV 89130-5630	12535811006
MOUNTAIN GATE HOMEOWNERS ASSN	601 WHITNEY RANCH #B-10 HENDERSON NV 89014-2643	12535413043
MUNOZ XAVIER	6329 SIERRA PINES CT LAS VEGAS NV 89130-2344	13802610036
MURPHY ALYCIA & DAVID	6276 HILL HAVEN AVE LAS VEGAS NV 89130-2349	13802511035
MURRAY JULIE D	4816 AMERICANWOOD ST LAS VEGAS NV 89130	12535811012
MUSLIU XHEVAT & DRITA	6363 MARATEA AVE LAS VEGAS NV 89130-2111	12535812010
NAVARRO GERARDO	6262 KRAFT AVE LAS VEGAS NV 89130-2354	13802512003
NEUMULLER ROBERT J & CARYN R	4804 GENTLE PINES CT LAS VEGAS NV 89130-5627	12535811030
NICHOLS NICOLE R	4794 CANNON HILL CT LAS VEGAS NV 89130-2364	13802110005
NIEDBALSKI DAVID GEORGE & MARIA	6261 CHIMNEY WOOD AVE LAS VEGAS NV 89130	13802511027
NOVICH DAVID G & JENNIFER ARDEN	6428 HILLSIDE BROOK AVE LAS VEGAS NV 89130-1829	12535414048
OLIVE FAMILY TRUST	OLIVE HARLIE R & PHYLLIS C TRS 4620 WINDY HOLLOW ST LAS VEGAS NV 89130-2350	13802511067
OMOTO KENJI REVOCABLE TRUST	OMOTO KENJI TRS 6301 CHIMNEY WOOD AVE LAS VEGAS NV 89130-2351	13802511021
ORANGEROOT L L C	6413 HILLSIDE BROOK AVE LAS VEGAS NV 89130-1836	12535416009
ORTEGA & DELGADO REVOCABLE TRUST	ORTEGA LUIS A TRS 26 WILLOWBROOK LN PHILLIPS RANCH CA 91766	13802110075
OSBORN PATRICIA A	6245 SIERRA PINES CT LAS VEGAS NV 89130-2342	13802610028
OWEN SHIRLEY A	6413 SIERRA DIABLO AVE LAS VEGAS NV 89130-1864	12535416033
PAGADORA TEDDY & ROSITA	2528 S PEPPERDALE DR ROWLAND HEIGHTS CA 91748-4926	13802110111
PAJAK JEFFREY S	BENJAMIN PAMELA J 4812 GOLFRIDGE DR LAS VEGAS NV 89130-5616	12535810036
PALMER CECIL & JOYCE	5800 EMPEROR WY LAS VEGAS NV 89130	13802610029
PALMER JOYCE M & CECIL	5800 EMPEROR WY LAS VEGAS NV 89130-4904	12535416030
PANAMA INVESTORS	6600 HUNTER DR ROHNERT PARK CA 94928-2418	13802214008
PANZER LARRY	6417 QUANTUM LN LAS VEGAS NV 89130-1831	12535411029
PARHAM ROBERT & EDNA	6370 TEMPTING CHOICE AVE LAS VEGAS NV 89131	12535811010
PARTUSCH TIMOTHY G	PATUSCH SANDRA L 6368 GENTLEWOOD AVE LAS VEGAS NV 89130-5630	12535811003
PASKO PAULETTE	6304 HILL HAVEN AVE LAS VEGAS NV 89130-2352	13802511039
PATTERSON-WEBB WENDY	WEBB JASON 4797 PENCARROW CT LAS VEGAS NV 89130	13802110025
PAULSON YOSHIKO N	6420 HILLSIDE BROOK AVE LAS VEGAS NV 89130-1829	12535413035
PAYSON JEFFREY D & BONNIE G	7065 W ANN RD #130-512 LAS VEGAS NV 89130	13802513004
PETRINI ROSE	4604 WINDY HOLLOW ST LAS VEGAS NV 89130-2350	13802511063
PHETS L L C	AUM TRUST 2414 TWIN FLOWER CIR LAS VEGAS NV 89134-6006	13802110085
PICO-PEREZ RICARDO MARTIN	4793 PENCARROW CT LAS VEGAS NV 89130-2372	13802110026

**Report of All Selected Parcels****Case Number:** VAR-56177**Printed On:** Mon: January 5, 2015

<u>Owner</u>	<u>Address</u>	<u>Parcel Number</u>
PINHAS TAMIR	6271 VARIEL AVE #C WOODLAND HILLS CA 91367-2516	13802110081
PINTO ALBERT M & MARGARET J	6437 SIERRA DIABLO AVE LAS VEGAS NV 89130-1871	12535416027
PITZZ EUGENE P & JUDITH E A	6254 W KRAFT AVE LAS VEGAS NV 89130-2354	13802512001
PLAFKER LYNN	FREEDMAN GLORIA 6413 ANGEL MOUNTAIN AVE LAS VEGAS NV 89130-1860	12535414045
POORT FAMILY REVOCABLE LIVING TR	POORT HERBERT LEE & DEON TRS 4900 GOLFRIDGE DR LAS VEGAS NV 89130-5612	12535810032
POWELL GARY L & CRYSTA J	6405 QUANTUM LN LAS VEGAS NV 89130-1831	12535411032
PRIEST PETER R & PETER ROBERT	5429 SOUTHERN MANOR DR LAS VEGAS NV 89130-0106	12535812009
PURCELL FRANCIS A & JOY D DEC TR	PURCELL FRANCIS A JR & JOY D TRS 1850 CRESTVIEW DR PALM SPRINGS CA 92264-2601	13802511019
QUINTANA ERIC B	6379 MARATEA AVE LAS VEGAS NV 89130-2111	12535812006
QUIROZ RICARDO	FUENTES MARIA TERESA 4529 CHESTNUT DR NORTH LAS VEGAS NV 89032	12535416042
R1 INVESTMENTS L L C	8209 FOOTHILL BLVD #A138 SUNLAND CA 91040	13802110037
RADA ALAN D	6274 W KRAFT AVE LAS VEGAS NV 89130-2354	13802512009
RAHE BRUCE E & DEBRA REV LIV TR	RAHE BRUCE E & DEBRA K TRS 7304 BREEZY NIGHT CT LAS VEGAS NV 89129-5972	12535416028
RAMEY JAMES & DEALINA	6313 W KRAFT AVE LAS VEGAS NV 89130-2357	13802511004
RAMIREZ JUAN MIGUEL & MINERVA	6300 W LONE MOUNTAIN RD LAS VEGAS NV 89130-2116	12535805004
RANCHO 888 L L C	P O BOX 65157 VANCOUVER WA 98665	13802214002
RANCHO LONE MOUNTAIN L L C	9075 W DIABLO DR 3RD FLR LAS VEGAS NV 89148	13802102014
RANCHO LONE MTN MINI STORAGE LLC	9040 W EL CAMPO GRAND LAS VEGAS NV 89149-3319	13802111003
RANCHO PINES BUSINESS PARK L L C	13949 VENTURA BLVD #300 SHERMAN OAKS CA 91423	13802214012
RANDALL RICHARD R & B REV LIV TR	RANDALL RICHARD R & BARBARA TRS 4800 STORM MOUNTAIN ST LAS VEGAS NV 89130-1872	12535416037
RASMUSSEN DENTON K	6225 SADLER DR LAS VEGAS NV 89130-2324	13802510039
RAVIZ JACINTO R JR & ALEGRIA P	6336 YANKEE MEADOW CIR LAS VEGAS NV 89130-5615	12535810011
REED CHERYL A	6433 HILLSIDE BROOK AVE LAS VEGAS NV 89130-1838	12535416004
REEDER CHARLES T & VEANNE M	6265 HILL HAVEN AVE LAS VEGAS NV 89130-2347	13802511057
REIFEL STEPHEN A & JULIE M	6225 MINERVA DR LAS VEGAS NV 89130-2316	13802510009
REZENDE MARCIO	REZENDE FLAVIO & ELAINE 6268 HILL HAVEN AVE LAS VEGAS NV 89130-2346	13802511033
RICEBERG FAMILY REV LIV TR AGMT	RICEBERG HARVEY B & JANIS L TRS 2289 TURNER FALLS ST HENDERSON NV 89044-1041	13802110048
RICHARDS RODNEY E	4789 PENCARROW CT LAS VEGAS NV 89130-2372	13802110027
RIVERA LUIS A & ANGELA M	12819 RIVERSIDE DR #316 VALLEY VILLAGE CA 91607	13802110030
RIZZA FAMILY TRUST EXEMPTION TR	RIZZA EVELYN C TRS 5221 SANDY CACTUS LN LAS VEGAS NV 89149-4622	13802510024
ROBERTS RICHARD	6501 SIERRA DIABLO AVE LAS VEGAS NV 89130-1867	12535415056
ROBINETTE COURTNEY K	HUMM DAVID H 4793 HAMPSTEAD HEATH CT LAS VEGAS NV 89130-2370	13802110020

**Report of All Selected Parcels****Case Number:** VAR-56177**Printed On:** Mon: January 5, 2015

<u>Owner</u>	<u>Address</u>	<u>Parcel Number</u>
RODRIGUEZ ANTONIO	17749 CALCUTTA ST LA PUENTE CA 91744-5315	13802110029
ROGERS JUSTIN	6337 YANKEE MEADOW CIR LAS VEGAS NV 89130-5615	12535810012
ROMERO GABRIEL & MARIA	6313 HILL HAVEN AVE LAS VEGAS NV 89130-2353	13802511048
ROSEMILT INVESTMENTS L L C	282 N SALTAIR AVE LOS ANGELES CA 90049	13802511037
RUSSELL JULIE A	4816 STORM MOUNTAIN ST LAS VEGAS NV 89130-1872	12535416041
RUSSELL RICHARD & FELECIA REV TR	RUSSELL RICHARD D & FELECIA TRS 20302 TIMBERED ESTATES CARLINVILLE IL 62626-3943	13802610005
RUSSELL THEODORE EVELYN	6309 HILL HAVEN AVE LAS VEGAS NV 89130	13802511049
S F R 2012-1 U S WEST L L C	325 NORTH LOS ROBLES AVE 4TH FLR MAILSTOP 100 PASADENA CA 91101-1707	13802110019
SAIZ ROBERTA	6417 SIERRA DIABLO AVE LAS VEGAS NV 89130-1864	12535416032
SALAMI GEORGE DIB REV LIV TR	SALAMI GEORGE DIB TRS 6408 QUANTUM LN LAS VEGAS NV 89130-1830	12535411003
SALZANO SERGIO & CHERYL FAM TR	SALZANO SERGIO TRS 4935 BACKHORN BUTTE CT LAS VEGAS NV 89149-5259	13802214013
SANCHEZ EVETTE	4765 PRIORY GARDENS ST LAS VEGAS NV 89130	13802110103
SARDINAS UBALDO JR	6281 W LONE MOUNTAIN RD LAS VEGAS NV 89130-2101	13802501006
SCHERADO K W JR & P A REV LIV TR	SCHERADO KENNETH W JR & P A TRS 6301 W LONE MOUNTAIN RD LAS VEGAS NV 89130-2117	13802501005
SCHOFIELD ROGER T & DAWN M	4808 GOLFRIDGE DR LAS VEGAS NV 89130-5611	12535810037
SCHREYER-CIMINO S SEP PPTY TR	SCHREYER-CIMINO SHERRY TRS 8813 VILLA RIDGE DR LAS VEGAS NV 89134-8535	12535413034
SCHWARTZ DAVID H	6332 KEY VISTA CIR LAS VEGAS NV 89130-5620	12535810018
SCHWEBS KIM J	6372 MARATEA AVE LAS VEGAS NV 89130-2111	12535812045
SETSUMASA AYAKO	6488 ABBOTSFORD HOUSE CT LAS VEGAS NV 89130-2308	13802110122
SEUSS FAMILY TRUST 2011	SUESS MICHAEL R & SHANNON 2617 S DEANNE DR HACIENDA HEIGHTS CA 91745-5320	12535812005
SFONDILIAS BARBARA REV LIV TR	SFONDILIAS BARBARA J TRS 6304 SIERRA PINES CT LAS VEGAS NV 89130-2341	13802610008
SHAMTOUB PEYMAN & JIM	371 S ELM DR BEVERLY HILLS CA 90212	12535416005
SHEPPARD BERNICE L	6309 W KRAFT AVE LAS VEGAS NV 89130-2357	13802511005
SHITANISHI GARETT	3745 HILLARY ELAN CT LAS VEGAS NV 89139	12535413030
SILVA WILLIAM	6265 W LONE MOUNTAIN LAS VEGAS NV 89130-2101	13802501007
SINGH GURDEV	SINGH KARAMJIT P O BOX 95664 LAS VEGAS NV 89193-5664	13802501001
SINN RICHARD & SOPHEA	24647 STONEGATE DR WEST HILLS CA 91304-5273	13802110012
SISTI FRANK & BETTY	6229 SADLER DR LAS VEGAS NV 89130-2324	13802510038
SMART ASSET INVESTMENTS L L C	5850 W DESERT INN RD LAS VEGAS NV 89146-6715	12535416017
SOLLBERGER DONNA M	6425 HILLLSIDE BROOK AVE LAS VEGAS NV 89130	12535416006
SOSA CHRISTINA R	4766 PRIORY GARDENS ST LAS VEGAS NV 89130-2309	13802110064
SOUTHWEST COLLEGE	2121 W GARVEY AVE N WEST COVINA CA 91790	13802113001

**Report of All Selected Parcels****Case Number:** VAR-56177**Printed On:** Mon: January 5, 2015

<u>Owner</u>	<u>Address</u>	<u>Parcel Number</u>
SPIGEL KIRA D	4758 PRIORY GARDENS ST LAS VEGAS NV 89130-2309	13802110066
SPINELLI CRYSTAL R & GEORGE	6448 SIERRA DIABLO AVE LAS VEGAS NV 89130-1870	12535416024
SPOTOFORA NICOLE L	6453 HILLSIDE BROOK AVE LAS VEGAS NV 89130-1847	12535415032
SPROWL GARY E & KATHLEEN A	6352 GENTLEWOOD AVE LAS VEGAS NV 89130-5630	12535811007
STAJKOWSKI BRIAN D	4782 PRIORY GARDENS ST LAS VEGAS NV 89130-2310	13802110061
STAMATIS NICHOLAS P	1811 BASLIA LN SPRING HILL TN 37174-6124	12535413031
STANLEY JOSEPH R & CHARLOTTE L	6328 SIERRA PINES CT LAS VEGAS NV 89130-2343	13802610002
STAPLES EUGENE G	HOFHEINS PAMELA D 6273 CHIMNEY WOOD AVE LAS VEGAS NV 89130-2345	13802511024
STEFFENS THOMAS JAMES & SANDRA L	407 VICTOR HUGO DR CARY NC 27511-6388	12535413037
STEWART DAVID E	4825 AMERICANWOOD ST LAS VEGAS NV 89130-5629	12535811022
STONE JOSEPH R & DANA L	6272 HILL HAVEN AVE LAS VEGAS NV 89130-2346	13802511034
SULEWSKI KRZYSZTOF	210 8TH AVENUE S EDMONDS WA 98020-3430	13802110086
SUMMERS FAMILY TRUST	SUMMERS CHARLES D & CAROLE H TRS 12429 PINE CREEK RD CERRITOS CA 90703-2044	13802110078
SWALLEY LEAH	4754 NEWBY HALL CT LAS VEGAS NV 89130-2361	13802110077
SWEENEY RICHARD & KAREN LIV TR	SWEENEY RICHARD P & KAREN R TRS 16735 SAGEBRUSH ST CHINO HILLS CA 91709-4536	12535416012
SWIFT ANDREW L	6309 SIERRA PINES CT LAS VEGAS NV 89130-2344	13802610031
SZVOREN THOMAS M & ANH T	6313 CHIMNEY WOOD AVE LAS VEGAS NV 89130-2351	13802511018
TANCREDI LORETTA J TRUST	TANCREDI LORETTA J TRS 6304 CHIMNEY WOOD AVE LAS VEGAS NV 89130-2351	13802511009
TAYLOR BRANDON D & BROOKE D	6375 MARATEA AVE LAS VEGAS NV 89130-2111	12535812007
TAYLOR JOHN DAVID FAMILY TRUST	TAYLOR JOHN D & ELAINE B CO-TRS 6505 SIERRA DIABLO AVE LAS VEGAS NV 89130-1867	12535415055
TAYLOR TAMI L	6437 SUNDOWN HEIGHTS AVE LAS VEGAS NV 89130-1857	12535413019
TECSON JOHN ANTHONY & BEDA	4746 MUNSTEAD WOODS CT LAS VEGAS NV 89130-2358	13802110087
TEMPLE STREET HOMES L L C	909 N SEPULVEDA BLVD #840 EL SEGUNDO CA 90245	12535812017
TERRY STEVEN M & EVANGELINE S	6270 W KRAFT AVE LAS VEGAS NV 89130-2354	13802512008
TETZLAFF JOYCE	244 S COTTONWOOD RD #302 BOZEMAN MT 59718-9239	12535416019
THIBODEAU ROBERTA L	6404 QUANTUM LN LAS VEGAS NV 89130-1830	12535411002
THORNTON-KNIGHT BRIDGET R	KNIGHT WILLIAM M 1744 EVENING BLUFF PL NORTH LAS VEGAS NV 89084-2022	13802110115
TO MARGARET	4773 MEREWORTH CT LAS VEGAS NV 89130-2367	13802110046
TOBLER H ANTHONY & SHEILA	6269 CHIMNEY WOOD AVE LAS VEGAS NV 89130-2345	13802511025
TONOPAH-CRAIG ROAD CO L L L P	26135 MUREAU RD #200 CALABASAS CA 91302-3185	13802204001
TONOPAH-CRAIG ROAD CO L L L P	26135 MUREAU RD #200 CALABASAS CA 91302-3185	13802601001
TORREY PINES PROPERTIES L L C	P O BOX 71163 SALT LAKE CITY UT 84171-0163	13802102013

**Report of All Selected Parcels****Case Number:** VAR-56177**Printed On:** Mon: January 5, 2015

<b><u>Owner</u></b>	<b><u>Address</u></b>	<b><u>Parcel Number</u></b>
TREXLER MARK B & SARAH B	6312 SIERRA PINES CT LAS VEGAS NV 89130-2343	13802610006
TROMBLEY TIFFANY JEAN	GRANT KENDELL JR 4913 CAPE GALLO ST LAS VEGAS NV 89130-2146	12535812002
TUNG FRANCIS SR & JANICE	6413 SUNDOWN HEIGHTS AVE LAS VEGAS NV 89130-1856	12535413024
VALADEZ JOSE F	ESCOTO AZUCENA 6333 SIERRA PINES CT LAS VEGAS NV 89130	13802610037
VANGORDER JOHN E JR & LINDA J	6305 KRAFT AVE LAS VEGAS NV 89130-2357	13802511006
VANHARREVELT STEPHEN	SMITH LISA 6332 ECHO CANYON CIR LAS VEGAS NV 89130-5617	12535810014
VARNEY DEANNE L	WARREN TERRY E 6269 HILL HAVEN AVE LAS VEGAS NV 89130-2347	13802511056
VAUGHAN EVAN	4721 TRIMWATER CT LAS VEGAS NV 89130-2305	13802512006
VICTORIANO ELSIE B & WILSON	4797 GREENCOMBE LAS VEGAS NV 89130-2368	13802110013
VILLEGAS DAVID & LEGIRTHA K	6432 HILLSIDE BROOK AVE LAS VEGAS NV 89130-1837	12535414049
VISIONARY L V ONE L L C	1534 WOODWARD HEIGHTS WAY NORTH LAS VEGAS NV 89032	13802110050
VO MIMI T	265 PLAZA MARQUESSA CT HENDERSON NV 89074	13802110018
VOORHEES MICHAEL STEVEN	4710 TRIMWATER CT LAS VEGAS NV 89130	13802512004
WALKER TERRY	4804 AMERICANWOOD ST LAS VEGAS NV 89130-5628	12535811014
WARD MARTY	7038 DE CELIS PL #33 VAN NUYS CA 91406-3766	13802110045
WARNSHOLZ JON A	4824 GENTLE PINES CT LAS VEGAS NV 89130	12535811025
WEILAND ALEXANDER	6324 CHIMNEY WOOD AVE LAS VEGAS NV 89130-2351	13802511014
WEPRYK JOHN V	4862 CHARLEMAGNE AVE LAS VEGAS NV 89130-7293	12535416023
WHITT RENAE D	CARTER ROBYN L 4790 GREENCOMBE CT LAS VEGAS NV 89130-2368	13802110016
WILLIAMS ARLENE	103 SUNRISE ST DILLON MT 59725	12535416020
WILLIAMS CLARENCE R & DEBORAH S	6488 ARBURY HALL CT LAS VEGAS NV 89130-2307	13802110116
WILLIAMS G A & E F REV LIV TR	WILLIAMS GEORGE A & ESTHER F TRS 6244 SIERRA PINES CT LAS VEGAS NV 89130-2341	12535416014
WILLIAMS G A & E F REV LIV TR	WILLIAMS GEORGE A & ESTHER F TRS 6244 SIERRA PINES CT LAS VEGAS NV 89130-2341	13802610010
WILLIAMS JOYCE D	6408 ANGEL MOUNTAIN AVE LAS VEGAS NV 89130-1858	12535413025
WILLIS LIVING TRUST	WILLIS KENNETH S TRS 23618 PARKLAND AVE MORENO VALLEY CA 92557	13802610034
WILMORE ERNEST J	4780 WINDY HOLLOW ST LAS VEGAS NV 89130-2373	13802513001
WINBLAD ERIC & CHRISTINA M	6359 MARATEA AVE LAS VEGAS NV 89130-2111	12535812011
WINN GALEN & JULIE	6320 HILL HAVEN AVE LAS VEGAS NV 89130-2352	13802511043
WOOD LINDA L	6253 KRAFT AVE LAS VEGAS NV 89130-2355	13802511070
WOODFORD MATTHEW A	FOUGHT STACEY A 9655 BERLIN HEIGHTS DEERFIELD OH 44411-9754	12535413002
WYATT LEWIN JR & LILLIE LIV TR	6445 SIERRA DIABLO AVE LAS VEGAS NV 89130-1871	12535416025
XI WENSI	SHAO RONG 521 PORPOISE BAY TER #A SUNNYVALE CA 94089	13802110079

**Report of All Selected Parcels****Case Number:** VAR-56177**Printed On:** Mon: January 5, 2015

<u>Owner</u>	<u>Address</u>	<u>Parcel Number</u>
XIE WEI	3 CHATEAU CT DANVILLE CA 94506-4659	13802110047
YAKOUBOFF BIJAN	2706 ASHBY AVE LAS VEGAS NV 89102-2135	13802610012
YAMADA GILBERT & MILDRED	2075 VILLAGE CENTER CIR LAS VEGAS NV 89134	12535415031
YATES TOM	6360 MARATEA AVE LAS VEGAS NV 89130-2111	12535812042
YERANOSIAN TOROS	5115 COLLETE AVE ENCINO CA 91436-1420	13802102004
ZHANG BAOLING	5336 TOLEDO WAY FONTANA CA 92336-5925	13802110056
ZITEK WILLIAM C LIVING TRUST	ZITEK WILLIAM C TRS 4805 GENTLE PINES CT LAS VEGAS NV 89130-5627	12535811033
ZLATEFF SHANNON D	6412 SUNDOWN HEIGHTS AVE LAS VEGAS NV 89130-1854	12535413008