

City of Las Vegas
Department of Planning
Development Services Center
333 North Rancho Drive, 3rd Floor
Las Vegas, Nevada 89106

Return Service Requested Official Notice of Public Hearing

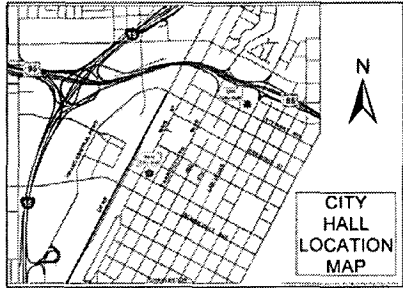

If you wish to file your protest or support on this request, check the appropriate box below and return this card in an envelope with postage to the Department of Planning at the address listed above, fax this side of this card to (702) 464-7499 or make your comments at www.lasvegasnevada.gov. If you would like to contact your Council Representative, please call (702) 229-6405.

I SUPPORT
this Request

I OPPOSE
this Request

Please use available blank space on card for your comments.

VAR-53865 & SUP-53867 [PRJ-53540]

Planning Commission Meeting of 6/10/2014

Application Information

VAR-53865 - VARIANCE - PUBLIC HEARING - APPLICANT/OWNER: WILLIAM B. ENSIGN LIVING TRUST - For possible action on a Variance TO ALLOW A TWO-FOOT SIDE YARD SETBACK WHERE 10 FEET IS REQUIRED FOR AN EXISTING 2,808 SQUARE-FOOT ACCESSORY STRUCTURE (CLASS II) [PIGEON COOP] on 1.35 acres at 6500 West Ann Road (APN 125-26-403-016) R-E (Residence Estates) Zone, Ward 6 (Ross) [PRJ-53540].

SUP-53867 - SPECIAL USE PERMIT RELATED TO VAR-53865 - PUBLIC HEARING - APPLICANT/OWNER: WILLIAM B. ENSIGN LIVING TRUST - For possible action on a Special Use Permit FOR ANIMAL KEEPING & HUSBANDRY (240 HOMING RACING PIGEONS) at 6500 West Ann Road (APN 125-26-403-016) R-E (Residence Estates) Zone, Ward 6 (Ross) [PRJ-53540].

Any and all interested persons may appear before the City Planning Commission either in person or by representative and object to or express approval of this request; or may, prior to this meeting, file a written objection thereto or approval thereof with the Department of Planning, Development Services Center, 333 North Rancho Drive, 3rd Floor, Las Vegas, Nevada 89106. Final Action on General Plan Amendments and Rezoning will be determined by the City Council. Other public hearing items may be deemed Final Action by the Planning Commission or forwarded to the City Council. The date of the City Council meeting, if applicable, will be announced at the Planning Commission meeting after the discussion of the item. For further information, including the full staff report, please call (702) 229-6301 (TDD 386-9108) or go to <http://www.lasvegasnevada.gov>.

Application Location

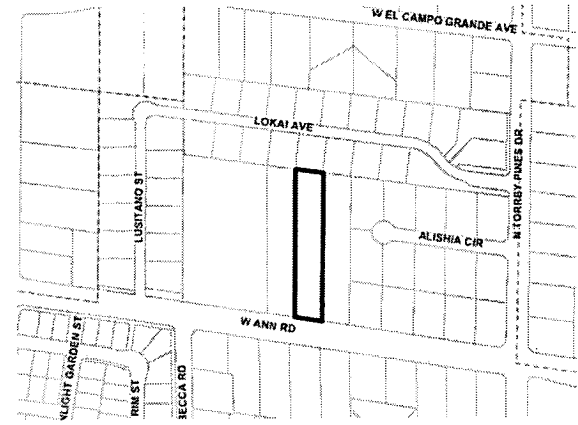

The proposed project may not pertain to the entire highlighted project site.

Public Hearing Information

Meeting:	Planning Commission
Date:	<i>June 10, 2014</i>
Time:	6:00 P.M.
Location:	City Council Chambers 495 South Main Street, 2 nd Floor Las Vegas, Nevada 89101

Report of All Selected Parcels**Case Number:** VAR-53865 + SUP-53867**Printed On:** Mon: April 28, 2014

<u>Owner</u>	<u>Address</u>	<u>Parcel Numbe</u>
ABERCROMBIE JUDITH V	EWING REX C III 5521 N TORREY PINES DR LAS VEGAS NV 89130-1909	12535501003
AIKEN PETER J III & GINA M	5513 PORCUPINE RIM ST LAS VEGAS NV 89130-4803	12535111036
AKI TRUST	SHUGARMAN ALAN TRS 5514 MOONLIGHT GARDEN ST LAS VEGAS NV 89130-4998	12535111027
ALLBRITTON VINCENT S	6417 TINA LN LAS VEGAS NV 89130-1766	12535110002
ALLEN GREGORY & EMELIA	6609 GRAY JUNIPER AVE LAS VEGAS NV 89130-4806	12535111025
AQUIAR HERIBERTO VALENTE	VALENTE MICHAEL NICOLA TRUST 6625 W EL CAMPO GRANDE AVE LAS VEGAS NV 89130-1203	12526402003
AUGUSTA INVESTMENT MANAGEMENT	2320 POTOSI ST #130 LAS VEGAS NV 89146-0312	12526302012
AUGUSTA INVESTMENT MGMT LLC	2320 POTOSI ST #130 LAS VEGAS NV 89146-0312	12526403021
BAIR KARLA KAY 1999 REVOCABLE TR	BAIR KARLA KAY TRS 5680 N TORREY PINES DR LAS VEGAS NV 89130-1332	12526801007
BAIRD RICK & SANDRA	6511 LOKAI AVE LAS VEGAS NV 89130-1260	12526411004
BANDY JAMES L III	2805 MARYLAND HILLS DR HENDERSON NV 89052-7701	12526801006
BANK J P MORGAN CHASE NATL ASSN	10790 RANCHO BERNARDO RD SAN DIEGO CA 92127-5705	12535111039
BASTONE DENISE	1020 S RED BRIDGE AVE LAS VEGAS NV 89134	12526411023
BAY TECHNOLOGIES INVESTMENTS LLC	P O BOX 5140 BELMONT CA 94002-5140	12535111040
BAYLISS HARRY EARL & MERIDTH	110 GLASS HOUSE LN SHADY COVE OR 97539-9807	12526403030
BEAN STEVEN E & ANN M REV LIV TR	BEAN STEVEN E & ANN M TRS 5640 N TORREY PINES DR LAS VEGAS NV 89130-1332	12526801009
BENAVIDEZ RAUL Z & ANA V	6516 GRAY JUNIPER AVE LAS VEGAS NV 89130-4807	12535111074
BERG DANA	5800 GILBERT LN LAS VEGAS NV 89130-1219	12526402001
BLAKE CRAIG	6501 W EL CAMPO GRANDE AVE LAS VEGAS NV 89130-1215	12526403005
BONNET GUILLERMO A	705 SARAJANE LANE LAS VEGAS NV 89107-1582	12535111066
BOONPICHATE KESANEEONE	P O BOX 570811 LAS VEGAS NV 89157-0811	12526403017
BOWMAN-WALKLIN ELVIRA ANNE	5517 REBECCA RD LAS VEGAS NV 89130-1706	12535102020
BRADSHAW RANDALL P & ROSE M	6432 TINA LN LAS VEGAS NV 89130-1710	12535102024
BRADY SCOTT M	5442 PORCUPINE ST LAS VEGAS NV 89130-4802	12535111062
BUCK MICHAEL D & RAQUEL	6517 TAYLOR CREEK AVE LAS VEGAS NV 89130-4805	12535111043
BUNKER DEREK & CHRISTIE	6512 LOKAI AVE LAS VEGAS NV 89130-1260	12526411025
BURNS STEPHEN A & SANDRA L	5728 N TORREY PINES LAS VEGAS NV 89130-1336	12526801004
BYRD JENNIFER L & SHAUNTE M	6508 GRAY JUNIPER AVE LAS VEGAS NV 89130-4807	12535111072
CAMPBELL DEREK GRANT	DUBOIS MARIN LINDSAY 6612 W GRAY JUNIPER AVE LAS VEGAS NV 89130-4806	12535111078
CARMONA-ORTEGA LUIS F ETAL	6509 TAYLOR CREEK AVE LAS VEGAS NV 89130-4805	12535111045
CAROTHERS HAROLD E M & C MELODY	5433 REBECCA RD LAS VEGAS NV 89130-1703	12535104002

Report of All Selected Parcels**Case Number:** VAR-53865**Printed On:** Mon: April 28, 2014

<u>Owner</u>	<u>Address</u>	<u>Parcel Number</u>
CARTER KHALIL J	5529 PORCUPINE RIM ST LAS VEGAS NV 89130-4803	12535111032
CHAMIAN DEEN	6441 TINA LN LAS VEGAS NV 89130-1705	12535104006
CHANG JOHN Y	TANG EMILY 505 ZENITH RIDGE DR DANVILLE CA 94506-1356	12526403031
CHARLES DOLORES C	6409 TINA LN LAS VEGAS NV 89130-1766	12535110004
CHENE CHEN & VIVIAN M	5636 LUSITANO ST LAS VEGAS NV 89130-1262	12526411010
CHESSE ROBERT W & PATRICIA L	5644 LUSITANO ST LAS VEGAS NV 89130-1262	12526411009
CHIRSE HAROLD L & JACQUELINE Y	5741 N TORREY PINES DR LAS VEGAS NV 89130-1331	12526403012
COLAGIOVANE-MILLER TRUST	MILLER ROBERT F TRS 6497 W EL CAMPO GRANDE AVE LAS VEGAS NV 89130-1217	12526403006
COX FAMILY TRUST ETAL	COX ORLO E JR TRS 3700 MEADE AVENUE LAS VEGAS NV 89102-7894	12535501001
COX MELANIE L & JEFFREY S JR	5438 PORCUPINE RIM ST LAS VEGAS NV 89130-4802	12535111061
CRUM DEAN R & JENNIFER	5501 REBECCA RD LAS VEGAS NV 89130-1706	12535102018
CRUMP MICHAEL E & SHEILA L	6363 W EL CAMPO GRANDE AVE LAS VEGAS NV 89130-1318	12526801002
CRUZ MARK & LAURA	5514 PORCUPINE RIM ST LAS VEGAS NV 89130-4803	12535111065
DAVIS BRADFORD S & DAWN M	6401 W ANN RD LAS VEGAS NV 89130-1211	12535102010
DEAL SHAUN H & KORI D	3050 SHERIDAN ST LAS VEGAS NV 89102-7819	12526411007
DECARO INVESTMENTS I L L C	840 S RANCHO DR #4-100 LAS VEGAS NV 89106-3837	12526302014
DECISIVE PURSUIT L L C	28 QUIET MOON LN LAS VEGAS NV 89135-7863	12526401003
DECISIVE PURSUIT L L C	28 QUIET MOON LN LAS VEGAS NV 89135-7863	12526304008
DELGADO CRUZ M & IRMA	6451 TINA LN LAS VEGAS NV 89130-1705	12535104003
DEPOSADA K C L SEP PPTY TR	DEPOSADA KATIUSHKA C LOZANO TRS 5522 MOONLIGHT GARDEN ST LAS VEGAS NV 89130-4998	12535111029
DODSON LISA J & JOHNNY L	6428 W ANN RD LAS VEGAS NV 89130-1223	12526403028
DODSON MYRON & MEREDYTHE	6435 LOKAI AVE LAS VEGAS NV 89130-1259	12526411001
DUKE CRAIG D	5521 PORCUPINE RIM ST LAS VEGAS NV 89130-4803	12535111034
DWILLIS MARK K & CYNTHIA L	6360 W ANN RD LAS VEGAS NV 89130-1302	12526801011
EARL RALPH C III	5530 N TORREY PINES DR LAS VEGAS NV 89130-1914	12535102013
EATON RICKY M & NANCY E	6417 W ANN RD LAS VEGAS NV 89130-1211	12535102008
ENSIGN WILLIAMS B LIVING TRUST	ENSIGN WILLIAMS B TRS 5170 RUSTIC RIDGE DR LAS VEGAS NV 89148-1454	12526403016
FALCONE MICHAEL V & SUNSHINE C	5620 N TORREY PINES DR LAS VEGAS NV 89130-1332	12526801010
FARMELO JOSEPH R & REBECCA L	6425 ALISHIA CIR LAS VEGAS NV 89130-1240	12526403024
FARR STEPHEN W	6445 TINA LN LAS VEGAS NV 89130-1705	12535104005
FENIMORE DEBORAH L	6443 LOKAI AVE LAS VEGAS NV 89130-1259	12526411002

Report of All Selected Parcels**Case Number:** VAR-53865**Printed On:** Mon: April 28, 2014

<u>Owner</u>	<u>Address</u>	<u>Parcel Number</u>
FITZGERALD GREGORY A & KATHRYN S	5534 PORCUPINE RIM ST LAS VEGAS NV 89130-4803	12535111070
FLETCHER DAVID W & MELINIRA S	6508 SAND BENCH AVE LAS VEGAS NV 89130-4800	12535111048
FOREMASTER KELLY R & CHARIS A	6424 TINA LN LAS VEGAS NV 89130-1714	12535102025
FREIERMUTH FAMILY TRUST 1997	FREIERMUTH DEAN H & CAROLE L TRS 6440 TINA LN LAS VEGAS NV 89130-1710	12535102023
FRIENDS MOOSE REVOCABLE LIV TR	NEAL JOE DENNIS TRS 6212 LULLABY PINE CT LAS VEGAS NV 89130-1404	12526402006
GARDNER CHRISTOPHER	6416 BLACKLION CT LAS VEGAS NV 89130-1764	12535110016
GIARMO CHERYL L	5611 LUSITANO ST LAS VEGAS NV 89130-1262	12526411016
GLANCY MICHAEL O & HELEN H	5751 N TORREY PINES LAS VEGAS NV 89130-1331	12526403011
GONZALES JOE & LYNDA A	4232 BLACKMOM CIR LAS VEGAS NV 89130-2519	12535102017
GRAHAM FAMILY TRUST	GRAHAM STEVEN E & SANDRA K TRS 6401 ALISHIA CIR LAS VEGAS NV 89130-1240	12526403027
GRANGER CHARLES W JR & CATHERINE	5750 N TORREY PINES DR LAS VEGAS NV 89130-1336	12526801003
GIULIANO LORI M	6520 GRAY JUNIPER AVE LAS VEGAS NV 89130-4807	12535111075
HANNAH ROBERT K & TASHA L	5712 N TORREY PINES DR LAS VEGAS NV 89130-1336	12526801005
HARLIN DAVID M & DEBORAH I	5510 N TORREY PINES DR LAS VEGAS NV 89130-1914	12535102027
HARTWIG JAMIE L & TERI D	5540 FIORINDA CIR LAS VEGAS NV 89130-1711	12535102012
HAVRDA MARVIN J	6424 W ANN RD LAS VEGAS NV 89130-1223	12526403029
HE XIN PING	6513 TAYLOR CREEK AVE LAS VEGAS NV 89130-4805	12535111044
HECKARD DAVID L & D'ANDREA P	5510 PORCUPINE RIM ST LAS VEGAS NV 89130-4803	12535111064
HEISTER JAY B	5533 REBECCA RD LAS VEGAS NV 89130-1706	12535102011
HILL CHRISTOPHER & CHANOTIP	CHINASAI CHALIE 6504 GRAY JUNIPER AVE LAS VEGAS NV 89130-4807	12535111071
HOWELL GARY D & GAYE LEINN	5627 LUSITANO ST LAS VEGAS NV 89130-1262	12526411018
HUCKEBA JOHN C & DONNA	6448 TINA LN LAS VEGAS NV 89130-1710	12535102021
HUDSON WILLIAM & C FAM TR	HUDSON CHARLAINE TRS 5619 LUSITANO ST LAS VEGAS NV 89130-1262	12526411017
HUDSPETH ROBERT & L M REV LIV TR	HUDSPETH ROBERT T & LISA M TRS 6441 W ANN RD LAS VEGAS NV 89130-1211	12535102005
HURST BRIAN & CHERYL	6433 W EL CAMPO GRANDE AVE LAS VEGAS NV 89130-1217	12526403008
INCHAUSTI DANIEL C	5530 MOONLIGHT GARDEN ST LAS VEGAS NV 89130-4998	12535111031
JANETTE CHARLES D & CHRISTINE K	6544 LOKAI AVE LAS VEGAS NV 89130-1261	12526411021
JOHNSON ROBB C & SANDRA A FAM TR	JOHNSON ROBB C JR & SANDRA TRS 6416 ALISHIA CIR LAS VEGAS NV 89130-1240	12526403020
KALCHBRENNER DIANA L	6531 W EL CAMPO GRANDE AVE LAS VEGAS NV 89130-1215	12526403001
KATTERHEINRICH ANITA J	1599A 39TH ST LOS ALAMOS NM 87544-2899	12526402014
KERR STANLEY F JR & TAMMY L	5522 PORCUPINE RIM ST LAS VEGAS NV 89130-4803	12535111067
KISTINGER GAVIN M & CLAUDIA B	6420 BLACKLION CT LAS VEGAS NV 89130-1764	12535110015

Report of All Selected Parcels**Case Number:** VAR-53865**Printed On:** Mon: April 28, 2014

<u>Owner</u>	<u>Address</u>	<u>Parcel Number</u>
KLINKNER KELLY & DIANNA	5604 LUSITANO ST LAS VEGAS NV 89130-1262	12526411014
KNELL AARON & MAUREEN	5434 PORCUPINE RIM ST LAS VEGAS NV 89130-4802	12535111060
KNOBLE LAQUAL N & JARED M	5517 PORCUPINE RIM ST LAS VEGAS NV 89130-4803	12535111035
KOZLOWICZ FAMILY TRUST	KOZLOWICZ GREGORY M & LINDA TRS 9067 TIERRA SANTA AVE LAS VEGAS NV 89129-3680	12526411005
KREIN PAUL	5521 FIORINDA CIR LAS VEGAS NV 89130-1711	12535102016
LAREAU TRUST	LAREAU DANIEL R & JAN A TRS 6431 TINA LN LAS VEGAS NV 89130-1705	12535104007
LAW EDGAR L III	6424 ALISHIA CIR LAS VEGAS NV 89130-1240	12526403019
LAWRENCE DAVID EUGENE & KERRY L	6465 W ANN RD LAS VEGAS NV 89130-1211	12535102002
LETUS KEITH A	6604 W MANZANITA GLEN AVE LAS VEGAS NV 89130-4997	12535111017
LEWIS REBECCA R	6527 LOKAI AVE LAS VEGAS NV 89130-1260	12526411006
LIU JERRY & ANN LS	4650 RANCH HOUSE RD #95 NO LAS VEGAS NV 89031-4602	12526303015
LUKEY'S FAMILY TRUST	CORRAL LUCRETIA G TRS 5760 GILBERT LN LAS VEGAS NV 89130-1228	12526402004
MARDUENO TAMARA	5520 FIORINDA CIR LAS VEGAS NV 89130-1711	12535102015
MATA ROBINSON R	6608 MANZANITA GLEN AVE LAS VEGAS NV 89130-4997	12535111018
MCCAMISH KELLY	MCCAMISH KEVIN & DONNA 5635 LUSITANO ST LAS VEGAS NV 89130-1262	12526411019
MCCLENAHAN KEITH A & JENNIFER K	6510 EL CAMPO GRANDE AVE LAS VEGAS NV 89130-1218	12526302015
MCEVOY EDWARD G III & ELLEN T	5643 LUSITANO ST LAS VEGAS NV 89130-1262	12526411020
MCPMAHON FAMILY TRUST	MCPMAHON MARK TRS 6416 TINA LN LAS VEGAS NV 89130-1714	12535102026
MCMCGARRY RICHARD L	HOFFMAN-KYLE LYNN 5612 LUSITANO ST LAS VEGAS NV 89130-1262	12526411013
MIANECKI & SHAWMIANECKI RV LV TR	MIANECKI BRUCE E TRS 6520 LOKAI AVE LAS VEGAS NV 89130-1260	12526411024
MILLER ROGER L & HEIDE L	6420 W EL CAMPO GRANDE AVE LAS VEGAS NV 89130-1216	12526303014
MITRI MAURICE & LAURICE	6 YELLOW BRICK RD RANCHO PALOS VERDES CA 90275-1770	12526403023
MURPHY FAMILY TRUST	MURPHY JAMES O TRS 6530 W EL CAMPO GRANDE AVE LAS VEGAS NV 89130-1218	12526302013
NEAFSEY BRIAN & LOIS	5620 LUSITANO ST LAS VEGAS NV 89130-1262	12526411012
NGUYEN LINA N	5530 PORCUPINE RIM ST LAS VEGAS NV 89130-4803	12535111069
NOVOTNY FAMILY LIVING REV TR	6660 W ANN RD LAS VEGAS NV 89130-1214	12526402012
O'MALLEY TONI J & BRIAN P	6512 GRAY JUNIPER AVE LAS VEGAS NV 89130-4807	12535111073
OSBORNE DANIEL & DEEANDRA	6425 TINA LN LAS VEGAS NV 89130-1766	12535110001
OVERTON FAMILY TRUST	OVERTON HARLAN C & SHARLENE TRS 6433 W ANN RD LAS VEGAS NV 89130-1211	12535102006
PACIFIC COAST DEVELOPEMENT	6293 DEAN MARTIN DR #G LAS VEGAS NV 89118-3845	12526411033
PACIFIC COAST DEVELOPEMENT	6293 DEAN MARTIN DR #G LAS VEGAS NV 89118-3845	12526411036
PACIFIC COAST DEVELOPEMENT	6293 DEAN MARTIN DR #G LAS VEGAS NV 89118-3845	12526411037

Report of All Selected Parcels**Case Number:** VAR-53865**Printed On:** Mon: April 28, 2014

<u>Owner</u>	<u>Address</u>	<u>Parcel Number</u>
PACIFIC COAST DEVELOPEMENT	6293 DEAN MARTIN DR #G LAS VEGAS NV 89118-3845	12526411034
PACIFIC COAST DEVELOPEMENT	6293 DEAN MARTIN DR #G LAS VEGAS NV 89118-3845	12526411035
PAGE MICHAEL S	5525 PORCUPINE RIM ST LAS VEGAS NV 89130-4803	12535111033
PAYGUN FAMILY TRUST	DODDS WALTER TADD & DEBI E TRS 5640 GILBERT LN LAS VEGAS NV 89130-1228	12526402013
PEPPLEY MICHAEL & STACY	5500 N TORREY PINES DR LAS VEGAS NV 89130-1914	12535102028
PLA JOHN F & MIGUEL	12482 PUTNAM ST WHITTIER CA 90602-1002	12535104004
QUINTANA MARY ANN	6413 TINA LN LAS VEGAS NV 89130-1766	12535110003
RABIN HARRY & SYLVIA	RABIN DAVID S 2869 LOS CEDROS CIR SANTA ROSA VALLEY CA 93012-8809	12535111026
REBECCA MANOR WATER USERS ASSN	5517 REBECCA RD LAS VEGAS NV 89130-1706	12535102019
REED THEODORE J & MARCIA A	6504 SAND BENCH AVE LAS VEGAS NV 89130-4800	12535111047
REED TOM F & CARRIE O TRUST	REED THOMAS F & CARRIE O TRS 6505 TAYLOR CREEK AVE LAS VEGAS NV 89130-4805	12535111046
REYES BIENVENIDO C REV LIV TR	REYES BIENVENIDO C TRS 6543 LOKAI AVE LAS VEGAS NV 89130-1261	12526411008
RINALDI DEBBIE	6449 W ANN RD LAS VEGAS NV 89130-1211	12535102004
RODRIGUEZ JOHN & ELIZABETH B	5841 REBECCA RD LAS VEGAS NV 89130-1227	12526302010
ROGERS PAUL D & STEPHANIE D	6444 TINA LN LAS VEGAS NV 89130-1710	12535102022
ROSSETTI DENICE M	5610 GILBERT LN LAS VEGAS NV 89130-1228	12526402011
RUBINSON DAVID & CYNTHIA	6417 ALISHIA CIR LAS VEGAS NV 89130-1240	12526403025
RUGGED OAKS INVESTMENTS L L C	2320 POTOSI ST #130 LAS VEGAS NV 89146-0312	12526411029
RUGGED OAKS INVESTMENTS L L C	2320 POTOSI ST #130 LAS VEGAS NV 89146-0312	12526411028
RUGGED OAKS INVESTMENTS L L C	2320 POTOSI ST #130 LAS VEGAS NV 89146-0312	12526411027
RUGGED OAKS INVESTMENTS L L C	2320 SOUTH POTOSI #130 LAS VEGAS NV 89146-0312	12526411032
RUGGED OAKS INVESTMENTS L L C	2320 POTOSI ST #130 LAS VEGAS NV 89146-0312	12526411031
RUGGED OAKS INVESTMENTS L L C	2320 POTOSI ST #130 LAS VEGAS NV 89146-0312	12526411030
SANDERS JOSEPH & SHEILA L	5526 PORCUPINE RIM ST LAS VEGAS NV 89130-4803	12535111068
SATICOY BAY LLC 5526 MOONLIGHT G	P O BOX 36208 LAS VEGAS NV 89133-6208	12535111030
SCHOMBS FAMILY REVOCABLE LIV TR	SCHOMBS ROBERT JR & JULIE TRS 5865 N TORREY PINES DR LAS VEGAS NV 89130-1333	12526303012
SELMANI SULEJMAN	385 MASON AVE HALEDON NJ 07508-1303	12535102003
SHIRLEY BRIAN J & CATHLEEN T	6521 W EL CAMPO GRANDE AVE LAS VEGAS NV 89130-1215	12526403002
SHIRLEY BRIAN J & CATHLEEN T	6521 W EL CAMPO GRANDE AVE LAS VEGAS NV 89130-1215	12526403003
SHIRLEY DALBY W	6511 W EL CAMPO GRANDE AVE LAS VEGAS NV 89130-1215	12526403004
SHUGARMAN ALAN	3635 S FORT APACHE RD #200-7 LAS VEGAS NV 89147-3403	12535111077
SIMPSON NORMAN K JR & MARLENE E	6504 LOKAI AVE LAS VEGAS NV 89130-1260	12526411026

Report of All Selected Parcels**Case Number:** VAR-53865**Printed On:** Mon: April 28, 2014

<u>Owner</u>	<u>Address</u>	<u>Parcel Numbe</u>
SKIN YOU'RE INN INC	5502 LAKE CHARLES ST NO LAS VEGAS NV 89031-2007	12535102001
SMITH JEREMY B	6400 W ANN RD LAS VEGAS NV 89130-1223	12526403032
SMITH MICHAEL H & CHERALYN Y	6613 GRAY JUNIPER AVE LAS VEGAS NV 89130-4806	12535111024
SNYDER PAUL B & VIRGINIA T	1283 GRANADA ST UPLAND CA 91784-1095	12526411011
SRABIAN SEROP	22881 HILTON HEAD DR #250 DIAMOND BAR CA 91765-4414	12535110017
STAGGS GARY	1400 COLORADO ST #C BOULDER CITY NV 89005-2436	12535102007
STANIULIS ANTHONY JR	5506 PORCUPINE RIM ST LAS VEGAS NV 89130-4803	12535111063
STONE LINA F	6504 TAYLOR CREEK AVE LAS VEGAS NV 89130-4805	12535111037
STRAUB RICHARD H & MARY R	6429 W EL CAMPO GRANDE AVE LAS VEGAS NV 89130-1217	12526403009
SWENSON ROGER A	3608 MORGAN SPRINGS AVE NO LAS VEGAS NV 89081-5224	12535102009
SWENSON WILTON G JR & MARY JO	6536 LOKAI AVE LAS VEGAS NV 89130-1261	12526411022
THOMAS LARRY D & NERISSA L	6500 W EL CAMPO GRANDE AVE LAS VEGAS NV 89130-1218	12526302016
TIMBER CREEK HOMEOWNERS' ASSN	3651 LINDELL RD #H LAS VEGAS NV 89103-1200	12535111087
TIMBER CREEK HOMEOWNERS' ASSN	3651 LINDELL RD #H LAS VEGAS NV 89103-1200	12535111081
TIMBER CREEK HOMEOWNERS' ASSN	3651 LINDELL RD #H LAS VEGAS NV 89103-1200	12535111080
TIMBER CREEK HOMEOWNERS' ASSN	3651 LINDELL RD #H LAS VEGAS NV 89103-1200	12535111086
TORRALBA EUGENE Y & HELEN E	9275 JUNE BERRY LN NORTH HILLS CA 91343-7821	12535111038
TRUSTEE CLARK COUNTY TREASURER	PECTOL STEVE 6425 W EL CAMPO GRANDE AVE LAS VEGAS NV 89130-1217	12526403010
TUBIN BRAD REVOCABLE TRUST	3291 E WARM SPRINGS RD #400 LAS VEGAS NV 89120-3184	12526402002
UDARBE JOEL U & ANTONIO T	UDARBE PATROCINIA U 6604 GRAY JUNIPER AVE LAS VEGAS NV 89130-4806	12535111076
VANDERVLIT CHRISTOPHER & M	5840 FANNINE WY LAS VEGAS NV 89130-1202	12526302011
VANDEVER GARRET & CHRISTINA	6461 TINA LN LAS VEGAS NV 89130-1705	12535104001
VIDOVIC IGOR	ALFASI-VIDOVIC KATIE 6400 ALISHIA CIR LAS VEGAS NV 89130-1240	12526403022
VIGNA E ROSE LIVING TRUST	VIGNA E ROSE TRS 6372 W EL CAMPO GRANDE AVE LAS VEGAS NV 89130-1317	12526701012
VILON PHILIPPE D	CHESSION ISABELLE 6409 ALISHA CIR LAS VEGAS NV 89130-1240	12526403026
VINEYARD FAMILY TRUST	VINEYARD JERRY W & RUTH A TRS P O BOX 751884 LAS VEGAS NV 89136-1884	12526403018
WALKLIN WILLIAM	BOWMAN-WALKLIN ELVIRA A 5517 REBECCA RD LAS VEGAS NV 89130-1706	12535102014
WEINGARDT FAMILY REV LIV TR	WEINGARDT ROGER & LISA TRS 5841 FANNINE WY LAS VEGAS NV 89130-1201	12526303011
WEINGARDT ROGER & LISA	WEINGARDT THOMAS & SHARON M 5831 FANNINE WY LAS VEGAS NV 89130-1201	12526303013
WEST BEATRICE F	5603 LUSITANO ST LAS VEGAS NV 89130-1262	12526411015
WHITAKER FAMILY TRUST	WHITAKER MARVA K TRS 2066 FALLSBURG WY HENDERSON NV 89002-3627	12526403015
WIEMERS ORVILLE JR & LISA	5660 N TORREY PINES DR LAS VEGAS NV 89130-1332	12526801008

Report of All Selected Parcels

Case Number: VAR-53865

Printed On: Mon: April 28, 2014

<u>Owner</u>	<u>Address</u>	<u>Parcel Numbe</u>
WITHERALL SCOTT	O'NEILL JOSEPH 5518 MOONLIGHT GARDEN ST LAS VEGAS NV 89130-4998	12535111028
WRIGHT IRVIN C & AILEEN M	P O BOX 542 PANACA NV 89042-0542	12526801001
YOUNG TYSON W	6503 LOKAI AVE LAS VEGAS NV 89130-1260	12526411003
ZAPPIA AARON V & JULIE L	6437 W EL CAMPO GRANDE AVE LAS VEGAS NV 89130-1217	12526403007
ZINK TRUST	ZINK BARBARA E TRS 421 MILTON DR SAN GABRIEL CA 91775-2822	12526403014