

City of Las Vegas
Department of Planning
Development Services Center
333 North Rancho Drive, 3rd Floor
Las Vegas, Nevada 89106

Return Service Requested
Official Notice of Public Hearing

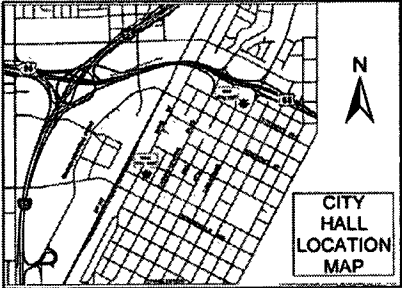

If you wish to file your protest or support on this request, check the appropriate box below and return this card in an envelope with postage to the Department of Planning at the address listed above or fax this side of this card to (702) 464-7499. If you would like to contact your Council Representative, please call (702) 229-6405.

I SUPPORT
this Request

I OPPOSE
this Request

Please use available blank space on card for your comments.

VAR-50841 & VAR-50842 [PRJ-50625]
Planning Commission Meeting of 10/8/2013

Application Information

VAR-50841 - VARIANCE - PUBLIC HEARING - APPLICANT: V & V TACK AND FEED - OWNER: MARY BARTSAS 13, LLC - For possible action on a request for a Variance TO ALLOW A ZERO-FOOT SIDE YARD SETBACK WHERE A 10-FOOT SIDE YARD SETBACK IS REQUIRED AND TO ALLOW A FIVE-FOOT REAR YARD SETBACK WHERE A 20-FOOT SETBACK IS REQUIRED on 1 acre at the northwest corner of Rancho Drive and Michael Way (APN 138-12-301-016), C-2 (General Commercial) Zone, Ward 5 (Barlow) [PRJ-50625].

VAR-50842 - VARIANCE - PUBLIC HEARING - APPLICANT: V & V TACK AND FEED - OWNER: MARY BARTSAS 13, LLC - For possible action on a request for a Variance TO ALLOW 17 PARKING SPACES WHERE 71 SPACES ARE REQUIRED on 1 acre at the northwest corner of Rancho Drive and Michael Way (APN 138-12-301-016), C-2 (General Commercial) Zone, Ward 5 (Barlow) [PRJ-50625].

Application Location

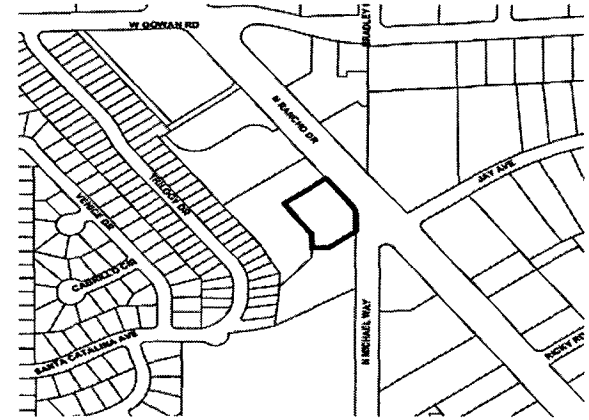

The proposed project may not pertain to the entire highlighted project site.

Public Hearing Information

Meeting: Planning Commission
Date: *October 08, 2013*
Time: 6:00 P.M.
Location: City Council Chambers
495 South Main Street
Las Vegas, Nevada

Any and all interested persons may appear before the City Planning Commission either in person or by representative and object to or express approval of this request; or may, prior to this meeting, file a written objection thereto or approval thereof with the Department of Planning, Development Services Center, 333 North Rancho Drive, 3rd Floor, Las Vegas, Nevada 89106. Final Action on General Plan Amendments and Rezonings will be determined by the City Council. Other public hearing items may be deemed Final Action by the Planning Commission or forwarded to the City Council. The date of the City Council meeting, if applicable, will be announced at the Planning Commission meeting after the discussion of the item. For further information, including the full staff report, please call (702) 229-6301 (TDD 386-9108) or go to <http://www.lasvegasnevada.gov>.

Report of All Selected Parcels**Case Number:**

VAR-50841

*VAR-50842***Printed On:** Mon: August 26, 2013

| <u>Owner</u> | <u>Address</u> | <u>Parcel Number</u> |
|---------------------------------|---|----------------------|
| A D K FAMILY TRUST 2000 | DIAZ ANGEL SANDOVAL TRS 7920 W LONE MOUNTAIN RD LAS VEGAS NV 89129-5302 | 13812314021 |
| A D K FAMILY TRUST 2000 | DIAZ ANGEL SANDOVAL TRS 7920 W LONE MOUNTAIN RD LAS VEGAS NV 89129-5302 | 13812312010 |
| A D K FAMILY TRUST 2000 | DIAZ ANGEL S TRS 7920 W LONE MOUNTAIN RD LAS VEGAS NV 89129-5302 | 13812314005 |
| A D K FAMILY TRUST 2000 | DIAZ ANGEL S TRS 7920 W LONE MOUNTAIN RD LAS VEGAS NV 89129-5302 | 13812314033 |
| ABREGO SILVIA I | 3525 TRILOGY DR LAS VEGAS NV 89108-4700 | 13812314028 |
| ACEVES JUAN O | 5721 SANTA CATALINA AVE LAS VEGAS NV 89108-4708 | 13812414007 |
| ADAMS CHRISTINE C | 119 N KENWOOD ST BURBANK CA 91505-4205 | 13812314034 |
| AHMAD INVESTMENTS & HOLDING LLC | 9008 GREENSBORO LN LAS VEGAS NV 89134-0500 | 13812710097 |
| ALDANA VICTOR MANUEL | 3500 MIRAMAR DR LAS VEGAS NV 89108-4771 | 13812311052 |
| ALVA ESTELA FIGUEROA | 3998 SHADY OAK DR LAS VEGAS NV 89115-0126 | 13812415023 |
| ALVAREZ MA ELENA | 3412 TRILOGY DR LAS VEGAS NV 89108-4779 | 13812312028 |
| ANGULO ANN H & PETER | 1634 BUFFALO TRAIL DR HENDERSON NV 89014-0361 | 13812213061 |
| ARANA JUAN | EGUEZ MARISOL 2018 W WASHINGTON AVE SANTA ANA CA 92706-3233 | 13812312003 |
| ARELLANO LADONNA | 5717 CABRILLO CIR LAS VEGAS NV 89108-4770 | 13812311034 |
| ARITA ALFREDO C & LETICIA | 3420 TRILOGY DR LAS VEGAS NV 89108-4779 | 13812312030 |
| ARUSY EZRA | 18 PENNINGTON RD EAST WINDSOR NJ 08520-5721 | 13812311043 |
| ATHANAS SUSANN J & RAND W | 3428 VENICE DR LAS VEGAS NV 89108-4713 | 13812311017 |
| ATOIGUE JOANNE & ANA C | 3421 BONN CT LAS VEGAS NV 89130-3143 | 13812711004 |
| AVERY FAMILY REVOCABLE LIV TR | AVERY CHADWICK D & JANET H TRS 336 BRILLIANT SUMMIT CIR HENDERSON NV 89052-2375 | 13812311020 |
| B N Y MIDWEST TRUST COMPANY | %J KEATING 9 TECH CENTER NATICK MA 01760-1023 | 13812801007 |
| BABCOCK KENT L & SABRINA | 3524 MIRAMAR DR LAS VEGAS NV 89108-4706 | 13812311006 |
| BALASE OSIAS C | 3513 TRILOGY DR LAS VEGAS NV 89108-4700 | 13812312002 |
| BARRISTER GLOBAL SERV NETWORK | P O BOX 1979 HAMMOND LA 70404-1979 | 13812213049 |
| BARTSAS MARY 13 L L C | 601 S RANCHO DR #C23 LAS VEGAS NV 89106-4825 | 13812301016 |
| BLAIR DEENA A | 5704 CABRILLO CIR LAS VEGAS NV 89108-4702 | 13812311040 |
| BOUSE LEIGH MAURIEN IRR TR | CLARK WILLIAM TRS 22918 CANYON LAKE DR S CANYON LAKE CA 92587 | 13812710043 |
| BRANSON MARTIN R & UNETTE L | BRANSON MARTIN R & UNETTE L 3601 BRADLEY RD LAS VEGAS NV 89130-2917 | 13812610013 |
| BROVIK RAYMOND CHARLES FAM TR | BROVIK RAYMOND CHARLES TRS 3464 TRILOGY DR LAS VEGAS NV 89108-4781 | 13812314020 |
| C K 3435 RANCHO L L C | %L SHAPIRO 10300 W CHARLESTON BLVD #13-156 LAS VEGAS NV 89135-1037 | 13812701001 |
| CAMPOS ERIC | 8737 HICKORI ST LOS ANGELES CA 90002 | 13812311054 |
| CAN-CEL NV L L C | %S CELIKEL 23721 HARBOR VISTA DR MALIBU CA 90265-4816 | 13812213048 |
| CARYLANN LIVING TRUST | MEIER CARYLANN TRS 3501 VENICE DR LAS VEGAS NV 89108-4714 | 13812311048 |

Report of All Selected Parcels**Case Number:** VAR-50841**Printed On:** Mon: August 26, 2013

| <u>Owner</u> | <u>Address</u> | <u>Parcel Number</u> |
|----------------------------------|---|----------------------|
| CASE JAMES & CECILIA REV LIV TR | CASE JAMES B & CECILIA M TRS 3516 VENICE DR LAS VEGAS NV 89108-4774 | 13812311008 |
| CASON TESSA | 5694 MISSION CENTER RD #213 SAN DIEGO CA 92108-4355 | 13812311050 |
| CASTELLANOS MILTON B RIOS | 3517 TRILOGY DR LAS VEGAS NV 89108-4700 | 13812312001 |
| CAUBALEJO EDEN | 3501 TRILOGY DR LAS VEGAS NV 89108-4700 | 13812312005 |
| CEJA ENRIQUE & JUAN | 8944 TELFAIR AVE SUN VALLEY CA 91352-2440 | 13812414010 |
| CEJA ENRIQUE & MARIA E | 3536 TRILOGY DR LAS VEGAS NV 89108-4777 | 13812314006 |
| CHAVEZ RAFAEL D & ROSA D | 3401 TRILOGY DR LAS VEGAS NV 89108-4779 | 13812312024 |
| CHRISTIAN SHIRLEY A | 3425 TRILOGY DR LAS VEGAS NV 89108-4780 | 13812312020 |
| CHURCH CHRISTIAN ONE BODY CHRIST | 950 N TONOPAH DR LAS VEGAS NV 89106-1902 | 13812710048 |
| CHURCH CHRISTIAN ONE BODY CHRIST | 5367 JAY AVE LAS VEGAS NV 89130-3101 | 13812710042 |
| CHURCH METHODIST ADVENT UNITED | 5333 JAY AVE LAS VEGAS NV 89130-3101 | 13812710046 |
| CHURCH METHODIST ADVENT UNITED | 5333 JAY AVE LAS VEGAS NV 89130-3101 | 13812710045 |
| CITY OF NORTH LAS VEGAS | %CITY CLERK P O BOX 4086 NO LAS VEGAS NV 89036-4086 | 13812710002 |
| COX DARLENE S REVOCABLE TRUST | COX DARLENE S TRS 1016 VIEW CREST LN KAYSVILLE UT 84037-9437 | 13812311013 |
| CROSBY STEVE & DIANE | 3529 TRILOGY DR LAS VEGAS NV 89108-4700 | 13812314030 |
| CROSBY STEVE & DIANE | 3529 TRILOGY DR LAS VEGAS NV 89108-4700 | 13812314029 |
| CS 03 CPN 3606 NORTH RANCHO DR | %MIDLAND LOAN SERV 10851 MASTIN #300 OVERLAND PARK KS 66210-1690 | 13812213062 |
| CUBILLO GONZALO & MARTHA | 3541 TRILOGY DR LAS VEGAS NV 89108-4778 | 13812314032 |
| D A D L NEVADA L L C | %DL CHAPMAN 5546 CAMINO AL NORTE #2-296 NO LAS VEGAS NV 89031-0805 | 13812314011 |
| D F A L L C | 1401 MINERAL AVE LAS VEGAS NV 89106-4342 | 13812301014 |
| D F A L L C | 1401 MINERAL AVE LAS VEGAS NV 89106-4342 | 13812301003 |
| D F A L L C | 1401 MINERAL AVE LAS VEGAS NV 89106-4342 | 13812301004 |
| D F A L L C | 1401 MINERAL AVE LAS VEGAS NV 89106-4342 | 13812301002 |
| DAVILA ARELIS C | 3456 TRILOGY DR LAS VEGAS NV 89108-4781 | 13812314022 |
| DAVIS WILLIAM H & ELIZABETH E | %KERRYS SPORTS PUB 3520 N RANCHO DR LAS VEGAS NV 89130-3120 | 13812315010 |
| DENGUILAY VANNITHONE B | VANNITHONE MING 5717 SANTA CATALINA AVE LAS VEGAS NV 89108-4708 | 13812414008 |
| DIEPPA NILDA M | 5713 SANTA CATALINA AVE LAS VEGAS NV 89108-4708 | 13812414009 |
| DIMBSTHAL L L C | %J SADDI P O BOX 50191 HENDERSON NV 89016-0191 | 13812315008 |
| DIZON JESUS A & AURORA G | DIZON ARLENE G 3437 TRILOGY DR LAS VEGAS NV 89108-4780 | 13812312017 |
| DOSHI PINAL & FALGUNI | 12915 BERKHAMSTED ST CERRITOS CA 90703-7235 | 13812311061 |
| DOWELL DENNIS L | 3337 TERRA BELLA DR LAS VEGAS NV 89108-4749 | 13812414022 |
| D'SOUZA PAUL C | 3432 TRILOGY DR LAS VEGAS NV 89108-4780 | 13812312033 |

Report of All Selected Parcels**Case Number:** VAR-50841**Printed On:** Mon: August 26, 2013

| <u>Owner</u> | <u>Address</u> | <u>Parcel Number</u> |
|----------------------------------|---|----------------------|
| DUARTE RONALD E & PAM | 5305 EVERGREEN MEADOW AVE LAS VEGAS NV 89130-7070 | 13812710052 |
| DUENAS-ORTIZ CECILIA E | 3505 TRILOGY DR LAS VEGAS NV 89108-4700 | 13812312004 |
| DUTY DARREN | 3524 TRILOGY DR LAS VEGAS NV 89108-4700 | 13812314009 |
| E S C DEVELOPMENT L L C | %R ESTEY II P O BOX 93835 LAS VEGAS NV 89193-3835 | 13812801003 |
| E S C DEVELOPMENT L L C | %R ESTEY II P O BOX 93835 LAS VEGAS NV 89193-3835 | 13812801006 |
| E S M I PROPERTIES L L C | 5252 RICKY RD LAS VEGAS NV 89130-3108 | 13812710054 |
| EDWARDS REBECCA E & ANTHONY C | 3500 VENICE DR LAS VEGAS NV 89108-4774 | 13812311012 |
| ELLIS LLOYD JR & E REV LIV TR | %L & E ELLIS 3705 OCEAN WATERS ST LAS VEGAS NV 89129-7863 | 13812311029 |
| ELLISON-KLINE EDNA | KLINE JAMES J 3313 POINT LOBOS DR LAS VEGAS NV 89108-4761 | 13812415022 |
| ENZI ROGER R & LINDA J | 379 E 600 S MONROE UT 84754-4403 | 13812414011 |
| EVANS ROBERT | 25422 TRABUCO RD #105-399 LAKE FOREST CA 92630-2791 | 13812311030 |
| EVERGREEN-SAN DIEGO L L C | EVERGREEN-OXNARD L L C 2635 CAMINO DEL RIO SOUTH #300 SAN DIEGO CA 92108-3728 | 13812401002 |
| EWING IRRIGATION PRODUCTS INC | 3441 E HARBOUR DR PHOENIX AZ 85034-7229 | 13812301019 |
| EWING IRRIGATION PRODUCTS INC | 3441 E HARBOUR DR PHOENIX AZ 85034-7229 | 13812301018 |
| FADDIS RICHARD | 5307 JAY AVE LAS VEGAS NV 89130-3101 | 13812710039 |
| FINKE DOUGLAS & PATRICIA J | 3504 VENICE DR LAS VEGAS NV 89108-4774 | 13812311011 |
| FLORES-GRANADOS OSMIN | 5521 W CHEYENNE AVE #D LAS VEGAS NV 89108-4787 | 13812311027 |
| FORBIDDEN HOLDINGS L L C | P O BOX 231135 LAS VEGAS NV 89105-1135 | 13812312023 |
| FREEMAN MATTHEW D & JOVANNA E | 3412 MIRAMAR DR LAS VEGAS NV 89108-4705 | 13812311060 |
| GARCIA JAVIER | MAZARIEGOS MARCOLFA 12222 WICKS ST SUN VALLEY CA 91352 | 13812311015 |
| GARCIA-VILLA JOSE D | GARCIA CLAUDIA H 3600 WATERHOLE ST LAS VEGAS NV 89130-2909 | 13812611029 |
| GIANFREDA CATHERINE | 3440 TRILOGY DR LAS VEGAS NV 89108-4780 | 13812314026 |
| GIBSON LEE G & MARIA C | 2730 BELCASTRO ST LAS VEGAS NV 89117-3038 | 13812314015 |
| GIBSON LEE GARDNER & MARIA C | 2730 BELACASTRO ST LAS VEGAS NV 89117-3038 | 13812312011 |
| GIBSON MARIA | 2730 BELCASTRO ST LAS VEGAS NV 89117-3038 | 13812312008 |
| GIJON JUAN | 3240 ARLENE WY LAS VEGAS NV 89108-4621 | 13812812001 |
| GODINEZ JOSE ANTONIO | 5225 W GOWAN RD LAS VEGAS NV 89130-3118 | 13812710005 |
| GONZALES ADRIAN F | 424 E SMITH ST LONG BEACH CA 90805-2921 | 13812710003 |
| GRANGE TRUST | GRANGE SCOTT M & PHYLLIS A TRS 2909 HADDEN DR LAS VEGAS NV 89134-8981 | 13812610012 |
| GUIDI ALBERT J & MILVIA L REV TR | GUIDI ALBERT J & MILVIA L CO-TRS 3370 RAMONA ST PALO ALTO CA 94306-3528 | 13812313004 |
| GUTIERREZ ROBERTO | 6517 OUIDA WAY LAS VEGAS NV 89108-5524 | 13812311053 |
| HAAG DAVID & SARAH | 3477 TRILOGY DR LAS VEGAS NV 89108-4781 | 13812312007 |

Report of All Selected Parcels**Case Number:** VAR-50841**Printed On:** Mon: August 26, 2013

| <u>Owner</u> | <u>Address</u> | <u>Parcel Number</u> |
|----------------------------------|---|----------------------|
| HAGEN RANDY W | 3537 TRILOGY DR LAS VEGAS NV 89108-4778 | 13812314031 |
| HALL JANICE N | 34 N 300 W #465-5 ROOSEVELT UT 84066-2746 | 13812311038 |
| HALSTAN INC | 6433 GLADIOLUS CT LAS VEGAS NV 89108-5604 | 13812710044 |
| HART MARTHA & BRIAN C | 5716 SANTA CATALINA AVE LAS VEGAS NV 89108-4709 | 13812411005 |
| HEDGES EDITH K LIVING TRUST | HEDGES COLIN K & WAYNE K CO-TRS 5320 GABARONE AVE LAS VEGAS NV 89108-2317 | 13812710047 |
| HERRERA DELIA SAR & ROGER | 45529 W GUILDUR AVE MARICOPA AZ 85139-6629 | 13812314014 |
| HERRERA JOSE DAVID & MARIA A | 3424 SUN RHYTHM ST LAS VEGAS NV 89129-8169 | 13812801004 |
| HIBLER TRUST | HIBLER THOMAS W TRS 5701 BAY CIR LAS VEGAS NV 89108-4701 | 13812311042 |
| HILEMAN JOSEPH M & ZOLA JEAN | 3400 VENICE DR LAS VEGAS NV 89108-4713 | 13812311024 |
| HILL CHARLES E & JOANNE D | 3512 MIRAMAR DR LAS VEGAS NV 89108-4771 | 13812311049 |
| I B 3601 NORTH RANCHO L L C | %L SHAPIRO 10300 W CHARLESTON BLVD #13-156 LAS VEGAS NV 89135-1037 | 13812202004 |
| J 2 K L L C | 4327 SOUTH 1350 EAST SALT LAKE CITY UT 84124-2779 | 13812312022 |
| J T S S L L C | 1224 S RIVER ROAD #B220 ST GEORGE UT 84790-8554 | 13812811021 |
| J T S S L L C | 1224 S RIVER RD #B-220 ST GEORGE UT 84790-8554 | 13812811002 |
| JAFFE FAMILY TRUST | JAFFE EDWARD & VIOLET TRS 10424 BUSH MOUNTAIN AVE LAS VEGAS NV 89166-5005 | 13812314018 |
| JERGER BENEDICT K & J REV LIV TR | JERGER BENEDICT K TRS 3417 TRILOGY DR LAS VEGAS NV 89108-4779 | 13812312021 |
| JOHNSON MICHAEL R | 5712 SANTA CATALINA AVE LAS VEGAS NV 89108-4709 | 13812311025 |
| JOHNSON WILLIAM C | 3345 TERRA BELLA DR LAS VEGAS NV 89108-4749 | 13812414024 |
| JOJKIC ANGELA | TIBLJAS BRUNO 5708 SANTA CATALINA AVE LAS VEGAS NV 89108-4709 | 13812311026 |
| KATZOVITZ HAROLD | 11054 VENTURA BLVD #248 STUDIO CITY NV 91604-3546 | 13812312027 |
| KEENE ALLEN D & CHERYL L | 3324 TERRA BELLA DR LAS VEGAS NV 89108-4748 | 13812414013 |
| KILLIAN CHRISTINA M | 3424 MIRAMAR DR LAS VEGAS NV 89108-4705 | 13812311057 |
| KING FUTT'S P F M L L C | 5700 BOULDER HWY LAS VEGAS NV 89122-7204 | 13812311021 |
| KORBEL VALERIE REVOCABLE LIV TR | KORBEL VALERIE TRS 3616 WATERHOLE ST LAS VEGAS NV 89130-2909 | 13812611027 |
| LANGE TERESA A | 5720 SANTA CATALINA AVE LAS VEGAS NV 89108-4709 | 13812411004 |
| LANGEL ANDREW J & JANICE F TRS | 5106 EUGENE AVE LAS VEGAS NV 89108-3000 | 13812411003 |
| LAS VEGAS VALLEY WATER DISTRICT | %LAND ACQUISITION & MGT MS95 P O BOX 99956 LAS VEGAS NV 89193 | 13812801005 |
| LIANG LIWEI | 1281 S 2ND ST RATON NM 87740-2234 | 13812313001 |
| LIFSEY JOAN L | 5720 CABRILLO CIR LAS VEGAS NV 89108-4702 | 13812311036 |
| LLAMAS JELLISA L | 3504 MIRAMAR DR LAS VEGAS NV 89108-4771 | 13812311051 |
| LONDONO JAIME R | 3512 VENICE DR LAS VEGAS NV 89108-4774 | 13812311009 |
| MALEK LIVING TRUST | MALEKSALEHI SHOHREH TRS 4966 EL CAMINO REAL #209 LOS ALTOS CA 94022-1458 | 13812401001 |

Report of All Selected Parcels**Case Number:** VAR-50841**Printed On:** Mon: August 26, 2013

| <u>Owner</u> | <u>Address</u> | <u>Parcel Number</u> |
|---------------------------------|--|----------------------|
| MARTINEZ SAMUEL MERCADO | 3424 VENICE DR LAS VEGAS NV 89108-4713 | 13812311018 |
| MCBRIDE STEVE & ANDREA | 3608 WATERHOLE ST LAS VEGAS NV 89130-2909 | 13812611028 |
| MCCRANEY RICKY L | 5700 BAY CIR LAS VEGAS NV 89108-4701 | 13812311047 |
| MELARA NELSON WIGBERTO | GARCIA LUIS ALONSO & LYDIA M 5709 CABRILLO CIR LAS VEGAS NV 89108-4770 | 13812311032 |
| MELENDEZ FILOMENA DE MARIA | 3468 TRILOGY DR LAS VEGAS NV 89108-4781 | 13812314019 |
| MELENDEZ OMAR A | 1701 ROCK SPRINGS DR LAS VEGAS NV 89128-3126 | 13812314008 |
| MERCADO CONSUELO M | 5700 CABRILLO CIR LAS VEGAS NV 89108-4702 | 13812311041 |
| MERCADO JOSE RAFAEL | 3424 VENICE DR LAS VEGAS NV 89108-4713 | 13812314016 |
| MEUNIER CLARK | 3521 TRILOGY DR LAS VEGAS NV 89108-4700 | 13812314027 |
| MILLER JAMES E & REBECCA K | 3328 TERRA BELLA DR LAS VEGAS NV 89108-4754 | 13812414012 |
| MOUG WILLIAM R SR | 3441 TRILOGY DR LAS VEGAS NV 89108-4780 | 13812313005 |
| MUNOZ SANTOS | BARRERA MARIA E 3220 W 109TH ST INGLEWOOD CA 90303-2032 | 13812312026 |
| MUSSER KURT & SHERRYL | 3252 HIGHLAND CARLSBAD CA 92008-1918 | 13812314012 |
| NATIONAL CREDIT UNION ADMIN | 4807 SPICEWOOD SPRINGS RD #5100 AUSTIN TX 78759-8438 | 13812710040 |
| NAUTICAL BEACH L L C | 3830 VALLEY CENTRE DR #705-306 SAN DIEGO CA 92130-3320 | 13812311046 |
| NIZNICK JEFFREY A & MARYBETH D | 6275 BUNKER COMMONS CT LAS VEGAS NV 89108-3962 | 13812314002 |
| NORPESON L L C | 3544 TRILOGY DR LAS VEGAS NV 89108-4777 | 13812314004 |
| PEACH JANET | 3416 MIRAMAR DR LAS VEGAS NV 89108-4705 | 13812311059 |
| PERKINS LIVING TRUST | PERKINS J D & DONNA TRS 3404 VENICE DR LAS VEGAS NV 89108-4713 | 13812311023 |
| PICHON GEORGE C | 3449 TRILOGY DR LAS VEGAS NV 89108-4780 | 13812313003 |
| PIERCE ROGER S | 5708 CABRILLO CIR LAS VEGAS NV 89108-4702 | 13812311039 |
| POLTRONIERI DANIEL M & TERESITA | 3508 TRILOGY DR LAS VEGAS NV 89108-4700 | 13812314013 |
| PONCE DAVID & MARIA DEL CARMEN | 3213 POINT LOBOS DR LAS VEGAS NV 89108-4759 | 13812811022 |
| PRAPAVAT FAMILY TRUST | PRAPAVAT VUTHISIT & JONGCHIT TRS 6925 PARAMOUNT BLVD #B LONG BEACH CA 90805-1865 | 13812313002 |
| PUIA FRANK J JR & TERESA M | 3428 TRILOGY DR LAS VEGAS NV 89108-4780 | 13812312032 |
| Q D H Y GROUP CO USA LTD | 7680 LITTLE VALLEY AVE LAS VEGAS NV 89147-8508 | 13812314025 |
| QUINN RICARDO J | 5709 BAY CIR LAS VEGAS NV 89108-4701 | 13812311044 |
| QUOCK LES L | QUOCK STANLEY P O BOX 6627 MORAGA CA 94570-6627 | 13812801002 |
| R & S FAMILY TRUST | RASMUSSEN RICHARD J TRS %REAL ESTATE SPECIALISTS 531 S 10TH ST LAS VEGAS NV 89101-7025 | 13812311037 |
| R J J M L P | 4617 SAVIN CIR LAS VEGAS NV 89130-5373 | 13812312018 |
| R L GOWAN L L C | 4949 CAMPBELL RD LAS VEGAS NV 89149-3525 | 13812315009 |

Report of All Selected Parcels**Case Number:** VAR-50841**Printed On:** Mon: August 26, 2013

| <u>Owner</u> | <u>Address</u> | <u>Parcel Number</u> |
|----------------------------------|--|----------------------|
| RAMIREZ FERNANDO F | 3436 TRILOGY DR LAS VEGAS NV 89108-4780 | 13812312034 |
| RAMOS DAVID & ROSALINDA | 5708 BAY CIR LAS VEGAS NV 89108-4701 | 13812311045 |
| RANCHO AUTO CENTER L L C | P O BOX 28008 LAS VEGAS NV 89126-2008 | 13812702001 |
| RANCHO DEL MAR L L C | %S FUNSTON 7065 W ANN RD #130 #662 LAS VEGAS NV 89130-4990 | 13812315006 |
| RANCHO DRIVE L L C | %J MORAN JR %MORAN & ASSOC 630 S 4TH ST #400 LAS VEGAS NV 89101-6604 | 13812810001 |
| RANCHO DRIVE L L C | %J MORAN JR %MORAN & ASSOC 630 S 4TH ST #400 LAS VEGAS NV 89101-6604 | 13812810013 |
| RANCHO GOWAN PROPERTIES L L C | %MDL GROUP/J CLIFFORD 3065 S JONES BLVD #201 LAS VEGAS NV 89146-6780 | 13812213056 |
| REALTY INCOME CORPORATION | %PORTFOLIO MGT P O BOX 460069 ESCONDIDO CA 92046-0069 | 13812710057 |
| RHODES BRITTNEY RANAE | 5310 JAY AVE LAS VEGAS NV 89130-3109 | 13812710041 |
| RICHARDSON HOWARD & JUDY | 687 ROUNDTABLE LAS VEGAS NV 89110-3879 | 13812311010 |
| RICKEY CREST L L C | 5151 TEE PEE LN LAS VEGAS NV 89149-2540 | 13812710055 |
| RICKEY CREST L L C | 5151 TEE PEE LN LAS VEGAS NV 89149-2540 | 13812710056 |
| RODRIGUEZ GABRIEL | 3428 MIRAMIR DR LAS VEGAS NV 89108-4705 | 13812311056 |
| ROSEQUIST CRAIG | 3420 VENICE DR LAS VEGAS NV 89108-4713 | 13812311019 |
| ROTTERDAM PAUL | 3149 MONET SUNRISE AVE HENDERSON NV 89044-0280 | 13812312006 |
| S S D NEVADA | 750 N 17TH LAS CRUCES NM 88005-4153 | 13812801001 |
| SALAS SATURNINO L & LAURA | 15063 FONTTEE LN FONTANA CA 92335 | 13812414021 |
| SANNER FAMILY LIVING TRUST | SANNER GLENN R & RUBY C TRS 3408 VENICE DR LAS VEGAS NV 89108-4713 | 13812311022 |
| SARGENT JEREMY | 3601 WATERHOLE ST LAS VEGAS NV 89130-2908 | 13812611030 |
| SCHMUCK JIM | 3520 MIRAMAR LAS VEGAS NV 89108-4706 | 13812311007 |
| SCHUERMANN MICHAEL R & MARILYN | 3329 TERRA BELLA DR LAS VEGAS NV 89108-4749 | 13812414020 |
| SERVETZ JEFFREY D & ELLEN L | 3432 VENICE DR LAS VEGAS NV 89108-4713 | 13812311016 |
| SHENG YU | 4010 W SAHARA AVE LAS VEGAS NV 89102-3724 | 13812311055 |
| SIEGER ARLETTE G | 288 MADEIRA BLVD MELVILLE NY 11747-5208 | 13812311031 |
| SKILAN FRANCO | 10426 MAGNOLIA BLVD NORTH HOLLYWOOD CA 91601-4108 | 13812312031 |
| SLACK JOHN P | 5700 SANTA CATALINA AVE LAS VEGAS NV 89108-4709 | 13812311028 |
| SMITH NORMAN L & M J REV TR AGMT | SMITH NORMAN L & MURIEL J CO-TRS 3420 MIRAMAR DR LAS VEGAS NV 89108-4705 | 13812311058 |
| SOLORZANO KAREN B | 5301 W GOWAN RD LAS VEGAS NV 89130-3116 | 13812710004 |
| SOUTHERN NV HOUSING AUTHORITY | %C ROWE 340 N 11 ST #170 LAS VEGAS NV 89101-3125 | 13812312019 |
| SOWERS SHANNON J & SUSAN I | 5217 W GOWAN RD LAS VEGAS NV 89130-3118 | 13812710006 |
| SPARKS MICHAEL & JUDITH F | 3617 BRADLEY RD LAS VEGAS NV 89130-2917 | 13812610011 |
| STANDARD SAMUEL C | PAYAO CHERRY BIC B 3416 TRILOGY DR LAS VEGAS NV 89108-4779 | 13812312029 |

Report of All Selected Parcels**Case Number:** VAR-50841**Printed On:** Mon: August 26, 2013

| <u>Owner</u> | <u>Address</u> | <u>Parcel Numbe</u> |
|---------------------------------|--|---------------------|
| TAGUCHI FAMILY TRUST | TAGUCHI JIMMIE M & MARY S TRS 2102 W 166TH ST TORRANCE CA 90504-1906 | 13812414023 |
| TANG KWAN NAM | 15155 LEFFINGWELL RD WHITTIER CA 90604-2272 | 13812312009 |
| TELLEZ DOLORES | 3476 TRILOGY DR LAS VEGAS NV 89108-4781 | 13812314017 |
| THOMAS ANTHONY | 3452 TRILOGY DR LAS VEGAS NV 89108-4780 | 13812314023 |
| THOMPSON MAXINE | %D THOMPSON 4121 BUFFALO BILL LAS VEGAS NV 89110-3295 | 13812311014 |
| TINKER L L C | 6200 SMOKE RANCH RD LAS VEGAS NV 89108-3891 | 13812301017 |
| TSOU SUN FAMILY TRUST | 6704 OLD NEWBURY AVE LAS VEGAS NV 89108-0252 | 13812314003 |
| USSERY JAKE W TRUST | TEMPLE LOUISE A TRS P O BOX 570332 LAS VEGAS NV 89157-0332 | 13812710053 |
| V R INVESTMENTS L L C | %V HASON 7500 W LAKE MEAD LAS VEGAS NV 89128-0297 | 13812311033 |
| VARGA LASZLO B & ILDIKO | 3808 OLD ORCHARD CT LAS VEGAS NV 89108-5243 | 13812312025 |
| VASQUEZ DOUGLAS & DAISY | 3532 TRILOGY DR LAS VEGAS NV 89108-4777 | 13812314007 |
| VAZQUEZ CASIMIRO | 3448 TRILOGY DR LAS VEGAS NV 89108-4780 | 13812314024 |
| WAGNER FRED A | 3520 TRILOGY DR LAS VEGAS NV 89108-4700 | 13812314010 |
| WASLESKY JACK W & THERESA M | 5301 JAY AVE LAS VEGAS NV 89130-3101 | 13812710049 |
| WILSON LIVING TRUST | WILSON JAMES C & LINDA TRS 3348 N RANCHO DR LAS VEGAS NV 89130-3121 | 13812810002 |
| WITZEL FAMILY TRUST | %D & N WITZEL TRS 9505 BALLINDARRY AVE #7 LAS VEGAS NV 89129-6975 | 13812311035 |
| WOJTOWICZ STANLEY P & VALERIE G | WOJTOWICZ STANLEY & V REV TR 6433 GLADIOLUS CT LAS VEGAS NV 89108-5604 | 13812710001 |
| YOUNG LINDA P | MCKINLAY JERRY B 5259 JAY AVE LAS VEGAS NV 89130-3138 | 13812710050 |
| ZARGARI MAHYAR | 9030 W SAHARA AVE #668 LAS VEGAS NV 89117-5744 | 13812811001 |