

City of Las Vegas
Department of Planning
Development Services Center
333 North Rancho Drive, 3rd Floor
Las Vegas, Nevada 89106

5 ✓
PRSR
FIRST CLASS MAIL
U.S. Postage
PAID
Las Vegas, NV
Permit No. 1630

Return Service Requested
Official Notice of Public Hearing

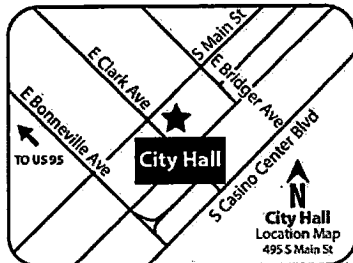

If you wish to file your protest or support on this request, check the appropriate box below and return this card in an envelope with postage to the Department of Planning at the address listed above; fax this side of this card to (702) 464-7499 or make your comments at www.lasvegasnevada.gov. If you would like to contact your Council Representative, please call (702) 229-6405.

I SUPPORT
this Request

I OPPOSE
this Request

Please use available blank space on card for your comments.

VAC-66473 [PRJ-66358]

Planning Commission Meeting of 10/11/2016

5 ✓

Application Information

VAC-66473 - VACATION RELATED TO GPA-66467, ZON-66468, VAR-66469, WVR-66470 AND WVR-66471 - PUBLIC HEARING - APPLICANT: DR HORTON, INC. - OWNER BERNARD AND ESTELLE KAHN, ET AL - For possible action on a request for a Petition to Vacate U.S. Government Patent Easements on property located at the northwest corner of El Campo Grande Avenue and Alpine Ridge Way (APNs 126-25-301-004 and 005), Ward 6 (Ross) [PRJ-66358].

Application Location

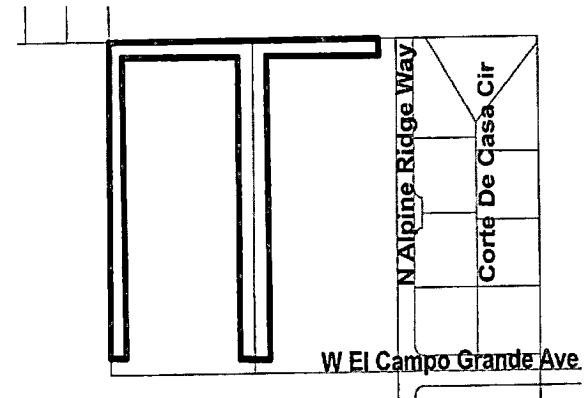

The proposed project may not pertain to the entire highlighted project site.

Public Hearing Information

Meeting: Planning Commission
Date: *October 11, 2016*
Time: 9:00 A.M.
Location: City Council Chambers
495 South Main Street, 2nd Floor
Las Vegas, Nevada 89101

Any and all interested persons may appear before the City Planning Commission either in person or by representative and object to or express approval of this request; or may, prior to this meeting, file a written objection thereto or approval thereof with the Department of Planning, Development Services Center, 333 North Rancho Drive, 3rd Floor, Las Vegas, Nevada 89106. Final Action on General Plan Amendments and Rezoning will be determined by the City Council. Other public hearing items may be deemed Final Action by the Planning Commission or forwarded to the City Council. The date of the City Council meeting, if applicable, will be announced at the Planning Commission meeting after the discussion of the item. For further information, including the full staff report, please call (702) 229-6301 (TTY 7-1-1) or go to <http://www.lasvegasnevada.gov>.

Report of All Selected ParcelsCase Number:VAC-66473
~~GPA-66467, ZON-66468~~Printed On: Mon: September 12, 2016

<u>Owner</u>	<u>Address</u>	<u>Parcel Numbe</u>
ARGO FAMILY TRUST	5850 S MICHELLI CREST WAY LAS VEGAS NV 89149-1217	12625701031
BACA RANDY J	6028 ALPINE ESTATES CIR LAS VEGAS NV 89149-2023	12625211001
BANK NEW YORK MELLON TRS	4708 MERCANTILE DR FORT WORTH TX 76137	12625801006
BARFIELD JOSHUA	5725 MICHELLI CREST WAY LAS VEGAS NV 89149	12625801022
BARKEN MARVIN B & CINDY C REV TR	BARKEN MARVIN B & CINDY C TRS 10455 W LA MANCHA AVE LAS VEGAS NV 89149-1006	12625401014
BARKER BILLY H & MARIE	5905 GOLDEN AROWANA WAY LAS VEGAS NV 89149	12625310007
BARRETT CHAD L & SHANNON	6028 GOLDEN AROWANA WAY LAS VEGAS NV 89149	12625213005
BARRY BARBARA ANN	2336 MINOLTA CT HENDERSON NV 89044	12625701030
BECK FAMILY TRUST	BECK STEPHEN E & PATRICIA TRS 5940 MICHELLI CREST WY LAS VEGAS NV 89149-1218	12625701006
BONEY CHARLES L & PAULA A REVOCA	BONEY CHARLES L & PAULA A CO-TRS 5842 CORTE DE CASA CIR LAS VEGAS NV 89149	12625710006
BOYD FAMILY TRUST	BOYD RENE THOMAS JR & R TRS 5750 N ALPINE RIDGE WY LAS VEGAS NV 89149-1248	12625801019
BRANDT TRAVIS	6042 GOLDEN AROWANA WAY LAS VEGAS NV 89149	12625213004
BRENNAN KRIS V & ANGELA C	6072 ALPINE ESTATES CIR LAS VEGAS NV 89149-2024	12625211018
CASPER FAMILY TRUST	CASPER HERBERT J & ELIZABETH S T 10270 W EL CAMPO GRANDE AVE LAS VEGAS NV 89149-1212	12625701035
COPE JAMES E & SARAH BETH C	5942 GOLDEN AROWANA WAY LAS VEGAS NV 89149	12625310005
COUNTY OF CLARK(PUBLIC WORKS)	500 S GRAND CENTRAL PKWY LAS VEGAS NV 89155	12625401022
COUNTY OF CLARK(PUBLIC WORKS)	500 S GRAND CENTRAL PKWY LAS VEGAS NV 89155	12625401023
COUNTY OF CLARK(PUBLIC WORKS)	500 S GRAND CENTRAL PKWY LAS VEGAS NV 89155	12625301010
COUNTY OF CLARK(PUBLIC WORKS)	500 S GRAND CENTRAL PKWY LAS VEGAS NV 89155	12625301009
DUIS FAMILY TRUST	DUIS LARRY & IRENE M TRS 5861 CORTE DE CASA CIR LAS VEGAS NV 89149	12625710001
FINK FAMILY TRUST	FINK WILLIAM C & NANCY A TRS 5933 GOLDEN AROWANA WAY LAS VEGAS NV 89149	12625310009
FORNEY DOROTHY J	WALTERS CARRIE L 10250 W EL CAMPO GRANDE AVE LAS VEGAS NV 89149	12625701037
FRANCO LINDA	5998 GOLDEN AROWANA WAY LAS VEGAS NV 89149	12625310001
FRANKEN BENJAMIN E & MYONGSU	6056 GOLDEN AROWANA WAY LAS VEGAS NV 89149	12625212021
GERBER MATTHEW D & JENNIFER A	6025 ALPINE ESTATES CIR LAS VEGAS NV 89149-2023	12625211025
GIBSON FAMILY TRUST	GIBSON DONALD & BARBARA J TRS 6014 ALPINE ESTATES CIR LAS VEGAS NV 89149-2023	12625211005
GIBSON PATRICIA A	5960 MICHELLI CREST WY LAS VEGAS NV 89149-1218	12625701002
GRAUBERGER ELDON & CAROL A REVOC	GRAUBERGER ELDON & CAROL A TRS 10280 W EL CAMPO GRANDE AVE LAS VEGAS NV 89149-1245	12625701034
HALL ROBERT EDWARD LEE JR & ROSA	6003 GOLDEN AROWANA WAY LAS VEGAS NV 89149	12625310014
HELFMAN FAMILY SURVIVORS TRUST	HELFMAN LAUREN DEPIERO TRS 5112 FOREST OAKS DR LAS VEGAS NV 89149	12625801003
HELFMAN LAUREN	HELFMAN FAMILY SURVIVOR'S TRUST 5112 FOREST OAKS DR LAS VEGAS NV 89149	12625801001

Report of All Selected Parcels**Case Number:****VAC-66473**
~~CBA 60407, ZON-00468~~**Printed On:** Mon: September 12, 2016

<u>Owner</u>	<u>Address</u>	<u>Parcel Numbe</u>
HOGAN RUSSELL M & DALENA	5956 GOLDEN AROWANA WAY LAS VEGAS NV 89149	12625310004
HORTON D R INC	1081 WHITNEY RANCH DR #141 HENDERSON NV 89014	12625701001
HOSANNY RHYMAL L	6059 GOLDEN AROWANA WAY LAS VEGAS NV 89149	12625212001
HUCKLEBUCK IRREVOCABLE SPENDTHRI	MCKAY KENNETH R & DENISE S TRS 10260 W EL CAMPO GRANDE AVE LAS VEGAS NV 89149-1212	12625701036
HUME PAUL W & DAWN E	6014 GOLDEN AROWANA WAY LAS VEGAS NV 89149	12625213006
JAKOVAC AMANDA M	6024 ALPINE ESTATES CIR LAS VEGAS NV 89149-2023	12625211007
JORDAN LYLE & IRENE A	6020 ALPINE ESTATES CIR LAS VEGAS NV 89149-2023	12625211006
KAHN BERNARD & ESTELLE	25 B ELMWOOD TERR ELMWOOD PARK NJ 07407-1728	12625301004
LERONI L L C	1600 PINE ST LAS VEGAS NV 89102-2242	12625301003
LEWIS RACHEL B & MATTHEW G	5919 GOLDEN AROWANA WAY LAS VEGAS NV 89149	12625310008
LIBERTY HOMES LAS VEGAS L L C	1180 N TOWN CENTER DR #100 LAS VEGAS NV 89144	12625710002
LIBERTY HOMES LAS VEGAS L L C	1180 N TOWN CENTER DR #100 LAS VEGAS NV 89144	12625710003
LIBERTY HOMES LAS VEGAS L L C	1180 N TOWN CENTER DR #100 LAS VEGAS NV 89144	12625710005
LIBERTY HOMES LAS VEGAS L L C	1180 N TOWN CENTER DR #100 LAS VEGAS NV 89144	12625710009
LIBERTY HOMES LAS VEGAS L L C	1180 N TOWN CENTER DR #100 LAS VEGAS NV 89144	12625710008
LIBERTY HOMES LAS VEGAS L L C	1180 N TOWN CENTER DR #100 LAS VEGAS NV 89144	12625710007
LIBERTY HOMES LAS VEGAS L L C	1180 N TOWN CENTER DR #100 LAS VEGAS NV 89144	12625710004
LIEN STEPHANIE TRUST	LIEN STEPHANIE TRS 5860 MICHELLI CREST WY LAS VEGAS NV 89149-1217	12625701032
LONG GARY W	5975 GOLDEN AROWANA WAY LAS VEGAS NV 89149	12625310012
MISSAGHI BIJAN & DENA	5961 GOLDEN AROWANA WAY LAS VEGAS NV 89149	12625310011
MOORE MATTHEW S & JENNIFER K	5989 GOLDEN AROWANA WAY LAS VEGAS NV 89149	12625310013
MURRAY MICHAEL T	CRAWFORD-MURRAY CONNIE D 6031 GOLDEN AROWANA WAY LAS VEGAS NV 89149	12625213002
NORTON EDWARD C II & VICTORIA S	6077 ALPINE ESTATES CIR LAS VEGAS NV 89149-2024	12625211020
PERNICIARO THOMAS	6029 ALPINE ESTATES CIR LAS VEGAS NV 89149-2023	12625211024
RAMIREZ TONY & ESMERALDA	5947 GOLDEN AROWANA WAY LAS VEGAS NV 89149	12625310010
REED EDWARD W & MARY K	6090 ALPINE ESTATES CIR LAS VEGAS NV 89149-2024	12625211003
SCHRAEDER FAMILY TRUST	SCHRAEDER SYLVIA A TRS 1729 N MICHAEL WY LAS VEGAS NV 89108-2306	12625801005
SCHUSTER CHELSEA L & SCOTT R	6045 GOLDEN AROWANA WAY LAS VEGAS NV 89149	12625213003
SCOTT BILL & JO A	5928 GOLDEN AROWANA WAY LAS VEGAS NV 89149	12625310006
SHAPIRO ELAINE KAHN & FRED J	34-10 HILLSIDE TERRACE FAIR LAWN NJ 07410-4255	12625301005
SIERRA DAVID R & LISA M	5870 MICHELLI CREST WAY LAS VEGAS NV 89149	12625701033

Report of All Selected ParcelsCase Number:**VAC-66473**
~~GPA-66467, ZON-66468~~Printed On: Mon: September 12, 2016

<u>Owner</u>	<u>Address</u>	<u>Parcel Numbe</u>
SMITH FAMILY TRUST	SMITH JULIANA B TRS 5980 MICHELLI CREST WY LAS VEGAS NV 89149-1218	12625701003
SPRIGGS JAMES C & SUSAN L	6073 ALPINE ESTATES CIR LAS VEGAS NV 89149-2024	12625211021
THEWIS DANIEL J	5125 WOODLAWN BLVD MINNEAPOLIS MN 55417	12625701061
THOMAS CYNTHIA M	6076 ALPINE ESTATES CIR LAS VEGAS NV 89149-2024	12625211019
THOMAS MICHAEL R	10465 W LA MANCHA AVE LAS VEGAS NV 89149	12625401011
THOMPSON BRUCE & SUSANN	6086 ALPINE ESTATES CIR LAS VEGAS NV 89149-2024	12625211002
TIEDT DAVID	HALEY JENNIFER 5970 GOLDEN AROWANA WAY LAS VEGAS NV 89149	12625310003
VANHOOVE KYLE & BLYTHE	6028 ALPINE ESTATES CIR LAS VEGAS NV 89149-2023	12625211008
WILKINSON WESLEY E	P O BOX 752726 LAS VEGAS NV 89136	12625213001
WILLIAMS LELAND L TRUST	WILLIAMS LELAND TRS 10475 W LA MANCHA AVE LAS VEGAS NV 89149-1006	12625401012
WILLIAMS LELAND L TRUST	WILLIAMS LELAND L TRS 10475 N LA MANCHA AVE LAS VEGAS NV 89149-1006	12625401013
WOOD DAVID & JULIA	5984 GOLDEN AROWANA WAY LAS VEGAS NV 89149	12625310002
YOST DOUGLAS	6010 ALPINE ESTATES CIR LAS VEGAS NV 89149-2023	12625211004