

City of Las Vegas
Department of Planning
Development Services Center
333 North Rancho Drive, 3rd Floor
Las Vegas, Nevada 89106

Return Service Requested
Official Notice of Public Hearing

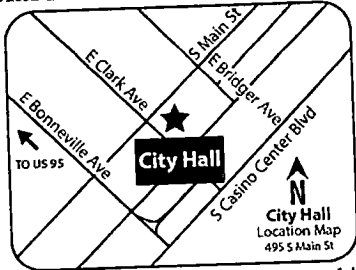

If you wish to file your protest or support on this request, check the appropriate box below and return this card in an envelope with postage to the Department of Planning at the address listed above, fax this side of this card to (702) 464-7499 or make your comments at www.lasvegasnevada.gov. If you would like to contact your Council Representative, please call (702) 229-6405.

I SUPPORT
this Request

I OPPOSE
this Request

Please use available blank space on card for your comments.

SUP-67489 [PRJ-67423]

Planning Commission Meeting of 12/13/2016

5, ✓
PRSR
FIRST CLASS MAIL
U.S. Postage
PAID
Las Vegas, NV
Permit No. 1630

25 ✓

Application Information

SUP-67489 - SPECIAL USE PERMIT - PUBLIC HEARING - APPLICANT/OWNER: HARRISON PROPERTIES, LTD - For possible action on a request for a Special Use Permit TO ALLOW AN AUTOMOBILE RENTAL USE at 725 South Las Vegas Boulevard, Suite #260 (APN 139-34-401-020), C-2 (General Commercial) Zone, Ward 3 (Coffin) [PRJ-67423].

Application Location

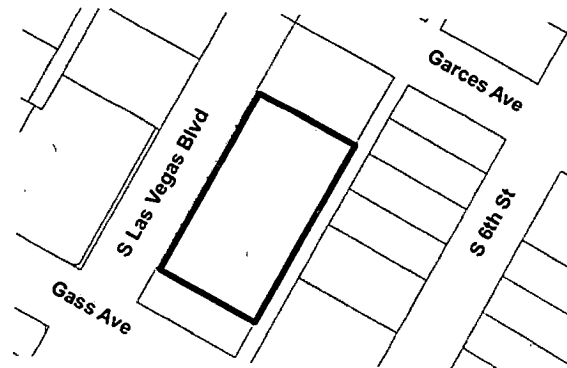

The proposed project may not pertain to the entire highlighted project site.

Public Hearing Information

Meeting: Planning Commission
Date: *December 13, 2016*
Time: 6:00 P.M.
Location: City Council Chambers
495 South Main Street, 2nd Floor
Las Vegas, Nevada 89101

Any and all interested persons may appear before the City Planning Commission either in person or by representative and object to or express approval of this request; or may, prior to this meeting, file a written objection thereto or approval thereof with the Department of Planning, Development Services Center, 333 North Rancho Drive, 3rd Floor, Las Vegas, Nevada 89106. Final Action on General Plan Amendments and Rezonings will be determined by the City Council. Other public hearing items may be deemed Final Action by the Planning Commission or forwarded to the City Council. The date of the City Council meeting, if applicable, will be announced at the Planning Commission meeting after the discussion of the item. For further information, including the full staff report, please call (702) 229-6301 (TTY 7-1-1) or go to <http://www.lasvegasnevada.gov>.

S.V

Report of All Selected Parcels

Case Number:

SUP-67489

Printed On: Thu: November 3, 2016

<u>Owner</u>	<u>Address</u>	<u>Parcel Number</u>
1201 S LAS VEGAS BLVD L L C	1213 S LAS VEGAS BLVD LAS VEGAS NV 89104	13934411104
1412 L L C	217 ROSEMARY LN LAS VEGAS NV 89107	13934411108
1415 L L C	217 ROSEMARY LN LAS VEGAS NV 89107	13934411111
1501 PENTHOUSE INC	%H RITTOFF 900 S LAS VEGAS BLVD #809 LAS VEGAS NV 89101-6850	13934411113
3 BAD CATS TRUST	INGERSOLL DANIELLE TRS 8004 FOUR SEASON DR LAS VEGAS NV 89129	13934410239
3RD GASS PARTNERS L L C	2487 SILVER BEACH DR HENDERSON NV 89052	13934401018
518 GARCES AVE LTD	631 LAS VEGAS BLVD S LAS VEGAS NV 89101-6696	13934410186
518 GARCES AVE LTD	631 S LAS VEGAS BLVD LAS VEGAS NV 89101-6696	13934410180
521 SOUTH THIRD L L C	521 S 3RD ST LAS VEGAS NV 89101	13934301009
611 S 6TH ST L L C	611 S 6TH ST LAS VEGAS NV 89101	13934410221
6TH STREET PARTNERS L L C	8689 W CHARLESTON BLVD #109 LAS VEGAS NV 89117	13934710017
6TH STREET PARTNERS L L C	8689 W CHARLESTON BLVD #109 LAS VEGAS NV 89117	13934710018
702 S 6TH ST L L C	9345 HELENA AVE LAS VEGAS NV 89129-2640	13934401016
708 SIXTH STREET L L C	P O BOX 28887 LAS VEGAS NV 89126-2887	13934410189
708 SIXTH STREET L L C	P O BOX 28887 LAS VEGAS NV 89126-2887	13934410190
715 APARTMENTS L L C	1716 W HORIZON RIDGE PKWY #130 HENDERSON NV 89014	13934410116
716 SOUTH SIXTH STREET L L C	716 S SIXTH ST LAS VEGAS NV 89101-6922	13934410191
717 S 7TH ST L L C	925 LAS PALOMAS DR LAS VEGAS NV 89138	13934410243
718 PROFESSIONAL BUILDING L L C	718 S 8TH ST LAS VEGAS NV 89101-7007	13934810034
777 SOUTH 4TH L L C	555 S 3RD ST LAS VEGAS NV 89101	13934410150
7TH STREET MANAGEMENT L L C	700 S 7TH ST LAS VEGAS NV 89101	13934410227
7TH STREET MANAGEMENT L L C	700 S 7TH ST LAS VEGAS NV 89101	13934410228
830 L L C	830 LAS VEGAS BLVD S LAS VEGAS NV 89101-6723	13934410160
830 L L C	830 LAS VEGAS BLVD S LAS VEGAS NV 89101-6723	13934410161
830 L L C	830 LAS VEGAS BLVD S LAS VEGAS NV 89101-6723	13934410162
900 S LAS VEGAS BLVD #710 L L C	1845 S ELENA AVE #300 REDONDO BEACH CA 90277-5708	13934411010
A A K P	7151 COPPER RD LAS VEGAS NV 89110-4221	13934810010
ABBOTT TAMMY	4008 FOREST KNOLL LN LAS VEGAS NV 89129	13934410230
ACME INVESTMENT SERVICES L L C	3753 HOWARD HUGHES PKWY #200 LAS VEGAS NV 89109	13934410256
ADAMS BRIAN M	712 S 8TH ST LAS VEGAS NV 89101-7007	13934810033
ALVARADO TOMMY C & BETTY J	RICHISON KYLE P 5503 BEACON CT BAKERSFIELD CA 93312-4981	13934312137
AMERICAN PORTFOLIO MORTGAGE CORP	%T PEINADO 800 E NORTHWEST HWY #821 PALATINE IL 60074	13934411089

25 ✓

Report of All Selected Parcels**Case Number:**

SUP-67489

Printed On: Thu: November 3, 2016

<u>Owner</u>	<u>Address</u>	<u>Parcel Number</u>
A-Z PROPERTIES L L C	701 E CHARLESTON LAS VEGAS NV 89104	13934410237
BAHRAMI JAMSHIED NIKKHAH	7817 SEA ROCK RD LAS VEGAS NV 89128-6837	13934411054
BANK U S NATIONAL ASSOCIATION TR	5221 N OCONNOR BLVD #600E IRVING TX 75039	13934311159
BANK U S NATIONAL ASSOCIATION TR	5221 N OCONNOR BLVD #600E IRVING TX 75039	13934311158
BARDI JEANNETTE CHIANG TRUST	BARDI JEANNETTE CHIANG TRS 6398 SOMBRERO AVE CYPRESS CA 90630-5326	13934312065
BARNOSKE JOSEPH	COZZENS CHRISTOPHER 900 LAS VEGAS BLVD S #911 LAS VEGAS NV 89101-6859	13934411043
BEAUDRY GENORA S LIVING TRUST	BEAUDRY GENORA S TRS P O BOX 1790 PORT TOWNSEND WA 98368	13934411015
BECKER ERNEST A JR & K C FAM TR	3065 N RANCHO RD #130 LAS VEGAS NV 89130	13934410104
BECKER NEVADA TRUST	3065 N RANCHO RD #130 LAS VEGAS NV 89130	13934410078
BECKER-NEVADA TRUST	3065 N RANCHO RD #130 LAS VEGAS NV 89130	13934410077
BERMAN BRIAN K & K FAM IRR TR	BERMAN BRIAN KEITH TRS 1340 MARINA DEL REY CT LAS VEGAS NV 89117-1542	13934810036
BETHEL ASSOCIATES L L C	848 N RAINBOW BLVD #653 LAS VEGAS NV 89107-1103	13934411090
BIG DOG PROPERTY	817 S 7TH ST #817 LAS VEGAS NV 89101-6909	13934410238
BLANCETT PHIL	4365 N CAMPBELL RD LAS VEGAS NV 89129	13934411085
BLANCETT PHIL	4365 N CAMPBELL RD LAS VEGAS NV 89129	13934411060
BLEUCIEL L L C	%SOHO #1413~SER IV~UNION JACK MG P O BOX 1108 LAS VEGAS NV 89125	13934411109
BLEUCIEL L L C	%SOHO #1108~SER III~UNION JACK M P O BOX 1108 LAS VEGAS NV 89125	13934411072
BLOOM KELVIN MARK	1080 S BERETANIA ST #GPHW HONOLULU HI 96814-1400	13934411084
BOCCADORO GINA	900 S LAS VEGAS BLVD #1013 LAS VEGAS NV 89101-6861	13934411061
BOGAN VALERIE M	30157 N KESSLER CT CASTAIC CA 91384-4557	13934312155
BONNEVILLE BUNGALOWS L L C	3286 BRENTWOOD ST LAS VEGAS NV 89121	13934710044
BONNEVILLE BUNGALOWS L L C	3286 BRENTWOOD ST LAS VEGAS NV 89121	13934810018
BONNEVILLE CENTER L L C	600 S 3RD ST LAS VEGAS NV 89101-6602	13934311071
BONNEVILLE CENTER L L C	600 S 3RD ST LAS VEGAS NV 89101-6602	13934311072
BONNEVILLE CENTER L L C	600 S 3RD ST LAS VEGAS NV 89101-6602	13934311069
BONNEVILLE CENTER L L C	1068 TAM O SHANTER DR LAS VEGAS NV 89109-1489	13934311070
BOOK LINDA & ROBERT	3944 PARKVIEW DR SALT LAKE CITY UT 84124-2324	13934411003
BOOK ROBERT M & LINDA S	3944 PARK VIEW DR SALT LAKE CITY UT 84124	13934411067
BRAUNSTEIN JANET	VANRIPER MARTHA J 640 FAIRMONT DR CLAREMONT CA 91711-2608	13934312041
BROCKER DOUGLAS L	900 S LAS VEGAS BLVD #1016 LAS VEGAS NV 89101	13934411064
BRODEY LAWRENCE B & CAROL M	647 INWOOD LN SOUTH ORANGE NJ 07079-1107	13934411047
BULAWAN VICENTE	BULAWAN BRYAN D & BESSIE 47-435 HOOPALA ST KANEOHE HI 96744-4843	13934312156

Report of All Selected Parcels**Case Number:**

SUP-67489

Printed On: Thu: November 3, 2016

<u>Owner</u>	<u>Address</u>	<u>Parcel Number</u>
BUYERS ONLY REAL EST AGENCY LLC	555 S 3RD ST LAS VEGAS NV 89101-6501	13934301007
C & A INVESTMENT TRUST	3022 W BEACH DR OAK ISLAND NC 28465-7735	13934710014
C & A INVESTMENT TRUST	3022 W BEACH DR OAK ISLAND NC 28465-7735	13934710013
CAMMARATA PAOLO	10120 S EASTERN AVE #200 HENDERSON NV 89052	13934411125
CANFIELD FAMILY TRUST	CANFIELD ROBERT B & VICTORIA TRS 30981 VIA ESTENAGASAN JUAN CAPIS TRANO CA 92675-2933	13934312075
CANFIELD JENNIFER L	FOX ANDY 30981 VIA ESTENAGA SAN JUAN CAPISTRANO CA 92675	13934312162
CARREDO SALVADOR M	900 S LAS VEGAS BLVD #1113 LAS VEGAS NV 89101-6862	13934411077
CAWLEY F KELLY & ALISON	CAWLEY F KELLY 808 S 6TH ST LAS VEGAS NV 89101-6924	13934410196
CENTRO 910 L L C	910 S LAS VEGAS BLVD LAS VEGAS NV 89101-6823	13934410164
CENTRO 910 L L C	910 S LAS VEGAS BLVD LAS VEGAS NV 89101-6823	13934410140
CHAN DONALD WING LIVING TRUST	CHAN DONALD WING TRS 900 S LAS VEGAS BLVD #1411 LAS VEGAS NV 89101	13934411107
CHANNING REAL ESTATE L L C	131 W 35TH ST 6TH FLR NEW YORK NY 10001-2111	13934411099
CHARLESTON BUILDING L L C	9920 FOLSOM DR LAS VEGAS NV 89134-7502	16203501004
CHARLESTON SUITES L L C	3790 PARADISE RD #250 LAS VEGAS NV 89169-4640	13934410138
CHENG CHING	2775 W PEBBLE RD #318 LAS VEGAS NV 89123-6563	13934411079
CHEUNG KIN YAN	P O BOX 30668 LAS VEGAS NV 89173-0668	13934810013
CHRISTENSEN FAMILY TRUST	CHRISTENSEN JAMES R & DAWN M TRS 601 S 6TH ST LAS VEGAS NV 89101-6919	13934310072
CHRISTENSEN FAMILY TRUST	CHRISTENSEN JAMES R & DAWN M TRS 601 S 6TH ST LAS VEGAS NV 89101-6919	13934410222
CHU JYH-GANG	P O BOX 400882 LAS VEGAS NV 89140	13934411002
CINLEE 7 L L C	608 S 8TH ST LAS VEGAS NV 89101-7005	13934810023
CLARK DOUGLAS ADRON	ORMSBY NANCY KAY 112 NORTH GRANT ST BEULAVILLE NC 28518	13934411051
CLOVELLY L L C	STUPAK SUMMER PATRICIA TRS 3015 BEL AIR DR LAS VEGAS NV 89109	13934410175
COLE & CASHS CASTLE L L C	108 QUAIL RUN RD HENDERSON NV 89014-2149	13934410184
COLE & CASH'S CASTLE L L C	108 QUAIL RUN RD HENDERSON NV 89014-2149	13934310053
COLLURA JOSEPH WILLIAM	WARNKE CAROL 3220 BRYANT AVE LAS VEGAS NV 89102-2055	13934410126
COLUCCI CARMINE J	MINAGIL STEPHEN R 289 E ROBINDALE RD LAS VEGAS NV 89123	13934410217
COWLEY TEAGUE	173 CAMEO DR LIVERMORE CA 94550	13934411092
COWLEY TEAGUE	173 CAMEO DR LIVERMORE CA 94550	13934411044
COWLEY TEAGUE	173 CAMEO DR LIVERMORE CA 94550	13934411115
COWLEY TEAGUE	173 CAMEO DR LIVERMORE CA 94550	13934411116
CRAIG JEFFERY MICHAEL	900 S LAS VEGAS BLVD #712 LAS VEGAS NV 89101	13934411012

Report of All Selected Parcels**Case Number:**

SUP-67489

Printed On: Thu: November 3, 2016

<u>Owner</u>	<u>Address</u>	<u>Parcel Number</u>
CRAWFORD RICHARD M & LOIS Y 2002	CRAWFORD RICHARD M & LOIS Y TRS 2525 VANCOUVER AVE SAN DIEGO CA 92104-5356	13934411078
CROSSHILL 2 L L C	500 S FOURTH ST LAS VEGAS NV 89101-6599	13934810014
CROSSHILL I L L C	500 S4TH ST LAS VEGAS NV 89101-6599	13934311115
D K JUHL L L C	%KRE CAPITAL LLC/M KHOURY 315 S BEVERLY DR #201 BEVERLY HILLS CA 90212	13934312127
D K JUHL L L C	%KRE CAPITAL LLC/M KHOURY 315 S BEVERLY DR #201 BEVERLY HILLS CA 90212	13934312128
D K JUHL L L C	%KRE CAPITAL LLC/M KHOURY 315 S BEVERLY DR #201 BEVERLY HILLS CA 90212	13934312126
D K JUHL L L C	%KRE CAPITAL LLC/M KHOURY 315 S BEVERLY DR #201 BEVERLY HILLS CA 90212	13934312129
D K JUHL L L C	%KRE CAPITAL LLC/M KHOURY 315 S BEVERLY DR #201 BEVERLY HILLS CA 90212	13934312133
D K JUHL L L C	%KRE CAPITAL LLC/M KHOURY 315 S BEVERLY DR #201 BEVERLY HILLS CA 90212	13934312140
D K JUHL L L C	%KRE CAPITAL LLC/M KHOURY 315 S BEVERLY DR #201 BEVERLY HILLS CA 90212	13934312141
D K JUHL L L C	%KRE CAPITAL LLC/M KHOURY 315 S BEVERLY DR #201 BEVERLY HILLS CA 90212	13934312130
D K JUHL L L C	%KRE CAPITAL LLC/M KHOURY 315 S BEVERLY DR #201 BEVERLY HILLS CA 90212	13934312131
D K JUHL L L C	%KRE CAPITAL LLC/M KHOURY 315 S BEVERLY DR #201 BEVERLY HILLS CA 90212	13934312132
D K JUHL L L C	%KRE CAPITAL LLC/M KHOURY 315 S BEVERLY DR #201 BEVERLY HILLS CA 90212	13934312139
D K JUHL L L C	%KRE CAPITAL LLC/M KHOURY 315 S BEVERLY DR #201 BEVERLY HILLS CA 90212	13934312138
D K JUHL L L C	%KRE CAPITAL LLC/M KHOURY 315 S BEVERLY DR #201 BEVERLY HILLS CA 90212	13934312134
D K JUHL L L C	%KRE CAPITAL LLC/M KHOURY 315 S BEVERLY DR #201 BEVERLY HILLS CA 90212	13934312135
D K JUHL L L C	%KRE CAPITAL LLC/M KHOURY 315 S BEVERLY DR #201 BEVERLY HILLS CA 90212	13934312142
D K JUHL L L C	%KRE CAPITAL LLC/M KHOURY 315 S BEVERLY DR #201 BEVERLY HILLS CA 90212	13934312113
D K JUHL L L C	%KRE CAPITAL LLC/M KHOURY 315 S BEVERLY DR #201 BEVERLY HILLS CA 90212	13934312188
D K JUHL L L C	%KRE CAPITAL LLC/M KHOURY 315 S BEVERLY DR #201 BEVERLY HILLS CA 90212	13934312143
D K JUHL L L C	%KRE CAPITAL LLC/M KHOURY 315 S BEVERLY DR #201 BEVERLY HILLS CA 90212	13934312100
D K JUHL L L C	%KRE CAPITAL LLC/M KHOURY 315 S BEVERLY DR #201 BEVERLY HILLS CA 90212	13934312102
D K JUHL L L C	%KRE CAPITAL LLC/M KHOURY 315 S BEVERLY DR #201 BEVERLY HILLS CA 90212	13934312103
D K JUHL L L C	%KRE CAPITAL LLC/M KHOURY 315 S BEVERLY DR #201 BEVERLY HILLS CA 90212	13934312104
D K JUHL L L C	%KRE CAPITAL LLC/M KHOURY 315 S BEVERLY DR #201 BEVERLY HILLS CA 90212	13934312105
D K JUHL L L C	%KRE CAPITAL LLC/M KHOURY 315 S BEVERLY DR #201 BEVERLY HILLS CA 90212	13934312106
D K JUHL L L C	%KRE CAPITAL LLC/M KHOURY 315 S BEVERLY DR #201 BEVERLY HILLS CA 90212	13934312108
D K JUHL L L C	%KRE CAPITAL LLC/M KHOURY 315 S BEVERLY DR #201 BEVERLY HILLS CA 90212	13934312111
D K JUHL L L C	%KRE CAPITAL LLC/M KHOURY 315 S BEVERLY DR #201 BEVERLY HILLS CA 90212	13934312099
D K JUHL L L C	%KRE CAPITAL LLC/M KHOURY 315 S BEVERLY DR #201 BEVERLY HILLS CA 90212	13934312125
D K JUHL L L C	%KRE CAPITAL LLC/M KHOURY 315 S BEVERLY DR #201 BEVERLY HILLS CA 90212	13934312114

Report of All Selected Parcels

Case Number:

SUP-67489

Printed On: Thu: November 3, 2016

<u>Owner</u>	<u>Address</u>	<u>Parcel Numbe</u>
D K JUHL L L C	%KRE CAPITAL LLC/M KHOURY 315 S BEVERLY DR #201 BEVERLY HILLS CA 90212	13934312116
D K JUHL L L C	%KRE CAPITAL LLC/M KHOURY 315 S BEVERLY DR #201 BEVERLY HILLS CA 90212	13934312117
D K JUHL L L C	%KRE CAPITAL LLC/M KHOURY 315 S BEVERLY DR #201 BEVERLY HILLS CA 90212	13934312118
D K JUHL L L C	%KRE CAPITAL LLC/M KHOURY 315 S BEVERLY DR #201 BEVERLY HILLS CA 90212	13934312119
D K JUHL L L C	%KRE CAPITAL LLC/M KHOURY 315 S BEVERLY DR #201 BEVERLY HILLS CA 90212	13934312120
D K JUHL L L C	%KRE CAPITAL LLC/M KHOURY 315 S BEVERLY DR #201 BEVERLY HILLS CA 90212	13934312121
D K JUHL L L C	315 S BEVERLY DR #201 BEVERLY HILLS CA 90212	13934312122
D K JUHL L L C	%KRE CAPITAL LLC/M KHOURY 315 S BEVERLY DR #201 BEVERLY HILLS CA 90212	13934312123
D K JUHL L L C	%KRE CAPITAL LLC/M KHOURY 315 S BEVERLY DR #201 BEVERLY HILLS CA 90212	13934312124
D K JUHL L L C	%KRE CAPITAL LLC/M KHOURY 315 S BEVERLY DR #201 BEVERLY HILLS CA 90212	13934312109
D K JUHL L L C	%KRE CAPITAL LLC/M KHOURY 315 S BEVERLY DR #201 BEVERLY HILLS CA 90212	13934312182
D K JUHL L L C	%KRE CAPITAL LLC/M KHOURY 315 S BEVERLY DR #201 BEVERLY HILLS CA 90212	13934312186
D K JUHL L L C	%KRE CAPITAL LLC/M KHOURY 315 S BEVERLY DR #201 BEVERLY HILLS CA 90212	13934312172
D K JUHL L L C	%KRE CAPITAL LLC/M KHOURY 315 S BEVERLY DR #201 BEVERLY HILLS CA 90212	13934312173
D K JUHL L L C	%KRE CAPITAL LLC/M KHOURY 315 S BEVERLY DR #201 BEVERLY HILLS CA 90212	13934312174
D K JUHL L L C	%KRE CAPITAL LLC/M KHOURY 315 S BEVERLY DR #201 BEVERLY HILLS CA 90212	13934312175
D K JUHL L L C	%KRE CAPITAL LLC/M KHOURY 315 S BEVERLY DR #201 BEVERLY HILLS CA 90212	13934312176
D K JUHL L L C	%KRE CAPITAL LLC/M KHOURY 315 S BEVERLY DR #201 BEVERLY HILLS CA 90212	13934312177
D K JUHL L L C	%KRE CAPITAL LLC/M KHOURY 315 S BEVERLY DR #201 BEVERLY HILLS CA 90212	13934312179
D K JUHL L L C	%KRE CAPITAL LLC/M KHOURY 315 S BEVERLY DR #201 BEVERLY HILLS CA 90212	13934312170
D K JUHL L L C	%KRE CAPITAL LLC/M KHOURY 315 S BEVERLY DR #201 BEVERLY HILLS CA 90212	13934312181
D K JUHL L L C	%KRE CAPITAL LLC/M KHOURY 315 S BEVERLY DR #201 BEVERLY HILLS CA 90212	13934312169
D K JUHL L L C	%KRE CAPITAL LLC/M KHOURY 315 S BEVERLY DR #201 BEVERLY HILLS CA 90212	13934312183
D K JUHL L L C	%KRE CAPITAL LLC/M KHOURY 315 S BEVERLY DR #201 BEVERLY HILLS CA 90212	13934312184
D K JUHL L L C	%KRE CAPITAL LLC/M KHOURY 315 S BEVERLY DR #201 BEVERLY HILLS CA 90212	13934312185
D K JUHL L L C	%KRE CAPITAL LLC/M KHOURY 315 S BEVERLY DR #201 BEVERLY HILLS CA 90212	13934312098
D K JUHL L L C	%KRE CAPITAL LLC/M KHOURY 315 S BEVERLY DR #201 BEVERLY HILLS CA 90212	13934312187
D K JUHL L L C	%KRE CAPITAL LLC/M KHOURY 315 S BEVERLY DR #201 BEVERLY HILLS CA 90212	13934312045
D K JUHL L L C	%KRE CAPITAL LLC/M KHOURY 315 S BEVERLY DR #201 BEVERLY HILLS CA 90212	13934312189
D K JUHL L L C	%KRE CAPITAL LLC/M KHOURY 315 S BEVERLY DR #201 BEVERLY HILLS CA 90212	13934312190
D K JUHL L L C	%KRE CAPITAL LLC/M KHOURY 315 S BEVERLY DR #201 BEVERLY HILLS CA 90212	13934312191
D K JUHL L L C	%KRE CAPITAL LLC/M KHOURY 315 S BEVERLY DR #201 BEVERLY HILLS CA 90212	13934312180

Report of All Selected ParcelsCase Number:

SUP-67489

Printed On: Thu: November 3, 2016

<u>Owner</u>	<u>Address</u>	<u>Parcel Number</u>
D K JUHL L L C	%KRE CAPITAL LLC/M KHOURY 315 S BEVERLY DR #201 BEVERLY HILLS CA 90212	13934312157
D K JUHL L L C	%KRE CAPITAL LLC/M KHOURY 315 S BEVERLY DR #201 BEVERLY HILLS CA 90212	13934312145
D K JUHL L L C	%KRE CAPITAL LLC/M KHOURY 315 S BEVERLY DR #201 BEVERLY HILLS CA 90212	13934312146
D K JUHL L L C	%KRE CAPITAL LLC/M KHOURY 315 S BEVERLY DR #201 BEVERLY HILLS CA 90212	13934312147
D K JUHL L L C	%KRE CAPITAL LLC/M KHOURY 315 S BEVERLY DR #201 BEVERLY HILLS CA 90212	13934312148
D K JUHL L L C	%KRE CAPITAL LLC/M KHOURY 315 S BEVERLY DR #201 BEVERLY HILLS CA 90212	13934312149
D K JUHL L L C	%KRE CAPITAL LLC/M KHOURY 315 S BEVERLY DR #201 BEVERLY HILLS CA 90212	13934312150
D K JUHL L L C	%KRE CAPITAL LLC/M KHOURY 315 S BEVERLY DR #201 BEVERLY HILLS CA 90212	13934312151
D K JUHL L L C	%KRE CAPITAL LLC/M KHOURY 315 S BEVERLY DR #201 BEVERLY HILLS CA 90212	13934312152
D K JUHL L L C	%KRE CAPITAL LLC/M KHOURY 315 S BEVERLY DR #201 BEVERLY HILLS CA 90212	13934312171
D K JUHL L L C	%KRE CAPITAL LLC/M KHOURY 315 S BEVERLY DR #201 BEVERLY HILLS CA 90212	13934312154
D K JUHL L L C	%KRE CAPITAL LLC/M KHOURY 315 S BEVERLY DR #201 BEVERLY HILLS CA 90212	13934312144
D K JUHL L L C	%KRE CAPITAL LLC/M KHOURY 315 S BEVERLY DR #201 BEVERLY HILLS CA 90212	13934312158
D K JUHL L L C	%KRE CAPITAL LLC/M KHOURY 315 S BEVERLY DR #201 BEVERLY HILLS CA 90212	13934312159
D K JUHL L L C	%KRE CAPITAL LLC/M KHOURY 315 S BEVERLY DR #201 BEVERLY HILLS CA 90212	13934312160
D K JUHL L L C	%KRE CAPITAL LLC/M KHOURY 315 S BEVERLY DR #201 BEVERLY HILLS CA 90212	13934312161
D K JUHL L L C	%KRE CAPITAL LLC/M KHOURY 315 S BEVERLY DR #201 BEVERLY HILLS CA 90212	13934312163
D K JUHL L L C	%KRE CAPITAL LLC/M KHOURY 315 S BEVERLY DR #201 BEVERLY HILLS CA 90212	13934312164
D K JUHL L L C	%KRE CAPITAL LLC/M KHOURY 315 S BEVERLY DR #201 BEVERLY HILLS CA 90212	13934312166
D K JUHL L L C	%KRE CAPITAL LLC/M KHOURY 315 S BEVERLY DR #201 BEVERLY HILLS CA 90212	13934312167
D K JUHL L L C	%KRE CAPITAL LLC/M KHOURY 315 S BEVERLY DR #201 BEVERLY HILLS CA 90212	13934312168
D K JUHL L L C	%KRE CAPITAL LLC/M KHOURY 315 S BEVERLY DR #201 BEVERLY HILLS CA 90212	13934312153
D K JUHL L L C	%KRE CAPITAL LLC/M KHOURY 315 S BEVERLY DR #201 BEVERLY HILLS CA 90212	13934312033
D K JUHL L L C	%KRE CAPITAL LLC/M KHOURY 315 S BEVERLY DR #201 BEVERLY HILLS CA 90212	13934312047
D K JUHL L L C	%KRE CAPITAL LLC/M KHOURY 315 S BEVERLY DR #201 BEVERLY HILLS CA 90212	13934312024
D K JUHL L L C	%KRE CAPITAL LLC/M KHOURY 315 S BEVERLY DR #201 BEVERLY HILLS CA 90212	13934312025
D K JUHL L L C	%KRE CAPITAL LLC/M KHOURY 315 S BEVERLY DR #201 BEVERLY HILLS CA 90212	13934312026
D K JUHL L L C	%KRE CAPITAL LLC/M KHOURY 315 S BEVERLY DR #201 BEVERLY HILLS CA 90212	13934312027
D K JUHL L L C	%KRE CAPITAL LLC/M KHOURY 315 S BEVERLY DR #201 BEVERLY HILLS CA 90212	13934312028
D K JUHL L L C	%KRE CAPITAL LLC/M KHOURY 315 S BEVERLY DR #201 BEVERLY HILLS CA 90212	13934312029
D K JUHL L L C	%KRE CAPITAL LLC/M KHOURY 315 S BEVERLY DR #201 BEVERLY HILLS CA 90212	13934312030
D K JUHL L L C	%KRE CAPITAL LLC/M KHOURY 315 S BEVERLY DR #201 BEVERLY HILLS CA 90212	13934312022

Report of All Selected Parcels

Case Number:

SUP-67489

Printed On: Thu: November 3, 2016

<u>Owner</u>	<u>Address</u>	<u>Parcel Numbe</u>
D K JUHL L L C	%KRE CAPITAL LLC/M KHOURY 315 S BEVERLY DR #201 BEVERLY HILLS CA 90212	13934312032
D K JUHL L L C	%KRE CAPITAL LLC/M KHOURY 315 S BEVERLY DR #201 BEVERLY HILLS CA 90212	13934312021
D K JUHL L L C	%KRE CAPITAL LLC/M KHOURY 315 S BEVERLY DR #201 BEVERLY HILLS CA 90212	13934312034
D K JUHL L L C	%KRE CAPITAL LLC/M KHOURY 315 S BEVERLY DR #201 BEVERLY HILLS CA 90212	13934312035
D K JUHL L L C	%KRE CAPITAL LLC/M KHOURY 315 S BEVERLY DR #201 BEVERLY HILLS CA 90212	13934312036
D K JUHL L L C	%KRE CAPITAL LLC/M KHOURY 315 S BEVERLY DR #201 BEVERLY HILLS CA 90212	13934312037
D K JUHL L L C	%KRE CAPITAL LLC/M KHOURY 315 S BEVERLY DR #201 BEVERLY HILLS CA 90212	13934312038
D K JUHL L L C	%KRE CAPITAL LLC/M KHOURY 315 S BEVERLY DR #201 BEVERLY HILLS CA 90212	13934312039
D K JUHL L L C	%KRE CAPITAL LLC/M KHOURY 315 S BEVERLY DR #201 BEVERLY HILLS CA 90212	13934312042
D K JUHL L L C	%KRE CAPITAL LLC/M KHOURY 315 S BEVERLY DR #201 BEVERLY HILLS CA 90212	13934312043
D K JUHL L L C	%KRE CAPITAL LLC/M KHOURY 315 S BEVERLY DR #201 BEVERLY HILLS CA 90212	13934312044
D K JUHL L L C	%KRE CAPITAL LLC/M KHOURY 315 S BEVERLY DR #201 BEVERLY HILLS CA 90212	13934312031
D K JUHL L L C	%KRE CAPITAL LLC/M KHOURY 315 S BEVERLY DR #201 BEVERLY HILLS CA 90212	13934312011
D K JUHL L L C	%KRE CAPITAL LLC/M KHOURY 315 S BEVERLY DR #201 BEVERLY HILLS CA 90212	13934312001
D K JUHL L L C	%KRE CAPITAL LLC/M KHOURY 315 S BEVERLY DR #201 BEVERLY HILLS CA 90212	13934312002
D K JUHL L L C	%KRE CAPITAL LLC/M KHOURY 315 S BEVERLY DR #201 BEVERLY HILLS CA 90212	13934312003
D K JUHL L L C	%KRE CAPITAL LLC/M KHOURY 315 S BEVERLY DR #201 BEVERLY HILLS CA 90212	13934312004
D K JUHL L L C	%KRE CAPITAL LLC/M KHOURY 315 S BEVERLY DR #201 BEVERLY HILLS CA 90212	13934312005
D K JUHL L L C	%KRE CAPITAL LLC/M KHOURY 315 S BEVERLY DR #201 BEVERLY HILLS CA 90212	13934312006
D K JUHL L L C	%KRE CAPITAL LLC/M KHOURY 315 S BEVERLY DR #201 BEVERLY HILLS CA 90212	13934312007
D K JUHL L L C	%KRE CAPITAL LLC/M KHOURY 315 S BEVERLY DR #201 BEVERLY HILLS CA 90212	13934312008
D K JUHL L L C	%KRE CAPITAL LLC/M KHOURY 315 S BEVERLY DR #201 BEVERLY HILLS CA 90212	13934312023
D K JUHL L L C	%KRE CAPITAL LLC/M KHOURY 315 S BEVERLY DR #201 BEVERLY HILLS CA 90212	13934312010
D K JUHL L L C	%KRE CAPITAL LLC/M KHOURY 315 S BEVERLY DR #201 BEVERLY HILLS CA 90212	13934312192
D K JUHL L L C	%KRE CAPITAL LLC/M KHOURY 315 S BEVERLY DR #201 BEVERLY HILLS CA 90212	13934312012
D K JUHL L L C	%KRE CAPITAL LLC/M KHOURY 315 S BEVERLY DR #201 BEVERLY HILLS CA 90212	13934312013
D K JUHL L L C	%KRE CAPITAL LLC/M KHOURY 315 S BEVERLY DR #201 BEVERLY HILLS CA 90212	13934312014
D K JUHL L L C	%KRE CAPITAL LLC/M KHOURY 315 S BEVERLY DR #201 BEVERLY HILLS CA 90212	13934312015
D K JUHL L L C	%KRE CAPITAL LLC/M KHOURY 315 S BEVERLY DR #201 BEVERLY HILLS CA 90212	13934312016
D K JUHL L L C	%KRE CAPITAL LLC/M KHOURY 315 S BEVERLY DR #201 BEVERLY HILLS CA 90212	13934312017
D K JUHL L L C	%KRE CAPITAL LLC/M KHOURY 315 S BEVERLY DR #201 BEVERLY HILLS CA 90212	13934312018
D K JUHL L L C	%KRE CAPITAL LLC/M KHOURY 315 S BEVERLY DR #201 BEVERLY HILLS CA 90212	13934312019

Report of All Selected Parcels

Case Number:

SUP-67489

Printed On: Thu: November 3, 2016

<u>Owner</u>	<u>Address</u>	<u>Parcel Numbe</u>
D K JUHL L L C	%KRE CAPITAL LLC/M KHOURY 315 S BEVERLY DR #201 BEVERLY HILLS CA 90212	13934312020
D K JUHL L L C	%KRE CAPITAL LLC/M KHOURY 315 S BEVERLY DR #201 BEVERLY HILLS CA 90212	13934312009
D K JUHL L L C	%KRE CAPITAL LLC/M KHOURY 315 S BEVERLY DR #201 BEVERLY HILLS CA 90212	13934312086
D K JUHL L L C	%KRE CAPITAL LLC/M KHOURY 315 S BEVERLY DR #201 BEVERLY HILLS CA 90212	13934312074
D K JUHL L L C	%KRE CAPITAL LLC/M KHOURY 315 S BEVERLY DR #201 BEVERLY HILLS CA 90212	13934312076
D K JUHL L L C	%KRE CAPITAL LLC/M KHOURY 315 S BEVERLY DR #201 BEVERLY HILLS CA 90212	13934312077
D K JUHL L L C	%KRE CAPITAL LLC/M KHOURY 315 S BEVERLY DR #201 BEVERLY HILLS CA 90212	13934312078
D K JUHL L L C	%KRE CAPITAL LLC/M KHOURY 315 S BEVERLY DR #201 BEVERLY HILLS CA 90212	13934312080
D K JUHL L L C	%KRE CAPITAL LLC/M KHOURY 315 S BEVERLY DR #201 BEVERLY HILLS CA 90212	13934312081
D K JUHL L L C	%KRE CAPITAL LLC/M KHOURY 315 S BEVERLY DR #201 BEVERLY HILLS CA 90212	13934312082
D K JUHL L L C	%KRE CAPITAL LLC/M KHOURY 315 S BEVERLY DR #201 BEVERLY HILLS CA 90212	13934312083
D K JUHL L L C	%KRE CAPITAL LLC/M KHOURY 315 S BEVERLY DR #201 BEVERLY HILLS CA 90212	13934312112
D K JUHL L L C	%KRE CAPITAL LLC/M KHOURY 315 S BEVERLY DR #201 BEVERLY HILLS CA 90212	13934312085
D K JUHL L L C	%KRE CAPITAL LLC/M KHOURY 315 S BEVERLY DR #201 BEVERLY HILLS CA 90212	13934312071
D K JUHL L L C	%KRE CAPITAL LLC/M KHOURY 315 S BEVERLY DR #201 BEVERLY HILLS CA 90212	13934312087
D K JUHL L L C	%KRE CAPITAL LLC/M KHOURY 315 S BEVERLY DR #201 BEVERLY HILLS CA 90212	13934312088
D K JUHL L L C	%KRE CAPITAL LLC/M KHOURY 315 S BEVERLY DR #201 BEVERLY HILLS CA 90212	13934312090
D K JUHL L L C	%KRE CAPITAL LLC/M KHOURY 315 S BEVERLY DR #201 BEVERLY HILLS CA 90212	13934312091
D K JUHL L L C	%KRE CAPITAL LLC/M KHOURY 315 S BEVERLY DR #201 BEVERLY HILLS CA 90212	13934312092
D K JUHL L L C	%KRE CAPITAL LLC/M KHOURY 315 S BEVERLY DR #201 BEVERLY HILLS CA 90212	13934312093
D K JUHL L L C	%KRE CAPITAL LLC/M KHOURY 315 S BEVERLY DR #201 BEVERLY HILLS CA 90212	13934312094
D K JUHL L L C	%KRE CAPITAL LLC/M KHOURY 315 S BEVERLY DR #201 BEVERLY HILLS CA 90212	13934312095
D K JUHL L L C	%KRE CAPITAL LLC/M KHOURY 315 S BEVERLY DR #201 BEVERLY HILLS CA 90212	13934312096
D K JUHL L L C	%KRE CAPITAL LLC/M KHOURY 315 S BEVERLY DR #201 BEVERLY HILLS CA 90212	13934312084
D K JUHL L L C	%KRE CAPITAL LLC/M KHOURY 315 S BEVERLY DR #201 BEVERLY HILLS CA 90212	13934312059
D K JUHL L L C	%KRE CAPITAL LLC/M KHOURY 315 S BEVERLY DR #201 BEVERLY HILLS CA 90212	13934312097
D K JUHL L L C	%KRE CAPITAL LLC/M KHOURY 315 S BEVERLY DR #201 BEVERLY HILLS CA 90212	13934312048
D K JUHL L L C	%KRE CAPITAL LLC/M KHOURY 315 S BEVERLY DR #201 BEVERLY HILLS CA 90212	13934312050
D K JUHL L L C	%KRE CAPITAL LLC/M KHOURY 315 S BEVERLY DR #201 BEVERLY HILLS CA 90212	13934312051
D K JUHL L L C	%KRE CAPITAL LLC/M KHOURY 315 S BEVERLY DR #201 BEVERLY HILLS CA 90212	13934312052
D K JUHL L L C	%KRE CAPITAL LLC/M KHOURY 315 S BEVERLY DR #201 BEVERLY HILLS CA 90212	13934312053
D K JUHL L L C	%KRE CAPITAL LLC/M KHOURY 315 S BEVERLY DR #201 BEVERLY HILLS CA 90212	13934312054

Report of All Selected ParcelsCase Number:

SUP-67489

Printed On: Thu: November 3, 2016

<u>Owner</u>	<u>Address</u>	<u>Parcel Numbe</u>
D K JUHL L L C	%KRE CAPITAL LLC/M KHOURY 315 S BEVERLY DR #201 BEVERLY HILLS CA 90212	13934312055
D K JUHL L L C	%KRE CAPITAL LLC/M KHOURY 315 S BEVERLY DR #201 BEVERLY HILLS CA 90212	13934312056
D K JUHL L L C	%KRE CAPITAL LLC/M KHOURY 315 S BEVERLY DR #201 BEVERLY HILLS CA 90212	13934312073
D K JUHL L L C	%KRE CAPITAL LLC/M KHOURY 315 S BEVERLY DR #201 BEVERLY HILLS CA 90212	13934312058
D K JUHL L L C	%KRE CAPITAL LLC/M KHOURY 315 S BEVERLY DR #201 BEVERLY HILLS CA 90212	13934312072
D K JUHL L L C	%KRE CAPITAL LLC/M KHOURY 315 S BEVERLY DR #201 BEVERLY HILLS CA 90212	13934312061
D K JUHL L L C	%KRE CAPITAL LLC/M KHOURY 315 S BEVERLY DR #201 BEVERLY HILLS CA 90212	13934312062
D K JUHL L L C	%KRE CAPITAL LLC/M KHOURY 315 S BEVERLY DR #201 BEVERLY HILLS CA 90212	13934312063
D K JUHL L L C	%KRE CAPITAL LLC/M KHOURY 315 S BEVERLY DR #201 BEVERLY HILLS CA 90212	13934312066
D K JUHL L L C	%KRE CAPITAL LLC/M KHOURY 315 S BEVERLY DR #201 BEVERLY HILLS CA 90212	13934312067
D K JUHL L L C	%KRE CAPITAL LLC/M KHOURY 315 S BEVERLY DR #201 BEVERLY HILLS CA 90212	13934312068
D K JUHL L L C	%KRE CAPITAL LLC/M KHOURY 315 S BEVERLY DR #201 BEVERLY HILLS CA 90212	13934312069
D K JUHL L L C	%KRE CAPITAL LLC/M KHOURY 315 S BEVERLY DR #201 BEVERLY HILLS CA 90212	13934312070
D K JUHL L L C	%KRE CAPITAL LLC/M KHOURY 315 S BEVERLY DR #201 BEVERLY HILLS CA 90212	13934312046
D K JUHL L L C	%KRE CAPITAL LLC/M KHOURY 315 S BEVERLY DR #201 BEVERLY HILLS CA 90212	13934312057
D K JUHL L L C	%KRE CAPITAL LLC/M KHOURY 315 S BEVERLY DR #201 BEVERLY HILLS CA 90212	13934312195
D K JUHL L L C	%KRE CAPITAL LLC/M KHOURY 315 S BEVERLY DR #201 BEVERLY HILLS CA 90212	13934312284
D K JUHL L L C	%KRE CAPITAL LLC/M KHOURY 315 S BEVERLY DR #201 BEVERLY HILLS CA 90212	13934312285
D K JUHL L L C	%KRE CAPITAL LLC/M KHOURY 315 S BEVERLY DR #201 BEVERLY HILLS CA 90212	13934312286
D K JUHL L L C	%KRE CAPITAL LLC/M KHOURY 315 S BEVERLY DR #201 BEVERLY HILLS CA 90212	13934312287
D K JUHL L L C	%KRE CAPITAL LLC/M KHOURY 315 S BEVERLY DR #201 BEVERLY HILLS CA 90212	13934312288
D K JUHL L L C	%KRE CAPITAL LLC/M KHOURY 315 S BEVERLY DR #201 BEVERLY HILLS CA 90212	13934312289
D K JUHL L L C	%KRE CAPITAL LLC/M KHOURY 315 S BEVERLY DR #201 BEVERLY HILLS CA 90212	13934312299
D K JUHL L L C	%KRE CAPITAL LLC/M KHOURY 315 S BEVERLY DR #201 BEVERLY HILLS CA 90212	13934312291
D K JUHL L L C	%KRE CAPITAL LLC/M KHOURY 315 S BEVERLY DR #201 BEVERLY HILLS CA 90212	13934312281
D K JUHL L L C	%KRE CAPITAL LLC/M KHOURY 315 S BEVERLY DR #201 BEVERLY HILLS CA 90212	13934312292
D K JUHL L L C	%KRE CAPITAL LLC/M KHOURY 315 S BEVERLY DR #201 BEVERLY HILLS CA 90212	13934312293
D K JUHL L L C	%KRE CAPITAL LLC/M KHOURY 315 S BEVERLY DR #201 BEVERLY HILLS CA 90212	13934312294
D K JUHL L L C	%KRE CAPITAL LLC/M KHOURY 315 S BEVERLY DR #201 BEVERLY HILLS CA 90212	13934312295
D K JUHL L L C	%KRE CAPITAL LLC/M KHOURY 315 S BEVERLY DR #201 BEVERLY HILLS CA 90212	13934312296
D K JUHL L L C	%KRE CAPITAL LLC/M KHOURY 315 S BEVERLY DR #201 BEVERLY HILLS CA 90212	13934312297
D K JUHL L L C	%KRE CAPITAL LLC/M KHOURY 315 S BEVERLY DR #201 BEVERLY HILLS CA 90212	13934312264

Report of All Selected Parcels

Case Number:

SUP-67489

Printed On: Thu: November 3, 2016

<u>Owner</u>	<u>Address</u>	<u>Parcel Numbe</u>
D K JUHL L L C	%KRE CAPITAL LLC/M KHOURY 315 S BEVERLY DR #201 BEVERLY HILLS CA 90212	13934312290
D K JUHL L L C	%KRE CAPITAL LLC/M KHOURY 315 S BEVERLY DR #201 BEVERLY HILLS CA 90212	13934312318
D K JUHL L L C	%KRE CAPITAL LLC/M KHOURY 315 S BEVERLY DR #201 BEVERLY HILLS CA 90212	13934312265
D K JUHL L L C	%KRE CAPITAL LLC/M KHOURY 315 S BEVERLY DR #201 BEVERLY HILLS CA 90212	13934312266
D K JUHL L L C	%KRE CAPITAL LLC/M KHOURY 315 S BEVERLY DR #201 BEVERLY HILLS CA 90212	13934312267
D K JUHL L L C	%KRE CAPITAL LLC/M KHOURY 315 S BEVERLY DR #201 BEVERLY HILLS CA 90212	13934312268
D K JUHL L L C	%KRE CAPITAL LLC/M KHOURY 315 S BEVERLY DR #201 BEVERLY HILLS CA 90212	13934312269
D K JUHL L L C	%KRE CAPITAL LLC/M KHOURY 315 S BEVERLY DR #201 BEVERLY HILLS CA 90212	13934312270
D K JUHL L L C	%KRE CAPITAL LLC/M KHOURY 315 S BEVERLY DR #201 BEVERLY HILLS CA 90212	13934312271
D K JUHL L L C	%KRE CAPITAL LLC/M KHOURY 315 S BEVERLY DR #201 BEVERLY HILLS CA 90212	13934312283
D K JUHL L L C	%KRE CAPITAL LLC/M KHOURY 315 S BEVERLY DR #201 BEVERLY HILLS CA 90212	13934312273
D K JUHL L L C	%KRE CAPITAL LLC/M KHOURY 315 S BEVERLY DR #201 BEVERLY HILLS CA 90212	13934312282
D K JUHL L L C	%KRE CAPITAL LLC/M KHOURY 315 S BEVERLY DR #201 BEVERLY HILLS CA 90212	13934312275
D K JUHL L L C	%KRE CAPITAL LLC/M KHOURY 315 S BEVERLY DR #201 BEVERLY HILLS CA 90212	13934312110
D K JUHL L L C	%KRE CAPITAL LLC/M KHOURY 315 S BEVERLY DR #201 BEVERLY HILLS CA 90212	13934312276
D K JUHL L L C	%KRE CAPITAL LLC/M KHOURY 315 S BEVERLY DR #201 BEVERLY HILLS CA 90212	13934312278
D K JUHL L L C	%KRE CAPITAL LLC/M KHOURY 315 S BEVERLY DR #201 BEVERLY HILLS CA 90212	13934312279
D K JUHL L L C	%KRE CAPITAL LLC/M KHOURY 315 S BEVERLY DR #201 BEVERLY HILLS CA 90212	13934312280
D K JUHL L L C	%KRE CAPITAL LLC/M KHOURY 315 S BEVERLY DR #201 BEVERLY HILLS CA 90212	13934312302
D K JUHL L L C	%KRE CAPITAL LLC/M KHOURY 315 S BEVERLY DR #201 BEVERLY HILLS CA 90212	13934312272
D K JUHL L L C	%KRE CAPITAL LLC/M KHOURY 315 S BEVERLY DR #201 BEVERLY HILLS CA 90212	13934312335
D K JUHL L L C	%KRE CAPITAL LLC/M KHOURY 315 S BEVERLY DR #201 BEVERLY HILLS CA 90212	13934312325
D K JUHL L L C	%KRE CAPITAL LLC/M KHOURY 315 S BEVERLY DR #201 BEVERLY HILLS CA 90212	13934312326
D K JUHL L L C	%KRE CAPITAL LLC/M KHOURY 315 S BEVERLY DR #201 BEVERLY HILLS CA 90212	13934312327
D K JUHL L L C	%KRE CAPITAL LLC/M KHOURY 315 S BEVERLY DR #201 BEVERLY HILLS CA 90212	13934312329
D K JUHL L L C	%KRE CAPITAL LLC/M KHOURY 315 S BEVERLY DR #201 BEVERLY HILLS CA 90212	13934312330
D K JUHL L L C	%KRE CAPITAL LLC/M KHOURY 315 S BEVERLY DR #201 BEVERLY HILLS CA 90212	13934312331
D K JUHL L L C	%KRE CAPITAL LLC/M KHOURY 315 S BEVERLY DR #201 BEVERLY HILLS CA 90212	13934312298
D K JUHL L L C	%KRE CAPITAL LLC/M KHOURY 315 S BEVERLY DR #201 BEVERLY HILLS CA 90212	13934312334
D K JUHL L L C	%KRE CAPITAL LLC/M KHOURY 315 S BEVERLY DR #201 BEVERLY HILLS CA 90212	13934312322
D K JUHL L L C	%KRE CAPITAL LLC/M KHOURY 315 S BEVERLY DR #201 BEVERLY HILLS CA 90212	13934312336
D K JUHL L L C	%KRE CAPITAL LLC/M KHOURY 315 S BEVERLY DR #201 BEVERLY HILLS CA 90212	13934312337

Report of All Selected Parcels

Case Number:

SUP-67489

Printed On: Thu: November 3, 2016

<u>Owner</u>	<u>Address</u>	<u>Parcel Numbe</u>
D K JUHL L L C	%KRE CAPITAL LLC/M KHOURY 315 S BEVERLY DR #201 BEVERLY HILLS CA 90212	13934312338
D K JUHL L L C	%KRE CAPITAL LLC/M KHOURY 315 S BEVERLY DR #201 BEVERLY HILLS CA 90212	13934312340
D K JUHL L L C	%KRE CAPITAL LLC/M KHOURY 315 S BEVERLY DR #201 BEVERLY HILLS CA 90212	13934312342
D K JUHL L L C	%KRE CAPITAL LLC/M KHOURY 315 S BEVERLY DR #201 BEVERLY HILLS CA 90212	13934312343
D K JUHL L L C	%KRE CAPITAL LLC/M KHOURY 315 S BEVERLY DR #201 BEVERLY HILLS CA 90212	13934312344
D K JUHL L L C	%KRE CAPITAL LLC/M KHOURY 315 S BEVERLY DR #201 BEVERLY HILLS CA 90212	13934312332
D K JUHL L L C	%KRE CAPITAL LLC/M KHOURY 315 S BEVERLY DR #201 BEVERLY HILLS CA 90212	13934312313
D K JUHL L L C	%KRE CAPITAL LLC/M KHOURY 315 S BEVERLY DR #201 BEVERLY HILLS CA 90212	13934312303
D K JUHL L L C	%KRE CAPITAL LLC/M KHOURY 315 S BEVERLY DR #201 BEVERLY HILLS CA 90212	13934312304
D K JUHL L L C	%KRE CAPITAL LLC/M KHOURY 315 S BEVERLY DR #201 BEVERLY HILLS CA 90212	13934312305
D K JUHL L L C	%KRE CAPITAL LLC/M KHOURY 315 S BEVERLY DR #201 BEVERLY HILLS CA 90212	13934312306
D K JUHL L L C	%KRE CAPITAL LLC/M KHOURY 315 S BEVERLY DR #201 BEVERLY HILLS CA 90212	13934312307
D K JUHL L L C	%KRE CAPITAL LLC/M KHOURY 315 S BEVERLY DR #201 BEVERLY HILLS CA 90212	13934312308
D K JUHL L L C	%KRE CAPITAL LLC/M KHOURY 315 S BEVERLY DR #201 BEVERLY HILLS CA 90212	13934312309
D K JUHL L L C	%KRE CAPITAL LLC/M KHOURY 315 S BEVERLY DR #201 BEVERLY HILLS CA 90212	13934312324
D K JUHL L L C	%KRE CAPITAL LLC/M KHOURY 315 S BEVERLY DR #201 BEVERLY HILLS CA 90212	13934312312
D K JUHL L L C	%KRE CAPITAL LLC/M KHOURY 315 S BEVERLY DR #201 BEVERLY HILLS CA 90212	13934312323
D K JUHL L L C	%KRE CAPITAL LLC/M KHOURY 315 S BEVERLY DR #201 BEVERLY HILLS CA 90212	13934312314
D K JUHL L L C	%KRE CAPITAL LLC/M KHOURY 315 S BEVERLY DR #201 BEVERLY HILLS CA 90212	13934312315
D K JUHL L L C	%KRE CAPITAL LLC/M KHOURY 315 S BEVERLY DR #201 BEVERLY HILLS CA 90212	13934312316
D K JUHL L L C	%KRE CAPITAL LLC/M KHOURY 315 S BEVERLY DR #201 BEVERLY HILLS CA 90212	13934312319
D K JUHL L L C	%KRE CAPITAL LLC/M KHOURY 315 S BEVERLY DR #201 BEVERLY HILLS CA 90212	13934312320
D K JUHL L L C	%KRE CAPITAL LLC/M KHOURY 315 S BEVERLY DR #201 BEVERLY HILLS CA 90212	13934312321
D K JUHL L L C	%KRE CAPITAL LLC/M KHOURY 315 S BEVERLY DR #201 BEVERLY HILLS CA 90212	13934312274
D K JUHL L L C	%KRE CAPITAL LLC/M KHOURY 315 S BEVERLY DR #201 BEVERLY HILLS CA 90212	13934312311
D K JUHL L L C	%KRE CAPITAL LLC/M KHOURY 315 S BEVERLY DR #201 BEVERLY HILLS CA 90212	13934312225
D K JUHL L L C	%KRE CAPITAL LLC/M KHOURY 315 S BEVERLY DR #201 BEVERLY HILLS CA 90212	13934312216
D K JUHL L L C	%KRE CAPITAL LLC/M KHOURY 315 S BEVERLY DR #201 BEVERLY HILLS CA 90212	13934312217
D K JUHL L L C	%KRE CAPITAL LLC/M KHOURY 315 S BEVERLY DR #201 BEVERLY HILLS CA 90212	13934312218
D K JUHL L L C	%KRE CAPITAL LLC/M KHOURY 315 S BEVERLY DR #201 BEVERLY HILLS CA 90212	13934312219
D K JUHL L L C	%KRE CAPITAL LLC/M KHOURY 315 S BEVERLY DR #201 BEVERLY HILLS CA 90212	13934312220
D K JUHL L L C	%KRE CAPITAL LLC/M KHOURY 315 S BEVERLY DR #201 BEVERLY HILLS CA 90212	13934312221

Report of All Selected Parcels

Case Number:

SUP-67489

Printed On: Thu: November 3, 2016

<u>Owner</u>	<u>Address</u>	<u>Parcel Number</u>
D K JUHL L L C	%KRE CAPITAL LLC/M KHOURY 315 S BEVERLY DR #201 BEVERLY HILLS CA 90212	13934312232
D K JUHL L L C	%KRE CAPITAL LLC/M KHOURY 315 S BEVERLY DR #201 BEVERLY HILLS CA 90212	13934312224
D K JUHL L L C	%KRE CAPITAL LLC/M KHOURY 315 S BEVERLY DR #201 BEVERLY HILLS CA 90212	13934312213
D K JUHL L L C	%KRE CAPITAL LLC/M KHOURY 315 S BEVERLY DR #201 BEVERLY HILLS CA 90212	13934312226
D K JUHL L L C	%KRE CAPITAL LLC/M KHOURY 315 S BEVERLY DR #201 BEVERLY HILLS CA 90212	13934312227
D K JUHL L L C	%KRE CAPITAL LLC/M KHOURY 315 S BEVERLY DR #201 BEVERLY HILLS CA 90212	13934312228
D K JUHL L L C	%KRE CAPITAL LLC/M KHOURY 315 S BEVERLY DR #201 BEVERLY HILLS CA 90212	13934312229
D K JUHL L L C	%KRE CAPITAL LLC/M KHOURY 315 S BEVERLY DR #201 BEVERLY HILLS CA 90212	13934312230
D K JUHL L L C	%KRE CAPITAL LLC/M KHOURY 315 S BEVERLY DR #201 BEVERLY HILLS CA 90212	13934312231
D K JUHL L L C	%KRE CAPITAL LLC/M KHOURY 315 S BEVERLY DR #201 BEVERLY HILLS CA 90212	13934312223
D K JUHL L L C	%KRE CAPITAL LLC/M KHOURY 315 S BEVERLY DR #201 BEVERLY HILLS CA 90212	13934312204
D K JUHL L L C	%KRE CAPITAL LLC/M KHOURY 315 S BEVERLY DR #201 BEVERLY HILLS CA 90212	13934312196
D K JUHL L L C	%KRE CAPITAL LLC/M KHOURY 315 S BEVERLY DR #201 BEVERLY HILLS CA 90212	13934312197
D K JUHL L L C	%KRE CAPITAL LLC/M KHOURY 315 S BEVERLY DR #201 BEVERLY HILLS CA 90212	13934312198
D K JUHL L L C	%KRE CAPITAL LLC/M KHOURY 315 S BEVERLY DR #201 BEVERLY HILLS CA 90212	13934312199
D K JUHL L L C	%KRE CAPITAL LLC/M KHOURY 315 S BEVERLY DR #201 BEVERLY HILLS CA 90212	13934312200
D K JUHL L L C	%KRE CAPITAL LLC/M KHOURY 315 S BEVERLY DR #201 BEVERLY HILLS CA 90212	13934312201
D K JUHL L L C	%KRE CAPITAL LLC/M KHOURY 315 S BEVERLY DR #201 BEVERLY HILLS CA 90212	13934312215
D K JUHL L L C	%KRE CAPITAL LLC/M KHOURY 315 S BEVERLY DR #201 BEVERLY HILLS CA 90212	13934312203
D K JUHL L L C	%KRE CAPITAL LLC/M KHOURY 315 S BEVERLY DR #201 BEVERLY HILLS CA 90212	13934312214
D K JUHL L L C	%KRE CAPITAL LLC/M KHOURY 315 S BEVERLY DR #201 BEVERLY HILLS CA 90212	13934312205
D K JUHL L L C	%KRE CAPITAL LLC/M KHOURY 315 S BEVERLY DR #201 BEVERLY HILLS CA 90212	13934312207
D K JUHL L L C	%KRE CAPITAL LLC/M KHOURY 315 S BEVERLY DR #201 BEVERLY HILLS CA 90212	13934312208
D K JUHL L L C	%KRE CAPITAL LLC/M KHOURY 315 S BEVERLY DR #201 BEVERLY HILLS CA 90212	13934312209
D K JUHL L L C	%KRE CAPITAL LLC/M KHOURY 315 S BEVERLY DR #201 BEVERLY HILLS CA 90212	13934312210
D K JUHL L L C	%KRE CAPITAL LLC/M KHOURY 315 S BEVERLY DR #201 BEVERLY HILLS CA 90212	13934312212
D K JUHL L L C	%KRE CAPITAL LLC/M KHOURY 315 S BEVERLY DR #201 BEVERLY HILLS CA 90212	13934312222
D K JUHL L L C	%KRE CAPITAL LLC/M KHOURY 315 S BEVERLY DR #201 BEVERLY HILLS CA 90212	13934312202
D K JUHL L L C	%KRE CAPITAL LLC/M KHOURY 315 S BEVERLY DR #201 BEVERLY HILLS CA 90212	13934312260
D K JUHL L L C	%KRE CAPITAL LLC/M KHOURY 315 S BEVERLY DR #201 BEVERLY HILLS CA 90212	13934312233
D K JUHL L L C	%KRE CAPITAL LLC/M KHOURY 315 S BEVERLY DR #201 BEVERLY HILLS CA 90212	13934312250
D K JUHL L L C	%KRE CAPITAL LLC/M KHOURY 315 S BEVERLY DR #201 BEVERLY HILLS CA 90212	13934312254

Report of All Selected Parcels**Case Number:**

SUP-67489

Printed On: Thu: November 3, 2016

<u>Owner</u>	<u>Address</u>	<u>Parcel Numbe</u>
D K JUHL L L C	%KRE CAPITAL LLC/M KHOURY 315 S BEVERLY DR #201 BEVERLY HILLS CA 90212	13934312255
D K JUHL L L C	%KRE CAPITAL LLC/M KHOURY 315 S BEVERLY DR #201 BEVERLY HILLS CA 90212	13934312256
D K JUHL L L C	%KRE CAPITAL LLC/M KHOURY 315 S BEVERLY DR #201 BEVERLY HILLS CA 90212	13934312249
D K JUHL L L C	%KRE CAPITAL LLC/M KHOURY 315 S BEVERLY DR #201 BEVERLY HILLS CA 90212	13934312248
D K JUHL L L C	%KRE CAPITAL LLC/M KHOURY 315 S BEVERLY DR #201 BEVERLY HILLS CA 90212	13934312257
D K JUHL L L C	%KRE CAPITAL LLC/M KHOURY 315 S BEVERLY DR #201 BEVERLY HILLS CA 90212	13934312247
D K JUHL L L C	%KRE CAPITAL LLC/M KHOURY 315 S BEVERLY DR #201 BEVERLY HILLS CA 90212	13934312258
D K JUHL L L C	%KRE CAPITAL LLC/M KHOURY 315 S BEVERLY DR #201 BEVERLY HILLS CA 90212	13934312245
D K JUHL L L C	%KRE CAPITAL LLC/M KHOURY 315 S BEVERLY DR #201 BEVERLY HILLS CA 90212	13934312253
D K JUHL L L C	%KRE CAPITAL LLC/M KHOURY 315 S BEVERLY DR #201 BEVERLY HILLS CA 90212	13934312259
D K JUHL L L C	%KRE CAPITAL LLC/M KHOURY 315 S BEVERLY DR #201 BEVERLY HILLS CA 90212	13934312251
D K JUHL L L C	%KRE CAPITAL LLC/M KHOURY 315 S BEVERLY DR #201 BEVERLY HILLS CA 90212	13934312262
D K JUHL L L C	%KRE CAPITAL LLC/M KHOURY 315 S BEVERLY DR #201 BEVERLY HILLS CA 90212	13934312234
D K JUHL L L C	%KRE CAPITAL LLC/M KHOURY 315 S BEVERLY DR #201 BEVERLY HILLS CA 90212	13934312242
D K JUHL L L C	%KRE CAPITAL LLC/M KHOURY 315 S BEVERLY DR #201 BEVERLY HILLS CA 90212	13934312241
D K JUHL L L C	%KRE CAPITAL LLC/M KHOURY 315 S BEVERLY DR #201 BEVERLY HILLS CA 90212	13934312240
D K JUHL L L C	%KRE CAPITAL LLC/M KHOURY 315 S BEVERLY DR #201 BEVERLY HILLS CA 90212	13934312239
D K JUHL L L C	%KRE CAPITAL LLC/M KHOURY 315 S BEVERLY DR #201 BEVERLY HILLS CA 90212	13934312238
D K JUHL L L C	%KRE CAPITAL LLC/M KHOURY 315 S BEVERLY DR #201 BEVERLY HILLS CA 90212	13934312261
D K JUHL L L C	%KRE CAPITAL LLC/M KHOURY 315 S BEVERLY DR #201 BEVERLY HILLS CA 90212	13934312243
D K JUHL L L C	%KRE CAPITAL LLC/M KHOURY 315 S BEVERLY DR #201 BEVERLY HILLS CA 90212	13934312235
D K JUHL L L C	%KRE CAPITAL LLC/M KHOURY 315 S BEVERLY DR #201 BEVERLY HILLS CA 90212	13934312244
D K JUHL L L C	%KRE CAPITAL LLC/M KHOURY 315 S BEVERLY DR #201 BEVERLY HILLS CA 90212	13934312237
D K JUHL L L C	%KRE CAPITAL LLC/M KHOURY 315 S BEVERLY DR #201 BEVERLY HILLS CA 90212	13934312236
DALACAS FAMILY L P	1012 SECRET GARDEN ST LAS VEGAS NV 89145-8697	13934311139
DAVIS LARRY	353 E BONNEVILLE AVE #1402 LAS VEGAS NV 89101-6529	13934312339
DAWSON INVESTMENT L P #1	614 E FAIRWAY RD HENDERSON NV 89015-7408	13934311067
DECARO INVESTMENTS I L L C	840 S RANCHO DR #4-100 LAS VEGAS NV 89106	13934410233
DECKER L L C	8941 TORCELLO DR LAS VEGAS NV 89117	13934410219
DELNEGRO LOIS	6904 HELSEM WY DALLAS TX 75230-1921	13934411013
DEN EQUITY L L C	616 S 8TH ST LAS VEGAS NV 89101-7005	13934810026
DENIX LTD	3453 WHIPPLE AVE CHICAGO IL 60618	13934312193

Report of All Selected Parcels**Case Number:**

SUP-67489

Printed On: Thu: November 3, 2016

<u>Owner</u>	<u>Address</u>	<u>Parcel Numbe</u>
DENISON STEVEN G & PAMELA J	30581 EMPEROR DR CANYON LAKE CA 92587	13934312277
DIAMOND DOWNTOWN L L C	7885 WESTWIND RD LAS VEGAS NV 89139	13934801011
DIAMOND DOWNTOWN L L C	7885 WESTWIND RD LAS VEGAS NV 89139	13934810003
DIAMOND RICHARD & S 2004 REV TR	DIAMOND RICHARD N & SUSAN TRS 24518-B WINDSOR DR VALENCIA CA 91355-4427	13934410201
DIAMOND RICHARD & S 2004 REV TR	DIAMOND RICHARD N & SUSAN TRS 24518-B WINDSOR DR VALENCIA CA 91355-4427	13934410202
DIANE LESLIE TRUST	DIANE LESLIE TRS P O BOX 232107 LAS VEGAS NV 89105-2107	13934410182
DOCTOR L L C	ISTRA IRREVOCABLE TRUST 601 E CHARLESTON BLVD LAS VEGAS NV 89104-1508	13934410203
DOWNTOWN HOLDING GROUP L L C	8905 W POST RD #210 LAS VEGAS nv 89148	13934401009
DOWNTOWN HOLDING GROUP L L C	8905 W POST RD #210 LAS VEGAS nv 89148	13934410131
DOWNTOWN HOLDING GROUP L L C	CITY OF LAS VEGAS LEASE 8905 W POST RD #210 LAS VEGAS nv 89148	13934410101
DOWNTOWN HOLDING GROUP L L C	8905 W POST RD #210 LAS VEGAS nv 89148	13934410252
DOWNTOWN HOLDING GROUP L L C	8905 W POST RD #210 LAS VEGAS nv 89148	13934401008
DOWNTOWN LEGAL L L C	5215 PONDEROSA WAY 1ST FLR LAS VEGAS NV 89118	13934710023
DOWNTOWN SANCHEZ L L C	3960 HOWARD HUGHES PKWY #150 LAS VEGAS NV 89169	13934810029
DOWNTOWN SANCHEZ L L C	3960 HOWARD HUGHES PKWY #150 LAS VEGAS NV 89169	13934311138
DRAGONFYRE TRUST	FIELDER MEGAN ANDERSON TRS 1885 SOLARI DR RENO NV 89509-5116	13934312165
DRAPS-AZ L L C	720 S 7TH ST 3RD FLR LAS VEGAS NV 89101-6932	13934410229
DRAPS-AZ L L C	720 S 7TH ST #300 LAS VEGAS NV 89101-6930	13934410210
DYNAVID LTD	631 LAS VEGAS BLVD S LAS VEGAS NV 89101-6696	13934410181
ECLIPSE THEATER L V L L C	11700 W CHARLESTON BLVD #170-124 LAS VEGAS NV 89134	13934401014
EGNOR JOHN	39 HISTORY ROW SPRING TX 77380	13934411073
ELDER MIKAL LEE & MIKAL L	900 S LAS VEGAS BLVD #1014 LAS VEGAS NV 89101-6861	13934411062
ELI & DUSTY L L C	2512 FULANO WAY LAS VEGAS NV 89102-2033	13934410197
ELLING HENRY & CANDACE	9188 WIGHEIL ST SUFFOLK VA 22433	13934411039
EMPIRE S K 1 L L C	900 S LAS VEGAS BLVD #803 LAS VEGAS NV 89101-6850	13934411018
EMPIRE S K 2 L L C	900 S LAS VEGAS BLVD #803 LAS VEGAS NV 89101-6850	13934411040
EMPIRE S K 4 L L C	900 S LAS VEGAS BLVD #803 LAS VEGAS NV 89101	13934411076
EMPIRE S K MASTER L L C	900 S LAS VEGAS BLVD #803 LAS VEGAS NV 89101-6850	13934411019
ESCOBAR LUZ MARCELA TRUST	ESCOBAR LUZ MARCELA TRS 4108 S NORTON AVE LOS ANGELES CA 90008-3747	13934312317
EVANGELISTA L L C	700 S SEVENTH ST LAS VEGAS NV 89101-6908	13934401005
F M F L L C	1401 LAS VEGAS BLVD SO LAS VEGAS NV 89104-1327	13934710025
FLORES ELEANOR	217 S MAIMONE AVE SAN DIMAS CA 91773-2451	13934312115

Report of All Selected Parcels**Case Number:**

SUP-67489

Printed On: Thu: November 3, 2016

<u>Owner</u>	<u>Address</u>	<u>Parcel Number</u>
FOURTH STREET PLACE L L C	P O BOX 751330 LAS VEGAS NV 89136	13934410120
FOURTH STREET PLACE L L C	P O BOX 751330 LAS VEGAS NV 89136	13934410119
FOURTH STREET PLACE L L C	P O BOX 751330 LAS VEGAS NV 89136	13934410121
FRASE ANDREW WAYNE	131 MILL CREEK CROSSING MADISON AL 35758	13934312301
FREDEKING ROBIN	900 S LAS VEGAS BLVD #1107 LAS VEGAS NV 89101-6861	13934411071
FRITZ ON SEVENTH L L C	609 S 7TH ST LAS VEGAS NV 89101-6905	13934810015
FUMO OSVALDO E	601 LAS VEGAS BLVD LAS VEGAS NV 89101	13934301010
G P PROPERTIES L L C	520 S 4TH ST LAS VEGAS NV 89101-6520	13934310058
GAMETTE BRAUNDA T	GAMETTE CRAIG T & JANE M 620 S 8TH ST LAS VEGAS NV 89101-7005	13934810027
GAMMON BETTY	P O BOX 35698 LAS VEGAS NV 89133-5698	13934411033
GARCES VENTURE L L C	1065 KANE CONCOURSE #201BAY HARB OR ISLANDS FL 33154-2100	13934311140
GARCES VENTURE L L C	1065 KANE CONCOURSE #201BAY HARB OR ISLANDS FL 33154-2100	13934311143
GARCES VENTURE L L C	1065 KANE CONCOURSE #201BAY HARB OR ISLANDS FL 33154-2100	13934311141
GARCES VENTURE L L C	1065 KANE CONCOURSE #201BAY HARB OR ISLANDS FL 33154-2100	13934311142
GASSIX L L C	5115 S DURANGO DR LAS VEGAS NV 89113	13934410194
GATEWAY MOTEL INC	P O BOX 7014 RIVERSIDE CA 92513-7014	13934410165
GATEWAY MOTEL INC	P O BOX 7014 RIVERSIDE CA 92513-7014	13934410139
GEBHART DAVID S	2430 VICTORY PARK LN #2104 DALLAS TX 75219-7606	13934411036
GIARDINO FAMILY TRUST	LINDLEY MARGARET M 1993 REV TR 9 TOLUCA ESTATES DR TOLUCA LAKE CA 91602-2835	13934311113
GIARDINO FAMILY TRUST	LINDLEY MARGARET M 1993 REV TR 9 TOLUCA ESTATES DR TOLUCA LAKE CA 91602-2835	13934311114
GIARDINO FAMILY TRUST	LINDLEY MARGARET M 1993 REV TR 9 TOLUCA ESTATES DR TOLUCA LAKE CA 91602-2835	13934311112
GIUNTA ROBERT & LORI REV TR AGMT	GIUNTA ROBERT G & LORI A CO-TRS 881 SHIRLEY LN BOULDER CITY NV 89005-3617	13934310070
H G SUNFLOWER L L C	9237 EVERGREEN CANYON DR LAS VEGAS NV 89134-6063	13934410125
HARRIS AMANDA	1820 WILLIAMSPORT ST HENDERSON NV 89052	13934411025
HARRIS AMANDA N	900 LAS VEGAS BLVD 120 LAS VEGAS NV 89101-6826	13934411037
HARRISON PROPERTIES LTD	713 LAS VEGAS BLVD S LAS VEGAS NV 89101-6755	13934401020
HELLFIRE MEDIA L L C	7 BOULDER CROSSING CIR LAS VEGAS NV 89135	16203501001
HOLMES CHONITA L REVOCABLE TRUST	HOLMES CHONITA L TRS 1379 PARK WESTERN DR #302 SAN PEDRO CA 90732-2300	13934411053
HOLMES LESTER & KATHELEEN TRUST	MURPHY LESLIE ANN TRS 7900 KIOWA CIR LAS VEGAS NV 89149	13934810025
IQBAL MOHAMED A	900 LAS VEGAS BLVD S #807 LAS VEGAS NV 89101	13934411023
IREDALE EUGENE G PROFIT SHR PL	IREDALE EUGENE G AGENT %LAW OFFICE E IREDALE 105 W F ST 4TH FLR SAN DIEGO CA 92101-6087	13934411057

Report of All Selected Parcels**Case Number:**

SUP-67489

Printed On: Thu: November 3, 2016

<u>Owner</u>	<u>Address</u>	<u>Parcel Number</u>
J C S 1 L L C	P O BOX 50762 HENDERSON NV 89016-0762	13934410211
J J M PROPERTIES L L C	520 S 4TH ST #300 LAS VEGAS NV 89101-6524	13934410216
JACK & GRACIE L L C	7 MOUNTAIN COVE CT HENDERSON NV 89052-6680	13934810022
JACKSON MICHAEL WILLIAM	2545 KOKOMO RD HAIKU HI 96708	13934411088
JAM II HOLDINGS L L C	701 S 7TH ST LAS VEGAS NV 89101-6907	13934801006
JAZA LAND 1 L L C	630 S 4TH ST LAS VEGAS NV 89101-6604	13934311103
JAZA LAND 1 L L C	630 S 4TH ST LAS VEGAS NV 89101-6604	13934311104
JENSEN JASON	900 S LAS VEGAS BLVD #1001 HENDERSON NV 890101	13934411049
JOHNSON & JOHNSON PPTYS L L C	1160 N TOWN CENTER DR #390 LAS VEGAS NV 89144	13934311111
JOSSEL JONATHAN R	217 ROSEMARY LN LAS VEGAS NV 89107	13934411029
JUDGMENTS L L C	P O BOX 3072 STATELINE NV 89449-3072	13934410100
JUMAT PON	ISMAIL FARIDAH 360 E DESERT ROSE DR HENDERSON NV 89015	13934410232
JUNIOR CORP	2700 W RIVER RD ST ANTHONY ID 83445	13934410158
K C W PARTNERS L L C	4525 DEAN MARTIN DR #2812 LAS VEGAS NV 89103	13934312060
KAY FAMILY TRUST	KAY LANE S & SUSAN B TRS 1617 BAYONNE DR LAS VEGAS NV 89134-6186	13934410206
KELESIS MICHAEL	947 SERENA VENEDA LN LAS VEGAS NV 89138	13934410110
KELESIS MICHAEL	947 SERENA VENEDA LN LAS VEGAS NV 89138	13934410111
KENNY CRAIG P	501 S 8TH ST LAS VEGAS NV 89101-7002	13934410242
KENNY CRAIG P	501 S 8TH ST LAS VEGAS NV 89101-7002	13934810006
KENYON L P	617 HOOVER AVE LAS VEGAS NV 89101-6816	13934410236
KENYON L P	617 HOOVER LAS VEGAS NV 89101-6816	13934410234
KENYON L P	617 HOOVER AVE LAS VEGAS NV 89101-6816	13934410235
KHALAF ALEXANDER & F REV LIV TR	O V B TRUST 2370 CORPORATE CIR #250 HENDERSON NV 89074	13934710016
KIMBALL CHARLEEN	900 LAS VEGAS BLVD S #1110 LAS VEGAS NV 89101-6862	13934411069
KIMBALL CHARLEEN L	599 W BAY AREA BLVD WEBSTER TX 77598-4136	13934411074
KINT L L C	10300 WELLSIDE HILL AVE LAS VEGAS NV 89145	13934410118
KJORVESTAD SANDRA	900 S LAS VEGAS BLVD #803 LAS VEGAS NV 89101	13934411075
KLAI JOHN R II	SPARER JONATHAN S 7 SABLE RIDGE CT LAS VEGAS NV 89135	13934312341
KOPF KEITH A	900 LAS VEGAS BLVD S #1207 LAS VEGAS NV 89101-6863	13934411087
KOPF PROPERTIES II L L C	3280 RAVEN AVE LAS VEGAS NV 89139	13934410198
KOPPE FAMILY L P	4545 RIVA DE ROMANZA LAS VEGAS NV 89135-2544	13934311093
KOPPE GREGORY A SEPARATE FAM TR	KOPPE GREGORY A TRS 711 S 4TH ST #205 LAS VEGAS NV 89101-6763	13934410151

Report of All Selected Parcels**Case Number:**

SUP-67489

Printed On: Thu: November 3, 2016

<u>Owner</u>	<u>Address</u>	<u>Parcel Numbe</u>
KOVACS ALBERT	900 S LAS VEGAS BLVD #1004 LAS VEGAS NV 89101	13934411052
KRIEGER FAMILY TRUST	KRIEGER CHERYL A TRS 8009 SUMMER HARVEST AVE LAS VEGAS NV 89129-7304	13934810012
L V CAPITAL FUND L L C	267 CRESCENT BAY DR LAGUNA BEACH CA 92651	13934411098
L V CAPITAL FUND L L C	267 CRESCENT BAY DR LAGUNA BEACH CA 92651	13934411124
L V LAND COMPANY II L L C	1215 S FORT APACHE RD #120 LAS VEGAS NV 89117	13934311153
L V LAND COMPANY II L L C	1215 S FORT APACHE RD #120 LAS VEGAS NV 89117	13934311152
L V LAND COMPANY II L L C	1215 S FORT APACHE RD #120 LAS VEGAS NV 89117	13934311151
L V LAND COMPANY L L C	1215 S FORT APACHE RD #120 LAS VEGAS NV 89117	13934303002
LAGUNA CEDAR CLIFF PARTNERSHIP	MASON DAVID L LIVING TRUST 2003 1137 SO RANCHO DR #120 LAS VEGAS NV 89102-2259	13934310065
LAKEWEST LAS VEGAS PPTYS L L C	P O BOX 1159 DEERFIELD IL 60015	16203114002
LANG GARY D & TRACY	6449 CELESTE AVE LAS VEGAS NV 89107-2402	13934410241
LAS VEGAS BOULEVARD DEV L L C	6050 S FORT APACHE RD #200A LAS VEGAS NV 89148	13934410149
LAS VEGAS BOULEVARD DEV L L C	6050 S FORT APACHE RD #200A LAS VEGAS NV 89148	13934410156
LAS VEGAS BOULEVARD SOUTH TRUST	P O BOX 36208 LAS VEGAS NV 89133-6208	13934411026
LAS VEGAS ICE L L C	5655 S YOSEMITE ST #301 GREENWOOD VILLAGE CO 80111-3221	13934301011
LAW WILLIAM	MORIKAWA RANI G 28 HALSTED CIR ALHAMBRA CA 91801-2832	13934312089
LE SAYAD L L C	4525 DEAN MARTIN DR #3107 LAS VEGAS NV 89103	13934311066
LEARY WILLIAM & HONG TOK	800 S LAS VEGAS BLVD LAS VEGAS NV 89101-6723	13934410157
LEAVITT ANDREW M & P A REV TR	LEAVITT ANDREW M & PATRICIA TRS 633 S 7TH ST LAS VEGAS NV 89101	13934810011
LEGACY L V L L C	706 S 8TH ST LAS VEGAS NV 89101-7007	13934810031
LEGAL AID CENTER SOUTHERN NEVADA	725 E CHARLESTON BLVD LAS VEGAS NV 89104	13934401017
LEIGH LYNN & JAMES L L C	800 S 4TH ST LAS VEGAS NV 89101-6709	13934410122
LEIGH LYNN & JAMES L L C	800 S 4TH ST LAS VEGAS NV 89101-6709	13934410123
LEIGH LYNN & JAMES L L C	800 S 4TH ST LAS VEGAS NV 89101-6709	13934410124
LEWIS SHERRI Y	353 E BONNEVILLE AVE #612 LAS VEGAS NV 89101-6659	13934312194
LIGON KYLE L REVOCABLE TRUST	LIGON KYLE TRS 4525 DEAN MARTIN DR #2812 LAS VEGAS NV 89103	13934312064
LIOSIS STAN	900 S LAS VEGAS BLVD #1406 LAS VEGAS NV 89101-6865	13934411102
L'OCTAINE L P	7660 FAY AVE #H525 LA JOLLA CA 92037	13934401006
LODGE VEGAS #32 F & A M	632 E CHARLESTON LAS VEGAS NV 89104-1563	16203501002
LOWE BRENT	3729 VINTON AVE #101 LOS ANGELES CA 90034-5970	13934411034
LUTHER LAURENCE B	1906 ASHLEY COVE CIR ANCHORAGE AK 99516-7707	13934411110
LV OPPORTUNITY FUND L L C	267 CRESCENT BAY DR LAGUNA BEACH CA 92651	13934411035

Report of All Selected Parcels**Case Number:**

SUP-67489

Printed On: Thu: November 3, 2016

<u>Owner</u>	<u>Address</u>	<u>Parcel Number</u>
MACK J VENTURES L L C	1842 TEE BOX WAY HENDERSON NV 89074	13934411030
MAIN STREET DEVELOPMENT L L C	37 PROMONTORY RIDGE DR LAS VEGAS NV 89135	13934710019
MARSH GREG W REVOCABLE TRUST	MARSH GREG W TRS 3465 W MAULE AVE LAS VEGAS NV 89118	13934410240
MASON DAVID L LIVING TRUST 2003	MASON DAVID L TRS 1137 SO RANCHO DR #120 LAS VEGAS NV 89102-2259	13934310078
MASTRANGELO REVOCABLE LIVING TR	MASTRANGELO NIKOLAS & ORALIA TRS 5705 AVENIDA SILLA LAS VEGAS NV 89108-4182	13934410207
MAUDIE DOG TRUST	607 LAS VEGAS BLVD S LAS VEGAS NV 89101-6623	13934310055
MAUGERI ANDREA	900 LAS VEGAS BLVD S #808 LAS VEGAS NV 89101-6850	13934411024
MCGEE RONALD	900 LAS VEGAS BLVD S #706 LAS VEGAS NV 89101	13934411006
MCLOUGHLIN STEVEN JOHN	900 S LAS VEGAS BLVD #812 LAS VEGAS NV 89101-6850	13934411028
MCMAHAN FAMILY 1999 LIVING TRUST	MCMAHAN ROY ROBERT & NORMA P TRS 1589 TRAVOIS CIR LAS VEGAS NV 89119-6283	13934810028
MEADOWLAND INVESTMENTS L L C	230 E OHIO ST #400 CHICAGO IL 60611	13934311133
MEADOWLAND INVESTMENTS L L C	230 E OHIO ST #400 CHICAGO IL 60611	13934311134
MEADOWLAND INVESTMENTS L L C	230 E OHIO ST #400 CHICAGO IL 60611	13934311135
MEADOWLAND INVESTMENTS L L C	230 E OHIO ST #400 CHICAGO IL 60611	13934311136
MOON JOON	900 LAS VEGAS BLVD S #1507 LAS VEGAS NV 89101	13934411119
MOON JOON	900 LAS VEGAS BLVD S #1507 LAS VEGAS NV 89101	13934411120
MUELLER CRAIG A	600 S 8TH ST LAS VEGAS NV 89101-7005	13934410231
MURI MONIQUE	1212 6TH AVE N NASHVILLE TN 37208	13934312328
NEVADA FOUNDATION CONSUMER ED	406 N NEVADA ST CARSON CITY NV 89703-4107	13934410115
NEVADA LEGAL SERVICES INC	800 S 6TH ST LAS VEGAS NV 89101-6924	13934310068
NEVADA LEGAL SERVICES INC	800 S 6TH ST LAS VEGAS NV 89101-6924	13934310067
NOMBERG ELIZABETH	113 CAMELIA DR DOTHAN AL 36303	13934411011
NYAMUSWA GILBERT M	1704 AUTHENTIC CT HENDERSON NV 89012	13934312333
OAKTREE CAPITAL SERIES L L C SER	3722 LAS VEGAS BLVD S #1604 E LAS VEGAS NV 89158	13934410152
OAKTREE CAPITAL SERIES L L C SER	3722 LAS VEGAS BLVD S #1604 E LAS VEGAS NV 89158	13934410153
ORMSBY NANCY KAY	112 N GRANT ST BEULAVILLE NC 28518	13934411038
P & M M L L C	19 CASTLE OAKS CT LAS VEGAS NV 89141-6043	13934410212
P R M D L L C	823 S LAS VEGAS BLVD LAS VEGAS NV 89101-6727	13934410170
P R M D L L C	823 LAS VEGAS BLVD S LAS VEGAS NV 89101-6727	13934401012
PALACE MOTELS INC	3096 SHADOWRIDGE AVE LAS VEGAS NV 89120	13934310057
PARCEL 155 L L C	6050 S FORT APACHE RD #200A LAS VEGAS NV 89148	13934410155
PARK JI-YOON	505 HARVARD AVE SANTA CLARA CA 95051-6015	13934411021

Report of All Selected Parcels**Case Number:**

SUP-67489

Printed On: Thu: November 3, 2016

<u>Owner</u>	<u>Address</u>	<u>Parcel Numbe</u>
PAYNE CARY COLT 1992 TRUST AGMT	PAYNE CARY COLT TRS 700 S 8TH ST LAS VEGAS NV 89101-7007	13934810030
PEBBLE & STIR L L C	710 S 4TH ST LAS VEGAS NV 89101-6707	13934410117
PEBBLE & STIR L L C	710 S 4TH ST LAS VEGAS NV 89101-6707	13934310051
PENTZ THOMAS WESLEY	16 W 22ND ST 2ND FLOOR NEW YORK NY 10010	13934411055
PEPO MICHAEL & ROSANNA REV TR	PEPO MICHAEL V & ROSANNA TRS 5660 LONE PINE PL PASO ROBLES CA 93446	13934312206
PETO FAMILY TRUST	PETO JEANNE HAM TRS P O BOX 790 LAS VEGAS NV 89125-0790	16203112041
PHILLIPS DAVID LEE & ASSOCIATES	700 S 4TH ST LAS VEGAS NV 89101-6707	13934310052
PIGGY 23 L L C	625 S 6TH ST LAS VEGAS NV 89101-6919	13934410218
POLURI VIJAYA	C S E HOLDING L L C 506 PEPPERTREE RD WALNUT CREEK CA 94598-2702	13934810032
PRITCHARD JASON C & KIMBERLY L	900 S LAS VEGAS BLVD #1002 LAS VEGAS NV 89101-6850	13934411050
PROVIEW SERIES 22 L L C	144 N BRISTOL AVE LOS ANGELES CA 90049	13934410154
PROVIEW SERIES 31 L L C	144 N BRISTOL AVE LOS ANGELES CA 90049	13934311137
QUINN MICHELE C ART ADVISORY L L	620 S 7TH ST LAS VEGAS NV 89101-6906	13934410223
R M C M PROPERTY PARTNERSHIP L L	700 S 3RD ST LAS VEGAS NV 89101-6703	13934310047
R N M C M L L C	1589 TRAVOIS CIR LAS VEGAS NV 89119	13934810035
R R PROPERTIES L L C	801 S 4TH ST LAS VEGAS NV 89101-6708	13934401004
R R PROPERTIES L L C	801 S FOURTH ST LAS VEGAS NV 89101-6708	13934410144
R R PROPERTIES L L C	801 S FOURTH ST LAS VEGAS NV 89101-6708	13934410143
R R PROPERTIES L L C	801 S 4TH ST LAS VEGAS NV 89101	13934410128
R R PROPERTIES L L C	801 S FOURTH STREET LAS VEGAS NV 89101-6708	13934410142
R R PROPERTIES L L C	801 S 4TH ST LAS VEGAS NV 89101	13934410127
RAMACHANDRAN PARTHIBAN	4808 N 24TH ST #724 PHOENIX AZ 85016-9127	13934411032
RAS SHAWN Y	5625 N CHIEFTAN ST LAS VEGAS NV 89149	13934312049
RATINOFF FAMILY TRUST ETAL	P O BOX 11434 MARINA DEL REY CA 90295	13934410159
RAYNER FREDERICK	2430 VICTORY PARK LN #2104 DALLAS TX 75219-7606	13934411101
REBONG-SERRATORE IRREVOCABLE TRU	SERRATORE NAOMIE S TRS 9 TALL RUFF DR LAS VEGAS NV 89148	13934310046
REILLY MICHAEL & PATRICIA REV TR	REILLY MICHAEL D & PATRICIA TRS 225 N BROADWAY AVE BOZEMAN MT 59715-3803	13934411001
REILLY MICHAEL D & PATRICIA REVO	REILLY MICHAEL D & PATRICIA CO-T 225 N BROADWAY AVE BOZEMAN MT 59715-3803	13934411027
RETAIL 110 INC	900 S LAS VEGAS BLVD #140 LAS VEGAS NV 89101	13934411121
RETAIL 130 INC	%S CHERRY 900 S LAS VEGAS BLVD #130 LAS VEGAS NV 89101-6891	13934411122
RICK MELISSA 2013 DEC TR	RICK MELISSA TRS 1815 DE LA VINA ST #F SANTA BARBARA CA 93101	13934411017
ROLLINS FAMILY TRUST	ROLLINS SHEILA & RANDOLPH TRS 353 E BONNEVILLE AVE #413 LAS VEGAS NV 89101-6651	13934312107

Report of All Selected Parcels**Case Number:**

SUP-67489

Printed On: Thu: November 3, 2016

<u>Owner</u>	<u>Address</u>	<u>Parcel Numbe</u>
ROTHROCK FAMILY LIVING TRUST	ROTHROCK TOM & MONIQUE TRS 900 LAS VEGAS BLVD S #916 LAS VEGAS NV 89101	13934411048
RUDEL WESTON W LIVING TRUST	RUDEL WESTON W TRS 712 S 3RD ST LAS VEGAS NV 89101	13934310045
S J LIVING TRUST	1732 GLENVIEW DR LAS VEGAS NV 89134	13934801001
S V S PROPERTIES LTD L L C	4431 S EASTERN AVE #2 LAS VEGAS NV 89119-7850	16203501003
S Z VEGAS HOLDINGS L L C	%TAMARES LV PPTYS LLC~H BRAUNSTE 7600 JERICHO TURNPIKE #402 WOODBURY NY 11797	13934411083
SANTANGELO ANDREA	900 S LAS VEGAS BLVD #1401 LAS VEGAS NV 89101-6864	13934411097
SCHIFF MARVIN JAMES TR #R-501	SCHIFF MARVIN JAMES TRS 2401 INDUSTRIAL RD LAS VEGAS NV 89102-4817	13934410199
SCOFFLAW HOLDINGS L L C	511 E TALLGRASS DR APPLETON WI 54913	13934411118
SCOW STEVEN R & MARY BETH	326 MEDIO CT HENDERSON NV 89014-5132	13934810004
SHANER CHERYL TRUST	8208 W CAMERO AVE LAS VEGAS NV 89113-4405	13934410188
SHANER JEFFREY IAN	715 S 6TH ST LAS VEGAS NV 89101-6921	13934410214
SHANER JEFFREY IAN	715 S 6TH ST LAS VEGAS NV 89101-6921	13934410213
SHANER JEFFREY IAN	715 S 6TH ST LAS VEGAS NV 89101-6921	13934410215
SHAWLER DAVID F	%O T SHAWLER P O BOX 67 MARSHALL IL 62441-0067	13934312246
SHEN HONG	KOCH ANDREA 900 S LAS VEGAS BLVD #1010 LAS VEGAS NV 89101-6860	13934411058
SHUFFIELD JACQUELINE FAMILY TR	LOPRESTI LOUISE TRS 7485 ULLOM DR LAS VEGAS NV 89139-5770	13934810007
SILVER DAVID F	903 CLINTON ST #3R PHILADELPHIA PA 19107	13934411004
SIMON INC	2624 SPALDING DR LAS VEGAS NV 89134-7550	13934410166
SINGH FAMILY TRUST	SINGH BEDI AJAY & BHARATHI GOVIN 322 W 57TH ST #30B NEW YORK NY 10019	13934411016
SINGH FAMILY TRUST	SINGH BEDI & BHARATHI TRS 2216 MANHATTAN AVE MANHATTAN BEACH CA 90266	13934411103
SIX SIXTEEN SOUTH THIRD ST L L C	626 S 3RD ST LAS VEGAS NV 89101-6602	13934311068
SIXTH ST STRATEGIC SOLUTIONS LLC	1930 VILLAGE CENTER CIR LAS VEGAS NV 89134	13934310066
SKUPA WILLIAM S & SHARRON R	P O BOX 778237 HENDERSON NV 89077	13934810001
SMITH LESLIE H REV LIV TR	SMITH LESLIE H TRS 4711 E FLAMINGO RD LAS VEGAS NV 89121	13934410185
SOHO 1502 L L C	267 CRESCENT BAY DR LAGUNA BEACH CA 92651	13934411114
SORAYA MEHRAN	BOHN CASEY P O BOX 22911 OKLAHOMA CITY OK 73123	13934411009
SORENSEN R PAUL	HIGGINS SARAH 8320 SPRING ARTS LAS VEGAS NV 89101	13934710015
SPACEMAKER L L C	214 N WEATHERLY DR BEVERLY HILLS CA 90211-1624	13934310054
SPINAZZOLA DONATO MARK	13330 TRAILHEAD PL SAN DIEGO CA 92129-4620	13934312079
STEINMAN STUART & FRANCISCA	371 N ADAMS ST SIERRA CA 91024-1138	13934411068
STEINMAN STUART & FRANCISCA	371 ADAMS ST SIERRA MADRE CA 91024-1138	13934411095
STEINMAN STUART & FRANCISCA	371 ADAMS ST SIERRA MADRE CA 91024-1138	13934411091

Report of All Selected Parcels**Case Number:**

SUP-67489

Printed On: Thu: November 3, 2016

<u>Owner</u>	<u>Address</u>	<u>Parcel Numbe</u>
STEINMAN STUART N & FRANCISCA	371 ADAMS ST SIERRA MADRE CA 91024-1138	13934411042
STEINMAN STUART N & FRANCISCA	371 N ADAMS ST SIERRA MADRE CA 91024-1138	13934411063
STEINMAN STURAR & FRANCISCA	371 ADAMS ST SIERRA MADRE CA 91024-1138	13934411007
STONE FAMILY TRUST	STONE JAMES E & IRIS B TRS 353 E BONNEVILLE AVE #573 LAS VEGAS NV 89101-6658	13934312178
SUMMERLIN LV L L C	2605 CAMINO DEL RIO SOUTH SAN DIEGO CA 92108	13934410114
SUNRISE REALTY L L C	%FOSTER RLTY LLC 3900 PARADISE RD #121 LAS VEGAS NV 89169	13934411056
SUNRISE REALTY L L C	%FOSTER RLTY LLC 3900 PARADISE RD #121 LAS VEGAS NV 89169	13934411093
T & N INVESTMENTS L L C	2340 PASEO DEL PRADO #D-307 LAS VEGAS NV 89102-4342	13934410133
T & N INVESTMENTS L L C	2340 PASEO DEL PRADO #D-307 LAS VEGAS NV 89102-4342	13934410132
T L D T HOLDINGS L L C	9812 EAGLE ROCK CT LAS VEGAS NV 89117	13934410105
TAING HUOD S	339 PEACH ST #A MONTEREY PARK CA 91755-4406	13934312263
TAYLOR CARL LEE	303 ATLANTIC AVE #300 VA BEACH VA 23451-3645	13934312040
TAYLOR JIMMY D & RENEE D	BAILEY STANLEY & JUSTINE 4955 S E CASA DEL REY MILWAUKIE OR 97222-4786	13934312310
TEITEL SUSAN M	10067 STAMPEDE CANYON CT LAS VEGAS NV 89147-7221	13934810005
TEMRAZ YASAMAN	LALEHZADEH JONAS 9 MACARTHUR PL #N1509 SANTA ANA CA 92707	13934410106
TEMRAZ YASAMAN	LALEHZADEH JONAS 9 MACARTHUR PL #N1509 SANTA ANA CA 92707	13934410109
TEMRAZ YASAMAN	LALEHZADEH JONAS 9 MACARTHUR PL #N1509 SANTA ANA CA 92707	13934410108
TEMRAZ YASAMAN	LALEHZADEH JONAS 9 MACARTHUR PL #N1509 SANTA ANA CA 92707	13934410107
TERRY WILLIAM B	4564 S PECOS LAS VEGAS NV 89121-5923	13934710021
TERRY WILLIAM B	4564 S PECOS LAS VEGAS NV 89121-5923	13934710020
THREE CASTLES L L C	1137 S RANCHO DR #120 LAS VEGAS NV 89102	13934310069
TOWANDA L L C	4262 BLUE DIAMOND RD #102-325 LAS VEGAS NV 89139	13934410209
TRINAYSTICH CATHERINE	FITZGERALD WILLIAM 693 TYNE DALE CT LAS VEGAS NV 89123	13934410070
TRUSTEE CLARK COUNTY TREASURER	73387 WILLOW ST PALM DESERT CA 92260-5754	13934310060
TRUSTEE CLARK COUNTY TREASURER	73387 WILLOW ST PALM DESERT CA 92260-5754	13934310059
UNITED STATES MEXICO	330 S 4TH ST LAS VEGAS NV 89101-6004	13934401015
VAKNEEN MICHAEL	900 LAS VEGAS BLVD #815 LAS VEGAS NV 89101	13934411031
VALLES RAY	GODINEZ PEDRO F 12112 VISTA RANCH AVE SYLMAR CA 91342-5507	13934312300
VANASTEN MICHAEL G	N-169A ARROWHEAD RD FREMONT WI 54940	13934312211
VANDERWERKEN PAUL W & LESLIE H	522 S 7TH ST LAS VEGAS NV 89101-6904	13934710022
VENTAROSA EQUITY GROUP	900 S LAS VEGAS BLVD #1007 LAS VEGAS NV 89101-6860	13934411094
VITALE CHRISTIAN	2877 PARADIESE RD #1004 LAS VEGAS NV 89109	13934411112

Report of All Selected Parcels**Case Number:**

SUP-67489

Printed On: Thu: November 3, 2016

<u>Owner</u>	<u>Address</u>	<u>Parcel Number</u>
VITALE CHRISTIAN	2877 PARADISE RD #1004 LAS VEGAS NV 89109	13934411046
VITALE GILLES	2877 PARADISE RD #1004 LAS VEGAS NV 89109	13934411020
VITALE GILLES	2877 PARADISE RD #1004 LAS VEGAS NV 89109	13934411100
VITALE GILLES	2877 PARADISE RD #1004 LAS VEGAS NV 89109	13934411066
VITALE GILLES	2877 PARADISE RD #1004 LAS VEGAS NV 89109	13934312136
WALKER FRED R TRUST	WALKER FRED R TRS 5240 ACGUA LN PAHRUMP NV 89061-7037	13934810024
WALLACE 2014 TRUST	WALLACE DAVID M & NADIA M TRS 900 S LAS VEGAS BLVD #1011 LAS VEGAS NV 89101	13934411059
WATKINS JOHN G & BARBARA A	6217 LORILLE LN LAS VEGAS NV 89108-5222	13934410195
WAWERNA JOHN	GIUNTA ROBERT G 881 SHIRLEY LN BOULDER CITY NV 89005-3617	13934310071
WAWERNA JOHN C	614 S 6TH ST LAS VEGAS NV 89101-6920	13934410183
WAYWARD PROPERTIES INC	228 SOUTH 4TH ST #100 LAS VEGAS NV 89101-5709	13934710024
WEIDNER HOLDINGS L L C	3575 W POST RD LAS VEGAS NV 89118-3867	13934411117
WEISBART FAMILY PROPERTIES L L C	3160 W SAHARA AVE #A-22 LAS VEGAS NV 89102	13934410071
WEISBART FAMILY PROPERTIES L L C	3160 W SAHARA AVE #A-22 LAS VEGAS NV 89102	13934310043
WEISBART FAMILY PROPERTIES L L C	3160 W SAHARA AVE #A-22 LAS VEGAS NV 89102	13934410113
WEISBART FAMILY PROPERTIES L L C	3160 W SAHARA AVE #A-22 LAS VEGAS NV 89102	13934310044
WEISS MICHAEL B	2980 LAKE PLACID LN NORTHBROOK IL 60062-4331	13934312252
WELEBIR MATTHEW D FAMILY PROTECT	WELEBIR METTHEW D TRS 900 S LAS VEGAS BLVD #913 LAS VEGAS NV 89101	13934411045
WESTWIND TRUST	TINGEY DON C & JUDITH W TRS 2714 S WESTWIND RD LAS VEGAS NV 89146-5458	13934310049
WESTWIND TRUST	TINGEY DON C & JUDITH W TRS 2714 WESTWIND RD LAS VEGAS NV 89146-5458	13934310050
WESTWIND TRUST	TINGEY DON C & JUDITH W TRS 2714 S WESTWIND RD LAS VEGAS NV 89146-5458	13934310048
WHITESIDE JOHN M III REV LIV TR	WHITESIDE JOHN MARION III TRS 900 LAS VEGAS BLVD S #1410 LAS VEGAS NV 89101	13934411106
WILDFIELD CO REVOCABLE	CONESH SHIMON & KRISTINA TRS 615 S 6TH ST LAS VEGAS NV 89101	13934410220
WOLFSON MEDICAL CTR DOWNTOWN LLC	921 S LAS VEGAS BLVD LAS VEGAS NV 89101	13934410169
WOLFSON MEDICAL CTR DOWNTOWN LLC	921 S LAS VEGAS BLVD LAS VEGAS NV 89101	13934410168
WOLFSON MEDICAL CTR DOWNTOWN LLC	921 S LAS VEGAS BLVD LAS VEGAS NV 89101	13934410167
WOLFSON MEDICAL CTR DOWNTOWN LLC	921 S LAS VEGAS BLVD LAS VEGAS NV 89101	13934410200
WYATT ANDREW J	900 LAS VEGAS BLVD S #708 LAS VEGAS NV 89101-6848	13934411008
YOM KI	2534 PLAZA DEL AMO TORRANCE CA 90503-7366	13934411005
YOU ME L L C	3900 PARADISE RD #121 LAS VEGAS NV 89169	13934411065
YOU ME L L C	3900 PARADISE RD #121 LAS VEGAS NV 89169	13934411080
YOU ME L L C	3900 PARADISE RD #121 LAS VEGAS NV 89169	13934411086

Report of All Selected Parcels**Case Number:**

SUP-67489

Printed On: Thu: November 3, 2016**Owner**

YOU ME L L C

YOUNGBLOOD STEPHANIE J

Z VEGAS HOLDINGS L L C

Z-VEGAS HOLDINGS L L C

Z-VEGAS HOLDINGS L L C

Z-VEGAS HOLDINGS L L C

Address

3900 PARADISE RD #121 LAS VEGAS NV 89169

1905 CALLE DE VEGA LAS VEGAS NV 89102-4015

1500 BROADWAY 24TH FLOOR NEW YORK NY 10036

%TAMARES REAL ESTATE 1500 BROADWAY #2400 NEW YORK NY 10036

%TAMARES REAL ESTATE 1500 BROADWAY 24TH FLR NEW YORK NY 10036

1500 BROADWAY 24TH PL NEW YORK NY 10036

Parcel Numbe

13934411096

13934410208

13934411022

13934411014

13934411105

13934411070