

City of Las Vegas
Department of Planning
Development Services Center
333 North Rancho Drive, 3rd Floor
Las Vegas, Nevada 89106

5. v
PRSR
FIRST CLASS MAIL
U.S. Postage
PAID
Las Vegas, NV
Permit No. 1630

Return Service Requested
Official Notice of Public Hearing

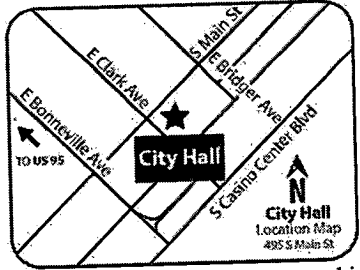

If you wish to file your protest or support on this request, check the appropriate box below and return this card in an envelope with postage to the Department of Planning at the address listed above, fax this side of this card to (702) 464-7499. If you would like to contact your Council Representative, please call (702) 229-6405.

I SUPPORT
this Request

I OPPOSE
this Request

Please use available blank space on card for your comments.
SUP-64483 [PRJ-64427]
Planning Commission Meeting of 6/14/2016

//

Application Information

SUP-64483 - SPECIAL USE PERMIT - PUBLIC HEARING - APPLICANT: BOULEVARD MEDICAL, LLC - OWNER: FLORESTA INC. - For possible action on a request for a Special Use Permit FOR A PROPOSED 1,960 SQUARE-FOOT MEDICAL MARIJUANA PRODUCTION FACILITY WITH A WAIVER TO ALLOW THE MEDICAL MARIJUANA PRODUCTION USE UNDER THE SAME ROOF AS ANOTHER USE at 3070 Sirius Avenue, Suite #103 (APN 162-08-303-032), M (Industrial) Zone, Ward 1 (Tarkanian) [PRJ-64427].

Application Location

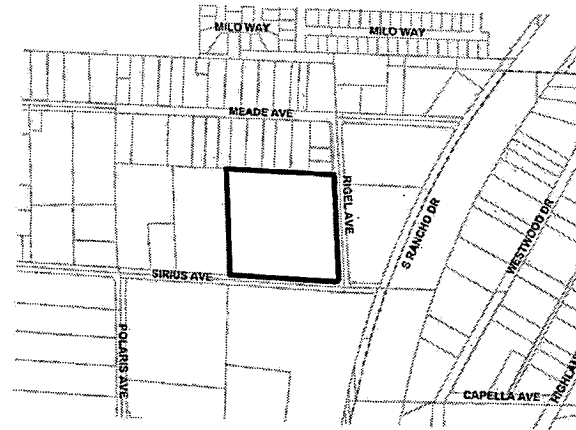

The proposed project may not pertain to the entire highlighted project site.

Public Hearing Information

Meeting: Planning Commission
Date: June 14, 2016
Time: 6:00 P.M.
Location: City Council Chambers
495 South Main Street, 2nd Floor
Las Vegas, Nevada 89101

Any and all interested persons may appear before the City Planning Commission either in person or by representative and object to or express approval of this request; or may, prior to this meeting, file a written objection thereto or approval thereof with the Department of Planning, Development Services Center, 333 North Rancho Drive, 3rd Floor, Las Vegas, Nevada 89106. Final Action on General Plan Amendments and Rezoning will be determined by the City Council. Other public hearing items may be deemed Final Action by the Planning Commission or forwarded to the City Council. The date of the City Council meeting, if applicable, will be announced at the Planning Commission meeting after the discussion of the item. For further information, including the full staff report, please call (702) 229-6301 (TTY 7-1-1) or go to <http://www.lasvegasnevada.gov>. Note that postcards and comments received after an agenda posts will not be reflected online until after the meeting; however, the comments are made available to the members of the governing body for their consideration prior to the meeting.

Report of All Selected Parcels**Case Number:**

SUP-64483

Printed On: Tue: June 7, 2016

<u>Owner</u>	<u>Address</u>	<u>Parcel Number</u>
2953 WESTWOOD LAS VEGAS L L C	10951 SORRENTO VALLEY RD #2A SAN DIEGO CA 92121	16208703002
3100 MEAD L L C	3100 MEADE AVE LAS VEGAS NV 89102-7892	16208301019
3100 MEAD L L C	3100 MEAD AVE LAS VEGAS NV 89102-7892	16208301023
3100 MEAD L L C	3100 MEAD AVE LAS VEGAS NV 89102-7892	16208201005
A M FALSAFI L L C	39 PRINCEVILLE LN LAS VEGAS NV 89113	16208302014
ACCESS BARGAIN STORAGE L L C	1331 N W LOVEJOY ST #755 PORTLAND OR 97209	16208802001
ALDABBAGH OMAR ENTERPRISE L P	2025 REDBIRD DR LAS VEGAS NV 89134-6159	16208804004
AMELCO INC	26236 ENTERPRISE CT LAKE FOREST CA 92630-8405	16208704006
ANTIQUÉ EMPORIUM	P O BOX 27856 LAS VEGAS NV 89126-1856	16217110006
ANTOKU D J & M V REV LIV TR ETAL	ANTOKU TIMOTHY TAKASHI & CAROL A 2020 CLEMENT ST HONOLULU HI 96822	16208303029
ARANA MARISELA S	2821 SULTANA ST LAS VEGAS NV 89102-5978	16208211035
B M S D PROPERTIES L L C	5113 N TOMSIK ST LAS VEGAS NV 89149	16208303013
BARBOUR DESIREE A	2832 NORTHAM ST LAS VEGAS NV 89102-0130	16208210024
BLACKACRE PROPERTIES L L C SERIE	3878 W OQUENDO RD LAS VEGAS NV 89118-3009	16208703012
BORLASE/KNAUFF L L C	3120 MEADE AVE LAS VEGAS NV 89102-7892	16208301018
BUNCH FAMILY TRUST	BUNCH GERARD & TRACY TRS 3013 MILO WAY LAS VEGAS NV 89102-5983	16208211031
CELESTINO-VIEYRA JULIO ALDOLFO	MANRIQUEZ FLOR 2809 SULTANA ST LAS VEGAS NV 89102-5978	16208211038
CENTRAL TELEPHONE CO	P O BOX 7909 OVERLAND PARK KS 66207-0909	16217103002
CHEN YING	12440 HAZELTINE DR TUSTIN CA 94520	16208212013
CHRISTIANIA L L C	3300 W DESERT INN RD LAS VEGAS NV 89102	16208401006
CHRISTIENSEN J D & D REV LIV TR	CHRISTIENSEN JACK D & DEE A TRS P O BOX 27710 LAS VEGAS NV 89126-1710	16208301005
CHRISTIENSEN JACK & D REV LIV TR	P O BOX 27710 LAS VEGAS NV 89126-1710	16208301004
CHUNG ENTERPRISES L P	25 KEARNY ST #302 SAN FRANCISCO CA 94108-5515	16208401014
CLEMENS FAMILY TRUST	CLEMENS JANICE JOY TRS P O BOX 80927 LAS VEGAS NV 89180-0927	16208803002
CLINE KENNETH L & MARILYN D	CLINE KENNETH L & MARILYN REV TR 4090 DEERFIELD AVE LAS VEGAS NV 89147	16208303002
CLUKA TYLOR M	2825 NORTHAM ST LAS VEGAS NV 89102-5986	16208210027
COUNTY OF CLARK(PUBLIC WORKS)	500 S GRAND CENTRAL PKWY LAS VEGAS NV 89155	16217110005
CRAB HOLDINGS L L C	2756 N GREEN VALLEY PKWY #197 HENDERSON NV 89014	16208301013
CRAB HOLDINGS L L C	2756 N GREEN VALLEY PKWY #197 HENDERSON NV 89014	16208301014
CREIGH C T TR MARITAL INCOME TR	CREIGH JEWELL C TRS 1325 N RADWICK DR LAS VEGAS NV 89110-2025	16208704008
CROMER GEORGE A FAMILY TRUST	CROMER JAMES & GEORGE E CO-TRS P O BOX 1747 TEMPLETON CA 93465	16208703009
CROMER GEORGE A FAMILY TRUST	CROMER JAMES & GEORGE E CO-TRS P O BOX 1747 TEMPLETON CA 93465	16208703010

Report of All Selected Parcels**Case Number:**

SUP-64483

Printed On: Tue: June 7, 2016

<u>Owner</u>	<u>Address</u>	<u>Parcel Number</u>
CROMER GEORGE A FAMILY TRUST	CROMER JAMES & GEORGE E CO-TRS P O BOX 1747 TEMPLETON CA 93465	16208703011
D M S INVESTMENTS L L C	3131 S HIGHLAND DR #A LAS VEGAS NV 89109-5411	16208804001
DALEY JEANETTE TRUST	DALEY JEANETTE TRS 1501 TEN PALMS CT LAS VEGAS NV 89117-1478	16208210031
DIAZ ROBERTO ZAMORA	2825 SULTANA ST LAS VEGAS NV 89102	16208211034
DICKINSON ROBIN SEP PPTY TR	DICKINSON ROBIN TRS 3131 MEADE AVE LAS VEGAS NV 89102	16208303011
DUR MAY INVESTMENTS L L C	P O BOX 28639 LAS VEGAS NV 89126-2639	16208301022
EDEN LAS VEGAS L L C	299 PARK AVE 42ND FL NEW YORK NY 10171-4299	16208701005
EDEN LAS VEGAS L L C	299 PARK AVE 42ND FL NEW YORK NY 10171-4299	16208603001
EDEN LAS VEGAS L L C	299 PARK AVE 42ND FL NEW YORK NY 10171-4299	16208603002
ELIZARRARAZ CATHERINE	2805 NORTHAM ST LAS VEGAS NV 89102-5986	16208210032
ELIZARRARAZ CATHERINE E	2805 NORTHAM ST LAS VEGAS NV 89102-5986	16208210033
EQUUS BUSINESS CENTER L P	4755 DEAN MARTIN DR LAS VEGAS NV 89103	16208413001
EQUUS BUSINESS CENTER L P	4755 DEAN MARTIN DR LAS VEGAS NV 89103	16208411003
EQUUS BUSINESS CENTER L P	4755 DEAN MARTIN DR LAS VEGAS NV 89103	16208414001
EQUUS BUSINESS CENTER L P	4755 DEAN MARTIN DR LAS VEGAS NV 89103	16208417001
EQUUS BUSINESS CENTER L P	4755 DEAN MARTIN DR LAS VEGAS NV 89103	16208412004
EQUUS BUSINESS CENTER L P	4755 DEAN MARTIN DR LAS VEGAS NV 89103	16208416004
EQUUS BUSINESS CENTER L P	4755 DEAN MARTIN DR LAS VEGAS NV 89103	16208415004
ESPINOZA JOSE & MARTIN	GARCIA LIDUVINA 2813 SULTANA ST LAS VEGAS NV 89102-5978	16208211037
ESSEX I L L C	2150 E HIGHLAND AVE #207 PHOENIX AZ 85016-4721	16217110039
FAN ELLEN L	3421 CARBURY CT LAS VEGAS NV 89129	16208210015
FISHER BROTHERS LAS VEGAS L L C	299 PARK AVE 42ND FL NEW YORK NY 10171-4299	16208303017
FISHER BROTHERS LAS VEGAS L L C	299 PARK AVE 42ND FL NEW YORK NY 10171-4299	16208701003
FISHER BROTHERS LAS VEGAS L L C	299 PARK AVE 42ND FL NEW YORK NY 10171-4299	16208701002
FISHER BROTHERS LAS VEGAS L L C	299 PARK AVE 42ND FL NEW YORK NY 10171-4299	16208303016
FISHER BROTHERS LAS VEGAS L L C	299 PARK AVE 42ND FL NEW YORK NY 10171-4299	16208702002
FISHER BROTHERS LAS VEGAS L L C	299 PARK AVE 42ND FL NEW YORK NY 10171-4299	16208303033
FISHER BROTHERS LAS VEGAS L L C	299 PARK AVE 42ND FL NEW YORK NY 10171-4299	16208303018
FISHER BROTHERS LAS VEGAS L L C	299 PARK AVE 42ND FL NEW YORK NY 10171-4299	16208303015
FISHER BROTHERS LAS VEGAS L L C	299 PARK AVE 42ND FL NEW YORK NY 10171-4299	16208702001
FISHER BROTHERS LAS VEGAS L L C	299 PARK AVE 42ND FL NEW YORK NY 10171-4299	16208701001
FREIM ELIAS D & MARIE LOUISE	3095 S HIGHLAND DR LAS VEGAS NV 89109-1048	16208705011

Report of All Selected Parcels**Case Number:**

SUP-64483

Printed On: Tue: June 7, 2016

<u>Owner</u>	<u>Address</u>	<u>Parcel Number</u>
GAGNON GUY FAMILY TRUST	GAGNON GUY OR DIANA J TRS 2108 WESTLUND DR LAS VEGAS NV 89102-2049	16208303012
GALBRAITH KENNETH F & JANE R	2817 SULTANA ST LAS VEGAS NV 89102-5978	16208211036
GRAY BERN HOLDINGS INC	P O BOX 660937 MD 3A-300 DALLAS TX 75266-0937	16208401001
GUTHRIE RONALD G	CORDELL TERRANCE A 3016 MILO WY LAS VEGAS NV 89102-5982	16208211029
HARSCH INVESTMENT PPTYS-NV L L C	P O BOX 2708 PORTLAND OR 97208-2708	16208401008
HARSCH INVESTMENT PPTYS-NV L L C	P O BOX 2708 PORTLAND OR 97208-2708	16208401009
HARSCH INVESTMENT PPTYS-NV L L C	P O BOX 2708 PORTLAND OR 97208-2708	16208401007
HERNANDEZ SILVIA	2708 NORTHAM ST LAS VEGAS NV 89102-5984	16208210014
HIGHLAND ASSOCIATES L L C	3271 S HIGHLAND DR #704 LAS VEGAS NV 89109-1051	16217501001
HIGHLAND ASSOCIATES L L C	3271 S HIGHLAND DR #704 LAS VEGAS NV 89109-1051	16208807002
HIGHLAND INDUSTRIAL PARK PTNRSHIP	2500 W SAHARA AVE #211 LAS VEGAS NV 89102-4393	16208604002
HIGHLAND PARTNERS L L C	3138 SERENA AVE CARPINTERIA CA 93013-3034	16208804005
HIGHLAND PARTNERS L L C	3138 SERENA AVE CARPINTERIA CA 93013-3034	16208804006
HOLLISTER PARTNERS L L C	510 WHITE COTTAGE RD S ANGWIN CA 94508	16208704005
INTEGRAL PTNRS PARK PL L V LLC	299 PARK AVE 42ND FL NEW YORK NY 10171-4299	16208418002
J D B C ENTERPRISES L L C	795 S 1080 E OREM UT 84097	16208301007
J D B C ENTERPRISES L L C	795 S 1080 E OREM UT 84097	16208301006
J X E INVESTMENT L L C	10569 PURDEY RD EDEN PRAIRIE MN 55347-5224	16208703004
J X E INVESTMENT L L C	10569 PURDEY RD EDEN PRAIRIE MN 55347	16208703003
JOHNSON C R B A TRUST	JOHNSON CHARLES R & BARBARA TRS 2405 GRASSY SPRING PL LAS VEGAS NV 89135-1543	16208410014
JOHNSON GARY M IRREVOCABLE TRUST	3163 S HIGHLAND DR LAS VEGAS NV 89109-1010	16208804002
JOHNSON GARY M IRREVOCABLE TRUST	3163 S HIGHLAND DR LAS VEGAS NV 89109-1010	16208804003
JONATHAN PARK L L C	6050 S FORT APACHE RD #200A LAS VEGAS NV 89148	16208303004
JONATHAN PARK L L C	6050 S FORT APACHE RD #200A LAS VEGAS NV 89148	16208303027
JONATHAN PARK L L C	6050 S FORT APACHE RD #200A LAS VEGAS NV 89148	16208303028
JOSEPHS FAMILY L P	5395 S POLARIS AVE LAS VEGAS NV 89118-2456	16208303019
KASSABIAN LARISSA	3220 WESTLEIGH AVE LAS VEGAS NV 89102-6121	16208211033
L D Y GROUP L L C	522 E TWAIN AVE LAS VEGAS NV 89169	16208302007
LA PLANTA L L C	3700 CAPELLA AVE LAS VEGAS NV 89102-8449	16208410006
LANDALE U S HOLDINGS L P	CROWN REAL ESTATE L P 3960 HOWARD HUGHES PKWY #150 LAS VEGAS NV 89169	16208303022
LANDALE U S HOLDINGS L P	CROWN REAL ESTATE L P 3960 HOWARD HUGHES PKWY #150 LAS VEGAS NV 89169	16208303020
LAS VEGAS MEADOWS LTD	11100 SANTA MONICA BLVD #1150 LOS ANGELES CA 90025	16208201003

Report of All Selected Parcels**Case Number:**

SUP-64483

Printed On: Tue: June 7, 2016

<u>Owner</u>	<u>Address</u>	<u>Parcel Numbe</u>
LEAVITT FAMILY TRUST	LEAVITT M LEONARD & DONNA J TRS 265 N HOLLYWOOD BLVD LAS VEGAS NV 89110	16208210023
LEAVITT MARY E & WILLIAM J JR	1701 GRIFFITH AVE LAS VEGAS NV 89104-3638	16208303026
LEAVITT MARY E & WILLIAM J JR	1701 GRIFFITH AVE LAS VEGAS NV 89104-3638	16208303023
LEAVITT MARY E & WILLIAM J JR	1701 GRIFFITH AVE LAS VEGAS NV 89104-3638	16208303025
LEAVITT WILLIAM J JR	P O BOX 43334 LAS VEGAS NV 89116	16208303024
LEE SIU CHING REVOCABLE LIV TR	LEE SIU CHING TR 2824 NORTHAM ST LAS VEGAS NV 89102-0130	16208210022
LI MING	5538 WELLAND AVE #3 TEMPLE CITY CA 91780	16208212012
LI QUINGHE	1755 29TH AVE SAN FRANCISCO CA 94122-4222	16208212015
LITTLE WOODS L L C	3130 WESTWOOD DR LAS VEGAS NV 89109-1067	16208803004
LOPEZ RAUDEL A	2804 RICHFIELD BLVD LAS VEGAS NV 89102-5971	16208212007
M B T L V 2014 L L C	50 GRAND MASTERS DR LAS VEGAS NV 89141	16208303010
M B T L V 2014 L L C	50 GRAND MASTERS DR LAS VEGAS NV 89141	16208303009
MAGUIRE JOHN P & ALICE A FAM TR	MAGUIRE JOHN P & ALICE A TRS 3021 MILO WY LAS VEGAS NV 89102-5983	16208210049
MARTIN ROBERT E & KAYE	1500 MARBELLA RIDGE CT LAS VEGAS NV 89117	16208703001
MARTIN ROBERT E & KAYE	1500 MARBELLA RIDGE CT LAS VEGAS NV 89117	16208301017
MARTIN ROBERT E & KAYE B	1500 MARBELLA RIDGE CT LAS VEGAS NV 89117	16208303008
MASIGLAT AGNES	4271 NORTHVALE DR HOUSTON TX 77014	16208210018
MEADE AVENUE PROF CTR L L C	3700 MEADE AVE LAS VEGAS NV 89102-7894	16208301003
MIGUEL FAMILY TRUST 1993 ETAL	BOLI PETER K & JILL CO-TRS 513 S MYRTLE AVE MONROVIA CA 91016	16208301002
MILLER MICHAEL W	2705 NORTHAM ST LAS VEGAS NV 89102-5985	16208210035
MINOLI MARGARITA REVOCABLE LIVIN	MINOLI MARGARITA TRS 2844 MILO WY LAS VEGAS NV 89102-5980	16208610057
MORTON VINCENETTE FAMILY TRUST	MORTON VINCENETTE TRS 2817 NORTHAM ST LAS VEGAS NV 89102-5986	16208210029
MURPHY SUSAN	2709 NORTHAM ST LAS VEGAS NV 89102-5985	16208210034
NEWPORT GENE W	6020 W OQUENDO RD LAS VEGAS NV 89118	16208703008
NICHOLL INVESTMENTS L L C	3701 SIRIUS AVE LAS VEGAS NV 89102	16208410005
NYCHI TRUST	3754 VIOLET ROSE CT LAS VEGAS NV 89147-7401	16208301021
NYCHI TRUST	3754 VIOLET ROSE CT LAS VEGAS NV 89147-7401	16208301020
P P B L L C	105 BUCKSHOT WAY CEDAR PARK tx 78613	16208302004
PARADISE LAS VEGAS L L C	299 PARK AVE NEW YORK NY 10171-0002	16208701004
PARADISE LAS VEGAS L L C	299 PARK AVE 42ND FL NEW YORK NY 10171-4299	16208701007
PARADISE LAS VEGAS L L C	299 PARK AVE NEW YORK NY 10171-0002	16208418003
PARADISE LAS VEGAS L L C	299 PARK AVE 42ND FL NEW YORK NY 10171-4299	16208603003

Report of All Selected Parcels**Case Number:**

SUP-64483

Printed On: Tue: June 7, 2016

<u>Owner</u>	<u>Address</u>	<u>Parcel Numbe</u>
PARAMOUNT INVESTMENTS CO	P O BOX 370261 LAS VEGAS NV 89137	16208303007
PARKER BRENDA	3017 PALM SPRINGS WY LAS VEGAS NV 89102-5967	16208211026
PEACH JOHN L L C	746 OAKMONT AVE #702 LAS VEGAS NV 89109	16208210016
PERKINS JONATHAN	HU CHRISTA 3015 KASHIWA ST TORRANCE CA 90505	16208211040
PU FAMILY TRUST	PU LAWRENCE & SHERRY TRS 9924 VERMILLION CLIFFS AVE LAS VEGAS NV 89147	16208210020
R & J EQUITIES L L C	5790 WYNN RD #2 LAS VEGAS NV 89118-3076	16208303005
R & S C RENTALS INC	3050 WESTWOOD DR #A-1 LAS VEGAS NV 89109-1040	16208704007
RAGA AMADOR M & MIRASOL F	6937 TRAILRIDE WY CITRUS HEIGHTS CA 95621-3323	16208210019
RAVESE GAYLE JOAN	3000 PALM SPRINGS WY LAS VEGAS NV 89102-5966	16208212005
RICCO PHYLLIS M	2800 MILO WY LAS VEGAS NV 89102-5980	16208610046
ROBINSON PAUL & GRACE	1690 HARDROCK ST LAS VEGAS NV 89156	16208210025
RODRIGUEZ RAUL	2821 NORTHAM ST LAS VEGAS NV 89102-5986	16208210028
RUSSELL-WARNER INC	P O BOX 74 GENOA NV 89411	16208301012
SANDOVAL RAMON	2813 NORTHAM ST LAS VEGAS NV 89102	16208210030
SCANSON MICHAEL & PEGGY	7705 VELVET MIST ST LAS VEGAS NV 89131	16208210017
SELBY ELIZABETH & DOUGLAS ALLEN	3017 W JAMESTOWN WY LAS VEGAS NV 89102-5923	16208211028
SERVE-IT L L C	3020 S VALLEY VIEW BLVD LAS VEGAS NV 89102-7805	16208302005
SHAFER FAMILY TRUST	SHAFER BERNARD A & ELIZABETH TRS 31 CRANBERRY COVE CT LAS VEGAS NV 89135	16208302009
SHERIDAN D J C L L C	500 CATADEL DR #140 COMMERCE CA 90040-1588	16208302021
SHERIDAN D J C L L C	500 CATADEL DR #140 COMMERCE CA 90040-1588	16208302016
SHEW WILLIAM	WONG EVENA 1130 GILMAN AVE SAN FRANCISCO CA 94124	16208211025
SOLARIO-RINCON JOSE ESTANISLAO	3004 PALM SPRINGS WAY LAS VEGAS NV 89102	16208211022
SOUTHERN N V RENTAL HOLDINGS	299 PARK AVE 42ND FL NEW YORK NY 10171-4299	16208610017
SOUTHERN N V RENTAL HOLDINGS LLC	229 PARK AVE 42ND FL NEW YORK NY 10171	16208610091
SOUTHERN N V RENTAL HOLDINGS LLC	299 PARK AVE 42ND FL NEW YORK NY 10171-4299	16208610038
SOUTHERN N V RENTAL HOLDINGS LLC	299 PARK AVE 42ND FLR NEW YORK NY 10171-4299	16208610010
SOUTHERN NEVADA RENTAL HOLDINGS	299 PARK AVE 42ND FL NEW YORK NY 10171-4299	16208610085
SOUTHERN NV RENTAL HOLDINGS	299 PARK AVE 42ND FLOOR NEW YORK NY 10171-4299	16208610026
SOUTHERN NV RENTAL HOLDINGS	299 PARK AVE 42ND FL NEW YORK NY 10171-4299	16208610086
SOUTHERN NV RENTAL HOLDINGS	299 PARK AVE 42ND FL NEW YORK NY 10171-4299	16208610060
SOUTHERN NV RENTAL HOLDINGS	299 PARK AVE 42ND FLR NEW YORK NY 10171-0002	16208610062
SOUTHERN NV RENTAL HOLDINGS	299 PARK AVE 42ND FL NEW YORK NY 10171-4299	16208610059

Report of All Selected Parcels**Case Number:**

SUP-64483

Printed On: Tue: June 7, 2016

<u>Owner</u>	<u>Address</u>	<u>Parcel Numbe</u>
SOUTHERN NV RENTAL HOLDINGS	299 PARK AVE 42ND FLR NEW YORK NY 10171-4299	16208212008
SOUTHERN NV RENTAL HOLDINGS	299 PARK AVE 42ND FLR NEW YORK NY 10171-0002	16208610050
SOUTHERN NV RENTAL HOLDINGS	299 PARK AVE 42ND FLR NEW YORK NY 10171-0002	16208610041
SOUTHERN NV RENTAL HOLDINGS	299 PARK AVE 42ND FL NEW YORK NY 10171-4299	16208610039
SOUTHERN NV RENTAL HOLDINGS	299 PARK AVE 42ND FLR NEW YORK NY 10171-0002	16208610031
SOUTHERN NV RENTAL HOLDINGS	299 PARK AVE 42ND FL NEW YORK NY 10171-4299	16208212014
SOUTHERN NV RENTAL HOLDINGS	299 PARK AVE 42ND FLR NEW YORK NY 10171-0002	16208610088
SOUTHERN NV RENTAL HOLDINGS	299 PARK AVE 42ND FLR NEW YORK NY 10171-4299	16208610052
SOUTHERN NV RENTAL HOLDINGS	299 PARK AVE 42ND FLR NEW YORK NY 10171-0002	16208610054
SOUTHERN NV RENTAL HOLDINGS	299 PARK AVE NEW YORK NY 10171-0002	16208610011
SOUTHERN NV RENTAL HOLDINGS LLC	299 PARK AVE 42ND FLOOR NEW YORK NY 10171-4299	16208212024
SOUTHERN NV RENTAL HOLDINGS LLC	299 PARK AVE 42ND FLR NEW YORK NY 10171-4299	16208610045
SOUTHERN NV RENTAL HOLDINGS LLC	299 PARK AVE 42ND FLR NEW YORK NY 10171-4299	16208610040
SOUTHERN NV RENTAL HOLDINGS LLC	299 PARK AVE 42ND FL NEW YORK NY 10171-4299	16208212011
SOUTHERN NV RENTAL HOLDINGS LLC	299 PARK AVE 42ND FLR NEW YORK NY 10171-4299	16208212020
SOUTHERN NV RENTAL HOLDINGS LLC	299 PARK AVE 42ND FL NEW YORK NY 10171-4299	16208212018
SOUTHERN NV RENTAL HOLDINGS LLC	299 PARK AVE 42ND FLR NEW YORK NY 10171-4299	16208610049
SOUTHERN NV RENTAL HOLDINGS LLC	299 PARK AVE 42ND FL NEW YORK NY 10171-4299	16208610035
SOUTHERN NV RENTAL HOLDINGS LLC	299 PARK AVE 42ND FLR NEW YORK NY 10171-4299	16208610075
SOUTHERN NV RENTAL HOLDINGS LLC	299 PARK AVE 42ND FLR NEW YORK NY 10171-4299	16208212019
SOUTHERN NV RENTAL HOLDINGS LLC	299 PARK AVE 42ND FL NEW YORK NY 10171-4299	16208610092
SOUTHERN NV RENTAL HOLDINGS LLC	299 PARK AVE 42ND FL NEW YORK NY 10171-4299	16208610034
SOUTHERN NV RENTAL HOLDINGS LLC	299 PARK AVE 42ND FL NEW YORK NY 10171-4299	16208212009
SOUTHERN NV RENTAL HOLDINGS LLC	299 PARK AVE 42ND FLR NEW YORK NY 10171-4299	16208610061
SOUTHERN NV RENTAL HOLDINGS LLC	299 PARK AVE 42ND FL NEW YORK NY 10171-4299	16208610042
SOUTHERN NV RENTAL HOLDINGS LLC	299 PARK AVE 42ND FL NEW YORK NY 10171-4299	16208610072
SOUTHERN NV RENTAL HOLDINGS LLC	299 PARK AVE 42ND FL NEW YORK NY 10171-4299	16208610014
SOUTHERN NV RENTAL HOLDINGS LLC	299 PARK AVE 42ND FLR NEW YORK NY 10171-4299	16208212023
SOUTHERN NV RENTAL HOLDINGS LLC	299 PARK AVE 42ND FL NEW YORK NY 10171-4299	16208610006
SOUTHERN NV RENTAL HOLDINGS LLC	299 PARK AVE 42ND FLR NEW YORK NY 10171-4299	16208610018
SOUTHERN NV RENTAL HOLDINGS LLC	299 PARK AVE 42ND FL NEW YORK NY 10171-4299	16208610036
SOUTHERN NV RENTAL HOLDINGS LLC	299 PARK AVE 42ND FLR NEW YORK NY 10171-4299	16208212021

Report of All Selected Parcels**Case Number:**

SUP-64483

Printed On: Tue: June 7, 2016

<u>Owner</u>	<u>Address</u>	<u>Parcel Numbe</u>
SOUTHERN NV RENTAL HOLDINGS LLC	299 PARK AVE 42ND FL NEW YORK NY 10171-4299	16208610002
SOUTHERN NV RENTAL HOLDINGS LLC	299 PARK AVE 42ND FLR NEW YORK NY 10171-4299	16208610007
SOUTHERN NV RENTAL HOLDINGS LLC	299 PARK AVE 42ND FL NEW YORK NY 10171-4299	16208610068
SOUTHERN NV RENTAL HOLDINGS LLC	299 PARK AVE 42ND FLR NEW YORK NY 10171-4299	16208610069
SOUTHERN NV RENTAL HOLDINGS LLC	299 PARK AVE 42ND FL NEW YORK NY 10171-4299	16208610016
SOUTHERN NV RENTAL HOLDINGS LLC	299 PARK AVE 42ND FL NEW YORK NY 10171-4299	16208610033
SOUTHERN NV RENTAL HOLDINGS LLC	299 PARK AVE 42ND FLR NEW YORK NY 10171-4299	16208610051
SOUTHERN NV RENTAL HOLDINGS LLC	299 PARK AVE 42ND FLR NEW YORK NY 10171-4299	16208212016
SOUTHERN NV RENTAL HOLDINGS LLC	299 PARK AVE 42ND FLR NEW YORK NY 10171-4299	16208610005
SOUTHERN NV RENTAL HOLDINGS LLC	299 PARK AVE 42ND FLR NEW YORK NY 10171-4299	16208212027
SOUTHERN NV RENTAL HOLDINGS LLC	299 PARK AVE 42ND FL NEW YORK NY 10171-4299	16208610019
SOUTHERN NV RENTAL HOLDINGS LLC	299 PARK AVE 42ND FLR NEW YORK NY 10171-4299	16208610073
SOUTHERN NV RENTAL HOLDINGS LLC	299 PARK AVE 42ND FL NEW YORK NY 10171-4299	16208610009
SOUTHERN NV RENTAL HOLDINGS LLC	299 PARK AVE 42ND FL NEW YORK NY 10171-4299	16208610029
SOUTHERN NV RENTAL HOLDINGS LLC	299 PARK AVE NEW YORK NY 10171-0002	16208610032
SOUTHERN NV RENTAL HOLDINGS LLC	299 PARK AVE 42ND FL NEW YORK NY 10171-4299	16208610047
SOUTHERN NV RENTAL HOLDINGS LLC	299 PARK AVE 42ND FL NEW YORK NY 10171-4299	16208610013
SOUTHERN NV RENTAL HOLDINGS LLC	299 PARK AVE 42ND FL NEW YORK NY 10171-4299	16208610048
SOUTHERN NV RENTAL HOLDINGS LLC	299 PARK AVE 42ND FLR NEW YORK NY 10171-4299	16208610070
SOUTHERN NV RENTAL HOLDINGS LLC	299 PARK AVE 42ND FL NEW YORK NY 10171-4299	16208610024
SOUTHERN NV RENTAL HOLDINGS LLC	299 PARK AVE 42ND FLR NEW YORK NY 10171-4299	16208610004
SOUTHERN NV RENTAL HOLDINGS LLC	299 PARK AVE 42ND FL NEW YORK NY 10171-4299	16208610015
SOUTHERN NV RENTAL HOLDINGS LLC	299 PARK AVE 42ND FL NEW YORK NY 10171-4299	16208212017
SOUTHERN NV RENTAL HOLDINGS LLC	299 PARK AVE 42ND FL NEW YORK NY 10171-4299	16208610066
SOUTHERN NV RENTAL HOLDINGS LLC	299 PARK AVE 42ND FL NEW YORK NY 10171-4299	16208610065
SOUTHERN NV RENTAL HOLDINGS LLC	299 PARK AVE 42ND FL NEW YORK NY 10171-4299	16208610008
SOUTHERN NV RENTAL HOLDINGS LLC	299 PARK AVE 42ND FL NEW YORK NY 10171-4299	16208212025
SOUTHERN NV RENTAL HOLDINGS LLC	299 PARK AVE 42ND FL NEW YORK NY 10171-4299	16208610003
SOUTHERN NV RENTAL HOLDINGS LLC	299 PARK AVE 42ND FL NEW YORK NY 10171-4299	16208610021
SOUTHERN NV RENTAL HOLDINGS LLC	299 PARK AVE 42ND FLR NEW YORK NY 10171-4299	16208610028
SOUTHERN NV RENTAL HOLDINGS LLC	299 PARK AVE 42FLR NEW YORK NY 10171-4299	16208610022
SOUTHERN NV RENTAL HOLDINGS LLC	299 PARK AVE 42ND FL NEW YORK NY 10171-4299	16208610037

Report of All Selected Parcels**Case Number:**

SUP-64483

Printed On: Tue: June 7, 2016

<u>Owner</u>	<u>Address</u>	<u>Parcel Number</u>
SOUTHERN NV RENTAL HOLDINGS LLC	299 PARK AVE 42ND FLR NEW YORK NY 10171-4299	16208212022
SOUTHERN NV RENTAL HOLDINGS LLC	299 PARK AVE 42ND FL NEW YORK NY 10171-4299	16208610055
SOUTHERN NV RENTAL HOLDINGS LLC	299 PARK AVE 42ND FL NEW YORK NY 10171-4299	16208610025
SOUTHERN NV RENTAL HOLDINGS LLC	299 PARK AVE 42ND FL NEW YORK NY 10171-4299	16208610074
SOUTHERN NV RENTAL HOLDINGS LLC	299 PARK AVE 42ND FLR NEW YORK NY 10171-4299	16208212026
SOUTHERN NV RENTAL HOLDINGS LLC	299 PARK AVE 42ND FL NEW YORK NY 10171-4299	16208610012
SOUTHERN NV RENTAL HOLDINGS LLC	299 PARK AVE 42ND FL NEW YORK NY 10171-4299	16208610053
SOUTHERN NV RENTAL HOLDINGS LLC	299 PARK AVE 42ND FLR NEW YORK NY 10171-4299	16208610044
SOUTHERN NV RENTAL HOLDINGS LLC	299 PARK AVE NEW YORK NY 10171-0002	16208610020
SOUTHERN NV RENTAL HOLDINGS LLC	299 PARK AVE 42ND FLR NEW YORK NY 10171-4299	16208610056
SOUTHERN NV RENTAL HOLDINGS LLC	299 PARK AVE 42ND FLR NEW YORK NY 10171-4299	16208610089
SOUTHERN NV RENTAL HOLDINGS LLC	299 PARK AVE 42ND FL NEW YORK NY 10171-4299	16208610030
SOUTHERN NV RENTAL HOLDINGS LLC	299 PARK AVE 42ND FL NEW YORK NY 10171-4299	16208212010
SOUTHERN NV RENTAL HOLDINGS LLC	299 PARK AVE 42ND FL NEW YORK NY 10171-4299	16208610090
SOUTHERN NV RENTAL HOLDINGS LLC	299 PARK AVE 42ND FLR NEW YORK NY 10171-4299	16208610067
SOUTHERN NV RENTAL HOLDINGS LLC	299 PARK AVE 42ND FL NEW YORK NY 10171-4299	16208610027
SOUTHERN NV RENTAL HOLDINGS LLC	299 PARK AVE 42ND FL NEW YORK NY 10171-4299	16208610087
SOUTHERN NV RENTAL HOLDINGS LLC	299 PARK AVE 42ND FLR NEW YORK NY 10171-4299	16208610023
SOUTHERN NV RENTAL HOLDINGS LLC	299 PARK AVE 42ND FLR NEW YORK NY 10171-4299	16208610064
SOUTHERN NV RENTAL HOLDINGS LLC	299 PARK AVE 42ND FLR NEW YORK NY 10171-4299	16208610063
SOUTHERN NV RENTAL HOLDINGS LLC	299 PARK AVE 42ND FLR NEW YORK NY 10171-4299	16208610043
SOUTHERN NV RENTAL HOLDINGS LLC	299 PARK AVE 42ND FL NEW YORK NY 10171-4299	16208610058
SPILSBURY J & M INVEST CO	2448 W VALLEY VIEW HURRICANE UT 84737-3028	16208802003
STATEWOOD L L C	3163 S HIGHLAND LAS VEGAS NV 89109-1010	16208803001
STEVENS FAMILY TRUST	WILLIAMS FAMILY TRUST 1007 CALLE DE ALCALA ESCONDIDO CA 92025-7671	16208211024
STEWART JEFFREY & J FAMILY TR	STEWART JEFFERY D & JULIE 51 E ADAM LN WASHINGTON UT 84780-2443	16208802002
STORAGE WORKS II L L C	2922 RED ARROW DR LAS VEGAS NV 89135	16208704003
STORE-N-LOCK	2181 E FOOTHILL BLVD #105 PASADENA CA 91107-6825	16208303006
STORE-N-LOCK	2181 E FOOTHILL BLVD #105 PASADENA CA 91107-6825	16208303030
STORE-N-LOCK	565 BONITA AVE SAN MARINO CA 91108-1304	16208303021
TAHOE MEADE L L C	10940 WILSHIRE BLVD #600 LOS ANGELES CA 90024	16208301009
TAHOE MEADE L L C	10940 WILSHIRE BLVD #600 LOS ANGELES CA 90024	16208301010

Report of All Selected Parcels**Case Number:**

SUP-64483

Printed On: Tue: June 7, 2016

<u>Owner</u>	<u>Address</u>	<u>Parcel Numbe</u>
TAHOE MEADE L L C	3300 MEADE AVE #A LAS VEGAS NV 89102-0749	16208301008
TAOS LAND COMPANY LLC	299 PARK AVE 42ND FL NEW YORK NY 10171-4299	16208701008
TASHJIAN SAM & R 2001 LIV TR	TASHJIAN SAM & REGINA TRS 8001 RYANS REEF LN LAS VEGAS NV 89128-6886	16208303001
THRIVING L L C	3125 HIGHLAND DR LAS VEGAS NV 89109	16208705012
TRAN CHRISTOPHER	3009 MILO WY LAS VEGAS NV 89102-5983	16208211032
TUFFLI COMPANY INC	2780 SKYPARK DR #410 TORRANCE CA 90505	16208703007
TUFFLI COMPANY INC	2780 SKYPARK DR #410 TORRANCE CA 90505	16208703006
TUFFLI COMPANY INC	2780 SKYPARK DR #410 TORRANCE CA 90505	16208703005
UNION ACQUISITION INC	5560 S FORT APACHE RD #100 LAS VEGAS NV 89148	16208303003
USAITIS STEVE	782 COLONIAL RD DURANGO CO 81303-6461	16208301011
VALLONE RONALD & ANN TRUST	VALLONE RONALD C & ANN C TRS 108 TWIN OAK CT MYRTLE BEACH SC 29572	16208302011
VIPER LAND & INVESTMENTS L L C	850 S BOULDER HWY #444 HENDERSON NV 89015	16208301016
VIPER LAND & INVESTMENTS L L C	850 S BOULDER HWY #444 HENDERSON NV 89015	16208301015
VOTAW WILLIAM W	2820 NORTHAM ST LAS VEGAS NV 89102-0130	16208210021
VOYAGE INVESTMENT L L C	611 MANZANTA AVE SIERRA MADRE CA 91024-2217	16208211023
W W LAND L L C	3130 WESTWOOD DR LAS VEGAS NV 89109-1067	16208803003
WANG JIE	LI QIAN QIAN 9237 LA ROSA DR TEMPLE CITY CA 91780	16208610071
WANG SONGBIN	3016 JAMESTOWN WAY LAS VEGAS NV 89102-5909	16208211027
WAREHOUSE PROPERTIES	4801 W BELL DR LAS VEGAS NV 89118	16208303031
WESTWOOD STORAGE L L C	1469 MIDNIGHT COWBOY CT LAS VEGAS NV 89110	16208704004
WHITE FRANCIS A II & JENNIFER E	3017 MILO WY LAS VEGAS NV 89102-5983	16208211030
WINTER TRUST	4218 RIMCREST RD LAS VEGAS NV 89121	16208212006
WYANDOTTE HOLDINGS L L C	299 PARK AVE 42ND FL NEW YORK NY 10171-4299	16208610104
WYANDOTTE HOLDINGS L L C	299 PARK AVE 42ND FL NEW YORK NY 10171-4299	16208602003
YATES BUDDY D PROPERTIES L L C	3711 W SIRIUS LAS VEGAS NV 89102-8315	16208410007
YOUNG C & E 1985 LIV TR SURV TR	8160 OBANNON DR LAS VEGAS NV 89117-1920	16208303014
ZHENG BO	P O BOX 30305 LAS VEGAS NV 89173-0305	16208211039