

City of Las Vegas
Department of Planning
Development Services Center
333 North Rancho Drive, 3rd Floor
Las Vegas, Nevada 89106

Return Service Requested
Official Notice of Public Hearing

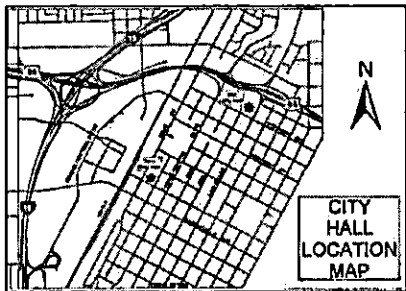

If you wish to file your protest or support on this request, check the appropriate box below and return this card in an envelope with postage to the Department of Planning at the address listed above, fax this side of this card to (702) 464-7499 or make your comments at www.lasvegasnevada.gov. If you would like to contact your Council Representative, please call (702) 229-6405.

I SUPPORT
this Request

I OPPOSE
this Request

Please use available blank space on card for your comments.

SUP-61064 [PRJ-60934]

Planning Commission Meeting of 10/13/2015

Application Information

SUP-61064 - SPECIAL USE PERMIT - PUBLIC HEARING - APPLICANT: DIAMOND AUTO SALES - OWNER: RAMIREZ RUBIO, LLC - For possible action on a request for a Special Use Permit FOR A PROPOSED MOTOR VEHICLE SALES (USED) USE WITH A WAIVER TO ALLOW 10,478 SQUARE FEET OF AREA DEDICATED TO THE USE WHERE 25,000 SQUARE FEET IS THE MINIMUM REQUIRED at 1385 North Nellis Boulevard (APN 140-29-601-001), C-2 (General Commercial) Zone, Ward 3 (Coffin) [PRJ-60934].

Application Location

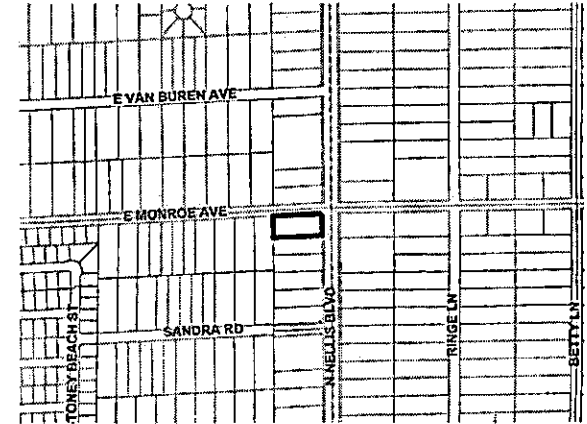

The proposed project may not pertain to the entire highlighted project site.

Public Hearing Information

Meeting: Planning Commission
Date: *October 13, 2015*
Time: 6:00 P.M.
Location: City Council Chambers
495 South Main Street, 2nd Floor
Las Vegas, Nevada 89101

Any and all interested persons may appear before the City Planning Commission either in person or by representative and object to or express approval of this request; or may, prior to this meeting, file a written objection thereto or approval thereof with the Department of Planning, Development Services Center, 333 North Rancho Drive, 3rd Floor, Las Vegas, Nevada 89106. Final Action on General Plan Amendments and Rezonings will be determined by the City Council. Other public hearing items may be deemed Final Action by the Planning Commission or forwarded to the City Council. The date of the City Council meeting, if applicable, will be announced at the Planning Commission meeting after the discussion of the item. For further information, including the full staff report, please call (702) 229-6301 (TDD 386-9108) or go to <http://www.lasvegasnevada.gov>.

Report of All Selected Parcels**Case Number:**

SUP-61064

Printed On: Mon: August 31, 2015

<u>Owner</u>	<u>Address</u>	<u>Parcel Numbe</u>
ALCARAZ MARIANA	1315 RINGE LN LAS VEGAS NV 89110-1604	14028210020
ANAYA ANNA L	4917 E MONROE AVE LAS VEGAS NV 89110-1586	14029612001
ANDERSON DE VON FAMILY TRUST	ANDERSON DE VON TRS 4971 SANDRA RD LAS VEGAS NV 89110-1519	14029612028
ARELLANO SERGIO	1394 N NELLIS BLVD LAS VEGAS NV 89110-5337	14028210025
ARELLANO SERGIO	1394 N NELLIS BLVD LAS VEGAS NV 89110-5337	14028210001
BARLOW GORDON L & LOUISE R	789 ROSSMORE DR LAS VEGAS NV 89110-4124	14028110008
BARLDW RAMON O & YOREL H FAMILY	BARLOW YOREL H TRS 789 ROSSMORE DR LAS VEGAS NV 89110-4124	14028110007
BARLOW RAMON O & YOREL H FAMILY	BARLOW YOREL H TRS 789 ROSSMORE DR LAS VEGAS NV 89110-4124	14028110009
BARLOW RAMON O & YOREL H FAMILY	BARLOW YOREL H TRS 789 RDSSMDRE DR LAS VEGAS NV 89110-4124	14028110018
BARNETT FAMILY TRUST	BARNETT JOHN L & NINA TRS 4958 E VAN BUREN AVE LAS VEGAS NV 89110-1561	14029510035
BARRAGAN-SILVA BLADIMIR	MCKNIGHT JANET H 4918 E MONROE AVE LAS VEGAS NV 89110-1584	14029510090
BARTSAS MARY 12 L L C	601 S RANCHO DR #C23 LAS VEGAS NV 89106-4825	14028210029
BARTSAS MARY 12 L L C	601 S RANCHO DR #C23 LAS VEGAS NV 89106-4825	14028210003
BARTSAS MARY 12 L L C	601 S RANCHO DR #C23 LAS VEGAS NV 89106-4825	14028210002
BASCOS LINDA L REVOCABLE LIV TR	BASCOS LINDA L TRS 8801 SCENIC HARBOR DR LAS VEGAS NV 89117-2295	14028110006
BELLER HELEN	4941 E MONROE AVE LAS VEGAS NV 89110-1586	14029612003
BENITEZ-FAJARDO ANTONIO	1451 RINGE LN LAS VEGAS NV 89110-1630	14028110014
BOYER DONALD & PATSY DECENDENTS	BOYER PATSY M TRS 1341 RINGE LN LAS VEGAS NV 89110	14028210022
BROWN DAVID F	BROWN DAVID PARKER TRUST P O BOX 35 DOBBINS CA 95935-0035	14029612025
BUCHANAN GEO CO	W C LAS VEGAS STORAGE L P 433 E LAS COLINAS BLVD #300 IRVING TX 75039	14029510079
CARDENAS FELIPE M & MARTHA O	1450 RINGE LN LAS VEGAS NV 89110-1631	14028110033
CARREON MELCHOR & MARGARITA	5058 E VAN BUREN AVE LAS VEGAS NV 89110-1562	14029510028
CARRILLO EVERARDO & LUZ C	807 BOTTLE CREEK DR DALTON GA 30721	14028210052
CARRILLO-GUILLEN ALEJANDRO	1889 RACINE DR LAS VEGAS NV 89156	14028210008
CAVADA LUCIO C & LUCRECIA	4897 E MONROE AVE LAS VEGAS NV 89110-1511	14029611045
CENTRAL TELEPHONE CO	P O BOX 7909 OVERLAND PARK KS 66207-0909	14029602001
CHAVEZ FAMILY TRUST	CHAVEZ JORGE & ANA B TRS 6268 DOWNPOUR CT LAS VEGAS NV 89110-5037	14029510033
CLARK MICHAEL K	DIKET SUSAN O 1282 RINGE LN LAS VEGAS NV 89110-1627	14028210033
DENIGER ALANA	1385 RINGE LN LAS VEGAS NV 89110-1604	14028210024
DIAZ JORGE CRUZ	909 S MAIN ST LAS VEGAS NV 89101-6426	14028210017
DIAZ JORGE CRUZ	909 S MAIN ST LAS VEGAS NV 89101-6426	14028210007
DUDLEY ELSIE M REVOCABLE TRUST	DUDLEY ELSIE M TRS 1335 RINGE LN LAS VEGAS NV 89110-1604	14028210021

Report of All Selected Parcels**Case Number:**

SUP-61064

Printed On: Mon: August 31, 2015

<u>Owner</u>	<u>Address</u>	<u>Parcel Numbe</u>
E S C DEVELOPMENT L L C	P O BOX 93835 LAS VEGAS NV 89193-3835	14029510110
FELKINS RICKEY E	1283 RINGE LN LAS VEGAS NV 89110-1626	14028210018
FRANK'S 1322 NORTH NELLIS L L C	P O BOX 4399 SALEM OR 97302	14028210004
FREGOSO JOSE A & MARIA T	1213 STONEY BEACH ST LAS VEGAS NV 89110-1591	14029611024
FREIBURGER JOSEPH E & CYNTHIA D	1469 RINGE LN LAS VEGAS NV 89110-1630	14028110015
GARCIA ALEJANDRA	1221 RINGE LN LAS VEGAS NV 89110-1626	14028210015
GILLETTE JULIANA	STEWART PAUL M 4961 SANDRA RD LAS VEGAS NV 89110-1519	14029612027
GONZALEZ FRANCISCO J	GONZALES MARTHA E 1499 RINGE LN LAS VEGAS NV 89110-1630	14028110017
GUTIERREZ RIGOBERTO ORTIZ	1314 RINGE LN LAS VEGAS NV 89110	14028210031
HACKLEY MARSHA S	SPAZIANI BERNARD JR 4978 E MONROE AVE LAS VEGAS NV 89110-1584	14029510086
HAGGARD RONALD R & SHERRY D	HAGGARD LASHAY 2221 CAMEL ST LAS VEGAS NV 89115-5224	14029510074
HAGGARD RONALD R & SHERRY DIANE	HAGGARD LASHAY 2221 CAMEL ST LAS VEGAS NV 89115-5224	14029510075
HARRIS ARTHUR J & NADYNE N	2808 N WOLF RD MELROSE PARK IL 60164-1155	14029510076
HERNANDEZ EDGARDO & MARTHA ETAL	VALENCIA YESENIA 917 N NELLIS BLVD LAS VEGAS NV 89110	14029602004
HERNANDEZ EDGARDO ISRAEL	P O BOX 26239 LAS VEGAS NV 89126-0239	14029602003
HERNANDEZ EDGARDO ISRAEL	P O BOX 26239 LAS VEGAS NV 89126-0239	14029602002
HERNANDEZ RICARDO & AMALIA	4953 E MONROE AVE LAS VEGAS NV 89110-1586	14029612006
HILL MORGAN G & SALLIE L	4990 E VAN BUREN AVE LAS VEGAS NV 89110-1561	14029510032
HUGHES MADELINE A	4945 E MONROE AVE LAS VEGAS NV 89110-1586	14029612004
JACKS JOYCE R	5023 E MONROE AVE LAS VEGAS NV 89110-1587	14029612008
JACKS JOYCE R QUALIFIED RES TR	JACKS JOYCE R TRS 5023 E MONROE AVE LAS VEGAS NV 89110-1587	14029612009
JACKSON HAROLD M	5058 SANDRA RD LAS VEGAS NV 89110-1548	14029612012
JENSEN MARK S	4998 E VAN BUREN AVE LAS VEGAS NV 89110-1561	14029510031
JOZUYAGA L L C	1841 BALZAC DR LAS VEGAS NV 89156-7183	14028110034
LANG GRANT A & CAROLINE H	1330 RINGE LN LAS VEGAS NV 89110-1603	14028210030
LAURIA VINCENT F & DEBORA J	1426 RINGE LN LAS VEGAS NV 89110-1631	14028110032
LEAVITT FAMILY TRUST	LEAVITT LEONARD & DONNA J CO-TRS 5040 SANDRA RD LAS VEGAS NV 89110-1548	14029612013
LEAVITT FAMILY TRUST	LEAVITT LEONARD TRS 265 N HOLLYWOOD BLVD LAS VEGAS NV 89110	14029612026
LEAVITT FAMILY TRUST	LEAVITT M LEONARD TRS 265 N HOLLYWOOD BLVD LAS VEGAS NV 89110	14028210023
LEAVITT LEONARD	265 N HOLLYWOOD BLVD LAS VEGAS NV 89110	14029612007
LIAO LIH-NAN & SHU-CHEN	7697 KEATING CIR LAS VEGAS NV 89147-4927	14029510030
LIAO LIH-NAN & SHU-CHEN	7697 KEATING CIR LAS VEGAS NV 89147-4927	14029510029

Report of All Selected Parcels**Case Number:**

SUP-61064

Printed On: Mon: August 31, 2015

<u>Owner</u>	<u>Address</u>	<u>Parcel Number</u>
LICEA LIVING TRUST	LICEA TEODORO G & ANA P CO-TRS 17644 SCOTTSDALE RD RIVERSIDE CA 92504-9408	14029612033
LINDQUIST CHERYL A LIVING TRUST	4836 HOT SPRINGS AVE LAS VEGAS NV 89110-1508	14029611025
LOPEZ INGRID ADILENY	1359 MOUNT HOOD ST LAS VEGAS NV 89110	14029602008
LOPEZ-SANDOVAL PEDRO & CLARISSA	P O BOX 335544 NORTH LAS VEGAS NV 89033-5544	14029612011
LOZANO-CARRERA ARMANDO JR	8435 W CAMERO AVE LAS VEGAS NV 89113-4533	14029612029
LU HON & KEVIN	1395 ADAQUETTO DR HENDERSON NV 89052-6590	14028210032
LUJAN DOMINGO & YOLANDA	5000 E WASHINGTON AVE LAS VEGAS NV 89110-2429	14029602009
MACINTOSH DALE T & JOYCE E	4979 E VAN BUREN AVE LAS VEGAS NV 89110-1564	14029510073
MARCOS IGNACIO SOTO DE	DIAZ NORMA A URIBE 5059 E VAN BUREN AVE LAS VEGAS NV 89110-1565	14029510077
MARTIN TIMM W & CRYSTAL D	5018 E MONROE AVE LAS VEGAS NV 89110-1585	14029510084
MARTINEZ OSCAR A	1394 RINGE LN LAS VEGAS NV 89110-1603	14028210026
MATTHEWS JAMES E & TAMMY J	1483 RINGE LN LAS VEGAS NV 89110-1630	14028110016
MESSINA SANDRA E	4959 E VAN BUREN AVE LAS VEGAS NV 89110-1564	14029510108
MEZA LUIS & INES	6395 HOTCHKISS CT LAS VEGAS NV 89110	14028210019
MEZA MANUEL JESUS	4998 E MONROE AVE LAS VEGAS NV 89110-1584	14029510085
MIAMI SHORES DEVELOPMENT L L C	P O BOX 620660 LAS VEGAS NV 89162-0660	14029510083
MIAMI SHORES DEVELOPMENT L L C	P O BOX 620660 LAS VEGAS NV 89162-0660	14029510082
MODENA DONALD R	5004 SANDRA RD LAS VEGAS NV 89110-1548	14029612015
MORRIS M SCOTT & CHARLETTA	1801 SHANER LN LAS VEGAS NV 89156	14028110036
MURRAY BRADLEY & JACQUELYN	5050 E WASHINGTON LAS VEGAS NV 89110-2429	14029602007
MURRAY BRADLEY B & JACQUELYN L	5050 E WASHINGTON AVE LAS VEGAS NV 89110-2429	14029602006
NAM REAL ESTATE L L C	8601 DUNWOODY PL #406 ATLANTA GA 30350-2550	14028210006
NAVARRO BERNARDO RAMIREZ	1418 RINGE LN LAS VEGAS NV 89110-1631	14028110035
NAVARRO ROSALIO	2107 BASSLER ST NORTH LAS VEGAS NV 89030	14029510069
NEVADA POWER COMPANY	P O BOX 98910 LAS VEGAS NV 89193-8910	14028210009
NEVADA POWER COMPANY	P O BOX 98910 LAS VEGAS NV 89193-8910	14028210010
OHANIAN RAFI REVOCABLE LIVING TR	1101 N NELLIS BLVD #1113 LAS VEGAS NV 89110	14029601006
OHANIAN RAFI REVOCABLE LIVING TR	1101 N NELLIS BLVD #1113 LAS VEGAS NV 89110	14029601005
PACHECO JOSE F & NOELIA	5041 SANDRA RD LAS VEGAS NV 89110-1550	14029612032
PACHOLKE STEVEN W	4974 SANDRA RD LAS VEGAS NV 89110-1520	14029612018
PALMER SELINA A	1475 RINGE LN LAS VEGAS NV 89110	14028110013
PEREGRINO MARIA C	PEREGRINO-SOLIS VIDAL 1251 RINGE LN LAS VEGAS NV 89110-1626	14028210016

Report of All Selected Parcels**Case Number:**

SUP-61064

Printed On: Mon: August 31, 2015

<u>Owner</u>	<u>Address</u>	<u>Parcel Numbe</u>
PEREZ RIGOBERTO	1166 MINT JULEP WAY LAS VEGAS NV 89142	14029612019
RAMIREZ ALFREDO	5024 SANDRA RD LAS VEGAS NV 89110-1548	14029612014
RAMIREZ RUBIO L L C	9316 RUBY ARROW CT #101 LAS VEGAS NV 89178	14029601001
REECE THOMAS M & LENETTE	4934 SANDRA RD LAS VEGAS NV 89110-1520	14029612022
REECE THOMAS M & LENETTE	4934 SANDRA RD LAS VEGAS NV 89110-1520	14029611023
REECE THOMAS M & LENETTE	4934 SANDRA RD LAS VEGAS NV 89110-1520	14029612021
RESNIK ROBERT S	4928 E MONROE AVE LAS VEGAS NV 89110-1584	14029510089
RINGLER SCOTT A & PATRICIA L	4935 E MONROE AVE LAS VEGAS NV 89110-1586	14029612002
ROBERSON KIM S	4970 E VAN BUREN AVE LAS VEGAS NV 89110-1561	14029510034
ROBINSON CATHERINE	1428 RINGE LN LAS VEGAS NV 89110-1631	14028110031
ROBINSON SAMULE M & LAURA D	4938 E MONROE AVE LAS VEGAS NV 89110-1584	14029510088
SAHARA CONDOS SOUTHWEST L L C	522 E TWAIN AVE LAS VEGAS NV 89169	14028210005
SANABRIA PEDRO MORALES	4939 E VAN BUREN AVE LAS VEGAS NV 89110-1564	14029510070
SANCHEZ OMAR	1712 BRADY AVE LAS VEGAS NV 89101	14029602010
SCHULTZ KASUMI	1549 RINGE LN LAS VEGAS NV 89110-1630	14028110019
SHAPPIE FAMILY TRUST	SHAPPIE LARRY H & MICHELLE L TRS 4998 SANDRA RD LAS VEGAS NV 89110-1520	14029612016
SHARP VAL D	4958 E MONROE AVE LAS VEGAS NV 89110-1584	14029510087
SOLORZANO JOSE E & BERTA	2105 MOONLITE DR LAS VEGAS NV 89115-5330	14029612010
STRAIGHT RYAN	WALDRIP KAINOA 5005 SANDRA RD LAS VEGAS NV 89110-1550	14029612030
THOMAS FAMILY TRUST	THOMAS RODNEY L & KIMBERLY E TRS 1498 RINGE LN LAS VEGAS NV 89110-1631	14028110030
TOP GUN II L P	3075 ROSANNA ST LAS VEGAS NV 89117-3141	14028110011
TOP GUN II L P	3075 ROSANNA ST LAS VEGAS NV 89117-3141	14028110012
TOP GUN II L P	3075 ROSANNA ST LAS VEGAS NV 89117-3141	14028110010
TRUSTEE CLARK COUNTY TREASURER	6975 DOCILE DAYBREAK CT LAS VEGAS NV 89156-7208	14029612005
TÜSSING DONALD R	4954 SANDRA RD LAS VEGAS NV 89110-1520	14029612020
V M B ENTERPRISES INC	9030 W SAHARA AVE #610 LAS VEGAS NV 89117-5744	14028110005
VALENZUELA RODOLFO & MARTHA A	4898 E MONROE AVE LAS VEGAS NV 89110-1500	14029510091
W C LAS VEGAS STORAGE L P	433 E LAS COLINAS BLVD #300 IRVING TX 75039	14029601003
W C LAS VEGAS STORAGE L P	433 E LAS COLINAS BLVD #300 IRVING TX 75039	14029510025
W C LAS VEGAS STORAGE L P	433 E LAS COLINAS BLVD #300 IRVING TX 75039	14029601002
W C LAS VEGAS STORAGE L P	433 E LAS COLINAS BLVD #300 IRVING TX 75039	14029510081
W C LAS VEGAS STORAGE L P	433 E LAS COLINAS BLVD #300 IRVING TX 75039	14029601004

Report of All Selected Parcels**Case Number:**

SUP-61064

Printed On: Mon: August 31, 2015

<u>Owner</u>	<u>Address</u>	<u>Parcel Numbe</u>
W C LAS VEGAS STORAGE L P	433 E LAS COLINAS BLVD #300 IRVING TX 75039	14029510080
W C LAS VEGAS STORAGE L P	433 E LAS COLINAS BLVD #300 IRVING TX 75039	14029510078
W C LAS VEGAS STORAGE L P	433 E LAS COLINAS BLVD #300 IRVING TX 75039	14029510024
WALDRIP JANICE E	5023 SANDRA AVE LAS VEGAS NV 89110-1550	14029612031
WHITTEN-VICZKO PENNIE L	STACKHOUSE JERRY 1382 RINGE LN LAS VEGAS NV 89110-1603	14028210027
WILLARS JUDITH	4988 SANDRA RD LAS VEGAS NV 89110-1520	14029612017
WORKMAN WILLIAM M & SANDRA J	1362 RINGE LN LAS VEGAS NV 89110-1603	14028210028