

City of Las Vegas  
Department of Planning  
Development Services Center  
333 North Rancho Drive, 3<sup>rd</sup> Floor  
Las Vegas, Nevada 89106

S. ✓

## Return Service Requested Official Notice of Public Hearing

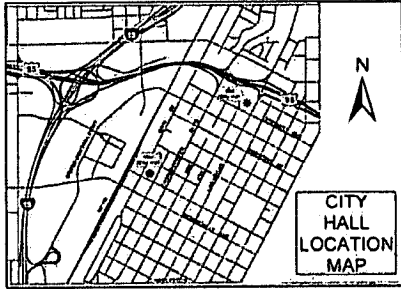

If you wish to file your protest or support on this request, check the appropriate box below and return this card in an envelope with postage to the Department of Planning at the address listed above, fax this side of this card to (702) 464-7499 or make your comments at [www.lasvegasnevada.gov](http://www.lasvegasnevada.gov). If you would like to contact your Council Representative, please call (702) 229-6405.

I SUPPORT  
this Request

I OPPOSE  
this Request

Please use available blank space on card for your comments.

**SUP-58561 & SDR-58562 [PRJ-58523]**

Planning Commission Meeting of 5/12/2015

15 ✓

## Application Information

**SUP-58561 - SPECIAL USE PERMIT - PUBLIC HEARING - APPLICANT: TOWER DISTRIBUTION CENTER, LLC - OWNER: SOUTHWEST COLLEGE OF MEDICAL-DENTAL ASSISTANTS & PRACTICAL NURSES** - For possible action on a request for a Special Use Permit FOR A PUBLIC SCHOOL, PRIMARY USE at 4624-4660 North Rancho Drive (APN 138-02-113-001), C-1 (Limited Commercial) Zone, Ward 4 (Anthony) [PRJ-58523].

**SDR-58562 - SITE DEVELOPMENT PLAN REVIEW RELATED TO SUP-58561 - PUBLIC HEARING - APPLICANT: TOWER DISTRIBUTION CENTER, LLC - OWNER: SOUTHWEST COLLEGE OF MEDICAL-DENTAL ASSISTANTS & PRACTICAL NURSES** - For possible action on a request for a Major Amendment to an approved Site Development Plan Review (SDR-16503) FOR NINE PROPOSED DETACHED MODULAR BUILDINGS TOTALING 14,816 SQUARE FEET on 6.42 acres at 4624-4660 North Rancho Drive (APN 138-02-113-001), C-1 (Limited Commercial) Zone, Ward 4 (Anthony) [PRJ-58523].

Any and all interested persons may appear before the City Planning Commission either in person or by representative and object to or express approval of this request; or may, prior to this meeting, file a written objection thereto or approval thereof with the Department of Planning, Development Services Center, 333 North Rancho Drive, 3<sup>rd</sup> Floor, Las Vegas, Nevada 89106. Final Action on General Plan Amendments and Rezoning will be determined by the City Council. Other public hearing items may be deemed Final Action by the Planning Commission or forwarded to the City Council. The date of the City Council meeting, if applicable, will be announced at the Planning Commission meeting after the discussion of the item. For further information, including the full staff report, please call (702) 229-6301 (TDD 386-9108) or go to <http://www.lasvegasnevada.gov>.

## Application Location

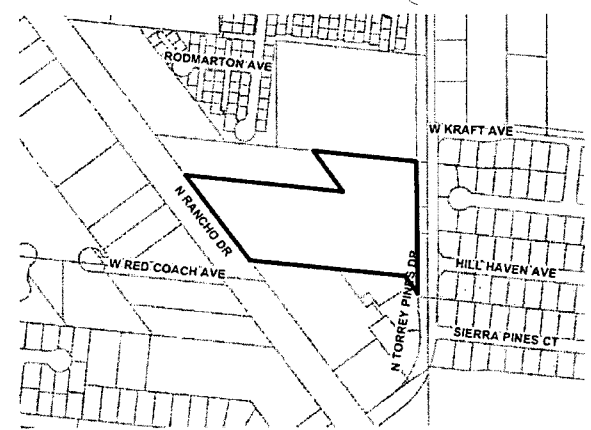

The proposed project may not pertain to the entire highlighted project site.

## Public Hearing Information

<b>Meeting:</b>	Planning Commission
<b>Date:</b>	<i>May 12, 2015</i>
<b>Time:</b>	6:00 P.M.
<b>Location:</b>	City Council Chambers 495 South Main Street, 2 <sup>nd</sup> Floor Las Vegas, Nevada 89101

**Report of All Selected Parcels****Case Number:**

SUP-58561 &amp; SDR-58562

**Printed On:** Thu: March 26, 2015

<u>Owner</u>	<u>Address</u>	<u>Parcel Number</u>
786 REVOCABLE TRUST	2102 DONLON CT HENDERSON NV 89012-2709	13802110060
A M H 2014-1 BORROWER L L C	30601 AGOURA RD #200 AGOURA HILLS ca 91301	13802110093
ACOSTA ELIZABETH MAIDANA	6504 DOBY PEAK DR LAS VEGAS NV 89108	13802212060
ADCOCK JOSHUA J	6229 SIERRA PINES CT LAS VEGAS NV 89130-2342	13802610024
AGUILAR EVA MARIA REVOCABLE TR	AGUILAR EVA MARIA TRS 6480 ABBOTSFORD HOUSE CT LAS VEGAS NV 89130-2308	13802110124
AHLBERG KIMBERLY M	4773 MORTON MANOR CT LAS VEGAS NV 89130-2371	13802110034
ALDAKHEELY ILLHAM	207 18TH ST HUNTINGTON BEACH CA 92648-3903	13802110010
ALINO JESUS E & ESTERLITA C	4789 GREENCOMBE CT LAS VEGAS NV 89130-2368	13802110015
AL-TUWAJRI MOHAMMED	207 18TH ST HUNTINGBEACH CA 92648-3903	13802110091
ALVAREZ LYANNET	4781 MORTON MANOR CT LAS VEGAS NV 89130-2371	13802110036
AMEER INVESTMENTS	6525 ROMANCE CIR LAS VEGAS NV 89108	13802211005
AMMON CHERYL	6421 WHEELBARROW PEAK DR LAS VEGAS NV 89108-5727	13802212069
ATLAS III TRUST	GOODMAN STEVE TRS 368 DALEHURST AVE LOS ANGELES CA 90024-2512	13802101007
ATLAS III TRUST	GOODMAN STEVE TRS 368 DALEHURST AVE LOS ANGELES CA 90024-2512	13802101008
AYALA RICARDO D	DENSHAM AMY M 4741 PRIORY GARDENS ST LAS VEGAS NV 89130-2309	13802110073
B R N V L L C	4201 JORY TRL LAS VEGAS NV 89108-5210	13802101005
B R N V L L C	4201 JORY TRL LAS VEGAS NV 89108-5210	13802101017
B2 PROPERTIES L L C	8209 FOOTHILL BLVD #A138 SUNLAND CA 91040	13802110117
BABBINGTON BRIDGET M	6429 SIERRA DIABLO AVE LAS VEGAS NV 89130-1871	12535416029
BACANI PAOLO-DOMINIQUE A	BUENAVENTURA EDWARD R & MARYANN 6484 ABBOTSFORD HOUSE CT LAS VEGAS NV 89130	13802110123
BAHENA MARIA ISABEL	2745 S CONCORD AVE ONTARIO CA 91761	13802211011
BAILEY MILLICENT L	4765 BURGESS PARK CT LAS VEGAS NV 89130-2362	13802110099
BALANDRA JERMAINE	4480 SIRIUS AVE #210 LAS VEGAS NV 89102	13802110004
BANK FIRST SAVINGS CUSTODIAN	2605 E FLAMINGO RD LAS VEGAS NV 89121	12535416017
BARMAN RONALD M & CAROLE REV TR	BARMAN RONALD M & CAROLE TRS 6317 KRAFT AVE LAS VEGAS NV 89130-2357	13802511003
BARRETT MICHAEL W	6433 DOBY PEAK DR LAS VEGAS NV 89108-5724	13802212053
BARRETT PAUL J & SHERYL L	340 ALISO DR NE ALBUQUERQUE NM 87108-1005	13802110109
BATTON JACQUELYN	SCARLATO GERTRUDE 6404 SIERRA DIABLO AVE LAS VEGAS NV 89130	12535416013
BAUER LAWRENCE JR	4793 HAMPSTEAD HEATH CT LAS VEGAS NV 89130-2370	13802110020
BAUMGART JONI R	4773 MANDERSTON CT LAS VEGAS NV 89130-2365	13802110052
BECKER NORMAN P	18375 VENTURA BLVD #148 TARZANA CA 91356	12535415054
BIAZZO SALVATORE J	6509 WHEELBARROW PEAK DR LAS VEGAS NV 89108-5750	13802212077

**Report of All Selected Parcels****Case Number:**

SUP-58561 &amp; SDR-58562

**Printed On:** Thu: March 26, 2015

<u>Owner</u>	<u>Address</u>	<u>Parcel Number</u>
BILAVARN JOHNNY	6277 HILL HAVEN AVE LAS VEGAS NV 89130	13802511054
BIRDMAN LIVING TRUST	TAYLOR DONALD & EILEEN F TRS 6325 CHIMNEY WOOD AVE LAS VEGAS NV 89130-2351	13802511015
BLACK NIGEL L	6257 HILL HAVEN AVE LAS VEGAS NV 89130-2347	13802511059
BOASBERG PETER D	CAVALE KAREN L 829 WARREN AVE LOS ANGELES CA 90024	13802213014
BOISSELLE ROGER P SR & BONNIE J	BOISSELLE ROGER P JR 5070 UPPER FALLS CT LAS VEGAS NV 89141-8641	13802212065
BOLINGER JOSHUA	UDELL CHRISTOPHER 7808 PORTLAND TRL AUSTIN TX 78729-8041	13802110059
BONUGLI LAUREN R	10536 EARLY HEIGHTS CT LAS VEGAS NV 89129	13802110011
BORDEN THURMOND H	U S EMBASSY BEIJING PSC 461 BOX 50 FPO AP 96521	13802110043
BOTT FAMILY REVOCABLE LIVING TR	BOTT EDWARD J & ROSE MARIE TRS 6429 DOBY PEAK DR LAS VEGAS NV 89108-5724	13802212052
BRANCH JESSICA A	WRIGHT-DECAMPOS ANNETTE M 4793 DRUMMOND CASTLE CT LAS VEGAS NV 89130-2366	13802110008
BRANDT KENNETH H & CAROL J	6437 WHEELBARROW PEAK DR LAS VEGAS NV 89108-5727	13802212073
BROOKS NISHA N	6488 BENTLEY WOOD CT LAS VEGAS NV 89130-2311	13802110104
BROWNE HALE	6416 WHEELBARROW PEAK DR LAS VEGAS NV 89108-5715	13802212010
BUCHANAN HERBERT JR & MARGARET	4325 AL CARRISON ST LAS VEGAS NV 89129	13802511007
BUYERS DAVID C	4742 NEWBY HALL CT LAS VEGAS NV 89130	13802110080
CALDER PROPERTIES L L C	5945 WASATCH RIDGE CIR LAS VEGAS NV 89149-3967	13802110096
CALLAHAN DERRICK G	6528 ROMANCE CIR LAS VEGAS NV 89108-5729	13802211013
CAMPANELLI BARROS FAMILY TRUST	CAMPANELLI DILMA TRS 6276 CHIMNEY WOOD AVE LAS VEGAS NV 89130-2300	13802511077
CARNS DAVID C & SHIRLEY P	6237 SIERRA PINES CT LAS VEGAS NV 89130-2342	13802610026
CARY REHNA C	6489 ABBOTSFORD HOUSE CT LAS VEGAS NV 89130-2308	13802110121
CASTANEDA WILMA S	4778 PRIORY GARDENS ST LAS VEGAS NV 89130-2310	13802110062
CECILLO BRIAN & DIANE	4777 MARWOOD VILLA CT LAS VEGAS NV 89130-2369	13802110041
CHAVEZ ANGELICA	MESTA JOSE ROBERT 8923 SNOWTRACK AVE LAS VEGAS NV 89149	13802110007
CHAVEZ SYLVIA TRUST	CHAVEZ SYLVIA V TRS 6320 SIERRA PINES CT LAS VEGAS NV 89130-2343	13802610004
CHIN LOIS	4778 MEREWORTH CT LAS VEGAS NV 89130-2367	13802110044
CHING CHARLIE HO & DOLORES HO	P O BOX 508 PAGO PAGO AS 96799	13802110040
CHRISTENSEN RONALD J	6513 PAINTED DESERT DR LAS VEGAS NV 89108-5754	13802202007
CHURCH BAPTIST LONE MOUNTAIN	6319 W LONE MOUNTAIN RD LAS VEGAS NV 89130-2134	13802501004
CLARK RICHARD R & PATRICIA A	6513 WHEELBARROW PEAK DR LAS VEGAS NV 89108-5750	13802211114
CLINE KARI LEIGH	6512 WHEELBARROW PEAK DR LAS VEGAS NV 89108-5700	13802211001
COFFMAN DEBRA & MARTIN	4417 LOOKOUT PEAK WY LAS VEGAS NV 89108-5720	13802212015
COLE JEFFREY WADE	COLE PAULA SIMBRO 4527 ORRINGTON RD CORONA DEL MAR CA 92625-3121	12535416039

**Report of All Selected Parcels****Case Number:**

SUP-58561 &amp; SDR-58562

**Printed On:** Thu: March 26, 2015

<u>Owner</u>	<u>Address</u>	<u>Parcel Number</u>
COLE WY PORTFOLIO NV L L C	1328 DUBLIN RD #300 COLUMBUS OH 43215	13802203003
COLEMAN MICHAEL A & JOYCE ANN	4801 AMERICANWOOD ST LAS VEGAS NV 89130-5629	12535811016
COLFIN AI-NV 2 L L C	9305 E VIA VENTURA #201 SCOTTSDALE AZ 85258	13802110017
COLFIN AI-NV 2 L L C	9305 E VIA DE VENTURA #201 SCOTTSDALE AZ 85258	13802110028
CONROY SCOTT C	6436 DOBY PEAK DR LAS VEGAS NV 89108	13802212063
CONSTANTINO ESTELA ESER	6481 ARROW COTTAGE CT LAS VEGAS NV 89130	13802110107
CONTI GIUSEPPE & BELINDA I	6261 KRAFT AVE LAS VEGAS NV 89130-2355	13802511072
COOKE LIVING TRUST	COOKE DOUGLAS J & PATRICIA L TRS 4321 COBBLEHILL WY NORTH LAS VEGAS NV 89032-0176	12535811032
COOPER CHAD E	6481 ABBOTSFORD HOUSE CT LAS VEGAS NV 89130-2308	13802110119
COOPER JOHN A & DEIDRA A	12452 SAINT MARK GARDEN GROVE CA 92845	13802110106
COOPER TIMOTHY A	104 BRIGHTWATER DR ANNAPOLIS MD 21401-4520	13802511038
CORTEZ ROSA	P O BOX 10522 ROCKVILLE MD 20849-0522	13802110053
COSTELLO BARRY	233 BROAD ST P O BOX 37 NEVADA CITY CA 95959-0037	13802610011
COYLE JAMES	6264 HILL HAVEN AVE LAS VEGAS NV 89130-2346	13802511032
CROARO HOLDINGS L L C	9040 W EL CAMPO GRAND LAS VEGAS NV 89149-3319	13802111002
CROMER ASHLEY ANN	6305 HILL HAVEN AVE LAS VEGAS NV 89130-2353	13802511050
CRONISTER FREDESVINDA	6440 WHEELBARROW PEAK DR LAS VEGAS NV 89108-5715	13802212004
CRUMB JANINE R	12947 72ND AVE NORTHEAST KIRKLAND WA 98034-165 5	13802110022
CULLORS CANDICE N	4765 SAVILLE GARDEN CT LAS VEGAS NV 89130-2360	13802110090
CUMMING GLADYS MAE	4061 PARK CENTER LN #A FREMONT CA 94538	13802110050
D D C DEALS	P O BOX 43876 LAS VEGAS NV 89116-1876	13802110068
D F A L L C	1401 MINERAL AVE LAS VEGAS NV 89106-4342	13802101010
D.F A L L C	1401 MINERAL AVE LAS VEGAS NV 89106-4342	13802101009
D W REALTY HOLDINGS INC	3145 LIGHTHOUSE RIDGE LN SAN DIEGO CA 92110-5342	13802110021
DAVID ERNESTO & VIOLETA TR 2007	DAVID ERNESTO G & VIOLETA V TRS 4746 PRIORY GARDENS ST LAS VEGAS NV 89130-2309	13802110069
DAVIES EVAN LEROY & LAURA L	8620 COPPER KNOLL AVE LAS VEGAS NV 89129-7651	13802501003
DAVIS JAMES M LIVING TRUST 2009	DAVIS JAMES M TRS 4754 PRIORY GARDENS ST LAS VEGAS NV 89130-2309	13802110067
DAYANAN HENRY	6308 CHIMNEY WOOD AVE LAS VEGAS NV 89130-2351	13802511010
DBM PROPERTIES 1 L L C	291 BROKEN PAR DR LAS VEGAS NV 89148-5209	13802211002
DEAGOSTENO JOANN LIVING TRUST	DEAGOSTENO JOANN TRS 6453 SIERRA DIABLO AVE LAS VEGAS NV 89130	12535415057
DEAGOSTENO JOHN J & KATHLEEN A	6449 SIERRA DIABLO AVE LAS VEGAS NV 89130-1865	12535415058

**Report of All Selected Parcels****Case Number:**

SUP-58561 &amp; SDR-58562

**Printed On:** Thu: March 26, 2015

<u>Owner</u>	<u>Address</u>	<u>Parcel Number</u>
DELAUNE PHILLIP CHARLES	4711 TRIMWATER CT LAS VEGAS NV 89130-2305	13802512007
DENNEY CHARLES W & ELIZABETH S	4800 AMERICANWOOD LAS VEGAS NV 89130-5628	12535811015
DIAZ MARIBEL	4761 PRIORY GARDENS ST LAS VEGAS NV 89130	13802110102
DIFLOURE JOHN BRUCE & SHARON L	504 VIA DE FORTUNA WY MESQUITE NV 89027-7608	12535416031
DILLON TERRY L & CRISTINA M	DILLON TERRY L & CRISTINA M 6281 CHIMNEY WOOD AVE LAS VEGAS NV 89130-2345	13802511022
DILLOW LOUIS FAMILY TRUST	DILLOW LOUIS C TRS 1900 SIROCCO CT LAS VEGAS NV 89117	13802610033
DIPAY CLAIRE	4781 MARWOOD VILLA CT LAS VEGAS NV 89130	13802110042
DODDS DEBI ELAINE	6481 ARBURY HALL CT LAS VEGAS NV 89130-2307	13802110113
DOSHI PRAFULL	406 GULPH RIDGE DR KING OF PRUSSIA PA 19406	13802110002
DOUGLAS E'LON	22807 SHELL DR CARSON CA 90745-4743	13802110065
DOWLEN CARNEY	6500 PAINTED DESERT DR LAS VEGAS NV 89108-5753	13802201008
DOWLEN PATRICK W REVOCABLE TRUST	DOWLEN PATRICK W TRS 6501 PAINTED DESERT DR LAS VEGAS NV 89108-5754	13802202009
DOWNEY KATHLEEN M	4749 NEWBY HALL CT LAS VEGAS NV 89130-2361	13802110083
DYKA KAREN D	6501 WHEELBARROW PEAK DR LAS VEGAS NV 89108-5750	13802212075
EAP SEREY	1001 FIGUEROA TERR #310 LOS ANGELES CA 90012-1398	13802110071
EHELBERGER ALAN & SARAH	6325 HILL HAVEN AVE LAS VEGAS NV 89130-2353	13802511045
EGGERT DANIEL T	6420 DOBY PEAK DR LAS VEGAS NV 89108-5723	13802212067
ELLIS HUI MEI	8101 W FLAMINGO RD #1044 LAS VEGAS NV 89147	13802511031
ENGLERT AUBREE M	6416 SIERRA DIABLO LAS VEGAS NV 89130-1863	12535416016
FARRARONS ENRIQUE ALPUERTO	CASTILLO ANGELLIE MARIE 5740 FRANKLIN AVE #109 HOLLYWOOD CA 90028-5737	13802110108
FEATHERAN CODY-TAYLOR K	4742 PRIORY GARDENS ST LAS VEGAS NV 89130	13802110070
FENECH PETER RENO	ANDREOFF CHARLIE 4793 GREENCOMBE CT LAS VEGAS NV 89130	13802110014
FERNANDEZ FAMILY TRUST AGMT	FERNANDEZ ROBERT N TRS 6280 HILL HAVEN AVE LAS VEGAS NV 89130	13802511036
FLORES RICARDO	1548 18TH AVE OAKLAND CA 94606	13802110057
FOGELMAN TRUST	FOGELMAN LEO TRS 6265 CHIMNEY WOOD AVE LAS VEGAS NV 89130-2345	13802511026
FOUSEK RONALD S	7 N 3RD ST NEW FREEDOM PA 17349-9441	13802110038
FRAZIER CHARLES B & AMANDA M	6265 W KRAFT AVE LAS VEGAS NV 89130	13802511073
FRAZIER PAUL D & DALIN	4425 CARIBOU WY LAS VEGAS NV 89108-5707	13802212020
FRENCH-SCHALK KARIN	6232 SIERRA PINES CT LAS VEGAS NV 89130-2341	13802610013
FUERST PROPERTIES L L C	12 BEACON BAY NEWPORT BEACH CA 92660	13802110074
FULTON RANDY D & KAZUYO I	17127 W BERNARDO DR #207 SAN DIEGO CA 92127-1513	13802110076
FUNDEX PROPERTIES L L C	336 36TH ST #382 BELLINGHAM WA 98225-6580	13802211014

**Report of All Selected Parcels****Case Number:**

SUP-58561 &amp; SDR-58562

**Printed On:** Thu: March 26, 2015

<b>Owner</b>	<b>Address</b>	<b>Parcel Number</b>
GABISAN HELEN D	DAVID MA FERLEN D III 4774 MARWOOD VILLA CT LAS VEGAS NV 89130-2369	13802110039
GAGNON JACLYN	4416 CARIBOU WY LAS VEGAS NV 89108-5707	13802212019
GAINES CARLETTA	6540 ROMANCE CIR LAS VEGAS NV 89108-5729	13802211016
GALLINA MAMIE	6320 CHIMNEY WOOD AVE LAS VEGAS NV 89115	13802511013
GALVAN MARIA L	ARIAS CESAR E 4421 CARIBOU WY LAS VEGAS NV 89108-5707	13802212021
GARCIA MARIA E & JOSE	6428 WHEELBARROW PEAK DR LAS VEGAS NV 89108-5715	13802212007
GIBSON MICHAEL H & KATHLEEN C	6321 HILL HAVEN AVE LAS VEGAS NV 89130-2353	13802511046
GIVEALL NATIONAL L C	414 N ORLEANS #402 CHICAGO IL 60654-4461	13802213012
GLINSKI DARIN L	MASONER-GLINSKI KRISTIN 3636 FAIRMONT LN OXNARD CA 93036-6331	13802511017
GOMAN KEITH L & TONI	6425 WHEELBARROW PEAK DR LAS VEGAS NV 89108-5727	13802212070
GOMEZ FRANCIS GASTON	5140 JAMAICA COAST CT NORTH LAS VEGAS NV 89031-3902	13802110063
GRABB DONALD W	6321 KRAFT AVE LAS VEGAS NV 89130	13802511002
GRANDBERRY SHANNELEE	P O BOX 71294 LAS VEGAS NV 89170-1294	13802110114
GRANIL BRYAN	6233 SIERRA PINES CT LAS VEGAS NV 89130-2342	13802610025
GREEN JEAN M & WILLIAM W	6316 HILL HAVEN AVE LAS VEGAS NV 89130-2352	13802511042
GREENMEADOWS REALTY L L C	1404 S MARYLAND PKWY LAS VEGAS NV 89104-3315	13802110031
GRUSE DON	P O BOX 33985 LAS VEGAS NV 89133-3985	12535811017
GURDWARA BABA DEEP SINGH INC	P O BOX 571495 LAS VEGAS NV 89157-1495	13802501018
GURDWARA BABA DEEP SINGH INC	9312 RED TWIG DR LAS VEGAS NV 89134-1810	13802501002
GURUDAWARA BABA DEEP SINGH INC	P O BOX 571495 LAS VEGAS NV 89157-1495	13802501014
GUTIERREZ JAMIE & SOFIA	2332 WANDERING RIDGE DR CHINO HILLS CA 91709	13802110035
HABUDA DANIEL S	1271 PARKVIEW DR NORTH TONAWANDA NY 14120-4806	13802610007
HALBERG CAROL	6332 SIERRA PINES CT LAS VEGAS NV 89130-2343	13802610001
HALLE PROPERTIES L L C	DEPT 1100-NLV04 20225 N SCOTTSDALE RD SCOTTSDALE AZ 85255-6456	13802213003
HAMMAREN JOANNE	BURROUGHS MICHAEL LEE 4720 TRIMWATER CT LAS VEGAS NV 89130-2305	13802512005
HANKINS CARL WALDEN	6256 CHIMNEY WOOD AVE LAS VEGAS NV 89130-2300	13802511082
HARDIN TASS C & LOIS REV FAM TR	4095 N CHIEFTAIN ST LAS VEGAS NV 89129-2667	13802202017
HARDIN TASS C & LOIS REV FAM TR	4095 N CHIEFTAIN ST LAS VEGAS NV 89129-2667	13802202010
HARDIN TASS C & LOIS REV FAM TR	4095 N CHIEFTAIN ST LAS VEGAS NV 89129-2667	13802202015
HARMER THOMAS E	6272 CHIMNEY WOOD AVE LAS VEGAS NV 89130-2300	13802511078
HARRIS CHARLES RAY & ROBBIE L	4433 LOOKOUT PEAK WY LAS VEGAS NV 89108-5720	13802212011
HAWK ROBIN N REVOCABLE LIVING TR	HAWK ROBIN N TRS 3210 N RANCHO DR LAS VEGAS NV 89130	13802101011

**Report of All Selected Parcels****Case Number:**

SUP-58561 &amp; SDR-58562

**Printed On:** Thu: March 26, 2015

<u>Owner</u>	<u>Address</u>	<u>Parcel Number</u>
HAYES-MCKEIRNAN ELIZABETH	6485 ABBOTSFORD HOUSE CT LAS VEGAS NV 89130-2308	13802110120
HEARTLAND AUTOMOTIVE SERVICES	105 DECKER CT #900 IRVING TX 75062-2227	13802213010
HEATH JESSIE LEA-FAMILY TRUST	HEATH JESSIE L TRS 6324 HILL HAVEN AVE LAS VEGAS NV 89130-2352	13802511044
HENDERSON BREYONNA	4773 LONGSTOCK CT LAS VEGAS NV 89130-2363	13802110058
HERRERA AGUSTIN & CENAYDA	4800 GENTLE PINES CT LAS VEGAS NV 89130-5627	12535811031
HERRMANN SONIA M	6264 CHIMNEY WOOD AVE LAS VEGAS NV 89130-2300	13802511080
HEUER SUSAN E	6261 HILL HAVEN AVE LAS VEGAS NV 89130-2347	13802511058
HIGGS FAMILY TRUST	HIGGS RICHARD & DIANA E TRS 7315 N MONTE CRISTO WY LAS VEGAS NV 89131-3333	13802212072
HOBGOOD MELISSA	6421 DOBY PEAK DR LAS VEGAS NV 89108-5724	13802212050
HOLMAN JUSTIN L	4766 BURGESS PARK CT LAS VEGAS NV 89130-2362	13802110100
HOMMEL CHARLES FAMILY TRUST	HOMMEL CHARLES E & BARBARA A TRS 6277 CHIMNEY WOOD AVE LAS VEGAS NV 89130-2345	13802511023
HORNE DARNESE SR & FLORENE J	6325 KRAFT AVE LAS VEGAS NV 89130-2357	13802511001
HOUSTON LUZMARIA Q & STEVEN	6742 BAYHAM ABBEY CT LAS VEGAS NV 89130	13802110097
HUEY JOHN P	91-1162 LANAKOI ST KAPOLEI HI 96707	13802110098
HUGHES JOHN C	6441 SIERRA DIABLO AVE LAS VEGAS NV 89130-1871	12535416026
HUNGER RICHARD J JR	6305 CHIMNEY WOOD AVE LAS VEGAS NV 89130-2351	13802511020
ICENHOWER STEVEN & PATRIA	PSC 78 BOX 715 APO AP 96326	13802512010
ISBELL TODD L	6480 ARBURY HALL CT LAS VEGAS NV 89130-2307	13802110118
IVO SANDRA S	6409 SIERRA DIABLO AVE LAS VEGAS NV 89130-1864	12535416034
J N J SYSTEMS L L C	6180 EISNER DR LAS VEGAS NV 89131	12535811033
JACOBS MEREDITH	4778 MORTON MANOR CT LAS VEGAS NV 89130-2371	13802110032
JEANROY FAMILY TRUST	JEANROY THOMAS L & SUE A TRS 6257 KRAFT AVE LAS VEGAS NV 89130-2355	13802511071
JEW FAMILY TRUST	JEW DOROTHY M & DENNIS L TRS 6268 CHIMNEY WOOD AVE LAS VEGAS NV 89130-2300	13802511079
JEWEL DONALD L L C	6760 ROCKING HORSE AVE LAS VEGAS NV 89108-5922	13802212076
JOHNSON RICHARD & V LIV TR	JOHNSON RICHARD & VIRGINIA TRS 4732 N TORREY PINES DR LAS VEGAS NV 89130-2302	13802501019
JOHNSON WILLIAM H	6321 CHIMNEY WY LAS VEGAS NV 89130	13802511016
JOLLY DONNA M	6520 WHEELBARROW PEAK DR LAS VEGAS NV 89108-5700	13802211003
JONES JUNE	6277 KRAFT AVE LAS VEGAS NV 89130-2355	13802511076
JONES MARIA D	6536 ROMANCE CIR LAS VEGAS NV 89108-5729	13802211015
JONES MEGAN	TUTTLE DAVID 6429 WHEELBARROW PEAK DR LAS VEGAS NV 89108-5727	13802212071
JUILFS HANNAH R	4782 LONGSTOCK CT LAS VEGAS NV 89130-2363	13802110055
JUNGERS LYNN	804 EASTVIEW DR LAS VEGAS NV 89115	13802511047

**Report of All Selected Parcels****Case Number:**

SUP-58561 &amp; SDR-58562

**Printed On:** Thu: March 26, 2015

<u>Owner</u>	<u>Address</u>	<u>Parcel Number</u>
K & D HOLDINGS L L C	3208 W SR 426 #2060 OVIEDO FL 32765-8656	13802110033
KRAMER THADDEUS LANE	6308 HILL HAVEN AVE LAS VEGAS NV 89130-2352	13802511040
KROL ALEKSANDER	1682 APAPUS LN SAN JACINTO CA 92583	12535416038
KUOCH PETER L C & SUTTHY EAP	4055 HOOSIER LAWN WY YORBA LINDA CA 92886-7026	13802110024
L W 3 N V HOLDINGS A L L C	415 GLENEAGLES PL LA CANADA CA 91011-2810	13802213011
LA TONY K & JUDY M	6228 SIERRA PINES CT LAS VEGAS NV 89130	13802610014
LABRECQUE SEAN	6412 SIERRA DIABLO AVE LAS VEGAS NV 89130-1863	12535416015
LABUTTI RONALD J & SUSAN REV TR	LABUTTI RONALD J & SUSAN A TRS 6241 SIERRA PINES CT LAS VEGAS NV 89130-2342	13802610027
LAIKEN STEVE G & MARIA T	6273 W KRAFT AVE LAS VEGAS NV 89130	13802511075
LANGE BRYAN R & JERI A	6269 KRAFT AVE LAS VEGAS NV 89130-2355	13802511074
LARA HUGO	6313 SIERRA PINES CT LAS VEGAS NV 89130-2344	13802610032
LAUGHMAN MICHAEL	4425 LOOKOUT PEAK WY LAS VEGAS NV 89108-5720	13802212013
LEUNG ON WAH MONICA	4745 NEWBY HALL ST LAS VEGAS NV 89130	13802110082
LEUNG YIM THONG	LUO YUNDI 15 CRESTVIEW AVE DALY CITY CA 94015-4502	13802110084
LIEBLIN GEMA TRUST	LOPEZ TONEY E SR & LUPE G TRS 6260 CHIMNEY WOOD AVE LAS VEGAS NV 89130-2300	13802511081
LIM PETER CHEN-LEONG	CHUAH LAY HONG 20 VIA SIENNA DANA POINT CA 92629-3358	13802110051
LINANG MANUEL L	SAEZ JOCELYN L 914 DRIFTWOOD DR SUISUN CITY CA 94585-2657	13802110023
LLACUNA JEFFREY BERNARD	87-1004 MOALI ST WAIANAE HI 96792	13802110112
LONE MOUNTAIN APTS I L P	6021 S FORT APACHE #100 LAS VEGAS NV 89148-5562	13802112450
LOPEZ HILDA B	P O BOX 571695 LAS VEGAS NV 89157-1695	13802110105
LOPEZ LUIS & DARLING	6517 WHEELBARROW PEAK DR LAS VEGAS NV 89108-5750	13802211113
LOUDEN MORRIE	6312 CHIMNEY WOOD AVE LAS VEGAS NV 89130-2351	13802511011
LYMAN JAMES E & RHEA N REV TR	LYMAN JAMES E & RHEA N TRS 6432 WHEELBARROW PEAK DR LAS VEGAS NV 89108-5715	13802212006
MA RAYMOND & JANICE	1710 LOUISE AVE ARCADIA CA 91006-4648	13802110072
MARCHELLO CRAIG	6405 SIERRA DIABLO AVE LAS VEGAS NV 89130-1864	12535416035
MARTIN BEVERLY L	6316 CHIMNEY WOOD AVE LAS VEGAS NV 89130-2351	13802511012
MARTINAT MARY LOU	6281 HILL HAVEN AVE LAS VEGAS NV 89130-2348	13802511053
MAUER ROGER 1996 LIVING TRUST	5495 N DURANGO DR LAS VEGAS NV 89149-4066	13802101012
MAURY ANITA M	6324 SIERRA PINES CT LAS VEGAS NV 89130-2343	13802610003
MCCLONDON LILIT	957 GALLERY CT SAN DIEGO CA 92114-6509	13802610035
MCDOWELL SYLVIA & ROY	6312 HILL HAVEN AVE LAS VEGAS NV 89130	13802511041
MCGRAIL JOHN M & DIANA	6258 W KRAFT AVE LAS VEGAS NV 89130-2354	13802512002

**Report of All Selected Parcels****Case Number:**

SUP-58561 &amp; SDR-58562

**Printed On:** Thu: March 26, 2015

<u>Owner</u>	<u>Address</u>	<u>Parcel Number</u>
MCGREEVEY MARGARET	4700 N TORREY PINES DR LAS VEGAS NV 89130-2302	13802501013
MCGUIRE PATRICIA & MICHAEL J	6300 SIERRA PINES CT LAS VEGAS NV 89130	13802610009
MCKINNEY DONALD G	4798 CANNON HILL CT LAS VEGAS NV 89130-2364	13802110006
MEADOWBROOK HOMEOWNERS ASSN	4815 W RUSSELL RD #15-0 LAS VEGAS NV 89118-6241	13802110132
MEADOWBROOK HOMEOWNERS ASSN	4815 W RUSSELL RD #15-0 LAS VEGAS NV 89118-6241	13802110137
MEADOWBROOK HOMEOWNERS ASSN	4815 W RUSSELL RD #15-0 LAS VEGAS NV 89118-6241	13802110130
MEADOWBROOK HOMEOWNERS ASSN	4815 W RUSSELL RD #15-0 LAS VEGAS NV 89118-6241	13802110141
MEADOWBROOK HOMEOWNERS ASSN	4815 W RUSSELL RD #15-0 LAS VEGAS NV 89118-6241	13802110129
MEADOWBROOK HOMEOWNERS ASSN	4815 W RUSSELL RD #15-0 LAS VEGAS NV 89118-6241	13802110138
MEADOWBROOK HOMEOWNERS ASSN	4815 W RUSSELL RD #15-0 LAS VEGAS NV 89118-6241	13802110136
MEADOWBROOK HOMEOWNERS ASSN	4815 W RUSSELL RD #15-0 LAS VEGAS NV 89118-6241	13802110135
MEADOWBROOK HOMEOWNERS ASSN	4815 W RUSSELL RD #15-0 LAS VEGAS NV 89118-6241	13802110131
MEADOWBROOK HOMEOWNERS ASSN	4815 W RUSSELL RD #15-0 LAS VEGAS NV 89118-6241	13802110145
MEADOWBROOK HOMEOWNERS ASSN	4815 W RUSSELL RD #15-0 LAS VEGAS NV 89118-6241	13802110144
MEADOWBROOK HOMEOWNERS ASSN	4815 W RUSSELL RD #15-0 LAS VEGAS NV 89118-6241	13802110127
MEADOWBROOK HOMEOWNERS ASSN	4815 W RUSSELL RD #15-0 LAS VEGAS NV 89118-6241	13802110140
MEADOWBROOK HOMEOWNERS ASSN	4815 W RUSSELL RD #15-0 LAS VEGAS NV 89118-6241	13802110126
MEADOWBROOK HOMEOWNERS ASSN	4815 W RUSSELL RD #15-0 LAS VEGAS NV 89118-6241	13802110143
MEADOWBROOK HOMEOWNERS ASSN	4815 W RUSSELL RD #15-0 LAS VEGAS NV 89118-6241	13802110142
MEADOWBROOK HOMEOWNERS ASSN	4815 W RUSSELL RD #15-0 LAS VEGAS NV 89118-6241	13802110128
MEADOWBROOK HOMEOWNERS ASSN	4815 W RUSSELL RD #15-0 LAS VEGAS NV 89118-6241	13802110125
MEADOWBROOK HOMEOWNERS ASSN	4815 W RUSSELL RD #15-0 LAS VEGAS NV 89118-6241	13802110133
MEADOWBROOK HOMEOWNERS ASSN	4815 W RUSSELL RD #15-0 LAS VEGAS NV 89118-6241	13802110139
MEADOWBROOK HOMEOWNERS ASSN	4815 W RUSSELL RD #15-0 LAS VEGAS NV 89118-6241	13802110134
MELENDEZ JAVIER R	6408 TRAUTMAN CT LAS VEGAS NV 89149	13802212068
MIKAMI LISA	98-627 KAAHELE ST AIEA HI 96701-2705	13802212066
MILAS JOHN A REVOCABLE TRUST	6401 SIERRA DIABLO AVE LAS VEGAS NV 89130-1864	12535416036
MILLER TAWN	BHAKTA REISA 7630 CHANTILLY ISLAND CT LAS VEGAS NV 89123	13802110049
MILLS HOWARD C & MARGARET LIV TR	MILLS HOWARD C & MARGARET R TRS 6300 CHIMNEY WOOD AVE LAS VEGAS NV 89130-2351	13802511008
MILSAP MICHAEL R	DRUMMOND NORBURTH P 399 HANCOCK ST BROOKLYN NY 11216-2414	13802110110
MOHON PATSY L	HARTMAN KAREN L 6305 SIERRA PINES CT LAS VEGAS NV 89130-2344	13802610030
MOORE JOHN R	6533 ROMANCE CIR LAS VEGAS NV 89108-5729	13802211021

**Report of All Selected Parcels****Case Number:**

SUP-58561 &amp; SDR-58562

**Printed On:** Thu: March 26, 2015

<u>Owner</u>	<u>Address</u>	<u>Parcel Numbe</u>
MORALES TIFFANY R	MORALES-VIDANA OMAR A 4781 MANDERSTON CT LAS VEGAS NV 89130-2365	13802110054
MUNOZ XAVIER	6329 SIERRA PINES CT LAS VEGAS NV 89130-2344	13802610036
MURPHY ALYCIA & DAVID	6276 HILL HAVEN AVE LAS VEGAS NV 89130-2349	13802511035
NAVARRO GERARDO	6262 KRAFT AVE LAS VEGAS NV 89130-2354	13802512003
NELSON RICHARD W & C REV LIV TR	3528 BARREL BRONCO CT NORTH LAS VEGAS NV 89032-2442	13802202008
NEUMULLER ROBERT J & CARYN R	4804 GENTLE PINES CT LAS VEGAS NV 89130-5627	12535811030
NGUYEN ANTHONY	1185 S SUMMER BREEZE LN ANAHEIM CA 92808	13802110094
NICHOLS NICOLE R	4794 CANNON HILL CT LAS VEGAS NV 89130-2364	13802110005
NIEDBALSKI DAVID GEORGE & MARIA	6261 CHIMNEY WOOD AVE LAS VEGAS NV 89130	13802511027
NIGHTINGALE AARON M	GARVEY SHANNON M 6420 WHEELBARROW PEAK DR LAS VEGAS NV 89108-5715	13802212009
OFFSTEIN E & LOCKE E FAMILY TRUS	OFFSTEIN EDWARD TRS 2903 TODD ST OCEANSIDE CA 92054-3719	13802212059
OMOTO KENJI REVOCABLE TRUST	OMOTO KENJI TRS 6301 CHIMNEY WOOD AVE LAS VEGAS NV 89130-2351	13802511021
ORTEGA & DELGADO REVOCABLE TRUST	ORTEGA LUIS A TRS 26 WILLOWBROOK LN PHILLIPS RANCH CA 91766	13802110075
ORTIZ HUEBERTO & MARTHA	6436 WHEELBARROW PEAK DR LAS VEGAS NV 89108-5715	13802212005
OSBORN PATRICIA A	6245 SIERRA PINES CT LAS VEGAS NV 89130-2342	13802610028
OWEN SHIRLEY A	6413 SIERRA DIABLO AVE LAS VEGAS NV 89130-1864	12535416033
PAGADORA FAMILY TRUST	PAGADORA TEDDY M & ROSITA L TRS 2528 S PEPPERDALE DR ROWLAND HEIGHTS CA 91748-4926	13802110111
PALACIOS HERNAN	13607 CULLEN ST WHITTIER CA 90605	13802211010
PALMER CECIL & JOYCE	5800 EMPEROR WY LAS VEGAS NV 89130	13802610029
PALMER JOYCE M & CECIL	5800 EMPEROR WY LAS VEGAS NV 89130-4904	12535416030
PANAMA INVESTORS	6600 HUNTER DR ROHNERT PARK CA 94928-2418	13802214008
PASKO PAULETTE	6304 HILL HAVEN AVE LAS VEGAS NV 89130-2352	13802511039
PATTERSON-WEBB WENDY	WEBB JASON 4797 PENCARROW CT LAS VEGAS NV 89130	13802110025
PEREZ GILBERT L & SANDRA M O	6513 ROMANCE CIR LAS VEGAS NV 89108-5729	13802211008
PERRONI JOSEPH	6504 WHEELBARROW PEAK DR LAS VEGAS NV 89108-5700	13802212002
PICO-PEREZ RICARDO MARTIN	4793 PENCARROW CT LAS VEGAS NV 89130-2372	13802110026
PINHAS TAMIR	6271 VARIEL AVE #C WOODLAND HILLS CA 91367-2516	13802110081
PINTO ALBERT M & MARGARET J	6437 SIERRA DIABLO AVE LAS VEGAS NV 89130-1871	12535416027
PODOLL GARRY G & AMY C	4413 CARIBOU WY LAS VEGAS NV 89108-5707	13802212023
PROGRESS RESIDENTIAL 2014-1 BORR	909 N SEPULVEDA BLVD #840 EL SEGUNDO CA 90245	13802511052
PURCELL FRANCIS A & JOY D DEC TR	PURCELL FRANCIS A JR & JOY D TRS 1850 CRESTVIEW DR PALM SPRINGS CA 92264-2601	13802511019

**Report of All Selected Parcels****Case Number:**

SUP-58561 &amp; SDR-58562

**Printed On:** Thu: March 26, 2015

<b>Owner</b>	<b>Address</b>	<b>Parcel Number</b>
R1 INVESTMENTS L L C	8209 FOOTHILL BLVD #A138 SUNLAND CA 91040	13802110037
RAHE BRUCE E & DEBRA REV LIV TR	RAHE BRUCE E & DEBRA K TRS 7304 BREEZY NIGHT CT LAS VEGAS NV 89129-5972	12535416028
RAINBOW/LEVI L L C	P O BOX 371330 LAS VEGAS NV 89137-1330	13802213015
RAMEY JAMES & DEALINA	6313 W KRAFT AVE LAS VEGAS NV 89130-2357	13802511004
RANCHO & CRAIG L L C	4427 E SUNSET RD HENDERSON NV 89014-2265	13802213008
RANCHO 888 L L C	P O BOX 65157 VANCOUVER WA 98665	13802214002
RANCHO LONE MOUNTAIN L L C	9075 W DIABLO DR 3RD FLR LAS VEGAS NV 89148	13802102014
RANCHO LONE MTN MINI STORAGE LLC	9040 W EL CAMPO GRAND LAS VEGAS NV 89149-3319	13802111003
RANCHO PINES BUSINESS PARK L L C	13949 VENTURA BLVD #300 SHERMAN OAKS CA 91423	13802214012
RANCHO REFLECTIONS L L C	4553 N RANCHO DR LAS VEGAS NV 89130-3403	13802202016
RANDALL RICHARD R & B REV LIV TR	RANDALL RICHARD R & BARBARA TRS 4800 STORM MOUNTAIN ST LAS VEGAS NV 89130-1872	12535416037
RAYNER ELMO JR & JO ANNE R	6600 PAINTED DESERT DR LAS VEGAS NV 89108-5718	13802201006
REEDER CHARLES T & VEANNE M	6265 HILL HAVEN AVE LAS VEGAS NV 89130-2347	13802511057
REZENDE MARCIO	REZENDE FLAVIO & ELAINE 6268 HILL HAVEN AVE LAS VEGAS NV 89130-2346	13802511033
RICEBERG FAMILY REV LIV TR AGMT	RICEBERG HARVEY B & JANIS L TRS 2289 TURNER FALLS ST HENDERSON NV 89044-1041	13802110048
RICH BRAXTON R & BETTRICE E	6512 W PAINTED DESERT DR LAS VEGAS NV 89108-5753	13802201007
RICHARDS RODNEY E	4789 PENCARROW CT LAS VEGAS NV 89130-2372	13802110027
RIGGS CHARLES M & CONNIE M	6524 WHEELBARROW PEAK DR LAS VEGAS NV 89108-5700	13802211004
RIVERA LUIS A & ANGELA M	12819 RIVERSIDE DR #316 VALLEY VILLAGE CA 91607	13802110030
ROBERTS RICHARD	6501 SIERRA DIABLO AVE LAS VEGAS NV 89130-1867	12535415056
RODRIGUEZ ANTONIO	17749 CALCUTTA ST LA PUENTE CA 91744-5315	13802110029
ROMANCE L L C	2112 45TH RD LONG ISLAND CITY NY 11101	13802211007
ROMERO GABRIEL & MARIA	6313 HILL HAVEN AVE LAS VEGAS NV 89130-2353	13802511048
ROSEMILT INVESTMENTS L L C	282 N SALTAIR AVE LOS ANGELES CA 90049	13802511037
ROY MARY ANN	6508 WHEELBARROW PEAK DR LAS VEGAS NV 89108-5700	13802212001
RUSSELL RICHARD & FELECIA REV TR	RUSSELL RICHARD D & FELECIA TRS 20302 TIMBERED ESTATES CARLINVILLE IL 62626-3943	13802610005
RUSSELL THEODORE EVELYN	6309 HILL HAVEN AVE LAS VEGAS NV 89130	13802511049
S F R 2012-1 U S WEST L L C	325 NORTH LOS ROBLES AVE 4TH FLR MAILSTOP 100 PASADENA CA 91101-1707	13802110019
SAIZ ROBERTA	6417 SIERRA DIABLO AVE LAS VEGAS NV 89130-1864	12535416032
SALZANO SERGIO & CHERYL FAM TR	SALZANO SERGIO TRS 4935 BACKHORN BUTTE CT LAS VEGAS NV 89149-5259	13802214013
SANCHEZ EVETTE	4765 PRIORY GARDENS ST LAS VEGAS NV 89130	13802110103
SARDINAS UBALDO JR	6281 W LONE MOUNTAIN RD LAS VEGAS NV 89130-2101	13802501006

**Report of All Selected Parcels****Case Number:**

SUP-58561 &amp; SDR-58562

**Printed On:** Thu: March 26, 2015

<u>Owner</u>	<u>Address</u>	<u>Parcel Number</u>
SAVILLE COURT TRUST	BAHAR SANDS L L C TRS 10001 PEACE WAY #2345 LAS VEGAS NV 89147	13802110089
SCHERADO K W JR & P A REV LIV TR	SCHERADO KENNETH W JR & P A TRS 6301 W LONE MOUNTAIN RD LAS VEGAS NV 89130-2117	13802501005
SEARS ROBEY T & CAROLE J	6417 DOBY PEAK DR LAS VEGAS NV 89108-5724	13802212049
SETSUMASA AYAKO	6488 ABBOTSFORD HOUSE CT LAS VEGAS NV 89130-2308	13802110122
SFONDILIAS BARBARA REV LIV TR	SFONDILIAS BARBARA J TRS 6304 SIERRA PINES CT LAS VEGAS NV 89130-2341	13802610008
SHAO RONG	521 PORPOISE BAY TERR #A SUNNYVALE CA 94089	13802110101
SHEPPARD BERNICE L	6309 W KRAFT AVE LAS VEGAS NV 89130-2357	13802511005
SILVER SUNSET IV L L C	PHETS L L C 1611 SPRINGGATE LN #371632 LAS VEGAS NV 89137	13802110085
SINGH AMRIK & MANINDER K	WESTWOOD STORAGE L L C 1469 MIDNIGHT COWBOY CT LAS VEGAS NV 89110	13802101006
SINGH GURDEV	SINGH KARAMJIT P O BOX 95664 LAS VEGAS NV 89193-5664	13802501001
SINN RICHARD & SOPHEA	24647 STONEGATE DR WEST HILLS CA 91304-5273	13802110012
SLUSHER LOUISE R	BOYCE STACY 3221 E JANICE ST LONG BEACH CA 90805	13802110095
SMITH DAVID M	4417 CARIBOU WY LAS VEGAS NV 89108-5707	13802212022
SOSA CHRISTINA R	4766 PRIORY GARDENS ST LAS VEGAS NV 89130-2309	13802110064
SOUTHWEST COLLEGE	2121 W GARVEY AVE N WEST COVINA CA 91790	13802113001
SPIGEL KIRA D	4758 PRIORY GARDENS ST LAS VEGAS NV 89130-2309	13802110066
STAJKOWSKI BRIAN D	4782 PRIORY GARDENS ST LAS VEGAS NV 89130-2310	13802110061
STANLEY JOSEPH R & CHARLOTTE L	6328 SIERRA PINES CT LAS VEGAS NV 89130-2343	13802610002
STAPLES EUGENE G	HOFHEINS PAMELA D 6273 CHIMNEY WOOD AVE LAS VEGAS NV 89130-2345	13802511024
STARBIRD ROBERT D & KAREN A	6500 WHEELBARROW PEAK DR LAS VEGAS NV 89108-5700	13802212003
STEIB KENNETH & NANCY	P O BOX 1231 PAHRUMP NV 89041-1231	13802212014
STONE JOSEPH R & DANA L	6272 HILL HAVEN AVE LAS VEGAS NV 89130-2346	13802511034
STONE RANDALL G & STACIE R	6274 W KRAFT AVE LAS VEGAS NV 89130-2354	13802512009
STRAUB ARACELI C	6524 ROMANCE CIR LAS VEGAS NV 89108-5729	13802211012
STROUP ROBERT A & BETTY H REV TR	STROUP ROBERT A & BETTY H TRS 6517 PAINTED DESERT DR LAS VEGAS NV 89108-5754	13802202006
SULEWSKI KRZYSZTOF	210 8TH AVENUE S EDMONDS WA 98020-3430	13802110086
SUMMERS FAMILY TRUST	SUMMERS CHARLES D & CAROLE H TRS 12429 PINE CREEK RD CERRITOS CA 90703-2044	13802110078
SWAIN JOSEPH M	CRAWFORD MIA 4753 MUNSTEAD WOODS CT NORTH LAS VEGAS NV 89130-2358	13802110088
SWALLEY LEAH	1376 EUROPEAN DR HENDERSON NV 89052	13802110077
SWAN DEVIN S & SALLY A	6521 ROMANCE CIR LAS VEGAS NV 89108-5729	13802211006
SWIFT ANDREW L	6309 SIERRA PINES CT LAS VEGAS NV 89130-2344	13802610031
SZVOREN THOMAS M & ANH T	6313 CHIMNEY WOOD AVE LAS VEGAS NV 89130-2351	13802511018

**Report of All Selected Parcels****Case Number:**

SUP-58561 &amp; SDR-58562

**Printed On:** Thu: March 26, 2015

<b><u>Owner</u></b>	<b><u>Address</u></b>	<b><u>Parcel Number</u></b>
TADLOCK JOSEPH A & SHARON L	6440 DOBY PEAK DR LAS VEGAS NV 89108-5723	13802212062
TAITZ BARRY	170 S GREEN VALLEY PKWY #300 HENDERSON NV 89012	13802110018
TANCREDI LORETTA J TRUST	TANCREDI LORETTA J TRS 6304 CHIMNEY WOOD AVE LAS VEGAS NV 89130-2351	13802511009
TANKERSLEY ALICE M	6424 WHEELBARROW PEAK DR LAS VEGAS NV 89108-5715	13802212008
TAYLOR JOHN DAVID FAMILY TRUST	TAYLOR JOHN D & ELAINE B CO-TRS 6505 SIERRA DIABLO AVE LAS VEGAS NV 89130-1867	12535415055
TECSON JOHN ANTHONY & BEDA	4746 MUNSTEAD WOODS CT LAS VEGAS NV 89130-2358	13802110087
TERRY STEVEN M & EVANGELINE S	6270 W KRAFT AVE LAS VEGAS NV 89130-2354	13802512008
THAM LONNY DUN & JENNY C	1921 VIOLA CT WEST COVINA CA 91792-2347	13802212064
THORNTON-KNIGHT BRIDGET R	KNIGHT WILLIAM M 1744 EVENING BLUFF PL NORTH LAS VEGAS NV 89084-2022	13802110115
TO MARGARET	4773 MEREWORTH CT LAS VEGAS NV 89130-2367	13802110046
TOBLER H ANTHONY & SHEILA	6269 CHIMNEY WOOD AVE LAS VEGAS NV 89130-2345	13802511025
TONOPAH-CRAIG ROAD CO L L L P	26135 MUREAU RD #200 CALABASAS CA 91302-3185	13802204001
TONOPAH-CRAIG ROAD CO L L L P	26135 MUREAU RD #200 CALABASAS CA 91302-3185	13802601002
TONOPAH-CRAIG ROAD CO L L L P	26135 MUREAU RD #200 CALABASAS CA 91302-3185	13802601001
TORREY PINES PROPERTIES L L C	P O BOX 71163 SALT LAKE CITY UT 84171-0163	13802102013
TREXLER MARK B & SARAH B	6312 SIERRA PINES CT LAS VEGAS NV 89130-2343	13802610006
VALADEZ JOSE F	ESCOTO AZUCENA 6333 SIERRA PINES CT LAS VEGAS NV 89130	13802610037
VANGORDER JOHN E JR & LINDA J	6305 KRAFT AVE LAS VEGAS NV 89130-2357	13802511006
VARNEY DEANNE L	WARREN TERRY E 6269 HILL HAVEN AVE LAS VEGAS NV 89130-2347	13802511056
VAUGHAN EVAN	4721 TRIMWATER CT LAS VEGAS NV 89130-2305	13802512006
VICTORIANO ELSIE B & WILSON	4797 GREENCOMBE LAS VEGAS NV 89130-2368	13802110013
VOORHEES MICHAEL STEVEN	4710 TRIMWATER CT LAS VEGAS NV 89130	13802512004
WADSWORTH DANIEL	4429 LOOKOUT PEAK WY LAS VEGAS NV 89108-5720	13802212012
WALKENSHAW SANDY L	6512 ROMANCE CIR LAS VEGAS NV 89108-5729	13802211009
WARD MARTY	7038 DE CELIS PL #33 VAN NUYS CA 91406-3766	13802110045
WATTS DONYE	4766 SAVILLE GARDEN CT LAS VEGAS NV 89130-2360	13802110092
WEILAND ALEXANDER	6324 CHIMNEY WOOD AVE LAS VEGAS NV 89130-2351	13802511014
WHITT RENAE D	CARTER ROBYN L 4790 GREENCOMBE CT LAS VEGAS NV 89130-2368	13802110016
WIESNER SURVIVORS TRUST	WIESNER LYNN TRS 4547 N RANCHO DR #A LAS VEGAS NV 89130-3432	13802202012
WIESNER SURVIVORS TRUST	WIESNER LYNN TRS 4547 N RANCHO DR #A LAS VEGAS NV 89130-3432	13802202014
WIESNER SURVIVORS TRUST	WIESNER LYNN TRS 4547 N RANCHO DR #A LAS VEGAS NV 89130-3432	13802202013
WILLIAMS CLARENCE R & DEBORAH S	6488 ARBURY HALL CT LAS VEGAS NV 89130-2307	13802110116

**Report of All Selected Parcels****Case Number:**

SUP-58561 &amp; SDR-58562

**Printed On:** Thu: March 26, 2015

<u>Owner</u>	<u>Address</u>	<u>Parcel Number</u>
WILLIAMS FAMILY TRUST	WILLIAMS DOROTHY L TRS 6500 DOBY PEAK LAS VEGAS NV 89108-5708	13802212061
WILLIAMS G A & E F REV LIV TR	WILLIAMS GEORGE A & ESTHER F TRS 6244 SIERRA PINES CT LAS VEGAS NV 89130-2341	13802610010
WILLIAMS G A & E F REV LIV TR	WILLIAMS GEORGE A & ESTHER F TRS 6244 SIERRA PINES CT LAS VEGAS NV 89130-2341	12535416014
WILLIS LIVING TRUST	WILLIS KENNETH S TRS 23618 PARKLAND AVE MORENO VALLEY CA 92557	13802610034
WINN GALEN & JULIE	6320 HILL HAVEN AVE LAS VEGAS NV 89130-2352	13802511043
WYATT KEITH ALLEN & JULIE L	6441 WHEELBARROW PEAK DR LAS VEGAS NV 89108-5727	13802212074
WYATT LEWIN JR & LILLIE LIV TR	6445 SIERRA DIABLO AVE LAS VEGAS NV 89130-1871	12535416025
XI WENSI	SHAO RONG 521 PORPOISE BAY TER #A SUNNYVALE CA 94089	13802110079
XIE WEI	3 CHATEAU CT DANVILLE CA 94506-4659	13802110047
YAKOUBOFF BIJAN	2706 ASHBY AVE LAS VEGAS NV 89102-2135	13802610012
YERANOSIAN TOROS	5115 COLLETE AVE ENCINO CA 91436-1420	13802102004
ZACHERO ROBERT	6425 DOBY PEAK DR LAS VEGAS NV 89108-5724	13802212051
ZHANG BAOLING	5336 TOLEDO WAY FONTANA CA 92336-5925	13802110056