

City of Las Vegas  
Department of Planning  
Development Services Center  
333 North Rancho Drive, 3<sup>rd</sup> Floor  
Las Vegas, Nevada 89106

### Return Service Requested Official Notice of Public Hearing

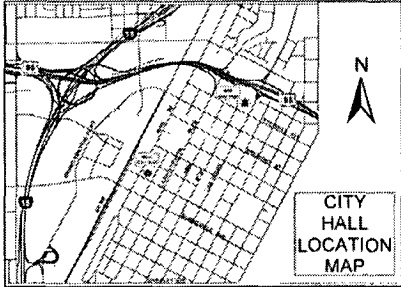

If you wish to file your protest or support on this request, check the appropriate box below and return this card in an envelope with postage to the Department of Planning at the address listed above, fax this side of this card to (702) 464-7499 or make your comments at [www.lasvegasnevada.gov](http://www.lasvegasnevada.gov). If you would like to contact your Council Representative, please call (702) 229-6405.

I SUPPORT  
this Request

I OPPOSE  
this Request

Please use available blank space on card for your comments.

**SUP-55639 [PRJ-55628]**

Planning Commission Meeting of 10/14/2014

## Application Information

**SUP-55639 - SPECIAL USE PERMIT - PUBLIC HEARING - APPLICANT: NEVADA HEALTH CENTERS, INC. - OWNER: CONSTANTINO NOVAL NEVADA 2, LLC** - For possible action on a request for a Major Amendment to an approved Special Use Permit (SUP-25366) FOR A PROPOSED 2,357 SQUARE-FOOT EXPANSION TO AN EXISTING 1,840 SQUARE-FOOT SOCIAL SERVICE PROVIDER USE at 5001 East Bonanza Road, Suite #104 (APN 140-32-502-003), C-1 (Limited Commercial) Zone, Ward 3 (Coffin) [PRJ-55628].

## Application Location

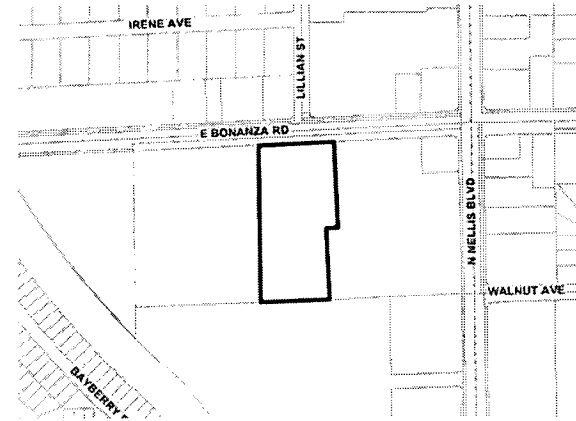

The proposed project may not pertain to the entire highlighted project site.

## Public Hearing Information

**Meeting:** Planning Commission  
**Date:** *October 14, 2014*  
**Time:** 6:00 P.M.  
**Location:** City Council Chambers  
495 South Main Street, 2<sup>nd</sup> Floor  
Las Vegas, Nevada 89101

Any and all interested persons may appear before the City Planning Commission either in person or by representative and object to or express approval of this request; or may, prior to this meeting, file a written objection thereto or approval thereof with the Department of Planning, Development Services Center, 333 North Rancho Drive, 3<sup>rd</sup> Floor, Las Vegas, Nevada 89106. Final Action on General Plan Amendments and Rezoning will be determined by the City Council. Other public hearing items may be deemed Final Action by the Planning Commission or forwarded to the City Council. The date of the City Council meeting, if applicable, will be announced at the Planning Commission meeting after the discussion of the item. For further information, including the full staff report, please call (702) 229-6301 (TDD 386-9108) or go to <http://www.lasvegasnevada.gov>.

**Report of All Selected Parcels****Case Number:** SUP-55639**Printed On:** Tue: August 26, 2014

<b>Owner</b>	<b>Address</b>	<b>Parcel Number</b>
4869 IRENE AVE TRUST	4869 IRENE AVE LAS VEGAS NV 89110-2408	14029810011
7-ELEVEN INC	P O BOX 711 DALLAS TX 75221-0711	14029802011
A R M S GROUP L L C	2380 N GATEWAY RD LAS VEGAS NV 89115	14033101013
ACEVEDO ADRIAN	516 BAYBERRY DR LAS VEGAS NV 89110-3460	14032515029
AGUAYO RAMON	532 BAYBERRY DR LAS VEGAS NV 89110-3462	14032515037
ALECO ENTERPRISES INC	12111 LA CASA LN LOS ANGELES CA 90049-1529	14029802009
ALECO ENTERPRISES INC	12111 LA CASA LN LOS ANGELES CA 90049-1529	14029802006
ALECO ENTERPRISES INC	12111 LA CASA LN LOS ANGELES CA 90049-1529	14029802007
ALECO ENTERPRISES INC	12111 LA CASA LN LOS ANGELES CA 90049-1529	14029802008
ALEXANDER MARK ALAN & ALMA N	317 DERWYN RD LANSLOWNE PA 19050-1027	14032515004
ARCHULETA GENARO	QUINTANA YOLANDA 4904 MONTEBELLO AVE LAS VEGAS NV 89110-3518	14032611003
ARELLANO JOSE JESUS	4831 LANCEWOOD AVE LAS VEGAS NV 89110-3451	14032514025
ARGUMEDO ISABEL	QUIROZ JOSE LUIS 528 BAYBERRY DR LAS VEGAS NV 89110-3460	14032515035
AVALOS MARTHA	531 BAYBERRY DR LAS VEGAS NV 89110-3464	14032515006
BARAJAS ROBERTO	4828 MONTEBELLO AVE LAS VEGAS NV 89110-3555	14032610018
BARELA RICHARD J	4956 IRENE AVE LAS VEGAS NV 89110-2446	14029810021
BARG DANIEL L & THERESA E	4992 NETTIE AVE LAS VEGAS NV 89110-2414	14029810041
BARRON JESSY	517 BAYBERRY DR LAS VEGAS NV 89110-3461	14032515013
BEFFERMAN AARON H & DODI S	509 BAYBERRY DR LAS VEGAS NV 89110-3459	14032515017
BONANZA SPRINGS L L C	494 SPANISH VIEW LN LAS VEGAS NV 89110	14032502002
BONANZA SUNRISE L L C	9220 CATHWELL LN TUJUNGA CA 91042-3321	14029801011
BRITOS BRUCE & COLLEEN	4905 NETTIE AVE LAS VEGAS NV 89110-2415	14029810035
BROWN DAVID R & DAVID ROBERT	1011 MORNING SUN CT LAS VEGAS NV 89110-2929	14029801010
C A H 2014-1 BORROWER L L C	9305 VIA DE VENTURA #201 SCOTTSDALE AZ 85258	14032515010
C F T-T C C NELLIS L L C	1683 WALNUT GROVE AVE ROSEMEAD CA 91770-3711	14032517003
C F T-T C C NELLIS L L C	1683 WALNUT GROVE AVE ROSEMEAD CA 91770-3711	14032517001
CARDENAS JUAN	49 PRINCE LN LAS VEGAS NV 89110-4536	14032515005
CARRILLO ANGELINA CARRILLO	518 BAYBERRY DR LAS VEGAS NV 89110-3460	14032515030
CAZARES JOEL & EVA M	8620 W FORD AVE LAS VEGAS NV 89148	14032514021
CHAVEZ GABRIELA	68217 CALLE CERRITO DESERT HOT SPRING CA 92240-6427	14032515040
CHAVEZ SERGIO	1742 LUCKY ST LAS VEGAS NV 89104-5433	14032611008
CHRISTY ELENA	4839 LANCEWOOD LAS VEGAS NV 89110-3451	14032515027

**Report of All Selected Parcels****Case Number:** SUP-55639**Printed On:** Tue: August 26, 2014

<u>Owner</u>	<u>Address</u>	<u>Parcel Number</u>
CLARK CONCEPCION	527 BAYBERRY DR LAS VEGAS NV 89110-3461	14032515008
COBIAN-OSORIO LUZ M	COBIAN-MICHEL GILBERTO 4849 LANCEWOOD AVE LAS VEGAS NV 89110-3452	14032515022
CONSTANTINO NOVAL NEVADA 2 L L C	2500 W SAHARA AVE #211 LAS VEGAS NV 89102-4393	14032502004
CONSTANTINO NOVAL NEVADA 2 L L C	2500 W SAHARA AVE #211 LAS VEGAS NV 89102-4393	14032502003
CORRAL PILAR LEYVA	4938 IRENE AVE LAS VEGAS NV 89110-2446	14029810022
COSPER WALTER H & SUSAN E	4956 NETTIE AVE LAS VEGAS NV 89110-2414	14029810043
COTA MANUEL & MARTINA	420 OAKFORD ST LAS VEGAS NV 89110-3550	14032611062
CRUZ MEACHELL P	1116 BARRON CREEK DR NORTH LAS VEGAS NV 89081-2972	14032514012
DELGADO HUMBERTO & VIRGINIA	413 OAKFORD ST LAS VEGAS NV 89110-3551	14032611009
DOWNEAST L L C	5245 E BONANZA RD LAS VEGAS NV 89110-3601	14033101004
ECONO LUBE N'TUNE REALTY L L C	440 S CHURCH ST #700 CHARLOTTE NC 28202	14028410009
FEDERAL NATIONAL MORTGAGE ASSN	14523 SW MILIKAN WY #200 P O BOX 4128 BEAVERTON OR 97005	14032515012
FISHER JASON D & CHRISTY L	3637 BADURA AVE LAS VEGAS NV 89118-5211	14032515009
GALINDO SIGIFREDO	4949 IRENE AVE LAS VEGAS NV 89110-2445	14029810016
GARCIA LUIS	DIAKONOS HOLDINGS L L C TRS 725 DAMON DR LAS VEGAS NV 89110	14033110002
GARCIA MARGARITO & ROSA E	543 BAYBERRY DR LAS VEGAS NV 89110	14032512021
GARCIA MARLENE	VALDEZ JAVIER J 4869 NETTIE AVE LAS VEGAS NV 89110-2418	14029810033
GEX JOHN & REINA	4902 IRENE AVE LAS VEGAS NV 89110-2446	14029810024
GINES SERGIO & ANGELA	1994 LAVANTE AVE LAS VEGAS NV 89109	14029810017
GOMEZ ALFRED	4845 LANCEWOOD AVE LAS VEGAS NV 89110-3452	14032515024
GONZALEZ ANAVEY	6238 BERRY PATCH WY LAS VEGAS NV 89142-0969	14033110005
GRIFFIN THOMAS M & CLARICE J	4995 NETTIE AVE LAS VEGAS NV 89110-2415	14029810040
GUERRA HERMOGENES & MARIA M	7349 RIVERTON AVE SUN VALLEY CA 91352-5123	14032512024
GUEVARA ENRIQUE	4887 NETTIE AVE LAS VEGAS NV 89110-2418	14029810034
GURNEY NOEL	5212 JEFF DR LAS VEGAS NV 89110-3618	14033110006
GUTIERREZ EDUARDO	821 UTE LN #B LAS VEGAS NV 89110-2573	14028410013
GUZMAN SULEMA C	4848 IRENE AVE LAS VEGAS NV 89110-2409	14029810027
HALLE PROPERTIES L L C	20225 N SCOTTSDALE RD SCOTTSDALE AZ 85255	14028410007
HALLE PROPERTIES L L C	DEPT 1100 NVL07 20225 N SCOTTSDALE RD SCOTTSDALE AZ 85255-6456	14028410006
HAU PHUONG HUE	515 BAYBERRY DR LAS VEGAS NV 89110-3461	14032515014
HERMAN-DECKER FAMILY TRUST	HERMAN MAYNARD E TRS 541 BAYBERRY DR LAS VEGAS NV 89110-3464	14032515001
HERNANDEZ IRENE	425 OAKFORD ST LAS VEGAS NV 89110-3551	14032611006

**Report of All Selected Parcels****Case Number:** SUP-55639**Printed On:** Tue: August 26, 2014

<u>Owner</u>	<u>Address</u>	<u>Parcel Number</u>
HERNANDEZ MARTIN	BANUELOS GUADALUPE 4884 IRENE AVE LAS VEGAS NV 89110-2409	14029810025
HERNANDEZ-MALDONADO J GABRIEL	4977 NETTIE AVE LAS VEGAS NV 89110-2415	14029810039
HICKS MEGAN	2403 WILLOWBY DR HOUSTON TX 77008-3058	14032515002
HIGH VALLEY II L L C	1755 E MARTIN LUTHER KING JR LOS ANGELES CA 90058-1522	14033102002
HOGAN CAIL LIVING TRUST	HOGAN CAIL TRS 5175 E BONANZA LAS VEGAS NV 89110-3601	14033101005
HOLT JACKY D JR & VALERIE N	4910 E BONANZA LAS VEGAS NV 89110-3505	14029801008
HORTA JOSE & JUANA MARIA	4941 NETTIE AVE LAS VEGAS NV 89110-2415	14029810037
HORTA JUANA & ANGELICA M	4941 NETTIE AVE LAS VEGAS NV 89110	14029810036
I Q REALTY L L C	2893 SENTER RD #A SAN JOSE CA 95111-1161	14032515034
JOHNSTON JUDY A	4974 IRENE AVE LAS VEGAS NV 89110-2446	14029810020
JONES CATHERINE L	505 BAYBERRY DR LAS VEGAS NV 89110-3459	14032515019
JONES FAYEANN F & FRANCIS E	501 BAYBERRY DR LAS VEGAS NV 89110-3459	14032515021
KENNEDY JOSEPH W III	524 BAYBERRY DR LAS VEGAS NV 89110-3460	14032515033
KERSELL CHRISTINE TRUST	KERSELL CHRISTINE TRS 530 BAYBERRY DR LAS VEGAS NV 89110-3462	14032515036
KLAUMENZER MARK W & DEE A	4851 IRENE AVE LAS VEGAS NV 89110-2408	14029810010
KLAUMENZER THOMAS W & CAMMAE H	4833 IRENE AVE LAS VEGAS NV 89110-2408	14029810009
KLOSSNER CARLTON R	5153 STATE ROUTE 96 ROMULUS NY 14541-9701	14033110001
LAKE MEAD HOSPITAL INC	117 SEABOARD LN BLDG E FRANKLIN TN 37067-2855	14028410005
LANDEROS PAUL MATTHEW	4843 LANCEWOOD AVE LAS VEGAS NV 89110-3451	14032515025
LARSON S FAMILY L P	2950 E FLAMINGO RD #14 LAS VEGAS NV 89121-5209	14032502005
LAS VEGAS LEGACY TRUST	5407 ORINDA AVE LAS VEGAS NV 89120-1770	14033101019
LEIVA JOSE J & ROSA M	4833 LANCEWOOD AVE LAS VEGAS NV 89110-3451	14032514024
LIN GUO WAI & KAM TAO	511 GREASEWOOD DR LAS VEGAS NV 89110-3445	14032514013
LOVATO RICHARD J & NADINE Y	513 BAYBERRY DR LAS VEGAS NV 89110-3459	14032515015
LUTFI ANTON & ANNA	MARONI GREG G & LINDA 2368 MARITIME DR #100 ELK GROVE CA 95758	14028410008
MADRID HECTOR R	4938 NETTIE AVE LAS VEGAS NV 89110-2414	14029810044
MAGANA JOSE LUIS & MAYRA I	4995 IRENE AVE LAS VEGAS NV 89110-2445	14029810018
MARTINEZ ASUCENA	511 BAYBERRY DR LAS VEGAS NV 89110-3459	14032515016
MARTINEZ LORENA P	RODAS-ESCOBAR ELIAS 4941 IRENE AVE LAS VEGAS NV 89110-2445	14029810015
MCDONALD'S U S A L L C	P O BOX 182571 COLUMBUS OH 43218-2571	14028410010
MICHEL LIONEL & GUADALUPE	4912 MONTEBELLO AVE LAS VEGAS NV 89110-3518	14032611005
MIGUEL WILLIAM P	601 S RANCHO DR # A-5 LAS VEGAS NV 89106-4898	14029802005

**Report of All Selected Parcels****Case Number:** SUP-55639**Printed On:** Tue: August 26, 2014

<u>Owner</u>	<u>Address</u>	<u>Parcel Number</u>
MIGUEL WILLIAM P	601 S RANCHO DR A-5 LAS VEGAS NV 89106-4898	14029802003
MILLS SABRINA N	5220 JEFF DR LAS VEGAS NV 89110-3618	14033110007
MONJE ANGELINA	941 W BROADWAY PHOENIX AZ 85041-2304	14029810013
MORALES HUMBERTO E	4103 BALBOA AVE LAS VEGAS NV 89121-1720	14032515023
MORRAS JULIO & MARIA T	4949 NETTIE AVE LAS VEGAS NV 89110-2415	14029810038
NEVADA FEDERAL CREDIT UNION	2645 S MOJAVE RD LAS VEGAS NV 89121-1238	14028410012
NGO GIANG & LIEN CHAU	4897 N LOUIS RIVER WY TUCSON AZ 85718-4757	14032515039
OCHOA FRANCISCO JAVIER	537 BAYBERRY DR LAS VEGAS NV 89110-3464	14032515003
OREGEL CESAR A	2206 LAUREL RIDGE WAY LAS VEGAS NV 89142-1600	14032514023
ORTEGA DENNIS J & CELESTINA	503 BAYBERRY DR LAS VEGAS NV 89110-3459	14032515020
PETO FAMILY TRUST	PETO JEANNE HAM TRS 550 E CHARLESTON BLVD #F LAS VEGAS NV 89104-1303	14033201006
PILA DE ORO L L C	716 VAQUERO DR MOUNTAINVIEW CA 94043-3139	14032514018
PINCKNEY TINISHA L	521 BAYBERRY DR LAS VEGAS NV 89110	14032515011
PINEDA ESEQUIEL	VILLANUEVA FAUSTA PINEDA 4887 IRENE AVE LAS VEGAS NV 89110-2408	14029810012
QUETZAL L L C	1682 MAPLELEAF ST LAS VEGAS NV 89142-1208	14032514014
RAMIREZ CORNELIO	8756 NORRIS AVE SUN VALLEY CA 91352-2719	14032512023
RAMZI & FEBERONIA FAMILY TRUST	GARMO FEBERONIA TRS 2147 DEHESA RD EL CAJON CA 92019-2723	14032517004
RANGEL SERGIO	507 BAYBERRY DR LAS VEGAS NV 89110-3459	14032515018
REALTY INCOME CORPORATION	P O BOX 460069 ESCONDIDO CA 92046-0069	14032601003
REGALDO ANASTASIA	400 OAKFORD ST LAS VEGAS NV 89110-3502	14032610020
REYES HORACIO	URIAS ROSARIO 3705 HUDSON BAY AVE LAS VEGAS NV 89110	14033110003
RINGLER CAROLYN	515 GREASEWOOD DR LAS VEGAS NV 89110-3446	14032514011
RIVERA ALFREDO O	421 GREENBROOK ST LAS VEGAS NV 89110-3516	14032611064
RIVERA YOLANDA M	421 GREENBROOK ST LAS VEGAS NV 89110-3516	14032611063
ROBINSON 1996 TRUST	ROBINSON FRED J & JOELLYN L TRS 6880 E BONANZA RD LAS VEGAS NV 89110-4133	14033101010
RODRIGUEZ JORGE L & MARIA A	4920 IRENE AVE LAS VEGAS NV 89110-2446	14029810023
ROMERO ANGELICA	4974 NETTIE AVE LAS VEGAS NV 89110-2414	14029810042
ROMERO ESTHER PATRICIA	4900 MONTEBELLO AVE LAS VEGAS NV 89110-3518	14032611002
ROSALES SALVADOR & TRINIDAD	ROSALES SALVADOR JR 1358 STACCATO ST HENDERSON NV 89052	14028410015
S & R HOLDING LTD	8645 BERMUDA RD LAS VEGAS NV 89123-3027	14029801009
S A L V L L C	22 N GREENWOOD AVE PASADENA CA 91107-3514	14032515026
S M D R PROPERTIES L P	8150 CENTRAL EXPY #M1008 DALLAS tx 75206	14033101017

**Report of All Selected Parcels****Case Number:** SUP-55639**Printed On:** Tue: August 26, 2014

<u>Owner</u>	<u>Address</u>	<u>Parcel Numbe</u>
S M D R PROPERTIES L P	4541 COMSTOCK RD HOLLISTER CA 95023-9043	14033101018
S S D	750 17TH ST LAS CRUCES NM 88005-4153	14032601002
S S T I 4851 E BONANZA RD L L C	P O BOX 320099 ALEXANDRIA VA 22320-4099	14032502001
SAGI ORTAL	8775 COSTA VERDE BLVD #615 SAN DIEGO CA 92122	14032515038
SALAZAR ROSA	91 DROPLET ST LAS VEGAS NV 89110-5041	14032515028
SANCHEZ-NAVARRO JOSE	4837 LANCEWOOD AVE LAS VEGAS NV 89110-3451	14032514022
SECOND TEXLAND PPTYS CORP	P O BOX 711 DALLAS TX 75221-0711	14033101001
SEVILLA FELIPE	4925 IRENE AVE LAS VEGAS NV 89110-2445	14029810014
SHARIF SIDNEY R	505 GREASEWOOD DR LAS VEGAS NV 89110-3445	14032514016
SILL J STEPHEN & SHIRLENE	491 SPANISH VIEW LAS VEGAS NV 89110-4000	14029801013
SMITH KAREN J	4832 LANCEWOOD AVE LAS VEGAS NV 89110-3449	14032514019
SNIPES CHRISTOPHER C & TAMMI S	520 BAYBERRY DR LAS VEGAS NV 89110-3460	14032515031
SOUTHERN NV HOUSING AUTHORITY	340 N 11TH ST #170 LAS VEGAS NV 89101-3125	14033102003
SOUTHERN NV HOUSING AUTHORITY	340 N 11 ST #170 LAS VEGAS NV 89101-3125	14032610019
STAMPLEY J & HERRON L REV LIV TR	STAMPLEY JAMES W TRS 983 MAJESTIC FALLS LN LAS VEGAS NV 89110	14032514015
SUMMERFIELD MICHAEL V & DEBORAH	4866 IRENE AVE LAS VEGAS NV 89110-2409	14029810026
THOMAS MOKOTA	TROTTER MICHAEL 545 BAYBERRY DR LAS VEGAS NV 89110-3465	14032512022
TORRES JOSE JESUS & MARIA M	1300 HILLSIDE PL LAS VEGAS NV 89104-1835	14028410014
TRAISMAN STEVEN LIVING TRUST	TRAISMAN STEVEN TRS 1675 FILBERT ST SAN FRANCISCO CA 94123-3705	14032612001
VANDRUFF MELISSA	4908 MONTEBELLO AVE LAS VEGAS NV 89110-3518	14032611004
VERDUZCO-GARCIA MARIA	522 BAYBERRY DR LAS VEGAS NV 89110-3460	14032515032
VILLEGAS REFUGIO JR	4834 LANCEWOOD AVE LAS VEGAS NV 89110-3449	14032514020
W R E P II EMERALD L L C	1201 ELM ST #1600 DALLAS TX 75270	14032601001
W R E P II SPRINGS L L C	%J BLACK 6720 E CAMELBACK RD #100 SCOTTSDALE AZ 85251-2015	14032516305
WAGNER BRUCE ELWIN REVOCABLE TR	WAGNER BRUCE ELWIN TRS 4992 IRENE AVE LAS VEGAS NV 89110-2446	14029810019
WAY RICK D & ROBERTA M	741 DAMON DR LAS VEGAS NV 89110-3611	14033110004
WILLIAMS GREG	VALLETTE WILLIAM 421 OAKFORD ST LAS VEGAS NV 89110-3551	14032611007
XA HAI & CHAU AITIEN H LIV TR	XA HAI TRS 893 S RAINBOW BLVD LAS VEGAS NV 89145	14029802010
YUTAN P S & G W 1975 FAM TR AGMT	Y TAX DEPT 401P O BOX 4900SCOTTS ALE AZ 85261-4900	14028410011
ZAMORA ARMANDO	915 SHOREPOINT CT #E101 ALMEDA CA 94501	14032514017
ZAMORA RAMIRO	529 BAYBERRY DR LAS VEGAS NV 89110-3461	14032515007