

City of Las Vegas
Department of Planning
Development Services Center
333 North Rancho Drive, 3rd Floor
Las Vegas, Nevada 89106

Return Service Requested Official Notice of Public Hearing

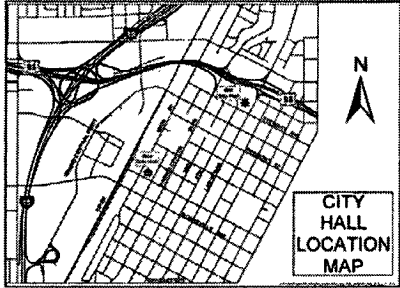

If you wish to file your protest or support on this request, check the appropriate box below and return this card in an envelope with postage to the Department of Planning at the address listed above or fax this side of this card to (702) 464-7499. If you would like to contact your Council Representative, please call (702) 229-6405.

I SUPPORT
this Request

I OPPOSE
this Request

Please use available blank space on card for your comments.

SUP-51703 & SDR-51704 [PRJ-51218]

Planning Commission Meeting of **12/10/2013**

Application Information

SUP-51703 - SPECIAL USE PERMIT - PUBLIC HEARING - APPLICANT: RARE HOSPITALITY MANAGEMENT, INC. - OWNER: INLAND DIVERSIFIED LAS VEGAS CENTENNIAL CENTER, LLC - For possible action on a request for a Special Use Permit FOR A PROPOSED SUPPER CLUB at the southeast corner of Azure Drive and Centennial Center Boulevard (APN 125-28-610-005), T-C (Town Center) Zone [GC-TC (General Commercial - Town Center) Special Land Use Designation], Ward 6 (Ross) [PRJ-51218].

SDR-51704 - SITE DEVELOPMENT PLAN REVIEW RELATED TO SUP-51703 - PUBLIC HEARING - APPLICANT: RARE HOSPITALITY MANAGEMENT, INC. - OWNER: INLAND DIVERSIFIED LAS VEGAS CENTENNIAL CENTER, LLC - For possible action on a request for a Site Development Plan Review FOR A PROPOSED 6,233 SQUARE-FOOT RESTAURANT WITH A WAIVER OF THE TOWN CENTER DEVELOPMENT STANDARDS TO ALLOW THE RESTAURANT TO BE LOCATED AWAY FROM PUBLIC RIGHTS-OF-WAY on a portion of 4.14 acres at the southeast corner of Azure Drive and Centennial Center Boulevard (APN 125-28-610-005), T-C (Town Center) Zone [GC-TC (General Commercial - Town Center) Special Land Use Designation], Ward 6 (Ross) [PRJ-51218].

Any and all interested persons may appear before the City Planning Commission either in person or by representative and object to or express approval of this request; or may, prior to this meeting, file a written objection thereto or approval thereof with the Department of Planning, Development Services Center, 333 North Rancho Drive, 3rd Floor, Las Vegas, Nevada 89106. Final Action on General Plan Amendments and Rezonings will be determined by the City Council. Other public hearing items may be deemed Final Action by the Planning Commission or forwarded to the City Council. The date of the City Council meeting, if applicable, will be announced at the Planning Commission meeting after the discussion of the item. For further information, including the full staff report, please call (702) 229-6301 (TDD 386-9108) or go to <http://www.lasvegasnevada.gov>.

Application Location

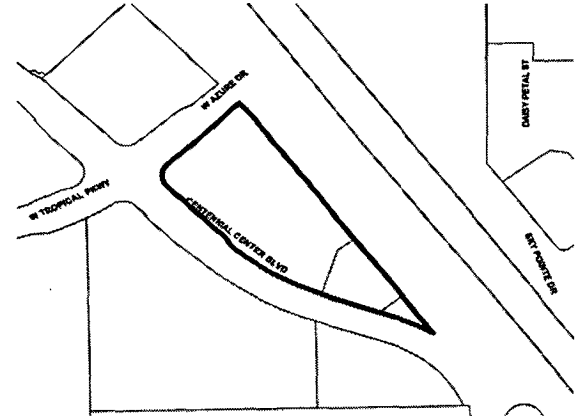

The proposed project may not pertain to the entire highlighted project site.

Public Hearing Information

Meeting: Planning Commission
Date: *December 10, 2013*
Time: 6:00 P.M.
Location: City Council Chambers
495 South Main Street
Las Vegas, Nevada

Report of All Selected Parcels**Case Number:** SUP-51703**Printed On:** Mon: October 28, 2013

<u>Owner</u>	<u>Address</u>	<u>Parcel Number</u>
		12527114000
		12527313000
		12527219000
		12527216000
2012-C PROPERTY HOLDINGS L L C	%COSTELLO REALTY & MGT 9406 W LAKE MEAD BLVD #101 LAS VEGAS NV 89134-8331	12527217039
7513 BOWLES TRUST	BALLANTYNE S D TRS P O BOX 762 MANHATTAN BEACH CA 90267-0762	12527212031
A R P PHOENIX FUND I LP	7047 E GREENWAY PKWY #350 SCOTTSDALE AZ 85254-8117	12527217008
ADELMAN FAMILY TRUST	ADELMAN ALAN N & EDA A TRS 9617 BENAVENTE ST SAN DIEGO CA 92129-3003	12527217024
AFFLECK SPENCER	530 WILDE CHERRY AVE SANDY UT 84070-5922	12528710051
ALLEN KATHERINE	7712 PINE FALLS DR LAS VEGAS NV 89149-5159	12528815015
ALVAREZ LUISTO & EVANGELINA	7841 BLUE CHARM AVE LAS VEGAS NV 89149-5105	12528710060
AMATO ANTHONY & DEBORAH E	7509 HEATHER KNOLL CIR LAS VEGAS NV 89129-5975	12527217002
ANTHONY DENISE	7520 JOCKEY AVE LAS VEGAS NV 89130-1095	12527217006
ARANTE GERRY & HOPE G	7520 HICKORY HILLS DR LAS VEGAS NV 89130-1055	12527212028
ASSAD EMAN & MARHEJ	5744 DESERT SKY WY LAS VEGAS NV 89149-5130	12528812012
ATLAS WILFRED S	7872 MARCH BROWN AVE LAS VEGAS NV 89149-5188	12528712011
BALUYUT PAULO MARIA S & MARIA R	7521 HICKORY HILLS DR LAS VEGAS NV 89130-1056	12527212018
BANDA RAUL	55 SAHALEE DR LAS VEGAS NV 89148-2713	12527217014
BANJAC VOJISLAV & KATHLEEN L	2213 5TH AVE SAN DIEGO CA 92101-2103	12527217023
BARAJAS YOLIA A	6029 PEBBLE GREY LN LAS VEGAS NV 89130-7907	12527217012
BARRAZA FELICIA	7536 MAIDEN RUN AVE LAS VEGAS NV 89130-7931	12527217032
BATAC VIRGINIA P LIVING TRUST	BATAC VIRGINIA P TRS 7412 MAIDEN RUN AVE LAS VEGAS NV 89130-1057	12527218009
BAUMEISTER ROSEMARY & JOHN E	7836 MARCH BROWN AVE LAS VEGAS NV 89149-5181	12528712020
BEEN PATRICIA TRUST	BEEN PATRICIA TRS 7853 MARCH BROWN AVE LAS VEGAS NV 89149-5187	12528712035
BENNETT LESTER J JR	7501 BOWLES DR LAS VEGAS NV 89130-1069	12527212034
BERGGREN JACK D & DONNA L	7812 QUILL GORDON AVE LAS VEGAS NV 89149-5165	12528710033
BIRMINGHAM THOMAS J & CLARE D	3940 SCOTT ROBINSON BLVD #1120 NO LAS VEGAS NV 89032-7876	12528710046
BOEGLIN BRUCE & ADA	P O BOX 17612 PORTLAND OR 97217-0612	12528712031
BOOTS FAMILY REVOCABLE LIVING TR	BOOTS CONRAD E & BARBARA A TRS 9733 COFFEE AVE LAS VEGAS NV 89147-8237	12528712008
BOYD LIVING TRUST	BOYD RAYMOND D & DOROTHY CO-TRS 7828 BLUE CHARM AVE LAS VEGAS NV 89149-5164	12528710044
BRAMBLEY NELSON A	SANCHEZ-BRAMBLEY LINDA A 7528 MAIDEN RUN AVE LAS VEGAS NV 89130-7931	12527217030
BUCKNER VICKIE L	7421 JOCKEY AVE LAS VEGAS NV 89130-1071	12527220009

Report of All Selected Parcels**Case Number:** SUP-51703**Printed On:** Mon: October 28, 2013

<u>Owner</u>	<u>Address</u>	<u>Parcel Number</u>
BUTTA MICHAEL A & CHRISTIANE	7637 RAVEN HILLS DR LAS VEGAS NV 89149-5129	12528812044
CAO THANH VAN	BACH KIM TIEN 2836 PLUMAS DR SAN JOSE CA 95121-2343	12527212016
CAPITOLA L L C	4224 W CHARLESTON #185 LAS VEGAS NV 89102-1625	12527212008
CAPPS JONATHAN & LORI	1929 GROVESPRING ST LAS VEGAS NV 89135-1085	12527218003
CARLISLE CHARLES C	7841 MARCH BROWN AVE LAS VEGAS NV 89149-5187	12528712032
CARRANZA CYNTHIA D	7416 MAIDEN RUN AVE LAS VEGAS NV 89130-1057	12527218008
CENTENNIAL 2009 L P	%M DANIELPOUR 9420 WILSHIRE BLVD #400 BEVERLY HILLS CA 90212-3151	12527411007
CENTENNIAL 2009 L P	%M DANIELPOUR 9420 WILSHIRE BLVD #400 BEVERLY HILLS CA 90212-3151	12527411014
CENTENNIAL CENTRE L L C	%TERRITORY INC 5785 CENTENNIAL CENTER BLVD #230 LAS VEGAS NV 89149-7109	12528701005
CENTENNIAL CENTRE L L C	%TERRITORY INC 5785 CENTENNIAL CENTER BLVD #230 LAS VEGAS NV 89149-7109	12528713004
CENTENNIAL-AZURE HOLDINGS L L C	6200 CENTENNIAL CENTER BLVD LAS VEGAS NV 89149-4565	12528610010
CERBANA MA-CHRISTIAN & CHERLYN A	7617 RAVEN HILLS DR LAS VEGAS NV 89149-5127	12528812049
CHEN YU GUI	7852 BLUE CHARM AVE LAS VEGAS NV 89149-5105	12528710050
CHERRY WALTER & BERTA	7860 MARCH BROWN AVE LAS VEGAS NV 89149-5106	12528712014
CHIU WILLIAM	LU MINNIE M 1065 N HIGH KNOLL AVE WALNUT CA 91789-4471	12528812046
CLARKE KENNETH L	7852 MARCH BROWN AVE LAS VEGAS NV 89149-5106	12528712016
CLYDUS & TOOTS L L C	%P WHETTON MGR 1830 TERRA VISTA LAS VEGAS NV 89117-2049	12527212023
COLFIN AI-NV 2 L L C	9305 E VIA VENTURA #201 SCOTTSDALE AZ 85258	12527217050
COLFIN AI-NV 2 L L C	9305 E VIA DE VENTURA #201 SCOTTSDALE AZ 85258-3423	12527217010
COLFIN AI-NV 2 L L C	9305 E VIA DE VENTURA #201 SCOTTSDALE AZ 85258-3423	12528710059
COLFIN AI-NV 2 L L C	9305 E VIA VENTURA #201 SCOTTSDALE AZ 85258	12527217001
COTHRAN PENNY G LIVING TRUST	COTHRAN PENNY G TRS 7432 MAIDEN RUN AVE LAS VEGAS NV 89130-1059	12527218004
COUNTY OF CLARK(PUBLIC WORKS)	500 S GRAND CENTRAL PKWY LAS VEGAS NV 89155	12528502001
CURRIE JOHN W III	22421 BARTON RD #130 GRAND TERRACE CA 92313-5008	12527217034
D S B K C L L C	16 SARDANA CT HENDERSON NV 89011-2405	12527218005
DARLING WAYNE JR & LINDA	524 S INDIAN TRAIL ANAHEIM CA 92807-4713	12527217017
DAVIS JOHN D & MARIESA A	7633 RAVEN HILLS DR LAS VEGAS NV 89149-5129	12528812045
DELGADO ANTHONY	GUEVARA VANESSA 7425 JOCKEY AVE LAS VEGAS NV 89130-1071	12527218001
DEOLIVEROS FELICITAS ACOSTA	7517 BOWLES DR LAS VEGAS NV 89130-1069	12527212030
DESERT CREEK OWNERS ASSOCIATION	%IDEAL COMMUNITY MGMT 3470 W CHEYENNE AVE #200 NO LAS VEGAS NV 89032-8244	12528815053
DIRRIKL KENNETH M	7520 BOWLES DR LAS VEGAS NV 89130-1068	12527212006
DYNAMIC PROPERTY HOLDINGS L L C	7495 W AZURE DR #100 LAS VEGAS NV 89130-4417	12527114005

Report of All Selected Parcels**Case Number:** SUP-51703**Printed On:** Mon: October 28, 2013

<u>Owner</u>	<u>Address</u>	<u>Parcel Number</u>
EVANS ANTHONY	7541 MAIDEN RUN AVE LAS VEGAS NV 89130-7930	12527217041
FAKOURI LEILA	1503 S CENTRAL AVE LOS ANGELES CA 90021-2608	12527212011
FELDES ANTON & MARGARET REV TR	FELDES ANTON & MARGARET TRS 8124 SHAD BUSH AVE LAS VEGAS NV 89149-4674	12528712037
FELDES ANTON & MARGARET REV TR	8124 SHADE BUSH AVE LAS VEGAS NV 89149-4674	12528710061
FERNANDEZ RODOLFO & SOFIA M	SANCHEZ CONSTANZA 7817 BLUE CHARM AVE LAS VEGAS NV 89149-5133	12528710035
FERRO PATRICIA	FORTUNE DAVID 7524 BOWLES DR LAS VEGAS NV 89130-1068	12527212007
FINDLAY FAMILY PROPERTIES L P	%T CORDER 310 N GIBSON RD HENDERSON NV 89014-6702	12527101036
FINDLAY FAMILY PROPERTIES L P	%T CORDOR 310 N GIBSON RD HENDERSON NV 89014-6702	12528503001
FITZGIBBONS ROBERTA L	HCR-38 BOX 566 MT CHARLESTON NV 89124-9102	12527218002
FLORES-RODRIGUEZ LYDIA	7704 PINE FALLS DR LAS VEGAS NV 89149-5159	12528815017
FRANCIS ALAN J	SHONER JEAN M P O BOX 640 STOCKBRIDGE MI 49285-0640	12528710040
FRIED ATILLA	1828 STONEFIELD ST LAS VEGAS NV 89144-5441	12527212005
GERMDR FAMILY TRUST	PHILLIPS GARY D JR & E G TRS 10078 BRIARGROVE WY HIGHLANDS RANCH CO 80126-5530	12527214043
GESELL R E JR	P O BOX 99439 CLEVELAND OH 44199-0439	12528710045
GO WILLIAM & DEBORAH	1409 IRONSTONE DR BAKERSFIELD CA 93312-4671	12527217040
GOLDSTEIN JEFFREY & JAY M	GOLSTEIN ESTHER 8485 W HAMMER LN LAS VEGAS NV 89149-4015	12528712030
GRAEBER JENNY K	8821 VALLEY CREEK DR LAS VEGAS NV 89134-0372	12528710038
GUAN ALAN W	5760 SPRING MOUNTAIN RD LAS VEGAS NV 89146-8811	12527212032
H & G G L P	MASON DAVID L REVOCABLE LIV TR 1137 S RANCHO DR #120 LAS VEGAS NV 89102-2259	12527201005
H & G G L P	MASON DAVID L REVOCABLE LIV TR 1137 S RANCHO DR #120 LAS VEGAS NV 89102-2259	12527201004
HABIBZADEH SHIVA & MITRA	HABIBZADEH MOJGAN 117 S CLARK DR #201 LOS ANGELES CA 90048-3255	12527212004
HARRIS BRYAN R	CAMPAGIORNI BARBARA A 7508 JOCKEY AVE LAS VEGAS NV 89130-1093	12527217003
HARRIS KEITH D	7848 BLUE CHARM AVE LAS VEGAS NV 89149-5105	12528710049
HARRISON FRANK R	7513 MAIDEN RUN AVE LAS VEGAS NV 89130-7905	12527217048
HARTER STEVEN & SHELLY	8228 TIVOLI COVE DR LAS VEGAS NV 89128-7452	12528812011
HATTERMAN JAMES L	6582 157TH ST W #112B APPLE VALLEY MN 55124-6057	12527212013
HEINRICH ALYSSE V	7421 MAIDEN RUN AVE LAS VEGAS NV 89130-1060	12527214041
HERASIMTSCHUK MARLENE	6013 PEBBLE GREY LN LAS VEGAS NV 89130-7906	12527217036
HILL JUDITH LEE	22029 NICOLLE AVE CARSON CA 90745-2913	12527217025
HOFF R TODD & DAYNA K	2609 TOWN GARDEN RD CARLSBAD CA 92009-3072	12528812050
HORAN BETTY L	7808 QUILL GORDON AVE LAS VEGAS NV 89149-5165	12528710032
HUGHES KENNETH & MARILYN	7532 MAIDEN RUN AVE LAS VEGAS NV 89130-7931	12527217031

Report of All Selected Parcels**Case Number:** SUP-51703**Printed On:** Mon: October 28, 2013

<u>Owner</u>	<u>Address</u>	<u>Parcel Numbe</u>
HURD DARBY	7500 BOWLES DR LAS VEGAS NV 89130-1068	12527212001
IBARRA JOSE J	7512 MAIDEN RUN AVE LAS VEGAS NV 89130-7904	12527217026
INLAND DIVERSIFIED L V CENT CTR	SAM'S REAL ESTATE TR (LEASE) %SAMS CLUB/PPTY TAX DEPT P O BOX 8050 MAILSTOP #0555 BENTONVILLE AR 72712-8055	12528210001
INLAND DIVERSIFIED L V CENT CTR	K F C U S PROPERTIES IN LEASE %KFC CORP/REAL ESTATE TAX DEPT 1900 COLONEL SANDERS LN LOUISVILLE KY 40213-1970	12528610006
INLAND DIVERSIFIED L V CENT CTR	%PPTY TAX DEPT P O BOX 3666 OAK BROOK IL 60522-3666	12528610002
INLAND DIVERSIFIED L V CENT CTR	WAL-MART REAL ESTATE TR (LEASE) %WAL-MART CORP/PPTY TAX DEPT P O BOX 8050 MAILSTOP #0555 BENTONVILLE AR 72712-8055	12528210002
INLAND DIVERSIFIED L V CENT CTR	%PPTY TAX DEPT P O BOX 3666 OAK BROOK IL 60522-3666	12528610007
INLAND DIVERSIFIED L V CENT CTR	%PPTY TAX DEPT P O BOX 3666 OAK BROOK IL 60522-3666	12528713006
INLAND DIVERSIFIED L V CENT CTR	%PPTY TAX DEPT P O BOX 3666 OAK BROOK IL 60522-3666	12528610004
INLAND DIVERSIFIED L V CENT CTR	%PPTY TAX DEPT P O BOX 3666 OAK BROOK IL 60522-3666	12528610005
INLAND DIVERSIFIED L V CTR	%PPTY TAX DEPT P O BOX 3666 OAK BROOK IL 60522-3666	12528713002
INLAND DIVERSIFIED L V CTR	HOME DEPOT U S A INC (LEASE) %HOME DEPOT INC/PPTY MGT DIV 2455 PACES FERRY RD ATLANTA GA 30339-1834	12528713003
INLAND DIVERSIFIED L V CTR	%PPTY TAX DEPT P O BOX 3666 OAK BROOK IL 60522-3666	12528713007
J B 1933 L L C	O'KEEFE THOMAS B 7290 W AZURE DR LAS VEGAS NV 89130-4410	12527217043
J L E TRUST	EBERT JACQUELYN LEE TRS 255 E MESA VERDE LN LAS VEGAS NV 89123-1706	12528712015
JANOSTA ARLENE TRUST	JANOTA JOHN M TRS 1592 GIRARD WAY #C BOURBONNAIS IL 60914-4626	12527214039
JONES DIONNE M	7524 JOCKEY AVE LAS VEGAS NV 89130-1095	12527217007
K F H HOLDINGS L L C	4102 COTTON CREEK AVE NO LAS VEGAS NV 89031-3661	12527217049
KEEFER ROY K II & MELISSA A	7409 MAIDEN RUN AVE LAS VEGAS NV 89130-1058	12527214038
KENNEY ANDREA M	5736 DESERT SKY WY LAS VEGAS NV 89149-5130	12528812010
KEPPEL RUDOLF LIVING TRUST	7812 BLUE CHARM AVE LAS VEGAS NV 89149-5133	12528710042
KING FUTT'S P F M L L C	5700 BOULDER HWY LAS VEGAS NV 89122-7204	12527212029
KING FUTT'S P F M L L C	5700 BOULDER HWY LAS VEGAS NV 89122-7204	12527212012
KORTE KELLY L	7416 HICKORY HILLS DR LAS VEGAS NV 89130-1002	12527221008
KRAMER MAXIM L	6439 BIG PINE WY LAS VEGAS NV 89108-3419	12528812047
KREZO IGOR	7425 MAIDEN RUN AVE LAS VEGAS NV 89130-1060	12527214042
KROLL JONI R	7505 BOWLES DR LAS VEGAS NV 89130-1069	12527212033
L N MANAGEMENT LLC SER 7512 JOCK	P O BOX 36208 LAS VEGAS NV 89133-6208	12527217004
LANCASTER JOHN A	7509 HICKORY HILLS DR LAS VEGAS NV 89130-1056	12527212021

Report of All Selected Parcels**Case Number:** SUP-51703**Printed On:** Mon: October 28, 2013

<u>Owner</u>	<u>Address</u>	<u>Parcel Number</u>
LARSEN KATHERINE A	MONGER WILMA J 7868 MARCH BROWN AVE LAS VEGAS NV 89149-5106	12528712012
LAS VEGAS DEV GROUP L L C	397 3RD AVE #A CHULA VISTA CA 91910-3982	12528710031
LAWSON STEVEN J	7424 JOCKEY AVE LAS VEGAS NV 89130-1070	12527214003
LI QIANG	GU KATHY 1016 RIVERSIDE DR LOS ALTOS CA 94024-4917	12527212017
LINDENBAUM RONALD L	10636 TRAY MOUNTAIN AVE LAS VEGAS NV 89166-5078	12528812017
LINDSAY LIVING TRUST	LINDSAY STEPHEN J & MARGARET TRS 29 PRISCILLA CIR WEYMOUTH MA 02188-4226	12528712033
LIQUID ASCA LTD	8209 SHAD BUSH LAS VEGAS NV 89149-2001	12528811002
LOOMIS LAWRENCE A JR	9216 RED TWIG DR LAS VEGAS NV 89134-6036	12528710052
LOUGHRY DAVID K & JACQUELINE A	6735 ROWENA CIR LAS VEGAS NV 89131-3534	12528712017
LU JUDY H & LIN YING	1111 JEFFRIES AVE ARCADIA CA 91006-5008	12527217016
LUXEM MICHAEL J	6117 CROCKERY ST LAS VEGAS NV 89130-1067	12527212010
MANDZIARA MARIA V & KENNETH A	460 EL CERRITO SANTA MARIA CA 93455-5411	12528712013
MARTIN LARRY L & CYNTHIA L	8662 ELLSWORTH LN SANTEE CA 92071-4006	12527217019
MATULICH LINDA J LIVING TRUST	MATULICH LINDA J TRS 7808 BLUE CHARM AVE LAS VEGAS NV 89149-5133	12528710041
MCDEVITT RICHARD E JR	2270 GRAND BLVD NISKAYUNA NY 12309-5803	12528712027
MCENULTY JAMES W & JENNIFER J	7521 MAIDEN RUN AVE LAS VEGAS NV 89130-7905	12527217046
MCGOVERN ANTHONY K	7516 MAIDEN RUN AVE LAS VEGAS NV 89130-7904	12527217027
MCKENZIE LYNDA D TRUST	MCKENZIE LYNDA D TRS 7632 RAVEN HILLS DR LAS VEGAS NV 89149-5128	12528812019
MCVEIGH L D & HELEN	6436 SANDY COPPER CT LAS VEGAS NV 89131-3713	12528712023
MESERLIAN FAMILY TRUST	MESERLIAN BARKEV & SONIA TRS 707 S BROADWAY ST #415 LOS ANGELES CA 90014-2858	12527217013
MIELLO JEROME M & THERESA A	7876 MARCH BROWN AVE LAS VEGAS NV 89149-5188	12528712010
MINERO JUAN & MARIBEL	7529 MAIDEN RUN AVE LAS VEGAS NV 89130-7930	12527217044
MIRACLE L L C	%B & L DADOURIAN 1901 S REALEZA CT LAS VEGAS NV 89102-2062	12527221007
MITTAGE CHERYL L	7801 BLUE CHARM AVE LAS VEGAS NV 89149-5133	12528710039
MOLINA CHERYL J	7433 MAIDEN RUN AVE LAS VEGAS NV 89130-1060	12527214044
MONARREZ ANTONIO & WENDY	7512 HICKORY HILLS DR LAS VEGAS NV 89130-1055	12527212026
MONIZ JOSEPH W JR	1521 CAMINO DE FLORES YUBA CITY CA 95993-5211	12528712039
MORA JILL A	6009 PEBBLE GREY LN LAS VEGAS NV 89130-7906	12527217037
MORTIMER ROBERT E	DAHLE-MORTIMER KAREN 8169 SEDONA SUNSET DR LAS VEGAS NV 89128-7309	12527213001
MOSS JOSHUA	7505 JOCKEY AVE LAS VEGAS NV 89130-1094	12527217021
MURPHY CASEY J & JENNIFER M	1157 W 650 S LAYTON UT 84041-3563	12527221009
NOLAN MICHAEL E & KELLY	5848 DRIFT BOAT ST LAS VEGAS NV 89149-5169	12528712025

Report of All Selected Parcels**Case Number:** SUP-51703**Printed On:** Mon: October 28, 2013

<u>Owner</u>	<u>Address</u>	<u>Parcel Numbe</u>
NORTHWEST AUTOWORLD LTD	5850 CENTENNIAL CENTER BLVD LAS VEGAS NV 89149-4570	12527301007
OREBAUGH CHRISTINE	7421 HICKORY HILLS DR LAS VEGAS NV 89130-1002	12527221010
ORTEGA SAMANTHA	7517 HICKORY HILLS DR LAS VEGAS NV 89130-1056	12527212019
PARKER PATRICK L & JONETTA T	5844 DRIFT BOAT ST LAS VEGAS NV 89149-5169	12528712026
PASTOR LAURA	P O BOX 2172 WESTCHESTER PA 19380-0093	12527214001
PATTERSON KENNETH D & ADRIENNE B	6905 BEECH NEST DR LAS VEGAS NV 89130-1172	12527217045
PENSCO TRUST COMPANY	LUCHSINGER DAVID TRS 1408 VIA MERANO ST HENDERSON NV 89052-4094	12528712021
PEREZ JUAN	PADILLA OLIVIA 7424 MAIDEN RUN AVE LAS VEGAS NV 89130-1059	12527218006
PIERSON RENEE E	7621 RAVEN HILLS DR LAS VEGAS NV 89149-5127	12528812048
PINARELLI JOHN	7417 HICKORY HILLS DR LAS VEGAS NV 89130-1002	12527221011
POOLE BRYAN L & ROSEMARIE L	5824 WILLOWCREEK RD NO LAS VEGAS NV 89031-1438	12527212027
PREVIN VICTOR	PREVIN NADA 30 MARLBOROUGH ST COLLEGE PARK SA 5069 AUSTRALIA	12527220008
PREY TONY A & SUSAN D	10257 SUNSET GARDENS DR LAS VEGAS NV 89135-2895	12528710030
PRICE D SR & TATE-PRICE B TR	PRICE DONALD R & BETTY J TRS 915 S 55TH ST EL CERRITO CA 94530-2105	12527212025
PRICE TYREESE	7517 JOCKEY AVE LAS VEGAS NV 89130-1094	12527217018
PROTTUNG WOLFGANG G	10854 ANDORA AVE CHATSWORTH CA 91311-1303	12527218007
R A G LIVING TRUST	GREEN ROBERT A TRS 5512 COLLIER HILLS ST LAS VEGAS NV 89149-4018	12527212020
R L P TENAYA VILLAGE L L C	%A CORWIN 3900 S HUALAPAI WAY #126 LAS VEGAS NV 89147-5725	12527114022
RALSTEN L L C	27452 N ELDER VIEW DR VALENCIA CA 91354-2003	12528712036
RANCH BOWLES 2 TRUST	%G FUENTES 11700 W CHARLESTON BLVD #170-311 LAS VEGAS NV 89135-1573	12527212002
RANCH HOUSE ROAD L L C	4327 W SUNSET RD LAS VEGAS NV 89118-3852	12527223001
RAVEN HILLS DRIVE TRUST	900 S LAS VEGAS BLVD #810 LAS VEGAS NV 89101-6850	12528812018
RED ROCK 55 L L C	10181 PARK RUN DR LAS VEGAS NV 89145-8865	12527217020
REESE LAURENCE ROTHWELL	282 S PINE AVE BREA CA 92821-5540	12527217051
ROCHA BEATRIZ	7217 FRANK BORMAN AVE LAS VEGAS NV 89145-6016	12527217009
ROSS GENEVA M	CURTIS PEGGY J 7865 MARCH BROWN AVE LAS VEGAS NV 89149-5187	12528712038
S F R INVESTMENTS POOL 1 L L C	5030 PARADISE RD #B-214 LAS VEGAS NV 89119-1225	12527212022
S K J L K PROPERTIES L L C	%OISHI'S PPTY MGT 2075 VILLAGE CENTER CIR LAS VEGAS NV 89134-6251	12528812016
SAENZ MANOLO	5034 W GOWAN RD LAS VEGAS NV 89130-3225	12527212015
SAGE REALTY L L C SERIES 1	8550 W DESERT INN RD #102-112 LAS VEGAS NV 89117-4401	12528815016
SAIKI DENNIS TAKAO	2860 CORTE CABALLOS CAMARILLO CA 93010-2216	12527214002
SAMS GEORGE R SR & DAVID R	7413 JOCKEY AVE LAS VEGAS NV 89130-1071	12527220011

Report of All Selected Parcels**Case Number:** SUP-51703**Printed On:** Mon: October 28, 2013

<u>Owner</u>	<u>Address</u>	<u>Parcel Number</u>
SANCHEZ-MONTOYA EDUARDO A & LANI	7408 MAIDEN RUN AVE LAS VEGAS NV 89130-1057	12527218010
SATICOY BAY LLC SER 7540 MAIDEN	P O BOX 36208 LAS VEGAS NV 89133-6208	12527217033
SATTLER WILLIAM D	7820 MARCH BROWN AVE LAS VEGAS NV 89149-5181	12528712024
SCALA JOSEPH	6401 CENTENNIAL CENTER BLVD LAS VEGAS NV 89149-4532	12528510003
SCALA JOSEPH	6401 CENTENNIAL CENTER BLVD LAS VEGAS NV 89149-4532	12528610008
SCALA JOSEPH	6401 CENTENNIAL CENTER BLVD LAS VEGAS NV 89149-4532	12528610009
SHARP DAVID R	5327 W MOUNTAIN MEN DR SALT LAKE CITY UT 84118-6926	12528712018
SIMS DEANN	3975 RIVIERA DR #A SAN DIEGO CA 92109-5828	12527217015
SITZMAN SHANE MICHAEL & PATRICIA	7616 ADORNMENT CT LAS VEGAS NV 89131-4796	12527221012
SKYRISE PROPERTIES L L C	809 MERIALDO LN LAS VEGAS NV 89145-4827	12528712028
SMITH KERMIT DAVID	SERAFINI-SMITH CECILIA MARIE P O BOX 5941 NORCO CA 92860-8031	12527217029
SMITH KURT R	7520 MAIDEN RUN AVE LAS VEGAS NV 89130-7904	12527217028
SNYDER KIMBERLY R & BRYAN K	7417 JOCKEY AVE LAS VEGAS NV 89130-1071	12527220010
SORIANO JUAN & BEATRIS	SORIANO JULIO 5440 EL MORADO ST MONTCLAIR CA 91763-3313	12528710036
SPEICHER LEON D & SANDRA S	7437 MAIDEN RUN AVE LAS VEGAS NV 89130-7929	12527217052
STAUFFER ROBERT E	7508 BOWLES DR LAS VEGAS NV 89130-1068	12527212003
STEEHLER LORI A	7640 RAVEN HILLS DR LAS VEGAS NV 89149-5128	12528812021
STEELE SAMUEL D	7608 RAVEN HILLS DR LAS VEGAS NV 89149-5126	12528812013
STRICKLAND JUDITH M & THERON L	7762 S HARRISON CIR CENTENNIAL CO 80122-3515	12527217047
SURGE & SURGE L L C	%J SURGE 3550 CLAREMORE AVE LONG BEACH CA 90808-3103	12527212014
SWORD NORMA J	7849 MARCH BROWN AVE LAS VEGAS NV 89149-5187	12528712034
SZCZURKO PIOTR	WATTS-SZCZURKO TERESA J 7833 BLUE CHARM AVE LAS VEGAS NV 89149-5105	12528710062
T H P I ACQUISITION HOLDINGS LLC	%ROBINSON PPTY MGT 3765 E SUNSET RD #B1 LAS VEGAS NV 89120-6200	12527213002
TAYLOR WILLIAM D & EARLEAN	7816 BLUE CHARM AVE LAS VEGAS NV 89149-5133	12528710043
TEEHAN MICHAEL J & DIANE M	7828 QUILL GORDON AVE LAS VEGAS NV 89149-5166	12528710064
TELZEROW RAYMOND C & SHARON A	7829 MARCH BROWN AVE LAS VEGAS NV 89149-5183	12528712029
TRUSTEE CLARK COUNTY TREASURER	%DYNAMIC PROPERTY HOLDINGS L L C 7495 W AZURE DR #100 LAS VEGAS NV 89130-4417	12527114025
TRUSTEE CLARK COUNTY TREASURER	%DYNAMIC PROPERTY HOLDINGS L L C 7495 W AZURE DR #100 LAS VEGAS NV 89130-4417	12527114024
TRUSTEE CLARK COUNTY TREASURER	%SHEA TENAYA VILLAGE OWNERS ASSN %THE MASTERS GROUP P O BOX 20094 SAN JOSE CA 95160-0094	12527114023
TURMAN DAVID J	7840 MARCH BROWN AVE LAS VEGAS NV 89149-5106	12528712019
URETA ABEL O LOPEZ	7501 JOCKEY AVE LAS VEGAS NV 89130-1094	12527217022

Report of All Selected Parcels**Case Number:** SUP-51703**Printed On:** Mon: October 28, 2013

<u>Owner</u>	<u>Address</u>	<u>Parcel Numbe</u>
VANN DARHYL T	6121 CROCKERY ST LAS VEGAS NV 89130-1067	12527212009
VAUGHT JENNIFER	BOWMAN BERNICE & MADISON SR 7809 BLUE CHARM AVE LAS VEGAS NV 89149-5133	12528710037
VELASCO GABRIEL A	5745 HEATHERWOOD ST LAS VEGAS NV 89149-5141	12528811001
VILORIA SANTIAGO & LOUISE FAM TR	VILORIA SANTIAGO & LOUISE TRS 7900 MARCH BROWN AVE LAS VEGAS NV 89149-5101	12528712009
VU JOHN BAO	1523 PARK HARBOR OAKS CT HOUSTON TX 77084-5689	12527212024
VU JOHN BAO	1523 PARK HARBOR OAKS CT HOUSTON TX 77084-5689	12527217035
WARD EVIE JEAN	7844 BLUE CHARM AVE LAS VEGAS NV 89149-5105	12528710048
WEBER HELEN M LIVING TRUST	WEBER HELEN M TRS 27 DOUGLAS DR N BROOMFIELD CO 80020-1103	12527214040
WEIR ROSE MARY REVOCABLE LIV TR	302 E YORKSHIRE DR STOCKTON CA 95207-5841	12528712022
WEIRICK JOHN F LIVING TRUST	WEIRICK JOHN F TRS 7829 BLUE CHARM AVE LAS VEGAS NV 89149-5164	12528710063
WHETTEN LANCE L & PEGGY L	1830 TERRA VISTA WY LAS VEGAS NV 89117-2049	12527217005
WHITE HAROLD DEAN	9340 OLYMPIA FALLS AVE LAS VEGAS NV 89149-0193	12528812020
WINSOR SOPHIA REVOCABLE TRUST	PREMIER TRUST TRS %PREMIER TRUST 4465 S JONES BLVD LAS VEGAS NV 89103-3307	12528812015
WITHROW ERIK E	7540 JOCKEY AVE LAS VEGAS NV 89130-1095	12527217011
WONG BETTY	CHHIT RAVUT 6890 VIA BORREGOS CARLSBAD CA 92009-6079	12527217042
WOODS GRANT R	7840 BLUE CHARM AVE LAS VEGAS NV 89149-5105	12528710047
WOW PROPERTIES L L C	3100 S GRAND AVE LOS ANGELES CA 90007-3815	12528710029
YEATES LINDA	%IDEAL REALTY & MGT 6260 W SPRING MOUNTAIN RD #115 LAS VEGAS NV 89146-8867	12527220007
YEKUTIEL YONATAN	818 E FLAMINGO #208 LAS VEGAS NV 89119-7318	12527217038
YEREMIAN GIRAYER O FAMILY TR	YEREMIAN GIRAYER O TRS 5346 LOMA LINDA AVE #103 LOS ANGELES CA 90027-3691	12528812014
YOUNG ROBERT W & CATHY J	7816 QUILL GORDON AVE LAS VEGAS NV 89149-5165	12528710034