



Legal Notices Transmittal and Scanning Separator Sheet

Legal Notice Type: Legal Mailings

Date of Transfer to ERM: 2/9/2012

Page Count: 12

Meeting Date: 2/14/2012

Meeting Type: Planning Commission <=>

Case Number(s): SUP-44160 <=>

Subject of Affidavit: APPLICANT: LOANMAX, LLC - OWNER: 3121 WEST SAHARA PARTNERSHIP - 3121 West Sahara Avenue <=>

Record Series: Legal Notices

LRDA Number: 2007-1717

Retention: Permanent

File By: Meeting Date



Prepared By: aCroll

Scanned By:

QC By:

SCANNED

FEB - 9 2012

City of Las Vegas
Department of Planning
Development Services Center
333 North Rancho Drive, 3rd Floor
Las Vegas, Nevada 89106

Return Service Requested Official Notice of Public Hearing

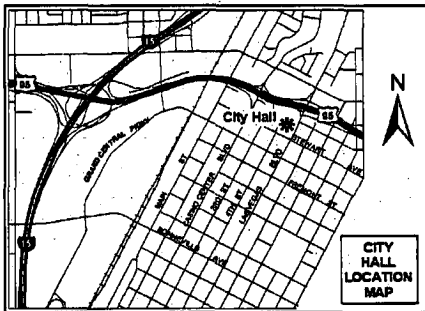

If you wish to file your protest or support on this request, check the appropriate box below and return this card in an envelope with postage to the Department of Planning, Case Planning Division at the address listed above or fax this side of this card to (702) 385-7268. If you would like to contact your Council Representative, please call (702) 229-6405.

I SUPPORT
this Request

I OPPOSE
this Request

Please use available blank space on card for your comments.

SUP-44160

Planning Commission Meeting of 2/14/2012

Application Information

SUP-44160 - SPECIAL USE PERMIT - PUBLIC HEARING - APPLICANT: LOANMAX, LLC - OWNER: 3121 WEST SAHARA PARTNERSHIP - For possible action on a request for a Special Use Permit FOR AN PROPOSED AUTO TITLE LOAN USE WITH WAIVERS TO ALLOW NO DISTANCE SEPARATION FROM A RESIDENTIAL USE WHERE 200 FEET IS REQUIRED, AND A 167-FOOT DISTANCE SEPARATION FROM AN EXISTING AUTO TITLE LOAN USE WHERE 1,000 FEET IS REQUIRED at 3121 West Sahara Avenue (APN 162-08-104-003), C-1 (Limited Commercial) Zone, Ward 1 (Tarkanian).

Application Location

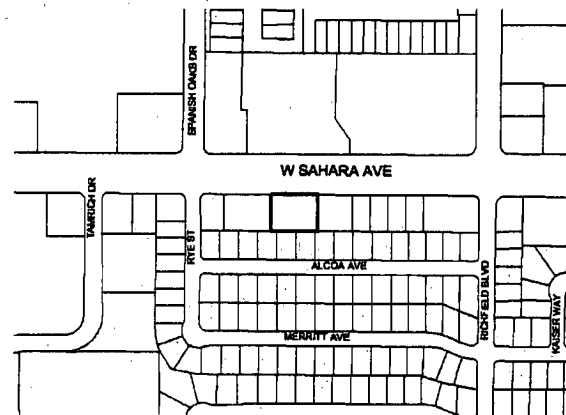

The proposed project may not pertain to the entire highlighted project site.

Public Hearing Information

Meeting: Planning Commission
Date: February 14, 2012
Time: 6:00 P.M.
Location: City Council Chambers
400 Stewart Avenue
Las Vegas, Nevada

Any and all interested persons may appear before the City Planning Commission either in person or by representative and object to or express approval of this request; or may, prior to this meeting, file a written objection thereto or approval thereof with the Department of Planning, Case Planning Division, Development Services Center, 333 North Rancho Drive, 3rd Floor, Las Vegas, Nevada 89106. Final Action on General Plan Amendments and Rezoning will be determined by the City Council. Other public hearing items may be deemed Final Action by the Planning Commission or forwarded to the City Council. The date of the City Council meeting, if applicable, will be announced at the Planning Commission meeting after the discussion of the item. For further information, including the full staff report, please call (702) 229-6301 (TDD 386-9108) or go to <http://www.lasvegasnevada.gov>.

Report of All Selected Parcels**Case Number:** SUP-44160**Printed On:** Tue: January 24, 2012

<u>Owner</u>	<u>Address</u>	<u>Parcel Number</u>
012048 TRUST	BLED SOE CURTIS TRS 1281 STRONG AVE LAS VEGAS NV 89102-2160	16205415018
3 J FOUNDATION	3293 MONTECITO DR SAN JOSE CA 95135-2322	16208511001
3001 ALCOA AVE TRUST	6577 KEYNOTE DR LAS VEGAS NV 89118-1835	16208111016
3121 W SAHARA PARTNERSHIP	%LUNAN CORP 414 N ORLEANS #402 CHICAGO IL 60654-4461	16208104003
ABBATE MARIA	3013 ALCOA AVE LAS VEGAS NV 89102-6021	16208111019
ALDERETTE SHANE ACE	831 TONI AVE LAS VEGAS NV 89119-4824	16208111046
ALEGRIA MICHAEL L	2716 BURTON AVE LAS VEGAS NV 89102-2110	16205415010
ALEGRIA MICHAEL L	2816 BURTON AVE LAS VEGAS NV 89102-2012	16205415017
AMBRE RICHARD V III & CYNTHIA L	3068 EL CAMINO AVE LAS VEGAS NV 89102-4006	16205415011
AMMAR SHOSHANA	%M FORREST 2929 CAPE VERDE LN LAS VEGAS NV 89128-7237	16208111051
ANDERSEN JOHN M	3026 EL CAMINO AVE LAS VEGAS NV 89102-4037	16205415044
ANDJELKOVICH DRAGOLJUB	5908 ROBINSON AVE RIVERSIDE CA 92503-8618	16208512002
ANDRADE JESUS AYALA	3109 ALCOA AVE LAS VEGAS NV 89102-6076	16208111024
ARAHAKUNI SARKIS	3205 KINGS WAY LAS VEGAS NV 89102-5979	16208112018
AUTRY BRYON L & CYNTHIA L	5871 SHEILA AVE LAS VEGAS NV 89108-3613	16208511005
AXELROD TODD MICHAEL	3601 W SAHARA AVE #207 LAS VEGAS NV 89102-5821	16205416019
BAILES FAMILY TRUST ETAL	BAILES LEONARD B & GEORGINA TRS %BAILES & ASSOC 11911 SAN VICENTE BLVD #325 LOS ANGELES CA 90049-6611	16205801010
BANK NEVADA STATE	P O BOX 990 LAS VEGAS NV 89125-0990	16205402009
BANK U S NATIONAL ASSN TRS	%RECONTRUST CO 400 NATIONAL WAY SIMI VALLEY CA 93065-6414	16205415003
BANK WEST	P O BOX 5155 SAN RAMON CA 94583-5155	16205816005
BARTON H KEITH	3054 EL CAMINO AVE LAS VEGAS NV 89102-4037	16205415035
BASILIO TONY S	3120 KINGS WY LAS VEGAS NV 89102-0156	16208114048
BAUTISTA ABRAHAM D & EVELYN L	3012 ALCOA AVE LAS VEGAS NV 89102-6016	16208111012
BEAVER MICHAEL J & RANNIE L	3117 MERRITT AVE LAS VEGAS NV 89102-6085	16208111056
BENEFICIAL FINANCIAL I INC	%REO DEPT 931 CORPORATE CENTER DR POMONA CA 91768-2642	16208111040
BICKET VICKI S 2005 REVOCABLE TR	BICKET VICKI S TRS P O BOX 310 BARSTOW CA 92312-0310	16208111064
BIGGIO FAMILY TRUST	%D BIGGIO 3013 MERRITT AVE LAS VEGAS NV 89102-6014	16208111049
BLAKE DARLA KAI LIVING TRUST	BALKE DARLA KAI TRS 2308 PLAZA DEL GRANDE LAS VEGAS NV 89102-4028	16205413022
BLUT JEROME L & ARLENE	2409 PLAZA DEL GRANDE LAS VEGAS NV 89102-4020	16205413010
BORDENAVE EDWARD A & LOUISE O	3013 KINGS WY LAS VEGAS NV 89102-5925	16208114034
BORDENAVE EDWARD A JR & LOUISE O	3013 KINGS WAY LAS VEGAS NV 89102-5925	16208114033

Report of All Selected Parcels**Case Number:** SUP-44160**Printed On:** Tue: January 24, 2012

<u>Owner</u>	<u>Address</u>	<u>Parcel Number</u>
BROWN SHAYNE	2420 PLAZA DEL GRANDE LAS VEGAS NV 89102-4017	16205413013
BUCK ERIC	1310 WATER MILL CT HENDERSON NV 89002-3659	16208112008
C B PLAZA DE ROSA L L C	%C BLANCO 1420 WESTWIND RD LAS VEGAS NV 89146-1356	16205416030
CAMILLI CARMELLA REV LIV TR	CAMILLI CARMELLA TRS 2833 MERRITT AVE LAS VEGAS NV 89102-6048	16208511065
CAPUTO LIVING TRUST	4521 EXPOSITION AVE LAS VEGAS NV 89102-1545	16208111017
CARRILLO DELIA	2514 KAISER WY LAS VEGAS NV 89102-6032	16208511003
CASON PETER J	CASON JACK E & MAXINE FAMILY TR 2200 S HIGHLAND DR LAS VEGAS NV 89102-4629	16208103001
CECHURA STELLA	HOBBS FARRAH MEILING 3116 ALCOA AVE LAS VEGAS NV 89102-6074	16208111005
CENTENO JAIME	3120 MERRITT AVE LAS VEGAS NV 89102-6083	16208111034
CHACON MARIA	3004 KINGS WY LAS VEGAS NV 89102-5924	16208114038
CHANG MULLIKA	3200 MERRITT AVE LAS VEGAS NV 89102-6084	16208111033
CHANG WEN MING	KAW SUSAN 3016 MERRITT AVE LAS VEGAS NV 89102-6015	16208111041
CHRISTY DUANE A	7633 CALM PASSAGE CT LAS VEGAS NV 89139-5323	16208111006
CLARK TERRACE MUTUAL HOMES INC	%A DEVIRO 4730 S FORT APACHE #170 LAS VEGAS NV 89147-7946	16208103008
COHEN FAMILY TRUST	COHEN LILA TRS 8370 PLU, CREEK CT LAS VEGAS NV 89113	16205416015
Condominium master parcel		16205415000
CONLON SENIOR CENTER	%DONNA 1601 CARMEN DR #100 CAMARILLO CA 93010-3103	16208103007
CONTRERAS LESTER	MINOTH-MILLAN ROSA 2620 YARDLEY ST LAS VEGAS NV 89102-5976	16208112010
CORKALO FAMILY TRUST	CORKALO VLADIMIR & SABINA TRS 3200 KINGS WY LAS VEGAS NV 89102-0157	16208112001
COSCINO FRANK A & VICKI	3200 ALCOA AVE LAS VEGAS NV 89102-6077	16208111003
COURTNEY THOMAS L	48290 WYNNE RD RIDGE MD 20680-3133	16208111065
CRAIG BARBARA	4365 N BONITA VISTA ST LAS VEGAS NV 89129-0404	16205415006
CRIBARI LIVING TRUST	CRIBARI KENNETH W & KATHLEEN TRS 2321 CALLE DE NUEVO LAS VEGAS NV 89102-4039	16205416006
CUMMINGS FAMILY TRUST	CUMMINGS PETER & KAREN M TRS 3025 PLAZA DE ROSA LAS VEGAS NV 89102-4048	16205416025
DAHAN DAVID	9101 ALTA DR #501 LAS VEGAS NV 89145-8501	16208112003
DAITCH BARBARA A	3064 EL CAMINO AVE LAS VEGAS NV 89102-4006	16205415013
DANCE FAMILY TRUST	DANCE RONALD L & CATHERINE O TRS 3013 PLAZA DE ROSA LAS VEGAS NV 89102-4048	16205416022
DECELLES-NAVE LIVING TRUST	DECELLES JOSEPH C TRS 3100 MERRITT AVE LAS VEGAS NV 89102-6083	16208111039
DELGADO AMILCAR IVAN	3109 PIEDMONT AVE LAS VEGAS NV 89102-0129	16208114007
DEMASI FAMILY TRUST	2908 BERNARDO LN LAS VEGAS NV 89102-4052	16208114008
DEMASI FAMILY TRUST	DEMASI SHIRLEEN TRS 2908 BERNARDO LN LAS VEGAS NV 89102-4052	16208111030
DIFIORE HILDA A	DIFIORE JOHN ALEXANDER & HILDA A 3080 EL CAMINO AVE LAS VEGAS NV 89102-4006	16205415005

Report of All Selected Parcels**Case Number:** SUP-44160**Printed On:** Tue: January 24, 2012

<u>Owner</u>	<u>Address</u>	<u>Parcel Number</u>
DIROSSE DEBORAH	3212 KINGS WY LAS VEGAS NV 89102-0157	16208112004
DOOLIN TRAVIS E OR ARNETA L	3008 PIEDMONT AVE LAS VEGAS NV 89102-5968	16208114017
DORSEY PATRICIA E	7901 GOTHIC AVE LAS VEGAS NV 89117-1345	16208511066
DOTTORE EVELYN	3004 EL CAMINO AVE LAS VEGAS NV 89102-4056	16205415024
DOVWICK L L C	578 WASHINGTON BLVD #909 MARINA DEL REY CA 90292-5442	16208111044
DRAO JUNE KAY	3000 MERRITT AVE LAS VEGAS NV 89102-6015	16208111045
DUMKE EDMUND W & CAROL B FAM TR	DUMKE EDMUND W & CAROL B TRS 2416 PLAZA DEL GRANDE LAS VEGAS NV 89102-4017	16205413014
EARL MARY	EARL HAROLD & DOLLY REV LIV TR 2260 WESTWIND RD LAS VEGAS NV 89146-0305	16208111053
EMERALD TRUST	3022 EL CAMINO AVE LAS VEGAS NV 89102-4056	16205415027
ENRIQUEZ MARIANO & LEOBELDINA M	2621 YARDLEY ST LAS VEGAS NV 89102-5977	16208112013
EVANS CHARLES R	3028 CALLE DE LAREDO LAS VEGAS NV 89102-4038	16205415026
FAVELA JUVENAL	3117 KINGS WY LAS VEGAS NV 89102-0158	16208114026
FEIKES JOANN TRUST	FEIKES JOANN PATRICIA TRS 2401 PLAZA DEL GRANDE LAS VEGAS NV 89102-4020	16205413008
FERRERA JOSEPH & MARLY	3009 ALCOA AVE LAS VEGAS NV 89102-6021	16208111018
FLIPPIN ALFRED B FAMILY TRUST	3645 MOUNTCREST DR LAS VEGAS NV 89121-4917	16205415022
FRAGOLA VITO II	3082 EL CAMINO AVE LAS VEGAS NV 89102-4006	16205415004
FRANK FAMILY TRUST	FRANK DAVID LEE & CHARLEEN M TRS 3117 ALCOA AVE LAS VEGAS NV 89102-6076	16208111026
FREEMAN CHARLES F & JOYCE	3001 KINGS WY LAS VEGAS NV 89102-5925	16208114036
FROST SCHYLER G & MARLENE J	3048 EL CAMINO AVE LAS VEGAS NV 89102-4037	16205415038
FULTON KEITH L & MARVIS F	3113 ALCOA AVE LAS VEGAS NV 89102-6076	16208111025
G P PARTNERS L L C	P O BOX 27230 LAS VEGAS NV 89126-1230	16208104002
GAMBLE WILLIAM F & BETTY FAM TR	GAMBLE BETTY L TRS 3008 ALCOA AVE LAS VEGAS NV 89102-6016	16208111013
GAMEZ ROSA	2900 KINGS WY LAS VEGAS NV 89102-6000	16208512003
GARDBERG MARK J	SQUAREY SUSAN L 3116 PLAZA DE ROSA LAS VEGAS NV 89102-4023	16205416008
GARDNER WILLIAM & MICHAELLETTA	4991 BIG PINE DR LAKESIDE AZ 85929-5520	16205416024
GERMOLUS ALVIN	GERMOLUS FAMILY TRUST 620 EFFORT DR LAS VEGAS NV 89145-4817	16208114010
GEVORKIAN GRIGOR & AGHAVNI	8609 LAKERIDGE CIR LAS VEGAS NV 89117-5828	16208510001
GEVORKIAN GRIGOR & AGHAVNI	8609 LAKERIDGE CIR LAS VEGAS NV 89117-5828	16208510002
GIANCOLA PETER	TRUITT ELLEN 4963 WOODWARD GARDENS COLUMBIA MD 21044-1525	16205416003
GILE FAMILY TRUST	GILE MERLYN DEAN & DOROTHY M TRS 3013 WATERSIDE CIR LAS VEGAS NV 89117-2277	16205415015
GLICKEN FAMILY TRUST	GLICKEN KEN TRUST 2413 PLAZA DEL GRANDE LAS VEGAS NV 89102-4020	16205413011

Report of All Selected Parcels**Case Number:** SUP-44160**Printed On:** Tue: January 24, 2012

<u>Owner</u>	<u>Address</u>	<u>Parcel Number</u>
GOULD EDWIN B JANUARY 12 1990 TR	GOULD JAMES C TRS %ENTERPRISES RENT A CAR 8290 S ARVILLE ST LAS VEGAS NV 89139-7114	16208102001
GRABIN CAROLYNN	608 E BEVAN DR JOLIET IL 60435-5613	16205415019
GRATHWOHL HENRY L & DIANE	3062 EL CAMINO AVE LAS VEGAS NV 89102-4006	16205415014
GREEN LANNY	23077 GREENFIELD RD #144 SOUTHFIELD MI 48075-3738	16205416014
GUNDERSON LUPE	3113 CALLE DE EL CORTEZ LAS VEGAS NV 89102-4004	16205415007
GUNNARSSON EMIL & JOEL	PARTERNAS GRAND 49 22647 LUND SWEDEN	16205413017
HAAPALA REVOCABLE FAMILY TRUST	HAAPALA CHARLES A & VICKY A TRS 3020 PLAZA DE ROSA LAS VEGAS NV 89102-4021	16205416013
HANDAL JEANNETTE & FUAD	1807 RIDGE PARK DR URBANA IL 61802-7065	16208114004
HARRISON FRANCES A	3072 ELCAMINO LAS VEGAS NV 89102	16205415009
HARVEY MARIA NORMA	3000 ROSEVILLE WY LAS VEGAS NV 89102-5973	16208111038
HATH KRYLE BLAINE	3052 EL CAMINO AVE LAS VEGAS NV 89102-4037	16205415036
HAWK LORI A	2900 MERRITT AVE LAS VEGAS NV 89102-6036	16208511002
HERNANDEZ ESTEBAN	2525 RICHFIELD BLVD LAS VEGAS NV 89102-6018	16208510004
HERRERA OCIEL M	DEHERRERA SONIA H MAGANDA 3209 KINGS WY LAS VEGAS NV 89102-5979	16208112017
HILLTOP CUSTOMS L L C	4012 S RAINBOW #K312 LAS VEGAS NV 89103-2010	16208111066
HOLLANDER DIANA SUE	3018 EL CAMINO AVE LAS VEGAS NV 89102-4056	16205415029
HOWARD MICHAEL I & YVONNE	3108 PIEDMONT AVE LAS VEGAS NV 89102-0128	16208114023
HURLEY RYAN	2617 YARDLEY ST LAS VEGAS NV 89102-5977	16208112014
J L S C L L C	8535 EDNA AVE #120 LAS VEGAS NV 89117-4430	16208103003
JACKS WILLIAM H	3121 MERRITT AVE LAS VEGAS NV 89102-6085	16208111057
JAMES JOSEPH	12345 LAKE CITY WY N E #386 SEATTLE WA 98125-5401	16205413026
JENKINS E & S 1990 LIV TR AGMT	JENKINS EARL N & SHIRLEY A TRS 3010 EL CAMINO AVE LAS VEGAS NV 89102-4056	16205415021
JEZEBEL LIVING TRUST	DAVIS JAMES F TRS 3014 EL CAMINO AVE LAS VEGAS NV 89102-4056	16205415031
JOFFRION ADA	3104 PIEDMONT AVE LAS VEGAS NV 89102-0128	16208114022
JUNKINS FAMILY INTERVIVOS TRUST	JUNKINS PHILIP D & SYLVIA TRS 3101 PLAZA DE ROSA LAS VEGAS NV 89102-4025	16205416026
K P PROPERTIES L L C	1040 E SAHARA AVE #202 LAS VEGAS NV 89104-3232	16208104005
K P PROPERTIES L L C	1040 E SAHARA AVE #202 LAS VEGAS NV 89104-3232	16208104007
K P PROPERTIES L L C	1040 E SAHARA AVE #202 LAS VEGAS NV 89104-3232	16208104006
KAKER FRANK	P O BOX 28518 LAS VEGAS NV 89126-2518	16205416016
KASE CHIKASHI & SHIZUE	3108 MERRITT AVE LAS VEGAS NV 89102-6083	16208111037
KATSAM L L C	%D BASFORD 8720 FORT DENT WY #230 SEATTLE WA 98188-2589	16205816006

Report of All Selected Parcels**Case Number:** SUP-44160**Printed On:** Tue: January 24, 2012

<u>Owner</u>	<u>Address</u>	<u>Parcel Number</u>
KATZ JOEL E & IRIS B	3009 PLAZA DE ROSA LAS VEGAS NV 89102-4048	16205416021
KEETER BRADLEY A	3004 PLAZA DE ROSA LAS VEGAS NV 89102-4021	16205416017
KEETER BRADLEY A	3000 PLAZA DE ROSA LAS VEGAS NV 89102-4021	16205416018
KENNEDY JAMES & MARTHA P	2608 CABOT ST LAS VEGAS NV 89102-5904	16208114002
KIMBERLIN FAMILY REVOCABLE TRUST	KIMBERLIN JAMES F JR TRS 3116 KINGS WY LAS VEGAS NV 89102-0156	16208114047
KIMBERLIN JAMES FRANK & TAMARA L	3113 KINGS WY LAS VEGAS NV 89102-0158	16208114027
KING FRANCISCO	3038 EL CAMINO AVE LAS VEGAS NV 89102-4037	16205415020
KIRKER JOHN R	3101 PIEDMONT AVE LAS VEGAS NV 89102-0129	16208114009
KNIGHT BERNARD L & DENISE	271 HALLSWAY ST PAHRUMP NV 89048-6585	16208112006
KOPELLÉ ARNOLD M REV LIV TR	KOPELLE ARNOLD M TRS 3101 KINGS WY LAS VEGAS NV 89102-0158	16208114030
LAIRD CHARLES J & LOIS J	LAIRD VALERIE A 3021 KINGS WY LAS VEGAS NV 89102-5925	16208114031
LANCES JENNIFER B	3121 PLAZA DE ROSA LAS VEGAS NV 89102-4025	16205416031
LANDBARON ULTRA TRUST	CRE DI LAS VEGAS L L C 2412 PLAZA DEL GRANDE LAS VEGAS NV 89102-4017	16205413015
LANG JUN MEI	620 HIGHLAND AVE CHERRY HILL NJ 08002-2832	16208510006
LAS VEGAS PIZZA L L C	1101.SUMMITVIEW AVE YAKIMA WA 98902-3024	16208104009
LASKOWSKI MIECZYSLAW	8218 WILDFIRE ST LAS VEGAS NV 89123-0923	16208114011
LEA JAMES B & JOY J	11001 PINE KNOLLS CT LAS VEGAS NV 89144-1652	16208111009
LEAD ENTERPRISES L L C	%L MILLER 10812 SLEEPY RIVER AVE LAS VEGAS NV 89144-1422	16208111020
LEE & WANG D V M INC	KO WEI MEN 10158 E GARVEY AVE EL MONTE CA 91733-2006	16205415032
LEE CHI LUNG	408 N LINCOLN AVE #B MONTEREY PARK CA 91755-1202	16208111011
LEE KAREN LAI YIN	PANG STEPHANIE YORK MEE 2301 ASHLAND AVE SANTA MONICA CA 90405-6029	16208111014
LEE SUI YING & WING YEE	3204 ALCOA AVE LAS VEGAS NV 89102-6077	16208111002
LEIGON RALPH & GEORGIA TRUST	3108 PLAZA DE ROSA LAS VEGAS NV 89102-4023	16205416010
LEVY JEANNE FAMILY TRUST	LEVY ALVIN TRS 7800 SILVER PLATEAU AVE LAS VEGAS NV 89128-2655	16208501001
LEVY JEANNE FAMILY TRUST	LEVY ALVIN TRS 7800 SILVER PLATEAU AVE LAS VEGAS NV 89128-2655	16208501002
LIN HELEN M & AARON Y	2023 CENTER AVE FORT LEE NJ 07024-4707	16208111027
LIU YILAN	ZHAO CHANGHAI 3205 ALCOA AVE LAS VEGAS NV 89102-6078	16208111029
LLANOS GABRIEL	3012 PIEDMONT AVE LAS VEGAS NV 89102-5968	16208114018
LLAVE ZOSIMO	2529 RICHFIELD BLVD LAS VEGAS NV 89102-6018	16208510005
LOEZA MARIA L	P O BOX 27595 LAS VEGAS NV 89128-1595	16208114021
LOOSE ALFRED C	3109 KINGSWAY DR LAS VEGAS NV 89102-0158	16208114028
LOPEZ RAMIRO	LOPEZ RAMIRO & AURORA 3101 ALCOA AVE LAS VEGAS NV 89102-6076	16208111022

Report of All Selected Parcels**Case Number:** SUP-44160**Printed On:** Tue: January 24, 2012

<u>Owner</u>	<u>Address</u>	<u>Parcel Number</u>
LYONS JON L	3113 PLAZA DE ROSA LAS VEGAS NV 89102-4025	16205416029
MACTEZUMA OCIEL HERRERA	MAGANDA-DEHERRERA SONIA 3104 ALCOA AVE LAS VEGAS NV 89102-6074	16208111008
MALLAS SCOTT A	4012 S RAINBOW K-310 LAS VEGAS NV 89103-2010	16208512024
MANGIONE LORETTA A REV LIV TR	MANGIONE LORETTA A TRS 37 SCORPION CT HENDERSON NV 89074-6159	16208112015
MARINAS JULIUS WILFRED & MARIA	3105 ALCOA AVE LAS VEGAS NV 89102-6076	16208111023
MARINO ALFRED T TRUST	MARINO ALFRED T TRS 2540 RYE ST LAS VEGAS NV 89102-6020	16208111063
MARINO RONALD	1562 MEANDER DR SIMI VALLEY CA 93065-5759	16208112016
MARROQUIN MIRIAN Y	4607 HAYES PL LAS VEGAS NV 89107-4164	16208114016
MASON DONALD M JR	3317 PLAZA DEL PAZ LAS VEGAS NV 89102-4032	16205413029
MCCALLISTER DONALD	3105 PLAZA DE ROSA LAS VEGAS NV 89102-4025	16205416027
MCCRACKEN MERLE A	3013 PIEDMONT AVE LAS VEGAS NV 89102-5969	16208114012
MEDIALDEA FERNANDO ETAL	3108 KINGS WY LAS VEGAS NV 89102-0156	16208114045
MEZA MANUEL	3005 KINGS WY LAS VEGAS NV 89102-5925	16208114035
MILNE MARLON T	3020 EL CAMINO AVE LAS VEGAS NV 89102-4056	16205415028
MINDEN SIBYL	3200 LAS VEGAS BLVD S #2475 LAS VEGAS NV 89109-0743	16205416011
MORAN HELEN REVOCABLE LIVING TR	MORAN HELEN TRS 2824 ALCOA AVE LAS VEGAS NV 89102-6023	16208511008
MORELOS ROSA M	3009 MERRITT AVE LAS VEGAS NV 89102-6014	16208111048
MORRIS JULIE ANN TRUST	MORRIS JULIE ANN TRS 2317 PLAZA DEL GRANDE LAS VEGAS NV 89102-4019	16205413006
MORRIS NIDA	%RMS & ASSOC 3020 KINGS WY LAS VEGAS NV 89102-5924	16208114042
MORRISSEY GEORGE	1818 INDUSTRIAL RD #101 LAS VEGAS NV 89102-2631	16205413005
MUNRO RONALD BRUCE & BARBARA M	3281 DOE VALLEY PKWY E BRANDENBURG KY 40108-8017	16208511035
MUNTEAN PATRICK J SUV TR	MUNTEAN HATIJA E TRS 3002 EL CAMINO AVE LAS VEGAS NV 89102-4056	16205415025
MUNTHE ARNOLD E	VINCENT BAMBI P O BOX 80177 LAS VEGAS NV 89180-0177	16205413020
NARDINI DOMINIC J III	3066 EL CAMINO AVE LAS VEGAS NV 89102-4006	16205415012
NEVADA NEW BUILDS L L C	7570 NORMAN ROCKWELL #140 LAS VEGAS NV 89143-6012	16205413028
NEVADA POWER COMPANY	%LAND SERV STA #9 P O BOX 98910 LAS VEGAS NV 89193-8910	16208103005
NOOCHLAOR KEERANA	2223 N COMMONWEALTH AVE LOS ANGELES CA 90027-1201	16208511036
OASIS WEST SAHARA AVENUE LV LLC	%WIGHT & CO INC 10 CEDAR ST WOBURN MA 01801-6364	16205402011
OASIS WEST SAHARA AVENUE LV LLC	%WIGHT & CO INC 10 CEDAR ST WOBURN MA 01801-6364	16205402010
OEHLER C F FAMILY TRUST	OEHLER CHARLES & BEVERLY TRS 2824 MERRITT AVE LAS VEGAS NV 89102-6087	16208511038
OLIVA RENADIS SOLER	3000 KINGS WY LAS VEGAS NV 89102-5924	16208114037
OLIVEIRA ANTONIO & ADRIANE	3209 MERRITT AVE LAS VEGAS NV 89102-6086	16208111060

Report of All Selected Parcels**Case Number:** SUP-44160**Printed On:** Tue: January 24, 2012

Owner	Address	Parcel Number
ORTIZ ISMAEL	3012 KINGS WY LAS VEGAS NV 89102-5924	16208114040
PANG STEPHANIE YOR MEE	2301 ASHLAND AVE SANTA MONICA CA 90405-6029	16208111061
PANG STEPHANIE YORK M & WOON YEE	3113 MERRITT AVE LAS VEGAS NV 89102-6085	16208111055
PANG STEPHANIE YORK MEE	2301 ASHLAND AVE SANTA MONICA CA 90405-6029	16208111062
PANG STEPHANIE YORK MEE	2301 ASHLAND AVE SANTA MONICA CA 90405-6029	16208111067
PANG STEPHANIE YORK MEE	230 ASHLAND AVE SANTA MONICA CA 90405-5463	16208111036
PANG STEPHANIE YORK MEE	2301 ASHLAND AVE SANTA MONICA CA 90405-6029	16208112005
PANG YORK MEE ETAL	2301 ASHLAND AVE SANTA MONICA CA 90405-6029	16208111059
PANG YORK MEE STEPHANIE	2301 ASHLAND AVE SANTA MONICA CA 90405-6029	16208111058
PARADA ISRAEL	TURCIOS-PARADA CANDELARIA 4641 LILLPUT LN LAS VEGAS NV 89102-5712	16208114032
PAYMENT BONNIE DANIEL TRS	3005 PLAZA DE ROSA LAS VEGAS NV 89102-4048	16205416020
PELUAGA HENRY JOSEPH	TUTHILL ELOY JASON 3116 PIEDMONT AVE LAS VEGAS NV 89102-0128	16208114025
PEREZ MARIA CIRIA	2521 RICHFIELD BLVD LAS VEGAS NV 89102-6018	16208510003
PEREZ RIGOBERTO	2829 MERRITT AVE LAS VEGAS NV 89102-6048	16208511064
PETERSON E ROBERT TRUST	PETERSON E ROBERT TRS 3030 EL CAMINO AVE LAS VEGAS NV 89102-4037	16205415042
PETERSON E ROBERT TRUST	PETERSON E ROBERT TRS 3030 EL CAMINO AVE LAS VEGAS NV 89102-4037	16205415043
PETERSON ROSS W	3301 PLAZA DEL PAZ LAS VEGAS NV 89102-4032	16205413025
PHAIRIS OWEN & CAROL A	P O BOX 3400 BIG BEAR LAKE CA 92315-3400	16208111047
PLAZA GROUP INVESTMENT TRUST	DAVIS ERIC M TRS 1818 INDUSTRIAL RD #101 LAS VEGAS NV 89102-2631	16205413030
PONTSLEER 1995 TRUST	PONTSLEER GLENN F & MIRA CO-TRS 3112 PLAZA DE ROSA LAS VEGAS NV 89102-4023	16205416009
PREMIER TRUST NEVADA	4465 S JONES BLVD LAS VEGAS NV 89103-3307	16205416012
PROGRESS HOLDINGS L L C	6292 SPRING MOUNTAIN RD #105 LAS VEGAS NV 89146-8884	16208111015
PROGRESS HOLDINGS L L C	6292 SPRING MOUNTAIN RD #105 LAS VEGAS NV 89146-8884	16208114019
REID JEFF & KYONGE	3088 EL CAMINO AVE LAS VEGAS NV 89102-4008	16205415001
REIS PHILIP M	3020 PIEDMONT AVE LAS VEGAS NV 89102-5968	16208114020
RICHARDS DICK & FERN B	2612 CABOT ST LAS VEGAS NV 89102-5904	16208114003
RIOS TONY	3108 ALCOA AVE LAS VEGAS NV 89102-6074	16208111007
RITZMAN ROBERT 1982 TRUST	RITZMAN ROBERT R TRS 2233 CAPISTRANO WAY #14 CHULA VISTA CA 91915-2334	16205416028
ROCK FRANCINE WENDY	3201 ALCOA AVE LAS VEGAS NV 89102-6078	16208111028
RODRIGUEZ EDGAR	3112 KINGS WY LAS VEGAS NV 89102-0156	16208114046
ROLLINS BEVERLY A	3016 KINGS WY LAS VEGAS NV 89102-5924	16208114041
ROSE TERRENCE K TRUST	ROSE TERRENCE K TRS 3100 KINGS WY LAS VEGAS NV 89102-0156	16208114043

Report of All Selected Parcels**Case Number:** SUP-44160**Printed On:** Tue: January 24, 2012

<u>Owner</u>	<u>Address</u>	<u>Parcel Number</u>
ROSS & ROSS L L C	2488 OLD CASH RD CHERAW SC 29520-5729	16208104008
ROTHFUSS EDWIN L & PETER L	3208 MERRITT AVE LAS VEGAS NV 89102-6084	16208111031
RUBALCAVA MARTIN V & MARIA	3113 PIEDMONT AVE LAS VEGAS NV 89102-0129	16208114006
RUGERIO BLANCA G	3109 MERRITT AVE LAS VEGAS NV 89102-6085	16208111054
RUIZ FLOR MENDEZ	3201 KINGS WY LAS VEGAS NV 89102-5979	16208114001
RUPP ROBERT T JR	2320 PLAZA DEL GRANDE LAS VEGAS NV 89102-4028	16205413019
SAHARA SUITES L L C	3790 PARADISE RD #250 LAS VEGAS NV 89169-4840	16208501003
SARGENT JUDITH L	8535 EDNA AVE #120 LAS VEGAS NV 89117-4430	16208111069
SARGENT JUDY TAM	8535 EDNA AVE #120 LAS VEGAS NV 89117-4430	16208103002
SCHecter ELLIOT	3074 EL CAMINO AVE LAS VEGAS NV 89102-4006	16205415008
SCHNEIDER MADELYN	3017 PLAZA DE ROSA LAS VEGAS NV 89102-4048	16205416023
SCOTT EDWIN E 1996 REVOCABLE TR	SCOTT EDWIN E TRS %B MASNACK 9553 E LYNWOOD CIR MESA AZ 85207-2508	16205415045
SCOTT EDWIN E REVOCABLE TRUST	%B MASNACK 9553 E LYNWOOD CIR MESA AZ 85207-2508	16205415039
SEVILLET OTTO & LYDIA	3019 MERRITT AVE LAS VEGAS NV 89102-6014	16208111050
SIMON INC	8109 SAPPHIRE BAY CIR LAS VEGAS NV 89128-7738	16208104001
SIMON LEONARDA M	3204 MERRIT AVE LAS VEGAS NV 89102-6084	16208111032
SIMON PETER A & JOY MARIE	P O BOX 19088 JEAN NV 89019-9088	16205413004
SIMONELIS FAMILY TRUST	SIMONELIS ALFONSAS & ONA I TRS 1117-21ST ST #5 SANTA MONICA CA 90403-5649	16205415040
SINGER LARRY F	2317 CALLE DE NUEVO LAS VEGAS NV 89102-4039	16205416005
SNYDER LEASING	%H SNYDER %REAL EST DEPT 4199 CAMPUS DR 9TH FLOOR IRVINE CA 92612-4684	16205816007
SOLORIO VICTOR HUGO	3008 KINGS WY LAS VEGAS NV 89102-5924	16208114039
SOUSOURES WILLIAM G LIVING TRUST	SOUSOURES WILLIAM G TRS 6115 LAREDO ST LAS VEGAS NV 89146-5246	16208111001
SOUTHERN NV RENTAL HOLDINGS LLC	%FISHER BROTHERS 299 PARK AVE 42ND FL NEW YORK NY 10171-4299	16208114005
SOUTHERN NV RENTAL HOLDINGS LLC	%FISHER BROTHERS 299 PARK AVE 42ND FL NEW YORK NY 10171-4299	16208111052
SOUTHERN NV RENTAL HOLDINGS LLC	%FISHER BROTHERS 299 PARK AVE 42ND FL NEW YORK NY 10171-4299	16208511004
SOUTHERN NV RENTAL HOLDINGS LLC	%FISHER BROTHERS 299 PARK AVE 42ND FL NEW YORK NY 10171-4299	16208512001
SOUTHERN NV RENTAL HOLDINGS LLC	%FISHER BROTHERS 299 PARK AVE 42ND FL NEW YORK NY 10171-4299	16208111068
SPANISH OAKS HOWNERS ASSN	2201 SPANISH OAKS DR LAS VEGAS NV 89102-4099	16205413001
SPANISH OAKS HOWNERS ASSN INC	2201 SPANISH OAKS DR LAS VEGAS NV 89102-4099	16205416007
SPARKS FAMILY TRUST	SPARKS CAROLYN M TRS 2313 CALLE DE NUEVO LAS VEGAS NV 89102-4039	16205416004
STRONG GARY P	2832 ALCOA AVE LAS VEGAS NV 89102-6023	16208511006
STROUD ASHLEY	2905 MERRITT AVE LAS VEGAS NV 89102-6081	16208511067

Report of All Selected Parcels**Case Number:** SUP-44160**Printed On:** Tue: January 24, 2012

<u>Owner</u>	<u>Address</u>	<u>Parcel Number</u>
SUMAN MARK	LANCASTER MELODY E 3046 EL CAMINO AVE LAS VEGAS NV 89102-4037	16205415016
SUMMERS CYNTHIA E REV LIV TR	SUMMERS CYNTHIA E TRS 2405 PLAZA DEL GRANDE LAS VEGAS NV 89102-4020	16205413009
SUNSHINE LIVING TRUST	CASZATT CEYLON & DEBRA TRS 2417 PLAZA DEL GRANDE LAS VEGAS NV 89102-4020	16205413012
SUTTON EVELYN	HOPPER JOSEPH R 2828 ALCOA AVE LAS VEGAS NV 89102-6023	16208511007
SZECHWAN CORP	5138 CARTARO DR LAS VEGAS NV 89103-2404	16208104004
T & N INVESTMENTS L L C	%N ROITMAN 2340 PASEO DEL PRADO #D-307 LAS VEGAS NV 89102-4342	16205415037
T & N INVESTMENTS L L C	%N ROITMAN 2340 PASEO DEL PRADO #D-307 LAS VEGAS NV 89102-4342	16205415030
TAKEUCHI HATSUO	FEINER ELIANE 224 SAYRE DR PRINCETON NJ 08540-5852	16205413007
TAM KUO HSIEN & LIN AI HUA	2616 YARDLEY ST LAS VEGAS NV 89102-5976	16208112009
TATE DENNIS & ANN TRUST	TATE R DENNIS & E ANN TRS 2408 PLAZA DEL GRANDE LAS VEGAS NV 89102-4017	16205413016
TATUM PHILLIP D	ROOSEN SHARON M 9465 MOHAWK AVE LAS VEGAS NV 89139-7418	16208112007
TEDDY ENTERPRISES & ASSOCIATES	%S WONG 132 9TH ST #200 OAKLAND CA 94607-4727	16208110001
TEDDY ENTERPRISES & ASSOCIATES	%S WONG 132 9TH ST #200 OAKLAND CA 94607-4727	16208103004
THORNTON VIRGINIA E	3006 EL CAMINO AVE LAS VEGAS NV 89102-4056	16205415023
TOBIN EILEEN CANDACE	8430 CARMEL RIDGE CT LAS VEGAS NV 89113-0121	16208111035
TONG SHI GUO	3021 ALCOA AVE LAS VEGAS NV 89102-6021	16208111021
TRAN DUNG D & ANH P	3008 MERRITT AVE LAS VEGAS NV 89102-6015	16208111043
TSANG MAN JUDY	LANG JUNNING 620 HIGHLAND AVE CHERRY HILL NJ 08002-2832	16208510007
VELDONEY L L C	840 MARK WEST SPRINGS RD SANTA ROSA CA 95404-1140	16205415033
VO THU THUY THI	400 E VALLEY RD #2 CARBONDALE CO 81623-7737	16208111004
W S C R E O L L C	851 S RAMPART #160 LAS VEGAS NV 89145-4885	16205403003
W S C R E O L L C	851 S RAMPART #160 LAS VEGAS NV 89145-4885	16205403001
W S C R E O L L C	851 S RAMPART #160 LAS VEGAS NV 89145-4885	16205403002
WAGENER FAMILY TRUST	10401 W CHARLESTON BLVD #D204 LAS VEGAS NV 89135-8702	16205413027
WALKER THOMAS P & MARIAN E	WALKER PATRICK MICHAEL 3712 LA PASADA AVE LAS VEGAS NV 89102-0530	16205415041
WALTER MICHELLE	NATTRESS CARLENE 3086 EL CAMINO AVE LAS VEGAS NV 89102-4006	16205415002
WEBB DORIS P LIVING TRUST	WEBB DORIS P TRS 2913 KINGS WAY LAS VEGAS NV 89102-6089	16208512023
WIENER VALERIE TRUST	WIENER VALERIE TRS 2312 PLAZA DEL GRANDE LAS VEGAS NV 89102-4028	16205413021
WILLBANKS RONALD	9340 SIENNA VISTA DR LAS VEGAS NV 89117-7034	16205415034
WILLIAMS THOMAS L	3020 ALCOA AVE LAS VEGAS NV 89102-6016	16208111010
WILSON CORLISS R	3012 MERRITT AVE LAS VEGAS NV 89102-6015	16208111042
WOLZINGER REVOCABLE FAMILY TRUST	WOLZINGER MELVIN B & RUTH A TRS 2400 PLAZA DEL GRANDE LAS VEGAS NV 89102-4017	16205413018

Report of All Selected Parcels

Case Number: SUP-44160

Printed On: Tue: January 24, 2012

<u>Owner</u>	<u>Address</u>	<u>Parcel Number</u>
WONG JAVIER ALBERTO	3204 KINGS WY LAS VEGAS NV 89102-0157	16208112002
WONG SHU MAN	CHOW SZE WAI 3111 S VALLEY VIEW #L120 LAS VEGAS NV 89102-7710	16208114024
WOO RUTH L & LAWRENCE C	3104 KINGS WY LAS VEGAS NV 89102-0156	16208114044
YOO KYOUNG MI	SOUN SANG P O BOX 173 SAND POINT AK 99661-0173	16208511037
ZEBRA MICHAEL & CHANEL	3105 KINGS WY LAS VEGAS NV 89102-0158	16208114029
ZEPEDA JORGE	2620 CABOT ST LAS VEGAS NV 89102-5904	16208113001
ZUFFA L L C	2960 W SAHARA AVE LAS VEGAS NV 89102-1709	16205816004
ZUFFA L L C	2960 W SAHARA AVE LAS VEGAS NV 89102-1709	16205816011