



# Legal Notices Transmittal and Scanning Separator Sheet

---

## Legal Notice Type: Affidavit of Mailings ..

---

Date of Transfer to ERM: 101/12/2012

Page Count: 14 ..

---

Meeting Date: 1/10/2012

Meeting Type: Planning Commission <=>

Case Number(s): SUP-43999, SDR-43997 <=>

Subject of Affidavit: APPLICANT/OWNER: VEGAS CAR WASH, LLC - 3810 North Jones Boulevard  
<=>

Record Series: Legal Notices

LRDA Number: 2007-1717

Retention: Permanent

File By: Meeting Date

---



Prepared By:                     

Scanned By:                     

**SCANNED**

JAN 17 2012

QC By:

City of Las Vegas  
Department of Planning  
Development Services Center  
333 North Rancho Drive, 3<sup>rd</sup> Floor  
Las Vegas, Nevada 89106

## Return Service Requested Official Notice of Public Hearing

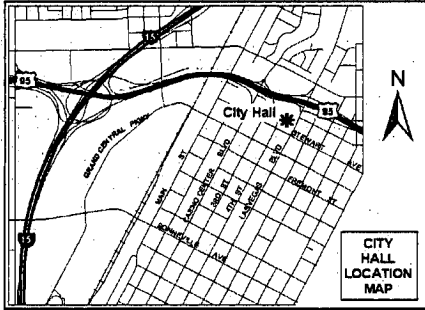

If you wish to file your protest or support on this request, check the appropriate box below and return this card in an envelope with postage to the Department of Planning, Case Planning Division at the address listed above or fax this side of this card to (702) 385-7268. If you would like to contact your Council Representative, please call (702) 229-6405.

I SUPPORT  
this Request

I OPPOSE  
this Request

Please use available blank space on card for your comments.

**SUP-43999 & SDR-43997**

Planning Commission Meeting of 1/10/2012

## Application Information

**SUP-43999 - SPECIAL USE PERMIT - PUBLIC HEARING - APPLICANT/OWNER: VEGAS CAR WASH, LLC** - For possible action on a request for a Special Use Permit TO RE-ESTABLISH AN ABANDONED CAR WASH, SELF-SERVICE USE WITH WAIVERS TO ALLOW THE OPENING OF THE WASH BAYS TO FACE PUBLIC RIGHTS-OF-WAY, TO ALLOW A ZERO-FOOT DISTANCE SEPARATION FROM A RESIDENTIAL PROPERTY WHERE A MINIMUM OF 200 FEET IS REQUIRED, AND TO ALLOW THE USE TO BE ACCESSIBLE TO THE PUBLIC AFTER BUSINESS HOURS at 3810 North Jones Boulevard (APN 138-12-111-005), C-1 (Limited Commercial) Zone, Ward 6 (Ross).

**SDR-43997 - SITE DEVELOPMENT PLAN REVIEW RELATED TO SUP-43999 - PUBLIC HEARING - APPLICANT/OWNER: VEGAS CAR WASH, LLC** - For possible action on a request for a Site Development Plan Review TO ADD AN AUTO SMOG CHECK AND OFFICE TO AN EXISTING CAR WASH, SELF-SERVICE FACILITY WITH WAIVERS TO ALLOW LANDSCAPE BUFFER WIDTHS OF 12 FEET ALONG A PORTION OF THE WEST PERIMETER AND FIVE FEET ALONG THE SOUTH PERIMETER WHERE 15 FEET IS REQUIRED, at 3810 North Jones Boulevard (APN 138-12-111-005), C-1 (Limited Commercial) Zone, Ward 6 (Ross).

Any and all interested persons may appear before the City Planning Commission either in person or by representative and object to or express approval of this request; or may, prior to this meeting, file a written objection thereto or approval thereof with the Department of Planning, Case Planning Division, Development Services Center, 333 North Rancho Drive, 3<sup>rd</sup> Floor, Las Vegas, Nevada 89106. Final Action on General Plan Amendments and Rezonings will be determined by the City Council. Other public hearing items may be deemed Final Action by the Planning Commission or forwarded to the City Council. The date of the City Council meeting, if applicable, will be announced at the Planning Commission meeting after the discussion of the item. For further information, including the full staff report, please call (702) 229-6301 (TDD 386-9108) or go to <http://www.lasvegasnevada.gov>.

## Application Location

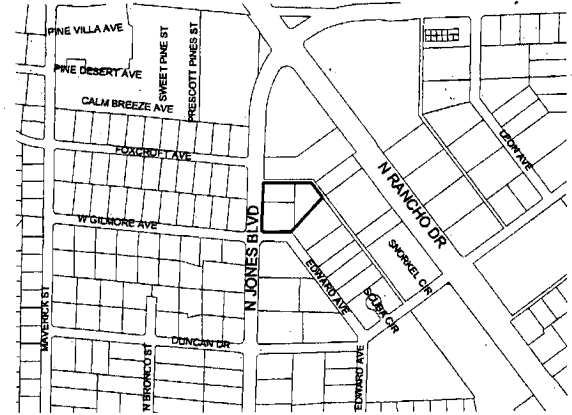

The proposed project may not pertain to the entire highlighted project site.

## Public Hearing Information

**Meeting:** Planning Commission  
**Date:** *January 10, 2012*  
**Time:** 6:00 P.M.  
**Location:** City Council Chambers  
400 Stewart Avenue  
Las Vegas, Nevada

**Report of All Selected Parcels****Case Number:** SDR-43997**Printed On:** Tue: November 29, 2011

<u>Owner</u>	<u>Address</u>	<u>Parcel Number</u>
3735 N BRONCO ST TRUST	3904 RAYMERT DR LAS VEGAS NV 89121-3247	13811601003
A D K FAMILY TRUST 2000	DIAZ ANGEL SANDOVAL TRS 7920 W LONE MOUNTAIN RD LAS VEGAS NV 89129-5302	13811511012
ABAIR ALAN & SANDRA	3916 SWEET PINES ST #102 LAS VEGAS NV 89108-8134	13811517050
ABEL STEVEN F & LEANNE E FAM TR	%S ABEL 1819 BELCASTRO ST LAS VEGAS NV 89117-2103	13811517088
ABEL STEVEN F & LEANNE E FAM TR	ABEL STEVEN F & LEANNE E TRS 1819 BELCASTRO ST LAS VEGAS NV 89117-2103	13811517086
ABEL STEVEN F & LEANNE E FAM TR	%S ABEL 1819 BELCASTRO ST LAS VEGAS NV 89117-2103	13811517155
ABEYTA L & JAFFA-ABEYTA M TR	ABEYTA LEONARD TRS 6140 GILMORE AVE LAS VEGAS NV 89108-5136	13811511028
ACKERMAN FRED 1999 FAMILY TRUST	ACKERMAN FRED TRS 3670 N BRONCO ST LAS VEGAS NV 89108-5102	13811604003
ACQUEST VEGAS L L C	80 CARTWRIGHT DR #5 AMHERST NY 14221-7055	13812102003
AGHA RAZA ALI	7865 TIDAL POOL CT LAS VEGAS NV 89139-6121	13811517028
AGHA RAZA ALI	7865 TIDAL POOL CT LAS VEGAS NV 89139-6121	13811517175
AGUILAR MELINDA P	907 CRESCENT AVE SAN FRANCISCO CA 94110-6153	13811517074
ALEX AMBER	3716 SNORKEL CIR #A LAS VEGAS NV 89108-5167	13812211029
ALI SYED A & FOZIA REV LIV TR	ALI SYED AKHTAR & FOZIA TRS 5468 CANOPY OAK DR LAS VEGAS NV 89135-4009	13811517054
AMIRI HEIDI	DOWLATSHAHI PATRICK NIMA 4777 CRAKOW CT LAS VEGAS NV 89147-8123	13811517020
ARAM'S INVESTMENTS L L C	4001 S DECATUR BLVD #37-156 LAS VEGAS NV 89103-5860	13812212006
ARAM'S INVESTMENTS L L C	4001 S DECATUR BLVD #37-156 LAS VEGAS NV 89103-5860	13812212007
ARAM'S INVESTMENTS L L C	4001 S DECATUR BLVD #37-156 LAS VEGAS NV 89103-5860	13812212008
ARAM'S INVESTMENTS L L C	4001 S DECATUR BLVD #37-156 LAS VEGAS NV 89103-5860	13812212005
ARTIAGA ROGELIO SANDOVAL	3721 SNORKEL CIR #C LAS VEGAS NV 89108-5169	13812211023
AVILA DENISE	3905 SWEET PINE ST #101 LAS VEGAS NV 89108-5195	13811517158
AVILA DENISE	3905 SWEET PINE ST #101 LAS VEGAS NV 89108-5195	13811517079
B R E PROPERTIES INC	3651 N RANCHO DR LAS VEGAS NV 89130-3129	13812210035
BABA J & A INVESTMENTS L L C	%A BABA P O BOX 43858 LAS VEGAS NV 89116-1858	13811517108
BAGORIO SHERWIN & TOMAS	45 TARALEA CIR N E CALGARY AB CANADA T3J5G8	13811517029
BALES LESLIE B & RUTH E	6157 FOXCROFT AVE LAS VEGAS NV 89108-5117	13811511019
BANK AMERICA N A	400 COUNTRYWIDE WY MS SV-35 SIMI VALLEY CA 93065-6298	13811517058
BANK AMERICA N A	400 NATIONAL WAY SIMI VALLEY CA 93065-6414	13811517136
BANK MORGAN J P CHASE NATL ASSN	800 BROOKSEDGE BLVD WESTERVILLE OH 43081-2822	13812211040
BANK NEW YORK MELLON TRS	400 NATIONAL WAY SIMI VALLEY CA 93065-6414	13811517122
BANK NEW YORK MELLON TRS	400 NATIONAL WAY SIMI VALLEY CA 93065-6414	13812210013
BANK U S NATIONAL ASSN TRS	%AMERICAN HOME MTGE SERV 4875 BELFORT RD JACKSONVILLE FL 32256-6058	13811511033

**Report of All Selected Parcels****Case Number:** SDR-43997**Printed On:** Tue: November 29, 2011

<u>Owner</u>	<u>Address</u>	<u>Parcel Number</u>
BARCLEY MYRA L	6170 CALM BREEZE AVE #102 LAS VEGAS NV 89108-8112	13811517119
BARRUGA CONSTANTE A	3717 SNORKEL CIR #B LAS VEGAS NV 89108-5148	13812211018
BARTSAS MARY 13 L L C	601 S RANCHO DR #C23 LAS VEGAS NV 89106-4825	13812110049
BARTSAS MARY 13 L L C	601 S RANCHO DR #C23 LAS VEGAS NV 89106-4825	13811502003
BASA DALE	6153 PINE DESERT AVE #102 LAS VEGAS NV 89108-8155	13811517137
BENCHMARK CONTRACTING INC	5553 SUMAC RIDGE CT LAS VEGAS NV 89149-4020	13812111003
BENCHMARK CONTRACTING INC	5553 SUMAC RIDGE CT LAS VEGAS NV 89149-4020	13812111004
BERMUDEZ RAQUEL C RAMIREZ	3701 SNORKEL CIR #C LAS VEGAS NV 89108-5162	13812211003
BIADNOK SRIPAI	5929 DUNCAN DR LAS VEGAS NV 89108-5103	13812210011
BILLMAIER GINGER ANNE	6176 CALM BREEZE AVE #103 LAS VEGAS NV 89108-8113	13811517123
BJERKE JACK L & DIANE R	P O BOX 906 VALLEY CITY ND 58072-0906	13811517110
BLUE STAR CAPITAL L L C	900 S FOURTH ST #220 LAS VEGAS NV 89101-6805	13811511014
BOTT LEAH	3929 SWEET PINE ST #102 LAS VEGAS NV 89108-8143	13811517062
BOWGREN DALE H & MARGARET C	P O BOX 28112 LAS VEGAS NV 89126-2112	13812110014
BOWGREN FAMILY L P	5320 BRAEMAR DR LAS VEGAS NV 89130-2021	13812110013
BRIGGS FAMILY REVOCABLE LIV TR	BRIGGS DORIS JOHNSON TRS 3737 BRADLEY SPRINGS CIR LAS VEGAS NV 89108-5157	13811611039
BROOKS PAULA	9526 CAPISTRANO AVE CHATSWORTH CA 91311-2631	13811517032
BROOKS STEWART	9526 CAPISTRANO AVE CHATSWORTH CA 91311-2631	13811517089
BROWN RETAIL L L C	1669 W HORIZON RIDGE PKWY #10 HENDERSON NV 89012-3426	13812211015
BURNETTE BARBARA ANN	P O BOX 8248 AMARILLO TX 79114-8248	13812211030
CACCAVALE ROBERT	5755 SUNSET DOWN ST NO LAS VEGAS NV 89081-5243	13811517049
CALLAHAN FAMILY TRUST	CALLAHAN JOHN P TRS 3700 SNORKEL CIR #3 LAS VEGAS NV 89108-5146	13812211042
CANFIELD BRADLEY D & DONNA L	6050 DUNCAN DR LAS VEGAS NV 89108-5105	13811602007
CARTER MICHAEL T	3717 SNORKEL CIR #C LAS VEGAS NV 89108-5148	13812211019
CARUSO MICHAEL FRANCIS	6164 FOXCROFT AVE LAS VEGAS NV 89108-5116	13811511003
CASTRO GERARDO M	3912 SWEET PINE ST #101 LAS VEGAS NV 89108-8183	13811517169
CASTRO GERARDO M & NEMIA J	3912 SWEET PINE ST #101 LAS VEGAS NV 89108-8183	13811517046
CHAO KO SHIH & LIFANG	10212 ROBIN HOOD CIR VILLA PARK CA 92861-4512	13811517111
CHASE HOME FINANCE L L C	10790 RANCHO BERNARDO DR SAN DIEGO CA 92127-5705	13811511010
CHEN KUAN-CHENG & LE C H FAM TR	CHEN KUAN-CHENG & LE CHAU H TRS 28371 VISTA DEL VALLE HEMET CA 92544-8361	13811517056
CHILDRESS-LEFLORE JOSEPHINE	6164 W GILMORE AVE LAS VEGAS NV 89108-5136	13811511025
CLARK JASON	5421 ROYAL YACHT WY NO LAS VEGAS NV 89031-0731	13811517047

**Report of All Selected Parcels****Case Number:** SDR-43997**Printed On:** Tue: November 29, 2011

<u>Owner</u>	<u>Address</u>	<u>Parcel Number</u>
CLARK JONATHAN A	3908 SWEET PINE ST #101 LAS VEGAS NV 89108-8129	13811517170
CLARK JONATHAN A	3908 SWEET PINE ST #101 LAS VEGAS NV 89108-8129	13811517043
CLARK NORMAN W & MARIA L	3917 PRESCOTT PINES ST #103 LAS VEGAS NV 89108-8173	13811517030
CLEVESY MICHAEL & MARCIA	P O BOX 571581 LAS VEGAS NV 89157-1581	13811511011
CLOUSE ANN M	6122 PINE VILLA AVE #101 LAS VEGAS NV 89108-8122	13811517013
CLOUSE ANN M	6122 PINE VILLA AVE #101 LAS VEGAS NV 89108-8122	13811517180
COHEN ISRAEL & SHOSANA	23673 GERRAD WY WEST HILLS CA 91307-1319	13811517027
COLEMAN LORETTA	438 W 1045 N CEDAR CITY UT 84721-4164	13811517126
COMTE KRISTIN LEE-ANN ETAL	2987 RANGE LINE RD ONTARIO CANADA L1S7M4	13811517012
Condominium master parcel		13812211000
Condominium master parcel		13811517000
Condominium master parcel		13812212000
CORD DONNA G	6158 CALM BREEZE AVE #101 LAS VEGAS NV 89108-8110	13811517112
CORD DONNA G	6158 CALM BREEZE AVE #101 LAS VEGAS NV 89108-8110	13811517147
COTTERILL ANDREW	%SMART REALTY 6955 N DURANGO DR #1115-107 LAS VEGAS NV 89149-4411	13811517178
COTTERILL ANDREW	%SMART REALTY 6955 N DURANGO DR #1115-107 LAS VEGAS NV 89149-4411	13811517019
COX FAMILY TRUST	9905 FOX SPRINGS DR LAS VEGAS NV 89117-0942	13812110021
DARLING VICKY L	WINFREE LANITA M 3725 N JONES BLVD LAS VEGAS NV 89108-5119	13811602008
DAVID STEPHANIE L & CHRISTOPHER	PSC 251 BOX 1185 APO AP 96542-0008	13811517024
DENNISON RONALD L	3981 HAMILTON ST #5 SAN DIEGO CA 92104-2853	13811517041
DERR TAMI J	3721 SNORKEL CIR UNIT D #3 LAS VEGAS NV 89108-5169	13812211024
DESERT PINE L L C	%R & L MUNDEE 8485 W EL CAMPO GRANDE AVE LAS VEGAS NV 89149-3929	13811517083
DEVANE CASHIA M	KEARNEY JERMON C 3920 SWEET PINE ST #101 LAS VEGAS NV 89108-8187	13811517167
DEVANE CASHIA M	KEARNEY JERMON C 3920 SWEET PINE ST #101 LAS VEGAS NV 89108-8187	13811517052
DEVERA ALFONSO R & N D REV TR	DEVERA ALFONSO R & NORMA D TRS 2277 PHEASANT DR HERCULES CA 94547-1640	13811517015
DIGREGORIO CHRISTINE	6153 PINE DESERT AVE #103 LAS VEGAS NV 89108-8155	13811517138
DOMINGUEZ JAIME & HUMBERTO	3704 SNORKEL CIR #C LAS VEGAS NV 89108-5163	13812211039
DONAHUE FRANK TRUST	DONAHUE FRANK J TRS 6100 YELLOWSTONE AVE LAS VEGAS NV 89156-5837	13812211020
DUCK HORN TRUST	SENDLEIN ROBIN B TRS 14737 E MARK LN SCOTTSDALE AZ 85262-7814	13812211006
DUNKLEY LESLIE J & BARBARA W	6116 GILMORE ST LAS VEGAS NV 89108-5136	13811511031
DURAND PIERRE	24 LYLEWOOD CT SACRAMENTO CA 95834-3827	13811517081
EISENBERG CHELY	A4 CHISIN ST TELAVIV 64284 ISRAEL	13812211016

**Report of All Selected Parcels****Case Number:** SDR-43997**Printed On:** Tue: November 29, 2011

<u>Owner</u>	<u>Address</u>	<u>Parcel Numbe</u>
EISENBERG CHELY	A4 CHISIN ST TELAVIV 64284 ISRAEL	13812211033
ELIADES DOLORES I	3660 N BRONCO ST LAS VEGAS NV 89108-5102	13811604005
ELLIANO J JR & ANICETTA FAM TR	%J & A ELLIANO 4117 ROXANNE DR LAS VEGAS NV 89108-5219	13811601007
EMANI ROSE G	1901 DESERT FALLS CT #102 LAS VEGAS NV 89128-2757	13811517068
EMIGBUAN JUDITH	SNOH BARTHOLOMEW WLEH JR 3925 PRESCOTT PINES ST #102 LAS VEGAS NV 89108-8177	13811517023
FARMER FAMILY 2006 LIVING TRUST	FARMER JEFFERY M & LISA A TRS %J & L FARMER P O BOX 36791 LAS VEGAS NV 89133-6791	13811511029
FEDERAL HOME LOAN MORTGAGE CORP	5000 PLANO PKWY CARROLLTON TX 75010-4900	13811517168
FEDERAL NATIONAL MORTGAGE ASSN	400 NATIONAL WAY SIMI VALLEY CA 93065-6414	13811517166
FEDERAL NATIONAL MORTGAGE ASSN	400 NATIONAL WAY SIMI VALLEY CA 93065-6414	13811517055
FERNANDEZ ROXANE	6148 W GILMORE AVE LAS VEGAS NV 89108-5136	13811511027
FINLEY PRISCILLA J	3913 SWEET PINE ST #101 LAS VEGAS NV 89108-8185	13811517073
FINLEY PRISCILLA J	3913 SWEET PINE ST #101 LAS VEGAS NV 89108-8185	13811517160
FITZPATRICK VIOLETA REVOCABLE TR	7921 MT SHASTA CIR LAS VEGAS NV 89145-4983	13812211001
FLYNN EDWARD J III	103 GLENDALE AVE MANCHESTER NH 03103-2900	13811517153
FLYNN EDWARD J III	103 GLENDALE AVE MANCHESTER NH 03103-2900	13811517094
FOURTEEN S A C SELF-STORAGE CORP	%LOAN SERVICING 1250 E MISSOURI AVE PHOENIX AZ 85014-2912	13812101004
FOURTEEN S A C SELF-STORAGE CORP	%LOAN SERVICING 1250 E MISSOURI AVE PHOENIX AZ 85014-2912	13812101005
FRIEDLANDER FRANK	5100 ROYER RANCH RD LAS VEGAS NV 89149-4742	13811517107
FRONTIER CAPITAL GROUP LTD	%D SCHAEFFER P O BOX 99 DIMMITT TX 79027-0099	13812110020
FULSTONE MARLENE LIVING TRUST	FULSTONE MARLENE TRS 6080 DUNCAN DR LAS VEGAS NV 89108-5105	13811602006
G M A C MORTGAGE L L C	1100 VIRGINIA DR FT WASHINGTON PA 19034-3204	13811517179
GALLAGHER MICHAEL & APRIL	3916 LAZY PINE ST #103 LAS VEGAS NV 89108-5188	13811517016
GALLAGHER MICHAEL & APRIL	3916 LAZY PINE ST #103 LAS VEGAS NV 89108-5188	13811517011
GALLAGHER MICHAEL & APRIL	3916 LAZY PINE ST #103 LAS VEGAS NV 89108-5188	13811517091
GALLAGHER MICHAEL J & APRIL L	3916 LAZY PINE ST #103 LAS VEGAS NV 89108-5188	13811517093
GARCIA ERIC G	6140 PINE VILLA AVE #103 LAS VEGAS NV 89108-8100	13811517006
GARCIA GERONIMO	3829 SWEET PINE ST #101 LAS VEGAS NV 89108	13811517164
GARCIA GERONIMO	3829 SWEET PINE ST #101 LAS VEGAS NV 89108	13811517061
GARCIA GIL D	760 SHADYDALE AVE WEST COVINA CA 91790-1225	13812211013
GARCIA JAIME G & ROSALINDA C	3921 SWEET PINE ST #103 LAS VEGAS NV 89108-8189	13811517069
GARCIA LISA	3912 LAZY PINE ST #103 LAS VEGAS NV 89108-5187	13811517090
GARNET ENTERPRISES L L C	%G & R GATES 6255 W ARBY AVE #376 LAS VEGAS NV 89118-4662	13811517140

**Report of All Selected Parcels****Case Number:** SDR-43997**Printed On:** Tue: November 29, 2011

<u>Owner</u>	<u>Address</u>	<u>Parcel Number</u>
GARNET ENTERPRISES L L C	%G & R GATES 6255 W ARBY AVE #376 LAS VEGAS NV 89118-4662	13811517133
GAYMAN RICHARD & DONNA	3685 N EDWARD AVE LAS VEGAS NV 89108-5123	13812210012
GEORGE JULIUS II	3913 PRESCOTT PINE ST #101 LAS VEGAS NV 89108-8171	13811517174
GEORGE JULIUS II	3913 PRESCOTT PINE ST #101 LAS VEGAS NV 89108-8171	13811517031
GRANITO GENE & SHAWN K	3770 EDWARD AVE LAS VEGAS NV 89108-5109	13812210007
GRAY ROLAND L & KELLY S	6317 LORILLE LN LAS VEGAS NV 89108-5214	13812110003
GREGG KRISTEN E	6164 CALM BREEZE AVE LAS VEGAS NV 89108-8107	13811517117
GRIZZLE JODY B & DARCY	3777 N JONES BLVD LAS VEGAS NV 89108-5119	13811602001
GROVE FAMILY TRUST	GROVE CHARLES W & JEANETTE S TRS 6156 W GILMORE AVE LAS VEGAS NV 89108-5136	13811511026
GULDENZOPH PATRICIA E	6146 PINE VILLA AVE #102 LAS VEGAS NV 89108-8126	13811517002
GUR IZHAK	14534 NEWPORT AVE #2 TUSTIN CA 92780-1017	13811517106
GVIDAS NORTHRIDGE PLAZA L L C	41775 ELM ST #201 MURRIETA CA 92562-9267	13812110012
HADI HERMAWAN	1445 AMERICAN PACIFIC DR 110-188 HENDERSON NV 89074-7402	13811517105
HALL SHERRY D	3904 LAZY PINE ST #101 LAS VEGAS NV 89108-5182	13811517082
HALL SHERRY D	3904 LAZY PINE ST #101 LAS VEGAS NV 89108-5182	13811517157
HAMMONTREE ALBERT L & DANA J	6109 FOXCROFT AVE LAS VEGAS NV 89108-5117	13811511013
HANSEN FREDERICK W & ELLEN L	3722 N JONES BLVD LAS VEGAS NV 89108-5118	13812210003
HANSEN FREDERICK W JR	3752 N JONES BLVD LAS VEGAS NV 89108-5118	13812210002
HARBOUR JAMES P & CAROLYN M	3680 N BRONCO ST LAS VEGAS NV 89108-5102	13811604001
HARDEMAN RAMONA L	P O BOX 2572 REDWOOD CITY CA 94064-2572	13811517008
HASHIMOTO FRED M & SUN R	6140 PINE VILLA AVE #102 LAS VEGAS NV 89108-8100	13811517005
HASSELFELD ERNEST C & L FAM TR	BROWN WENDY V TRS 1835 BANABA LN LAS VEGAS NV 89156-6892	13812110017
HERNANDEZ MARIA L	3909 SWEET PINE ST #103 LAS VEGAS NV 89108-8131	13811517078
HERRERA OFELIA	2900 S VALLEY VIEW BLVD #228 LAS VEGAS NV 89102-5946	13812211032
HICKS DIANE L	5820 BENNER ST #303 LOS ANGELES CA 90042-4762	13812211026
HODSON ADAM	6116 PINE VILLA AVE #102 LAS VEGAS NV 89108-8121	13811517017
HOFNER JOHN	3720 SNORKEL CIR #1 LAS VEGAS NV 89108-5168	13812211027
HOLBOKE LAWRENCE E & REGINA M	3737 KYLE SPRINGS CIR LAS VEGAS NV 89108-5155	13811611037
HOLT RONALD C	3665 EDWARD AVE LAS VEGAS NV 89108-5123	13812210014
HONTUCAN MARY NANCY	3921 PRESCOTT PINES ST #101 LAS VEGAS NV 89108-8175	13811517176
HONTUCAN MARY NANCY	3921 PRESCOTT PINES ST #101 LAS VEGAS NV 89108-8175	13811517025
HOUSING AUTHORITY SOUTHERN NV	%J HILL 340 N 11TH ST #170 LAS VEGAS NV 89101-3125	13812210021

**Report of All Selected Parcels****Case Number:** SDR-43997**Printed On:** Tue: November 29, 2011

<u>Owner</u>	<u>Address</u>	<u>Parcel Number</u>
HOWARD LARRY J	ISON-HOWARD SHERYL A 3736 JUSTIN SPRINGS CIR LAS VEGAS NV 89108-5100	13811611036
HOWARD WILLIAM S & WILLIAM SCOTT	2780 TWIN PALMS CIR LAS VEGAS NV 89117-2977	13811517063
HUGHES KAREN	3920 LAZY PINE ST #103 LAS VEGAS NV 89108-5190	13811517096
HUSAR JEROME A	3716 SNORKEL CIR #1 LAS VEGAS NV 89108-5167	13812211031
INGRAM VINCENT & CAROL L	3745 N JONES BLVD LAS VEGAS NV 89108-5119	13811602005
J A M PROPERTIES INTL L L C	3863 S VALLEY VIEW BLVD #5 LAS VEGAS NV 89103-2943	13811517145
J A M PROPERTIES INTL L L C	3863 S VALLEY VIEW BLVD #5 LAS VEGAS NV 89103-2943	13811517118
JESSUP HARRY W	2009 WESTLUND DR LAS VEGAS NV 89102-6100	13812212020
JESSUP HARRY W	2009 WESTLUND DR LAS VEGAS NV 89102-6100	13812212014
JESSUP HARRY W	2009 WESTLUND DR LAS VEGAS NV 89102-6100	13812212016
JESSUP HARRY W	2009 WESTLUND DR LAS VEGAS NV 89102-6100	13812212017
JESSUP HARRY W	2009 WESTLUND DR LAS VEGAS NV 89102-6100	13812212018
JESSUP HARRY W	2009 WESTLUND DR LAS VEGAS NV 89102-6100	13812212019
JESSUP HARRY W	2009 WESTLUND DR LAS VEGAS NV 89102-6100	13812212013
JESSUP HARRY W	2009 WESTLUND DR LAS VEGAS NV 89102-6100	13812212012
JESSUP HARRY W	2009 WESTLUND DR LAS VEGAS NV 89102-6100	13812212011
JESSUP HARRY W	2009 WESTLUND DR LAS VEGAS NV 89102-6100	13812212010
JESSUP HARRY W	2009 WESTLUND DR LAS VEGAS NV 89102-6100	13812212009
JESSUP HARRY W	2009 WESTLUND DR LAS VEGAS NV 89102-6100	13812212015
JOHNSON PAULETTE L	6122 PINE VILLA AVE #102 LAS VEGAS NV 89108-8122	13811517014
JOHNSON SEAN	3908 LAZY PINE ST #101 LAS VEGAS NV 89108-5184	13811517085
JOHNSON-BASS BEVERLY	BASS LEROY %FIDELITY NATL TITLE AGENCY NV 500 N RAINBOW BLVD #100 LAS VEGAS NV 89107-1058	13812212023
JOHNSON-BASS BEVERLY	BASS LEROY %FIDELITY NATL TITLE AGENCY NV 500 N RAINBOW BLVD #100 LAS VEGAS NV 89107-1058	13812212024
JOHNSON-BASS BEVERLY	BASS LEROY %FIDELITY NATL TITLE AGENCY NV 500 N RAINBOW BLVD #100 LAS VEGAS NV 89107-1058	13812212025
JOHNSON-BASS BEVERLY	BASS LEROY %FIDELITY NATL TITLE AGENCY NV 500 N RAINBOW BLVD #100 LAS VEGAS NV 89107-1058	13812212026
KABILING DONNA	%L KABILING 4935 DONNA ST NO LAS VEGAS NV 89081-3047	13811517009
KIRKWOOD JOEL & AMBER	3913 PRESCOTT PINES ST #103 LAS VEGAS NV 89108-8171	13811517033
KIRKWOOD JOEL D	3913 PRESCOTT PINES ST #103 LAS VEGAS NV 89108-8171	13811517034
KIRKWOOD JOEL D	3913 PRESCOTT PINES #103 LAS VEGAS NV 89108-8171	13811517173

**Report of All Selected Parcels****Case Number:** SDR-43997**Printed On:** Tue: November 29, 2011

<u>Owner</u>	<u>Address</u>	<u>Parcel Numbe</u>
KITE KENNETH DALE	3704 SNORKEL CIR #2 LAS VEGAS NV 89108-5163	13812211037
KLIPSTAITE PATRICIJA	P O BOX 800772 SANTA CLARITA CA 91380-0772	13812211034
KOELLER RANDY & LADONNA	5112 COPPER RIVER AVE LAS VEGAS NV 89130-2938	13812211043
KRISTI INC	P O BOX 800772 SANTA CLARITA CA 91380-0772	13812211038
KRISTI INC	P O BOX 800772 SAN CLARITA CA 91380-0772	13812211010
KURLAND MARCIA	3905 PRESCOTT PINES ST #103 LAS VEGAS NV 89108-8167	13811517039
LAI PAK SUNG & ANGIE WONG	2128 BELLBROOK ST COVINA CA 91724-2346	13811517162
LAI PAK SUNG & ANGIE WONG	2128 BELLBROOK ST COVINA CA 91724-2346	13811517067
LAKES RESIDENCY L L C	7150 BEVERLY GLENN LAS VEGAS NV 89110-4206	13812111005
LAKIS MARK G & KITTY M	6320 DARBY AVE LAS VEGAS NV 89146-6608	13811517132
LAM PUN-TAK ROGER	REIMER LAI MING 11252 EMERALD PINE LN LAS VEGAS NV 89138-1589	13811517185
LAM ROGER PUN-TAK	REIMER LAI MING 11252 EMERALD PINE LN LAS VEGAS NV 89138-1589	13811517072
LANDINI RICHARD J & JANEEN	9116 CRIMSON CLOVER LAS VEGAS NV 89134-1815	13811511018
LANE KAMERON A	3916 LAZY PINE ST #101 LAS VEGAS NV 89108-5188	13811517154
LARA HECTOR RODRIGUEZ	DERODRIGUEZ VALENTINA MODESTO 6108 W GILMORE AVE LAS VEGAS NV 89108-5136	13811511032
LAS VEGAS DEV GROUP L L C	397 3RD AVE #A CHULA VISTA CA 91910-3982	13811517057
LAS VEGAS PROPERTY L L C	9551 GLADBECK AVE NORTHRIDGE CA 91324-2221	13812211005
LAWRENCE CARL F	3736 KYLE SPRINGS CIR LAS VEGAS NV 89108-5155	13811611038
LAYMAN JOHN P & PATRICIA M	8512 LYNHURST DR LAS VEGAS NV 89134-8635	13812211022
LE MICHAEL	NGO THUY HANG & TONY 5664 SULTANA AVE TEMPLE CITY CA 91780-2327	13811517051
LEASKAS VICKY	WIGGINS RODNEY K JR 3751 EDWARD AVE LAS VEGAS NV 89108-5108	13812210005
LEAU FRANCIS M & ADELINE L	6133 FOXCROFT AVE LAS VEGAS NV 89108-5117	13811511016
LEDDY JAMES	6177 PINE DESERT AVE #101 LAS VEGAS NV 89108-8163	13811517124
LEDDY JAMES	6177 PINE DESERT AVE #101 LAS VEGAS NV 89108-8163	13811517143
LEE JEFFERY JAMES THOMAS	3928 LAZY PINE ST #102 LAS VEGAS NV 89108-8149	13811517101
LEEPER MATTHEW	CHRISTENSEN JOYCE 5546 CAMINO AL NORTE #2316 NO LAS VEGAS NV 89031-0805	13812211044
LEVIN EUGENE R & MARILYN L	3715 N JONES BLVD LAS VEGAS NV 89108-5119	13811602009
LEWIS MICHAEL R & CAROLYN K	6165 PINE DESERT AVE #102 LAS VEGAS NV 89108-8159	13811517131
LU CHYI-CHING & YUH-YUN	3908 LAZY PINE ST #103 LAS VEGAS NV 89108-5184	13811517087
LUZ SANTA MARIE	P O BOX 750814 LAS VEGAS NV 89136-0814	13812211021
MACON JANISSA	2128 SADDLEBILL CT NO LAS VEGAS NV 89084-3109	13811517048
MADDOX RICHARD A & BETH L	6812 WAR EAGLE CIR LAS VEGAS NV 89108-5017	13811517141

**Report of All Selected Parcels****Case Number:** SDR-43997**Printed On:** Tue: November 29, 2011

<u>Owner</u>	<u>Address</u>	<u>Parcel Number</u>
MADDOX RICHARD A & BETH L	6812 WAR EAGLE CIR LAS VEGAS NV 89108-5017	13811517130
MADSEN CHRISTOPHER E	6158 CALM BREEZE AVE #102 LAS VEGAS NV 89108-8110	13811517113
MAGRUDER JAMES & THERESA LIV TR	MAGRUDER JAMES K & THERESA M TRS 4321 FLANDES ST LAS VEGAS NV 89121-5330	13812210008
MANUMALEUNA BRANDON	6159 PINE DESERT AVE #102 LAS VEGAS NV 89108-8157	13811517134
MANZO THOMAS	3928 LAZY PINE ST LAS VEGAS NV 89108-8148	13811517151
MANZO THOMAS	3928 LAZY PINE ST LAS VEGAS NV 89108-8148	13811517100
MARKLE KELCIE	3925 SWEET PINES ST #102 LAS VEGAS NV 89108-8140	13811517065
MARTINEZ JOAQUIN	MARTINEZ JOSE MANUEL 5434 W ALEXANDER RD LAS VEGAS NV 89130-2806	13812110019
MARTINEZ JOAQUIN & JOSE	MARTINEZ FULGENCIO 5434 W ALEXANDER RD LAS VEGAS NV 89130-2806	13812110018
MASJID IBRAHIM INC	%S HASEEBULLAH 2102 DONLON CT HENDERSON NV 89012-2709	13812210001
MASOOD AHMED & MALKA M	6171 PINE DESERT AVE #102 LAS VEGAS NV 89108-8161	13811517128
MASTERSON III TRUST	MASTERSON TRACY & C III TRS 6124 W GILMORE AVE LAS VEGAS NV 89108-5136	13811511030
MATHIEU RHEA	KEEFE VAL QUINCY 6158 QUINTILLION AVE LAS VEGAS NV 89122-3461	13812110008
MENEICE DAVID J & JUDITH REV TR	MENEICE DAVID & JUDITH TRS 3733 BRADLEY SPRINGS CIR LAS VEGAS NV 89108-5157	13811611012
MEYER KENNETH W JR	MEYER KENNETH & TRACEY P O BOX 232 PIOCHE NV 89043-0232	13812211007
MIONE TRISA L	7320 GENTLE VALLEY ST LAS VEGAS NV 89149-1616	13811517149
MOE ALTA M	135 BONNIE DOONE LN OAK HARBOR WA 98277-9602	13811517037
MOE ALTA M	135 BONNIE DOONE LN OAK HARBOR WA 98277-9602	13811517172
MONTESANO LUCILLE	WILEY JOHN JR 6116 FOXCROFT AVE LAS VEGAS NV 89108-5116	13811511009
MONTOYA ORLANDO & LISA M	6101 W GILMORE AVE LAS VEGAS NV 89108-5113	13811611016
MOORE LOREN & MICHELLE M	5932 LADY CAROLINA ST NO LAS VEGAS NV 89081-6457	13811517077
MOREHEAD FAMILY TRUST	MOREHEAD SUZANNE J & HAROLD TRS 3715 N BRONCO ST LAS VEGAS NV 89108-5132	13811601008
MORGAN FOSTER J JR & MEREDITH M	6141 FOXCROFT AVE LAS VEGAS NV 89108-5117	13811511017
MUNGIA-PINEDA CRISTIAN	3665 N JONES BLVD LAS VEGAS NV 89108-5121	13811604006
NEILL HARVEY D & MARGARET L	3736 BRADLEY SPRINGS CIR LAS VEGAS NV 89108-5157	13811611040
NERO DOROTHY W REVOCABLE LIV TR	NERO DOROTHY W TRS 3732 BRADLEY SPRINGS CIR LAS VEGAS NV 89108-5157	13811611013
NGUYEN LIEU THE	LAM SANG THU 191 ARBOUR CREST RISE N W CALGARY AB T3G4R9 CANADA	13811517076
NGUYEN LIEU THE	LAM SANG THU 191 ARBOUR CREST RISE NW CALGARY ALBERTA T3G 4R9 CANADA	13811517080
NGUYEN LIEU THE	LAM SANG THU 191 ARBOUR CREST RISE N W CALGARY AB T3G4R9 CANADA	13811517159
OBRIEN DAN & MARIA DELIA C	6128 PINE VILLA AVE #101 LAS VEGAS NV 89108-8123	13811517181
OBRIEN DAN & MARIA DELIA C	6128 PINE VILLA AVE #101 LAS VEGAS NV 89108-8123	13811517010
OCEANSIDE CYPRESS APRINGS L L C	%S DONIA 16133 VENTURA BLVD #1045 ENCINO CA 91436-2423	13812202002

**Report of All Selected Parcels****Case Number:** SDR-43997**Printed On:** Tue: November 29, 2011

<u>Owner</u>	<u>Address</u>	<u>Parcel Number</u>
OCHOA FRANCISCO JAVIER GONZALEZ	3705 SNORKEL CIR #D LAS VEGAS NV 89108-5164	13812211008
ORLANDO SUZANNE E	3904 SWEET PINE ST #103 LAS VEGAS NV 89108-8181	13811517042
PANIAGUA PABLO	6060 DUNCAN DR LAS VEGAS NV 89108-5105	13811602003
PARKS JACQUELINE	5908 DUNCAN DR LAS VEGAS NV 89108-5104	13812210004
PARTIGUIAN HRAG & CAROL	2408 TWIN FLOWER CIR LAS VEGAS NV 89134-6006	13812211025
PAZ FAMILY LIVING TRUST	PAZ CAESAR JR & ESMERALDA TRS 600 FESTIVO ST OXNARD CA 93030-7304	13811517115
PEDROLA JILL & STEVE	6132 FOXCROFT AVE LAS VEGAS NV 89108-5116	13811511007
PERCELL BRADLEY S	HENSEN AMBER L 6156 FOXCROFT AVE LAS VEGAS NV 89108-5116	13811511004
PERCELL RICHARD & LISA LIVING TR	PERCELL RICHARD E & LISA N TRS 6148 FOXCROFT LAS VEGAS NV 89108-5116	13811511005
PETERSON LIVING TRUST	PETERSON ALAN R & SUSAN L TRS 6125 FOXCROFT AVE LAS VEGAS NV 89108-5117	13811511015
PHAM DIANA	3961 OAKDALE AVE PASADENA CA 91107-4912	13812212021
PIKE RANDALL & CYNTHIA	6164 CALM BREEZE AVE #102 LAS VEGAS NV 89108-8111	13811517116
POOLE-SANFORD L L C	3901 N RANCHO DR LAS VEGAS NV 89130-3415	13812110005
POOLE-SANFORD L L C	3901 N RANCHO DR LAS VEGAS NV 89130-3415	13812110004
PREMDAS ALISON R	3700 SNORKEL CIR LAS VEGAS NV 89108-5146	13812211041
PRODROMIDES JOHN & BRENDA	1916 SMITH ST LAS VEGAS NV 89108-2433	13811517092
REAGAN LYNE	3913 SWEET PINE ST #103 LAS VEGAS NV 89108-8185	13811517075
REINHARDT KATHERINE A	6177 PINE DESERT AVE #102 LAS VEGAS NV 89108-8163	13811517125
REXING MATTHEW K	3745 N BRONCO ST LAS VEGAS NV 89108-5132	13811601004
RICH MAURISSA K & JEREMY A	6116 PINE VILLA AVE #103 LAS VEGAS NV 89108-8121	13811517018
ROBERTS JOSEPH P & SANDRA J	3685 N JONES BLVD LAS VEGAS NV 89108-5121	13811604002
ROBISON ELMER LEE & MARY KAYE	6124 FOXCROFT AVE LAS VEGAS NV 89108-5116	13811511008
ROBITAILLE JANET	3928 LAZY PINE ST #103 LAS VEGAS NV 89108-8149	13811517102
ROGERS PAUL STEWART & M P FAM TR	ROGERS PAUL S & MELINDA P TRS 3685 N BRONCO ST LAS VEGAS NV 89108-5101	13811603004
ROMMELFANGER KURT	3737 JUSTIN SPRINGS CT LAS VEGAS NV 89108-5100	13811611003
ROSAS DAVID J III	1025 CALHOUN AVE BRONX NY 10465-1910	13811517038
ROSE MICHAEL S & CAROL D	5424 IRELAND ST LAS VEGAS NV 89149-2019	13811517163
ROSE MICHAEL S & CAROL D	5424 IRELAND ST LAS VEGAS NV 89149-2019	13811517064
ROSENSTEIN STEVEN M	3925 PRESCOTT PINES ST #101A LAS VEGAS NV 89108-8177	13811517177
ROSENSTEIN STEVEN M & RACHEL	3925 PRESCOTT PINES ST #101A LAS VEGAS NV 89108-8177	13811517022
ROSS IRIS M	6159 PINE DESERT AVE #103 LAS VEGAS NV 89108-8157	13811517135
ROVERE GREG	RETCHLESS VICTORIA ANN 100 PANORAMA DR #A LAS VEGAS NV 89107-1131	13811517095

**Report of All Selected Parcels****Case Number:** SDR-43997**Printed On:** Tue: November 29, 2011

<u>Owner</u>	<u>Address</u>	<u>Parcel Number</u>
ROVERE GREG A	RETCHLESS VICTORIA ANN 100 PANORAMA DR #A LAS VEGAS NV 89107-1131	13811517003
SANTOS AMANDA RIBERTO	3929 PRESCOTT PINES ST #103 LAS VEGAS NV 89108-8179	13811517021
SECRETARY HOUSING & URBAN DEV	%CR TITLE SERV 1000 TECHNOLOGY DR MS-314 O'FALLON MO 63368-2239	13811517053
SHERPA INVESTMENTS L L C	%C MCCLAUGHLIN 3528 BROOKS RANGE ST LAS VEGAS NV 89129-7339	13811511006
SHIRLEY RYAN L	6171 PINE DESERT AVE #101 LAS VEGAS NV 89108-8161	13811517127
SHIRLEY RYAN L	6171 PINE DESERT AVE #101 LAS VEGAS NV 89108-8161	13811517142
SINGMAN LEIF V & ONNIE V	3735 N JONES BLVD LAS VEGAS NV 89108-5119	13811602004
SISOMPHOU SOUK & VENG	SISOMPHOU MANIVANH 3750 EDWARD AVE LAS VEGAS NV 89108-5109	13812210009
SLAGLE DON L	3674 N JONES BLVD LAS VEGAS NV 89108-5120	13812210020
SLAVIN HELEN	%H BALDWIN 517 FALCON LN LAS VEGAS NV 89107-3838	13812101002
SMITH CHRISTOPHER A	1116 PORTER ST RIDGECREST CA 93555-8805	13811517071
SMITH REVOCABLE TRUST	SMITH TIMOTHY P TRS 3675 N JONES BLVD LAS VEGAS NV 89108-5121	13811604004
SMITH ROBERT	10420 S ARVILLE ST LAS VEGAS NV 89141-0900	13812211012
SMITH TIMOTHY P REVOCABLE TRUST	SMITH TIMOTHY P TRS 3675 N JONES BLVD LAS VEGAS NV 89108-5121	13811611041
SODHA AMAR K	2436 PASEO DEL PALACIO CHINO HILLS CA 91709-5031	13811517044
SOJKA MARYLEE	2721 MOON WAVE AVE NO LAS VEGAS NV 89031-1105	13811517098
SOMOYA JOHN P & V R REV LIV TR	SOMOYA JOHN P & VIRGINIA R TRS 10040 KEYSBOROUGH DR LAS VEGAS NV 89134-7546	13812211017
SOTELO HONORIO P & TAMARA S	3732 KYLE SPRINGS CIR LAS VEGAS NV 89108-5155	13811611009
SOWDER JEFFREY L	GREELEY SHARI ANN 6134 PINE VILLA AVE #101 LAS VEGAS NV 89108-8124	13811517007
SOWDER JEFFREY L	GREELEY SHARI ANN 6134 PINE VILLA AVE #101 LAS VEGAS NV 89108-8124	13811517182
SPEIGHT DAVID & GLENDA	20275 OSPRING ST MAPLE RIDGE B C CANADA V2X 1K5	13811517148
SPEIGHT DAVID & GLENDA	20275 OSPRING ST MAPLE RIDGE B C CANADA V2X 1K5	13811517109
SROMALLA FAMILY TRUST	SROMALLA CURTIS D & VICKIE S TRS 6618 GOLDEN BIT AVE LAS VEGAS NV 89131-0220	13812110052
STETS MARK	3925 LOST MINER CT LAS VEGAS NV 89129-7658	13811517099
STEWART BRUCE	6146 PINE VILLA AVE #101 LAS VEGAS NV 89108-8126	13811517184
STEWART BRUCE	6146 PINE VILLA AVE #101 LAS VEGAS NV 89108-8126	13811517001
STEWART THOMAS J	3904 LAZY PINES ST #103 LAS VEGAS NV 89108-5182	13811517084
TATE JAY C	6171 PINE DESERT AVE #103 LAS VEGAS NV 89108-8161	13811517129
TAXPAYER	LAS VEGAS NV 89000	13811517121
TAXPAYER	LAS VEGAS NV 89000	13811517036
TAXPAYER	LAS VEGAS NV 89000	13811611008
THATCHER LLOYD E	6070 DUNCAN DR LAS VEGAS NV 89108-5105	13811602002

**Report of All Selected Parcels****Case Number:** SDR-43997**Printed On:** Tue: November 29, 2011

<u>Owner</u>	<u>Address</u>	<u>Parcel Number</u>
THODUPUNOORI SRIKANTH	480 BOYTON AVE #16 SAN JOSE CA 95117-1433	13811517059
THOMA ERIC D	3908 SWEET PINE ST #103 LAS VEGAS NV 89108-8129	13811517045
THOMAS LARRY D & NERISSA L	6500 W EL CAMPO GRANDE AVE LAS VEGAS NV 89130-1218	13812110015
THOMAS LAURA	3709 SNORKEL CIR LAS VEGAS NV 89108-5147	13812211009
TISDALE DAVID	6153 PINE DESERT AVE #101 LAS VEGAS NV 89108-8155	13811517139
TRICE JOHN R	3709 SNORKEL CIR #1 C LAS VEGAS NV 89108-5147	13812211011
TRINIDAD TITO	3732 JUSTIN SPRINGS CIR LAS VEGAS NV 89108-5100	13811611005
TRUSTEE CLARK COUNTY TREASURER	%BANK NEW YORK TRS 2300 BROOKSTONE CENTRE PKWY COLUMBUS GA 31904-4500	13811517146
TRUSTEE CLARK COUNTY TREASURER	%TOWNER PHELEANCE 3928 SWEET PINE ST #101 LAS VEGAS NV 89108-8191	13811517165
TRUSTEE CLARK COUNTY TREASURER	%JOHNSON SEAN 3908 LAZY PINE ST #101 LAS VEGAS NV 89108-5184	13811517156
TRUSTEE CLARK COUNTY TREASURER	%ELIAS YOLANDA 316 AUTUMN PALACE CT LAS VEGAS NV 89144-4108	13811517152
UGOCHUKWU VITALIS N & GLORIA N	4430 CELESTE CT VALLEJO CA 94591-6385	13811517035
ULANSKI MICHAEL	3921 PRESCOTT PINES ST #102 LAS VEGAS NV 89108-8175	13811517026
VALADEZ ANTONIO VAZQUEZ	3701 SNORKEL CIR #3 LAS VEGAS NV 89108-5162	13812211004
VARTANOVA REGINA S	P O BOX 235093 ENCINITAS CA 92023-5093	13811517114
VASEUR DAWN A REVOCABLE LIV TR	VASEUR DAWN A TRS 6165 FOXCROFT AVE LAS VEGAS NV 89108-5117	13811511020
VERRI ROBERT JR LIVING TRUST	4521 OCEAN BREEZE AVE NO LAS VEGAS NV 89031-0223	13812211036
VOLK MICHAEL D	3909 LAZY PINE ST #102 LAS VEGAS NV 89108-5185	13811517104
W & H ASSOCIATES L L C	16468 BELL RIDGE DR CHINO HILLS CA 91709-4911	13811517066
WALSH DORIS A	8812 MARGURITE DR OCEAN SPRINGS MS 39564-7667	13812211014
WEINBERGER DAVID ALAN	3924 LAZY PINE #101 LAS VEGAS NV 89108-8145	13811517097
WESTCARE WORKS INC	P O BOX 94738 LAS VEGAS NV 89193-4738	13812210036
WHITE HAROLD DEAN REV LIV TR	WHITE HAROLD DEAN TRS 9340 OLYMPIA FALLS AVE LAS VEGAS NV 89149-0193	13812211002
WHITE HAROLD DEAN REV LIV TR	WHITE HAROLD DEAN TRS 9340 OLYMPIA FALLS AVE LAS VEGAS NV 89149-0193	13812211035
WIGGINS RODNEY & LORA KAY	3778 EDWARD AVE LAS VEGAS NV 89108-5109	13812210006
WILBURN PHYLLIS L REV LIV TR	5969 DUNCAN DR LAS VEGAS NV 89108-5103	13812210010
WILCOX GEOFF	3917 SWEET PINE ST #101 LAS VEGAS NV 89108-8136	13811517070
WILCOX GEOFF	3917 SWEET PINE ST #101 LAS VEGAS NV 89108-8136	13811517161
WOOD ROBERT F	3720 SNORKEL CIR #D LAS VEGAS NV 89108-5168	13812211028
WOOD ROBIN L	3928 SWEET PINE ST #103 LAS VEGAS NV 89108-8191	13811517060
WOYTOWISH STEPHEN J	3904 SWEET PINE ST #101 LAS VEGAS NV 89108-8181	13811517040
WOYTOWISH STEPHEN J	3904 SWEET PINE ST #101 LAS VEGAS NV 89108-8181	13811517171

**Report of All Selected Parcels**

**Case Number:** SDR-43997

**Printed On:** Tue: November 29, 2011

<u>Owner</u>	<u>Address</u>	<u>Parcel Number</u>
YOUNG JOHN M & ROBIN L	6176 CALM BREEZE AVE #101 LAS VEGAS NV 89108-8113	13811517144
YUAN JERRY	423 ST PAUL BLVD #2A NORFOLK VA 23510-2818	13811517120
ZABIB MARTY	ARIELI OFIR 4435 S BUFFALO DR LAS VEGAS NV 89147-5006	13811517103
ZABIB MARTY	ARIELI OFIR 4435 S BUFFALO DR LAS VEGAS NV 89147-5006	13811517150