



Legal Notices Transmittal and Scanning Separator Sheet

Legal Notice Type: Legal Mailings

Date of Transfer to ERM: 9/17/2012

Page Count: 47

Meeting Date: 9/11/2012

Meeting Type: Planning Commission <=>

Case Number(s): SDR-46293 <=>

Subject of Affidavit: APPLICANT: DR HORTON, INC. - OWNER: FORT GRAND, LLC - on 31.8 acres at the northeast corner of Grand Teton Drive and Tee Pee Lane (APN 125-07-801-003) <=>

Record Series: Legal Notices

LRDA Number: 2007-1717

Retention: Permanent

File By: Meeting Date



Prepared By: gportillo

Scanned By:

QC By:

SCANNED

SEP 18 2012

City of Las Vegas
Department of Planning
Development Services Center
333 North Rancho Drive, 3rd Floor
Las Vegas, Nevada 89106

Return Service Requested
Official Notice of Public Hearing

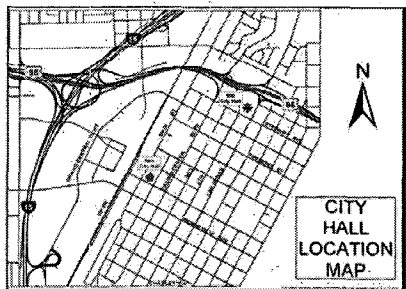

If you wish to file your protest or support on this request, check the appropriate box below and return this card in an envelope with postage to the Department of Planning, Case Planning Division at the address listed above or fax this side of this card to (702) 385-7268. If you would like to contact your Council Representative, please call (702) 229-6405.

I SUPPORT
this Request

I OPPOSE
this Request

Please use available blank space on card for your comments.

SDR-46293

Planning Commission Meeting of **09/11/2012**

Application Information

SDR-46293 - SITE DEVELOPMENT PLAN REVIEW RELATED TO GPA-46373 AND MOD-46292 - PUBLIC HEARING - APPLICANT: DR HORTON, INC. - OWNER: FORT GRAND, LLC - For possible action on a request for a Site Development Plan Review FOR A PROPOSED 183-LOT RESIDENTIAL SUBDIVISION WITH A WAIVER OF THE TOWN CENTER RESIDENTIAL STREET STANDARDS AND AN ASSOCIATED ENCROACHMENT INTO THE PUBLIC RIGHTS-OF-WAY ON 31.8 acres at the northeast corner of Grand Teton Drive and Tee Pee Lane (APN 125-07-801-003), T-C (Town Center) Zone [EC-TC (Employment Center Mixed Use - Town Center) Special Land Use Designation] [PROPOSED: ML-TC (Medium-Low Residential - Town Center)], Ward 6 (Ross).

Application Location

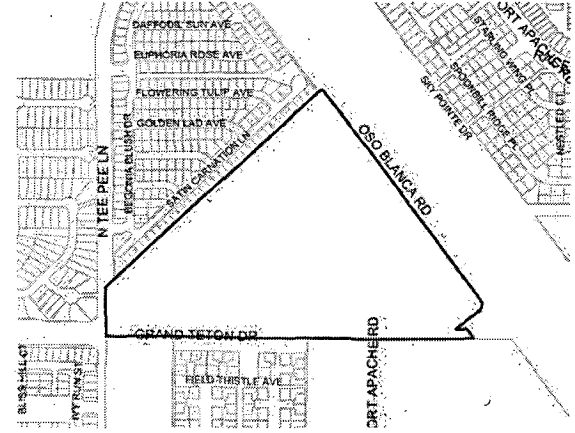

The proposed project may not pertain to the entire highlighted project site.

Public Hearing Information

Meeting: Planning Commission
Date: *September 11, 2012*
Time: 6:00 P.M.
Location: City Council Chambers
495 South Main Street
Las Vegas, Nevada

Any and all interested persons may appear before the City Planning Commission either in person or by representative and object to or express approval of this request; or may, prior to this meeting, file a written objection thereto or approval thereof with the Department of Planning, Case Planning Division, Development Services Center, 333 North Rancho Drive, 3rd Floor, Las Vegas, Nevada 89106. Final Action on General Plan Amendments and Rezoning will be determined by the City Council. Other public hearing items may be deemed Final Action by the Planning Commission or forwarded to the City Council. The date of the City Council meeting, if applicable, will be announced at the Planning Commission meeting after the discussion of the item. For further information, including the full staff report, please call (702) 229-6301 (TDD 386-9108) or go to <http://www.lasvegasnevada.gov>.

Report of All Selected Parcels**Case Number:** MOD-46292**Printed On:** Thu: July 26, 2012

<u>Owner</u>	<u>Address</u>	<u>Parcel Number</u>
1018 TRUST	6955 N DURANGO DR #1115-387 LAS VEGAS NV 89149-4411	12507715034
1062 TRUST	6955 N DURANGO #1115-387 LAS VEGAS NV 89149-4411	12507715122
2000 FATBOY L L C	8071 LOTTIE AVE LAS VEGAS NV 89149-4769	12507813036
2018 TRUST	6955 N DURANGO DR #115-387 LAS VEGAS NV 89149-4411	12507715042
8057 FARTHINGS HILL ASSOC L L C	88 LENOX RD WAYNE NJ 07470-5551	12507810042
A G H C L L C	%W AU 8406 MONDAVI HILL CT LAS VEGAS NV 89139-7166	12518514065
A S H C L L C	%W AU 8406 MONDAVI HILL CT LAS VEGAS NV 89139-7166	12518513040
A W T T L L C	%W AU 8406 MONDAVI HILL CT LAS VEGAS NV 89139-7166	12518513116
ABBOTT TAMMY	4008 FOREST KNOLL LN LAS VEGAS NV 89129-5429	12507715088
ABELARD VENISE	COMPERE MARCUS 9352 CRANESBILL CT LAS VEGAS NV 89149-1636	12518513016
ABLAHAD NICK	8250 GRAND CANYON DR #1172 LAS VEGAS NV 89166-3739	12507715336
ABLAHAD NICK	8250 N GRAND CANYON DR #1172 LAS VEGAS NV 89166-3739	12507715304
ABODEELY SCOTT G	PEARCE BALINDA J 8324 FAWN MEADOW CT LAS VEGAS NV 89149-4513	12507715371
ABRAMS GROUP	%S ABRAMS P O BOX 89398 HONOLULU HI 96830-7398	12507715044
ABTAHI LALEH	1589 SABATINI HENDERSON NV 89052-4127	12507715271
ACOSTA TERESA R	8348 WINTERCHASE PL LAS VEGAS NV 89143-6414	12508327039
ADIB RAMINA	9305 LONGHORN FALLS CT LAS VEGAS NV 89149-0133	12507715073
A FEWORK AYALEW	8156 SATIN CARNATION LN LAS VEGAS NV 89166-3768	12507815021
AGRESOR JAY C	8404 TETON CREST PL LAS VEGAS NV 89143-6419	12508327005
AGUILAR TERESA M	12570 BROMONT AVE SAN FERNANDO CA 91340-1249	12508419014
AHERN DANIEL A & LINDA L	9336 CRANESBILL CT LAS VEGAS NV 89149-1636	12518514009
AIRINGTON GREGORY & LISA M	7906 IVY RUN ST LAS VEGAS NV 89149-1688	12518515004
AKHAVAN MAHNAZ	4605 GALENDO ST WOODLAND HILLS CA 91364-5313	12507715222
AKHLAGHI BITA	325C GLEN ECHO LN CARY NC 27518-9633	12507715308
AKIN MICHAEL & STACIA E	39840 AVENIDA PALIZADA MURRIETA CA 92563-5221	12518511072
ALAN DAVID & MORGAN	8236 BRILLIANT POMPON PL LAS VEGAS NV 89166-3773	12507713031
ALCOSER JOSEPHINE T & DANIEL	8004 FARTHINGS HILL DR LAS VEGAS NV 89166-3702	12507810001
ALDERMAN ANTOINETTE	8028 FARTHINGS HILL DR LAS VEGAS NV 89166-3702	12507810007
ALISO TRUST	BEGONIA TRUST 6955 N DURANGO DR #1115-387 LAS VEGAS NV 89149-4411	12507713008
ALLEN GEORGE W & MARIANNE L	2557 42ND AVE LONGVIEW WA 98632-4945	12507715157
ALLEN JAMMIE	9528 CABOT FALLS AVE LAS VEGAS NV 89149-3724	12518511062
ALLEN-ROSS MARIA	CHAPMAN JOHN 9121 STARLING WING PL LAS VEGAS NV 89143-4485	12508419094

Report of All Selected Parcels**Case Number:** MOD-46292**Printed On:** Thu: July 26, 2012

<u>Owner</u>	<u>Address</u>	<u>Parcel Numbe</u>
ALMANSOUR MUMTAZ & JENAN	2021 COLINA GRANDE EL CAJON CA 92019-3591	12507715223
ALMANZA JOSHUA & MELISSA	7906 POINT OAKS CT LAS VEGAS NV 89149-1693	12518515079
ALMARIPO L L C	9228 DALMAHOY PL LAS VEGAS NV 89145-8722	12507811007
ALMARIPO L L C	9228 DALMAHOY PL LAS VEGAS NV 89145-8722	12507715189
ALMARIPO L L C	9228 DALMAHOY PL LAS VEGAS NV 89145-8722	12507715398
ALOSI ALBERT	2040 SAN PEDRO MORGAN HILL CA 95037-9562	12507811011
AL-TUWAIJRI MOHAMMED	%S MALERBE 207 18TH ST HUNTINGTON BEACH CA 92648-3903	12508419049
ALVEY MARIE N	6619 RINGBILL CT NO LAS VEGAS NV 89084-2606	12508418001
AMATO VINCE	NOE KAREN M 28051 27 MILE RD LENOX MI 48048-1706	12518514025
AMBLER JOHN W & COLLEEN D	8540 O HARE RD LAS VEGAS NV 89143	12508419054
AMORY REGINALD B	9345 FLOWERING TULIP AVE LAS VEGAS NV 89166-3770	12507815038
ANDERSON JEREMY & ANGELA	8128 SATIN CARNATION LN LAS VEGAS NV 89166-3767	12507816022
ANDERSON LAWRENCE T & SHEILA M	9081 SPOONBILL RIDGE PL LAS VEGAS NV 89143-4496	12508419030
ANDRA MIRCEA	CONDEI OFELIA 9120 BIG PLANTATION AVE LAS VEGAS NV 89143-5442	12507715177
ANDRE DAVID	9320 BUTTERCUP CT LAS VEGAS NV 89149-1629	12518514078
ANDREE KEVIN L	34046 N PATE PL CAVE CREEK AZ 85331-4033	12508419043
ANDREWS RICHARD LYNN & NANCY J	8260 BRILLANT POMPON PL LAS VEGAS NV 89166-3775	12507713025
APODERADO VAL	9450 BLOOMING GROVE AVE LAS VEGAS NV 89149-1697	12518515036
ARANAS RICHARD & BONDA FAMILY TR	ARANAS RICHARD & BONDA TRS 1755 E SAMPLE ST FRESNO CA 93710-5742	12518514118
ARIAS JULIUS F	7940 STORMY FALLS ST LAS VEGAS NV 89149-3729	12518511023
ARIAS NICOLAS	8008 FARTHING HILL ST LAS VEGAS NV 89166-3702	12507715179
ARIAS NICOLAS & ROSALBA	8008 FARTHING HILL DR LAS VEGAS NV 89166-3702	12507810002
ARLT BRIAN THOMAS	9412 EAGLE RIVER CT LAS VEGAS NV 89166-3704	12507810018
ARNOWITZ CINDY	8132 STARLING VIEW CT LAS VEGAS NV 89166-3719	12507812001
ARONICA DIEGO A	6633 YUCCA APT 201 HOLLYWOOD CA 90028-4104	12507715047
ARTHUR KAREN A	9065 SPOONBILL RIDGE PL LAS VEGAS NV 89143-4497	12508419026
ASTLE JOHN JR	PIERCE KIMBERLY A 8148 NESTLED CT LAS VEGAS NV 89143-6406	12508419081
AURORA LOAN SERVICES L L C	2617 COLLEGE PK DR SCOTTSDLUFF NE 69361-2294	12518510066
AYALA JAVIER	7918 BAKMAN AVE SUN VALLEY CA 91352-4427	12508325035
AYVAZIAN HENRY & ANAHID LIV TR	AYVAZIAN HENRY & ANAHID TRS 20 MAYGREEN CT GLENDALE CA 91206-1736	12518510027
AZEB OUMMAR	3046 LENOIR ST LAS VEGAS NV 89135-2225	12507715294
AZEB OUMMAR	3046 LENOIR ST LAS VEGAS NV 89135-2225	12507715386

Report of All Selected Parcels**Case Number:** MOD-46292**Printed On:** Thu: July 26, 2012

<u>Owner</u>	<u>Address</u>	<u>Parcel Number</u>
BAEZ STEPHEN	9313 EUPHORIA ROSE AVE LAS VEGAS NV 89166-3771	12507815010
BAILEY BETTY L	9929 TRADITION CREEK AVE LAS VEGAS NV 89149-1945	12507715141
BAILLIS KEITH W & PAMELA A	9192 STARLING WING PL LAS VEGAS NV 89143-4487	12508325014
BALANE ROLANDO D & ANICETA V	9132 SPOONBILL RIDGE PL LAS VEGAS NV 89143-4490	12508419109
BALASHOV ALEXANDER & ALLA	1219 MOUNTAIN SIDE CT CONCORD CA 94521-5508	12507812027
BALASHOV ALEXANDER & ALLA	1219 MOUNTAIN SIDE CT CONCORD CA 94521-5508	12508325012
BALASHOV ALEXANDER & ALLA	1219 MOUNTAIN SIDE CT CONCORD CA 94521-5508	12507812021
BALBA PEDRO JUN	3 IRISH MOSS LADERA RANCH CA 92694-0746	12507715153
BAMIRO OLUWAREMILEKUN	8233 BEGONIA BLUSH DR LAS VEGAS NV 89166-3779	12507713004
BANK H S B C USA NATL ASSN TRS	7495 NEW HORIZON WY MAIL STOP-NAC #X3902-01F FREDERICK MD 21703-8388	12507715391
BANK U S N A	4801 FREDERICA ST OWENSBORO KY 42301-7441	12508419070
BANK U S NATIONAL ASSN	4801 FREDERICA ST OWENSBORO KY 42301-7441	12507713084
BARKER BILLY & MARIE	9416 SANTANA SIESTA AVE LAS VEGAS NV 89166-3700	12507811016
BARKER PHILLIP D	9424 JEWEL LAKE AVE LAS VEGAS NV 89166-3703	12507810034
BARNEY MARIANTHI P & RICHARD V	8356 WINTERCHASE PL LAS VEGAS NV 89143-6415	12508327038
BARQUERO RAFAEL	3 PEPPERIDGE RD TRUMBULL CT 06611-5308	12507715182
BASTIAN JOHN A	P O BOX 243 GREEN RIVER UT 84525-0243	12508325024
BEATIFICATO RAYMOND	20 GOLDEN POPPY DR COTO DE CAZA CA 92679-5118	12507810043
BEATIFICATO RAYMOND	20 GOLDEN POPPY DR COTO DE CAZA CA 92679-5118	12518511068
BEAUCHESNE ROBIN C	9144 SPOONBILL RIDGE PL LAS VEGAS NV 89143-4490	12508419106
BEAVERS JAMES O	8397 WINTERCHASE PL LAS VEGAS NV 89143-6415	12507714015
BEAZER PRE-OWNED HOMES L L C	1621 W RIO SALADO PKWY #103 TEMPE AZ 85281-2608	12508325016
BECK PHILIP & ETHEL	9308 EUPHORIA ROSE AVE LAS VEGAS NV 89166-3771	12507713064
BEECH ANNE MARGARET & OLICER F	1312 YOSEMITE CIR OAKLEY CA 94561-5206	12508419082
BEESON LARRY B & MARIA S	17 W 230 OAKDALE DR BENSENVILLE IL 60106	12507715399
BEESON LARRY B & MARIA S	17 W 230 OAKDALE DR BENSENVILLE IL 60106	12507715220
BEHA CHARLES & KIVILCIM	4820 BUCKING BRONC DR BENBROOK TX 76126-6436	12507815024
BEKMANIS ROBERT & WINNIE M	2279 GALENA AVE CARLSBAD CA 92009-1714	12507713007
BENITEZ BERTIN B	8132 FINCH FEATHER ST LAS VEGAS NV 89143-6402	12508419013
BENNETT DOUGLAS R & JANET REV TR	BENNETT DOUGLAS R & JANET D TRS 3504 SERENITY LN SANTA CLARA UT 84765-5368	12518513023
BENNION GRAND CANYON L L C	10503 LINNINGTON CT LAS VEGAS NV 89135-2863	12507715068
BENOIT NOEL J III	HEBERT KENNETH D 9408 EAGLE RIVER CT LAS VEGAS NV 89166-3704	12507810017

Report of All Selected Parcels**Case Number:** MOD-46292**Printed On:** Thu: July 26, 2012

<u>Owner</u>	<u>Address</u>	<u>Parcel Number</u>
BERGER LARRY J	5120 DONOVAN DR #404 ALEXANDRIA VA 22304-8662	12507715046
BERRY JEFFREY S & JUDY M	8316 TETON CREST PL LAS VEGAS NV 89143-6417	12508327016
BERTELSEN GORDON & MARTHA J	249 KENSINGTON ST MEDFORD OR 97504-6913	12507715334
BERTELSEN MARTHA J & GORDON P	10435 SOFFERTO AVE LAS VEGAS NV 89135-3242	12507715333
BERTOLONE CYNTHIA & MICHAEL	216 AMMERSEE LAKES DR MONTEVALLO AL 35115-8641	12507811026
BERTOLONE ELVIRA	8044 MARSHALL CANYON DR LAS VEGAS NV 89166-3705	12507810053
BIANCHI F ALLENE	7942 BLISS HILL CT LAS VEGAS NV 89149-1698	12518515060
BILLSTEN GORDON	NICHOLSON SALLY P O BOX 2304 COWICHAN BAY BC V0R 1N0 CANADA	12507715033
BISHOP DAVID R & CAROL	9404 MELVA BLUE CT LAS VEGAS NV 89166-3708	12507811033
BLACK AMANDA	9348 EUPHORIA ROSE AVE LAS VEGAS NV 89166-3772	12507713054
BLAIR FREDERICK Q	P O BOX 30 CODY WY 82414-0030	12507713088
BLAIR FREDERICK Q	9053 STARLING WING PL LAS VEGAS NV 89143-6405	12508419076
BLAND LARRY K	203 EGMONT AVE MT VERNON NY 10553-1610	12507715409
BLAND LARRY K	203 EGMONT AVE MT VERNON NY 10553-1610	12507715109
BLAND TIFFANY T	8317 WINTERCHASE PL LAS VEGAS NV 89143-6414	12508327024
BLEAK CURTIS A & BRITTANY L	9429 PLOVER FALLS AVE LAS VEGAS NV 89149-0115	12518510065
BLOWERS BRIAN A & DEBRA K	2007 WILBY CIR ALBERT LEA MN 56007-2093	12507715344
BONILLA ROSA	9324 DAFFODIL SUN AVE LAS VEGAS NV 89166-3774	12507713045
BOONE JACK M	8250 N GRAND CANYON DR #1149 LAS VEGAS NV 89166-3738	12507715297
BOONE JACK M	8250 N GRAND CANYON DR #1149 LAS VEGAS NV 89166-3738	12507715377
BOSTOCK BRUCE W & MELINDA	290 CARRERA CIR APTOS CA 95003-4631	12507715132
BOUDREAUX BRENDA A	3676 LILLY ST OAKLAND CA 94619-2704	12507715151
BOULTON HARVEY W JR & RHONDA	9305 PINK PEAR CT LAS VEGAS NV 89149-1643	12518513109
BOX CYRIL L	7921 POINT OAKS CT LAS VEGAS NV 89149-1693	12518515076
BOYD CHARLES T & JEANANNE	9252 BOLTONIA CT LAS VEGAS NV 89149-1628	12518514109
BOYLE CHRISTOHER C	WEAVER MICHELE J 9408 JEWEL LAKE AVE LAS VEGAS NV 89166-3703	12507810030
BOYZ INVESTMENT GROUP	9020 PARTRIDGE HILL LAS VEGAS NV 89148-4970	12507715155
BRADSHAW RICHARD A & TRUDI R	P O BOX 927 WAUKEGAN IL 60079-0927	12507713023
BRANAUGH MICHELLE D	8221 BRILLIANT POMPON PL LAS VEGAS NV 89166-3773	12507815015
BRANDON TIMOTHY W & SHEILA V	9400 BRILLIANT ORE DR LAS VEGAS NV 89143-2309	12507715345
BRANDON TIMOTHY W & SHEILA V	9400 BRILLIANT ORE DR LAS VEGAS NV 89143-2309	12507715197
BRIZIO PATRICIA M TRUST	BRIZIO 2012 TRUST 11279 PARLEYS CONE CT LAS VEGAS NV 89135-1839	12507813037

Report of All Selected Parcels**Case Number:** MOD-46292**Printed On:** Thu: July 26, 2012

<u>Owner</u>	<u>Address</u>	<u>Parcel Numbe</u>
BROCKMAN MICHAEL JR	GARCIA CYNTHIA 7913 TWIN LEAF ST LAS VEGAS NV 89149-1694	12518515023
BROOK CREEK L L C	%A KITCHEN P O BOX 803 LEHI UT 84043-0803	12507810023
BROOKHAVEN HOMEOWNERS ASSN	%KB HOME LV BROOKHAVEN LLC 5655 BADURA AVE LAS VEGAS NV 89118-4713	12518515089
BROOKHAVEN HOMEOWNERS ASSN	%KB HOME LV BROOKHAVEN LLC 5655 BADURA AVE LAS VEGAS NV 89118-4713	12518515093
BROOKHAVEN HOMEOWNERS ASSN	%KB HOME LV BROOKHAVEN LLC 5655 BADURA AVE LAS VEGAS NV 89118-4713	12518515087
BROOKHAVEN HOMEOWNERS ASSN	%KB HOME LV BROOKHAVEN LLC 5655 BADURA AVE LAS VEGAS NV 89118-4713	12518515086
BROOKHAVEN HOMEOWNERS ASSN	%KB HOME LV BROOKHAVEN LLC 5655 BADURA AVE LAS VEGAS NV 89118-4713	12518515096
BROOKHAVEN HOMEOWNERS ASSN	%KB HOME LV BROOKHAVEN LLC 5655 BADURA AVE LAS VEGAS NV 89118-4713	12518515088
BROOKHAVEN HOMEOWNERS ASSN	%KB HOME LV BROOKHAVEN LLC 5655 BADURA AVE LAS VEGAS NV 89118-4713	12518515092
BROOKHAVEN HOMEOWNERS ASSN	%KB HOME LV BROOKHAVEN LLC 5655 BADURA AVE LAS VEGAS NV 89118-4713	12518515091
BROOKHAVEN HOMEOWNERS ASSN	%KB HOME LV BROOKHAVEN LLC 5655 BADURA AVE LAS VEGAS NV 89118-4713	12518515097
BROOKHAVEN HOMEOWNERS ASSN	%KB HOME LV BROOKHAVEN LLC 5655 BADURA AVE LAS VEGAS NV 89118-4713	12518515094
BROOKHAVEN HOMEOWNERS ASSN	%KB HOME LV BROOKHAVEN LLC 5655 BADURA AVE LAS VEGAS NV 89118-4713	12518515090
BROOKHAVEN HOMEOWNERS ASSN	%KB HOME LV BROOKHAVEN LLC 5655 BADURA AVE LAS VEGAS NV 89118-4713	12518515095
BROOKHAVEN PARTNERSHIP L L C	%D FORUZANFAR 8960 LURLINE AVE CHATSWORTH CA 91311-6103	12518515057
BROOKHAVEN PARTNERSHIP L L C	%D FORUZANFAR 8960 LURLINE AVE CHATSWORTH CA 91311-6103	12518515053
BROOKHAVEN PARTNERSHIP L L C	%D FORUZANFAR 8960 LURLINE AVE CHATSWORTH CA 91311-6103	12518515049
BROOKHAVEN PARTNERSHIP L L C	%D FORUZANFAR 8960 LURLINE AVE CHATSWORTH CA 91311-6103	12518515056
BROOKHAVEN PARTNERSHIP L L C	%D FORUZANFAR 8960 LURLINE AVE CHATSWORTH CA 91311-6103	12518515043
BROOKHAVEN PARTNERSHIP L L C	%D FORUZANFAR 8960 LURLINE AVE CHATSWORTH CA 91311-6103	12518515045
BROOKHAVEN PARTNERSHIP L L C	%D FORUZANFAR 8960 LURLINE AVE CHATSWORTH CA 91311-6103	12518515050
BROOKHAVEN PARTNERSHIP L L C	%D FORUZANFAR 8960 LURLINE AVE CHATSWORTH CA 91311-6103	12518515044
BROOKHAVEN PARTNERSHIP L L C	%D FORUZANFAR 8960 LURLINE AVE CHATSWORTH CA 91311-6103	12518515051
BROOKHAVEN PARTNERSHIP L L C	%D FORUZANFAR 8960 LURLINE AVE CHATSWORTH CA 91311-6103	12518515042
BROOKHAVEN PARTNERSHIP L L C	%D FORUZANFAR 8960 LURLINE AVE CHATSWORTH CA 91311-6103	12518515054
BROOKHAVEN PARTNERSHIP L L C	%D FORUZANFAR 8960 LURLINE AVE CHATSWORTH CA 91311-6103	12518515046
BROOKHAVEN PARTNERSHIP L L C	%D FORUZANFAR 8960 LURLINE AVE CHATSWORTH CA 91311-6103	12518515055
BROOKHAVEN PARTNERSHIP L L C	%D FORUZANFAR 8960 LURLINE AVE CHATSWORTH CA 91311-6103	12518515052
BROOKS MARIA E & RICHARD M	7627 MAPLE MEADOW ST LAS VEGAS NV 89131-4665	12508327027
BROSNAHAN BRETT A & CRYSTAL G	8013 CASPIAN MOON DR LAS VEGAS NV 89166-3710	12507813022
BROWN ANGELA	9409 SWEETWOOD AVE LAS VEGAS NV 89149-1690	12518515007
BROWN DELMAR & CLARICE REV TR	BROWN DELMAR & CLARICE TRS 8033 PEACEFUL VILLAGE PL LAS VEGAS NV 89143-4472	12508418065

Report of All Selected Parcels**Case Number:** MOD-46292**Printed On:** Thu: July 26, 2012

<u>Owner</u>	<u>Address</u>	<u>Parcel Number</u>
BROWN JAIR & ANDREA	9125 STARLING WING PL LAS VEGAS NV 89143-4485	12508419095
BROWN M & S 2006 FAMILY TRUST	BROWN MICHAEL L & SALLY J TRS 109 MEADOWCREEK RD BREA CA 92821-4389	12508419071
BROWN OLLIS H	8233 VALLEY STREAM AVE LAS VEGAS NV 89131-4633	12507715164
BROWN WESLEY & DEBBIE TRUST	BROWN WESLEY R & DEBBIE K TRS 1962 SEGO LILY DR SANDY UT 84092	12508419027
BROWNING 2011 TRUST	BROWNING DAVID E & CAROL CO-TRS 8048 MARSHALL CANYON DR LAS VEGAS NV 89166-3705	12507810054
BRUNK HENRY EDWIN & MARY LEE	8389 TETON CREST PL LAS VEGAS NV 89143-6418	12508327051
BRUZAN MADONNA	8349 WINTERCHASE PL LAS VEGAS NV 89143-6414	12508327028
BUCKLEY KEVIN & JANA	9337 LONGHORN FALLS LAS VEGAS NV 89149-0134	12507813024
BUDELL VINCENT L & SUSAN L	7744 BEAR CREEK CT BOISE ID 83704-0708	12508419059
BUMANGLAG DONALD E & ELSIE	565 SHIFFRAR PL NIPOMO CA 93444-9789	12507715212
BUMANGLAG DONALD E & ELSIE	565 SHIFFRAR PL NIPOMO CA 93444-9789	12507715397
BUMGARNER JACOB & AMANDA S	9445 SWEETWOOD AVE LAS VEGAS NV 89149-1691	12518515016
BURGESS CHERYL D	8025 FARTHING HILL DR LAS VEGAS NV 89166-3702	12507810050
BURGHARDT PAUL E & JANICE C	10512 HAYWOOD DR LAS VEGAS NV 89135-2850	12507715023
BURGHARDT PAUL E & JANICE C	10512 HAYWOOD DR LAS VEGAS NV 89135-2850	12507715139
BURNS ADAM C	4300 SILVER PROSPECT DR LAS VEGAS NV 89108	12507812023
BUSSOLA ANTHONY	8276 BRILLIANT POMPON PL LAS VEGAS NV 89166-3775	12507713021
BUSTAMANTE JOSEPH & RUTH	9305 CRANESBILL CT LAS VEGAS NV 89149-1636	12518513127
CACCIATORE PAUL R	7939 STORMY FALLS ST LAS VEGAS NV 89149-3729	12518511067
CADWALLADER DENNIS P & HAENG CHA	7856 MOHICAN CANYON ST LAS VEGAS NV 89113-3014	12507715332
CAFIERO STEPHANIE A	7977 CROWNBEARD ST LAS VEGAS NV 89149-1627	12518514124
CALUBAQUIB EDMUNDO & ESTRELLA	1400 RICHARDS AVE DOWNERS GROVE IL 60516-3704	12507715065
CAMERON FAMILY TRUST	CAMERON RONALD S & ROSA S TRS 532 FRESH MEADOWS RD SIMI VALLEY CA 93065-6801	12507713081
CANDELA ROCCO	7985 CROWNBEARD ST LAS VEGAS NV 89149-1627	12518514123
CANDILELA CT TRUST	P O BOX 36208 LAS VEGAS NV 89133-6208	12518514054
CANFIELD BOB & PATRICIA B	7412 VIA RIMINI ST LAS VEGAS NV 89131-0116	12507714017
CANGEMI NATALIE	9292 BOLTONIA CT LAS VEGAS NV 89149-1628	12518513145
CANNON BRUCE & NAOMI	5112 CHAMBLISS DR LAS VEGAS NV 89130-5606	12507715028
CANTATORE MICHAEL E & THERESA	9538 MICHELLE FALLS AVE LAS VEGAS NV 89149-3727	12518511034
CAPALBO JUDY L	8216 BRILLIAN POMPON PL LAS VEGAS NV 89166-3773	12507713036
CAPIRAL EDGARDO	OEHMKE MELISA 8253 BRILLIANT POMPON PL LAS VEGAS NV 89166-3775	12507713067

Report of All Selected Parcels**Case Number:** MOD-46292**Printed On:** Thu: July 26, 2012

<u>Owner</u>	<u>Address</u>	<u>Parcel Numbe</u>
CAPORALE SCOTT	9104 SPOONBILL RIDGE PL LAS VEGAS NV 89143-4496	12508419116
CAREY MICHAEL J & DONNA J	9324 FLOWERING TULIP AVE LAS VEGAS NV 89166-3770	12507815050
CARRE JACOB B	CADACIO ARMELIN 10300 VIA APOLINA MORENO VALLEY CA 92557-2705	12507715050
CARROLL PHILLIP J	%EMERGING MARKETS 8090 N 85TH WY #101 SCOTTSDALE AZ 85258-4344	12507715396
CARROLL PHILLIP J	%EMERGING MARKETS OF N AMER 8090 N 85TH WY #101 SCOTTSDALE AZ 85258-4344	12507715216
CARSON RYAN & SUSANNAH L	9433 SANTANA SIESTA AVE LAS VEGAS NV 89166-3707	12507811003
CARTER LEE & LISA REVOCABLE TR	CARTER LEE THOMAS & LISA M TRS 2105 ALBERTA AVE BELLEVUE NE 68005-4515	12507715099
CASA BELLAMIA L L C	7872 MORNING FLOWER LN LAS VEGAS NV 89129-2138	12507715261
CASHEN RICHARD J & DEBRA L	7449 S 16TH ST LINCOLN NE 68512-9243	12518515037
CASILLAS AMPELIE & TERESA	9507 CABOT FALLS AVE LAS VEGAS NV 89149-3724	12518511017
CASTANEDA ANA M	9285 BOLTONIA CT LAS VEGAS NV 89149-1628	12518514093
CASTELLI JOSEPH L	9344 BUTTERCUP CT LAS VEGAS NV 89149-1629	12518514014
CATIIS BRENDA A	8265 BRILLIANT POMPON LAS VEGAS NV 89166-3775	12507713085
CATO DUANE	12 GLENBARR CIR BELLA VISTA AR 72715-4912	12518514089
CATO RICHARD A	7853 HORSENETTLE ST LAS VEGAS NV 89149-1638	12518513085
CELIS MARITZA	9437 SWEETWOOD AVE LAS VEGAS NV 89149-1691	12518515014
CENTENNIAL POINT COMMUNITY ASSN	%TERRA WEST PPTY MGT 2655 S RAINBOW #200RD #200 LAS VEGAS NV 89146-4000	12507811061
CHAMPAGNE ALBERT	8140 SATIN CARNATION LN LAS VEGAS NV 89166-3768	12507816025
CHAN LAURA ELISE TSING WAN	%UNIVERSITY OF ALBERTA P O BOX 60102 EDMONTON AB T6G 2S4 CANADA	12507715300
CHAN YEUNG TRUST	YEUNG ALGER TRS 1441 VALLEY AVE PLEASANTON CA 94566-3509	12508325033
CHANG TAI L ETAL	31 ALMOND TREE LN IRVINE CA 92612-2230	12518512017
CHANTHASIRIPHAN GEORGE	9420 MELVA BLUE CT LAS VEGAS NV 89166-3708	12507811037
CHAPMAN DESIREE	8250 N GRAND CANYON #1185 LAS VEGAS NV 89166-3739	12507715365
CHAPMAN FAMILY TRUST	8412 STARSTRUCK AVE LAS VEGAS NV 89143-1393	12507715316
CHARLES R & LEETHA M FAMILY TR	JOHNSON CHARLES R & LEETHA M TRS P O BOX 34354 LAS VEGAS NV 89133-4354	12518513172
CHASEY DONALD C JR	9113 SPOONBILL RIDGE PL LAS VEGAS NV 89143-4496	12508419038
CHEN DANNY HAN-LIN	FUNG YUET YI 13291 STEVESTON HWY RICHMOND BC V6W 1A5 CANADA	12507816023
CHEN HONG FA O	HUANG JOANN AIMEI 6696 CORONADO PALMS AVE LAS VEGAS NV 89139-5344	12518511025
CHILTON ROBERT J	14617 N 63RD PL SCOTTSDALE AZ 85254-2501	12507715191
CHILTON ROBERT J	14617 N 63RD PL SCOTTSDALE AZ 85254-2501	12507715384
CHINO SERGIO	9321 COLORFUL RAINBOW LAS VEGAS NV 89166-3777	12507713069
CHIU YUI MING	CHIUNG KWAI YUNG 9060 BIG PLANTATION AVE LAS VEGAS NV 89143-5441	12507715130

Report of All Selected Parcels**Case Number:** MOD-46292**Printed On:** Thu: July 26, 2012

<u>Owner</u>	<u>Address</u>	<u>Parcel Number</u>
CHOW KA SHIU & ROWENA BIK HAR	11561 169TH ST ARTESIA CA 90701-1706	12508419019
CHRISTENSEN JEANNE	6337 AVENIDA LA COSTA ALBUQUERQUE NM 87109-4103	12518513084
CHRISTICOLE L L C	%N ABUDAYEH P O BOX 2301 PLEASANT HILL CA 94523-0001	12518511020
CHURCHILL JESSE & LEAH J	9404 JEWEL LAKE AVE S-314 LAS VEGAS NV 89166-3703	12507810029
CISNEROS CARLOS	9037 SPRINT CANYON AVE LAS VEGAS NV 89149	12507715035
CITY OF LAS VEGAS	%D ROARK 400 E STEWART AVE 4TH FL LAS VEGAS NV 89101-2913	12508401004
CLARK LORI	9180 STARLING WING PL LAS VEGAS NV 89143-4487	12508325017
CLINE DONALD A	35 E HORIZON RIDGE PKWY #110-142 HENDERSON NV 89002-7905	12518513091
COBLE KASPER F & LENORA	9165 STARLING WING PL LAS VEGAS NV 89143-4486	12508325028
COE VIVIENNE E	P O BOX 751052 LAS VEGAS NV 89136-1052	12518513166
COHEEN REVOCABLE TRUST	COHEEN IRENE & DAVID TRS 4882 GREY MESA ST LAS VEGAS NV 89149-5228	12507715094
COHEEN REVOCABLE TRUST	COHEEN IRENE & DAVID TRS 4882 GREY MESA ST LAS VEGAS NV 89149-5228	12507715415
COLE JAMES MARVIN JR	8164 SATIN CARNATION LN LAS VEGAS NV 89166-3768	12507815019
COLE JOSEPHINE	15133 LA BARCA DR LA MIRADA CA 90638-4711	12507812025
COLEMAN WILLIAM P	9341 FLOWERING TULIP AVE LAS VEGAS NV 89166-3770	12507815037
COLLARD JOHN S & GAYANN S	7957 BLISS HILL CT LAS VEGAS NV 89149-1698	12518515063
COLLINS HAROLD W LIVING TRUST	COLLINS HAROLD W TRS 7885 CLEARWEED CT LAS VEGAS NV 89149-1633	12518514107
COLLINS MAURICE & NAJLA	7729 FALCON WING AVE LAS VEGAS NV 89131-8206	12508418066
COLLINS STELLA	8250 N GRAND CANYON #1068 LAS VEGAS NV 89166-3740	12507715402
COLLINS STELLA	8250 N GRAND CANYON #1068 LAS VEGAS NV 89166-3740	12507715128
COLLIS WILLIAM	TENUTA JEAN 41736 FIRENZE ST LANCASTER CA 93536-2970	12507715401
COLLIS WILLIAM	TENUTA JEAN 41736 FIRENZE ST LANCASTER CA 93536-2970	12507715104
COMSTOCK INVESTMENT TRUST	HAYES MATTHEW T TRS P O BOX 1830 LA QUINTA CA 92247-1830	12507715064
CONDEI OFELIA A	ANDRA MIRCEA 9120 BIG PLANTATION AVE LAS VEGAS NV 89143-5442	12507715327
Condominium master parcel		12507715000
CONLON JAY DANIEL	9100 STARLING WING PL LAS VEGAS NV 89143-4485	12508419056
CONNER MAUDE	8250 N GRAND CANYON DR #1127 LAS VEGAS NV 89166-3737	12507715251
CONNOR DAVID MICHAEL & JENNIFER	8308 TETON CREST PL LAS VEGAS NV 89143-6417	12508327017
CONSTANTINE JOHN & BARBARA	8250 N GRAND CANYON DR #1040 LAS VEGAS NV 89166-3728	12507715072
CONSTANTINO GLENN & ANNALYN	9524 CUBOT FALLS AVE LAS VEGAS NV 89149-3724	12518511063
COOPER DEBORAH L	MILLER JOANNE 8120 SATIN CARNATION LN LAS VEGAS NV 89166-3767	12507816020
CORNELIUS WILLIAM D & PEGGY B	8017 CASPIAN MOON DR LAS VEGAS NV 89166-3710	12507813021

Report of All Selected Parcels**Case Number:** MOD-46292**Printed On:** Thu: July 26, 2012

<u>Owner</u>	<u>Address</u>	<u>Parcel Number</u>
CORNELL ULRIKE L	9084 SPOONBILL RIDGE PL LAS VEGAS NV 89143-4496	12508419118
CORSI JOAN	9109 STARLING WING PL LAS VEGAS NV 89143-4485	12508419091
COSBURN ROBERT S	9261 LOPSEED CT LAS VEGAS NV 89149-1640	12518514111
COSTA BALTAZAR	2221 HISTORIC DECATUR #59 SAN DIEGO CA 92106-6098	12507715190
CRAWFORD KELLIE & GREGORY	8353 WILD THING CT LAS VEGAS NV 89131-1511	12518510031
CRESPO JUANITA	8545 W VERDE WY LAS VEGAS NV 89149-4165	12508419032
CRISAN DANIELA	8250 N GRAND CANYON DR #1181 LAS VEGAS NV 89166-3739	12507715361
CROCKETT HARMON O SR	8288 BRILLIANT POMPON PL LAS VEGAS NV 89166-3775	12507713018
CROFFORD PETRA	9321 BUTTERCUP CT LAS VEGAS NV 89149-1629	12518514075
CRONIN JAMES & VIRGINIA	1963 7TH AVE NE THOMPSON ND 58278-9208	12507715020
CRONKHITE JASON E W	8250 N GRAND CANYON DR #1041 LAS VEGAS NV 89166-3728	12507715081
CROSETTI JACK F & JUDITH A	9292 SWAMP ROSE AVE LAS VEGAS NV 89149-1646	12518513151
CROSS JUSTIN LIVING TRUST	CROSS JUSTIN TRS 9507 MILKWEED CANYON AVE LAS VEGAS NV 89166-3758	12508419053
CRUZ ADRIAN J	8421 WINTERCHASE PL LAS VEGAS NV 89143-6416	12507714012
CRUZ CRISTOBAL S & MARRINA K	9320 LADY FINGER CT LAS VEGAS NV 89149-1639	12518514066
CUDDY THOMAS W	9333 COLORFUL RAINBOW AVE LAS VEGAS NV 89166-3777	12507713072
CULLISON D R & C M REV LIV TR	CULLISON DONALD & CHRISTINE TRS 6598 GOLDEN BIT AVE LAS VEGAS NV 89131-0220	12507715346
CUNNINGHAM MICHAEL A & GINA M	8228 BRILLIANT POMPON PL LAS VEGAS NV 89166-3773	12507713033
CUSTOM ESTATES L L C	5594 S FORT APACHE RD #100 LAS VEGAS NV 89149	12518514113
CUTTING ANGELLA	7925 TWIN LEAF ST LAS VEGAS NV 89149-1694	12518515025
D F 2 B L L C	%L PILLON P O BOX 401613 LAS VEGAS NV 89140-1613	12507715247
DAGAN YULIYA & YAACOV	11 HAOREN ST P O BOX 440 RAMAT ISHAY 30095 ISRAEL	12507715298
DAHL WESTON & SARAH E	9129 STARLING WING PL LAS VEGAS NV 89143-4485	12508419096
DAKE THOMAS	9353 LADY FINGER CT LAS VEGAS NV 89149-1639	12518513041
DALIDA MICHAEL & BLESILLE	9324 EUPHORIA ROSE AVE LAS VEGAS NV 89166-3771	12507713060
DAMJANOVIC IVAN & IRENA	910 PANORAMA HILLS DR N W CALGARY AB T3K 5C2 CANADA	12507715062
DANIELS HOWARD & CRISTINA	1266 MOONBEAM WY MILPITAS CA 95035-6222	12508327037
DANIELSON LARRY IRR TR AGMT	12015 MARINE DR #360 TUALIP WA 98271-9306	12507715026
DANSIRIMITRI PONGSAK	8153 NESTLED CT LAS VEGAS NV 89143-6406	12508419088
DARLING BRENDA MARIE	9401 MELVA BLUE CT LAS VEGAS NV 89166-3708	12507811031
DARROW LOGAN & JON E	8324 WINTERCHASE PL LAS VEGAS NV 89143-6414	12508327042
DAVENPORT JOHNATHAN S & JANA L	7961 TWIN LEAF ST LAS VEGAS NV 89149-1695	12518515031

Report of All Selected Parcels**Case Number:** MOD-46292**Printed On:** Thu: July 26, 2012

<u>Owner</u>	<u>Address</u>	<u>Parcel Numbe</u>
DAVID FRED & LYNN FAMILY TRUST	DAVID FREDRIC J & LYNNE TRS 9609 HAWKSBILL CT LAS VEGAS NV 89117-0647	12507810031
DAVIES RONALD S & TRISHA G	1326 IRIS ST POCATELLO ID 83201-2344	12507715274
DAVIS SHANE	9276 LOPSEED CT LAS VEGAS NV 89149-1640	12518514087
DAVIS TONY	5208 ACACIA VIEW AVE LAS VEGAS NV 89131-2773	12507713046
DAY JACK C & SANDRA H	7960 TWIN LEAF ST LAS VEGAS NV 89149-1695	12518515064
DEAL LISA MARIE	NAVALTA MARVIN OCHOCO 6465 TRAUTMAN CT LAS VEGAS NV 89149-4776	12518513160
DEBORTNOWSKY ANDREAS	1314 CORTE ENTRADA THOUSAND OAKS CA 91360-6907	12507713063
DEBRITO RENEE	9542 MICHELLE FALLS AVE LAS VEGAS NV 89149-3728	12518511035
DEHERNANDEZ MONICA VIVAS	GAYTAN JUAN ALONSO HERNANDEZ 8948 HAPPY STREAM AVE LAS VEGAS NV 89143-4477	12508418002
DEJESUS LUCY	8188 HUMMING LN LAS VEGAS NV 89143-4489	12508325030
DEJONG EDWARD & ANNE MARIE	2993 BRADBURY DR PRINCE ALBERT SK S6V 7W2 CANADA	12507715201
DEKICH LUCIAN & KIMBERLY	9454 BLOOMING GROVE AVE LAS VEGAS NV 89149-1697	12518515035
DEL HOULE L L C	87 N 30TH ST SAN JOSE CA 95116-1124	12507811010
DELAROSA RAUL & NELIA	683 N TUOLUMNE DR WALNUT CA 91789-4123	12507715146
DELBARRIO MARIA LOURDES SIGUA	80 DESCANO DR #1432 SAN JOSE CA 95134-1833	12507715048
DELLABELLA BERNICE	8250 N GRAND CANYON DR #1020 LAS VEGAS NV 89166-3726	12507715036
DELLAMAGGIORE NICK	15585 OAK GLEN AVE MORGAN HILL CA 95037-8803	12507811006
DENT PETER	903 9TH GREEN DR KAMLOOPS BRITISH COLOMBIA CANADA V2H1T9	12507715206
DEPORTO DELFINA	9321 BUTTERCUP CT LAS VEGAS NV 89149-1629	12507715338
DEPOT TRUST	6955 N DURANGO #1115-387 LAS VEGAS NV 89149-4411	12507713006
DEROSEMONT MOEAVA & ALEXANDRA	8000 W BADURA AVE #2126 LAS VEGAS NV 89113-2117	12507715097
DESERT CHILL L L C	%BLACKBIRD REALTY & MGT 3690 S EASTERN AVE #101 LAS VEGAS NV 89169-3376	12508419120
DESHER JOHN L	8250 N GRAND CANYON DR #1059 LAS VEGAS NV 89166-3728	12507715111
DEVITO KENNETH J	754 DEER RUN LN OAK PARK CA 91377-5439	12508419016
DICK LO ANN & EDWARD	1582 W 238TH ST HARBOR CITY CA 90710-1305	12507715250
DIEP KEVIN	TRAN HELEN L 4534 N IVAR AVE ROSEMEAD CA 91770-1229	12508325018
DILAURA RICHARD & MARINA	7885 WILD THISTLE CT LAS VEGAS NV 89149-1632	12518514103
DITTO KENNETH W	7932 STORMY FALLS ST LAS VEGAS NV 89149-3729	12518511021
DITZLER CHRISTINE E	8445 FRAZIER PARK CT LAS VEGAS NV 89143-5002	12507715265
DITZLER CHRISTINE E	8445 FRAZIER PARK CT LAS VEGAS NV 89143-5002	12507715382
DLOOMY EVA	4901 HASKELL AVE ENCINO CA 91436-1628	12507713055
DOERING JENNIFER L	9253 SPIDERLILY CT LAS VEGAS NV 89149-1645	12518514116

Report of All Selected Parcels**Case Number:** MOD-46292**Printed On:** Thu: July 26, 2012

<u>Owner</u>	<u>Address</u>	<u>Parcel Numbe</u>
DOLLAR SABRINA M	9313 CRANESBILL CT LAS VEGAS NV 89149-1636	12518514080
DONBOLI ALI & ELHAM	9137 STARLING WING PL LAS VEGAS NV 89143-4486	12508419098
D'ONOFRIO JOSHUA R	8250 N GRAND CANYON DR #2043 LAS VEGAS NV 89166-3732	12507715091
DORIO JOE & CHRISTINE A	8033 FARTHINGS HILL DR LAS VEGAS NV 89166-3702	12507810048
DORNER SYLVENA HOFF	9751 BURGESS AVE OAKLAND CA 94605-4937	12508419020
DOW ANN E & DANIEL L	7948 BLISS HILL CT LAS VEGAS NV 89149-1698	12518515059
DOW ANTHONY	7945 BLISS HILL CT LAS VEGAS NV 89149-1698	12518515061
DRAKE DARIN	9169 SPOONBILL RIDGE PL LAS VEGAS NV 89143-4498	12508419052
DRENNAN BRIAN & KRISTAL	9413 SANTANA SIESTA AVE LAS VEGAS NV 89166-3700	12507811008
DROESSLER MAURICE M	11762 ARDIS DR GARDEN GROVE CA 92841-2424	12507713017
DUBAY GEORGE	9292 SPIDERLILY CT LAS VEGAS NV 89149-1645	12518513133
DUCHNYCZ IHOR & LINDA	8125 FINCH FEATHER ST LAS VEGAS NV 89143-6402	12508419067
DUNKIN FRIER A	8250 N GRAND CANYON DR #1074 LAS VEGAS NV 89166-3729	12507715142
DUNKLEY BARBARA & LESLIE J	6116 W GILMORE AVE LAS VEGAS NV 89108-5136	12507715318
DUNKLEY BARBARA & LESLIE J	6116 W GILMORE AVE LAS VEGAS NV 89108-5136	12507715378
DUNSTON JOHN W III	9284 SWAMP ROSE AVE LAS VEGAS NV 89149-1646	12518514096
DUNYON DENNIS ADAM & JESSICA K	9420 SANTANA SIESTA AVE LAS VEGAS NV 89166-3700	12507811017
DUPA MARK	9417 SWEETWOOD AVE LAS VEGAS NV 89149-1690	12518515009
DURHAM THOMAS F III & FRANCES C	5120 MAYWEED CT COLORADO SPRINGS CO 80917-1330	12507715231
DURRAND DARRELL & SHELLY	4-53412 RANGE RD #272 SPRUCE GROVE AB T7X 3N2 CANADA	12507715276
DWYER PATRICK T	9425 JEWEL LAKE AVE LAS VEGAS NV 89166-3703	12507810038
DZIEDZIC JASON	1046 S CENTER ST BENSENVILLE IL 60106-3312	12507715095
EARL GEORGE E & KAREN D	8250 N GRAND CANYON DR #2098 LAS VEGAS NV 89166-3743	12507715202
EARLEY BRIAN	1582 CHANDLER ST OAKLAND CA 94603-3883	12507715049
EDELMAN JEFFERY	9196 SPOONBILL RIDGE PL LAS VEGAS NV 89143-4491	12508325006
EDENFIELD LIANA J & JOSEPH P	7884 CROWBEARD ST LAS VEGAS NV 89149	12518513171
EDGEALL ARLEY & CAROLYN	9252 SPIDERLILY CT LAS VEGAS NV 89149-1645	12518514117
EDWARDS NATHAN	WRIGHT RAYMOND S & DIANE M 9189 WILD BRIAR LN LAS VEGAS NV 89143-6420	12508327020
ELIRAZ DALIT	63 CASABEL DR MAPLE ON L6A 3L6 CANADA	12507715167
ELLIOTT MICHELE A	8132 NESTLED CT LAS VEGAS NV 89143-6406	12508419085
ELLIS RUFUS J & KIMM	5345 KEVIN WY LAS VEGAS NV 89149-3411	12518513115
ELTRINGHAM AMY	9277 BOLTONIA CT LAS VEGAS NV 89149-1628	12518514094

Report of All Selected Parcels**Case Number:** MOD-46292**Printed On:** Thu: July 26, 2012

<u>Owner</u>	<u>Address</u>	<u>Parcel Numbe</u>
ENGLER JONATHAN	139 LA CUESTA DR SCOTTS VALLEY CA 95066-4710	12508325007
ENGLERTH JARED B & JESSICA D	8029 FARTHINGS HILL DR LAS VEGAS NV 89166-3702	12507810049
ENRIQUEZ EMERITA & PERRY	10828 S LONG AVE OAKLAWN IL 60453-5048	12507715008
ERAZ U S L L C	P O BOX 320122 SAN FRANCISCO CA 94132-0122	12507715367
ERAZ U S L L C	P O BOX 320122 SAN FRANCISCO CA 94132-0122	12507715143
ERAZ US L L C	P O BOX 320122 SAN FRANCISCO CA 94132-0122	12507715236
ERICKSEN FAMILY TRUST	ERICKSEN JED L & VICKIE S TRS 3307 N 660 E LEHI UT 84043-2967	12507715211
ESTACIO FRANCISCO Y & JOANIFER	8373 TETON CREST PL LAS VEGAS NV 89143-6418	12508327049
EVELYNMOE HOLLIS C	3695 CANNON CIR LAS VEGAS NV 89121-4411	12508419069
EVERHART LINDSAY	KENN JOHN F & MELANIE A 9337 BUTTERCUP CT LAS VEGAS NV 89149-1629	12518514016
EWING NATHANIEL E	8040 CASPIAN MOON DR LAS VEGAS NV 89166-3710	12507813035
EXECUTIVE EUROPEAN RESORTS L L C	P O BOX 90868 HENDERSON NV 89009-0868	12507715014
FANNIE MAE	135 N LOS ROBLES #300 PASADENA CA 91101-4529	12507812026
FARGNOLI SHARON	9402 BLOOMING GROVE AVE LAS VEGAS NV 89149-1696	12518515048
FARKAS TIBOR W	P O BOX 2252 GEORGETOWN TX 78627-2252	12507715037
FEDDERN ELIZABETH A	9284 LOPSEED CT LAS VEGAS NV 89149-1640	12518514088
FEDERAL HOME LOAN MORTGAGE CORP	%JPMORGAN CHASE BANK NA 7255 BAYMEADOWS WAY JACKSONVILLE FL 32256-6851	12508419021
FEDERAL NATIONAL MORTGAGE ASSN	%SETERUS INC IBM LBPS 14523 S W MILLIKAN WAY #200 BEAVERTON OR 97005-2352	12507810022
FEDERAL NATIONAL MORTGAGE ASSN	14221 DALLAS PKWY #1000 DALLAS TX 75254-2946	12507810052
FEGA LLC	16010 VALLEY VISTA BLVD ENCINO CA 91436-3457	12507715107
FEGA LLC	16010 VALLEY VISTA RD ENCINO CA 91436-3457	12507715414
FEGA LLC	16010 VALLEY VISTA RD ENCINO CA 91436-3457	12507715105
FEGA LLC	16010 VALLEY VISTA BLVD ENCINO CA 91436-3457	12507715192
FEGA LLC	16010 VALLEY VISTA RD ENCINO CA 91436-3457	12507715031
FELDBERG WILLIAM	8024 FARTHINGS HILL DR LAS VEGAS NV 89166-3702	12507810006
FELIX FAUSTO G	9405 SWEETWOOD AVE LAS VEGAS NV 89149-1690	12518515006
FELS PAUL L & DEBORA M	7884 WILD THISTLE CT LAS VEGAS NV 89149-1632	12518514102
FERNANDEZ CARMEN & JORGE	9260 VERVAIN CT LAS VEGAS NV 89149-1647	12518514058
FERNANDEZ CHRISTIAN	8396 TETON CREST PL LAS VEGAS NV 89143-6418	12508327006
FERRARO LAVERNE R	FERRARO JOHN P 10532 BACK PLAINS DR LAS VEGAS NV 89134-7410	12507715348
FERRARO LAVERNE R	FERRARO JOHN P 10532 BACK PLAINS DR LAS VEGAS NV 89134-7410	12507715270
FIAZEAN MOHAMMED R	8253 BEGONIA BLUSH DR LAS VEGAS NV 89166-3780	12507713009

Report of All Selected Parcels**Case Number:** MOD-46292**Printed On:** Thu: July 26, 2012

<u>Owner</u>	<u>Address</u>	<u>Parcel Numbe</u>
FINTZ CAROL N	8414 W FARM RD #180 BOX 425 LAS VEGAS NV 89125-0425	12518514105
FINTZ STEVEN TRUST	FINTZ STEVEN TRS 9304 EUPHORIA ROSE AVE LAS VEGAS NV 89166-3771	12507713065
FISHER THOMAS W & MARGARET D	8248 BRILLIANT POMPON PL LAS VEGAS NV 89166-3773	12507713028
FITUCI FAMILY TRUST	FITUCI SAM & TOVA TRS 6852 PONCE AVE WEST HILLS CA 91307-2610	12518510013
FLORES ESPERANZA	7944 STORMY FALLS ST LAS VEGAS NV 89149-3729	12518511024
FLORES HERMALINDA	8250 N GRAND CANYON DR #1128 LAS VEGAS NV 89166-3746	12507715252
FORD EDWARD	9349 DAFFODIL SUN AVE LAS VEGAS NV 89166-3776	12507713051
FORSTER CECILIA B	213 FULTON ST WESTBURY NY 11590-3003	12518513104
FORT GRAND L L C	2200 PASEO VERDE #330 LAS VEGAS NV 89052-2703	12507801003
FOSKARIS FAMILY LIVING TRUST	FOSKARIS NICHOLAS G & DANA A TRS 2780 EL CAMINO RD LAS VEGAS NV 89146-5221	12518512016
FOWLER MICHAEL J LIVING TRUST	FOWLER MICHAEL J TRS 19 MATISSE CIR ALISO VIEJO CA 92656-3859	12508419103
FOX WANDA W & JOSEPH A	9472 PLOVER FALLS AVE LAS VEGAS NV 89149-0116	12518510033
FRANCHEY LAYTON K & SASHA M	8136 SATIN CARNATION LN LAS VEGAS NV 89166-3768	12507816024
FRANCO ANTOANETTE ALVARADO	8148 SATIN CARNATION LN LAS VEGAS NV 89166-3768	12507815023
FRANKE JACK A & CHERYL	7530 N JONES BLVD LAS VEGAS NV 89131-2305	12518514091
FRANKLIN FATEMEH	8717 WESTERN SADDLE AVE LAS VEGAS NV 89129-7238	12507715390
FRANKLIN FATEMEH	8717 WESTERN SADDLE AVE LAS VEGAS NV 89129-7238	12507715343
FRICK XARA L	7920 TWIN LEAF ST LAS VEGAS NV 89149-1694	12518515071
FRIERSON JASON M	9068 STARLING WING PL LAS VEGAS NV 89143-6405	12508419060
FRITZ LEWIS E	9277 LOPSEED CT LAS VEGAS NV 89149-1640	12518514090
FROBY KELLY & ELLIOTT	9353 CRANESBILL CT LAS VEGAS NV 89149-1636	12518513017
FULWILER CODY J	9408 MELVA BLUE LAS VEGAS NV 89166-3708	12507811034
FUNG ERIC & LAWRENCE	21136 DENKER AVE TORRANCE CA 90501-2333	12507713037
FURGER MICHAEL DAVID	9112 SPOONBILL RIDGE PL LAS VEGAS NV 89143-4496	12508419114
G & S CARPENTER L L C	8320 SPANISH MEADOWS LAS VEGAS NV 89131-1448	12518515017
G R K NEVADA HOLDINGS L L C	10850 N 93RD PL SCOTTSDALE AZ 85255	12507715238
GAINES MARK D & DEBRA	P O BOX 732 SARATOGA WY 82331-0732	12507715119
GALIK JASON C	8429 WINTERCHASE PL LAS VEGAS NV 89143-6416	12507714011
GALLAGHER FAMILY TRUST	GALLAGHER CLYDE & ANNETTE TRS 81-174 AVENIDA CASTELAR INDIO CA 92203-7578	12518510058
GALLEGOS VERONICA	9416 PLOVER FALLS AVE LAS VEGAS NV 89149-0115	12518510020
GALLEMIT ALEXANDER F	8029 CASPIAN MOON DR LAS VEGAS NV 89166-3710	12507813018
GALVAN DAVID G	BERTELSEN MIA JANE 1125 MISTY CREEK ST CHULA VISTA CA 91913-2817	12507715112

Report of All Selected Parcels**Case Number:** MOD-46292**Printed On:** Thu: July 26, 2012

<u>Owner</u>	<u>Address</u>	<u>Parcel Numbe</u>
GAMBINO CHARLES A & WANDA LIV TR	GAMBINO WANDA J TRS 9413 MELVA BLUE CT LAS VEGAS NV 89166-3708	12507811028
GAN QUIRINO & LILING	856 KATHRYNE AVE SAN MATEO CA 94401-3125	12518510018
GARATE JORGE I & ASHLEY R	8025 CASPIAN MOON DR LAS VEGAS NV 89166-3710	12507813019
GARCIA CAROL & DONALD A	6003 DUNBAR CT GLADWIN MI 48624	12507715056
GARCIA HERMINIA A & RICO	8682 TWANA DR GARDEN GROVE CA 92841-1909	12507715158
GARCIA LUCIA	9442 BLOOMING GROVE AVE LAS VEGAS NV 89149-1697	12518515038
GARCIA NOELLE SARAVOLATZ	7908 TWIN LEAF ST LAS VEGAS NV 89149-1694	12518515073
GARCIA RICKY J	8250 N GRAND CANYON DR #1037 LAS VEGAS NV 89166-3728	12507715069
GARCIA-NUEZ SERGIO & ISABEL	8121 STARTLING VIEW CT LAS VEGAS NV 89166-3718	12507812022
GARZA CARLOS C	8340 TETON CREST PL LAS VEGAS NV 89143-6417	12508327013
GAUGER SHARI & SETH	8145 NESTLED CT LAS VEGAS NV 89143-6406	12508419086
GEORGE BRADLEY P	P O BOX 371866 LAS VEGAS NV 89137-1866	12507713024
GEORGESCU STEPHANE OLIVIER	4525 DEAN MARTIN DR #1603 LAS VEGAS NV 89103-8114	12507715296
GEORGESCU STEPHANE OLIVIER	4525 DEAN MARTIN DR #1603 LAS VEGAS NV 89103-8114	12507715219
GERARD ALLESHA	9424 PLOVER FALLS AVE LAS VEGAS NV 89149-0115	12518510022
GERHARDT JAMES R	9429 MELVA BLUE CT LAS VEGAS NV 89166-3709	12507811024
GHARIB MAKRAM F & NORMA M	1503 S 6TH AVE ARCADIA CA 91006-4319	12518515026
GIANNINI MARIO & KRISTA	8157 SATIN CARNATION LN LAS VEGAS NV 89166-3768	12507815060
GILES NICHOLAS & MONIKA G	8124 FINCH FEATHER ST LAS VEGAS NV 89143-6402	12508419015
GILROY ANNETTE L	9336 BUTTERCUP CT LAS VEGAS NV 89149-1629	12518514013
GINSBERG LARRY & ALESA	GINSBERG IAN 62 BEACON CT BROOKLYN NY 11229-6373	12507810036
GIORGETTI MICHAEL & MARIETTA	23 COBBLESTONE CIR NORTH ANDOVER MA 01845-4547	12507714020
GIVENS JOSHUA ALLEN	9336 EUPHORIA ROSE LAS VEGAS NV 89166-3772	12507713057
GOBEL DANIEL K & CAROLYN L	9428 SANTANA SIESTA AVE LAS VEGAS NV 89166-3707	12507811019
GOLIGHTLY CHRISTOPHER & RHONDA	7976 BIDENS CT LAS VEGAS NV 89149-1624	12518514001
GOMEZ JONATHAN	9181 SPOONBILL RIDGE PL LAS VEGAS NV 89143-4491	12508325001
GONZALES CORINA B	1658 CAMDEN AVE #208 W LOS ANGELES CA 90025-7551	12507715257
GONZALES JACQUELINE	8421 TETON CREST PL LAS VEGAS NV 89143-6419	12508327055
GONZALEZ MICHELLE R	9076 STARLING WING PL LAS VEGAS NV 89143-6405	12508419058
GONZALEZ NOE JR	9440 PLOVER FALLS AVE LAS VEGAS NV 89149-0115	12518510026
GONZALEZ RICARDO	2032 W 66TH ST LOS ANGELES CA 90047-1718	12507812003
GONZALEZ ROQUE & GINA REV LIV TR	GONZALEZ ROQUE & GINA S TRS 8625 ROSEY CT LAS VEGAS NV 89149-3900	12507715057

Report of All Selected Parcels**Case Number:** MOD-46292**Printed On:** Thu: July 26, 2012

<u>Owner</u>	<u>Address</u>	<u>Parcel Number</u>
GOODINE DENNIS M & CHRISTINA M	26 QUAIL DR DRACUT MA 01826-2172	12507715150
GOODINE JOE & TINA	10764 ESCOBAR DR SAN DIEGO CA 92124-2027	12507715260
GOODMAN PAUL & JULIE	7017 RIO GRANDE GORGE CT LAS VEGAS NV 89130-1012	12518514012
GOODMAN TROY & MARIA	25126 344TH AVE CHAMBERLAIN SD 57325-6322	12507715087
GOODRICH ADELINE ELIZABETH	8145 FINCH FEATHER ST LAS VEGAS NV 89143-6403	12508419072
GOTTLIEB S & R CHAR RMNDR UNITR	2304 HOT OAK RIDGE ST LAS VEGAS NV 89134-5522	12507811004
GOTTLIEB SIEGARD & ROSLYN C RT	DEGRAAF STEVE TRS 2304 HOT OAK RIDGE LAS VEGAS NV 89134-5522	12518513122
GOTTLIEB SIEGARD & ROSLYN FAM TR	GOTTLIEB SIEGARD & ROSLYN M TRS 2304 HOT OAK RIDGE ST LAS VEGAS NV 89134-5522	12518513178
GRAND CANYON 1083 L L C	%M MILLER 2023 MONTANE DR E GOLDEN CO 80401-8099	12507715163
GRANT LENORA ARDENAH	9037 CROOKED SHELL AVE LAS VEGAS NV 89143-4458	12508411027
GRAVES DARRELL	9416 MELVA BLUE CT LAS VEGAS NV 89166-3708	12507811036
GRECZEK FAMILY REVOCABLE LIV TR	GRECZEK GERALD R & ROSEMARIE TRS 4405 SAN CASCINA ST LAS VEGAS NV 89135-2409	12518513190
GREDZA RICHARD J	GRZEDA ERLINDA D 8250 N GRAND CANYON DR #2054 LAS VEGAS NV 89166-3732	12507715416
GREENE FUJIKO M & WALTER	6205 RODMAN RIDGE CT LAS VEGAS NV 89130-1416	12518510062
GREENWALD RICHARD K & DOLORES G	S52W22900 HUNTERS HOLLOW CT WAUKESHA WI 53189-9739	12507810032
GREG YURI	CHUBAKOVA OLGA 2817 SHADY AVE PITTSBURG PA 15217-2740	12507715335
GREG YURI	CHUBAKOVA OLGA 2817 SHADY AVE PITTSBURG PA 15217-2740	12507715370
GRIFFITHS ANTHONY MEURIG	4093 MISSISSIPPI ST SAN DIEGO CA 92104-2410	12507715209
GRUBER JERRY	9433 PLOVER FALLS AVE LAS VEGAS NV 89149-0115	12518510064
GRZEDA RICHARD J & ERLINDA D	8250 N GRAND CANYON DR #2054 LAS VEGAS NV 89166-3732	12507715114
GRZESKOWIAK JASON T & CRAIG T	8076 FARTHING HILL RD LAS VEGAS NV 89166-3701	12507810028
GUARINO PATRICK M & LINDA L	7743 ARDEN GROVE ST LAS VEGAS NV 89113-4028	12518510016
GUIANG RYAN	9325 COLORFUL RAINBOW AVE LAS VEGAS NV 89166-3777	12507713070
GULIFORD ARTHUR S	LIGHTFOOT-GULIFORD MARY ANN 3704 WHITESTAR ST LAS VEGAS NV 89129-1710	12507715019
GULIFORD ARTHUR S	LIGHTFOOT-GULIFORD MARY ANN 3704 WHITESTAR ST LAS VEGAS NV 89129-1710	12507715340
GUMARU CHARLES SR	SORNEO ZENAIDA F 8144 SATIN CARNATION LN LAS VEGAS NV 89166-3768	12507816026
GUTIERREZ ROSARIO D	7319 S NUTREE DR SALT LAKE CITY UT 84121-4428	12507715266
GUTKIN MICHAEL E	10730 CHURCH ST #317 RANCHO CUCAMONGA CA 91730-6656	12507713076
GUZMAN JOSE M	5626 BERKSHIRE DR LOS ANGELES CA 90032-1322	12507813049
HABERMAN RACHEL	508 N LARCHMONT BLVD LOS ANGELES CA 90004-1306	12507715102
HAIR WEST	1304 GRAND AVE SAN RAFAEL CA 94901-2233	12507811045
HAJIZADEH-SEYSAN SAADAT	20480 122B AV MAPLE RIDGE BC V2X 1B6 CANADA	12507715199

Report of All Selected Parcels**Case Number:** MOD-46292**Printed On:** Thu: July 26, 2012

<u>Owner</u>	<u>Address</u>	<u>Parcel Number</u>
HAJJI FAMILY TRUST	HAJJI SHANNON & JEAN-PIERRE TRS 29129 HIGHPLAINS CT CASTAIC CA 91384-3563	12518513157
HALBACH DOUGLAS N	9337 DAFFODIL SUN AVE LAS VEGAS NV 89166-3776	12507713048
HAMEL DAVE B & LAURIE J	401 W HOWELL RIDGECREST CA 93555-3525	12518511018
HAMILTON KEVIN S LIVING TRUST	HAMILTON KEVIN S TRS 9061 STARLING WING PL LAS VEGAS NV 89143-6405	12508419078
HANEEFZAI FAWZIA	8041 TILKUNI DR LAS VEGAS NV 89166-3721	12507813040
HANNA KRESTEN	6817 LEILANI LN CYPRESS CA 90630-5717	12507811005
HANSEN JOHN & NICOLE	9104 STARLING WING PL LAS VEGAS NV 89143-4485	12508419055
HANSEN WILLIAM JAMES	VICUNA TERESA ANN 8252 BRILLIANT POMPON PL LAS VEGAS NV 89166-3775	12507713027
HANSON TIMOTHY L & MARSHA	5245 CAGNEY CT LAS VEGAS NV 89103-2503	12518510028
HARDIN SARAH	7992 BIDENS CT LAS VEGAS NV 89149-1624	12518513003
HARGREAVES TOM & KATHY	31751 224 PL S E BLACK DIAMOND WA 98010-1717	12518511022
HARNESS TURNER & KAREN	7612 CHASE HOLLOW ST LAS VEGAS NV 89149-1939	12507715314
HARRIS EUGENE III	6252 EUGENE AVE LAS VEGAS NV 89108-3311	12507715092
HARRIS RICHARD	9148 STARLING WING PL LAS VEGAS NV 89143-4486	12508325021
HART DANIEL & ALICIA	81 SATIN CARNATION LN LAS VEGAS NV 89166	12507815017
HARTLEB KURT D JR	1427 E 13TH ST UPLAND CA 91786-2802	12518515034
HARTMANN DANIEL JAMES	GARWOOD STACY RAE 9353 PINK PEAR CT LAS VEGAS NV 89149-1643	12518513035
HARTWICK BRIAN D & ELIZABETH J	232 RENWICK LN MOORESVILLE NC 28117-6662	12507715245
HARTWICK BRIAN D & ELIZABETH J	8321 DONATELLO CT LAS VEGAS NV 89129-2176	12507715248
HARTWIG JAY	7833 ITHACA FALLS ST LAS VEGAS NV 89149-0145	12518510068
HARVEY DANA	BLOSL JANINE 1031 SILVERHIL DR LAFAYETTE CA 94549-1734	12507715204
HASSAN MOHAMMAD & SALMA	1720 SONESTA CT RALEIGH NC 27613-8562	12508419050
HASTINGS DEAN	2549 MONARCH BAY DR LAS VEGAS NV 89128-6884	12507715134
HASTINGS DEAN	2549 MONARCH BAY DR LAS VEGAS NV 89128-6884	12507715054
HATCHER MARCUS D	AMADOR-SEGOVIA YESIKA 8250 N GRAND CANYON #2111 LAS VEGAS NV 89166-3734	12507715227
HEHR JOHN & AMY	9440 MELVA BLUE CT LAS VEGAS NV 89166-3709	12507811042
HENDERSON ALLEN J	9101 STARLING WING PL LAS VEGAS NV 89143-4485	12508419089
HENNEMAN KIMBERLY	3070 W RASMUSSEN RD PARK CITY UT 84098-5486	12507715131
HENRY SUNNY H & RHONITA C	8105 MARSHALL CANYON DR LAS VEGAS NV 89166-3705	12507811055
HERALD PHYLLIS	9433 MELVA BLUE CT LAS VEGAS NV 89166-3709	12507811023
HERDER PAUL & SONGAE	23697 HORSEFLY RD MONTROSE CO 81403-8526	12508419073
HERDER PAUL & SONGAE	23697 HORSEFLY RD MONTROSE CO 81403-8526	12508419062

Report of All Selected Parcels**Case Number:** MOD-46292**Printed On:** Thu: July 26, 2012

<u>Owner</u>	<u>Address</u>	<u>Parcel Numbe</u>
HERMANEK JUSTIN J	8009 CASPIAN MOON DR LAS VEGAS NV 89166-3710	12507813023
HERMIZ RENEE	2040 HIDDEN SPRINGS CT EL CAJON CA 92019-5801	12507715387
HERMIZ RENEE	2040 HIDDEN SPRINGS CT EL CAJON CA 92019-5801	12507715262
HERNANDEZ MICHAEL T	8996 DORRELL LN LAS VEGAS NV 89149-3016	12507715103
HERNANDEZ MICHAEL T	8996 DORRELL LN LAS VEGAS NV 89149-3016	12507715403
HERVEY VIOLA	1925 WALNUT LEAF DR WALNUT CA 91789-3543	12507715254
HESTER MELISSA	8944 RYAN CREEK AVE LAS VEGAS NV 89149-3268	12507715200
HEWITT PAMELA	BURWELL SANDRA 8250 N GRAND CANYON DR #2037 LAS VEGAS NV 89166-3732	12507715077
HIGHTOWER COLLIN & LINDA	5109 MASOTTA AVE LAS VEGAS NV 89141-3888	12507715214
HILDEBRAND WILLIAM C	BYRUM JENNIFER 7837 ITHACA FALLS ST LAS VEGAS NV 89149-0145	12518510067
HILL DAVID ALLEN	2250 E TROPICANNA AVE #19 LAS VEGAS NV 89119-8330	12507811021
HILL NANCY	24431 CALLE TASSJARA MURRIETA CA 92562-4303	12507715374
HILL OLIVER L	P O BOX 750691 LAS VEGAS NV 89136-0691	12507713056
HISSUNG-KRISTINA M	9353 FLOWERING TULIP AVE LAS VEGAS NV 89166-3770	12507815040
HO LUNG MICHELE ANNE	PO BOX 60102 UNIVERSITY ALBERTA EDMONTON AB T6G 2S4 CANADA	12507715302
HOBBS NICHOLAS C & WHITNEY A	FALL GINGER G & ALBERT S 9405 MELVA BLUE CT LAS VEGAS NV 89166-3708	12507811030
HOBBS WILLIAMS A	CHAROENAKSORNKUL SIRIN 8356 TETON CREST PL LAS VEGAS NV 89143-6418	12508327011
HOCEVAR FRANK	BOX 1772 UXBRIDGE ON L9P 1N8 CANADA	12507715329
HOCEVAR FRANK	BOX 1772 UXBRIDGE ON L9P 1N8 CANADA	12507715317
HOCEVAR FRANK	P O BOX 1772 UXBRIDGE ON L9P1N8 CANADA	12507715342
HOEVENER GREG	P O BOX 35993 LAS VEGAS NV 89133-5993	12507713022
HOEVENER GREG	P O BOX 35993 LAS VEGAS NV 89133-5993	12507715079
HOLLAND TIMOTHY W & CORINNE M	8113 MARSHALL CANYON DR LAS VEGAS NV 89166-3706	12507811057
HOLMES DORIS	2104 BRIGHTON SHORE ST LAS VEGAS NV 89128-7436	12507810055
HOLMES WILLIAM L	HOLMES WILLIAM J O FAMILY TRUST 29 CLOVERVIEW DR HELENA MT 59601-0252	12518513034
HORNER BROTHERS INC	4681 S VALLEY VIEW LAS VEGAS NV 89103-5515	12508419025
HOROWITZ STEVEN E	150 E 56TH ST #103 NEW YORK NY 10022-3631	12507715011
HORTON D R INC	330 CAROUSEL PKWY HENDERSON NV 89014-8817	12508327060
HORTON D R INC	330 CAROUSEL PKWY HENDERSON NV 89014-8817	12508327059
HORTON D R INC	330 CAROUSEL PKWY HENDERSON NV 89014-8817	12507714022
HORTON D R INC	330 CAROUSEL PKWY HENDERSON NV 89014-8817	12508327058
HORTON D R INC	330 CAROUSEL PKWY HENDERSON NV 89014-8817	12507714023

Report of All Selected Parcels**Case Number:** MOD-46292**Printed On:** Thu: July 26, 2012

<u>Owner</u>	<u>Address</u>	<u>Parcel Number</u>
HORTON D R INC	330 CAROUSEL PKWY HENDERSON NV 89014-8817	12507714024
HOSTIKKA RICHARD L & ASHLEY M	7930 TWIN LEAF ST LAS VEGAS NV 89149-1694	12518515069
HOUSH FAMILY REVOCABLE TRUST	HOUSH BILL C & ELAINE N TRS 3245 ROSEMONT DR SACRAMENTO CA 95826-4547	12508419068
HOWARD RICHARD D JR	7954 TWIN LEAF ST LAS VEGAS NV 89149-1695	12518515065
HUGHES ELIZABETH MARGARET FAM TR	HUGHES ELIZABETH MARGARET TRS 9245 DENTARIA CT LAS VEGAS NV 89149-1637	12518513189
HUIT SHARON F	9136 SPOONBILL RIDGE PL LAS VEGAS NV 89143-4490	12508419108
HUMBLE JOSEPH J	8193 HUMMING LN LAS VEGAS NV 89143-4489	12508325010
HURTADO CHRISTOPHER & CONSTANCE	9529 MICHELLE FALLS AVE LAS VEGAS NV 89149-3727	12518511071
HURTADO FAMILY LIVING TRUST	HURTADO RAMON A & DARLENE C TRS 4345 HALLENDALE DR LAS VEGAS NV 89147-4976	12507715281
HURTADO FAMILY LIVING TRUST	HURTADO RAMON A & DARLENE C TRS 4345 HALLENDALE DR LAS VEGAS NV 89147-4976	12507715060
HUSTAD PHILIP H	1351 KALUM LAKE DR TERRACE BC V8G 0C4 CANADA	12507715293
HUSTAD PHILIP H	1351 KALUM LAKE DR TERRACE BC V8G 0C4 CANADA	12507715392
HUSTED BRETT & PERRI	6 REAGAN DR BRIDGEWATER NJ 08807-1975	12518514011
HYATT CRAIG R	1093 WILSON DR SIMI VALLEY CA 93065-5109	12507715385
HYATT CRAIG R	1093 WILSON DR SIMI VALLEY CA 93065-5109	12507715295
HYSKO JEFF	9460 PLOVER FALLS AVE LAS VEGAS NV 89149-0116	12518510030
IBARRA EUGENIA E & JOHNNY R	7828 ITHACA FALLS ST LAS VEGAS NV 89149-0145	12518510012
ILACQUA NICHOLAS M & JACQUELYN S	14 OVERLOOK DR RIVERDALE NJ 07457-1025	12507714013
ILER JAMES LANCE TRUST	ILER JAMES TRS 2032 RIVA DEL GARDA LAS VEGAS NV 89134-2564	12507715176
INTHACHACK VICHAI	8250 N GRAND CANYON DR #2061 LAS VEGAS NV 89166-3732	12507715129
IPPOLITO ANTHONY & MARILYN E	2538 E DESERT LN GILBERT AZ 85234-2818	12508419099
J C LIVING TRUST	7121 W CRAIG RD #113-142 LAS VEGAS NV 89129-6001	12507715084
J D R E TRUST	UNSON JOSE & ELSA TRS 1348 BARRANCA AVE GLENDORA CA 91740-4914	12508325005
J J VENTURES INVESTMENTS	5900 CANOGA AVE #400 WOODLAND HILLS CA 91367-5126	12507813017
J M P PROPERTIES L L C	P O BOX 470284 AURORA CO 80047-0284	12507715052
JACKSON GARY K	14964 PRESTON DR FONTANA CA 92336-5505	12507715358
JACKSON JEREL K & NICOLE D	285 UPTOWN BLVD #729 ALTAMONTE SPRINGS FL 32701-4011	12518514026
JACOB JEFFREY & BONNIE	9116 SPOONBILL RIDGE PL LAS VEGAS NV 89143-4490	12508419113
JAMES DAVID	4367 ROBINWOOD LN MOOREPARK CA 93021-2323	12507715090
JAMISON CRAIG C & APRIL	35 TROUT DR/THE FISH RANCH CENTENNIAL WY 82055	12507713047
JAY BEE L L C	7832 BEN HOGAN DR LAS VEGAS NV 89149-6600	12507715243
JAYME JOSE	4445 N RAINBOW BLVD LAS VEGAS NV 89108-5711	12518514069

Report of All Selected Parcels**Case Number:** MOD-46292**Printed On:** Thu: July 26, 2012

<u>Owner</u>	<u>Address</u>	<u>Parcel Numbe</u>
JEEVES ANTHONY R & FLOR DE M	9515 CABOT FALLS AVE LAS VEGAS NV 89149-3724	12518511015
JEFCIK RONALD RAYMOND JR	9149 SPOONBILL RIDGE PL LAS VEGAS NV 89143-4498	12508419047
JENKEI L L C	7832 BEN HOGAN DR LAS VEGAS NV 89149-6600	12507715147
JENSON KAREN MELINDA LIVING TR	JENSON KAREN M & HARRIS L TRS 8969 MONTE ORO DR LAS VEGAS NV 89131-3912	12507715233
JERNAZIAN FAMILY TRUST	JERNAZIAN LEVON TRS 1234 ALMA ST GLENDALE CA 91202-2053	12507715024
JERNAZIAN FAMILY TRUST	JERNAZIAN LEVON TRS 1234 ALMA ST GLENDALE CA 91202-2053	12507715013
JEWEL TRUST	6955 N DURANGO #1115-387 LAS VEGAS NV 89149-4411	12507810039
JOHNSON IRA O	8045 FARTHINGS HILL DR LAS VEGAS NV 89166-3701	12507810045
JOHNSON JEFFREY & MARIA C	9523 CABOT FALLS AVE LAS VEGAS NV 89149-3724	12518511013
JOHNSON LARRY	63 ROBINHOOD LN TEXARKANA AR 71854-0797	12507715121
JOHNSON LARRY & SANDRA	P O BOX 236 IDAHO CITY ID 83631-0236	12507715255
JOHNSON MICHAEL & COLLEEN	16113 E 9000 N RD GRAND PARK IL 60940-5558	12507715288
JOHNSON ROBERT KARL	217 GRAZIER ST JOHNSTOWN PA 15905-9534	12507715310
JOHNSON ROBERT KARL	217 GRAZIER ST JOHNSTOWN PA 15905-9534	12507715061
JONES AARON	ELIAS-JONES LAVON 9328 EUPHORIA ROSE AVE LAS VEGAS NV 89166-3772	12507713059
JONES SHANNON	TATE NADINE 2617 WHITE OAK RD NO LAS VEGAS NV 89030-5340	12507713079
JONES SHARON L	9329 FLOWERING TULIP AVE LAS VEGAS NV 89166-3770	12507815034
JOSCO HOLDINGS L L C	%T & N MESERVEY 241 JUMPING SPRINGS PL HENDERSON NV 89012-3414	12507715118
JU CHANGCHING	LIU TZYY-HANN 22 GARNET TERRACE LIVINGSTONE NJ 07039-2302	12507715184
JU CHANGCHING	LIU TZYY-HANN 22 GARNET TERRACE LIVINGSTONE NJ 07039-2302	12507715156
JUAN DOMINADOR & ESPERANZA A	MUCHO ELENITA A & RAMON J 593 VIA LA PALOMA CHULA VISTA CA 91910-7948	12518510035
JULIAN DOUGLAS	9317 EUPHORIA ROSE AVE LAS VEGAS NV 89166-3771	12507815009
JUST ROBERT	9101 SPOONBILL RIDGE PL LAS VEGAS NV 89143-4496	12508419035
K B HOME L V BROOKHAVEN L L C	5655 BADURA AVE LAS VEGAS NV 89118-4713	12518515078
K B HOME L V BROOKHAVEN L L C	5655 BADURA AVE LAS VEGAS NV 89118-4713	12518515081
K B HOME L V BROOKHAVEN L L C	5655 BADURA AVE LAS VEGAS NV 89118-4713	12518515058
K B HOME L V BROOKHAVEN L L C	5655 BADURA AVE LAS VEGAS NV 89118-4713	12518515083
K B HOME L V BROOKHAVEN L L C	5655 BADURA AVE LAS VEGAS NV 89118-4713	12518515003
K B HOME L V BROOKHAVEN L L C	5655 BADURA AVE LAS VEGAS NV 89118-4713	12518515075
K B HOME L V BROOKHAVEN L L C	5655 BADURA AVE LAS VEGAS NV 89118-4713	12518515085
K B HOME L V BROOKHAVEN L L C	5655 BADURA AVE LAS VEGAS NV 89118-4713	12518515002
K B HOME L V BROOKHAVEN L L C	5655 BADURA AVE LAS VEGAS NV 89118-4713	12518515082

Report of All Selected Parcels**Case Number:** MOD-46292**Printed On:** Thu: July 26, 2012

<u>Owner</u>	<u>Address</u>	<u>Parcel Numbe</u>
K B HOME L V BROOKHAVEN L L C	5655 BADURA AVE LAS VEGAS NV 89118-4713	12518515084
K B HOME L V BROOKHAVEN L L C	5655 BADURA AVE LAS VEGAS NV 89118-4713	12518515001
K B HOME L V BROOKHAVEN L L C	5655 BADURA AVE LAS VEGAS NV 89118-4713	12518515008
KAELIN GENEVIEVE FAMILY TRUST	MILFORD SHARON K TRS 9269 SWAMP ROSE AVE LAS VEGAS NV 89149-1646	12518514099
KAKISH HABIB & JERIES	550 STRATFORD AKRON OH 44303-1822	12507715012
KAKISH-FISHER NAWZAT	FISHER LAWRENCE P 660 DELAWARE AVE AKRON OH 44303-1302	12507715080
KALAGIAN SCOTT J	KALAGIAN MARC & EMILY P O BOX 28982 LAS VEGAS NV 89126-2982	12507713010
KAMACAPA PROPERTIES SERIES L L C	43 THORNTON ST HILLSBOROUGH NJ 08844-7028	12507715018
KAMACAPA PROPERTIES SERIES L L C	43 THORNTON ST HILLSBOROUGH NJ 08844-7028	12507715253
KAMINSKY JESSICA	SCHNEIDER STEFANIE 8116 SATIN CARNATION LN LAS VEGAS NV 89166-3767	12507816019
KANE THOMAS J & BENEDICTA LIV TR	KANE THOMAS J & BENEDICTA C TRS 9185 GRAND SUNBURST CT LAS VEGAS NV 89149-3267	12518514060
KARR AUSTIN	8161 SATIN CARNATION LN LAS VEGAS NV 89166-3768	12507815061
KATZ IVAN A	221 N GELSTON ST ARLINGTON VA 22203	12507715226
KAULEINAMOKU DARYL LEISON	3671 HAWKWOOD DIAMOND BAR CA 91765-3790	12507811002
KAZARIAN CHRISTINE M	8065 MARSHALL CANYON DR LAS VEGAS NV 89166-3705	12507811052
KELLERMAN YULIYA	9412 SANTANA SIESTA AVE LAS VEGAS NV 89166-3700	12507811015
KELLEY AARON & IRYNA	9245 LOPSEED CT LAS VEGAS NV 89149-1640	12518513177
KELLY BRIAN S	11200 PLAYA BONITA LAS VEGAS NV 89138-1538	12507715217
KERIVAN FRANCES	8160 SATIN CARNATION LN LAS VEGAS NV 89166-3768	12507815020
KERR CLARENCE	6637 HARTMAN ST LAS VEGAS NV 89108-5621	12507713043
KHALID NIAZ	74 GOODE ST RICHMOND HILL ON L4S 2T5 CANADA	12508419107
KHATRI ARJUN M & WANITA A	9277 SPIDERLILY CT LAS VEGAS NV 89149-1645	12518514086
KIM HWAN Y	8140 WALDEN LAKE ST LAS VEGAS NV 89131-6710	12518514067
KIM JUNG HA	10712 LAKE CENTER PARK LN SANTA FE SPRINGS CA 90670-4218	12507715313
KIM SUNGWOOD	112 HAMSTEAD TERRANCE NW CALGARY AB T3A 5Z8 CANADA	12507715074
KING DORA	3210 AVENUE H APT 5A BROOKLYN NY 11210-3250	12518513121
KINSELLA JOHN R & GRACE M	508 S OWEN ST MOUNT PROSPECT IL 60056-3943	12518511030
KIRKPATRICK JESSICA	3311 W CORAN LN LAS VEGAS NV 89106-1115	12507815044
KITCHEN MARK & NICOLE	9432 MELVA BLUE CT LAS VEGAS NV 89166-3709	12507811040
KLEIN FAMILY TRUST	KLEIN DONNA M & RICHARD I TRS 822 CHAMISE CT SAN MARCOS CA 92069-1166	12507713061
KLUTH JESSICA	9301 EUPHORIA ROSE AVE LAS VEGAS NV 89166-3771	12507815013
KNAPP MARGARETH EMILE FAMILY TR	KNAPP MARGARETH EMILE TRS 9352 POKEWEED CT LAS VEGAS NV 89149-1644	12518513028

Report of All Selected Parcels**Case Number:** MOD-46292**Printed On:** Thu: July 26, 2012

<u>Owner</u>	<u>Address</u>	<u>Parcel Numbe</u>
KNIGHT RACHEL JULIA	8324 TETON CREST PL LAS VEGAS NV 89143-6417	12508327015
KNIGHTEN ASHTON C	9337 FLOWERING TULIP AVE LAS VEGAS NV 89166-3770	12507815036
KNUTH JOHN E	8020 FARTHINGS HILL DR LAS VEGAS NV 89166-3702	12507810005
KOCHVA YOAV BAR & MARTINA BAR	8 BOONE ST BETHPAGE NY 11714-4115	12507810012
KONRAD JEROME W	9344 POKEWEEED CT LAS VEGAS NV 89149-1644	12518514018
KOPP ALLEN J & CARA J	7909 POINT OAKS CT LAS VEGAS NV 89149-1693	12518515074
KOWALCZIK DARREN & SHAUNA	8420 RIVER RIDGE DR LAS VEGAS NV 89131-1723	12507715286
KOZLOVA LIUDMILA	OMELCHENKO ALEXANDER 10 MEADOW LAKE DR WINNIPEG MANITOBA R2C 4R8 CANADA	12507715043
KRELLENSTEIN STANLEY & EILEEN	9188 RACCOON CREEK LN LAS VEGAS NV 89143-6413	12507714005
KRINSKY KENNETH & JUDITH	8250 N GRAND CANYON DR #1076 LAS VEGAS NV 89166-3729	12507715144
KRUMM TOM & RHONA JO C	2110 100TH ST BOONE IA 50036-7302	12507714014
KRYSTA DEAN & VANESSA	49-21215 WYE RD SHERWOOD PARK AB T8G 1C8 CANADA	12507715360
KRYSTA VANESSA & DEAN	49-21215 WYERD SHERWOOD PARK AB T8G 1C8 CANADA	12507715352
KUBACKI RICHARD P	9525 MICHELLE FALLS AVE LAS VEGAS NV 89149-3727	12518511070
KUBANDA KASANDRA	9421 SWEETHOOD AVE LAS VEGAS NV 89149-1690	12518515010
KUHL DENNIS & ANNETTE	7224 W 15TH AVE KENNWICK WA 99338-1221	12507715305
KUHNS JOYCE FABBRO	8328 PREPPY FOX AVE LAS VEGAS NV 89131-3938	12507715096
KUIPER DAN	9249 S BROADWAY #200-129 HIGHLANDS RANCH CO 80129-5690	12507813048
KULMATYCSKI MICHAEL R & APRIL	9461 SWEETWOOD AVE LAS VEGAS NV 89149-1691	12518515020
KUOCH CHAN Q	6133 N MUSCATEL AVE SAN GABRIEL CA 91775-2624	12508325034
KUZNIAR KEITH & WENDY	9321 FLOWERING TULIP AVE LAS VEGAS NV 89166-3769	12507815032
L & R U S PROPERTIES L P	618 CLEARWATER WAY COQUITLAM BC V3C 5E6 CANADA	12508325002
L & R US PROPERTIES L P	618 CLEARWATER WAY COQUITLAM BC V3G 5E6 CANADA	12507715116
L V HOLDING ENTERPRISES L L C	606 S OLIVE ST #900 LOS ANGELES CA 90014-1666	12508419039
LABLABOO TRUST	17311 KINGSBURY ST GRANADA HILLS CA 91344-6111	12507813038
LAGUNA JOSE DEJESUS	GONZALEZ-LAGUNA JINA 15138 DEVONSHIRE ST MISSION HILLS CA 91345-2743	12508325020
LAGUNA LILIANA	9345 EUPHORIA ROSE AVE LAS VEGAS NV 89166-3772	12507815002
LAI TIM TAT & ANITA KIT-WAN	8 INDEPENDENCE WY TITUSVILLE NJ 08560-1521	12508327032
LAIKONA LAURIE	9252 VERVAIN CT LAS VEGAS NV 89149-1647	12518514057
LAKIN CHARLES D & LINDA M	9332 FLOWERING TULIP AVE LAS VEGAS NV 89166-3770	12507815048
LALLITE JENNIFER L	2120 SEA RIDGE DR SIGNAL HILL CA 90755-3779	12508327022
LAMB ARDIS	987 COMELLIA WAY SAN JOSE CA 95117-2302	12518514021

Report of All Selected Parcels**Case Number:** MOD-46292**Printed On:** Thu: July 26, 2012

<u>Owner</u>	<u>Address</u>	<u>Parcel Number</u>
LAMBERT MAXINE E	8120 STARLING VIEW CT LAS VEGAS NV 89166-3718	12507812037
LANE LYNDA	261 W ST CLAIR ROME MI 48065-4663	12507715240
LANE WILLIAM	8250 N GRAND CANYON #2079 LAS VEGAS NV 89166-3733	12507715159
LANE WILLIAM	8250 N GRAND CANYON DR #2079 LAS VEGAS NV 89166-3733	12507715408
LANG MICKEY	7701 W ROBINDALE RD #216 LAS VEGAS NV 89113-4048	12507715328
LANG MICKEY	7701 W ROBINDALE RD #216 LAS VEGAS NV 89113-4048	12507715041
LANG MICKEY	7701 W ROBINDALE RD #216 LAS VEGAS NV 89113-4048	12507715356
LANGEMO DOUGLAS B	9537 MICHELLE FALLS AVE LAS VEGAS NV 89149-3727	12518511073
LANGER CHRISTOPHER G	8250 N GRAND CANYON DR #1164 LAS VEGAS NV 89166-3747	12507715320
LANSBERRY MARK W & CANDACE J	9193 WILD BRIAR LN LAS VEGAS NV 89143-6420	12508327021
LAPITAN RED B & COURTNEY M	7948 TWIN LEAF ST LAS VEGAS NV 89149-1695	12518515066
LARIOZA ADRIANO	94-219 WAHO PL WAIPAHU HI 96797-5632	12518515018
LARITA GAYLIEN H LIVING TRUST	LARITA GAYLIEN H TRS 3075 ALA POHA PL #2111 HONOLULU HI 96818-1690	12518514115
LARSEN THOMAS H & JULIE	HOCKETT JACK C 908 BARBARA ST LAKE IN THE HILLS IL 60156-1587	12507715154
LAW KIM D	8250 N GRAND CANYON DR #2031 LAS VEGAS NV 89166-3731	12507715063
LAW LISA D & BARBARA J	9345 PINK PEAR CT LAS VEGAS NV 89149-1643	12518514023
LEAVITT KATHLEEN	9329 EUPHORIA ROSE AVE LAS VEGAS NV 89166-3772	12507815006
LEAVITT RAEHEL L	8277 BEGONIA BLUSH DR LAS VEGAS NV 89166-3780	12507713015
LEE ANTHONY S & MARGO MA	36 STONEHAM PL METUCHEN NJ 08840-1633	12507715208
LEE BRIAN S	CHANG KATHERINE 9325 EUPHORIA ROSE AVE LAS VEGAS NV 89166-3771	12507815007
LEE GRANT	PARIS ESTELLE 9337 EUPHORIA ROSE AVE LAS VEGAS NV 89166-3772	12507815004
LEE HWAYEON	3949 PLACITA DEL RICO LAS VEGAS NV 89120-2630	12507715353
LEE INVESTMENT PROPERTIES INC	9522 OBSERVER ST LAS VEGAS NV 89123-6273	12507715373
LEE IRVIN J	LEE ERIC 4500 ELI DR APT T-1 OWINGS MILLS MD 21117-3797	12507715123
LEE JEFFREY K	CHANG DORIS TILLY 759 26TH AVE SAN MATEO CA 94403-2602	12507715232
LEE SHAWN M & LENORA J	106 GLENN LAUREL DR PIKEVILLE NC 27863-9608	12508419117
LEE WILLIAM M & G K REV LIV TR	LEE WILLIAM M & GAIL K TRS 11233 BLAIR RD APISON TN 37302-9705	12507715229
LEFEVRE DAVID ALAN	7969 LOVELY PINE PL LAS VEGAS NV 89143-4406	12517114002
LEFLER MARTY	8412 WINTERCHASE PL LAS VEGAS NV 89143-6416	12507714018
LEHMANN SEAN	2566 BEDFORD WY CARSON CITY NV 89703-4617	12507715039
LEMAIRE PAUL H	8280 BRILLIANT POMPON PL LAS VEGAS NV 89166-3775	12507713020
LENNAR COMMUNITIES NEVADA L L C	2490 PASEO VERDE PKWY #120 HENDERSON NV 89074-7121	12507815062

Report of All Selected Parcels**Case Number:** MOD-46292**Printed On:** Thu: July 26, 2012

<u>Owner</u>	<u>Address</u>	<u>Parcel Number</u>
LEON-COBIAN J GUADALUPE	9193 STARLING WING PL LAS VEGAS NV 89143-4487	12508325011
LEUCK JARED C	LWIN JANICE M 10216 CAMINITO PITAYA SAN DIEGO CA 92131-2010	12507715234
LEVY PEGGY KARYL	78-860 ZENITH WAY LA QUINTA CA 92253-7902	12518514019
LEWIS DONNA	9341 DAFFODIL SUN AVE LAS VEGAS NV 89166-3776	12507713049
LEWIS MATTHEW G	OISBOID RACHEL B 9409 SANTANA SIESTA AVE LAS VEGAS NV 89166-3700	12507811009
LIM CATHY H	2724 TRUESDALE DR BURLINGAME CA 94010-5753	12507715364
LIMB TAMMY C & JOHN J	9293 LOPSEED CT LAS VEGAS NV 89149-1640	12518513140
LINAN GABRIEL R	9313 DAFFODIL SUN LAS VEGAS NV 89166-3774	12507713042
LINCOLN GARY	13166 11 MILE RD CARESCO MI 49033-9769	12507715030
LIPPERT MARIAN 1995 FAMILY TRUST	LIPPERT MARIAN TRS 205 REEVES CREEK WAY JAMESBORO GA 30236-4235	12508419044
LITLE BRYAN & IMELDA	7984 BIDENS CT LAS VEGAS NV 89149-1624	12518514002
LIU CLIVE	XIAO PING 1844 LANCEWOOD AVE HACIENDA HEIGHTS CA 91745-3510	12507713073
LIU WENAKI	BOX 375 45 MAIN ST ELIE MANITOBA R0H 0H0 CANADA	12508325031
LIZAMA OFELIA	9172 STARLING WING PL LAS VEGAS NV 89143-4487	12508325019
LOGGINS JESSICA & DONALD	8429 TETON CREST PL LAS VEGAS NV 89143-6419	12508327056
LOHNES CECIL & BARBARA	217 51559 RANGE RD #225 SHERWOOD PARK AB T8C1H5 CANADA	12507715350
LOPER COURTNEY S	9465 SWEETWOOD AVE LAS VEGAS NV 89149-1691	12518515021
LOPICCOLO SABRINA	9352 BUTTERCUP CT LAS VEGAS NV 89149-1629	12518513022
LOUKS PHYLLIS & GORDON	P O BOX 87 LAUREL IA 50141-0087	12507715082
LOVELL WILLIAM H TRUST	LOVELL WILLIAM H TRS 4253 BAY BEACH LN #7-B FT MYERS BEACH FL 33931-4906	12518514112
LOWE LUTHER & LILLIAN Y	425 MEADOWBROOK DR SANTA MARIA CA 93455-3605	12508325022
LOWE WANDA & EDWARD	P O BOX 4604 KEY WEST FL 33041-4604	12507715168
LOZANO-MUNOZ ANTONIO J	7943 TWIN LEAF ST LAS VEGAS NV 89149-1695	12518515028
LUBANG JOHNREY	9309 DAFFODIL SUN AVE LAS VEGAS NV 89166-3774	12507713041
LUCARELLI ANTHONY D	625 WATER VIEW DR CRANBERRY TOWNSHIP PA 16066-3490	12507715045
LUND KENNETH R & MARY A	9457 PLOVER FALLS AVE LAS VEGAS NV 89149-0116	12518510059
LV RES OPPORTUNITY FUND I L L C	6201 OAK CANYON DR #200 IRVINE CA 92618-5231	12507715138
LYNCH WILLIAM R & DENISE A	1 GIFFORD PL BOSTON MA 02127-3512	12507715108
LZ ENTERPRISES L L C	8350 HAVEN ST LAS VEGAS NV 89123-2107	12507715040
M M L ENTERPRISES L L C	5828 BARGULL BAY AVE LAS VEGAS NV 89131-2169	12508419042
M S RIALTO SKY RIDGE NV L L C	%LENNAR 2490 PASEO VERDE PKWY #120 HENDERSON NV 89074-7121	12507816087
M S RIALTO SKY RIDGE NV L L C	%LENNAR 2490 PASEO VERDE PKWY #120 HENDERSON NV 89074-7121	12507816051

Report of All Selected Parcels

Case Number: MOD-46292

Printed On: Thu: July 26, 2012

<u>Owner</u>	<u>Address</u>	<u>Parcel Number</u>
M S RIALTO SKY RIDGE NV L L C	%LENNAR 2490 PASEO VERDE PKWY #120 HENDERSON NV 89074-7121	12507816088
M S RIALTO SKY RIDGE NV L L C	%LENNAR 2490 PASEO VERDE PKWY #120 HENDERSON NV 89074-7121	12507816049
M S RIALTO SKY RIDGE NV L L C	%LENNAR 2490 PASEO VERDE PKWY #120 HENDERSON NV 89074-7121	12507816090
M S RIALTO SKY RIDGE NV L L C	%LENNAR 2490 PASEO VERDE PKWY #120 HENDERSON NV 89074-7121	12507815042
M S RIALTO SKY RIDGE NV L L C	%LENNAR 2490 PASEO VERDE PKWY #120 HENDERSON NV 89074-7121	12507816078
M S RIALTO SKY RIDGE NV L L C	%LENNAR 2490 PASEO VERDE PKWY #120 HENDERSON NV 89074-7121	12507816058
M S RIALTO SKY RIDGE NV L L C	%LENNAR 2490 PASEO VERDE PKWY #120 HENDERSON NV 89074-7121	12507816097
M S RIALTO SKY RIDGE NV L L C	%LENNAR 2490 PASEO VERDE PKWY #120 HENDERSON NV 89074-7121	12507816089
M S RIALTO SKY RIDGE NV L L C	%LENNAR 2490 PASEO VERDE PKWY #120 HENDERSON NV 89074-7121	12507816086
M S RIALTO SKY RIDGE NV L L C	%LENNAR 2490 PASEO VERDE PKWY #120 HENDERSON NV 89074-7121	12507816059
M S RIALTO SKY RIDGE NV L L C	%LENNAR 2490 PASEO VERDE PKWY #120 HENDERSON NV 89074-7121	12507816057
M S RIALTO SKY RIDGE NV L L C	%LENNAR 2490 PASEO VERDE PKWY #120 HENDERSON NV 89074-7121	12507816081
M S RIALTO SKY RIDGE NV L L C	%LENNAR 2490 PASEO VERDE PKWY #120 HENDERSON NV 89074-7121	12507816033
M S RIALTO SKY RIDGE NV L L C	%LENNAR 2490 PASEO VERDE PKWY #120 HENDERSON NV 89074-7121	12507816060
M S RIALTO SKY RIDGE NV L L C	%LENNAR 2490 PASEO VERDE PKWY #120 HENDERSON NV 89074-7121	12507816041
M S RIALTO SKY RIDGE NV L L C	%LENNAR 2490 PASEO VERDE PKWY #120 HENDERSON NV 89074-7121	12507816044
M S RIALTO SKY RIDGE NV L L C	%LENNAR 2490 PASEO VERDE PKWY #120 HENDERSON NV 89074-7121	12507816074
M S RIALTO SKY RIDGE NV L L C	%LENNAR 2490 PASEO VERDE PKWY #120 HENDERSON NV 89074-7121	12507816070
M S RIALTO SKY RIDGE NV L L C	%LENNAR 2490 PASEO VERDE PKWY #120 HENDERSON NV 89074-7121	12507816029
M S RIALTO SKY RIDGE NV L L C	%LENNAR 2490 PASEO VERDE PKWY #120 HENDERSON NV 89074-7121	12507816001
M S RIALTO SKY RIDGE NV L L C	%LENNAR 2490 PASEO VERDE PKWY #120 HENDERSON NV 89074-7121	12507816093
M S RIALTO SKY RIDGE NV L L C	%LENNAR 2490 PASEO VERDE PKWY #120 HENDERSON NV 89074-7121	12507815043
M S RIALTO SKY RIDGE NV L L C	%LENNAR 2490 PASEO VERDE PKWY #120 HENDERSON NV 89074-7121	12507816091
M S RIALTO SKY RIDGE NV L L C	%LENNAR 2490 PASEO VERDE PKWY #120 HENDERSON NV 89074-7121	12507816046
M S RIALTO SKY RIDGE NV L L C	%LENNAR 2490 PASEO VERDE PKWY #120 HENDERSON NV 89074-7121	12507816083
M S RIALTO SKY RIDGE NV L L C	%LENNAR 2490 PASEO VERDE PKWY #120 HENDERSON NV 89074-7121	12507816092
M S RIALTO SKY RIDGE NV L L C	%LENNAR 2490 PASEO VERDE PKWY #120 HENDERSON NV 89074-7121	12507816099
M S RIALTO SKY RIDGE NV L L C	%LENNAR 2490 PASEO VERDE PKWY #120 HENDERSON NV 89074-7121	12507816096
M S RIALTO SKY RIDGE NV L L C	%LENNAR 2490 PASEO VERDE PKWY #120 HENDERSON NV 89074-7121	12507815059
M S RIALTO SKY RIDGE NV L L C	%LENNAR 2490 PASEO VERDE PKWY #120 HENDERSON NV 89074-7121	12507816100
M S RIALTO SKY RIDGE NV L L C	%LENNAR 2490 PASEO VERDE PKWY #120 HENDERSON NV 89074-7121	12507815056
M S RIALTO SKY RIDGE NV L L C	%LENNAR 2490 PASEO VERDE PKWY #120 HENDERSON NV 89074-7121	12507816047

Report of All Selected Parcels

Case Number: MOD-46292

Printed On: Thu: July 26, 2012

<u>Owner</u>	<u>Address</u>	<u>Parcel Number</u>
M S RIALTO SKY RIDGE NV L L C	%LENNAR 2490 PASEO VERDE PKWY #120 HENDERSON NV 89074-7121	12507816098
M S RIALTO SKY RIDGE NV L L C	%LENNAR 2490 PASEO VERDE PKWY #120 HENDERSON NV 89074-7121	12507816053
M S RIALTO SKY RIDGE NV L L C	%LENNAR 2490 PASEO VERDE PKWY #120 HENDERSON NV 89074-7121	12507816045
M S RIALTO SKY RIDGE NV L L C	%LENNAR 2490 PASEO VERDE PKWY #120 HENDERSON NV 89074-7121	12507816038
M S RIALTO SKY RIDGE NV L L C	%LENNAR 2490 PASEO VERDE PKWY #120 HENDERSON NV 89074-7121	12507816085
M S RIALTO SKY RIDGE NV L L C	%LENNAR 2490 PASEO VERDE PKWY #120 HENDERSON NV 89074-7121	12507816039
M S RIALTO SKY RIDGE NV L L C	%LENNAR 2490 PASEO VERDE PKWY #120 HENDERSON NV 89074-7121	12507815053
M S RIALTO SKY RIDGE NV L L C	%LENNAR 2490 PASEO VERDE PKWY #120 HENDERSON NV 89074-7121	12507816071
M S RIALTO SKY RIDGE NV L L C	%LENNAR 2490 PASEO VERDE PKWY #120 HENDERSON NV 89074-7121	12507815027
M S RIALTO SKY RIDGE NV L L C	%LENNAR 2490 PASEO VERDE PKWY #120 HENDERSON NV 89074-7121	12507816095
M S RIALTO SKY RIDGE NV L L C	%LENNAR 2490 PASEO VERDE PKWY #120 HENDERSON NV 89074-7121	12507816094
M S RIALTO SKY RIDGE NV L L C	%LENNAR 2490 PASEO VERDE PKWY #120 HENDERSON NV 89074-7121	12507816082
M S RIALTO SKY RIDGE NV L L C	%LENNAR 2490 PASEO VERDE PKWY #120 HENDERSON NV 89074-7121	12507816048
M S RIALTO SKY RIDGE NV L L C	%LENNAR 2490 PASEO VERDE PKWY #120 HENDERSON NV 89074-7121	12507816052
M S RIALTO SKY RIDGE NV L L C	%LENNAR 2490 PASEO VERDE PKWY #120 HENDERSON NV 89074-7121	12507816050
M S RIALTO SKY RIDGE NV L L C	%LENNAR 2490 PASEO VERDE PKWY #120 HENDERSON NV 89074-7121	12507816004
M S RIALTO SKY RIDGE NV L L C	%LENNAR 2490 PASEO VERDE PKWY #120 HENDERSON NV 89074-7121	12507816064
M S RIALTO SKY RIDGE NV L L C	%LENNAR 2490 PASEO VERDE PKWY #120 HENDERSON NV 89074-7121	12507815026
M S RIALTO SKY RIDGE NV L L C	%LENNAR 2490 PASEO VERDE PKWY #120 HENDERSON NV 89074-7121	12507713002
M S RIALTO SKY RIDGE NV L L C	%LENNAR 2490 PASEO VERDE PKWY #120 HENDERSON NV 89074-7121	12507816036
M S RIALTO SKY RIDGE NV L L C	%LENNAR 2490 PASEO VERDE PKWY #120 HENDERSON NV 89074-7121	12507816008
M S RIALTO SKY RIDGE NV L L C	%LENNAR 2490 PASEO VERDE PKWY #120 HENDERSON NV 89074-7121	12507816007
M S RIALTO SKY RIDGE NV L L C	%LENNAR 2490 PASEO VERDE PKWY #120 HENDERSON NV 89074-7121	12507815054
M S RIALTO SKY RIDGE NV L L C	%LENNAR 2490 PASEO VERDE PKWY #120 HENDERSON NV 89074-7121	12507816005
M S RIALTO SKY RIDGE NV L L C	%LENNAR 2490 PASEO VERDE PKWY #120 HENDERSON NV 89074-7121	12507816030
M S RIALTO SKY RIDGE NV L L C	%LENNAR 2490 PASEO VERDE PKWY #120 HENDERSON NV 89074-7121	12507713001
M S RIALTO SKY RIDGE NV L L C	%LENNAR 2490 PASEO VERDE PKWY #120 HENDERSON NV 89074-7121	12507816084
M S RIALTO SKY RIDGE NV L L C	%LENNAR 2490 PASEO VERDE PKWY #120 HENDERSON NV 89074-7121	12507816068
M S RIALTO SKY RIDGE NV L L C	%LENNAR 2490 PASEO VERDE PKWY #120 HENDERSON NV 89074-7121	12507816034
M S RIALTO SKY RIDGE NV L L C	%LENNAR 2490 PASEO VERDE PKWY #120 HENDERSON NV 89074-7121	12507816003
M S RIALTO SKY RIDGE NV L L C	%LENNAR 2490 PASEO VERDE PKWY #120 HENDERSON NV 89074-7121	12507713052
M S RIALTO SKY RIDGE NV L L C	%LENNAR 2490 PASEO VERDE PKWY #120 HENDERSON NV 89074-7121	12507816006

Report of All Selected Parcels

Case Number: MOD-46292

Printed On: Thu: July 26, 2012

<u>Owner</u>	<u>Address</u>	<u>Parcel Number</u>
M S RIALTO SKY RIDGE NV L L C	%LENNAR 2490 PASEO VERDE PKWY #120 HENDERSON NV 89074-7121	12507816010
M S RIALTO SKY RIDGE NV L L C	%LENNAR 2490 PASEO VERDE PKWY #120 HENDERSON NV 89074-7121	12507816037
M S RIALTO SKY RIDGE NV L L C	%LENNAR 2490 PASEO VERDE PKWY #120 HENDERSON NV 89074-7121	12507713005
M S RIALTO SKY RIDGE NV L L C	%LENNAR 2490 PASEO VERDE PKWY #120 HENDERSON NV 89074-7121	12507816013
M S RIALTO SKY RIDGE NV L L C	%LENNAR 2490 PASEO VERDE PKWY #120 HENDERSON NV 89074-7121	12507816012
M S RIALTO SKY RIDGE NV L L C	%LENNAR 2490 PASEO VERDE PKWY #120 HENDERSON NV 89074-7121	12507816031
M S RIALTO SKY RIDGE NV L L C	%LENNAR 2490 PASEO VERDE PKWY #120 HENDERSON NV 89074-7121	12507816063
M S RIALTO SKY RIDGE NV L L C	%LENNAR 2490 PASEO VERDE PKWY #120 HENDERSON NV 89074-7121	12507816066
M S RIALTO SKY RIDGE NV L L C	%LENNAR 2490 PASEO VERDE PKWY #120 HENDERSON NV 89074-7121	12507816011
M S RIALTO SKY RIDGE NV L L C	%LENNAR 2490 PASEO VERDE PKWY #120 HENDERSON NV 89074-7121	12507816042
M S RIALTO SKY RIDGE NV L L C	%LENNAR 2490 PASEO VERDE PKWY #120 HENDERSON NV 89074-7121	12507816065
M S RIALTO SKY RIDGE NV L L C	%LENNAR 2490 PASEO VERDE PKWY #120 HENDERSON NV 89074-7121	12507816017
M S RIALTO SKY RIDGE NV L L C	%LENNAR 2490 PASEO VERDE PKWY #120 HENDERSON NV 89074-7121	12507816016
M S RIALTO SKY RIDGE NV L L C	%LENNAR 2490 PASEO VERDE PKWY #120 HENDERSON NV 89074-7121	12507816009
M S RIALTO SKY RIDGE NV L L C	%LENNAR 2490 PASEO VERDE PKWY #120 HENDERSON NV 89074-7121	12507816015
M S RIALTO SKY RIDGE NV L L C	%LENNAR 2490 PASEO VERDE PKWY #120 HENDERSON NV 89074-7121	12507816062
M S RIALTO SKY RIDGE NV L L C	%LENNAR 2490 PASEO VERDE PKWY #120 HENDERSON NV 89074-7121	12507816067
M S RIALTO SKY RIDGE NV L L C	%LENNAR 2490 PASEO VERDE PKWY #120 HENDERSON NV 89074-7121	12507816018
M S RIALTO SKY RIDGE NV L L C	%LENNAR 2490 PASEO VERDE PKWY #120 HENDERSON NV 89074-7121	12507816079
M S RIALTO SKY RIDGE NV L L C	%LENNAR 2490 PASEO VERDE PKWY #120 HENDERSON NV 89074-7121	12507815031
M S RIALTO SKY RIDGE NV L L C	%LENNAR 2490 PASEO VERDE PKWY #120 HENDERSON NV 89074-7121	12507816073
M S RIALTO SKY RIDGE NV L L C	%LENNAR 2490 PASEO VERDE PKWY #120 HENDERSON NV 89074-7121	12507816014
M S RIALTO SKY RIDGE NV L L C	%LENNAR 2490 PASEO VERDE PKWY #120 HENDERSON NV 89074-7121	12507816056
M S RIALTO SKY RIDGE NV L L C	%LENNAR 2490 PASEO VERDE PKWY #120 HENDERSON NV 89074-7121	12507816032
M S RIALTO SKY RIDGE NV L L C	%LENNAR 2490 PASEO VERDE PKWY #120 HENDERSON NV 89074-7121	12507815055
M S RIALTO SKY RIDGE NV L L C	%LENNAR 2490 PASEO VERDE PKWY #120 HENDERSON NV 89074-7121	12507816076
M S RIALTO SKY RIDGE NV L L C	%LENNAR 2490 PASEO VERDE PKWY #120 HENDERSON NV 89074-7121	12507815057
M S RIALTO SKY RIDGE NV L L C	%LENNAR 2490 PASEO VERDE PKWY #120 HENDERSON NV 89074-7121	12507815029
M S RIALTO SKY RIDGE NV L L C	%LENNAR 2490 PASEO VERDE PKWY #120 HENDERSON NV 89074-7121	12507816054
M S RIALTO SKY RIDGE NV L L C	%LENNAR 2490 PASEO VERDE PKWY #120 HENDERSON NV 89074-7121	12507816043
M S RIALTO SKY RIDGE NV L L C	%LENNAR 2490 PASEO VERDE PKWY #120 HENDERSON NV 89074-7121	12507815028
M S RIALTO SKY RIDGE NV L L C	%LENNAR 2490 PASEO VERDE PKWY #120 HENDERSON NV 89074-7121	12507816061

Report of All Selected Parcels**Case Number:** MOD-46292**Printed On:** Thu: July 26, 2012

<u>Owner</u>	<u>Address</u>	<u>Parcel Number</u>
M S RIALTO SKY RIDGE NV L L C	%LENNAR 2490 PASEO VERDE PKWY #120 HENDERSON NV 89074-7121	12507816040
M S RIALTO SKY RIDGE NV L L C	%LENNAR 2490 PASEO VERDE PKWY #120 HENDERSON NV 89074-7121	12507816055
M S RIALTO SKY RIDGE NV L L C	%LENNAR 2490 PASEO VERDE PKWY #120 HENDERSON NV 89074-7121	12507816075
M S RIALTO SKY RIDGE NV L L C	%LENNAR 2490 PASEO VERDE PKWY #120 HENDERSON NV 89074-7121	12507816035
M S RIALTO SKY RIDGE NV L L C	%LENNAR 2490 PASEO VERDE PKWY #120 HENDERSON NV 89074-7121	12507713053
M S RIALTO SKY RIDGE NV L L C	%LENNAR 2490 PASEO VERDE PKWY #120 HENDERSON NV 89074-7121	12507815041
M S RIALTO SKY RIDGE NV L L C	%LENNAR 2490 PASEO VERDE PKWY #120 HENDERSON NV 89074-7121	12507816069
M S RIALTO SKY RIDGE NV L L C	%LENNAR 2490 PASEO VERDE PKWY #120 HENDERSON NV 89074-7121	12507816072
M S RIALTO SKY RIDGE NV L L C	%LENNAR 2490 PASEO VERDE PKWY #120 HENDERSON NV 89074-7121	12507816077
M S RIALTO SKY RIDGE NV L L C	%LENNAR 2490 PASEO VERDE PKWY #120 HENDERSON NV 89074-7121	12507816002
M S RIALTO SKY RIDGE NV L L C	%LENNAR 2490 PASEO VERDE PKWY #120 HENDERSON NV 89074-7121	12507815030
M S RIALTO SKY RIDGE NV L L C	%LENNAR 2490 PASEO VERDE PKWY #120 HENDERSON NV 89074-7121	12507815058
M S RIALTO SKY RIDGE NV L L C	%LENNAR 2490 PASEO VERDE PKWY #120 HENDERSON NV 89074-7121	12507816080
MACABUHAY GODOFREDO G & APRIL F	12303 JULIUS AVE DOWNING CA 90242-3309	12508419009
MACDONALD MICHAEL C	8116 FINCH FEATHER ST LAS VEGAS NV 89143-6402	12508419017
MACEACHEM AMY	9108 STARLING WING PL LAS VEGAS NV 89143-4485	12508419057
MACWILLIAMS RICKY & DEBRA	7958 CUSTER SCHOOL RD CUSTER WA 98240-9516	12507715221
MADDAUS ELLETT	8506 RIVER RIDGE DR LAS VEGAS NV 89131-1724	12507715181
MADERAZO ENTERPRISES L L C	23 PERENNIAL BORDER CT LAS VEGAS NV 89148-2777	12507715032
MAGEL DON J & DONNA L	9344 CRANESBILL CT LAS VEGAS NV 89149-1636	12518514010
MAHAN ELDON & KAREN	1317 WASHINGTON ST RAMONA CA 92065-7600	12507715301
MAHAN ELDON & KAREN	1317 WASHINGTON ST ROMONA CA 92065-7600	12507715381
MAHAN PATRICIA S	GIESZ FREDERICK G 9252 DENTARIA CT LAS VEGAS NV 89149-1637	12518514121
MAHENDERNATH DEVENDRANATH & R	391 CHADWICK CIR HENDERSON NV 89014-4524	12507715249
MAHENDERNATH DEVENDRANATH & RANI	391 CHADWICK CIR HENDERSON NV 89014-4524	12507715007
MAKOA L L C	249 KUPAA STREET PAIA HI 96779-9731	12508419100
MALERBE SUZANNE	207 18TH ST HUNTINGTON BEACH CA 92648-3903	12507810044
MANNING DAN & NANCY	16854 COUNTRY RIDGE LN MACOMB MI 48044-5209	12507715256
MARELLO MARYROSE	FISCHER KARL 9345 COLORFUL RAINBOW AVE LAS VEGAS NV 89166-3777	12507713075
MARINELLI PATRICIA J	8333 TETON CREST PL LAS VEGAS NV 89143-6417	12508327044
MARKHAM ADAM S	9400 MELVA BLUE CT LAS VEGAS NV 89166-3708	12507811032
MARQUEZ ERIC A	5924 CAMINITO DEPORTE SAN DIEGO CA 92108-2605	12508419018

Report of All Selected Parcels**Case Number:** MOD-46292**Printed On:** Thu: July 26, 2012

<u>Owner</u>	<u>Address</u>	<u>Parcel Numbe</u>
MARSH L L C	6955 N DURANGO DR #1115 LAS VEGAS NV 89149-4418	12507811054
MARSH SHANNON L	8044 FARTHING HILLS DR LAS VEGAS NV 89166-3701	12507810020
MARSHALL CANYON L L C	91 RUTLAND ST WATERTOWN MA 02472-2107	12507811060
MARSHALL TRUST	6955 N DURANGO #1115-387 LAS VEGAS NV 89149-4411	12507811059
MARTIN ELAINE L	8225 BERMUDA BEACH DR LAS VEGAS NV 89128-7439	12507715400
MARTIN ELAINE L	8225 BERMUDA BEACH DR LAS VEGAS NV 89128-7439	12507715152
MARTIN MICHAEL S & REGINA M	9404 EAGLE RIVER CT LAS VEGAS NV 89166-3704	12507810016
MARTINEZ ANTHONY	3129 W ROBIN LN PHOENIX AZ 85027-1613	12507715309
MARTINEZ DAN	8065 STARLING VIEW CT LAS VEGAS NV 89166-3717	12507812029
MARX ROBERT A & KATHRYN L	9341 COLORFUL RAINBOW AVE LAS VEGAS NV 89166-3777	12507713074
MASON RONALD	COOPER CHERENE 5724 N GRAND CANYON DR LAS VEGAS NV 89149-1410	12507713086
MATTI WISAM	25585 BERG RD SOUTHFIELD MI 48033-2561	12507715117
MATTY LINDA	809 WOODHAVEN DR COMERCE TWP MI 48390-5800	12507715083
MATTY LINDA	809 WOODHAVEN DR COMMERCE TWP MI 48390-5800	12507715183
MAXWELL ROBERT S & GINGER T	9024 ACKERMAN AVE LAS VEGAS NV 89143-4450	12508411001
MCARDLE DANIEL A	8333 WINTERCHASE PL LAS VEGAS NV 89143-6414	12508327026
MCARTHUR CHRISTINE & CLAYTON	9345 FIELD THISTLE AVE LAS VEGAS NV 89149-1625	12518514007
MCARTHUR CHRISTINE & CLAYTON	9345 FIELD THISTLE AVE LAS VEGAS NV 89149-1625	12518513010
MCBEE TIMOTHY & ELIZABETH	8153 FINCH FEATHER ST LAS VEGAS NV 89143-6404	12508419074
MCCARTHY RACHEL	8121 SATIN CARNATION LN LAS VEGAS NV 89166-3767	12507816101
MCCLUNG BRADLEY D & TERRI A	8380 WINTERCHASE PL LAS VEGAS NV 89143-6415	12508327035
MCCOY LIVING TRUST	MCCOY CURTIS KEITH TRS 6193 TARRANT RANCH RD LAS VEGAS NV 89131-3144	12518513134
MCDONNELL ANTHONY #1 L V L L C	2917 E ALEXANDER RD NO LAS VEGAS NV 89030	12507715242
MCELROY KENNETH & LAURA	8553 E SAN ALBERTO DR SCOTTSDALE AZ 85258-4400	12507715393
MCGEE STEPHANIE M	9401 SWEETWOOD AVE LAS VEGAS NV 89149-1690	12518515005
MCKINNON LISA RENE	9284 SPIDERLILY CT LAS VEGAS NV 89149-1645	12518514084
MEADOWS CHAD & COURTNEY	9341 EUPHORIA ROSE AVE LAS VEGAS NV 89166-3772	12507815003
MEBANE BRANDY NICOLE	7893 WILD THISTLE CT LAS VEGAS NV 89149-1632	12518513161
MECHAM HEATHER ANN	7951 BLISS HILL CT LAS VEGAS NV 89149-1698	12518515062
MEDINA ARTURO	8016 FARTHING HILL DR LAS VEGAS NV 89166-3702	12507810004
MEDINA NICHOLAS M & B L LIV TR	MEDINA NICHOLAS M & BEVERLEY TRS 7123 NARROW PEAK ST LAS VEGAS NV 89149-0160	12507715006
MEDINA NICHOLAS M & B L LIV TR	MEDINA NICHOLAS M & BEVERLEY TRS 7123 NARROW PEAK ST LAS VEGAS NV 89149-0160	12507715005

Report of All Selected Parcels**Case Number:** MOD-46292**Printed On:** Thu: July 26, 2012

<u>Owner</u>	<u>Address</u>	<u>Parcel Number</u>
MEIS NICHOLAS J	8389 WINTERCHASE PL LAS VEGAS NV 89143-6415	12507714016
MELAERTS FRANCOIS & MARTIN DAVID	MELAERTS MARY ELIZABETH 4502 PATRIOT CANNON NO LAS VEGAS NV 89031-0191	12507715237
MELAERTS LISA R	9284 BOLTONIA CT LAS VEGAS NV 89149-1628	12518514092
MELENDEZ JAVIER R	6408 TRAUTMAN CT LAS VEGAS NV 89149-4750	12508419080
MENDIOLA ENCARNACION	P O BOX 3184 PAHRUMP NV 89041-3184	12518510021
MENDOZA JAIRO ANDRES	400 SONOMA VALLEY ST LAS VEGAS NV 89144-4039	12507715161
MENZEL DORTHY	8265 BEGONIA BLUSH DR LAS VEGAS NV 89166-3780	12507713012
MESERVEY IRREVOCABLE TRUST	2753 RED ARROW DR LAS VEGAS NV 89135-1621	12507715029
MEYERS KYLE	9181 WILD BRIAR LN LAS VEGAS NV 89143-6420	12508327018
MIGWI KELI-DIONNE	8136 NESTLED CT LAS VEGAS NV 89143-6406	12508419084
MIKLOS FRANK JR & FRANK SR	9432 SANTANA SIESTA AVE LAS VEGAS NV 89166-3707	12507811020
MILES SAM & CHRISTINE	8040 PANDUR ST LAS VEGAS NV 89131-4699	12507811050
MILLAN MEDGAR & MARIE JANET	13219 LA TIERRA WY SYLMAR CA 91342-3468	12507715101
MILLER BERNARD I & MARILYN S	9141 SPOONBILL RIDGE PL LAS VEGAS NV 89143-4490	12508419045
MILLER BRIAN & CHRISTY	7914 TWIN LEAF ST LAS VEGAS NV 89149-1694	12518515072
MILLER JOE & CICCI FAMILY TRUST	MILLER CARTIS J & ROSARIA C TRS 10343 POPLAR PARK AVE LAS VEGAS NV 89166-1704	12507815001
MILLER STEVEN & THERESA	8250 N GRAND CANYON DR #1045 LAS VEGAS NV 89166-3728	12507715085
MINTER TROY	8261 BEGONIA BLUSH DR LAS VEGAS NV 89166-3780	12507713011
MIORELLI FAMILY TRUST	MIORELLI CHRISTOPHER & JULIE TRS 21601 SURVEYOR CIR HUNTINGTON BEACH CA 92646-7015	12507811051
MIRAMONTES ANDREA	ARRIETA-OJEDA SERGIO 7935 STORMY FALLS ST LAS VEGAS NV 89149-3729	12518511066
MITSUYASU ROBERT & KYM	8349 TETON CREST PL LAS VEGAS NV 89143-6417	12508327046
MOHRLAND GREGORY J	7425 ALCOVE GLEN CT LAS VEGAS NV 89129-5958	12507812032
MOLINA CHARLES & AIDA	1208 TORRANCE AVE SUNNYVALE CA 94089-2606	12508419022
MOLISEE EMMETT C	8249 BRILLIANT POMPON PL LAS VEGAS NV 89166-3773	12507713066
MONGELLUZZO JOSEPH A	9432 PLOVER FALLS AVE LAS VEGAS NV 89149-0115	12518510024
MONTALVO MARIA T	9345 BUTTERCUP CT LAS VEGAS NV 89149-1629	12518514015
MONTANARO PETER & DALE	28620 MISSION DR MENIFEE CA 92584-8544	12507715170
MONTEROS DANIEL	9520 CABOT FALLS AVE LAS VEGAS NV 89149-3724	12518511064
MONZO STEVE A FAMILY TRUST	MONZO STEVE A TRS P O BOX 34263 LAS VEGAS NV 89133-4263	12507715174
MOONEY TIMOTHY BRIAN	7907 PORT CHARLES CT LAS VEGAS NV 89149-1692	12518515080
MOORE JAMES R & JESSICA A V	9468 PLOVER FALLS AVE LAS VEGAS NV 89149-0116	12518510032

Report of All Selected Parcels**Case Number:** MOD-46292**Printed On:** Thu: July 26, 2012

<u>Owner</u>	<u>Address</u>	<u>Parcel Numbe</u>
MORA MICHAELINE B	7952 STORMY FALLS ST LAS VEGAS NV 89149-3729	12518511026
MORAN MARIA TERESA	3310 FERNBIRD LN NO LAS VEGAS NV 89084-2449	12508419110
MORENAS ENTPRS SERIES III L L C	1704 PINION MESA CT LAS VEGAS NV 89128-7382	12507715290
MORENAS ENTPRS SERIES IV L L C	1704 PINION MESA CT LAS VEGAS NV 89128-7382	12507715375
MORGAN DANIEL W	8250 N GRAND CANYON DR #2181 LAS VEGAS NV 89166-3736	12507715369
MORISHIGE WALLACE J & SHARON S	1001 SLEEPY CREEK CT NO LAS VEGAS NV 89144-1423	12507713032
MORROSS ROBERT F	8032 FARTHINGS HILL DR LAS VEGAS NV 89166-3702	12507810008
MOSEMAN WADE	6955 N DURANGO DR #1115-382 LAS VEGAS NV 89149-4411	12518514122
MOZINSKI MARY ANN & GERALD	1915 S 19 ST GRAND FORKS ND 58201-8118	12507715413
MOZINSKI MARY ANN & GERALD	1915 S 19 ST GRAND FORKS ND 58201-8118	12507715115
MULLER RANDOLPH A & TERRI A	636 SHANAS LN ENCINITAS CA 92024-2433	12507713058
MUNOZ DIEGO	8192 HUMMING LN LAS VEGAS NV 89143-4489	12508325029
MUNOZ JUAN & MONICA	8064 FARTHINGS HILL DR LAS VEGAS NV 89166-3701	12507810025
MUROSAKI MICHELE M	9325 FLOWERING TULIP AVE LAS VEGAS NV 89166-3770	12507815033
MURPHY MELISSA	9309 EUPHORIA ROSE AVE LAS VEGAS NV 89166-3771	12507815011
MURRAY AMANDA & HEATHER	8365 TETON CREST PL LAS VEGAS NV 89143-6418	12508327048
MURRAY ELFREDA C	9261 DENTARIA CT LAS VEGAS NV 89149-1637	12518514119
MUSIAL RYAN W	MARTIN CHRISTINA D 9428 MELVA BLUE CT LAS VEGAS NV 89166-3709	12507811039
NADINE L OSHIMA	46-026 ALIIKANE PL #411 KANEOHE HI 96744-3721	12507815052
NATALE PHILIP	9 SHERRI RD SARATOGA SPRINGS NY 12866-8514	12518514110
NAVARRO CHARLES	8250 N GRAND CANYON DR #2068 LAS VEGAS NV 89166-3742	12507715136
NAZZARO DEBBIE	8250 N GRAND CANYON #1031 LAS VEGAS NV 89166-3730	12507715055
NEGRETE JOSEFINA C	6908 ARBUTUS AVE HUNTINGTON PARK CA 90255-5228	12507715275
NELSON MATTHEW J	9109 SPOONBILL RIDGE PL LAS VEGAS NV 89143-4496	12508419037
NESS STEVEN K	8269 BEGONIA BLUSH DR LAS VEGAS NV 89166-3780	12507713013
NEUBAUER JEAN M & ROBERT R	9344 FIELD THISTLE AVE LAS VEGAS NV 89149-1625	12518514006
NEVADA NEW BUILDS L L C	7409 MIDNIGHT RAMBLER LAS VEGAS NV 89149-0118	12518514085
NEVADA PROPERTY MGT 1 L L C	202 E 1800 S OREM UT 84058-7835	12507814060
NEWILL PATRICIA	4215 CRESCENDO AVE SAN JOSE CA 95136-2114	12507714021
NG CHERESA C	SEIDMAN DAVID W 70 ZIRCON PL SAN FRANCISCO CA 94131-2216	12508419115
NG DARRON & LISA	NG MASON 23491 PORTER CIR LAGUNA NIGUEL CA 92677-4630	12507713087
NGO JOHN H & DUSTY C	7936 TWIN LEAF ST LAS VEGAS NV 89149-1694	12518515068

Report of All Selected Parcels**Case Number:** MOD-46292**Printed On:** Thu: July 26, 2012

<u>Owner</u>	<u>Address</u>	<u>Parcel Numbe</u>
NGUYEN BAC VAN	LE MINH DI 8027 WASCANA GARDENS DRIVE REGINA SK S4V 1E9 CANADA	12518513094
NGUYEN KIM LOAN THI	8021 CASPIAN MOON DR LAS VEGAS NV 89166-3710	12507813020
NGUYEN TIMOTHY T	TAM SHEENA YEN 16 ELDERWOOD ALISO VIEJO CA 92656-2114	12507715207
NICOLALDE FAMILY TRUST	NICOLALDE LUIS A & G P CO-TRS 7599 SUMMER DAY DR CORONA CA 92883-5987	12507715113
NICOLALDE FAMILY TRUST	NICOLALDE LUIS A & G P CO-TRS 7599 SUMMER DAY DR CORONA CA 92883-5987	12507715355
NISBY BARBARA	8250 N GRAND CANYON DR #2132 LAS VEGAS NV 89166-3744	12507715264
NORRIS MARTIN P	8057 TILKUNI DR LAS VEGAS NV 89166-3721	12507813044
NOTIS SANDRA S	529 SALEM WY SMITHVILLE NJ 08205-6619	12507715354
NOUNA HILAL	36648 ETON CT STERLING HEIGHTS MI 48310-4337	12507715246
NULL PATRICK L & DEBRA K A	8381 TETON CREST PL LAS VEGAS NV 89143-6418	12508327050
NUQUI ROSELLE S	9413 MELVA BLUE CT LAS VEGAS NV 89166-3708	12507811027
NV PROPERTY MANAGEMENT L L C	PMB 29 BOX 10001 SAIPAN MP 96950-8901	12507715337
NV PROPERTY MANAGEMENT L L C	PMB 29 BOX 10001 SAIPAN MD 96950	12507715137
NYGAARD SETH J & JEAN M	9434 BLOOMING GROVE AVE LAS VEGAS NV 89149-1697	12518515040
O GROUP L L C	101-2255 TWIN CREEK PL WEST VANCOUVER BC V7S 3K4 CANADA	12518515013
O'BRIEN MATTHEW J	9353 POKEWEEED CT LAS VEGAS NV 89149-1644	12518513029
O'CALLAGHAN JAMES & JOSEPHINE	9016 ENVIRONMENT CT LAS VEGAS NV 89149-3076	12507715289
O'CONNER GRACE A & BARRIE P	9511 CABOT FALLS AVE LAS VEGAS NV 89149-3724	12518511016
O'CONNOR RAYMOND J	8273 BEGONIA BLUSH DR LAS VEGAS NV 89166-3780	12507713014
O'DELL AISHA N	9064 SPOONBILL RIDGE PL LAS VEGAS NV 89143-4497	12508419123
ODELL CHRISTOPHER R	9421 EAGLE RIVER CT LAS VEGAS NV 89166-3704	12507810009
O'HAIR PATSY J LIVING TRUST	O'HAIR PATSY J TRS 10308 CRYSTAL ARCH AVE LAS VEGAS NV 89129-8161	12518511033
OKHOMINA EVBUSOGIE	82 RIVERWOOD VW DALLAS GA 30157-4156	12507715315
OMELCHENKO ALEXANDER	KOZLOVA LIUDMILA 10 MEADOW LAKE DR WINNIPEG MB R2C 4R8 CANADA	12507715324
OPENBRIER JEFFREY M II	TAYLOR KRISTA L 9305 EUPHORIA ROSE AVE LAS VEGAS NV 89166-3771	12507815012
ORNELAS BENNY D	8061 TILKUNI DR LAS VEGAS NV 89166-3721	12507813045
ORNELAS DAVID & PEGGY JO	832 W 2300 S SYRACUSE UT 84075-9168	12518513170
ORTANEZ ALVIN REVOCABLE LIV TR	ORTANEZ ALVIN TRS 9192 RACCOON CREEK LN LAS VEGAS NV 89143-6413	12507714006
ORTEGA MARTHA P	9293 BOLTONIA CT LAS VEGAS NV 89149-1628	12518513146
ORTH PEGGY	9437 PLOVER FALLS AVE LAS VEGAS NV 89149-0115	12518510063
OSHIMA NADINE L	46-026 ALIIKANE PL #411 KANEOHE HI 96744-3721	12507815008
OTHMER KONSTANTIN	EL-FISHAWY & WERNICKE REV TR 710 W CALIFORNIA WAY WOODSIDE CA 94062-4057	12507713080

Report of All Selected Parcels**Case Number:** MOD-46292**Printed On:** Thu: July 26, 2012

<u>Owner</u>	<u>Address</u>	<u>Parcel Number</u>
OVERTON CLARK	9152 SPOONBILL RIDGE PL LAS VEGAS NV 89143-4498	12508419105
OWEN CHRISTOPHER	748 MOLASSES MILL DR DRAPER UT 84020-7578	12508419051
PACIFIC DREAMS L L C	848 N RAINBOW BLVD #1999 LAS VEGAS NV 89107-1103	12508327012
PACIOS BRIAN	8057 SCHOLARSHIP IRVINE CA 92612-5697	12508419093
PACK MARY MARGARET	4213 OAK CREEK NACOGDOCHES TX 75965-6532	12518511027
PALASKY SUE E	7924 STORMY FALLS ST LAS VEGAS NV 89149-3729	12518511019
PALMER LOUIS Q & VERONICA M	9344 PINK PEAR CT LAS VEGAS NV 89149-1643	12518514022
PALUBINSKY WILLIAM J	7877 WILD THISTLE CT LAS VEGAS NV 89149-1632	12518514104
PANICKO KEITH D	7937 TWIN LEAF ST LAS VEGAS NV 89149-1694	12518515027
PAPA DORIS V & JOJO C	1654 CANDLELIGHT AVE ESCONDIDO CA 92029-3143	12507715180
PARAVICINO PAOLA T	9424 SANTANA SIESTA AVE LAS VEGAS NV 89166-3707	12507811018
PARCELLS MICHAEL T & ERIN	9057 SPOONBILL RIDGE PL LAS VEGAS NV 89143-4497	12508419024
PARADES FAMILY TRUST	PARADES ROBERT & CANDEE LEE TRS 21724 STANDING ROCK AVE APPLE VALLEY CA 92307-4044	12507813042
PARADES VIRGILIO & ANN MARIE	3 MAYAPPLE RD SICKLERVILLE NJ 08081-1640	12508325015
PARKER JESSICA R	9093 SPOONBILL RIDGE PL LAS VEGAS NV 89143-4496	12508419033
PARROTT MICHAEL D & JO A LIV TR	PARROTT MICHAEL DAVID & JO A TRS 8250 N GRAND CANYON DR #2109 LAS VEGAS NV 89166-3734	12507715225
PARROTT MICHAEL D & JO ANN	8250 N GRAND CANYON RD #2109 LAS VEGAS NV 89166-3734	12507715394
PATINO JESSE S & ASHLEY D	7877 CLEARWEED CT LAS VEGAS NV 89149-1633	12518514108
PATRICK ANDREW W & CASSIE	7955 TWIN LEAF ST LAS VEGAS NV 89149-1695	12518515030
PATTON-HINTON TRELIS	9212 CANDILELA CT LAS VEGAS NV 89149-1630	12518514053
PAVON-VERDUZCO KARLA	8224 BRILLIANT POMPON PL LAS VEGAS NV 89166-3773	12507713034
PAYAWAL MICHELLE JOYCE	293 N STATE COLLEGE BLVD #1007 ORANGE CA 92868-5702	12507715244
PAYTON MARGARITE	P O BOX 963 MCGILL NV 89318-0963	12508419097
PEARL MARK & MARSHA	9428 PLOVER FALLS AVE LAS VEGAS NV 89149-0115	12518510023
PECTOL DUSTIN	9428 JEWEL LAKE AVE LAS VEGAS NV 89166-3703	12507810035
PEDERSON NICOLE	9337 FIELD THISTLE AVE LAS VEGAS NV 89149-1625	12518514008
PEETS DERECK J & BRITTNEY A	7926 TWIN LEAF ST LAS VEGAS NV 89149-1694	12518515070
PERATSAKIS STAVROS	1115 CEDAR AVE REDLANDS CA 92373-6646	12507810041
PEREA NANCY S	9313 PINK PEAR CT LAS VEGAS NV 89149-1643	12518514068
PEREZ DAISY L	9815 OCOTILLO FALLS LAS VEGAS NV 89148-1693	12507715406
PEREZ FAMILY TRUST	PEREZ DAISY LYNN TRS 9815 OCOTILLO FALLS LAS VEGAS NV 89148-1693	12507715162

Report of All Selected Parcels**Case Number:** MOD-46292**Printed On:** Thu: July 26, 2012

<u>Owner</u>	<u>Address</u>	<u>Parcel Numbe</u>
PEREZ WALTER ENRIQUE	7907 TWIN LEAF ST LAS VEGAS NV 89149-1694	12518515022
PERKS WILLIAM	8445 WINTERCHASE PL LAS VEGAS NV 89143-6416	12507714009
PERLONGO LANI J	8104 STARLING VIEW CT LAS VEGAS NV 89166-3717	12507812033
PERLSTEIN IDY	P O BOX 300414 BROOKLYN NY 11230-0414	12508419092
PERREIRA GEORGIA REVOCABLE TR	PERREIRA GEORGIA TRS 9292 LOPSEED CT LAS VEGAS NV 89149-1640	12518513139
PERRIGO THOMAS A & SYLVIA	11756 CASHMERE MIST AVE LAS VEGAS NV 89138-1565	12507715389
PHILLIPS TODD K	MADEDDU DANIEL J 7713 SEAGULL AVE LAS VEGAS NV 89145-5930	12518514024
PIERRA ERIC & ROBIN	18955 LOS PALOMINOS DR YORBA LINDA CA 92886-2649	12508325009
PIERRA ERIC & ROBIN	207 18TH ST HUNTINGTON BEACH CA 92648-3903	12508419075
PIMENTEL HECTOR F & ASALIA T	8068 FARTHINGS HILL DR LAS VEGAS NV 89166-3701	12507810026
PINELL JOSUE A	BROPHY KARA 9336 FLOWERING TULIP AVE LAS VEGAS NV 89166-3770	12507815047
PINTO JAMES & SUSAN	19335 PEACHTREE CIR HUNTINGTON BEACH CA 92648-5507	12518514059
PIRZADEH AMIR & MARTA Z	1020 SOUTH HILL DR #130 CARY NC 27513-8639	12507715341
PIRZADEH AMIR & MARTA Z	1020 SOUTH HILL DR #130 CARY NC 27513-8639	12507715376
PITTSLEY JOSHUA ROBERT	FRAZIER JASON MATTHEW 4480 MURRIETA CIR SAN DIEGO CA 92154-1712	12507715100
PLA JOHN & MIGUEL	12482 PUTNAM ST WHITTIER CA 90602-1002	12507812035
PLATT KATHLEEN M	8217 BRILLIANT POMPON PL LAS VEGAS NV 89166-3773	12507815016
PLATTE CURTIS	PARR LISA 181 BROOKS CT SIMI VALLEY CA 93065-8230	12507713090
PLATTE PRODUCTIONS PENSION PL	PLATTE CURTIS TRS 181 BROOKS RD SIMI VALLEY CA 93065-8230	12507713089
PLATTE PRODUCTIONS PENSION PLAN	181 BROOKS CT SIMI VALLEY CA 93065-8230	12507713071
PLUMERIA R E L L C	2248 MERIDIAN BLVD #H MINDEN NV 89423-8620	12507715410
PLUMERIA R E L L C	2248 MERIDIAN BLVD #H MINDEN NV 89423-8620	12507715160
PODOLSKY DOUGLAS	P O BOX 750811 LAS VEGAS NV 89136-0811	12507714019
POLAND RONALD	8250 N GRAND CANYON DR #2065 LAS VEGAS NV 89166-3742	12507715133
PONCE MERCEDES ALICIA	13096 LE PARC #54 CHINO HILLS CA 91709-1168	12507715325
PONCE SERGIO	8437 WINTERCHASE PL LAS VEGAS NV 89143-6416	12507714010
PONCE VICTOR	9436 JEWEL LAKE AVE LAS VEGAS NV 89166-3703	12507811001
PONEN IAN	8229 BRILLANT POMPON PL LAS VEGAS NV 89166-3773	12507713038
PONTI MICHAEL A	1057 PARKINSON CT SAN JOSE CA 95126-4827	12508419101
POON JOHNNY K	8341 TETON CREST PL LAS VEGAS NV 89143-6417	12508327045
POON JOHNNY K	8250 N GRAND CANYON DR #2155 LAS VEGAS NV 89166-3735	12507715311
POPE JACKIE W JR	8037 TILKUNI DR LAS VEGAS NV 89166-3721	12507813039

Report of All Selected Parcels**Case Number:** MOD-46292**Printed On:** Thu: July 26, 2012

<u>Owner</u>	<u>Address</u>	<u>Parcel Numbe</u>
PORTER ALFREDA LYNN	932 E 88TH ST BROOKLYN NY 11236-3943	12507715093
POUNDS CHARLES E & MICHONG	1621 ALPENHORN AVE ANCHORAGE AK 99507-1612	12518511069
POWELL CANDELARIA	7058 E STEARNS ST LONG BEACH CA 90815-2432	12507713077
POWELL JOHN	309 SONOMA VINE CT BAKERSFIELD CA 93314-4761	12507715258
POWLISHTA JEFFERY S	9312 BUTTERCUP CT LAS VEGAS NV 89149-1629	12518514077
PRICE HELEN E	2756 SAN GABRIEL AVE CLOVIS CA 93611-5047	12507715279
PRINCIPE GENE & KAREN	834 KLARVATTEN CLOSE NW EDMONTON AB T5Z3G6 CANADA	12507715165
PRINCIPE GENE & KAREN	834 KLARVATTEN CLOSE NW EDMONTON AB T5Z3G6 CANADA	12507715395
PROCTOR LARRY V & SHERRY	8141 SATIN CARNATION LN LAS VEGAS NV 89166-3768	12507816027
PRUETT ALISON LOUISE	9097 SPOONBILL RIDGE PL LAS VEGAS NV 89143-4496	12508419034
PU CHARLENE	CARPENDALE GARY 10032 VILLAGE WALK AVE LAS VEGAS NV 89149-3776	12507715263
PU CHARLENE	CARPENDALE GARY 10032 VILLAGE WALK AVE LAS VEGAS NV 89149-3776	12507715383
PUMPKIN LIVING TRUST	HAYNES DARYL N TRS 5720 CALM LAGOON AVE LAS VEGAS NV 89130-7076	12507715187
PYKNIS NICK	59 BIRCHWOOD DR PALOS PARK IL 60464-1574	12507715135
PYUNE HEEKYUNG	9261 SWAMP ROSE AVE LAS VEGAS NV 89149-1646	12518514100
PYUNE HEEKYUNG	9261 SWAMP ROSE AVE LAS VEGAS NV 89149-1646	12518514101
QUALLS DARLENE	8064 TILKUNI DR LAS VEGAS NV 89166-3721	12507813047
QUAN MING & STELLA	39 SEA CLIFF AVE SAN FRANCISCO CA 94121-1122	12507812036
QUINN MARK & ELENA	26942 MARBELLA MISSION VIEJO CA 92691-6036	12508327008
RAHMAN RUSSEL	8056 MARSHALL CANYON DR LAS VEGAS NV 89166-3705	12507810056
RAMIREZ JOHN L & ANGELITA F	16762 SANTA CORINA CT SAN DIEGO CA 92127-3308	12507713026
RAMIREZ MARIOLA T & CARLOS A	4529 W MOUNTAIN CHICAGO IL 60639	12507713019
RAMIREZ REYNALDO SR & GLORIA	8130 PEACH AVE HESPERIA CA 92345-7139	12507715051
RAMOS FEDERICO R	WILSON JOYCE M 9033 CROOKED SHELL AVE LAS VEGAS NV 89143-4458	12508411026
RAMOS HILARY & MICHELLE L	11202 BUELL ST DOWNEY CA 90241-3113	12507715372
RAMOS HILARY & MICHELLE L	11202 BUELL ST DOWNE CA 90241-3113	12507715347
RAMOS HILARY & MICHELLE L	11202 BUELL ST DOWNE CA 90241-3113	12507715380
RAMOS WILSON JR & CASSANDRA S	9429 SWEETWOOD AVE LAS VEGAS NV 89149-1690	12518515012
RANDALL WILLIAM JR	THOMPSON MONICA 802 W FORTH ST ONTARIO CA 91762	12507715178
RANDALL WILLIAM JR	THOMPSON MONICA 802 W FORTH ST ONTARIO CA 91762	12507715407
RANDAZZO PETER J & ANNA E	10017 BUNDELLA DR LAS VEGAS NV 89134-7577	12507715359
RASH ROY O & BETSY M	7744 PAINTED SUNSET DR LAS VEGAS NV 89149	12507715127

Report of All Selected Parcels**Case Number:** MOD-46292**Printed On:** Thu: July 26, 2012

<u>Owner</u>	<u>Address</u>	<u>Parcel Number</u>
RAYMOND BRIAN J	8244 BRILLIANT POMPON PL LAS VEGAS NV 89166-3773	12507713029
RAYSU HOLDINGS INC	6268 SPRING MOUNTAIN RD #100D LAS VEGAS NV 89146-8874	12507715272
REED DEBORAH R	3601 PASEO PRIMARIO CALABASAS CA 91302-3024	12507715001
REED HEATHER & WILLIAM	8124 SATIN CARNATION LN LAS VEGAS NV 89166-3767	12507816021
REICH WILLIAM & ALICE	310 HADDON CIR VERNON HILLS IL 60061-2919	12507811048
REICH WILLIAM A & ALICE R	310 HADDON CIR VERNON HILLS IL 60061-2919	12507715303
REICH WILLIAM A & ALICE R	310 HADDON CIR VERNON HILLS IL 60061-2919	12507715306
REIS MATTHEW	9316 EUPHORIA ROSÉ AVE LAS VEGAS NV 89166-3771	12507713062
RELLINS JENNIFER	8041 FARTHINGS HILL DR LAS VEGAS NV 89166-3702	12507810046
REMMEL JEFFERY A	8168 SATIN CARNATION LN LAS VEGAS NV 89166-3768	12507815018
RESTIVO GINA	1057 DAYLIGHT BLAZE WY HENDERSON NV 89052-0401	12507715307
REYES VIVENCIO A	11470 SPRINGWOOD CT RIVERSIDE CA 92505-5120	12507715110
REYNOLDS DOROTHEA	9320 PINK PEAR CT LAS VEGAS NV 89149-1643	12518514070
RICCARDI ANTHONY M & GEMMA	4 LAWCRENCE AVE STANHOPE NJ 07874-2930	12507812004
RICE FORREST	8250 GRAND CANYON DR #1009 LAS VEGAS NV 89166-3726	12507715017
RICE IDALMI A & MATTHEW J	9425 SWEETWOOD AVE LAS VEGAS NV 89149	12518515011
RICHARDSON JULIA A	9125 SPOONBILL RIDGE PL LAS VEGAS NV 89143-4490	12508419041
RICHARDSON PAMELA	CRADDOCK RONALD 22330 MEYLER ST #32 TORRANCE CA 90502-2382	12507715078
RICHTER CATHY	9028 ACKERMAN AVE LAS VEGAS NV 89143-4450	12508420003
RISTOFF GUY M & JOAN P	4887 SADDLE RIDGE DR COLORADO SPRINGS CO 80922-2227	12507810014
ROBARTS RANDALL	7993 BIDEENS CT LAS VEGAS NV 89149-1624	12518513004
ROBBINS DONALD M L L C	P O BOX 1002 NORTH BEND OR 97459-0077	12507715009
ROBBINS MARIE T L L C	P O BOX 1002 NORTH BEND OR 97459-0077	12507715120
ROBERTS KARLA	8257 BRILLIANT POMPON PL LAS VEGAS NV 89166-3775	12507713068
ROBERTS PHILLIP R & EMILY	7942 TWIN LEAF ST LAS VEGAS NV 89149-1695	12518515067
ROCHE JOAN RAE	1750 N COMMUNITY DR #102 ANAHEIM CA 92806-1043	12508327054
RODRIGUEZ JOSEPHINE	9320 DAFFODIL SUN AVE LAS VEGAS NV 89166-3774	12507713083
RODRIGUEZ LAURA	8364 TETON CREST PL LAS VEGAS NV 89143-6418	12508327010
ROGERS KATHRYN	HUDSON LEROY J III 9344 FLOWERING TULIP AVE LAS VEGAS NV 89166-3770	12507815045
ROGERS WAYNE C & ANNA E	9417 JEWEL LAKE AVE LAS VEGAS NV 89166-3703	12507810040
ROMIOS DENA	3264 SKYVIEW RIDGE CHINO HILLS CA 91709-3541	12507715076
ROSS DAVID K & RINETTE S	8145 MARSHALL CANYON DR LAS VEGAS NV 89166-3706	12507811047

Report of All Selected Parcels**Case Number:** MOD-46292**Printed On:** Thu: July 26, 2012

<u>Owner</u>	<u>Address</u>	<u>Parcel Numbe</u>
ROTH JEFFERY T & GINA M	8304 FULTON RANCH ST LAS VEGAS NV 89131-2039	12507814061
ROTSHEIN VITAL	928 S HOLT AVE LOS ANGELES CA 90035-2008	12507811038
ROUMBOS PARASKEVAS & MELINA	226 PEACOCK LN MONTEBELLO CA 90640-2638	12507715071
ROZENBLIT DMITRIY	RADOVSKY NATASHA 32 CEDAR TREE LN IRVINE CA 92612-2203	12508325032
RUECKER ERIC W	848 N RAINBOW BLVD #1999 LAS VEGAS NV 89107-1103	12507714007
RUEDINGER ERIK JAMES	9333 FLOWERING TULIIP AVE LAS VEGAS NV 89166-3770	12507815035
RUSH DONNA	HOLLEY HARRY 9277 SWAMP ROSE AVE LAS VEGAS NV 89149-1646	12518514098
RUSS CHRISTOPHER MICHAEL	7919 TWIN LEAF ST LAS VEGAS NV 89149-1694	12518515024
RUSSO JOHN	P O BOX 1275 HUNTINGTON BEACH CA 92647-1275	12507715175
RUSSO MARIA	18803 SANDHURST DR CLINTON TOWNSHIP MI 48038-4980	12507715285
RUSTIN HAL R	9276 SWAMP ROSE AVE LAS VEGAS NV 89149-1646	12518514095
RUTKOSKIE DENNIS	1483 MIDWAY WASHINGTON UT 84780-8134	12507715321
S O S MONEY PURCHASE PLAN	SCHULTZ HARVEY J & ANDREA P TRS 12 OLD CHIMNEY RD UPPER SADDLE RIVER NJ 07458-1509	12507812024
SABELLA ANDREA L	7993 CROWNBEARD ST LAS VEGAS NV 89149-1627	12518513193
SADEGHI AMIR IRA 20-8980956	BANK DELTA TRUST CUST 11700 CANTRELL RD LITTLE ROCK AR 72223-1712	12507715218
SAILORS CINDY K	P O BOX 288 LA HONDA CA 94020-0288	12507713039
SAMUELS RICHARD & STACEY	8072 FARTHINGS HILL DR LAS VEGAS NV 89166-3701	12507810027
SANABIA-PARRA LORENA	952 VIA COLUMBO ST HENDERSON NV 89011-0108	12507812031
SANCHEZ MARIA C REVOCABLE TRUST	551 JOOST AVE SAN FRANCISCO CA 94127-2407	12507810047
SANCHEZ ROGELIO	645 LA CANADA DR OXNARD CA 93033-5473	12518513183
SANGUINETTI RICHARD J	DELGRANDE ALICIA L 1215 VANCOUVER AVE BURLINGAME CA 94010-5669	12507810051
SANKIEWICZ TODD & JENNIFER	42544 WALKER CLINTON TOWNSHIP MI 48038-5406	12507715292
SANKIEWICZ TODD J & JENNIFER L	42544 WALKER ST CLINTON TOWNSHIP MI 48038-5406	12507715291
SANNES WAYNE & DORENE	914 N JENNIFER LN EAST WENATCHEE WA 98802-4668	12507715283
SANO DANIEL R	9456 PLOVER FALLS AVE LAS VEGAS NV 89149-0116	12518510029
SANTANA TRUST	6955 N DURANGO #1115-387 LAS VEGAS NV 89149-4411	12507811013
SANTOS ALBERTO F & SELENA A	9073 SPOONBILL RIDGE PL LAS VEGAS NV 89143-4497	12508419028
SARDINA REGINA	9305 LADY FINGER CT LAS VEGAS NV 89149-1639	12518513103
SASSY NEVADA MANAGEMENT L L C	7884 CLEARWEED CT LAS VEGAS NV 89149-1633	12518514106
SAVARONA L L C	33 TALL RUFF DR LAS VEGAS NV 89148-5243	12507715213
SCHMIDT R ERIC	41 LANGLEY ST COLORADO SPRINGS CO 80916-5249	12518514072

Report of All Selected Parcels**Case Number:** MOD-46292**Printed On:** Thu: July 26, 2012

<u>Owner</u>	<u>Address</u>	<u>Parcel Number</u>
SCHOEBEL ALEX & SHIRLEY	5701 CLARK DR DELTA BC V4E 1A5	12507715363
SCHOENBECK RUSSELL G & ELIZABETH	9364 OUTER BANKS AVE LAS VEGAS NV 89149-0164	12518510057
SCHOEPP DAVID & DENISE	711 FRONTIER DR GILLETTE WAY WY 82718-5743	12507715284
SCHULTZ PEGGY E	9333 EUPHORIA ROSE AVE LAS VEGAS NV 89166-3772	12507815005
SCHWARTZ HAROLD	8250 N GRAND CANYON DR #2035 LAS VEGAS NV 89166-3765	12507715075
SCHY HORTENSE	4805 CALAVO ST LAS VEGAS NV 89122-7577	12507715145
SCOTT JAMES & FRANCINE	8357 TETON CREST PL LAS VEGAS NV 89143-6418	12508327047
SCOTT JAMES F & SUSAN M	8124 STARLING VIEW CT LAS VEGAS NV 89166-3718	12507812038
SECRETARY HOUSING & URBAN DEV	%MICHAELSON CONNOR & BOUL INC 4400 WILL ROGERS PKWY #300 OKLAHOMA CITY OK 73108-1870	12508325003
SECRETARY OF HOUSING & URBAN DEV	900 E FIRST AVE SEATTLE WA 98104-1000	12518513009
SELLMAN SCOTT	26771 RANCHO PKWY LAKE FOREST CA 92630-8706	12507715066
SELLMAN SCOTT	26771 RANCHO PKWY LAKE FOREST CA 92630-8706	12507715198
SELLMAN SCOTT WARREN REV TR	CEDENO GRACE TRS 21831 MEADOWVIEW LN LAKE FOREST CA 92630-2438	12507715125
SELSER FELTON W	9153 STARLING WING LAS VEGAS NV 89143-4486	12508325025
SHADARAM SAEID	8250 N GRAND CANYON DR #1064 LAS VEGAS NV 89166-3740	12507715124
SHAH SHREYAS & AARTI	%PPTY GROUP 3286 BRENTWOOD ST LAS VEGAS NV 89121-3316	12507811053
SHANUN GERSHON REVOCABLE LIV TR	SHANUN GERSHON TRS P O BOX 751411 LAS VEGAS NV 89136-1411	12507811029
SHAPIRO ADAM J	33595 BAYPORT WY DANA POINT CA 92629-2151	12507810024
SHAPIRO LEONARD B	10300 W CHARLESTON BLVD #13-156 LAS VEGAS NV 89135-1037	12508419077
SHAPIRO MARY E	4424 SAN JOSE #4 MONTCLAIR CA 91763-1754	12507715205
SHAPIRO MARY E	4424 SAN JOSE ST #4 MONTCLAIR CA 91763-1754	12507715203
SHAPIRO MARY E	4424 SAN JOSE ST #4 MONTCLAIR CA 91763-1754	12507715228
SHARP DOUGLAS D	8250 N GRAND CANYON DR #1072 LAS VEGAS NV 89166-3729	12507715140
SHELTON THOMAS N	12514 27TH ST E EDGEWOOD WA 98372-1959	12518511028
SHERWOOD FAMILY TRUST	SHERWOOD DAVID P & DONNA M TRS 9293 SWAMP ROSE AVE LAS VEGAS NV 89149-1646	12518513152
SHPITZER GILAD	8237 BRILLIANT POMPON PL LAS VEGAS NV 89166-3773	12507713040
SHUFFORD CHARLES P & NORMA J	9321 DAFFODIL SUN AVE LAS VEGAS NV 89166-3774	12507713044
SIEGEL SCOTT	67-38 108TH ST #B53 FOREST HILLS NY 11375-2376	12508327029
SIEMEN DAVID E & LEAH ANN	8069 STARLING VIEW CT LAS VEGAS NV 89166-3717	12507812028
SIKES STEPHEN	8045 TILKUNI DR LAS VEGAS NV 89166-3721	12507813041
SILVEIRA DONNA C REVOCABLE TRUST	SILVEIRA DONNA C TRS 3017 BECKS HILL DR LAS VEGAS NV 89134-7405	12518510014

Report of All Selected Parcels**Case Number:** MOD-46292**Printed On:** Thu: July 26, 2012

<u>Owner</u>	<u>Address</u>	<u>Parcel Number</u>
SILVER STATE SCHOOLS C U	4222 S MCLEOD DR LAS VEGAS NV 89121-5216	12508419040
SILVERS FAMILY TRUST	SILVERS SUE M TRS 8309 GREEN CLOVER AVE LAS VEGAS NV 89149-2010	12518514083
SIMMONS PATRICK MORGAN & SUZANNE	7840 ITHACA FALLS ST LAS VEGAS NV 89149-0145	12518510015
SIMONSON JODY	10017 SCENIC WALK AVE LAS VEGAS NV 89149-3774	12507713030
SINOPOLI SALVADORE	SINOPOLI JUDITH 8309 WINTERCHASE PL LAS VEGAS NV 89143-6414	12508327023
SKAGGS JOSEPH G & BRENDA L	6680 FARM RD LAS VEGAS NV 89131-2222	12507715322
SKIRVIN JOHNNY & JULIEANN	2554 W 6000 N CEDAR UT 84721-5965	12508419036
SKRTICH ROBERT L & BRANDI L	9437 MELVA BLUE CT LAS VEGAS NV 89166-3709	12507811022
SLACK DAVID W	9064 STARLING WING PL LAS VEGAS NV 89143-6405	12508419061
SLATSKY WILLIAM	8137 MARSHALL CANYON DR LAS VEGAS NV 89166-3706	12507811049
SLEPION STEVEN	MURRELL-SLEPION SANDRA LEE 504 HIDDEN CT HENDERSON NV 89145-4501	12518511065
SMETAK LAURA	9312 CRANESBILL CT LAS VEGAS NV 89149-1636	12518514081
SMITH CHRISTOPHER A & ANITA T	145 APACHE DR EVANSTON WY 82930-4523	12507715195
SMITH FELICIA	9193 SPOONBILL RIDGE PL LAS VEGAS NV 89143-4491	12508325004
SMITH LAM M	8048 FARTHING HILL DR LAS VEGAS NV 89166-3701	12507810021
SMITH MICHAEL LOUIS	9328 FLOWERING TULIP AVE LAS VEGAS NV 89166-3770	12507815049
SMITH NORMAN & SANDRA	5433 GARTH AVE LOS ANGELES CA 90056-1115	12507813016
SMITH S J FAMILY TRUST	SMITH STEVEN M & JILL J TRS 11560 WHITE CLIFFS DR LAS VEGAS NV 89138-3018	12507715010
SMITH STEVEN J	RR #1 441061 CONC 8 ELMWOOD ON N0G 1S0 CANADA	12507715186
SMITH STUART	7949 TWIN LEAF ST LAS VEGAS NV 89149-1695	12518515029
SMOYAK JAMES W & TERRY A	9032 ACKERMAN AVE LAS VEGAS NV 89143-4450	12508420002
SNOWY DESERT L L C	%JEN GROUP MGT INC 10550 W ALEXANDER RD #2064 LAS VEGAS NV 89129-3513	12507715239
SNYDER REGINALD	8157 MARSHALL CANYON DR LAS VEGAS NV 89166-3706	12507811044
SOCIA JASON D & LORA	8340 WINTERCHASE PL LAS VEGAS NV 89143-6414	12508327040
SOKO TRUST	9933 MAGIC DUNES AVE LAS VEGAS NV 89149-1948	12518511031
SOKOLOVA VALENTINA G	8373 WINTERCHASE PL LAS VEGAS NV 89143-6415	12508327031
SORANNO BRYALYN A & VINCENT	8108 TILKUNI DR LAS VEGAS NV 89166-3722	12507814059
SORBORO ROSANNE M	5701 PEARL DROP LAS VEGAS NV 89107-1519	12518511014
SORRELL TOD MATTHEW	9436 MELVA BLUE CT LAS VEGAS NV 89166-3709	12507811041
SOVITSKY GEORGE A & PAULINE R	8025 BATTISTA LN LAS VEGAS NV 89123-1857	12518511029
SPANN PAUL	9157 STARLING WING PL LAS VEGAS NV 89143-4486	12508325026
SPARROWGATE HOLDINGS L L C	6955 N DURANGO DR #1115-387 LAS VEGAS NV 89149-4411	12507715362

Report of All Selected Parcels**Case Number:** MOD-46292**Printed On:** Thu: July 26, 2012

<u>Owner</u>	<u>Address</u>	<u>Parcel Numbe</u>
SPINDLER LOUANN	9204 CANDILELA CT LAS VEGAS NV 89149-1630	12518513081
STARLING VIEW COURT INVEST LLC	8108 STARLING VIEW AVE LAS VEGAS NV 89166-3717	12507812034
STATLER KIM K	8250 N GRAND CANYON DR #1013 LAS VEGAS NV 89166-3726	12507715021
STEINER DAVID GERALD	WRIGHT MELISSA ANN H C 32 BOX 32327 ELY NV 89301-9711	12507715148
STEINS JAMES	1144 MIRAMAR LAGUNA BEACH CA 92651-3526	12508325013
STEPHAN 2008 FAMILY TRUST	STEPHAN WALEED & ATHRA TRS 2262 WIND RIVER RD EL CAJON CA 92019-4153	12507715173
STEPHAN 2008 FAMILY TRUST	STEPHAN WALEED & ATHRA TRS 2262 WIND RIVER RD EL CAJON CA 92019-4153	12507715196
STEPHENS AIMEE J & ZACKERY A	8121 FINCH FEATHER ST LAS VEGAS NV 89143-6402	12508419066
STEPHENS JERRY	STEPHENS JOSEPH & MELISSA 9430 BLOOMING GROVE AVE LAS VEGAS NV 89149-1697	12518515041
STEWART FAITH L	9080 SPOONBILL RIDGE PL LAS VEGAS NV 89143-4496	12508419119
STEWART SARAH O	9120 SPOONBILL RIDGE DR LAS VEGAS NV 89143-4490	12508419112
STEWART VAUGHN C & AMBER L	8053 TILKUNI DR LAS VEGAS NV 89166-3721	12507813043
STONGE ROBERT E & ALICE M	1515 AUTUMN HILL RD DIAMOND BAR CA 91765-2606	12518514073
STRIBLING THEODORE WADE	9340 DAFFODIL SUN AVE LAS VEGAS NV 89166-3776	12507713078
SUING JUDY	8405 TETON CREST PL LAS VEGAS NV 89143-6419	12508327053
SUTCLIFFE JOAN M	1102 11TH ST #307 SANTA MONICA CA 90403-5327	12507715027
SVOBODA DANIEL L ETAL	9313 BUTTERCUP CT LAS VEGAS NV 89149-1629	12518514076
SWONGER MILTON E III	CARMONA-SWONGER LISA R 9292 VERVAIN CT LAS VEGAS NV 89149-1647	12518513097
SYKES WILLIE	9417 EAGLE RIVER CT LAS VEGAS NV 89166-3704	12507810010
SYNERGY PROPERTIES GROUP L L C	105 FOALING RIDGE NICHOLASVILLE KY 40356-8855	12507715089
SZUKALA REID J	7829 ITHACA FALLS ST LAS VEGAS NV 89149-0145	12518510069
T S P PROPERTIES I L L C	11756 CASHMERE MIST AVE LAS VEGAS NV 89138-1565	12507715273
TACKETT ARLINE L	1379 PARK WESTERN DR #165 SAN PEDRO CA 90732-2300	12508327014
TALLMAN BLAINE & MARTHA	9416 EAGLE RIVER CT LAS VEGAS NV 89166-3704	12507810019
TAM LIN	11923 ATLANTIC AVE LOS ANGELES CA 90066-5903	12507715330
TAM TED T	459 SIERRA PL GURNEE IL 60031-5160	12507715038
TAMBOR ALLAN	WOLAN JUDITH A 135 E 213TH ST EUCLID OH 44123-1066	12508419111
TAMJIDI BAHMAN & MARYAM FAM TR	TAMJIDI BAHMAN & MARYAM JT-TRS 4030 CLARINDA DR TARZANA CA 91356-5047	12507812030
TAXPAYER	LAS VEGAS NV 89000	12508419122
TAXPAYER	LAS VEGAS NV 89000	12508419031
TENG JERRY	2808 SPALDING DR LAS VEGAS NV 89134-7554	12508327036
TERRY JOSHUA	8388 WINTERCHASE PL LAS VEGAS NV 89143-6415	12508327034

Report of All Selected Parcels**Case Number:** MOD-46292**Printed On:** Thu: July 26, 2012

<u>Owner</u>	<u>Address</u>	<u>Parcel Number</u>
THAI ENTERPRISES L L C	8350 HAVEN ST LAS VEGAS NV 89123-2107	12507715230
THE BETTER HALVES L L C	8395 RAINBOW SKY ST LAS VEGAS NV 89131-0231	12518513128
THIRD BASE PROPERTIES L L C	%J ROSENBERG P O BOX 60031 LAS VEGAS NV 89160-0031	12507715025
THISTLE ROBERT & BRITTANY	9349 FLOWERING TULIP AVE LAS VEGAS NV 89166-3770	12507815039
THOMAS ANTONIETTA & JIMMY	P O BOX 524 NEW CUMBERLAND PA 17070-0524	12518514005
THOMAS JACK B & JACK	9265 EUPHORIA ROSE AVE LAS VEGAS NV 89166-3771	12507815014
THOMAS JOHN	OATES MARION 7977 BIDENS CT LAS VEGAS NV 89149-1624	12518514004
THOME THOMAS C & DEBRA A	9466 BLOOMING GROVE AVE LAS VEGAS NV 89149-1697	12518515032
THOMPSETT ROBERT & CLAUDIA A	9453 PLOVER FALLS AVE LAS VEGAS NV 89149-0116	12518510060
THOMPSON DEANNE & BRAD	STARCKE TAMMY 207 EDGEBROOK CIR N W CALGARY AB T3A 5A3 CANADA	12507715015
THOMPSON DEANNE & BRAD	STARCKE TAMMY 207 EDGEBROOK CIR N W CALGARY AB T3A 5A3 CANADA	12507715412
THOMPSON DERRICK	9438 BLOOMING GROVE AVE LAS VEGAS NV 89149-1697	12518515039
THOMPSON LESLIE	2510 RISA DR GLENDALE CA 91208-2321	12508419102
THOMSON JOHN E & JACKIE L	11404 JESSIE MAE CIR EAGLE RIVER AK 99577-7964	12507715188
TIEMAN JOSEPH M & MELODY T	8325 WINTERCHASE PL LAS VEGAS NV 89143-6414	12508327025
TIGHI FAMILY L P	%J TIGHI P O BOX 26272 LAS VEGAS NV 89126-0272	12517102001
TIGHI FAMILY L P	%J TIGHI P O BOX 26272 LAS VEGAS NV 89126-0272	12517101001
TINGLEY PHILIP M	THERESINE TANIA S 9457 SWEETWOOD AVE LAS VEGAS NV 89149-1691	12518515019
TIPPETTS BENJAMIN R & SHERIDON	8149 MARSHALL CANYON DR LAS VEGAS NV 89166-3706	12507811046
TIRRITO JAMES G & MIRELA A	24901 BLUE IRIS CT N PLAINFIELD IL 60585-2935	12507715326
TOLEDO GLADYS C & RUBEN P	DELACRUZ GLORIA 8420 155TH ST CT E PUYALLUP WA 98375-8475	12508419104
TOMASHEK PAUL	1518 N CHRISTY LN LAS VEGAS NV 89110-1632	12507715277
TOMASHEK PAUL RICHARD	1518 N CHRISTY LN LAS VEGAS NV 89110-1632	12507715268
TOMCZYK FRANK & DONNA	9413 EAGLE RIVER CT LAS VEGAS NV 89166-3704	12507810011
TORGERSON CHRISTOPHER	2633 LINCOLN BLVD #125 SANTA MONICA CA 90405-4619	12507713035
TORRES LUNINGNING C & ALEJANDRO	538 IVORY LN BARTLETT IL 60103-1229	12507715022
TORRUELLA LUIS & THERESA	11650 MOONRIDGE DR WHITTIER CA 90601-1780	12507715185
TOTARO LAUREN M	7973 LOVELY PINE PL LAS VEGAS NV 89143-4406	12517114001
TOWNSEND VICTOR MAURICE & NAYCEE	8104 TULKUNI DR LAS VEGAS NV 89166-3722	12507814058
TRAVEZ PAOLA VERONICA	8250 N GRAND CANYON #1135 LAS VEGAS NV 89166-3746	12507715267
TRAVIS CIARA MARIE & CHAD	7918 POINT OAKS CT LAS VEGAS NV 89149	12518515077
TRIPATHI FAMILY TRUST	TRIPATHI AMITABH & CLARA LU TRS 5347 CALATRANA DR WOODLAND HILLS CA 91364-1814	12507713082

Report of All Selected Parcels**Case Number:** MOD-46292**Printed On:** Thu: July 26, 2012

<u>Owner</u>	<u>Address</u>	<u>Parcel Numbe</u>
TROFIMENKO LYUDMILA	BELDING DAVID 7447 GRASSY FIELD CT LAS VEGAS NV 89131-4117	12507714008
TRUSTEE CLARK COUNTY TREASURER	%AMERICAN HOME MORTGAGE SRVCING 6501 IRVINE CENTER DR IRVINE CA 92618-2118	12507715388
TRUSTEE CLARK COUNTY TREASURER	%HALBACH BRUCE R 1025 SIERRA VISTA DR #16 LAS VEGAS NV 89169-2942	12507715126
TRUSTEE CLARK COUNTY TREASURER	%BANK AMTRUST 1111 CHESTER AVE MAIL CODE # OH98-0805 CLEVELAND OH 44114-3545	12507715404
TRUSTEE CLARK COUNTY TREASURER	%HARRIS EUGENE III 8805 BUFFALO CLOUD AVE LAS VEGAS NV 89143-5407	12507715405
TRUSTEE CLARK COUNTY TREASURER	%BANK AMTRUST 1111 CHESTER AVE MAIL CODE #OH98-0805 CLEVELAND OH 44114-3545	12507715411
TRUSTEE CLARK COUNTY TREASURER	%CLAY LIEZEL 11108 OLEG CT LAS VEGAS NV 89141-3996	12507715319
TRUSTEE CLARK COUNTY TREASURER	%WATKINS JOHN S 8149 SATIN CARNATION LN LAS VEGAS NV 89166-3768	12507815025
TUCCI ROBERT L	5700 PASEO MONTANA LAS VEGAS NV 89108-4112	12507715003
TUCKER CHRISTOPHER L	9140 STARLING WING PL LAS VEGAS NV 89143-4486	12508325023
TURIACE THOMAS F & MARGARET M	9512 MOUNTAINAIR AVE LAS VEGAS NV 89134-6219	12507715016
TURLEY TRAVIS DON	9449 PLOVER FALLS AVE LAS VEGAS NV 89149-0116	12518510061
TURNER ALAN B	9077 SPOONBILL RIDGE PL LAS VEGAS NV 89143-4497	12508419029
TYLER STEFANIE T	9153 SPOONBILL RIDGE PL LAS VEGAS NV 89143-4498	12508419048
TYLER TRUST	CHARBONNEAU JEFFERY P & S A TRS %J CHARBONNEAU P O BOX 669 PAHRUMP NV 89041-0669	12518511032
U S HOME CORPORATION	%LENNAR 2490 PASEO VERDE PKWY #120 HENDERSON NV 89074-7121	12507816111
U S HOME CORPORATION	%LENNAR 2490 PASEO VERDE PKWY #120 HENDERSON NV 89074-7121	12507713093
U S HOME CORPORATION	%LENNAR 2490 PASEO VERDE PKWY #120 HENDERSON NV 89074-7121	12507816102
U S HOME CORPORATION	%LENNAR 2490 PASEO VERDE PKWY #120 HENDERSON NV 89074-7121	12507713095
U S HOME CORPORATION	%LENNAR 2490 PASEO VERDE PKWY #120 HENDERSON NV 89074-7121	12507816110
U S HOME CORPORATION	%LENNAR 2490 PASEO VERDE PKWY #120 HENDERSON NV 89074-7121	12507815063
U S HOME CORPORATION	%LENNAR 2490 PASEO VERDE PKWY #120 HENDERSON NV 89074-7121	12507816108
U S HOME CORPORATION	%LENNAR 2490 PASEO VERDE PKWY #120 HENDERSON NV 89074-7121	12507713092
U S HOME CORPORATION	%LENNAR 2490 PASEO VERDE PKWY #120 HENDERSON NV 89074-7121	12507816107
U S HOME CORPORATION	%LENNAR 2490 PASEO VERDE PKWY #120 HENDERSON NV 89074-7121	12507816103
U S HOME CORPORATION	%LENNAR 2490 PASEO VERDE PKWY #120 HENDERSON NV 89074-7121	12507816104
U S HOME CORPORATION	%LENNAR 2490 PASEO VERDE PKWY #120 HENDERSON NV 89074-7121	12507713099
U S HOME CORPORATION	%LENNAR 2490 PASEO VERDE PKWY #120 HENDERSON NV 89074-7121	12507713094
U S HOME CORPORATION	%LENNAR 2490 PASEO VERDE PKWY #120 HENDERSON NV 89074-7121	12507815066
U S HOME CORPORATION	%LENNAR 2490 PASEO VERDE PKWY #120 HENDERSON NV 89074-7121	12507816109
U S HOME CORPORATION	%LENNAR 2490 PASEO VERDE PKWY #120 HENDERSON NV 89074-7121	12507815065

Report of All Selected Parcels**Case Number:** MOD-46292**Printed On:** Thu: July 26, 2012

<u>Owner</u>	<u>Address</u>	<u>Parcel Numbe</u>
U S HOME CORPORATION	%LENNAR 2490 PASEO VERDE PKWY #120 HENDERSON NV 89074-7121	12507816105
U S HOME CORPORATION	%LENNAR 2490 PASEO VERDE PKWY #120 HENDERSON NV 89074-7121	12507713091
U S HOME CORPORATION	%LENNAR 2490 PASEO VERDE PKWY #120 HENDERSON NV 89074-7121	12507815064
U S HOME CORPORATION	%LENNAR 2490 PASEO VERDE PKWY #120 HENDERSON NV 89074-7121	12507816114
U S HOME CORPORATION	%LENNAR 2490 PASEO VERDE PKWY #120 HENDERSON NV 89074-7121	12507815067
U S HOME CORPORATION	%LENNAR 2490 PASEO VERDE PKWY #120 HENDERSON NV 89074-7121	12507816106
U S HOME CORPORATION	%LENNAR 2490 PASEO VERDE PKWY #120 HENDERSON NV 89074-7121	12507816112
U S HOME CORPORATION	%LENNAR 2490 PASEO VERDE PKWY #120 HENDERSON NV 89074-7121	12507713100
U S HOME CORPORATION	%LENNAR 2490 PASEO VERDE PKWY #120 HENDERSON NV 89074-7121	12507816113
U S HOME CORPORATION	%LENNAR 2490 PASEO VERDE PKWY #120 HENDERSON NV 89074-7121	12507713097
U S HOME CORPORATION	%LENNAR 2490 PASEO VERDE PKWY #120 HENDERSON NV 89074-7121	12507713096
U S HOME CORPORATION	%LENNAR 2490 PASEO VERDE PKWY #120 HENDERSON NV 89074-7121	12507713098
UHM YOUNG M	71-22 164TH ST FRESH MEADOWS NY 11365-4239	12507715282
UNGERMANN HEATHER	8281 BEGONIA BLUSH DR LAS VEGAS NV 89166-3780	12507713016
URCIA ANDRES & ROWENA	3345 ANNANDALE RD FALLS CHURCH VA 22042-3721	12507715269
URIBE ANTONIO	9260 LOPSEED CT LAS VEGAS NV 89149-1640	12518514114
USA	CITY OF LAS VEGAS LEASE 400 STEWART AVE LAS VEGAS NV 89101	12518501006
USA	WASHINGTON DC 20260	12518501014
VACCARINO CHAD & KIMBERLY	9408 SANTANA SIESTA AVE LAS VEGAS NV 89166-3700	12507811014
VALDEZ ISABELO C JR	8604 BLOWING PINES DR LAS VEGAS NV 89143-4464	12507715194
VANDENBERGHE ROBERT J	7408 DELECTABLE CT LAS VEGAS NV 89149-3066	12507715193
VANHOLLEBEKE ANTHONY & STEPHANIE	7477 W LAKE MEAD BLVD #110 LAS VEGAS NV 89128-0374	12507811056
VANRYNE STEVEN P II & LAURA C	8396 WINTERCHASE PL LAS VEGAS NV 89143-6415	12508327033
VANUS ERIC K & AMY P	7848 ITHACA FALLS ST LAS VEGAS NV 89149-0145	12518510017
VAUGHN CRAIG & SOPHIA	8388 TETON CREST PL LAS VEGAS NV 89143-6418	12508327007
VAUGHN-O'BRIEN DAKOTA	8773 COUNTRY PINES AVE LAS VEGAS NV 89129-7641	12508325008
VEGAS PROPERTY NOW L L C	P O BOX 336078 NO LAS VEGAS NV 89033-6078	12507715235
VEGAS VERDE CORP	9389 W VERDE WY LAS VEGAS NV 89149-2508	12507715349
VEJVODA DANIEL W	9161 STARLING WING PL LAS VEGAS NV 89143-4486	12508325027
VELOCE PROPERTIES L L C	12301 BRANFORD ST SUN VALLEY CA 91352-1012	12507715287
VELOCE PROPERTIES L L C	20119 WELLS DR WOODLAND HILLS CA 91364-4729	12507715210
VENTURA TONY & NICOLE	9244 SPIDERLILY CT LAS VEGAS NV 89149-1645	12518513184

Report of All Selected Parcels**Case Number:** MOD-46292**Printed On:** Thu: July 26, 2012

<u>Owner</u>	<u>Address</u>	<u>Parcel Numbe</u>
VICK KATHY & PAUL	6455 BLUFF DWELLERS AVE LAS VEGAS NV 89131-3027	12508418003
VILLAVERDE BENEDICT K & CHRISTIE	491 PAUMAKUA WY KAILUA HI 96734-3172	12507715339
VILLAVICENCIO GUIDO & SARA J	8012 FARTHINGS HILL DR LAS VEGAS NV 89166-3702	12507810003
VILORIA JEANETTE KANANI	91-1288 KANEANA ST #18B EWA BEACH HI 96706-4703	12508327019
VIRCSIK TRUST	VIRCSIK ROBIN FRANCES TRS 9065 STARLING WING PL LAS VEGAS NV 89143-6405	12508419079
VIVIANO STEVEN L & SUSAN L	7 SMOCK CT TOWACO NJ 07082-1453	12518510019
VLAMING DOUG B JR	VLAMING FAMILY TRUST AGREEMENT 22909 FRISCA DR VALENCIA CA 91354-2224	12507715368
VUKSANOVIC MILORAD	8229 BEGONIA BLUSH DR LAS VEGAS NV 89166-3779	12507713003
WADIE INVESTMENTS L L C	%D BAILEY JR 1613 ESTRELLA ST LAS VEGAS NV 89117-9020	12518510034
WALCZAK REGINA M LIVING TRUST	WALCZAK REGINA M TRS 10404 ERICAS EDEN ST LAS VEGAS NV 89131-1507	12507715149
WALKER ADAM	8136 FINCH FEATHER ST LAS VEGAS NV 89143-6403	12508419012
WALKER NICOLE S	9508 QUITMAN AVE LAS VEGAS NV 89149-1934	12518512015
WALKER PAUL & DENISE R	SCHUELLER GAIL 10380 WILSHIRE BLVD #301 LOS ANGELES CA 90024-4741	12507715169
WALLIS STEEL C	9420 JEWEL LAKE AVE LAS VEGAS NV 89166-3703	12507810033
WALTERS JEFF & KIM	2689 MAPLEWOOD DR LONGVIEW WA 98632-4604	12507715106
WANG JACKSON & HSIU	4239 N 165TH ST OMAHA NE 68116-2924	12507715004
WARD SHAWN & VERONICA	9412 MELVA BLUE CT LAS VEGAS NV 89166-3708	12507811035
WARD TERI	8414 W FARM RD #180-290 LAS VEGAS NV 89131-8170	12507715278
WARE DAN S	7729 RIO VISTA ST LAS VEGAS NV 89131-0101	12507715070
WARE DAN S	7729 RIO VISTA ST LAS VEGAS NV 89131-0101	12507715171
WARE MARCUS	9320 FLOWERING TULIP AVE LAS VEGAS NV 89166-3769	12507815051
WASHINGTON MICHAEL A	9441 SWEETWOOD AVE LAS VEGAS NV 89149-1691	12518515015
WASHINGTON RON & BRENDA	8372 TETON CREST PL LAS VEGAS NV 89143-6418	12508327009
WATKINS AMANDA L & JOHN S	8137 SATIN CARNATION LN LAS VEGAS NV 89166-3768	12507816028
WATSON ALBERT LAWSON	8136 STARLING VIEW CT LAS VEGAS NV 89166-3719	12507812002
WATSON NICOLE M & RENE S	7985 BIDENS CT LAS VEGAS NV 89149-1624	12518514003
WEAVER CAROLINE J	JENKS LAWRENCE M P O BOX 1562 SANTA ROSA CA 95402-1562	12507715299
WEAVER TIMOTHY P	7230 REDCINDER LAS VEGAS NV 89131-3319	12507715331
WEAVER TIMOTHY P	7230 RED CINDER LAS VEGAS NV 89131-3319	12507715224
WEAVER TIMOTHY P	7230 RED CINDER LAS VEGAS NV 89131-3319	12507715323
WEBER ALYSON K	8117 MARSHALL CANYON DR LAS VEGAS NV 89166-3706	12507811058
WEGENER TAMMY K	8152 SATIN CARNATION LN LAS VEGAS NV 89166-3768	12507815022

Report of All Selected Parcels**Case Number:** MOD-46292**Printed On:** Thu: July 26, 2012

<u>Owner</u>	<u>Address</u>	<u>Parcel Numbe</u>
WEINTRAUB KEVYN M	233 SENECA TRL CRESTVIEW FL 32536-6532	12518515033
WELBORN BOBBY D	7965 LOVELY PINE PL LAS VEGAS NV 89143-4406	12517114003
WESLEY PAMELA M & STEPHEN W	9053 SPOONBILL RIDGE PL LAS VEGAS NV 89143-4497	12508419023
WESTERMAN KEVIN	9145 SPOONBILL RIDGE PL LAS VEGAS NV 89143-4490	12508419046
WESTERN HOME LOANS INC	350 CANOE COVE DR DIAMOND BAR CA 91765-1806	12508419090
WHALEY ADELA	P O BOX 30903 LAS VEGAS NV 89173-0903	12507715312
WHITEHEAD STEVEN R & LESLIE	9285 SWAMP ROSE AVE LAS VEGAS NV 89149-1646	12518514097
WHITFIELD DONALD R	9253 DENTARIA CT LAS VEGAS NV 89149-1637	12518514120
WIESNER THOMAS CHARLES JR & YUKO	8140 NESTLED CT LAS VEGAS NV 89143-6406	12508419083
WILDER CHELSEA R	HURLEY KYLE PATRICK 8397 TETON CREST PL LAS VEGAS NV 89143-6418	12508327052
WILDIN DARRYL & MARION	688 CADOGAN ST NANAIMO BC V9S 1T7 CANADA	12507715357
WILDIN DARRYL & MARION	688 CADOGAN ST NANAIMO BC V9S 1T7 CANADA	12507715379
WILDS CHARLES E & MADELINE E	9429 JEWEL LAKE AVE LAS VEGAS NV 89166-3703	12507810037
WILKERSON FAMILY TRUST	BARTON JOHN & PATRICIA TRUST 3914 S CLIFFHAVEN LN WEST VALLEY UT 84128-5303	12507715002
WILLARD AMBER E	9340 FLOWERING TULIP AVE LAS VEGAS NV 89166-3770	12507815046
WILLIAMS GLORIA J	6600 SILVER PENNY AVE LAS VEGAS NV 89108-0206	12507715172
WILLIAMS JAMES T	9320 CRANESBILL CT LAS VEGAS NV 89149-1636	12518514082
WILLIAMS MARSHYAN	9321 CRANESBILL CT LAS VEGAS NV 89149-1636	12518514079
WILLIAMS NICHOLE L	9072 SPOONBILL RIDGE PL LAS VEGAS NV 89143-4497	12508419121
WILLIAMS PATRICIA O	9400 SANTANA SIESTA AVE LAS VEGAS NV 89166-3700	12507811012
WINSTON MARSHAUN A R REV LIV TR	3216 W CHARLESTON BLVD #B LAS VEGAS NV 89102-1983	12518513167
WIZE TEAM L L C	2123 LOUIS RD PALO ALTO CA 94303-3454	12507715053
WOMACK BERNADETTE	5529 TIMBERCREST AVE LAS VEGAS NV 89131-3693	12507715241
WOMACK CASSANDRA E	9321 POKEWEEED CT LAS VEGAS NV 89149-1644	12518514071
WONDERS KAYE A	9329 FIELD THISTLE AVE LAS VEGAS NV 89149-1625	12518513013
WONG SIENFU & HSIU H	4202 N 163RD AVE OMAHA NE 68116-2919	12507715280
WOOD ALAN & LEE ANNE	%S FOSTER 4047 W DOROTHY CIR HURRICANE UT 84737-7739	12518510025
WOODEN JEROME & JOYCE	9406 BLOOMING GROVE AVE LAS VEGAS NV 89149-1696	12518515047
WOODY PAUL	8000 STONE CASTLE RD ATHENS OH 45701-8871	12508327041
WOTTON DAVID R & CHARLOTTE M	5590 PEBBLE RIDGE CT ANN ARBOR MI 48108-9770	12508327043
WOULFIN ANDREW P	9345 DAFFODIL SUN AVE LAS VEGAS NV 89166-3776	12507713050
WRIGHT CRAIG & KATHLEEN	8452 BRODY MARSH AVE LAS VEGAS NV 89143-5152	12507715098

Report of All Selected Parcels**Case Number:** MOD-46292**Printed On:** Thu: July 26, 2012

<u>Owner</u>	<u>Address</u>	<u>Parcel Number</u>
WRIGHT FRANK W III	8029 PEACEFUL VILLAGE PL LAS VEGAS NV 89143-4472	12508418064
WRIGHT JEFFREY B	1603 TEAL CREST CT KELLER TX 76248-5412	12507715058
WUCINICH MICHAEL KENNETH	JAMES CRYSTAL 8149 NESTLED CT LAS VEGAS NV 89143-6406	12508419087
YAGHOUBIAN EBRAHIM	10380 WILSHIRE BLVD #301 LOS ANGELES CA 90024-4741	12507715166
YAGHOUBIAN EBRAHIM	10380 WILSHIRE BLVD #301 LOS ANGELES CA 90024-4741	12507715366
YAGHOUBIAN EBRAHIM	10380 WILSHIRE BLVD #301 LOS ANGELES CA 90024-4741	12507715351
YAGODA GERALDINE	CORTINA STACEY & MICHAEL 9036 ACKERMAN AVE LAS VEGAS NV 89143-4450	12508420001
YAP THEODORE M L JR	9336 POKEWEEED CT LAS VEGAS NV 89149-1644	12518514017
YENS SHARON T & ROBERT	9400 EAGLE RIVER CT LAS VEGAS NV 89166-3704	12507810015
YIP RYAN E	342 SCOTTSDALE RD PLEASANT HILL CA 94523-5106	12507810013
YOUNG ASHLIE M	9425 MELVA BLUE CT LAS VEGAS NV 89166-3709	12507811025
ZAERINGER FRANK	998 STANFORD AVE #208 BATON ROUGE LA 70808-3663	12508327030
ZAMANTA IV INC	9322 FRONT BEACH RD PC BEACH FL 32407-4033	12518513110
ZAND MOHAMMAD & AZAR FAM TR 2003	68 HACKAMORE LN BELL CANYON CA 91307-1017	12507715067
ZEDEK RON	6889 S EASTERN AVE #100 LAS VEGAS NV 89119-4687	12507715059
ZEDEK RON	6889 S EASTERN AVE #100 LAS VEGAS NV 89119-4687	12507715215
ZEILMAN GARY D & MARGARET A	8025 SWEET CLOVER CT LAS VEGAS NV 89131-8124	12518514020
ZHANG FAMILY TRUST	ZHANG XICHEN TRS 2317 GILLINGHAM CIR THOUSAND OAKS CA 91362-1608	12507715259
ZOMET YOSSEF & ATIV	1678 DOLORES ST SAN FRANCISCO CA 94110-4923	12507715086
ZWIJAC JOSEPH A & JESSICA	9320 POKEWEEED CT LAS VEGAS NV 89149-1644	12518514074