



Legal Notices Transmittal and Scanning Separator Sheet

Legal Notice Type: Legal Mailings

Date of Transfer to ERM: 12/8/2011

Page Count: 9

Meeting Date: 12/13/2011

Meeting Type: Planning Commission <=>

Case Number(s): SDR-43737 <=>

Subject of Affidavit: APPLICANT/OWNER: JRJ PROPERTIES - on 5.40 acres at the northwest corner of Sahara Avenue and Decatur Boulevard <=>

Record Series: Legal Notices

LRDA Number: 2007-1717

Retention: Permanent

File By: Meeting Date



Prepared By: gporrillo

Scanned By:

SCANNED

DEC 13 2011

QC By:

City of Las Vegas
Department of Planning
Development Services Center
333 North Rancho Drive, 3rd Floor
Las Vegas, Nevada 89106

Return Service Requested
Official Notice of Public Hearing

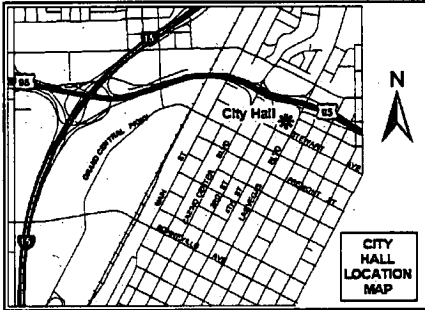

If you wish to file your protest or support on this request, check the appropriate box below and return this card in an envelope with postage to the Department of Planning, Case Planning Division at the address listed above or fax this side of this card to (702) 385-7268. If you would like to contact your Council Representative, please call (702) 229-6405.

I SUPPORT
this Request

I OPPOSE
this Request

Please use available blank space on card for your comments.

SDR-43737

Planning Commission Meeting of 12/13/2011

Application Information

SDR-43737 - SITE DEVELOPMENT PLAN REVIEW - PUBLIC HEARING - APPLICANT/OWNER: JRJ PROPERTIES - For possible action on a request for a Site Development Plan Review FOR A PROPOSED MOTOR VEHICLE SALES (NEW) FACILITY WITH WAIVERS TO ALLOW LANDSCAPE BUFFER WIDTHS OF ZERO FEET ALONG PORTIONS OF THE SOUTH AND EAST PROPERTY LINES WHERE 15 FEET IS REQUIRED AND ALONG THE NORTH AND WEST PROPERTY LINES WHERE EIGHT FEET IS REQUIRED on 5.40 acres at the northwest corner of Sahara Avenue and Decatur Boulevard (APNs 163-01-803-004 and 005), C-2 (General Commercial) Zone, Ward 1 (Tarkanian).

Application Location

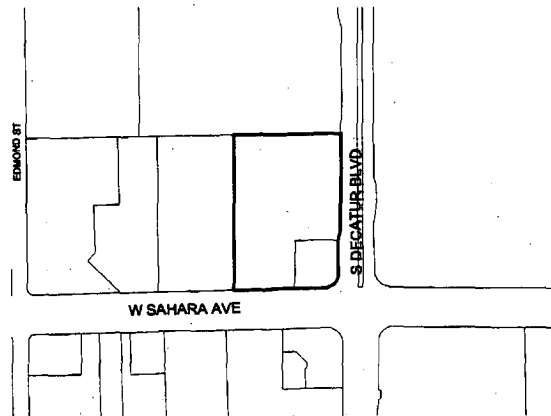

The proposed project may not pertain to the entire highlighted project site.

Public Hearing Information

Meeting: Planning Commission
Date: December 13, 2011
Time: 6:00 P.M.
Location: City Council Chambers
400 Stewart Avenue
Las Vegas, Nevada

Any and all interested persons may appear before the City Planning Commission either in person or by representative and object to or express approval of this request; or may, prior to this meeting, file a written objection thereto or approval thereof with the Department of Planning, Case Planning Division, Development Services Center, 333 North Rancho Drive, 3rd Floor, Las Vegas, Nevada 89106. Final Action on General Plan Amendments and Rezonings will be determined by the City Council. Other public hearing items may be deemed Final Action by the Planning Commission or forwarded to the City Council. The date of the City Council meeting, if applicable, will be announced at the Planning Commission meeting after the discussion of the item. For further information, including the full staff report, please call (702) 229-6301 (TDD 386-9108) or go to <http://www.lasvegasnevada.gov>.

Report of All Selected Parcels**Case Number:** SDR-43737**Printed On:** Thu: December 8, 2011

<u>Owner</u>	<u>Address</u>	<u>Parcel Number</u>
B W PROPERTIES L P	50 S JONES BLVD #100 LAS VEGAS NV 89107-2672	16312502010
B W PROPERTIES L P	50 S JONES BLVD #100 LAS VEGAS NV 89107-2672	16312502015
BANK U S NEVADA	%U S BANK CORPORATE PPTYS 2800 E LAKE ST LAKE0012 MINNEAPOLIS MN 55408-3116	16301708005
BECKER INVESTMENT COMPANY L P	50 S JONES BLVD #100 LAS VEGAS NV 89107-2672	16312502009
BECKER INVESTMENT COMPANY L P	50 S JONES BLVD #100 LAS VEGAS NV 89107-2672	16312502006
BECKER INVESTMENT COMPANY L P	50 S JONES BLVD #100 LAS VEGAS NV 89107-2672	16312502016
BECKER TRUST L L C	50 S JONES BLVD #101 LAS VEGAS NV 89107-2676	16312502005
BIEGGER JACK REVOCABLE LIVING TR	BIEGGER SHIRLEY TRS 20 WILD DUNES CT LAS VEGAS NV 89113-1332	16301803003
BREMONT SIMONE TRUST	BREMONT SIMONE TRS 2108 MISSION PEAK CIR LAS VEGAS NV 89146-0337	16301812016
BUILDERS ASSOCIATES #2	%LV ATHLETIC CLUBS 2655 S MARYLAND PKWY #201 LAS VEGAS NV 89109-1646	16301802010
CATTON LARRY D & BARBARA	%D REED 702 WILCLIFF PL MCPHERSON KS 67460-3612	16301812012
CENTRAL PARK APARTMENTS LLC ETAL	%H & L REALTY P O BOX 7440 LAS VEGAS NV 89125-7440	16301811059
CENTRAL PARK APARTMENTS LLC ETAL	%H & L REALTY P O BOX 7440 LAS VEGAS NV 89125-7440	16301811066
CENTRAL PARK APARTMENTS LLC ETAL	%H & L REALTY P O BOX 7440 LAS VEGAS NV 89125-7440	16301811072
CENTRAL PARK APARTMENTS LLC ETAL	%H & L REALTY P O BOX 7440 LAS VEGAS NV 89125-7440	16301811071
CENTRAL PARK APARTMENTS LLC ETAL	%H & L REALTY P O BOX 7440 LAS VEGAS NV 89125-7440	16301811070
CENTRAL PARK APARTMENTS LLC ETAL	%H & L REALTY P O BOX 7440 LAS VEGAS NV 89125-7440	16301811089
CENTRAL PARK APARTMENTS LLC ETAL	%H & L REALTY P O BOX 7440 LAS VEGAS NV 89125-7440	16301811068
CENTRAL PARK APARTMENTS LLC ETAL	%H & L REALTY P O BOX 7440 LAS VEGAS NV 89125-7440	16301811067
CENTRAL PARK APARTMENTS LLC ETAL	%H & L REALTY P O BOX 7440 LAS VEGAS NV 89125-7440	16301811065
CENTRAL PARK APARTMENTS LLC ETAL	%H & L REALTY P O BOX 7440 LAS VEGAS NV 89125-7440	16301811064
CENTRAL PARK APARTMENTS LLC ETAL	%H & L REALTY P O BOX 7440 LAS VEGAS NV 89125-7440	16301811063
CENTRAL PARK APARTMENTS LLC ETAL	%H & L REALTY P O BOX 7440 LAS VEGAS NV 89125-7440	16301811062
CENTRAL PARK APARTMENTS LLC ETAL	%H & L REALTY P O BOX 7440 LAS VEGAS NV 89125-7440	16301811074
CENTRAL PARK APARTMENTS LLC ETAL	%H & L REALTY P O BOX 7440 LAS VEGAS NV 89125-7440	16301811060
CENTRAL PARK APARTMENTS LLC ETAL	%H & L REALTY P O BOX 7440 LAS VEGAS NV 89125-7440	16301811081
CENTRAL PARK APARTMENTS LLC ETAL	%H & L REALTY P O BOX 7440 LAS VEGAS NV 89125-7440	16301811058
CENTRAL PARK APARTMENTS LLC ETAL	%H & L REALTY P O BOX 7440 LAS VEGAS NV 89125-7440	16301811061
CENTRAL PARK APARTMENTS LLC ETAL	%H & L REALTY P O BOX 7440 LAS VEGAS NV 89125-7440	16301811082
CENTRAL PARK APARTMENTS LLC ETAL	%H & L REALTY P O BOX 7440 LAS VEGAS NV 89125-7440	16301811090
CENTRAL PARK APARTMENTS LLC ETAL	%H & L REALTY P O BOX 7440 LAS VEGAS NV 89125-7440	16301811089
CENTRAL PARK APARTMENTS LLC ETAL	%H & L REALTY P O BOX 7440 LAS VEGAS NV 89125-7440	16301811088

Report of All Selected Parcels

Case Number: SDR-43737

Printed On: Thu: December 8, 2011

<u>Owner</u>	<u>Address</u>	<u>Parcel Number</u>
CENTRAL PARK APARTMENTS LLC ETAL	%H & L REALTY P O BOX 7440 LAS VEGAS NV 89125-7440	16301811087
CENTRAL PARK APARTMENTS LLC ETAL	%H & L REALTY P O BOX 7440 LAS VEGAS NV 89125-7440	16301811086
CENTRAL PARK APARTMENTS LLC ETAL	%H & L REALTY P O BOX 7440 LAS VEGAS NV 89125-7440	16301811085
CENTRAL PARK APARTMENTS LLC ETAL	%H & L REALTY P O BOX 7440 LAS VEGAS NV 89125-7440	16301811079
CENTRAL PARK APARTMENTS LLC ETAL	%H & L REALTY P O BOX 7440 LAS VEGAS NV 89125-7440	16301811083
CENTRAL PARK APARTMENTS LLC ETAL	%H & L REALTY P O BOX 7440 LAS VEGAS NV 89125-7440	16301811148
CENTRAL PARK APARTMENTS LLC ETAL	%H & L REALTY P O BOX 7440 LAS VEGAS NV 89125-7440	16301811050
CENTRAL PARK APARTMENTS LLC ETAL	%H & L REALTY P O BOX 7440 LAS VEGAS NV 89125-7440	16301811080
CENTRAL PARK APARTMENTS LLC ETAL	%H & L REALTY P O BOX 7440 LAS VEGAS NV 89125-7440	16301811057
CENTRAL PARK APARTMENTS LLC ETAL	%H & L REALTY P O BOX 7440 LAS VEGAS NV 89125-7440	16301811078
CENTRAL PARK APARTMENTS LLC ETAL	%H & L REALTY P O BOX 7440 LAS VEGAS NV 89125-7440	16301811077
CENTRAL PARK APARTMENTS LLC ETAL	%H & L REALTY P O BOX 7440 LAS VEGAS NV 89125-7440	16301811076
CENTRAL PARK APARTMENTS LLC ETAL	%H & L REALTY P O BOX 7440 LAS VEGAS NV 89125-7440	16301811084
CENTRAL PARK APARTMENTS LLC ETAL	%H & L REALTY P O BOX 7440 LAS VEGAS NV 89125-7440	16301811030
CENTRAL PARK APARTMENTS LLC ETAL	%H & L REALTY P O BOX 7440 LAS VEGAS NV 89125-7440	16301811052
CENTRAL PARK APARTMENTS LLC ETAL	%H & L REALTY P O BOX 7440 LAS VEGAS NV 89125-7440	16301811037
CENTRAL PARK APARTMENTS LLC ETAL	%H & L REALTY P O BOX 7440 LAS VEGAS NV 89125-7440	16301811036
CENTRAL PARK APARTMENTS LLC ETAL	%H & L REALTY P O BOX 7440 LAS VEGAS NV 89125-7440	16301811035
CENTRAL PARK APARTMENTS LLC ETAL	%H & L REALTY P O BOX 7440 LAS VEGAS NV 89125-7440	16301811034
CENTRAL PARK APARTMENTS LLC ETAL	%H & L REALTY P O BOX 7440 LAS VEGAS NV 89125-7440	16301811033
CENTRAL PARK APARTMENTS LLC ETAL	%H & L REALTY P O BOX 7440 LAS VEGAS NV 89125-7440	16301811039
CENTRAL PARK APARTMENTS LLC ETAL	%H & L REALTY P O BOX 7440 LAS VEGAS NV 89125-7440	16301811031
CENTRAL PARK APARTMENTS LLC ETAL	%H & L REALTY P O BOX 7440 LAS VEGAS NV 89125-7440	16301811040
CENTRAL PARK APARTMENTS LLC ETAL	%H & L REALTY P O BOX 7440 LAS VEGAS NV 89125-7440	16301811029
CENTRAL PARK APARTMENTS LLC ETAL	%H & L REALTY P O BOX 7440 LAS VEGAS NV 89125-7440	16301811028
CENTRAL PARK APARTMENTS LLC ETAL	%H & L REALTY P O BOX 7440 LAS VEGAS NV 89125-7440	16301811027
CENTRAL PARK APARTMENTS LLC ETAL	%H & L REALTY P O BOX 7440 LAS VEGAS NV 89125-7440	16301811026
CENTRAL PARK APARTMENTS LLC ETAL	%H & L REALTY P O BOX 7440 LAS VEGAS NV 89125-7440	16301811025
CENTRAL PARK APARTMENTS LLC ETAL	%H & L REALTY P O BOX 7440 LAS VEGAS NV 89125-7440	16301811024
CENTRAL PARK APARTMENTS LLC ETAL	%H & L REALTY P O BOX 7440 LAS VEGAS NV 89125-7440	16301811032
CENTRAL PARK APARTMENTS LLC ETAL	%H & L REALTY P O BOX 7440 LAS VEGAS NV 89125-7440	16301811047
CENTRAL PARK APARTMENTS LLC ETAL	%H & L REALTY P O BOX 7440 LAS VEGAS NV 89125-7440	16301811055

Report of All Selected Parcels**Case Number:** SDR-43737**Printed On:** Thu: December 8, 2011

<u>Owner</u>	<u>Address</u>	<u>Parcel Number</u>
CENTRAL PARK APARTMENTS LLC ETAL	%H & L REALTY P O BOX 7440 LAS VEGAS NV 89125-7440	16301811054
CENTRAL PARK APARTMENTS LLC ETAL	%H & L REALTY P O BOX 7440 LAS VEGAS NV 89125-7440	16301811053
CENTRAL PARK APARTMENTS LLC ETAL	%H & L REALTY P O BOX 7440 LAS VEGAS NV 89125-7440	16301811091
CENTRAL PARK APARTMENTS LLC ETAL	%H & L REALTY P O BOX 7440 LAS VEGAS NV 89125-7440	16301811051
CENTRAL PARK APARTMENTS LLC ETAL	%H & L REALTY P O BOX 7440 LAS VEGAS NV 89125-7440	16301811075
CENTRAL PARK APARTMENTS LLC ETAL	%H & L REALTY P O BOX 7440 LAS VEGAS NV 89125-7440	16301811038
CENTRAL PARK APARTMENTS LLC ETAL	%H & L REALTY P O BOX 7440 LAS VEGAS NV 89125-7440	16301811048
CENTRAL PARK APARTMENTS LLC ETAL	%H & L REALTY P O BOX 7440 LAS VEGAS NV 89125-7440	16301811056
CENTRAL PARK APARTMENTS LLC ETAL	%H & L REALTY P O BOX 7440 LAS VEGAS NV 89125-7440	16301811046
CENTRAL PARK APARTMENTS LLC ETAL	%H & L REALTY P O BOX 7440 LAS VEGAS NV 89125-7440	16301811045
CENTRAL PARK APARTMENTS LLC ETAL	%H & L REALTY P O BOX 7440 LAS VEGAS NV 89125-7440	16301811044
CENTRAL PARK APARTMENTS LLC ETAL	%H & L REALTY P O BOX 7440 LAS VEGAS NV 89125-7440	16301811043
CENTRAL PARK APARTMENTS LLC ETAL	%H & L REALTY P O BOX 7440 LAS VEGAS NV 89125-7440	16301811042
CENTRAL PARK APARTMENTS LLC ETAL	%H & L REALTY P O BOX 7440 LAS VEGAS NV 89125-7440	16301811041
CENTRAL PARK APARTMENTS LLC ETAL	%H & L REALTY P O BOX 7440 LAS VEGAS NV 89125-7440	16301811049
CENTRAL PARK APARTMENTS LLC ETAL	%H & L REALTY P O BOX 7440 LAS VEGAS NV 89125-7440	16301811134
CENTRAL PARK APARTMENTS LLC ETAL	%H & L REALTY P O BOX 7440 LAS VEGAS NV 89125-7440	16301811005
CENTRAL PARK APARTMENTS LLC ETAL	%H & L REALTY P O BOX 7440 LAS VEGAS NV 89125-7440	16301811073
CENTRAL PARK APARTMENTS LLC ETAL	%H & L REALTY P O BOX 7440 LAS VEGAS NV 89125-7440	16301811013
CENTRAL PARK APARTMENTS LLC ETAL	%H & L REALTY P O BOX 7440 LAS VEGAS NV 89125-7440	16301811092
CENTRAL PARK APARTMENTS LLC ETAL	%H & L REALTY P O BOX 7440 LAS VEGAS NV 89125-7440	16301811011
CENTRAL PARK APARTMENTS LLC ETAL	%H & L REALTY P O BOX 7440 LAS VEGAS NV 89125-7440	16301811010
CENTRAL PARK APARTMENTS LLC ETAL	%H & L REALTY P O BOX 7440 LAS VEGAS NV 89125-7440	16301811009
CENTRAL PARK APARTMENTS LLC ETAL	%H & L REALTY P O BOX 7440 LAS VEGAS NV 89125-7440	16301811136
CENTRAL PARK APARTMENTS LLC ETAL	%H & L REALTY P O BOX 7440 LAS VEGAS NV 89125-7440	16301811135
CENTRAL PARK APARTMENTS LLC ETAL	%H & L REALTY P O BOX 7440 LAS VEGAS NV 89125-7440	16301811137
CENTRAL PARK APARTMENTS LLC ETAL	%H & L REALTY P O BOX 7440 LAS VEGAS NV 89125-7440	16301811133
CENTRAL PARK APARTMENTS LLC ETAL	%H & L REALTY P O BOX 7440 LAS VEGAS NV 89125-7440	16301811132
CENTRAL PARK APARTMENTS LLC ETAL	%H & L REALTY P O BOX 7440 LAS VEGAS NV 89125-7440	16301811131
CENTRAL PARK APARTMENTS LLC ETAL	%H & L REALTY P O BOX 7440 LAS VEGAS NV 89125-7440	16301811130
CENTRAL PARK APARTMENTS LLC ETAL	%H & L REALTY P O BOX 7440 LAS VEGAS NV 89125-7440	16301811129
CENTRAL PARK APARTMENTS LLC ETAL	%H & L REALTY P O BOX 7440 LAS VEGAS NV 89125-7440	16301811128

Report of All Selected Parcels

Case Number: SDR-43737

Printed On: Thu: December 8, 2011

<u>Owner</u>	<u>Address</u>	<u>Parcel Number</u>
CENTRAL PARK APARTMENTS LLC ETAL	%H & L REALTY P O BOX 7440 LAS VEGAS NV 89125-7440	16301811007
CENTRAL PARK APARTMENTS LLC ETAL	%H & L REALTY P O BOX 7440 LAS VEGAS NV 89125-7440	16301811006
CENTRAL PARK APARTMENTS LLC ETAL	%H & L REALTY P O BOX 7440 LAS VEGAS NV 89125-7440	16301811008
CENTRAL PARK APARTMENTS LLC ETAL	%H & L REALTY P O BOX 7440 LAS VEGAS NV 89125-7440	16301811018
CENTRAL PARK APARTMENTS LLC ETAL	%H & L REALTY P O BOX 7440 LAS VEGAS NV 89125-7440	16301811147
CENTRAL PARK APARTMENTS LLC ETAL	%H & L REALTY P O BOX 7440 LAS VEGAS NV 89125-7440	16301811146
CENTRAL PARK APARTMENTS LLC ETAL	%H & L REALTY P O BOX 7440 LAS VEGAS NV 89125-7440	16301811145
CENTRAL PARK APARTMENTS LLC ETAL	%H & L REALTY P O BOX 7440 LAS VEGAS NV 89125-7440	16301811144
CENTRAL PARK APARTMENTS LLC ETAL	%H & L REALTY P O BOX 7440 LAS VEGAS NV 89125-7440	16301811023
CENTRAL PARK APARTMENTS LLC ETAL	%H & L REALTY P O BOX 7440 LAS VEGAS NV 89125-7440	16301811022
CENTRAL PARK APARTMENTS LLC ETAL	%H & L REALTY P O BOX 7440 LAS VEGAS NV 89125-7440	16301811021
CENTRAL PARK APARTMENTS LLC ETAL	%H & L REALTY P O BOX 7440 LAS VEGAS NV 89125-7440	16301811015
CENTRAL PARK APARTMENTS LLC ETAL	%H & L REALTY P O BOX 7440 LAS VEGAS NV 89125-7440	16301811019
CENTRAL PARK APARTMENTS LLC ETAL	%H & L REALTY P O BOX 7440 LAS VEGAS NV 89125-7440	16301811012
CENTRAL PARK APARTMENTS LLC ETAL	%H & L REALTY P O BOX 7440 LAS VEGAS NV 89125-7440	16301811017
CENTRAL PARK APARTMENTS LLC ETAL	%H & L REALTY P O BOX 7440 LAS VEGAS NV 89125-7440	16301811016
CENTRAL PARK APARTMENTS LLC ETAL	%H & L REALTY P O BOX 7440 LAS VEGAS NV 89125-7440	16301811143
CENTRAL PARK APARTMENTS LLC ETAL	%H & L REALTY P O BOX 7440 LAS VEGAS NV 89125-7440	16301811142
CENTRAL PARK APARTMENTS LLC ETAL	%H & L REALTY P O BOX 7440 LAS VEGAS NV 89125-7440	16301811141
CENTRAL PARK APARTMENTS LLC ETAL	%H & L REALTY P O BOX 7440 LAS VEGAS NV 89125-7440	16301811140
CENTRAL PARK APARTMENTS LLC ETAL	%H & L REALTY P O BOX 7440 LAS VEGAS NV 89125-7440	16301811139
CENTRAL PARK APARTMENTS LLC ETAL	%H & L REALTY P O BOX 7440 LAS VEGAS NV 89125-7440	16301811138
CENTRAL PARK APARTMENTS LLC ETAL	%H & L REALTY P O BOX 7440 LAS VEGAS NV 89125-7440	16301811020
CENTRAL PARK APARTMENTS LLC ETAL	%H & L REALTY P O BOX 7440 LAS VEGAS NV 89125-7440	16301811102
CENTRAL PARK APARTMENTS LLC ETAL	%H & L REALTY P O BOX 7440 LAS VEGAS NV 89125-7440	16301811110
CENTRAL PARK APARTMENTS LLC ETAL	%H & L REALTY P O BOX 7440 LAS VEGAS NV 89125-7440	16301811109
CENTRAL PARK APARTMENTS LLC ETAL	%H & L REALTY P O BOX 7440 LAS VEGAS NV 89125-7440	16301811004
CENTRAL PARK APARTMENTS LLC ETAL	%H & L REALTY P O BOX 7440 LAS VEGAS NV 89125-7440	16301811107
CENTRAL PARK APARTMENTS LLC ETAL	%H & L REALTY P O BOX 7440 LAS VEGAS NV 89125-7440	16301811098
CENTRAL PARK APARTMENTS LLC ETAL	%H & L REALTY P O BOX 7440 LAS VEGAS NV 89125-7440	16301811105
CENTRAL PARK APARTMENTS LLC ETAL	%H & L REALTY P O BOX 7440 LAS VEGAS NV 89125-7440	16301811104
CENTRAL PARK APARTMENTS LLC ETAL	%H & L REALTY P O BOX 7440 LAS VEGAS NV 89125-7440	16301811111

Report of All Selected Parcels**Case Number:** SDR-43737**Printed On:** Thu: December 8, 2011

<u>Owner</u>	<u>Address</u>	<u>Parcel Number</u>
CENTRAL PARK APARTMENTS LLC ETAL	%H & L REALTY P O BOX 7440 LAS VEGAS NV 89125-7440	16301811103
CENTRAL PARK APARTMENTS LLC ETAL	%H & L REALTY P O BOX 7440 LAS VEGAS NV 89125-7440	16301811108
CENTRAL PARK APARTMENTS LLC ETAL	%H & L REALTY P O BOX 7440 LAS VEGAS NV 89125-7440	16301811101
CENTRAL PARK APARTMENTS LLC ETAL	%H & L REALTY P O BOX 7440 LAS VEGAS NV 89125-7440	16301811093
CENTRAL PARK APARTMENTS LLC ETAL	%H & L REALTY P O BOX 7440 LAS VEGAS NV 89125-7440	16301811095
CENTRAL PARK APARTMENTS LLC ETAL	%H & L REALTY P O BOX 7440 LAS VEGAS NV 89125-7440	16301811014
CENTRAL PARK APARTMENTS LLC ETAL	%H & L REALTY P O BOX 7440 LAS VEGAS NV 89125-7440	16301811100
CENTRAL PARK APARTMENTS LLC ETAL	%H & L REALTY P O BOX 7440 LAS VEGAS NV 89125-7440	16301811096
CENTRAL PARK APARTMENTS LLC ETAL	%H & L REALTY P O BOX 7440 LAS VEGAS NV 89125-7440	16301811099
CENTRAL PARK APARTMENTS LLC ETAL	%H & L REALTY P O BOX 7440 LAS VEGAS NV 89125-7440	16301811097
CENTRAL PARK APARTMENTS LLC ETAL	%H & L REALTY P O BOX 7440 LAS VEGAS NV 89125-7440	16301811094
CENTRAL PARK APARTMENTS LLC ETAL	%H & L REALTY P O BOX 7440 LAS VEGAS NV 89125-7440	16301811122
CENTRAL PARK APARTMENTS LLC ETAL	%H & L REALTY P O BOX 7440 LAS VEGAS NV 89125-7440	16301811003
CENTRAL PARK APARTMENTS LLC ETAL	%H & L REALTY P O BOX 7440 LAS VEGAS NV 89125-7440	16301811001
CENTRAL PARK APARTMENTS LLC ETAL	%H & L REALTY P O BOX 7440 LAS VEGAS NV 89125-7440	16301811127
CENTRAL PARK APARTMENTS LLC ETAL	%H & L REALTY P O BOX 7440 LAS VEGAS NV 89125-7440	16301811126
CENTRAL PARK APARTMENTS LLC ETAL	%H & L REALTY P O BOX 7440 LAS VEGAS NV 89125-7440	16301811125
CENTRAL PARK APARTMENTS LLC ETAL	%H & L REALTY P O BOX 7440 LAS VEGAS NV 89125-7440	16301811106
CENTRAL PARK APARTMENTS LLC ETAL	%H & L REALTY P O BOX 7440 LAS VEGAS NV 89125-7440	16301811112
CENTRAL PARK APARTMENTS LLC ETAL	%H & L REALTY P O BOX 7440 LAS VEGAS NV 89125-7440	16301811002
CENTRAL PARK APARTMENTS LLC ETAL	%H & L REALTY P O BOX 7440 LAS VEGAS NV 89125-7440	16301811123
CENTRAL PARK APARTMENTS LLC ETAL	%H & L REALTY P O BOX 7440 LAS VEGAS NV 89125-7440	16301811121
CENTRAL PARK APARTMENTS LLC ETAL	%H & L REALTY P O BOX 7440 LAS VEGAS NV 89125-7440	16301811120
CENTRAL PARK APARTMENTS LLC ETAL	%H & L REALTY P O BOX 7440 LAS VEGAS NV 89125-7440	16301811119
CENTRAL PARK APARTMENTS LLC ETAL	%H & L REALTY P O BOX 7440 LAS VEGAS NV 89125-7440	16301811118
CENTRAL PARK APARTMENTS LLC ETAL	%H & L REALTY P O BOX 7440 LAS VEGAS NV 89125-7440	16301811117
CENTRAL PARK APARTMENTS LLC ETAL	%H & L REALTY P O BOX 7440 LAS VEGAS NV 89125-7440	16301811116
CENTRAL PARK APARTMENTS LLC ETAL	%H & L REALTY P O BOX 7440 LAS VEGAS NV 89125-7440	16301811115
CENTRAL PARK APARTMENTS LLC ETAL	%H & L REALTY P O BOX 7440 LAS VEGAS NV 89125-7440	16301811114
CENTRAL PARK APARTMENTS LLC ETAL	%H & L REALTY P O BOX 7440 LAS VEGAS NV 89125-7440	16301811113
CENTRAL PARK APARTMENTS LLC ETAL	%H & L REALTY P O BOX 7440 LAS VEGAS NV 89125-7440	16301811124
Condominium master parcel		16301811000

Report of All Selected Parcels**Case Number:** SDR-43737**Printed On:** Thu: December 8, 2011

<u>Owner</u>	<u>Address</u>	<u>Parcel Number</u>
DAVIS LISA A	2116 MISSION PEAK CIR LAS VEGAS NV 89146-0337	16301812014
DESERT DODGE INC	4701 W SAHARA AVE LAS VEGAS NV 89102-3511	16207101002
DESERT DODGE INC	4701 W SAHARA AVE LAS VEGAS NV 89102-3511	16207101003
E P DECATUR L P	%J SUSA 3275 S JONES BLVD LAS VEGAS NV 89146-6783	16301708002
E P DECATUR L P	%J SUSA 3275 S JONES BLVD LAS VEGAS NV 89146-6783	16301708001
FINDLAY FAMILY PROPERTIES L P	310 N GIBSON RD HENDERSON NV 89014-6702	16312501010
GUO ROBERT D ETAL	2120 MISSION PEAK CIR LAS VEGAS NV 89146-0337	16301812013
INTERNATIONAL INVEST & DEV CORP	%AUBURNDALE PPTYS 50 TICE BLVD WOODCLIFF LAKES NJ 07677-7654	16301803008
J R J PROPERTIES	4021 MEADOWS LN LAS VEGAS NV 89107-3117	16301803004
J R J PROPERTIES	4021 MEADOWS LN LAS VEGAS NV 89107-3117	16301803005
JANE KIM INVESTMENTS L L C	619 N WALDEN DR BEVERLY HILLS CA 90210-3108	16312502014
KOENIG PROPERTY HOLDINGS I L L C	9220 SUNDIAL DR LAS VEGAS NV 89134-8322	16312502013
KOROWICKI RICHARD & LOLA	2128 MISSION PEAK CIR LAS VEGAS NV 89146-0341	16301813002
LOSACCO LIVING TRUST	LOSACCO MICHAEL G & KAREN S TRS 2782 BOGUE CREEK DR HOWELL MI 48855-6836	16301813001
M L C F C 2006-4 SAHARA RETAIL	%LNR PTNRS LLC 1601 WASHINGTON AVE #700 MIAMI BEACH FL 33139-3165	16206401001
M L C F C 2006-4 SAHARA RETAIL	%LNR PTNRS LLC 1601 WASHINGTON AVE #700 MIAMI BEACH FL 33139-3165	16206402001
MARTINET VALERIE J	2112 MISSION PEAK CIR LAS VEGAS NV 89146-0337	16301812015
PARSA 5001 L L C	%M PARS A 3940 LAUREL CANYON BLVD #1142 STUDIO CITY CA 91604-3709	16301707004
PEBBLE COVE L L C	9179 W FLAMINGO RD #100 LAS VEGAS NV 89147-6462	16301707003
QUALITY PROPERTIES ASSET MGT CO	600 ANTON BLVD #100 COSTA MESA CA 92626-7194	16206301006
SAHARA PAVILION SOUTH S C L L C	%KIMCO REALTY CORP 3333 NEW HYDE PARK RD #100 NEW HYDE PARK NY 11042-1205	16207101001
SAHARA PAVILION SOUTH S C L L C	%KIMCO REALTY CORP 3333 NEW HYDE PARK RD #100 NEW HYDE PARK NY 11042-1205	16207101016
SCHOOL BOARD OF TRUSTEES	2832 E FLAMINGO AVE LAS VEGAS NV 89121-5205	16301803007
SHELTER COVE S P E CORP	7 CORPORATE PLAZA NEWPORT BEACH CA 92660-7904	16312502011
T A S HOLDING L P	2300 W SAHARA AVE #1110 BOX 16 LAS VEGAS NV 89102-4354	16312502002
T A S HOLDING L P	2300 W SAHARA AVE #1110 BOX 16 LAS VEGAS NV 89102-4354	16312502003
T A S HOLDING L P	2300 W SAHARA AVE #1110 BOX 16 LAS VEGAS NV 89102-4354	16312502001
T J PLAZA L L C	D S W C INC %S & S DEV 3275 S JONES BLVD LAS VEGAS NV 89146-6783	16301708004
T J PLAZA L L C	D S W C INC %S & S DEV 3275 S JONES BLVD LAS VEGAS NV 89146-6783	16301708003
TADJRISHI MEHDI MONSARED	2133 MISSION PEAK CIR LAS VEGAS NV 89146-0339	16301812009
TURNER TEODORA	2104 MISSION PEAK CIR LAS VEGAS NV 89146-0337	16301812017
USA POSTAL SERVICE	8055 E TUFTS AVE #400 DENVER CO 80237	16206301005

Report of All Selected Parcels

Case Number: SDR-43737

Printed On: Thu: December 8, 2011

Owner

VENTAS REALTY L P

WEDDINGTON FRED TRUST

Address

%NATL TAX SEARCH LLC 303 E WACKER DR #850 CHICAGO IL 60601-5201

BECKER MARY ELIZABETH TRS 50 S JONES BLVD #100 LAS VEGAS NV 89107-2672

Parcel Numbe

16301803006

16312502008