



Legal Notices Transmittal and Scanning Separator Sheet

Legal Notice Type: Legal Mailings

Date of Transfer to ERM: 9/8/2011

Page Count: 9

Meeting Date: 8/9/2011

Meeting Type: Planning Commission <=>

Case Number(s): SDR-42251 <=>

Subject of Affidavit: APPLICANT: CLARK COUNTY SCHOOL DISTRICT - OWNER: SCHOOL BOARD OF TRUSTEES <=>

Record Series: Legal Notices

LRDA Number: 2007-1717

Retention: Permanent

File By: Meeting Date



Prepared By: acrolli

Scanned By: _____

QC By: _____

SCANNED

SEP 12 2011

City of Las Vegas
Department of Planning
Development Services Center
333 North Rancho Drive, 3rd Floor
Las Vegas, Nevada 89106

Return Service Requested
Official Notice of Public Hearing

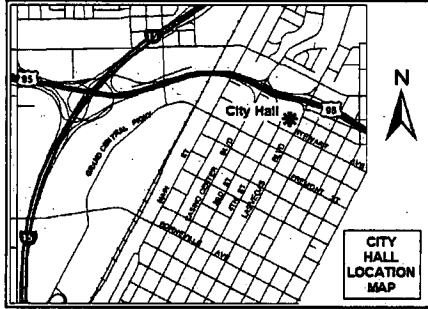

If you wish to file your protest or support on this request, check the appropriate box below and return this card in an envelope with postage to the Department of Planning, Case Planning Division at the address listed above or fax this side of this card to (702) 385-7268. If you would like to contact your Council Representative, please call (702) 229-6405.

I SUPPORT
this Request

I OPPOSE
this Request

Please use available blank space on card for your comments.

SDR-42251

Planning Commission Meeting of 8/9/2011

Application Information

SDR-42251 - SITE DEVELOPMENT PLAN REVIEW - PUBLIC HEARING - APPLICANT: CLARK COUNTY SCHOOL DISTRICT - OWNER: SCHOOL BOARD OF TRUSTEES - For possible action on a request for a Site Development Plan Review FOR A PROPOSED 79,513 SQUARE-FOOT PUBLIC SCHOOL (K-12) on 11.7 acres at 2800 Stewart Avenue (APN 139-36-303-001), C-V (Civic) Zone, Ward 3 (Coffin).

Application Location

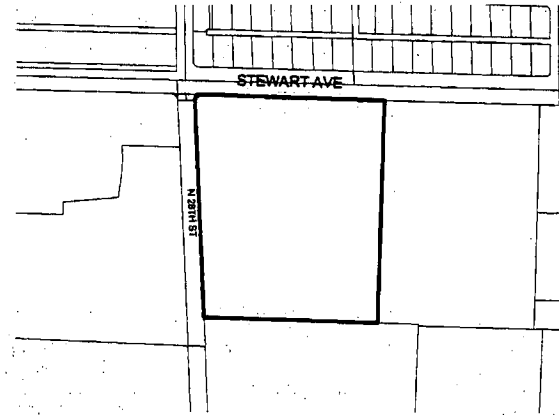

The proposed project may not pertain to the entire highlighted project site.

Public Hearing Information

Meeting: Planning Commission
Date: *August 09, 2011*
Time: 6:00 P.M.
Location: City Council Chambers
400 Stewart Avenue
Las Vegas, Nevada

Any and all interested persons may appear before the City Planning Commission either in person or by representative and object to or express approval of this request, or may, prior to this meeting, file a written objection thereto or approval thereof with the Department of Planning, Case Planning Division, Development Services Center, 333 North Rancho Drive, 3rd Floor, Las Vegas, Nevada 89106. Final Action on General Plan Amendments and Rezonings will be determined by the City Council. Other public hearing items may be deemed Final Action by the Planning Commission or forwarded to the City Council. The date of the City Council meeting, if applicable, will be announced at the Planning Commission meeting after the discussion of the item. For further information, including the full staff report, please call (702) 229-6301 (TDD 386-9108) or go to <http://www.lasvegasnevada.gov>.

P/L 177/93

Report of All Selected Parcels

Case Number: SDR-42251

Printed On: Wed: July 20, 2011

<u>Owner</u>	<u>Address</u>	<u>Parcel Number</u>
AHMED MOHAMED ETAL	P O BOX 1945 LA JOLLA CA 92038-1945	13927410000
B J P INVESTMENTS L L C	30 SAWGRASS CT LAS VEGAS NV 89113-1324	13934210025
BAERG FAMILY TRUST	BAERG WILLIAM & MARTHA HELEN TRS 3386 SAINT MICHAEL DR PALO ALTO CA 94306-3057	13934111012
BANK NEW YORK MELLON TR CO TRS	%LEVY SMALL & LALLAS 815 MORAGA DR LOS ANGELES CA 90049-1633	13934111009
C VERAPAPPA W W L L C	513 S MAIN ST LAS VEGAS NV 89101-6319	13934302003
CALIFORNIA HOTEL & CASINO	%BOYD GAMING 6465 S RAINBOW BLVD LAS VEGAS NV 89118-3215	13934210016
CALIFORNIA HOTEL & CASINO	%BOYD GAMING 6465 S RAINBOW BLVD LAS VEGAS NV 89118-3215	13927402009
CALIFORNIA HOTEL & CASINO	%BOYD GAMING 6465 S RAINBOW BLVD LAS VEGAS NV 89118-3215	13934111002
CITY OF LAS VEGAS	%OFFICE DF BUSINESS DEVELOPMENT 400 STEWART AVE 2ND FLOOR LAS VEGAS NV 89101-2913	13934111001
CITY OF LAS VEGAS	400 STEWART AVE 2ND FLR LAS VEGAS NV 89101-2913	13933610026
CITY OF LAS VEGAS REDEVELOPMENT	FREMONT EXPERIENCE L L C %FINANCE DEPT 425 FREMONT ST LAS VEGAS NV 89101-5620	13934201023
CITY PARKWAY IV A INC	%OFFICE BUSINESS PARKING 1 INC 400 STEWART AVE LAS VEGAS NV 89101-2913	13934111064
CITY PARKWAY IV A INC	%OFFICE BUSINESS DEV 400 STEWART AVE 2ND FLR LAS VEGAS NV 89101-2913	13934110011
CITY PARKWAY IV A INC	%CITY OF LAS VEGAS %BUS DEV 400 STEWART AVE 2ND FLOOR LAS VEGAS NV 89101-2913	13927401031
CITY PARKWAY V INC	%CITY OF LV %CITY ATTORNEYS OFFICE 400 STEWART AVE 9TH FLOOR LAS VEGAS NV 89101-2913	13934110005
CITY PARKWAY V INC	%CITY OF LV %CITY ATTORNEYS OFFICE 400 STEWART AVE 9TH FLOOR LAS VEGAS NV 89101-2913	13934110007
CITY PARKWAY V INC	%CITY OF LV %CITY ATTORNEYS OFFICE 400 STEWART AVE 9TH FLOOR LAS VEGAS NV 89101-2913	13933610025
CITY PARKWAY V INC	%CITY OF LV %CITY ATTORNEYS OFFICE 400 STEWART AVE 9TH FLOOR LAS VEGAS NV 89101-2913	13934110009
CITY PARKWAY V INC	%CITY OF LV %CITY ATTORNEYS OFFICE 400 STEWART AVE 9TH FLOOR LAS VEGAS NV 89101-2913	13933511008
CITY PARKWAY V INC	%CITY OF LV %CITY ATTORNEYS OFFICE 400 STEWART AVE 9TH FLOOR LAS VEGAS NV 89101-2913	13933610027
CITY PARKWAY V INC	%CITY OF LV %CITY ATTORNEYS OFFICE 400 STEWART AVE 9TH FLOOR LAS VEGAS NV 89101-2913	13934211001
CITY PARKWAY V INC	%CITY OF LV %CITY ATTORNEYS OFFICE 400 STEWART AVE 9TH FLOOR LAS VEGAS NV 89101-2913	13934110008
CITY PARKWAY V INC	%CITY OF LV %CITY ATTORNEYS OFFICE 400 STEWART AVE 9TH FLOOR LAS VEGAS NV 89101-2913	13934211002
COSMAN CHARLES F	COSMAN ELLIOTT 3805 APACHE LN LAS VEGAS NV 89107-2006	13934302005
COUNTY OF CLARK(ADMINISTRATIVE)	COUNTY OF CLARK(METRO)LEASE 500 S GRAND CENTRAL PKWY LAS VEGAS NV 89155	13934210033
COUNTY OF CLARK(ADMINISTRATIVE)	500 S GRAND CENTRAL PKWY LAS VEGAS NV 89155	13933710002

Report of All Selected Parcels

Case Number: SDR-42251

Printed On: Wed: July 20, 2011

<u>Owner</u>	<u>Address</u>	<u>Parcel Number</u>
COUNTY OF CLARK(RPM)	COUNTY OF CLARK(METRO)LEASE 500 S GRAND CENTRAL PKWY LAS VEGAS NV 89155	13934210038
COUNTY OF CLARK(RPM)	COUNTY OF CLARK(METRO)LEASE 500 S GRAND CENTRAL PKWY LAS VEGAS NV 89155	13934210037
COUNTY OF CLARK(RPM)	500 S GRAND CENTRAL PKWY LAS VEGAS NV 89155	13934210035
COUNTY OF CLARK(RPM)	COUNTY OF CLARK(METRO)LEASE 500 S GRAND CENTRAL PKWY LAS VEGAS NV 89155	13934210036
COUNTY OF CLARK(RPM)	COUNTY OF CLARK(METRO)LEASE 500 S GRAND CENTRAL PKWY LAS VEGAS NV 89155	13934210034
DECARO RUSSIANO	710 S 1ST ST LAS VEGAS NV 89101-6411	13934310016
DECARO RUSSIANO	710 S 1ST ST LAS VEGAS NV 89101-6411	13934310017
DOWNEY NANCY L	P O BOX 585 GENOA NV 89411-0585	13934111010
DOWNEY NANCY L	P O BOX 585 GENOA NV 89411-0585	13934111005
DUBOVIK WILLIE & NATALIE	708 S FIRST ST LAS VEGAS NV 89101-6411	13934310018
DUBOVIK WILLIE & NATALIE	708 S FIRST ST LAS VEGAS NV 89101-6411	13934310019
ENOMOTO JOHN Y ETAL	2035 HEATHER DR MONTEREY PARK CA 91755-6719	13934311004
F C L W VEGAS L L C	L W T I C SUCCESSOR L L C %FOREST CITY ENTPRS/DIRECTOR TAX 50 PUBLIC SQ TERMINAL TOWER #1410 CLEVELAND OH 44113-2202	13934311010
F C L W VEGAS L L C	L W T I C SUCCESSOR L L C %FOREST CITY ENTPRS/DIRECTOR TAX 50 PUBLIC SQ TERMINAL TOWER #1410 CLEVELAND OH 44113-2202	13934311026
F C L W VEGAS L L C	L W T I C SUCCESSOR L L C %FOREST CITY ENTPRS/DIRECTOR TAX 50 PUBLIC SQ TERMINAL TOWER #1410 CLEVELAND OH 44113-2202	13934210018
F C L W VEGAS L L C	L W T I C SUCCESSOR L L C %FOREST CITY ENTPRS/DIRECTOR TAX 50 PUBLIC SQ TERMINAL TOWER #1410 CLEVELAND OH 44113-2202	13934311030
F C L W VEGAS L L C	L W T I C SUCCESSOR L L C %FOREST CITY ENTPRS/DIRECTOR TAX 50 PUBLIC SQ TERMINAL TOWER #1410 CLEVELAND OH 44113-2202	13934311023
F C L W VEGAS L L C	L W T I C SUCCESSOR L L C %FOREST CITY ENTPRS/DIRECTOR TAX 50 PUBLIC SQ TERMINAL TOWER #1410 CLEVELAND OH 44113-2202	13934311013
F C L W VEGAS L L C	L W T I C SUCCESSOR L L C %FOREST CITY ENTPRS/DIRECTOR TAX 50 PUBLIC SQ TERMINAL TOWER #1410 CLEVELAND OH 44113-2202	13934311018
F C L W VEGAS L L C	L W T I C SUCCESSOR L L C %FOREST CITY ENTPRS/DIRECTOR TAX 50 PUBLIC SQ TERMINAL TOWER #1410 CLEVELAND OH 44113-2202	13934311022
F C L W VEGAS L L C	L W T I C SUCCESSOR L L C %FOREST CITY ENTPRS/DIRECTOR TAX 50 PUBLIC SQ TERMINAL TOWER #1410 CLEVELAND OH 44113-2202	13934311029
F C L W VEGAS L L C	L W T I C SUCCESSOR L L C %FOREST CITY ENTPRS/DIRECTOR TAX 50 PUBLIC SQ TERMINAL TOWER #1410 CLEVELAND OH 44113-2202	13934311001
F C L W VEGAS L L C	L W T I C SUCCESSOR L L C %FOREST CITY ENTPRS/DIRECTOR TAX 50 PUBLIC SQ TERMINAL TOWER #1410 CLEVELAND OH 44113-2202	13934311019
F C L W VEGAS L L C	L W T I C SUCCESSOR L L C %FOREST CITY ENTPRS/DIRECTOR TAX 50 PUBLIC SQ TERMINAL TOWER #1410 CLEVELAND OH 44113-2202	13934210017

Report of All Selected Parcels**Case Number:** SDR-42251**Printed On:** Wed: July 20, 2011

<u>Owner</u>	<u>Address</u>	<u>Parcel Number</u>
F C L W VEGAS L L C	L W T I C SUCCESSOR L L C %FOREST CITY ENTPRS/DIRECTOR TAX 50 PUBLIC SQ TERMINAL TOWER #1410 CLEVELAND OH 44113-2202	13934311028
F C L W VEGAS L L C	L W T I C SUCCESSOR L L C %FOREST CITY ENTPRS/DIRECTOR TAX 50 PUBLIC SQ TERMINAL TOWER #1410 CLEVELAND OH 44113-2202	13934311025
F C L W VEGAS L L C	L W T I C SUCCESSOR L L C %FOREST CITY ENTPRS/DIRECTOR TAX 50 PUBLIC SQ TERMINAL TOWER #1410 CLEVELAND OH 44113-2202	13934311009
F C L W VEGAS L L C	L W T I C SUCCESSOR L L C %FOREST CITY ENTPRS/DIRECTOR TAX 50 PUBLIC SQ TERMINAL TOWER #1410 CLEVELAND OH 44113-2202	13934311021
F C L W VEGAS L L C	L W T I C SUCCESSOR L L C %FOREST CITY ENTPRS/DIRECTOR TAX 50 PUBLIC SQ TERMINAL TOWER #1410 CLEVELAND OH 44113-2202	13934311007
F C L W VEGAS L L C	L W T I C SUCCESSOR L L C %FOREST CITY ENTPRS/DIRECTOR TAX 50 PUBLIC SQ TERMINAL TOWER #1410 CLEVELAND OH 44113-2202	13934311016
F C L W VEGAS L L C	L W T I C SUCCESSOR L L C %FOREST CITY ENTPRS/DIRECTOR TAX 50 PUBLIC SQ TERMINAL TOWER #1410 CLEVELAND OH 44113-2202	13934311015
F C L W VEGAS L L C	L W T I C SUCCESSOR L L C %FOREST CITY ENTPRS/DIRECTOR TAX 50 PUBLIC SQ TERMINAL TOWER #1410 CLEVELAND OH 44113-2202	13934311020
F C L W VEGAS L L C	L W T I C SUCCESSOR L L C %FOREST CITY ENTPRS/DIRECTOR TAX 50 PUBLIC SQ TERMINAL TOWER #1410 CLEVELAND OH 44113-2202	13934210015
F C L W VEGAS L L C	L W T I C SUCCESSOR L L C %FOREST CITY ENTPRS/DIRECTOR TAX 50 PUBLIC SQ TERMINAL TOWER #1410 CLEVELAND OH 44113-2202	13934311031
F C L W VEGAS L L C	L W T I C SUCCESSOR L L C %FOREST CITY ENTPRS/DIRECTOR TAX 50 PUBLIC SQ TERMINAL TOWER #1410 CLEVELAND OH 44113-2202	13934311003
F C L W VEGAS L L C	L W T I C SUCCESSOR L L C %FOREST CITY ENTPRS/DIRECTOR TAX 50 PUBLIC SQ TERMINAL TOWER #1410 CLEVELAND OH 44113-2202	13934311011
F C L W VEGAS L L C	L W T I C SUCCESSOR L L C %FOREST CITY ENTPRS/DIRECTOR TAX 50 PUBLIC SQ TERMINAL TOWER #1410 CLEVELAND OH 44113-2202	13934311002
F C L W VEGAS L L C	L W T I C SUCCESSOR L L C %FOREST CITY ENTPRS/DIRECTOR TAX 50 PUBLIC SQ TERMINAL TOWER #1410 CLEVELAND OH 44113-2202	13934210014
F C L W VEGAS L L C	L W T I C SUCCESSOR L L C %FOREST CITY ENTPRS/DIRECTOR TAX 50 PUBLIC SQ TERMINAL TOWER #1410 CLEVELAND OH 44113-2202	13934311008
F C L W VEGAS L L C	L W T I C SUCCESSOR L L C %FOREST CITY ENTPRS/DIRECTOR TAX 50 PUBLIC SQ TERMINAL TOWER #1410 CLEVELAND OH 44113-2202	13934311014
F C L W VEGAS L L C	L W T I C SUCCESSOR L L C %FOREST CITY ENTPRS/DIRECTOR TAX 50 PUBLIC SQ TERMINAL TOWER #1410 CLEVELAND OH 44113-2202	13934311012
F C L W VEGAS L L C	L W T I C SUCCESSOR L L C %FOREST CITY ENTPRS/DIRECTOR TAX 50 PUBLIC SQ TERMINAL TOWER #1410 CLEVELAND OH 44113-2202	13934311027
F C L W VEGAS L L C	L W T I C SUCCESSOR L L C %FOREST CITY ENTPRS/DIRECTOR TAX 50 PUBLIC SQ TERMINAL TOWER #1410 CLEVELAND OH 44113-2202	13934311017
F C R T C 20 L L C ETAL	REGIONAL TRANSPORTATION LEASE %FINANCE 600 GRAND CENTRAL PKWY #350 LAS VEGAS NV 89106-4512	13934301008

Report of All Selected Parcels**Case Number:** SDR-42251**Printed On:** Wed: July 20, 2011

<u>Owner</u>	<u>Address</u>	<u>Parcel Number</u>
F D G-GRAND CENTRAL L L C	%J FINE 3883 HOWARD HUGHES PKWY #800 LAS VEGAS NV 89169-0965	13933710004
G N L V CORP	129 E FREMONT ST LAS VEGAS NV 89101-5603	13934111069
G N L V CORP	P O BOX 610 LAS VEGAS NV 89125-0610	13934210032
G N L V CORP	P O BOX 610 LAS VEGAS NV 89125-0610	13934210031
G N L V CORP	129 E FREMONT ST LAS VEGAS NV 89101-5603	13934111040
GHELFI SOPHIA ANN INCOME TR ETAL	BRANDENBURG MARCUS TRS ETAL 1 FREMONT ST LAS VEGAS NV 89101-5601	13934111048
GHELFI SOPHIA ANN INCOME TRUST	DESERT ROCK GOLDEN GATE L L C 1 FREMONT ST LAS VEGAS NV 89101-5601	13934111045
GHELFI SOPHIA ANN INCOME TRUST	DESERT ROCK/GOLDEN GATE L L C 1 FREMONT ST LAS VEGAS NV 89101-5601	13934111046
GRANITE PROPERTIES I L L C	111 NORTH 1ST ST LAS VEGAS NV 89101-2912	13934111031
GRANITE PROPERTIES IA L L C	SNYDER EARL LEASE 111 N 1ST ST LAS VEGAS NV 89101-2912	13934111027
GRANITE PROPERTIES II L L C	%GRANITE GAMING GROUP LLC 111 NORTH FIRST ST LAS VEGAS NV 89101-2912	13934111029
GRANITE PROPERTIES II L L C	111 N FIRST ST LAS VEGAS NV 89101-2912	13934111030
GRANITE PROPERTIES IV L L C	%S BURNSTINE 111 N 1ST ST LAS VEGAS NV 89101-2912	13934111032
HAM VICKI ETAL	9009 ROBINSON RIDGE DR LAS VEGAS NV 89117-5424	13934311005
HAM VICKI ETAL	9009 ROBINSON RIDGE DR LAS VEGAS NV 89117-5424	13934311006
HERBST JERRY	P O BOX 93417 LAS VEGAS NV 89193-3417	13934210024
HERBST JERRY E	P O BOX 93417 LAS VEGAS NV 89193-3417	13934210006
JORAI ENTPRS	RAIZIN LEONARD & CAROL TRS 2 THAYNES CANYON WY PARK CITY UT 84060-7237	13934111011
KEEP MEMORY ALIVE	%PRESIDENT 9101 W SAHARA AVE LAS VEGAS NV 89117-5772	13933610024
KONG IVAN F S & LILY L	1630 KALAKAUA AVE HONOLULU HI 96826-2496	13934210028
KONG IVAN F S & LILY L	1630 KALAKAUA AVE HONOLULU HI 96826-2496	13934210027
L G E INC	1510 W LOOP SOUTH HOUSTON TX 77027-9505	13934111042
L G E INC	1510 W LOOP SOUTH HOUSTON TX 77027-9505	13934111044
L G E INC	1510 W LOOP SOUTH HOUSTON TX 77027-9505	13934111043
LAMB RICHARD P ETAL	%J MARSHALL 301 S MAIN ST LAS VEGAS NV 89101-6316	13934210002
L'CHAIM 24 FREMONT PPTY L L C	24 FREMONT ST LAS VEGAS NV 89101-5601	13934111028
LONGLEY CONSTRUCTION CO INC	P O BOX 1960 LAS VEGAS NV 89125-1960	13927401021
M B LAND L L C	901 N GREEN VALLEY PKWY #200 HENDERSON NV 89074-7105	13934302007
M S W INC	%BOYD GAMING 6465 S RAINBOW BLVD LAS VEGAS NV 89118-3215	13927402008
M S W INC	%BOYD GAMING 6465 S RAINBOW BLVD LAS VEGAS NV 89118-3215	13927402006
M S W INC	%BOYD GAMING 6465 S RAINBOW BLVD LAS VEGAS NV 89118-3215	13934101003
M S W INC	%BOYD GAMING 6465 S RAINBOW BLVD LAS VEGAS NV 89118-3215	13927402007

Report of All Selected Parcels**Case Number:** SDR-42251**Printed On:** Wed: July 20, 2011

<u>Owner</u>	<u>Address</u>	<u>Parcel Number</u>
M S W INC	%BOYD GAMING 6465 S RAINBOW BLVD LAS VEGAS NV 89118-3215	13934101010
MARYMARSH L L C	P O BOX 3390 LAKE TAHOE NV 89449-3390	13934111008
MAXIE L L C	%C BYRD 1061 E 1720 S ST GEORGE UT 84790-2268	13934302004
MESQUITE PARTNERS LTD	716 W MESQUITE AVE LAS VEGAS NV 89106-4612	13927401005
MESQUITE PARTNERS LTD	716 W MESQUITE AVE LAS VEGAS NV 89106-4612	13927401004
MESQUITE PARTNERS LTD	716 W MESQUITE AVE LAS VEGAS NV 89106-4612	13928802001
MESQUITE500 L L C	716 W MESQUITE AVE LAS VEGAS NV 89106-4612	13927401020
MESQUITE500 L L C	716 W MESQUITE AVE LAS VEGAS NV 89106-4612	13927401019
MESQUITWOOD L L C	8741 NEWPORT ISLE CT LAS VEGAS NV 89117-2268	13927401023
MILLER RALPH W JR	MILLER TRUST 4437 ANNETTE PARK DR BOZEMAN MT 59715-9273	13934111006
NEVADA POWER COMPANY	%LAND SERV STA #9 P O BOX 98910 LAS VEGAS NV 89193-8910	13934310001
NEVADA POWER COMPANY	%LAND SERV STA #9 P O BOX 98910 LAS VEGAS NV 89193-8910	13934210005
NEVADA POWER COMPANY	%LAND SERV STA #9 P O BOX 98910 LAS VEGAS NV 89193-8910	13934310002
NEVADA READY MIX CORPORATION	151 CASSIA WY HENDERSON NV 89014-6616	13927401007
NEVADA READY MIX CORPORATION	151 CASSIA WY HENDERSON NV 89014-6616	13927401006
OAKBROOK REALTY & INVEST II LLC	1000 ROYCE BLVD OAKBROOK IL 60181-4809	13934210004
OAKBROOK REALTY & INVEST II LLC	1000 ROYCE BLVD OAKBROOK IL 60181-4809	13934210003
OCCIDENTAL COLLEGE	%BOYD GAMING-TAX DEPT 6465 S RAINBOW BLVD LAS VEGAS NV 89118-3215	13934111007
OFFICE DISTRICT PARKING I INC	%OFFICE BUSINESS DEV 400 STEWART AVE 2ND FLR LAS VEGAS NV 89101-2913	13934110010
P H G S A L L C	100 N CITY PKWY #1700 LAS VEGAS NV 89106-4614	13927410011
P Q LAS VEGAS L L C	%FOREST CITY ENTPRS INC %REAL ESTATE TAX DEPT P O BOX 94877 CLEVELAND OH 44101-4877	13934201022
PARKWAY CENTER L L C	100 N CITY PKWY #1700 LAS VEGAS NV 89106-4614	13927410016
PARKWAY CENTER L L C	100 N CITY PKWY #1700 LAS VEGAS NV 89106-4614	13927410013
PARKWAY CENTER L L C	100 N CITY PKWY #1700 LAS VEGAS NV 89106-4614	13927410015
PETITTI CARRIE ETAL	460 MAGNOLIA DR CRESWELL OR 97426-9473	13934111041
R & S P FAMILY TRUST ETAL	PECCOLE ROBERT N JR TRS 8689 W CHARLESTON BLVD #109 LAS VEGAS NV 89117-5485	13934111003
R & S P FAMILY TRUST ETAL	PECCOLE ROBERT N JR TRS 8689 W CHARLESTON BLVD #109 LAS VEGAS NV 89117-5485	13934111004
REGIONAL TRANSPORTATION COMM	600 S GRAND CENTRAL PKWY #350 LAS VEGAS NV 89106-4512	13933801019
REGIONAL TRANSPORTATION COMM	600 S GRAND CENTRAL PKWY #350 LAS VEGAS NV 89106-4512	13934302006
RUNNELLS RANDAL LEE L L C	679 CORAL VIEW ST LAS VEGAS NV 89110-4046	13933703001
S M K INC	766 POHUKANA ST HONOLULU HI 96813-5307	13934111037

Report of All Selected Parcels

Case Number: SDR-42251

Printed On: Wed: July 20, 2011

<u>Owner</u>	<u>Address</u>	<u>Parcel Number</u>
SAGE REALTY CO	SPEAKEASY GAMING FREMONT-IMPS 128 EAST FREMONT ST LAS VEGAS NV 89101-5604	13934111025
SAL SAGEV HOTEL CO INC	1 FREMONT ST LAS VEGAS NV 89101-5601	13934111034
SCHIFF ABRAHAM	1004 NEW RD NORTHFIELD NJ 08225-1661	13934111067
SCHIFF ENTERPRISES	1004 NEW ROAD NORTHFIELD NJ 08225-1661	13934111036
SIMON CHELSEA L V DEV L L C	%CPG PTNRS LP P O BOX 6120 INDIANAPOLIS IN 46206-6120	13933710003
SOUTHERN NEVADA WATER AUTHORITY	%LAND ACQUISITION & MGT MS 95 P O BOX 99956 LAS VEGAS NV 89193-9956	13927410014
STATE OF NEVADA TRANS LEASOR	M S W INC LEASE %BOYD GAMING-TAX DEPT 6465 S RAINBOW BLVD LAS VEGAS NV 89118-3215	13927402005
STAUFFER FAMILY TRUST ETAL	STAUFFER DARLENE J TRS 128 E FREMONT ST LAS VEGAS NV 89101-5604	13934111023
STOCKER HAROLD J & MAYME V TR	BANK FIRST INTERSTATE TRS %H PASTOR CASINO 115 N 1ST ST LAS VEGAS NV 89101-2912	13934111035
SUMMIT ONE NETWORK INC	%TAX DEPT 1510 W LOOP S HOUSTON TX 77027-9505	13934210001
SUMMIT ONE NETWORK INC	%LANDRYS RESTAURANTS INC %TAX DEPT 1510 W LOOP S HOUSTON TX 77027-9505	13934210029
SUMMIT ONE NETWORK INC	%LANDRYS RESTAURANTS INC %TAX DEPT 1510 W LOOP S HOUSTON TX 77027-9505	13934210030
SYMPHONY PARK MASTER ASSN INC	%S GLADSTEIN 6130 ELTON AVE #212 LAS VEGAS NV 89107-2538	13933511010
SYMPHONY PARK MASTER ASSN INC	%S GLADSTEIN 6130 ELTON AVE #212 LAS VEGAS NV 89107-2538	13933511009
T BROTHERS PROPERTIES L L C	4325 W PATRICK #120 LAS VEGAS NV 89118-6864	13927401022
T-L V C R L L C	1 MAIN ST LAS VEGAS NV 89101-6370	13934111033
T-Q H R L L C	% BARRICK GAMING 1 MAIN ST LAS VEGAS NV 89101-6370	13934210026
T-U P R L L C	1 MAIN ST LAS VEGAS NV 89101-6370	13934101009
T-U P R L L C	1 MAIN ST LAS VEGAS NV 89101-6370	13934201016
T-U P R L L C	1 MAIN ST LAS VEGAS NV 89101-6370	13934101005
T-U P R L L C	1 MAIN ST LAS VEGAS NV 89101-6370	13934101004
T-U P R L L C	1 MAIN ST LAS VEGAS NV 89101-6370	13934101007
T-U P R L L C	%MARVIN F POER & CO P O BOX 52427 ATLANTA GA 30355-0427	13934101008
T-U P R L L C	1 MAIN ST LAS VEGAS NV 89101-6370	13934201007
T-U P R L L C	1 MAIN ST LAS VEGAS NV 89101-6370	13934201003
T-U P R L L C	1 MAIN ST LAS VEGAS NV 89101-6370	13934101006
UNION PACIFIC RAILROAD COMPANY	%PPTY TAX 1400 DOUGLAS STOP 1640 OMAHA NE 68179-0001	13927401030
UNION PACIFIC RAILROAD COMPANY	%PPTY TAX 1400 DOUGLAS STOP 1640 OMAHA NE 68179-0001	13934302008
UNION PACIFIC RAILROAD COMPANY	%PPTY TAX 1400 DOUGLAS STOP 1640 OMAHA NE 68179-0001	13934310004
UNION PACIFIC RAILROAD COMPANY	%PPTY TAX 1400 DOUGLAS STOP 1640 OMAHA NE 68179-0001	13927401027
UNION PACIFIC RAILROAD COMPANY	%PPTY TAX 1400 DOUGLAS STOP 1640 OMAHA NE 68179-0001	13933703003

Report of All Selected Parcels**Case Number:** SDR-42251**Printed On:** Wed: July 20, 2011

<u>Owner</u>	<u>Address</u>	<u>Parcel Number</u>
UNION PACIFIC RAILROAD COMPANY	%PPTY TAX 1400 DOUGLAS STOP 1640 OMAHA NE 68179-0001	13927401032
UNION PACIFIC RAILROAD COMPANY	%PPTY TAX 1400 DOUGLAS STOP 1640 OMAHA NE 68179-0001	139341101002
VINTAGE VEGAS GAMING INC	%R SZEPELAK 128 E FREMONT ST LAS VEGAS NV 89101-5604	13934111022
VINTAGE VEGAS GAMING INC	%CHIEF OPERATING OFFICER 128 E FREMONT ST LAS VEGAS NV 89101-5604	13934111024
W M C II ASSOCIATES L L C	%WORLD MARKET CTR LV %DIRECTOR ADMIN 495 S GRAND CENTRAL PKWY LAS VEGAS NV 89106-4555	13933511012
W M C II ASSOCIATES L L C	%WORLD MARKET CTR LV %DIRECTOR FIN 495 S GRAND CENTRAL PKWY #2203 LAS VEGAS NV 89106-4555	13933511011
W M C III ASSOCIATES L L C	%J KASHANI 350 S BEVERLY DR #330 BEVERLY HILLS CA 90212-4817	13933511004
W M C III ASSOCIATES L L C	%J KASHANI 350 S BEVERLY DR #330 BEVERLY HILLS CA 90212-4817	13927410005
W M C V PHASE 2 L L C	%WORLD MARKET CTR %DIRECTOR OF ADMIN 495 S GRAND CENTRAL PKWY LAS VEGAS NV 89106-4555	13933610014
W M C V PHASE 3 L L C	%WORLD MARKET CTR %DIRECTOR OF FINANCE 495 S GRAND CENTRAL PKWY #2203 LAS VEGAS NV 89106-4555	13933610022
W M C V PHASE I L L C	%WORLD MARKET CTR %DIRECTOR OF ADMIN 495 S GRAND CENTRAL PKWY LAS VEGAS NV 89106-4555	13933610023
WEST MAIN & BONNEVILLE L P	10525 VISTA SORRENTO PKWY #110 SAN DIEGO CA 92121-2747	13934201018
ZAHN ELIZABETH TRS	1912 S MARYLAND PKWY LAS VEGAS NV 89104-3106	13934111047