

City of Las Vegas
Department of Planning
Development Services Center
333 North Rancho Drive, 3rd Floor
Las Vegas, Nevada 89106

PRSR
FIRST CLASS MAIL
U.S. Postage
PAID
Las Vegas, NV
Permit No. 1630

Return Service Requested
Official Notice of Public Hearing

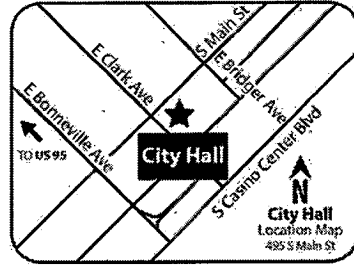

If you wish to file your protest or support on this request, check the appropriate box below and return this card in an envelope with postage to the Department of Planning at the address listed above, fax this side of this card to (702) 464-7499 or make your comments at www.lasvegasnevada.gov. If you would like to contact your Council Representative, please call (702) 229-6405.

I SUPPORT
this Request

I OPPOSE
this Request

Please use available blank space on card for your comments.

GPA-63547 & ZON-63548 [PRJ-63446]

Planning Commission Meeting of 4/12/2016

Application Information

GPA-63547 - GENERAL PLAN AMENDMENT - PUBLIC HEARING - APPLICANT/OWNER: IGLESIA EL GRAN YO SOY - For possible action on a request for a General Plan Amendment FROM: PR-OS (PARKS/RECREATION/OPEN SPACE) AND SC (SERVICE COMMERCIAL) TO: PF (PUBLIC FACILITIES) on 0.80 acres at 4955 and 4965 Bevvie Drive (APNs 138-13-801-030, 031 and 032), Ward 5 (Barlow) [PRJ-63446].

ZON-63548 - REZONING RELATED TO GPA-63547 - PUBLIC HEARING - APPLICANT/OWNER: IGLESIA EL GRAN YO SOY - For possible action on a request for a Rezoning FROM: R-E (RESIDENCE ESTATES) TO: C-V (CIVIC) on 0.80 acres at 4955 and 4965 Bevvie Drive (APNs 138-13-801-030, 031 and 032), Ward 5 (Barlow) [PRJ-63446].

Application Location

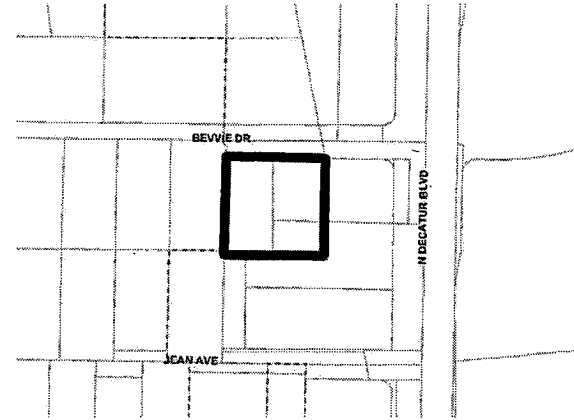

The proposed project may not pertain to the entire highlighted project site.

Public Hearing Information

Meeting: Planning Commission
Date: April 12, 2016
Time: 6:00 P.M.
Location: City Council Chambers
495 South Main Street, 2nd Floor
Las Vegas, Nevada 89101

Any and all interested persons may appear before the City Planning Commission either in person or by representative and object to or express approval of this request; or may, prior to this meeting, file a written objection thereto or approval thereof with the Department of Planning, Development Services Center, 333 North Rancho Drive, 3rd Floor, Las Vegas, Nevada 89106. Final Action on General Plan Amendments and Rezonings will be determined by the City Council. Other public hearing items may be deemed Final Action by the Planning Commission or forwarded to the City Council. The date of the City Council meeting, if applicable, will be announced at the Planning Commission meeting after the discussion of the item. For further information, including the full staff report, please call (702) 229-6301 (TTY 7-1-1) or go to <http://www.lasvegasnevada.gov>.

Report of All Selected Parcels**Case Number:** GPA-63547, ZON-63548, WVR-63549 & SDR-63550**Printed On:** Wed: April 20, 2016

<u>Owner</u>	<u>Address</u>	<u>Parcel Number</u>
AIRPORT VAULT RANCHO L L C	7674 W LAKE MEAD #104 LAS VEGAS NV 89128-6648	13918410009
ALGER JACK	1221 SHADY LN PAHRUMP NV 89060	13813801026
AMEER INVESTMENTS INC	108 W BLUE JAY ONTARIO CA 91762	13813801062
ANDERSON TRACEY C	4936 AUBORN AVE LAS VEGAS NV 89108-3034	13824511016
BARNETT DANNY E	5010 JEAN AVE LAS VEGAS NV 89108-3515	13813801043
BATISTA OBED	4044 THOMAS PATRICK AVE NORTH LAS VEGAS NV 89032	13824511015
BELL STEWART L	VRANESH JOSEPH REVOCABLE FAM TR 1700 S 8TH ST LAS VEGAS NV 89104-2845	13813801034
BELL STEWART L	VRANESH JOSEPH REVOCABLE FAM TR 1700 S 8TH ST LAS VEGAS NV 89104-2845	13813801046
BOLLINGER ETHYL MARIE LIVING TR	BOLLINGER ETHYL MARIE TRS 5030 SMOKE RANCH RD LAS VEGAS NV 89108-3501	13813801066
BORG STEEN STEENSEN	3118 SISK ST LAS VEGAS NV 89108-4321	13813801008
BOURGUIGNON MICHEL & LAURENCE	P O BOX 400938 LAS VEGAS NV 89140	13813712037
BREEN JOHN	5010 SMOKE RANCH RD LAS VEGAS NV 89108-3501	13813801076
BRENT HOWARD ACCT & COMP SRVCS	2385 N DECATUR BLVD LAS VEGAS NV 89108-2956	13824511011
BROOKS TIMOTHY	4279 BERTSOS DR LAS VEGAS NV 89148	13813801002
BRUCE SHANE	5049 SMOKE RANCH RD LAS VEGAS NV 89108	13824511003
BULLOCH BRENT & DIANE	P O BOX 335417 NORTH LAS VEGAS NV 89033	13813801010
BULLOCH BRENT & DIANE	P O BOX 335417 NORTH LAS VEGAS NV 89033	13813801009
CESARS HOLDINGS L L C	3436 LACEBARK PINE ST LAS VEGAS NV 89129	13813801057
CESARS HOLDINGS L L C	3436 LACEBARK PINE ST LAS VEGAS NV 89129	13813801058
CHURCH CHRIST HOLY SANCTIFIED	P O BOX 271226 LAS VEGAS NV 89127-1226	13824511008
CHURCH DESERT HARVEST MISSION	4900 BEVVIE DR LAS VEGAS NV 89108-3522	13918401001
CHURCH DESERT HARVEST MISSION	4900 BEVVIE DR LAS VEGAS NV 89108-3522	13813801017
DONNELLY FAMILY TRUST	5404 SAWYER LAS VEGAS NV 89108-3064	13824511019
DUFRENE LAURETTA ANN REV TR	DUFRENE LAURETTA ANA TRS 5015 ROBERTA DR LAS VEGAS NV 89108-3507	13813801007
ESCOBAR WILFREDO R & A M FAM TR	ESCOBAR WILFREDO & ANGELINA TRS 14918 REYNAUD DR SAN JOSE CA 95127-2565	13918401002
ESQUIVEL PEDRO	5055 EL CASTANO AVE LAS VEGAS NV 89108-6600	13813712039
FLORES LUIS	1516 FRANKLIN AVE LAS VEGAS NV 89104	13813801056
FLORES LUIS	1516 FRANKLIN AVE LAS VEGAS NV 89104	13813801048
FOSTER DAY I L L C	2560 RED ARROW DR LAS VEGAS NV 89135-1627	13813801080
FOSTER-DAY CORP	2560 RED ARROW DR LAS VEGAS NV 89135-1627	13813801083
FOSTER-DAY CORPORATION	2560 RED ARROW DR LAS VEGAS NV 89135-1627	13813801081
GAINES DALE A & KATHRYN	4981 JEAN AVE LAS VEGAS NV 89108-3519	13813801059

Report of All Selected Parcels**Case Number:** GPA-63547, ZON-63548, WVR-63549 & SDR-63550**Printed On:** Wed: April 20, 2016

<u>Owner</u>	<u>Address</u>	<u>Parcel Number</u>
GODINEZ BRANDY	5051 EL CASTANO AVE LAS VEGAS NV 89108-6600	13813712040
GOLDEN SKY L L C	3350 SHALLOW POND DR LAS VEGAS NV 89117-6718	13813712038
GRISHAM FAMILY TRUST	GRISHAM EDWIN & LUCY TRS 4946 AUBORN AVE LAS VEGAS NV 89108-3034	13824511017
HADDIS MICHAEL	5007 W BEVVIE DR LAS VEGAS NV 89108-3566	13813801027
HAMILTON TIMOTHY D & PATRICIA G	4992 AUBORN AVE LAS VEGAS NV 89108-3034	13824511018
HARDY ROBERT M & BARBARA FAM TR	HARDY ROBERT M & BARBARA A TRS 5075 BEVVIE DR LAS VEGAS NV 89108-3513	13813801023
HERNANDEZ EDGAR & JESSICA LEE	4979 JEAN AVE LAS VEGAS NV 89108-3519	13813801060
HOLLAND JANICE	5020 BEVVIE DR LAS VEGAS NV 89108-3514	13813801014
HOLLY JONATHON	5040 JEAN AVE LAS VEGAS NV 89108-3515	13813801041
IGLESIA EL GRAN YO SOY	7245 MADONA DR LAS VEGAS NV 89156	13813801032
IGLESIA EL GRAN YO SOY	7245 MADONA DR LAS VEGAS NV 89156	13813801030
IGLESIA EL GRAN YO SOY	7245 MADONA DR LAS VEGAS NV 89156	13813801031
IWAMOTO PATRICIA EILEEN	YEE STEVEN YET MUN 379 LIHOLIHO ST WAILUKU HI 96793-2509	13918310001
JEAN AVENUE COOPERATIVE WATER CO	5100 SMOKE RANCH RD LAS VEGAS NV 89108-3521	13813801049
JOHNSON RICHARD D & ROBERT ETAL	LAFRENIERE JOANNE 5020 BEVVIE DR LAS VEGAS NV 89108-3514	13813801015
JOHNSON ROBERT A & DENISE P	5060 JEAN AVE LAS VEGAS NV 89108-3515	13813801040
JOHNSON SAMUEL I	SHELDON NICOLE 5021 JEAN AVE LAS VEGAS NV 89108-3516	13813801051
KATZ BARRY N & JULIE A	2510 APRICOT LN LAS VEGAS NV 89108-3556	13813801022
KINNETT LINDA JAYNE	5071 EL CASTANO AVE LAS VEGAS NV 89108-6600	13813712035
KNAUSS ENTERPRISES L L C	P O BOX 130548 HOUSTON TX 77219-0548	13813801063
KRUMICK CAREY F	7500 W LAKE MEAD BLVD #9-390 LAS VEGAS NV 89128-0297	13813801064
L A K V DECATURE INC	7995 FOKESTONE DR CUPERTINO CA 95014	13919101001
LAFRENIERE FAMILY TRUST	LAFRENIERE BRUCE A & JOANNE TRS 5040 BEVVIE DR LAS VEGAS NV 89108-3514	13813801013
LIU CHING-MEI TRUST	LIU CHING-MEI TRS 4621 REGALO BELLO ST LAS VEGAS NV 89135-2534	13824511013
LUNDGREN FAMILY TRUST	2810 W CHARLESTON BLVD #H-81 LAS VEGAS NV 89102	13813801087
MCALPINE MIKE & DIANE	5021 SMOKE RANCH RD LAS VEGAS NV 89108-3536	13824511004
MCGEE RICKY & MELBA	2500 APRICOT LN LAS VEGAS NV 89108-3556	13813801035
MON OF 5 L L C	6133 BENCHMARK WY NORTH LAS VEGAS NV 89031-1801	13918301004
MUNOZ SANDRA J	5005 BEVVIE RD LAS VEGAS NV 89108-3566	13813801028
NICOSIA MICHAEL W	4417 MCLEOD DR LAS VEGAS NV 89121-5320	13824511014
NICOSIA MICHAEL W	4417 MCLEOD DR LAS VEGAS NV 89121-5320	13824511009
NICOSIA MICHAEL W	4417 MCLEOD DR LAS VEGAS NV 89121-5320	13824511007

Report of All Selected Parcels**Case Number:** GPA-63547, ZON-63548, WVR-63549 & SDR-63550**Printed On:** Wed: April 20, 2016

<u>Owner</u>	<u>Address</u>	<u>Parcel Numbe</u>
PAPELINO FRANK & SHIRLEY REV TR	PAPELINO FRANK & SHIRLEY TRS 4021 FEATHERSTONE LN LAS VEGAS NV 89129-5447	13813801082
POHLMAN LORRAINE H	5135 BEVVIE DR LAS VEGAS NV 89108-3565	13813801020
PUPO-LOPEZ ALEIDY	5055 ROBERTA LN LAS VEGAS NV 89108	13813801005
PYTUKAS TRUST	LOPEZ IRMA L TRS 9 LASWELL ST HENDERSON NV 89015-5337	13813801075
QUIMSON VICTORINO R	4963 SMOKE RANCH RD LAS VEGAS NV 89108-3536	13824511006
RAMSITA TRUST	5054 EL CASTANO AVE LAS VEGAS NV 89108-6600	13813712042
REBER JAMES	36 N 1050 W CEDAR CITY UT 84720	13813801039
REEVES SCOTT WILLIAM & ELNOMA M	4993 SMOKE RANCH RD LAS VEGAS NV 89108-3536	13824511005
RETH TOUCH	5021 BEVVIE DR LAS VEGAS NV 89108	13813801025
REYES OLGA S & MICHAEL	425 HARVARD ST LAS VEGAS NV 89107-1865	13813801016
ROMERO EDWARD & ELIZABETH R	5050 EL CASTANO AVE LAS VEGAS NV 89108-6600	13813712041
SAFE NEST TEMP ASST DMST CRISIS	2915 W CHARLESTON #12 LAS VEGAS NV 89102-1904	13919101002
SIPPLE MARTIN	5058 EL CASTANO AVE LAS VEGAS NV 89108-6600	13813712043
SLATSKY FAMILY TRUST	SLATSKY WILLIAM TRS 1003 SCENIC WALK LAS VEGAS NV 89149	13824511012
SMOKE RANCH DECATUR L L C	2300 W SAHARA AVE #1110 LAS VEGAS NV 89102-4354	13918410010
STONE MEADOW L L C	1159 KINGSTON HILLS CT HENDERSON NV 89002	13918402001
SUN LEON LILIANG	6329 LONG COVE DR FONTANA CA 92336	13813801065
SWARTZ RAY L & FRANCES	5000 JEAN AVE LAS VEGAS NV 89108-3515	13813801044
SWARTZ RAY L & FRANCES	5000 JEAN AVE LAS VEGAS NV 89108-3515	13813801029
TABAR 12 L L C	2479 FIELD ROSE DR SALT LAKE CITY UT 84121	13918410012
TAWK DEVELOPMENT L T D	P O BOX 572042 LAS VEGAS NV 89157	13813701058
THOMAS WALTER & TINA	5020 JEAN AVE LAS VEGAS NV 89108-3515	13813801042
THREE V CORP	4825 SMOKE RANCH RD LAS VEGAS NV 89108-3585	13824511010
TRUJILLO JEFFREY	5095 ROBERTA LN LAS VEGAS NV 89108-3507	13813801084
TRUSTEE CLARK COUNTY TREASURER	4355 S DURNAGO #180 LAS VEGAS NV 89147-8634	13813801052
USA POSTAL SERVICE	8055 E TUFTS AVE #400 DENVER CO 80237	13813701051
VALDEZ TONY	5080 BEVVIE DR LAS VEGAS NV 89108-3514	13813801086
VIENE IGLESIA CRISTO	4901 JEAN AVE LAS VEGAS NV 89108-3519	13813801061
VRANESH JOSEPH	BELL STEWART L 1700 S 8TH ST LAS VEGAS NV 89104-2845	13813801045
WOLATZ SCOTT S & MARGARET	5031 BERRIE DR LAS VEGAS NV 89108	13813801024
WOLF PAC FAMILY TRUST	AUSTIN LINDA LOU TRS P O BOX 19425 JEAN NV 89019-9425	13813801004
YURCIC SUSAN REVOCABLE TRUST	MATAYA WILLIAM R TRS 5095 BEVVIE RD LAS VEGAS NV 89108-3513	13813801033

Report of All Selected Parcels

Case Number: GPA-63547, ZON-63548, WVR-63549 & SDR-63550

Printed On: Wed: April 20, 2016

Owner
ZAVALA ANTHONY R

Address
5067 EL CASTANO AVE LAS VEGAS NV 89108-6600

Parcel Numbe
13813712036