

City of Las Vegas
Department of Planning
Development Services Center
333 North Rancho Drive, 3rd Floor
Las Vegas, Nevada 89106

Return Service Requested
Official Notice of Public Hearing

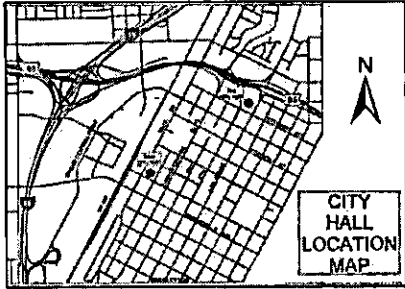

If you wish to file your protest or support on this request, check the appropriate box below and return this card in an envelope with postage to the Department of Planning at the address listed above, fax this side of this card to (702) 464-7499 or make your comments at www.lasvegasnevada.gov. If you would like to contact your Council Representative, please call (702) 229-6405.

I SUPPORT
this Request

I OPPOSE
this Request

Please use available blank space on card for your comments.

GPA-60977 & ZON-60978 [PRJ-60825]

Planning Commission Meeting of 10/13/2015

Application Information

GPA-60977 - GENERAL PLAN AMENDMENT - PUBLIC HEARING - APPLICANT/OWNER: RAINBOW ANN (I), LLC
- For possible action on a request for a General Plan Amendment FROM: DR (DESERT RURAL DENSITY RESIDENTIAL) TO: SC (SERVICE COMMERCIAL) on 1.64 acres on the southeast corner of Ann Road and Rainbow Boulevard (APNs 125-35-101-001 and 002), Ward 4 (Anthony) [PRJ-60825].

ZON-60978 - REZONING RELATED TO GPA-60977 - PUBLIC HEARING - APPLICANT/OWNER: RAINBOW ANN (I), LLC
- For possible action on a request for a Rezoning FROM: R-E (RESIDENCE ESTATES) TO: C-1 (LIMITED COMMERCIAL) on 1.64 acres on the southeast corner of Ann Road and Rainbow Boulevard (APNs 125-35-101-001 and 002), Ward 4 (Anthony) [PRJ-60825].

Application Location

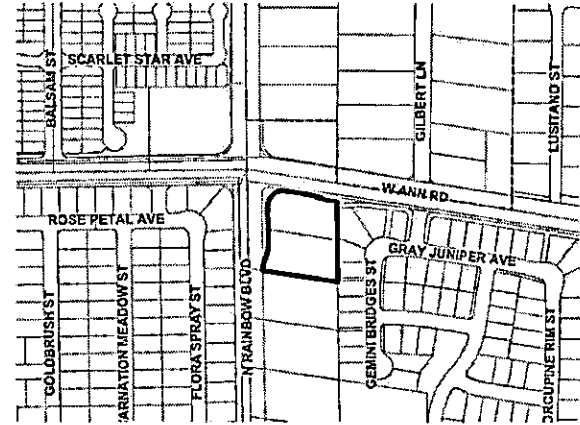

The proposed project may not pertain to the entire highlighted project site.

Public Hearing Information

Meeting:	Planning Commission
Date:	<i>October 13, 2015</i>
Time:	6:00 P.M.
Location:	City Council Chambers 495 South Main Street, 2 nd Floor Las Vegas, Nevada 89101

Any and all interested persons may appear before the City Planning Commission either in person or by representative and object to or express approval of this request; or may, prior to this meeting, file a written objection thereto or approval thereof with the Department of Planning, Development Services Center, 333 North Rancho Drive, 3rd Floor, Las Vegas, Nevada 89106. Final Action on General Plan Amendments and Rezonings will be determined by the City Council. Other public hearing items may be deemed Final Action by the Planning Commission or forwarded to the City Council. The date of the City Council meeting, if applicable, will be announced at the Planning Commission meeting after the discussion of the item. For further information, including the full staff report, please call (702) 229-6301 (TDD 386-9108) or go to <http://www.lasvegasnevada.gov>.

Report of All Selected Parcels**Case Number:** GPA-60977: 70N-60978; SUP-60980;
SUP-60982 & SDR-60983**Printed On:** Mon: September 14, 2015

<u>Owner</u>	<u>Address</u>	<u>Parcel Number</u>
2015-3 I H 2 BORROWER L P	901 MAIN ST #4700 DALLAS TX 75202	12527816016
A B S NV-O L L C	P O BOX 990 MINNEAPOLIS MN 55440	12534515002
A H 4 R PROPERTIES L L C	30601 AGOURA RD #200 AGOURA HILLS CA 91301	12527815021
A M H 2014-1 BORROWER L L C	30601 AGOURA RD #200 AGOURA HILLS CA 91301	12534513010
A M H ROMAN TWO N V L L C	30601 AGOURA #200 AGOURA HILLS CA 91301	12535111032
A V V RESIDENTIAL L L C	2075 VILLAGE CENTER CIR LAS VEGAS NV 89134-6251	12534512043
ABERNATHY PAMELA	6713 SNAKE RIVER AVE LAS VEGAS NV 89130-1680	12534614030
AIKEN PETER J III & GINA M	5513 PORCUPINE RIM ST LAS VEGAS NV 89130-4803	12535111036
AKI TRUST	SHUGARMAN ALAN TRS 3635 S FORT APACHE RD #200-7 LAS VEGAS NV 89147	12535111027
ALBERICI JOHN & PATRICIA FAM TR	ALBERICI JOHN S & PATRICIA A TRS 5425 CARNATION MEADOW ST LAS VEGAS NV 89130-3822	12534513034
ALBERT DIANE L	6704 FRUIT FLOWER AVE LAS VEGAS NV 89130-3848	12534514018
ALBERTY L D REVOCABLE LIV TR	ALBERTY L D TRS 145 LA MIRADA DR HENDERSON NV 89015	12535103008
ALEXANDER NAGUIB M & G Z TRUST	ALEXANDER NAGUIB M & G Z TRS 6812 ROSE PETAL AVE LAS VEGAS NV 89130-1657	12534511004
ALLEN GREGORY & EMELIA	6609 GRAY JUNIPER AVE LAS VEGAS NV 89130-4806	12535111025
ALLEN LARRY D & TAMMY L	5317 GOLDEN CLIFF ST LAS VEGAS NV 89130-1677	12534614057
ALLEN MICHAEL J	17117 JOURNEYS END DR ODESSA FL 33556	12527815001
ALLEN VALERIE M	6810 BRIARWOOD BEND LAS VEGAS NV 89130-5005	12527816034
ALVA WILLIE B	OMINGA GLORIA M 6947 YELLOW COSMOS AVE LAS VEGAS NV 89130	12527819047
ANDERSON CHARLES P & GERALDINE	6817 FRUIT FLOWER AVE LAS VEGAS NV 89130-1665	12534512009
ANDRADE CHARLES R	KIRBY SHELLY A 6836 WHITE LAKES AVE LAS VEGAS NV 89130-1660	12534614001
ANDRADE JOSE	5509 GREEN WILLOW ST LAS VEGAS NV 89130-1647	12534511017
ANN S D L L C	1 CVS DR WOONSOCKET RI 02895-6146	12534502006
APEL JOAN M & CHARLES G	6700 WHITE LAKES AVE LAS VEGAS NV 89130-1663	12534614016
AQUA BAMBOO L L C	6717 CAMBIUM PINE AVE LAS VEGAS NV 89130-1420	12526410004
AQUIAR HERIBERTO VALENTE	VALENTE MICHAEL NICOLA TRUST 6625 W EL CAMPO GRANDE AVE LAS VEGAS NV 89130-1203	12526402003
ARCHER JOSEPH R & SUSAN N	6820 FRUIT FLOWER AVE LAS VEGAS NV 89130-1664	12534512040
ARMONIO ALEXIS	5675 FOXGLOVE FIELDS ST LAS VEGAS NV 89130	12527819004
ARONSTEIN HOWARD	6801 HAVEN HOLLOW AVE LAS VEGAS NV 89130-1187	12527714018
ASTANTIS L L C	201 E MAYFLOWER AVE NORTH LAS VEGAS NV 89030	12534513023
AYALA ERICK A	5508 ROSE THICKET ST LAS VEGAS NV 89130-1652	12534511044
B D S INVESTMENT L L C	2660 S RAINBOW BLVD #H-108 LAS VEGAS NV 89146	12527819025

Report of All Selected Parcels**Case Number:** GPA-60977: ZON-60978; ; SUP-60980; ;
SUP-60982 & SDR-60983**Printed On:** Mon: September 14, 2015

<u>Owner</u>	<u>Address</u>	<u>Parcel Number</u>
B O F A HOLDINGS	21800 OXNARD ST #1160 WOODLAND HILLS CA 93167	12527816018
BACALLAO ARAMIS	5688 BISHOP FLOWERS ST LAS VEGAS NV 89130	12527819021
BAILEY JOHN M	5455 N RAINBOW BLVD LAS VEGAS NV 89130-1608	12535101005
BAILEY RICHARD L	5416 FLORA SPRAY ST LAS VEGAS NV 89130-3843	12534514035
BAIN JAMES A & MAUREEN	6617 MANZANITA GLEN AVE LAS VEGAS NV 89130-4997	12535111015
BAIRD RICK & SANDRA	6511 LOKAI AVE LAS VEGAS NV 89130-1260	12526411004
BALAYAN KRISTINA	SHIAN RAYMOND 5623 BISHOP FLOWERS ST LAS VEGAS NV 89130	12527819078
BALENT MARK	2121 S COLUMBINE ST DENVER CO 80210-4813	12534512032
BANK MORGAN J P CHASE NATL ASSN	10790 RANCHO BERNARDO RD SAN DIEGO CA 92127	12535111039
BARAJAS ANTONIO JR & YOLANDA	9048 WHITE EYES AVE LAS VEGAS NV 89143	12527819088
BARCARSE DEMETRIO	10972 TOPEKA DR PORTER RANCH CA 91326-2322	12527815018
BARCLAY DONALD L JR & ANNETTE M	5412 ROSE THICKET ST LAS VEGAS NV 89130-1674	12534512035
BARCLAY MICHAEL L	6813 WHITE LAKES AVE NORTH LAS VEGAS NV 89130-1661	12534614034
BARNARD HEATH	6794 WEEPING FIG CT LAS VEGAS NV 89130-5007	12527816014
BARNES JAMES A & MERELIN	5412 GOLDBRUSH ST LAS VEGAS NV 89130-1671	12534512002
BARTHA LIDIA	5412 CARNATION MEADOW ST LAS VEGAS NV 89130-3821	12534513028
BASILIO MARK	5512 ROSE THICKET ST LAS VEGAS NV 89130-1652	12534511045
BASTONE DENISE	1020 S RED BRIDGE AVE LAS VEGAS NV 89134	12526411023
BASURA JOSEPH E SR & MAGDA H	6816 WHITE LAKES AVE LAS VEGAS NV 89130	12534614006
BEATTIE TRACY	5630 AFRICAN LILLY CT LAS VEGAS NV 89130-4992	12527815037
BECERRIL XAVIER G	5421 FLORA SPRAY ST LAS VEGAS NV 89130-3844	12534514022
BELCHER DAVID M & W & M LIV TR	BELCHER WALTER H & MURIEL F TRS 6611 W HAMMER LN LAS VEGAS NV 89130-1708	12535201017
BELOSKUR FAMILY TRUST	BELOSKUR LEONARD & PATRICIA A TR 5413 GOLDBRUSH ST LAS VEGAS NV 89130	12534512045
BENAVIDEZ RAUL	6512 SAND BENCH AVE LAS VEGAS NV 89130-4800	12535111049
BENAVIDEZ RAUL Z & ANA V	6516 GRAY JUNIPER AVE LAS VEGAS NV 89130-4807	12535111074
BENDAVID JACOB & RACHEL	714 N OGDEN DR LOS ANGELES CA 90046-7306	12534614042
BERENDS JAMES & TERESA	6820 ROSE PETAL AVE LAS VEGAS NV 89130-1657	12534511006
BERG DANA	5800 GILBERT LN LAS VEGAS NV 89130-1219	12526402001
BERGSTRAND RICHARD E	5332 DANA SPRINGS WY LAS VEGAS NV 89130-1736	12535215020
BETHEA PATRICIA	6917 GLEN LANDING AVE LAS VEGAS NV 89130-4909	12527814004
BINAMIRA IMELDA L	5644 BALSAM ST LAS VEGAS NV 89130-1106	12527815045
BLAZZARD DEANNE	7108 DILLSEED DR LAS VEGAS NV 89131-8154	12534513022

Report of All Selected Parcels**Case Number:** GPA-60977; ZON-60978; SUP-60980;
; SUP-60982 & SDR-60983**Printed On:** Mon: September 14, 2015

<u>Owner</u>	<u>Address</u>	<u>Parcel Number</u>
BLINN DARREN	TRAN DUYN 5606 BISHOP FLOWERS ST LAS VEGAS NV 89130	12527819075
BOEHLER KRISTEN	569 CANLITE ST HENDERSON NV 89015	12535215016
BONNET GUILLERMO A	705 SARAJANE LANE LAS VEGAS NV 89107-1582	12535111066
BOONPICHATE KESANEEOE	P O BOX 570811 LAS VEGAS NV 89157-0811	12526403017
BOOTH RACHEL V TRUST	BOOTH RACHEL V TRS P O BOX 34045 LAS VEGAS NV 89133	12535215019
BOWMAN-WALKLIN ELVIRA A	5517 REBECCA RD LAS VEGAS NV 89130-1706	12535102014
BOWMAN-WALKLIN ELVIRA ANNE	5517 REBECCA RD LAS VEGAS NV 89130-1706	12535102020
BOYAKINS GREGORY D	6700 ROSE PETAL AVE LAS VEGAS NV 89130-1686	12534513005
BRADFORD PATRICK A & CECILIA M	6809 HAVEN HOLLOW AVE LAS VEGAS NV 89130-1187	12527714020
BRADY SCOTT M	5442 PORCUPINE ST LAS VEGAS NV 89130-4802	12535111062
BRAY MARY MAGGIE & DAVID ROBERT	5945 N EL CAPITAN WAY LAS VEGAS NV 89149	12527803004
BREWER DEXTER R & JOLYNN H	5416 FLOWERING BUSH CT LAS VEGAS NV 89130-1676	12534512023
BREWSTER STANLEY B	6709 FRUIT FLOWER AVE LAS VEGAS NV 89130-3849	12534514005
BROWN GABRIEL B & MELISSA J	5408 GOLDBRUSH ST LAS VEGAS NV 89130-1671	12534512003
BROWN JACQUELYN D	5511 GEMINI BRIDGES ST LAS VEGAS NV 89130-4996	12535111009
BROWN JOHN T & GLORIA J	5516 CARNATION MEADOW ST LAS VEGAS NV 89130-1692	12534513020
BROWN ROBERT L	6501 W HAMMER LN LAS VEGAS NV 89130-1702	12535215006
BROWNING PHILLIP MARK & LEANN	5417 CARNATION MEADOW ST LAS VEGAS NV 89130-3822	12534513032
BRUNO RAFAEL & KATIE	6816 SNAKE RIVER AVE LAS VEGAS NV 89130	12534614039
BUCK MICHAEL D & RAQUEL	6517 TAYLOR CREEK AVE LAS VEGAS NV 89130-4805	12535111043
BUMGARNER MARGIE E TRUST	BUMGARNER MARGIE E TRS 6801 SNAKE RIVER AVE LAS VEGAS NV 89130-1670	12534614044
BUNKER DEREK & CHRISTIE	6512 LOKAI AVE LAS VEGAS NV 89130-1260	12526411025
BURCHARD FAMILY TRUST	BURCHARD CARL L & THANH T TRS 5500 GOLDBRUSH ST LAS VEGAS NV 89130-1655	12534511027
BURMEISTER ROBERT F & JANICE J	6513 SAND BENCH AVE LAS VEGAS NV 89130-4800	12535111057
BURNS IAN R & KIM	1110 JENNIE RIDGE TRL KISSIMMEE FL 34747-1926	12535111012
BURTON EDWARD J & DORIS J	WALDEN SALLY A 6828 ROSE PETAL AVE LAS VEGAS NV 89130-1657	12534511008
BUSH LAURENS A IV	WILSON MARISSA R 5635 BISHOP FLOWERS ST LAS VEGAS NV 89130	12527819081
BYRD JENNIFER L & SHAUNTE M	6508 GRAY JUNIPER AVE LAS VEGAS NV 89130-4807	12535111072
C A H 2014-1 BORROWER L L C	9305 E VIA DE VENTURA #201 SCOTTSDALE AZ 85258	12534614027
C A H 2014-1 BORROWER L L C	9305 E VIA DE VENTURA #201 SCOTTSDALE AZ 85258	12527815026
C A H 2014-1 BORROWER L L C	9305 E VIA DE VENTURA #201 SCOTTSDALE AZ 85258	12527816024
C A H 2014-1 BORROWER L L C	9305 E VIA DE VENTURA #201 SCOTTSDALE AZ 85258	12527815049

Report of All Selected Parcels

Case Number: GPA-60977; ZON-60978; ; SUP-60980; ;
SUP-60982 & SDR-60983

Printed On: Mon: September 14, 2015

<u>Owner</u>	<u>Address</u>	<u>Parcel Number</u>
C A H 2014-1 BORROWER L L C	9305 E VIA DE VENTURA #201 SCOTTSDALE AZ 85258	12527815008
C A H 2015-1 BORROWER L L C	9305 E VIA DE VENTURA #201 SCOTTSDALE AZ 85258	12534513035
CACERES ANDRE K & KATHRYN M	8 COBBLEWOOD DR MOUNT POCONO PA 18344	12534614035
CACEROS JOSE A & MARIA V	6920 WHITE LAKES AVE LAS VEGAS NV 89130-1654	12534613006
CALAYCAY BIANCA R	5671 FOXGLOVE FIELDS ST LAS VEGAS NV 89130	12527819003
CALIGURL L L C	9721 CAMDEN HILLS AVE LAS VEGAS NV 89145-8611	12534511001
CALLEJO MARIANO A	5638 AFRICAN LILLY CT LAS VEGAS NV 89130	12527815035
CAMPBELL CORBET C	2841 CHANNEL BAY DR LAS VEGAS NV 89128	12534512026
CAMPBELL DEREK GRANT	DUBOIS MARIN LINDSAY 6612 W GRAY JUNIPER AVE LAS VEGAS NV 89130-4806	12535111078
CAMPOS DEBORA J	6931 YELLOW COSMOS AVE LAS VEGAS NV 89130	12527819043
CANCIL MARVIN & RHONDA	P O BOX 572052 LAS VEGAS NV 89157-2052	12534511011
CANITES MARY ANNE B	6747 SCARLET STAR AVE LAS VEGAS NV 89130-4995	12527815034
CANTILLO CARLOS	6817 BRIARWOOD BEND AVE LAS VEGAS NV 89130-5005	12527816002
CARABALLO GERMAN JR & ELIZABETH	9376 THUNDER BASIN AVE LAS VEGAS NV 89149-0127	12535111050
CARABALLO GERMAN JR & ELIZABETH	9376 THUNDER BASIN AVE LAS VEGAS NV 89149-0127	12535111051
CARCELLI LOUISE A	5405 CARNATION MEADOW ST LAS VEGAS NV 89130-3822	12534514013
CAROTHERS HAROLD E M & C MELODY	5433 REBECCA RD LAS VEGAS NV 89130-1703	12535104002
CARRAGHER STEVEN	6713 WHITE LAKES AVE LAS VEGAS NV 89130-1663	12534614020
CARRILLO FERNANDO	6821 FRUIT FLOWER AVE LAS VEGAS NV 89130-1665	12534512010
CARRINGTON JOEL	5517 ROSE THICKET ST LAS VEGAS NV 89130-1653	12534511053
CARTER DARRYL GREGG	5512 CARNATION MEADOW ST LAS VEGAS NV 89130-1692	12534513021
CARVER CAROL SUE REV LIV TR	CARVER CAROL SUE TRS 5529 ROSE THICKET ST LAS VEGAS NV 89130-1653	12534511050
CARVOTTA PASCAL F	HENDRICKSON ALLEN STEVE 6804 ROSE PETAL AVE LAS VEGAS NV 89130-1662	12534511002
CASCAYAN EMERSON	KANESHIRO VALERIE 5667 BALSAM ST LAS VEGAS NV 89130	12527819031
CASELL STEVEN CHRISTOPHER & KAT	5630 BISHOP FLOWERS ST LAS VEGAS NV 89130	12527819069
CASTILLO ANA M	5529 FLORA SPRAY ST LAS VEGAS NV 89130-1697	12534513016
CASTILLO FRANCES N	GORMAN ROBERT L 5320 DANA SPRINGS WY LAS VEGAS NV 89130-1736	12535215017
CASTRO-PIREZ LAZARO	5634 AFRICIAN LILLY CT LAS VEGAS NV 89130-4992	12527815036
CATELO EMILEE ANN & JIMRYAN Y	6939 YELLOW COSMOS AVE LAS VEGAS NV 89130	12527819045
CEBALLOS EVELIA	6820 WHITE LAKES AVE LAS VEGAS NV 89130-1659	12534614005
CHAPARIAN MARK A	6913 FRUIT FLOWER AVE LAS VEGAS NV 89130-1668	12534512016
CHAVEZ JOSEPH	3130 S RAINBOW BLVD #301 LAS VEGAS NV 89146	12534614019

Report of All Selected Parcels**Case Number:** GPA-60977; ZON-60978; ; SUP-60980;
;UP-60982 & SDR-60983**Printed On:** Mon: September 14, 2015

<u>Owner</u>	<u>Address</u>	<u>Parcel Number</u>
CHENE CHEN & VIVIAN M	5636 LUSITANO ST LAS VEGAS NV 89130-1262	12526411010
CHESS ROBERT W & PATRICIA L	5644 LUSITANO ST LAS VEGAS NV 89130-1262	12526411009
CHICO SILVIA	6601 W HAMMER LN LAS VEGAS NV 89130	12535201016
CHOUNLAMOUNTRY VIMARANH	6777 BRIARWOOD BEND AVE LAS VEGAS NV 89130-5005	12527816006
CHUI CHING	CHEUNG KIT POH P O BOX 911 BRASELTON GA 30517	12527815033
CLARK TAMMERA	5632 FOXGLOVE FIELDS ST LAS VEGAS NV 89130	12527819084
COHU VICTORIA L	12543 CATARA ST NO HOLLYWOOD CA 91605	12527815002
COLE DONALD E	5324 DANA SPRINGS WY LAS VEGAS NV 89130-1736	12535215018
COLFIN AI-NV 2 L L C	9305 E VIA DE VENTURA #201 SCOTTSDALE AZ 85258	12527815011
COLLIER TERENCE D	5720 WINTER CHERRY AVE LAS VEGAS NV 89130-5006	12527817003
COMPAGNO JOHN	9811 W CHARLESTON BLVD #2792 LAS VEGAS NV 89117	12527803002
CONLEY FAMILY TRUST	CONLEY JOHN M & NANCY J CO-TRS 6829 FRUIT FLOWER AVE LAS VEGAS NV 89130-1667	12534512012
COON NORMA D LIVING TRUST	COON NORMA D TRS 6825 WHITE LAKES AVE LAS VEGAS NV 89130-1661	12534614037
COUCH YASUKO	6705 WHITE LAKES AVE LAS VEGAS NV 89130-1663	12534614018
COULOUTE PIERRE	5409 GOLDBRUSH ST LAS VEGAS NV 89130-1678	12534512044
COVERT LORETTA & DARREN	5683 BALSAM ST LAS VEGAS NV 89130	12527819035
COWPERTHWAIT TODD & SHELLEY	6802 BAYBERRY CREEK CT LAS VEGAS NV 89130-4999	12527816023
CRAMER ERNEST W	CRANMER-CRAMER JANIS C 5420 GOLDBRUSH ST LAS VEGAS NV 89130	12534511025
CROWTHER TROY & CHERYL	6820 BOTTLE SAGE AVE LAS VEGAS NV 89130-1648	12534511043
CRUM DEAN R & JENNIFER	5501 REBECCA RD LAS VEGAS NV 89130-1706	12535102018
CRUZ MARK & LAURA	5514 PORCUPINE RIM ST LAS VEGAS NV 89130-4803	12535111065
CSOENDES IRREVOCABLE PPTY TR	SZOKE LASZLO TRS 8600 SCHOLAR LN #1008 LAS VEGAS NV 89128	12534513019
CUETO JOSE III	VILLANUEVA MARIA 5680 BISHOP FLOWERS ST LAS VEGAS NV 89130	12527819023
CURDY ROBERT H & DANA E	6708 FRUIT FLOWER AVE LAS VEGAS NV 89130-3848	12534514017
CURTIS JOSEPH W & BETTY	6801 FRUIT FLOWER AVE LAS VEGAS NV 89130-3851	12534514008
CUSHING GARY	5673 ORANGEROOT CT LAS VEGAS NV 89130-4994	12527815019
CYRUS HERMAN J IV & PHELICIA M	6927 YELLOW COSMOS AVE LAS VEGAS NV 89130	12527819042
CZECH LAWRENCE W	5400 ROSE THICKET ST LAS VEGAS NV 89130-1674	12534512038
D S F R NV HOLDINGS L L C	615 FRONT ST SAN FRANCISCO CA 94111	12535111045
DAHL LARK A	5521 ROSE THICKET ST LAS VEGAS NV 89130-1653	12534511052
DALERE ELA FLORES	5669 PRIMROSE PEAK CT LAS VEGAS NV 89130	12527819053
DANG VINCENT & BETTY	33142 VINO WAY TEMECULA CA 92591	12527819079

Report of All Selected Parcels

Case Number: GPA-60977; ZON-60978; : SUP-60980;
SUP-60982 & SDR-60983

Printed On: Mon: September 14, 2015

<u>Owner</u>	<u>Address</u>	<u>Parcel Numbe</u>
DAVIS KENNETH L & CHERYL	5500 CARNATION MEADOW LAS VEGAS NV 89130-1692	12534513024
DAVIS TONY	6 RUE DU PALAIS CT HENDERSON NV 89011-2009	12527818006
DEAL SHAUN H & KORI D	3050 SHERIDAN ST LAS VEGAS NV 89102-7819	12526411007
DEAN JESSE JR & JERRILYN K	6545 W HAMMER LN LAS VEGAS NV 89130-1702	12535215002
DEGAETANO JOHN & EMILY	117 MARVIN CT PETALUMA CA 94954	12527819028
DELGADO CRUZ M & IRMA	6451 TINA LN LAS VEGAS NV 89130-1705	12535104003
DEPOSADA K C L SEP PPTY TR	5522 MOONLIGHT GARDEN ST LAS VEGAS NV 89130-4998	12535111029
DEVIN PAT R & ANITA R	P O BOX 78420 PHOENIX AZ 85062	12534513004
DEWIT YOLANDA C	123 S FIGUEROA #1231 LOS ANGELES CA 90012-5478	12527816025
DIAMOND JACK K & GAIL FAMILY TRU	DIAMOND JACK K & GAIL TRS 5509 FLORA SPRAY ST LAS VEGAS NV 89130-1695	12534514028
DIAZ JOSE & FRANCINE REV 1993 TR	DIAZ JOSE LUIS & FRANCINE J TRS 9821 TERRADELL ST PICO RIVERA CA 90660-5645	12527816027
DICKINSON JO-ANN	6824 SNAKE RIVER AVE LAS VEGAS NV 89130-1669	12534614038
DIETRICH FAMILY TRUST	DIETRICH JASON E & KIMBERLY TRS 5417 GOLDBRUSH ST LAS VEGAS NV 89130-1678	12534512046
DIXON MARION	728 DIAMOND ST SAN FRANCISCO CA 94114	12527816004
DONOHUE PATRICK & JUDITH	5715 GILBERT LN LAS VEGAS NV 89130-1225	12526410013
DONOHUE TARA	DONAHUE PATRICK & JUDITH 5715 GILBERT LN LAS VEGAS NV 89130-1225	12526410011
DOROBANTU MARIAN & CRISTINA	4358 DEFOREST ST LAS VEGAS NV 89103	12534513030
DUKE CRAIG D	5521 PORCUPINE RIM ST LAS VEGAS NV 89130-4803	12535111034
DUMAS ROSALIND BRANNON	5661 AFRICAN LILLY CT LAS VEGAS NV 89130-4992	12527815006
DURANDETTO KENNETH TODD	BROOKS IMELDA H 5637 AFRICAN LILLY CT LAS VEGAS NV 89130-4992	12527815042
DUTSON DEREK M	5425 N RAINBOW BLVD LAS VEGAS NV 89130	12535103003
ELLEFSON GLEN P JR & MARLENA K	5424 CARNATION MEADOW ST LAS VEGAS NV 89130-3821	12534513025
ELZABEN KHALED SOHAIL & SUN	5409 FLORA SPRAY ST LAS VEGAS NV 89130-3844	12534514019
EMBERLIN GREG R	6943 YELLOW COSMOS AVE LAS VEGAS NV 89130	12527819046
ENCIZO RICHARD & LORENA	5528 GOLDBRUSH ST LAS VEGAS NV 89130	12534511034
ENEA CHRISTOPHER K & ISABELLE M	5661 PRIMROSE PEAK CT LAS VEGAS NV 89130	12527819051
ENSIGN WILLIAMS B LIVING TRUST	ENSIGN WILLIAMS B TRS 5170 RUSTIC RIDGE DR LAS VEGAS NV 89148	12526403016
ESTOUP MEGAN NICOLE	5684 BISHOP FLOWERS ST LAS VEGAS NV 89130	12527819022
ESTRADA PEDRO A & GRISELDA	5524 GOLDBRUSH ST LAS VEGAS NV 89130-1655	12534511033
EVANS BOBBYE E	5528 GREEN WILLOW ST LAS VEGAS NV 89130-1646	12534511064
EVENSON SUSAN R	5804 KANE HOLLY ST LAS VEGAS NV 89130-4942	12527714013
EVERHART ROBERT L & JOANNE S	5521 FLORA SPRAY ST LAS VEGAS NV 89130	12534513014

Report of All Selected Parcels**Case Number:** GPA-60977; ZON-60978; SUP-60980;
SUP-60982 & SDR-60983**Printed On:** Mon: September 14, 2015

<u>Owner</u>	<u>Address</u>	<u>Parcel Number</u>
EXCELLENT INVESTMENTS L P	3635 S FORT APACHE RD #200-7 LAS VEGAS NV 89147	12535111077
FARR STEPHEN W	5435 N RAINBOW BLVD LAS VEGAS NV 89130	12535103004
FARR STEPHEN W	5435 N RAINBOW BLVD LAS VEGAS NV 89130	12535103002
FAUDOASALCIDO LUIS C	6460 W HAMMER LN LAS VEGAS NV 89130-1709	12535104011
FEDERAL NATIONAL MORTGAGE ASSN	135 N LOS ROBLES AVE PASADENA CA 91101	12534511038
FEDERAL NATIONAL MORTGAGE ASSOCI	14221 DALLAS PKWY #1000 DALLAS TX 75254	12527815030
FERRARA LORRAINE	5528 FLORA SPRAY ST LAS VEGAS NV 89130-1696	12534513007
FICHTENBAUM ERIC & SHARON REV TR	7294 ELESSAR AVE LAS VEGAS NV 89178	12527815017
FIFIELD STEPHANIE J	5417 ROSE THICKET ST LAS VEGAS NV 89130-1675	12534512033
FIJOLEK ZBIGNIEW J & MARZENNA M	6912 WHITE LAKES AVE LAS VEGAS NV 89130-1654	12534613004
FIRTH BRIAN TRUST	FIRTH BRIAN TRS 5521 GREEN WILLOW ST LAS VEGAS NV 89130-1647	12534511014
FITZGERALD GREGORY A & KATHRYN S	5534 PORCUPINE RIM ST LAS VEGAS NV 89130-4803	12535111070
FITZPATRICK PETER W & CAROL A	5504 GOLDBRUSH ST LAS VEGAS NV 89130-1655	12534511028
FLEWELLEN DANNY & PATSY	5676 BISHOP FLOWERS ST LAS VEGAS NV 89130	12527819024
FOULKES MARK S & SABINE E	6520 TAYLOR CREEK AVE LAS VEGAS NV 89130	12535111040
FRANCOMANO GENNARO & JOY	5525 GREEN WILLOW ST LAS VEGAS NV 89130-1647	12534511013
FRAZIER MICHAEL & TAEM	5433 FLORA SPRAY ST LAS VEGAS NV 89130	12534514025
FREIERMUTH FAMILY TRUST 1997	FREIERMUTH DEAN H & CAROLE L TRS 6440 TINA LN LAS VEGAS NV 89130-1710	12535102023
FRIEDMAN SCOTT	FRIEDMAN JOEL & DIANA 6786 WEEPING FIG CT LAS VEGAS NV 89130	12527816013
FRIENDS MOOSE REVOCABLE LIV TR	NEAL JOE DENNIS TRS 6212 LULLABY PINE CT LAS VEGAS NV 89130-1404	12526402006
FROISTAD FREDRICK H	WALLACE-FROISTAD DANELLE L 6613 TAYLOR CREEK AVE LAS VEGAS NV 89130-4804	12535111041
FRUIT FLOWER 6909 LAND TRUST	2000 W ANA RD #102-220 NORTH LAS VEGAS NV 89031	12534512015
GAIN WILLIAM A & SUSAN	5336 DANA SPRINGS WY LAS VEGAS NV 89130-1736	12535215021
GAITAN VIDAL A & IMELDA D	5438 PORCUPINE RIM ST LAS VEGAS NV 89130	12535111061
GALANGA CEASAR	6620 GRAY JUNIPER AVE LAS VEGAS NV 89130-4806	12535111001
GALEY SHAUN R & HOLLY A	6923 YELLOW COSMOS AVE LAS VEGAS NV 89130	12527819041
GALLEGOS FAMILY TRUST	GALLEGOS ANITA M TRS 6912 GLEN LANDING AVE LAS VEGAS NV 89130-4908	12527814013
GAMBOA RUEL L & LUCIEN A	7147 32ND AVE S SEATTLE WA 98118-3503	12534513009
GAMBURG NATHAN	LUI BRITTANY 5636 FOXGLOVE FIELDS ST LAS VEGAS NV 89130	12527819083
GARAVITO JOSE	3695 N LAS VEGAS BLVD LAS VEGAS NV 89115-0511	12535103009
GARCIA EDMON P & JENNY P	5662 FOXGLOVE FIELDS ST LAS VEGAS NV 89130	12527819050
GARCIA-LOPEZ RICHARD	DEGARCIA MILITZA I FERNANDEZ 5673 DANCING ORCHID CT LAS VEGAS NV 89130-4993	12527815029

Report of All Selected Parcels

Case Number: GPA-60977: ZON-60978; ; SUP-60980; .
SUP-60982 & SDR-60983

Printed On: Mon: September 14, 2015

<u>Owner</u>	<u>Address</u>	<u>Parcel Numbe</u>
GARDNER TAUREAN & DIONNDRA S	5668 AFRICAN LILLY CT LAS VEGAS NV 89130	12527815013
GASPER SHAYNE T & TERRY L	6828 WHITE LAKES AVE LAS VEGAS NV 89130-1659	12534614003
GASTELUM OLVIDO A	5532 FLORA SPRAY ST LAS VEGAS NV 89130-1696	12534513006
GATES ROGER L III & MELANIE B	5517 GREEN WILLOW ST LAS VEGAS NV 89130	12534511015
GAUFF AIRON	5671 BALSAM ST LAS VEGAS NV 89130	12527819032
GAYE MOUHAMADOU L	LEWIS-GAYE SHAMOYIA 5408 FLOWERING BUSH CT LAS VEGAS NV 89130-1676	12534512025
GERVASIO LOUIS	6454 W HAMMER LN LAS VEGAS NV 89130	12535104012
GIARMO ANNA FAMILY TRUST	GIARMO ANNA TRS 6717 FRUIT FLOWER AVE LAS VEGAS NV 89130-3849	12534514007
GIARMO CHERYL L	5611 LUSITANO ST LAS VEGAS NV 89130-1262	12526411016
GLORIOSO CLAUDIO G & MARIA L	GLORIOSO MARIA C & CLARIZA 6735 SCARLET STAR AVE LAS VEGAS NV 89130-4995	12527818008
GLOVER JEFFREY JR & JILL	5529 CRIMSON RIDGE DR LAS VEGAS NV 89130-5133	12534511060
GODOY RICARDO C & CHRISTINA M	6620 MANZANITA GLEN AVE LAS VEGAS NV 89130-4997	12535111021
GOLD L T R E L L C #6	9159 W FLAMINGO RD #102 LAS VEGAS NV 89147-6454	12535101007
GONZALES JEANINE J	5625 AFRICAN LILLY CT LAS VEGAS NV 89130-4991	12527815039
GOWER-SKALA LIVING TRUST	GOWER DONNIE G TRS 5524 GREEN WILLOW ST LAS VEGAS NV 89130-1646	12534511063
GRAY TARA DONENE	5640 BALSAM ST LAS VEGAS NV 89130-1106	12527815046
GRIMBLOT ERIC	5635 FOXGLOVE FIELDS ST LAS VEGAS NV 89130	12527819089
GROHS CHARLES & CAREY	6901 BOTTLE SAGE AVE LAS VEGAS NV 89130-1651	12534511021
GTATREAKS RONALD C & SARAPEE	5501 GREEN WILLOW ST LAS VEGAS NV 89130-1647	12534511068
GUERRERO ARMANDO & MARIA	5516 GOLDBRUSH LAS VEGAS NV 89130-1655	12534511031
GUEVARA ANDREW	6801 WHITE LAKES AVE LAS VEGAS NV 89130-1661	12534614032
GUEVARA CARLO T	5513 FLORA SPRAY ST LAS VEGAS NV 89130-1697	12534513012
GUILIANO LORI M	6520 GRAY JUNIPER AVE LAS VEGAS NV 89130-4807	12535111075
GUNNY GARY L & SHERI LABRUM	5409 FLOWERING BUSH CT LAS VEGAS NV 89130-1676	12534512020
GUTIERREZ BUENERES V	5663 BALSAM ST LAS VEGAS NV 89130	12527819030
GUTIERREZ MARIA ESTHER	6808 FRUIT FLOWER AVE LAS VEGAS NV 89130-1664	12534512006
GUTIERREZ RAUL JR	LEAL IVONNE 5675 BALSAM ST LAS VEGAS NV 89130	12527819033
HAAR MARIA CORAZON LIVING TRUST	HAAR MARIA CORAZON TRS 5525 ROSE THICKET ST LAS VEGAS NV 89130-1653	12534511051
HAGEN CHARLES & DEBRA	6808 WHITE LAKES AVE LAS VEGAS NV 89130-1659	12534614008
HALL C D L L C	5348 N RAINBOW BLVD LAS VEGAS NV 89130-1602	12535201020
HALL JOHN R & GLENDA S	DILLER RICHARD C & JHONNA G 5398 N RAINBOW LAS VEGAS NV 89130-1607	12535201018
HALL LEROY E & BRANDY T	5508 FLORA SPRAY ST LAS VEGAS NV 89130-1694	12534514029

Report of All Selected Parcels**Case Number:** GPA-60977: ZON-60978; SUP-60980; : SUP-60982 & SDR-60983**Printed On:** Mon: September 14, 2015

<u>Owner</u>	<u>Address</u>	<u>Parcel Numbe</u>
HAMAWI BURKAN & MEGAN O	5805 KANE HOLLY ST LAS VEGAS NV 89130	12527714007
HAMILTON DEIDRA	HUFNAGLE AARON 6719 SCARLET STAR AVE LAS VEGAS NV 89130-4995	12527818004
HANCOCK JERRY A	KOLENDA BARBARA L 6521 W HAMMER LN LAS VEGAS NV 89130-1702	12535215004
HANSON FAMILY TRUST	HANSON CLYDE E & VICKI TRS 5400 CARNATION MEADOW ST LAS VEGAS NV 89130-3821	12534514015
HARMON CATHIE	5509 CARNATION MEADOW ST LAS VEGAS NV 89130-1693	12534513037
HARRIS ELBERT	6701 WHITE LAKES AVE LAS VEGAS NV 89130-1663	12534614017
HARRISON MERCY	6715 SCARLET STAR AVE LAS VEGAS NV 89130	12527818003
HARTOUNIAN VAHIK	416 AUDREYNE AVE GLENDALE CA 91202	12527815016
HAYASHI ALAN M & ESTELLE M REVOC	HAYASHI ALAN M & ESTELLE M CO-TR 1947 9TH AVE HONOLULU HI 96816	12527816005
HE XIN PING	6513 TAYLOR CREEK AVE LAS VEGAS NV 89130-4805	12535111044
HECKARD DAVID L & D'ANDREA P	5510 PORCUPINE RIM ST LAS VEGAS NV 89130-4803	12535111064
HEISTER JAY B	5533 REBECCA RD LAS VEGAS NV 89130-1706	12535102011
HENDRICKSON ALLEN L & ARLENE L	HENDRICKSON ALLEN STEVE 5509 GOLDBRUSH ST LAS VEGAS NV 89130-1656	12534511040
HENRIQUEZ JULIO C & VILMA	6821 BOTTLE SAGE AVE LAS VEGAS NV 89130-1649	12534511022
HENRIQUEZ RUSSELL L & GUADALUPE	5726 WINTER CHERRY ST LAS VEGAS NV 89130-5006	12527817004
HEREDIA ALBERTO	5505 GREEN WILLOW ST LAS VEGAS NV 89130-1647	12534511018
HERRERA MANUEL A & DAISY L	6932 YELLOW COSMDS AVE LAS VEGAS NV 89130	12527819014
HEYBORNE SHARON KAY REVOCABLE LI	5412 FLOWERING BUSH CT LAS VEGAS NV 89130-1676	12534512024
HICKS BRIAN C & BRENDA A	6550 W HAMMER LN LAS VEGAS NV 89130-1707	12535103010
HICKS JANICE SUSAN & KEVIN	6540 W HAMMER LN LAS VEGAS NV 89130-1707	12535103011
HIGHLAND GROVE HOMEOWNERS ASSN	630 TRACE CENTER DR #100 LAS VEGAS NV 89119	12527815056
HIGHLAND GROVE HOMEOWNERS ASSN	630 TRACE CENTER DR #100 LAS VEGAS NV 89119	12527816042
HIGHLAND GROVE HOMEOWNERS ASSN	630 TRACE CENTER DR #100 LAS VEGAS NV 89119	12527815055
HIGHLAND GROVE HOMEOWNERS ASSN	630 TRACE CENTER DR #100 LAS VEGAS NV 89119	12527816037
HIGHLAND GROVE HOMEOWNERS ASSN	630 TRACE CENTER DR #100 LAS VEGAS NV 89119	12527815053
HIGHLAND GROVE HOMEOWNERS ASSN	630 TRACE CENTER DR #100 LAS VEGAS NV 89119	12527815052
HIGHLAND GROVE HOMEOWNERS ASSN	630 TRACE CENTER DR #100 LAS VEGAS NV 89119	12527815058
HIGHLAND GROVE HOMEOWNERS ASSN	630 TRACE CENTER DR #100 LAS VEGAS NV 89119	12527815057
HIGHLAND GROVE HOMEOWNERS ASSN	630 TRACE CENTER DR #100 LAS VEGAS NV 89119	12527815054
HILL CHRISTOPHER & CHANOTIP	CHINASAI CHALIE 6504 GRAY JUNIPER AVE LAS VEGAS NV 89130-4807	12535111071
HINDMAN SAMUEL H	5639 FOXGLOVE FIELDS ST LAS VEGAS NV 89130	12527819090
HIRSCHUBER JOSHUA & KELLY	5622 BISHOP FLOWERS ST LAS VEGAS NV 89130	12527819071

Report of All Selected Parcels**Case Number:** GPA-60977: ZON-60978; SUP-60980; ;
SUP-60982 & SDR-60983**Printed On:** Mon: September 14, 2015

<u>Owner</u>	<u>Address</u>	<u>Parcel Numbe</u>
HOLMES PAMELA D	6909 GLEN LANDING LAS VEGAS NV 89130-4909	12527814002
HOLST CLEM & DIANE TRUST	HOLST CLEMENT L & YVONNE D TRS 720 ARBOR POINTE AVE GUSTINE CA 95322	12527819056
HOLST CLEM & DIANE TRUST	HOLST CLEMENT L & YVONNE D TRS 720 ARBOR POINTE AVE GUSTINE CA 95322	12527819077
HOOPER DAN	9048 LITTLE ARROW CT LAS VEGAS NV 89143	12534513033
HOPKINS DANIEL B & DIANA J	1620 SONGLIGHT CT LAS VEGAS NV 89117-1583	12534511003
HOWE RAYMOND & EILEEN FAMILY TRU	HOWE RAYMOND J & EILEEN TRS 6901 GLEN LANDING AVE LAS VEGAS NV 89130-4909	12527814001
HOWELL GARY D & GAYE LEINN	5627 LUSITANO ST LAS VEGAS NV 89130-1262	12526411018
HOWLETT RICHARD B	P O BOX 211101 CRESCENT VALLEY NV 89821-1101	12534511056
HUCKEBA JOHN C & DONNA	6448 TINA LN LAS VEGAS NV 89130-1710	12535102021
HUDSON WILLIAM & C FAM TR	HUDSON CHARLAINE TRS 5619 LUSITANO ST LAS VEGAS NV 89130-1262	12526411017
HUDSPETH ROBERT & L M REV LIV TR	HUDSPETH ROBERT T & LISA M TRS 6441 W ANN RD LAS VEGAS NV 89130-1211	12535102005
HUFF JAN	5740 WINTER CHERRY ST LAS VEGAS NV 89130-5006	12527817006
INCHAUSTI DANIEL C	5530 MOONLIGHT GARDEN ST LAS VEGAS NV 89130-4998	12535111031
INDVIK LAURIE	5664 BISHOP FLOWERS ST LAS VEGAS NV 89130	12527819027
INIBA-OFIANA LERMA	5668 BISHOP FLOWERS ST LAS VEGAS NV 89130	12527819026
J & J SERIES L L C	6900 ROSE PETAL AVE LAS VEGAS NV 89130-1658	12534511010
JACKSON CHARLES R JR & PATRICIA	6825 FRUIT FLOWER AVE LAS VEGAS NV 89130-1667	12534512011
JACOBS NICOLETTE & DONTA LEVITE	5621 AFRICAN LILLY CT LAS VEGAS NV 89130-4991	12527815038
JANETTE CHARLES D & CHRISTINE K	6544 LOKAI AVE LAS VEGAS NV 89130-1261	12526411021
JAQUEZ SANTOS	5666 PRIMROSE PEAK CT LAS VEGAS NV 89130	12527819055
JENSEN RONALD L & KITTY L	5631 GILBERT LN LAS VEGAS NV 89130-1225	12526410009
JENSON FREDRICK M	1013 COBBLESTONE COVE RD NORTH LAS VEGAS NV 89081-3071	12534513018
JOB LISA M	5535 GEMINI BRIDGES ST LAS VEGAS NV 89130	12535111003
JOHNSON DEREK	6708 WHITE LALES AVE LAS VEGAS NV 89130	12534614014
JOHNSON FORREST D REV LIV TR	JOHNSON FORREST DALE TRS 6252 FISHER AVE LAS VEGAS NV 89130-2144	12534511042
JOHNSON JOANN	5416 CARNATION MEADOW ST LAS VEGAS NV 89130-3821	12534513027
JOHNSON NEIL E REVOCABLE TR	JOHNSON NEIL E TRS 8455 FOUNTAIN AVE #210 WEST HOLLYWOOD CA 90069-2531	12534614002
JOINES FAMILY TRUST	6905 BOTTLE SAGE DR LAS VEGAS NV 89130-1651	12534511067
JURKOFKY ROBERT L & ELAINE S	6609 SAND BENCH AVE LAS VEGAS NV 89130-4801	12535111054
KALCHBRENNER DIANA L	6531 W EL CAMPO GRANDE AVE LAS VEGAS NV 89130-1215	12526403001
KANIPE JOAN	O'BRIEN CYNTHIA 5809 GLENMERE AVE LAS VEGAS NV 89131	12534511007
KAPNER HARVEY	5412 FLORA SPRAY ST LAS VEGAS NV 89130-3843	12534514036

Report of All Selected Parcels

Case Number: GPA-60977; ZON-60978; SUP-60980; ;
SUP-60982 & SUP-60983

Printed On: Mon: September 14, 2015

<u>Owner</u>	<u>Address</u>	<u>Parcel Numbe</u>
KARYDAS KONSTANTINOS & SHAWN	5641 AFRICAN LILLY CT LAS VEGAS NV 89130	12527815043
KATRI LENORE J	4145 S SILVERADO DR IDAHO FALLS ID 83404-7788	12527818007
KATTERHEINRICH ANITA J	1599A 39TH ST LOS ALAMOS NM 87544-2899	12526402014
KELLY RICHARD & RACHEL E	5501 FLORA SPRAY ST LAS VEGAS NV 89130-1695	12534514026
KEMPF LAURENCE M & MAUREEN	6613 MANZANITA GLEN AVE LAS VEGAS NV 89130-4997	12535111016
KERR STANLEY F JR & TAMMY L	5522 PORCUPINE RIM ST LAS VEGAS NV 89130-4803	12535111067
KLEMZ JOHN & MISTY	5634 BISHOP FLOWERS ST LAS VEGAS NV 89130	12527819068
KLINKNER KELLY & DIANNA	5604 LUSITANO ST LAS VEGAS NV 89130-1262	12526411014
KLINKNER PAMELA GAIL & M REV TR	KLINKNER PAMELA GAIL & M E TRS 158 OAKRIDGE DR DAYTON NV 89403	12527816033
KNELL AARON & MAUREEN	5434 PORCUPINE RIM ST LAS VEGAS NV 89130-4802	12535111060
KNELL AARON P & MAUREEN	6817 BAYBERRY CREEK CT LAS VEGAS NV 89130-5004	12527816028
KNELL AARON P & MAUREEN G	5434 PORCUPINE RIM ST LAS VEGAS NV 89130-4802	12527816029
KNOBLE LAQUAL N & JARED M	5517 PORCUPINE RIM ST LAS VEGAS NV 89130-4803	12535111035
KNOX FAMILY LIVING TRUST ETAL	KNOX TYRONE TRS P O BOX 570954 LAS VEGAS NV 89157-0954	12535111042
KOZLOWICZ FAMILY TRUST	KOZLOWICZ GREGORY MICHAEL & LIND 6519 LOKAI AVE LAS VEGAS NV 89130	12526411005
KUSTOSZ JOSEPH C D & CACEY L	5665 PRIMROSE PEAK CT LAS VEGAS NV 89130	12527819052
LAAM GLORIA W LIVING TRUST	508 GOLDBRUSH ST LAS VEGAS NV 89130	12534511029
LAMBERT CARL E & BRONIE S	5428 FLORA SPRAY ST LAS VEGAS NV 89130-3839	12534514032
LANATA MICHAEL L	6908 BOTTLE SAGE AVE LAS VEGAS NV 89130-1650	12534511058
LARSON STEVEN R & SHARON	6712 ROSE PETAL LAS VEGAS NV 89130-1687	12534513003
LARY MICHAEL P & CECILIA L	5808 KANE HOLLY ST LAS VEGAS NV 89130-4942	12527714012
LAUB ELMER B & CICELIA K	6781 HAVEN HOLLOW AVE LAS VEGAS NV 89130-4912	12527714015
LAWRENCE DAVID EUGENE & KERRY L	6465 W ANN RD LAS VEGAS NV 89130-1211	12535102002
LAYAG ANTONIO L & LUCIA D	6805 WHITE LAKES AVE LAS VEGAS NV 89130-1661	12534614033
LESKO JOSEPH M & CHRISTINA	6800 SNAKE RIVER AVE LAS VEGAS NV 89130-1669	12534614043
LETUS KEITH A	6604 W MANZANITA GLEN AVE LAS VEGAS NV 89130-4997	12535111017
LEWIS REBECCA R	6527 LOKAI AVE LAS VEGAS NV 89130-1260	12526411006
LEYVA JOSE L	ARCHIBEQUE CIARA A 5529 CARNATION MEADOW ST LAS VEGAS NV 89130	12534513042
LI TAO & SERENE	12814 SEABREEZE FARMS DR SAN DIEGO CA 92130	12527816026
LIEDER FAMILY TRUST	LIEDER GERALD V & MARILYN R TRS 6812 WHITE LAKES AVE LAS VEGAS NV 89130-1659	12534614007
LIENDO RAMON ALBERTO URBEAZ	5620 FOXGLOVE FIELDS ST LAS VEGAS NV 89130	12527819087
LILORE CHARLES & PATRICIA	5417 FLOWERING BUSH CT LAS VEGAS NV 89130-1676	12534512022

Report of All Selected Parcels

Case Number: GPA-60977: ZON-60978; SUP-60980;
SUP-60982 & SDR-60983

Printed On: Mon: September 14, 2015

<u>Owner</u>	<u>Address</u>	<u>Parcel Numbe</u>
LINNEAR BEVERLY ART	6704 WHITE LAKES AVE LAS VEGAS NV 89130-1663	12534614015
LIRA ERICA M	5673 AFRICAN LILLY CT LAS VEGAS NV 89130-4992	12527815009
LOCASCIO CARMELA REV LIV TR	LOCASCIO CARMELA TRS 6700 SNAKE RIVER AVE LAS VEGAS NV 89130-1679	12534614026
LONG C L REVOCABLE LIVING TRUST	5800 GRAND HERITAGE ST LAS VEGAS NV 89130-4938	12527714006
LOPEZ SAMUEL	6818 BRIARWOOD BEND AVE LAS VEGAS NV 89130-5005	12527816035
LOVE SANDRA L	6802 WEEPING FIG CT LAS VEGAS NV 89130-5007	12527816015
LOVEGROVE LYNNE A & DOUGLAS R	HARDY GAIL E 6500 W HAMMER LN LAS VEGAS NV 89130-1707	12535103013
LOZZI THOMAS	ADAIR VALERIE 9340 PITCHING WEDGE DR LAS VEGAS NV 89134-6336	12526410007
LU DONNAH LYZETTE & GEORGE KYLE	5696 BISHOP FLOWERS ST LAS VEGAS NV 89130	12527819019
LUCIANI ROBERT & HEIKE	6701 FRUIT FLOWER AVE LAS VEGAS NV 89130-3849	12534514003
LUKER CHELSEA E	5524 FLORA SPRAY ST LAS VEGAS NV 89130-1696	12534513008
LUKEY'S FAMILY TRUST	CORRAL LUCRETIA G TRS 5760 GILBERT LN LAS VEGAS NV 89130-1228	12526402004
LUNSFORD THOMAS W	5420 FLORA SPRAY ST LAS VEGAS NV 89130-3843	12534514034
LUONG TAM TRONG	6816 ROSE PETAL AVE LAS VEGAS NV 89130-1657	12534511005
LYNCH CARL R & ROSE MARIE	5513 CARNATION MEADOW ST LAS VEGAS NV 89130-1693	12534513038
LYNCH WYATT	5631 BISHOP FLOWERS ST LAS VEGAS NV 89130	12527819080
MAANAO PETER J JR	5507 GEMINI BRIDGES ST LAS VEGAS NV 89130	12535111010
MACLEAN JAMES E & DARLENE J	5628 FOXGLOVE FIELDS ST LAS VEGAS NV 89130	12527819085
MADDEN PRENTISS K	5640 FOXGLOVE FIELDS ST LAS VEGAS NV 89130	12527819082
MARCOM NORA H	5524 ROSE THICKET ST LAS VEGAS NV 89130-1652	12534511048
MARKLE DIANE L & HERBERT E	5800 KANE HOLLY ST LAS VEGAS NV 89130-4942	12527714014
MARSHALL FAMILY TRUST	5513 GREEN WILLOW ST LAS VEGAS NV 89130-1647	12534511016
MARTINEZ JOSE A	6794 BAYBERRY CREEK CT LAS VEGAS NV 89130-4999	12527816022
MARTINEZ MICHAEL ANTHONY	5605 BALSAM ST LAS VEGAS NV 89130	12527819060
MARTINEZ RICHARD ANTHONY JR	5416 ROSE THICKET ST LAS VEGAS NV 89130-1674	12534512034
MATA ROBINSON R	6608 MANZANITA GLEN AVE LAS VEGAS NV 89130-4997	12535111018
MATHE JAMES B & VICKY L	5509 ROSE THICKET ST LAS VEGAS NV 89130	12534511055
MCALPIN MICHAEL L	MCALPIN EDWARD D & THELMA F 5611 GILBERT LN LAS VEGAS NV 89130-1225	12526410008
MCCAMISH KELLY	MCCAMISH KEVIN & DONNA 5635 LUSITANO ST LAS VEGAS NV 89130-1262	12526411019
MCCARTHY MICHAEL E & SUSAN L	5401 CARNATION MEADOW ST LAS VEGAS NV 89130-3822	12534514012
MCCLURE KENNETH R & JACKIE A	5504 FLORA SPRAY ST LAS VEGAS NV 89130-1694	12534514030
MCEVOY EDWARD G III & ELLEN T	5643 LUSITANO ST LAS VEGAS NV 89130-1262	12526411020

Report of All Selected Parcels**Case Number:** GPA-60977; ZON-60978; I; SUP-60980;
SUP-60982 & SDR-60983**Printed On:** Mon: September 14, 2015

<u>Owner</u>	<u>Address</u>	<u>Parcel Number</u>
MCGOWAN SHANNON	5420 CARNATION MEADOW ST LAS VEGAS NV 89130-3821	12534513026
MCKNIGHT CECILIA	6713 FRUIT FLOWER AVE LAS VEGAS NV 89130-3849	12534514006
MCMCGARRY RICHARD L	HOFFMAN-KYLE LYNN 5612 LUSITANO ST LAS VEGAS NV 89130-1262	12526411013
MECHAM YVONNE M	6800 FRUIT FLOWER AVE LAS VEGAS NV 89130-3850	12534514011
MELTON STEPHANIE	6812 BOTTLE SAGE AVE LAS VEGAS NV 89130-1648	12534511041
MENDOZA JOSE L	6509 SAND BEACH AVE LAS VEGAS NV 89130	12535111058
MERCURIO CURTIS G	SWANSON STEPHANIE L 5519 GEMINI BRIDGES ST LAS VEGAS NV 89130-4996	12535111007
MIANECKI & SHAWMIANECKI RV LV TR	MIANECKI BRUCE E TRS 6520 LOKAI AVE LAS VEGAS NV 89130-1260	12526411024
MILLER JOHN J III & CAROL A	6900 WHITE LAKES AVE LAS VEGAS NV 89130-1654	12534613001
MILTON JO A	REESE KIMBERLY 5785 N RAINBOW BLVD LAS VEGAS NV 89130-1230	12527803001
MIRKA MISHA	6818 WEEPING FIG CT LAS VEGAS NV 89130-5007	12527816017
MOLINA EDWIN T & ZARINA B	6712 SNAKE RIVER AVE LAS VEGAS NV 89130-1679	12534614023
MONAGHAN FARMS INC	P O BOX 1159 DEERFIELD IL 60015	12527803007
MOONEY MILDRED F & LYNN M	5517 FLORA SPRAY ST LAS VEGAS NV 89130-1697	12534513013
MOORE RHIANNON & JASON	5610 BISHOP FLOWERS ST LAS VEGAS NV 89130	12527819074
MORAWSKI FAMILY TRUST	MORAWSKI CHRISTOPHER & I TRS 9408 BRILLIANT ORE DR LAS VEGAS NV 89143	12534513015
MORGAN GUY A & JOY L	2140 HOT OAK RIDGE ST LAS VEGAS NV 89134	12535111014
MURILLO ANGELA	5663 FOXGLOVE FIELDS ST LAS VEGAS NV 89130	12527819001
MYERS BERNARD D & SU CHOL	MYERS STEVE & NATHALIE 5417 FLORA SPRAY ST LAS VEGAS NV 89130-3844	12534514021
NATH JEFFREY ALAN & MARISA TELEN	5512 GOLDBRUSH ST LAS VEGAS NV 89130-1655	12534511030
NEAFSEY BRIAN & LOIS	5620 LUSITANO ST LAS VEGAS NV 89130-1262	12526411012
NETSKI JUDITH A	5400 FLORA SPRAY LAS VEGAS NV 89130-3838	12534514002
NETZ RAYMOND L	6551 HAMMER LN LAS VEGAS NV 89130-1702	12535215001
NEWMAN AUSTIN & KATIE	5691 BALSAM ST LAS VEGAS NV 89130	12527819037
NGUYEN LINA N	5530 PORCUPINE RIM ST LAS VEGAS NV 89130-4803	12535111069
NORRIS NANCY L	6785 HAVEN HOLLOW AVE LAS VEGAS NV 89130-4912	12527714016
NOVOTNY FAMILY LIVING REV TR	6660 W ANN RD LAS VEGAS NV 89130-1214	12526402012
NUNGARAY DANIEL	6916 YELLOW COSMOS AVE LAS VEGAS NV 89130	12527819018
O'LARK LIVING TRUST ETAL	OHMAN-CLARK LINDA TRS 7065 W ANN RD #130-532 LAS VEGAS NV 89130-3865	12534511057
OLARTE JAVIER	5664 ORANGEROOT CT LAS VEGAS NV 89130-4994	12527815024
OLZASKI DENISE R	5512 FLORA SPRAY ST LAS VEGAS NV 89130-1696	12534513039
OLZASKI-THOMAS DENISE	5512 FLORA SPRAY ST LAS VEGAS NV 89130-1696	12534513011

Report of All Selected Parcels

Case Number: GPA-60977; ZON-60978; SUP-60980;
SUP-60982 & SDR-60983

Printed On: Mon: September 14, 2015

<u>Owner</u>	<u>Address</u>	<u>Parcel Numbe</u>
O'MALLEY TONI J & BRIAN P	6512 GRAY JUNIPER AVE LAS VEGAS NV 89130-4807	12535111073
ORTEGA CARLOS	5525 GOLDBRUSH ST LAS VEGAS NV 89130-1656	12534511036
OSOS JAMES ERICH & DEBORAH J	8289 JO MARCY DR LAS VEGAS NV 89131-4625	12534614009
P & J KLIMEK TRUST	KLIMEK PHILLIP & JODIE LYNN TRS 6705 FRUIT FLOWER AVE LAS VEGAS NV 89130-3849	12534514004
PACIFIC COAST DEVELOPEMENT	6293 DEAN MARTIN DR #G LAS VEGAS NV 89118-3845	12526411037
PACIFIC COAST DEVELOPEMENT	6293 DEAN MARTIN DR #G LAS VEGAS NV 89118-3845	12526411036
PACIFIC COAST DEVELOPEMENT	6293 DEAN MARTIN DR #G LAS VEGAS NV 89118-3845	12526411035
PAGE JEFFREY & JENNIFER	6793 WEEPING FIG CT LAS VEGAS NV 89130-5007	12527816021
PAGE MICHAEL S	5525 PORCUPINE RIM ST LAS VEGAS NV 89130-4803	12535111033
PAINE SHAWN R	1 W SUPERIOR #1209 CHICAGO IL 60654	12527815041
PATINO-MONTANO OBRYAN	JARAMILLO-ALVARADO STAR 5669 BISHOP FLOWERS ST LAS VEGAS NV 89130	12527819059
PATRICK JOHN V & SHARON M	5520 GREEN WILLOW ST LAS VEGAS NV 89130-1646	12534511062
PAVLIGA STEVEN	LODGE KELLY 6801 WEEPING FIG CT LAS VEGAS NV 89130-5007	12527816020
PAYGUN FAMILY TRUST	DODDS WALTER TADD & DEBI E TRS 5640 GILBERT LN LAS VEGAS NV 89130-1228	12526402013
PAYNE ANTHONY	BOYD-PAYNE LAKESHA 6817 BOTTLE SAGE AVE LAS VEGAS NV 89130	12534511023
PEARSON FAMILY TRUST	PEARSON KEITH H & MARIA T TRS 5710 N RAINBOW BLVD LAS VEGAS NV 89130-1247	12526410003
PECHACEK NATHAN & LISA	6543 LOKAI AVE LAS VEGAS NV 89130-1261	12526411008
PECKHAM JESSE G	6908 WHITE LAKES AVE LAS VEGAS NV 89130-1654	12534613003
PENA CARLOS M	6716 ROSE PETAL AVE LAS VEGAS NV 89130-1687	12534513002
PERCELL SEAN R	8300 NICE CT LAS VEGAS NV 89129	12527810004
PEREZ FERNANDO	5669 DANCING ORCHID CT LAS VEGAS NV 89130	12527815028
PEREZ JORGE C & MARIA L	PEREZ DIANA 6900 FRUIT FLOWER AVE LAS VEGAS NV 89130-1668	12534512028
PETKOVICH MARIE	5672 AFRICAN LILLY CT LAS VEGAS NV 89130-4992	12527815012
PETRIANO RICHARD	6825 BRIARWOOD BEND AVE LAS VEGAS NV 89130-5005	12527816001
PHAM ANH N	6612 MANZANITA GLEN AVE LAS VEGAS NV 89130-4997	12535111019
PICKENS KAREN	5609 BALSAM ST LAS VEGAS NV 89130	12527819061
PITCHER ROBERT W & MARIA L	5520 ROSE THICKET ST LAS VEGAS NV 89130	12534511047
PLA JOHN F & MIGUEL	1323B E ST GERTRUDE PL SANTA ANA CA 92705	12535104004
PLATZEK ROGER F & CARA S	1033 N CO RD 27 E BERTHOUD CO 80513-8716	12534614056
POCINO CHRISTOPHER L & VERONICA	5521 CARNATION MEADOW ST LAS VEGAS NV 89130-1693	12534513040
PRACTICAL RENEWABLE ENERGY CORP	5435 N RAINBOW BLVD LAS VEGAS NV 89130	12535103001
PRICE FAMILY TRUST	PRICE BRYAN E & MARY JOY M TRS 6900 ROSE PETAL AVE LAS VEGAS NV 89130-1658	12534511009

Report of All Selected Parcels**Case Number:** GPA-60977; ZON-60978; ; SUP-60980; SUP-60982 & SDR-60983**Printed On:** Mon: September 14, 2015

<u>Owner</u>	<u>Address</u>	<u>Parcel Numbe</u>
PROGRESS RESIDENTIAL 2014-1 BORR	909 N SEPULVEDA BLVD #840 EL SEGUNDO CA 90245	12527815022
PROGRESS RESIDENTIAL 2014-1 BDRR	909 N SEPULVEDA BLVD #840 EL SEGUNDO CA 90245	12534513036
PROGRESS RESIDENTIAL 2014-1 BORR	909 N SEPULVEDA BLVD #840 EL SEGUNDO CA 90245	12534512042
PROGRESS RESIDENTIAL 2015-1 BDRR	7702 E DOUBLETREE RANCH RD #100 SCOTTSDALE AZ 85258	12534614021
PRDGRESS RESIDENTIAL 2015-2 BORR	7702 E DDUBLETREE RANCH RD #100 SCOTTSSOALE AZ 85258	12534613069
PROGRESS RESIDENTIAL 2015-2 BDRR	7702 E DOUBLETREE RANCH RD #100 SCOTTSDALE AZ 85258	12535215022
PROSSER HELENE & STACEY JANE	6913 GLEN LANDING AVE LAS VEGAS NV 89130-4909	12527814003
PRUSS JONATHAN	5618 BISHOP FLOWERS ST LAS VEGAS NV 89130	12527819072
QUITON JANICE	5529 GREEN WILLOW ST LAS VEGAS NV 89130-1647	12534511012
RABIN HARRY & SYLVIA REV TR ETAL	RABIN DAVID & JEANNIE TRS 2869 LOS CEDROS CIR CAMARILLO CA 93012	12535111026
RAINBOW ANN 1 L L C	719 OAKBRIDGE CT NORTH LAS VEGAS NV 89032	12535101001
RAINBOW ANN 1 L L C	719 DAKBRIDGE CT NORTH LAS VEGAS NV 89032	12535101002
RAINES JAMES W & AUDREY E	6616 MANZANITA GLEN AVE LAS VEGAS NV 89130-4997	12535111020
RAMOS JOSE T & CLAUDIA	5523 GEMINI BRIDGES ST LAS VEGAS NV 89130-4996	12535111006
RANGEL JDRGE L	7001 DRAMATIC WY LAS VEGAS NV 89130-1140	12527810003
RATLIFF GARY L & JEANETTE	6904 GLEN LANDING AVE LAS VEGAS NV 89130-4908	12527814015
RATNER DALE & MARTA	6813 BOTTLE SAGE AVE LAS VEGAS NV 89130-1649	12534511024
RAU JAMES A SR	DERMODY JUDITH A 6517 SAND BENCH AVE LAS VEGAS NV 89130-4800	12535111056
REBECCA MANDR WATER USERS ASSN	5517 REBECCA RD LAS VEGAS NV 89130-1706	12535102019
REDA FRANCIS X & ANNETTE	6916 WHITE LAKES AVE LAS VEGAS NV 89130-1654	12534613005
REED THEODORE J & MARCIA A	6504 SAND BENCH AVE LAS VEGAS NV 89130-4800	12535111047
RENDUDE VICTORIA R	CANTRELL TRACY R 5404 GOLDBRUSH ST LAS VEGAS NV 89130-1671	12534512004
REDCH DEBRA J	5640 N RAINBOW BLVD LAS VEGAS NV 89130-1236	12526410006
REV1 HOMES LIMITED	2881 SKOWHEGAN DR HENDERSON NV 89074	12534512008
RICHARDS CHRISTOPHER & JENNIFER	6809 BRIARWOOD BEND AVE LAS VEGAS NV 89130-5005	12527816003
RICHMOND AMERICAN HOMES NEVADA	4350 S MONACO ST #400 DENVER CO 80237-3400	12527817008
RICHMOND AMERICAN HOMES NEVADA	4350 S MDNACO ST #400 DENVER CO 80237-3400	12527817009
RICHMOND AMERICAN HOMES NEVADA	4350 S MONACO ST #400 DENVER CO 80237-3400	12527817007
RICHMOND AMERICAN HOMES NEVADA	4350 S MONACO ST #400 DENVER CO 80237-3400	12527816038
RICHMOND AMERICAN HOMES NEVADA I	7770 S DEAN MARTIN DR #308 LAS VEGAS NV 89139	12526401002
RICHMDND AMERICAN HOMES NEVADA I	7770 S DEAN MARTIN DR #308 LAS VEGAS NV 89139	12526304007
RICHMOND AMERICAN HOMES NEVADA I	7770 S DEAN MARTIN OR #308 LAS VEGAS NV 89139	12526304006

Report of All Selected Parcels

Case Number: GPA-60977; ZON-60978; SUP-60980;
SUP-60982 & SDR-60983

Printed On: Mon: September 14, 2015

<u>Owner</u>	<u>Address</u>	<u>Parcel Number</u>
RICHMOND AMERICAN HOMES NEVADA I	7770 S DEAN MARTIN DR #308 LAS VEGAS NV 89139	12526401003
RICHMOND AMERICAN HOMES NEVADA I	7770 S DEAN MARTIN DR #308 LAS VEGAS NV 89139	12526304008
RICHMOND AMERICAN HOMES NEVADA I	7770 S DEAN MARTIN DR #308 LAS VEGAS NV 89139	12526304005
RICHMOND AMERICAN HOMES NEVADA I	7770 S DEAN MARTIN DR #308 LAS VEGAS NV 89139	12526401001
RICHMOND AMERICAN HOMES NV INC	4350 S MONACO ST DENVER CO 80237	12527819063
RICHMOND AMERICAN HOMES NV INC	4350 S MONACO ST DENVER CO 80237	12527819065
RICHMOND AMERICAN HOMES NV INC	4350 S MONACO ST DENVER CO 80237	12527819066
RICHMOND AMERICAN HOMES NV INC	4350 S MONACO ST DENVER CO 80237	12527819062
RICHTER JAMES F	WESSELDINE LISA & TYLER 6948 YELLOW COSMOS AVE LAS VEGAS NV 89130	12527819010
RICHTER JAMES F	5624 FOXGLOVE FIELDS ST LAS VEGAS NV 89130	12527819086
RIDEOUT DIANE E	5416 GOLDBRUSH ST LAS VEGAS NV 89130-1671	12534512001
RINALDI DEBBIE	6449 W ANN RD LAS VEGAS NV 89130-1211	12535102004
RIO VISTA PLAZA L L C	P O BOX 11568 NEWPORT BEACH CA 92658-5034	12534515003
RIVER OF LIFE MINISTRIES INC	5300 N RAINBOW BLVD LAS VEGAS NV 89130	12535201006
ROADVILLE JOHN M & PATTI JO	6809 FRUIT FLOWER AVE LAS VEGAS NV 89130-1665	12534512007
ROBERTS CALVIN L	LUCERO NOEMI 6915 YELLOW COSMOS AVE LAS VEGAS NV 89130	12527819039
ROBERTSON THOMAS R 2004 TRUST	5401 REBECCA RD LAS VEGAS NV 89130-1703	12535104010
ROBINSON LEE & KATHY	5525 CARNATION MEADOW ST LAS VEGAS NV 89130	12534513041
ROCHA BRYAN & TENICE C	5668 BALSAM ST LAS VEGAS NV 89130-1106	12527815003
RODNEY MARK A & KARRAH L	6808 SNAKE RIVER AVE LAS VEGAS NV 89130-1669	12534614041
RODRIGUEZ JOHN M	5670 FOXGLOVE FIELDS ST LAS VEGAS NV 89130	12527819048
ROGERS PAUL D & STEPHANIE D	6444 TINA LN LAS VEGAS NV 89130-1710	12535102022
ROSALES GLORIA	5665 AFRICAN LILY CT LAS VEGAS NV 89130-4992	12527815007
ROSSETTI DENICE M	5610 GILBERT LN LAS VEGAS NV 89130-1228	12526402011
ROXAS NICANOR R & ERLINDA A	6812 SNAKE RIVER AVE LAS VEGAS NV 89130-1669	12534614040
ROYBAL FAMILY TRUST	ROYBAL BERNIE L GRACE N TRS 5508 GREEN WILLOW ST LAS VEGAS NV 89130-1646	12534511059
RUSHING FAMILY TRUST	RUSHING THOMAS E & TONYA K 7104 SPRING BEAUTY AVE LAS VEGAS NV 89131	12534614022
S F R INVESTMENTS POOL I L L C	5030 PARADISE RD #B-214 LAS VEGAS NV 89119	12535111004
SAGE DOUGLAS & ANITA REV LIV TR	SAGE DOUGLAS & ANITA TRS 5116 HARTWELL RD SARANAC MI 48881-9761	12534512027
SAKERS YU CHAI	2115 8TH ST DR WATSONTOWN PA 17777-8006	12534512005
SALAS DEVAN DAWN & ARISTOTLE D	5620 BALSAM ST LAS VEGAS NV 89130-1106	12527815051
SALDANA VERONICA	5645 AFRICAN LILLY CT LAS VEGAS NV 89130-4992	12527815044

Report of All Selected Parcels

Case Number: GPA-60977; ZON-60978; SUP-60980; - **Printed On:** Mon: September 14, 2015
; SUP-60982 & SDR-60983

<u>Owner</u>	<u>Address</u>	<u>Parcel Number</u>
SALLOVITZ AZUL	5526 PORCUPINE RIM ST LAS VEGAS NV 89130-4803	12535111068
SAMPSON BARBARA C	5424 FLORA SPRAY ST LAS VEGAS NV 89130-3839	12534514033
SAMSAMSHARIAT SPRING	1175 E KENNEDY BLVD #N631 TAMPA FL 33602	12535111048
SANDECKI DANIEL M & JORDAN E	6928 YELLOW COSMOS AVE LAS VEGAS NV 89130	12527819015
SANDERELLA TRUST ETAL	LOVE SANDRA LEE TRS 6613 SAND BEACH AVE LAS VEGAS NV 89130	12535111053
SANDY NANCIE LEAH	6711 SCARLET STAR AVE LAS VEGAS NV 89130-4995	12527818002
SANTOS SUZETTE & RAYMOND	5695 BALSAM ST LAS VEGAS NV 89130	12527819038
SAPONARO JOSEPH JAMES & DENISE K	5405 ROSE THICKET ST LAS VEGAS NV 89130-1675	12534512030
SATICOY BAY LLC 5526 MOONLIGHT G	P O BOX 36208 LAS VEGAS NV 89133	12535111030
SAWICKI JOSEPH	5413 FLOWERING BUSH CT LAS VEGAS NV 89130-1676	12534512021
SCALES RYAN EARL & REBECCA	5424 GOLDBRUSH ST LAS VEGAS NV 89130-1671	12534511026
SCANLAN JOHN L & CAROL L	2505 ANTHEM VILLAGE DR #E608 HENDERSDN NV 89052	12527819057
SCHENCK STEVEN G & JOANNE K	6804 FRUIT FLOWER AVE LAS VEGAS NV 89130-3850	12534514010
SCHLEGEL ROBERT E	5695 N GILBERT LN LAS VEGAS NV 89130-1225	12526410012
SCHLOSSER CINDY L & JAMES R	5401 ROSE THICKET ST LAS VEGAS NV 89130-1675	12534512029
SCHOUTEN 1983 TRUST	SCHOUTEN ALBERT & MARILYN L TRS 8987 KING JDHN CT LAS VEGAS NV 89149-3221	12535103014
SCHOUTEN 1983 TRUST	SCHOUTEN ALBERT & MARILYN L TRS 8987 KING JOHN CT LAS VEGAS NV 89149-3221	12535103016
SCHUMAN FAMILY REVOCABLE LIV TR	SCHUMAN BRUCE J & SHARON J TRS 5404 N CARNATION MEADOW ST LAS VEGAS NV 89130-3821	12534514014
SCOGGINS MICHELLE JUNE	KEMP KANNON KAY 5632 BALSAM ST LAS VEGAS NV 89130-1106	12527815048
SEABORG WENDELL D & TERRY	5528 ROSE THICKET ST LAS VEGAS NV 89130-1652	12534511049
SEDMAN RDNALD D	6513 W HAMMER LN LAS VEGAS NV 89130-1702	12535215005
SELMANI SULEJMAN	385 MASON AVE HALEDON NJ 07508-1303	12535102003
SEVIGNY ELIZABETH R	6716 WHITE LAKES AVE LAS VEGAS NV 89130-1663	12534614012
SHARP ROBERT LEE & SHERYL ANN	6919 YELLOW COSMOS AVE LAS VEGAS NV 89130	12527819040
SHEPHERD JEAN M	6705 SNAKE RIVER AVE LAS VEGAS NV 89130	12534614028
SHIRLEY BRIAN J & CATHLEEN T	6521 W EL CAMPO GRANDE AVE LAS VEGAS NV 89130-1215	12526403002
SHIRLEY BRIAN J & CATHLEEN T	6521 W EL CAMPO GRANDE AVE LAS VEGAS NV 89130-1215	12526403003
SHIRLEY DALBY TRUST	SHIRLEY DALBY TRS 6511 W EL CAMPO GRANDE AVE LAS VEGAS NV 89130-1215	12526403004
SHRIVASTAVA KRISHNA & MADHULIKA	6908 GLEN LANDING AVE LAS VEGAS NV 89130-4908	12527814014
SILVEIRA DANIEL S	5714 WINTER CHERRY ST LAS VEGAS NV 89130-5006	12527817002
SIMPSON REX JAY & COLLEEN MARIE	5408 ROSE THICKET ST LAS VEGAS NV 89130-1674	12534512036

Report of All Selected Parcels

Case Number: GPA-60977; ZON-60978; SUP-60980;
SUP-60982 & SDR-60983

Printed On: Mon: September 14, 2015

<u>Owner</u>	<u>Address</u>	<u>Parcel Number</u>
SIMS CANDICE & RICHARD	5527 GEMINI BRIDGES ST LAS VEGAS NV 89130	12535111005
SKARL DALE & SUSIE	1219 STRDNG DR LAS VEGAS NV 89102	12534514031
SKIN YOU'RE INN INC	5502 LAKE CHARLES ST NORTH LAS VEGAS NV 89031-2007	12535102001
SMITH GORDON RENE & LINDA	5515 GEMINI BRIDGES ST LAS VEGAS NV 89130-4996	12535111008
SMITH MICHAEL H & CHERALYN Y	6613 GRAY JUNIPER AVE LAS VEGAS NV 89130-4806	12535111024
SMITH RICHARD F & JULIA A	5404 ROSE THICKET ST LAS VEGAS NV 89130-1674	12534512037
SMITH SCDTT & MIN	9490 COMPASS POINT DR SOUTH #4 SAN DIEGO CA 92126	12527815004
SNODDY JOHN H & SHIRLEY A	5528 CARNATION MEADOW ST LAS VEGAS NV 89130-1692	12534513017
SNYDER PAUL B & VIRGINIA T	1283 GRANADA ST UPLAND CA 91784	12526411011
SOWA GARY J & CRYSTAL	6935 YELLOW COSMOS AVE LAS VEGAS NV 89130	12527819044
SPARKS CASEY JONAS & SACHA ELENA	5425 FLORA SPRAY ST LAS VEGAS NV 89130-3840	12534514023
SPIKE ALAN R	5670 PRIMRDSE PEAK CT LAS VEGAS NV 89130	12527819054
SPISAK JASDN J & HOLLY A	5405 FLOWERING BUSH CT LAS VEGAS NV 89130-1676	12534512049
SPURK LORI A & MATTHEW A	5615 BISHOP FLOWERS ST LAS VEGAS NV 89130	12527819076
SRODES L L C	5913 CASTLEBERRY PEAK AVE LAS VEGAS NV 89131-2043	12527803005
STALEY TROY & AMANDA	5621 BALSAM ST LAS VEGAS NV 89130	12527819064
STANIULIS ANTHONY JR	5506 PORCUPINE RIM ST LAS VEGAS NV 89130-4803	12535111063
STARESINIC JENNIFER A	6905 FRUIT FLOWER AVE LAS VEGAS NV 89130-1668	12534512014
STATON GREGORY & NORIKO	5626 BISHOP FLOWERS ST LAS VEGAS NV 89130	12527819070
STEELMAN CHRISTOPHER & PRINCES	6944 YELLOW COSMOS AVE LAS VEGAS NV 89130	12527819011
STONE LINA F	6504 TAYLOR CREEK AVE LAS VEGAS NV 89130-4805	12535111037
STONE ZULMA L	5508 GEMINI BRIDGES ST LAS VEGAS NV 89130-4996	12535111013
STONER TIFFANY	5666 FOXGLOVE FIELDS ST LAS VEGAS NV 89130	12527819049
STUART JAMES E & CHERYL Y	6793 BAYBERRY CREEK CT LAS VEGAS NV 89130-4999	12527816031
SUAREZ-GUERRERO JOSE A	OTIS DESIREE J 6805 HAVEN HOLLOW AVE LAS VEGAS NV 89130-1187	12527714019
SULLIVAN JASON E & KIMBERLY G	6824 WHITE LAKES AVE LAS VEGAS NV 89130-1659	12534614004
SUNSTRUM JOSEPH & GEORGIA	6720 ROSE PETAL AVE LAS VEGAS NV 89130-1687	12534513001
SUTHERLAND RODNEY D	STIMPFL MARAGARET S 6624 GRAY JUNIPER AVE LAS VEGAS NV 89130-4806	12535111002
SWALLOW HILL L L C	11556 WHITE CLIFFS AVE LAS VEGAS NV 89138-3018	12534614029
SWANSON DUSTIN & NATALIE	5679 BALSAM ST LAS VEGAS NV 89130	12527819034
SWEET TRUST	SWEET DAVID M TRS 5668 ORANGEROOT CT LAS VEGAS NV 89130	12527815023
SWENSON WILTON G JR & MARY JO	6536 LOKAI AVE LAS VEGAS NV 89130-1261	12526411022

Report of All Selected Parcels**Case Number:** GPA-60977; ZON-60978; SUP-60980;
SUP-60982 & SDR-60983**Printed On:** Mon: September 14, 2015

<u>Owner</u>	<u>Address</u>	<u>Parcel Number</u>
SYKES WILLIE D	6901 FRUIT FLOWER AVE LAS VEGAS NV 89130-1668	12534512013
T J M TRUST	MEYER TIMOTHY J & THERESA J TRS 7965 MAVERICK ST LAS VEGAS NV 89131-2148	12527814016
TABBERNER RAYMOND S JR & RHONDA	6505 SAND BENCH AVE LAS VEGAS NV 89130-4800	12535111059
TAFF JACQUELINE J SEP PPTY TR	TAFF JACQUELINE J TRS P O BOX 19549 SACRAMENTO CA 95819	12526410010
TALWAR AMIT & SUCHIKA	SEHGAL SUMESH & RITU 8742 FOUNDERS GROVE ST CHINO CA 91708	12534613002
TANDY NOLAN W & LOIS J	5516 ROSE THICKET ST LAS VEGAS NV 89130-1652	12534511046
TAPCOM INVESTMENTS L L C	3017 BEACH VIEW CT LAS VEGAS NV 89117	12527815040
TARIN RODOLFO JR & MARTHA P	5429 FLORA SPRAY ST LAS VEGAS NV 89130-3840	12534514024
TAYLOR BRIAN & APRIL	6720 WHITE LAKES AVE LAS VEGAS NV 89130	12534614011
TAYLOR LISA A & ADAM	5664 N RAINBOW LAS VEGAS NV 89130-1236	12526410005
TENDVAHL FAMILY TRUST	TENDVAHL EUGENE D & M M CO-TRS 6727 W EL CAMPO GRANDE AVE LAS VEGAS NV 89130-1238	12526410015
TEO MERCY S	6924 YELLOW COSMOS AVE LAS VEGAS NV 89130	12527819016
TERESO CESAR	6746 SCARLETT STAR AVE LAS VEGAS NV 89130-4995	12527815014
TERRAZAS-MEZA EZEQUIEL	TERRAZAS MARIA Y 6541 W HAMMER LN LAS VEGAS NV 89130	12535215003
TESTERMAN FAMILY TRUST	TESTERMAN WARD D & BRENDA K TRS 6448 RANCHO SANTE FE DR LAS VEGAS NV 89130	12535104005
THARP DEBRA	6712 WHITE LAKES AVE LAS VEGAS NV 89130-1663	12534614013
THEROUX VICKI L	5667 FOXGLOVE FIELDS ST LAS VEGAS NV 89130	12527819002
TIMBER CREEK HOMEOWNERS' ASSN	3651 LINDELL RD #H LAS VEGAS NV 89103-1200	12535111086
TIMBER CREEK HOMEOWNERS' ASSN	3651 LINDELL RD #H LAS VEGAS NV 89103-1200	12535111079
TIMBER CREEK HOMEOWNERS' ASSN	3651 LINDELL RD #H LAS VEGAS NV 89103-1200	12535111080
TIMBER CREEK HOMEOWNERS' ASSN	3651 LINDELL RD #H LAS VEGAS NV 89103-1200	12535111084
TIMBER CREEK HOMEOWNERS' ASSN	3651 LINDELL RD #H LAS VEGAS NV 89103-1200	12535111083
TIMBER CREEK HOMEOWNERS' ASSN	3651 LINDELL RD #H LAS VEGAS NV 89103-1200	12535111085
TIMBER CREEK HOMEOWNERS' ASSN	3651 LINDELL RD #H LAS VEGAS NV 89103-1200	12535111082
TIMBER CREEK HOMEOWNERS' ASSN	3651 LINDELL RD #H LAS VEGAS NV 89103-1200	12535111087
TIMBER CREEK HOMEOWNERS' ASSN	3651 LINDELL RD #H LAS VEGAS NV 89103-1200	12535111081
TORRALBA EUGENE Y & HELEN E	9275 JUNE BERRY LN NORTH HILLS CA 91343-7821	12535111038
TORRES EVELYN V & CESAR S	6821 WHITE LAKES AVE LAS VEGAS NV 89130-1661	12534614036
TRIMAX CAPITAL L L C	269 S BEVERLY DR #1826 BEVERLY HILLS CA 90212-3851	12527816032
TRIMMER FAMILY L L C	HOG CREEK INC 6032 S DURANGO DR #100 LAS VEGAS NV 89113	12527802016
TRIPP LAUREN N	5636 BALSAM ST LAS VEGAS NV 89130-1106	12527815047

Report of All Selected Parcels

Case Number: GPA-60977; ZON-60978; SUP-60980;
SUP-60982 & SDR-60983

Printed On: Mon: September 14, 2015

<u>Owner</u>	<u>Address</u>	<u>Parcel Numbe</u>
TUBIN BRAD REVOCABLE TRUST	TUBIN BRADLEY G TRS 6645 W EL CAMPO GRANDE AVE LAS VEGAS NV 89130	12526402002
TULE VICTOR	5520 GOLDBRUSH ST LAS VEGAS NV 89130-1655	12534511032
TURPIN NATHAN & ANA C	6824 BRIARWOOD BEND AVE LAS VEGAS NV 89130-5005	12527816036
UDARBE JOEL U & ANTONIO T	UDARBE PATROCINIA U 6604 GRAY JUNIPER AVE LAS VEGAS NV 89130-4806	12535111076
VACKICEV ELIO	BUERS-VACKICEV HILDA 5413 FLORA SPRAY ST LAS VEGAS NV 89130-3844	12534514020
VALENCIA TIFFANY	6801 BAYBERRY CREEK CT LAS VEGAS NV 89130-4999	12527816030
VALENZUELA DANIEL	5660 BALSAM ST LAS VEGAS NV 89130	12527815005
VANDEVER GARRET & CHRISTINA	6461 TINA LN LAS VEGAS NV 89130-1705	12535104001
VANSLETTE PATRICIA & WILLIAM K	5692 BISHOP FLOWERS ST LAS VEGAS NV 89130	12527819020
VARELA SAMUEL R	5480 RIO VISTA ST LAS VEGAS NV 89130-1612	12534503013
VEACH TERRI J	6824 FRUIT FLOWER AVE LAS VEGAS NV 89130-1666	12534512039
VEGA JAIME R	6723 SCARLET STAR AVE LAS VEGAS NV 89130-4995	12527818005
VELAZQUEZ EDGAR	5732 WINTER CHERRY AVE LAS VEGAS NV 89130-5006	12527817005
VELAZQUEZ JATHNIEL	6805 FRUIT FLOWER AVE LAS VEGAS NV 89130-3851	12534514009
VELAZQUEZ VILMA	6739 SCARLET STAR AVE LAS VEGAS NV 89130-4995	12527815032
VICKREY RICK & MONIQUE	5633 BALSAM ST LAS VEGAS NV 89130	12527819067
VIERRA JERRY	6617 GRAY JUNIPER AVE LAS VEGAS NV 89130-4806	12535111023
VILLANUEVA FRANK M & SUSIE C	6612 SAND BENCH AVE LAS VEGAS NV 89130-4801	12535111052
VIZMANOS VIVIAN D	5660 ORANGEROOT CT LAS VEGAS NV 89130-4994	12527815025
VUONG RANDY T	5503 GEMINI BRIDGES ST LAS VEGAS NV 89130-4996	12535111011
W O W PROPERTIES L L C	3100 S GRAND AVE LOS ANGELES CA 90007-3815	12527815010
WALCZAK ROBERT & ANNA	6809 WEEPING FIG CT LAS VEGAS NV 89130-5007	12527816019
WALLER NIKKI	VANDENBERK PATRICK 6936 YELLOW COSMOS AVE LAS VEGAS NV 89130	12527819013
WANG MINGYU	SUN HAOQING 1211 HAMIDA CT SAN JOSE CA 95120-5538	12527815020
WARRILOW RICHARD L & LINDA S	5712 CRYSTAL LILLY CT LAS VEGAS NV 89130	12527814017
WEBER PAUL L & JOYCE A	6520 W HAMMER LN LAS VEGAS NV 89130-1707	12535103012
WEIR DEAN	6717 SNAKE RIVER AVE LAS VEGAS NV 89130-1680	12534614031
WENDELIN DOUGLAS RAY JR	5513 GOLDBRUSH ST LAS VEGAS NV 89130	12534511039
WEST BEATRICE F	5603 LUSITANO ST LAS VEGAS NV 89130-1262	12526411015
WHEELER DAYNON & SHIRLEY C	5529 GOLDBRUSH ST LAS VEGAS NV 89130-1656	12534511035
WHITAKER FAMILY TRUST	WHITAKER MARVA K TRS 2066 FALLSBURG WY HENDERSON NV 89002-3627	12526403015
WILEY WESLEY L	5521 GOLDBRUSH ST LAS VEGAS NV 89130-1656	12534511037

Report of All Selected Parcels

Case Number: GPA-60977; ZON-60978; SUP-60980;
SUP-60982 & SDR-60983

Printed On: Mon: September 14, 2015

<u>Owner</u>	<u>Address</u>	<u>Parcel Numbe</u>
WILKS KIM L	5324 WHITE COYOTE PL LAS VEGAS NV 89130-1632	12534614025
WILLIAMS CHRISTOPHER	5614 BISHOP FLOWERS ST LAS VEGAS NV 89130	12527819073
WILLIAMS MARC & SARA	5737 GILBERT LN LAS VEGAS NV 89130-1225	12526410014
WILLIAMSON PETER SEAN	6940 YELLOW COSMOS AVE LAS VEGAS NV 89130	12527819012
WINCHESTER RACHEL	ORTIZ MIGUEL 5659 BALSAM ST LAS VEGAS NV 89130	12527819029
WINDHAVEN HOMEOWNERS ASSN	2555 W CHEYENNE AVE NORTH LAS VEGAS NV 89032	12527819101
WINDHAVEN HOMEOWNERS ASSN	2555 W CHEYENNE AVE NORTH LAS VEGAS NV 89032	12527819096
WINDHAVEN HOMEOWNERS ASSN	2555 W CHEYENNE AVE NORTH LAS VEGAS NV 89032	12527819094
WINDHAVEN HOMEOWNERS ASSN	2555 W CHEYENNE AVE NORTH LAS VEGAS NV 89032	12527819092
WINDHAVEN HOMEOWNERS ASSN	2555 W CHEYENNE AVE NORTH LAS VEGAS NV 89032	12527819093
WINDHAVEN HOMEOWNERS ASSN	2555 W CHEYENNE AVE NORTH LAS VEGAS NV 89032	12527819102
WINDHAVEN HOMEOWNERS ASSN	2555 W CHEYENNE AVE NORTH LAS VEGAS NV 89032	12527819095
WINDHAVEN HOMEOWNERS ASSN	2555 W CHEYENNE AVE NORTH LAS VEGAS NV 89032	12527819100
WINDHAVEN HOMEOWNERS ASSN	2555 W CHEYENNE AVE NORTH LAS VEGAS NV 89032	12527819091
WINDHAVEN HOMEOWNERS ASSN	2555 W CHEYENNE AVE NORTH LAS VEGAS NV 89032	12527819097
WINDHAVEN HOMEOWNERS ASSN	2555 W CHEYENNE AVE NORTH LAS VEGAS NV 89032	12527819098
WINDHAVEN HOMEOWNERS ASSN	2555 W CHEYENNE AVE NORTH LAS VEGAS NV 89032	12527819099
WINTON CHRIS J	6800 WHITE LAKES AVE LAS VEGAS NV 89130	12534614010
WISHENGRAD STUART & CYNTHIA L	6117 LONESOME CACTUS ST LAS VEGAS NV 89130-1054	12534513031
WITHERALL SCOTT	O'NEILL JOSEPH 5518 MOONLIGHT GARDEN ST LAS VEGAS NV 89130-4998	12535111028
WITT FAMILY TRUST	WITT ROBERT L & JUDY A TRS 8712 BECKETT RIDGE AVE LAS VEGAS NV 89149-4017	12526410002
WITT RANDY L	5756 N RAINBOW BLVD LAS VEGAS NV 89130-1247	12526410001
WONG GEORGE & LINDY	5516 GREEN WILLOW ST LAS VEGAS NV 89130-1646	12534511061
WOODBEEK FRANK R II & MARISSA R	5409 ROSE THICKET LAS VEGAS NV 89130-1675	12534512031
WOODBURY SCOTT L TRUST NO 1	WOODBURY ANNETTE M TRUST NO 1 209 W 29TH AVE HUTCHINSON KS 67502-3415	12534514001
WU WENDY YUN-CHIN	P O BOX 7554 LAGUNA NIGUEL CA 92607	12534614024
YAMAMOTO YOUN	6605 SAND BENCH AVE LAS VEGAS NV 89130-4801	12535111055
YAMAMOTO YUJI T	6505 TAYLOR CREEK AVE LAS VEGAS NV 89130-4805	12535111046
YAMAMOTO YUMI L	FELLER JOHANN A 6621 GRAY JUNIPER AVE LAS VEGAS NV 89130-4806	12535111022
YANG RAYMOND & HELEN K	6920 YELLOW COSMOS AVE LAS VEGAS NV 89130	12527819017
YAPCHING WILFREDO	P O BOX 750972 LAS VEGAS NV 89136	12534513029
YEN KEVIN C & ELISE	618 S BROADWAY #B REDONDO BEACH CA 90277	12527815027

Report of All Selected Parcels

Case Number: GPA-60977; ZON-60978; ; SUP-60980;
SUP-60982 & SDR-60983

Printed On: Mon: September 14, 2015

<u>Owner</u>	<u>Address</u>	<u>Parcel Numbe</u>
YENOR BECKY	5505 FLORA SPRAY ST LAS VEGAS NV 89130-1695	12534514027
YOGI HENRY	218 KONA PL KAHULUI MAUI HI 96732	12527818001
YOGI HENRY SEICHI TRUST	YOGI HENRY S TRS 218 KONA PL KAHULUI HI 96732	12527815050
ZHOU CHONGYU	FANG DONGRUI 48 MONTEVIDEO CIR FREMONT CA 94539-5350	12527815015
ZINK TRUST	ZINK BARBARA E TRS 421 MILTON DR SAN GABRIEL CA 91775-2822	12526403014
ZITIELLO DOMINIC M	5665 BISHOP FLOWERS ST LAS VEGAS NV 89130	12527819058
ZUBRICK JOAN KATHARINA TRUST	ZUBRICK JOAN KATHARINA TRS 6789 HAVEN HOLLOW AVE LAS VEGAS NV 89130-4912	12527714017