

City of Las Vegas  
Department of Planning  
Development Services Center  
333 North Rancho Drive, 3<sup>rd</sup> Floor  
Las Vegas, Nevada 89106

## Return Service Requested Official Notice of Public Hearing

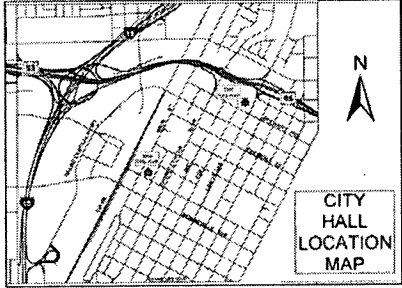

If you wish to file your protest or support on this request, check the appropriate box below and return this card in an envelope with postage to the Department of Planning at the address listed above, fax this side of this card to (702) 464-7499 or make your comments at [www.lasvegasnevada.gov](http://www.lasvegasnevada.gov). If you would like to contact your Council Representative, please call (702) 229-6405.

I SUPPORT  
this Request

I OPPOSE  
this Request

Please use available blank space on card for your comments.

**GPA-56713 & ZON-56715 [PRJ-55891]**

Planning Commission Meeting of 1/13/2015

## Application Information

**GPA-56713 - GENERAL PLAN AMENDMENT - PUBLIC HEARING - APPLICANT: MERLIN HARDY - OWNER: BONANZA SPRINGS, LLC** - For possible action on a request for a General Plan Amendment FROM: MLA (MEDIUM LOW ATTACHED DENSITY RESIDENTIAL) TO: M (MEDIUM DENSITY RESIDENTIAL) on 7.27 acres at 4901 East Bonanza Road (APN 140-32-502-002), Ward 3 (Coffin) [PRJ-55891].

**ZON-56715 - REZONING RELATED TO GPA-56713 - PUBLIC HEARING - APPLICANT: MERLIN HARDY - OWNER: BONANZA SPRINGS, LLC** - For possible action on a request for a Rezoning FROM: R-MH (MOBILE / MANUFACTURED HOME RESIDENTIAL) TO: R-3 (MEDIUM DENSITY RESIDENTIAL) on 7.27 acres at 4901 East Bonanza Road (APN 140-32-502-002), Ward 3 (Coffin) [PRJ-55891].

## Application Location

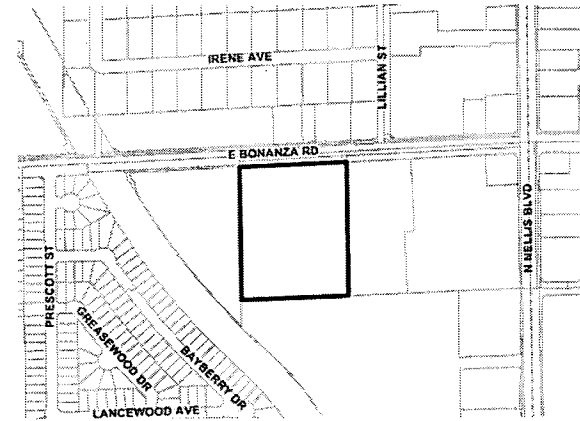

The proposed project may not pertain to the entire highlighted project site.

## Public Hearing Information

**Meeting:** Planning Commission  
**Date:** *January 13, 2015*  
**Time:** 6:00 P.M.  
**Location:** City Council Chambers  
495 South Main Street, 2<sup>nd</sup> Floor  
Las Vegas, Nevada 89101

Any and all interested persons may appear before the City Planning Commission either in person or by representative and object to or express approval of this request; or may, prior to this meeting, file a written objection thereto or approval thereof with the Department of Planning, Development Services Center, 333 North Rancho Drive, 3<sup>rd</sup> Floor, Las Vegas, Nevada 89106. Final Action on General Plan Amendments and Rezonings will be determined by the City Council. Other public hearing items may be deemed Final Action by the Planning Commission or forwarded to the City Council. The date of the City Council meeting, if applicable, will be announced at the Planning Commission meeting after the discussion of the item. For further information, including the full staff report, please call (702) 229-6301 (TDD 386-9108) or go to <http://www.lasvegasnevada.gov>.

**Report of All Selected Parcels****Case Number:** GPA-56713**Printed On:** Thu: November 20, 2014

<u>Owner</u>	<u>Address</u>	<u>Parcel Number</u>
29 MCKINLEY HOLDING L P	P O BOX 6434 FOLSOM CA 95763	14032514035
4869 IRENE AVE TRUST	4869 IRENE AVE LAS VEGAS NV 89110-2408	14029810011
7-ELEVEN INC	P O BOX 711 DALLAS TX 75221-0711	14029802011
ACEVEDO ADRIAN	516 BAYBERRY DR LAS VEGAS NV 89110-3460	14032515029
ACEVEDO JUAN CARLOS & ERENDIRA D	4828 ALAMEDA AVE LAS VEGAS NV 89110-3553	14032610052
ADVANCED CAPITAL GROUP L L C	COOPER CARY & MARSHA TRS 8019 ECHO CLIFF LN LAS VEGAS NV 89129-4880	14029801004
AGUAYO RAMON	532 BAYBERRY DR LAS VEGAS NV 89110-3462	14032515037
ALARCON VICTOR	4815 IRENE AVE LAS VEGAS NV 89110-2408	14029810008
ALECO ENTERPRISES INC	12111 LA CASA LN LOS ANGELES CA 90049-1529	14029802009
ALECO ENTERPRISES INC	12111 LA CASA LN LOS ANGELES CA 90049-1529	14029802007
ALECO ENTERPRISES INC	12111 LA CASA LN LOS ANGELES CA 90049-1529	14029802008
ALECO ENTERPRISES INC	12111 LA CASA LN LOS ANGELES CA 90049-1529	14029802006
ALEXANDER CRISANTHA R & JAMES II	4808 MONTEBELLO AVE LAS VEGAS NV 89110-3555	14032610013
ALEXANDER MARK ALAN & ALMA N	317 DERWYN RD LANSDOWNE PA 19050-1027	14032515004
AMARO AURORA CARDENAS	FORECLOSURE SALES SERV L L C 416 OAKFORD ST LAS VEGAS NV 89110	14032611061
AMEREH FUAD	DJASSEMI HOORI 1293 ECHO WIND AVE HENDERSON NV 89052-3004	14032512020
AMERSON FAMILY TRUST	AMERSON GERALD & KAROLYNN CO-TRS 2901 VISTA DEL SOL LAS VEGAS NV 89120-3612	14032512005
ANDEREGG FRED & SANDRA	516 PRESCOTT ST LAS VEGAS NV 89110-3437	14032513007
ANELLI PETER & G-A W REV FAM TR	9233 SPRUCE MOUNTAIN WAY LAS VEGAS NV 89134-6026	14029810046
ANOTHER NEW IDEA L L C	18 CHATMOSS RD HENDERSON NV 89052	14032512008
ARCHULETA GENARO	QUINTANA YOLANDA 4904 MONTEBELLO AVE LAS VEGAS NV 89110-3518	14032611003
ARELLANO JOSE JESUS	4831 LANCEWOOD AVE LAS VEGAS NV 89110-3451	14032514025
ARGUMEDO ISABEL	QUIROZ JOSE LUIS 528 BAYBERRY DR LAS VEGAS NV 89110-3460	14032515035
ARIDA JANET M & RICHARD C	4805 OSBORN CT LAS VEGAS NV 89110-3478	14032512035
ARONOFF STEVEN	522 PRESCOTT ST LAS VEGAS NV 89110-3437	14032513004
AVALOS MARTHA	531 BAYBERRY DR LAS VEGAS NV 89110-3464	14032515006
B K B CAPITAL L L C	6625 W SAHARA AVE #10 LAS VEGAS NV 89146	14032513042
BARAJAS ROBERTO	4828 MONTEBELLO AVE LAS VEGAS NV 89110-3555	14032610018
BARELA RICHARD J	4956 IRENE AVE LAS VEGAS NV 89110-2446	14029810021
BARG DANIEL L & THERESA E	4992 NETTIE AVE LAS VEGAS NV 89110-2414	14029810041
BARRON JESSY	517 BAYBERRY DR LAS VEGAS NV 89110-3461	14032515013
BEFFERMAN AARON H & DODI S	509 BAYBERRY DR LAS VEGAS NV 89110-3459	14032515017

**Report of All Selected Parcels****Case Number:** GPA-56713**Printed On:** Thu: November 20, 2014

<u>Owner</u>	<u>Address</u>	<u>Parcel Number</u>
BONANZA SPRINGS L L C	5113 ALPINE PL LAS VEGAS NV 89107	14032502002
BONANZA SUNRISE L L C	9220 CATHWELL LN TUJUNGA CA 91042-3321	14029801011
BONILLA SEPTIMIO ENRIQUEZ	ENRIQUEZ MARTHA C 3540 KEMP ST NORTH LAS VEGAS NV 89032-7734	14032610015
BOONE MONTHO REVOCABLE LIVING TR	BOONE MONTHO TRS 544 PRESCOTT ST LAS VEGAS NV 89110-3440	14032512006
BOWEN REBECCA S	RILEY BRADLEY D 4810 LINKWOOD DR LAS VEGAS NV 89110-3421	14032512027
BRITOS BRUCE & COLLEEN	4905 NETTIE AVE LAS VEGAS NV 89110-2415	14029810035
BROWN DAVID R & DAVID ROBERT	1011 MORNING SUN CT LAS VEGAS NV 89110-2929	14029801010
BROWN DEBORAH A	4827 LANCEWOOD AVE LAS VEGAS NV 89110-3450	14032514027
BURNETT DALE & JOYCE	4807 OSBORN CT LAS VEGAS NV 89110-3478	14032512036
BUTTICCI BRENDA	5564 SUPER BOWL DR LAS VEGAS NV 89110-5636	14032512034
C A H 2014-1 BORROWER L L C	9305 E VIA DE VENTURA #201 SCOTTSDALE AZ 85258	14032515010
C F T DEVELOPMENTS L L C	1683 WALNUT GROVE AVE ROSEMEAD CA 91770-3711	14032517003
C F T DEVELOPMENTS L L C	1683 WALNUT GROVE AVE ROSEMEAD CA 91770-3711	14032517001
C T L USA L L C	1908 MARIGOLD LANE WEST COVINA CA 91791-4173	14032512028
CAMARYIO-LEAL GUILDARDO	519 PRESCOTT ST LAS VEGAS NV 89110-3439	14032513040
CAMBEROS MARINA & GABRIELA F	540 BAYBERRY DR LAS VEGAS NV 89110-3462	14032515041
CAMPOS RAUL & GLENDA	520 GREASEWOOD DR LAS VEGAS NV 89110-3444	14032514034
CARDENAS JUAN	49 PRINCE LN LAS VEGAS NV 89110-4536	14032515005
CARDENAS MIGUEL A & IRMA Y	2427 FLINTWOOD DR ROWLAND HEIGHTS CA 91748-3215	14032514007
CARRILLO RODOLFO	548 PRESCOTT ST LAS VEGAS NV 89110-3440	14032512004
CARTER BRIAN	550 PRESCOTT ST LAS VEGAS NV 89110	14032512003
CASTANEDA ABUNDIO AL & ALBA LUZ	4808 OSBORN CT LAS VEGAS NV 89110-3468	14032512037
CAWREN L L C	6628 SECLUDED AVE LAS VEGAS NV 89110-5155	14032513010
CAZARES JOEL & EVA M	8620 W FORD AVE LAS VEGAS NV 89148	14032514021
CHARRES OCTAVIO	2721 S RENE DR SANTA ANA CA 92704	14032514032
CHAVEZ GABRIELA	68217 CALLE CERRITO DESERT HOT SPRING CA 92240-6427	14032515040
CHAVEZ SERGIO	1742 LUCKY ST LAS VEGAS NV 89104-5433	14032611008
CHIVAS-PENA MAYRA	420 GREENBROOK ST LAS VEGAS NV 89110	14032610050
CHRISTY ELENA	4839 LANCEWOOD LAS VEGAS NV 89110-3451	14032515027
CITY OF LAS VEGAS	333 N RANCHO DR 8TH FL LAS VEGAS NV 89106-3703	14029801001
CITY OF LAS VEGAS	495 S MAIN ST 6TH FL LAS VEGAS NV 89101-6318	14032610049
CLARK CONCEPCION	527 BAYBERRY DR LAS VEGAS NV 89110-3461	14032515008

**Report of All Selected Parcels****Case Number:** GPA-56713**Printed On:** Thu: November 20, 2014

<u>Owner</u>	<u>Address</u>	<u>Parcel Number</u>
CLARK LYNN A	4807 LINKWOOD DR LAS VEGAS NV 89110-3466	14032512016
COBIAN JOSE J & GILBERTO	4849 LANCEWOOD AVE LAS VEGAS NV 89110-3452	14032514009
COBIAN-OSORIO LUZ M	COBIAN-MICHEL GILBERTO 4849 LANCEWOOD AVE LAS VEGAS NV 89110-3452	14032515022
CONSTANTINO NOVAL NEVADA 2 L L C	2500 W SAHARA AVE #211 LAS VEGAS NV 89102-4393	14032502004
CONSTANTINO NOVAL NEVADA 2 L L C	2500 W SAHARA AVE #211 LAS VEGAS NV 89102-4393	14032502003
CORRAL PILAR LEYVA	4938 IRENE AVE LAS VEGAS NV 89110-2446	14029810022
CORTEZ GABRIEL	CORTES ANTONIO L 4821 MONTEBELLO LAS VEGAS NV 89110-3556	14032610046
COSPER WALTER H & SUSAN E	4956 NETTIE AVE LAS VEGAS NV 89110-2414	14029810043
COTA MANUEL & MARTINA	420 OAKFORD ST LAS VEGAS NV 89110-3550	14032611062
CRUZ MEACHELL P	1116 BARRON CREEK DR NORTH LAS VEGAS NV 89081-2972	14032514012
DAVILA-MARQUEZ RUBEN	4542 WISCONSIN AVE LAS VEGAS NV 89104	14032515012
DELGADILLO JORGE	DELGADO MARLENE 4802 DIAMOND HEAD DR LAS VEGAS NV 89110-3448	14032514001
DELGADO HUMBERTO & VIRGINIA	413 OAKFORD ST LAS VEGAS NV 89110-3551	14032611009
DETORRES MARIA G PEREZ	4830 IRENE AVE LAS VEGAS NV 89110	14029810028
DIAZ ALEJANDRO	4800 DIAMOND HEAD DR LAS VEGAS NV 89110-3448	14032513043
DIAZ MARIA DE JESUS	4795 NETTIE AVE LAS VEGAS NV 89110-2416	14029810004
DIDWAY JAMES R & DEBRA R	4812 MONTEBELLO AVE LAS VEGAS NV 89110-3555	14032610014
DONAN LEONEL & ANTONIA	17243 OROZCO ST GRANADA HILLS CA 91344-1149	14032610048
DUENAS MARCOS & ROSA MARINA	4803 LINKWOOD DR LAS VEGAS NV 89110-3466	14032512014
ECONO LUBE N'TUNE REALTY L L C	440 S CHURCH ST #700 CHARLOTTE NC 28202	14028410009
ELDER TONY M & CHANTAL M J	505 PRESCOTT ST LAS VEGAS NV 89110-3426	14032513033
ESPINO HUBER	4817 LANCEWOOD AVE LAS VEGAS NV 89110-3450	14032513024
FALCON CONSUELO G & LOURDES	531 GREASEWOOD DR LAS VEGAS NV 89110-3447	14032514003
FIGUEROA ROSA	700 MARCO ST LAS VEGAS NV 89110-2410	14029810005
FISHER JASON D & CHRISTY L	3637 BADURA AVE LAS VEGAS NV 89118-5211	14032515009
GALINDO SIGIFREDO	4949 IRENE AVE LAS VEGAS NV 89110-2445	14029810016
GAMBOA RUBEN & YOLANDA M	538 PRESCOTT ST LAS VEGAS NV 89110-3422	14032512009
GARCIA CARMEN	534 PRESCOTT ST LAS VEGAS NV 89110-3422	14032512011
GARCIA FERNANDO & VICTORIA	4824 MONTEBELLO AVE LAS VEGAS NV 89110-3555	14032610017
GARCIA JOSE A	AYALA GLORIA E 4806 LINKWOOD DR LAS VEGAS NV 89110-3420	14032512029
GARCIA JOSE A	525 PRESCOTT ST LAS VEGAS NV 89110-3439	14032514037
GARCIA MARGARITO & ROSA E	543 BAYBERRY DR LAS VEGAS NV 89110	14032512021

**Report of All Selected Parcels****Case Number:** GPA-56713**Printed On:** Thu: November 20, 2014

<u>Owner</u>	<u>Address</u>	<u>Parcel Number</u>
GARCIA MARLENE	VALDEZ JAVIER J 4869 NETTIE AVE LAS VEGAS NV 89110-2418	14029810033
GEX JOHN & REINA	4902 IRENE AVE LAS VEGAS NV 89110-2446	14029810024
GINES SERGIO & ANGELA	1994 LAVANTE AVE LAS VEGAS NV 891109	14029810017
GOMEZ ALFRED	4845 LANCEWOOD AVE LAS VEGAS NV 89110-3452	14032515024
GOMEZ JUAN	PRADO MARIA 521 GREASWOOD DR LAS VEGAS NV 89110-3446	14032514008
GOMEZ-RODRIGUEZ ANABEL	4800 LINKWOOD DR LAS VEGAS NV 89110-3420	14032512032
GONZALEZ MIRNA M	AVELAR JUANA A 4805 LINKWOOD DR LAS VEGAS NV 89110-3466	14032512015
GRIFFIN THOMAS M & CLARICE J	4995 NETTIE AVE LAS VEGAS NV 89110-2415	14029810040
GUERRA HERMOGENES & MARIA M	25682 ESTORIL ST VALENCIA CA 91355	14032512024
GUEVARA ENRIQUE	4887 NETTIE AVE LAS VEGAS NV 89110-2418	14029810034
GUZMAN SULEMA C	4848 IRENE AVE LAS VEGAS NV 89110-2409	14029810027
HAU PHUONG HUE	515 BAYBERRY DR LAS VEGAS NV 89110-3461	14032515014
HERMAN-DECKER FAMILY TRUST	HERMAN MAYNARD E TRS 541 BAYBERRY DR LAS VEGAS NV 89110-3464	14032515001
HERNANDEZ IRENE	425 OAKFORD ST LAS VEGAS NV 89110-3551	14032611006
HERNANDEZ MARTIN	BANUELOS GUADALUPE 4884 IRENE AVE LAS VEGAS NV 89110-2409	14029810025
HERNANDEZ-MALDONADO J GABRIEL	4977 NETTIE AVE LAS VEGAS NV 89110-2415	14029810039
HERNANDEZ-MEDRANO RAMIRO A	517 PRESCOTT ST LAS VEGAS NV 89110-3439	14032513039
HERRERA MODESTO & ALICIA	4800 MONTEBELLO AVE LAS VEGAS NV 89110-3555	14032610011
HICKS MEGAN	2403 WILLOWBY DR HOUSTON TX 77008-3058	14032515002
HO ESTHER KUA CHIEH	110 E LONGDEN AVE ARCADIA CA 91006-5242	14032513035
HOLT JACKY D JR & VALERIE N	4910 E BONANZA LAS VEGAS NV 89110-3505	14029801008
HORTA JOSE & JUANA MARIA	4941 NETTIE AVE LAS VEGAS NV 89110-2415	14029810037
HORTA JUANA & ANGELICA M	4941 NETTIE AVE LAS VEGAS NV 89110	14029810036
HOWELL WALLACE E	4513 COUNTRY RUN WAY ANTELOPE CA 95843	14032513025
I Q REALTY L L C	2893 SENTER RD #A SAN JOSE CA 95111-1161	14032515034
JACKSON FAMILY 2008 TRUST	JACKSON JANICE D & BOBBIE L TRS 524 PRESCOTT ST LAS VEGAS NV 89110-3437	14032513003
JAUREGUI DIANA & BLANCA D	JAUREGUI MARIA R 4820 MONTEBELLO AVE LAS VEGAS NV 89110-3555	14032610016
JOHNSON MICHELLE V	WELLS HATTIE V & L C 527 GREASEWOOD DR LAS VEGAS NV 89110-3447	14032514005
JOHNSTON JUDY A	4974 IRENE AVE LAS VEGAS NV 89110-2446	14029810020
JONES CATHERINE L	505 BAYBERRY DR LAS VEGAS NV 89110-3459	14032515019
JONES FAYEANN F & FRANCIS E	501 BAYBERRY DR LAS VEGAS NV 89110-3459	14032515021
KATZOVITZ HAROLD	11054 VENTURA BLVD #248 STUDIO CITY CA 91604	14032512002

**Report of All Selected Parcels****Case Number:** GPA-56713**Printed On:** Thu: November 20, 2014

<u>Owner</u>	<u>Address</u>	<u>Parcel Number</u>
KENNEDY JOSEPH W III	524 BAYBERRY DR LAS VEGAS NV 89110-3460	14032515033
KERSELL CHRISTINE TRUST	KERSELL CHRISTINE TRS 530 BAYBERRY DR LAS VEGAS NV 89110-3462	14032515036
KHANNA OM P	12 GOLDEN ASTER LITTLETON CO 80127-2222	14032512039
KIMSEY MYRA J & JAMIE D	4851 NETTIE AVE LAS VEGAS NV 89110-2418	14029810032
KLAUMENZER MARK W & DEE A	4851 IRENE AVE LAS VEGAS NV 89110-2408	14029810010
KLAUMENZER THOMAS W & CAMMAE H	4833 IRENE AVE LAS VEGAS NV 89110-2408	14029810009
KLINE KENDALL G	4795 IRENE AVE LAS VEGAS NV 89110-2444	14029810006
KLOCHKO TATYANA & SERGEY	5412 HAZELTINE AVE SHERMAN OAKS CA 91401-5743	14032512033
KOWALSKI CRAIG & MINGJIE	1905 RED ROBIN CT LAS VEGAS NV 89134-6157	14032513041
LANDEROS PAUL MATTHEW	4843 LANCEWOOD AVE LAS VEGAS NV 89110-3451	14032515025
LARSON S FAMILY L P	2950 E FLAMINGO RD #14 LAS VEGAS NV 89121-5209	14032502005
LAS VEGAS LEGACY TRUST	5407 ORINDA AVE LAS VEGAS NV 89120-1770	14033101019
LEE ALAN	P O BOX 7775 #79701 SAN FRANCISCO CA 94120-7775	14032513037
LEE SAMANTHA M	VASQUEZ NIVARDO U 4825 MONTEBELLO AVE LAS VEGAS NV 89110-3556	14032610047
LEIVA EFRAIN & MARIA L	529 GREASEWOOD DR LAS VEGAS NV 89110-3447	14032514004
LEIVA JOSE J & ROSA M	4833 LANCEWOOD AVE LAS VEGAS NV 89110-3451	14032514024
LIN GUO WAI & KAM TAO	511 GREASEWOOD DR LAS VEGAS NV 89110-3445	14032514013
LOPEZ-RODRIGUEZ FIDEL	4817 MONTEBELLO AVE LAS VEGAS NV 89110-3556	14032610045
LOVATO RICHARD J & NADINE Y	513 BAYBERRY DR LAS VEGAS NV 89110-3459	14032515015
MACIAS RAQUEL	4829 LANCEWOOD AVE LAS VEGAS NV 89110-3451	14032514026
MADRID HECTOR R	4938 NETTIE AVE LAS VEGAS NV 89110-2414	14029810044
MAGANA JOSE LUIS & MAYRA I	4995 IRENE AVE LAS VEGAS NV 89110-2445	14029810018
MARTIN MONTEZ I	FOBBS JOANNA 518 PRESCOTT ST LAS VEGAS NV 89110-3437	14032513006
MARTINEZ ASUCENA	511 BAYBERRY DR LAS VEGAS NV 89110-3459	14032515016
MARTINEZ BALTAZAR & ANGELICA	528 PRESCOTT ST LAS VEGAS NV 89110-3422	14032512019
MARTINEZ BALTAZAR S & MARIA A	528 PRESCOTT ST LAS VEGAS NV 89110-3422	14032513002
MARTINEZ LORENA P	RODAS-ESCOBAR ELIAS 4941 IRENE AVE LAS VEGAS NV 89110-2445	14029810015
MARTINEZ RAMIRO	4866 NETTIE AVE LAS VEGAS NV 89110-2419	14029810048
MCDONALD'S U S A L L C	P O BOX 182571 COLUMBUS OH 43218-2571	14028410010
MENDOZA-CISNEROS MARYANN E	508 PRESCOTT ST LAS VEGAS NV 89110	14032513011
MERAZ-OLIVAS ISAIAS	ISAIAS MARIA ELVA 4800 OSBORN CT LAS VEGAS NV 89110-3468	14032512041
MICHEL LIONEL & GUADALUPE	4912 MONTEBELLO AVE LAS VEGAS NV 89110-3518	14032611005

**Report of All Selected Parcels****Case Number:** GPA-56713**Printed On:** Thu: November 20, 2014

<u>Owner</u>	<u>Address</u>	<u>Parcel Number</u>
MIGUEL WILLIAM P	601 S RANCHO DR A-5 LAS VEGAS NV 89106-4898	14029802003
MIGUEL WILLIAM P	601 S RANCHO DR # A-5 LAS VEGAS NV 89106-4898	14029802005
MONJE ANGELINA	941 W BROADWAY PHOENIX AZ 85041-2304	14029810013
MONOLIT BUILDERS INC	1788 PARK OAK DR ROSEVILLE CA 95661-4055	14032513027
MORALES HUMBERTO E	4103 BALBOA AVE LAS VEGAS NV 89121-1720	14032515023
MORRAS JULIO & MARIA T	4949 NETTIE AVE LAS VEGAS NV 89110-2415	14029810038
NELLIS-STEWART INC	1901 LAS VEGAS BLVD S #101 LAS VEGAS NV 89104	14033102002
NELSON DARRYL & KIMBERLY	525 GREASEWOOD DR LAS VEGAS NV 89110-3447	14032514006
NEUWOHNER CHARLES & HELENE	4920 NETTIE AVE LAS VEGAS NV 89110-2414	14029810045
NGO GIANG & LIEN CHAU	4897 N LOUIS RIVER WY TUCSON AZ 85718-4757	14032515039
NUNEZ RAMON FIGUEROA	518 BAYBERRY DR LAS VEGAS NV 89110-3460	14032515030
OCHOA ADALBERTO	CHAVEZDE-OCHOA IRENE 515 PRESCOTT ST LAS VEGAS NV 89110-3439	14032513038
OCHOA CARLOS O	4802 LINKWOOD DR LAS VEGAS NV 89110	14032512031
OCHOA FRANCISCO JAVIER	537 BAYBERRY DR LAS VEGAS NV 89110-3464	14032515003
ONG VINCE & LAN	6628 SECLUDED AVE LAS VEGAS NV 89110-5155	14032512030
OREGEL CESAR A	2206 LAUREL RIDGE WAY LAS VEGAS NV 89142-1600	14032514023
ORTEGA DENNIS J & CELESTINA	503 BAYBERRY DR LAS VEGAS NV 89110-3459	14032515020
ORTIZ JESUS M	4809 LINKWOOD DR LAS VEGAS NV 89110-3467	14032512017
ORTIZ SONIA	4812 LINKWOOD DR LAS VEGAS NV 89110-3421	14032512026
PASCUAL SARAHI	514 PRESCOTT ST LAS VEGAS NV 89110-3437	14032513008
PATEL AVKASH	LIN MENG C 1195 BURNHAM DR SAN JOSE CA 95132-2710	14032514010
PAZ-SALDANA RAUL	4804 DIAMOND HEAD DR LAS VEGAS NV 89110-3448	14032514002
PEREZ-MAGNA MARIA	546 BAYBERRY DR LAS VEGAS NV 89110-3463	14032512018
PERLA DAVID & NANCY	532 PRESCOTT ST LAS VEGAS NV 89110-3422	14032512012
PETTIT NANCY J	4821 LANCEWOOD AVE LAS VEGAS NV 89110-3450	14032513026
PILA DE ORO L L C	716 VAQUERO DR MOUNTAINVIEW CA 94043-3139	14032514018
PINCKNEY TINISHA L	521 BAYBERRY DR LAS VEGAS NV 89110	14032515011
PINEDA ESEQUIEL	VILLANUEVA FAUSTA PINEDA 4887 IRENE AVE LAS VEGAS NV 89110-2408	14029810012
QUETZAL L L C	1682 MAPLELEAF ST LAS VEGAS NV 89142-1208	14032514014
QUINTERO-GALLARZO VICTOR	4814 LANCEWOOD AVE LAS VEGAS NV 89110-3443	14032513029
RAMEAUX BERNARD & MARIECHRISTINE	8000 W BADURA #2126 LAS VEGAS NV 89113	14032513020
RAMIREZ CORNELIO	8756 NORRIS AVE SUN VALLEY CA 91352-2719	14032512023

**Report of All Selected Parcels****Case Number:** GPA-56713**Printed On:** Thu: November 20, 2014

<u>Owner</u>	<u>Address</u>	<u>Parcel Numbe</u>
RAMOS DANIEL	LAMAS DELIA 4802 OSBORN CT LAS VEGAS NV 89110-3468	14032512040
RAMZI & FEBERONIA FAMILY TRUST	GARMO FEBERONIA TRS 2147 DEHESA RD EL CAJON CA 92019-2723	14032517004
RANGEL SERGIO	507 BAYBERRY DR LAS VEGAS NV 89110-3459	14032515018
REALTY INCOME CORPORATION	P O BOX 460069 ESCONDIDO CA 92046-0069	14032601003
REED ALLEN	4825 LANCEWOOD AVE LAS VEGAS NV 89110-3450	14032514028
REGALADO-NANEZ FELIPE	511 PRESCOTT ST LAS VEGAS NV 89110-3426	14032513036
REGALDO ANASTASIA	400 OAKFORD ST LAS VEGAS NV 89110-3502	14032610020
RINGLER CAROLYN	515 GREASEWOOD DR LAS VEGAS NV 89110-3446	14032514011
RIVERA ALFREDO O	421 GREENBROOK ST LAS VEGAS NV 89110-3516	14032611064
RIVERA YOLANDA M	421 GREENBROOK ST LAS VEGAS NV 89110-3516	14032611063
ROBINSON 1996 TRUST	ROBINSON FRED J & JOELLYN L TRS 6880 E BONANZA RD LAS VEGAS NV 89110-4133	14033101010
ROBLES-MORALES FRANCISCO	4815 LANCEWOOD AVE LAS VEGAS NV 89110-3450	14032513023
RODAREL L L C	1568 AMITOLA AVE LAS VEGAS NV 89123	14032514033
RODRIGUEZ JORGE L & MARIA A	4920 IRENE AVE LAS VEGAS NV 89110-2446	14029810023
ROMERO ANGELICA	4974 NETTIE AVE LAS VEGAS NV 89110-2414	14029810042
ROMERO ESTHER PATRICIA	4900 MONTEBELLO AVE LAS VEGAS NV 89110-3518	14032611002
ROMERO PEDRO	554 PRESCOTT ST LAS VEGAS NV 89110-3440	14032512001
S & R HOLDING LTD	8645 BERMUDA RD LAS VEGAS NV 89123-3027	14029801009
S A L V L L C	22 N GREENWOOD AVE PASADENA CA 91107-3514	14032515026
S M D R PROPERTIES L P	8150 CENTRAL EXPY #M1008 DALLAS tx 75206	14033101017
S M D R PROPERTIES L P	4541 COMSTOCK RD HOLLISTER CA 95023-9043	14033101018
S S D	750 17TH ST LAS CRUCES NM 88005-4153	14032601002
S S T I 4851 E BONANZA RD L L C	P O BOX 320099 ALEXANDRIA VA 22320-4099	14032502001
SAGI ORTAL	8775 COSTA VERDE BLVD #615 SAN DIEGO CA 92122	14032515038
SALAZAR ROSA	91 DROPLET ST LAS VEGAS NV 89110-5041	14032515028
SALCIDO HARMONY A	417 GREENBROOK ST LAS VEGAS NV 89110-3516	14032611065
SALGADO ATILANO & MARIA	4810 LANCEWOOD AVE LAS VEGAS NV 89110-3442	14032513031
SANCHEZ-NAVARRO JOSE	4837 LANCEWOOD AVE LAS VEGAS NV 89110-3451	14032514022
SECOND TEXLAND PPTYS CORP	P O BOX 711 DALLAS TX 75221-0711	14033101001
SEVILLA FELIPE	4925 IRENE AVE LAS VEGAS NV 89110-2445	14029810014
SHARIF SIDNEY R	505 GREASEWOOD DR LAS VEGAS NV 89110-3445	14032514016
SILL J STEPHEN & SHIRLENE	491 SPANISH VIEW LAS VEGAS NV 89110-4000	14029801013

**Report of All Selected Parcels****Case Number:** GPA-56713**Printed On:** Thu: November 20, 2014

<u>Owner</u>	<u>Address</u>	<u>Parcel Number</u>
SIMPSON DIANE M	530 PRESCOTT ST LAS VEGAS NV 89110-3422	14032513001
SKINNER THAD E	SKINNER TODD E & SHANE THAD 4815 NETTIE AVE LAS VEGAS NV 89110-2418	14029810029
SKINNER THAD E & NANCY CAROL	4815 NETTIE AVE LAS VEGAS NV 89110-2418	14029810030
SMITH DEAN L TRUST	SMITH DEAN TRS 4833 NETTIE AVE LAS VEGAS NV 89110-2418	14029810031
SMITH KAREN J	4832 LANCEWOOD AVE LAS VEGAS NV 89110-3449	14032514019
SNIPES CHRISTOPHER C & TAMMI S	520 BAYBERRY DR LAS VEGAS NV 89110-3460	14032515031
SOUTHERN NV HOUSING AUTHORITY	340 N 11 ST #170 LAS VEGAS NV 89101-3125	14032512013
SOUTHERN NV HOUSING AUTHORITY	340 N 11 ST #170 LAS VEGAS NV 89101-3125	14032513018
SOUTHERN NV HOUSING AUTHORITY	340 N 11 ST #170 LAS VEGAS NV 89101-3125	14032512025
SOUTHERN NV HOUSING AUTHORITY	340 N 11 ST #170 LAS VEGAS NV 89101-3125	14032513034
SOUTHERN NV HOUSING AUTHORITY	340 N 11 ST #170 LAS VEGAS NV 89101-3125	14032610019
STAMPLEY J & HERRON L REV LIV TR	STAMPLEY JAMES W TRS 983 MAJESTIC FALLS LN LAS VEGAS NV 89110	14032514015
STAMPLEY J W & L S H REV LIV TR	983 N MAJESTIC FALLS LAS VEGAS NV 89110-2721	14032513022
SUMMERFIELD MICHAEL V & DEBORAH	4866 IRENE AVE LAS VEGAS NV 89110-2409	14029810026
TAM FRANCES	4804 MONTEBELLO AVE LAS VEGAS NV 89110-3555	14032610012
TANOUE HARRY YOSHIKAZU	2971 PAPALI ST HONOLULU HI 96819-3051	14032512010
THOMAS MOKOTA	TROTTER MICHAEL 545 BAYBERRY DR LAS VEGAS NV 89110-3465	14032512022
TORRES TERESA	4736 MONTEBELLO AVE LAS VEGAS NV 89110-3513	14032610010
TREVIZO JESUS G & MARIA E	4808 LANCEWOOD AVE LAS VEGAS NV 89110-3442	14032513032
TU BANG & TRAN NANCY FAMILY TR	TU BANG SI TRS 4823 LANCEWOOD LAS VEGAS NV 89110-3450	14032514029
TU LINH P	4820 LANCEWOOD AVE LAS VEGAS NV 89110-3443	14032514030
TURNER AVERY L	HEISKELL WILEY L & LORIA A 4809 MONTEBELLO AVE LAS VEGAS NV 89110-3556	14032610043
VALDIVIAS-ARREOLA MARIA EDITH	4813 MONTEBELLO AVE LAS VEGAS NV 89110-3556	14032610044
VANDRUFF MELISSA	4908 MONTEBELLO AVE LAS VEGAS NV 89110-3518	14032611004
VELAZQUEZ ELEAZAR & FRANCISCA	514 GREASEWOOD DR LAS VEGAS NV 89110-3444	14032514031
VERDUZCO-GARCIA MARIA	522 BAYBERRY DR LAS VEGAS NV 89110-3460	14032515032
VICTORIA LAND L L C	3863 S VALLEY VIEW BLVD #5 LAS VEGAS NV 89103-2943	14032513009
VILLALPANDO MARIA TRINIDAD	542 PRESCOTT ST LAS VEGAS NV 89110-3440	14032512007
VILLEGAS REFUGIO JR	4834 LANCEWOOD AVE LAS VEGAS NV 89110-3449	14032514020
W R E P II EMERALD L L C	1201 ELM ST #1600 DALLAS TX 75270	14032601001
W R E P II SPRINGS L L C	%J BLACK 6720 E CAMELBACK RD #100 SCOTTSDALE AZ 85251-2015	14032516305
WAGNER BRUCE ELWIN REVOCABLE TR	WAGNER BRUCE ELWIN TRS 4992 IRENE AVE LAS VEGAS NV 89110-2446	14029810019

**Report of All Selected Parcels****Case Number:** GPA-56713**Printed On:** Thu: November 20, 2014

<u>Owner</u>	<u>Address</u>	<u>Parcel Numbe</u>
WENTWORTH CARL J & KATHLEEN A	524 GREASEWOOD DR LAS VEGAS NV 89110-3444	14032514036
WILLIAMS FERRIS MCKAY	6535 VILLA DEL SOL LAS VEGAS NV 89110-5137	14029810047
WILLIAMS GREG	VALLETTE WILLIAM 421 OAKFORD ST LAS VEGAS NV 89110-3551	14032611007
WILSON ROBERT W	1608 GHOST FLOWER CT LAS VEGAS NV 89128-7390	14032513021
WRIGHT NANCY LOU	4812 LANCEWOOD AVE LAS VEGAS NV 89110-3443	14032513030
XA HAI & CHAU AITIEN H LIV TR	XA HAI TRS 893 S RAINBOW BLVD LAS VEGAS NV 89145	14029802010
YUTAN P S & G W 1975 FAM TR AGMT	Y TAX DEPT 401P O BOX 4900SCOTTS ALE AZ 85261-4900	14028410011
ZALEZ9004 L L C	4807 LANCEWOOD AVE LAS VEGAS NV 89110-3441	14032513019
ZAMORA ARMANDO	915 SHOREPOINT CT #E101 ALMEDA CA 94501	14032514017
ZAMORA RAMIRO	529 BAYBERRY DR LAS VEGAS NV 89110-3461	14032515007
ZEPEDA BRENDA	989 PEARL PEAK ST LAS VEGAS NV 89110	14032512038
ZEPEDA YOLANDA	520 PRESCOTT ST LAS VEGAS NV 89110-3437	14032513005
ZHANG JACK HONG	WANG LING LI 6924 HIGHLAND DR CORONA CA 92880-3906	14032513028