

City of Las Vegas  
Department of Planning  
Development Services Center  
333 North Rancho Drive, 3<sup>rd</sup> Floor  
Las Vegas, Nevada 89106

## Return Service Requested Official Notice of Public Hearing

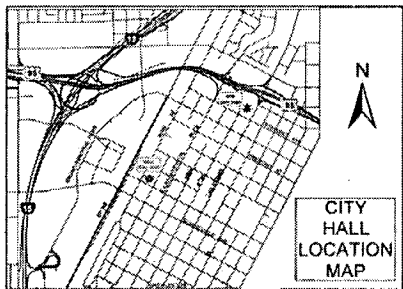

If you wish to file your protest or support on this request, check the appropriate box below and return this card in an envelope with postage to the Department of Planning at the address listed above, fax this side of this card to (702) 464-7499 or make your comments at [www.lasvegasnevada.gov](http://www.lasvegasnevada.gov). If you would like to contact your Council Representative, please call (702) 229-6405.

I SUPPORT  
this Request

I OPPOSE  
this Request

Please use available blank space on card for your comments.

**GPA-53191 & ZON-53192**

Planning Commission Meeting of 4/8/2014

## Application Information

**GPA-53191 - GENERAL PLAN AMENDMENT - PUBLIC HEARING - APPLICANT/OWNER: NVRE LLC** - For possible action on a request for a General Plan Amendment FROM: RNP (RURAL NEIGHBORHOOD PRESERVATION) TO: PCD (PLANNED COMMUNITY DEVELOPMENT) on 2.5 acres located on the north side of Centennial Parkway, approximately 328 feet east of Shaumber Road (APN 126-24-401-024), Ward 6 (Ross).

**ZON-53192 - REZONING RELATED TO GPA-53191 - PUBLIC HEARING - APPLICANT/OWNER: NVRE LLC** - For possible action on a request for a Rezoning FROM: U (UNDEVELOPED) [RNP (RURAL NEIGHBORHOOD PRESERVATION) GENERAL PLAN DESIGNATION] TO: PD (PLANNED DEVELOPMENT) on 2.5 acres located on the north side of Centennial Parkway, approximately 328 feet east of Shaumber Road (APN 126-24-401-024), Ward 6 (Ross).

## Application Location

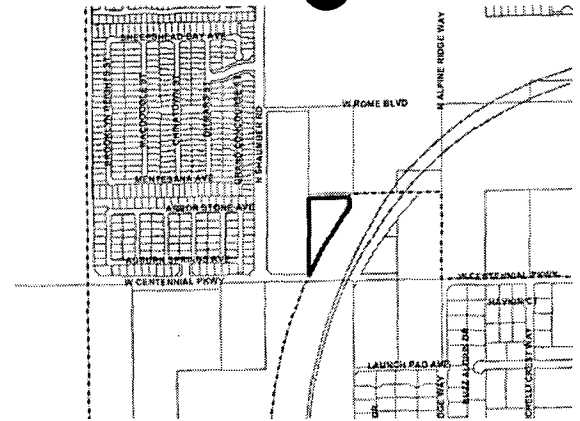

The proposed project may not pertain to the entire highlighted project site.

## Public Hearing Information

**Meeting:** Planning Commission  
**Date:** *April 08, 2014*  
**Time:** 6:00 P.M.  
**Location:** City Council Chambers  
495 South Main Street, 2<sup>nd</sup> Floor  
Las Vegas, Nevada 89101

Any and all interested persons may appear before the City Planning Commission either in person or by representative and object to or express approval of this request; or may, prior to this meeting, file a written objection thereto or approval thereof with the Department of Planning, Development Services Center, 333 North Rancho Drive, 3<sup>rd</sup> Floor, Las Vegas, Nevada 89106. Final Action on General Plan Amendments and Rezonings will be determined by the City Council. Other public hearing items may be deemed Final Action by the Planning Commission or forwarded to the City Council. The date of the City Council meeting, if applicable, will be announced at the Planning Commission meeting after the discussion of the item. For further information, including the full staff report, please call (702) 229-6301 (TDD 386-9108) or go to <http://www.lasvegasnevada.gov>.

**Report of All Selected Parcels****Case Number:** GPA-53191**Printed On:** Wed: March 5, 2014

<u>Owner</u>	<u>Address</u>	<u>Parcel Number</u>
ANDERSON ANDREW M	6561 GRAND CONCOURSE ST LAS VEGAS NV 89166-8024	12624411051
ARENCIBIA ALIVIA M	NICHOLS DAVID R 6529 GRAND CONCOURSE ST LAS VEGAS NV 89166-8023	12624411059
ARMSTRONG ALINE E	PIERCE CALEB 1038 GOETTINGEN SAN FRANCISCO CA 94134-2116	12624411037
AUBURN & BRADFORD PROVIDENCE HOA	%THOROUGHbred MGT 2555 W CHEYENNE AVE NO LAS VEGAS NV 89032-8211	12624411144
BABINEAU JAY F	154 ORCHARD RD EAST LONGMEADOW MA 01028-1438	12624411043
BAILEY JIMMY & CHIEKO LYNN	6438 CAMERON PARK ST LAS VEGAS NV 89166-8038	12624412017
BANANA TRUST	ECHAVES ROBERTA K & DEBORAH TRS 6421 WILLOWSTONE ST LAS VEGAS NV 89166-8036	12624412041
BEATTY MICHAEL D & MICHELE M	6434 TURNBRIDGE ST LAS VEGAS NV 89166-8035	12624412047
BILL TOWER INVESTMENT TRUST	PARKER ROBERT JEFFREY TRS 1801 WHITE HAWK CT LAS VEGAS NV 89134-6113	12624401019
BILL TOWER INVESTMENT TRUST	PARKER ROBERT JEFFREY TRS 1801 WHITE HAWK CT LAS VEGAS NV 89134-6113	12624401017
BISE JASON J	6534 CHINATOWN ST LAS VEGAS NV 89166-8029	12624411089
BLEVINS STEPHEN D & MEGAN A	6537 GRAND CONCOURSE ST LAS VEGAS NV 89166-8023	12624411057
BLUMBERG JARROD S	REINISH SUE A 6430 SCOTTS CROSSING ST LAS VEGAS NV 89166-7019	12624413031
BOWLES DALE & LAURA	6293 GALILEO DR LAS VEGAS NV 89149-1385	12625110006
BRACKINS JASON P & LINDSAY N	6542 DITMARS ST LAS VEGAS NV 89166-8026	12624411067
BRANISH MABBY JOY & ERIC	10623 MENTESANA AVE LAS VEGAS NV 89166-8021	12624411031
BULAGLAG CYNTHIA S	6526 CHINATOWN ST LAS VEGAS NV 89166-8029	12624411087
BUMPHREY JOHN D	10701 MENTESANA AVE LAS VEGAS NV 89166-8021	12624411025
CALDERON MARIA A & CHRISTOPHER D	10640 ARBOR STONE AVE LAS VEGAS NV 89166-8039	12624412007
CAMPBELL CHRISTOPHER C	6604 DITMARS ST LAS VEGAS NV 89166-8027	12624314104
CAMPISE JOSEPH M & STEPHANIE J	6438 SCOTTS CROSSING ST LAS VEGAS NV 89166-7019	12624413029
CAPITINI WILLIAM A & PHYLLIS A	6558 GRAND CONCOURSE ST LAS VEGAS NV 89166-8024	12624411047
CARRIGY THOMAS J	6545 GRAND CONCOURSE ST LAS VEGAS NV 89166-8023	12624411055
CARUGATI DANTE A & ASHLEY M	6526 GRAND CONCOURSE ST LAS VEGAS NV 89166-8023	12624411039
CEXTON KEITH & KIMBERLY	10632 ARBOR STONE AVE LAS VEGAS NV 89166-8039	12624412009
COLFIN AI-NV 2 L L C	9305 E VIA DE VENTURA #201 SCOTTSDALE AZ 85258-3423	12624411052
CONTRATTO BRENT M & TANEL L	6429 TURNBRIDGE ST LAS VEGAS NV 89166-8035	12624412004
CORRAL IKE D	6434 CAMERON PARK ST LAS VEGAS NV 89166-8038	12624412018
CROKER ADAM R & SHANA L	10620 ARBOR STONE AVE LAS VEGAS NV 89166-8039	12624412012
CRUZ JOSE A	6549 GRAND CONCOURSE ST LAS VEGAS NV 89166-8024	12624411054
CRUZ RACHELLE L & ERIC	6430 TURNBRIDGE ST LAS VEGAS NV 89166-8035	12624412046

**Report of All Selected Parcels****Case Number:** GPA-53191**Printed On:** Wed: March 5, 2014

<u>Owner</u>	<u>Address</u>	<u>Parcel Number</u>
CURTIS NICOLE M & HARRY W	6541 DITMARS ST LAS VEGAS NV 89166-8026	12624411080
DAY BARRY J & LUCINDA M	6522 GRAND CONCOURSE ST LAS VEGAS NV 89166-8023	12624411038
DEMELO ARLETE & NATASHA	6425 TURNBRIDGE ST LAS VEGAS NV 89166-8035	12624412003
DESILVESTR MICHAEL I	6537 DITMARS ST LAS VEGAS NV 89166-8026	12624411081
EDWARDS DANIELLE A	6550 GRAND CONCOURSE ST LAS VEGAS NV 89166-8024	12624411045
ESTRADA ANDREI F	APPLE JESSICA M 6554 DITMARS ST LAS VEGAS NV 89166-8027	12624411070
FAIRFIELD CENTENNIAL L L C	5510 MOREHOUSE DR #200 SAN DIEGO CA 92121-3722	12625111415
FERNANDEZ JUAN C	6562 GRAND CONCOURSE ST LAS VEGAS NV 89166-8024	12624411048
FIELDS JAMEY R & SHANNON I	6422 SCOTTS CROSSING ST LAS VEGAS NV 89166-7019	12624413033
FRIEDMAN KENNETH A & SHARON M	3061 POWDER MILL CIR BETHLEHEM PA 18017-2541	12624411068
FUTUREGEN COMPANY	%TRIUMPH PPTY MGT 9030 W SAHARA AVE #668 LAS VEGAS NV 89117-5744	12624411062
G & P INVESTMENT ENTERPRISES LLC	9212 CANALINO DR LAS VEGAS NV 89134-0610	12624411056
GREENE JESSE L	6562 DITMARS ST LAS VEGAS NV 89166-8027	12624411072
GREYSTONE NEVADA L L C	%J PARNES 2490 PASEO VERDE PKWY #120 HENDERSON NV 89074-7121	12625101004
GREYSTONE NEVADA L L C	%J PARNES 2490 PASEO VERDE PKWY #120 HENDERSON NV 89074-7121	12625101003
GROVER JAMES E & JACQUALINE E	10627 MENTESANA AVE LAS VEGAS NV 89166-8021	12624411030
GUTHERIE KATHRYN	6426 SCOTTS CROSSING ST LAS VEGAS NV 89166-7019	12624413032
GUY ARTHUR J	10608 ARBOR STONE AVE LAS VEGAS NV 89166-8039	12624412015
HARRIS RONNIE D	6422 TURNBRIDGE ST LAS VEGAS NV 89166-8035	12624412044
HARRISON CHRISTOPHER R	6533 GRAND CONCOURSE ST LAS VEGAS NV 89166-8023	12624411058
HENDRIX IAN & NICOLE	6607 GRAND CONCOURSE ST LAS VEGAS NV 89166-8025	12624314110
HOLBROOK JONATHAN P	6545 DITMARS ST LAS VEGAS NV 89166-8026	12624411079
HOLMAN ROBERT B & GAIL L	6417 WILLOWSTONE ST LAS VEGAS NV 89166-8036	12624412042
HOUGHTON FREDERICK	KIRK MICHAEL 6525 DITMARS ST LAS VEGAS NV 89166-8026	12624411084
JACKSON IRIS L	6525 GRAND CONCOURSE ST LAS VEGAS NV 89166-8023	12624411060
JOHNSON CHARLES E	6294 GALILEO DR LAS VEGAS NV 89149-1385	12625110007
JOHNSTONE WENDY	BAUMBACH JED 6433 TURNBRIDGE ST LAS VEGAS NV 89166-8035	12624412005
JONES BRIAN	2463 TRIBECA ST LAS VEGAS NV 89135-1143	12624411077
JONES ELVIN I	6553 GRAND CONCOURSE ST LAS VEGAS NV 89166-8024	12624411053
JOSHUA SOLOMON	10631 MENTESANA AVE LAS VEGAS NV 89166-8021	12624411029
KING LARRY D & LUZENDA	6421 TURNBRIDGE ST LAS VEGAS NV 89166-8035	12624412002
KONYS MARK A & MARY E	6534 GRAND CONCOURSE ST LAS VEGAS NV 89166-8023	12624411041

**Report of All Selected Parcels**

**Case Number:** GPA-53191

**Printed On:** Wed: March 5, 2014

<u>Owner</u>	<u>Address</u>	<u>Parcel Number</u>
KROTA JOSEPH J IV & MICHAEL ANN	6418 SCOTTS CROSSING ST LAS VEGAS NV 89166-7019	12624413034
LADOMERSZKY KATIE L	6425 WILLOWSTONE ST LAS VEGAS NV 89166-8036	12624412040
LANGLEY MATTHEW A & CHANNA G	6566 GRAND CONCOURSE ST LAS VEGAS NV 89166-8024	12624411049
LIVING SMART PROVIDENCE SO COMM	4966 S RAINBOW BLVD #100 LAS VEGAS NV 89118-1431	12624412056
LIVING SMART PROVIDENCE SO COMM	4966 S RAINBOW BLVD #100 LAS VEGAS NV 89118-1431	12624412050
LIVING SMART PROVIDENCE SO COMM	4966 S RAINBOW BLVD #100 LAS VEGAS NV 89118-1431	12624413062
LIVING SMART PROVIDENCE SO COMM	4966 S RAINBOW BLVD #100 LAS VEGAS NV 89118-1431	12624412052
LIVING SMART PROVIDENCE SO COMM	4966 S RAINBOW BLVD #100 LAS VEGAS NV 89118-1431	12624412049
LIVING SMART PROVIDENCE SO COMM	4966 S RAINBOW BLVD #100 LAS VEGAS NV 89118-1431	12624412053
LIVING SMART PROVIDENCE SO COMM	4966 S RAINBOW BLVD #100 LAS VEGAS NV 89118-1431	12624412051
LIVING SMART PROVIDENCE SO COMM	4966 S RAINBOW BLVD #100 LAS VEGAS NV 89118-1431	12624412055
LIVING SMART PROVIDENCE SO COMM	4966 S RAINBOW BLVD #100 LAS VEGAS NV 89118-1431	12624412054
MADRID MARIA P	6566 DITMARS ST LAS VEGAS NV 89166-8027	12624411073
MALERBE SUZANNE	207 18TH ST HUNTINGTON BEACH CA 92648-3903	12624314114
MARCHANT BRANDON S & HOLLY	10616 ARBOR STONE AVE LAS VEGAS NV 89166-8039	12624412013
MARKS MINE & JOHN W	6542 CHINATOWN ST LAS VEGAS NV 89166-8029	12624411091
MARTIN MATTHEW R	6546 CHINATOWN ST LAS VEGAS NV 89166-8029	12624411092
MCDONAGH SEAN M & KAYLA L	6565 DITMARS ST LAS VEGAS NV 89166-8027	12624411074
MCDONALD MICHAEL & DEBBIE	10648 BERKSHIRE WOODS AVE LAS VEGAS NV 89166-7018	12624413028
MCGEE DENNIS DEWAYNE & TRISHA D	6561 DITMARS ST LAS VEGAS NV 89166-8027	12624411075
MCGILL ROBERT L JR & CAROL G	608 MEADOW CREEK DR PARACHUTE CO 81635-8916	12624411027
MCKENZIE TRAMEL G	6529 DITMARS ST LAS VEGAS NV 89166-8026	12624411083
MEDRANO CHRISTINA M	10628 ARBOR STONE AVE LAS VEGAS NV 89166-8039	12624412010
MILL CHRISTOPHER & JENNIFER	6442 CAMERON PARK ST LAS VEGAS NV 89166-8038	12624412016
MILLER KELLI A & LEE T	10611 MENTESANA AVE LAS VEGAS NV 89166-8021	12624411034
MORRELLO MICHAEL A	6429 WILLOWSTONE ST LAS VEGAS NV 89166-8036	12624412039
MORRELLO THERESA	6439 CAMERON PARK ST LAS VEGAS NV 89166-8038	12624412036
MORTON MATTHEW S	10615 MENTESANA AVE LAS VEGAS NV 89166-8021	12624411033
MURRIETA JACOB M	DAVIS-MURRIETA LEAH 10624 ARBOR STONE AVE LAS VEGAS NV 89166-8039	12624412011
N V R E L L C	3425 CLIFF SHADOWS PKWY #130 LAS VEGAS NV 89129-5113	12624401024
NAMAHOE BLAINETTE K	6521 DITMARS ST LAS VEGAS NV 89166-8026	12624411085
NELSON BRYAN K & CHRISTY M	6433 WILLOWSTONE ST LAS VEGAS NV 89166-8036	12624412038

**Report of All Selected Parcels****Case Number:** GPA-53191**Printed On:** Wed: March 5, 2014

<u>Owner</u>	<u>Address</u>	<u>Parcel Number</u>
NICOLARI ALICIA & SCOTT	6549 DITMARS ST LAS VEGAS NV 89166-8026	12624411078
NIELSON MARGARET A & BLAIN	6438 TURNBRIDGE ST LAS VEGAS NV 89166-8035	12624412048
NOESIS PROPERTY ACQUISITIONS LLC	11856 MOORPARK ST #B STUDIO CITY CA 91604-2138	12624411069
OBERG JASON L & BRIANNA C	6437 WILLOWSTONE ST LAS VEGAS NV 89166-8036	12624412037
O'BRIEN TIMOTHY P & PHYLLIS R	6277 GALILEO DR LAS VEGAS NV 89149-1385	12625110005
OTTENWESS FAMILY TRUST	OTTENWESS BRUCE J & CAROLINA TRS 6558 DITMARS ST LAS VEGAS NV 89166-8027	12624411071
PARDEE HOMES NEVADA	2120 PARK PL #120 EL SEGUNDO CA 90245-4824	12624412033
PARDEE HOMES NEVADA	2120 PARK PL #120 EL SEGUNDO CA 90245-4824	12624413061
PARDEE HOMES NEVADA	2120 PARK PL #120 EL SEGUNDO CA 90245-4824	12624412030
PARDEE HOMES NEVADA	2120 PARK PL #120 EL SEGUNDO CA 90245-4824	12624412026
PARDEE HOMES NEVADA	2120 PARK PL #120 EL SEGUNDO CA 90245-4824	12624412034
PARDEE HOMES NEVADA	2120 PARK PL #120 EL SEGUNDO CA 90245-4824	12624412032
PARDEE HOMES NEVADA	2120 PARK PL #120 EL SEGUNDO CA 90245-4824	12624412022
PARDEE HOMES NEVADA	2120 PARK PL #120 EL SEGUNDO CA 90245-4824	12624412028
PARDEE HOMES NEVADA	2120 PARK PL #120 EL SEGUNDO CA 90245-4824	12624412019
PARDEE HOMES NEVADA	2120 PARK PL #120 EL SEGUNDO CA 90245-4824	12624412021
PARDEE HOMES NEVADA	2120 PARK PL #120 EL SEGUNDO CA 90245-4824	12624412029
PARDEE HOMES NEVADA	2120 PARK PL #120 EL SEGUNDO CA 90245-4824	12624412020
PARDEE HOMES NEVADA	2120 PARK PL #120 EL SEGUNDO CA 90245-4824	12624412031
PARDEE HOMES NEVADA	2120 PARK PL #120 EL SEGUNDO CA 90245-4824	12624412027
PARDEE HOMES NEVADA	2120 PARK PL #120 EL SEGUNDO CA 90245-4824	12624412024
PARDEE HOMES NEVADA	2120 PARK PL #120 EL SEGUNDO CA 90245-4824	12624412023
PARDEE HOMES NEVADA	2120 PARK PL #120 EL SEGUNDO CA 90245-4824	12624412025
PARKER JOHN W & NANCY S	6435 CAMERON PARK ST LAS VEGAS NV 89166-8038	12624412035
PATTERSON PATRICIA L	6611 GRAND CONCOURSE ST LAS VEGAS NV 89166-8025	12624314109
PHOUMIPHAT SARENA P	6533 DITMARS ST LAS VEGAS NV 89166-8026	12624411082
PINEDA ENRIQUE G & JESSICA	6546 GRAND CONCOURSE ST LAS VEGAS NV 89166-8024	12624411044
RACOMA REGGY D & RENALYN A	6526 DITMARS ST LAS VEGAS NV 89166-8026	12624411063
RAMIREZ LOUISE	6600 GRAND CONCOURSE ST LAS VEGAS NV 89166-8025	12624314113
RAMOS LARISSA N & RANDY B	6530 GRAND CONCOURSE ST LAS VEGAS NV 89166-8023	12624411040
REGINO HERVEY & LETICIA	6620 GRAND CONCOURSE ST LAS VEGAS NV 89166-8025	12624314118
REZAI TAHA	1070 N COVENTRY AVE CLOVIS CA 93611-8182	12624411032

**Report of All Selected Parcels****Case Number:** GPA-53191**Printed On:** Wed: March 5, 2014

<u>Owner</u>	<u>Address</u>	<u>Parcel Numbe</u>
RINGGENBERG PATRICIA A	6603 GRAND CONCOURSE ST LAS VEGAS NV 89166-8025	12624314111
ROARING FORK MANAGEMENT L L C	%N PAVELL 11603 GLOWING SUNSET LN LAS VEGAS NV 89135-1659	12624401016
ROBINSON MARISA	6538 DITMARS ST LAS VEGAS NV 89166-8026	12624411066
ROSE WILFRED J III	6530 CHINATOWN ST LAS VEGAS NV 89166-8029	12624411088
ROWE KIRK R & AURELIA	2470 HILTONHEAD PL #2176 EL CAJON CA 92019-4447	12624412014
RUBINO KENNETH F & CHRISTINA R	6565 GRAND CONCOURSE ST LAS VEGAS NV 89166-8024	12624411050
S F R INVESTMENTS POOL I L L C	5030 PARADISE RD #B-214 LAS VEGAS NV 89119-1225	12624411090
S P-5 L L C	3455 CLIFF SHADOWS PKWY #220 LAS VEGAS NV 89129-1077	12624401006
SARMIENTO RONALD B & RAYNEL E	6437 TURNBRIDGE ST LAS VEGAS NV 89166-8035	12624412006
SCHINDELL DAVID P & SHEREE	6418 TURNBRIDGE ST LAS VEGAS NV 89166-8035	12624412043
SCHOOL BOARD OF TRUSTEES	4190 MCLEOD DR 2ND FLR LAS VEGAS NV 89121-4454	12624801007
SEEBOLD PETER L & ALICE M	6417 TURNBRIDGE ST LAS VEGAS NV 89166-8035	12624412001
SHKORUPA RYAN M	KENNEDY BREANNA L 6608 GRAND CONCOURSE ST LAS VEGAS NV 89166-8025	12624314115
SOUTH PROVIDENCE HOLDINGS L L C	3455 CLIFF SHADOWS PKWY #220 LAS VEGAS NV 89129-1077	12624410003
SPAW WILLIAM R III & DANIELLE J	6514 GRAND CONCOURSE ST LAS VEGAS NV 89166-8023	12624411036
STEELE FANNYE M	6391 BUZZ ALDRIN DR LAS VEGAS NV 89149-1389	12625510013
STEINKELLNER BETH J & THOMAS V	1106 SHERMAN ST YPSILANTI MI 48197-4629	12624314116
STEWART DAWCHICO D	10649 AUBURN SPRINGS AVE LAS VEGAS NV 89166-8037	12624413001
THOMAS-COLE TAWANA	COLE JASON F 6538 GRAND CONCOURSE ST LAS VEGAS NV 89166-8023	12624411042
TUNSON WILLIE J & LINDA M	6534 DITMARS ST LAS VEGAS NV 89166-8026	12624411065
TYLER CHARLES L & KATHERINE L	6295 CAPE CANAVERAL LAS VEGAS NV 89149-1383	12625110018
USA	CITY OF LAS VEGAS LEASE 333 NORTH RANCHO DR 8TH FLR LAS VEGAS NV 89106	12624301018
USA	CITY OF LAS VEGAS LEASE 333 NORTH RANCHO DR 8TH FLR LAS VEGAS NV 89106	12624401023
VALLES JOHNNY C & ELIZABETH M	6557 DITMARS ST LAS VEGAS NV 89166-8027	12624411076
VONSLOMSKI DAWN M	6616 GRAND CONCOURSE ST LAS VEGAS NV 89166-8025	12624314117
WEI JIANI	10643 MENTESANA AVE LAS VEGAS NV 89166-8021	12624411026
WHITE SUSAN	6434 SCOTTS CROSSING ST LAS VEGAS NV 89166-7019	12624413030
WOODS-PEDERSON SHERRY L	6570 GRAND CONCOURSE ST LAS VEGAS NV 89166-8024	12624314112
WORF CAROLYN K	6426 TURNBRIDGE ST LAS VEGAS NV 89166-8035	12624412045
WORTHY WILLIAM W IV & JODIE R	10635 MENTESANA AVE LAS VEGAS NV 89166-8021	12624411028
WUERTZ MARK & EMMA	6510 GRAND CONCOURSE ST LAS VEGAS NV 89166-8023	12624411035
YANEZ JESUS J & JILLIAN D	10636 ARBOR STONE AVE LAS VEGAS NV 89166-8039	12624412008

**Report of All Selected Parcels**

**Case Number:** GPA-53191

**Printed On:** Wed: March 5, 2014

**Owner**

YOUNG ARTHUR L & CATHY D

YOUNG JAMES T & NANCY R

**Address**

1832 TIERRA NUEVA LN OCEANO CA 93445-8923

6521 GRAND CONCOURSE ST LAS VEGAS NV 89166-8023

**Parcel Numbe**

12624411064

12624411061