

City of Las Vegas
Office Of The City Clerk
495 South Main Street, 2nd Floor
Las Vegas, Nevada 89101

5. ✓
PRSRT STD
U.S. Postage
PAID
Las Vegas, NV
Permit No. 1630

Return Service Requested
Official Notice of Public Hearing

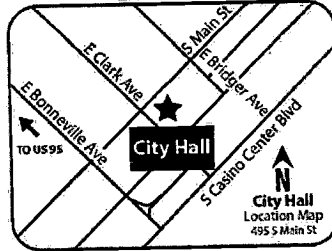

If you wish to file your protest or support on this request, check the appropriate box below and return this card in an envelope with postage to the Office Of The City Clerk at the address listed above or fax this side of this card to (702) 382-4803. If you would like to contact your Council Representative, please call (702) 229-6405.

I SUPPORT
this Request

I OPPOSE
this Request

Please use available blank space on card for your comments.

ZON-64975 & SDR-64976

City Council Meeting of 9/7/2016

16 ✓

Application Information

ZON-64975 - REZONING - PUBLIC HEARING - APPLICANT/OWNER: SANDHILL VILLAS, LLC - For possible action on a request for a Rezoning FROM: R-E (RESIDENCE ESTATES) TO: R-3 (MEDIUM DENSITY RESIDENTIAL) on 1.26 acres at the southeast corner of Owens Avenue and Sandhill Road (APN 140-30-501-002), Ward 3 (Coffin) [PRJ-64775]. The Planning Commission (5-0 vote) and Staff recommend APPROVAL.

SDR-64976 - SITE DEVELOPMENT PLAN REVIEW RELATED TO ZON-64975 - PUBLIC HEARING - APPLICANT/OWNER: SANDHILL VILLAS, LLC - For possible action on a request for a Site Development Plan Review FOR A PROPOSED 30-UNIT MULTI-FAMILY RESIDENTIAL DEVELOPMENT WITH A WAIVER OF PERIMETER LANDSCAPE STANDARDS TO ALLOW A ZERO-FOOT BUFFER ALONG THE EAST PROPERTY LINE WHERE SIX FEET IS REQUIRED on 1.26 acres at the southeast corner of Owens Avenue and Sandhill Road (APN 140-30-501-002), R-E (Residence Estates) Zone [PROPOSED: R-3 (Medium Density Residential)], Ward 3 (Coffin) [PRJ-64775]. The Planning Commission (5-0 vote) and Staff recommend APPROVAL.

Any and all interested persons may appear and be heard at said meeting, or may, prior thereto, file written objections thereto or approvals thereof with the City Clerk, 2nd Floor, City Hall, 495 South Main Street, Las Vegas, Nevada, 89101. For further information, please call (702) 229-6311 (TTY 7-1-1). **Note that postcards and comments received after an agenda posts will not be reflected online until after the meeting; however, the comments are made available to the members of the governing body for their consideration prior to the meeting.**

Application Location

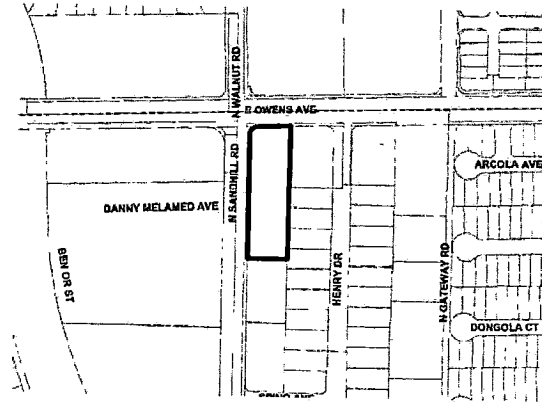

The proposed project may not pertain to the entire highlighted project site.

Public Hearing Information

Meeting: City Council
Date: *September 7, 2016*
Time: 9:00 A.M.
Location: City Council Chambers
495 South Main Street, 2nd Floor
Las Vegas, Nevada

S-✓

Report of All Selected Parcels

Case Number:

ZON-64975 & SDR-64976

Printed On: Tue: August 23, 2016

<u>Owner</u>	<u>Address</u>	<u>Parcel Number</u>
1428 STEVENS ST TRUST	5976 ZAWAWI CT LAS VEGAS NV 89110-5019	14030112070
4121 GALVA SERIES ZAMORA & ZAMOR	6928 WHISTLER RIDGE AVE LAS VEGAS NV 89110	14030522044
ACLUBA LESTER	1624 MENO PEAK ST LAS VEGAS NV 89115-1106	14019813019
ACLUBA SUSANA D & CESAR G	ACLUBA LESTER ALLEN D 1618 MENO PEAK ST LAS VEGAS NV 89115-1106	14019813018
AGUILAR EDWIN & MARTA	1606 MENO PEAK ST LAS VEGAS NV 89115-1106	14019813016
AKIOYAME BLANKSON & DOROTHY	5692 W BEDFORD FRESNO CA 93722	14030521018
ALCIVAR ELIAS E & RAQUEL	1910 VERDE MIRADA DR LAS VEGAS NV 89115-3845	14030521017
ALLEN SUSAN MARIE	3956 REBECCA RAITER AVE # 201 LAS VEGAS NV 89110	14030115099
ALMARAZ-REYES ARMANDO	ALMARAZ IRMA L 4101 PARK POINT CT LAS VEGAS NV 89110-1257	14030521026
ALTAMIRANO MARIA	1513 HENRY DR LAS VEGAS NV 89110	14030512022
ALVARADO SILVANO	4108 PARK POINT CT LAS VEGAS NV 89110-1290	14030521029
ALVAREZ ABELINO & STEFANIE	4104 DONGOLA CT LAS VEGAS NV 89110-5773	14030522069
AMERICAN LIVING TRUST	3869 PECAN LN LAS VEGAS NV 89115-7348	14019410034
ANAYA CLAUDIA	P O BOX 6235 SAN PABLO CA 94806	14030115004
ANDRADE-CUEVAS RITA	4124 ARCOLA AVE LAS VEGAS NV 89110-1254	14030521002
ANDREWS DERON L	AQUILAR-CALDERON ROSALVA 4101 ARCOLA AVE LAS VEGAS NV 89110-1247	14030521044
ANTUNES-MENDOZA CLAUDIO	2100 STEWART AVE #A LAS VEGAS NV 89101	14030115011
APONTE EDUARDO RIVERA	3957 DANNY MELAMED AVE #102 NORTH LAS VEGAS NV 89032	14030115086
ARABI BRIAN & TAMMY	22514 CASS AVE WOODLAND HILLS CA 91364	14030115100
ARABI BRIAN & TAMMY	22514 CASS AVE WOODLAND HILLS CA 91364-2910	14030115098
ARABI BRIAN & TAMMY	22514 CASS AVE WOODLAND HILLS CA 91364	14030115088
ARCAINA ANTONIO & TERESITA	4113 PARK POINT CT LAS VEGAS NV 89110-5728	14030521023
ARCEO MATEO G	1627 LEGATO FALLS ST LAS VEGAS NV 89115-1105	14019813002
ARELLANO RICARDO	4105 PARK POINT CT LAS VEGAS NV 89110-1257	14030521025
ARENDELL SHERRI	3829 PECAN LN LAS VEGAS NV 89115-7348	14019410029
AREVALO BRYAN JOSE	3960 DANNY MELAMED AVE #101 LAS VEGAS NV 89110-7002	14030115021
AREVALO MARTHA	4116 GALVA CT LAS VEGAS NV 89110-5776	14030522054
ARLINGTON HEIGHTS TRUST	DIAZ ALLENDE TRS 1456 ARLINGTON HEIGHTS ST LAS VEGAS NV 89110-5768	14030522006
ARRIETA LUCIA F	1966 DALISAI CIR STOCKTON CA 95206-6114	14030115091
ARRIETA LUCIA F	1966 DALISAI CIR STOCKTON CA 95206-6114	14030115074
ARTALEJO ADOLFO JR	ARTALEJO MARIA & ADOLFO 4113 GALVA CT LAS VEGAS NV 89110-5776	14030522046
ASFOUR INC	3980 E OWENS AVE LAS VEGAS NV 89110-1286	14019801011

16 ✓

Report of All Selected Parcels**Case Number:**

ZON-64975 & SDR-64976

Printed On: Tue: August 23, 2016

<u>Owner</u>	<u>Address</u>	<u>Parcel Number</u>
ATALLA BARRY & NAJOUA MEKOUAR	3727 FAUST AVE LONG BEACH CA 90808	14030115070
ATALLA BARRY & NAJOUA MEKOUAR	3727 FAUST AVE LONG BEACH CA 90808	14030115106
B K K S HOLDINGS L L C	80 S LAKE AVE #719 PASADENA CA 91109	14019802008
BAEZ ALONSO & ALMA	1391 MOUNT HOOD ST LAS VEGAS NV 89110	14030521022
BAHN JOHN E & PUAULA E	4100 ARCOLA AVE LAS VEGAS NV 89110-1244	14030521045
BALKE JOSEPH ROMANO	FALKENTHAL-BALKE CONSTANZE F M 3814 PECAN LN LAS VEGAS NV 89115	14019410049
BARAJAS ALFREDO LIVING TRUST	BARAJAS ALFREDO TRS 1270 BURNHAM AVE #1119 LAS VEGAS NV 89104	14030512014
BECERRA ALFREDO M & MARIA I	4109 ARCOLA AVE LAS VEGAS NV 89110-1247	14030521042
BENAVIDES LEO	957 RINGWOOD LN LAS VEGAS NV 89110-2769	14030115068
BENAVIDES LEO	957 RINGWOOD LN LAS VEGAS NV 89110-2769	14030115065
BENAVIDES LEO	957 RINGWOOD LN LAS VEGAS NV 89110-2769	14030115066
BENAVIDES LEO	957 RINGWOOD LN LAS VEGAS NV 89110-2769	14030115067
BOBADILLA-ROMERO ARMIDA	1708 CHARNUT LN LAS VEGAS NV 89115-6319	14019410087
BONILLA MAYRA M	4113 ARCOLA AVE LAS VEGAS NV 89110-1247	14030521041
BOYD JANNETTE REVOCABLE LIV TR	BOYD JANNETTE TRS 1401 N GATEWAY RD LAS VEGAS NV 89110-1202	14030502007
BRADLEY CHARLES	KIRWAN SEAN 23 WAVERLY PL #4K NEW YORK NY 10003-6712	14030115111
BRISVEGAS SERIES IV L L C	840 S RANCHO DR #4-620 LAS VEGAS NV 89106	14030521001
BUDDS ARTHUR LEROY LIVING TRUST	BUDDS ARTHUR TRS 5550 E OWENS AVE LAS VEGAS NV 89110-1714	14019410046
BUENO ROXANNA	1647 MENO PEAK ST LAS VEGAS NV 89115-1107	14019813026
BUTLER FAMILY TRUST	BUTLER ROY E & DAVID R TRS 3865 BUTTERNUT LN LAS VEGAS NV 89115-7343	14019410085
CALDERON ADELA B	1648 LEGATO FALLS ST LAS VEGAS NV 89115-1105	14019813029
CANTATA ASSOCIATION	6625 S VALLEY VIEW #310 LAS VEGAS NV 89118-4557	14019813037
CANTATA ASSOCIATION	6625 S VALLEY VIEW #310 LAS VEGAS NV 89118-4557	14019813035
CANTATA ASSOCIATION	6625 S VALLEY VIEW #310 LAS VEGAS NV 89118-4557	14019813034
CANTATA ASSOCIATION	6625 S VALLEY VIEW #310 LAS VEGAS NV 89118-4557	14019813036
CARAGAN DEBBIE A	1641 MENO PEAK ST LAS VEGAS NV 89115-1107	14019813027
CARRILLO-PEREZ MIGUEL	1324 STEVENS ST LAS VEGAS NV 89110	14030112060
CASSE L L C	7341 BROOKCREST AVE LAS VEGAS NV 89131	14030512024
CASTILLO HUGO	ALARCON MEDARDO 4113 TALAVERA CT LAS VEGAS NV 89110-5778	14030522028
CASTRO ANTONIO	1517 HENRY DR LAS VEGAS NV 89110-1240	14030512023
CHAN CHEUNG K	8064 W SAHARA AVE #100 LAS VEGAS NV 89117	14030115031
CHARLEBIOX PATRICIA RUTH	RYAN TIMOTHY GEORGE 6826 DONALD NELSON AVE LAS VEGAS NV 89131-3330	14019801006

Report of All Selected Parcels**Case Number:**

ZON-64975 & SDR-64976

Printed On: Tue: August 23, 2016

<u>Owner</u>	<u>Address</u>	<u>Parcel Numbe</u>
CHAVEZ MARIA	4109 GALVA CT LAS VEGAS NV 89110-5776	14030522047
CHEUNG PAUL & LOUELLA F	CHEUNG MICHAEL PAUL & CHRISTINA 2401 CHRISTIAN CT PINOLE CA 94564-2801	14019813017
CHOW & YU FAMILY TRUST ETAL	YU DAISY H TRS 7163 TWINSBUR CT EASTVALE CA 92880	14030522053
CITY OF LAS VEGAS	495 S MAIN ST 6TH FL LAS VEGAS NV 89101-6318	14030521004
CITY OF LAS VEGAS	333 N RANCHO DR 8TH FL LAS VEGAS NV 89106-3703	14030601001
CITY TOWER L L C	203 WATER #200 HENDERSON NV 89015-7226	14030505001
CONTRERAS GERARDO & ANGELICA	15167 MYSTIC ST WHITTIER CA 90604	14030513001
CORDERO ALFREDO	825 N LAMB BLVD #56 LAS VEGAS NV 89110	14019410042
CORDOVA OSCAR A & OSCAR	4104 ARCOLA AVE LAS VEGAS NV 89110-1244	14030521046
CORRAL CARLOS	3961 DANNY MELAMED AVE #102 LAS VEGAS NV 89110-7003	14030115082
CORRAL ISAAC & MARIA L	4128 PARK POINT CT LAS VEGAS NV 89110-1256	14030521034
CORTEZ JAIME H	4128 GALVA CT LAS VEGAS NV 89110-5777	14030522057
CROOKS JIMMY & LATONYA	1609 LEGATO FALLS ST LAS VEGAS NV 89115-1105	14019813005
CUELLAR JOSE JUAN	RAMOS-QUIRARTE MARICRUZ 1448 ARLINGTON HEIGHTS LAS VEGAS NV 89110-5768	14030522008
DAVALOS JOSE DEJESUS	1432 STEVENS ST LAS VEGAS NV 89110-1177	14030112071
DAVILA VINCENTE HERRERA	DEHERRERA BEATRIZ CARRILLO P O BOX 51 TIPTON CA 93272	14030112066
DAVIS BERNARD L & LETTIE M	202 6TH ST HUNTINGTON BEACH CA 92648-5004	14019410128
DEACOSTA MARTHA CONTRERAS	3953 REBECCA REITER #102 LAS VEGAS NV 89110-7010	14030115042
DEBOLD ADRIANNE	3815 PECAN LN LAS VEGAS NV 89115-7348	14019410024
DECORDOVA ANA ARELLANO	1544 ARLINGTON HEIGHTS LAS VEGAS NV 89110-1255	14030521010
DELATORRE MARTIN	4101 TALAVERA CT LAS VEGAS NV 89110-5778	14030522031
DELGADO HENRY	1206 N GROVE AVE ONTARIO CA 91764-2533	14030115052
DELICE ADELAIDA M	3076 PANORAMA RD #A RIVERSIDE CA 92506	14030115109
DESERT CASITAS MANAGEMENT L L C	8129 SOPPHIRE BAY CIR LAS VEGAS NV 89128-7719	14030115043
DESERT CASITAS MANAGEMENT L L C	8129 SOPPHIRE BAY CIR LAS VEGAS NV 89128-7719	14030115041
DIAZ JUAN MANUEL & FRANCISCO J	3896 DELLING CT LAS VEGAS NV 89104	14030502009
DIAZ MANUEL	P O BOX 1038 SOUTH GATE CA 90280-1038	14030112007
DIAZ MARIA REMEDIOS NUNEZ TRUST	DIAZ MARIA REMEDIOS NUNEZ TRS P O BOX 30325 BAKERSFIELD CA 93385-1325	14030502008
DIRKSON LISA M LIVING TRUST	DIRKSON LISA M TRS 3803 BUTTERNUT LN LAS VEGAS NV 89115-7343	14019410078
DUNN ROBERT T	2550 DENVER ST SAN DIEGO CA 92110	14019410091
DYER RONALD W	14021 DOOLITTLE DR SAN LEANDRO CA 94577-5537	14030522063
EAGLE ESTATES L L C	2765 LAGUNA SECA AVE HENDERSON NV 89052-4430	14030522056

Report of All Selected Parcels**Case Number:**

ZON-64975 & SDR-64976

Printed On: Tue: August 23, 2016

Owner	Address	Parcel Number
EDBON L L C	1760 HARDROCK ST LAS VEGAS NV 89156-7196	14019403001
ELIMOR CHEN	9315 PYROPE ST LAS VEGAS NV 89148	14030512015
ELVA TRUST	2602 LOSEE RD NORTH LAS VEGAS NV 89030-4134	14030513005
EMERSON HELEN G	LINDQUIST KAREN P O BOX 44044 LAS VEGAS NV 89116-2044	14030112031
ENKHBAYAR ZOLZAYA	421 S LA FAYETTE PARK P1 #419 LOS ANGELES CA 90057	14030115108
ESTRADA IMELDA S & CEFERINO P	MEDRANO NOEL J 1654 LEGATO FALLS ST LAS VEGAS NV 89115-1105	14019813030
ESTRADA IVETT Z	2311 LA PUENTA ST LAS VEGAS NV 89115	14030115092
ESTRADA MELANIA A & ROMEO	1620 LEGATO FALLS ST LAS VEGAS NV 89115-1105	14019813008
ESTRADA MIGUEL	3961 REBECCA RAITER AVE #201 LAS VEGAS NV 89110	14030115051
FALCON JORGE A & ELVIRA	8924 OTIS ST SOUTH GATE CA 90280-3204	14019410045
FAVELA AGUSTIN	3410 DUSTY VIEW ST NORTH LAS VEGAS NV 89030	14019411012
FAVELA OSCAR	5525 HIDDEN RAINBOW NORTH LAS VEGAS NV 89031-2961	14030502001
FIERRO IMELDA N	4443 EL CARMAL WY LAS VEGAS NV 89121-6633	14030115034
FLEMING KENNETH E & JOY C LIV TR	FLEMING JOY C TRS 7850 N WILLIAMSON VALLEY RD PRESCOTT AZ 86305	14030501001
FODAY ALEO	1643 LEGATO FALLS ST LAS VEGAS NV 89115-1105	14019813033
FRANCISCO & CONSUELO LIVING TR	RIVERA FRANCISCO & CONSUELO TRS 1501 HENRY DR LAS VEGAS NV 89110-1240	14030512019
FRAUSTO-ROJAS FLORENCIO	1552 ARLINGTON HEIGHTS ST LAS VEGAS NV 89110-1255	14030521008
FRYE FAMILY REVOCABLE LIVING TR	FRYE BILLY JOE & YOSHIKO TRS 1524 STEVENS ST LAS VEGAS NV 89110-1122	14030112080
GALVAN GUSTAVO	4129 PARK POINT CT LAS VEGAS NV 89110-5728	14030521019
GANDARA ANDRES N & MARGARITA E	1436 ARLINGTON HEIGHTS ST LAS VEGAS NV 89110-5753	14030522011
GARCIA ANDRES	HERNANDEZ MARIA E 4140 ARCOLA LAS VEGAS NV 89110-1254	14030521006
GARCIA-AGUILAR JOAQUIN	1520 BEN OR #101 LAS VEGAS NV 89110-7023	14030115033
GARNER LEK S	1532 ARLINGTON HEIGHTS ST LAS VEGAS NV 89110-1255	14030521013
GO KEVIN	LEE FERDINAND V 3859 S VALLEY VIEW BLVD #2-212 LAS VEGAS NV 89103	14030115036
GODINEZ EUTIQUIO	1614 LEGATO FALLS ST LAS VEGAS NV 89115-1105	14019813007
GODNIA-VELAZQUEZ ERIKA JUDITH	3964 DANNY MELAMED #102 LAS VEGAS NV 89110-7005	14030115018
GONZALES RICARDO VALLIN	DIAZ ARIANA MORAN 4252 CANDLE CREEK LN NORTH LAS VEGAS NV 89032	14030115054
GONZALEZ JESUS J & ELENA R	1708 NUTMEG LN LAS VEGAS NV 89115	14019410131
GONZALEZ JOSE M	530 E 68TH ST LOS ANGELES CA 90003-1911	14030112063
GONZALEZ JUAN & MARIA	3417 E WEBB AVE NORTH LAS VEGAS NV 89030-7413	14030522060
GOTO KOJI & JANET S	710 11TH ST S GREAT FALLS MT 59405-2127	14019410084
GRANADOS FRANCISCA	10029 MOSBY WOODS DR #148 FAIRFAX VA 22030-1726	14019410090

Report of All Selected Parcels**Case Number:**

ZON-64975 & SDR-64976

Printed On: Tue: August 23, 2016

Owner	Address	Parcel Number
GROCE FAMILY TRUST	GROCE RODNEY A & MARILYN TRS 1724 CHARNUT LN LAS VEGAS NV 89115-6319	14019410089
GROVEWOOD NEVADA L L C	9 PARK MEADOW CT LAS VEGAS NV 89141	14030521003
GUERRA HERMOGENES & MARIA M	25682 STORIL ST VALENCIA CA 91355	14030521038
GUERRA-GARCIA RAUL EDUARDO & MAR	3216 PARAGON PT LAS VEGAS NV 89127	14030115097
GUTIERREZ CRUZ & MAGDALENA	709 WEATHERSTONE DR LAS VEGAS NV 89110-5436	14030512016
GUTIERREZ LUIS CIRILO	1440 STEVENS ST LAS VEGAS NV 89110-1177	14030112073
GUTIERREZ LUIS G GARCIA	205 S WALLCE DR LAS VEGAS NV 89107	14030115064
HARDING MARY J	1632 LEGATO FALLS ST LAS VEGAS NV 89115-1105	14019813010
HARVEY PATRICIA ANN	1520 STEVENS ST LAS VEGAS NV 89110-1122	14030112079
HEALTH FIRST CORP	5000 W OAKLEY BLVD #A1 LAS VEGAS NV 89146	14030112072
HENRY LTD	7065 W ANN RD #130-430 LAS VEGAS NV 89130	14030513002
HEREDIA EDWARD A	P O BOX 358 SAN GABRIEL CA 91778-0358	14030512005
HERMOSILLO ARMANDO & RUFINA	4527 W 111 STREET LENNOX CA 90304	14030115107
HERNANDEZ ALBERTO & ANA L	4108 GALVA CT LAS VEGAS NV 89110-5776	14030522052
HERNANDEZ ESPERANZA	1616 STYRENZ ST #A2 LAS VEGAS NV 89115	14019411010
HERNANDEZ WILLIAM	1909 BUNKER AVE S EL MONTE CA 91733-4105	14030522075
HERRERA VINCENTE	DEHERRERA BEATRIZ P O BOX 51 TIPTON CA 93272-0051	14030112067
HIGUERA JUAN & MICHELLE	1724 NUTMEG LN LAS VEGAS NV 89115-6315	14019410133
HOLMES FAMILY TRUST	HOLMES RONALD E & CARRIE M TRS 1732 NUTMEG LN LAS VEGAS NV 89115-6315	14019410134
HOROWITZ JEFFREY B	LEE CAROL LIFENG 1251 VIA VIENTO SUAVE SAN MARCOS CA 92078-5263	14030115044
HOSTIA CESAR	3436 LACEBARK PINE ST LAS VEGAS NV 89129	14019802011
HOWARD DANIELLE R	520 BLANCHE CT HENDERSON NV 89052-7812	14030115077
HOWARD MARK LOUIS	5421 E HARMON AVE #M-12 LAS VEGAS NV 89112	14019410028
HURTADO EFRAIN & JULIA	1844 TARR PL POMONA CA 91766-5136	14030112077
IGLESIAS ANER & REBECCA	P O BOX 29269 LAS VEGAS NV 89126	14030522050
INTEGRITY WEALTH BUILDING L L C	P O BOX 5556 SAN CLEMENTE CA 92674	14030115078
INTEGRITY WEALTH BUILDING L L C	P O BOX 5556 SAN CLEMENTE CA 92674	14030115080
J P B TRUST	BYHAM JAMES C & PATRICIA A TRS 2061 HERITAGE OAKS ST LAS VEGAS NV 89119-7802	14019410037
JACKS DEANNA L	5023 E MONROE AVE LAS VEGAS NV 89110	14030512013
JIMENEZ ROSALINDA G	9537 S V L BOX VICTORVILLE CA 92395	14030502002
JORDAN ASSOCIATE INTL L L C	11 EMBARRADERO WEST #210 OAKLAND CA 94607-4543	14030115055
K D W L L C	9575 TRATTORIA LAS VEGAS NV 89178-8261	14030115022

Report of All Selected Parcels**Case Number:**

ZON-64975 & SDR-64976

Printed On: Tue: August 23, 2016

Owner	Address	Parcel Number
KAMARA LANSANA	1207 WHITPAIN HILLS BLUE BELL PA 19422	14030115013
KARSNOK SHELLEY E	4112 TALAVERA CT LAS VEGAS NV 89110-5778	14030522035
KASHANI OMRI	%STEVE BLAND GROUP 2654 W HORIZON RIDGE PKWY #B5-25 4HENDERSON NV 89052	14030115016
KING ERIC D	131 COVINGTON ST OAKLAND CA 94605-5805	14030115087
KIRBY ROBERT E II	PATT-KIRBY LAUREN 3873 BUTTERNUT LN LAS VEGAS NV 89115-7343	14019410086
KOHN RUTH	15025 72ND RD FLUSHING NY 11367-2155	14030115027
KOTHARI DEEPEN	4121 ARCOLA AVE LAS VEGAS NV 89110-1252	14030521039
KUVER ANIL & SUDHA D	4124 DONGOLA CT LAS VEGAS NV 89110-5774	14030522074
LAHEY KERRIANN	P O BOX 13802 LAS VEGAS NV 89112	14019813001
LANIER SHIRLEY COOK & ARTHUR LEE	1501 N GATEWAY RD LAS VEGAS NV 89110-1203	14030502004
LARA LAURA	4125 DONGOLA CT LAS VEGAS NV 89110-5774	14030522061
LARA MIRNA NINETH	VASCONCELOS MIGUEL ANGEL FAJARDO 1492 LADY BRYAN LN LAS VEGAS NV 89110	14030115003
LEE CLOMA LIVING TRUST	HOFFMAN CLOMA LEE TRS 2990 LA BARCA LN LAS VEGAS NV 89122	14019410082
LEE STEVEN	WONG CHRISTINE 9257 PITKIN ST ROSEMEAD CA 91770	14030115017
LEEPER ADA MARIE REVOCABLE TRUST	1500 STEVENS ST LAS VEGAS NV 89110-1122	14030112074
LEGASPI JOSE JESUS & JUDY E	5564 GALASSO AVE FONTANA CA 92336-5921	14030512006
LEON LORENZO & BLANCA ROSA	4129 ARCOLA AVE LAS VEGAS NV 89110-1252	14030521037
LEON RIGOBERTO & F REV TR	LEON RIGOBERTO & FLORIDALMA TRS 1244 RONNIE ST WEST COVINA CA 91792-1330	14030522071
LEYVA ROSARIO	1508 BEN OR ST #202 LAS VEGAS NV 89110-7021	14030115096
LOGSDON BARBARA JO	3739 PECAN LN LAS VEGAS NV 89115-6320	14030512009
LOPEZ JUAN S	RODRIGUEZ GLORIA 4125 PARK POINT CT LAS VEGAS NV 89110-5728	14030521020
LOPEZ NALLELY	4133 GALVA CT LAS VEGAS NV 89110-5777	14030522041
LOPEZ-PENALOZA MARCOS & ALBERTO	LOPEZ-PENALOZA JUAN CARLOS 1437 HENRY DR LAS VEGAS NV 89110-1240	14030512018
LOZANO SILVANO N & VICTORIA M	4100 DONGOLA CT LAS VEGAS NV 89110-5773	14030522068
LULE JOSE	1697 N GATEWAY RD LAS VEGAS NV 89115-6428	14019801007
M C REALTY L L C	41815 MISSION CREEK DR FREMONT CA 94539-4719	14030522029
M F S 26 L L C	P O BOX 364826 NORTH LAS VEGAS NV 89036	14030512003
M I R I FAMILY L L C SERIES I	2973 HARBOR BLVD #172 COSTA MESA CA 92626	14030115024
MA WANQIU	18593 WOLDORF PL ROWLAND HEIGHTS CA 91748	14030115083
MANCILLA JOSE LUIS	4108 TALAVERA CT LAS VEGAS NV 89110	14030522034
MANCINAS-HERNANDEZ RAFAEL A	MANCINAS GAYLENE R 1524 N BEN OR ST #101 LAS VEGAS NV 89110-7025	14030115037
MANGAN AMY & GUY S JR	1722 PEANUT CT LAS VEGAS NV 89115-6380	14019410162

Report of All Selected Parcels**Case Number:**

ZON-64975 & SDR-64976

Printed On: Tue: August 23, 2016

<u>Owner</u>	<u>Address</u>	<u>Parcel Number</u>
MARQUEZ ESTELA	1404 STEVENS ST LAS VEGAS NV 89110-1177	14030112064
MARTINEZ CESAR ADRIAN	1512 ARLINGTON HEIGHTS ST LAS VEGAS NV 89110-5768	14030522001
MARTINEZ MARIO A	MENJIVAR BALVINA A 629 QUEEN ST BRIDGEPORT CT 06606-3343	14030522033
MARVICK GERALD CARL SR	3853 PECAN LN LAS VEGAS NV 89115-7348	14019410032
MARX RONALD & KIMBERLY	4660 S EASTERN AVE #207 LAS VEGAS NV 89119-6139	14030502010
MARZOLO FERMIN TEOTILO JUAN	%CONSULTING 89103 400 S 4TH ST #270 LAS VEGAS NV 89101	14030115084
MASCORRO JOSE DOMINGO	1504 ARLINGTON HEIGHTS ST LAS VEGAS NV 89110-5768	14030522003
MAUCK BOBBIE	1716 NUTMEG LN LAS VEGAS NV 89115	14019410132
MCGAUGHEY ADAM	P O BOX 570296 LAS VEGAS NV 89157-0296	14019410083
MEDINA-VILLAREAL CECILIA	RODRIGUEZ-VALENZUELA MARIO A 3808 PECAN LN LAS VEGAS NV 89115-7300	14019410050
MENDEZ MARCO & OLGA K	4120 DONGOLA CT LAS VEGAS NV 89110-5773	14030522073
MENDOZA ALBERTO	4212 TIMPANI DR LAS VEGAS NV 89110	14030115095
MENDOZA MARIA L	RAMIREZ TEODORO MENDOZA 3908 CARLA ANN RD NORTH LAS VEGAS NV 89081	14030522045
MENDOZA-QUIROZ JUAN	4116 DONGOLA CT LAS VEGAS NV 89110-5773	14030522072
MERCADO JOHN	12173 PASO VERANO YUMA AZ 85367	14019813006
MES VENTURES L L C	1685 H ST #29229 BLAINE WA 98230	14030115025
MICHEL JAVIER	1508 JOHN BEVY CT NORTH LAS VEGAS NV 89086-1382	14019411008
MICHEL NORBERTO	1460 ARLINGTON HEIGHTS ST LAS VEGAS NV 89110-5768	14030522005
MIGDAL GOLDA	1624 ASPEN MEADOWS DR HENDERSON NV 89014	14030115069
MIKHALSKY OLGA SEPARATE PROPERTY	MIKHALSKY OLGA TRS 10991 CLAIREMONT MESA BLVD SAN DIEGO CA 92124-1429	14030115076
MIKHALSKY OLGA SEPARATE PROPERTY	MIKHALSKY OLGA TRS 10991 CLAIREMONT MESA BLVD SAN DIEGO CA 92124-1429	14030115075
MIRAMONTES DORA LUS	1615 LEGATO FALLS ST LAS VEGAS NV 89115-1105	14019813004
MIRI FAMILY L L C	2973 HARBOR BLVD #162 COSTA MESA CA 92626	14030115012
MIRI FAMILY L L C	2973 HARBOR BLVD #162 COSTA MESA CA 92626	14030115005
MIRI FAMILY L L C	2973 HARBOR BLVD #162 COSTA MESA CA 92626	14030115020
MIRI FAMILY L L C	2973 HARBOR BLVD #162 COSTA MESA CA 92626	14030115049
MIRI FAMILY L L C	2973 HARBOR BLVD #162 COSTA MESA CA 92626	14030115006
MIRI FAMILY L L C SERIES 17	%MIRI FAM TR-M MIRI-M SOLTANI 2973 HARBOR BLVD #162 COSTA MESA CA 92626	14030115089
MITCHELL DALE E	4104 PARK POINT CT LAS VEGAS NV 89110-1290	14030521028
MIYAZAKI NISABURO	1705 NUTMEG LN LAS VEGAS NV 89115-6314	14019410129
MODESTO ABELARDO	4768 WOODBRIDGE RD LAS VEGAS NV 89121-5814	14030521021
MONAHAN TIMOTHY P JR & DESIREE D	3921 CULL CANYON DR LAS VEGAS NV 89110	14030112019

Report of All Selected Parcels**Case Number:**

ZON-64975 & SDR-64976

Printed On: Tue: August 23, 2016

<u>Owner</u>	<u>Address</u>	<u>Parcel Number</u>
MONTES OSCAR	4007 FOLSOM DR ANTIOCH CA 94531	14030115029
MONTES OSCAR	4007 FOLSOM DR ANTIOCH CA 94531	14030115102
MONTES OSCAR	4007 FOLSOM DR ANTIOCH CA 94531	14030115103
MONTES OSCAR	GOMEZ DORA 4007 FOLSOM DR ANTIOCH CA 94531	14030115023
MONTESINOS FERNANDO E CAMPOS	P O BOX 26051 LAS VEGAS NV 89126-0051	14019411011
MONTOYA FELIPE DE JESUS	1556 ARLINGTON HEIGHTS ST LAS VEGAS NV 89110-1255	14030521007
MONZON FRANCISCO J	GONZALEZ JUANA 1433 HENRY DR LAS VEGAS NV 89110-1285	14030512017
MORALES DANIEL GARCIA	1640 MENO PEAK ST LAS VEGAS NV 89115-1107	14019813022
MORALES-TOVAR OCTAVIO	1621 LEGATO FALLS ST LAS VEGAS NV 89115	14019813003
MOYAL DAVID & EINAT	6506 CAPISTRANO AVE WEST HILLS CA 91307-3701	14030115014
MURRIETA MANUEL	CALVARIO GREGORIA 3837 PECAN LN LAS VEGAS NV 89115	14019410030
MYERS STEVEN C	3845 PECAN LN LAS VEGAS NV 89115-7348	14019410031
NATIONAL HORIZON CORP	5258 S EASTERN AVE #252 LAS VEGAS NV 89119-2328	14030502015
NAVARRETE ROCIO	224 HORIZON PEAK AVE HENDERSON NV 89012-4803	14030521040
NEVADA DREAM HOMES INC	3150 W SAHARA AVE #B-11 LAS VEGAS NV 89102	14030521043
NEVADAREALCO COM L L C	2375 E TROPICANA AVE #800 LAS VEGAS NV 89119-6564	14030115058
NGO MYLINH VU	329 EDUCATIONAL PARK DR SAN JOSE CA 95133-1713	14030115056
NIEMANN ROLF A	1684 N WALNUT RD LAS VEGAS NV 89115-6437	14019801004
NIEMIEC IRREVOCABLE TRUST	CHOUINARD WILLIAM TRS 20519 CRESCENT POINTE PL ASHBURN VA 20147	14019410033
NUNEZ GABRIELA F	91 E PALOMAR ST CHULA VISTA CA 91911	14030115008
O KEI	TOU TOU SI 3969 REBECCA RAITER AVE #202 LAS VEGAS NV 89110	14030115060
O'BRIEN ANITA L	1699 N GATEWAY RD LAS VEGAS NV 89115	14019801005
OJEDA FRANCISCO	ESCAMILLA SOFIA 623 VERMEER ST LAS VEGAS NV 89110-3922	14030112006
OLIVARES GEDEON	4105 GALVA CT LAS VEGAS NV 89110-5776	14030522048
OLIVEIRA ALEXANDRE RAFAEL	1646 MENO PEAK ST LAS VEGAS NV 89115	14019813023
OLSON JOSIAH N & MARY A	1930 VILLAGE CENTER CIR #3-9313 LAS VEGAS NV 89134	14030522066
OWENS STAR L L C	107 S WATER ST #210 HENDERSON NV 89015-7454	14030102006
P & T LEGACY L L C	3143 COLESHILL ST LAS VEGAS NV 89135	14019410036
P & T LEGACY L L C	3143 COLESHILL ST LAS VEGAS NV 89135	14019410147
P & T LEGACY L L C	3143 COLESHILL ST LAS VEGAS NV 89135	14019410148
P & T LEGACY L L C	3143 COLESHILL ST LAS VEGAS NV 89135	14019410038
P & T LEGACY L L C	3143 COLESHILL ST LAS VEGAS NV 89135	14019410146

Report of All Selected Parcels**Case Number:**

ZON-64975 & SDR-64976

Printed On: Tue: August 23, 2016

<u>Owner</u>	<u>Address</u>	<u>Parcel Number</u>
P & T LEGACY L L C	3143 COLESHILL ST LAS VEGAS NV 89135	14019410088
P J L INVESTMENTS L L C	9575 TRATTORIA ST LAS VEGAS NV 89178-8261	14030115048
P J L INVESTMENTS L L C	9575 TRATTORIA ST LAS VEGAS NV 89178-8261	14030115039
P J L INVESTMENTS L L C	9575 TRATTORIA ST LAS VEGAS NV 89178-8261	14030115040
P R B PARTNERS L L C	17555 VENTURA BLVD #202 ENCINO CA 91316	14030521024
PACAMARA MELGIE C & REYNALDO M	1571 W 34TH ST LONG BEACH CA 90810-2338	14019813015
PACE MICHAEL	334 SKY WAY DR SAN JOSE CA 95111	14030115010
PALMERIN-GONZALEZ SALVADOR	PALMERIN MARIA C 1630 MENO PEAK ST LAS VEGAS NV 89115-1106	14019813020
PAND T LEGACY L L C	3143 COLESHILL ST LAS VEGAS NV 89135	14019410035
PAND T LEGACY L L C	3143 COLESHILL ST LAS VEGAS NV 89135	14019410041
PARADA-GOMEZ PABLO	PARADA JOVITA 4109 DONGOLA CT LAS VEGAS NV 89110-5773	14030522065
PATEL NARENDRA & ROHINI TRUST	PATEL NARENDRA & ROHINI TRS 3215 PINOT BLANC WY SAN JOSE CA 95135-1141	14030115001
PATEL NARENDRA & ROHINI TRUST	PATEL NARENDRA & ROHINI TRS 3215 PINOT BLANC WY SAN JOSE CA 95135-1141	14030115002
PATEL NARENDRA & ROHINI TRUST	PATEL NARENDRA & ROHINI TRS 3215 PINOT BLANC WY SAN JOSE CA 95135-1141	14030115061
PATEL NARENDRA & ROHINI TRUST	PATEL NARENDRA & ROHINI TRS 3956 DANNY MELAMED AVE #102 LAS VEGAS NV 89110-7000	14030115026
PEARL INVESTMENT PPTYS LLC SER 7	2705 BONAPARTE LN HENDERSON NV 89044-0300	14030513007
PEARL INVESTMENT PPTYS LLC SER 8	2705 BONAPARTE LN HENDERSON NV 89044-0300	14030512011
PEARL INVESTMENT PPTYS LLC SER 9	2705 BONAPARTE LN HENDERSON NV 89044-0300	14030512012
PELAYO ENRIQUE	3964 DANNY MELAMED AVE #201 LAS VEGAS NV 89110-7005	14030115019
PENA VICTOR & MARIA E	4124 PARK POINT CT LAS VEGAS NV 89110-1256	14030521033
PEREZ LEO COVE	3964 REBECCA RAITER AVE #101 LAS VEGAS NV 89110	14030115105
PEREZ-LLAMAS LUIS F	PEREZ ROSARIO 1440 ARLINGTON HEIGHTS ST LAS VEGAS NV 89110-5768	14030522010
PINON JESSICA	1626 LEGATO FALLS ST LAS VEGAS NV 89115-1105	14019813009
PORTILLO-MARTINEZ MIGUEL A	LAINIZ VILMA A 4132 PARK POINT CT LAS VEGAS NV 89110-1256	14030521035
QUACH CUONG H	6714 CARO ST PARAMOUNT CA 90723	14030522043
QUEJADA MERITA LOPEZ	4100 PARK POINTE CT LAS VEGAS NV 89110-1290	14030521027
QUIJANO REYCEL T	1619 MENO PEAK ST LAS VEGAS NV 89115-1106	14019813013
QUILIZA ZENAIDA R	4116 PARK POINT CT LAS VEGAS NV 89110-1256	14030521031
R G GROUP CORP	MEHR KATAYOON HADIZADEH 210 SOCO DR FULLERTON CA 92832	14030115053
RAMIREZ ERICK	4125 E CAREY AVE LAS VEGAS NV 89115	14030513004
RAMIREZ JUAN DE DIOS	VILLEGAS MANUELA 10292 ARROYO AVE HESPERIA CA 92345	14030512004
RAMIREZ OSCAR & HILDA REVOCABLE	RAMIREZ OSCAR & HILDA G CO-TRS 1685 MOUNT HOOD ST LAS VEGAS NV 89156	14030512010

Report of All Selected Parcels**Case Number:**

ZON-64975 & SDR-64976

Printed On: Tue: August 23, 2016

<u>Owner</u>	<u>Address</u>	<u>Parcel Number</u>
RAMIRFS LORENZO VELAZQUEZ	6393 MAHOGANY PEAK AVE LAS VEGAS NV 89110	14030521005
RAMOS FLORENCIO	4105 TALAVERA CT LAS VEGAS NV 89110-5778	14030522030
RANGEL ROSA E	1500 HENRY DR #C LAS VEGAS NV 89110-1239	14030512007
RASKE JEFFREY	5014 S RAINBOW BLVD #102 LAS VEGAS NV 89118	14019410044
RATHBURN COREY	147 S DOHENY DR #201 LOS ANGELES CA 90048	14030513008
RAYSON PROPERTIES L L C	2801 WEHRLE DR #7 WILLIAMSVILLE NY 14221-7381	14030102004
REEDER FAMILY TRUST	REEDER CHARLES D & DARLINE L TRS 1655 N GATEWAY RD LAS VEGAS NV 89115-6428	14019801008
RICO LEONEL A & MARIA I	1540 ARLINGTON HEIGHTS ST LAS VEGAS NV 89110-1255	14030521011
ROBLES J GUADALUPE E & EVELIA	620 BROWN BREECES AVE NORTH LAS VEGAS NV 89081-8002	14030513003
ROBLES JAVIER & MARIA A	1697 S CHRISTY LN LAS VEGAS NV 89142	14030521016
RODRIGUEZ JOEL & BEATRIZ	7213 W GOWAN RD LAS VEGAS NV 89129-6551	14030512008
RODRIGUEZ MARIA GARCIA	3811 BUTTERNUT LN LAS VEGAS NV 89115-7343	14019410079
RODRIGUEZ MIGUEL & ANA MARIA	4100 TALAVERA CT LAS VEGAS NV 89110-5778	14030522032
RODRIGUEZ-MOYA CHRISTIAN RAMON	1771 CHARNUT LN LAS VEGAS NV 89115	14019410145
ROMERO CARLOS	3901 BUDLONG AVE LAS VEGAS NV 89110	14019410127
ROMO MARIA RITA	1516 STEVENS ST LAS VEGAS NV 89110-1122	14030112078
RUELAS-ORTEGA ISMAEL & ELSA S	1328 STEVENS ST LAS VEGAS NV 89110-1176	14030112061
RUIZ LOURDES M	91-1067 LELEOI ST EWA BEACH HI 96706	14030115093
S A J E L L C	6629 HYDE AVE LAS VEGAS NV 89107	14030512025
SABI PROPERTIES SERIES VI L L C	1617 BEVERLY GLEN BLVD #302 LOS ANGELES CA 90024	14030115015
SAENZ JOSE & LIBRADA P	1536 ARLINGTON HEIGHTS ST LAS VEGAS NV 89110-1255	14030521012
SALAS JAIME	1508 ARLINGTON HEIGHTS ST LAS VEGAS NV 89110-5768	14030522002
SALAS JOAQUIN & ESTELA	SALAS VERONICA 1452 ARLINGTON HEIGHTS ST LAS VEGAS NV 89110-5768	14030522007
SALGADO EDWIN V	4101 DONGOLA CT LAS VEGAS NV 89110-5773	14030522067
SALVA JESSE I & REGINA S	4133 ARCOLA AVE LAS VEGAS NV 89110-1252	14030521036
SANCHEZ ALEJANDRO & ESTHER	1548 ARLINGTON HEIGHTS ST LAS VEGAS NV 89110-1255	14030521009
SANCHEZ ALICIA C	4108 DONGOLA CT LAS VEGAS NV 89110	14030522070
SANDERS EVELYN	3820 PECAN LN LAS VEGAS NV 89115-7300	14019410048
SANDHILL VILLAS L L C	7500 W LAKE MEAD BLVD #9-232 LAS VEGAS NV 89128	14030501002
SANDOVAL MISAEAL	4120 GALVA CT LAS VEGAS NV 89110-5777	14030522055
SAVALA TONY G	1525 N GATEWAY RD LAS VEGAS NV 89110-1203	14030502003
SCANLAN KIRIFI W	4112 PARK POINT CT LAS VEGAS NV 89110-1290	14030521030

Report of All Selected Parcels**Case Number:**

ZON-64975 & SDR-64976

Printed On: Tue: August 23, 2016

<u>Owner</u>	<u>Address</u>	<u>Parcel Numbe</u>
SERVELLON ANIBAL	1508 BEN OR ST #102 LAS VEGAS NV 89110-7021	14030115094
SHAINSKY YAN A	612 DEVON PL ESCONDIDO CA 92025-5604	14030115073
SHEEHAN LAURA MAYE & KATHLEEN MA	13123 SHENANDOAH DR LAKESIDE CA 92040	14019410043
SHEWMAN MICHAEL J	3920 CULL CANYON DR LAS VEGAS NV 89110-1103	14030112030
SHILLIAN RAMIN & BEHDADI ROSA LI	BANDARI PROPERTIES L L C 18375 VENTURA BLVD #155 TARZANA CA 91356	14030522064
SHORT ASA L	1698 CHARNUT LN LAS VEGAS NV 89115-6331	14019410040
SIERRA MARIA LUISA MARTINEZ	4132 DONGOLA CT LAS VEGAS NV 89110-5774	14030522076
SILVA DEBORAH	3802 PECAN LANE LAS VEGAS NV 89115-7300	14019410051
SILVA RAMIRO D & NANCY VALERIA	1524 ARLINGTON HEIGHTS ST LAS VEGAS NV 89110-1255	14030521015
SILVER H PARTNERS L L C	%E HERSHBERGER 1610 CORDERO BAY DR LAS VEGAS NV 89123-5880	14030511006
SILVER H PARTNERS L L C	%E HERSHBERGER 1610 CORDERO BAY DR LAS VEGAS NV 89123-5880	14030511005
SILVER H PARTNERS L L C	%E HERSHBERGER 1610 CORDERO BAY DR LAS VEGAS NV 89123-5880	14030511002
SILVER H PARTNERS L L C	%E HERSHBERGER 1610 CORDERO BAY DR LAS VEGAS NV 89123-5880	14030510013
SILVER H PARTNERS L L C	%E HERSHBERGER 1610 CORDERO BAY DR LAS VEGAS NV 89123-5880	14030511004
SILVER H PARTNERS L L C	%E HERSHBERGER 1610 CORDERO BAY DR LAS VEGAS NV 89123-5880	14030510012
SILVER H PARTNERS L L C	%E HERSHBERGER 1610 CORDERO BAY DR LAS VEGAS NV 89123-5880	14030511001
SILVER H PARTNERS L L C	%E HERSHBERGER 1610 CORDERO BAY DR LAS VEGAS NV 89123-5880	14030510014
SILVER H PARTNERS L L C	%E HERSHBERGER 1610 CORDERO BAY DR LAS VEGAS NV 89123-5880	14030510001
SILVER H PARTNERS L L C	%E HERSHBERGER 1610 CORDERO BAY DR LAS VEGAS NV 89123-5880	14030511015
SILVER H PARTNERS L L C	%E HERSHBERGER 1610 CORDERO BAY DR LAS VEGAS NV 89123-5880	14030511014
SILVER H PARTNERS L L C	%E HERSHBERGER 1610 CORDERO BAY DR LAS VEGAS NV 89123-5880	14030511013
SILVER H PARTNERS L L C	%E HERSHBERGER 1610 CORDERO BAY DR LAS VEGAS NV 89123-5880	14030511012
SILVER H PARTNERS L L C	%E HERSHBERGER 1610 CORDERO BAY DR LAS VEGAS NV 89123-5880	14030511011
SILVER H PARTNERS L L C	%E HERSHBERGER 1610 CORDERO BAY DR LAS VEGAS NV 89123-5880	14030511009
SILVER H PARTNERS L L C	%E HERSHBERGER 1610 CORDERO BAY DR LAS VEGAS NV 89123-5880	14030511010
SILVER H PARTNERS L L C	%E HERSHBERGER 1610 CORDERO BAY DR LAS VEGAS NV 89123-5880	14030510011
SILVER H PARTNERS L L C	%E HERSHBERGER 1610 CORDERO BAY DR LAS VEGAS NV 89123-5880	14030510002
SILVER H PARTNERS L L C	%E HERSHBERGER 1610 CORDERO BAY DR LAS VEGAS NV 89123-5880	14030510003
SILVER H PARTNERS L L C	%E HERSHBERGER 1610 CORDERO BAY DR LAS VEGAS NV 89123-5880	14030510004
SILVER H PARTNERS L L C	%E HERSHBERGER 1610 CORDERO BAY DR LAS VEGAS NV 89123-5880	14030510005
SILVER H PARTNERS L L C	%E HERSHBERGER 1610 CORDERO BAY DR LAS VEGAS NV 89123-5880	14030511016
SILVER H PARTNERS L L C	%E HERSHBERGER 1610 CORDERO BAY DR LAS VEGAS NV 89123-5880	14030511003

Report of All Selected Parcels**Case Number:**

ZON-64975 & SDR-64976

Printed On: Tue: August 23, 2016

Owner	Address	Parcel Number
SILVER H PARTNERS L L C	%E HERSHBERGER 1610 CORDERO BAY DR LAS VEGAS NV 89123-5880	14030511008
SILVER H PARTNERS L L C	%E HERSHBERGER 1610 CORDERO BAY DR LAS VEGAS NV 89123-5880	14030510007
SILVER H PARTNERS L L C	%E HERSHBERGER 1610 CORDERO BAY DR LAS VEGAS NV 89123-5880	14030510010
SILVER H PARTNERS L L C	%E HERSHBERGER 1610 CORDERO BAY DR LAS VEGAS NV 89123-5880	14030510006
SILVER H PARTNERS L L C	%E HERSHBERGER 1610 CORDERO BAY DR LAS VEGAS NV 89123-5880	14030510008
SILVER H PARTNERS L L C	%E HERSHBERGER 1610 CORDERO BAY DR LAS VEGAS NV 89123-5880	14030511007
SILVER H PARTNERS L L C	%E HERSHBERGER 1610 CORDERO BAY DR LAS VEGAS NV 89123-5880	14030510009
SIMENTAL UBALDO RIVERA	RIVERA AMELIA 4420 MEADOWLARK WING WAY NORTH LAS VEGAS NV 89084	14030512001
SIMENTAL UBALDO RIVERA	RIVERA AMELIA 4420 MEADOWLARK WING WAY NORTH LAS VEGAS NV 89084	14030512002
SINGH SURINDER PAL	7201 MIRACLE MILE RIVERSIDE CA 92506	14030115062
SINGH SURINDER PAL	7201 MIRACLE MILE RIVERSIDE CA 92506	14030115112
SIRIVOLU RAJGOPAL & PRAVEEN	6822 CLEMSON LN SUGARLAND TX 77479	14030112082
SOBALVARRO YOLANDA	CHAMORRO MLAGROS 4132 TALAVERA CT LAS VEGAS NV 89110-5779	14030522040
SOLIS CARLOS FLORES	AGUAYO MARIA TERESA 1277 LIME POINT ST LAS VEGAS NV 89110-5908	14030521047
SOTELO-CHAVEZ SERGIO	ENCINAS-CORDOVA MARIA M 3809 PECAN LN LAS VEGAS NV 89115	14019410023
SOUTHERN NEVADA ACQUISITIONS L L	6292 SPRING MOUNTAIN RD #105 LAS VEGAS NV 89146	14030115079
SOUTHERN NV HOUSING AUTHORITY	340 N 11 ST #170 LAS VEGAS NV 89101-3125	14030522038
SOUTHERN NV HOUSING AUTHORITY	340 N 11 ST #170 LAS VEGAS NV 89101-3125	14030522036
STARR MANAGEMENT GROUP INC	4427 NORMA JEAN LN NORTH LAS VEGAS NV 89031	14030522059
STELLE PAUL & DONNA	4307 DELAWARE DR FREMONT CA 94538-5906	14030512020
STEPHANIE FAMILY TRUST	5614 MAMMOTH MOUNTAIN ST NORTH LAS VEGAS NV 89081	14019411009
STEWART LARRY TRUST	STEWART LARRY TRS 921 STONEBRYN DR HARBOR CITY CA 90710-1537	14030115047
SUAREZ ANDRES & ROSALIA	1137 E CALIFORNIA AVE # 2 GLENDALE CA 91206-5007	14030522009
SUMMERLIN L V L L C	2605 CAMINO DEL RIO S SAN DIEGO CA 92108	14030522037
SWERY ZION	1624 ASPEN MEADOWS DR HENDERSON NV 89014	14030115071
SWERY ZION	1624 ASPEN MEADOWS DR HENDERSON NV 89014	14030115072
TACLA LUIS T & LETICIA B	4121 DONGOLA CT LAS VEGAS NV 89110-5774	14030522062
TAFOYA RUDY R & SUSAN M	MANZANO TRACY L 1500 ARLINGTON HEIGHTS ST LAS VEGAS NV 89110-5768	14030522004
TARANGO MANUEL & MARIE M	3825 PECAN LN LAS VEGAS NV 89115-7348	14019410027
TATE JERMAINE R	1642 LEGATO FALLS ST LAS VEGAS NV 89115	14019813028
THAVARAYUSMA CHUSRI	1520 FRANK-AVED ST #201 LAS VEGAS NV 89110-7031	14030115007
TICER DAVID A	3826 PECAN LN LAS VEGAS NV 89115-7300	14019410047

Report of All Selected Parcels**Case Number:**

ZON-64975 & SDR-64976

Printed On: Tue: August 23, 2016

<u>Owner</u>	<u>Address</u>	<u>Parcel Number</u>
TILLEY SARAH M	1508 STEVENS ST LAS VEGAS NV 89110	14030112076
TODOROV IVAYLO	3961 DANNY MELEMED #101 LAS VEGAS NV 89110-7003	14030115081
TORRES JOSE LLAMAS	MENDOZA REBECCA LLAMAS 6981 COLDWATER DR LAS VEGAS NV 89110-5236	14030115030
TRUSTEE CLARK COUNTY TREASURER	%KIMCHY SHLOMO 3961 REBECCA RAITER AVE #102 LAS VEGAS NV 89110-7016	14030115050
TRUSTEE CLARK COUNTY TREASURER	2241 RED ALDER ST HENDERSON NV 89002-3672	14019410026
TRUSTEE CLARK COUNTY TREASURER	1736 E CHARLESTON #122 LAS VEGAS NV 89104-7900	14030502005
TRUSTEE CLARK COUNTY TREASURER	%IBARAR SONNY 3957 REBECCA RAITER AVE #101 LAS VEGAS NV 89110-7012	14030115045
TUGADE EDUARDO & VIRGINIA	1052 GILMAN DR DALY CITY CA 94015-2001	14019813011
TURANGI L L C	452 E SILVERADO RANCH BLVD #283 LAS VEGAS NV 89183-6290	14030512021
TURNBULL JOHN E & MARY J	2909 WOODLAND #318 DES MOINES IA 50312-3823	14030112081
TURNER BRUCE L & PEARLENA	3706 FERNDALE COVE LAS VEGAS NV 89129-7016	14030112018
TUTUIANU DUMITRU C	2837 E TONOPAH AVE NORTH LAS VEGAS NV 89030-8708	14030115090
U S A FLORIDA PPTYS B K P L L C	7279 HAWKSNEST BLVD ORLANDO FL 32835	14019813021
VALADEZ-HERNANDEZ VICTOR	GUEMES-GREGORIO LIZZETT 1655 LEGATO FALLS ST LAS VEGAS NV 89115-1105	14019813031
VALDOVINOS VERONICA	1504 STEVENS ST LAS VEGAS NV 89110	14030112075
VALLIN AGUSTIN	3938 MCGREGOR WAY NORTH LAS VEGAS NV 89032	14030115028
VALLIN RICARDO	DIAZ ARIANA MORAN 4252 CANDLE CREEK LN NORTH LAS VEGAS NV 89032	14030115046
VANHECK JANET C	4120 PARK POINT CT LAS VEGAS NV 89110-1256	14030521032
VARGAS ROBERTO	4129 GALVA CT LAS VEGAS NV 89110-5777	14030522042
VAZQUEZ ALICIA	CHAVEZ VERONICA 1528 ARLINGTON HEIGHTS ST LAS VEGAS NV 89110-1255	14030521014
VEGA MIGUEL & MARIA	1420 STEVENS ST LAS VEGAS NV 89110-1177	14030112068
VEGA MIGUEL & MARIA EUGENIA	1420 STEVENS ST LAS VEGAS NV 89110	14030112069
VEGAS PROPERTY SERVICES INC	5095 TURNBERRY LN LAS VEGAS NV 89113	14030115063
VEGASPHERE L L C	%AMEROPAN RLTY & PPTY MGT 3935 S DURANGO DR #C-1 LAS VEGAS NV 89147	14030115110
VELASQUEZ JUAN	VELASQUEZ SAUL 4372 HILLDALE AVE LAS VEGAS NV 89121-2608	14019410080
VELAZQUEZ LORENZO	RODRIGUEZ-ARROYO AMADA 4104 GALVA CT LAS VEGAS NV 89110-5776	14030522049
VELAZQUEZ LORENZO	RODRIGUEZ-ARROYO AMADA 4104 GALVA CT LAS VEGAS NV 89110-5776	14030522051
VERA-ROSAS DAVID	1652 MENO PEAK ST LAS VEGAS NV 89115	14019813024
VILAR VILMARIE	1653 MENO PEAK ST LAS VEGAS NV 89115	14019813025
VIRGIL CO L L C	714 KENNY WAY LAS VEGAS NV 89107	14030115101
VOYLES CONI	282 N MAIN VEYO UT 84782-4011	14030112062
WAITERS ROSETTA	1649 LEGATO FALLS ST LAS VEGAS NV 89115-1105	14019813032

Report of All Selected Parcels**Case Number:**

ZON-64975 & SDR-64976

Printed On: Tue: August 23, 2016

<u>Owner</u>	<u>Address</u>	<u>Parcel Numbe</u>
WALLER JAMES T L	1739 CHARNUT LN LAS VEGAS NV 89115	14019410144
WALNUT ESTATES L L C	9454 WILSHIRE PENTHOUSE BEVERLY HILLS CA 90212-2937	14019801003
WEBB GERALDINE F & JOSEPH W	1427 N GATEWAY RD LAS VEGAS NV 89110-1202	14030502006
WILCOX SOKEANG C & ORVILLE L	14534 ADELFA DR LA MIRADA CA 90638	14030513006
WISE BOBBY & BENEDICTA	1425 MENO PEAK ST LAS VEGAS NV 89115	14019813012
WOJKIEWICZ THOMAS M	1408 N STEVENS ST LAS VEGAS NV 89110-1177	14030112065
WRIGGINS PEARLIE M	21275 HICKS ST PERRIS CA 92570	14019410025
YANCY MARY L	7812 WAVERING PINE DR LAS VEGAS NV 89143	14019410039
YATPRACHUM SITHISACK & DARAPORN	4132 GALVA CT LAS VEGAS NV 89110-5777	14030522058
YU SILVIA	1717 CITRON ST HONOLULU HI 96826	14019813014
ZAMANIAN MOHAMMAD JAVAD & ROYA S	FARJAM FARAHAZ P O BOX 95844 LAS VEGAS NV 89193-5844	14030112086
ZAVALA ER	2021 HART AVE NORTH LAS VEGAS NV 89032	14030115032
ZELAYA VICTOR S	4128 TALAVERA CT LAS VEGAS NV 89110-5779	14030522039
ZIMBELMANN WANDA H TRUST	KAZEE ANTHONY E TRS 2280 CRESTLINE LOOP NORTH LAS VEGAS NV 89030-4102	14019410081