

City of Las Vegas
Office Of The City Clerk
495 S. Main St., City Hall
Las Vegas, Nevada 89101

PRSRT STD
U.S. Postage
PAID
Las Vegas, NV
Permit No. 1630

Return Service Requested Official Notice of Public Hearing



If you wish to file your protest or support on this request, check the appropriate box below and return this card in an envelope with postage to the Office Of The City Clerk at the address listed above, fax this side of this card to (702) 382-4803 or make your comments at www.lasvegasnevada.gov. If you would like to contact your Council Representative, please call (702) 229-6405.

I SUPPORT
this Request

I OPPOSE
this Request

Please use available blank space on card for your comments.

ZON-61791 [PRJ-61304]

City Council Meeting of January 20, 2016

Application Information

ZON-61791 - REZONING - PUBLIC HEARING - APPLICANT: PRECEDENT PROPERTIES, LLC - OWNER: RMH TRUST -
For possible action on a request for a Rezoning FROM: R-E (RESIDENCE ESTATES) TO: R-1 (SINGLE FAMILY RESIDENTIAL) on 1.89 acres at the northwest corner of Dorrell Lane and Decatur Boulevard (APN 125-24-503-020), Ward 6 (Ross) [PRJ-61304].

Application Location

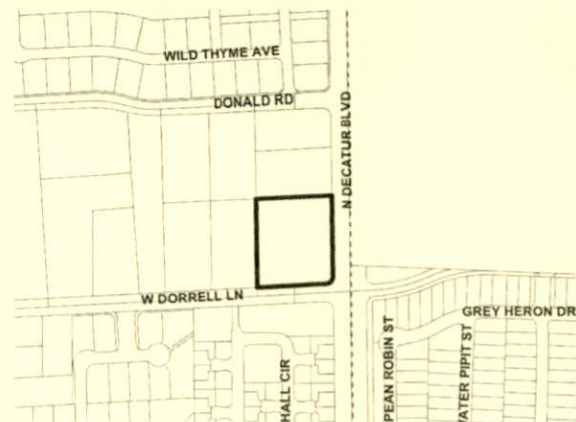

The proposed project may not pertain to the entire highlighted project site.

Public Hearing Information

Meeting: City Council
Date: *January 20, 2016*
Time: 1:00 P.M.
Location: City Council Chambers
495 South Main Street, 2nd Floor
Las Vegas, Nevada 89101

Any and all interested persons may appear and be heard at said meeting, or may, prior to this meeting, file a written objection thereto or approval thereof with the City Clerk, 2nd Floor, City Hall, 495 South Main Street, Las Vegas, Nevada 89101. For further information, including the full staff report, please call (702)229-6311 (7-1-1 Relay Nevada) or go to <http://www.lasvegasnevada.gov>.

Report of All Selected Parcels**Case Number:**

ZON-61791

Printed On: Tue: December 22, 2015

<u>Owner</u>	<u>Address</u>	<u>Parcel Number</u>
2014-1 IH BORROWER L P	21001 N TATUM BLVD #1630-630 PHOENIX AZ 85050	12419213071
ADKINS PHILIP	6921 WATER PIPIT ST NORTH LAS VEGAS NV 89084-2644	12419213068
ALBERTSON TOM C & DONNA GAIL	4920 WAYFARING TREE AVE LAS VEGAS NV 89131-2762	12524512010
ANDERSON BETTIE	4828 VIOLET BAY CT LAS VEGAS NV 89131-2794	12524612051
ANDERSON JOHN & SARA	6916 HAZELNUT GARDEN ST LAS VEGAS NV 89131-1029	12524611014
ANTUNES MARK	4932 WILD THYME AVE LAS VEGAS NV 89131-2765	12524512063
ARRINGTON FREDERICK L & LINDA S	6807 MINK AVE ANCHORAGE AK 99504	12419213049
ARTHUR JODY	4829 HARMONIZE CT LAS VEGAS NV 89131-2785	12524612064
AYALEW MISTRA T	4704 GREY HERON DR NORTH LAS VEGAS NV 89084-2635	12419213009
BAITZ MARIE A & ROBERT J	4825 HARMONIZE CT LAS VEGAS NV 89131-2785	12524612065
BAUGHER GLADYS I & SHARON I	LEHMAN KARON I 2514 TROPICAL SANDS AVE NORTH LAS VEGAS NV 89031	12524612052
BENEFIEL MICHAEL D	7119 GROUNSEL ST LAS VEGAS NV 89131-2761	12524512015
BINGHAM GARY E & GLENNIS M	4913 MEADDWS ENCORE AVE LAS VEGAS NV 89131-1024	12524611004
BLAKE WILLIAM SR & CATHRYN Y	4925 WAYFARING TREE AVE LAS VEGAS NV 89131-2762	12524512060
BOTELLO ELADIO	6921 CASPIAN TERN ST NORTH LAS VEGAS NV 89084-2636	12419213107
BOULWARE TAMIKA	5017 WAYFARING TREE AVE LAS VEGAS NV 89131-2763	12524512052
BOWERS EDWIN & PAMELA REV LIV TR	BOWERS EDWIN D & PAMELA SUE TRS 263 DELFINO WY HENDERSON NV 89074-1455	12524612019
BOZLEY CHRISTOPHER L & AMANDA S	6916 WATER PIPIT ST NORTH LAS VEGAS NV 89084	12419213070
BRANT JAMES R & KATHLEEN L	7131 GROUNSEL ST LAS VEGAS NV 89131-2761	12524512018
BRECEDA MICHAEL A	4905 MEADOWS ENCORE LAS VEGAS NV 89131-1024	12524611003
BROCKWAY JIMMY J & FAITH	P O BOX 5510 FORT PIERCE FL 34954-5510	12524612096
BROOKS JASON	JENKINSON JEANETTE 4929 WAYFARING TREE AVE LAS VEGAS NV 89131-2762	12524512059
BROWN ANTONID D & ALICIA MARIE	6937 WATER PIPIT ST NORTH LAS VEGAS NV 89084	12419213064
BROWN JON	4825 WARTBUG CT LAS VEGAS NV 89131	12524612059
BROWN MAALIKK	4841 GALVESTON HARBOR CT LAS VEGAS NV 89131	12524612014
BRUCE ADAM N & JENNIFER L	6936 WILLOW WARBLER ST NORTH LAS VEGAS NV 89084-2638	12419213094
BRUCKMAN DIANE PATRICIA FAM TR	BRUCKMAN DIANE PATRICIA TRS 5616 MAJESTIC TIDE AVE LAS VEGAS NV 89131	12524512043
BUETTNER MARK A & JUSTINE	4928 MEADOWS ENCORE AVE LAS VEGAS NV 89131-1024	12524611059
BUTLER-LOVE PEARL	4625 WHITE STORK DR NORTH LAS VEGAS NV 89084-2640	12419213041
BUTTERFIELD IDA M	4808 PLAMA CT LAS VEGAS NV 89131-2787	12524612082
C A H 2014-1 BORROWER L L C	9305 E VIA DE VENTURA #201 SCOTTSDALE AZ 85258	12419213065
C J N INVESTMENTS II L L C	117 HANDPEPE LOOP HONOLULU HI 96825	12419213040

Report of All Selected ParcelsCase Number:

ZON-61791

Printed On: Tue: December 22, 2015

<u>Owner</u>	<u>Address</u>	<u>Parcel Number</u>
CAMPBELL JUSTIN	4825 N RILEY ST LAS VEGAS NV 89149-4124	12419213056
CAMPBELL RACHEL	4829 PALM TREE CT LAS VEGAS NV 89131-2786	12524612046
CAPRARA GAMILY TRUST	CAPRARA MARIA & DDMENICO TRS 4928 ORCHARD SKY AVE LAS VEGAS NV 89131-1027	12524611008
CARLETON RONALD R & CATHIE L	4932 WAYFARING TREE AVE LAS VEGAS NV 89131-2762	12524512007
CARTER DAN W	4821 HARMONIZE CT LAS VEGAS NV 89131	12524612066
CERTAIN J SR & MRCDL-CRTN REV TR	CERTAIN JOSEPH & CLAUDELL TRS 5013 WAYFARING TREE AVE LAS VEGAS NV 89131-2763	12524512053
CHAO KENNETH & LUCIA	13602 STILL BAY CT HOUSTON TX 77077-3410	12419213075
CHAPMAN KIM M	6944 WILLOW WARBLER ST NORTH LAS VEGAS NV 89084-2638	12419213096
CHATTERTON RANDI M & MICHAEL R	4812 PALM TREE CT LAS VEGAS NV 89131-2786	12524612104
CHILDRESS BOBBY J	4841 PEACHTREE CREEK CT LAS VEGAS NV 89131-2792	12524612026
CHITTUM THERESA A	4837 MARS BLACK CT LAS VEGAS NV 89131-2789	12524612031
CHDW FAMILY ENTERPRISES L L C	2381 LUBERON DR HENDERSON NV 89044-0312	12419213067
CISNEROS-MENDOZA OSCAR F	6941 CASPIAN TERN ST NORTH LAS VEGAS NV 89084-2637	12419213102
CITY OF NORTH LAS VEGAS	2250 LAS VEGAS BLVD NORTH NORTH LAS VEGAS NV 89030	12419210010
CITY DF NORTH LAS VEGAS	2250 LAS VEGAS BLVD NORTH NORTH LAS VEGAS NV 89030	12419212002
CITY DF NORTH LAS VEGAS	2250 LAS VEGAS BLVD NORTH NORTH LAS VEGAS NV 89030	12419210009
CITY OF NORTH LAS VEGAS	2250 LAS VEGAS BLVD NORTH NORTH LAS VEGAS NV 89030	12419210011
CITY OF NORTH LAS VEGAS	2250 LAS VEGAS BLVD NORTH NORTH LAS VEGAS NV 89030	12419212003
CITY OF NORTH LAS VEGAS	2250 LAS VEGAS BLVD NORTH NORTH LAS VEGAS NV 89030	12419210008
CLAWSON ROBERT T & DEBORAH A	5000 WILD THYME AVE LAS VEGAS NV 89131-2765	12524512065
COLEMAN CHARLES E & SUSAN N REVO	COLEMAN CHARLES E & SUSAN N TRS 4928 FLOWER DANCE CT LAS VEGAS NV 89131	12524611040
COLFIN AH-NEVADA 3 L L C	9305 E VIA DE VENTURA #201 SCOTTSDALE AZ 85258	12419213078
CONDON FAMILY TRUST	CONDON GREGORY A & CARLA J TRS 7118 SPINDLE BERRY ST LAS VEGAS NV 89131-2764	12524512014
CONDON TRUST	CONDON ELOISE J TRS 4836 MARS BLACK CT LAS VEGAS NV 89131-2789	12524612036
CONNELLY BALKE R & KIRSTEN E REV	CONNELLY BLAKE R & KIRSTEN E TRS 4732 GREY HERON DR NORTH LAS VEGAS NV 89084-2635	12419213002
COOPER RICHARD W	6032 CRYSTAL CASCADE ST LAS VEGAS NV 89130-1500	12524612024
CORCORAN CHRISTOPHER & LARA	5008 WILD THYME AVE LAS VEGAS NV 89131-2766	12524512067
CORKILL JADE R	CORKILL BRUCE & MITZI 400 E CORKILL LN FALLON NV 89406-4185	12524512073
CRUMP LUCY C	4824 WARTBUG CT LAS VEGAS NV 89131-2795	12524612056
CUMMINGS DAMIAN	4820 HARMONIZE CT LAS VEGAS NV 89131-2785	12524612061
D'AMORE M M & D A 2008 REV TR	D'AMORE MICHAEL M & DIANE CO-TRS 302 E CARSON #804 LAS VEGAS NV 89101-5908	12524611047

Report of All Selected ParcelsCase Number:

ZON-61791

Printed On: Tue: December 22, 2015

<u>Owner</u>	<u>Address</u>	<u>Parcel Number</u>
DAVILA MIGUEL G	DEDAVILA ADRIANA M 4733 WHITE STORK DR NORTH LAS VEGAS NV 89084-2642	12419213053
DAVIS REED	4632 GREY HERON DR NDRTH LAS VEGAS NV 89084-2634	12419213012
DEARMOND JONATHAN & CARA BETH	6929 WILLOW WARBLER ST NORTH LAS VEGAS NV 89084-2638	12419213085
DEJESUS JERRY P & CARIDAD P	6924 EUROPEAN ROBIN ST NORTH LAS VEGAS NV 89084-2645	12419213057
DELAVEGA PRISCILLA	DAVIS BLAINE 6917 WILLOW WARBLER ST NORTH LAS VEGAS NV 89084-2639	12419213088
DESTIN TONY & NAGAKO	4931 WILD THYME AVE LAS VEGAS NV 89131-2765	12524512040
DORNAN KATHRYN A	4821 VIOLET BAY CT LAS VEGAS NV 89131-2794	12524612054
DORRELL SQUARE HOMEOWNERS ASSOC	P O BOX 750639 LAS VEGAS NV 89136-0639	12524612111
DORRELL SQUARE HOMEOWNERS ASSOC	P O BOX 750639 LAS VEGAS NV 89136-0639	12524612113
DORRELL SQUARE HOMEOWNERS ASSOC	P O BOX 750639 LAS VEGAS NV 89136-0639	12524612112
DOSS TERRY GLEN & CATHERINE M	7130 GROUNSEL ST LAS VEGAS NV 89131-2761	12524512071
DOTY BARNEY & GALEY	8724 TALA ST LAS VEGAS NV 89131	12524612057
DOUGHTY BRUCE	4929 MEADOWS ENCORE AVE LAS VEGAS NV 89131-1024	12524611006
DREITH MARK J & GAYLA L	5016 ORCHARD SKY AVE LAS VEGAS NV 89131	12524611055
DUNBAR RONALD L & PATRICIA L	860 S PANORAMA DR CEDAR CITY UT 84720-6202	12524612040
ELKINS DANIEL R JR	4617 WHITE STORK DR NORTH LAS VEGAS NV 89084	12419213039
ENOS ROBERT & LORELIE	2361 NW LEMHI PASS DR BEND OR 97703	12419213044
ESPY DANIEL F	BRUTON JOHANNA D 2825 DOTTED WREN AVE NORTH LAS VEGAS NV 89084-2238	12419213042
FERNQUIST FAMILY REV LIV TR	FERNQUIST DONALD E & JUDITH TRS 4928 WILD THYME AVE LAS VEGAS NV 89131-2765	12524512062
FLEMING KELLY B & SHELLEY R	4616 GREY HERON DR NORTH LAS VEGAS NV 89084-2633	12419213014
FLETCHER JOHNNY JAMES & YOLANDA	6933 WILLOW WARBLER ST NORTH LAS VEGAS NV 89084-2638	12419213084
FLETCHER MICHAEL R & MADELINE R	4721 WHITE STORK DR NORTH LAS VEGAS NV 89084-2642	12419213050
FOCUS 4 INVESTMENTS L L C	11700 W CHARLESTON BLVD #170-34 LAS VEGAS NV 89135	12419213005
FONTANEZ EDWARD & LORA L	4936 MEADOWS ENCORE LAS VEGAS NV 89131-1024	12524611058
FOSSAN FAMILY TRUST	FOSSAN LARRY P TRS 5012 WILD THYME AVE LAS VEGAS NV 89131-2766	12524512068
FRAME BRANDON A	4724 GREY HERON DR NORTH LAS VEGAS NV 89084-2635	12419213004
GARCIA CATALINA A	6932 WILLOW WARBLER ST NORTH LAS VEGAS NV 89084-2638	12419213093
GARCIA PEDRO	1536 RAINDANCE WAY LAS VEGAS NV 89169	12524503005
GARDNER ROBERT MICHAEL & DIANE W	GARDNER ROBERT MICHAEL & DIANE W 7420 BRIDLEHORNE AVE LAS VEGAS NV 89131-3355	12524612028
GILES ROSEANNE M	4805 PALM TREE CT LAS VEGAS NV 89131	12524612101
GILLENWATER NATASHA P	7118 GROUNSEL ST LAS VEGAS NV 89131-2761	12524512074
GLADDEN 2015 TRUST	GLADDEN CHARLES TRS 4325 W ROME BLVD #2121 NORTH LAS VEGAS NV 89084	12524603001

Report of All Selected ParcelsCase Number:

ZON-61791

Printed On: Tue: December 22, 2015

<u>Owner</u>	<u>Address</u>	<u>Parcel Number</u>
GOETTING THOMAS B JR	4904 MEADOWS ENCORE AVE LAS VEGAS NV 89131	12524611002
GOMEZ MARGARITO L	P O BOX 541 MERCURY NV 89023-0541	12419213010
GONZAGA WILLARD JAMES	GONZAGA CORAZON LANZANAS & ERNES 4641 WHITE STORK DR NORTH LAS VEGAS NV 89084-2640	12419213045
GOODMAN MARK	8139 VILLA DUENAS CT LAS VEGAS NV 89131-1666	12524612027
GORDON ROCCO J	7050 SEA ORCHARD ST LAS VEGAS NV 89131-1007	12524510062
GRANILLO TONY & MARTHA	4736 GREY HERON DR NORTH LAS VEGAS NV 89084-2635	12419213001
GRIFFITH DEBORAH L	7122 SPINDLE BERRY ST LAS VEGAS NV 89131-2764	12524512013
GUNNING FARRIS & MELISSA	7135 GROUNSEL ST LAS VEGAS NV 89131-2761	12524512019
HAMILTON DE'ANDRE	KRICORIAN KAREN & ADELE 7040 MANZANARES DR NORTH LAS VEGAS NV 89084-2344	12524612102
HAMILTON DE'ANDRE ETAL	KRICORIAN NUBAR BART & ADELE 7040 MANZANARES DR NORTH LAS VEGAS NV 89084	12524612016
HANLEY MICHAEL & SHARON	P O BOX 150075 ELY NV 89315	12524612084
HARRIS DEBRA & PHILLIP L	4921 ORCHARD SKY AVE LAS VEGAS NV 89131-1027	12524611044
HART ROBERT	7837 SILVER PLATEAU AVE LAS VEGAS NV 89128-2657	12524612097
HARVEY JEFFREY & TONI	6900 HAZELNUT GARDEN ST LAS VEGAS NV 89131-1029	12524611016
HAUGE SIDNEY O & VICKI L	1512 MAIN ST WILLISTON ND 58801	12524510061
HAVENS ROBERT J & TERRY L	6936 EUROPEAN ROBIN ST NORTH LAS VEGAS NV 89084	12419213060
HAWKINS LISA	TREK L L C 1498 REISTERSTOWN RD #367 PIKESVILLE MD 21208-3817	12524612032
HAZELNUT GARDEN L L C	6932 HAZELNUT GARDEN ST LAS VEGAS NV 89131-1029	12524611012
HONDA RICHARD M & BETSY H	4912 ORCHARD SKY AVE LAS VEGAS NV 89131-1027	12524611010
HOOD DEREK D & CASSANDRA L	5004 WILD THYME AVE LAS VEGAS NV 89131-2765	12524512066
HUDZIK JOSEPH A & KARINA SALCEDO	12440 CASWELL AVE LOS ANGELES CA 90066-4904	12419213019
HUFFINE EILEEN M	4841 RAY UMBER CT LAS VEGAS NV 89131-2788	12524612038
IRELAND MATTHEW M	6940 WILLOW WARBLER ST NORTH LAS VEGAS NV 89084-2638	12419213095
JACKSON YVETTE	6929 WATER PIPIT ST NORTH LAS VEGAS NV 89084-2644	12419213066
JARO ALFREDO	5312 CIELO ORO ST LAS VEGAS NV 89113-1166	12419213090
JENSEN WILLIAM C & GRETCHEN C	5009 WILD THYME AVE LAS VEGAS NV 89131-2766	12524512044
JEWELL COREY & TRACY I	7127 GROUNSEL ST LAS VEGAS NV 89131	12524512017
JONES FAMILY TRUST	JONES ROBERT M & KAYE M TRS 4912 MEADOWS ENCORE AVE LAS VEGAS NV 89131-1024	12524611001
JONES JIMMIE C	CANNON MARSHALL W 7126 GROUNSEL ST LAS VEGAS NV 89131-2761	12524512072
JONES RUBY	4924 WAYFARING TREE AVE LAS VEGAS NV 89131-2762	12524512009
JONES SANDY	5004 WAYFARING TREE AVE LAS VEGAS NV 89131-2763	12524512004

Report of All Selected ParcelsCase Number:

ZON-61791

Printed On: Tue: December 22, 2015

<u>Owner</u>	<u>Address</u>	<u>Parcel Number</u>
JOSEPH RONEN & ESTER	463 JUANITA DR SANTA CLARA CA 95050	12419213069
KELLNER MAYA	5405 W FLAMINGO RD LAS VEGAS NV 89103-3590	12419213072
KERNS DAVID B & TAMARA J	P O BOX 602 MEAD WA 99021-0602	12524612086
KIENER NORMAN R & MARIA E	4705 WHITE STORK DR NORTH LAS VEGAS NV 89084-2641	12419213046
KIM NENA & DONG JOO	94-220 OLUWA PL WAIPAHU HI 96797	12419213003
KING CHERYL ANN	7062 SEA ORCHARD ST LAS VEGAS NV 89131	12524510063
KING FUTT'S P F M L L C	5700 BOULDER HWY LAS VEGAS NV 89122-7204	12524612055
KOSTKA JAN	4805 FUCHSIA VINE CT LAS VEGAS NV 89131-2784	12524612107
KRICORIAN KAREN	KRICORIAN NUBAR & ADELE 7040 MANZANARES DR NORTH LAS VEGAS NV 89084-2344	12524612098
KRICORIAN KAREN	KRICORIAN NUBAR BART & ADELE 7040 MANZANARES DR NORTH LAS VEGAS NV 89084	12524612105
KRICORIAN KAREN	KRICORIAN NUBAR & ADELE 7040 MANZANARES NORTH LAS VEGAS NV 89084-2344	12524612035
KRICORIAN KAREN	KRICORIAN NUBAR & ADELE 7040 MANZANARES DR NORTH LAS VEGAS NV 89084-2344	12524612020
KRICORIAN KAREN	KRICORIAN NUBAR BART & ADELE A 7040 MANZANARES DR NORTH LAS VEGAS NV 89084-2344	12524612110
KRICORIAN KAREN	KRICORIAN NUBAR BART & ADELE 11829 DARBY AVE NORTHRIDGE CA 91326	12524612109
KRICORIAN KAREN	KRICORIAN NUBAR BART & ADELE A 7040 MANZANARES NORTH LAS VEGAS NV 89084-2344	12524612108
KRICORIAN KAREN	KRICORIAN NUBAR & ADELE 7040 MANZANARES DR NORTH LAS VEGAS NV 89084-2344	12524612050
KRICORIAN KAREN ANN	KRICORIAN NUBAR BART & ADELE A 7040 MANZANARES DR NORTH LAS VEGAS NV 89084-2344	12524612039
KWAN MING FAI	LAM PHILLIP 8675 RIGBY CT LAS VEGAS NV 89147	12524612092
LEWIS ALBERT	5000 WAYFARING WAY TREE AVE LAS VEGAS NV 89131-2763	12524512005
LEWIS TODD TRUST	LEWIS TODD TRS 7074 SEA ORCHARD ST LAS VEGAS NV 89131-1007	12524510064
LEXINGTON PARTNERS L L C	1526 S BROADWAY LOS ANGELES CA 90015-3031	12524503002
LEXINGTON PARTNERS L L C	1526 S BROADWAY LOS ANGELES CA 90015-3031	12524503001
LIMBERT RAYMOND & DEBORAH	4911 WILD THYME AVE LAS VEGAS NV 89131-2765	12524512035
LINERT EDWARD B JR & DEBORAH A	5017 WILD THYME AVE LAS VEGAS NV 89131-2766	12524512046
LIU ANDRE	NGUYEN NHUNG THI KIM 231 WEDGEWOOD AVE LOS GATOS CA 95032-1212	12419213080
LONG ROBERT M	6949 CASPIAN TERN ST NORTH LAS VEGAS NV 89084-2637	12419213100
LOPEZ MICHAEL & MONIQUE	4824 HARMONIZE CT LAS VEGAS NV 89131-2785	12524612062
LOWE ARTHUR & JUNE LIVING TRUST	LOWE ARTHUR & JUNE TRS 4880 DORRELL LN LAS VEGAS NV 89131-2740	12524503012
LOWERS GARY WILLIAM	MIRTO KAREN J 6952 WILLOW WARBLER ST NORTH LAS VEGAS NV 89084-2638	12419213098
LUGO JOHN	2723 PASTEL AVE HENDERSON NV 89074-1243	12524512045
MACARAEG JUAN O & ROSARIO	9525 HILLWOOD DR #120 LAS VEGAS NV 89134	12524612015

Report of All Selected Parcels**Case Number:**

ZON-61791

Printed On: Tue: December 22, 2015

<u>Owner</u>	<u>Address</u>	<u>Parcel Number</u>
MACARTHUR-BROOKS STEVEN C	6944 WATER PIPIT ST NORTH LAS VEGAS NV 89084-2643	12419213077
MACDOUGALL EVAN A & BRANDI M	6940 EUROPEAN ROBIN ST NORTH LAS VEGAS NV 89084-2645	12419213061
MAGAT ROSALINA R & ROLANDO R	6916 WILLOW WARBLER ST NORTH LAS VEGAS NV 89084-2639	12419213089
MAGUIRE MARK A	4927 WILD THYME AVE LAS VEGAS NV 89131-2765	12524512039
MANGIAGLI PAUL	7130 SPRINDLE BERRY ST LAS VEGAS NV 89131	12524512011
MARTIN RICK & MARTHA	1804 PALOMINO FARM WAY NORTH LAS VEGAS NV 89081-6753	12524612068
MARTINEZ RAMON A JR & YVONNE V	4633 WHITE STORK DR NORTH LAS VEGAS NV 89084-2640	12419213043
MARVEL ENTERPRISES INC	3634 EXTREME CT LAS VEGAS NV 89129-5049	12524612042
MAUK DAVID	4737 WHITE STORK DR NORTH LAS VEGAS NV 89084-2642	12419213054
MCGILL RAYFIELD & CHRISTINE	5005 WAYFARING TREE AVE LAS VEGAS NV 89131-2763	12524512055
MCKEOWN CHARLES A & DEBRA L	1600 SHANGRI LA COURT PLACERVILLE CA 95667-9597	12419213106
MENAFARO MICHAEL REVOCABLE TRUST	SIMONE AMY TRS 6534 JAY AVE MASPETH NY 11378-1643	12524612037
MENDOZA BRENDA B & ANDY	6928 EUROPEAN ROBIN ST NORTH LAS VEGAS NV 89084-2645	12419213058
MESTON BRUCE S & LYNDA M	6832 HAZELNUT GARDEN ST LAS VEGAS NV 89131-1031	12524611018
MILLER BRENDA	6953 WILLOW WARBLER ST NORTH LAS VEGAS NV 89084-2638	12419213079
MIRRAFATI SIDNEY J	6 NIGHT SKY NEWPORT COAST CA 92657-1658	12524611056
MOLINA HUBERTO R	LARRALDE LAURA 4628 GREY HERON DR NORTH LAS VEGAS NV 89084-2634	12419213013
MONTES DARLENE M	4809 VIOLET BAY CT LAS VEGAS NV 89131-2794	12524612094
MOYE RANDOLPH	4820 PLAMA CT LAS VEGAS NV 89131-2787	12524612067
MUNOZ ROBERT & ROSA	4840 RAW UMBER CT LAS VEGAS NV 89131	12524612041
MURPHY TIFFANY A	4828 HARMONIZE CTT LAS VEGAS NV 89131-2785	12524612063
MYSTIC CANYON HOMEOWNERS ASSN	3068 E SUNSET RD #14 LAS VEGAS NV 89120-2785	12524512069
NAGAOKA DDMINICK K & RAELENN K	NAGAOKA DENNIS H 6928 WILLOW WARBLER ST NORTH LAS VEGAS NV 89032	12419213092
NEHMER STEVEN H & SALLY	723 E ENCHANTED DR MIDVALE UT 84047	12524611015
NERY ARLENE ETAL	SYGENGCO GLORIA A 1087 HYDE ST SAN LEANDRO CA 94577	12419213017
NICHOLSON SALLY J	4836 GALVESTON HARBOR CT LAS VEGAS NV 89131-2783	12524612018
NISKAR GARY & DAWN	1004 MEADOWLEAH ST LAS VEGAS NV 89145-8642	12524612045
NOVACK ARTHUR J & AUDREY E	4804 HARMONIZE CT LAS VEGAS NV 89131-2785	12524612085
OKADA VALERIE S	4804 WARTBUG CT LAS VEGAS NV 89131	12524612090
ONG ANTHONY C	4608 GREY HERON DR NORTH LAS VEGAS NV 89084-2633	12419213016
PAGANO PETER & CHARLA	6932 WATER PIPIT ST NORTH LAS VEGAS NV 89084-2643	12419213074
PARCELLS JAMES R & RUTH A	6941 THOM BLVD LAS VEGAS NV 89131-2714	12524603004

Report of All Selected ParcelsCase Number:

ZON-61791

Printed On: Tue: December 22, 2015

<u>Owner</u>	<u>Address</u>	<u>Parcel Number</u>
PASILLAS JUAN & SANDRA	4936 WAYFARING TREE AVE LAS VEGAS NV 89131-2763	12524512006
PECHARICH STEVEN WILLIAM	4824 PALM TREE CT LAS VEGAS NV 89131-2786	12524612044
PERSONIUS CAROLINE J	4840 PEACHTREE CREEK CT LAS VEGAS NV 89131-2792	12524612029
PHUNG TU	3831 DRYSDALE AVE LOS ANGELES CA 90032-1622	12419213018
PRECEDENT PROPERTIES L L C	VERLAINE L L C 3425 CLIFF SHADOWS PKWY #130 LAS VEGAS NV 89129	12524503011
PRECEDENT PROPERTIES L L C	VERLAINE L L C 3425 CLIFF SHADOWS PKWY #150 LAS VEGAS NV 89129	12524503017
PROGRESS RESIDENTIAL 2015-1 BORR	7702 E DOUBLETREE RANCH RD #100 SCOTTSDALE AZ 85258	12419213047
PRUIM ANDRIES KARST MARINUS	PRUIM CHERYL 4712 GREY HERON DR NORTH LAS VEGAS NV 89084-2635	12419213007
PUGLISI GUY P II	6925 WILLOW WARBLER ST NORTH LAS VEGAS NV 89084-2638	12419213086
R M H TRUST	GHORMLEY CHARLES & VIRGINIA TRS 7432 OAK GROVE AVE LAS VEGAS NV 89117-1454	12524503020
RAMSAY JERRY T & CYNTHIA N	4913 FLOWER DANCE CT LAS VEGAS NV 89131-1030	12524611036
RANDOLPH BYRON & MECHELLE	7114 GROUNSEL ST LAS VEGAS NV 89131-2761	12524512075
REDMAN HUGH J & PAMELA B	75051 SADDLEHORN RD TWENTYNINE PALMS CA 92277	12524512042
RIVERA VICTOR M	6940 WATER PIPIT ST NORTH LAS VEGAS NV 89084-2643	12419213076
ROBERTS BRAD LUND & TAMARA SUE	4933 WAYFARING TREE AVE LAS VEGAS NV 89131-2762	12524512058
ROMERO MARTHA E	MORENO ALEJANDRO 12825 ROSE DR WHITTIER CA 90601-2432	12524612025
ROMNEY MARY	4805 VIOLET BAY CT LAS VEGAS NV 89131-2794	12524612095
ROSSER LEWIS & LEWIS A	4813 WARTBUG CT LAS VEGAS NV 89131-2795	12524612087
ROSSI ROSE	2367 TILDEN WY HENDERSON NV 89074-5422	12524612048
S F R 2012-1 U S WEST L L C	9305 E VIA DE VENTURA #201 SCOTTSDALE AZ 85258	12419213099
SABADO EDGARDO C & CECILIA	6916 EUROPEAN ROBIN ST NORTH LAS VEGAS NV 89084-2645	12419213055
SACHETTI EDWARD J JR & KELLEY T	5209 BLUE EVERGREEN AVE LAS VEGAS NV 89131-2759	12524612083
SAGO TERRY & CHERYL LIVING TRUST	SAGO TERRY L & CHERYL L TRS 6916 HAWAIIAN SKY CT LAS VEGAS NV 89131-1026	12524611048
SAKAMOTO FAMILY TRUST	SAKAMOTO SHIRO & HISAKO TRS 3394 N MILLS AVE CLAREMONT CA 91711-2026	12524612100
SALUS LAWRENCE & DULCENOMBRE H	5000 ORCHARD SKY AVE LAS VEGAS NV 89131	12524611057
SANCHEZ PATRICIA & LOUIS M	4937 WAYFARING TREE AVE LAS VEGAS NV 89131-2763	12524512057
SANDOVAL VICTOR	SILVA MARTHA M 6917 CASPIAN TERN ST NORTH LAS VEGAS NV 89084	12419213108
SARBACKER JOHN A & RUTH E	4821 WARTBUG CT LAS VEGAS NV 89131	12524612060
SCHAFFNER CHARLES J JR	4813 PALM TREE CT LAS VEGAS NV 89131-2786	12524612099
SCHMITT REBECCA	4912 FLOWER DANCE CT LAS VEGAS NV 89131-1030	12524611042
SCOTT JAIME E LIVING TRUST	SCOTT JAIME E TRS 4836 PEACHTREE CREEK CT LAS VEGAS NV 89131-2792	12524612030
SEGAWA BRIAN S	SHAROU MELONY L 4935 WILD THYME AVE LAS VEGAS NV 89131-2765	12524512041

Report of All Selected ParcelsCase Number:

ZON-61791

Printed On: Tue: December 22, 2015

<u>Owner</u>	<u>Address</u>	<u>Parcel Numbe</u>
SHEA LAWRENCE M & KATHLEEN A	4937 MEADOWS ENCORE AVE LAS VEGAS NV 89131-1024	12524611007
SHELTON RUSSELL W & KIMBERLY S	6951 THOM BLVD LAS VEGAS NV 89131-2714	12524603003
SHERMAN JEROME SEPARATE PPTY TR	SHERMAN JEROME TRS 1930 VILLAGE CENTER #3-700 LAS VEGAS NV 89134	12419213091
SHERMAN JEROME SEPERATE PPTY TR	SHERMAN JEROME TRS 1930 VILLAGE CENTER #3-700 LAS VEGAS NV 89134	12524512054
SHIN HAN J	604 DRURY CT FLUSING MI 48433-1472	12524612053
SIMON SAMMY & DEBBIE REV LIV TR	6759 COSTA PL LAS VEGAS NV 89146-6544	12524503018
SIMON SAMMY & DEBBIE REV LIV TR	SECHARIA UZI A & MARCY 6759 COSTA PL LAS VEGAS NV 89146-6544	12524503019
SIMONS LEE H & LAURIE S	7123 GROUNSEL ST LAS VEGAS NV 89131-2761	12524512016
SIMPER STEVE M & BRANDY LYNN	4937 ORCHARD SKY AVE LAS VEGAS NV 89131-1027	12524611046
SKULRAK FAMILY TRUST	SKULRAK MICHAEL S & PATRICIA TRS 2746 FAISS DR LAS VEGAS NV 89134-7468	12524612089
SMITH BILLY	GALLINEAU LORI 3217 BONASSOLA AVE NORTH LAS VEGAS NV 89031-7248	12419213062
SMITH J P TRUST	SMITH JDHN TRS 4923 WILD THYME AVE LAS VEGAS NV 89131-2765	12524512038
SMITH JOSIAH C	2912 HAMMOND BLVD CLOVIS NM 88101	12419213087
SPEARS KENNETH & DEBRA	7115 CELADINE ST LAS VEGAS NV 89131-2767	12524512047
STACKHOUSE HARPER G & GAYLE E	4924 WILD THYME AVE LAS VEGAS NV 89131-2765	12524512061
STEPHEN-FINLEY LELA	4837 GALVESTON HARBOR CT LAS VEGAS NV 89131	12524612013
SUAREZ RICARDO & LUCILLE M	4920 FLOWER DANCE CT LAS VEGAS NV 89131-1030	12524611041
SWEIKERT STEVEN G & CHARLENE R	6924 HAZELNUT GARDEN ST LAS VEGAS NV 89131-1029	12524611013
TAMURA CATHERINE M TRUST	2075 VILLAGE CENTER CIR LAS VEGAS NV 89134	12524612034
TAMURA CLIFFORD K TRUST	2075 VILLAGE CENTER CIR LAS VEGAS NV 89134-6251	12524612043
TAVOY L L C	23120 BENT OAK RD DIAMDND BAR CA 91765-3013	12419213059
TELALYAN MIHRAN M & MARINA	TELALYAN MIHRAN M & MARINA 8016 HOLLYWOOD WY SUN VALLEY CA 91352-4225	12524612103
THREE DS TRUST	FELSKI RICHARD TRS 4920 ORCHARD SKY AVE LAS VEGAS NV 89131-1027	12524611009
THWING RANDY L & KATHALYNN F	5001 DORRELL LN LAS VEGAS NV 89131-2731	12524603002
TITSWORTH JAMES	4708 GREY HERON DR NDRTH LAS VEGAS NV 89084	12419213008
TODD SONYA JEANNETTE	6933 CASPIAN TERN ST NORTH LAS VEGAS NV 89084-2636	12419213104
TONER FAMILY TRUST	TONER ROBERT E & GISELA R TRS 7134 GROUNSEL ST LAS VEGAS NV 89131-2761	12524512070
TOPOLSKI TIMOTHY G & TERESA D	4915 WILD THYME AVE LAS VEGAS NV 89131-2765	12524512036
TOWNS JEFFREY T	6937 CASPIAN TERN ST NDRTH LAS VEGAS NV 89084-2636	12419213103
TRENTON MANOR IRREVOCABLE TRUST	LARSON JOHN C & GAIL L TRS 7112 NATURE VALLEY ST LAS VEGAS NV 89149-0161	12524612021
TWENTYFIVE CHRISTOPHER	6929 CASPIAN TERN ST NORTH LAS VEGAS NV 89084	12419213105
TYSON MILLICENT K & MICHAEL J	9023 STDAKES AVE DOWNEY CA 90240-2328	12419213097

Report of All Selected Parcels**Case Number:**

ZON-61791

Printed On: Tue: December 22, 2015

<u>Owner</u>	<u>Address</u>	<u>Parcel Number</u>
U S C A DEVELOPMENT L L C	3245 CLIFF SHADOWS PKWY #150 LAS VEGAS NV 89129	12524503009
U S C A DEVELOPMENT L L C	3245 CLIFF SHADOWS PKWY #150 LAS VEGAS NV 89129	12524503008
UMETSU ALAN Y & LINDA W	2075 VILLAGE CENTER CIR LAS VEGAS NV 89134-6251	12524612058
VANEATON KENNETH & OLIVIA TRUST	VANEATON KENNETH C & OLIVIA TRS 6933 HAWAIIAN SKY CT LAS VEGAS NV 89131-1026	12524611054
VERLAINE L L C	3425 CLIFF SHADOWS #130 LAS VEGAS NV 89129	12524503004
VILLA MELIZA & PATRICK L	4929 ORCHARD SKY AVE LAS VEGAS NV 89131-1027	12524611045
VILLANUEVA NOE SIMON	6941 WILLOW WARBLER ST NORTH LAS VEGAS NV 89084-2638	12419213082
VOSHALL BRENDEE R	5001 WAYFARING TREE AVE LAS VEGAS NV 89131-2763	12524512056
WACHTEL TINA R	4813 VIOLET BAY CT LAS VEGAS NV 89131-2794	12524612093
WAN LOUIS	19 FALCONS RIDGE CIR HOLMDEL NJ 07733-1961	12419213015
WANG FUSHENG	FAN HAIYING 825 PINON AVE MILLBRAE CA 94030-3030	12524612088
WATANABE REIBUN	8791 VILLA CAMILLE LAS VEGAS NV 89147	12524612023
WATSON FAMILY TRUST	WATSON IRA EDWARD JR & MARIE TRS P O BOX 750038 LAS VEGAS NV 89136-0038	12524611017
WEST BURTON B & KAREN S	1718 PAWNEE RD GARDEN CITY KS 67846-3748	12419213073
WESTERN VALLEY PROPERTY L L C	2465 S W PEGGY ST MCMINNVILLE OR 97128	12524612106
WHITE LLOYD J	7126 SPINDLE BERRY ST LAS VEGAS NV 89131-2764	12524512012
WILLIAMS ANTHONY	4729 WHITE STORK DR NORTH LAS VEGAS NV 89084-2642	12419213052
WILSON MARTHA A & DANNY W SR	4919 WILD THYME AVE LAS VEGAS NV 89131-2765	12524512037
WINTER CAROL A FAMILY TRUST	WINTER CAROL A TRS 4205 COLDWATER DR ROCKLIN CA 95765-5603	12524611043
WITTMAN BRYAN W & JOANNE W	4936 WILD THYME AVE LAS VEGAS NV 89131-2765	12524512064
WONG DAMON R	4825 PALM TREE CT LAS VEGAS NV 89131-2786	12524612047
WONG KAREN S Y	17714 BIRKEWOOD CT CANYON COUNTRY CA 91387-3810	12419213063
WONG WING W	2217 DIAMONVILLE ST HENDERSON NV 89052	12524612049
WOOD NATHAN	BINNS DALYS V 6937 WILLOW WARBLER ST NORTH LAS VEGAS NV 89084-2638	12419213083
WORRELL PAUL C	ABRAMS PATRICIA L 4716 GREY HERON DR NORTH LAS VEGAS NV 89084-2635	12419213006
WRIGHT CHARLENE LOIS	4845 MARS BLACK CT LAS VEGAS NV 89131-2789	12524612033
WRIGHT VICTORIA C	4928 WAYFARING TREE AVE LAS VEGAS NV 89131-2762	12524512008
YATES JEANNIE LEE	7910 E CAMELBACK RD #511 SCOTTSDALE AZ 85251-2652	12524611049
YORK ANDREW N & ASHLEY L	4713 WHITE STORK DR NORTH LAS VEGAS NV 89084-2642	12419213048
YOUNG ANN YUAN	817 CORONADO CENTER DR #200 HENDERSON NV 89052-3964	12419213011
YU HONG HAI	LIN XIAXIA 4725 WHITE STORK DR NORTH LAS VEGAS NV 89084	12419213051
YUHAS CHRISTINE D	YUHAS EUGENE & MARY L 4808 WARTBUG CT LAS VEGAS NV 89131-2795	12524612091

Report of All Selected Parcels

Case Number:

ZON-61791

Printed On: Tue: December 22, 2015

Owner

ZAINO SAMUEL G JR SEP PPTY TRUST
ZAMMITT CHARLES F JR & ANGEL
ZHANG SHANE XUE-YUAN & YUAN
ZHU MINHE

Address

ZAINO SAMUEL G TRS 7346 PARADING POKEY ST LAS VEGAS NV 89131-2354
4904 ORCHARD SKY AVE LAS VEGAS NV 89131-1027
22604 SW 96TH DR TUALATION OR 97062-7399
2269 NORWAY PINE CT LAS VEGAS NV 89134-6074

Parcel Numbe

12419213101
12524611011
12419213081
12524612017