

City of Las Vegas
Office Of The City Clerk
495 S. Main St., City Hall
Las Vegas, Nevada 89101

S.v

Return Service Requested Official Notice of Public Hearing

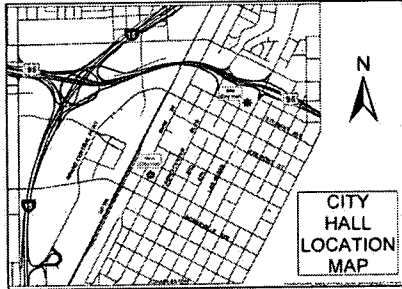

If you wish to file your protest or support on this request, check the appropriate box below and return this card in an envelope with postage to the Office Of The City Clerk at the address listed above, fax this side of this card to (702) 382-4803 or make your comments at www.lasvegasnevada.gov. If you would like to contact your Council Representative, please call (702) 229-6405.

I SUPPORT
this Request

I OPPOSE
this Request

Please use available blank space on card for your comments.

WVR-57213 & TMP-57025 [PRJ-56896]

City Council Meeting of May 20, 2015

12✓

Application Information

WVR-57213 - WAIVER RELATED TO VAR-57017 AND WVR-57018 - PUBLIC HEARING - APPLICANT/OWNER: VEGAS HOMES, LLC - For possible action on a request for a Waiver TO ALLOW NO STREETLIGHTS WHERE SUCH ARE REQUIRED AND TO ALLOW A 194-FOOT EXTERNAL INTERSECTION OFFSET WHERE 220 FEET IS THE MINIMUM DISTANCE SEPARATION REQUIRED on 4.69 acres at the northwest corner of Hickam Avenue and Leon Avenue (APN 138-01-301-017), R-E (Residence Estates) Zone, Ward 5 (Barlow) [PRJ-56896].

TMP-57025 - TENTATIVE MAP RELATED TO VAR-57017, WVR-57018 AND WVR-57213 - HICKAM AND LEON - PUBLIC HEARING - APPLICANT/OWNER: VEGAS HOMES, LLC - For possible action on a request for a Tentative Map FOR AN EIGHT-LOT RESIDENTIAL SUBDIVISION on 4.69 acres at the northwest corner of Hickam Avenue and Leon Avenue (APN 138-01-301-017), R-E (Residence Estates) Zone, Ward 5 (Barlow) [PRJ-56896].

Application Location

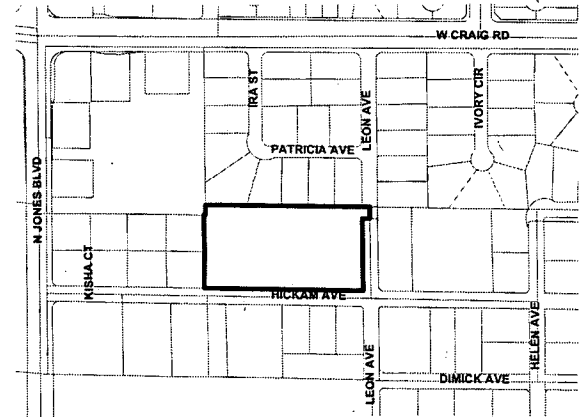

The proposed project may not pertain to the entire highlighted project site.

Public Hearing Information

Meeting: City Council
Date: *May 20, 2015*
Time: 1:00 P.M.
Location: City Council Chambers
495 South Main Street, 2nd Floor
Las Vegas, Nevada 89101

Any and all interested persons may appear and be heard at said meeting, or may, prior to this meeting, file a written objection thereto or approval thereof with the City Clerk, 2nd Floor, City Hall, 495 South Main Street, Las Vegas, Nevada 89101. For further information, including the full staff report, please call (702)229-6311 (7-1-1 Relay Nevada) or go to <http://www.lasvegasnevada.gov>.

S.✓

CASE# WVR-57213 TMP-57025

PARCEL#	OWNER	ADDRESS1	ADDRESS2	ADDRESS3	ADDRESS4	ADDRESS5
1	13801219005	1201 S LAS VEGAS BLVD L L C	1213 LAS VEGAS BLVD S	LAS VEGAS NV 89104		
2	13801312003	5801 W CRAIG L L C	5052 S JONES BLVD #145	LAS VEGAS NV 89118		
3	13801312002	5831 W CRAIG L L C	3942 OCTAGON RD	NORTH LAS VEGAS NV 89030-4483		
4	13801312006	A R C HOLDINGS L L C	1101 PINE ISLAND CT	LAS VEGAS nv 89134		
5	13801303001	ACOSTA RAFAEL & YOLANDA	42 CRESTVIEW RD	MT CHARLESTON NV 89124-9155		
6	13801403002	ADAMS CALVIN & ITASKA	5413 DIMICK AVE	LAS VEGAS NV 89130-2551		
7	13801311001	ALFEIRI KEITH W & PATRICIA	2230 AGATE DR	RENO NV .89521-6412		
8	13801305005	ALLRED JOY KAY	4209 HELEN AVE	LAS VEGAS NV 89130-2530		
9	13801310021	AMAYA LUIS A	4317 LEON AVE	LAS VEGAS NV 89130-2542		
10	13801402004	ANAYA ELSA YADIRA	7012 RESPLENDENT CT	LAS VEGAS NV 89130		
11	13801310030	AQUILERA HECTOR	4305 IVORY CIR	LAS VEGAS NV 89130-2545		
12	13801310019	ARABI BRIAN	4309 LEON AVE	LAS VEGAS NV 89130-2542		
13	13801310011	B P PREMIER PROPERTIES L L C	P O BOX 36553	LAS VEGAS NV 89133		
14	13801302001	BARTELS BENJAMIN L	5700 HICKAM AVE	LAS VEGAS NV 89130-2522		

12✓

	PARCEL#	OWNER	ADDRESS1	ADDRESS2	ADDRESS3	ADDRESS4	ADDRESS5
15	13801310009	BERNI RICHARD & LISA REV LIV TR	BERNI RICHARD P & LISA A TRS	5701 PATRICIA AVE	LAS VEGAS NV 89130-2526		
16	13801310025	BIZZARRO FIORINO	4312 IVORY CIR	LAS VEGAS NV 89130-2539			
17	13801310003	BLISS DARWIN G & MARCELLA ANN	4304 IRA ST	LAS VEGAS NV 89130-2541			
18	13801211071	BLUMBERG JILL S	4401 CRIMSON LEAF DR	LAS VEGAS NV 89130-5114			
19	13801310016	BOSWELL JOSEPH	HAMMOND JESSICA	5704 PATRICIA AVE	LAS VEGAS NV 89130-2515		
20	13801211069	BOYAKINS GREGORY D	6700 ROSE PETAL AVE	LAS VEGAS NV 89130-1686			
21	13801311011	BOYER PAUL & TAMMIE	5420 DOC HOLIDAY AVE	LAS VEGAS NV 89130-2527			
22	13801301003	BROWN DIANA	GODFREY JEFFERY JASON	P O BOX 572048	LAS VEGAS NV 89157		
23	13801402001	BULMER JOHN E & MELINDA M	5691 DIMICK AVE	LAS VEGAS NV 89130-2524			
24	13801310013	BURGENER DOUGLAS J	4313 IRA ST	LAS VEGAS NV 89130			
25	13801312005	C F T DEVELOPMENTS L L C	1683 WALNUT GROVE AVE	ROSEMEAD CA 91770-3711			
26	13801211089	CARLSON DAVID B	4406 LA REINA CIR	LAS VEGAS NV 89130-5100			
27	13801211085	CARTIER BARBARA	181 OFARRELL ST #508	SAN FRANCISCO CA 94102-2217			
28	13801213005	CAZDEN HEATHER	4405 CAMPO CIR	LAS VEGAS NV 89130			

	PARCEL#	OWNER	ADDRESS1	ADDRESS2	ADDRESS3	ADDRESS4	ADDRESS5
29	13801304007	CHILESE FAMILY REVOCABLE LIV TR	CHILESE JOHN F & BAMBI L TRS	5711 HICKAM AVE	LAS VEGAS NV 89130-2554		
30	13801404001	CONNOR MARTHA J	881 GLENBARD RD	GLEN ELLYN IL 60137-6472			
31	13801312004	CONSTRUCTION GROUP INC	4405 MEDLEY PL	ENCINO CA 91316- 4344			
32	13801211083	COOPER SUSAN E	4405 LA REINA CIR	LAS VEGAS NV 89130-5101			
33	13801304003	CORRAL CARMEN LUNA	1115 FAIRCHILD ST	LAS VEGAS NV 89110			
34	13801310007	COX FAMILY TRUST	COX DONALD H & KERRY L TRS	5709 PATRICIA AVE	LAS VEGAS NV 89130-2526		
35	13801310010	CREWDSON DEBRA A	5700 PATRICIA AVE	LAS VEGAS NV 89130-2515			
36	13801310027	DAVIDSON JILL RICHARDINE & TERRY	DAVIDSON JILL & TERRY TRS	4304 IVORY CIR	LAS VEGAS NV 89130-2539		
37	13801301002	DAY DALE SPENCER &/OR FRANKIE L	4240 KISHA CT	LAS VEGAS NV 89130-2518			
38	13801303003	DELACRUZ MODESTO & DONNA M	5413 HICKAM AVE	LAS VEGAS NV 89130-2525			
39	13801306002	DELANEY BRIAN J & ANITA J	5412 HICKAM	LAS VEGAS NV 89130-2520			
40	13801213007	DELMURO MARIO & ARACELI D	4400 CAMPO CIR	LAS VEGAS NV 89130-5287			
41	13801310015	EHLERS PAUL R & LEILANI K	5708 PATRICIA AVE	LAS VEGAS NV 89130-2515			
42	13801310018	EITEL FAMILY REVOCABLE TRUST	EITEL DELBERT L & CLAUDIE CO-TRS	P O BOX 338	KAYCEE WY 82639		

	PARCEL#	OWNER	ADDRESS1	ADDRESS2	ADDRESS3	ADDRESS4	ADDRESS5
43	13801211091	ENGLAND DON L LIVING TRUST	ENGLAND DON L TRS	4410 LA REINA CIR	LAS VEGAS NV 89130-5100		
44	13801310002	ENNEPER GREGORY E REV LIV TR	ENNEPER GREGORY E TRS	4308 IRA ST	LAS VEGAS NV 89130-2541		
45	13801305006	FAILLOS CARLOS A	4201 HELEN AVE	LAS VEGAS NV 89130-2530			
46	13801211068	FLANNIGAN PATRICK J	4413 CRIMSON LEAF DR	LAS VEGAS NV 89130			
47	13801301009	FULLER REBECCA	4232 BLACKMON CIR	LAS VEGAS NV 89130			
48	13801310012	GALINDO JORGE A BRACAMONTES	4320 LEON AVE	LAS VEGAS NV 89108			
49	13801310036	GARNICA AMADO RAMIREZ	5408 BAT MASTERSON CIR	LAS VEGAS NV 89130-2538			
50	13801301007	GLAZE RUSSELL LEE & LINDA GAIL	4232 KISHA CT	LAS VEGAS NV 89130-2518			
51	13801310034	GOLTRA FAMILY TRUST	GOLTRA JEFFREY G & HOLLY M TRS	5416 BAT MASTERSON CIR	LAS VEGAS NV 89130-2538		
52	13801301005	GONZALEZ LAURA	CORNETT DENNIS E	4241 BLACKMON CIR	LAS VEGAS NV 89130-2519		
53	13801211094	GREENWOOD FAMILY TRUST	GREENWOOD JANET M TRS	4416 LA REINA CIR	LAS VEGAS NV 89130-5100		
54	13801402006	GRIMES VICKY J	4135 HELEN	LAS VEGAS NV 89130-2507			
55	13801304006	HAMILTON SIVASOTHI & MICHAEL K	5721 HICKAM AVE	LAS VEGAS NV 89130-2554			
56	13801402002	HANSEN MARIANNE	3805 W RED COACH AVE	NORTH LAS VEGAS NV 89031-0142			

	PARCEL#	OWNER	ADDRESS1	ADDRESS2	ADDRESS3	ADDRESS4	ADDRESS5
57	13801402012	HARWOOD JOHN	5636 BRODERICK AVE	LAS VEGAS NV 89130-2516			
58	13801304009	HAYGOOD WILLIAM L & SHAENA R	4225 LEON AVE	LAS VEGAS NV 89130-2535			
59	13801211082	HERNANDEZ EDGAR	4407 LA REINA CIR	LAS VEGAS NV 89130-5101			
60	13801306005	HOLLIS TYSON	4200 N HELEN AVE	LAS VEGAS NV 89130-2532			
61	13801310022	HOPKINS HUEY & JEANNETTE P	4321 LEON AVE	LAS VEGAS NV 89130-2542			
62	13801310029	HUNTER TIMOTHY L II & ROCHELLE A	4301 IVORY CIR	LAS VEGAS NV 89130-2545			
63	13801305004	JAEHN FRANK & JULIE R	5647 HICKAM AVE	LAS VEGAS NV 89130-2521			
64	13801211070	JIANG GINGER J	YAO TONY K	73-15 192ND ST	FRESH MEADOWS NY 11366-1857		
65	13801311003	JONES MARK	5409 BAT MASTERTON CIR	LAS VEGAS NV 89130-2544			
66	13801311008	JONES RONALD W & CAROL O	23974 CO RD 24	LAJUNTA CO 81050-9775			
67	13801301013	K L Y L L C	980 TOURNAMENT DR	HILLSBORROUGH CA 94010-7428			
68	13801211103	KAN MAN YEE	13065 EL MORADO ST	LA MIRADA CA 90638-3449			
69	13801310033	KEENAN THOMAS & PAMELA FAMILY TR	KEENAN THOMAS J & PAMELA CO-TRS	4317 IVORY CIR	LAS VEGAS NV 89130-2545		
70	13801211097	KENNEDY LAURENCE	4417 INEZ DR	LAS VEGAS NV 89130-5119			

	PARCEL#	OWNER	ADDRESS1	ADDRESS2	ADDRESS3	ADDRESS4	ADDRESS5
71	13801310023	KIRKER WILLIAM J & AVIS L REV TR	KIRKER WILLIAM J & AVIS L TRS	4320 IVORY CIR	LAS VEGAS NV 89130-2539		
72	13801211067	KLINE TIMOTHY DAVID	4417 CRIMSON LEAF DR	LAS VEGAS NV 89130-5114			
73	13801301008	KNOBLOCK WALTER F & SANDRA A	4233 KISHA CT	LAS VEGAS NV 89130-2518			
74	13801402009	KRAFT KEVIN	200 S JONES	LAS VEGAS NV 89107			
75	13801212009	L K Y INC	4400 N JONES	LAS VEGAS NV 89130-2304			
76	13801211076	LAMARCA MICHAEL	4416 CRIMSON LEAF DR	LAS VEGAS NV 89130-5113			
77	13801211075	LUIKART MICHAEL D	WADE-LUIKART G J	4412 CRIMSON LEAF DR	LAS VEGAS NV 89130-5113		
78	13801403001	LYTLE JEFFREY KENT & KRISTIE D	5423 DIMICK AVE	LAS VEGAS NV 89130-2551			
79	13801402008	MANN STEPHEN T & CONNIE L	4123 HELEN AVE	LAS VEGAS NV 89130-2507			
80	13801303005	MAUPIN OLIVER S & SONNY	1720 SILVER AVE	LAS VEGAS NV 89102-2427			
81	13801310028	MCATEE JILL MARIE & SCOTT	4300 IVORY CIR	LAS VEGAS NV 89130-2539			
82	13801304010	MCGUIRE DARRYL W	10415 ERICAS EDEN ST	LAS VEGAS NV 89131-1507			
83	13801310008	MCPMAHON MARIANNE	5705 PATRICIA AVE	LAS VEGAS NV 89130			
84	13801310031	MERCADO MARVIN MEJIA	4309 IVORY CIR	LAS VEGAS NV 89130-2545			

	PARCEL#	OWNER	ADDRESS1	ADDRESS2	ADDRESS3	ADDRESS4	ADDRESS5
85	13801211074	MEZA ERIC J	4517 RED CIDER LANE	LAS VEGAS NV 89130-5153			
86	13801304004	MINER'S GOLD FAMILY L P	5783 HICKAM AVE	LAS VEGAS NV 89130-2512			
87	13801402005	MIRANDA MANLEO	6940 SENTON AVE	LAS VEGAS NV 89108			
88	13801311002	MONTELONGO MARIA T & RENE	5413 BAT MASTERSON CIR	LAS VEGAS NV 89130-2544			
89	13801310001	MUHS WILLIAM TODD	4312 IRA ST	LAS VEGAS NV 89130			
90	13801211087	NAKAMA GARY & SUSAN	P O BOX 1671	UNAKAWAO HI 96768-1671			
91	13801211090	NELSON MICHAEL KEN & JUDY S	4408 LA REINA CIR	LAS VEGAS NV 89130-5100			
92	13801310004	NOBLE C III & K L REV LIV TR	4300 IRA ST	LAS VEGAS NV 89130-2541			
93	13801211086	OSTERHOUT GREGG A & VICKIE D	4400 LA REINA CIR	LAS VEGAS NV 89130-5100			
94	13801305003	OUTHOUMMOUNTRY LALI & PATRICK S	5657 HICKAM AVE	LAS VEGAS NV 89130-2521			
95	13801211084	OWENS MICHAEL & PAMELA V	4403 LA REINA CIR	LAS VEGAS NV 89130-5101			
96	13801401002	PARRIS ROBINSON EASTERN L L C	120 PRESIDENTIAL WAY #300	WOBURN MA 01801			
97	13801306001	PATRICK MICHAEL	4220 HELEN AVE	LAS VEGAS NV 89130-2532			
98	13801310017	PEARSON WILLIAM F & NAOMI E	517 W MARIPOSA AVE	EL SEGUNDO CA 90245			

	PARCEL#	OWNER	ADDRESS1	ADDRESS2	ADDRESS3	ADDRESS4	ADDRESS5
99	13801211102	PHILIPPUS JOHN L & KARLA W	4400 INEZ DR	LAS VEGAS NV 89130-5117			
100	13801211099	PLACENCIA FRANCISCO & DEBRA	4409 INEZ DR	LAS VEGAS NV 89130-5119			
101	13801310035	PORTNEY JEFFREY S	5412 BAT MASTERSON CIR	LAS VEGAS NV 89130			
102	13801310005	QUINTANILLA MIGUEL & T LIV TR	5717 PATRICIA AVE	LAS VEGAS NV 89130-2526			
103	13801403004	REED DARRYL W	4124 HELEN AVE	LAS VEGAS NV 89130-2508			
104	13801211092	RITZ MARILYN & DONALD	4412 LA REINA CIR	LAS VEGAS NV 89130-5100			
105	13801402003	ROGERS WILLIAM O & LOREEN L	5647 DIMICK AVE	LAS VEGAS NV 89130-2524			
106	13801213006	ROMERO DANIEL & BRENDA	4401 CAMPO CIR	LAS VEGAS NV 89130-5287			
107	13801305007	RUTLEDGE KYLE REED	5697 HICKAM AVE	LAS VEGAS NV 89130-2521			
108	13801211101	SAKAY ANTHONY R & BECKY L	4401 INEZ DR	LAS VEGAS NV 89130-5119			
109	13801304002	SAUCEDO ARTURO	SAUCEDO- CHAIDEZ ARTURO	5941 HICKAM AVE	LAS VEGAS NV 89130-2556		
110	13801310020	SCODWELL FAMILY TRUST	SCODWELL ANTON J & MARY A TRS	4313 LEON AVE	LAS VEGAS NV 89130-2542		
111	13801211093	SEMPADIAN MONICA A	4414 LA REINA CIR	LAS VEGAS NV 89130-5100			
112	13801303002	SHARP JIMMIE J & JAMIE L	5421 DOC HOLIDAY AVE	LAS VEGAS NV 89130-2528			

	PARCEL#	OWNER	ADDRESS1	ADDRESS2	ADDRESS3	ADDRESS4	ADDRESS5
113	13801301010	SHERIDAN-DAGENAIS MELANIE M	4233 BLACKMON CIR	LAS VEGAS NV 89130-2519			
114	13801402011	SKAARUP MARY	5646 BRODERICK AVE	LAS VEGAS NV 89130-2516			
115	13801301004	SMITH BRUCE A & CATHERINE A	4240 BLACKMON CIR	LAS VEGAS NV 89130-2519			
116	13801311010	SMITH TIMOTHY O & KATHRYN A	5416 DOC HOLIDAY AVE	LAS VEGAS NV 89130-2527			
117	13801404002	SOTO JOE	5655 BRODERICK AVE	LAS VEGAS NV 89130-2517			
118	13801211100	STRICKLAND ELIZABETH	4405 INEZ DR	LAS VEGAS NV 89130-5119			
119	13801211104	SUTHERLAND LISA D	4408 INEZ DR	LAS VEGAS NV 89130-5117			
120	13801310032	SWANN NATALIE J & CLARENCE D JR	4313 IVORY CIR	LAS VEGAS NV 89130-2545			
121	13801211073	TEMPLE STREET HOMES L L C	909 N SEPULVEDA BLVD #840	EL SEGUNDO CA 90245			
122	13801304008	THEOBALD SCOTT A	5701 HICKAM AVE	LAS VEGAS NV 89130-2554			
123	13801211105	THORNTON ASHTON K	4412 INEZ DR	LAS VEGAS NV 89130			
124	13801310026	TORRES JOSE LUIS	4308 IVORY CIR	LAS VEGAS NV 89130-2539			
125	13801310024	VAUGHAN FAMILY TRUST	VAUGHAN PATRICK L & PATRICIA M	4316 IVORY CIR	LAS VEGAS NV 89130-2539		
126	13801302004	VEGAS HOMES L L C	19333 COLLINS AVE #1708	SUNNY ISLES BEACH FL 33160- 2371			

	PARCEL#	OWNER	ADDRESS1	ADDRESS2	ADDRESS3	ADDRESS4	ADDRESS5
127	13801219004	WAL-MART REAL ESTATE BUSINESS TR	%PPTY TAX DEPT	P O BOX 8050	MS 0555	BENTONVILLE AR 72712-8055	
128	13801311009	WARBURTON MARTIN A & PAMELA D	5412 DOC HOLIDAY AVE	LAS VEGAS NV 89130-2527			
129	13801211072	WARE TERRY & CAMILLE	4400 CRIMSON LEAF DR	LAS VEGAS NV 89130-5113			
130	13801211098	WEST GEORGE M & EVA MARIA	4817 FOXWARREN CT	LAS VEGAS NV 89130-5371			
131	13801213004	WEST VALENTINE M & PATRICIA A	4409 CAMPO CIR	LAS VEGAS NV 89130-5287			
132	13801402010	WILLIAMS DAVID	7856 VANTAGE AVE	NORTH HOLLYWOOD CA 91605-2408			
133	13801402007	WILLIAMS FAMILY TRUST	FRANKEL MICHAEL TRS	%M FRANKEL TRS	10061 RIVERSIDE DR #732	TOLUCA LAKE CA 91602	
134	13801211088	WOLFE MONTY & CYNDI	4404 LA REINA CIR	LAS VEGAS NV 89130			
135	13801310006	WOOLMAN-FLYNN TRUST	WOOLMAN CRAIG E TRS	5713 PATRICIA AVE	LAS VEGAS NV 89130-2526		
136	13801310014	WROUGHTON FAMILY TRUST	WROUGHTON PATRICK R & SANDA TRS	4309 IRA ST	LAS VEGAS NV 89130-2540		
137	13801303004	YOUNG ODIS L	5409 HICKAM AVE	LAS VEGAS NV 89130-2525			