

City of Las Vegas  
Office Of The City Clerk  
495 South Main Street, 2<sup>nd</sup> Floor  
Las Vegas, Nevada 89101

PRSRT  
FIRST CLASS MAIL  
U.S. Postage  
**PAID**  
Las Vegas, NV  
Permit No. 1630

**Return Service Requested**  
**Official Notice of Public Hearing**

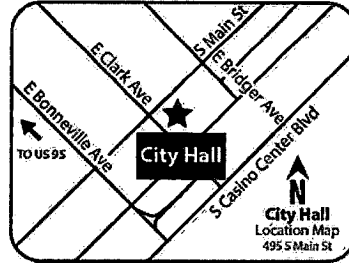

If you wish to file your protest or support on this request, check the appropriate box below and return this card in an envelope with postage to the Office Of The City Clerk at the address listed above or fax this side of this card to (702) 382-4803. If you would like to contact your Council Representative, please call (702) 229-6405.

I SUPPORT  
this Request

I OPPOSE  
this Request

Please use available blank space on card for your comments.

**VAR-66974 & WVR-66675**

City Council Meeting of 11/16/2016

## Application Information

VAR-66974 - VARIANCE RELATED TO GPA-64834, ZON-64833, VAR-66511 AND VAR-66512 - PUBLIC HEARING - APPLICANT/OWNER: FF SERIES HOLDINGS, LLC - For possible action on a request for a Variance TO ALLOW 35 PERCENT LOT COVERAGE WHERE 30 PERCENT IS THE MAXIMUM ALLOWED on 1.05 acres at the southeast corner of Azure Drive and Tenaya Way (APNs 125-27-610-001 and 024), U (Undeveloped) Zone [R (Rural Density Residential) General Plan Designation] [PROPOSED: O (Office)], Ward 6 (Ross) [PRJ-66419].

WVR-66675 - WAIVER RELATED TO GPA-64834, ZON-64833, VAR-66511, VAR-66512 AND VAR-66974 - PUBLIC HEARING - APPLICANT/ OWNER: FF SERIES HOLDINGS, LLC - For possible action on a request for a Waiver TO ALLOW NO STREETLIGHTS WHERE SUCH ARE REQUIRED FOR A PROPOSED CONVALESCENT CARE FACILITY/NURSING HOME on 1.05 acres at the southeast corner of Azure Drive and Tenaya Way (APNs 125-27-610-001 and 024), U (Undeveloped) Zone [R (Rural Density Residential) General Plan Designation] [PROPOSED: O (Office)], Ward 6 (Ross) [PRJ-66419].

Any and all interested persons may appear and be heard at said meeting, or may, prior thereto, file written objections thereto or approvals thereof with the City Clerk, 2<sup>nd</sup> Floor, City Hall, 495 South Main Street, Las Vegas, Nevada, 89101. For further information, please call (702) 229-6311 (TTY 7-1-1). **Note that postcards and comments received after an agenda posts will not be reflected online until after the meeting; however, the comments are made available to the members of the governing body for their consideration prior to the meeting.**

## Application Location

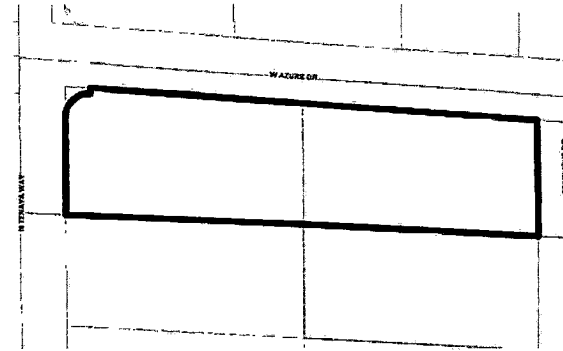

The proposed project may not pertain to the entire highlighted project site.

## Public Hearing Information

**Meeting:** City Council  
**Date:** *November 16, 2016*  
**Time:** 1:00 P.M.  
**Location:** City Council Chambers  
495 South Main Street, 2<sup>nd</sup> Floor  
Las Vegas, Nevada

**Report of All Selected Parcels****Case Number:**

VAR-66974, WVR-66675

**Printed On:** Tue: October 18, 2016

<u>Owner</u>	<u>Address</u>	<u>Parcel Number</u>
AFSHAR FATIMAH	6917 EMERALD TREE CT LAS VEGAS NV 89130-7909	12527510014
ALCAZAR ISIDORO	6033 RIO VISTA ST LAS VEGAS NV 89130	12527610054
ANDREWS ADRIAN J SR	7016 RIO GRANDE GORGE CT LAS VEGAS NV 89130-1012	12527511012
APPLE TAYLOR JON	7316 YOUNG DOE AVE LAS VEGAS NV 89130-7935	12527221032
AVEY MARK S & LINDA M	6224 PASEO DEL PUEBLO ST LAS VEGAS NV 89130-1033	12527511030
AZURE & TENAYA L L C	4427 E SUNSET RD HENDERSON NV 89014-2265	12527222012
AZURE CAPITAL MANAGEMENT L L C	7155 S RAINBOW BLVD #200 LAS VEGAS NV 89118	12527222015
AZURE DEVELOPMENT L L C	P O BOX 370246 LAS VEGAS NV 89137	12527222014
BAIG MICHAEL	5020 PORTRAITS PL LAS VEGAS NV 89149	12527610064
BAIG MICHAEL	5020 PORTRAITS PL LAS VEGAS NV 89149	12527610062
BAIG MICHAEL	5020 PORTRAITS PL LAS VEGAS NV 89149	12527610063
BARNES BRYCE W & JESSICA J	7125 W REGENA AVE LAS VEGAS NV 89130	12527503006
BLACKROCK UNIVERSAL L L C	3773 HOWARD HUGHES PKWY S TWR #5 LAS VEGAS NV 89169	12527610008
BLACKROCK UNIVERSAL L L C	3773 HOWARD HUGHES PKWY S TWR #5 LAS VEGAS NV 89169	12527610007
BONDS LYNN B REVOCABLE TRUST	BONDS LYNN B TRS P O BOX 26027 LAS VEGAS NV 89126-0027	12527610037
BOYLE CHRISTOPHER & MICHELE	9408 JEWEL LAKE AVE LAS VEGAS NV 89166	12527511022
BROAD HEAD TRUST	KEEFER SHELBY M & ROY K TRS 6101 GOLDEN SADDLE ST LAS VEGAS NV 89130-7913	12527612001
BRUNER MARILYN E	BRUNER MARILYN 2006 TRUST 44 ROOSEVELT CIR PALO ALTO CA 94306-4216	12527503010
BRYAN WANDA H FAMILY TRUST	HAHN LARRY L & CHRISTINA REV TR 6040 N MONTE CRISTO WY LAS VEGAS NV 89130-1046	12527203006
C A H 2014-2 BORROWER L L C	8665 E HARTFORD DR #200 SCOTTSDALE AZ 85255	12527220044
C B F LIVING TRUST	FLANIGAN CORA B & RACHEL E TRS 6067 RIO VISTA ST LAS VEGAS NV 89130-1003	12527610060
C B F LIVING TRUST	FLANIGAN CORA B & RACHEL E TRS 6067 RIO VISTA ST LAS VEGAS NV 89130-1003	12527610061
CAST IRON INVESTMENTS L L C	6545 WHISPERING SANDS DR LAS VEGAS NV 89131-2221	12527610023
CAVANESS JAMES E JR & JOHANNA M	6066 STARLIGHT DR LAS VEGAS NV 89130-1021	12527610032
CENTENNIAL PROPERTY L L C	561 DU FORT AVE HENDERSON NV 89002	12527113006
CHRISTENSEN AARON & AIMIE	7017 RANCHO DE TAOS CT LAS VEGAS NV 89130	12527511013
COFER TAS H REVOCABLE TRUST	COFER TAS H TRS 6072 MOONLIGHT DR LAS VEGAS NV 89130	12527610053
COLLINS MAURICE D & NAJLA J	7025 RANCHO DE TAOS CT LAS VEGAS NV 89130-1000	12527511015
COUEVAS PAMELA L REV LIV TR	COUEVAS PAMELA L TRS 2745 S WESTWIND LAS VEGAS NV 89146-5459	12527610067
COUEVAS PAMELA REVOCABLE LIV TR	COUEVAS PAMELA TRS 2745 S WESTWIND LAS VEGAS NV 89146-5459	12527610066
COUNTY OF CLARK(PUBLIC WORKS)	500 S GRAND CENTRAL PKWY LAS VEGAS NV 89155	12527102006
COUNTY OF CLARK(PUBLIC WORKS)	500 S GRAND CENTRAL PKWY LAS VEGAS NV 89155	12527102003

**Report of All Selected Parcels****Case Number:**

VAR-66974, WVR-66675

**Printed On:** Tue: October 18, 2016

<u>Owner</u>	<u>Address</u>	<u>Parcel Number</u>
COUNTY OF CLARK(PUBLIC WORKS)	500 S GRAND CENTRAL PKWY LAS VEGAS NV 89155	12527102005
COUNTY OF CLARK(PUBLIC WORKS)	500 S GRAND CENTRAL PKWY LAS VEGAS NV 89155	12527102009
COUNTY OF CLARK(PUBLIC WORKS)	500 S GRAND CENTRAL PKWY LAS VEGAS NV 89155	12527102001
COUNTY OF CLARK(PUBLIC WORKS)	500 S GRAND CENTRAL PKWY LAS VEGAS NV 89155	12527102008
COUNTY OF CLARK(PUBLIC WORKS)	500 S GRAND CENTRAL PKWY LAS VEGAS NV 89155	12527102004
COUNTY OF CLARK(PUBLIC WORKS)	500 S GRAND CENTRAL PKWY LAS VEGAS NV 89155	12527501007
COUNTY OF CLARK(PUBLIC WORKS)	500 S GRAND CENTRAL PKWY LAS VEGAS NV 89155	12527102007
CUBESMART L P	5 OLD LANCASTER RD MALVERN PA 19355	12527113005
CUBESMART L P	5 OLD LANCASTER RD MALVERN PA 19355	12527102010
CUEVAS ROBERTO	VACA GILBERTO 6104 BREEDERS CUP ST LAS VEGAS NV 89130-7917	12527220042
DISTINCTIVE HOMES TAOS EST III	5940 S RAINBOW BLVD #1006 LAS VEGAS NV 89118	12527511001
DISTINCTIVE HOMES TAOS EST III	5940 S RAINBOW BLVD #1006 LAS VEGAS NV 89118	12527511029
DISTINCTIVE HOMES TAOS EST III	5940 S RAINBOW BLVD #1006 LAS VEGAS NV 89118	12527511011
DISTINCTIVE HOMES TAOS EST III	5940 S RAINBOW BLVD #1006 LAS VEGAS NV 89118	12527511027
DISTINCTIVE HOMES TAOS EST III	5940 S RAINBOW BLVD #1006 LAS VEGAS NV 89118	12527511028
DURHAM FAMILY TRUST 2000	DURHAM ELISHA E & CORINNE L TRS 7116 RIO GRANDE GORGE CT LAS VEGAS NV 89130-1019	12527511008
ETTER SHARON L	6186 MOONLIGHT DR LAS VEGAS NV 89130-1044	12527610047
EWING JAMES L III	EWING APRIL 6075 NORTH TENAYA WAY LAS VEGAS NV 89130-1043	12527202004
EWING LEONARD & DIXIE FAMILY TRU	EWING JAMES L JR & DIXIE L TRS 6075 N TENAYA WAY LAS VEGAS NV 89130-1043	12527203004
F F SERIES HOLDINGS L L C	13861 ADARE MANOR LN FRISCO TX 75035	12527610024
F F SERIES HOLDINGS L L C	13861 ADARE MANOR LN FRISCO TX 75035	12527610005
F F SERIES HOLDINGS L L C	13861 ADARE MANOR LN FRISCO TX 75035	12527610001
F F SERIES HOLDINGS L L C	13861 ADARE MANOR LN FRISCO TX 75035	12527610004
F F SERIES HOLDINGS L L C	13861 ADARE MANOR LN FRISCO TX 75035	12527610006
F F SERIES HOLDINGS L L C	13861 ADARE MANOR LN FRISCO TX 75035	12527610021
F F SERIES HOLDINGS L L C	13861 ADARE MANOR LN FRISCO TX 75035	12527610020
FERREIRA LUIZ N	FENSTERMAKER LYNN F 6075 STARLIGHT DR LAS VEGAS NV 89130-1020	12527610069
FILOSI ELAINA V FAMILY TRUST	FILOSI ELAINA V TRS 7108 HOPLAND CIR LAS VEGAS NV 89129-6219	12527610003
FILOSI ELAINA V FAMILY TRUST	FILOSI ELAINA V TRS 7108 HOPLAND CIR LAS VEGAS NV 89129-6219	12527610022
FRAZIER CORAZON G	6016 CROWN JEWEL ST LAS VEGAS NV 89130-1086	12527220024
GATTI ROBERT D & JENNIFER	7145 W REGENA AVE LAS VEGAS NV 89130-1023	12527503004
GESLER FAMILY TRUST	GESLER JAMES M & SHARON 6048 STARLIGHT DR LAS VEGAS NV 89130-1021	12527610033

**Report of All Selected Parcels****Case Number:**

VAR-66974, WVR-66675

**Printed On:** Tue: October 18, 2016

<u>Owner</u>	<u>Address</u>	<u>Parcel Number</u>
GLATZ SAMIAO	7304 YOUNG DOE AVE LAS VEGAS NV 89130-7935	12527221029
GRAY DIANA S	7130 W AZURE DR LAS VEGAS NV 89130	12527503011
HALLER KRISTIE	6100 BREEDERS CUP ST LAS VEGAS NV 89130-7917	12527220041
HANCOX FAMILY TRUST	HANCOX TERESA & RAYMOND MICHAEL 7175 W REGENA AVE LAS VEGAS NV 89130	12527503002
HAYES GARY W	6109 STARLIGHT DR LAS VEGAS NV 89130-1049	12527610019
HAYGOOD ROBERT E	6141 N TENAYA WAY LAS VEGAS NV 89130	12527202005
HERSHEY HOLDINGS L L C SERIES A	7320 FALVO AVE LAS VEGAS NV 89131	12527503012
HOFF WILLIAM R II & LUPE S	6117 GOLDEN SADDLE ST LAS VEGAS NV 89130	12527612004
HOWARD MICHAEL ERIC	GLEDHILL HEATHER MICHELLE 7104 RANCHO DE TAOS CT LAS VEGAS NV 89130-1011	12527511023
HUDSON DAVID B TRUST	HUDSON DAVID B TRS 6014 STARLIGHT DR LAS VEGAS NV 89130-1021	12527610035
IMPERIAL C S I L L C	P O BOX 18946 GOLDEN CO 80402	12527221025
J V J TRUST	KILLEEN JULIE TRS 7017 RIO GRANDE GORGE CT LAS VEGAS NV 89130-1012	12527511003
JACKSON LARRY & V REV LIV FAM TR	JACKSON LARRY W & VIVIAN S TRS 6121 N TENAYA WY LAS VEGAS NV 89130-1007	12527202007
JOCO LORNABETH	SUGIMOTO JESSE C 8944 CLAIRTON CT LAS VEGAS NV 89117	12527612003
JOHNSON CRAIG	P O BOX 751132 LAS VEGAS NV 89136	12527203011
KASCHAK GINA M	7300 JOCKEY AVE LAS VEGAS NV 89130-7902	12527220025
KIM WILLIAM DONGWOOK	6105 GOLDEN SADDLE ST LAS VEGAS NV 89130-7913	12527612002
KING FUTT'S P F M L L C	5700 BOULDER HWY LAS VEGAS NV 89122-7204	12527221023
KODI BEAR CONCEPTS INC	6250 RIO VISTA ST LAS VEGAS NV 89130	12527502007
LABRANCHE JACQUES	6152 MOONLIGHT DR LAS VEGAS NV 89130-1044	12527610048
LACKER ROBERT P & MARY ANN	6065 N TENAYA WY LAS VEGAS NV 89130-1043	12527203005
LACY LEWIS DARRELL JR & STARLA S	7113 RANCHO DE TAOS CT LAS VEGAS NV 89130-1011	12527511018
LASSEK FLORIAN J & JOAN M	7312 YOUNG DOE AVE LAS VEGAS NV 89130-7935	12527221031
LAVOIE GERALD E	7300 YOUNG DOE LAS VEGAS NV 89130-7935	12527221028
LOUCKS GWEN L TRUST	LOUCKS GWEN LYNN TRS 7165 W REGENA AVE LAS VEGAS NV 89130-1023	12527503003
LUECK MARK & NANCY	REARDON K & KULAS K REV LIV TR 5301 GREAT HORIZON DR LAS VEGAS NV 89149	12527610002
M F E INC	955 TEMPLE VIEW LAS VEGAS NV 89110-2900	12527222009
MALKIEWICZ TRACY	6095 N TENAYA WAY LAS VEGAS NV 89130	12527203003
MARIANO CHARLES A & STEPHANIE Y	7009 RIO GRANDE GORGE CT LAS VEGAS NV 89130-1012	12527511002
MARTIN ANNETTE OCKER REV TR	SIRIANNI ANTHONY M TRS 5803 87TH ST LUBBOCK TX 79424	12527610071
MARTOCCIA MICHAEL L & PATRICIA J	6067 MOONLIGHT DR LAS VEGAS NV 89130-1016	12527610039
MAYS SARAH A	6012 CROWN JEWEL ST LAS VEGAS NV 89130-1086	12527220023

**Report of All Selected Parcels****Case Number:**

VAR-66974, WVR-66675

**Printed On:** Tue: October 18, 2016

<u>Owner</u>	<u>Address</u>	<u>Parcel Numbe</u>
MCTEAR DEVA S	7024 RANCHO DE TAOS CT LAS VEGAS NV 89130-1000	12527511024
MILLER EDWARD	137 WHITTIER AVE NORTH BABYLON NY 11703-4607	12527610034
MILLER JAMES C	CRUZE BONNIE J 6140 N MONTE CRISTO WY LAS VEGAS NV 89130-1001	12527202003
MONTERREY PLAZA L L C	8380 CARMEL RIDGE CT LAS VEGAS NV 89113	12527222011
MOSER DUANE	MANVILLE CHRISTINA J 6132 MOONLIGHT DR LAS VEGAS NV 89130-1044	12527610049
MOSER DUANE	MANVILLE CHRISTINA 6132 MOONLIGHT DR LAS VEGAS NV 89130	12527610070
MURILLO RAYMOND	7116 RANCHO DE TAOS CT LAS VEGAS NV 89130-1011	12527511020
NEVADA POWER COMPANY	P O BOX 98910 LAS VEGAS NV 89193-8910	12527101026
NGUYEN DANIEL J	NGO HANG 7112 RANCHO DE TAOS CT LAS VEGAS NV 89130-1011	12527511021
NIGERIAN ASSOCIATION OF LAS VEGA	840 S RANCHO DR LAS VEGAS NV 89128	12527610010
OBIAJULU RAYMOND & GERALDINE	11452 MORNING GROVE DR LAS VEGAS NV 89135	12527610009
PELECH TERRY M	FERNANDEZ ERWIN B 7109 RIO GRANDE GORGE CT LAS VEGAS NV 89130-1019	12527512001
POOLE ROBERT S	MOORE CHARME 6015 STARLIGHT DR LAS VEGAS NV 89130	12527610072
POPJOY JOHN T	2135 BLEDSOE LN LAS VEGAS NV 89156-5637	12527203002
PRISBREY JOSEPHINE & WALDO L	P O BOX 92504 HENDERSON NV 89009-2504	12527610031
PRISBREY JOSEPHINE &/OR WALDO L	P O BOX 92504 HENDERSON NV 89009-2504	12527610040
R R F T COMBINED ASSET L L C TEN	2510 W HORIZON RIDGE PKWY #230 HENDERSON NV 89052	12527203010
RAJCZI CHRISTOPHER & KRISTEE	P O BOX 485 FRIDAY HARBOR WA 98250	12527503005
RAVITSKI VLADISLAV	KAOURATE INDRA 415 RARITAN AVE STATEN ISLAND NY 10305-2345	12527221024
RECINTO WILLIAM P & MARITESS G	7016 RANCHO DE TAOS CT LAS VEGAS NV 89130-1000	12527511026
RINATO IGNACÍO & PAMELA F	7117 RIO GRANDE GORGE CT LAS VEGAS NV 89130-1019	12527512002
ROBINSON FAMILY REVOCABLE LIV TR	ROBINSON ROBIN A & DEBORAH L TRS 7280 TROPICAL PKWY LAS VEGAS NV 89130-1004	12527203009
RODRIGUEZ HERLINDA	6116 BREEDERS CUP ST LAS VEGAS NV 89130-7917	12527221027
ROGERS BRYANT & REBECCA	7105 RANCHO DE TAOS CT LAS VEGAS NV 89130-1011	12527511016
ROMEO JOSEPH	TALAVERA MARYANN 7301 BACKSTRETCH AVE LAS VEGAS NV 89130	12527220040
ROTH MARILYN	5039 PHILMAR AVE LAS VEGAS NV 89120-1575	12527610015
RYAN ROSLYN	7117 RANCHO DE TAOS CT LAS VEGAS NV 89130-1011	12527511019
S F R INVESTMENTS POOL 1 L L C	5030 PARADISE RD #B-214 LAS VEGAS NV 89119	12527220043
SANDOVAL SUSAN	7020 RANCHO DE TAOS CT LAS VEGAS NV 89130-1000	12527511025
SATTERTHWAITE MARA E & SHAWN S	7101 RIO GRANDE GORGE CT LAS VEGAS NV 89130-1019	12527511005
SCHANK KAREN	6049 MOONLIGHT DR LAS VEGAS NV 89130-1016	12527610038
SERETTA RICHARD D	6082 N MOONLIGHT DR LAS VEGAS NV 89130-1017	12527610052

**Report of All Selected Parcels****Case Number:**

VAR-66974, WVR-66675

**Printed On:** Tue: October 18, 2016

<u>Owner</u>	<u>Address</u>	<u>Parcel Number</u>
SHIELDS CHARLES H & GAIL W	7180 W AZURE DR LAS VEGAS NV 89130-1014	12527503008
SLIDER ELISA MARIE	6120 N RAINBOW BLVD LAS VEGAS NV 89130	12527610065
SMITH VALERIE L	7025 RIO GRANDE GORGE CT LAS VEGAS NV 89130	12527511004
SNELL CARROLL C	6445 WHISPERING SANDS LAS VEGAS NV 89131-2211	12527202006
TADA KAZUKO	8890 SPANISH RIDGE AVE LAS VEGAS NV 89148	12527221030
TEMPAZURE L L C	3311 S RAINBOW BLVD #225 LAS VEGAS NV 89146	12527610030
TEMPAZURE L L C	3311 S RAINBOW BLVD #225 LAS VEGAS NV 89146	12527610044
TEMPAZURE L L C	3311 S RAINBOW BLVD #225 LAS VEGAS NV 89146	12527610027
TEMPAZURE L L C	3311 S RAINBOW BLVD #225 LAS VEGAS NV 89146	12527610041
TEMPAZURE L L C	3311 S RAINBOW BLVD #225 LAS VEGAS NV 89146	12527610043
TEMPAZURE L L C	3311 S RAINBOW BLVD #225 LAS VEGAS NV 89146	12527610025
TEMPAZURE L L C	3311 S RAINBOW BLVD #225 LAS VEGAS NV 89146	12527610029
TEMPAZURE L L C	3311 S RAINBOW BLVD #225 LAS VEGAS NV 89146	12527610042
TEMPAZURE L L C	3311 S RAINBOW BLVD #225 LAS VEGAS NV 89146	12527610046
TEMPAZURE L L C	3311 S RAINBOW BLVD #225 LAS VEGAS NV 89146	12527610026
TEMPAZURE L L C	3311 S RAINBOW BLVD #225 LAS VEGAS NV 89146	12527610045
TEMPAZURE L L C	3311 S RAINBOW BLVD #225 LAS VEGAS NV 89146	12527610028
TENAYA VILLAGE L L C	1333 N BUFFALO DR #120 LAS VEGAS NV 89128	12527113007
TONG JACK	TONG ANN YIU PING REV LIV TR 6328 O'BANNON DR LAS VEGAS NV 89146-3043	12527203001
UNDERHILL BRUCE & DARLENE	6112 BREEDERS CUP ST LAS VEGAS NV 89130	12527221026
WEIFORD KEISHA V & DALE A	7021 RANCHO DE TAOS CT LAS VEGAS NV 89130-1000	12527511014
WISEMAN CRAIG & MARY	7160 W AZURE DR LAS VEGAS NV 89130	12527503009
ZAPPPIA FAMILY TRUST	ZAPPPIA WILLIAM & PAULA L TRS 7100 RIO GRANDE GORGE CT LAS VEGAS NV 89130-1019	12527511010