

City of Las Vegas  
Office Of The City Clerk  
495 South Main Street, 2<sup>nd</sup> Floor  
Las Vegas, Nevada 89101

PRSR  
FIRST CLASS MAIL  
U.S. Postage  
**PAID**  
Las Vegas, NV  
Permit No. 1630

**Return Service Requested**  
**Official Notice of Public Hearing**

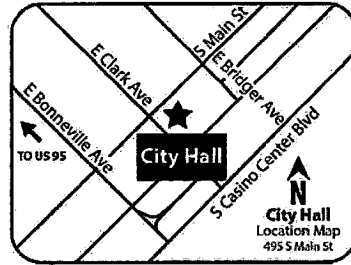

If you wish to file your protest or support on this request, check the appropriate box below and return this card in an envelope with postage to the Office Of The City Clerk at the address listed above or fax this side of this card to (702) 382-4803. If you would like to contact your Council Representative, please call (702) 229-6405.

I SUPPORT  
this Request

I OPPOSE  
this Request

Please use available blank space on card for your comments.

**VAR-66518 & VAR-66519**

City Council Meeting of 11/16/2016

## Application Information

VAR-66518 - VARIANCE RELATED TO GPA-64835 AND ZON-64836 - PUBLIC HEARING - APPLICANT/OWNER: FF SERIES HOLDINGS, LLC, ET AL - For possible action on a request for a Variance OF COMPLETE STREETS STANDARDS TO PROVIDE NO OFF-SITE IMPROVEMENTS ALONG STARLIGHT DRIVE FOR A PROPOSED CONVALESCENT CARE FACILITY/NURSING HOME on 3.28 acres located on the east side of Tenaya Drive, approximately 210 feet south of Azure Drive,(APNs 125-27-610-003 through 006, and 020 through 022), U (Undeveloped) Zone [R (Rural Density Residential) General Plan Designation] and O (Office) Zone [PROPOSED: O (Office)], Ward 6 (Ross) [PRJ-66416].

VAR-66519 - VARIANCE RELATED TO GPA-64835, ZON-64836 AND VAR-66518 - PUBLIC HEARING - APPLICANT/OWNER: FF SERIES HOLDINGS, LLC, ET AL - For possible action on a request for a Variance TO ALLOW A TEN-FOOT RESIDENTIAL ADJACENCY SETBACK WHERE 69 FEET IS REQUIRED FOR A PROPOSED CONVALESCENT CARE FACILITY/NURSING HOME on 3.28 acres located on the east side of Tenaya Drive, approximately 210 feet south of Azure Drive,(APNs 125-27-610-003 through 006, and 020 through 022), U (Undeveloped) Zone [R (Rural Density Residential) General Plan Designation] and O (Office) Zone [PROPOSED: O (Office)], Ward 6 (Ross) [PRJ-66416].

Any and all interested persons may appear and be heard at said meeting, or may, prior thereto, file written objections thereto or approvals thereof with the City Clerk, 2<sup>nd</sup> Floor, City Hall, 495 South Main Street, Las Vegas, Nevada, 89101. For further information, please call (702) 229-6311 (TTY 7-1-1). **Note that postcards and comments received after an agenda posts will not be reflected online until after the meeting; however, the comments are made available to the members of the governing body for their consideration prior to the meeting.**

## Application Location

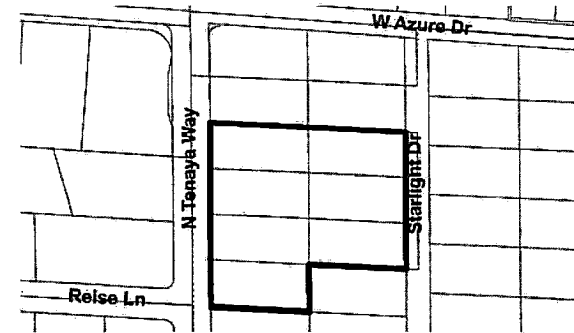

The proposed project may not pertain to the entire highlighted project site.

## Public Hearing Information

**Meeting:** City Council  
**Date:** *November 16, 2016*  
**Time:** 1:00 P.M.  
**Location:** City Council Chambers  
495 South Main Street, 2<sup>nd</sup> Floor  
Las Vegas, Nevada

**Report of All Selected Parcels****Case Number:**

VAR-66518, VAR-66519

**Printed On:** Tue: October 18, 2016

<u>Owner</u>	<u>Address</u>	<u>Parcel Number</u>
7209 PALATIAL AVE L L C	7260 W AZURE DR #140-404 LAS VEGAS NV 89130	12527715050
AFSHAR FATIMAH	6917 EMERALD TREE CT LAS VEGAS NV 89130-7909	12527510014
ALCAZAR ISIDORO	6033 RIO VISTA ST LAS VEGAS NV 89130	12527610058
ALCAZAR ISIDORO	6033 RIO VISTA ST LAS VEGAS NV 89130	12527610054
ALDINGER RONALD W & MARY A	6009 GOLDEN SADDLE ST LAS VEGAS NV 89130-7914	12527612040
ALFORD SAMUEL J JR	7301 MAIDEN RUN AVE LAS VEGAS NV 89130-1085	12527214025
ALMON ALBERT R	5936 ROUND CASTLE ST LAS VEGAS NV 89130-4947	12527312020
AMMON GRETHEL	5944 ROUND CASTLE ST LAS VEGAS NV 89130-4947	12527312018
ANDREWS ADRIAN J SR	7016 RIO GRANDE GORGE CT LAS VEGAS NV 89130-1012	12527511012
AVEY MARK S & LINDA M	6224 PASEO DEL PUEBLO ST LAS VEGAS NV 89130-1033	12527511030
AZURE & TENAYA L L C	4427 E SUNSET RD HENDERSON NV 89014-2265	12527222012
AZURE CAPITAL MANAGEMENT L L C	7155 S RAINBOW BLVD #200 LAS VEGAS NV 89118	12527222015
AZURE DEVELOPMENT L L C	P O BOX 370246 LAS VEGAS NV 89137	12527222014
BAIG MICHAEL	5020 PORTRAITS PL LAS VEGAS NV 89149	12527610062
BAIG MICHAEL	5020 PORTRAITS PL LAS VEGAS NV 89149	12527610063
BAIG MICHAEL	5020 PORTRAITS PL LAS VEGAS NV 89149	12527610064
BARKER WILLIAM SHANE	7317 YOUNG DOE AVE LAS VEGAS NV 89130-7935	12527221022
BARNES BRYCE W & JESSICA J	7125 W REGENA AVE LAS VEGAS NV 89130	12527503006
BLACKROCK UNIVERSAL L L C	3773 HOWARD HUGHES PKWY S TWR #5 LAS VEGAS NV 89169	12527610008
BLACKROCK UNIVERSAL L L C	3773 HOWARD HUGHES PKWY S TWR #5 LAS VEGAS NV 89169	12527610007
BONDS LYNN B REVOCABLE TRUST	BONDS LYNN B TRS P O BOX 26027 LAS VEGAS NV 89126-0027	12527610037
BOWLER NATHAN J	5940 SILVER HEIGHTS ST LAS VEGAS NV 89130-4948	12527312010
BOYLE CHRISTOPHER & MICHELE	9408 JEWEL LAKE AVE LAS VEGAS NV 89166	12527511022
BOYLE ROBERT TRUST	BOYLE ROBERT TRS 7104 DRAMATIC WAY LAS VEGAS NV 89130	12527712050
BRADSHAW TIMOTHY R	5949 ROUND CASTLE ST LAS VEGAS NV 89130	12527312014
BRAUN WILLIAM H	7304 JOCKEY AVE LAS VEGAS NV 89130-7902	12527220026
BROAD HEAD TRUST	KEEFER SHELBY M & ROY K TRS 6101 GOLDEN SADDLE ST LAS VEGAS NV 89130-7913	12527612001
BROOKS ELSA R & GARY J JR	5956 SILVER HEIGHTS ST LAS VEGAS NV 89130-4948	12527312006
BROWN FREDERICK C & ANN T	7200 PALATIAL AVE LAS VEGAS NV 89130-4919	12527715010
BRUNER MARILYN E	BRUNER MARILYN 2006 TRUST 44 ROOSEVELT CIR PALO ALTO CA 94306-4216	12527503010
BRYAN WANDA H FAMILY TRUST	HAHN LARRY L & CHRISTINA REV TR 6040 N MONTE CRISTO WY LAS VEGAS NV 89130-1046	12527203006
BURTON RONALD S	7020 PALATIAL AVE LAS VEGAS NV 89130-4917	12527715013

**Report of All Selected Parcels****Case Number:**

VAR-66518, VAR-66519

**Printed On:** Tue: October 18, 2016

<b><u>Owner</u></b>	<b><u>Address</u></b>	<b><u>Parcel Number</u></b>
C A H 2014-1 BORROWER L L C	8665 E HARTFORD DR #200 SCOTTSDALE AZ 85255	12527712047
C A H 2014-2 BORROWER L L C	8665 E HARTFORD DR #200 SCOTTSDALE AZ 85255	12527715048
C A H 2014-2 BORROWER L L C	8665 E HARTFORD DR #200 SCOTTSDALE AZ 85255	12527220044
C B F LIVING TRUST	FLANIGAN CORA B & RACHEL E TRS 6067 RIO VISTA ST LAS VEGAS NV 89130-1003	12527610059
C B F LIVING TRUST	FLANIGAN CORA B & RACHEL E TRS 6067 RIO VISTA ST LAS VEGAS NV 89130-1003	12527610061
C B F LIVING TRUST	FLANIGAN CORA B & RACHEL E TRS 6067 RIO VISTA ST LAS VEGAS NV 89130-1003	12527610060
C S H 2016-1 BORROWER L L C	8665 E HARTFORD DR #200 SCOTTSDALE AZ 85255	12527312002
CAI MINGHUA	1905 RED ROBIN CT LAS VEGAS NV 89134-6157	12527214024
CAMPO THOMAS & ROSEMARIE	7229 PALATIAL AVE LAS VEGAS NV 89130-4920	12527715055
CAMPOS FERNANDO RUBALCABA	RUBALCABA LILIANA G 7212 LONDON BRIDGE AVE LAS VEGAS NV 89130-1180	12527712043
CAST IRON INVESTMENTS L L C	6545 WHISPERING SANDS DR LAS VEGAS NV 89131-2221	12527610023
CASTILLO PAUL H & MARIA ELENA	7252 CREST PEAK AVE LAS VEGAS NV 89130-1082	12527311027
CAVANESS JAMES E JR & JOHANNA M	6066 STARLIGHT DR LAS VEGAS NV 89130-1021	12527610032
CENTENNIAL PROPERTY L L C	561 DU FORT AVE HENDERSON NV 89002	12527113006
CHAN DANIEL CHENG PIAW	7254 CREST PEAK AVE LAS VEGAS NV 89130-1082	12527311026
CHRISTENSEN AARON & AIMIE	7017 RANCHO DE TAOS CT LAS VEGAS NV 89130	12527511013
COFER TAS H REVOCABLE TRUST	COFER TAS H TRS 6072 MOONLIGHT DR LAS VEGAS NV 89130	12527610053
COLLINS MAURICE D & NAJLA J	7025 RANCHO DE TAOS CT LAS VEGAS NV 89130-1000	12527511015
CONKIEVICH LENIE FAMILY TRUST	7217 PALATIAL AVE LAS VEGAS NV 89130	12527715052
CONTRERAS JOHN	5928 ROUND CASTLE ST LAS VEGAS NV 89130-4947	12527312022
CORNFORD-LATHAM SHANNON LEE	JOHNSTON RICHARD D & SALLY J 7216 LONDON BRIDGE AVE LAS VEGAS NV 89130-1180	12527712044
COUEVAS PAMELA L REV LIV TR	COUEVAS PAMELA L TRS 2745 S WESTWIND LAS VEGAS NV 89146-5459	12527610067
COUEVAS PAMELA REVOCABLE LIV TR	COUEVAS PAMELA TRS 2745 S WESTWIND LAS VEGAS NV 89146-5459	12527610066
COUNTY OF CLARK(PUBLIC WORKS)	500 S GRAND CENTRAL PKWY LAS VEGAS NV 89155	12527102007
COUNTY OF CLARK(PUBLIC WORKS)	500 S GRAND CENTRAL PKWY LAS VEGAS NV 89155	12527501007
COUNTY OF CLARK(PUBLIC WORKS)	500 S GRAND CENTRAL PKWY LAS VEGAS NV 89155	12527102009
COUNTY OF CLARK(PUBLIC WORKS)	500 S GRAND CENTRAL PKWY LAS VEGAS NV 89155	12527102008
CUBESMART L P	5 OLD LANCASTER RD MALVERN PA 19355	12527113005
CUBESMART L P	5 OLD LANCASTER RD MALVERN PA 19355	12527102010
CUEVAS ROBERTO	VACA GILBERTO 6104 BREEDERS CUP ST LAS VEGAS NV 89130-7917	12527220042
DANYO EDWIN	95 WITMER RD YORK PA 17404-9629	12527220022
DIAZ SILVIA L	7224 LONDON BRIDGE AVE LAS VEGAS NV 89130-1182	12527712046

**Report of All Selected Parcels****Case Number:**

VAR-66518, VAR-66519

**Printed On:** Tue: October 18, 2016

<b><u>Owner</u></b>	<b><u>Address</u></b>	<b><u>Parcel Numbe</u></b>
DISTINCTIVE HOMES TAOS EST III	5940 S RAINBOW BLVD #1006 LAS VEGAS NV 89118	12527511028
DISTINCTIVE HOMES TAOS EST III	5940 S RAINBOW BLVD #1006 LAS VEGAS NV 89118	12527511027
DISTINCTIVE HOMES TAOS EST III	5940 S RAINBOW BLVD #1006 LAS VEGAS NV 89118	12527511029
DISTINCTIVE HOMES TAOS EST III	5940 S RAINBOW BLVD #1006 LAS VEGAS NV 89118	12527511011
DISTINCTIVE HOMES TAOS EST III	5940 S RAINBOW BLVD #1006 LAS VEGAS NV 89118	12527511001
DOEBLER COLLIN & DAWN STEPHANIE	5941 ROUND CASTLE ST LAS VEGAS NV 89130	12527312012
DOIN BUSINESS VEGAS STYLE L L C	7225 PALATIAL AVE LAS VEGAS NV 89130	12527715054
DUDAS KEVIN A	5929 MANSION ST LAS VEGAS NV 89130	12527715001
DURHAM FAMILY TRUST 2000	DURHAM ELISHA E & CORINNE L TRS 7116 RIO GRANDE GORGE CT LAS VEGAS NV 89130-1019	12527511008
EAGLE CREST L L L L C	280 PARK AVE NEW YORK NY 10017	12527302012
ERICKSON PAUL & TAMMY	5952 ROUND CASTLE ST LAS VEGAS NV 89130-4947	12527312016
ESCOTO ARTURO & CARMEN	4421 EL COMO WAY LAS VEGAS NV 89121-6645	12527715051
ETTER SHARON L	6186 MOONLIGHT DR LAS VEGAS NV 89130-1044	12527610047
EWING JAMES L III	EWING APRIL 6075 NORTH TENAYA WAY LAS VEGAS NV 89130-1043	12527202004
EWING LEONARD & DIXIE FAMILY TRU	EWING JAMES L JR & DIXIE L TRS 6075 N TENAYA WAY LAS VEGAS NV 89130-1043	12527203004
F F SERIES HOLDINGS L L C	13861 ADARE MANOR LN FRISCO TX 75035	12527610024
F F SERIES HOLDINGS L L C	13861 ADARE MANOR LN FRISCO TX 75035	12527610021
F F SERIES HOLDINGS L L C	13861 ADARE MANOR LN FRISCO TX 75035	12527610001
F F SERIES HOLDINGS L L C	13861 ADARE MANOR LN FRISCO TX 75035	12527610006
F F SERIES HOLDINGS L L C	13861 ADARE MANOR LN FRISCO TX 75035	12527610020
F F SERIES HOLDINGS L L C	13861 ADARE MANOR LN FRISCO TX 75035	12527610005
F F SERIES HOLDINGS L L C	13861 ADARE MANOR LN FRISCO TX 75035	12527610004
FACCHEN JOHANNES M	5937 ROYAL CASTLE LN LAS VEGAS NV 89130	12527715038
FARIAS CAROLINA	3417 LARGA AVE #7 LOS ANGELES CA 90039-1958	12527220045
FERREIRA LUIZ N	FENSTERMAKER LYNN F 6075 STARLIGHT DR LAS VEGAS NV 89130-1020	12527610069
FILOSI ELAINA V FAMILY TRUST	FILOSI ELAINA V TRS 7108 HOPLAND CIR LAS VEGAS NV 89129-6219	12527610003
FILOSI ELAINA V FAMILY TRUST	FILOSI ELAINA V TRS 7108 HOPLAND CIR LAS VEGAS NV 89129-6219	12527610022
FRAZIER CORAZON G	6016 CROWN JEWEL ST LAS VEGAS NV 89130-1086	12527220024
GATTI ROBERT D & JENNIFER	7145 W REGENA AVE LAS VEGAS NV 89130-1023	12527503004
GESLER FAMILY TRUST	GESLER JAMES M & SHARON 6048 STARLIGHT DR LAS VEGAS NV 89130-1021	12527610033
GHOLSON BRUCE E	THOMAS DEBRÁ J 2427 250TH ST NEW LONDON IA 52645-9208	12527610055
GLATZ SAMIAO	7304 YOUNG DOE AVE LAS VEGAS NV 89130-7935	12527221029

**Report of All Selected Parcels****Case Number:**

VAR-66518, VAR-66519

**Printed On:** Tue: October 18, 2016

<u>Owner</u>	<u>Address</u>	<u>Parcel Number</u>
GNADE JERRY M & REBECA R	5949 SILVER HEIGHTS ST LAS VEGAS NV 89130-4949	12527312003
GOODRICH HAROLD L & CYNTHIA D	6015 MOONLIGHT DR LAS VEGAS NV 89130-1016	12527610036
GRAY DIANA S	7130 W AZURE DR LAS VEGAS NV 89130	12527503011
GRIER ALEXANDER MARK & MARJORIE	7305 BACKSTRETCH AVE LAS VEGAS NV 89130	12527220039
GRIFFITH FAMILY TRUST	GRIFFITH MAUREEN L TRS 6013 CROWN JEWEL ST LAS VEGAS NV 89130-1087	12527220020
GUADRON ANGELA	MACIAS MARYLIN 5933 MANSION ST LAS VEGAS NV 89130	12527715002
HALL RODNEY W & VICTORIA L	7012 PALATIAL AVE LAS VEGAS NV 89130-4917	12527715014
HALLER KRISTIE	6100 BREEDERS CUP ST LAS VEGAS NV 89130-7917	12527220041
HANCOX FAMILY TRUST	HANCOX TERESA & RAYMOND MICHAEL 7175 W REGENA AVE LAS VEGAS NV 89130	12527503002
HAYES GARY W	6109 STARLIGHT DR LAS VEGAS NV 89130-1049	12527610019
HAYGOOD ROBERT E	6141 N TENAYA WAY LAS VEGAS NV 89130	12527202005
HERSHEY HOLDINGS L L C SERIES A	7320 FALVO AVE LAS VEGAS NV 89131	12527503012
HODGES BARBARA	5953 SILVER HEIGHTS ST LAS VEGAS NV 89130-4949	12527312004
HOFF WILLIAM R II & LUPE S	6117 GOLDEN SADDLE ST LAS VEGAS NV 89130	12527612004
HOLMES JOHN L JR & FILOMENA F	5944 SILVER HEIGHTS ST LAS VEGAS NV 89130-4948	12527312009
HOWARD MICHAEL ERIC	GLEDHILL HEATHER MICHELLE 7104 RANCHO DE TAOS CT LAS VEGAS NV 89130-1011	12527511023
HOWLAND CAROL & COHEN F REV TR	HOWLAND CAROL TRS 7233 PALATIAL AVE LAS VEGAS NV 89130-4920	12527715056
HUDSON DAVID B TRUST	HUDSON DAVID B TRS 6014 STARLIGHT DR LAS VEGAS NV 89130-1021	12527610035
IMPERIAL C S I L L C	P O BOX 18946 GOLDEN CO 80402	12527221025
J V J TRUST	KILLEEN JULIE TRS 7017 RIO GRANDE GORGE CT LAS VEGAS NV 89130-1012	12527511003
JACKSON LARRY & V REV LIV FAM TR	JACKSON LARRY W & VIVIAN S TRS 6121 N TENAYA WY LAS VEGAS NV 89130-1007	12527202007
JADEJA RAJENDRASINH B & NIYATI R	5925 MANSION ST LAS VEGAS NV 89130-1673	12527712049
JOCO LORNABETH	SUGIMOTO JESSE C 8944 CLAIRTON CT LAS VEGAS NV 89117	12527612003
JOHNSON CRAIG	P O BOX 751132 LAS VEGAS NV 89136	12527203011
JONES JOHN J & DOREATHER	225 RAPTORS VIEW AVE NORTH LAS VEGAS NV 89031-6821	12527311022
KASCHAK GINA M	7300 JOCKEY AVE LAS VEGAS NV 89130-7902	12527220025
KEYLOR KYLE B	5952 SILVER HEIGHTS ST LAS VEGAS NV 89130-4948	12527312007
KIM WILLIAM DONGWOOK	6105 GOLDEN SADDLE ST LAS VEGAS NV 89130-7913	12527612002
KING FUTT'S P F M L L C	5700 BOULDER HWY LAS VEGAS NV 89122-7204	12527221023
KING JOHN E & DAWN M	6013 GOLDEN SADDLE ST LAS VEGAS NV 89130-7914	12527612041
KOWALSKI CRAIG & MINJGIE	1905 RED ROBIN CT LAS VEGAS NV 89134-6157	12527715003
LABRANCHE JACQUES	6152 MOONLIGHT DR LAS VEGAS NV 89130-1044	12527610048

**Report of All Selected Parcels****Case Number:**

VAR-66518, VAR-66519

**Printed On:** Tue: October 18, 2016

<u>Owner</u>	<u>Address</u>	<u>Parcel Number</u>
LACKER ROBERT P & MARY ANN	6065 N TENAYA WY LAS VEGAS NV 89130-1043	12527203005
LACY LEWIS DARRELL JR & STARLA S	7113 RANCHO DE TAOS CT LAS VEGAS NV 89130-1011	12527511018
LARUE TODD	7232 PALATIAL AVE LAS VEGAS NV 89130-4919	12527715005
LASSEK FLORIAN J & JOAN M	7312 YOUNG DOE AVE LAS VEGAS NV 89130-7935	12527221031
LAVOIE GERALD E	7300 YOUNG DOE LAS VEGAS NV 89130-7935	12527221028
LONDON LAURIE REVOCABLE LIV TR	LONDON LAURIE TRS 7228 PALATIAL AVE LAS VEGAS NV 89130-4919	12527715006
LOUCKS GWEN L TRUST	LOUCKS GWEN LYNN TRS 7165 W REGENA AVE LAS VEGAS NV 89130-1023	12527503003
LOVE HAPPINESS & BEYOND L L C	9444 OLYMPIA FIELDS DR SAN RAMON CA 94583	12527715040
LUECK MARK & NANCY M F E INC	REARDON K & KULAS K REV LIV TR 5301 GREAT HORIZON DR LAS VEGAS NV 89149	12527610002
MALHOTRA KUNAL	955 TEMPLE VIEW LAS VEGAS NV 89110-2900	12527222009
MALKIEWICZ TRACY	SEPASSI MARJAN 501 BEAL #18B SAN FRANCISCO CA 94105-5023	12527312015
MARIANO CHARLES A & STEPHANIE Y	6095 N TENAYA WAY LAS VEGAS NV 89130	12527203003
MARTIN ANNETTE OCKER REV TR	7009 RIO GRANDE GORGE CT LAS VEGAS NV 89130-1012	12527511002
MARTOCCIA MICHAEL L & PATRICIA J	SIRIANNI ANTHONY M TRS 5803 87TH ST LUBBOCK TX 79424	12527610071
MAYS SARAH A	6067 MOONLIGHT DR LAS VEGAS NV 89130-1016	12527610039
MCCOID ANNELL RN LIVING TRUST	6012 CROWN JEWEL ST LAS VEGAS NV 89130-1086	12527220023
MCDEVITT PATRICK A	MCCOID ANNELL TRS 7200 LONDON BRIDGE AVE LAS VEGAS NV 89130-1180	12527712040
MCTEAR DEVA S	5941 MANSION ST LAS VEGAS NV 89130-1673	12527715004
MILLER EDWARD	7024 RANCHO DE TAOS CT LAS VEGAS NV 89130-1000	12527511024
MILLER JAMES C	137 WHITTIER AVE NORTH BABYLON NY 11703-4607	12527610034
MITCHELL LYNDA	CRUZE BONNIE J 6140 N MONTE CRISTO WY LAS VEGAS NV 89130-1001	12527202003
MONTALVO JOHN G & STACY	7308 JOCKEY AVE LAS VEGAS NV 89130-7902	12527220027
MONTERREY PLAZA L L C	7205 PALATIAL AVE LAS VEGAS NV 89130-4920	12527715049
MORAN ELMER & MARLENE LIV REV TR	8380 CARMEL RIDGE CT LAS VEGAS NV 89113	12527222011
MOSER DUANE	MORAN ELMER WAYNE & MARLENE TRS 7220 PALATIAL AVE LAS VEGAS NV 89130-4919	12527715007
MOSER DUANE	MANVILLE CHRISTINA 6132 MOONLIGHT DR LAS VEGAS NV 89130	12527610070
MUNGUIA-VARGAS LUIS MANUEL	MANVILLE CHRISTINA J 6132 MOONLIGHT DR LAS VEGAS NV 89130-1044	12527610049
MURILLO RAYMOND	DEMUNGUIA EDELMIRA LEAL LEAL 6015 RIO VISTA ST LAS VEGAS NV 89130	12527610057
MURRAY MARTHA L LIVING TRUST	7116 RANCHO DE TAOS CT LAS VEGAS NV 89130-1011	12527511020
NAKATANI BEN H & LENA	4925 N DAPPLE GRAY RD LAS VEGAS NV 89149-3539	12527312013
NELSON MARY LUCREZIA LIVING TR	7232 LONDON BRIDGE AVE LAS VEGAS NV 89130-1182	12527712048
	6005 GOLDEN SADDLE ST LAS VEGAS NV 89130-7914	12527612039

**Report of All Selected Parcels****Case Number:**

VAR-66518, VAR-66519

**Printed On:** Tue: October 18, 2016

<u>Owner</u>	<u>Address</u>	<u>Parcel Number</u>
NGUYEN DANIEL J	NGO HANG 7112 RANCHO DE TAOS CT LAS VEGAS NV 89130-1011	12527511021
NIGERIAN ASSOCIATION OF LAS VEGA	840 S RANCHO DR LAS VEGAS NV 89128	12527610010
OBIAJULU RAYMOND & GERALDINE	11452 MORNING GROVE DR LAS VEGAS NV 89135	12527610009
ORRICK FAMILY TRUST	ORRICK SAMUEL W & BETHANY ANN TR 4575 DEAN MARTIN DR #509 LAS VEGAS NV 89103	12527715012
PANDOLFI AYDEE	945 MONTGOMERY DR HERMOSA BEACH CA 90254-4038	12527311021
PELAN JOSEPH E	LEDFORD PATRICIA S 6525 CONVINTO CT LAS VEGAS NV 89131-3152	12527715009
PELECH TERRY M	FERNANDEZ ERWIN B 7109 RIO GRANDE GORGE CT LAS VEGAS NV 89130-1019	12527512001
POOLE ROBERT S	MOORE CHARME 6015 STARLIGHT DR LAS VEGAS NV 89130	12527610072
POPJOY JOHN T	2135 BLEDSOE LN LAS VEGAS NV 89156-5637	12527203002
PRISBREY JOSEPHINE & WALDO L	P O BOX 92504 HENDERSON NV 89009-2504	12527610031
PRISBREY JOSEPHINE &/OR WALDO L	P O BOX 92504 HENDERSON NV 89009-2504	12527610040
QUINN JERRY L & LORRAINE R	7108 PALATIAL AVE LAS VEGAS NV 89130	12527715011
R R F T COMBINED ASSET L L C TEN	2510 W HORIZON RIDGE PKWY #230 HENDERSON NV 89052	12527203010
RAJCZI CHRISTOPHER & KRISTEE	P O BOX 485 FRIDAY HARBOR WA 98250	12527503005
RAMIREZ JOSE ESTEBAN	MUNOZ MIRELLA ROSAS 5932 ROUND CASTLE ST LAS VEGAS NV 89130-4947	12527312021
RAVITSKI VLADISLAV	KAOURATE INDRA 415 RARITAN AVE STATEN ISLAND NY 10305-2345	12527221024
RECINTO WILLIAM P & MARITESS G	7016 RANCHO DE TAOS CT LAS VEGAS NV 89130-1000	12527511026
REED PATRICIA K LIVING TRUST	REED PATRICIA K TRS 7312 JOCKEY AVE LAS VEGAS NV 89130-7902	12527220028
RINATO IGNACIO & PAMELA F	7117 RIO GRANDE GORGE CT LAS VEGAS NV 89130-1019	12527512002
ROBINSON FAMILY REVOCABLE LIV TR	ROBINSON ROBIN A & DEBORAH L TRS 7280 TROPICAL PKWY LAS VEGAS NV 89130-1004	12527203009
RODRIGUEZ HERLINDA	6116 BREEDERS CUP ST LAS VEGAS NV 89130-7917	12527221027
RODRIGUEZ-CASTILLO YESENIA D	7309 BACKSTRETCH AVE LAS VEGAS NV 89130	12527220038
ROGERS BRYANT & REBECCA	7105 RANCHO DE TAOS CT LAS VEGAS NV 89130-1011	12527511016
ROMEO JOSEPH	TALAVERA MARYANN 7301 BACKSTRETCH AVE LAS VEGAS NV 89130	12527220040
ROTH MARILYN	5039 PHILMAR AVE LAS VEGAS NV 89120-1575	12527610015
RUNNION JASON P	5940 ROUND CASTLE ST LAS VEGAS NV 89130-4947	12527312019
RYAN ROSLYN	7117 RANCHO DE TAOS CT LAS VEGAS NV 89130-1011	12527511019
S B Y 2014-1 BORROWER L L C	9406 W LAKE MEAD BLVD #101 LAS VEGAS NV 89134	12527312017
S F R INVESTMENTS POOL 1 L L C	5030 PARADISE RD #B-214 LAS VEGAS NV 89119	12527220043
SAMORA ROBERT L & KATHLEEN M	7208 LONDON BRIDGE AVE LAS VEGAS NV 89130-1180	12527712042
SANCHEZ JOSE L & LUISA	7204 LONDON BRIDGE AVE LAS VEGAS NV 89130-1180	12527712041
SANDOVAL SUSAN	7020 RANCHO DE TAOS CT LAS VEGAS NV 89130-1000	12527511025

**Report of All Selected Parcels****Case Number:**

VAR-66518, VAR-66519

**Printed On:** Tue: October 18, 2016

<u>Owner</u>	<u>Address</u>	<u>Parcel Number</u>
SATTERTHWAITE MARA E & SHAWN S	7101 RIO GRANDE GORGE CT LAS VEGAS NV 89130-1019	12527511005
SCHANK KAREN	6049 MOONLIGHT DR LAS VEGAS NV 89130-1016	12527610038
SERETTA RICHARD D	6082 N MOONLIGHT DR LAS VEGAS NV 89130-1017	12527610052
SERWINSKI EDWARD S & MARY E LIVI	SERWINSKI MARY E TRS 7221 PALATIAL AVE LAS VEGAS NV 89130-4920	12527715053
SEVILLA PETER & SAKOWDUEN MEM BA	7212 PALATIAL AVE LAS VEGAS NV 89130	12527715008
SHELEY JENE & JOANNA	6005 CROWN JEWEL ST LAS VEGAS NV 89130-1087	12527214022
SHEPHERD WILLIAM	4525 E NEW YORK AVE LAS VEGAS NV 89104-5635	12527214023
SHIELDS CHARLES H & GAIL W	7180 W AZURE DR LAS VEGAS NV 89130-1014	12527503008
SLIDER ELISA MARIE	6120 N RAINBOW BLVD LAS VEGAS NV 89130	12527610065
SMITH VALERIE L	7025 RIO GRANDE GORGE CT LAS VEGAS NV 89130	12527511004
SNELL CARROLL C	6445 WHISPERING SANDS LAS VEGAS NV 89131-2211	12527202006
SOLOMON BRIAN H & DAWN MARIE	303 MAGNOLIA DR LAGUNA BEACH CA 92651	12527312008
SZUMILO ANDREW	7305 MAIDEN RUN AVE LAS VEGAS NV 89130-1085	12527214026
TADA KAZUKO	8890 SPANISH RIDGE AVE LAS VEGAS NV 89148	12527221030
TALBOT COREY	5937 ROUND CASTLE ST LAS VEGAS NV 89130-4947	12527312011
TARMANN FRED & PHYLLIS FAMILY TR	TARMANN FREDERICK & PHYLLIS TRS 35534 WOODBRIDGE PL FREMONT CA 94536-3378	12527311023
TEMPAZURE L L C	3311 S RAINBOW BLVD #225 LAS VEGAS NV 89146	12527610027
TEMPAZURE L L C	3311 S RAINBOW BLVD #225 LAS VEGAS NV 89146	12527610030
TEMPAZURE L L C	3311 S RAINBOW BLVD #225 LAS VEGAS NV 89146	12527610028
TEMPAZURE L L C	3311 S RAINBOW BLVD #225 LAS VEGAS NV 89146	12527610045
TEMPAZURE L L C	3311 S RAINBOW BLVD #225 LAS VEGAS NV 89146	12527610026
TEMPAZURE L L C	3311 S RAINBOW BLVD #225 LAS VEGAS NV 89146	12527610041
TEMPAZURE L L C	3311 S RAINBOW BLVD #225 LAS VEGAS NV 89146	12527610044
TEMPAZURE L L C	3311 S RAINBOW BLVD #225 LAS VEGAS NV 89146	12527610043
TEMPAZURE L L C	3311 S RAINBOW BLVD #225 LAS VEGAS NV 89146	12527610042
TEMPAZURE L L C	3311 S RAINBOW BLVD #225 LAS VEGAS NV 89146	12527610029
TEMPAZURE L L C	3311 S RAINBOW BLVD #225 LAS VEGAS NV 89146	12527610025
TEMPAZURE L L C	3311 S RAINBOW BLVD #225 LAS VEGAS NV 89146	12527610046
TEMPLE STREET HOMES L L C	909 N SEPULVEDA BLVD #840 EL SEGUNDO CA 90245	12527312005
TENAYA VILLAGE L L C	1333 N BUFFALO DR #120 LAS VEGAS NV 89128	12527113007
TONG JACK	TONG ANN YIU PING REV LIV TR 6328 O'BANNON DR LAS VEGAS NV 89146-3043	12527203001
TURNER EMILY C	5001 LIGHT SPRINGS AVE LAS VEGAS NV 89130-7052	12527610056

**Report of All Selected Parcels****Case Number:**

VAR-66518, VAR-66519

**Printed On:** Tue: October 18, 2016

<u>Owner</u>	<u>Address</u>	<u>Parcel Numbe</u>
UNDERHILL BRUCE & DARLENE	6112 BREEDERS CUP ST LAS VEGAS NV 89130	12527221026
V G A C FAMILY TRUST	GOREN VITALY TRS 7313 BACKSTRETCH AVE LAS VEGAS NV 89130	12527220037
VASANI SAMIR	BHAIDANI AMINA 1956 W 252ND ST LOMITA CA 90717	12527311025
VOGT WESLEY E & BARBARA A	6009 CROWN JEWEL LAS VEGAS NV 89130-1087	12527220021
WALKER CURTIS JOE	5932 TAJ MAHAL DR LAS VEGAS NV 89130-4916	12527715039
WARNECK SCOTT & MICHELE K	WARNECK SUSAN RAE 7266 CREST PEAK AVE LAS VEGAS NV 89130-1082	12527311020
WEIFORD KEISHA V & DALE A	7021 RANCHO DE TAOS CT LAS VEGAS NV 89130-1000	12527511014
WHITE PAMELA TRUST	WHITE PAMELA TRS 7258 CREST PEAK AVE LAS VEGAS NV 89130-1082	12527311024
WILCOX AARON & JULIA	7220 LONDON BRIDGE AVE LAS VEGAS NV 89130	12527712045
WILLIAMS SHARON L & JERRY D	6265 PARK ST LAS VEGAS NV 89149-2376	12527214021
WISEMAN CRAIG & MARY	7160 W AZURE DR LAS VEGAS NV 89130	12527503009
ZAPPIA FAMILY TRUST	ZAPPIA WILLIAM & PAULA L TRS 7100 RIO GRANDE GORGE CT LAS VEGAS NV 89130-1019	12527511010